

A.A.D.T. - 2022 = 10354
A.A.D.T. - 2032 = 12019
D.H.V. = 6.5%
T = 14%
V = 35-55 M.P.H.

NO RIGHT OF WAY ACQUISITION

	EXISTING	NEW
BUILDINGS AND STRUCTURES		
GUARD RAIL		
CONCRETE RIGHT-OF-WAY MARKER		
STEEL RIGHT-OF-WAY MARKER		
LOCATION SURVEY MARKER		
UTILITIES		
FIBER OPTICS	— FO —	— FO —
OVERHEAD TELEPHONE	— ○ —	— ● —
UNDERGROUND TELEPHONE	— T —	— T —
OVERHEAD POWER	— □ —	— ■ —
UNDERGROUND POWER	— P —	— P —
GAS	— G —	— G —
WATER	— W —	— W —
MANHOLE		SAN
FIRE HYDRANT		HYD
WATER VALVE		WV
WATER METER		WM
DROP INLET		DI
DITCH BLOCK		
GROUND MOUNTED SIGN		SIGN
LIGHT POLE		
H-FRAME POWER POLE		
TELEPHONE PEDESTAL		PED
FENCE		
CHAIN LINK		
WOVEN WIRE		
GATE POST		
BENCHMARK		BM

MISSOURI HIGHWAYS AND TRANSPORTATION COMMISSION
PLANS FOR PROPOSED
STATE HIGHWAY
CLAY COUNTY

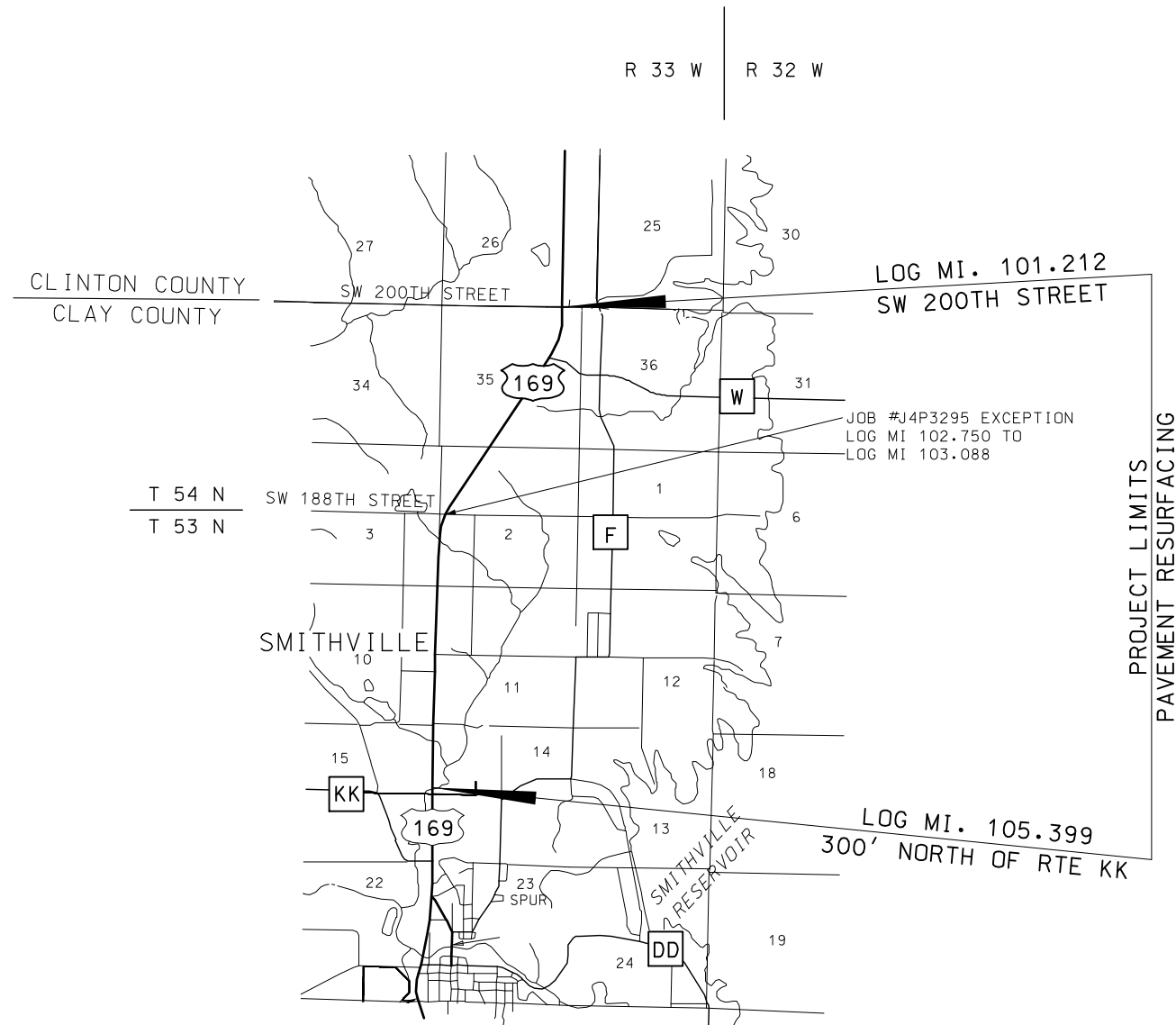

THE EXISTENCE AND APPROXIMATE LOCATION OF UTILITY FACILITIES KNOWN TO EXIST, AS SHOWN ON THE PLANS, ARE BASED ON THE BEST INFORMATION AVAILABLE TO THE COMMISSION AT THIS TIME. THIS INFORMATION IS PROVIDED BY THE COMMISSION "AS-IS" AND THE COMMISSION EXPRESSLY DISCLAIMS ANY REPRESENTATION OR WARRANTY AS TO THE COMPLETENESS, ACCURACY, OR SUITABILITY OF THE INFORMATION FOR ANY USE. RELIANCE UPON THIS INFORMATION IS DONE AT THE RISK AND PERIL OF THE USER, AND THE COMMISSION SHALL NOT BE LIABLE FOR ANY DAMAGES THAT MAY ARISE FROM ANY ERROR IN THE INFORMATION. IT IS, THEREFORE, THE RESPONSIBILITY OF THE CONTRACTOR TO VERIFY THE EXISTENCE, LOCATION AND STATUS OF ANY FACILITY. SUCH VERIFICATION INCLUDES DIRECT CONTACT WITH THE LISTED UTILITIES.

TITLE SHEET -----	1
TYPICAL SECTIONS (TS) (4 SHEETS)---	2
QUANTITIES (QU) (4 SHEETS)-----	3
SPECIAL SHEETS (SS)-----	4
TRAFFIC CONTROL SHEETS (TC)-----	5-12

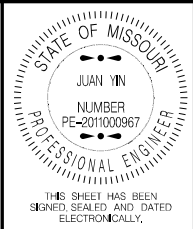

DATE PREPARED 7/9/2021	
ROUTE 169	STATE MO
DISTRICT KC	SHEET NO. 1

COUNTY	CLAY
--------	------

JOB NO.
J4S3340

CONTRACT ID.

PROJECT NO.

BRIDGE NO.

[illegible]

```

BEGINNING OF PROJECT      SB LOG MI. 101.212
END OF PROJECT            SB LOG MI. 105.399

APPARENT LENGTH                      22107.36  FEET

EQUATIONS AND EXCEPTIONS:

JOB #J4P3295
LOG MI 102.750 - LOG MI 103.088          1785  FEET

```

FOR INFORMATION ONLY	
ESTIMATED DISTURBED ACRES	0 ACRES

MISSOURI HIGHWAYS AND TRANSPORTATION COMMISSION

MoDOT

105 WEST CAPITOL
JEFFERSON CITY, MO 65102
1-888-ASK-MODOT (1-888-275-6636)

IF A SEAL IS PRESENT ON THIS SHEET IT HAS BEEN ELECTRONICALLY SEALED AND DATED.

ESTIMATE FACTORS	
FOR INFORMATION ONLY	
BP-1	1.993 TONS/YD ³
BITUMINOUS BIT BASE	2.006 TONS/YD ³
TACK COAT	0.1 GAL/YD ²
PERMANENT AGGREGATE EDGE TREATMENT	2 TONS/YD ³

NOTE: SAFETY EDGE SHALL BE INCLUDED

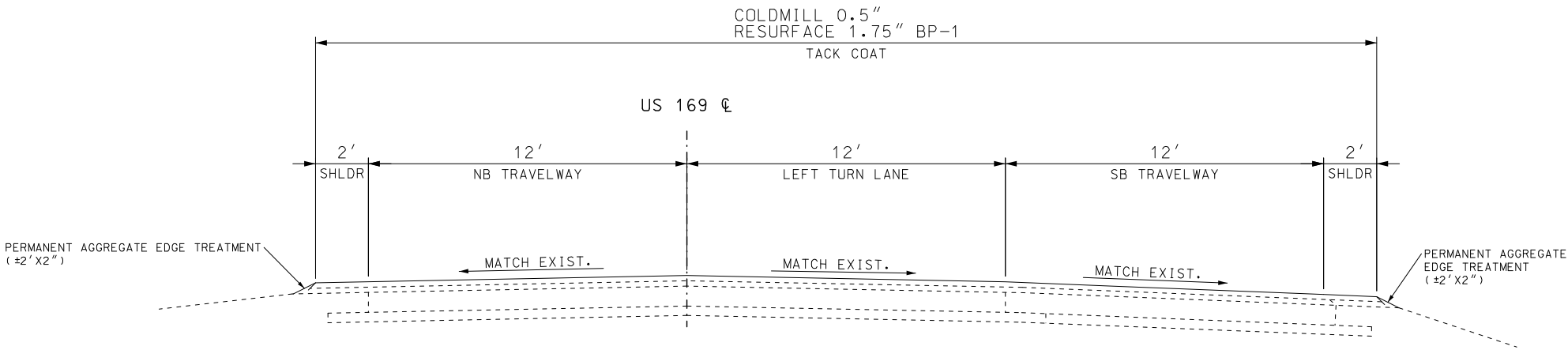

TYPICAL SECTION
SB LOG MI. 101.499 TO LOG MI. 101.610

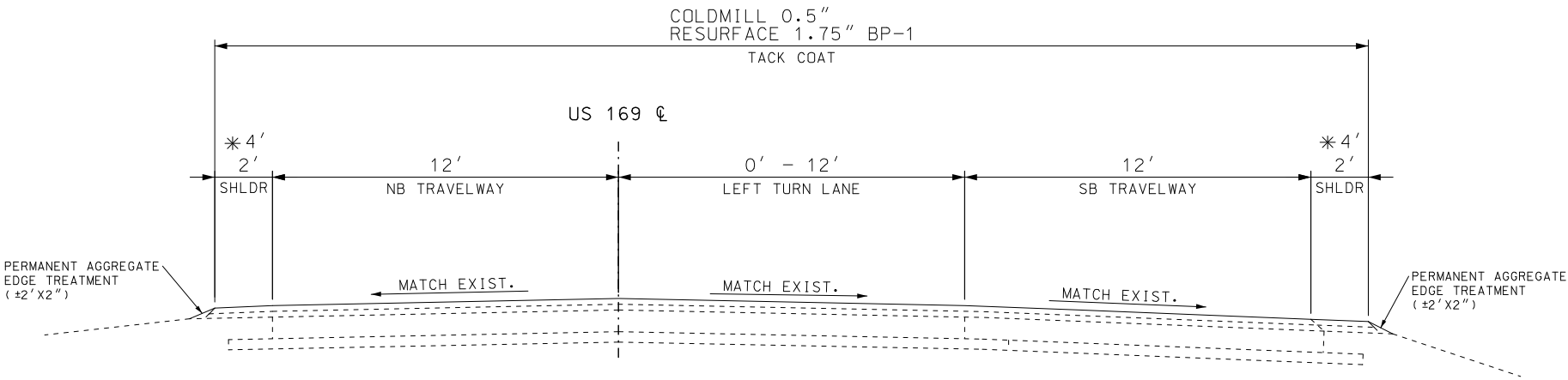

TYPICAL SECTION
SB LOG MI. 101.469 TO LOG MI. 101.499
* SB LOG MI. 105.339 TO LOG MI. 105.399

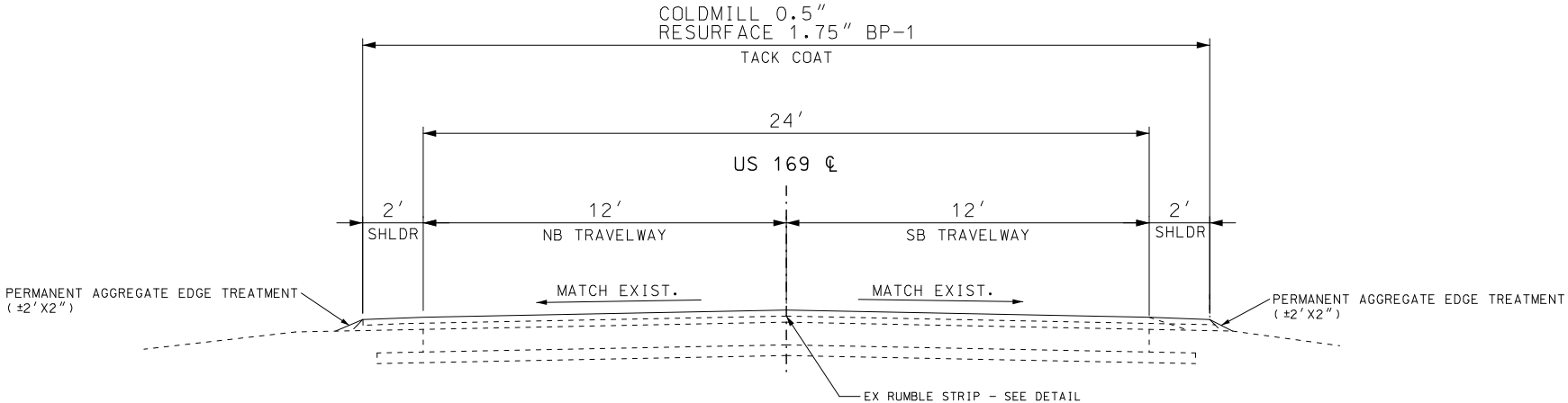

TYPICAL SECTION
SB LOG MI. 101.212 TO LOG MI. 101.469

NOT TO SCALE

ROUTE US 169
TYPICAL SECTION
SHEET 1 OF 4

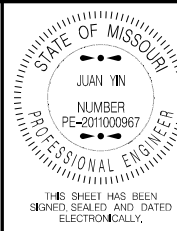

DATE PREPARED 8/26/2021	
ROUTE 169	STATE MO
DISTRICT KC	SHEET NO. 2
COUNTY CLAY	
JOB NO. J4S3340	
CONTRACT ID.	
PROJECT NO.	
BRIDGE NO.	

DATE	DESCRIPTION

MISSOURI HIGHWAYS AND TRANSPORTATION COMMISSION

105 WEST CAPITOL
JEFFERSON CITY, MO 65102
1-888-ASK-MODOT (1-888-275-6636)

IF A SEAL IS PRESENT ON THIS SHEET IT HAS BEEN ELECTRONICALLY SEALED AND DATED.

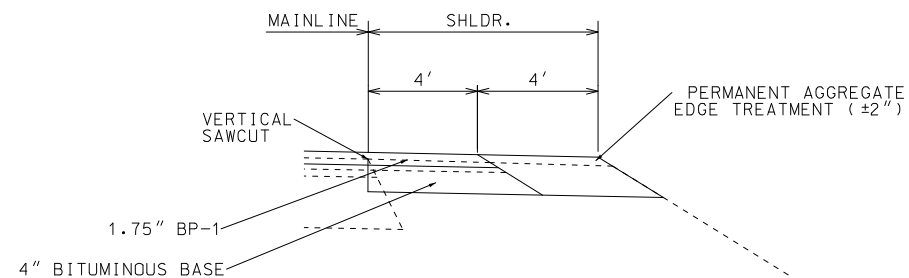
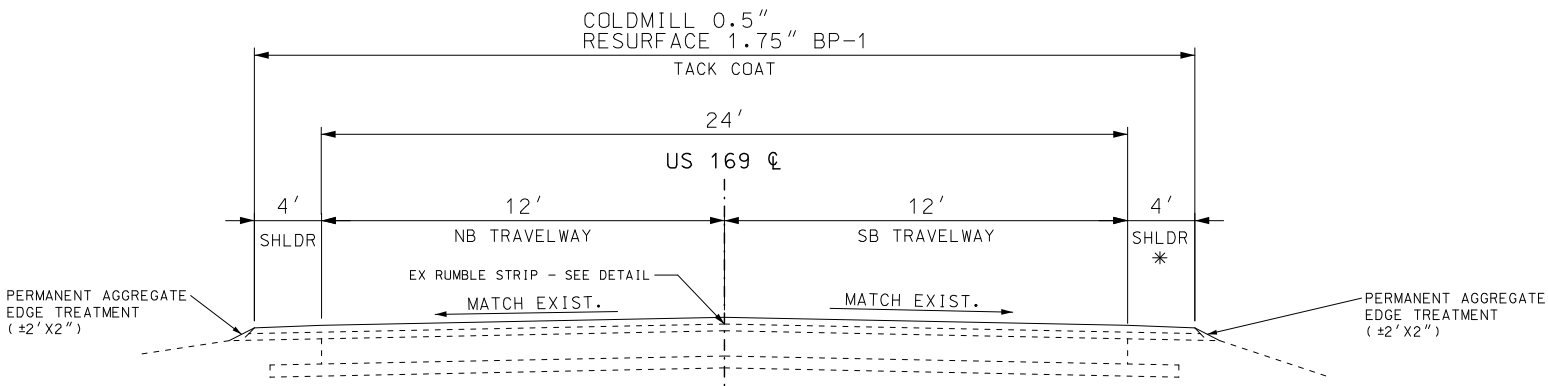

* SHOULDER REPAIR
NOTE:
LOG MI. 104.371 TO LOG MI. 104.447
EXACT LOCATION TO BE DETERMINED BY THE ENGINEER
PAVE 1 1/4" BP-1 MONOLITHICALLY WITH MAINLINE PAVEMENT

TYPICAL SECTION

SB LOG MI. 101.670 TO SB LOG MI. 102.000
SB LOG MI. 102.141 TO SB LOG MI. 102.750
SB LOG MI. 103.158 TO SB LOG MI. 103.298
SB LOG MI. 103.379 TO SB LOG MI. 103.959
SB LOG MI. 104.059 TO SB LOG MI. 104.880

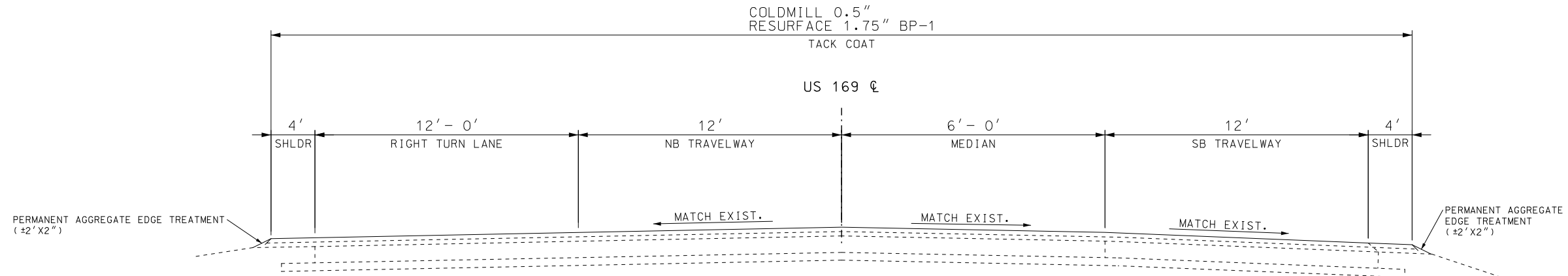

TYPICAL SECTION

SB LOG MI. 101.640 TO SB LOG MI. 101.670

NOTE: SAFETY EDGE SHALL BE INCLUDED

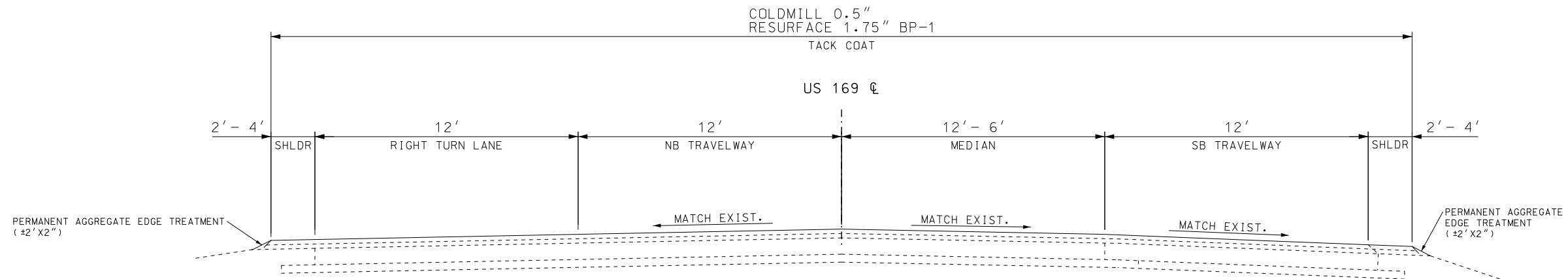

TYPICAL SECTION

SB LOG MI. 101.610 TO SB LOG MI. 101.640

ROUTE US 169
TYPICAL SECTION
SHEET 2 OF 4

NOT TO SCALE

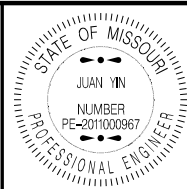

DATE PREPARED
7/9/2021

ROUTE 169 STATE MO

DISTRICT KC SHEET NO. 2

COUNTY CLAY

JOB NO. J4S3340

CONTRACT ID.

PROJECT NO.

BRIDGE NO.

DESCRIPTION	DATE

MISSOURI HIGHWAYS AND TRANSPORTATION COMMISSION

105 WEST CAPITOL
JEFFERSON CITY, MO 65102
1-888-ASK-MODOT (1-888-275-6636)

MoDOT

IF A SEAL IS PRESENT ON THIS SHEET IT HAS BEEN ELECTRONICALLY SEALED AND DATED.

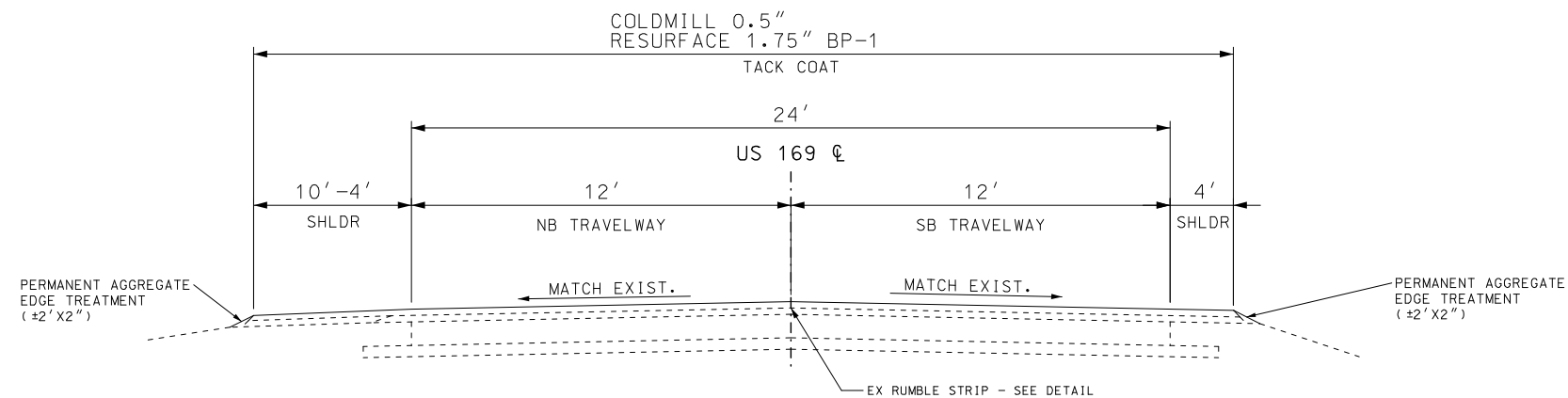

TYPICAL SECTION
SB LOG MI. 102.121 TO SB LOG MI. 102.141

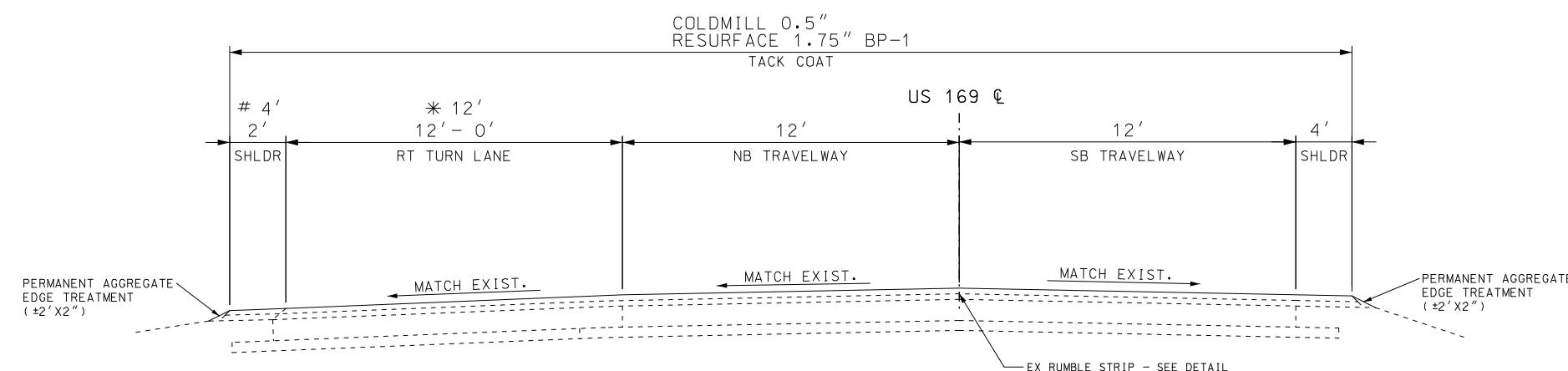

TYPICAL SECTION

- * SB LOG MI. 103.088 TO SB LOG MI. 103.118
- SB LOG MI. 103.118 TO SB LOG MI. 103.158
- * SB LOG MI. 103.298 TO SB LOG MI. 103.360
- SB LOG MI. 103.360 TO SB LOG MI. 103.379
- * SB LOG MI. 103.959 TO SB LOG MI. 104.019
- # SB LOG MI. 104.019 TO SB LOG MI. 104.059

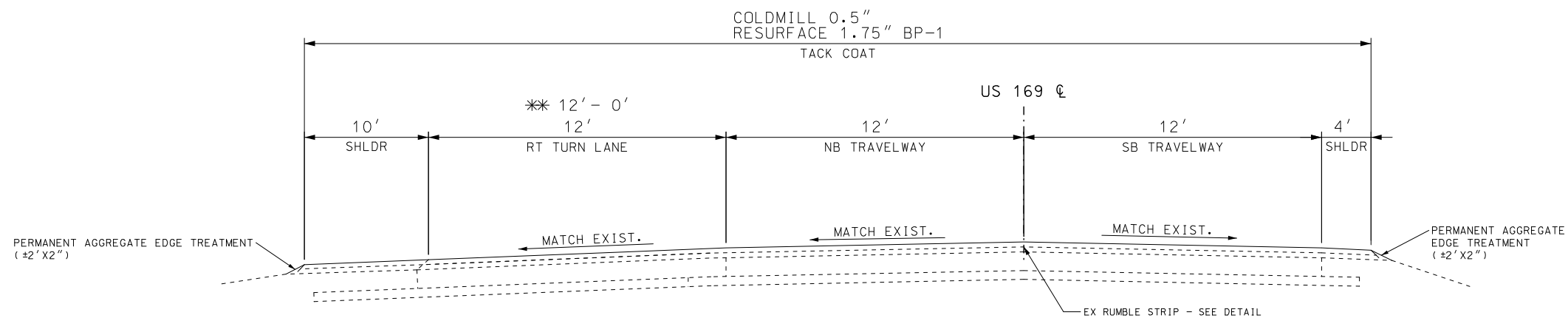

TYPICAL SECTION

- SB LOG MI. 102.000 TO SB LOG MI. 102.100
- * SB LOG MI. 102.100 TO SB LOG MI. 102.121

NOTE: SAFETY EDGE SHALL BE INCLUDED

NOT TO SCALE

ROUTE US 169
TYPICAL SECTION
SHEET 3 OF 4

STATE OF MISSOURI
JUAN YIN
NUMBER PE-201000967
PROFESSIONAL ENGINEER
THIS SHEET HAS BEEN
SIGNED, SEALED AND DATED
ELECTRONICALLY.

DATE PREPARED
7/9/2021

ROUTE 169	STATE MO
DISTRICT KC	SHEET NO. 2

COUNTY
CLAY

JOB NO.
J4S3340

CONTRACT ID.

PROJECT NO.

BRIDGE NO.

DATE	DESCRIPTION

MISSOURI HIGHWAYS AND TRANSPORTATION
COMMISSION

105 WEST CAPITOL
JEFFERSON CITY, MO 65102
1-888-ASK-MODOT (1-888-275-6636)

IF A SEAL IS PRESENT ON THIS SHEET IT HAS BEEN ELECTRONICALLY SEALED AND DATED.

NOTE: SAFETY EDGE SHALL BE INCLUDED

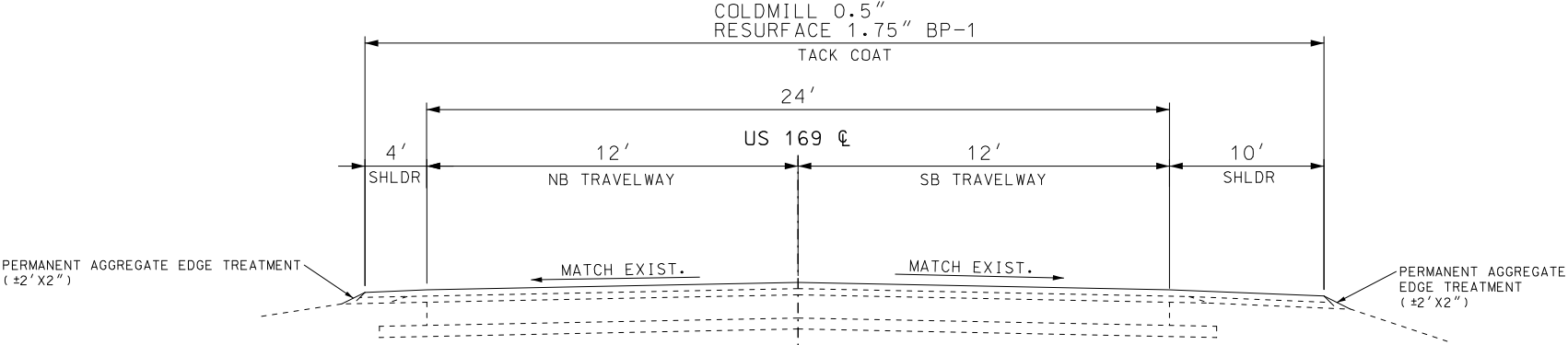

TYPICAL SECTION
SB LOG MI. 104.998 TO SB LOG MI. 105.339

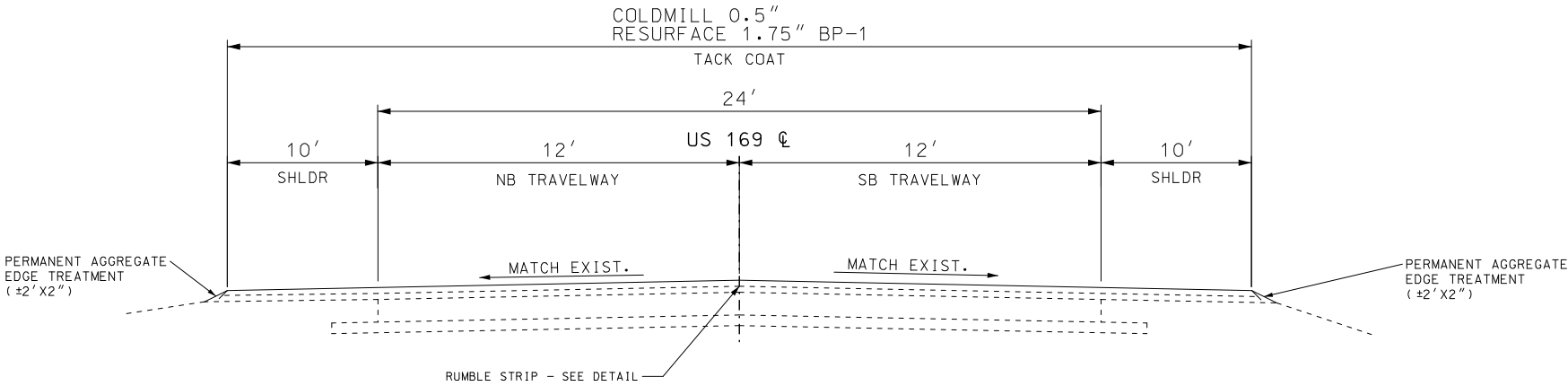

TYPICAL SECTION
SB LOG MI. 104.880 TO SB LOG MI. 104.998

NOT TO SCALE

STATE OF MISSOURI

JUAN YIN

NUMBER
PE-2011000967

PROFESSIONAL ENGINEER

THIS SHEET HAS BEEN
SIGNED, SEALED AND DATED
ELECTRONICALLY.

DATE PREPARED 7/9/2021	
ROUTE 169	STATE MO
DISTRICT KC	SHEET NO. 2
COUNTY CLAY	
JOB NO. J4S3340	
CONTRACT ID.	
PROJECT NO.	
BRIDGE NO.	

DATE	DESCRIPTION

MISSOURI HIGHWAYS AND TRANSPORTATION
COMMISSION



105 WEST CAPITOL
JEFFERSON CITY, MO 65102
1-888-ASK-MODOT (1-888-275-6636)

IF A SEAL IS PRESENT ON THIS SHEET IT HAS BEEN ELECTRONICALLY SEALED AND DATED.

MODIFIED COLDMILLING					
ROUTE	LOG MILE SB	LOG MILE SB	WIDTH FT	MODIFIED COLDMILLING SY	REMARKS
ROUTE 169	101.212	101.229	28	272	BEGINNING OF PROJECT
W HWY LT	101.604	101.612	87	97	STATE ROUTE (ASPHALT)
LAKE MEADOWS DRIVE LT	102.009	102.020	79	88	CITY STREET (ASPHALT)
PRIVATE ENTRANCE RT	102.011	102.021	53	24	COMMUNITY OF CHRIST CHURCH SMITHVILLE (CONCRETE)
ROUTE 169	102.733	102.750	32	311	JOB #J4P3295 EXCEPTION
ROUTE 169	103.088	103.105	42	408	JOB #J4P3295 EXCEPTION
PRIVATE ENTRANCE LT	103.080	103.090	51	57	CHURCH OF GOOD SHEPHERD (ASPHALT)
ROCK CREEK TERRACE LT	103.302	103.317	78	87	CITY STREET (ASPHALT)
180TH STREET LT	103.966	103.979	66	73	CITY STREET (ASPHALT)
NW 179TH STREET RT	104.095	104.100	26	29	CITY STREET (ASPHALT)
PRIVATE ENTRANCE LT	104.099	104.104	17	19	ENTRANCE (ASPHALT)
PRIVATE ENTRANCE RT	104.213	104.220	30	33	ENTRANCE (ASPHALT)
PRIVATE ENTRANCE RT	104.275	104.281	32	14	ENTRANCE (CONCRETE)
PRIVATE ENTRANCE RT	104.310	104.315	28	31	ENTRANCE (ASPHALT)
PRIVATE ENTRANCE RT	104.364	104.367	16	18	ENTRANCE (ASPHALT)
PRIVATE ENTRANCE RT	104.403	104.408	26	29	ENTRANCE (ASPHALT)
PRIVATE ENTRANCE RT	104.422	104.428	29	32	ENTRANCE (ASPHALT)
HILLCREST DRIVE LT	104.461	104.474	69	31	CITY STREET (CONCRETE)
PRIVATE ENTRANCE RT	104.468	104.475	35	39	ENTRANCE (ASPHALT)
PRIVATE ENTRANCE LT	104.880	104.898	95	42	TRANSFORMER STATION (CONCRETE)
PRIVATE ENTRANCE RT	104.881	104.887	32	36	ENTRANCE (ASPHALT)
PRIVATE ENTRANCE LT	105.043	105.052	48	21	SMITHVILLE UNITED METHODIST CHURCH (CONCRETE)
PRIVATE ENTRANCE LT	105.204	105.212	42	19	HOUSING OFFICE (CONCRETE)
PRIVATE ENTRANCE RT	105.228	105.232	21	9	ENTRANCE (CONCRETE)
PRIVATE ENTRANCE LT	105.275	105.279	21	9	ENTRANCE (CONCRETE)
PRIVATE ENTRANCE LT	105.280	105.285	20	22	ENTRANCE (ASPHALT)
PRIVATE ENTRANCE LT	105.297	105.302	26	12	ENTRANCE (CONCRETE)
PRIVATE ENTRANCE RT	105.300	105.303	16	18	ENTRANCE (ASPHALT)
PRIVATE ENTRANCE LT	105.382	105.388	32	14	ENTRANCE (CONCRETE)
PRIVATE ENTRANCE RT	105.388	105.399	58	26	YOUTH CENTER (CONCRETE)
ROUTE 169	105.382	105.399	38	369	END OF PROJECT
			PAY TOTAL	2289	

GUARDRAIL								
BEGIN LOG MI. SB	END LOG MI. SB	LOCATION	SIDE	LENGTH FT	MGS GUARDRAIL 8 FT POST LF	(MASH) TYPE A CRASHWORTHY END TERMINAL EACH	SHAPING SLOPES, CLASS III 100 FT	REMARKS
104.539	104.596	ROUTE 169	RT	300.00	200	2	1.50	
104.539	104.596	ROUTE 169	LT	300.00	200	2	1.50	
104.739	104.813	ROUTE 169	LT	393.75	300	2	1.50	
				PAY TOTAL	700	6	5	

REMOVAL OF IMPROVEMENTS – 1 LUMP SUM						
BEGIN LOG MI.	END LOG MI.	LOCATION	DESCRIPTION	UNITS	QUANTITY	REMARKS
104.539	104.596	RT 169	GUARDRAIL	LF	300	
104.539	104.596	RT 169	GUARDRAIL	LF	300	
104.739	104.813	RT 169	GUARDRAIL	LF	393.75	
104.371	104.447	RT 169	SAW CUT	LF	400	SHOULDER REPAIR

PAVEMENT MARKING – PREFORMED THERMOPLASTIC PAVEMENT MARKING						
ROUTE	LOG MILE SB	24" YELLOW SOL ID LF	6" WHITE SOL ID LF	24" WHITE SOL ID LF	LEFT/RIGHT TURN ARROWS EACH	REMARKS
169	101.479 – 101.539	72				HASH BARS
169	101.552 – 101.600		251			LANE LINE
169	101.562				1	LT TURN ARROW
169	101.591				1	LT TURN ARROW
169	101.604–101.608			22		STOP BAR ON RT W*
169	101.619 – 101.679	51				HASH BARS
169	101.625–101.654		155			LANE LINE
169	101.628				1	RT TURN ARROW
169	101.648				1	RT TURN ARROW
169	102.023 – 102.089		348			LANE LINE
169	102.038				1	RT TURN ARROW
169	102.061				1	RT TURN ARROW
169	103.080 – 103.120		211			LANE LINE
169	103.092				1	RT TURN ARROW
169	103.111				1	RT TURN ARROW
169	103.319 – 103.366		250			LANE LINE
169	103.319 – 103.366				2	RT TURN ARROW*
169	103.976 – 104.017		219			LANE LINE
169	103.985				1	RT TURN ARROW
169	104.004				1	RT TURN ARROW
169	105.346 – 105.391	62				HASH BARS
PAY TOTAL		185	1434	22	12	

* REFER TO STANDARD 620.00 FOR PLACEMENT

PAVEMENT MARKING – WATERBORNE PAINT WITH TYPE P BEADS						
ROUTE	LOG MILE SB	LOG MILE SB	4" WHITE SOL ID LF	4" YELLOW SOL ID LF	4" YELLOW INTERMEDIATE LF	REMARKS
169	101.212	102.750	16242	13221	980	
169	103.088	105.399	24404	17899	1350	
SUBTOTAL			40646	31120	2330	
PAY TOTAL			40646	33450		

MOBILIZATION
LUMP SUM = 1

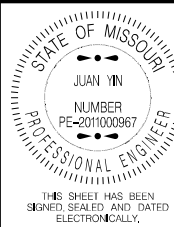

DATE PREPARED
8/19/2021
ROUTE 169 STATE MO
DISTRICT KC SHEET NO. 3

COUNTY
CLAY
JOB NO.
J4S3340
CONTRACT ID.

PROJECT NO.

BRIDGE NO.

DESCRIPTION	DATE

MISSOURI HIGHWAYS AND TRANSPORTATION
COMMISSION



105 WEST CAPITOL
JEFFERSON CITY, MO 65102
1-888-ASK-MODOT (1-888-275-6636)

IF A SEAL IS PRESENT ON THIS SHEET IT HAS BEEN ELECTRONICALLY SEALED AND DATED.

	PAVEMENT REPAIR											
LENGTH	WIDTH	PARTIAL DEPTH	FULL DEPTH	CLASS B PARTIAL DEPTH *		FULL DEPTH PAVEMENT REPAIR *					DOWEL BARS	REMARKS
				REMOVAL	FURNISH AND PLACE TONS	FULL DEPTH FURNISH AND PLACE S.Y.	SUBGRADE COMPACTION 6 IN. DEPTH S.Y.	TYPE 1 OR 5 AGGREGATE S.Y.	FULL DEPTH SAW CUTS			
FT.	FT.			S.Y.					TRANS. L.F.	LONG. L.F.	EACH	
6	12	X		336.0	149.2							
6	12		X			112.0	11.2	11.2	144	72	132	
SUBTOTAL				336.0	149.2	112.0	11.2	11.2	144	72	132	
PAY TOTAL				336.0	149.2	112	11	11	216		132	

* AS DIRECTED BY THE ENGINEER

SHOULDER REPAIR										
LOG MI SB	LOG MI SB	LANE	LENGTH FT	WIDTH FT	BIT BASE TONS	TACK COAT GAL	LINEAR GRADING CLASS 1 STA	PERMANENT AGGR. EDGE TREATMENT TONS	REMARKS	
104.371	104.447	SB	400	4	39.6	18	4.0	57	WEST SIDE	
* PAY TOTAL IN PAVEMENT QUANTITIES				SUB TOTAL	39.6	18	4	57		
				PAY TOTAL	39.6	*	4	*		

BITUMINOUS RUMBLE STRIP													
BEGIN LOG MILE LT	END LOG MILE LT	BEGIN LOG MILE RT	END LOG MILE RT	BEGIN CENTERLINE LOG MILE	END CENTERLINE LOG MILE	LENGTH LT FT	LENGTH RT FT	LENGTH CENTERLINE FT	LT RUMBLE STA	RT RUMBLE STA	CENTERLINE RUMBLE STA	REMARKS	
101.212	101.479	101.212	101.479	101.212	101.479	1409.8	1409.8	1409.8	14.1	14.1	14.1		
101.681	101.982	101.681	102.982	101.681	102.750	1589.3	6869.3	5644.3	15.9	68.7	56.4		
102.141	102.750	102.024	102.750	103.088	105.000	3215.5	3833.3	10095.4	32.2	38.3	101.0		
103.199	103.289	103.088	103.479			475.2	2064.5		4.8	20.6			
103.400	103.479	103.535	103.955			417.1	2217.6		4.2	22.2			
103.479	103.500	103.989	104.060			110.9	374.9		1.1	3.7			
103.535	103.715	104.111	104.181			950.4	369.6		9.5	3.7			
103.76	103.955	104.471	105.000			1029.6	2793.1		10.3	27.9			
104.06	104.079					100.3			1.0				
104.111	104.321					1108.8			11.1				
104.360	104.451					480.5			4.8				
104.491	104.875					2027.5			20.3				
104.921	105.000					417.1			4.2				
									SUBTOTAL	133.5	199.2	171.5	
									PAY TOTAL	332.7		171.5	

STATE OF MISSOURI

JUAN YIN

NUMBER
PE-201000967

PROFESSIONAL ENGINEER

THIS SHEET HAS BEEN
SIGNED, SEALED AND DATED
ELECTRONICALLY.

DATE PREPARED
8/19/2021

ROUTE
169

DISTRICT
KC

STATE
MO

SHEET NO.
3

COUNTY
CLAY

JOB NO.
J4S3340

CONTRACT ID.

PROJECT NO.

BRIDGE NO.

DESCRIPTION

DATE

MISSOURI HIGHWAYS AND TRANSPORTATION
COMMISSION

MoDOT

105 WEST CAPITOL
JEFFERSON CITY, MO 65102
1-888-ASK-MODOT (1-888-275-6636)

IF A SEAL IS PRESENT ON THIS SHEET IT HAS BEEN ELECTRONICALLY SEALED AND DATED.

EFFECTIVE: 01-01-2019																				
SIGN SIZE AREA QTY TOTAL QTY TOTAL SIGN IN. SQ.FT. EACH SQ.FT. EACH SQ.FT. NUM.								SIGN SIZE AREA QTY TOTAL QTY TOTAL SIGN IN. SQ.FT. EACH SQ.FT. EACH SQ.FT. NUM.								ITEM TOTAL NUMBER QTY		DESCRIPTION		
WARNING SIGNS								GUIDE SIGNS										DESCRIPTION		
W01-1L	48X48	16.00						TURN (SYMBOL LEFT ARROW)	E05-1	36X48	12.00						GORE EXIT	6122008		IMPACT ATTENUATOR 40 MPH (SAND BARRELS)
W01-1R	48X48	16.00						TURN (SYMBOL RIGHT ARROW)	E05-2	48X36	12.00						EXIT OPEN	6122009		IMPACT ATTENUATOR 45 MPH (SAND BARRELS)
W01-2L	48X48	16.00						CURVE (SYMBOL LEFT ARROW)	E05-2a	48X36	12.00						EXIT CLOSED	6122010		IMPACT ATTENUATOR 50 MPH (SAND BARRELS)
W01-2R	48X48	16.00						CURVE (SYMBOL RIGHT ARROW)	G020-1	60X24	10.00	2	20.00			1	ROAD WORK NEXT 4 MILES	6122012		IMPACT ATTENUATOR 55 MPH (SAND BARRELS)
W01-3L	48X48	16.00						REVERSE TURN (SYMBOL LEFT ARROW)	G020-2	48X24	8.00	2	16.00			26	END ROAD WORK	6122014		IMPACT ATTENUATOR 60 MPH (SAND BARRELS)
W01-3R	48X48	16.00						REVERSE TURN (SYMBOL RIGHT ARROW)	G020-4	36X18	4.50						PILOT CAR FOLLOW ME	6122017		IMPACT ATTENUATOR 65 MPH (SAND BARRELS)
W01-4L	48X48	16.00						REVERSE CURVE (SYMBOL LEFT ARROW)	G020-4a	42X30	8.75	2	17.50			58	PILOT CAR IN USE WAIT & FOLLOW	6122019		IMPACT ATTENUATOR 70 MPH (SAND BARRELS)
W01-4R	48X48	16.00						REVERSE CURVE (SYMBOL RIGHT ARROW)	G020-5aP	36X24	6.00	2	12.00			54	WORK ZONE (PLAQUE)	6122020		REPLACEMENT SAND BARREL
W01-4bL	48X48	16.00						DOUBLE ARROW REVERSE CURVE (SYMBOL LT ARROWS)	M04-8a	24X18	3.00						END DETOUR	6122030		IMPACT ATTENUATOR (RELOCATION)
W01-4bR	48X48	16.00						DOUBLE ARROW REVERSE CURVE (SYMBOL RT ARROWS)	M04-9L	48X36	12.00						DETOUR (LEFT ARROW)	6123000A	2*	TRUCK OR TRAILER MOUNTED ATTENUATOR (TMA)
W01-4cL	48X48	16.00						TRIPLE ARROW REVERSE CURVE (SYMBOL LT ARROWS)	M04-9R	48X36	12.00						DETOUR (RIGHT ARROW)	6161007		SPEED LIMIT AND STROBE LIGHT ASSEMBLY
W01-4cR	48X48	16.00						TRIPLE ARROW REVERSE CURVE (SYMBOL RT ARROWS)	M04-9P	48X12	4.00						STREET NAME (PLAQUE)	6161008		ADVANCED WARNING RAIL SYSTEM
W01-6	60X30	12.50						HORIZONTAL ARROW (SYMBOL)	M04-10L	48X18	6.00						DETOUR (ARROW LEFT)	6161009		FLAG ASSEMBLY
W01-6a	72X36	18.00						HORIZ. ARROW (SYMBOL ON PERMANENT BARRICADE)	M04-10R	48X18	6.00						DETOUR (ARROW RIGHT)	6161012		BUOYS (BOATS KEEP OUT)
W01-7	60X30	12.50						DOUBLE HEAD HORIZONTAL ARROW (SYMBOL)	REGULATORY SIGNS								6161013		BUOYS (NO WAKE)	
W01-7a	72X36	18.00						DOUBLE HEAD HORIZ. ARROW (SYMBOL ON PERM. BARR.)	R1-1	48X48	13.25						STOP	6161014		SPECIAL SIGN ASSEMBLY (BOATS KEEP OUT)
W01-8	18X24	3.00						CHEVRON (SYMBOL)	R1-2	48TRI.	6.93						YIELD	6161024		CHANNELIZER (TRIM LINE) WITH LIGHT
W01-8a	30X36	7.50						CHEVRON (SYMBOL FOR DIVIDED HIGHWAYS)	R1-2a	36X36	9.00						TO ONCOMING TRAFFIC (PLAQUE)	6161025	225	CHANNELIZER (TRIM LINE)
W03-1	48X48	16.00						STOP AHEAD (SYMBOL)	R1-3P	30X12	2.50						ALL WAY (PLAQUE)	6161030		TYPE III MOVEABLE BARRICADE
W03-2	48X48	16.00						YIELD AHEAD (SYMBOL)	R2-1	36X48	12.00	8	96.00			4&25	SPEED LIMIT 4-55 mph; 4-65 mph	6161031		TYPE III MOVEABLE BARRICADE WITH LIGHTS
W03-3	48X48	16.00						SIGNAL AHEAD (SYMBOL)	R3-1	48X48	16.00						NO RIGHT TURN (SYMBOL)	6161033		DIRECTION INDICATOR BARRICADE
W03-4	48X48	16.00	2	32.00			11	BE PREPARED TO STOP	R3-2	48X48	16.00						NO LEFT TURN (SYMBOL)	6161034		DIRECTION INDICATOR BARRICADE, WITH LIGHT
W03-5	48X48	16.00						SPEED LIMIT AHEAD	R3-3	36X36	9.00						NO TURNS	6161040		FLASHING ARROW PANEL
W04-1L	48X48	16.00						MERGE (SYMBOL FROM LEFT)	R3-4	48X48	16.00						NO U-TURN (SYMBOL)	6161047		TYPE III OBJECT MARKER
W04-1R	48X48	16.00						MERGE (SYMBOL FROM RIGHT)	R3-7L	30X30	6.25						LEFT LANE MUST TURN LEFT	6161052		WARNING LIGHT, TYPE B
W04-1aL	48X48	16.00						MERGE (ARROW SYMBOL)	R3-7R	30X30	6.25						RIGHT LANE MUST TURN RIGHT	6161055		SEQUENTIAL FLASHING WARNING LIGHT
W04-1aR	48X48	16.00						MERGE (ARROW SYMBOL)	R4-1	36X48	12.00						DO NOT PASS	6161070		TUBULAR MARKER
W05-1	48X48	16.00						ROAD/BRIDGE/RAMP NARROWS	R4-2	36X48	12.00						PASS WITH CARE	6161095		RADAR SPEED ADVISORY SYSTEM
W05-3	48X48	16.00						ONE LANE BRIDGE	R4-8a	36X48	12.00						KEEP LEFT (HORIZONTAL ARROW)	6161096		CHANGEABLE MESSAGE SIGN, COMMISSION FURNISHED/RETAINED
W05-5	48X48	16.00	1	16.00			34	NARROW LANES	R4-7a	36X48	12.00						KEEP RIGHT (HORIZONTAL ARROW)			CHANGEABLE MESSAGE SIGN W/O COMM. INTERFACE, CONTRACTOR FURNISHED/RETAINED
W06-1	48X48	16.00						DIVIDED HIGHWAY (SYMBOL)	R5-1	30X30	6.25						DO NOT ENTER	6161098A	2*	CHANGEABLE MESSAGE SIGN WITH COMM. INTERFACE, CONTRACTOR FURNISHED/RETAINED
W06-2	48X48	16.00						DIVIDED HIGHWAY END (SYMBOL)	R5-1a	36X24	6.00						WRONG WAY			INTERFACE, CONTRACTOR FURNISHED/RETAINED
W06-3	48X48	16.00						TWO WAY TRAFFIC (SYMBOL)	R6-1L	54X18	6.75						ONE WAY ARROW (LEFT)	6161099		CHANGEABLE MESSAGE SIGN WITH COMM. INTERFACE, CONTRACTOR FURNISHED/RETAINED
W07-3a	30X24	5.00	1	5.00			44a	NEXT 4 MILES (PLAQUE)	R6-1R	54X18	6.75						ONE WAY ARROW (RIGHT)	6162000A		WORK ZONE TRAFFIC SIGNAL SYSTEM
W08-1	48X48	16.00						BUMP	R6-2L	24X30	5.00						ONE WAY (LEFT)	6162002		TEMPORARY LONG-TERM RUMBLE STRIPS
W08-2	48X48	16.00						DIP	R6-2R	24X30	5.00						ONE WAY (RIGHT)	6162004		TEMPORARY SHORT-TERM RUMBLE STRIPS
W08-3	48X48	16.00						PAVEMENT ENDS	R9-9	24X12	2.00						SIDEWALK CLOSED	6173600D		TEMPORARY TRAFFIC BARRIER CONTRACTOR FURNISHED/RETAINED
W08-4	48X48	16.00						SOFT SHOULDER	R9-11L	24X18	3.00						SIDEWALK CLOSED AHEAD, (ARROW LEFT) CROSS HERE			TEMPORARY TRAFFIC BARRIER CONTRACTOR FURNISHED/RETAINED
W08-5	48X48	16.00						SLIPPERY WHEN WET (SYMBOL)	R9-11R	24X18	3.00						SIDEWALK CLOSED AHEAD, (ARROW RIGHT) CROSS HERE	6173602B		TEMPORARY TRAFFIC BARRIER CONTRACTOR FURNISHED/COMMISSION RETAINED
W08-6	48X48	16.00						TRUCK CROSSING	R10-6	24X36	6.00						STOP HERE ON RED (45° ARROW)	6174000A		TEMP. TRAFFIC BARRIER HEIGHT TRANSITION
W08-6c	48X48	16.00						TRUCK ENTRANCE	R11-2	48X30	10.00						ROAD CLOSED	6175010A		RELOCATING TEMPORARY TRAFFIC BARRIER
W08-7	36X36	9.00						LOOSE GRAVEL	R11-3a	60X30	12.50						ROAD CLOSED XX MILES AHEAD	6176000B		TEMPORARY TRAFFIC BARRIER COMMISSION FURNISHED/RETAINED
W08-7a	36X36	9.00						FRESH OIL/LOOSE GRAVEL	R11-4	60X30	12.50						LOCAL TRAFFIC ONLY	6177000B		TEMP. TRAFFIC BARRIER HEIGHT TRANSITION
W08-9	48X48	16.00						LOW SHOULDER	CONST-3A	60X48	20.00						ROAD CLOSED TO THRU TRAFFIC	6208064A		COMMISSION FURNISHED/RETAINED
W08-11	48X48	16.00	8	128.00			36	UNEVEN LANES	CONST-3X	56X12	4.67						FINE SIGN	9029400		TEMPORARY RAISED PAVEMENT MARKER
W08-12	48X48	16.00	6	96.00			35	NO CENTER LINE	MISCELLANEOUS SIGNS								POINT OF PRESENCE			TEMPORARY TRAFFIC SIGNALS
W08-15	48X48	16.00						GROOVED PAVEMENT	CONST-5-96	48X36	12.00						POINT OF PRESENCE	9029401		TEMPORARY TRAFFIC SIGNALS AND LIGHTING
W08-15P	30X24	5.00						MOTORCYCLE (PLAQUE)	CONST-4	96X48	32.00	2	64.00				POINT OF PRESENCE			
W08-17	48X48	16.00						SHOULDER DROP-OFF (SYMBOL)	CONST-7-72	48X24	8.00						RATE OUR WORK ZONE			
W08-17P	30X24	5.00						SHOULDER DROP-OFF (PLAQUE)	CONST-7											

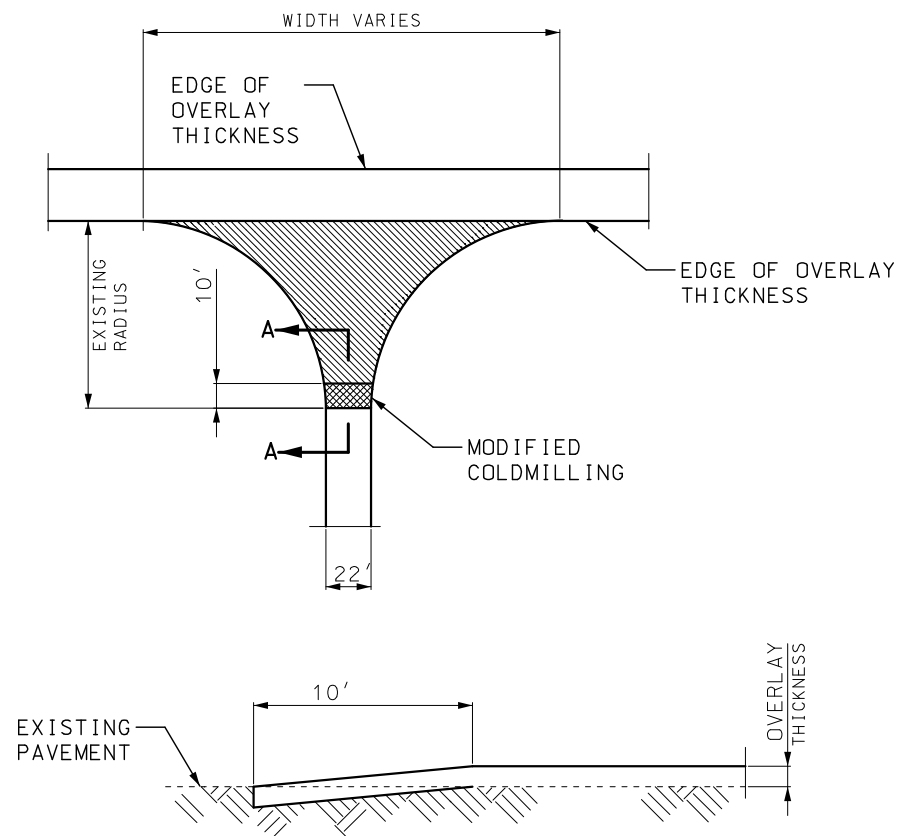

SECTION A-A
TYPICAL STATE ROUTE JUNCTION
(COLDMILLED TRANSITION)

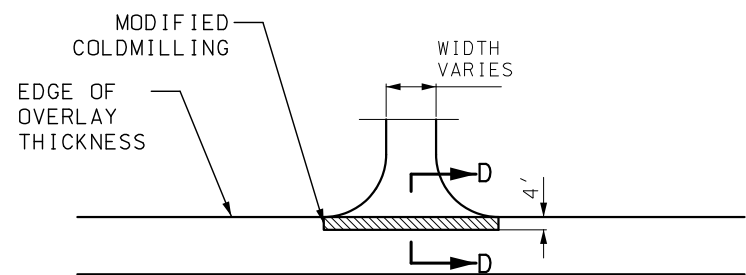

SECTION D-D
TYPICAL CONCRETE ENTRANCE

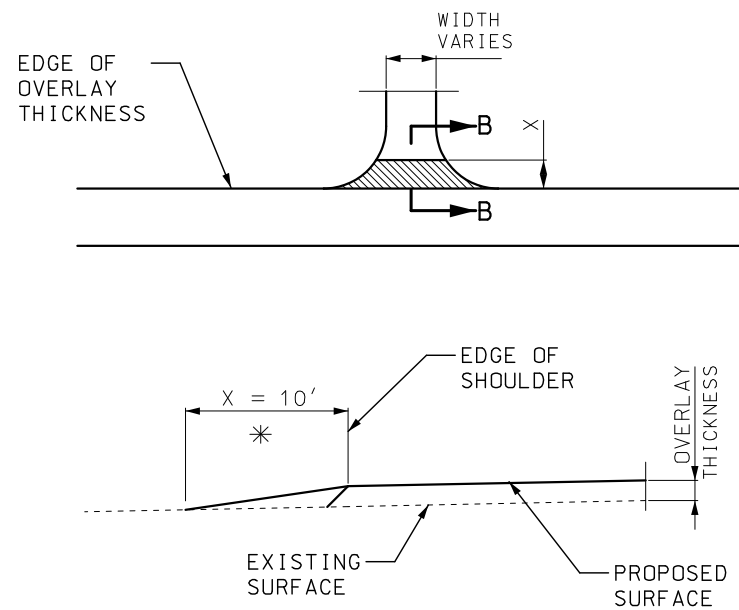

SECTION B-B
TYPICAL GRAVEL ENTRANCE
(FIELD, PRIVATE OR COUNTY ROAD)
* TAPER AT 1:1 FOR FIELD ENTRANCE

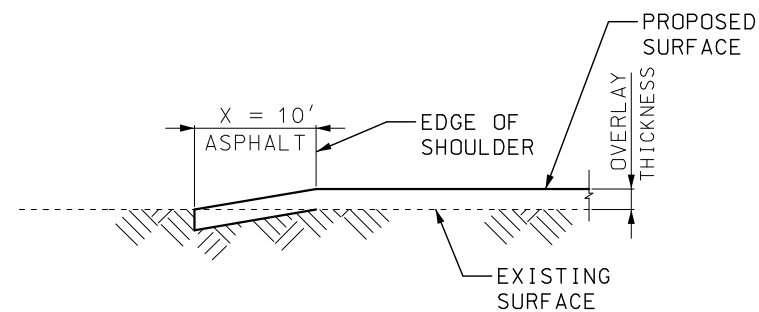

SECTION B-B
TYPICAL ASPHALT ENTRANCE

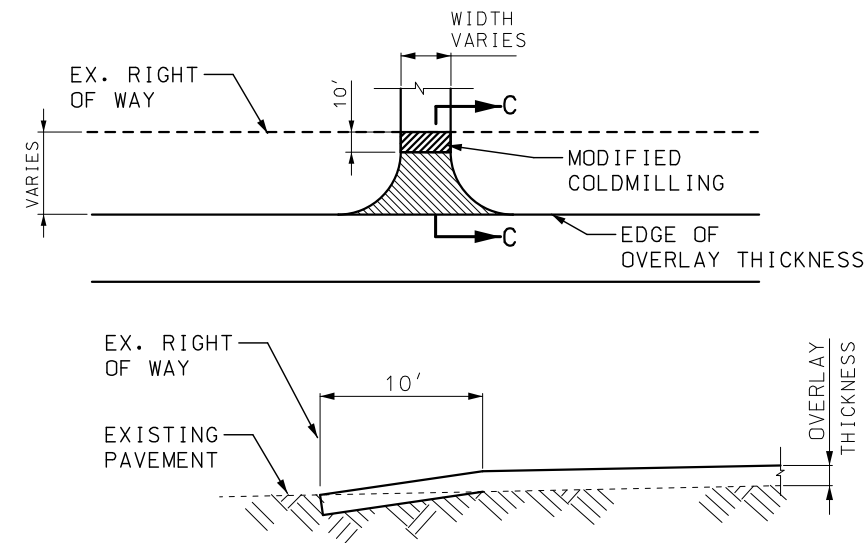

SECTION C-C
TYPICAL ASPHALT FOR
CITY OR COUNTY ROAD

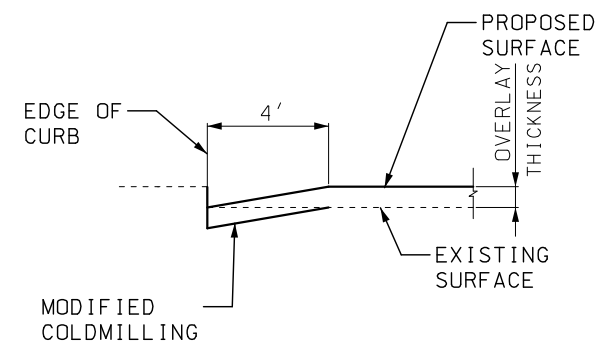
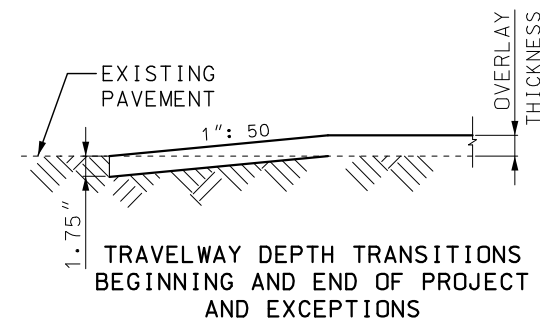

TYPICAL ROADWAY SECTION
WITH CURB

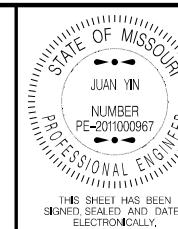

DATE PREPARED
7/9/2021

ROUTE 169 STATE MO
DISTRICT KC SHEET NO. 4

COUNTY CLAY
JOB NO. J4S3340
CONTRACT ID.

PROJECT NO.

BRIDGE NO.

DATE	DESCRIPTION

MISSOURI HIGHWAYS AND TRANSPORTATION
COMMISSION
105 WEST CAPITOL
JEFFERSON CITY, MO 65102
1-888-ASK-MODOT (1-888-275-6636)

IF A SEAL IS PRESENT ON THIS SHEET IT HAS BEEN ELECTRONICALLY SEALED AND DATED.

REV.

SPACING AND TAPER LENGTHS FOR WORK ZONE SIGNS, CHANNELIZERS AND CONCRETE BARRIER

SIGN SPACING FOR ADVANCE SIGN SERIES (1) (2)		
PERMANENT POSTED SPEED MPH	UNDIVIDED HIGHWAYS	DIVIDED HIGHWAYS
0-35	200'	200'
40-45	350'	500'
50-55	500'	1000'
60-70	1000'	SA - 1000' SB - 1500' SC - 2640'

TAPER LENGTHS AND END TREATMENTS FOR CONCRETE BARRIER				
PERMANENT POSTED SPEED MPH	MINIMUM LANE TAPER LENGTH (3)			END TREATMENT (4)
	10'	11'	12'	
< 40	160'	168'	176'	BARRIER HEIGHT TRANSITION
> 40	160'	168'	176'	APPROVED CRASH CUSHION

TAPER LENGTHS AND SPACING FOR CHANNELIZERS							
PERMANENT POSTED SPEED MPH	MINIMUM LANE TAPER LENGTH (3)			MINIMUM SHOULDER TAPER LENGTH BASED ON 10' SHOULDER	BUFFER LENGTH FT	MAXIMUM CHANNELIZER SPACING	
	10'	11'	12'			THROUGH TAPER	THROUGH WORK AREA
0-35	205'	225'	245'	70'	280'	35'	40'
40-45	450'	495'	540'	150'	400'	40'	80'
50-55	550'	605'	660'	185'	560'	50'	80'
60-70	700'	770'	840'	235'	840'	60'	120'

- NOTE:
- (1)

SPACING BETWEEN SIGNS AND SPACING BETWEEN LAST SIGN AND FLAGGER, BEGINNING OF TAPER, OF SIGNED CONDITION.
- (2)

SPACING MAY BE ADJUSTED AS NECESSARY TO MEET FIELD CONDITIONS.
- (3)

TAPER LENGTHS SHOWN INCLUDE LENGTH REQUIRED FOR LANE AND 10' SHOULDER
- (4)

CONCRETE BARRIER MAY BE INSTALLED AT 8:1 FLARE RATE FROM THE SHOULDER POINT OF THE LIMITS OF THE CLEAR ZONE WHERE THE SIDE SLOPE IS 6:1 OR FLATTER

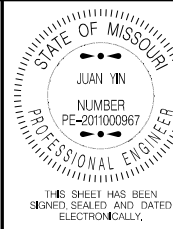

DATE PREPARED 7/13/2021	
ROUTE 169	STATE MO
DISTRICT KC	SHEET NO. 5
COUNTY CLAY	
JOB NO. J4S3340	
CONTRACT ID.	
PROJECT NO.	
BRIDGE NO.	

DESCRIPTION	DATE

MISSOURI HIGHWAYS AND TRANSPORTATION
COMMISSION



105 WEST CAPITOL
JEFFERSON CITY, MO 65102
1-888-ASK-MODOT (1-888-275-6636)

IF A SEAL IS PRESENT ON THIS SHEET IT HAS BEEN ELECTRONICALLY SEALED AND DATED. REV.

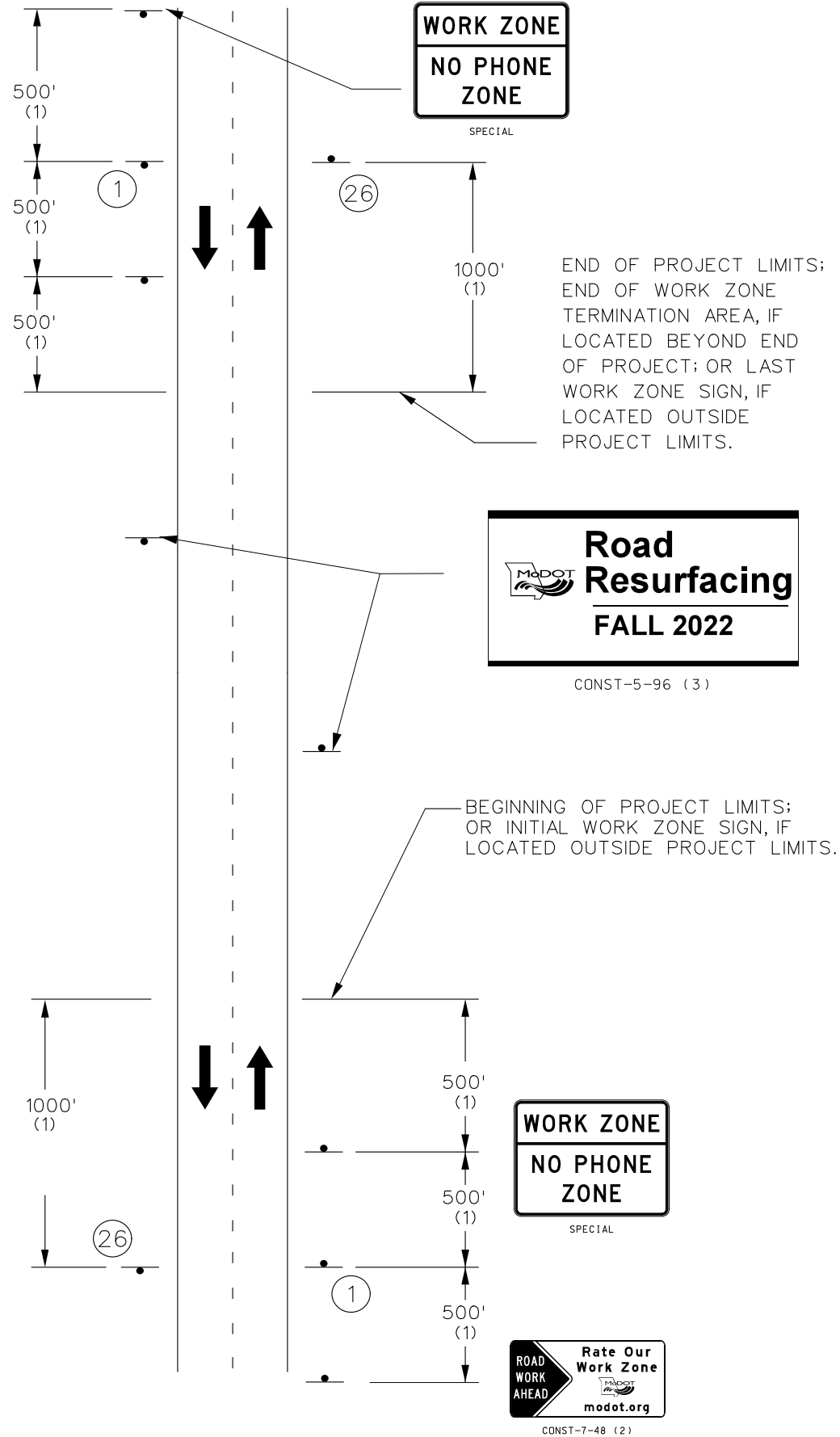
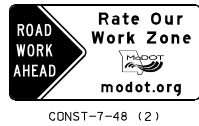

- NOTES:
- SIGN G020-1 IS REQUIRED PER EPG 616.6.56.
- SIGN G020-2 IS USED ON ALL PROJECTS WHERE SIGN G020-1 IS USED.
- OTHER SIGNS SUCH AS DETOUR OR ALTERNATE ROUTE SIGNING MAY BE USED OUTSIDE THE PROJECT LIMITS.
- ANY EXISTING SIGNING THAT CONFLICTS WITH THE TRAFFIC CONTROL SIGNING SHALL BE COMPLETELY COVERED OR REMOVED.
- (1) DISTANCE MAY BE ADJUSTED ACCORDING TO FIELD CONDITIONS. WHERE TRAFFIC BACKUPS ARE EXPECTED BEYOND THE ADVANCE WARNING AREA, ADDITIONAL SIGNING MAY BE NEEDED.
- (2) SIGN CONST-7-48 OR CONST-7-72 IS PLACED 500 FEET BEFORE THE BEGINNING OF PROJECT LIMITS OR THE ROAD WORK AHEAD SIGN OR ROAD WORK NEXT XX MILES SIGN, IF USED, WHEN THESE SIGNS ARE LOCATED OUTSIDE THE PROJECT LIMITS.
- (3) SIGN CONST-5-96 OR CONST-5-48 IS PLACED IN A VISIBLE AREA WITHIN THE PROJECT LIMITS PROVIDED ITS PLACEMENT DOES NOT DISRUPT A SEQUENCE OF SIGNS. IF A VISIBLE LOCATION WITHIN THE PROJECT IS NOT AVAILABLE, THE SIGN MAY BE PLACED 500 FEET BEFORE SIGN CONST-7-48 OR CONST-7-72.
- (4) THE "RATE OUR WORK ZONE" SIGN IS AVAILABLE IN TWO SIZES DEPENDING ON ROADWAY CONDITIONS. THE 48 IN. X 24 IN. SIGN IS USED ON LOW VOLUME ROUTES THAT CARRY 400 AADT OR LESS, ON PROJECTS THAT HAVE A DURATION OF 4 WEEKS OR LESS OR IN URBAN AREAS WHERE THERE IS INSUFFICIENT RIGHT OF WAY FOR A SIX FOOT WIDE SIGN. THE 72 IN. X 36 IN. VERSION OF THE SIGN IS USED IN ALL OTHER APPLICATIONS. BUT CAN ALSO BE USED IN PLACE OF THE 48 IN. X 24 IN. SIGN IF ADDED EMPHASIS IS DEEMED NECESSARY.
- (5) THE "POINT OF PRESENCE" SIGN IS AVAILABLE IN TWO SIZES DEPENDING ON ROADWAY CONDITION. THE 48 IN. X 36 IN. SIGN IS USED ON LOW VOLUME ROUTES THAT CARRY 400 AADT OR LESS, ON PROJECTS THAT HAVE A DURATION OF 4 WEEKS OR LESS OR IN URBAN AREAS WHERE THERE IS INSUFFICIENT RIGHT OF WAY FOR AN EIGHT FOOT WIDE SIGN. THE 96 IN. X 48 IN. VERSION OF THE SIGN IS USED IN ALL OTHER APPLICATIONS. BUT CAN ALSO BE USED IN PLACE OF THE 48 IN. X 36 IN. SIGN IF ADDED EMPHASIS IS DEEMED NECESSARY.

WORK ZONE
NO PHONE
ZONE

SPECIAL

WHEN THE "ROAD WORK NEXT XX MILES" IS NOT USED THE "NO PHONE ZONE" SIGN IS TO BE PLACED A MINIMUM OF 500' BEFORE THE "ROAD WORK AHEAD" SIGN. REFER TO EPG 616.6.51.3 WORK ZONE NO PHONE ZONE SIGN

ROAD WORK
NEXT 4 MILES

G020-1
1

END
ROAD WORK

G020-2
26

STATE OF MISSOURI

JUAN YIN

NUMBER
PE-2011000967

PROFESSIONAL ENGINEER

THIS SHEET HAS BEEN
SIGNED, SEALED AND DATED
ELECTRONICALLY.

DATE PREPARED
7/9/2021

ROUTE
169

DISTRICT
KC

STATE
MO

SHEET NO.
6

COUNTY
CLAY

JOB NO.
J4S3340

CONTRACT ID.

PROJECT NO.

BRIDGE NO.

DESCRIPTION	DATE

MISSOURI HIGHWAYS AND TRANSPORTATION
COMMISSION

MODOT

105 WEST CAPITOL
JEFFERSON CITY, MO 65102
1-888-ASK-MODOT (1-888-275-6636)

IF A SEAL IS PRESENT ON THIS SHEET IT HAS BEEN ELECTRONICALLY SEALED AND DATED.



NOTES:

ONLY APPLICABLE WHEN WORK IS WITHIN THE CLEAR ZONE.

SEE TRAFFIC CONTROL SHEET 1 FOR SIGN SPACING, DEVICE
SPACING AND CHANNELIZING TAPER LENGTHS.

SEE TRAFFIC CONTROL SHEET 1 FOR WORK ZONE SPEED
LIMIT GUIDELINES.

ON MULTI-LANE, DIVIDED HIGHWAYS SIGNS ADVISING OF SHOULDER WORK OR THE CONDITION OF THE SHOULDER SHOULD BE PLACED ONLY ON THE SIDE OF THE AFFECTED SHOULDER.

VEHICLE HAZARD WARNING SIGNALS SHALL NOT BE USED INSTEAD OF THE VEHICLE'S HIGH-INTENSITY ROTATING FLASHING, FLASHING, OSCILLATING, OR STROBE LIGHTS.



NOTES:

SEE TRAFFIC CONTROL SHEET 1 FOR WORK ZONE SPEED
LIMIT GUIDELINES.

SEE TRAFFIC CONTROL SHEET 1 FOR SIGN SPACING, DEVICE
SPACING AND CHANNELIZING TAPER LENGTHS.



SIGN 2 NOT REQUIRED IF SHOULDER WORK IS LOCATED WITHIN
THE LIMITS OF AN ACTIVITY AREA WHERE ANOTHER
SIGN 2 IS ALREADY USED.

PROVIDE SIGNS ON LEFT AND RIGHT SIDE OF DIVIDED HIGHWAYS.

VEHICLE HAZARD WARNING SIGNALS SHALL NOT BE USED INSTEAD OF THE VEHICLE'S HIGH -INTENSITY ROTATING FLASHING, FLASHING, OSCILLATING, OR STROBE LIGHTS.

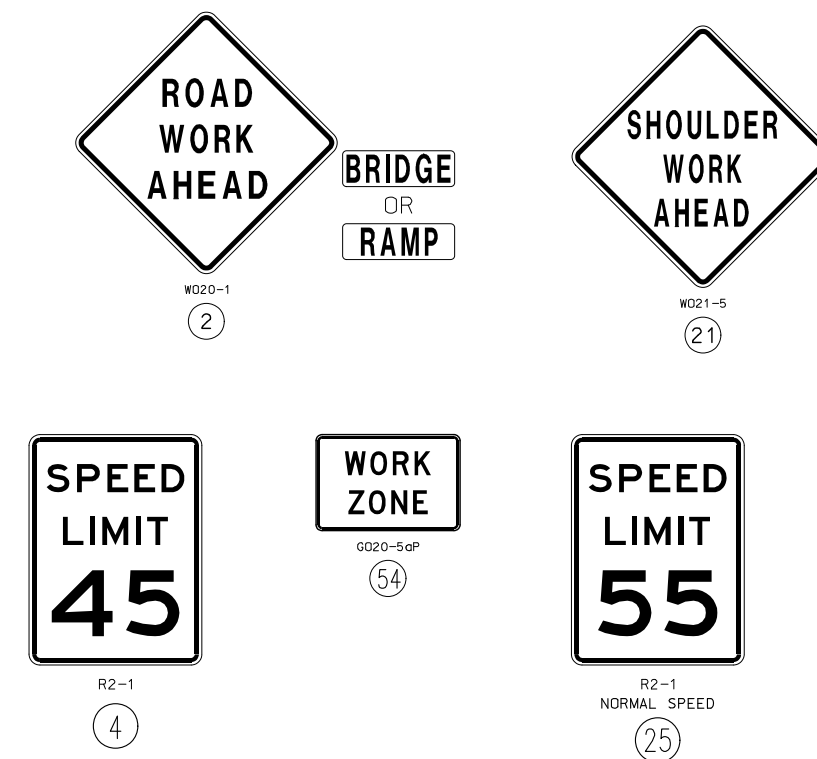
WHEN PAVED SHOULDERS HAVING A WIDTH OF 8 FEET OR MORE ARE CLOSED, AT LEAST ONE ADVANCE WARNING SIGN SHALL BE USED. IN ADDITION, CHANNELIZING DEVICES SHALL BE USED TO CLOSE THE SHOULDER IN ADVANCE TO DELINEATE THE BEGINNING OF THE WORK SPACE AND DIRECT VEHICULAR TRAFFIC TO REMAIN WITHIN THE TRAVELED WAY.



	FOR FLAGS AND ADVANCE WARNING RAIL SYSTEMS,
	REFER TO EPG 616.6.2.2
	FLAGS AND ADVANCED WARNING RAIL SYSTEM

SHOULDER WORK
TEMPORARY
TRAFFIC CONTROL
SHEET 3 OF 8

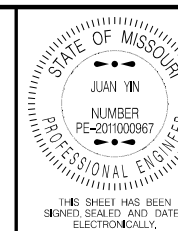

DATE PREPARED
7/9/2021

ROUTE	STA
169	MO

DISTRICT	SHEET
KC	7

COUNTY
CLAY

JOB NO.
J4S3340

CONTRACT ID.

PROJECT NO.

BRIDGE NO.

[illegible]MISSOURI HIGHWAYS AND TRANSPORTATION
COMMISSION

105 WEST CAPITOL
JEFFERSON CITY, MD 65102
1-888-ASK-MODOT (1-888-275-6636)

[illegible]

REV.

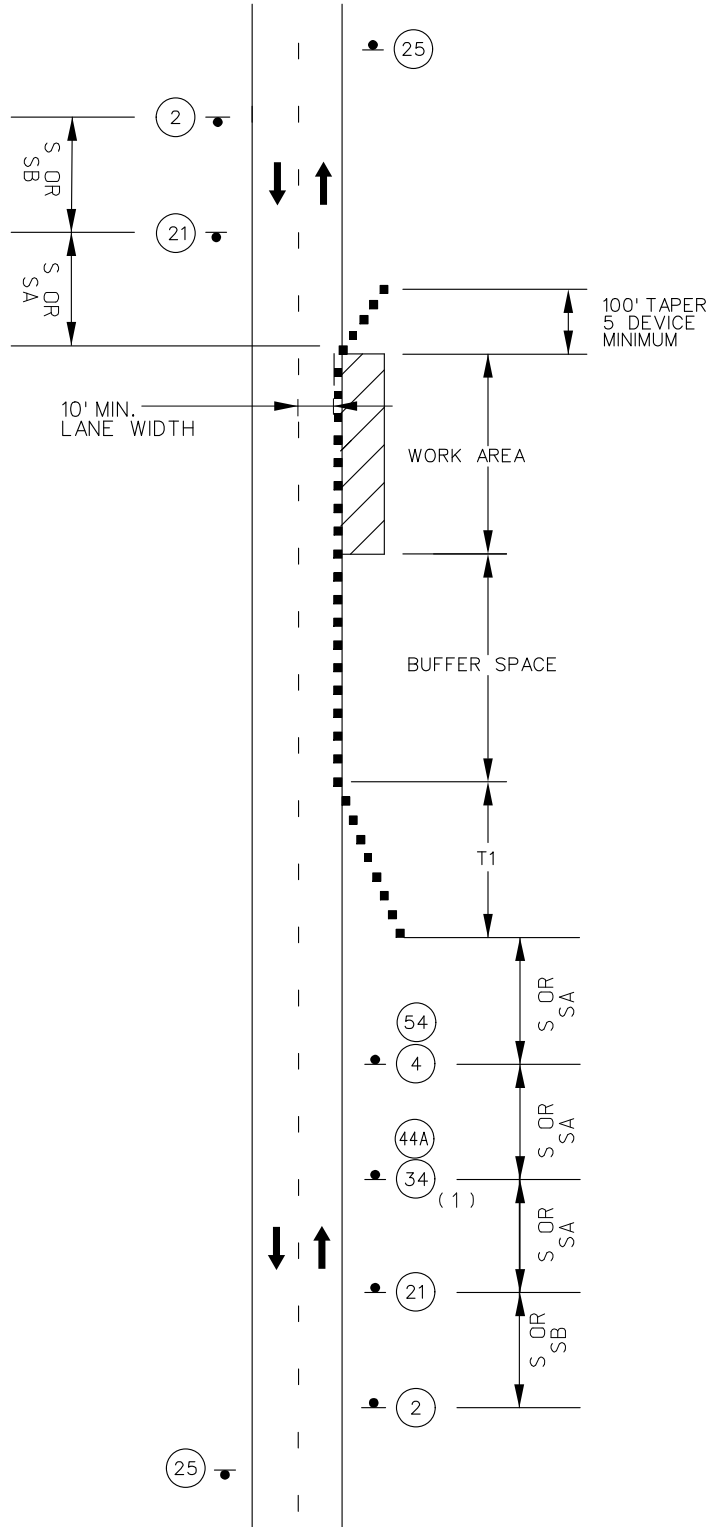

TWO LANE UNDIVIDED
SHOULDER WORK
MINOR TRAVELWAY ENCROACHMENT

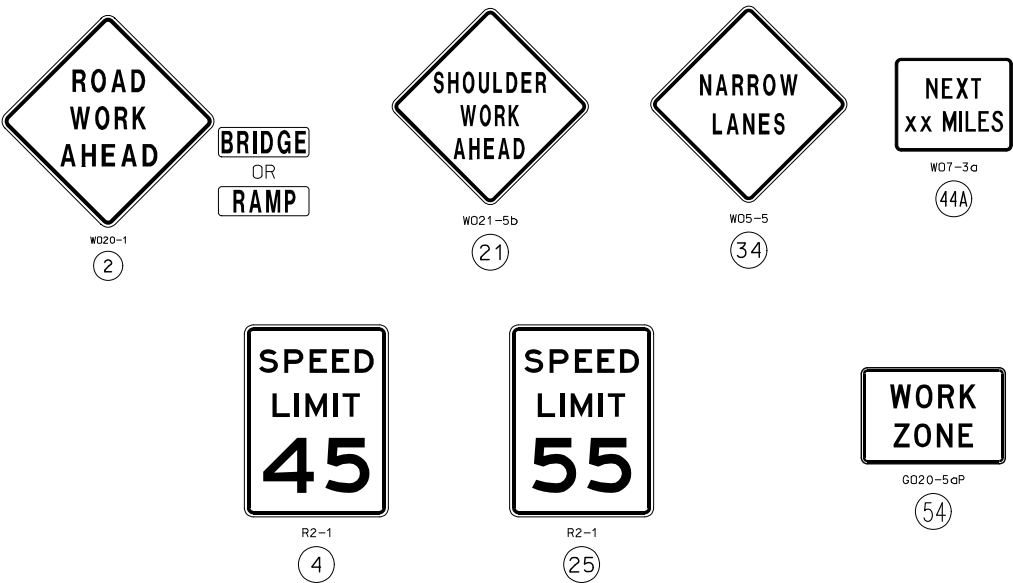

FOR FLAGS AND ADVANCE
WARNING RAIL SYSTEMS,
REFER TO EPG 616.6.2.2
FLAGS AND ADVANCED
WARNING RAIL SYSTEM

- NOTES:
- SEE TRAFFIC CONTROL SHEET 1 FOR WORKZONE SPEED LIMIT GUIDELINES.
- SEE TRAFFIC CONTROL SHEET 1 FOR SIGN SPACING, DEVICE SPACING AND CHANNELIZING TAPER LENGTHS.
- SIGN 2 NOT REQUIRED IF SHOULDER WORK IS LOCATED WITHIN THE LIMITS OF AN ACTIVITY AREA WHERE ANOTHER SIGN 2 IS ALREADY USED.
- THE PROTECTIVE VEHICLE MAY BE OMITTED IF A TAPER AND CHANNELIZING DEVICES ARE USED.
- VEHICLE- MOUNTED SIGNS SHALL BE MOUNTED IN A MANNER SUCH THAT THEY ARE NOT OBSCURED BY EQUIPMENT OR SUPPLIES. SIGN LEGEND ON VEHICLE-MOUNTED SIGNS SHALL BE COVERED OR TURNED FROM VIEW WHEN WORK IS NOT IN PROGRESS.
- VEHICLE HAZARD WARNING SIGNALS SHALL NOT BE USED INSTEAD OF THE VEHICLE'S HIGH -INTENSITY ROTATING FLASHING, FLASHING, OSCILLATING, OR STROBE LIGHTS.
- SHADOW AND WORK VEHICLES SHALL DISPLAY HIGH-DENSITY ROTATING, FLASHING, OSCILLATING, OR STROBE LIGHTS.
- (1). SIGN 44A NOT REQUIRED FOR NARROW LANE SECTIONS LESS THAN ONE MILE.

SHOULDER WORK
MINOR ENCROACHMENT
TEMPORARY
TRAFFIC CONTROL
SHEET 4 OF 8

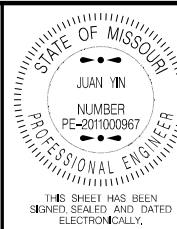

DATE PREPARED
7/9/2021

ROUTE 169 STATE MO
DISTRICT KC SHEET NO. 8

COUNTY CLAY
JOB NO. J4S3340
CONTRACT ID.

PROJECT NO.

BRIDGE NO.

DESCRIPTION	DATE

MISSOURI HIGHWAYS AND TRANSPORTATION
COMMISSION

105 WEST CAPITOL
JEFFERSON CITY, MO 65102
1-888-ASK-MODOT (1-888-275-6636)

TRANSPORTATION
105 WEST CAPITOL
N CITY, MD 65102
4 000 075 00701

PILOT CAR
FOLLOW ME

GO20-
(53)



W020-7a

(08)

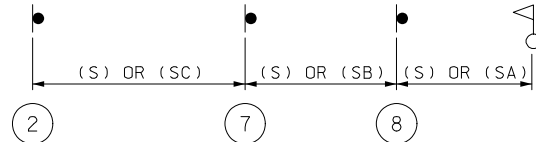

■ – CHANNELIZERS



SPEED	SIGN SPACING (FT.) (1)	
PERMANENT POSTED (MPH)	NON-DIVIDED HIGHWAYS (S)	DIVIDED HIGHWAYS (S)
0-35	200	200
40-45	350	500
50-55	500	1000
60-70	1000	(SA)-1000 (SB)-1500 (SC)-2640

PERMANENT POSTED SPEED LIMIT (MPH)	BUFFER SPACE LENGTH (FT)
0 - 35	280
40 - 45	400
50 - 55	560
60 - 70	840

ONE LANE CLOSURE TWO WAY
FLAGGER CONTROL
TEMPORARY
TRAFFIC CONTROL
SHEET 5 OF 8

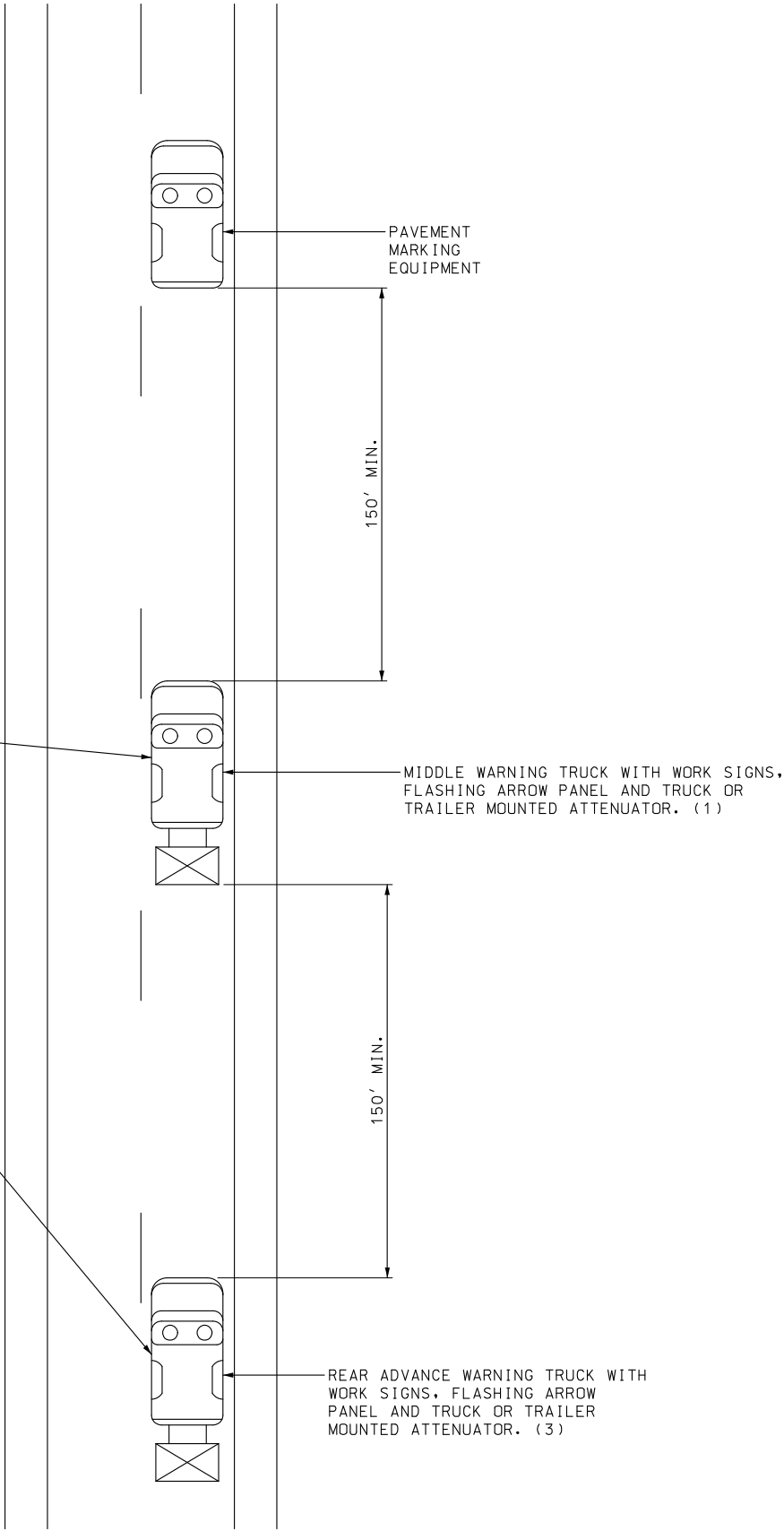
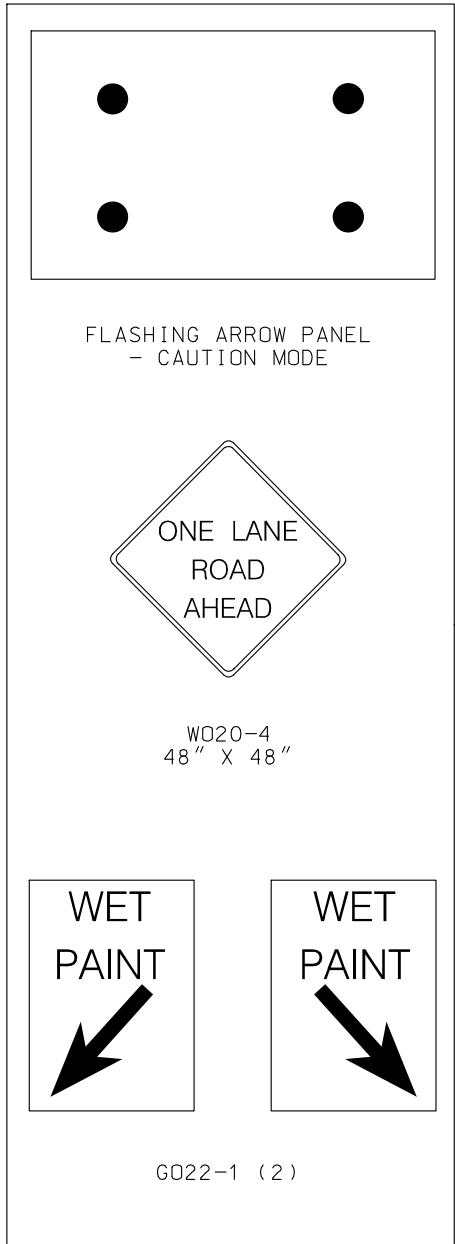

NOTES:

UPON APPROVAL OF THE ENGINEER, THE CONTRACTOR MAY PROVIDE ADDITIONAL PROTECTIVE TRUCK EQUIPPED WITH PROPER WARNING DEVICES.

PROTECTIVE TRUCK AND WORK VEHICLES SHALL DISPLAY HIGH-INTENSITY ROTATING, FLASHING, OSCILLATING, OR STROBE LIGHTS.

VEHICLE HAZARD WARNING SIGNALS SHALL NOT BE USED INSTEAD OF THE VEHICLE'S HIGH-INTENSITY ROTATING, FLASHING, OSCILLATING, OR STROBE LIGHTS.

FLASHING ARROW PANELS SHALL BE INCIDENTAL TO TRUCK MOUNTED ATTENUATORS, WHEREVER USED. NO ADDITIONAL PAYMENT SHALL BE MADE.

(1) TRUCK IS OPTIONAL ON TWO-LANE UNDIVIDED HIGHWAYS IF SIGNING AND ARROW BOARD IS MOUNTED ON THE PAVEMENT MARKING EQUIPMENT.

(2) WET PAINT SIGNS ARE INSTALLED TO INDICATE THE SIDE IN WHICH THE PAVEMENT MARKING MATERIAL IS BEING APPLIED. AT THE CONTRACTOR'S OPTION, A FRONT FACING WET PAINT SIGN MAY BE INSTALLED ON THE LEFT SIDE OF THE PAVEMENT MARKING EQUIPMENT.

(3) REAR ADVANCE WARNING TRUCK IS POSITIONED AT THE NO TRACK POINT OF THE PAVEMENT MARKING MATERIAL, OR VERTICAL OR HORIZONTAL CURVES THAT RESTRICT SIGHT DISTANCE, OR SPACING SHOWN.

STATE OF MISSOURI

JUAN YIN

NUMBER
PE-2011000967

PROFESSIONAL ENGINEER

THIS SHEET HAS BEEN
SIGNED, SEALED AND DATED
ELECTRONICALLY.

DATE PREPARED
7/9/2021

ROUTE
169

DISTRICT
KC

STATE
MO

SHEET NO.
10

COUNTY
CLAY

JOB NO.
J4S3340

CONTRACT ID.

PROJECT NO.

BRIDGE NO.

DATE	DESCRIPTION

MISSOURI HIGHWAYS AND TRANSPORTATION
COMMISSION

MoDOT

105 WEST CAPITOL
JEFFERSON CITY, MO 65102
1-888-ASK-MODOT (1-888-275-6636)

IF A SEAL IS PRESENT ON THIS SHEET IT HAS BEEN ELECTRONICALLY SEALED AND DATED. REV.

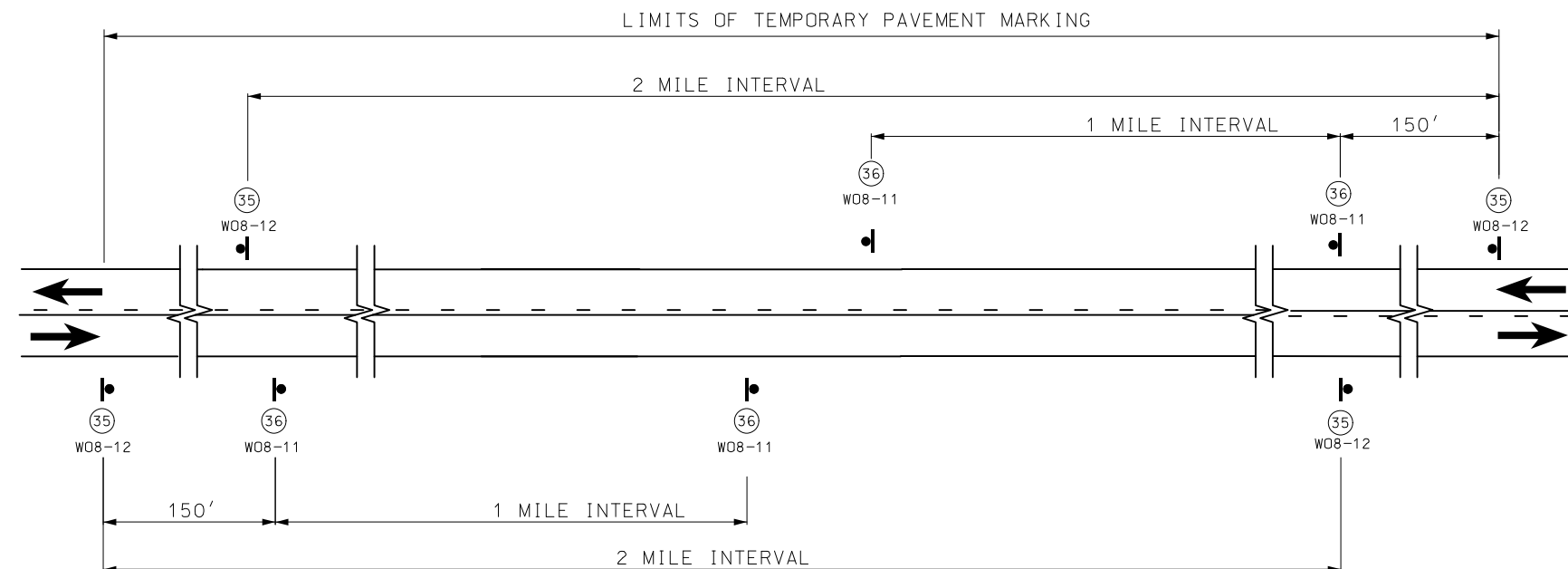

SIGN SPACING AND TEMPORARY STRIPING FOR MAINLINE

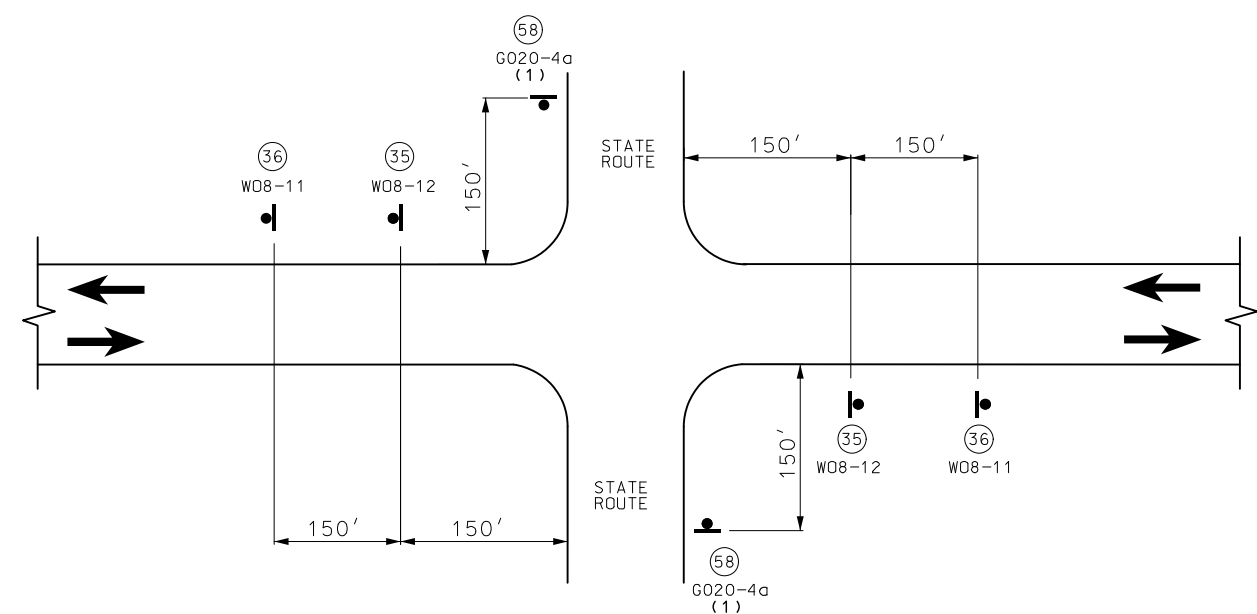

SIGN SPACING AT STATE ROUTE INTERSECTIONS
SHOWING TEMPORARY STRIPING FOR MAINLINE

(1) ADDITIONAL SIDEROADS MAY BE SIGNED AS APPROVED BY THE ENGINEER.

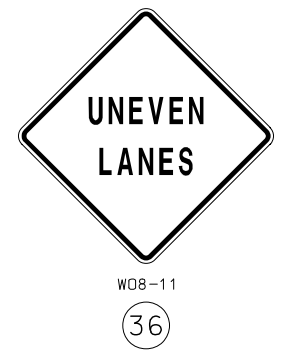

NOTES:

SIGN (35) AND TYPE 2 TRPM INSTALLED WHERE CENTERLINE STRIPING HAS BEEN COVERED OR REMOVED. SIGNS ARE TO REMAIN IN PLACE UNTIL THE PERMANENT CENTERLINE PAVEMENT MARKINGS ARE IN PLACE. SIGNS SHALL BE COVERED OR REMOVED WHEN PAVEMENT CENTERLINE MARKING HAS BEEN INSTALLED.

SIGN (35) IS PLACED AT APPROXIMATELY TWO-MILE INTERVALS AND AT STATE ROUTE JUNCTIONS. WHEN THE INSTALLATION AT A JUNCTION IS WITHIN ONE-EIGHTH MILE OF THE NORMAL MAINLINE SIGN (35), THE LATTER MAY BE ELIMINATED.

ALL SIGNS SHALL BE POST MOUNTED AND IN ACCORDANCE WITH STANDARD PLAN 616.10 AND 903.03.

STATE OF MISSOURI

JUAN YIN

NUMBER
PE-2011000967

PROFESSIONAL ENGINEER

THIS SHEET HAS BEEN
SIGNED, SEALED AND DATED
ELECTRONICALLY.

DATE PREPARED
7/9/2021

ROUTE
169

DISTRICT
KC

STATE
MO

SHEET NO.
11

COUNTY
CLAY

JOB NO.
J4S3340

CONTRACT ID.

PROJECT NO.

BRIDGE NO.

DATE	DESCRIPTION

MISSOURI HIGHWAYS AND TRANSPORTATION
COMMISSION

MoDOT

105 WEST CAPITOL
JEFFERSON CITY, MO 65102
1-888-ASK-MODOT (1-888-275-6636)

NOT TO SCALE

IF A SEAL IS PRESENT ON THIS SHEET IT HAS BEEN ELECTRONICALLY SEALED AND DATED. REV.

