

A.A.D.T. - 2023 = 8000
A.A.D.T. - 2043 = 9000
D.H.V. = 900
T = 10%
V = 35, 45 M.P.H.
D = 50%

FUNCTIONAL CLASSIFICATION - MINOR ARTERIAL

	EXISTING	NEW
BUILDINGS AND STRUCTURES		
GUARD RAIL		
GUARD CABLE		
CONCRETE RIGHT-OF-WAY MARKER		
STEEL RIGHT-OF-WAY MARKER		
LOCATION SURVEY MARKER		
UTILITIES		
FIBER OPTICS	- FO -	- FO -
OVERHEAD CABLE TV	- OTV -	- OTV -
UNDERGROUND CABLE TV	- UTV -	- UTV -
OVERHEAD TELEPHONE	- OT -	- OT -
UNDERGROUND TELEPHONE	- UT -	- UT -
OVERHEAD POWER	- OE -	- OE -
UNDERGROUND POWER	- UE -	- UE -
SANITARY SEWER	- S -	- S -
STORM SEWER	- SS -	- SS -
GAS	- G -	- G -
WATER	- W -	- W -
MANHOLE		
FIRE HYDRANT		
WATER VALVE		
WATER METER		
DROP INLET		
DITCH BLOCK		
GROUND MOUNTED SIGN		
LIGHT POLE		
H-FRAME POWER POLE		
TELEPHONE PEDESTAL		
FENCE		
CHAIN LINK		
WOVEN WIRE		
GATE POST		
BENCHMARK		

DASHED OR OPEN SYMBOLS INDICATE
 EXISTING FEATURES

NOT TO SCALE

PROJECT LIMITS
ROUTE 13

LOG MILE 72.660

LOG MILE 73.967

1.307 MILES

FROM BLACK DIAMOND STREET TO WALMART AVE.

MAINLINE, MILL OFF 0.5" EXISTING UBAWS
FILL WITH 0.75" TYPE B UBAWS ON MAINLINE AND SHOULDERS
SIDEROADS, MILL OFF 1.5", FILL WITH 1.5" BP-1

THE EXISTENCE AND APPROXIMATE LOCATION OF UTILITY FACILITIES KNOWN TO EXIST, AS SHOWN ON THE PLANS, ARE BASED ON THE BEST INFORMATION AVAILABLE TO THE COMMISSION AT THIS TIME. THIS INFORMATION IS PROVIDED BY THE COMMISSION "AS-IS" AND THE COMMISSION EXPRESSLY DISCLAIMS ANY REPRESENTATION OR WARRANTY AS TO THE COMPLETENESS, ACCURACY, OR SUITABILITY OF THE INFORMATION FOR ANY USE. RELIANCE UPON THIS INFORMATION IS DONE AT THE RISK AND PERIL OF THE USER, AND THE COMMISSION SHALL NOT BE LIABLE FOR ANY DAMAGES THAT MAY ARISE FROM ANY ERROR IN THE INFORMATION. IT IS, THEREFORE, THE RESPONSIBILITY OF THE CONTRACTOR TO VERIFY THE EXISTENCE, LOCATION AND STATUS OF ANY FACILITY. SUCH VERIFICATION INCLUDES DIRECT CONTACT WITH THE LISTED UTILITIES.

DESCRIPTION	NUMBER
TITLE SHEET -----	1
TYPICAL SECTIONS (TS) (3 SHEETS)--	2
QUANTITIES (QU) (9 SHEETS)-----	3
SPECIAL SHEETS (SS)-----	4-6
TRAFFIC CONTROL SHEETS (TC)-----	7-23

BEGINNING OF PROJECT	LOG MILE 72.660
END OF PROJECT	LOG MILE 73.967
APPARENT LENGTH	6900.96 FEET
EQUATIONS AND EXCEPTIONS:	

TOTAL CORRECTIONS	0.00 FEET
NET LENGTH OF PROJECT	6900.96 FEET
STATE LENGTH	1.307 MILES
FOR INFORMATION ONLY ESTIMATED DISTURBED ACRES	0.1 ACRES

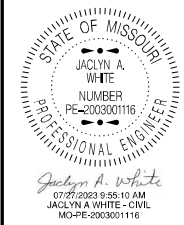

DATE PREPARED	
7/25/2023	
ROUTE	STATE
13	MO
DISTRICT	SHEET NO.
KC	1
COUNTY	
RAY	
JOB NO.	
J3P3108B	
CONTRACT ID.	
PROJECT NO.	
BRIDGE NO.	

[illegible]

MISSOURI HIGHWAYS AND TRANSPORTATION
COMMISSION

105 WEST CAPITOL
JEFFERSON CITY, MO 65102
1-888-ASK-MODOT (1-888-275-6636)

IF A SEAL IS PRESENT ON THIS SHEET IT HAS BEEN ELECTRONICALLY SEALED AND DATED.

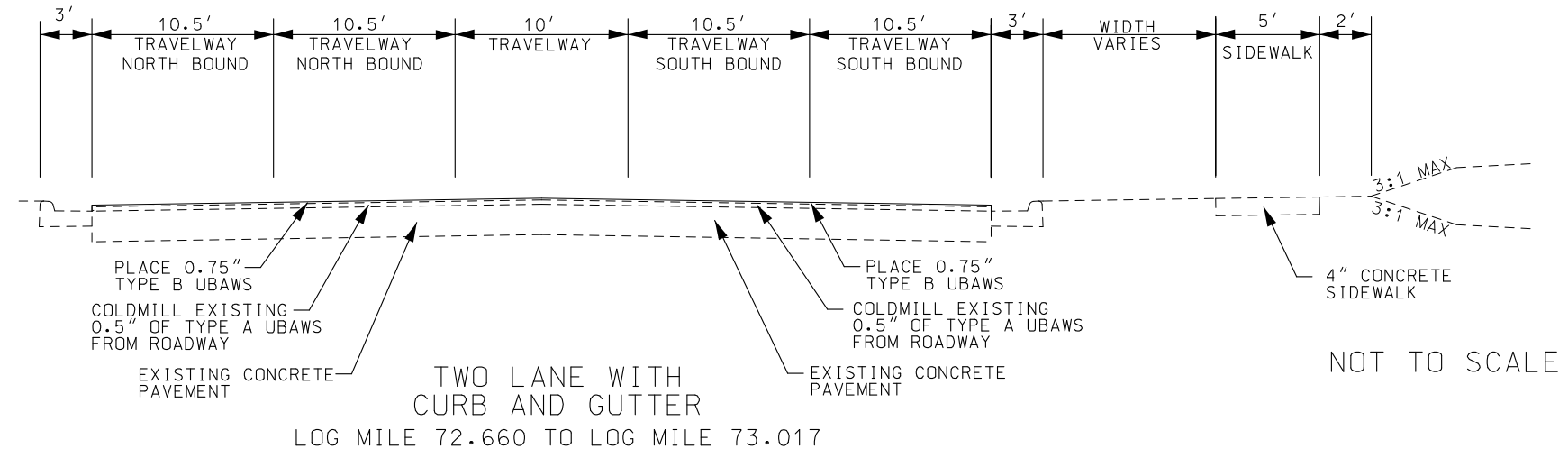
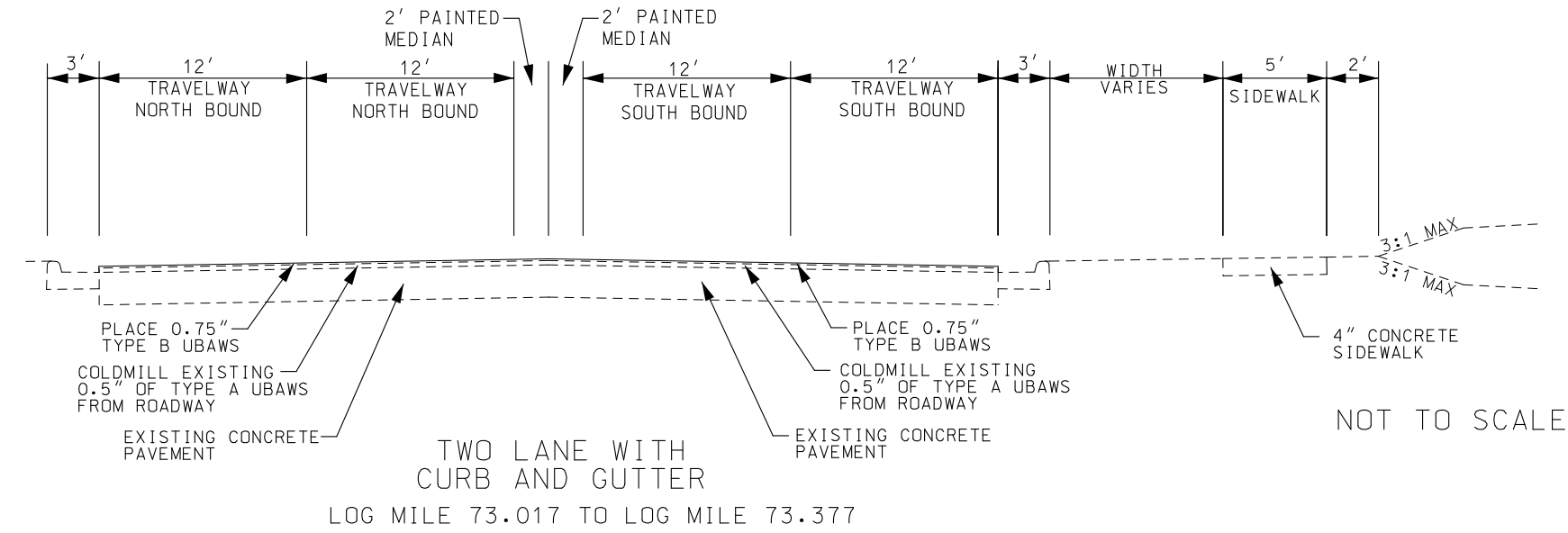
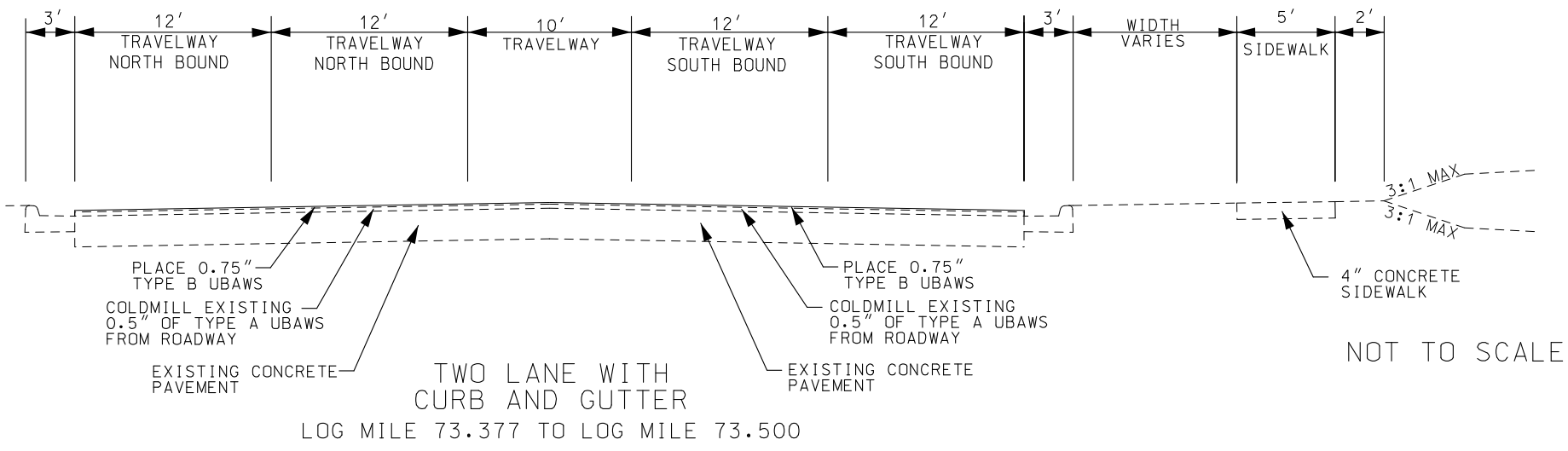

- NOTES:
- (1). NOTIFY ENGINEER TWO WEEKS PRIOR TO PROJECT COMPLETION.
 - (2). SURFACE PLACEMENT SHALL BE ONE PASS PER LANE.
 - (3). NO S.E. CORRECTION, MATCH EXISTING CROSS SLOPE.
 - (4). ANY CHANGES IN PAVEMENT DESIGN SHALL BE APPROVED BY THE ENGINEERIN CHARGE.

STATE OF MISSOURI

JACLYN A. WHITE

NUMBER

PE-2003001116

PROFESSIONAL ENGINEER

Jaclyn A. White

07/27/2023 9:55:55 AM

JACLYN A WHITE - CIVIL

MOPE-0003001116

DATE PREPARED

7/25/2023

ROUTE

13

STATE

MO

DISTRICT

KC

SHEET NO.

2

COUNTY

RAY

JOB NO.

J3P3108B

CONTRACT ID.

PROJECT NO.

BRIDGE NO.

DESCRIPTION

DATE

MISSOURI HIGHWAYS AND TRANSPORTATION COMMISSION

MoDOT

105 WEST CAPITOL

JEFFERSON CITY, MO 65102

1-888-ASK-MODOT (1-888-275-6636)

IF A SEAL IS PRESENT ON THIS SHEET IT HAS BEEN ELECTRONICALLY SEALED AND DATED.

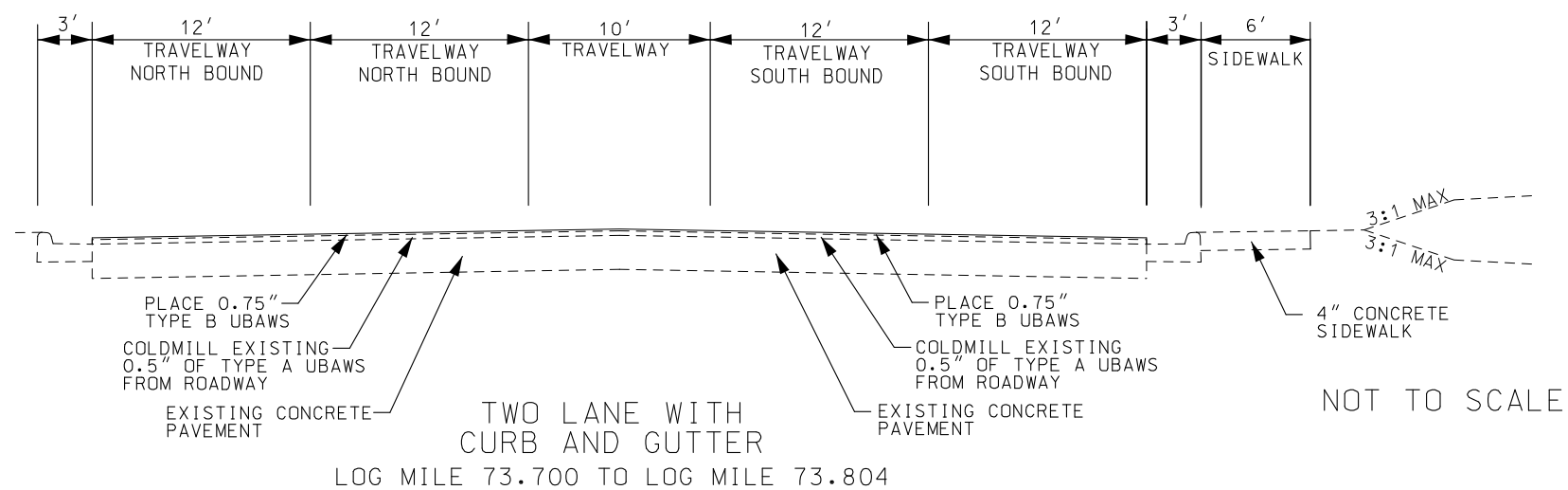
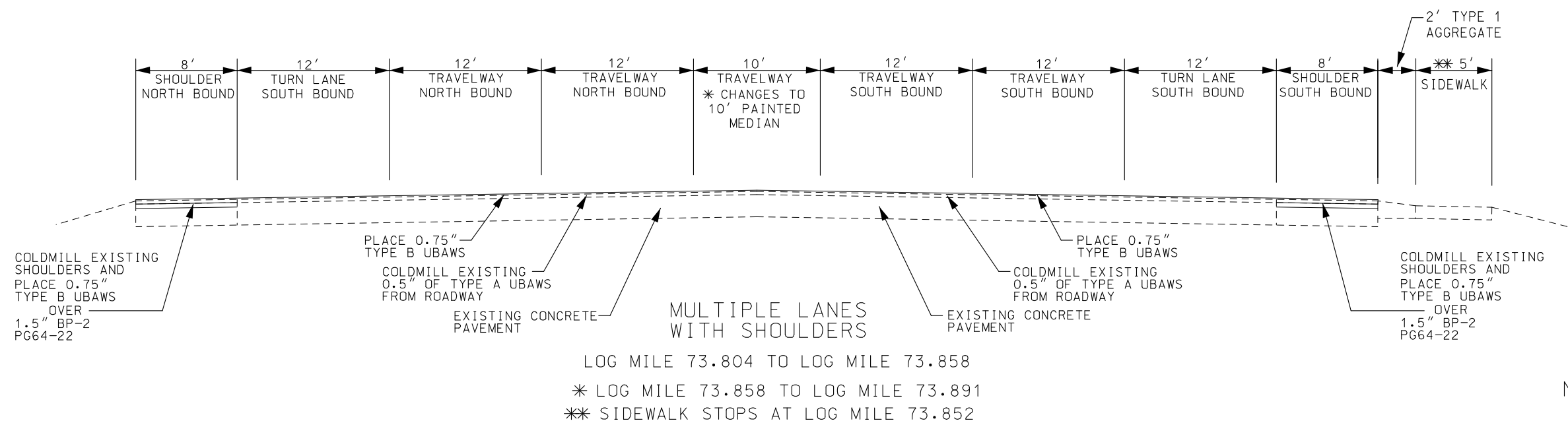
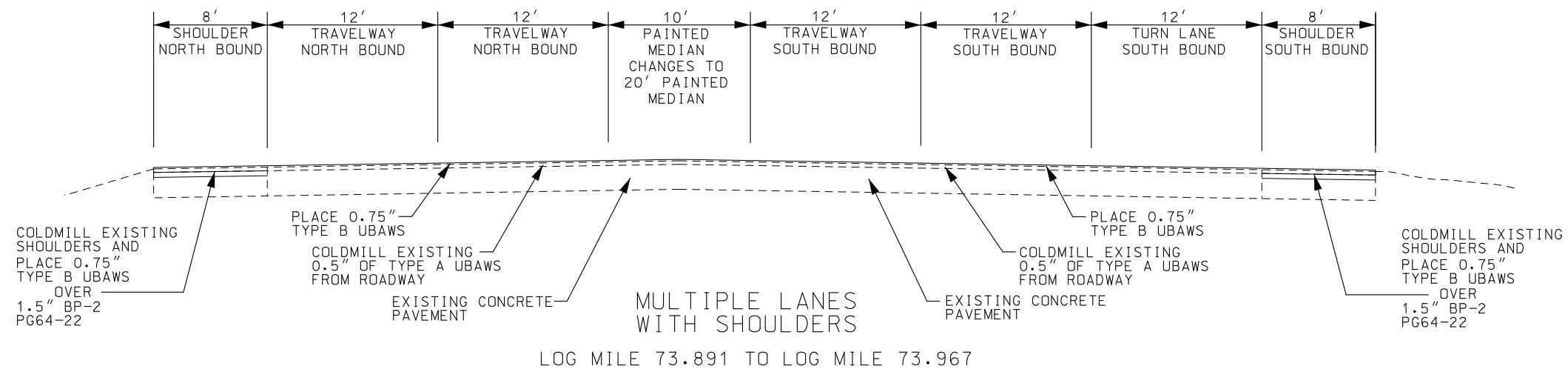

- NOTES:

- (1). NOTIFY ENGINEER TWO WEEKS PRIOR TO PROJECT COMPLETION.
- (2). SURFACE PLACEMENT SHALL BE ONE PASS PER LANE.
- (3). NO S.E. CORRECTION, MATCH EXISTING CROSS SLOPE.
- (4). ANY CHANGES IN PAVEMENT DESIGN SHALL BE APPROVED BY THE ENGINEER IN CHARGE.



Jaclyn A. White
07/27/2023 9:58:18 AM

DATE	DESCRIPTION

MISSOURI HIGHWAYS AND TRANSPORTATION
COMMISSION

105 WEST CAPITOL
JEFFERSON CITY, MD 65102
1-888-ASK-MODOT (1-888-275-6636)

2 INCHES OF TYPE 5 AGGREGATE FOR SHOULDER					
LOG MILE	LOCATION	LENGTH OF SHOULDER	AVERAGE WIDTH OF SHOULDER	SQUARE YARDS	TYPE 5 AGGREGATE
					TONS
73.851	CHAPEL DRIVE, NORTH SIDE OF ROADWAY	255 FEET	8 FEET	226.67	24.93
73.851	CHAPEL DRIVE, SOUTH SIDE OF ROADWAY	255 FEET	8 FEET	226.67	24.93
				TOTAL	49.86

NOTE:
TYPE 5 AGGREGATE FOR SHOULDER EQUALS 0.055 TONS PER SQ. YDS. PER INCH COMPACTED

PAVEMENT WIDENING AT WEST BOUND SOUTH STREET (WEST SIDE OF INTERSECTION)				
LOG MILE	LOCATION	SQUARE YARDS	8" NON-REINF CONCRETE PAVEMENT SQ. YDS.	4 INCHES TYPE 5 AGGREGATE TONS
73.450	SOUTH STREET, WEST BOUND LANE, WEST SIDE OF INTERSECTION	37.3	37.3	8.2
		TOTAL	37.3	8.2

NOTE:
TYPE 5 AGGREGATE FOR WIDENING, EQUALS 0.055 TONS PER SQ. YDS. PER INCH COMPACTED

PAVEMENT REPLACEMENT AT EXISTING ISLANDS (AFTER EXISTING ISLAND REMOVAL)				
LOG MILE	LOCATION	SQUARE YARDS	8" NON-REINF CONCRETE PAVEMENT SQ. YDS.	4 INCHES TYPE 5 AGGREGATE TONS
72.859	ROUTE 13 @ BUSINESS ROUTE 10, ISLAND NORTH EAST QUADRANT	5.7	5.7	1.3
72.859	ROUTE 13 @ BUSINESS ROUTE 10, ISLAND SOUTH WEST QUADRANT	9.8	9.8	2.2
72.859	ROUTE 13 @ BUSINESS ROUTE 10, ISLAND SOUTH EAST QUADRANT	4.8	4.8	1.1
		TOTAL	20.3	4.6

NOTE:
TYPE 5 AGGREGATE FOR WIDENING, EQUALS 0.055 TONS PER SQ. YDS. PER INCH COMPACTED

8" NON-REINF CONCRETE PAVEMENT TOTALS	
LOCATION	SQUARE YARDS
PAVEMENT WIDENING AT SOUTH STREET	37.3
PAVEMENT REPLACEMENT AT EXISTING ISLANDS	20.3
TOTAL	57.6
PAY TOTAL	57.6

TYPE 5 AGGREGATE TOTALS	
LOCATION	TONS
AGGREGATE FOR SHOULDERS AT CHAPEL DRIVE	49.86
AGGREGATE FOR PAVEMENT WIDENING AT SOUTH STREET	8.20
AGGREGATE FOR PAVEMENT REPLACEMENT AT EXISTING ISLANDS	4.60
TOTAL	62.66
PAY TOTAL	62.7

STATE OF MISSOURI

JACLYN A. WHITE

NUMBER
PE-2003001116

PROFESSIONAL ENGINEER

Jaclyn A. White

07/27/2023 10:02:02 AM

JACLYN A. WHITE - CIVIL

MO-PE-2003001116

DATE PREPARED

7/25/2023

ROUTE

13

STATE

MO

DISTRICT

KC

SHEET NO.

3

COUNTY

RAY

JOB NO.

J3P3108B

CONTRACT ID.

PROJECT NO.

BRIDGE NO.

DESCRIPTION

DATE

MISSOURI HIGHWAYS AND TRANSPORTATION COMMISSION

MoDOT

105 WEST CAPITOL

JEFFERSON CITY, MO 65102

1-888-ASK-MODOT (1-888-275-6636)

IF A SEAL IS PRESENT ON THIS SHEET IT HAS BEEN ELECTRONICALLY SEALED AND DATED.

NOTE:
ALL MOUNTING BRACKETS AND HARDWARE SHALL BE INCLUDED IN THE COST OF THE SIGNS

NOTE:
ANY ADDITIONAL QUESTIONS ABOUT SIGN LOCATIONS CONTACT THE DISTRICT TRAFFIC ENGINEER.

NOTE:
ANY ADDITIONAL QUESTIONS ABOUT SIGN LOCATIONS CONTACT THE DISTRICT TRAFFIC ENGINEER.

QUANTITIES
SHEET 7 OF 9



MISSOURI HIGHWAYS AND TRANSPORTATION
COMMISSION

105 WEST CAPITOL
JEFFERSON CITY, MO 65102

IF A SEAL IS PRESENT ON THIS SHEET IT HAS BEEN ELECTRONICALLY SEALED AND DATED.

REMOVAL OF IMPROVEMENTS					
LOG MILE	LOCATION	DESCRIPTION	QUANTITY	UNITS	
72.783	NORTH MAIN STREET, EAST OF ROUTE 13	REMOVE 22' OF SIDEWALK AND CURB NEED TO BUILD CURB RAMP, NORTH SIDE OF NORTH MAIN STREET, EAST OF ROUTE 13	12.2 +/-	SQ. YDS.	
72.792	NORTH MAIN STREET, EAST OF ROUTE 13	REMOVE 22' OF SIDEWALK AND CURB NEED TO BUILD CURB RAMP, SOUTH SIDE OF NORTH MAIN STREET, EAST OF ROUTE 13	12.2 +/-	SQ. YDS.	
72.848	RTE 13, NORTH OF RTE 13 & BUSINESS RTE 10 INTERSECTION	REMOVE THE BUSINESS ROUTE 13 SIGN & DIRECTIONAL SIGN FROM THE EXISTING POST	1	EACH	
72.848	RTE 13, NORTH OF RTE 13 & BUSINESS RTE 10 INTERSECTION	REMOVE THE SCHOOL ZONE SIGN FROM THE EXISTING POST	1	EACH	
72.859	ROUTE 13 @ BUSINESS ROUTE 10, NORTH EAST QUADRANT	REMOVE EXISTING ISLAND, INCLUDING PAVEMENT AND BASEROCK BELOW EXISTING ISLAND	5.7 +/-	SQ. YDS.	
72.859	ROUTE 13 @ BUSINESS ROUTE 10, SOUTH WEST QUADRANT	REMOVE EXISTING ISLAND, INCLUDING PAVEMENT AND BASEROCK BELOW EXISTING ISLAND	9.8 +/-	SQ. YDS.	
72.859	ROUTE 13 @ BUSINESS ROUTE 10, SOUTH EAST QUADRANT	REMOVE EXISTING ISLAND, INCLUDING PAVEMENT AND BASEROCK BELOW EXISTING ISLAND	4.8 +/-	SQ. YDS.	
72.859	ROUTE 13 @ BUSINESS ROUTE 10, NORTH EAST QUADRANT	SAW CUT ALONG EXISTING CONCRETE ISLAND AND PAVEMENT. FOR ISLAND AND PAVEMENT REMOVAL	28.35' +/-	L.F.	
72.859	ROUTE 13 @ BUSINESS ROUTE 10, SOUTH WEST QUADRANT	SAW CUT ALONG EXISTING CONCRETE ISLAND AND PAVEMENT. FOR ISLAND AND PAVEMENT REMOVAL	37.48' +/-	L.F.	
72.859	ROUTE 13 @ BUSINESS ROUTE 10, SOUTH EAST QUADRANT	SAW CUT ALONG EXISTING CONCRETE ISLAND AND PAVEMENT. FOR ISLAND AND PAVEMENT REMOVAL	25.42' +/-	L.F.	
72.859	ROUTE 13 @ BUSINESS ROUTE 10, INTERSECTION	LOOP DETECTORS, ROUTE 13 & BUSINESS ROUTE 10 ENTIRE INTERSECTION (IF NEEDED)	4037' +/-	L.F.	
72.859	ROUTE 13 @ BUSINESS ROUTE 10, NORTH EAST QUADRANT	REMOVE 1 SIGN POST, THAT PRESENTLY HAS 3 SIGNS, 1- BUSINESS ROUTE 10 SIGN, 2- ROUTE 13 SIGNS, 3-ARROW SIGNS	1	EACH	
72.859	ROUTE 13 @ BUSINESS ROUTE 10, SOUTH WEST QUADRANT	REMOVE 1 SIGN POST, THAT PRESENTLY HAS 1 SIGN, 1- ROUTE 13 SIGN, 1-ARROW SIGN	1	EACH	
72.859	ROUTE 13 @ BUSINESS ROUTE 10, SOUTH WEST QUADRANT	REMOVE 1 SIGN POST, THAT PRESENTLY HAS 3 SIGNS, 1- BUSINESS ROUTE 10 SIGN, 1- BUSINESS ROUTE 13 SIGN, 1- ROUTE 13 SIGN, 3-ARROW SIGNS	1	EACH	
72.859	ROUTE 13 @ BUSINESS ROUTE 10, SOUTH EAST QUADRANT	REMOVE 1 SIGN POST, THAT PRESENTLY HAS 2 SIGNS, 1- BUSINESS ROUTE 10 SIGN, 1- BUSINESS ROUTE 13 SIGN, 2-ARROW SIGNS	1	EACH	
72.872	RTE 13, SOUTH OF RTE 13 & BUSINESS RTE 10 INTERSECTION	REMOVE THE EXISTING POST AND SCHOOL ZONE SIGN	1	EACH	
72.872	RTE 13, SOUTH OF RTE 13 & BUSINESS RTE 10 INTERSECTION	REMOVE THE EXISTING POST AND LOGO SIGN (BP SIGN) SO IT CAN BE RELOCATED	1	EACH	
72.966	LEXINGTON STREET, EAST OF ROUTE 13	REMOVE 10' OF SIDEWALK AND CURB NEED TO BUILD CURB RAMP, NORTH SIDE OF LEXINGTON STREET, EAST OF ROUTE 13	5.6 +/-	SQ. YDS.	
72.975	LEXINGTON STREET, EAST OF ROUTE 13	REMOVE 10' OF SIDEWALK AND CURB NEED TO BUILD CURB RAMP, SOUTH SIDE OF LEXINGTON STREET, EAST OF ROUTE 13	5.6 +/-	SQ. YDS.	
73.450	ROUTE 13 @ SOUTH STREET, WEST SIDE OF INTERSECTION	REMOVE EXISTING ROCK AND DIRT AT RADIUS FOR WIDENING AT SOUTH STREET, WEST BOUND LANE,	52.1 +/-	SQ. YDS.	
73.456	ROUTE 13 @ SOUTH STREET, INTERSECTION	LOOP DETECTORS, ROUTE 13 & SOUTH STREET ENTIRE INTERSECTION (IF NEEDED)	3388 +/-	L.F.	
73.955	ROUTE 13 @ WALTON WAY, INTERSECTION	LOOP DETECTORS, ROUTE 13 & WALTON WAY ENTIRE INTERSECTION (IF NEEDED)	2584 +/-	L.F.	
		TOTAL	1 LUMP SUM		

LOOP DETECTORS					
LOG MILE	LOCATION	IN DUCT	LEAD-IN	REMARKS	
		(LF)	(LF)		
72.859	ROUTE 13 @ BUSINESS ROUTE 10	306	214	TURN LANE, NORTH SIDE ON ROUTE 13	
72.859	ROUTE 13 @ BUSINESS ROUTE 10	294	214	PASSING LANE, NORTH SIDE ON ROUTE 13	
72.859	ROUTE 13 @ BUSINESS ROUTE 10	284	214	DRIVING LANE, NORTH SIDE ON ROUTE 13	
72.859	ROUTE 13 @ BUSINESS ROUTE 10	316	216	TURN LANE, SOUTH SIDE ON ROUTE 13	
72.859	ROUTE 13 @ BUSINESS ROUTE 10	304	216	PASSING LANE, SOUTH SIDE ON ROUTE 13	
72.859	ROUTE 13 @ BUSINESS ROUTE 10	294	216	DRIVING LANE, SOUTH SIDE ON ROUTE 13	
72.859	ROUTE 13 @ BUSINESS ROUTE 10	299	336	DRIVING LANE, WEST SIDE ON BUSINESS ROUTE 10	
72.859	ROUTE 13 @ BUSINESS ROUTE 10	279	35	DRIVING LANE, EAST SIDE ON BUSINESS ROUTE 10	
73.456	ROUTE 13 @ SOUTH STREET	304	238	TURN LANE, NORTH SIDE ON ROUTE 13	
73.456	ROUTE 13 @ SOUTH STREET	294	238	PASSING LANE, NORTH SIDE ON ROUTE 13	
73.456	ROUTE 13 @ SOUTH STREET	284	238	DRIVING LANE, NORTH SIDE ON ROUTE 13	
73.456	ROUTE 13 @ SOUTH STREET	314	188	TURN LANE, SOUTH SIDE ON ROUTE 13	
73.456	ROUTE 13 @ SOUTH STREET	304	188	PASSING LANE, SOUTH SIDE ON ROUTE 13	
73.456	ROUTE 13 @ SOUTH STREET	294	188	DRIVING LANE, SOUTH SIDE ON ROUTE 13	
73.456	ROUTE 13 @ SOUTH STREET	284	32	DRIVING LANE, EAST SIDE ON SOUTH STREET	
73.955	ROUTE 13 @ WALTON WAY	299	148	PASSING LANE, NORTH SIDE ON ROUTE 13	
73.955	ROUTE 13 @ WALTON WAY	289	148	DRIVING LANE, NORTH SIDE ON ROUTE 13	
73.955	ROUTE 13 @ WALTON WAY	314	147	TURN LANE, SOUTH SIDE ON ROUTE 13	
73.955	ROUTE 13 @ WALTON WAY	302	147	PASSING LANE, SOUTH SIDE ON ROUTE 13	
73.955	ROUTE 13 @ WALTON WAY	292	147	DRIVING LANE, SOUTH SIDE ON ROUTE 13	
73.955	ROUTE 13 @ WALTON WAY	316	35	DRIVING LANE, WEST SIDE ON WALTON WAY	
	TOTAL	6266	3743		
	PAY TOTAL	6270	3740		

QUANTITIES
SHEET 8 OF 9

STATE OF MISSOURI
JACLYN A. WHITE
NUMBER
PE-2003001116
PROFESSIONAL ENGINEER

Jaclyn A. White
07/27/2023 10:03:37 AM
JACLYN A WHITE - CIVIL
MO-PE-2003001116

DATE PREPARED	
7/25/2023	
ROUTE	STATE
13	MO
DISTRICT	SHEET NO.
KC	3

COUNTY
RAY

JOB NO.
J3P3108B

CONTRACT ID.

PROJECT NO.

BRIDGE NO.[illegible]

MISSOURI HIGHWAYS AND TRANSPORTATION
COMMISSION

105 WEST CAPITAL
JEFFERSON CITY, MO 65102
1-888-ASK-MODOT (1-888-275-6636)

IF A SEAL IS PRESENT ON THIS SHEET IT HAS BEEN ELECTRONICALLY SEALED AND DATED.

DATE PREPARED	
7/25/2023	
ROUTE	STATE
13	MO
DISTRICT	SHEET NO.
KC	3

JOB NO.
J3P3108B

PROJECT NO.

--	--	--	--	--	--	--	--

[illegible]

TOL
102
36)

TAT: CAPI
0 65
5-66

WEST
Y, M
38-27TRANS
105 W
N CITT
1-888

D T
ION



1-888-



MCM

MIS

--	--

NOTE:
ISLAND REMOVAL AND PAVEMENT REPLACEMENT QUANTITIES MAY VARY DUE TO THE DETERIORATION OF EXISTING ISLANDS. THE ENGINEER IN CHARGE SHALL DETERMINE THE ACTUAL SQ. YARD QUANTITY FOR THE REPLACEMENT OF THE PAVEMENT UNDER THE EXISTING ISLANDS.

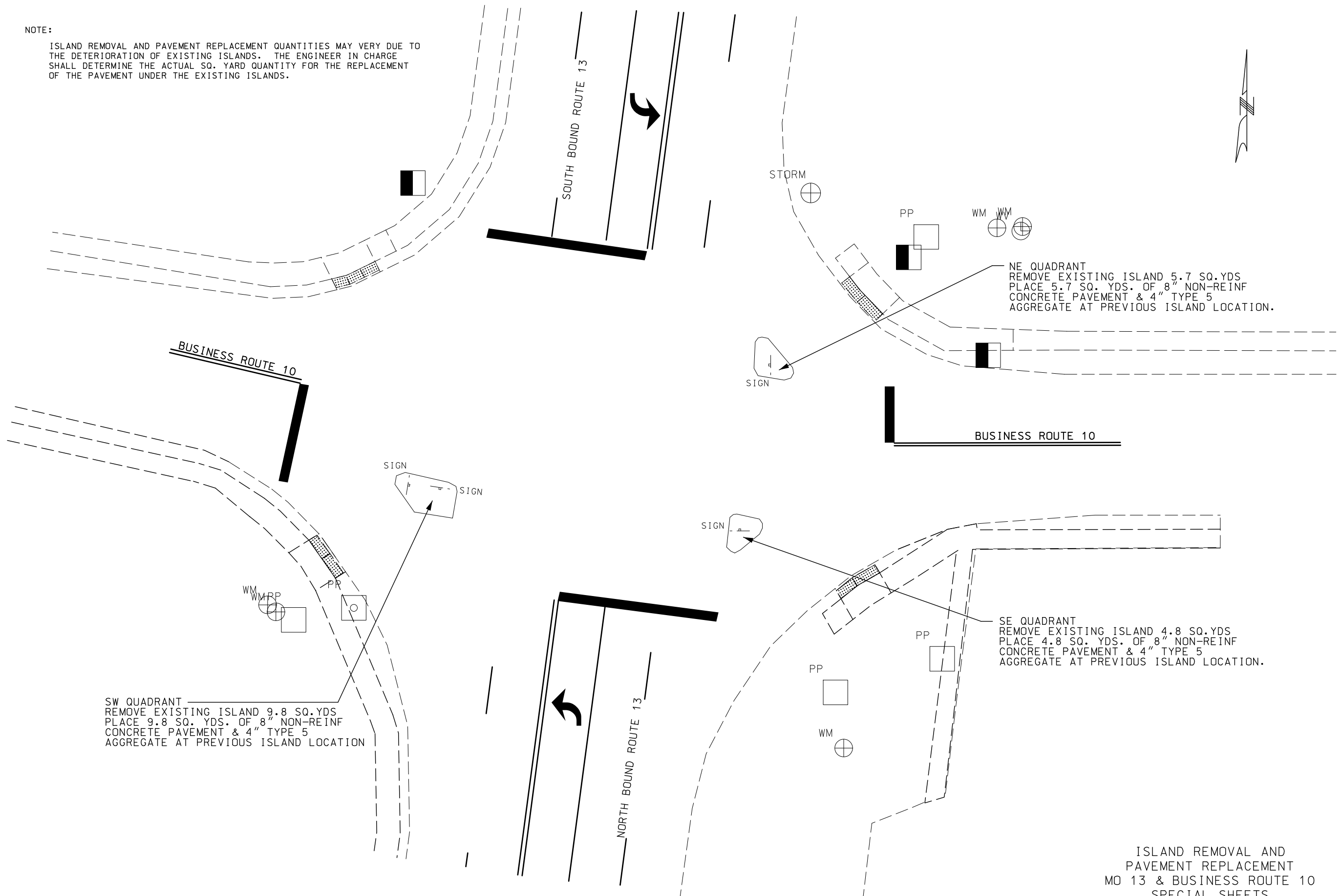

NOT TO SCALE

ISLAND REMOVAL AND
PAVEMENT REPLACEMENT
MO 13 & BUSINESS ROUTE 10
SPECIAL SHEETS
1 OF 3



Jaclyn A. White
07/27/2023 10:04:19 AM
JACLYN A WHITE - CIVIL
MO-PE-2003001116

DATE PREPARED
7/25/2023

ROUTE 13 STATE MO

DISTRICT KC SHEET NO. 4

COUNTY RAY

JOB NO. J3P3108B

CONTRACT ID.

PROJECT NO.

BRIDGE NO.

DESCRIPTION

DATE

DATE

DATE

DATE

DATE

DATE

DATE

DATE

DATE

DATE

DATE

DATE

DATE

DATE

DATE

DATE

DATE

DATE

DATE

DATE

DATE

DATE

DATE

DATE

DATE

DATE

DATE

DATE

DATE

DATE

DATE

DATE

DATE

DATE

DATE

DATE

DATE

DATE

DATE

DATE

DATE

DATE

DATE

DATE

DATE

DATE

DATE

DATE

DATE

DATE

DATE

DATE

DATE

DATE

DATE

DATE

DATE

DATE

DATE

DATE

DATE

DATE

DATE

DATE

DATE

MISSOURI HIGHWAYS AND TRANSPORTATION
COMMISSION
105 WEST CAPITOL
JEFFERSON CITY, MO 65102
1-888-ASK-MODOT (1-888-275-6636)

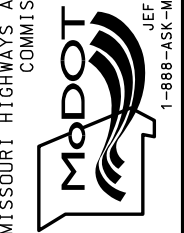

IF A SEAL IS PRESENT ON THIS SHEET IT HAS BEEN ELECTRONICALLY SEALED AND DATED.

REMOVE THE SCHOOL ZONE SIGN AND THE BUSINESS ROUTE 13 SIGN PLUS THE ARROW DIRECTIONAL SIGN FOR BUSINESS ROUTE 13 FROM THE EXISTING POST

EXISTING POST POST NUMBER 1
ADD NEW ROUTE 13 SIGN AND NEW DIRECTIONAL ARROW SIGN TO POST

SW QUADRANT REMOVE EXISTING POST AND SIGNS FROM EXISTING ISLAND

NE QUADRANT REMOVE EXISTING POST AND SIGNS FROM EXISTING ISLAND

NEW POST POST NUMBER 2
PLACE SIGN POST IN THE GREEN SPACE BETWEEN THE ROADWAY AND SIDEWALK THE POST CAN BE LOCATED 50'-70' FROM CROSSWALK LOCATION
ADD NEW ROUTE 13 SIGN AND NEW DIRECTIONAL ARROW SIGN
ALSO ADD NEW ROUTE 10 SIGN, NEW BUSINESS SIGN AND NEW DIRECTIONAL ARROW SIGN

BUSINESS ROUTE 10

NEW POST POST NUMBER 3
PLACE SIGN POST BETWEEN THE SIDEWALK AND CURB, ALSO PLACED AFTER THE SCHOOL ZONE SIGN WHICH IS LOCATED ON A EXISTING UTILITY POLE
ADD NEW ROUTE 13 SIGN AND NEW DIRECTIONAL ARROW SIGN
ALSO ADD NEW ROUTE 10 SIGN, NEW BUSINESS SIGN AND NEW DIRECTIONAL ARROW SIGN

SW QUADRANT REMOVE EXISTING POST AND SIGNS FROM EXISTING ISLAND

SE QUADRANT REMOVE EXISTING POST AND SIGNS FROM EXISTING ISLAND

NEW POST POST NUMBER 4
PLACE NEW SIGN WHERE EXISTING LOGO SIGN (BP SIGN) IS LOCATED
ADD NEW ROUTE 13 SIGN AND NEW DIRECTIONAL ARROW SIGN
ALSO ADD NEW ROUTE 10 SIGN
NEW BUSINESS SIGN AND NEW DIRECTIONAL ARROW SIGN

REMOVE THE EXISTING SCHOOL ZONE SIGN
PLACE EXISTING LOGO'S (BP SIGN) WHERE SCHOOL ZONE SIGN PREVIOUSLY WAS LOCATED

SIGN REMOVALS AND NEW SIGN LOCATIONS
MO 13 & BUSINESS ROUTE 10
SPECIAL SHEETS
2 OF 3

NOTE:
THE ENGINEER IN CHARGE SHALL CONTACT THE DISTRICT TRAFFIC ENGINEER ABOUT ANY QUESTIONS PERTAINING TO SIGN RELOCATIONS.

NOT TO SCALE

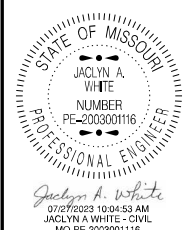

DATE PREPARED 7/25/2023	
ROUTE 13	STATE MO
DISTRICT KC	SHEET NO. 5
COUNTY RAY	
JOB NO. J3P3108B	
CONTRACT ID.	
PROJECT NO.	
BRIDGE NO.	

DATE	DESCRIPTION

MISSOURI HIGHWAYS AND TRANSPORTATION COMMISSION



105 WEST CAPITOL
JEFFERSON CITY, MO 65102
1-888-ASK-MODOT (1-888-275-6636)

IF A SEAL IS PRESENT ON THIS SHEET IT HAS BEEN ELECTRONICALLY SEALED AND DATED.

Traffic Control Legend,
Sign Spacing, Device Spacing, Channelizing Taper Lengths
And Recommended Maximum Speed Reductions

SPEED	SIGN SPACING (ft.)		TAPER LENGTH (ft.)		OPTIONAL	CHANNELIZER SPACING (ft.)	
	UNDIVIDED (S)	DIVIDED (S)	SHOULDER (1) (T1)	LANE (2) (T2)	BUFFER LENGTH (ft.) (B)	TAPERS	BUFFER LENGTH (ft.)
0-35	—	200	70	245	280	35	40
40-45	—	500	150	540	400	40	80
50-55	—	1000	185	660	560	50	80
60-70	—	SA-1000	235	840	840	60	120
		SB-1500					
		SC-2640					

1. SHOULDER TAPER LENGTH BASED ON 10 FT. (STANDARD SHOULDER WIDTH) OFFSET. 2. LANE TAPER LENGTH BASED ON 12 FT. (STANDARD LANE WIDTH) OFFSET.

SPEED	SIGN SPACING (ft.)		TAPER LENGTH (ft.)		OPTIONAL	CHANNELIZER SPACING (ft.)	
	UNDIVIDED (S)	DIVIDED (S)	SHOULDER (1) (T1)	LANE (2) (T2)	BUFFER LENGTH (ft.) (B)	TAPERS	BUFFER LENGTH (ft.)
0-35	200	—	70	245	280	35	40
40-45	350	—	150	540	400	40	80
50-55	500	—	185	660	560	50	80
60-70	1000	—	235	840	840	60	120

1. SHOULDER TAPER LENGTH BASED ON 10 FT. (STANDARD SHOULDER WIDTH) OFFSET.
2. LANE TAPER LENGTH BASED ON 12 FT. (STANDARD LANE WIDTH) OFFSET.

** THE SA DIMENSION IS THE DISTANCE FROM THE TRANSITION OR POINT OF RESTRICTION TO THE FIRST SIGN.
 THE SB DIMENSION IS THE DISTANCE BETWEEN THE FIRST AND SECOND SIGNS.
 THE SC DIMENSION IS THE DISTANCE BETWEEN THE SECOND AND THIRD SIGNS.
 (THE "FIRST SIGN" IS THE SIGN IN A THREE-SIGN SERIES THAT IS CLOSEST TO THE TEMPORARY TRAFFIC CONTROL ZONE. THE "THIRD SIGN" IS THE SIGN THAT IS FURTHEST UPSTREAM FROM THE TEMPORARY TRAFFIC CONTROL ZONE)

DETAILS NOTES:

- (1) SPACING BETWEEN SIGNS AND SPACING BETWEEN LAST SIGN AND FLAGGER, BEGINNING OF TAPER, OF SIGNED CONDITION.
- (2) SPACING MAY BE ADJUSTED AS NECESSARY TO MEET FIELD CONDITIONS.
- (3) TAPER LENGTHS SHOWN INCLUDE LENGTH REQUIRED FOR LANE AND 10' SHOULDER
- (4) CONCRETE BARRIER MAY BE INSTALLED AT 8:1 FLARE RATE FROM THE SHOULDER POINT OF THE LIMITS OF THE CLEAR ZONE WHERE THE SIDE SLOPE IS 6:1 OR FLATTER

TAPER LENGTH (L)
 L = W X P FOR 40 MPH OR MORE
 $L = \frac{WP^2}{60}$ FOR 35 MPH OR LESS
 L = TAPER LENGTH IN FEET
 W = LATERAL SHIFT IN FEET
 P = POSTED SPEED PRIOR TO ROAD WORK IN MPH

TRAFFIC CONTROL LEGEND

SIGN (SINGLE SIDED)

FLAGGER

CHANNELIZER

PROTECTIVE VEHICLE WITH WORK SIGN, FLASHING ARROW PANEL AND REAR-MOUNTED IMPACT ATTENUATOR UNIT.

FLASHING ARROW PANEL

CHANGEABLE MESSAGE BOARD

BARRICADE

TUBULAR MARKERS

LEGEND NOTE:
 THE PROTECTIVE VEHICLE SIGN SHALL BE MOUNTED AT A RECOMMENDED HEIGHT OF 48 IN. ABOVE THE ROAD SURFACE.

GENERAL NOTES:

1. SEE STANDARD PLAN 616.10 FOR DETAILS AND ITEMS NOT SHOWN.
2. EXISTING SIGNS SHALL BE COVERED DURING WORKING HOURS ONLY IF IN CONFLICT WITH TRAFFIC CONTROL PLANS.
3. NO DIRECT PAYMENT WILL BE MADE FOR RELOCATING, COVERING, UNCOVERING OR REMOVING SIGNS.
4. CONES ALLOWABLE FOR DAYTIME OPERATIONS ONLY.
5. LOCATE FLASHING ARROW PANEL AT BEGINNING OF TAPER WHEN FEASIBLE, ARROW PANELS ARE ALWAYS LOCATED BEHIND CHANNELIZERS OR CONES.
6. THE PLACEMENT OF THE CMS's ARE TO BE DIRECTED BY THE ENGINEER IN CHARGE.

EPG TABLE 616.12 RECOMMENDED MAXIMUM SPEED REDUCTIONS	
ACTIVITY (I.E. WORKERS, EQUIPMENT OR MATERIAL) LOCATION	RECOMMENDED WORK ZONE SPEED REDUCTION (WHEN APPLICABLE)
10 FT. BEYOND EDGE OF TRAVELWAY TO EDGE OF RIGHT OF WAY	NO SPEED REDUCTION
IN TRAFFIC LANE OR WITHIN 10FT. OF THE TRAFFIC LANE	10 MPH
HEAD-TO-HEAD ON MULTILANE	10 MPH
SPECIAL CIRCUMSTANCES WITHIN A TEMPORARY TRAFFIC CONTROL WORK ZONE MAY WARRANT A LOWER SPEED LIMIT THAN RECOMMENDED ABOVE. ALL SPEED LIMIT REDUCTIONS GREATER THAN 10 MPH SHALL BE DOCUMENTED, SUBMITTED TO AND APPROVED BY THE DISTRICT WORK ZONE COORDINATOR.	

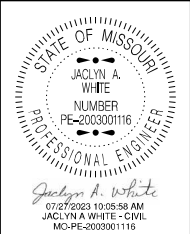

DATE PREPARED
7/25/2023

ROUTE
13

DISTRICT
KC

STATE
MO

SHEET NO.
7

COUNTY
RAY

JOB NO.
J3P3108B

CONTRACT ID.

PROJECT NO.

BRIDGE NO.

DESCRIPTION	DATE

MISSOURI HIGHWAYS AND TRANSPORTATION COMMISSION

105 WEST CAPITOL
JEFFERSON CITY, MO 65102
1-888-ASK-MODOT (1-888-275-6636)

IF A SEAL IS PRESENT ON THIS SHEET IT HAS BEEN ELECTRONICALLY SEALED AND DATED. REV.

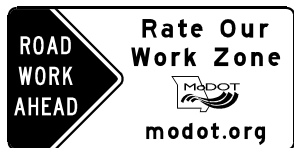

CONST-7-48 (2) (4)
OR
CONST-7-72 (2) (4)

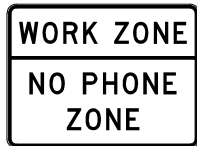

SPECIAL (6)

BEGINNING OF PROJECT LIMITS;
OR INITIAL WORK ZONE SIGN, IF
LOCATED OUTSIDE PROJECT LIMITS.



CONST-5-48 (3) (5)
OR
CONST-5-96 (3) (5)

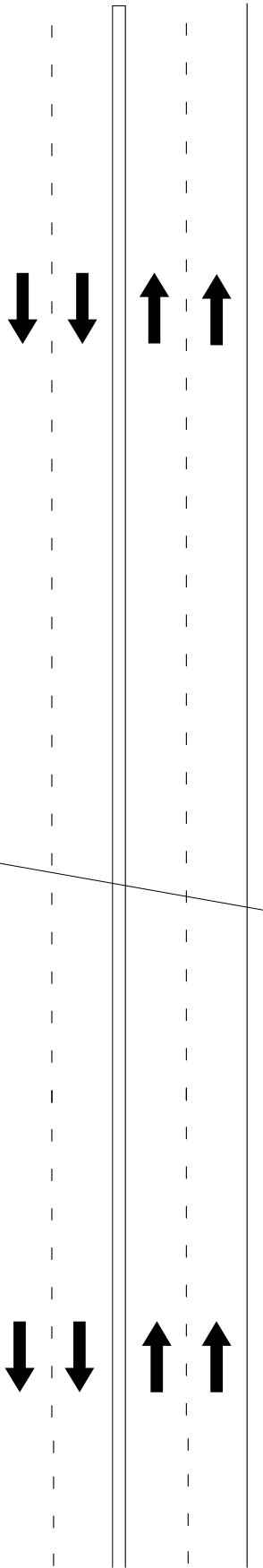
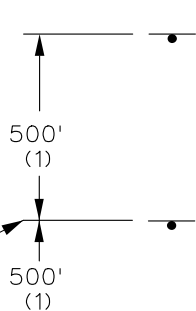

MULTI-LANE UNDIVIDED
BEGIN/END OF PROJECT SIGNING

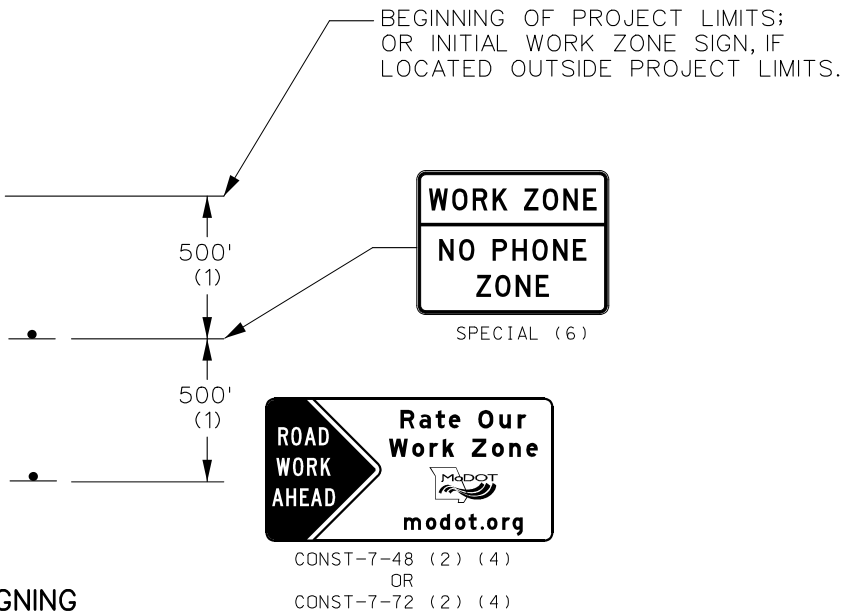

NOTES:

- SIGN G020-1 IS REQUIRED PER EPG 616.6.56.
- SIGN G020-2 IS USED ON ALL PROJECTS WHERE SIGN G020-1 IS USED.
- OTHER SIGNS SUCH AS DETOUR OR ALTERNATE ROUTE SIGNING MAY BE USED OUTSIDE THE PROJECT LIMITS.
- ANY EXISTING SIGNING THAT CONFLICTS WITH THE TRAFFIC CONTROL SIGNING SHALL BE COMPLETELY COVERED OR REMOVED.
- (1) DISTANCE MAY BE ADJUSTED ACCORDING TO FIELD CONDITIONS. WHERE TRAFFIC BACKUPS ARE EXPECTED BEYOND THE ADVANCE WARNING AREA, ADDITIONAL SIGNING MAY BE NEEDED.
- (2) SIGN CONST-7-48 OR CONST-7-72 IS PLACED 500 FEET BEFORE THE BEGINNING OF PROJECT LIMITS OR THE ROAD WORK AHEAD SIGN OR ROAD WORK NEXT XX MILES SIGN, IF USED, WHEN THESE SIGNS ARE LOCATED OUTSIDE THE PROJECT LIMITS.
- (3) SIGN CONST-5-96 OR CONST-5-48 IS PLACED IN A VISIBLE AREA WITHIN THE PROJECT LIMITS PROVIDED ITS PLACEMENT DOES NOT DISRUPT A SEQUENCE OF SIGNS. IF A VISIBLE LOCATION WITHIN THE PROJECT IS NOT AVAILABLE, THE SIGN MAY BE PLACED 500 FEET BEFORE SIGN CONST-7-48 OR CONST-7-72.
- (4) THE "RATE OUR WORK ZONE" SIGN IS AVAILABLE IN TWO SIZES DEPENDING ON ROADWAY CONDITIONS. THE 48 IN. X 24 IN. SIGN IS USED ON LOW VOLUME ROUTES THAT CARRY 400 AADT OR LESS, ON PROJECTS THAT HAVE A DURATION OF 4 WEEKS OR LESS OR IN URBAN AREAS WHERE THERE IS INSUFFICIENT RIGHT OF WAY FOR A SIX FOOT WIDE SIGN. THE 72 IN. X 36 IN. VERSION OF THE SIGN IS USED IN ALL OTHER APPLICATIONS. BUT CAN ALSO BE USED IN PLACE OF THE 48 IN. X 24 IN. SIGN IF ADDED EMPHASIS IS DEEMED NECESSARY.
- (5) THE "POINT OF PRESENCE" SIGN IS AVAILABLE IN TWO SIZES DEPENDING ON ROADWAY CONDITION. THE 48 IN. X 36 IN. SIGN IS USED ON LOW VOLUME ROUTES THAT CARRY 400 AADT OR LESS, ON PROJECTS THAT HAVE A DURATION OF 4 WEEKS OR LESS OR IN URBAN AREAS WHERE THERE IS INSUFFICIENT RIGHT OF WAY FOR AN EIGHT FOOT WIDE SIGN. THE 96 IN. X 48 IN. VERSION OF THE SIGN IS USED IN ALL OTHER APPLICATIONS. BUT CAN ALSO BE USED IN PLACE OF THE 48 IN. X 36 IN. SIGN IF ADDED EMPHASIS IS DEEMED NECESSARY.
- (6) THE "WORK ZONE NO PHONE ZONE" SIGN IS PLACED A MINIMUM OF 500 FEET BEFORE THE ROAD WORK AHEAD SIGN.

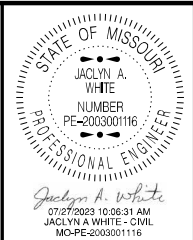

DATE PREPARED
7/25/2023

ROUTE 13	STATE MO
DISTRICT KC	SHEET NO. 8

COUNTY
RAY

JOB NO.
J3P3108B

CONTRACT ID.

PROJECT NO.

BRIDGE NO.

DATE	DESCRIPTION

MISSOURI HIGHWAYS AND TRANSPORTATION COMMISSION

105 WEST CAPITOL
JEFFERSON CITY, MO 65102
1-888-ASK-MODOT (1-888-275-6636)

IF A SEAL IS PRESENT ON THIS SHEET IT HAS BEEN ELECTRONICALLY SEALED AND DATED.

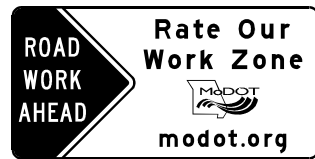
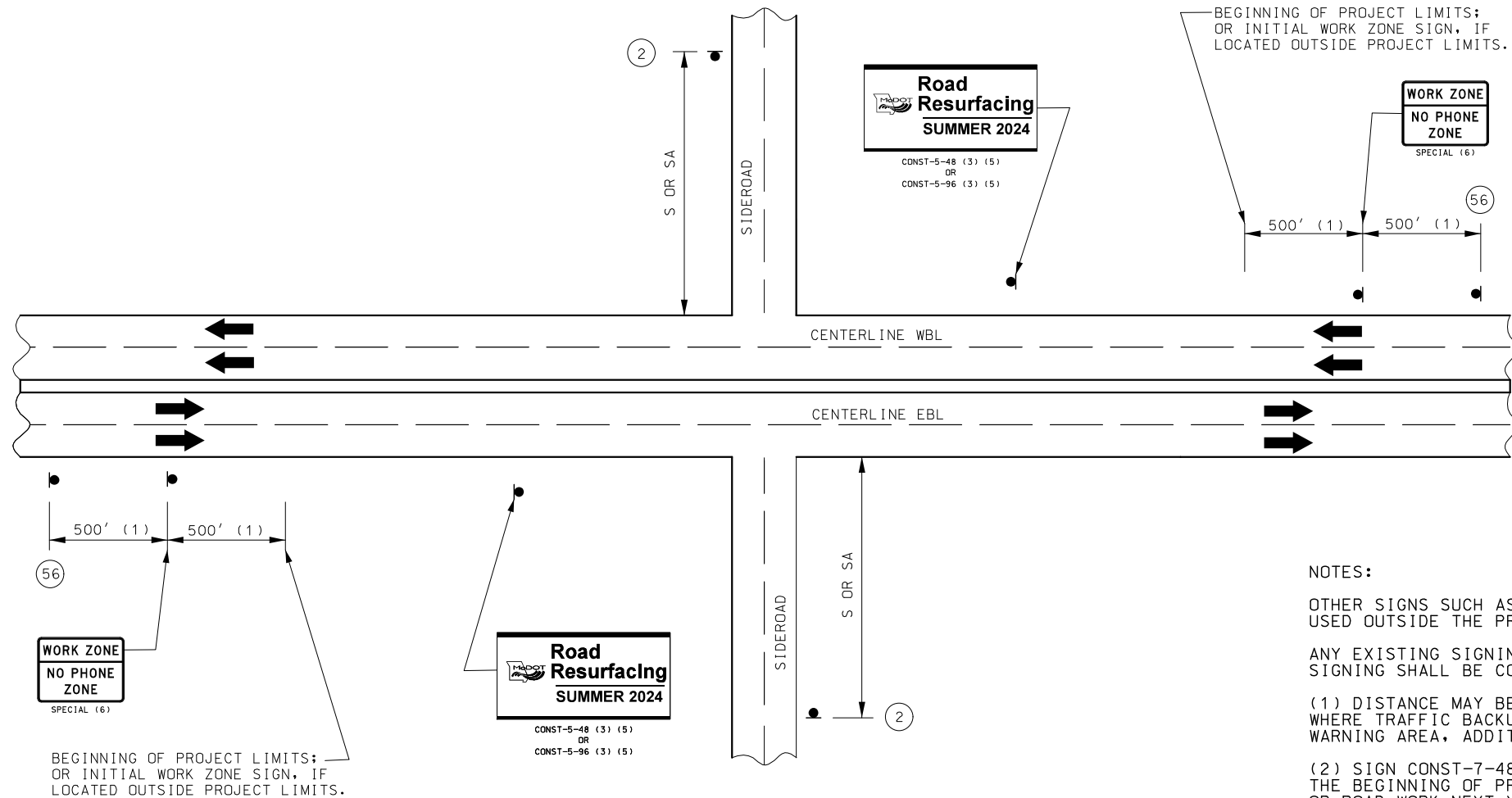

CONST-7-48 (2) (4)
OR
CONST-7-72 (2) (4)

56



SPECIAL (6)



CONST-5-48 (3) (5)
OR
CONST-5-96 (3) (5)



W020-1

2

NOTES:

OTHER SIGNS SUCH AS DETOUR OR ALTERNATE ROUTE SIGNING MAY BE USED OUTSIDE THE PROJECT LIMITS.

ANY EXISTING SIGNING THAT CONFLICTS WITH THE TRAFFIC CONTROL SIGNING SHALL BE COMPLETELY COVERED OR REMOVED.

(1) DISTANCE MAY BE ADJUSTED ACCORDING TO FIELD CONDITIONS. WHERE TRAFFIC BACKUPS ARE EXPECTED BEYOND THE ADVANCE WARNING AREA, ADDITIONAL SIGNING MAY BE NEEDED.

(2) SIGN CONST-7-48 OR CONST-7-72 IS PLACED 500 FEET BEFORE THE BEGINNING OF PROJECT LIMITS OR THE ROAD WORK AHEAD SIGN OR ROAD WORK NEXT XX MILES SIGN, IF USED, WHEN THESE SIGNS ARE LOCATED OUTSIDE THE PROJECT LIMITS.

(3) SIGN CONST-5-48 OR CONST-5-96 IS PLACED IN A VISIBLE AREA WITHIN THE PROJECT LIMITS PROVIDED ITS PLACEMENT DOES NOT DISRUPT A SEQUENCE OF SIGNS. IF A VISIBLE LOCATION WITHIN THE PROJECT IS NOT AVAILABLE, THE SIGN MAY BE PLACED 500 FEET BEFORE SIGN CONST-7-48 OR CONST-7-72.

(4) THE "RATE OUR WORK ZONE" SIGN IS AVAILABLE IN TWO SIZES DEPENDING ON ROADWAY CONDITIONS. THE 48 IN. X 24 IN. SIGN IS USED ON LOW VOLUME ROUTES THAT CARRY 400 AADT OR LESS, ON PROJECTS THAT HAVE A DURATION OF 4 WEEKS OR LESS OR IN URBAN AREAS WHERE THERE IS INSUFFICIENT RIGHT OF WAY FOR A SIX FOOT WIDE SIGN. THE 72 IN. X 36 IN. VERSION OF THE SIGN IS USED IN ALL OTHER APPLICATIONS. BUT CAN ALSO BE USED IN PLACE OF THE 48 IN. X 24 IN. SIGN IF ADDED EMPHASIS IS DEEMED NECESSARY.

(5) THE "POINT OF PRESENCE" SIGN IS AVAILABLE IN TWO SIZES DEPENDING ON ROADWAY CONDITION. THE 48 IN. X 36 IN. SIGN IS USED ON LOW VOLUME ROUTES THAT CARRY 400 AADT OR LESS, ON PROJECTS THAT HAVE A DURATION OF 4 WEEKS OR LESS OR IN URBAN AREAS WHERE THERE IS INSUFFICIENT RIGHT OF WAY FOR AN EIGHT FOOT WIDE SIGN. THE 96IN. X 48 IN. VERSION OF THE SIGN IS USED IN ALL OTHER APPLICATIONS. BUT CAN ALSO BE USED IN PLACE OF THE 48 IN. X 36 IN. SIGN IF ADDED EMPHASIS IS DEEMED NECESSARY.

(6) THE "WORK ZONE NO PHONE ZONE" SIGN IS PLACED A MINIMUM OF 500 FEET BEFORE THE ROAD WORK AHEAD SIGN.

SIDE ROAD
TEMPORARY
TRAFFIC CONTROL
SHEET 3 OF 17

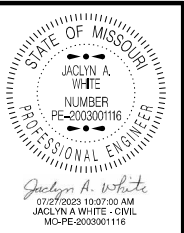

DATE PREPARED
7/25/2023

ROUTE 13 STATE MO
DISTRICT KC SHEET NO. 9

COUNTY
RAY

JOB NO.
J3P3108B

CONTRACT ID.

PROJECT NO.

BRIDGE NO.

DESCRIPTION	DATE

MISSOURI HIGHWAYS AND TRANSPORTATION COMMISSION

105 WEST CAPITOL
JEFFERSON CITY, MO 65102
1-888-ASK-MODOT (1-888-275-6636)

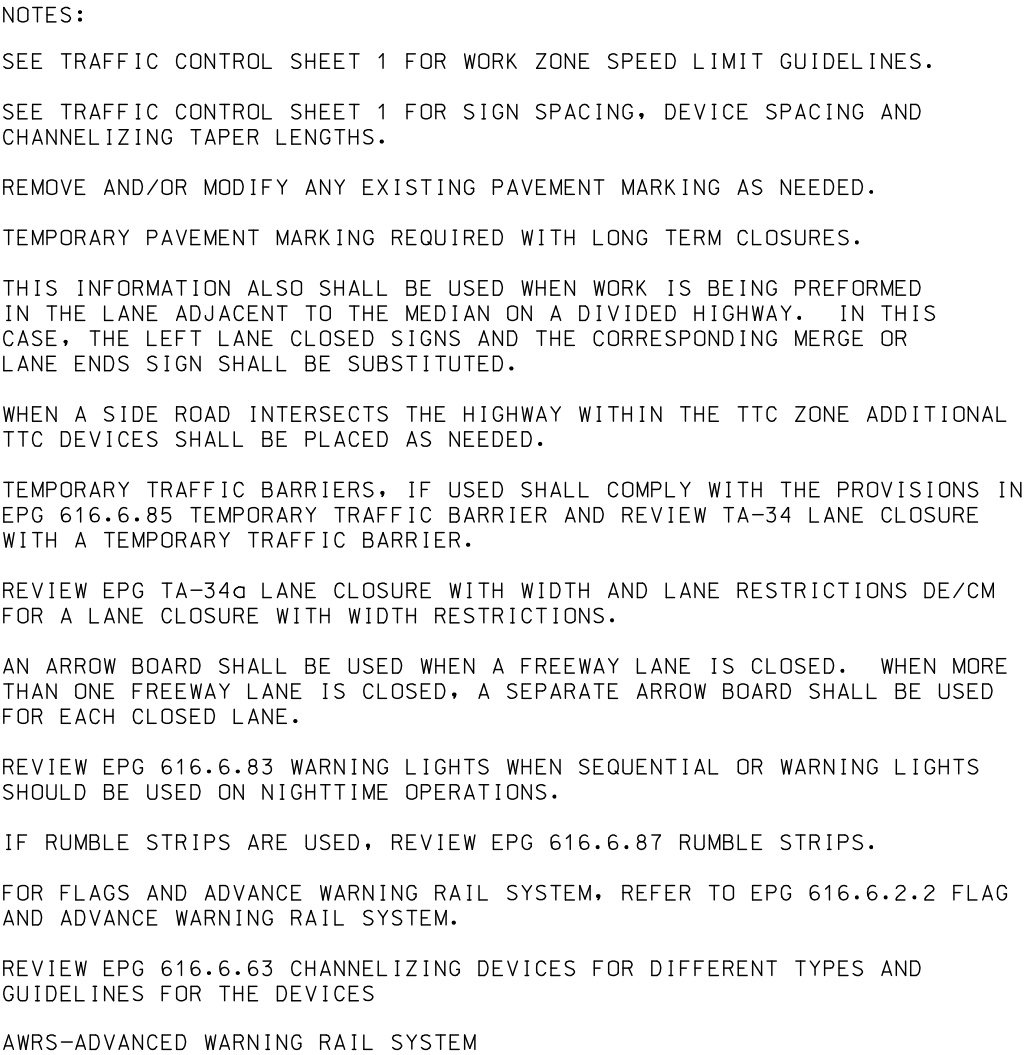

SHOULDER WORK
LANE CLOSURE
TEMPORARY
TRAFFIC CONTROL
SHEET 6 OF 17



MISSOURI HIGHWAYS AND TRANSPORTATION
COMMISSION

105 WEST CAPITAL
JEFFERSON CITY, MO 65102

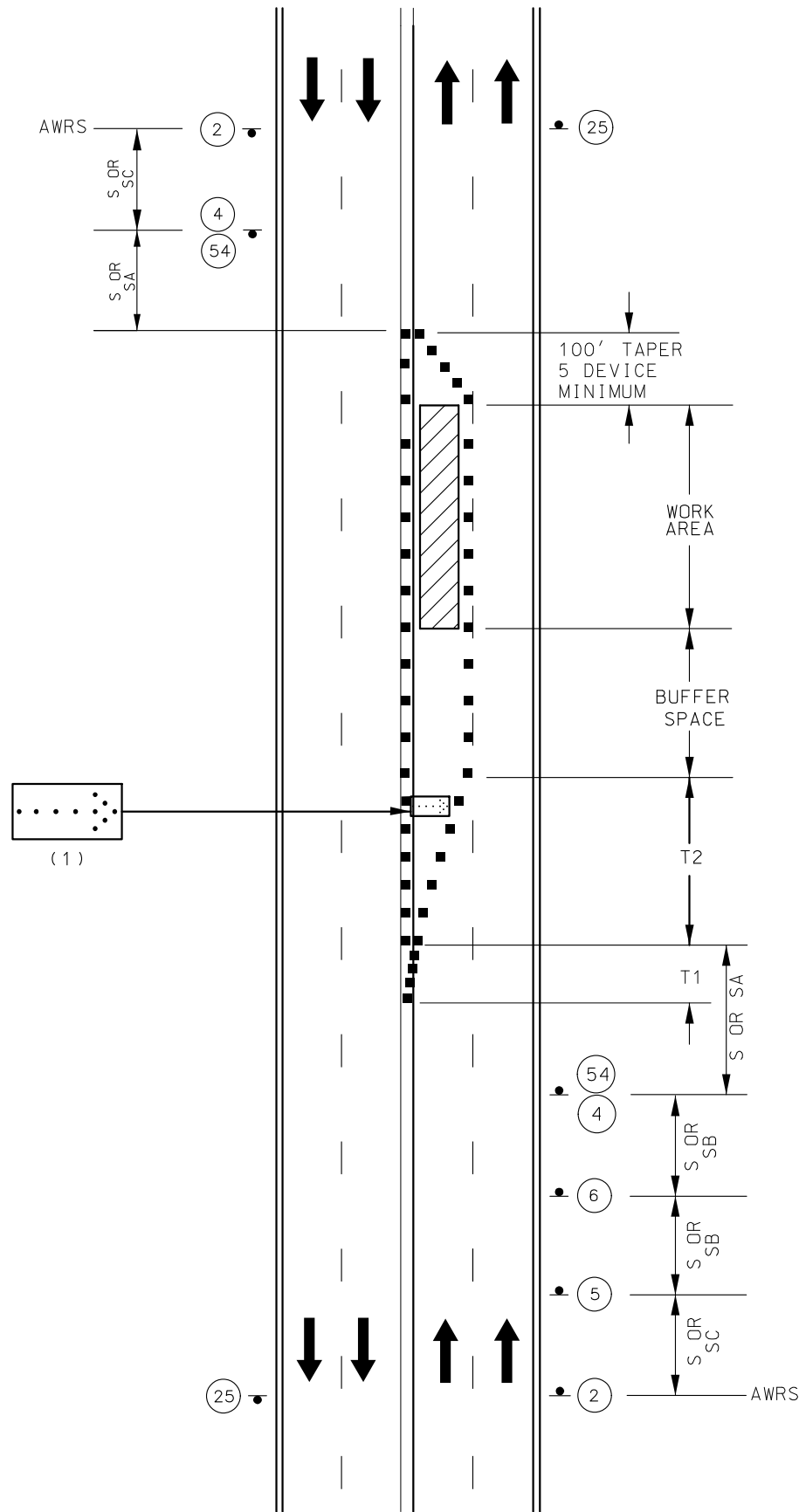

LANE CLOSURE
MULTI-LANE UNDIVIDED HIGHWAY

BRIDGE
OR
RAMP
W025-6

ROAD
WORK
AHEAD

W020-1

(2)

CENTER
LANE
CLOSED
AHEAD

W020-5

(5)

LEFT
OR
RIGHT

RIGHT
LANE
CLOSED

W020-6a

(6)

CENTER
OR
LEFT

SPEED
LIMIT
35

R2-1

(4)

SPEED
LIMIT
45

R2-1
NORMAL SPEED

(25)

WORK
ZONE

G020-5aP

(54)

FLASHING
ARROW
PANEL

CHANNEL IZERS

NOTES:

SEE TRAFFIC CONTROL SHEET 1 FOR WORK ZONE SPEED LIMIT GUIDELINES, OR EPG 616.12.

SEE TRAFFIC CONTROL SHEET 1 FOR SIGN SPACING, DEVICE SPACING AND CHANNELIZING TAPER LENGTHS.

REMOVE AND/OR MODIFY ANY EXISTING PAVEMENT MARKING AS NEEDED.

TEMPORARY PAVEMENT MARKING REQUIRED WITH LONG TERM CLOSURES.

WHEN A SIDE ROAD INTERSECTS THE HIGHWAY WITHIN THE TTC ZONE ADDITIONAL TTC DEVICES SHALL BE PLACED AS NEEDED.

TEMPORARY TRAFFIC BARRIERS, IF USED SHALL COMPLY WITH THE PROVISIONS IN EPG 616.6.85 TEMPORARY TRAFFIC BARRIER AND REVIEW TA-34 LANE CLOSURE WITH A TEMPORARY TRAFFIC BARRIER.

REVIEW EPG TA-34a LANE CLOSURE WITH WIDTH AND LANE RESTRICTIONS DE/CM FOR A LANE CLOSURE WITH WIDTH RESTRICTIONS.

REVIEW EPG 616.6.83 WARNING LIGHTS WHEN SEQUENTIAL OR WARNING LIGHTS SHOULD BE USED ON NIGHTTIME OPERATIONS.

IF RUMBLE STRIPS ARE USED, REVIEW EPG 616.6.87 RUMBLE STRIPS.

FOR FLAGS AND ADVANCE WARNING RAIL SYSTEM, REFER TO EPG 616.6.2.2 FLAG AND ADVANCE WARNING RAIL SYSTEM.

REVIEW EPG 616.6.63 CHANNELIZING DEVICES FOR DIFFERENT TYPES AND GUIDELINES FOR THE DEVICES

AWRS-ADVANCED WARNING RAIL SYSTEM

(1). THE FLASHING ARROW BOARD SHOULD BE LOCATED AT THE BEGINNING OF THE MERGING TAPER WHEN MEDIAN WIDTH ALLOW THIS PLACEMENT.

STATE OF MISSOURI
JACLYN A. WHITE
NUMBER
PE-2003001116
PROFESSIONAL ENGINEER
Jaclyn A. White
07/27/2023 10:09:12 AM
JACLYN A WHITE - CIVIL
MO-PE-2003001116

DATE PREPARED
7/25/2023

ROUTE
13

DISTRICT
KC

STATE
MO

SHEET NO.
13

COUNTY
RAY

JOB NO.
J3P3108B

CONTRACT ID.

PROJECT NO.

BRIDGE NO.

DESCRIPTION

DATE

MISSOURI HIGHWAYS AND TRANSPORTATION
COMMISSION

105 WEST CAPITOL
JEFFERSON CITY, MO 65102
1-888-ASK-MODOT (1-888-275-6636)

MoDOT

IF A SEAL IS PRESENT ON THIS SHEET IT HAS BEEN ELECTRONICALLY SEALED AND DATED.

REV.

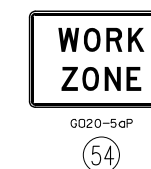
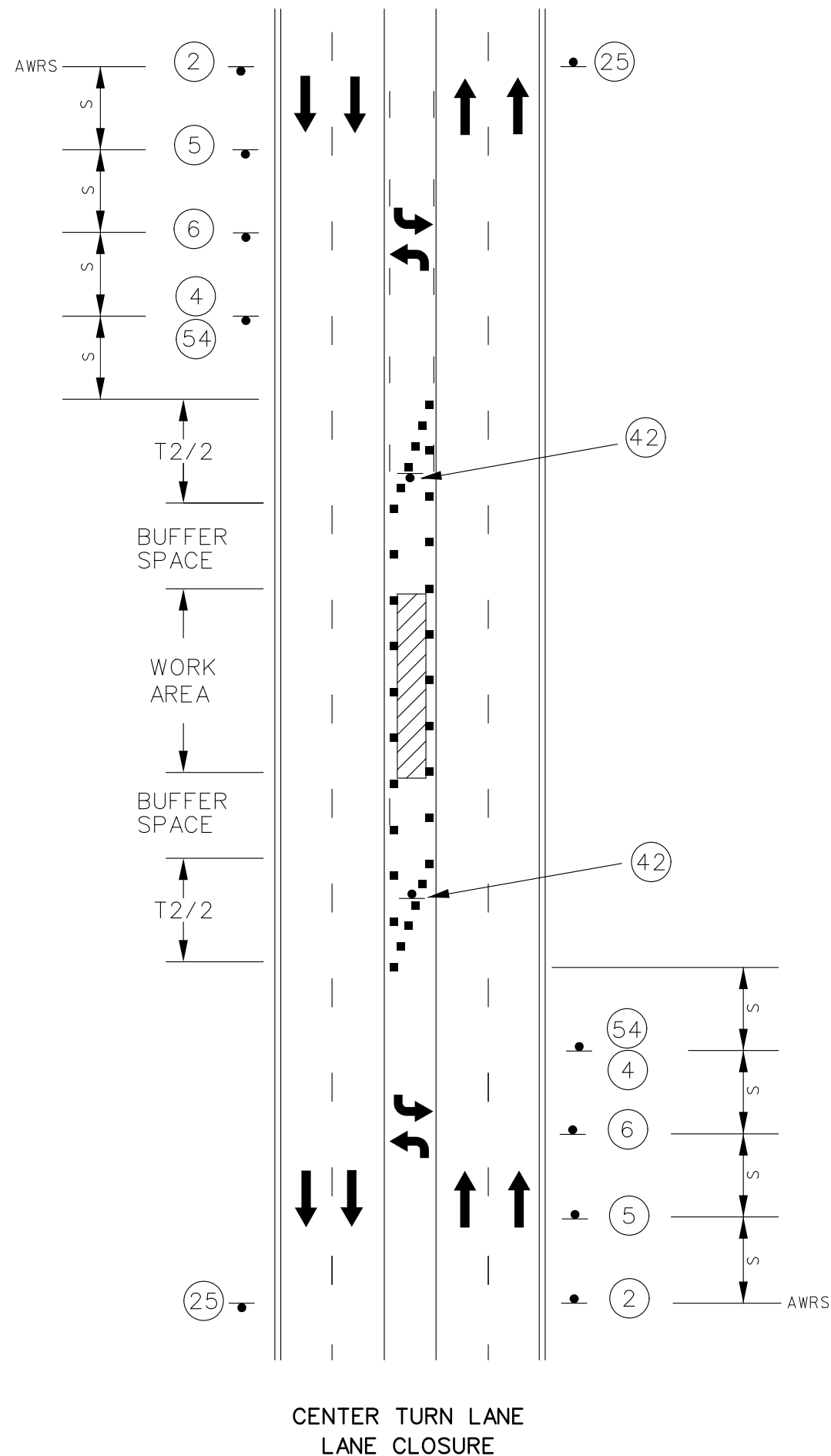

NOTES:

SIGN ⑤ MAY BE OMITTED IN URBAN AREAS WHERE THERE IS NOT SUFFICIENT SPACE FOR THE FULL SIGN SERIES, AND THE POSTED SPEED LIMIT PRIOR TO CONSTRUCTION IS 45 MPH OR LESS.

SEE TRAFFIC CONTROL SHEET 1 FOR WORK
ZONE SPEED LIMIT GUIDELINES.

SEE TRAFFIC CONTROL SHEET 1 FOR SIGN
SPACING, DEVICE SPACING AND CHANNELIZING
TAPER LENGTHS.

REMOVE AND/OR MODIFY ANY EXISTING PAVEMENT
MARKING AS NEEDED.

TEMPORARY PAVEMENT MARKING REQUIRED WITH
LONG TERM CLOSURES.

FOR SHORT TERM OPERATIONS WHERE IT IS NOT FEASIBLE TO MODIFY PAVEMENT MARKING, A 10' DEVICE SPACING IS USED IN THE SHIFTING TAPERS AND WHERE TRAFFIC IS GUIDED ACROSS OTHER CONFLICTING PAVEMENT MARKING, ALL OTHER SPACINGS ARE ONE-HALF OF THE TYPICAL SPACING.

AWRS-ADVANCED WARNING RAIL SYSTEM

[illegible]

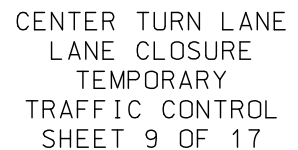
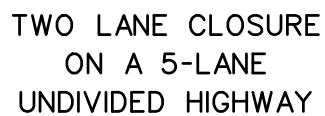
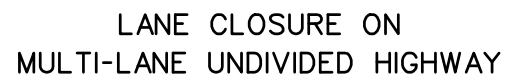

(1) SIGN 44 IS ONLY REQUIRED WHERE FULL LENGTH SHIFTING TAPERS CANNOT BE PROVIDED.

[illegible]

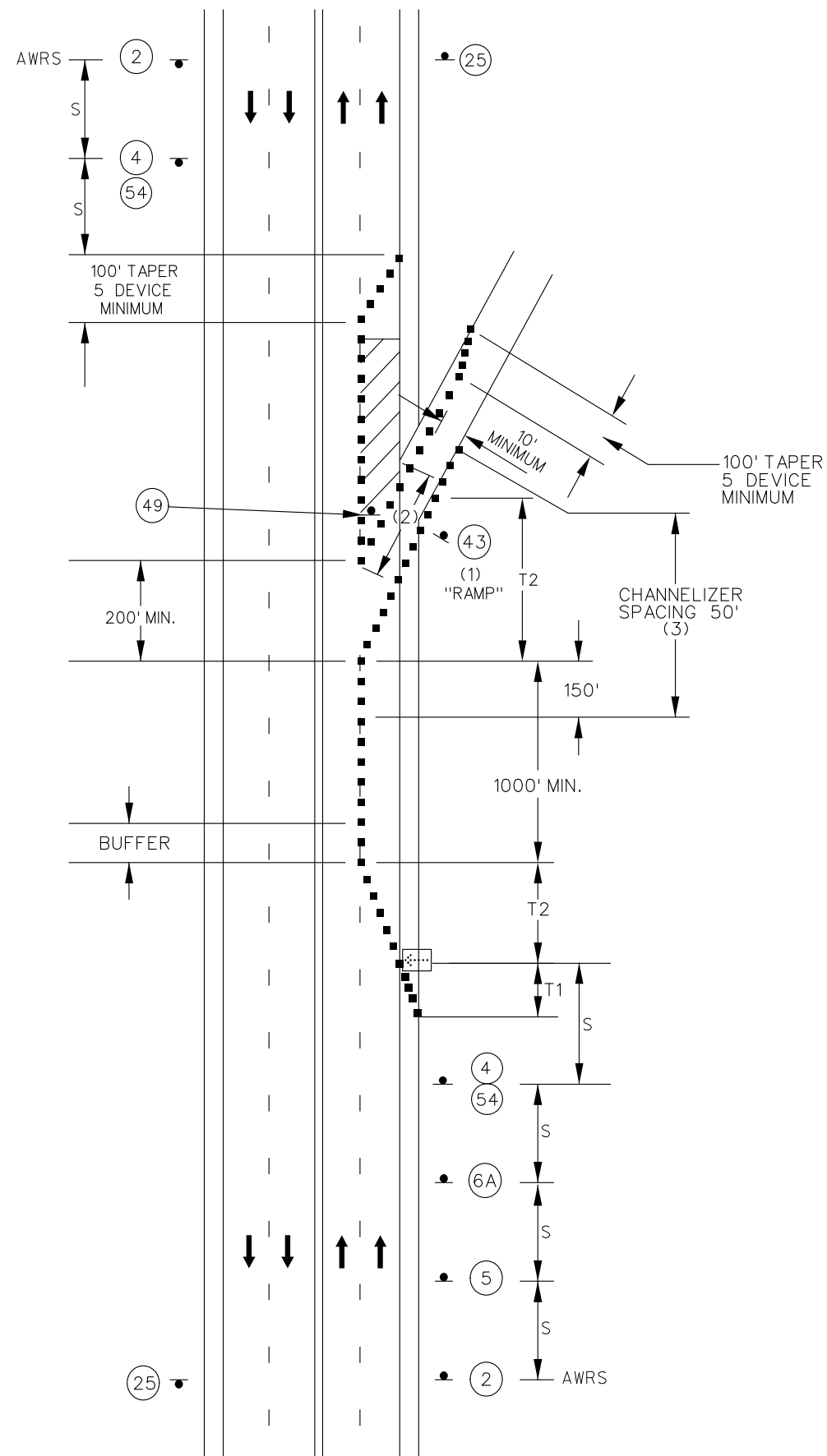

BRIDGE
OR
RAMP



CENTER LANE
OR
LEFT LANE



BRIDGE
OR
RAMP

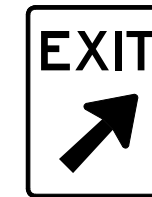

G020-5aF

(54)



R2-1

4

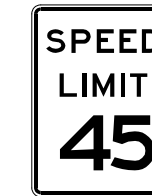

R2-1
NORMAL SPEED
(25)

■ ■ ■ ■ ■
CHANNELIZERS

NOTES:

SEE TRAFFIC CONTROL SHEET 1 FOR WORK ZONE SPEED LIMIT GUIDELINES.
SEE TRAFFIC CONTROL SHEET 1 FOR SIGN SPACING, DEVICE SPACING AND
CHANNELIZING TAPER LENGTHS.
REMOVE AND/OR MODIFY EXISTING PAVEMENT MARKING AS NEEDED.
TEMPORARY PAVEMENT MARKING REQUIRED WITH LONG TERM LANE CLOSURES.

FOR WORK ZONES WHERE DEVICES ARE IN PLACE OVERNIGHT, USE THE DIRECTIONAL INDICATOR BARRIERS AT THE TAPERS OR MAY BE USED AT THE DISCRETION OF THE ENGINEER IN CHARGE.

AWRS-ADVANCED WARNING RAIL SYSTEM

- (1). SIGN 43 REQUIRED WHEN RAMP WIDTH IS REDUCED.
- (2). FIVE DEVICE MINIMUM.
- (3). FOR WORK ZONES WHERE DEVICES ARE IN PLACE OVERNIGHT, USE TRIM-LINE CHANNELIZERS.

LANE CLOSURE
EXIT RAMP
TEMPORARY
TRAFFIC CONTROL
SHEET 10 OF 17

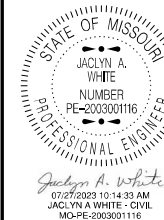

DATE PREPARED
7/25/2023

ROUTE 13	STATE MO
DISTRICT KC	SHEET NO. 16

COUNTY
RAY

JOB NO.
J3P3108B
CONTRACT ID.

PROJECT NO.

BRIDGE NO.

DATE	DESCRIPTION

MISSOURI HIGHWAYS AND TRANSPORTATION
COMMISSION

105 WEST CAPITOL
JEFFERSON CITY, MO 65102
1-888-ASK-MD00T (1-888-275-6636)

IF A SEAL IS PRESENT ON THIS SHEET IT HAS BEEN ELECTRONICALLY SEALED AND DATED.

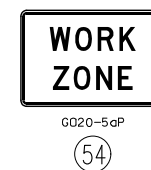
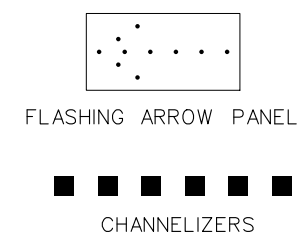
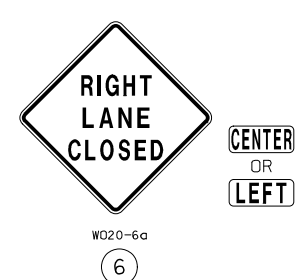
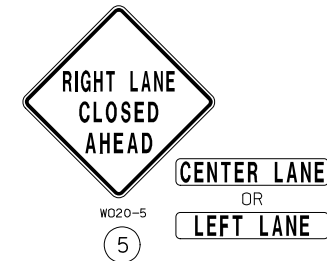
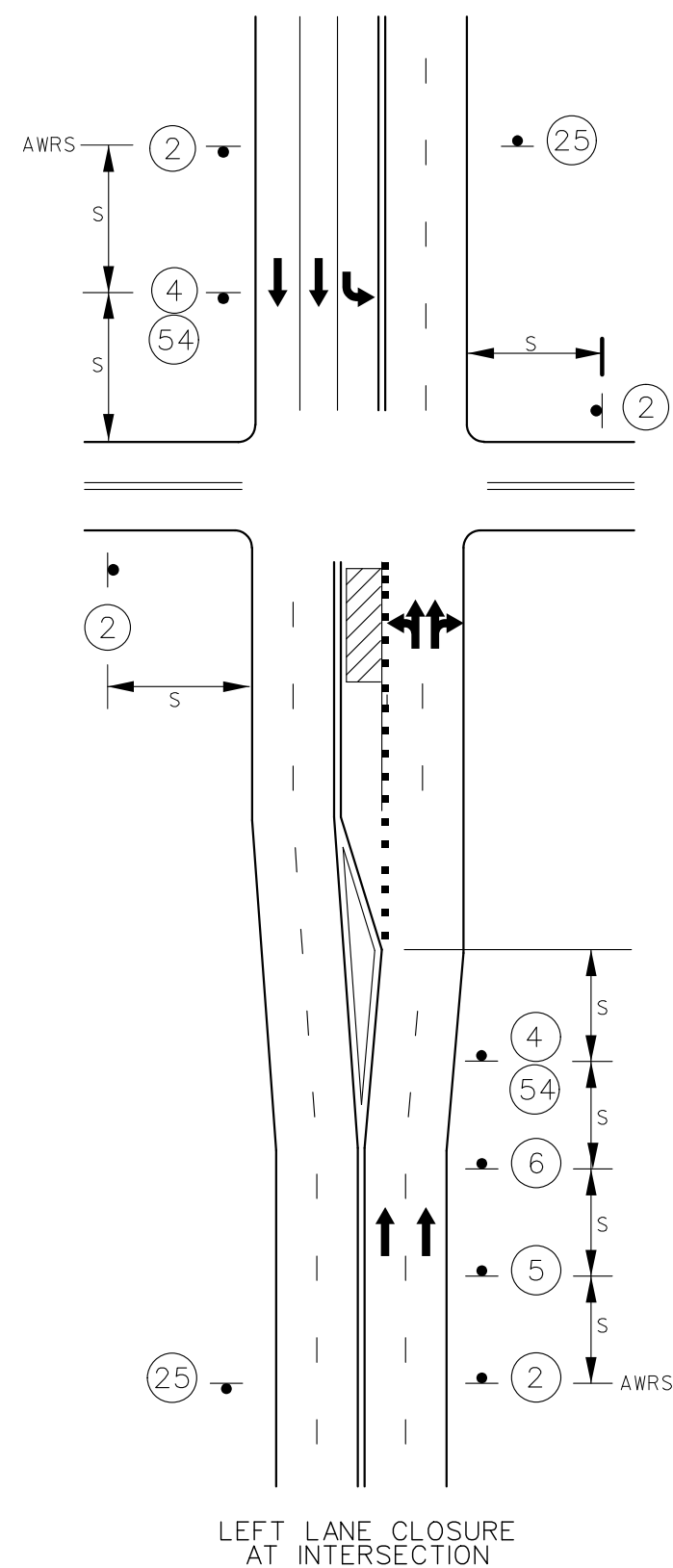
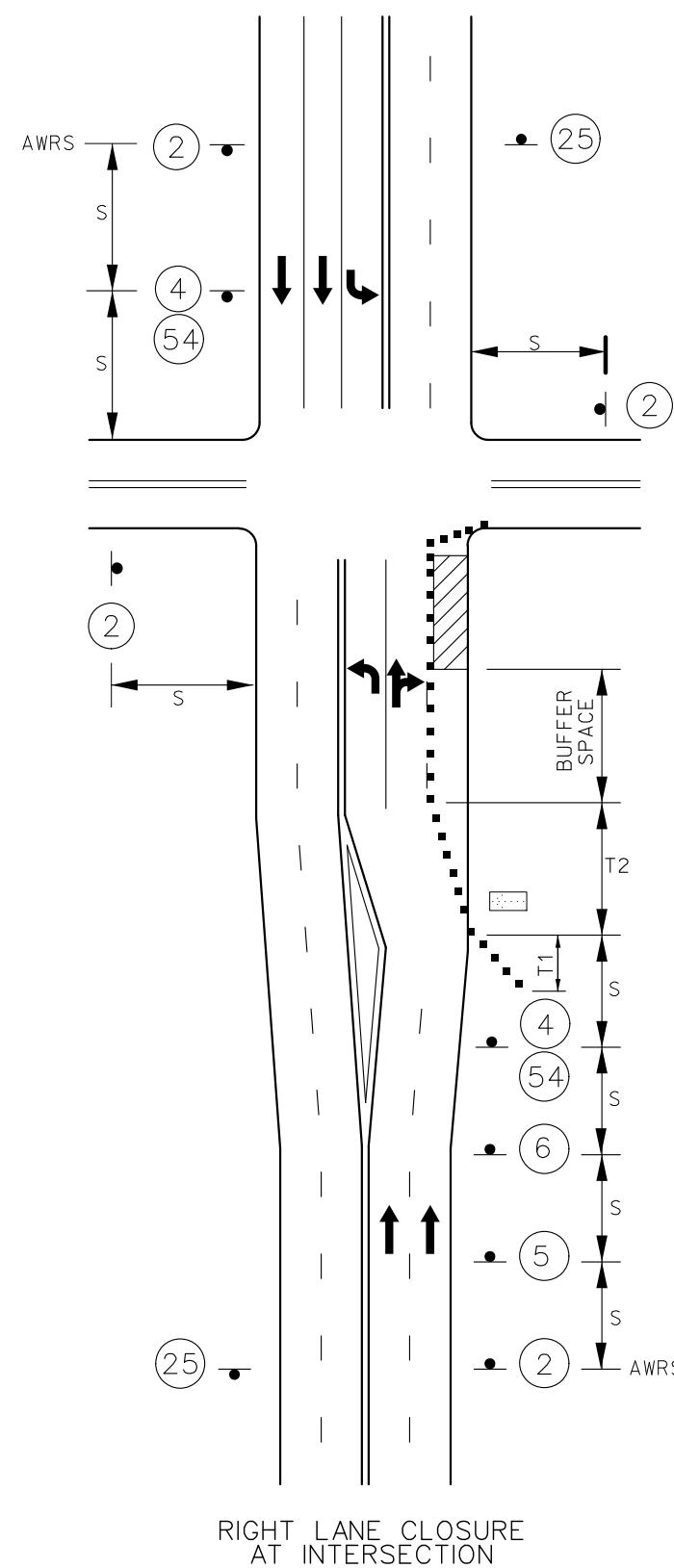

NOTES:

FOR SIGNALIZED INTERSECTIONS, ADJUSTMENTS
MAY NEED TO BE MADE TO SIGNAL PHASE, TIMING
INDICATIONS OR DETECTOR SETTINGS.

REMOVE AND/OR MODIFY EXISTING PAVEMENT
MARKINGS AS NEEDED.

PAVEMENT MARKINGS AND PARRICADES OPTIONAL
FOR SHORT TERM OPERATIONS.

TEMPORARY PAVEMENT MARKING REQUIRED WITH
LONG TERM LANE CLOSURE

FOR SHORT TERM OPERATIONS, WHERE IT IS NOT FEASIBLE TO MODIFY PAVEMENT MARKINGS, A 10' DEVICE SPACING IS USED WHERE TRAFFIC IS GUIDED ACROSS DOUBLE YELLOW LINES OR OTHER CONFLICTING PAVEMENT MARKINGS. ALL OTHER SPACINGS ARE ONE HALF THE SPACING SHOWN ON SHEET 1 OF THE TRAFFIC CONTROL SHEETS.

THE FLASHING ARROW BOARD SHOULD BE LOCATED AT THE BEGINNING OF THE MERGING TAPER WHEN MEDIAN WIDTH ALLOWS THIS PLACEMENT.

FOR WORK ZONES WHERE DEVICES ARE IN PLACE
OVERNIGHT, USE THE DIRECTIONAL INDICATOR
BARRIERS AT THE TAPERS OR MAY BE USED AT
THE DISCRETION OF THE ENGINEER IN CHARGE.

AWRS-ADVANCED WARNING RAIL SYSTEM

LANE CLOSURE AT INTERSECTION
TEMPORARY
TRAFFIC CONTROL
SHEET 13 OF 17

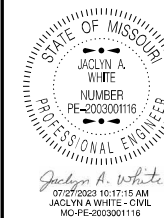

DATE PREPARED
7/25/2023

ROUTE 13	STATE MO
-------------	-------------

DISTRICT	SHEET NO.
KC	19
COUNTY	

COUNTY
RAY
JOB NO.

J3P3108B

CONTRACT ID.

PROJECT NO.

BRIDGE NO.

--	--	--	--	--	--	--

[illegible]

MISSOURI HIGHWAYS AND TRANSPORTATION
COMMISSION

105 WEST CAPITOL
JEFFERSON CITY, MO 65102

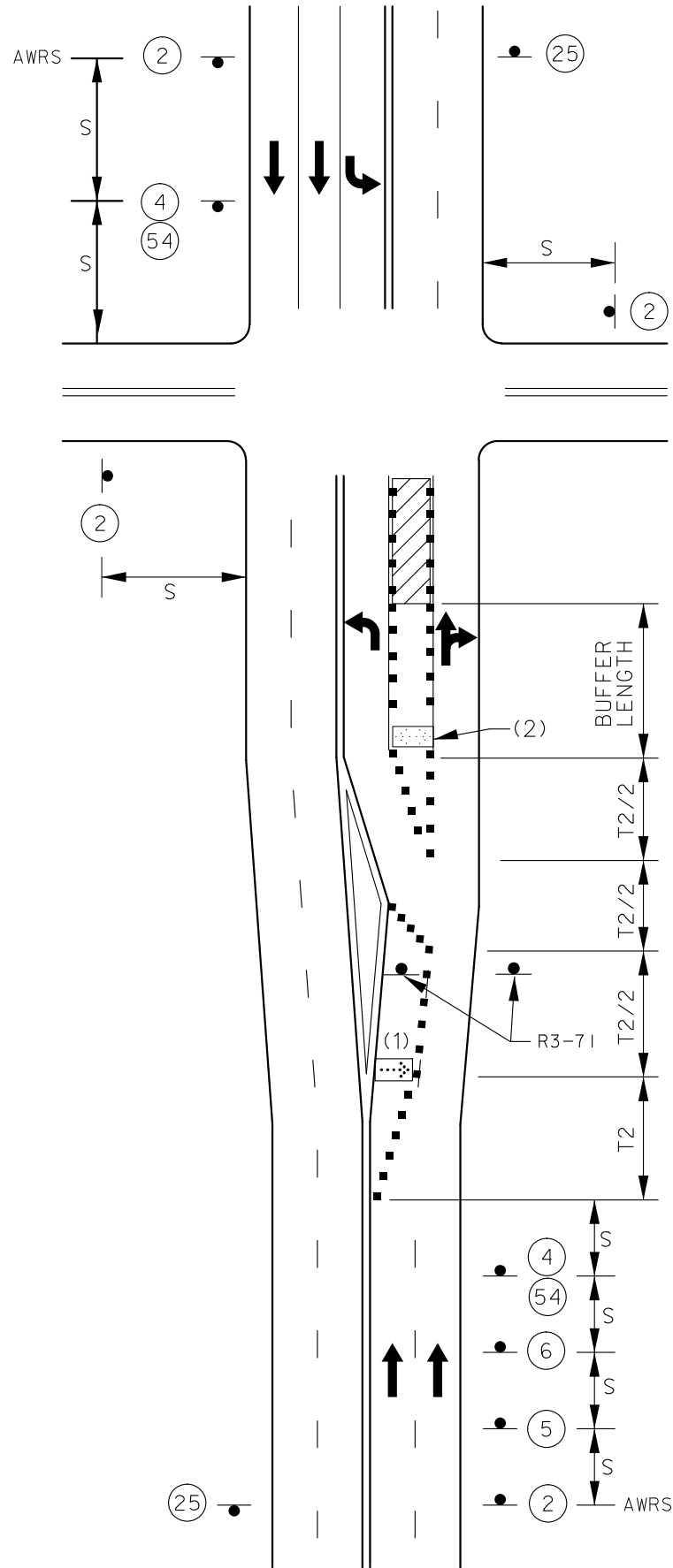

CENTER LANE CLOSURE
AT INTERSECTION

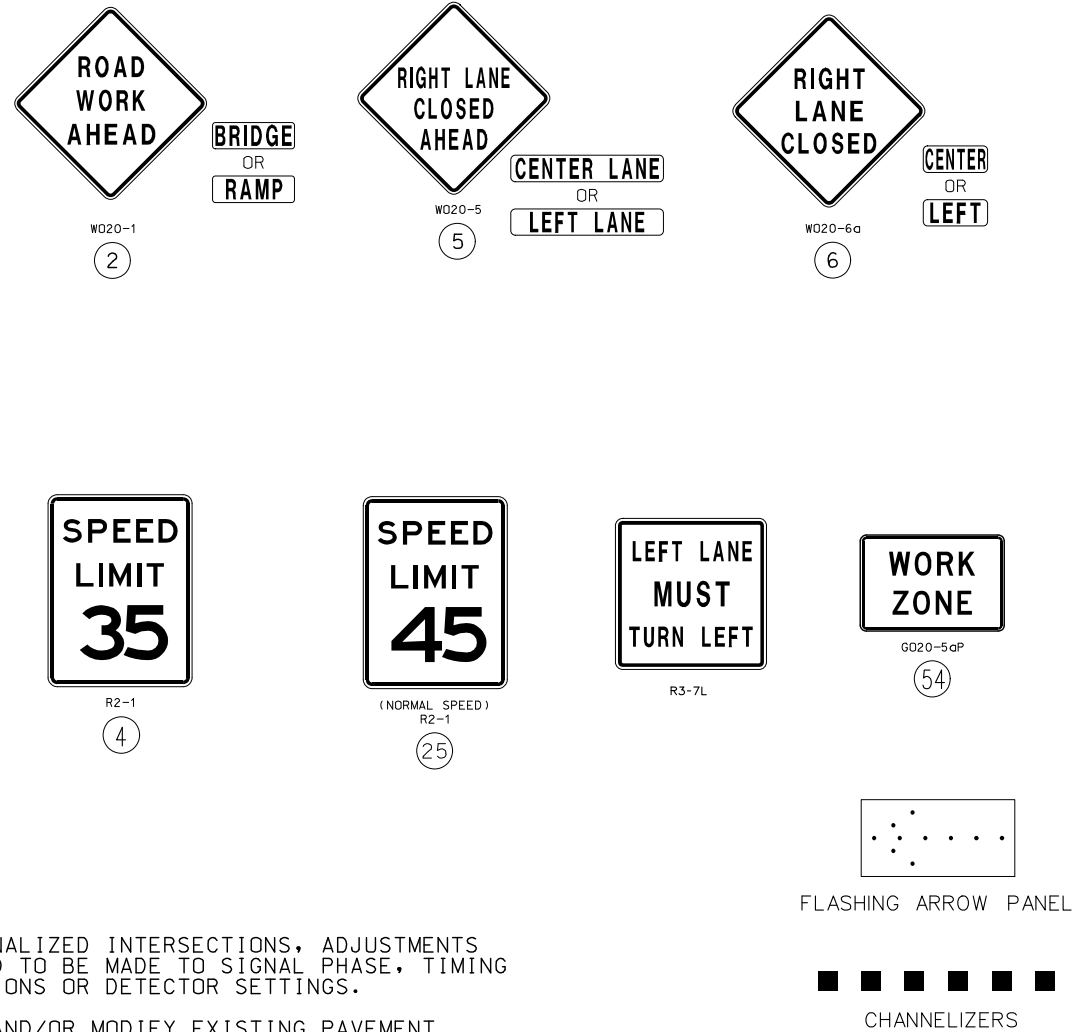

- NOTES:
- FOR SIGNALIZED INTERSECTIONS, ADJUSTMENTS MAY NEED TO BE MADE TO SIGNAL PHASE, TIMING INDICATIONS OR DETECTOR SETTINGS.
- REMOVE AND/OR MODIFY EXISTING PAVEMENT MARKINGS AS NEEDED.
- PAVEMENT MARKINGS AND PARRICADES OPTIONAL FOR SHORT TERM OPERATIONS.
- TEMPORARY PAVEMENT MARKING REQUIRED WITH LONG TERM LANE CLOSURE
- FOR SHORT TERM OPERATIONS, WHERE IT IS NOT FEASIBLE TO MODIFY PAVEMENT MARKINGS, A 10' DEVICE SPACING IS USED WHERE TRAFFIC IS GUIDED ACROSS DOUBLE YELLOW LINES OR OTHER CONFLICTING PAVEMENT MARKINGS. ALL OTHER SPACINGS ARE ONE HALF THE SPACING SHOWN ON SHEET 1 OF THE TRAFFIC CONTROL SHEETS.
- FOR WORK ZONES WHERE DEVICES ARE IN PLACE OVERNIGHT, USE THE DIRECTIONAL INDICATOR BARRIERS AT THE TAPERS OR MAY BE USED AT THE DISCRETION OF THE ENGINEER IN CHARGE.
- AWRS-ADVANCED WARNING RAIL SYSTEM
- (1) THE FLASHING ARROW BOARD SHOULD BE LOCATED AT THE BEGINNING OF THE MERGING TAPER WHEN MEDIAN WIDTH ALLOWS THIS PLACEMENT.
- (2) FLASHING ARROW BOARD AT THIS LOCATION IS OPTIONAL.

LANE CLOSURE AT INTERSECTION
TEMPORARY
TRAFFIC CONTROL
SHEET 14 OF 17

STATE OF MISSOURI

JACLYN A. WHITE

NUMBER

PE-2003001116

PROFESSIONAL ENGINEER

Jaclyn A. White

07/27/2023 10:17:48 AM

JACLYN A. WHITE - CIVIL

MO-PE-2003001116

DATE PREPARED

7/25/2023

ROUTE

13

DISTRICT

KC

STATE

MO

SHEET NO.

20

COUNTY

RAY

JOB NO.

J3P3108B

CONTRACT ID.

PROJECT NO.

BRIDGE NO.

DESCRIPTION

DATE

MISSOURI HIGHWAYS AND TRANSPORTATION COMMISSION

MoDOT

105 WEST CAPITOL

JEFFERSON CITY, MO 65102

1-888-ASK-MODOT (1-888-275-6636)

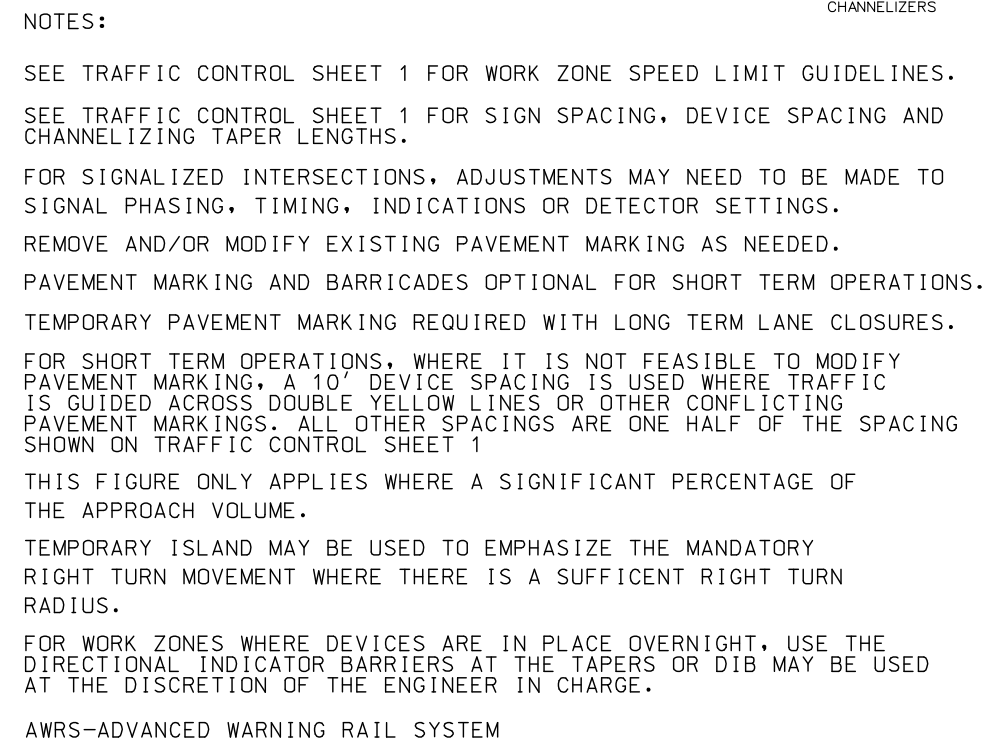
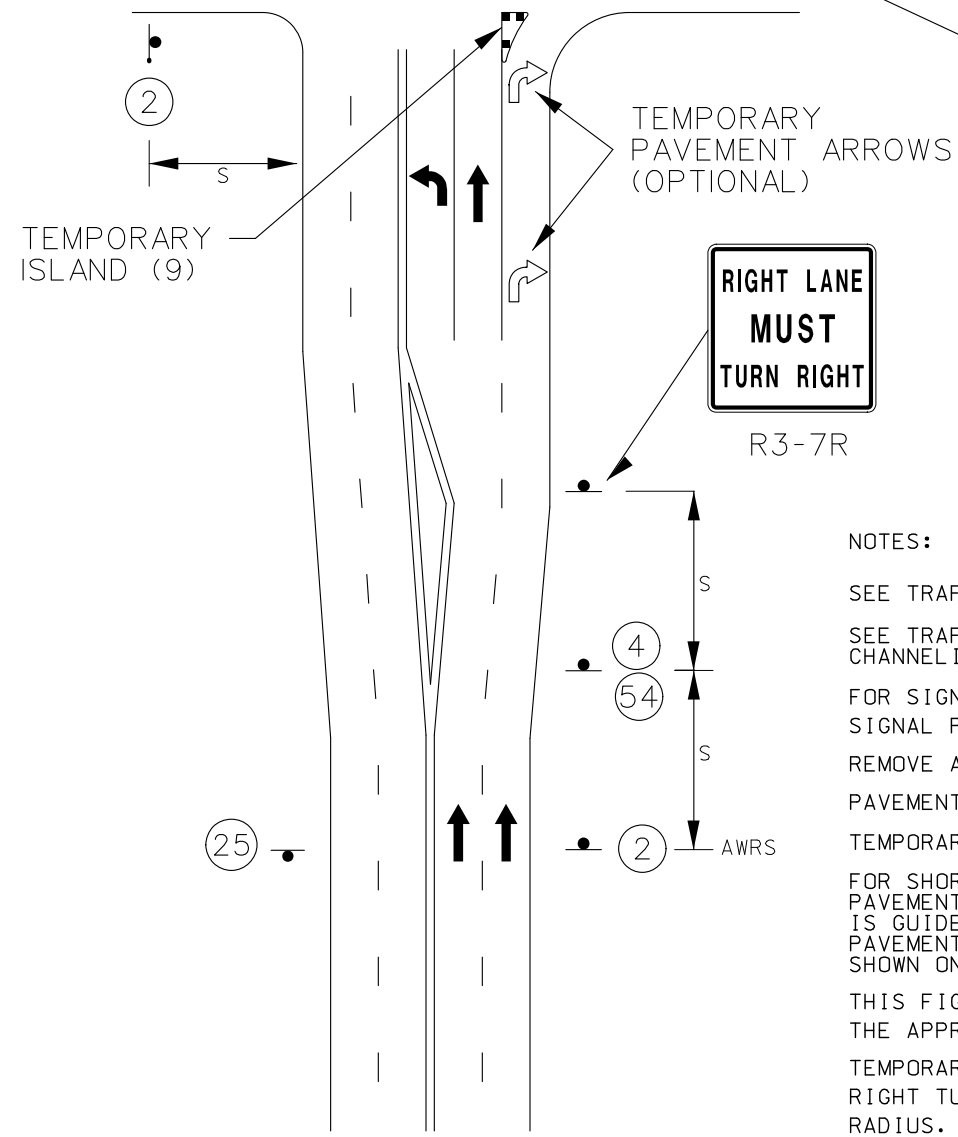
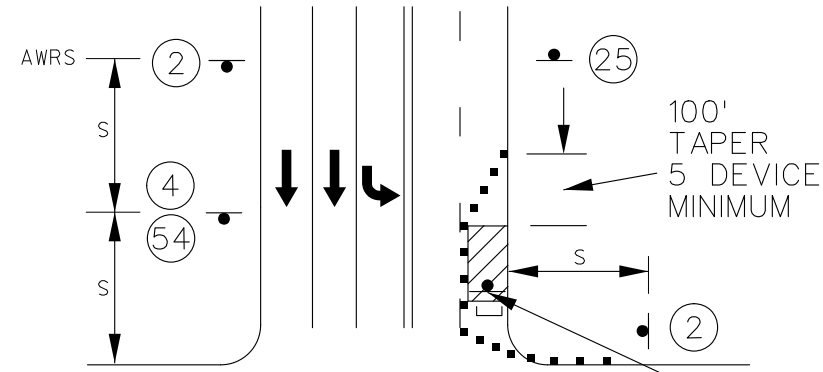

WORK ON FAR SIDE ONLY (8)

RIGHT LANE CLOSURE
AT INTERSECTION
TEMPORARY
TRAFFIC CONTROL
SHEET 15 OF 17

[illegible][illegible]

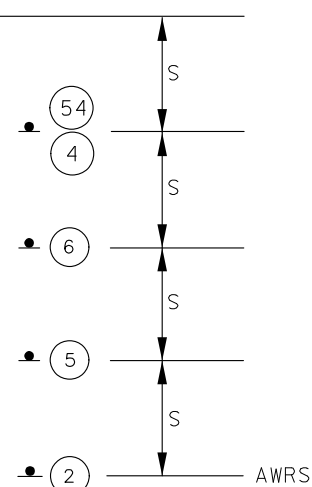

WORK UNIT OR
WORK AREA

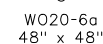

- PROTECTIVE TRUCK WITH WORK SIGN, FLASHING ARROW PANEL AND TRUCK MOUNTED ATTENUATOR.

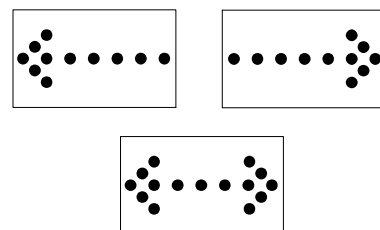

Left Lane
MOVING OPERATION ON
MULTI-LANE DIVIDED HIGHWAY
OPEN TO TRAFFIC

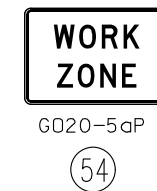
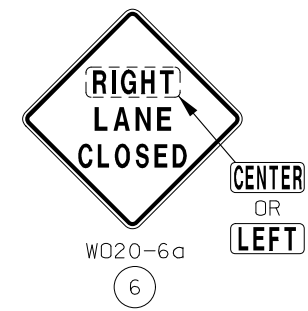

* IF THE FLAGGER IS NOT USED, THE ADVANCED
FLAGGER SIGN SHOULD BE DELETED.

MOVING OPERATION
OPEN TO TRAFFIC
TEMPORARY
TRAFFIC CONTROL
SHEET 16 OF 17

[illegible]

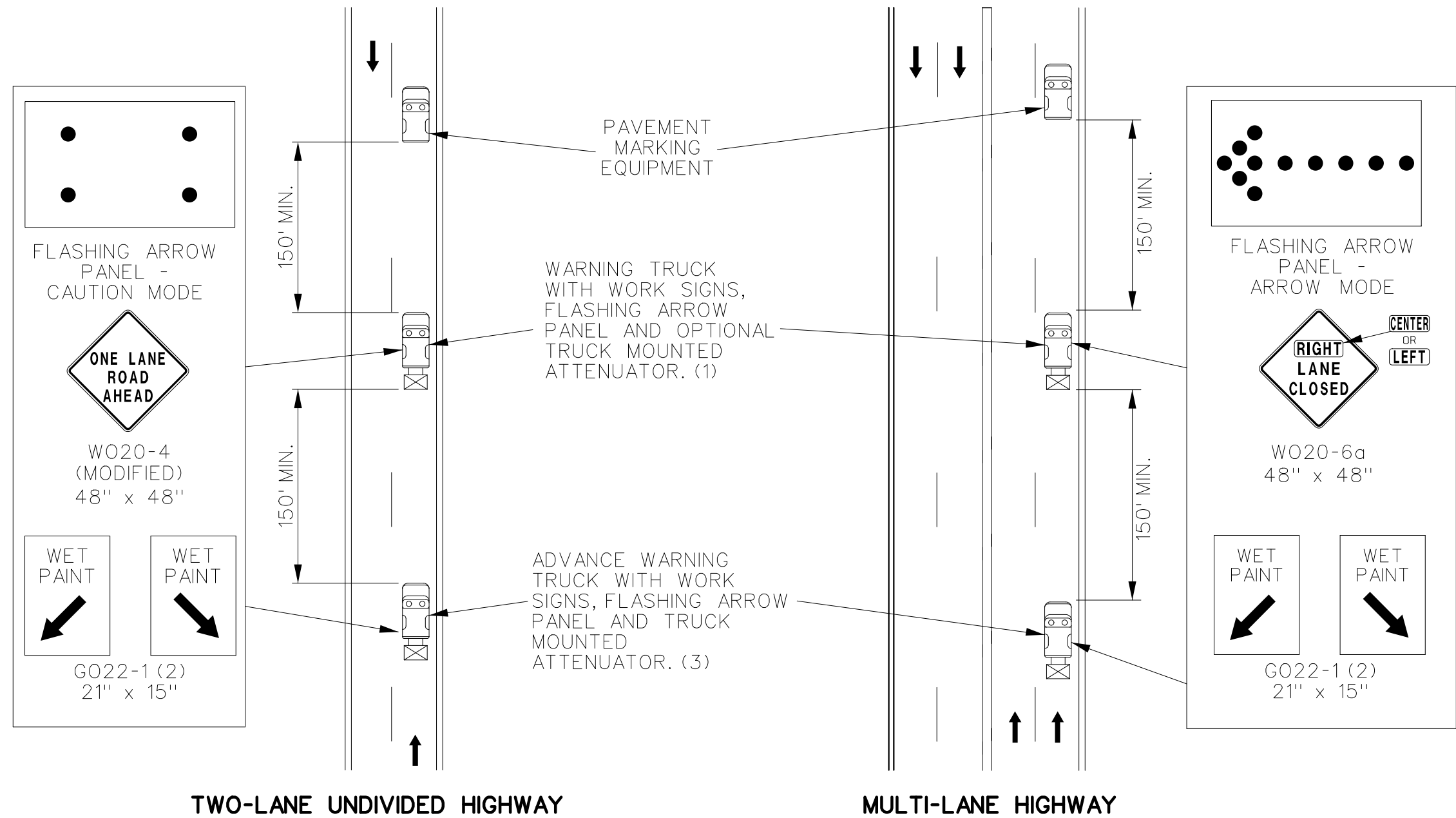

**MOVING OPERATION ON HIGHWAY
OPEN TO TRAFFIC**

NOTES:

ALL SIGNS HAVE TYPE 3 FLUORESCENT ORANGE RETROFLECTIVE SHEETING.

UPON APPROVAL OF THE ENGINEER, THE CONTRACTOR MAY PROVIDE ADDITIONAL PROTECTIVE TRUCKS EQUIPPED WITH PROPER WARNING DEVICES.

PROTECTIVE TRUCK AND WORK VEHICLES SHALL DISPLAY HIGH-INTENSITY ROTATING, FLASHING, OSCILLATING OR STROBE LIGHTS.

VEHICLE HAZARD WARNING SIGNALS SHALL NOT BE USED INSTEAD OF THE VEHICLE'S HIGH -INTENSITY ROTATING FLASHING, FLASHING, OSCILLATING, OR STROBE LIGHTS.

- (1). TRUCK IS OPTIONAL ON TWO-LANE UNDIVIDED HIGHWAYS IF SIGNING AND ARROW BOARD IS MOUNTED ON THE PAVEMENT MARKING EQUIPMENT.
- (2). WET PAINT SIGNS ARE INSTALLED TO INDICATE THE SIDE IN WHICH THE PAVEMENT MARKING MATERIAL IS BEING APPLIED. AT THE CONTRACTOR'S OPTION. A FRONT FACING WET PAINT SIGN MAY BE INSTALLED ON THE LEFT SIDE OF THE PAVEMENT MARKING EQUIPMENT.
- (3). ADVANCE WARNING TRUCK IS POSITIONED AT THE NO TRACK POINT OF THE PAVEMENT MARKING MATERIAL OR SPACING SHOWN, WHICHEVER IS GREATER.

MOVING OPERATION
OPEN TO TRAFFIC
TEMPORARY
TRAFFIC CONTROL
SHEET 17 OF 17

STATE OF MISSOURI
JACLYN A. WHITE
NUMBER
PE-2003001116
PROFESSIONAL ENGINEER

Jaclyn A. White
07/27/2023 10:19:35 AM
JACLYN A WHITE - CIVIL
MO-PE-2003001116

DATE PREPARED 7/25/2023	
ROUTE 13	STATE MO
DISTRICT KC	SHEET NO. 23
COUNTY RAY	
JOB NO. J3P3108B	
CONTRACT ID.	
PROJECT NO.	
BRIDGE NO.	

DATE	DESCRIPTION

MISSOURI HIGHWAYS AND TRANSPORTATION
COMMISSION

105 WEST CAPITOL
JEFFERSON CITY, MO 65102
1-888-ASK-MODOT (1-888-275-6636)

IF A SEAL IS PRESENT ON THIS SHEET IT HAS BEEN ELECTRONICALLY SEALED AND DATED. REV.