

V = 55 M.P.H.

BASE - ROUTE D/MO-224 INTERSECTION
A.A.D.T. - 2022 = 417

BASE - ROUTE D/US-24 INTERSECTION
A.A.D.T. - 2022 = 553

BASE - ROUTE D/ROUTE FF INTERSECTION 1
A.A.D.T. - 2022 = 1,169

BASE - ROUTE D/ROUTE FF INTERSECTION 2
A.A.D.T. - 2022 = 1,126

ADD ALT. A - ROUTE FF/ROUTE D INTER. 1
A.A.D.T. - 2022 = 482

KEY MAP
LOCATION OF LAFAYETTE COUNTY

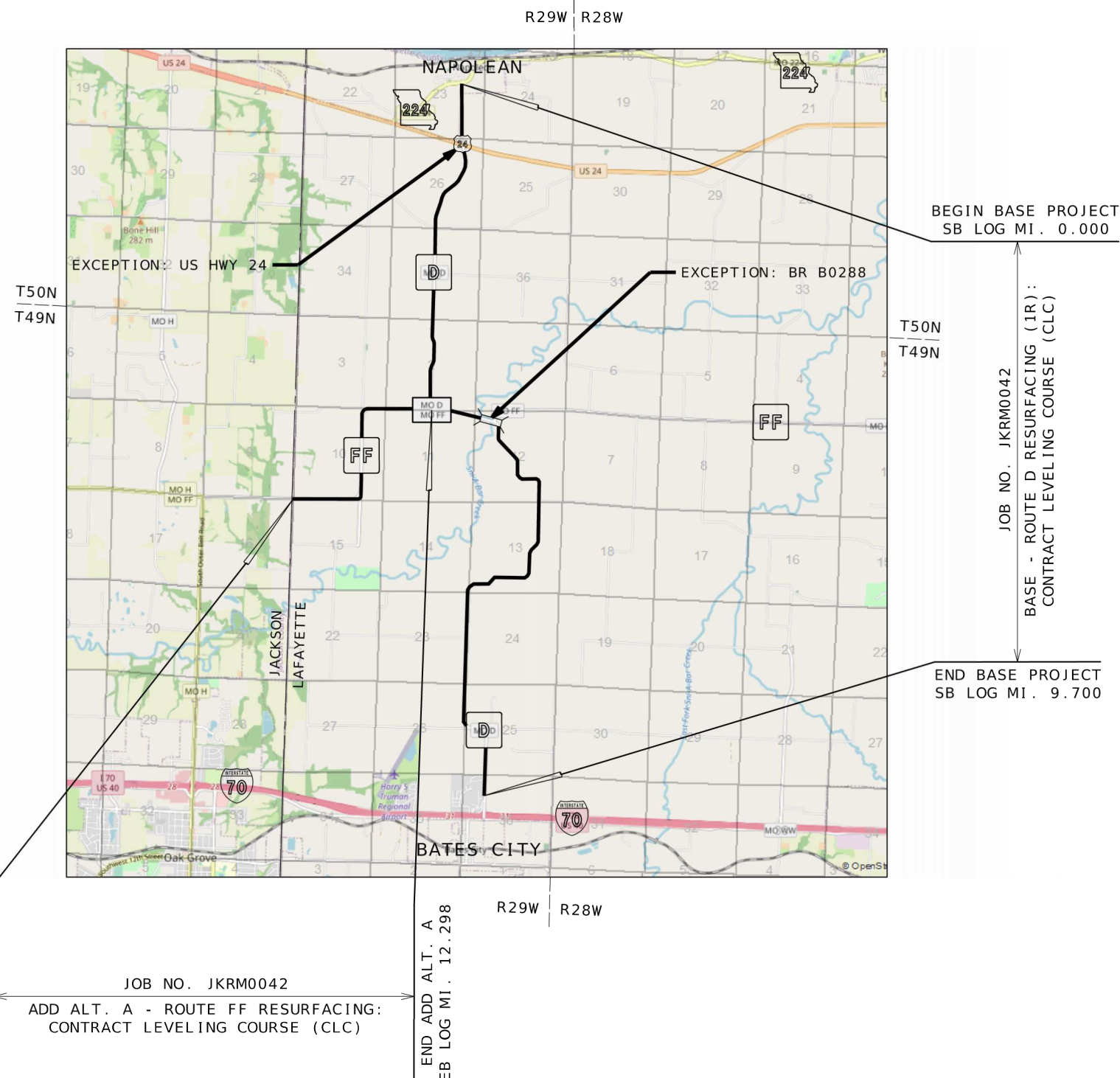
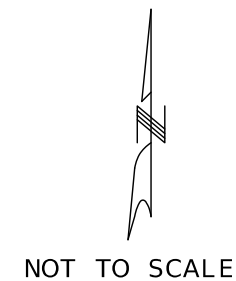

DESCRIPTION	NUMBER
TITLE SHEET -----	1
TYPICAL SECTIONS (TS) (2 SHEETS)---	2
QUANTITIES (QU) (3 SHEETS)-----	3
SPECIAL SHEET (SS)-----	4
TRAFFIC CONTROL SHEETS (TC)-----	5-9

```

BEGINNING OF PROJECT
      BASE - RTE D SB LOG MI.    0.000
      ADD ALT. A - RTE FF EB LOG MI.    9.876
END OF PROJECT
      BASE - RTE D SB LOG MI.    9.700
      ADD ALT. A - RTE FF EB LOG MI.  12.298

APPARENT LENGTH
      BASE - RTE D    51,216.00 FEET
      ADD ALT. A - ROUTE FF    12,788.16 FEET

```

EQUATIONS AND EXCEPTIONS:

US HWY 24

BASE - RTE D SB LOG MI. 0.691-0.699

BASE - RTE D NB LOG MI. 9.256-9.248

-44.00 FEET

BR B0288 - SNI-A-BAR CREEK

BASE - RTE D SB LOG MI. 4.424-4.453

BASE - RTE D NB LOG MI. 9.256-9.248

-153.12 FEET

TOTAL CORRECTIONS

BASE - RTE D	197.12 FEET
ADD ALT. A - RTE FF	0 FEET

NET LENGTH OF PROJECT

BASE - RTE D	51,018.88	FEET
ADD ALT. A - RTE FF	12,788.16	FEET

STATE LENGTH

BASE - RTE D	9.663 MILES
ADD ALT. A - RTE FF	2.422 MILES

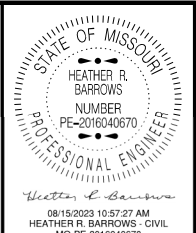

MUPP-20160406/01	
DATE PREPARED	
8/15/2023	
ROUTE	STATE
D, FF	MO
DISTRICT	SHEET NO.
KC	1
COUNTY	
LAFAYETTE	
JOB NO.	
JKRM0042	
CONTRACT ID.	
PROJECT NO.	
BRIDGE NO.	

[illegible]

MISSOURI HIGHWAYS AND TRANSPORTATION
COMMISSION

105 WEST CAPITOL
JEFFERSON CITY, MO 65102
1-888-ASK-MODOT (1-888-2-75-6636)

IF A SEAL IS PRESENT ON THIS SHEET IT HAS BEEN ELECTRONICALLY SEALED AND DATED.



NOT TO SCALE

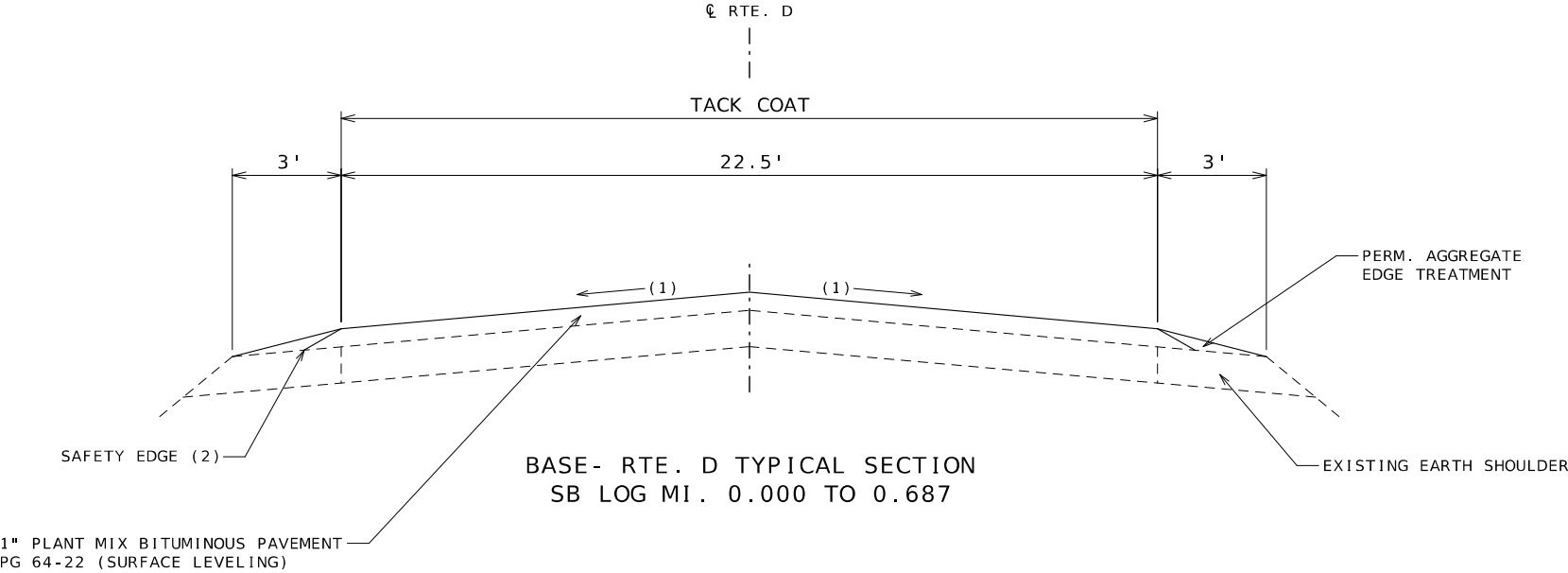

BITUMINOUS PAVEMENT MIXTURE PG64-22 (SURFACE LEVELING)	1.985 TON/YD ³
PERMANENT AGGREGATE EDGE TREATMENT	2.185 TON/YD ³
TACK COAT	0.08 GAL/YD ²
TACK COAT ON COLDMILLED SURFACE	0.10 GAL/YD ²

NOTE:

SURFACE PLACEMENT SHALL BE ONE PASS PER LANE NO S.E. CORRECTION.

USE 25% OF SURFACE LEVELING MATERIAL TO ACCOUNT FOR IRREGULARITIES

USE 2% OF SURFACE LEVELING MATERIAL FOR SAFETY EDGE

(1) MATCH EXISTING
(2) SAFETY EDGE STD. 401.00C

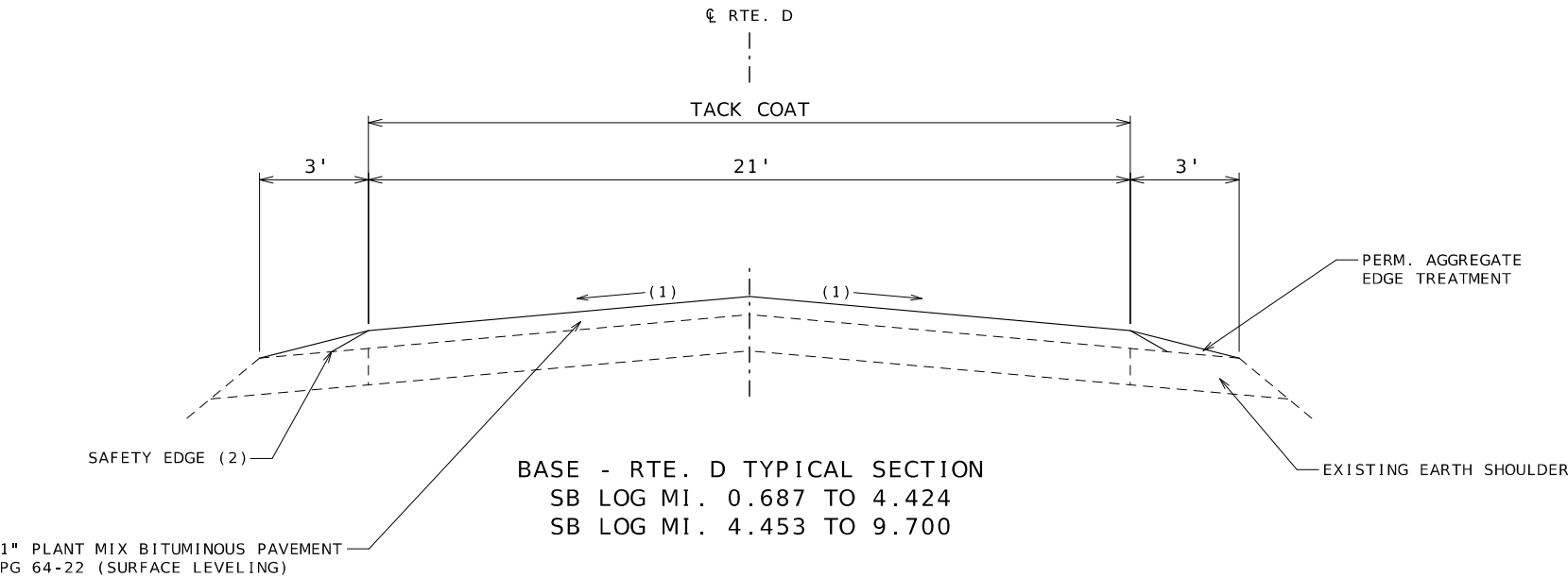

BASE PROJECT
TYPICAL SECTION
SHEET 1 OF 2

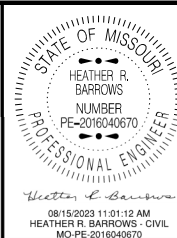

DATE PREPARED 8/15/2023	
ROUTE D, FF	STATE MO
DISTRICT KC	SHEET NO. 2
COUNTY LAFAYETTE	
JOB NO. JKRM0042	
CONTRACT ID.	
PROJECT NO.	
BRIDGE NO.	

DESCRIPTION	DATE

MISSOURI HIGHWAYS AND TRANSPORTATION COMMISSION

105 WEST CAPITOL
JEFFERSON CITY, MO 65102
1-888-ASK-MODOT (1-888-275-6636)

MoDOT

IF A SEAL IS PRESENT ON THIS SHEET IT HAS BEEN ELECTRONICALLY SEALED AND DATED.



NOT TO SCALE

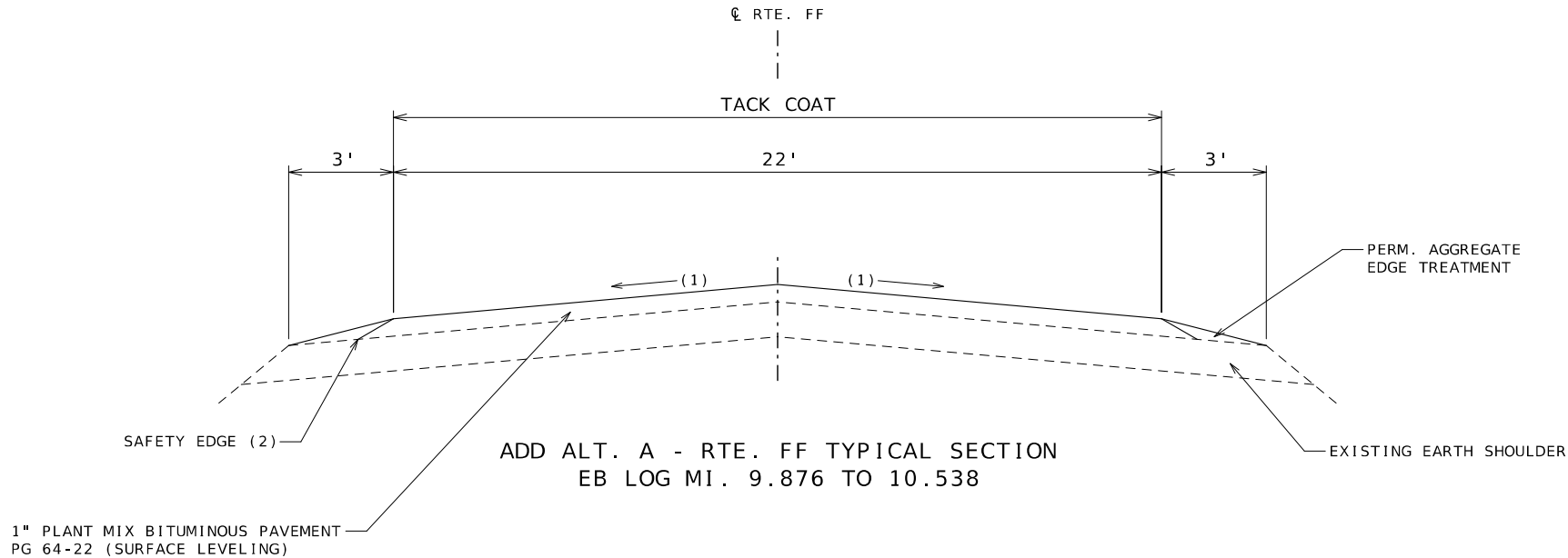

BITUMINOUS PAVEMENT MIXTURE PG64-22 (SURFACE LEVELING)	1.985 TON/YD ³
PERMANENT AGGREGATE EDGE TREATMENT	2.185 TON/YD ³
TACK COAT	0.08 GAL/YD ²
TACK COAT ON COLDMILLED SURFACE	0.10 GAL/YD ²

NOTE:

SURFACE PLACEMENT SHALL BE ONE PASS PER LANE
NO S.E. CORRECTION.

USE 25% OF SURFACE LEVELING MATERIAL TO
ACCOUNT FOR IRREGULARITIES

USE 2% OF SURFACE LEVELING MATERIAL FOR
SAFETY EDGE

(1) MATCH EXISTING
(2) SAFETY EDGE STD. 401.00C

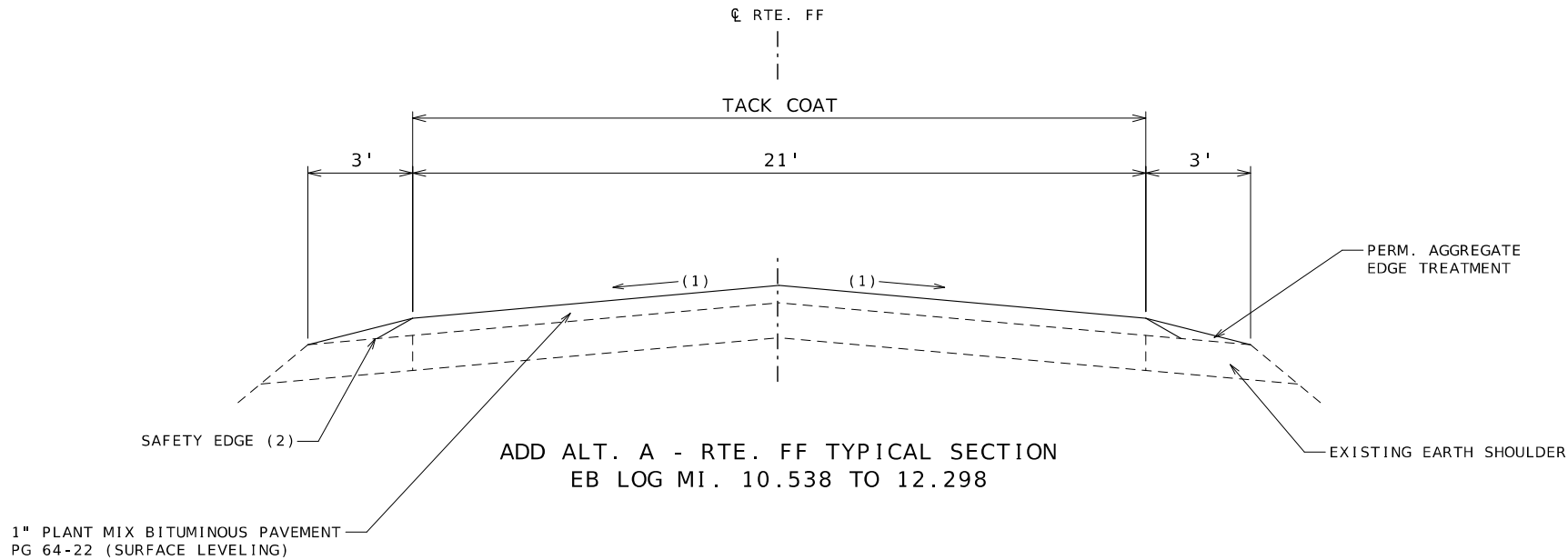

ADD ALTERNATE A
TYPICAL SECTION
SHEET 2 OF 2

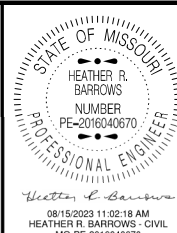

DATE PREPARED 8/15/2023	
ROUTE D, FF	STATE MO
DISTRICT KC	SHEET NO. 2
COUNTY LAFAYETTE	
JOB NO. JKRM0042	
CONTRACT ID.	
PROJECT NO.	
BRIDGE NO.	

DESCRIPTION	DATE



IF A SEAL IS PRESENT ON THIS SHEET IT HAS BEEN ELECTRONICALLY SEALED AND DATED.

BASE - ROUTE D ASPHALT QUANTITIES											
BEGIN LOG MILE	END LOG MILE	LOCATION	LENGTH	AVERAGE MAINLINE WIDTH	AGGREGATE EDGE TREATMENT WIDTH	1" BITUMINOUS PAVEMENT MIXTURE PG 64-22 SURFACE LEVELING 1.985 TONS/CY	TACK COAT	MODIFIED COLDMILLING (DEPTH TRANSITION)	PERMANENT EDGE DROP OFF TREATMENT TYPE 1 OR TYPE 5 AGGREGATE	BASE ROCK TYPE 1 OR TYPE 5 AGGREGATE	REMARKS
			FT	FT	FT	TONS	GAL	SY	TON	TON	
0.000	0.009	SB RTE D	50.00	22.5	2			136.11			BEGIN PROJECT
0.000	0.691	SB RTE D	3,648.48	22.5	2	502.93	729.70		197.82		FROM ROUTE 224 TO ROUTE 24
0.699	4.424	SB RTE D	19,668.00	21	2	2,530.43	3,671.36	127.78	1,066.41		FROM ROUTE 24 TO BR B0288
4.453	9.700	SB RTE D	27,704.16	21	2	3,564.35	5,171.44	127.78	1,502.13		FROM BR B0288 TO APPROX. 225 FT NORTH OF LOVE'S TRUCK STOP
9.691	9.700	SB RTE D	50.00	21	2			127.78			END PROJECT
6 ASPHALT ENTRANCES						10.57	15.83	158.33			
4 ASPHALT STATE ROUTES						25.78	40.36	403.61			RTE. D & HWY 24, RTE.D & RTE. FF INTERSECTIONS
3 ASPHALT STREETS						62.24	112.88	1,128.75			
6 CONCRETE ENTRANCES								193.33			
79 GRAVEL ENTRANCES										566.16	
6 GRAVEL STREETS										130.05	
2% FOR SAFETY EDGE						133.93					
25% FOR IRREGULARITIES						1,674.08					
TOTAL						8,504.31	9,741.57	2,403.47	2,766.36	696.21	
PAY TOTAL						8,505	9,742	2,404		3,464	

BASE - ROUTE D PERMANENT PAVEMENT MARKING					
BEGIN LOG MILE	END LOG MILE	LENGTH	4" YELLOW WATERBORNE P'VMT MARKING TYPE P BEADS	INTERMITTENT 4" YELLOW WATERBORNE P'VMT MARKING TYPE P BEADS	4" WHITE WATERBORNE P'VMT MARKING TYPE P BEADS
		FT	LF	LF	LF
0.000	0.038	201	402.00		
0.038	0.105	354	354.00	88.44	
0.105	0.285	950	1,900.00		
0.285	0.361	401	401.00	100.32	
0.361	0.443	433	866.00		
0.443	0.525	433	433.00	108.24	
0.525	0.697	908	1,816.00		
0.707	1.676	5,116	10,232.00		
1.676	1.949	1,441	1,441.00	360.36	
1.949	1.992	227	454.00		
1.992	2.203	1,114	1,114.00	278.52	
2.203	2.244	216		54.12	
2.244	2.393	787	787.00	196.68	
2.393	2.600	1,093	2,186.00		
2.600	2.911	1,642	1,642.00	410.52	
2.911	3.265	1,869	3,738.00		
3.265	3.466	1,061	1,061.00	265.32	
3.466	3.601	713		178.20	
3.601	3.686	449	449.00	112.20	
3.686	3.958	1,436	2,872.00		
3.736	4.424	3,633			7,266.00
3.958	4.102	760	760.00	190.08	
4.102	4.188	454		113.52	
4.188	4.417	1,209	1,209.00	302.28	
4.417	4.704	1,515	3,030.00		
4.704	4.793	470	470.00	117.48	
4.793	5.477	3,612	7,224.00		
5.477	5.592	607	607.00	151.80	
5.592	5.898	1,616	3,232.00		
5.898	5.978	422	422.00	105.60	
5.978	7.234	6,632	13,264.00		
7.234	7.578	1,816	1,816.00	454.08	
7.578	7.635	301	602.00		
7.635	7.726	480	480.00	120.12	
7.726	7.841	607	1,214.00		
7.841	7.926	449	449.00	112.20	
7.926	7.969	227	454.00		
7.969	8.199	1,214	1,214.00	303.60	
SUB TOTAL 1			68,595.00	4,123.68	7,266.00

BASE - ROUTE D PERMANENT PAVEMENT MARKING					
BEGIN LOG MILE	END LOG MILE	LENGTH	4" YELLOW WATERBORNE P'VMT MARKING TYPE P BEADS	INTERMITTENT 4" YELLOW WATERBORNE P'VMT MARKING TYPE P BEADS	4" WHITE WATERBORNE P'VMT MARKING TYPE P BEADS
		FT	LF	LF	LF
8.199	8.365	876	1,752.00		
8.365	8.428	333	333.00	83.16	
8.428	8.467	206	412.00		
8.467	8.573	560	560.00	139.92	
8.573	9.045	2,492	4,984.00		
9.045	9.179	708	708.00	176.88	
9.179	9.224	238		59.40	
9.224	9.422	1,045	1,045.00	261.36	
9.422	9.445	121	242.00		
9.445	9.700	1,346	1,346.00	336.60	
0.000	9.700	51,216			
SUB TOTAL 2			11,382.00	1,057.32	0.00
SUB TOTAL 1 + SUB TOTAL 2			79,977.00	5,181.00	7,266.00
PAY TOTAL			85,158		7,266

MOBILIZATION
1 = LUMP SUM

REMOVAL OF IMPROVEMENTS				
BEGIN LOG MILE	END LOG MILE	LOCATION	LENGTH	DESCRIPTION
			LF	
9.869	9.939	NB RT SHLDR	370.0	END TERMINAL, END ANCHOR AND GUARDRAIL
PAY TOTAL			1 LUMP SUM	

GUARDRAIL				
BEGIN LOG MILE	END LOG MILE	LOCATION	MGS GUARDRAIL 8' POST, 3.125' SPACING	TYPE A CRASHWORTHY END TERMINAL MASH
			LF	EA
9.869	9.939	NB RT SHLDR	325.0	2
PAY TOTAL			325	2

CLEARING AND GRUBBING				
BEGIN LOG MILE	END LOG MILE	LOCATION	CLEARING AND GRUBBING	REMARKS
			AC	
9.869	9.939	NB RT SHLDR	0.5	ROUTE 224 INTERSECTION
PAY TOTAL			1	

BASE PROJECT
SUMMARY OF QUANTITIES
SHEET 1 OF 3

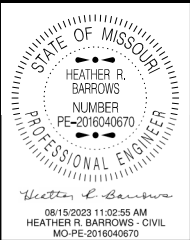

DATE PREPARED 8/15/2023	
ROUTE D, FF	STATE MO
DISTRICT KC	SHEET NO. 3

COUNTY LAFAYETTE
JOB NO. JKRM0042
CONTRACT ID.

PROJECT NO.
BRIDGE NO.

DESCRIPTION	DATE								

MISSOURI HIGHWAYS AND TRANSPORTATION COMMISSION

105 WEST CAPITOL
JEFFERSON CITY, MO 65102
1-888-ASK-MODOT (1-888-275-6636)

IF A SEAL IS PRESENT ON THIS SHEET IT HAS BEEN ELECTRONICALLY SEALED AND DATED.

ADD ALTERNATE A - ROUTE FF ASPHALT QUANTITIES											
BEGIN LOG MILE	END LOG MILE	LOCATION	LENGTH	AVERAGE MAINLINE WIDTH	AGGREGATE EDGE TREATMENT WIDTH	1" BITUMINOUS PAVEMENT MIXTURE PG 64-22 SURFACE LEVELING 1.985 TONS/CY	TACK COAT	MODIFIED COLDMILLING (DEPTH TRANSITION)	PERMANENT EDGE DROP OFF TREATMENT TYPE 1 OR TYPE 5 AGGREGATE	BASE ROCK TYPE 1 OR TYPE 5 AGGREGATE	REMARKS
			FT	FT	FT	TONS	GAL	SY	TON	TON	
9.876	9.885	EB RTE FF	50.00	22	2			133.33			BEGIN PROJECT
9.876	10.538	EB RTE FF	3,495.36	22	2	471.12	683.54		189.52		FROM JACKSON COUNTY LINE TO GILLISPIE ROAD
10.538	12.298	EB RTE FF	9,292.80	21	2	1,195.59	1,734.66		503.86		FROM GILLISPIE ROAD TO RTE. D
1 ASPHALT ENTRANCE						2.45	4.44	44.44			
2 CONCRETE ENTRANCES								28.44			
16 GRAVEL ENTRANCES										113.50	
4 GRAVEL STREETS										311.25	
2% FOR SAFETY EDGE						33.38					
25% FOR IRREGULARITIES						425.64					
TOTAL						2,128.18	2,422.64	206.21	693.38	424.75	
PAY TOTAL						2,129	2,423	207		1,119	

ADD ALTERNATE A - ROUTE FF PERMANENT PAVEMENT MARKING					
BEGIN LOG MILE	END LOG MILE	LENGTH	4" YELLOW WATERBORNE P'VMT MARKING TYPE P BEADS	INTERMITTENT 4" YELLOW WATERBORNE P'VMT MARKING TYPE P BEADS	4" WHITE WATERBORNE P'VMT MARKING TYPE P BEADS
		FT	LF	LF	LF
9.876	12.298	12,788			25,576.00
9.876	9.919	227	454.00		
9.919	10.232	1,653	1,653.00	413.16	
10.232	10.800	2,999	5,998.00		
10.800	10.906	560	560.00	139.92	
10.906	10.953	248	496.00		
10.953	11.055	539	539.00	134.64	
11.055	12.298	6,563	13,126.00		
TOTAL			22,826.00	687.72	25,576.00
PAY TOTAL			23,514		25,576

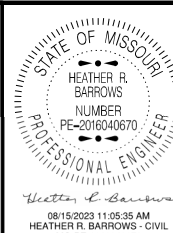

DATE PREPARED
8/15/2023

ROUTE	STATE
D, FF	MO
DISTRICT	SHEET NO.
KC	3

COUNTY
LAFAYETTE

JOB NO.
JKRM0042

CONTRACT ID.

PROJECT NO.

BRIDGE NO.

DESCRIPTION	DATE

MISSOURI HIGHWAYS AND TRANSPORTATION COMMISSION

105 WEST CAPITOL
JEFFERSON CITY, MO 65102
1-888-ASK-MODOT (1-888-275-6636)

IF A SEAL IS PRESENT ON THIS SHEET IT HAS BEEN ELECTRONICALLY SEALED AND DATED.

EFFECTIVE: 04-01-2023																							
SIGN	SIZE	AREA	QTY	TOTAL AREA	QTY RELOC	TOTAL RELOC	SIGN NUM.	DESCRIPTION	SIGN	SIZE	AREA	QTY	TOTAL	QTY RELOC	TOTAL RELOC	SIGN NUM.	DESCRIPTION	ITEM NUMBER	TOTAL QTY	DESCRIPTION			
SIGN	IN.	SQ. FT.	EACH	SQ. FT.	EACH	SQ. FT.			SIGN	IN.	SQ. FT.	EACH	SQ. FT.	EACH	SQ. FT.								
WARNING SIGNS									GUIDE SIGNS												REGULATORY SIGNS		
WO1-1L	48X48	16.00						TURN (SYMBOL LEFT ARROW)	E05-1	36X48	12.00						GORE EXIT	6122008		IMPACT ATTENUATOR 40 MPH (SAND BARRELS)			
WO1-1R	48X48	16.00						TURN (SYMBOL RIGHT ARROW)	E05-2	48X36	12.00						EXIT OPEN	6122009		IMPACT ATTENUATOR 45 MPH (SAND BARRELS)			
WO1-2L	48X48	16.00						CURVE (SYMBOL LEFT ARROW)	E05-2a	48X36	12.00						EXIT CLOSED	6122010		IMPACT ATTENUATOR 50 MPH (SAND BARRELS)			
WO1-2R	48X48	16.00						CURVE (SYMBOL RIGHT ARROW)	GO20-1	60X24	10.00	2	20				ROAD WORK NEXT XX MILES	6122012		IMPACT ATTENUATOR 55 MPH (SAND BARRELS)			
WO1-3L	48X48	16.00						REVERSE TURN (SYMBOL LEFT ARROW)	GO20-2	48X24	8.00	2	16				END ROAD WORK	6122014		IMPACT ATTENUATOR 60 MPH (SAND BARRELS)			
WO1-3R	48X48	16.00						REVERSE TURN (SYMBOL RIGHT ARROW)	GO20-4	36X18	4.50	2	9				PILOT CAR FOLLOW ME	6122017		IMPACT ATTENUATOR 65 MPH (SAND BARRELS)			
WO1-4L	48X48	16.00						REVERSE CURVE (SYMBOL LEFT ARROW)	GO20-4a	42X30	8.75	7	61.25				PILOT CAR IN USE WAIT & FOLLOW	6122019		IMPACT ATTENUATOR 70 MPH (SAND BARRELS)			
WO1-4R	48X48	16.00						REVERSE CURVE (SYMBOL RIGHT ARROW)	GO20-4a	18X12	1.50	9	13.5				PILOT CAR IN USE WAIT & FOLLOW	6122020		REPLACEMENT SAND BARREL			
WO1-4bL	48X48	16.00						DOUBLE ARROW REVERSE CURVE (SYMBOL LT ARROWS)	GO20-5aP	36X24	6.00						WORK ZONE (PLAQUE)	6122030		IMPACT ATTENUATOR (RELOCATION)			
WO1-4bR	48X48	16.00						DOUBLE ARROW REVERSE CURVE (SYMBOL RT ARROWS)	MO4-8a	24X18	3.00						END DETOUR	6123000A	2	TRUCK OR TRAILER MOUNTED ATTENUATOR (TMA)			
WO1-4cL	48X48	16.00						TRIPLE ARROW REVERSE CURVE (SYMBOL LT ARROWS)	MO4-9L	48X36	12.00						DETOUR (LEFT ARROW)	6161008		ADVANCED WARNING RAIL SYSTEM			
WO1-4cR	48X48	16.00						TRIPLE ARROW REVERSE CURVE (SYMBOL RT ARROWS)	MO4-9R	48X36	12.00						DETOUR (RIGHT ARROW)	6161012		BUOYS (BOATS KEEP OUT)			
WO1-6	60X30	12.50						HORIZONTAL ARROW (SYMBOL)	MO4-9P	48X12	4.00						STREET NAME (PLAQUE)	6161013		BUOYS (NO WAKE)			
WO1-6a	72X36	18.00						HORIZ. ARROW (SYMBOL ON PERMANENT BARRICADE)	MO4-10L	48X18	6.00						DETOUR (ARROW LEFT)	6161014		SPECIAL SIGN ASSEMBLY (BOATS KEEP OUT)			
WO1-7	60X30	12.50						DOUBLE HEAD HORIZONTAL ARROW (SYMBOL)	MO4-10R	48X18	6.00						DETOUR (ARROW RIGHT)	6161025	217	CHANNELIZER (TRIM LINE)			
WO1-7a	72X36	18.00						DOUBLE HEAD HORIZ. ARROW (SYMBOL ON PERM. BARR.)	REGULATORY SIGNS								6161030		TYPE III MOVEABLE BARRICADE				
WO1-8	18X24	3.00						CHEVRON (SYMBOL)	R1-1	48X48	13.25						STOP	6161033		DIRECTION INDICATOR BARRICADE			
WO1-8a	30X36	7.50						CHEVRON (SYMBOL FOR DIVIDED HIGHWAYS)	R1-2	48TRI.	6.93						YIELD	6161040		FLASHING ARROW PANEL			
WO3-1	48X48	16.00						STOP AHEAD (SYMBOL)	R1-2a	36X36	9.00						TO ONCOMING TRAFFIC (PLAQUE)	6161047		TYPE III OBJECT MARKER			
WO3-2	48X48	16.00						YIELD AHEAD (SYMBOL)	R1-3P	30X12	2.50						ALL WAY (PLAQUE)	6161055		SEQUENTIAL FLASHING WARNING LIGHT			
WO3-3	48X48	16.00						SIGNAL AHEAD (SYMBOL)	R2-1	36X48	12.00						SPEED LIMIT XX	6161070		TUBULAR MARKER			
WO3-4	48X48	16.00	4	64				BE PREPARED TO STOP	R3-1	48X48	16.00						NO RIGHT TURN (SYMBOL)	6161095		RADAR SPEED ADVISORY SYSTEM			
WO3-5	48X48	16.00						SPEED LIMIT AHEAD	R3-2	48X48	16.00						NO LEFT TURN (SYMBOL)	6161096		CHANGEABLE MESSAGE SIGN, COMMISSION FURNISHED/RETAINED			
WO4-1L	48X48	16.00						MERGE (SYMBOL FROM LEFT)	R3-3	36X36	9.00						NO TURNS	6161098A	2	CHANGEABLE MESSAGE SIGN W/O COMM. INTERFACE - CONTRACTOR FURNISHED/RETAINED			
WO4-1R	48X48	16.00						MERGE (SYMBOL FROM RIGHT)	R3-4	48X48	16.00						NO U-TURN (SYMBOL)	6161098A		CHANGEABLE MESSAGE SIGN WITH COMM. INTERFACE - CONTRACTOR FURNISHED/RETAINED			
WO4-1aL	48X48	16.00						MERGE (ARROW SYMBOL)	R3-7L	30X30	6.25						LEFT LANE MUST TURN LEFT	6161099		CHANGEABLE MESSAGE SIGN WITH COMM. INTERFACE - CONTRACTOR FURNISHED/RETAINED			
WO4-1aR	48X48	16.00						MERGE (ARROW SYMBOL)	R3-7R	30X30	6.25						RIGHT LANE MUST TURN RIGHT	6162000A		WORK ZONE TRAFFIC SIGNAL SYSTEM			
WO5-1	48X48	16.00						ROAD/BRIDGE/RAMP NARROWS	R4-1	36X48	12.00						DO NOT PASS	6162002		TEMPORARY LONG-TERM RUMBLE STRIPS			
WO5-3	48X48	16.00						ONE LANE BRIDGE	R4-2	36X48	12.00						PASS WITH CARE	6173600D		TEMPORARY TRAFFIC BARRIER CONTRACTOR FURNISHED/RETAINED			
WO5-5	48X48	16.00						NARROW LANES	R4-8a	36X48	12.00						KEEP LEFT (HORIZONTAL ARROW)	6173602B		TEMPORARY TRAFFIC BARRIER CONTRACTOR FURNISHED/COMMISSION RETAINED			
WO6-1	48X48	16.00						DIVIDED HIGHWAY (SYMBOL)	R4-7a	36X48	12.00						KEEP RIGHT (HORIZONTAL ARROW)	6174000A		TEMP. TRAFFIC BARRIER HEIGHT TRANSITION			
WO6-2	48X48	16.00						DIVIDED HIGHWAY END (SYMBOL)	R5-1	30X30	6.25						DO NOT ENTER	6175010A		RELOCATING TEMPORARY TRAFFIC BARRIER			
WO6-3	48X48	16.00						TWO WAY TRAFFIC (SYMBOL)	R5-1a	36X24	6.00						WRONG WAY	6176000B		TEMPORARY TRAFFIC BARRIER COMMISSION FURNISHED/RETAINED			
WO7-3a	30X24	5.00						NEXT XX MILES (PLAQUE)	R6-1L	54X18	6.75						ONE WAY ARROW (LEFT)	6177000B		TEMP. TRAFFIC BARRIER HEIGHT TRANSITION			
WO8-1	48X48	16.00						BUMP	R6-1R	54X18	6.75						ONE WAY ARROW (RIGHT)	6208064A		TEMPORARY RAISED PAVEMENT MARKER			
WO8-2	48X48	16.00						DIP	R6-2L	24X30	5.00						ONE WAY (LEFT)	9029400		TEMPORARY TRAFFIC SIGNALS			
WO8-3	48X48	16.00						PAVEMENT ENDS	R6-2R	24X30	5.00						ONE WAY (RIGHT)	9029401		TEMPORARY TRAFFIC SIGNALS AND LIGHTING			
WO8-4	48X48	16.00						SOFT SHOULDER	R9-9	24X12	2.00						SIDEWALK CLOSED						
WO8-5	48X48	16.00						SLIPPERY WHEN WET (SYMBOL)	R9-11L	24X18	3.00						SIDEWALK CLOSED AHEAD, (ARROW LEFT) CROSS HERE						
WO8-6	48X48	16.00						TRUCK CROSSING (WITH FLAGS)	R9-11R	24X18	3.00						SIDEWALK CLOSED AHEAD, (ARROW RIGHT) CROSS HERE						
WO8-6c	48X48	16.00						TRUCK ENTRANCE	R10-6	24X36	6.00						STOP HERE ON RED (45° ARROW)						
WO8-7	36X36	9.00						LOOSE GRAVEL	R11-2	48X30	10.00						ROAD CLOSED						
WO8-7a	36X36	9.00						FRESH OIL/LOOSE GRAVEL	R11-3a	60X30	12.50						ROAD CLOSED XX MILES AHEAD						
WO8-9	48X48	16.00						LOW SHOULDER	R11-4	60X30	12.50						LOCAL TRAFFIC ONLY						
WO8-11	48X48	16.00	12	192				UNEVEN LANES	R11-4	60X30	12.50						ROAD CLOSED TO THRU TRAFFIC						
WO8-12	48X48	16.00	7	112				NO CENTER LINE	CONST-3A	60X48	20.00						FINE SIGN						
WO8-15	48X48	16.00						GROOVED PAVEMENT	CONST-3X	56X12	4.67						SPEEDING/PASSING (PLATE)						
WO8-15P	30X24	5.00						MOTORCYCLE (PLAQUE)	MISCELLANEOUS SIGNS														
WO8-17	48X48	16.00	12	192				SHOULDER DROP-OFF (SYMBOL)	CONST-5	48X36	12.00						POINT OF PRESENCE						
WO8-17P	30X24	5.00	12	60				SHOULDER DROP-OFF (PLAQUE)	CONST-5	96X48	32.00						POINT OF PRESENCE						
W10-1	42RND.	9.62						RAILROAD CROSSING	CONST-7	48X24	8.00	2	16				RATE OUR WORK ZONE						
WO12-1	24X24	4.00						DOUBLE DOWN ARROW (SYMBOL)	CONST-7	72X36	18.00						RATE OUR WORK ZONE						
WO12-2	48X48	16.00						LOW CLEARANCE (SYMBOL)	CONST-8	48X36	12.00	2	24				WORK ZONE NO PHONE ZONE						
WO12-2X	24X18	3.00						LOW CLEARANCE (PLAQUE)															
WO12-2a	84X24	14.00						OVERHEAD LOW CLEARANCE (FEET AND INCHES)															
WO12-4	120X60	50.00						LOW CLEARANCE XX FT XX IN XX MILES AHEAD															
WO12-5	120X60	50.00						WIDTH RESTRICTION XX FT XX IN XX MILES AHEAD															
WO13-1	30X30	6.25						ADVISORY SPEED (PLAQUE)															
WO16-2	30X24	5.00						XXX FEET (PLAQUE)															
WO16-3	30X24	5.00						X MILE (PLAQUE)															
WO20-1	48X48	16.00	11	176				ROAD/BRIDGE/RAMP WORK AHEAD															
WO20-2	48X48	16.00						DETOUR AHEAD															
WO20-3	48X48	16.00						ROAD CLOSED AHEAD															
WO20-4	48X48	16.00	4	64				ONE LANE ROAD AHEAD	616-10.05 CONSTRUCTION SIGNS			TOTAL 1093											
WO20-5	48X48	16.00						RIGHT/CENTER/LEFT LANE CLOSED AHEAD	616-10.10 RELOCATED SIGNS						TOTAL 0								
WO20-5a	48X48	16.00						2 RIGHT/CENTER/LEFT LANES CLOSED AHEAD															
WO20-6a	48X48	16.00						RIGHT/CENTER/LEFT LANE CLOSED															
WO20-7a	48X48	16.00	4	64				FLAGGER (SYMBOL, WITH FLAGS)															
WO21-2	36X36	9.00						FRESH OIL															
WO21-5	48X48	16.00						SHOULDER WORK AHEAD															
WO22-1	48X48	16.00						BLASTING ZONE AHEAD															
WO22-2	42X36	10.50						TURN OFF 2-WAY RADIO AND PHONE															
WO22-3	42X36	10.50						END BLASTING ZONE															
GO22-1	21X15	2.19	4	8.76				WET PAINT (ARROW PIVOTS)															

BASE PROJECT
SUMMARY OF QUANTITIES
SHEET 3 OF 3

NOT TO SCALE

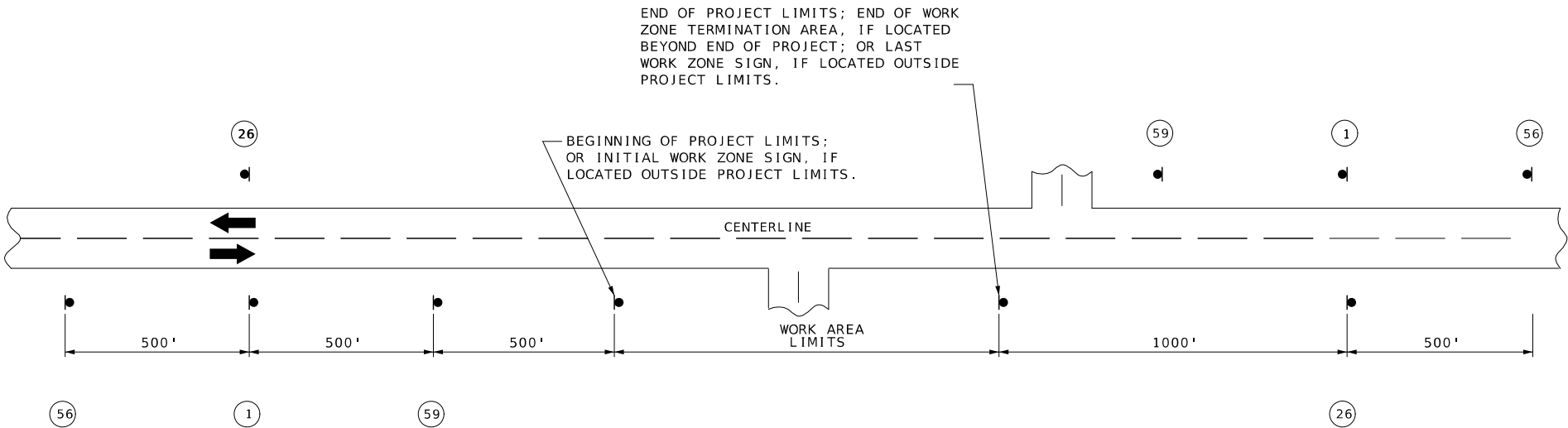

NOTES:

SIGN (1) AND (26) ARE ONLY USED ON PROJECT LENGTHS 2 MILES OR GREATER.

PROVIDE SIGNS IN EACH DIRECTION ON TWO-WAY HIGHWAY.

DISTANCE MAY BE ADJUSTED ACCORDING TO FIELD CONDITIONS.

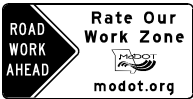

CONST-7-48

(56)



G020-2

(26)

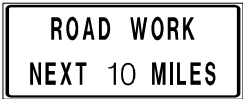

G020-1

(1)



CONST-8

(59)



DATE PREPARED
8/15/2023

ROUTE
D, FF
DISTRICT
KC

STATE
MO
SHEET NO.
5

COUNTY
LAFAYETTE

JOB NO.
JKRM0042

CONTRACT ID.

PROJECT NO.

BRIDGE NO.

DATE	DESCRIPTION

MISSOURI HIGHWAYS AND TRANSPORTATION
COMMISSION

105 WEST CAPITOL
JEFFERSON CITY, MO 65102
1-888-ASK-MODOT (1-888-275-6636)

MODOT

IF A SEAL IS PRESENT ON THIS SHEET IT HAS BEEN ELECTRONICALLY SEALED AND DATED.

NOT TO SCALE

SPEED	SIGN SPACING (FT.)	
PERMANENT POSTED (MPH)	NON-DIVIDED HIGHWAYS (S)	DIVIDED HIGHWAYS (S)
0-35	200	200
40-45	350	500
50-55	500	1000
60-70	1000	(SA)-1000 (SB)-1500 (SC)-2640

DISTANCE MAY BE ADJUSTED ACCORDING TO FIELD CONDITIONS.

NOTES:
WARNING SIGNS SHALL BE ERECTED AT EACH INTERSECTION WITH ANOTHER STATE HIGHWAY WITHIN THE WORK ZONE.

ADDITIONAL WARNING SIGNS SHALL BE ERECTED AT OTHER INTERSECTIONS WITHIN THE WORK ZONE, AS DIRECTED BY THE ENGINEER.

■ - CHANNELIZERS (AS SPECIFIED)

○ - FLAGGER

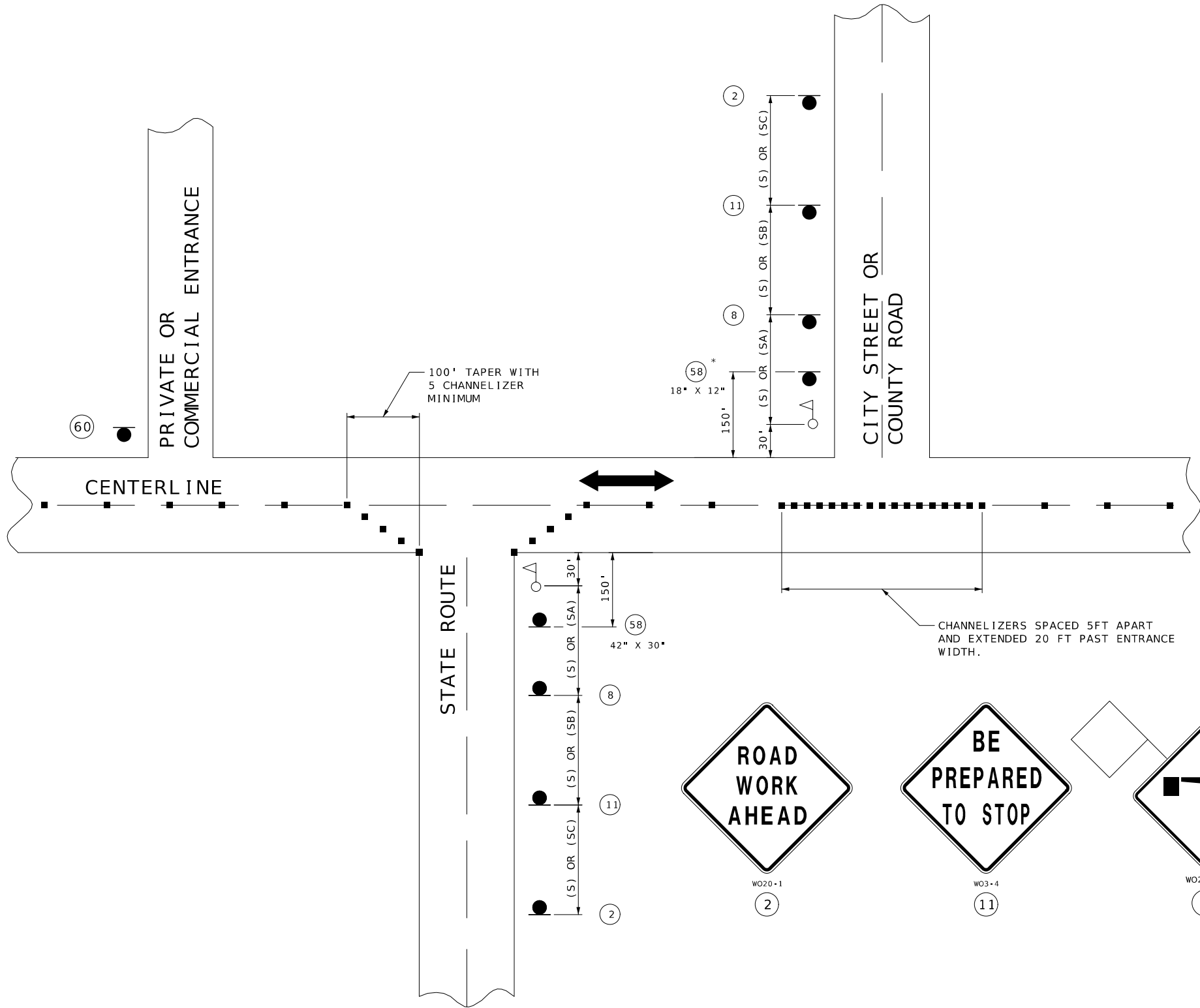

SHALL BE USED ON ALL STATE ROUTES AND MAY BE USED ON ANY NON-STATE ROUTES, AS DETERMINED BY THE ENGINEER.

* THE SMALLER 18" X 12" SIGN 58 IS USED ON ALL OTHER NON-STATE ROUTES (CITY STREETS, COUNTY ROADS, ETC.).

SHALL ONLY BE USED AT PRIVATE AND COMMERCIAL ENTRANCES. SEE STD PLAN 616.10BB SHEET 8 OF 9

SIDE ROADS ENTERING WORK ZONES

TRAFFIC CONTROL
SHEET 3 OF 5

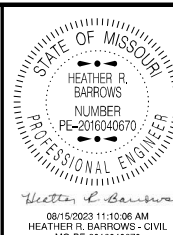

DATE PREPARED
8/15/2023
ROUTE
D, FF
DISTRICT
KC
STATE
MO
SHEET NO.
7
COUNTY
LAFAYETTE
JOB NO.
JKRM0042
CONTRACT ID.

PROJECT NO.
BRIDGE NO.

DATE	DESCRIPTION

MISSOURI HIGHWAYS AND TRANSPORTATION COMMISSION
105 WEST CAPITOL
JEFFERSON CITY, MO 65102
1-888-ASK-MODOT (1-888-275-6636)
MODOT

IF A SEAL IS PRESENT ON THIS SHEET IT HAS BEEN ELECTRONICALLY SEALED AND DATED.

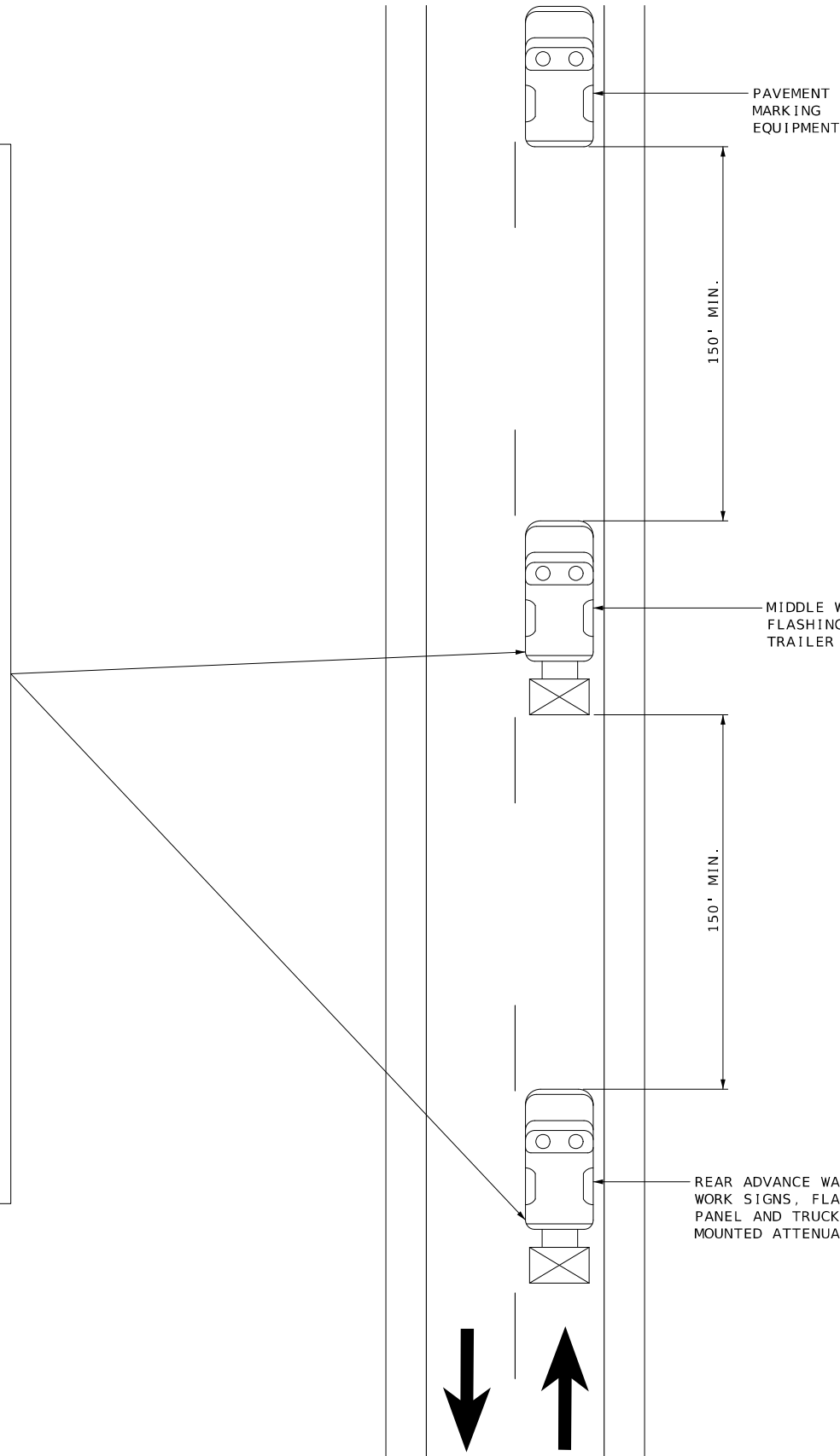

NOTES:

UPON APPROVAL OF THE ENGINEER, THE CONTRACTOR MAY PROVIDE ADDITIONAL PROTECTIVE TRUCK EQUIPPED WITH PROPER WARNING DEVICES.

PROTECTIVE TRUCK AND WORK VEHICLES SHALL DISPLAY HIGH-INTENSITY ROTATING, FLASHING, OSCILLATING, OR STROBE LIGHTS.

VEHICLE HAZARD WARNING SIGNALS SHALL NOT BE USED INSTEAD OF THE VEHICLE'S HIGH-INTENSITY ROTATING, FLASHING, OSCILLATING, OR STROBE LIGHTS.

FLASHING ARROW PANELS SHALL BE INCIDENTAL TO TRUCK MOUNTED ATTENUATORS, WHEREVER USED. NO ADDITIONAL PAYMENT SHALL BE MADE.

(1) TRUCK IS OPTIONAL ON TWO-LANE UNDIVIDED HIGHWAYS IF SIGNING AND ARROW BOARD IS MOUNTED ON THE PAVEMENT MARKING EQUIPMENT.

(2) WET PAINT SIGNS ARE INSTALLED TO INDICATE THE SIDE IN WHICH THE PAVEMENT MARKING MATERIAL IS BEING APPLIED. AT THE CONTRACTOR'S OPTION, A FRONT FACING WET PAINT SIGN MAY BE INSTALLED ON THE LEFT SIDE OF THE PAVEMENT MARKING EQUIPMENT.

(3) REAR ADVANCE WARNING TRUCK IS POSITIONED AT THE NO TRACK POINT OF THE PAVEMENT MARKING MATERIAL, OR VERTICAL OR HORIZONTAL CURVES THAT RESTRICT SIGHT DISTANCE, OR SPACING SHOWN.

TRAFFIC CONTROL
SHEET 5 OF 5

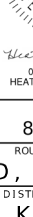
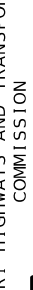
		IF A SEAL IS PRESENT ON THIS SHEET IT HAS BEEN ELECTRONICALLY SEALED AND DATED.	
<i>Heather R. Barrows</i> 08/15/2023 11:11:03 AM HEATHER R. BARROWS - CIVIL MO-PE-2016040670			
DATE PREPARED 8/15/2023			
ROUTE D, FF	STATE MO		
DISTRICT KC	SHEET NO. 9		
COUNTY LAFAYETTE			
JOB NO. JKRMO042			
CONTRACT ID.			
PROJECT NO.			
BRIDGE NO.			
DESCRIPTION			
DATE			
MISSOURI HIGHWAYS AND TRANSPORTATION COMMISSION			
			
105 WEST CAPITOL JEFFERSON CITY, MO 65102 1-888-ASK-MODOT (1-888-275-6636)			

A.A.D.T. - 2023 = UNKNOWN
V = 20 M.P.H.



THE EXISTENCE AND APPROXIMATE LOCATION OF UTILITY FACILITIES KNOWN TO EXIST, AS SHOWN ON THE PLANS, ARE BASED ON THE BEST INFORMATION AVAILABLE TO THE COMMISSION AT THIS TIME. THIS INFORMATION IS PROVIDED BY THE COMMISSION "AS-IS" AND THE COMMISSION EXPRESSLY DISCLAIMS ANY REPRESENTATION OR WARRANTY AS TO THE COMPLETENESS, ACCURACY, OR SUITABILITY OF THE INFORMATION FOR ANY USE. RELIANCE UPON THIS INFORMATION IS DONE AT THE RISK AND PERIL OF THE USER, AND THE COMMISSION SHALL NOT BE LIABLE FOR ANY DAMAGES THAT MAY ARISE FROM ANY ERROR IN THE INFORMATION. IT IS, THEREFORE, THE RESPONSIBILITY OF THE CONTRACTOR TO VERIFY THE EXISTENCE, LOCATION AND STATUS OF ANY FACILITY. SUCH VERIFICATION INCLUDES DIRECT CONTACT WITH THE LISTED UTILITIES.

DESCRIPTION	NUMBER
TITLE SHEET -----	1
TYPICAL SECTIONS (TS) (1 SHEETS)---	2
QUANTITIES (QU) (1 SHEETS)-----	3
PLAN-PROFILE (PP)-----	4
SPECIAL SHEETS (SS)-----	5-8
TRAFFIC CONTROL SHEETS (TC)-----	9-10
PAVEMENT MARKING SHEETS (PM)-----	11

BEGINNING OF PROJECT	VAR
END OF PROJECT	VAR
APPARENT LENGTH	23676.00 FEET
EQUATIONS AND EXCEPTIONS:NONE	

TOTAL CORRECTIONS	0 FEET
NET LENGTH OF PROJECT	23676 FEET
STATE LENGTH	4.484 MILES

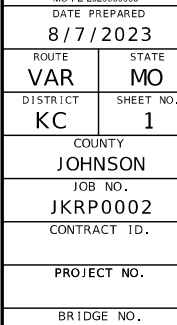
[illegible]

MISSOURI HIGHWAYS AND TRANSPORTATION COMMISSION

MoDOT

105 WEST CAPITOL
JEFFERSON CITY, MO 65102

[illegible]

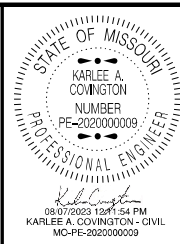

DATE PREPARED 8/7/2023	
ROUTE VAR	STATE MO
DISTRICT KC	SHEET NO. 2
COUNTY JOHNSON	
JOB NO. JKRP0002	
CONTRACT ID.	
PROJECT NO.	
BRIDGE NO.	

DESCRIPTION	DATE

MISSOURI HIGHWAYS AND TRANSPORTATION COMMISSION



105 WEST CAPITOL
JEFFERSON CITY, MO 65102
1-888-ASK-MODOT (1-888-275-6636)

IF A SEAL IS PRESENT ON THIS SHEET IT HAS BEEN ELECTRONICALLY SEALED AND DATED.

NOT TO SCALE

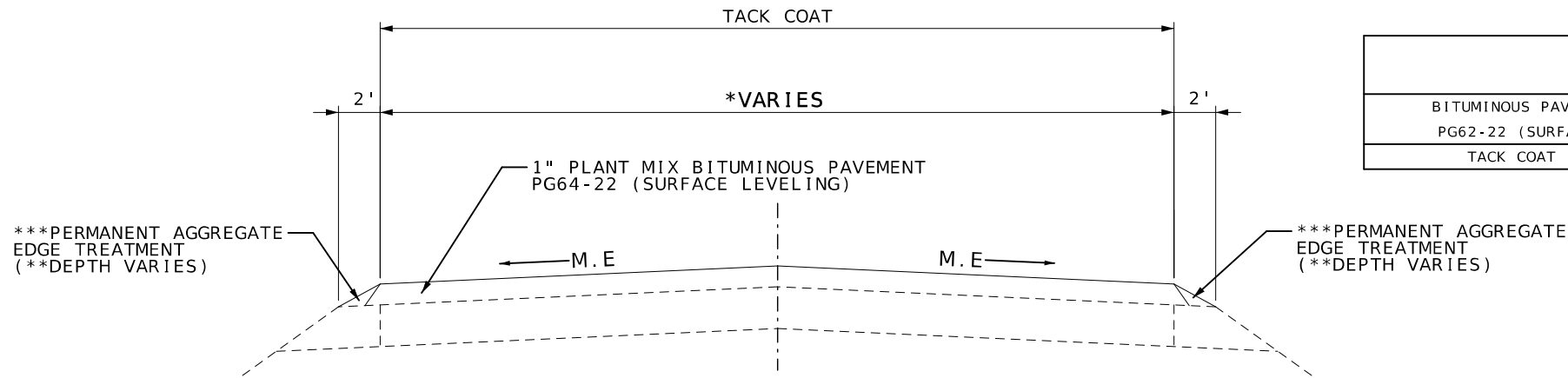

FACTORS		
BITUMINOUS PAVEMENT MIXTURE PG62-22 (SURFACE LEVELING)	1.983	TON / CY
TACK COAT (EXISTING)	0.08	GAL / CY

TYPICAL SECTION

SE 10
SE 10 LOOP
VISITOR CENTER
CAMPGROUND
BIG CAMPGROUND LOOP
SMALL CAMPGROUND LOOP
LAKE BUTEO
871 RD
871 LOOP
NE 751
CLEAR FORK LAKE
CAMP BOBWHITE
LOG MI 0.000 TO LOG MI 0.254
LOG MI 0.584 TO LOG MI 0.655

NOTE :

25% IRREGULARITIES ADDED FOR DEPTH OR
WIDTH IRREGULARITIES

CLEAN AREA OF DEBRIS AND PLACE TACK
BEFORE IRREGULARITIES

SURFACE PLACEMENT SHALL BE ONE PASS PER LANE
NO S.E. CORRECTION

LEGEND:

ME - MATCH EXISTING

*** - NO PLACEMENT AT ENTRANCES

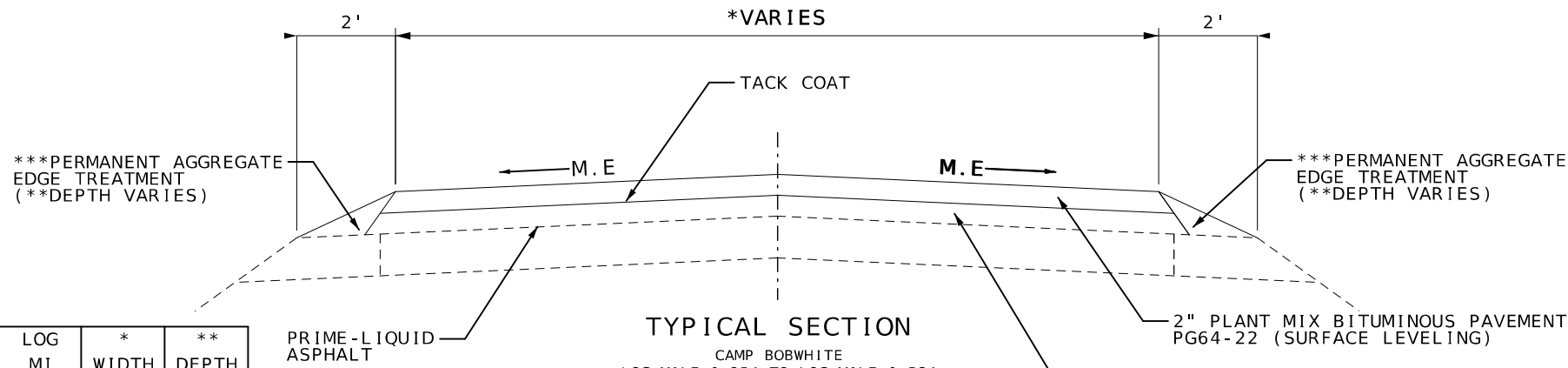

TYPICAL SECTION

CAMP BOBWHITE
LOG MILE 0.254 TO LOG MILE 0.584
CAMP BOBWHITE LOOP

NOTE :

25% IRREGULARITIES ADDED FOR DEPTH OR
WIDTH IRREGULARITIES

CLEAN AREA OF DEBRIS AND PLACE PRIME-LIQUID
ASPHALT BEFORE IRREGULARITIES

TO BE LAID IN 2-2" LIFTS

ROUTE	LOG MI	LOG MI	* WIDTH (FT)	** DEPTH (IN)
SE 10	-	-	20	1
SE 10 LOOP	-	-	17	1
VISITOR CENTER	-	-	VAR	1
CAMPGROUND	-	-	23.5	1
BIG CAMPGROUND LOOP	-	-	17	1
SMALL CAMPGROUND LOOP	-	-	VAR	1
LAKE BUTEO	-	-	21	1
871 RD	-	-	20.5	1
871 LOOP	-	-	VAR	1
NE 751	0.000	0.428	20	10
NE 751	0.428	0.835	18	10
CLEAR FORK LAKE	0.000	0.399	21	1
CLEAR FORK LAKE	0.399	0.468	23	1
CAMP BOBWHITE	0.000	0.254	17	10
CAMP BOBWHITE	0.254	0.555	17	14
CAMP BOBWHITE	0.555	0.584	VAR	14
CAMP BOBWHITE	0.584	0.655	VAR	14
CAMP BOBWHITE LOOP	-	-	12	6

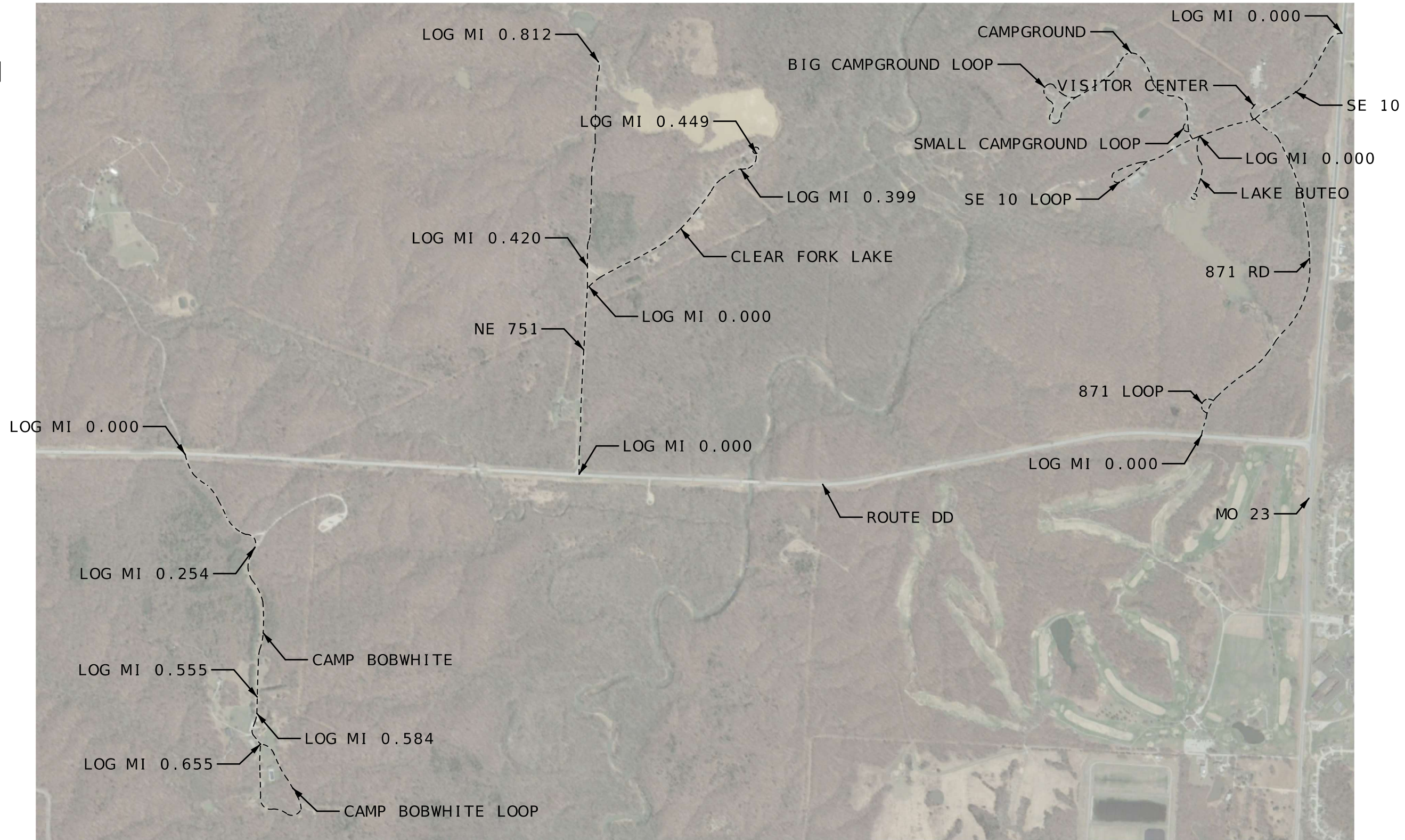

NOT TO SCALE

ANY WORK INDICATED ON THE PLANS THAT EXTENDS BEYOND THE PROJECT LIMITS IS CONSIDERED INCIDENTAL TO AND A PART OF THE CONSTRUCTION OF THIS PROJECT.

PLAN SHEET
SHEET 1 OF 1



DATE PREPARED
8/7/2023

ROUTE
VAR

STATE
MO

DISTRICT
KC

SHEET NO.
4

COUNTY
JOHNSON

JOB NO.
JKRP0002

CONTRACT ID.

PROJECT NO.

BRIDGE NO.

DATE	DESCRIPTION

MISSOURI HIGHWAYS AND TRANSPORTATION COMMISSION

105 WEST CAPITOL
JEFFERSON CITY, MO 65102
1-888-ASK-MODOT (1-888-275-6636)

IF A SEAL IS PRESENT ON THIS SHEET IT HAS BEEN ELECTRONICALLY SEALED AND DATED.

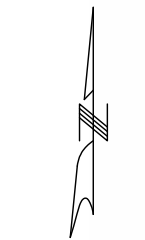

NOT TO SCALE

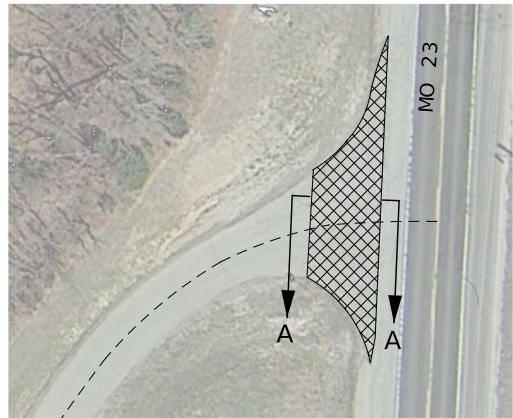

SE 10 ENTRANCE
(LOG MI 0.000)

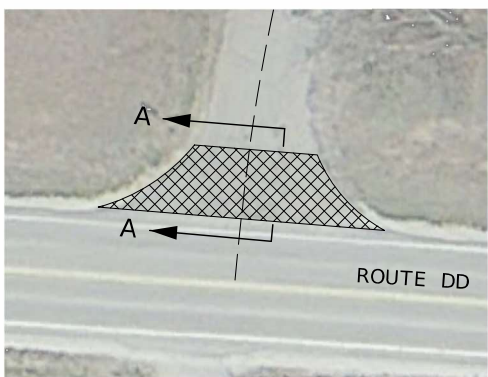

871 ROAD ENTRANCE
(LOG MI 0.000)

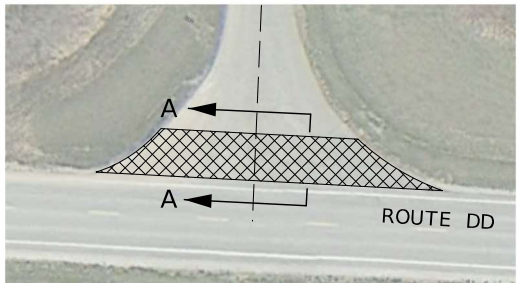

NE 751 ENTRANCE
(LOG MI 0.000)

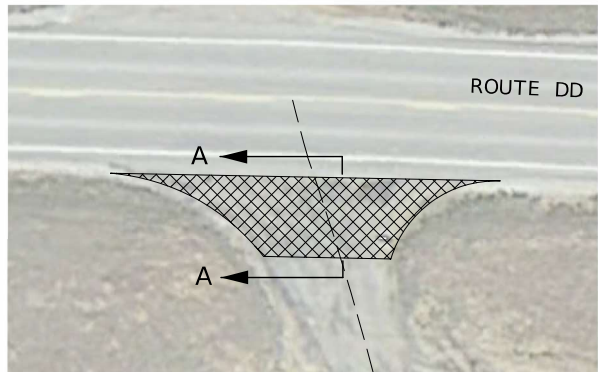

CAMP BOBWHITE ENTRANCE
(LOG MI 0.000)

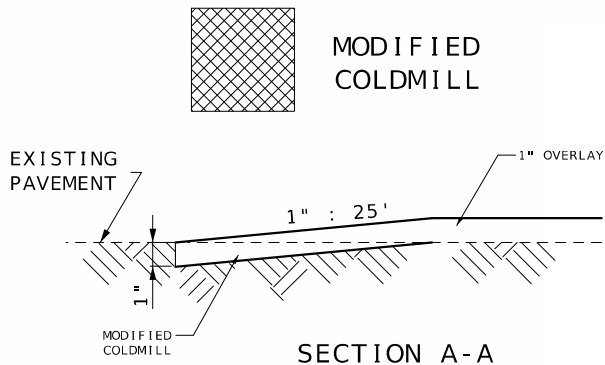

TRAVELWAY DEPTH TRANSITIONS
BEGINNING AND END OF PROJECT
AND ROADWAYS

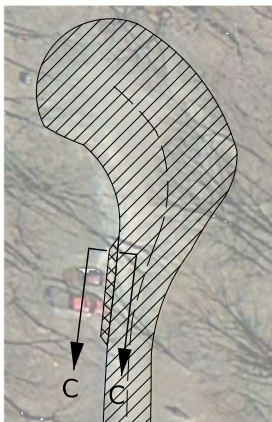

CUL DE SAC
AT NE 751

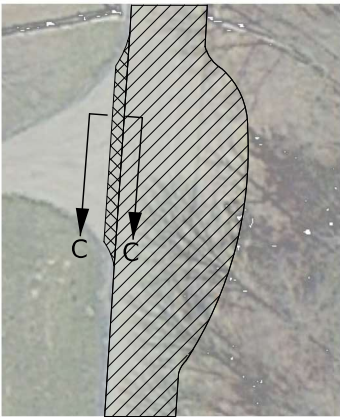

ENTRANCE
AT NE 751

COLDMILLING SPECIAL SHEET
SHEET 1 OF 4

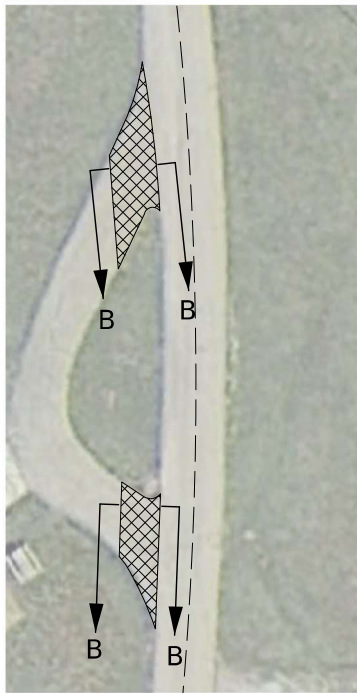

ENTRANCES
AT CAMPBOBWHITE LOOP

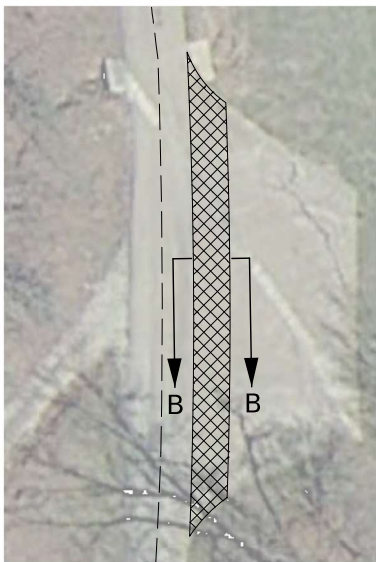

PARKING
AT CAMPBOBWHITE LOOP

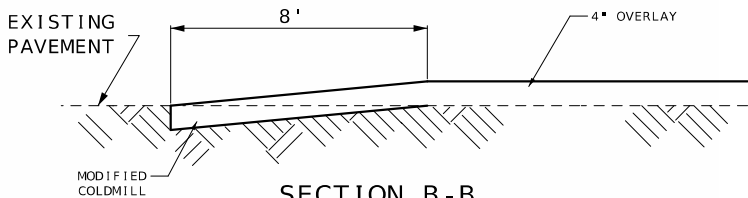

SECTION B-B
TYPICAL 4" CLC ENTRANCE

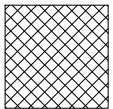

MODIFIED
COLDMILL

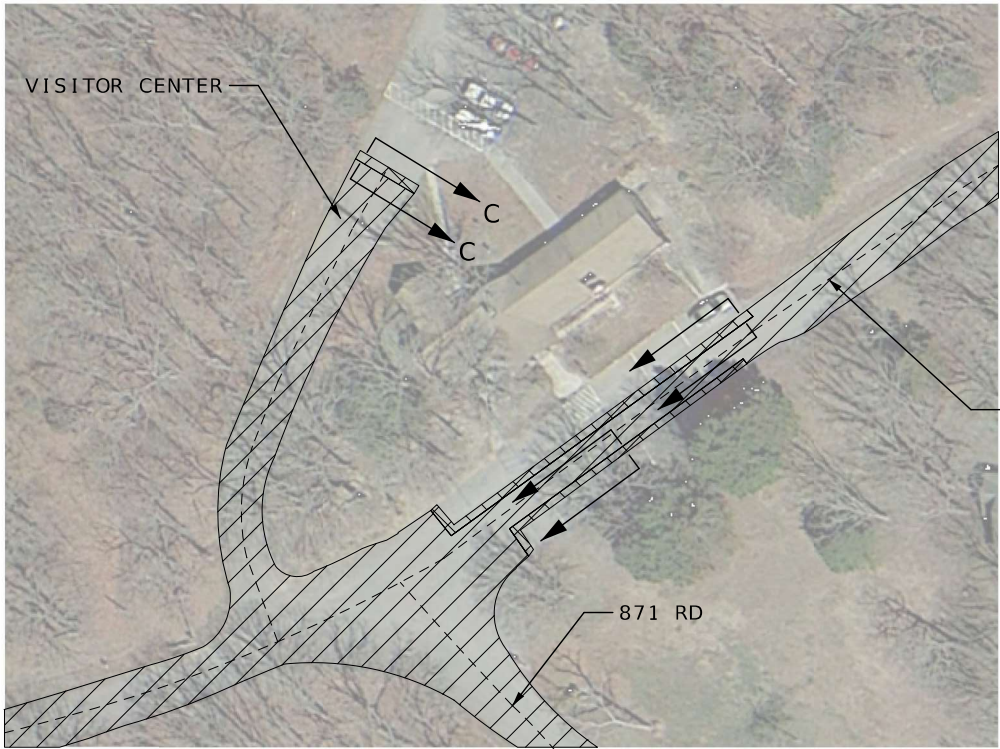

PARKING AT SE 10 AND
ENTRANCE AT VISITOR CENTER

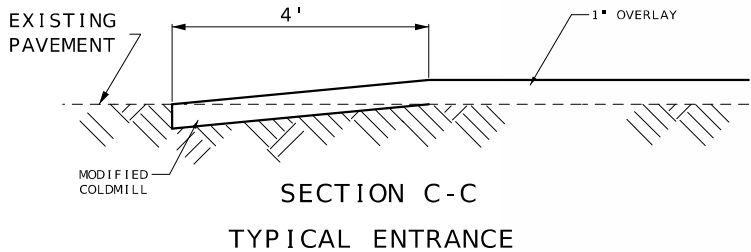

SECTION C-C
TYPICAL ENTRANCE

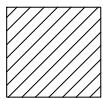

1" CLC

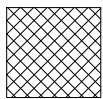

MODIFIED
COLDMILL

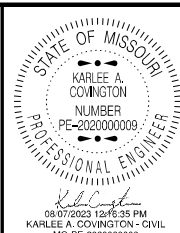

DATE PREPARED 8/7/2023	
ROUTE VAR	STATE MO
DISTRICT KC	SHEET NO. 5
COUNTY JOHNSON	
JOB NO. JKRP0002	
CONTRACT ID.	
PROJECT NO.	
BRIDGE NO.	

DATE	DESCRIPTION

MISSOURI HIGHWAYS AND TRANSPORTATION
COMMISSION

105 WEST CAPITOL
JEFFERSON CITY, MO 65102
1-888-ASK-MODOT (1-888-275-6636)

IF A SEAL IS PRESENT ON THIS SHEET IT HAS BEEN ELECTRONICALLY SEALED AND DATED.

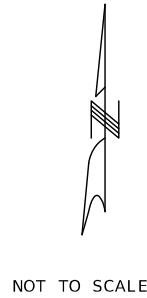

NOT TO SCALE

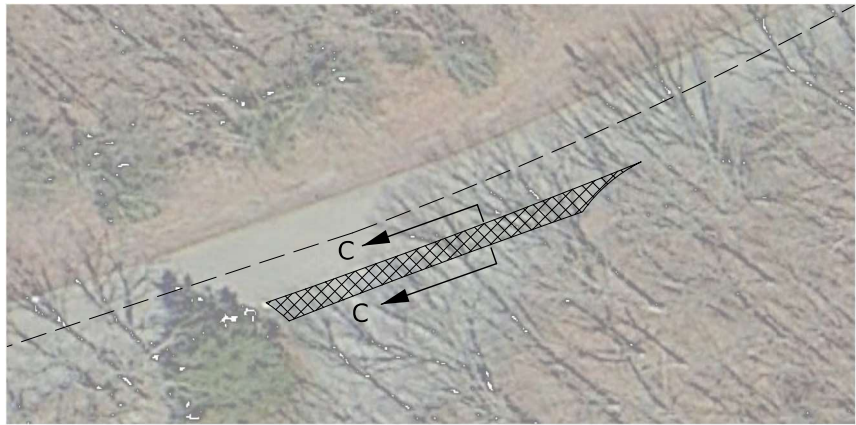

PARKING LOT
AT SE 10



ENTRANCES
AT CAMPGROUND

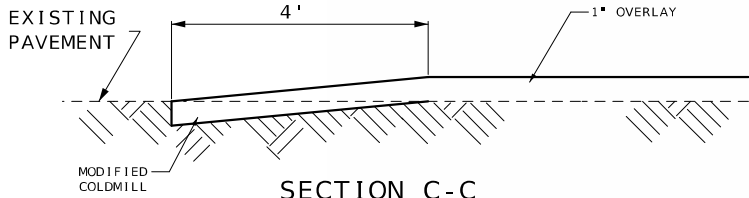

SECTION C-C
TYPICAL ENTRANCE



MODIFIED
COLDMILL



PARKING
AT LAKE BUTEO

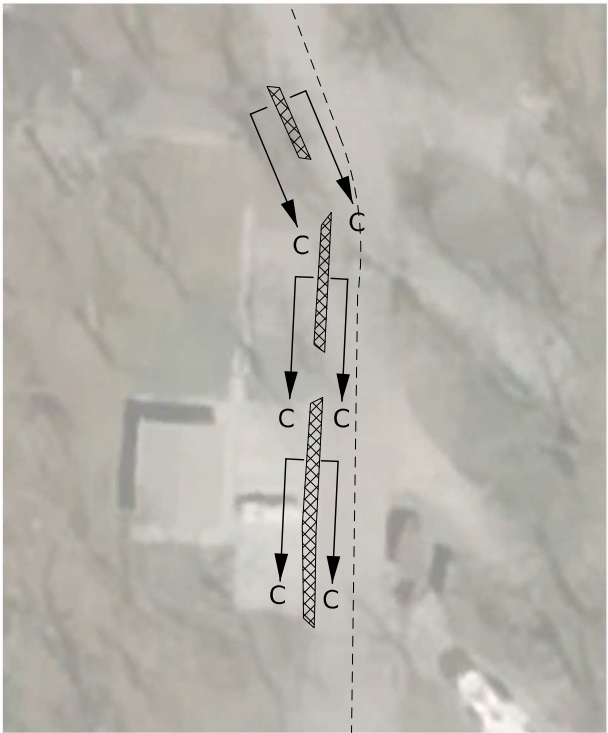

PARKING
AT CAMPGROUND



PARKING
AT CLEAR FORK LAKE

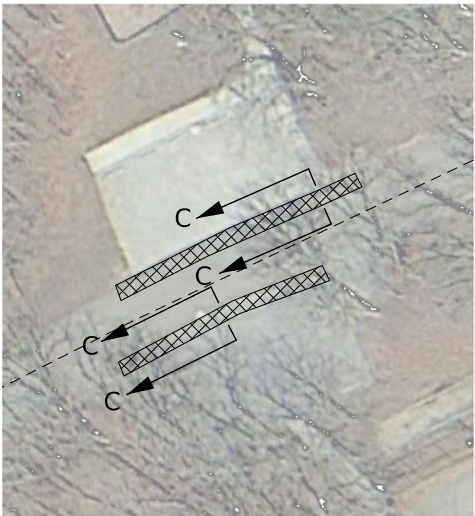

PARKING
AT SE 10

COLDMILLING SPECIAL SHEET
SHEET 2 OF 4

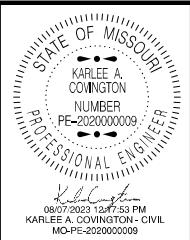

DATE PREPARED 8/7/2023	
ROUTE VAR	STATE MO
DISTRICT KC	SHEET NO. 6
COUNTY JOHNSON	
JOB NO. JKRP0002	
CONTRACT ID.	
PROJECT NO.	
BRIDGE NO.	

DATE	DESCRIPTION

MISSOURI HIGHWAYS AND TRANSPORTATION
COMMISSION

105 WEST CAPITOL
JEFFERSON CITY, MO 65102
1-888-ASK-MODOT (1-888-275-6636)

IF A SEAL IS PRESENT ON THIS SHEET IT HAS BEEN ELECTRONICALLY SEALED AND DATED.



NOT TO SCALE

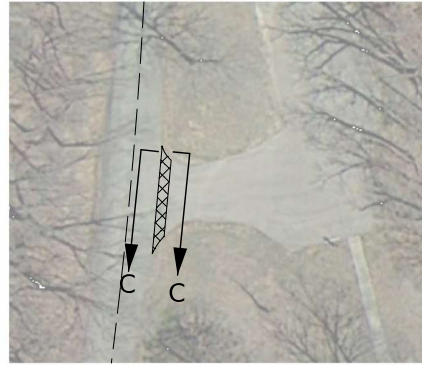

PARKING
AT NE 751

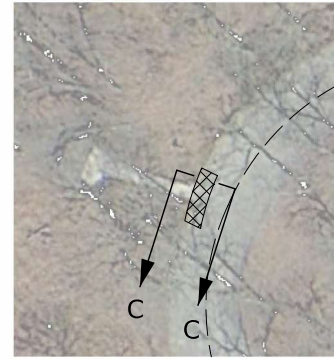

SIDEWALK
AT 871 LOOP



PARKING
AT NE 751



PARKING
AT CLEAR FORK LAKE

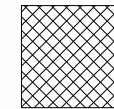

MODIFIED COLDMILL

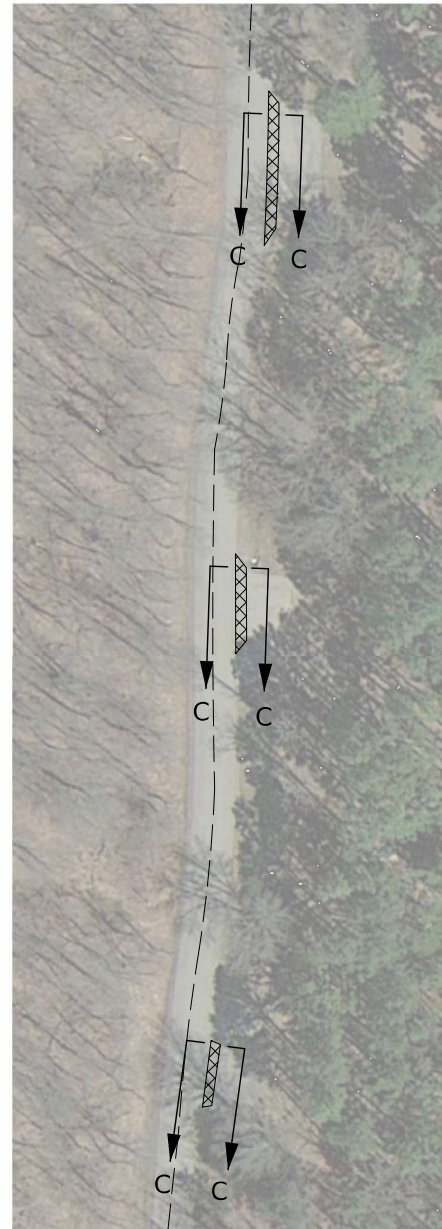

PARKING
AT NE 751

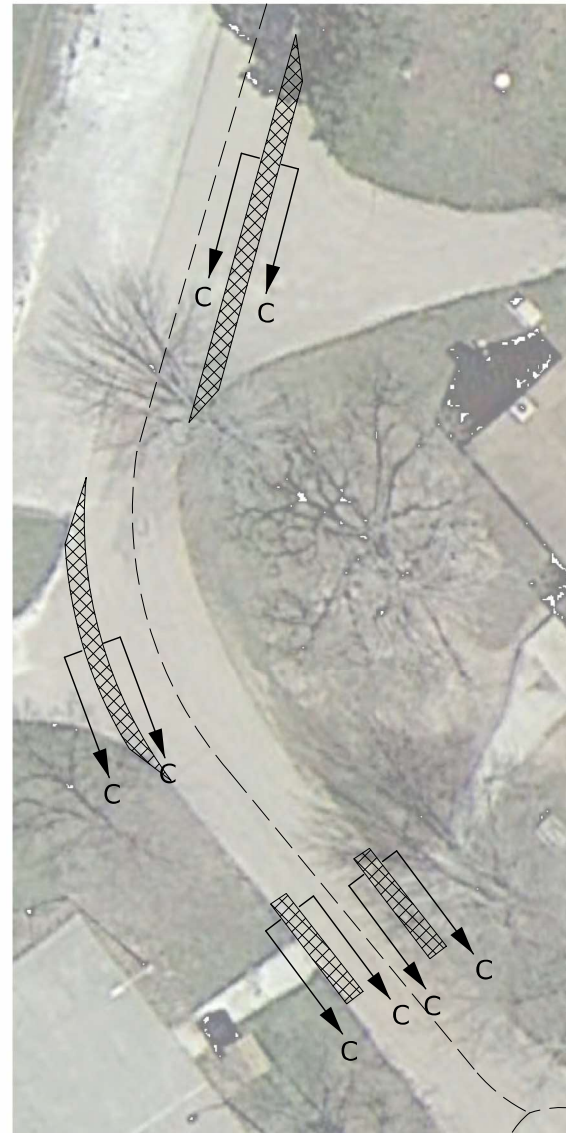

ENTRANCES AT CAMP BOBWHITE
LOG MI 0.655



ENTRANCE
AT 871 RD

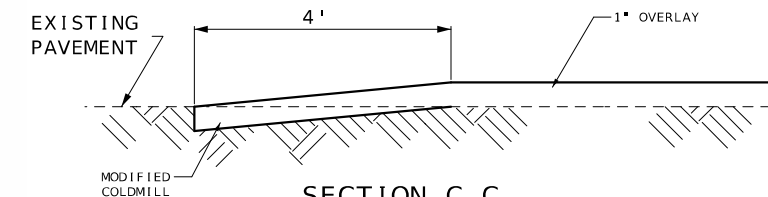

SECTION C-C
TYPICAL ENTRANCE

COLDMILLING SPECIAL SHEET
SHEET 3 OF 4

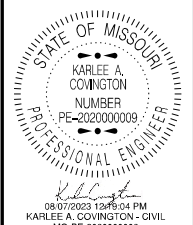

DATE PREPARED 8/7/2023	
ROUTE VAR	STATE MO
DISTRICT KC	SHEET NO. 7
COUNTY JOHNSON	
JOB NO. JKRP0002	
CONTRACT ID.	
PROJECT NO.	
BRIDGE NO.	

DATE	DESCRIPTION

MISSOURI HIGHWAYS AND TRANSPORTATION
COMMISSION

105 WEST CAPITOL
JEFFERSON CITY, MO 65102
1-888-ASK-MODOT (1-888-275-6636)

IF A SEAL IS PRESENT ON THIS SHEET IT HAS BEEN ELECTRONICALLY SEALED AND DATED.



NOT TO SCALE



CAMP BOBWHITE
(LOG MI 0.253)

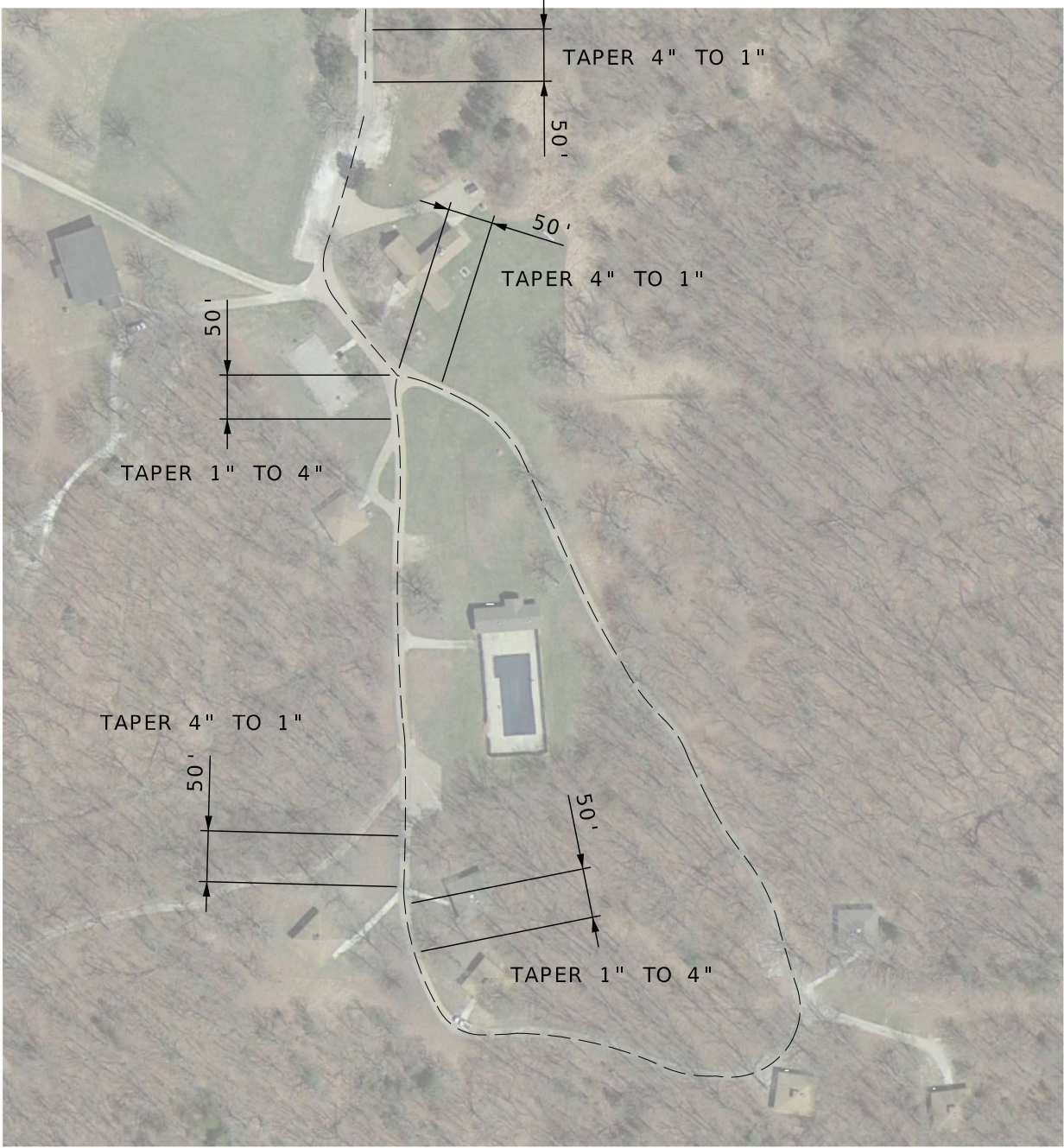

CAMP BOBWHITE AND CAMP BOBWHITE LOOP

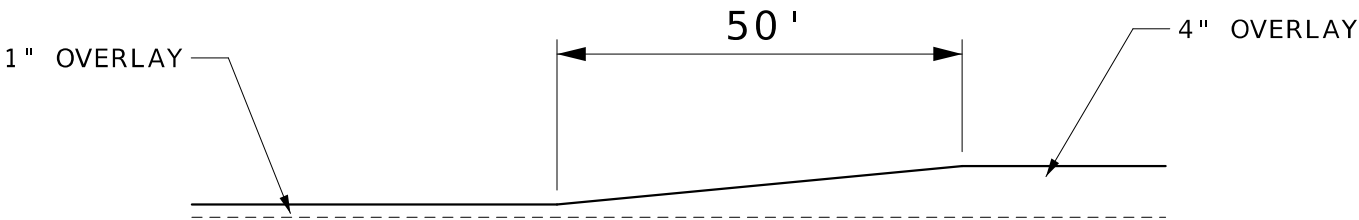

TAPER DETAIL

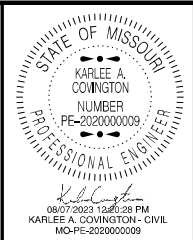

DATE PREPARED 8/7/2023	
ROUTE VAR	STATE MO
DISTRICT KC	SHEET NO. 8
COUNTY JOHNSON	
JOB NO. JKRP0002	
CONTRACT ID.	
PROJECT NO.	
BRIDGE NO.	

DATE	DESCRIPTION

MISSOURI HIGHWAYS AND TRANSPORTATION
COMMISSION

105 WEST CAPITOL
JEFFERSON CITY, MO 65102
1-888-ASK-MODOT (1-888-275-6636)

IF A SEAL IS PRESENT ON THIS SHEET IT HAS BEEN ELECTRONICALLY SEALED AND DATED.

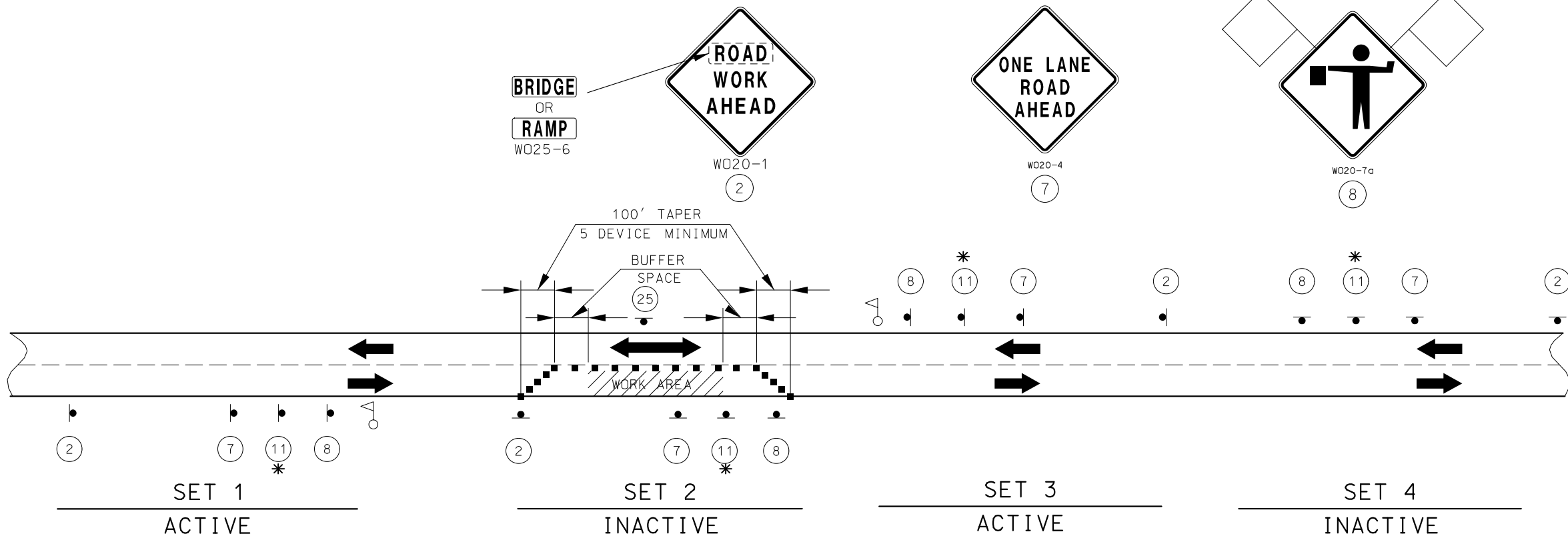

TAPER LENGTHS AND SPACING OF CHANNELIZING DEVICES						
SPEED (P) MPH	MINIMUM TAPER LENGTHS (L) FOR LANE WIDTHS (W)			MINIMUM TAPER SHOULDER (T)	MAXIMUM CHANNELIZER SPACING	
	10 FT	11 FT	12 FT		TAPERS	BUFFER/WORK AREA
0-35	205 FT	225 FT	245 FT	70	35 FT	40 FT
40-45	450 FT	495 FT	540 FT	150	40 FT	80 FT
50-55	550 FT	605 FT	660 FT	185	50 FT	80 FT
60-70	700 FT	770 FT	840 FT	235	60 FT	120 FT

SIGN SPACING FOR ADVANCE SIGN SERIES (1) (2)		
SPEED (P) MPH	NON-DIVIDED HIGHWAYS (S)	DIVIDED HIGHWAYS (S)
	10 FT	12 FT
0-35	200 FT	200 FT
40-45	350 FT	500 FT
50-55	500 FT	1000 FT
60-70	SA-1000 FT, SB-1500 FT, SC-2640 FT **	

** THE SA DIMENSION IS THE DISTANCE FROM THE TRANSITION OR POINT OF RESTRICTION TO THE FIRST SIGN.

THE SB DIMENSION IS THE DISTANCE BETWEEN THE FIRST AND SECOND SIGNS.

THE SC DIMENSION IS THE DISTANCE BETWEEN THE SECOND AND THIRD SIGNS.

(THE "FIRST SIGN" IS THE SIGN IN A THREE-SIGN SERIES THAT IS CLOSEST TO THE TEMPORARY TRAFFIC CONTROL ZONE. THE "THIRD SIGN" IS THE SIGN THAT IS FURTHEST UPSTREAM FROM THE TEMPORARY TRAFFIC CONTROL ZONE)

NOTES:

DIMENSIONS IN FEET UNLESS OTHERWISE NOTED.

(1) SPACING BETWEEN SIGNS AND SPACING BETWEEN LAST SIGN AND FLAGGER, BEGINNING OF TAPER, OR SIGNED CONDITION

(2) SPACINGS MAY BE ADJUSTED AS NECESSARY TO MEET FIELD CONDITIONS

LONGITUDINAL BUFFER SPACE	
SPEED (P) MPH	BUFFER SPACE (FEET)
0-35	280
40-45	400
50-55	560
60-70	840

TAPER LENGTH (L)
L = W X P FOR 40 MPH OR MORE
L = $\frac{WP^2}{60}$ FOR 35 MPH OR LESS
L = TAPER LENGTH IN FEET
W = LATERAL SHIFT IN FEET
P = POSTED SPEED PRIOR TO ROAD WORK IN MPH

GENERAL NOTES:

- SEE STANDARD PLAN 616.10 FOR DETAILS AND ITEMS NOT SHOWN
- EXISTING SIGNS SHALL BE COVERED DURING WORKING HOURS ONLY IF IN CONFLICT WITH TRAFFIC CONTROL PLANS.
- NO DIRECT PAYMENT WILL BE MADE FOR RELOCATING, COVERING, UNCOVERING OR REMOVING SIGNS.
- CONES ALLOWABLE FOR DAYTIME OPERATIONS ONLY.
- LOCATE FLASHING ARROW PANEL AT BEGINNING OF TAPER WHEN FEASIBLE, ARROW PANELS ARE ALWAYS LOCATED BEHIND CHANNELIZERS OR CONES.

○ - FLAGGER
■ ■ ■ ■ ■ ■ ■ ■
CHANNELIZERS



W03-4

(11)

SIGN SETS 1 AND 3 ARE ACTIVE AND (I.E., SIGNS FACE ONCOMING TRAFFIC).

SIGN SETS 2 AND 4 ARE INACTIVE (I.E., SIGNS DO NOT FACE EITHER DIRECTION OF TRAFFIC) WHEN THE RESURFACING OPERATION IS LOCATED BETWEEN SIGN SETS 1 AND 3.

WHEN SIGN SETS 2 AND 4 ARE ACTIVE, SIGN SETS 1 AND 3 BECOME INACTIVE AND ARE ADVANCED TO BECOME SETS 2 AND 4 WITH SIGN LEGENDS TURNED AWAY FROM BOTH DIRECTIONS OF TRAFFIC. WHEN THE RESURFACING OPERATION ADVANCES TO BETWEEN SIGN SET 2 AND 4, SIGN SET 2 AND 4 BECOME ACTIVE (I.E. NEW SIGN SET 1 AND 3) AND SIGN SET 1 AND 3 ADVANCED IN THE DIRECTION OF THE OPERATION (I.E. NEW SIGN SET 2 AND 4).

NOTES:

DAYLIGHT FLAGGING OPERATIONS ONLY.

CHANNELIZING DEVICES LOCATED DOWNSTREAM OF THE ONE-LANE, TWO-WAY TAPER ARE OPTIONAL. THESE DEVICES SHOULD BE ELIMINATED WHEN THEIR USE WILL REDUCE THE USABLE LANE WIDTH, INCLUDING ANY ACCEPTABLE SHOULDERS, TO LESS THAN 10' OR WILL SIGNIFICANTLY AFFECT THE RESURFACING OPERATION.

* NOTE: THIS SIGN IS INSERTED BETWEEN SIGNS 7 & 8 WITH THE SPACING OF 1/2 THE STANDARD SPACING WHEN NO WORK ZONE SPEED LIMIT IS ESTABLISHED.

TRAFFIC CONTROL
SHEET 1 OF 2



DATE PREPARED

8/7/2023

ROUTE

VAR

DISTRICT

KC

COUNTY

JOHNSON

JOB NO.

JKRP0002

CONTRACT ID.

PROJECT NO.

BRIDGE NO.

DESCRIPTION

DATE

MISSOURI HIGHWAYS AND TRANSPORTATION COMMISSION

105 WEST CAPITOL

JEFFERSON CITY, MO 65102

1-888-ASK-MODOT (1-888-275-6636)

IF A SEAL IS PRESENT ON THIS SHEET IT HAS BEEN ELECTRONICALLY SEALED AND DATED.

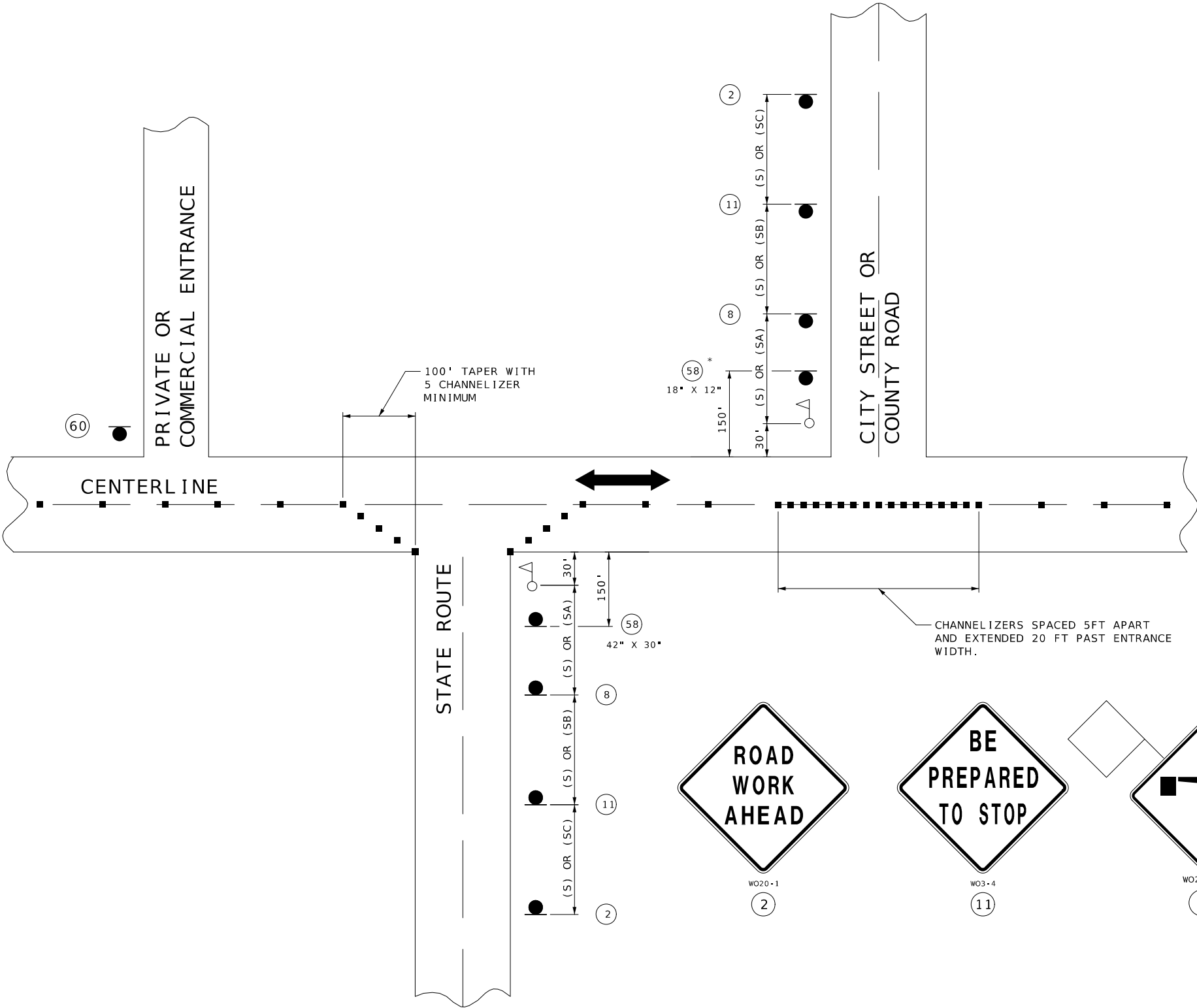

SPEED	SIGN SPACING (FT.)	
	NON-DIVIDED HIGHWAYS (S)	DIVIDED HIGHWAYS (S)
0-35	200	200
40-45	350	500
50-55	500	1000
60-70	1000	(SA)-1000 (SB)-1500 (SC)-2640

DISTANCE MAY BE ADJUSTED ACCORDING TO FIELD CONDITIONS.

NOTES:
WARNING SIGNS SHALL BE ERECTED AT EACH INTERSECTION WITH ANOTHER STATE HIGHWAY WITHIN THE WORK ZONE.

ADDITIONAL WARNING SIGNS SHALL BE ERECTED AT OTHER INTERSECTIONS WITHIN THE WORK ZONE, AS DIRECTED BY THE ENGINEER.

■ - CHANNELIZERS (AS SPECIFIED)

△ - FLAGGER

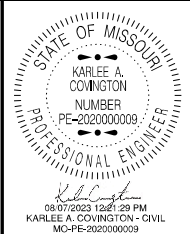

DATE PREPARED 8/7/2023	
ROUTE VAR	STATE MO
DISTRICT KC	SHEET NO. 10
COUNTY JOHNSON	
JOB NO. JKRP0002	
CONTRACT ID.	

PROJECT NO.
BRIDGE NO.

DATE	DESCRIPTION

MISSOURI HIGHWAYS AND TRANSPORTATION COMMISSION



105 WEST CAPITOL
JEFFERSON CITY, MO 65102
1-888-ASK-MODOT (1-888-275-6636)

IF A SEAL IS PRESENT ON THIS SHEET IT HAS BEEN ELECTRONICALLY SEALED AND DATED.

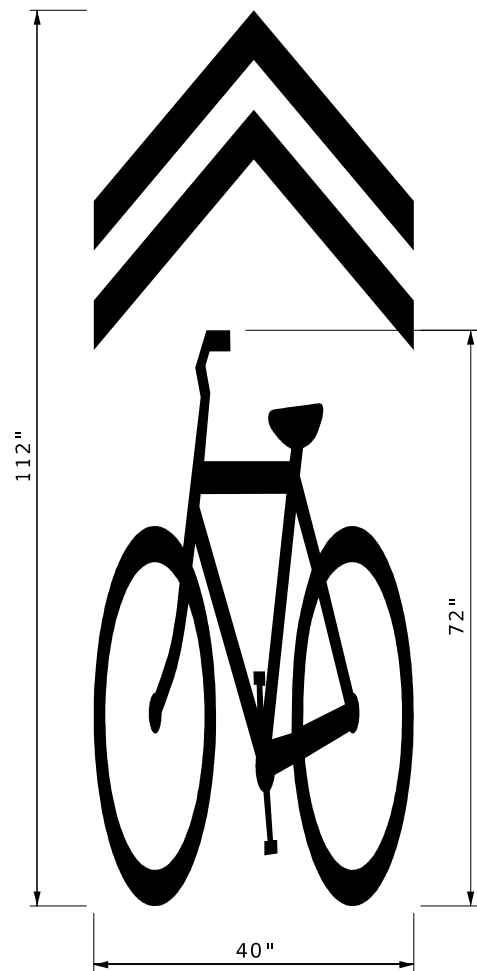

PREFORMED THERMOPLASTIC PAVEMENT MARKING,
SHARE THE ROAD SYMBOL

SOUTHBOUND ONLY



NE 751 AND CLEAR FORK LAKE



SE 10

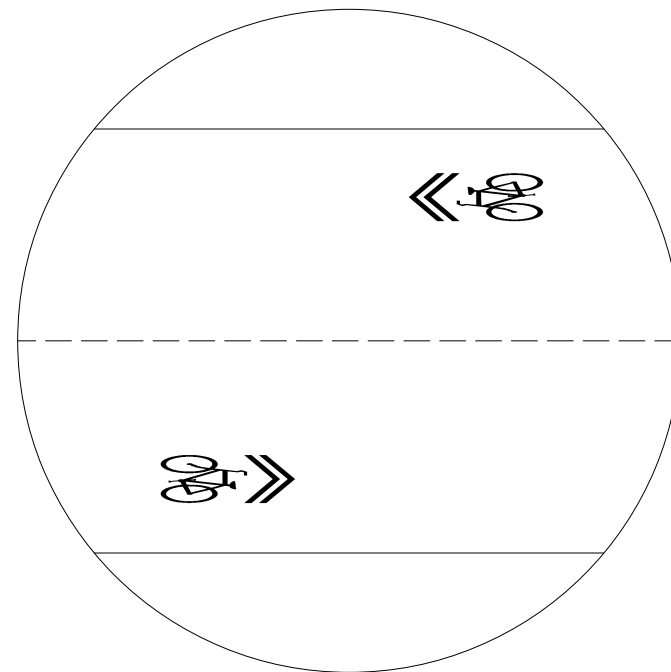

INSTALL SHARE THE ROAD SYMBOL EVERY
250' ON BOTH SIDES OF THE ROAD

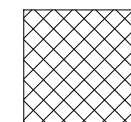

PAVEMENT LIMITS

PAVEMENT MARKING AND PAVEMENT PLAN
SHEET 1 OF 1

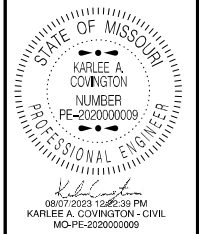

DATE PREPARED
8/7/2023

ROUTE
VAR

STATE
MO

DISTRICT
KC

SHEET NO.
11

COUNTY
JOHNSON

JOB NO.
JKRP0002

CONTRACT ID.

PROJECT NO.

BRIDGE NO.

DATE	DESCRIPTION

MISSOURI HIGHWAYS AND TRANSPORTATION
COMMISSION

105 WEST CAPITOL
JEFFERSON CITY, MO 65102
1-888-ASK-MODOT (1-888-275-6636)

MoDOT

IF A SEAL IS PRESENT ON THIS SHEET IT HAS BEEN ELECTRONICALLY SEALED AND DATED.