

DESIGN DESIGNATION

A.A.D.T. - 2024 = 612
A.A.D.T. - 2044 = 747
D.H.V. = 7.6%
T = 9.8%
V = 35, 45 M.P.H.

FUNCTIONAL CLASSIFICATION - MINOR COLLECTOR

NO NEW RIGHT OF WAY WILL BE
ACQUIRED WITH THIS PROJECT

CONVENTIONAL SYMBOLS
(USED IN PLANS)

	EXISTING	NEW
BUILDINGS AND STRUCTURES		
GUARD RAIL		
GUARD CABLE		
CONCRETE RIGHT-OF-WAY MARKER		
STEEL RIGHT-OF-WAY MARKER		
LOCATION SURVEY MARKER		
UTILITIES		
FIBER OPTICS	-FO-	-FO-
OVERHEAD CABLE TV	-OTV-	-OTV-
UNDERGROUND CABLE TV	-UTV-	-UTV-
OVERHEAD TELEPHONE	-OT-	-OT-
UNDERGROUND TELEPHONE	-UT-	-UT-
OVERHEAD POWER	-OE-	-OE-
UNDERGROUND POWER	-UE-	-UE-
SANITARY SEWER	-S-	-S-
STORM SEWER	-SS-	-SS-
GAS	-G-	-G-
WATER	-W-	-W-
MANHOLE		
FIRE HYDRANT		
WATER VALVE		
WATER METER		
DROP INLET		
DITCH BLOCK		
GROUND MOUNTED SIGN		
LIGHT POLE		
H-FRAME POWER POLE		
TELEPHONE PEDESTAL		
FENCE		
CHAIN LINK		
WOVEN WIRE		
GATE POST		
BENCHMARK		

NOTE: DASHED OR OPEN SYMBOLS INDICATE
EXISTING FEATURES

MISSOURI HIGHWAYS AND TRANSPORTATION COMMISSION
PRELIMINARY PLANS FOR PROPOSED
STATE HIGHWAY
FRANKLIN COUNTY

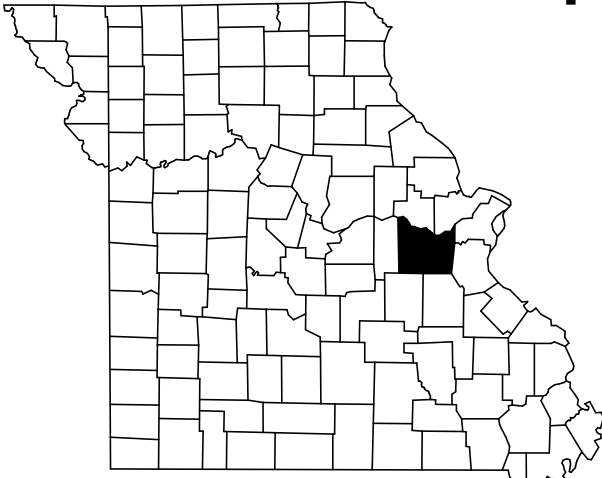

KEY MAP
LOCATION OF FRANKLIN COUNTY

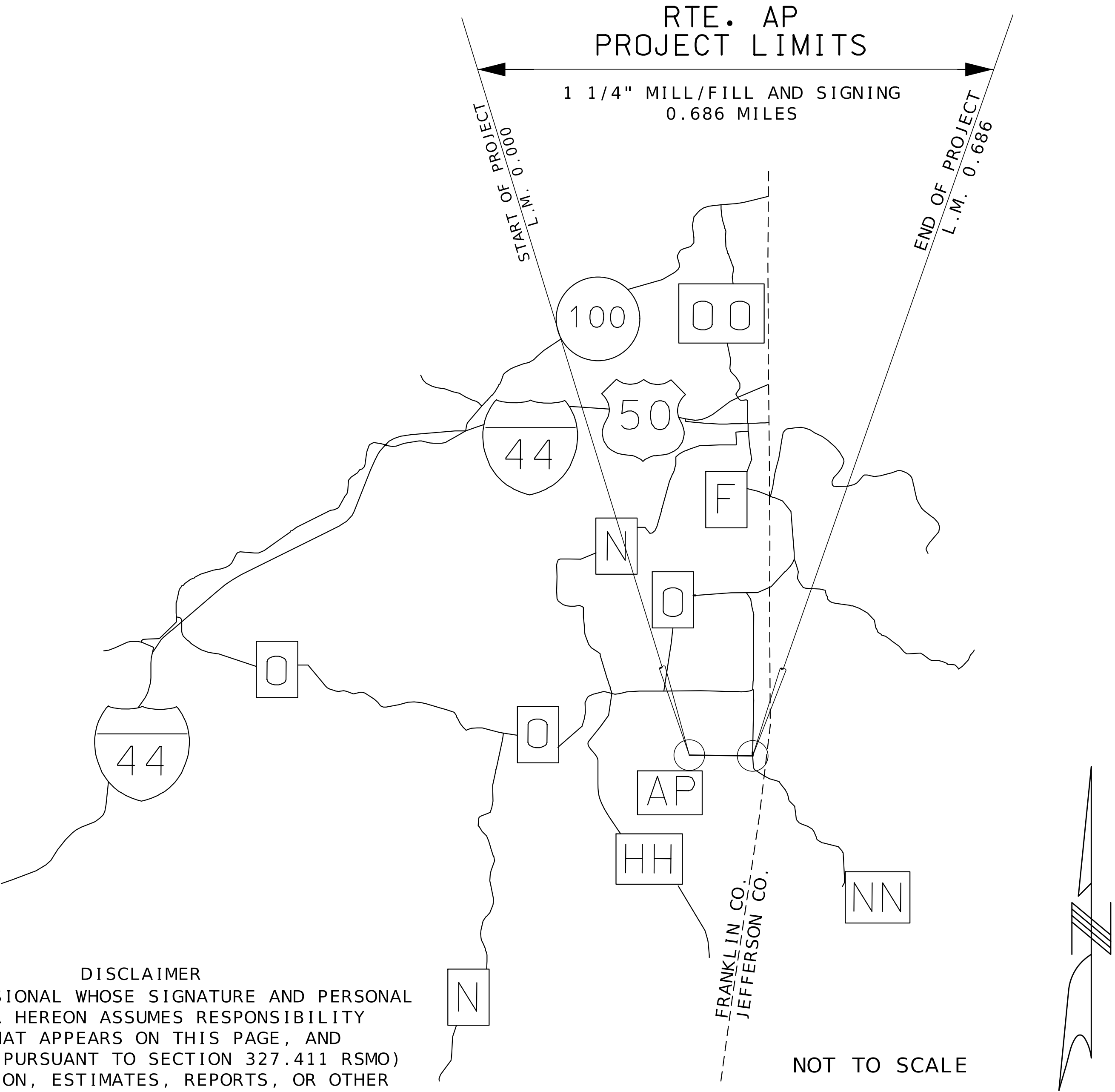

DISCLAIMER
THE PROFESSIONAL WHOSE SIGNATURE AND PERSONAL
SEAL APPEAR HEREON ASSUMES RESPONSIBILITY
ONLY FOR WHAT APPEARS ON THIS PAGE, AND
DISCLAIMS (PURSUANT TO SECTION 327.411 RSMO)
SPECIFICATION, ESTIMATES, REPORTS, OR OTHER
DOCUMENTS OR INSUMENTS NOT SEALED BY THE
UNDERSIGNED PROFESSIONAL RELATING TO OR
INTENDED TO BE USED FOR ANY PART OR PARTS OF
THE PROJECT TO WHICH THIS PAGE REFERS.

THE EXISTENCE AND APPROXIMATE LOCATION OF UTILITY FACILITIES KNOWN TO EXIST, AS SHOWN ON THE PLANS, ARE BASED ON THE BEST INFORMATION AVAILABLE TO THE COMMISSION AT THIS TIME. THIS INFORMATION IS PROVIDED BY THE COMMISSION "AS-IS" AND THE COMMISSION EXPRESSLY DISCLAIMS ANY REPRESENTATION OR WARRANTY AS TO THE COMPLETENESS, ACCURACY, OR SUITABILITY OF THE INFORMATION FOR ANY USE. RELIANCE UPON THIS INFORMATION IS DONE AT THE RISK AND PERIL OF THE USER, AND THE COMMISSION SHALL NOT BE LIABLE FOR ANY DAMAGES THAT MAY ARISE FROM ANY ERROR IN THE INFORMATION. IT IS, THEREFORE, THE RESPONSIBILITY OF THE CONTRACTOR TO VERIFY THE EXISTENCE, LOCATION AND STATUS OF ANY FACILITY. SUCH VERIFICATION INCLUDES DIRECT CONTACT WITH THE LISTED UTILITIES.

INDEX OF SHEETS

DESCRIPTION	SHEET NUMBER
TITLE SHEET -----	1
TYPICAL SECTIONS (TS) (01 SHEETS)--	2
QUANTITIES (QU) (02 SHEETS)-----	3
PLAN-PROFILE (PP)-----	4 - 7
SPECIAL SHEETS (SS)-----	8
TRAFFIC CONTROL SHEETS (TC)-----	9 - 14
SIGNING SHEETS (SN) (02 SHEETS)----	15 - 16

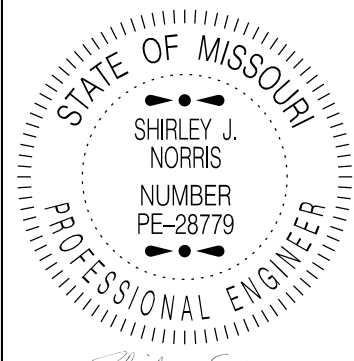

DATE PREPARED 9/12/2023	
ROUTE AP	STATE MO
DISTRICT SL	SHEET NO. 1
COUNTY FRANKLIN	
JOB NO. JSL0031	
CONTRACT ID.	

PROJECT NO.
BRIDGE NO.

DESCRIPTION	DATE

LENGTH OF PROJECT

BEGINNING OF PROJECT	LOG MILE 0.000
END OF PROJECT	LOG MILE 0.686

APPARENT LENGTH 3622.08 FEET

EQUATIONS AND EXCEPTIONS:

TOTAL CORRECTIONS	0.00 FEET
NET LENGTH OF PROJECT	3622.08 FEET
STATE LENGTH	0.686 MILES

FOR INFORMATION ONLY
ESTIMATED DISTURBED ACRES 0.1 ACRES

MISSOURI HIGHWAYS AND TRANSPORTATION COMMISSION

105 WEST CAPITOL
JEFFERSON CITY, MO 65102
1-888-ASK-MODOT (1-888-275-6636)

DISCLAIMER
THE PROFESSIONAL WHOSE SIGNATURE AND PERSONAL SEAL APPEAR HEREON ASSUMES RESPONSIBILITY ONLY FOR WHAT APPEARS ON THIS PAGE, AND DISCLAIMS (PURSUANT TO SECTION 327.411 RSMO) SPECIFICATION, ESTIMATES, REPORTS, OR OTHER DOCUMENTS OR INSTRUMENTS NOT SEALED BY THE UNDERSIGNED PROFESSIONAL RELATING TO OR INTENDED TO BE USED FOR ANY PART OR PARTS OF THE PROJECT TO WHICH THIS PAGE REFERS.

PG-58H-28 (SURFACE LEVELING)	1.94 TON/YD ³
TACK COAT	0.08 GAL/YD ²

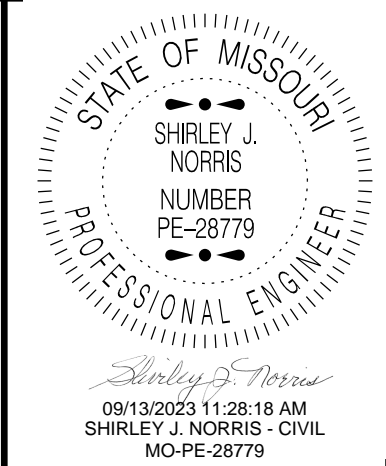

DATE PREPARED 9/12/2023	
ROUTE AP	STATE MO
DISTRICT SL	SHEET NO. 2
COUNTY FRANKLIN	
JOB NO. JSL0031	
CONTRACT ID.	
PROJECT NO.	
BRIDGE NO.	

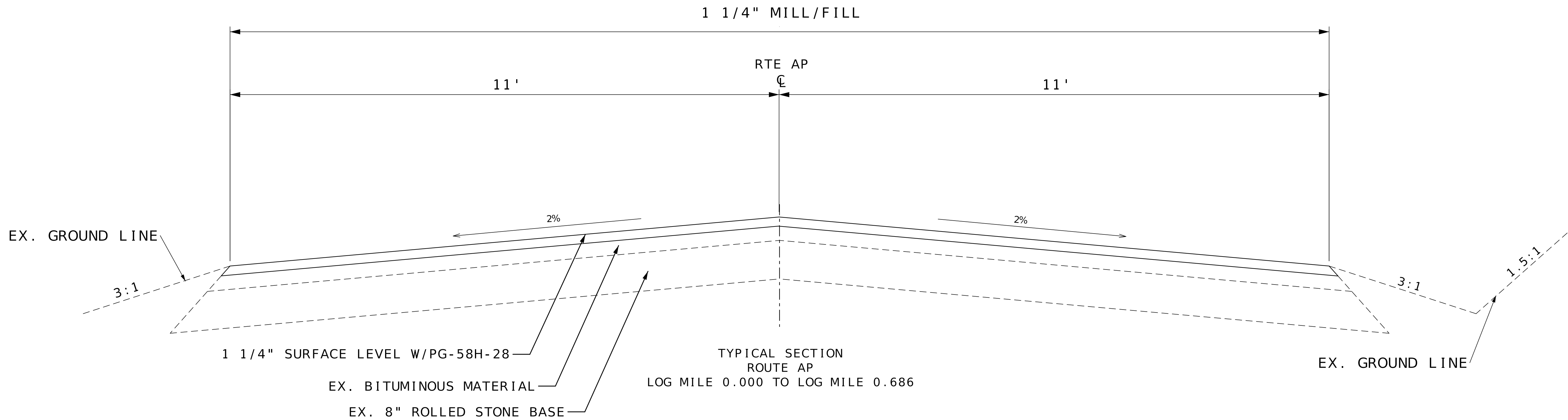

NOT TO SCALE

DATE	DESCRIPTION

MISSOURI HIGHWAYS AND TRANSPORTATION COMMISSION

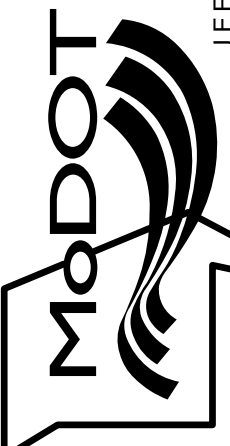

105 WEST CAPITOL
JEFFERSON CITY, MO 65102
1-888-ASK-MODOT (1-888-275-6636)

TYPICAL SECTION
SHEET 1 OF 1

EFFECTIVE: 04-01-2023																						
SIGN	SIZE	AREA	QTY	TOTAL	QTY	TOTAL	SIGN									ITEM	TOTAL					
IN.	SQ. FT.	EACH	SQ. FT.	EACH	SQ. FT.	NUM.	DESCRIPTION								NUMBER	QTY	DESCRIPTION					
WARNING SIGNS							DESCRIPTION								GUIDE SIGNS				DESCRIPTION			
WO1-1L	48X48	16.00					TURN (SYMBOL LEFT ARROW)	E05-1	36X48	12.00						GORE EXIT	6122008		IMPACT ATTENUATOR 40 MPH (SAND BARRELS)			
WO1-1R	48X48	16.00					TURN (SYMBOL RIGHT ARROW)	E05-2	48X36	12.00						EXIT OPEN	6122009		IMPACT ATTENUATOR 45 MPH (SAND BARRELS)			
WO1-2L	48X48	16.00					CURVE (SYMBOL LEFT ARROW)	E05-2a	48X36	12.00						EXIT CLOSED	6122010		IMPACT ATTENUATOR 50 MPH (SAND BARRELS)			
WO1-2R	48X48	16.00					CURVE (SYMBOL RIGHT ARROW)	GO20-1	60X24	10.00					1***	ROAD WORK NEXT 0.7 MILES	6122012		IMPACT ATTENUATOR 55 MPH (SAND BARRELS)			
WO1-3L	48X48	16.00					REVERSE TURN (SYMBOL LEFT ARROW)	GO20-2	48X24	8.00	3	24			26	END ROAD WORK	6122014		IMPACT ATTENUATOR 60 MPH (SAND BARRELS)			
WO1-3R	48X48	16.00					REVERSE TURN (SYMBOL RIGHT ARROW)	GO20-4	36X18	4.50						PILOT CAR FOLLOW ME	6122017		IMPACT ATTENUATOR 65 MPH (SAND BARRELS)			
WO1-4L	48X48	16.00					REVERSE CURVE (SYMBOL LEFT ARROW)	GO20-4a	42X30	8.75						PILOT CAR IN USE WAIT & FOLLOW	6122019		IMPACT ATTENUATOR 70 MPH (SAND BARRELS)			
WO1-4R	48X48	16.00					REVERSE CURVE (SYMBOL RIGHT ARROW)	GO20-4a	18X12	1.50	5	7.5			58	PILOT CAR IN USE WAIT & FOLLOW	6122020		REPLACEMENT SAND BARREL			
WO1-4bL	48X48	16.00					DOUBLE ARROW REVERSE CURVE (SYMBOL LT ARROWS)	GO20-5aP	36X24	6.00						WORK ZONE (PLAQUE)	6122030		IMPACT ATTENUATOR (RELOCATION)			
WO1-4bR	48X48	16.00					DOUBLE ARROW REVERSE CURVE (SYMBOL RT ARROWS)	MO4-8a	24X18	3.00						END DETOUR	6123000A	2*	TRUCK OR TRAILER MOUNTED ATTENUATOR (TMA)			
WO1-4cL	48X48	16.00					TRIPLE ARROW REVERSE CURVE (SYMBOL LT ARROWS)	MO4-9L	48X36	12.00						DETOUR (LEFT ARROW)	6161008	2	ADVANCED WARNING RAIL SYSTEM			
WO1-4cR	48X48	16.00					TRIPLE ARROW REVERSE CURVE (SYMBOL RT ARROWS)	MO4-9R	48X36	12.00						DETOUR (RIGHT ARROW)	6161012		BUOYS (BOATS KEEP OUT)			
WO1-6	60X30	12.50					HORIZONTAL ARROW (SYMBOL)	MO4-9P	48X12	4.00						STREET NAME (PLAQUE)	6161013		BUOYS (NO WAKE)			
WO1-6a	72X36	18.00					HORIZ. ARROW (SYMBOL ON PERMANENT BARRICADE)	MO4-10L	48X18	6.00						DETOUR (ARROW LEFT)	6161014		SPECIAL SIGN ASSEMBLY (BOATS KEEP OUT)			
WO1-7	60X30	12.50					DOUBLE HEAD HORIZONTAL ARROW (SYMBOL)	MO4-10R	48X18	6.00						DETOUR (ARROW RIGHT)	6161025	50	CHANNELIZER (TRIM LINE)			
WO1-7a	72X36	18.00					DOUBLE HEAD HORIZ. ARROW (SYMBOL ON PERM. BARR.)	REGULATORY SIGNS								6161030		TYPE III MOVEABLE BARRICADE				
WO1-8	18X24	3.00					CHEVRON (SYMBOL)	R1-1	48X48	13.25						STOP	6161033		DIRECTION INDICATOR BARRICADE			
WO1-8a	30X36	7.50					CHEVRON (SYMBOL FOR DIVIDED HIGHWAYS)	R1-2	48TRI	6.93						YIELD	6161040	2	FLASHING ARROW PANEL			
WO3-1	48X48	16.00					STOP AHEAD (SYMBOL)	R1-2a	36X36	9.00						TO ONCOMING TRAFFIC (PLAQUE)	6161047		TYPE III OBJECT MARKER			
WO3-2	48X48	16.00					YIELD AHEAD (SYMBOL)	R1-3P	30X12	2.50						ALL WAY (PLAQUE)	6161055		SEQUENTIAL FLASHING WARNING LIGHT			
WO3-3	48X48	16.00					SIGNAL AHEAD (SYMBOL)	R2-1	36X48	12.00						SPEED LIMIT XX	6161070		TUBULAR MARKER			
WO3-4	48X48	16.00	6	96		11	BE PREPARED TO STOP	R3-1	48X48	16.00						NO RIGHT TURN (SYMBOL)	6161095		RADAR SPEED ADVISORY SYSTEM			
WO3-5	48X48	16.00					SPEED LIMIT AHEAD	R3-2	48X48	16.00						NO LEFT TURN (SYMBOL)	6161096		CHANGEABLE MESSAGE SIGN, COMMISSION FURNISHED/RETAINED			
WO4-1L	48X48	16.00					MERGE (SYMBOL FROM LEFT)	R3-3	36X36	9.00						NO TURNS			CHANGEABLE MESSAGE SIGN W/O COMM.			
WO4-1R	48X48	16.00					MERGE (SYMBOL FROM RIGHT)	R3-4	48X48	16.00						NO U-TURN (SYMBOL)	6161098A		INTERFACE - CONTRACTOR FURNISHED/RETAINED			
WO4-1aL	48X48	16.00					MERGE (ARROW SYMBOL)	R3-7L	30X30	6.25						LEFT LANE MUST TURN LEFT			CHANGEABLE MESSAGE SIGN WITH COMM.			
WO4-1aR	48X48	16.00					MERGE (ARROW SYMBOL)	R3-7R	30X30	6.25						RIGHT LANE MUST TURN RIGHT	6161099		INTERFACE - CONTRACTOR FURNISHED/RETAINED			
WO5-1	48X48	16.00					ROAD/BRIDGE/RAMP NARROWS	R4-1	36X48	12.00						DO NOT PASS			WORK ZONE TRAFFIC SIGNAL SYSTEM			
WO5-3	48X48	16.00					ONE LANE BRIDGE	R4-2	36X48	12.00						PASS WITH CARE	6162000A		TEMPORARY LONG-TERM RUMBLE STRIPS			
WO5-5	48X48	16.00					NARROW LANES	R4-8a	36X48	12.00						KEEP LEFT (HORIZONTAL ARROW)	6162002		TEMPORARY SHORT-TERM RUMBLE STRIPS			
WO6-1	48X48	16.00					DIVIDED HIGHWAY (SYMBOL)	R4-7a	36X48	12.00						KEEP RIGHT (HORIZONTAL ARROW)	6162004		NTCIP COMPLIANT CHANGEABLE MESSAGE SIGN (CONTRACTOR FURNISHED/RETAINED)			
WO6-2	48X48	16.00					DIVIDED HIGHWAY END (SYMBOL)	R5-1	30X30	6.25						DO NOT ENTER	6169902	3				
WO6-3	48X48	16.00					TWO WAY TRAFFIC (SYMBOL)	R5-1a	36X24	6.00						WRONG WAY		*				
WO7-3a	30X24	5.00					NEXT XX MILES (PLAQUE)	R6-1L	54X18	6.75						ONE WAY ARROW (LEFT)	6173600D		TEMPORARY TRAFFIC BARRIER			
WO8-1	48X48	16.00					BUMP	R6-1R	54X18	6.75						ONE WAY ARROW (RIGHT)			CONTRACTOR FURNISHED/RETAINED			
WO8-2	48X48	16.00					DIP	R6-2L	24X30	5.00						ONE WAY (LEFT)	6173602B		TEMPORARY TRAFFIC BARRIER			
WO8-3	48X48	16.00					PAVEMENT ENDS	R6-2R	24X30	5.00						ONE WAY (RIGHT)			CONTRACTOR FURNISHED/COMMISSION RETAINED			
WO8-4	48X48	16.00					SOFT SHOULDER	R9-9	24X12	2.00						SIDEWALK CLOSED	6174000A		TEMP. TRAFFIC BARRIER HEIGHT TRANSITION			
WO8-5	48X48	16.00					SLIPPERY WHEN WET (SYMBOL)	R9-11L	24X18	3.00						SIDEWALK CLOSED AHEAD, (ARROW LEFT) CROSS HERE	6175010A		RELOCATING TEMPORARY TRAFFIC BARRIER			
WO8-6	48X48	16.00					TRUCK CROSSING (WITH FLAGS)										SIDEWALK CLOSED AHEAD, (ARROW RIGHT) CROSS HERE	6176000B		TEMPORARY TRAFFIC BARRIER		
WO8-6c	48X48	16.00					TRUCK ENTRANCE	R9-11R	24X18	3.00						STOP HERE ON RED (45° ARROW)	6177000B		COMMISSION FURNISHED/RETAINED			
WO8-7	36X36	9.00					LOOSE GRAVEL	R10-6	24X36	6.00						ROAD CLOSED			TEMPORARY RAISED PAVEMENT MARKER			
WO8-7a	36X36	9.00					FRESH OIL/LOOSE GRAVEL	R11-2	48X30	10.00						ROAD CLOSED XX MILES AHEAD	9029400		TEMPORARY TRAFFIC SIGNALS			
WO8-9	48X48	16.00					LOW SHOULDER	R11-4	60X30	12.50						LOCAL TRAFFIC ONLY	9029401		TEMPORARY TRAFFIC SIGNALS AND LIGHTING			
WO8-11	48X48	16.00	2	32		36	UNEVEN LANES	CONST-3A	60X48	20.00						ROAD CLOSED TO THRU TRAFFIC						
WO8-12	48X48	16.00	2	32		35	NO CENTER LINE	CONST-3X	56X12	4.67						FINE SIGN						
WO8-15	48X48	16.00					GROOVED PAVEMENT	MISCELLANEOUS SIGNS								NOTE:						
WO8-15P	30X24	5.00					MOTORCYCLE (PLAQUE)	CONST-5	48X36	12.00						POINT OF PRESENCE	ALL TRAFFIC CONTROL ITEMS ARE INCLUDED IN PAY ITEM 6169901, TEMPORARY TRAFFIC CONTROL, LUMP SUM, UNLESS OTHERWISE NOTED IN THE PLANS. THESE QUANTITIES ARE ONLY AN ESTIMATE AND ARE SUBJECT TO CHANGE BASED ON FIELD CONDITIONS AND CONTRACTOR'S TRAFFIC CONTROL OPERATIONS.					
WO8-17	48X48	16.00					SHOULDER DROP-OFF (SYMBOL)	CONST-5	96X48	32.00						POINT OF PRESENCE						
WO8-17P	30X24	5.00					SHOULDER DROP-OFF (PLAQUE)	CONST-7	48X24	8.00	3	24			56	RATE OUR WORK ZONE	6169901					
W10-1	42RND.	9.62					RAILROAD CROSSING	CONST-7	72X36	18.00						RATE OUR WORK ZONE						
WO12-1	24X24	4.00					DOUBLE DOWN ARROW (SYMBOL)	CONST-8	48X36	12.00	3	36			59	WORK ZONE NO PHONE ZONE	SIGN AND DEVICE LOCATIONS WILL BE FIELD VERIFIED AND APPROVED BY THE ENGINEER.					
WO12-2	48X48	16.00					LOW CLEARANCE (SYMBOL)															
WO12-2X	24X18	3.00					LOW CLEARANCE (PLAQUE)															

NOTES:
NO DIRECT PAY WILL BE MADE FOR ANY NECESSARY CLEARING AND GRUBBING.

PROJECT LOG MILES ARE BASED ON EB LOG MILES UNLESS OTHERWISE NOTED.

ANY WORK INDICATED ON THE PLANS THAT EXTENDS BEYOND THE PROJECT LIMITS IS CONSIDERED INCIDENTAL TO AND A PART OF THE CONSTRUCTION OF THIS PROJECT.

CONTRACTOR IS RESPONSIBLE FOR LOCATING ALL UNDERGROUND UTILITIES. UTILITIES PLOTTED ARE APPROXIMATE ONLY. IT IS POSSIBLE THERE MAY BE OTHERS WHICH ARE NOT SHOWN ON PLANS.

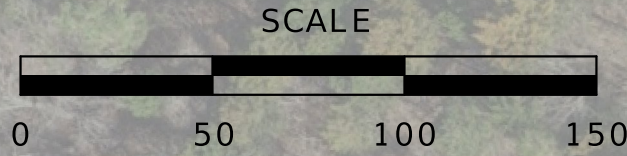

- LEGEND
- 1 1/4" MILL/FILL WITH PG 58H-28 SURFACE TREATMENT
 - ASPHALT MILL/FILL OF SIDE ROADS

- STRIPING LEGEND
- 4" SW = 4" SOLID WHITE
 - 4" DSY = 4" DOUBLE SOLID YELLOW

DISCLAIMER
THE PROFESSIONAL WHOSE SIGNATURE AND PERSONAL SEAL APPEAR HEREON ASSUMES RESPONSIBILITY ONLY FOR WHAT APPEARS ON THIS PAGE, AND DISCLAIMS (PURSUANT TO SECTION 327.411 RSMO) SPECIFICATION, ESTIMATES, REPORTS, OR OTHER DOCUMENTS OR INSTRUMENTS NOT SEALED BY THE UNDERSIGNED PROFESSIONAL RELATING TO OR INTENDED TO BE USED FOR ANY PART OR PARTS OF THE PROJECT TO WHICH THIS PAGE REFERS.

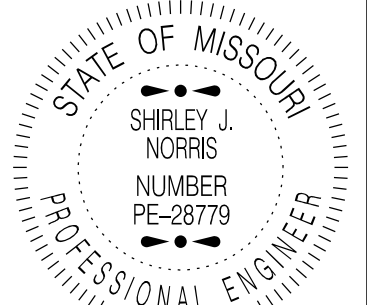

DATE PREPARED
9/12/2023

ROUTE AP STATE MO
DISTRICT SL SHEET NO. 4
COUNTY FRANKLIN

JOB NO.
JSL0031
CONTRACT ID.

PROJECT NO.
BRIDGE NO.

DATE	DESCRIPTION

MISSOURI HIGHWAYS AND TRANSPORTATION COMMISSION

105 WEST CAPITOL
JEFFERSON CITY, MO 65102
1-888-ASK-MODOT (1-888-275-6636)

PLAN SHEET

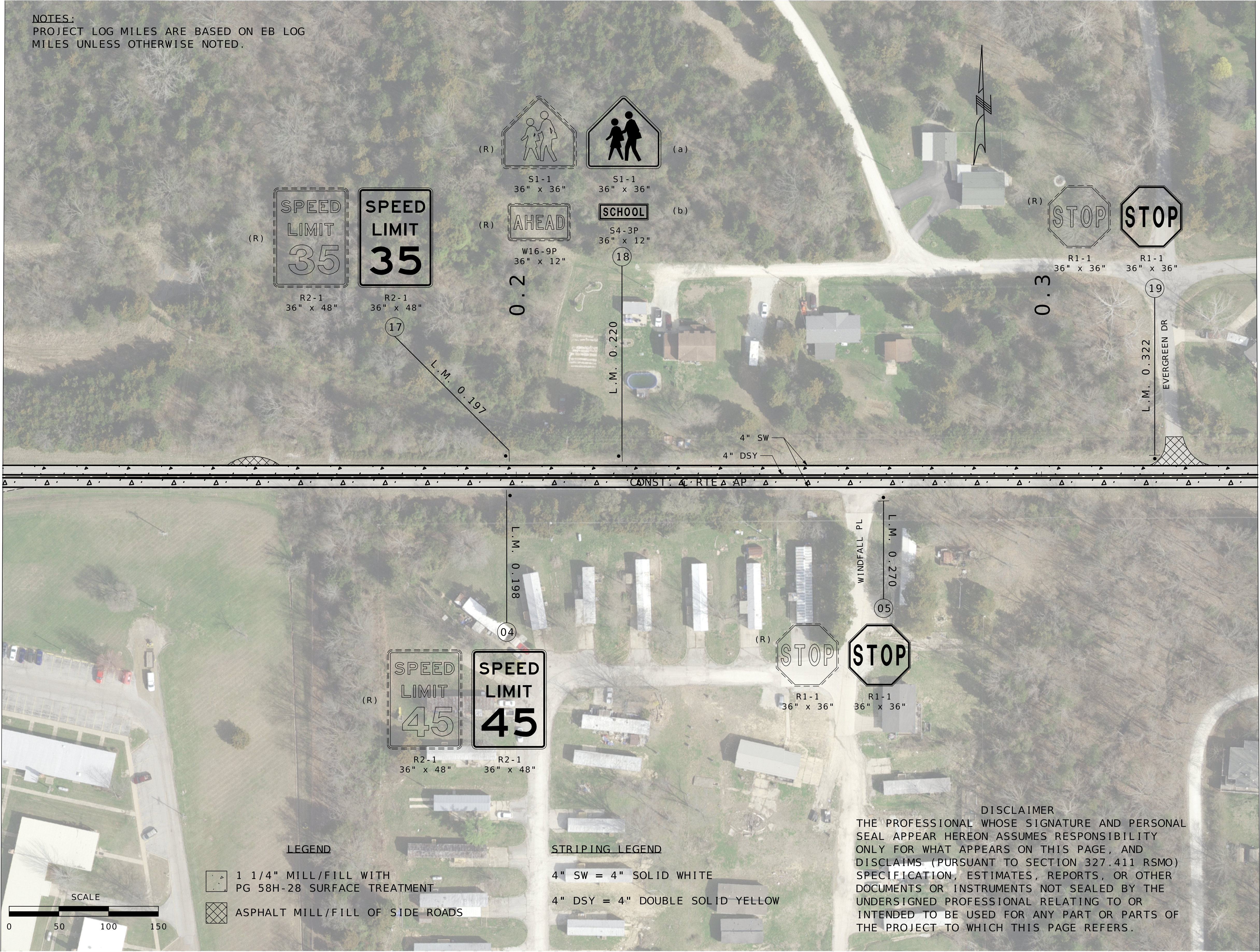

09/13/2023 12:28:39 PM
SHIRLEY J. NORRIS - CIVIL
MO-PE-28779
DATE PREPARED

9/12/2023

ROUTE	STATE
AP	MO
DISTRICT	SHEET NO.
SL	5

COUNTY
FRANKLIN

JOB NO.
JSL0031

CONTRACT ID.

PROJECT NO.

BRIDGE NO.

DATE	DESCRIPTION

MISSOURI HIGHWAYS AND TRANSPORTATION
COMMISSION

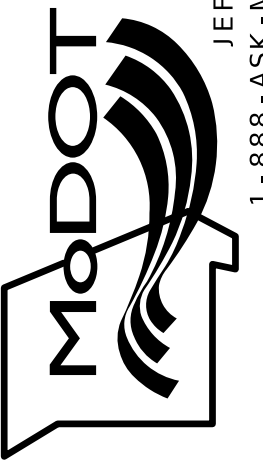

105 WEST CAPITOL
JEFFERSON CITY, MO 65102
1-888-ASK-MODOT (1-888-275-6636)

PLAN SHEET

MATCHLINE L.M. 0.341

MATCHLINE L.M. 0.582

NOTES:
PROJECT LOG MILES ARE BASED ON EB LOG
MILES UNLESS OTHERWISE NOTED.



LEGEND

- 1 1/4" MILL/FILL WITH PG 58H-28 SURFACE TREATMENT
- ASPHALT MILL/FILL OF SIDE ROADS

STRIPING LEGEND

- 4" SW = 4" SOLID WHITE
- 4" DSY = 4" DOUBLE SOLID YELLOW

DISCLAIMER
THE PROFESSIONAL WHOSE SIGNATURE AND PERSONAL
SEAL APPEAR HEREON ASSUMES RESPONSIBILITY
ONLY FOR WHAT APPEARS ON THIS PAGE, AND
DISCLAIMS (PURSUANT TO SECTION 327.411 RSMO)
SPECIFICATION, ESTIMATES, REPORTS, OR OTHER
DOCUMENTS OR INSTRUMENTS NOT SEALED BY THE
UNDERSIGNED PROFESSIONAL RELATING TO OR
INTENDED TO BE USED FOR ANY PART OR PARTS OF
THE PROJECT TO WHICH THIS PAGE REFERS.

STATE OF MISSOURI

SHIRLEY J. NORRIS

NUMBER

PE-28779

PROFESSIONAL ENGINEER

09/13/2023 12:32:20 PM

SHIRLEY J. NORRIS - CIVIL

MO-PE-28779

DATE PREPARED

9/12/2023

ROUTE

AP

DISTRICT

SL

STATE

MO

SHEET NO.

6

COUNTY

FRANKLIN

JOB NO.

JSL0031

CONTRACT ID.

PROJECT NO.

BRIDGE NO.

DATE	DESCRIPTION

MISSOURI HIGHWAYS AND TRANSPORTATION COMMISSION

MoDOT

105 WEST CAPITOL

JEFFERSON CITY, MO 65102

1-888-ASK-MODOT (1-888-275-6636)

PLAN SHEET

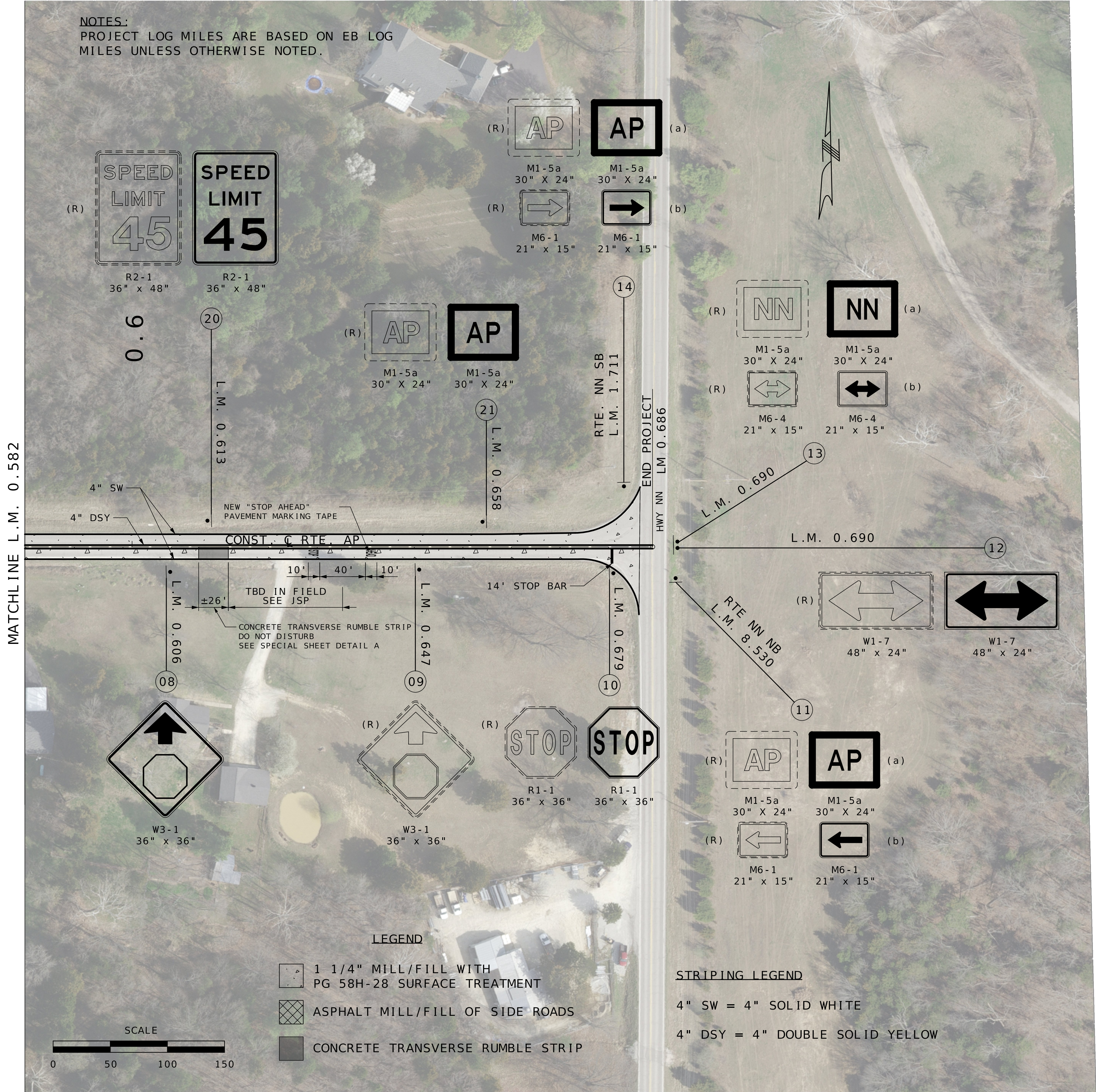

STATE OF MISSOURI

SHIRLEY J. NORRIS

NUMBER PE-28779

PROFESSIONAL ENGINEER

09/13/2023 12:35:28 PM

SHIRLEY J. NORRIS - CIVIL

MO-PE-28779

DATE PREPARED
9/12/2023

ROUTE
AP

STATE
MO

DISTRICT
SL

SHEET NO.
7

COUNTY
FRANKLIN

JOB NO.
JSL0031

CONTRACT ID.

PROJECT NO.

BRIDGE NO.

DATE	DESCRIPTION

MISSOURI HIGHWAYS AND TRANSPORTATION COMMISSION

105 WEST CAPITOL

JEFFERSON CITY, MO 65102

1-888-ASK-MODOT (1-888-275-6636)

PLAN SHEET

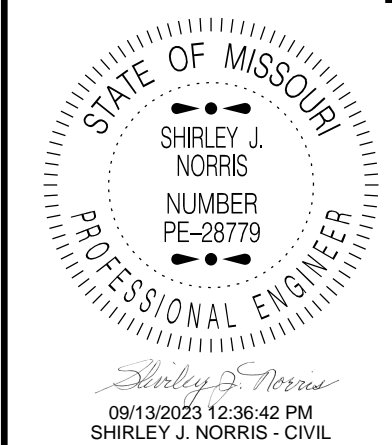

DATE PREPARED 9/12/2023	
ROUTE AP	STATE MO
DISTRICT SL	SHEET NO. 8
COUNTY FRANKLIN	
JOB NO. SL0031	
CONTRACT ID.	
PROJECT NO.	
BRIDGE NO.	

DESCRIPTION	DATE

MISSOURI HIGHWAYS AND TRANSPORTATION COMMISSION

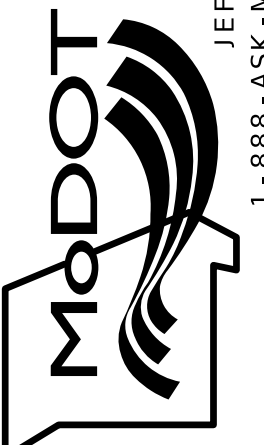

105 WEST CAPITOL
JEFFERSON CITY, MO 65102
1-888-ASK-MODOT (1-888-275-6636)

SPECIAL SHEET
PAVEMENT
TRANSITION DETAILS
SHEET 1 OF 1

DISCLAIMER
THE PROFESSIONAL WHOSE SIGNATURE AND PERSONAL SEAL APPEAR HEREON ASSUMES RESPONSIBILITY ONLY FOR WHAT APPEARS ON THIS PAGE, AND DISCLAIMS (PURSUANT TO SECTION 327.411 RSMO) SPECIFICATION, ESTIMATES, REPORTS, OR OTHER DOCUMENTS OR INSUMENTS NOT SEALED BY THE UNDERSIGNED PROFESSIONAL RELATING TO OR INTENDED TO BE USED FOR ANY PART OR PARTS OF THE PROJECT TO WHICH THIS PAGE REFERS.

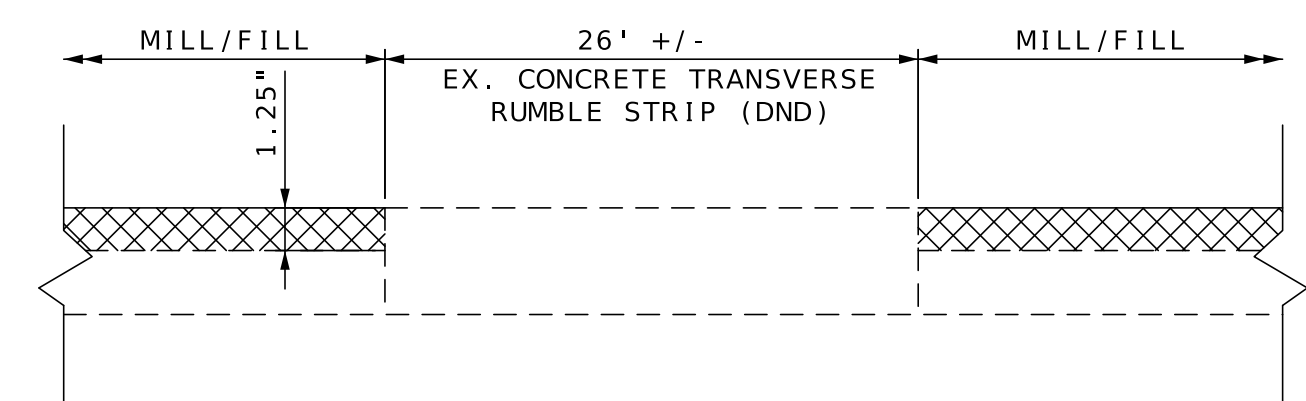

CONCRETE TRANSVERSE
RUMBLE STRIP TYP. DETAIL
RUMBLE STRIP IS APPROX. 26' LONG BY LANE WIDTH WIDE
FIELD VERIFY PRIOR TO WORK
DO NOT DISTURB
DETAIL A

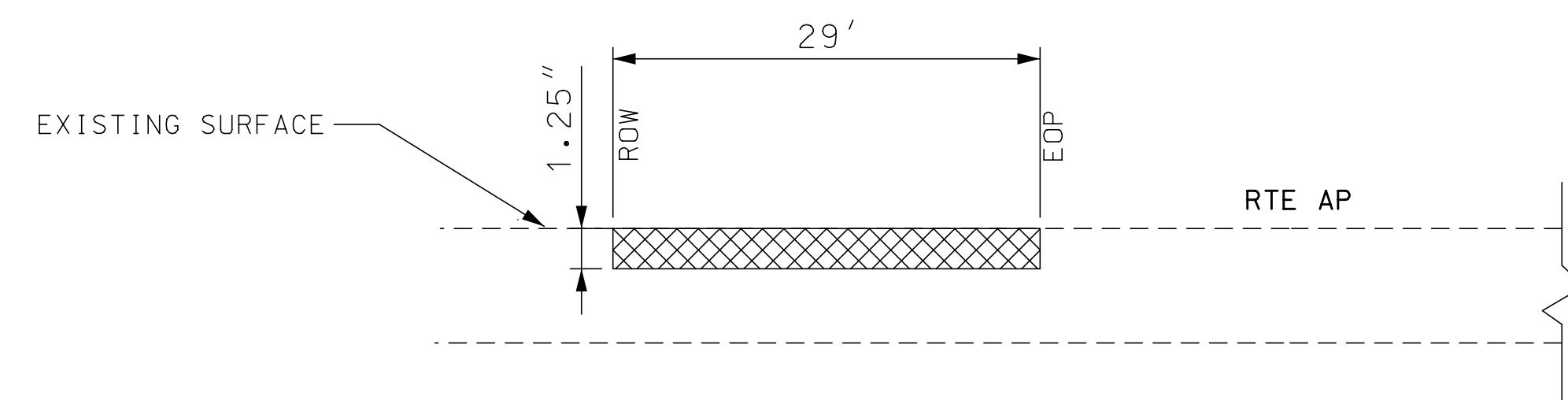
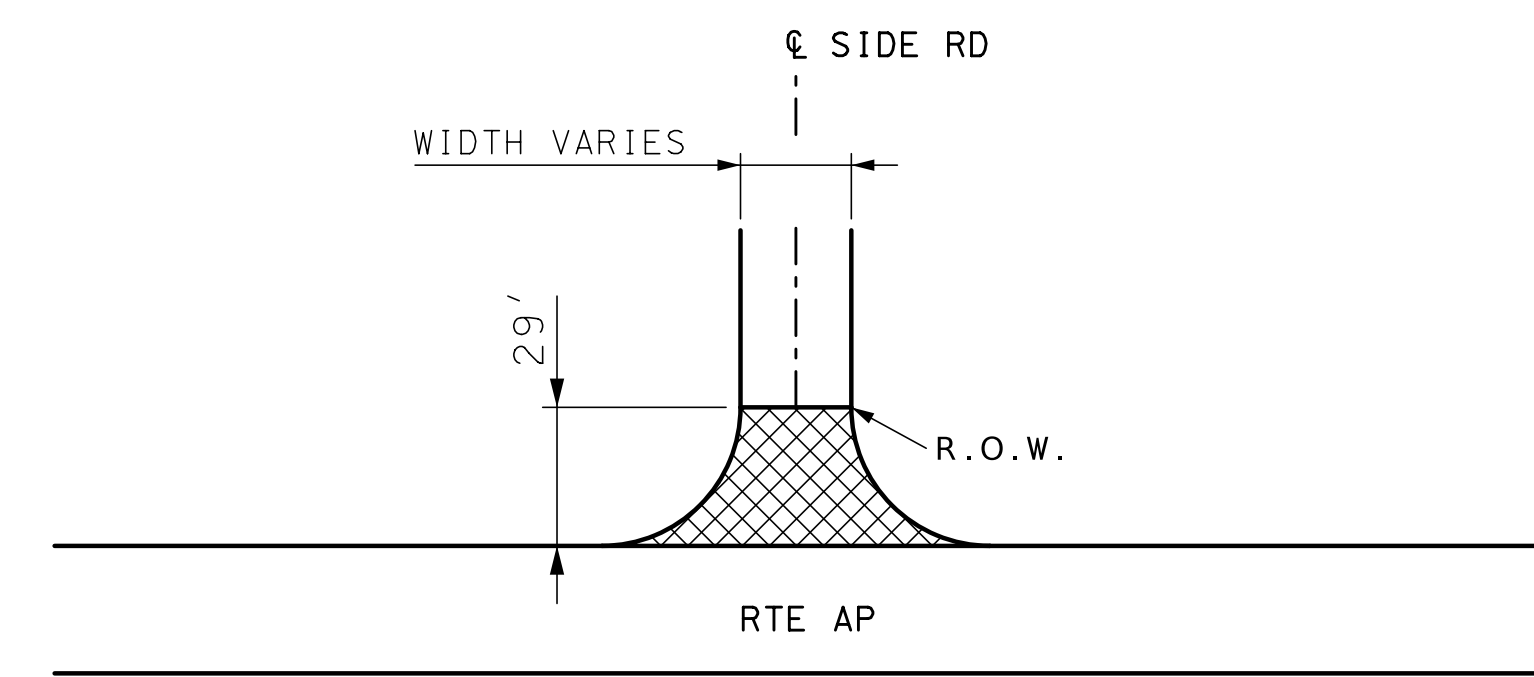

TYPICAL SIDE ROAD
AND ASPHALT ENTRANCES
DETAIL B

NOT TO SCALE



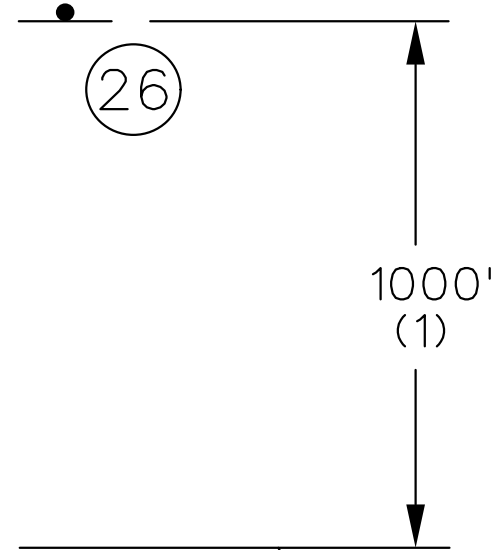
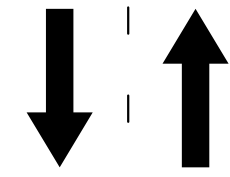
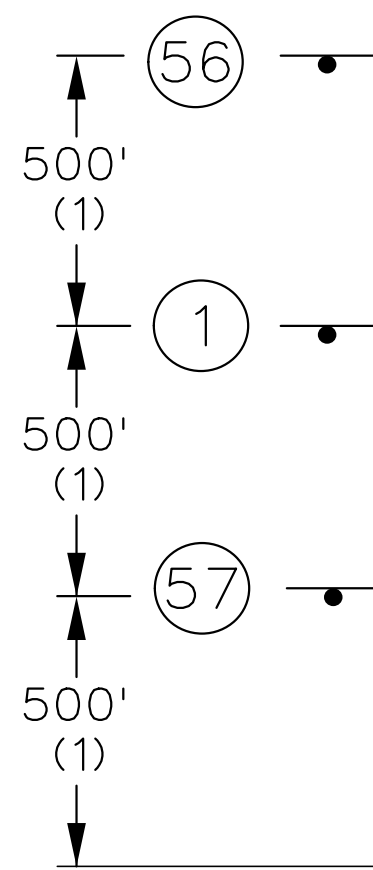

DISCLAIMER
THE PROFESSIONAL WHOSE SIGNATURE AND PERSONAL SEAL APPEAR HEREON ASSUMES RESPONSIBILITY ONLY FOR WHAT APPEARS ON THIS PAGE, AND DISCLAIMS (PURSUANT TO SECTION 327.411 RSMO) SPECIFICATION, ESTIMATES, REPORTS, OR OTHER DOCUMENTS OR INSUMENTS NOT SEALED BY THE UNDERSIGNED PROFESSIONAL RELATING TO OR INTENDED TO BE USED FOR ANY PART OR PARTS OF THE PROJECT TO WHICH THIS PAGE REFERS.

END OF PROJECT LIMITS; END OF WORK ZONE TERMINATION AREA, IF LOCATED BEYOND END OF PROJECT; OR LAST WORK ZONE SIGN, IF LOCATED OUTSIDE PROJECT LIMITS.

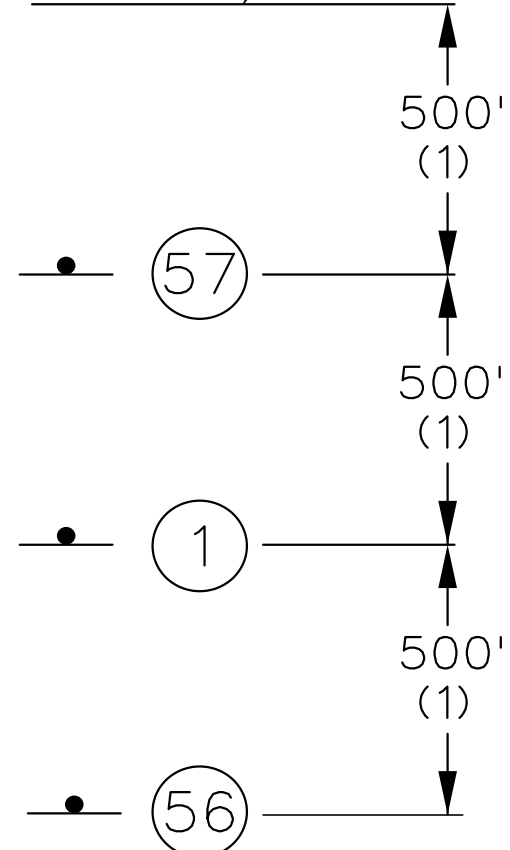
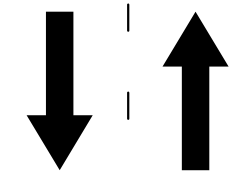
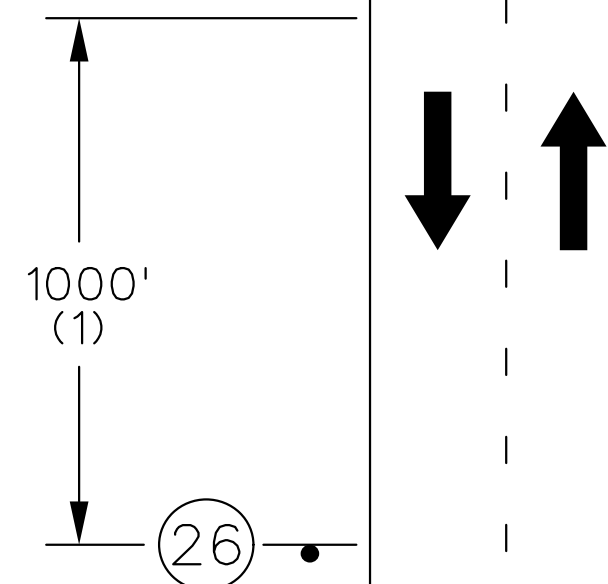
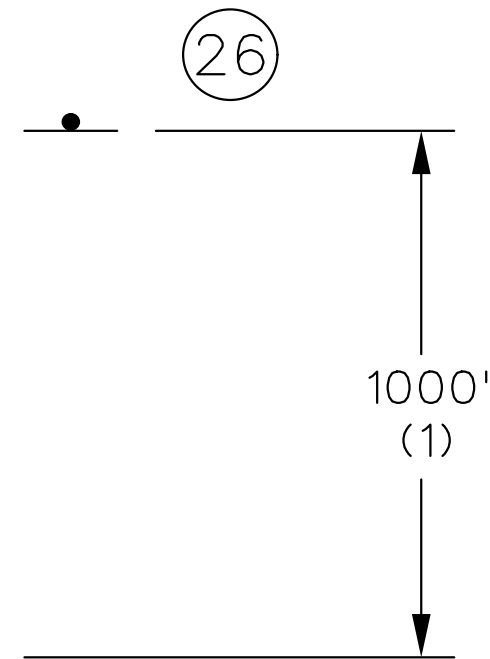
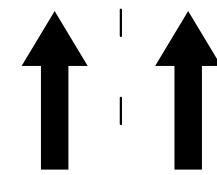
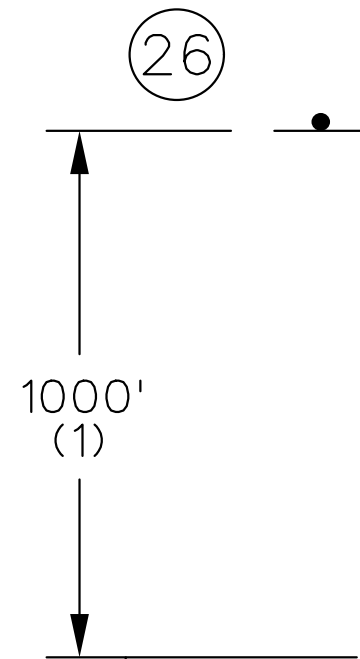

BEGINNING OF PROJECT LIMITS; OR INITIAL WORK ZONE SIGN, IF LOCATED OUTSIDE PROJECT LIMITS.

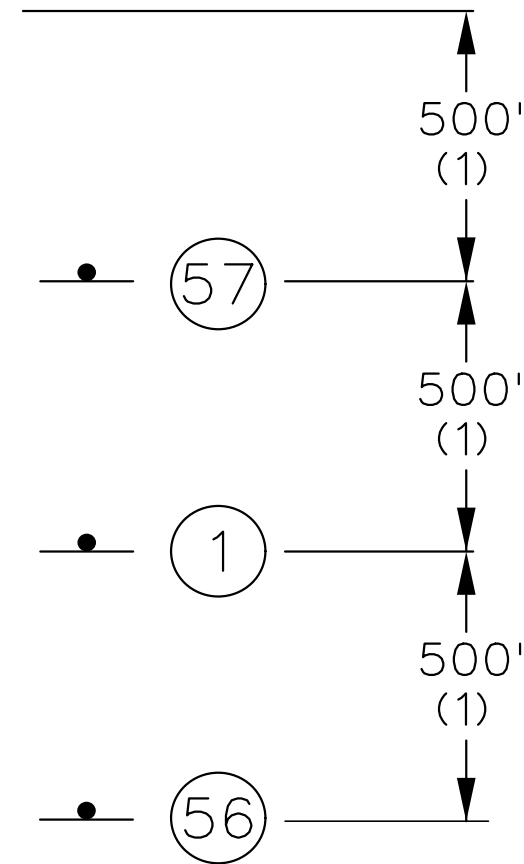
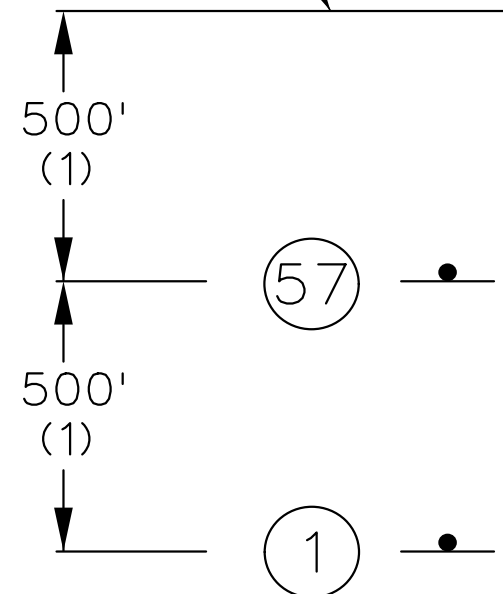

- NOTES:
SIGN G020-1 IS REQUIRED PER EPG 616.6.56.
SIGN G020-2 IS USED ON ALL PROJECTS WHERE SIGN G020-1 IS USED.
- OTHER SIGNS SUCH AS DETOUR OR ALTERNATE ROUTE SIGNING MAY BE USED OUTSIDE THE PROJECT LIMITS.
- ANY EXISTING SIGNING THAT CONFLICTS WITH THE TRAFFIC CONTROL SIGNING SHALL BE COMPLETELY COVERED OR REMOVED.
- (1) DISTANCE MAY BE ADJUSTED ACCORDING TO FIELD CONDITIONS. WHERE TRAFFIC BACKUPS ARE EXPECTED BEYOND THE ADVANCE WARNING AREA, ADDITIONAL SIGNING MAY BE NEEDED.
- (2) SIGN CONST-7-72 OR CONST-7-48 IS PLACED 500 FEET BEFORE THE BEGINNING OF PROJECT LIMITS OR THE ROAD WORK AHEAD SIGN OR ROAD WORK NEXT XX MILES SIGN. IF USED, WHEN THESE SIGNS ARE LOCATED OUTSIDE THE PROJECT LIMITS.
- (3) CONST-5-96 OR CONST-5-48 SIGN IS PLACED IN A VISIBLE AREA WITHIN THE PROJECT LIMITS PROVIDED ITS PLACEMENT DOES NOT DISRUPT A SEQUENCE OF SIGNS. IF A VISIBLE LOCATION WITHIN THE PROJECT IS NOT AVAILABLE, THE SIGN MAY BE PLACED 500 FEET BEFORE SIGN CONST-7-72 OR CONST-7-48.
- (4) THE "RATE OUR WORK ZONE" SIGN IS AVAILABLE IN TWO SIZES DEPENDING ON ROADWAY CONDITIONS. THE 48 IN. X 24 IN. SIGN IS USED ON LOW VOLUME ROUTES THAT CARRY 400 AADT OR LESS, ON PROJECTS THAT HAVE A DURATION OF 4 WEEKS OR LESS OR IN URBAN AREAS WHERE THERE IS INSUFFICIENT RIGHT OF WAY FOR A SIX FOOT WIDE SIGN. THE 72 IN. X 36 IN. VERSION OF THE SIGN IS USED IN ALL OTHER APPLICATIONS, BUT CAN ALSO BE USED IN PLACE OF THE 48 IN. X 24 IN. SIGN IF ADDED EMPHASIS IS DEEMED NECESSARY.
- (5) THE "WORK ZONE NO PHONE ZONE" SIGN IS PLACED A MINIMUM OF 500 FEET BEFORE THE ROAD WORK AHEAD SIGN.



G020-1
(1)

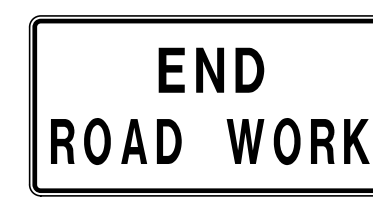

G020-2
(26)



SPECIAL (5)
(57)

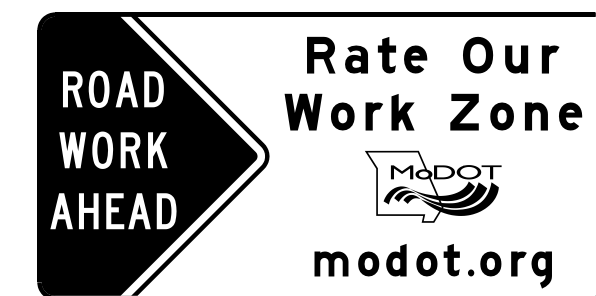

CONST-7-72 (2)
CONST-7-48 (2)(4)
(56)

TWO-LANE UNDIVIDED

BEGIN/END OF PROJECT SIGNING
(FOR USE ON ALL PROJECTS)

MULTI-LANE DIVIDED



DATE PREPARED 9/12/2023	
ROUTE AP	STATE MO
DISTRICT SL	SHEET NO. 9
COUNTY FRANKLIN	
JOB NO. JSL0031	
CONTRACT ID.	
PROJECT NO.	
BRIDGE NO.	

DESCRIPTION	DATE

MISSOURI HIGHWAYS AND TRANSPORTATION COMMISSION

105 WEST CAPITOL
JEFFERSON CITY, MO 65102
1-888-ASK-MODOT (1-888-275-6636)

TRAFFIC CONTROL SHEET
BEGIN/END OF
PROJECT SIGNING
SHEET 1 OF 6

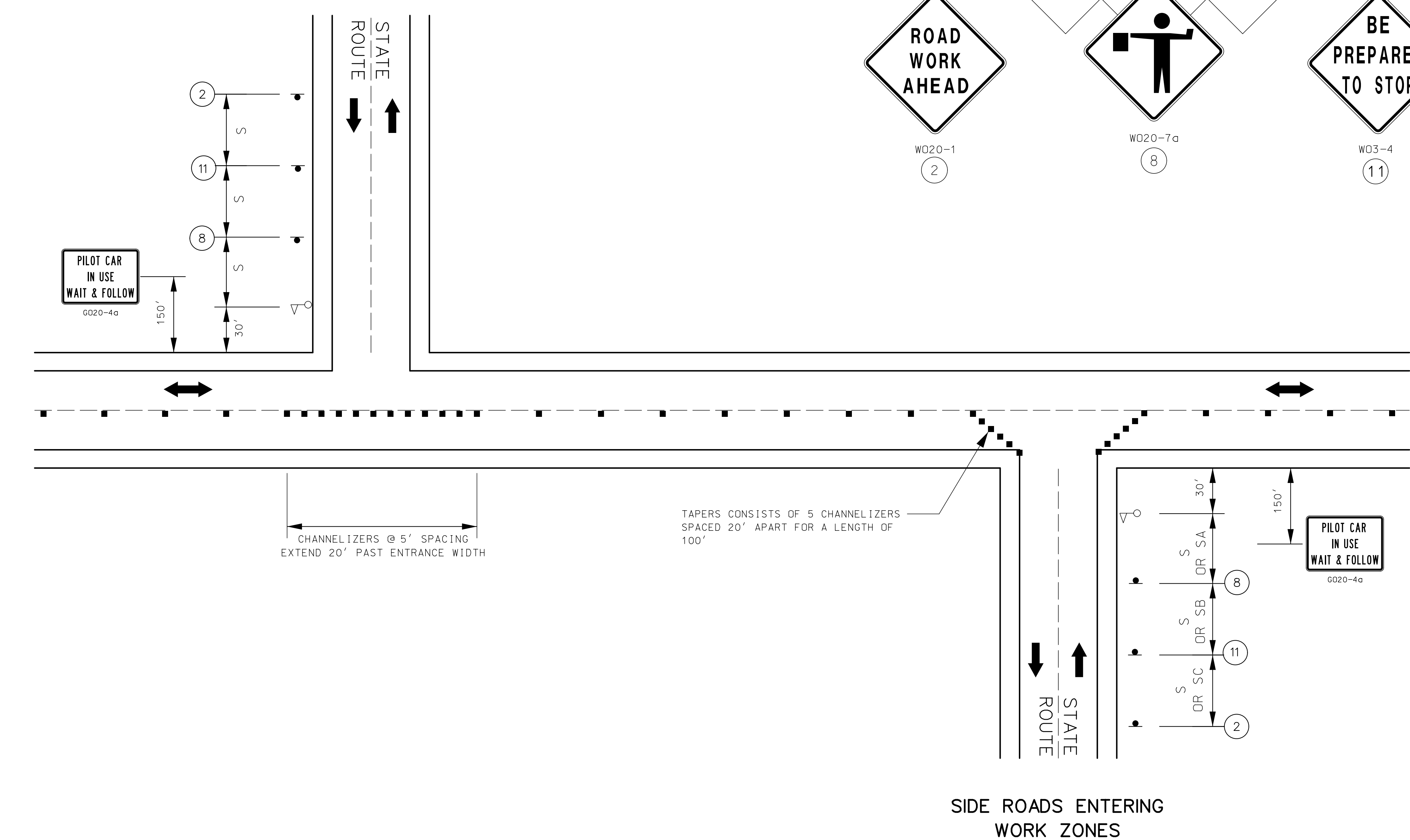

NOTES:

ADDITIONAL WARNING SIGNS SHALL BE ERECTED AT EACH INTERSECTION WITH ANOTHER STATE HIGHWAY WITHIN THE WORK ZONE. GUIDANCE MAY RANGE FROM A ROAD WORK AHEAD SIGN, A FLAGGER AT AN INTERSECTION, OR USE OF A PILOT CAR.

UPON THE DISCRETION OF THE ENGINEER, ADDITIONAL WARNING SIGNS MAY BE ERECTED AT OTHER INTERSECTIONS WITHIN THE WORK ZONE.

DISCLAIMER

THE PROFESSIONAL WHOSE SIGNATURE AND PERSONAL SEAL APPEAR HEREON ASSUMES RESPONSIBILITY ONLY FOR WHAT APPEARS ON THIS PAGE, AND DISCLAIMS (PURSUANT TO SECTION 327.411 RSMO) SPECIFICATION, ESTIMATES, REPORTS, OR OTHER DOCUMENTS OR INSUMENTS NOT SEALED BY THE UNDERSIGNED PROFESSIONAL RELATING TO OR INTENDED TO BE USED FOR ANY PART OR PARTS OF THE PROJECT TO WHICH THIS PAGE REFERS.

TRAFFIC CONTROL LEGEND

- SIGN (SINGLE SIDED)
- CHANNELIZER (TRIM-LINE)
- △ FLAGGER

SPEED	SIGN SPACING (ft.)	
PERM. POSTED (MPH)	UNDIVIDED (S)	DIVIDED (S)
0-35	200	200
40-45	350	500
50-55	500	1000
60-70	1000	SA-1000 SB-1500 SC-2640

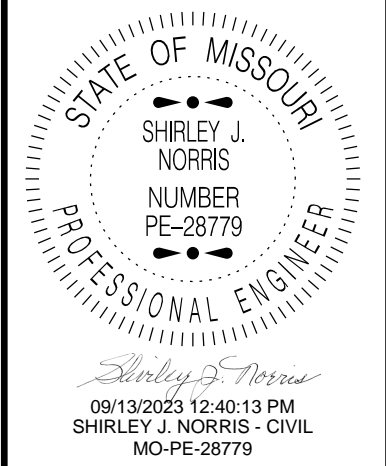

DATE PREPARED 9/12/2023	
ROUTE AP	STATE MO
DISTRICT SL	SHEET NO. 10
COUNTY FRANKLIN	
JOB NO. JSL0031	
CONTRACT ID.	
PROJECT NO.	
BRIDGE NO.	

DESCRIPTION	DATE

MISSOURI HIGHWAYS AND TRANSPORTATION COMMISSION

105 WEST CAPITOL
JEFFERSON CITY, MO 65102
1-888-ASK-MODOT (1-888-275-6636)

MoDOT

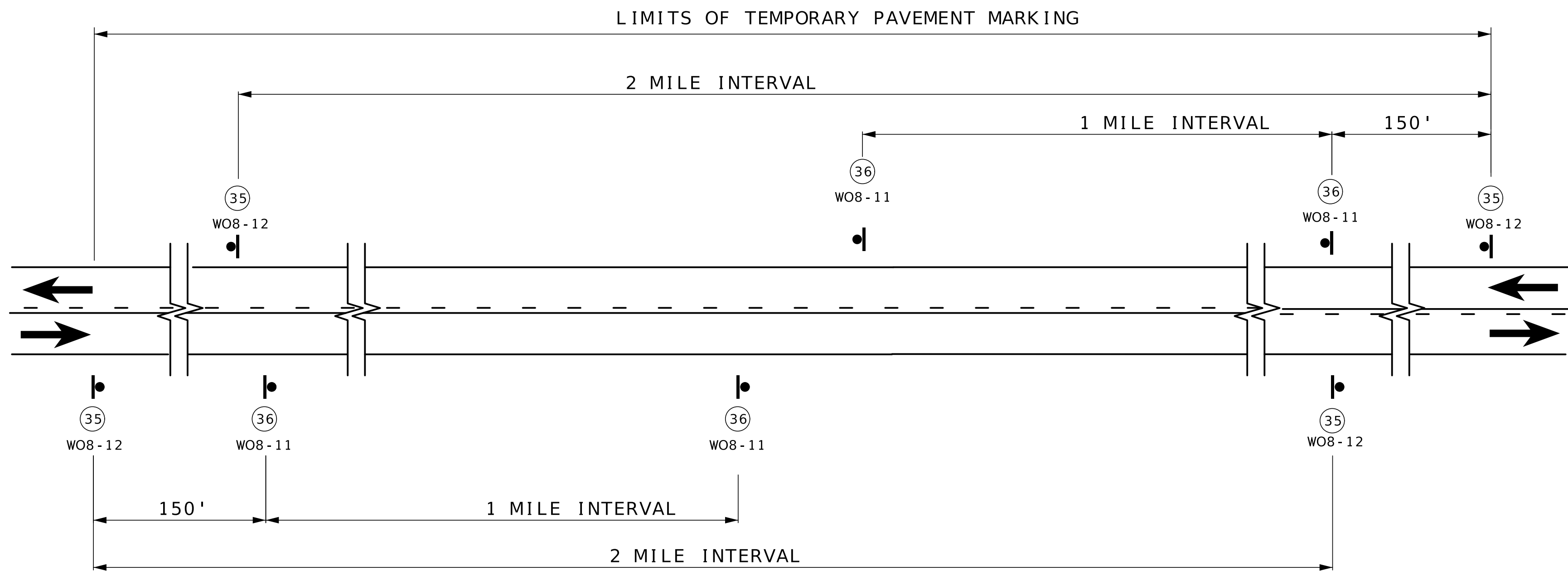

SIGN SPACING AND TEMPORARY STRIPING FOR MAINLINE

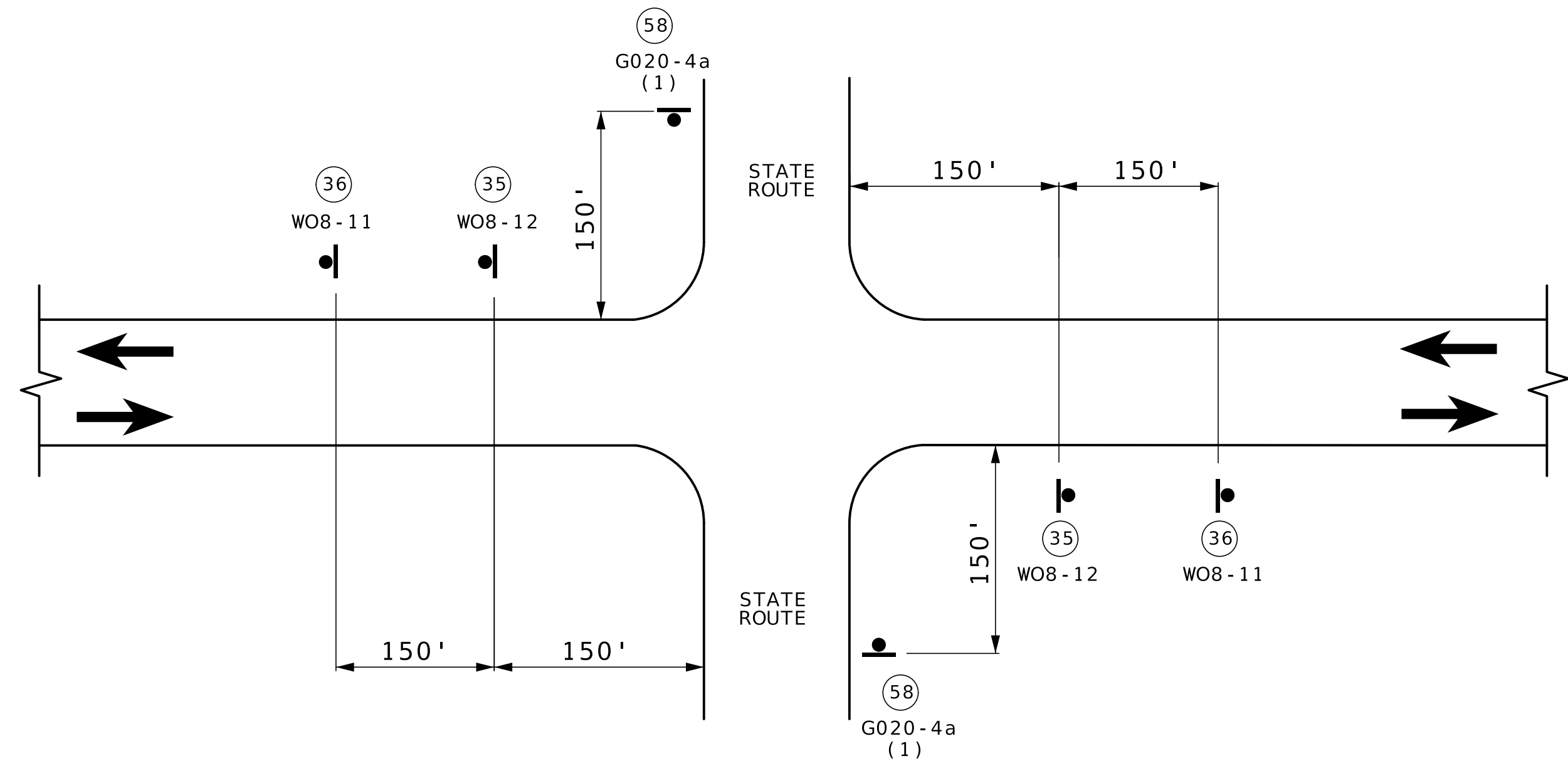

SIGN SPACING AT STATE ROUTE INTERSECTIONS
SHOWING TEMPORARY STRIPING FOR MAINLINE

(1) ADDITIONAL SIDEROADS MAY BE SIGNED AS APPROVED BY THE ENGINEER.

NOT TO SCALE

DISCLAIMER
THE PROFESSIONAL WHOSE SIGNATURE AND PERSONAL SEAL APPEAR HEREON ASSUMES RESPONSIBILITY ONLY FOR WHAT APPEARS ON THIS PAGE, AND DISCLAIMS (PURSUANT TO SECTION 327.411 RSMO) SPECIFICATION, ESTIMATES, REPORTS, OR OTHER DOCUMENTS OR INSUMENTS NOT SEALED BY THE UNDERSIGNED PROFESSIONAL RELATING TO OR INTENDED TO BE USED FOR ANY PART OR PARTS OF THE PROJECT TO WHICH THIS PAGE REFERS.



NOTES:
SIGN (35) AND TEMPORARY RAISED PAVEMENT MARKING (SEE STANDARD PLAN 620.10) INSTALLED WHERE CENTERLINE STRIPING HAS BEEN COVERED OR REMOVED. SIGNS ARE TO REMAIN IN PLACE UNTIL THE PERMANENT CENTERLINE PAVEMENT MARKINGS ARE IN PLACE. SIGNS SHALL BE COVERED OR REMOVED WHEN PAVEMENT CENTERLINE MARKING HAS BEEN INSTALLED.
SIGN (35) IS PLACED AT APPROXIMATELY TWO-MILE INTERVALS AND AT STATE ROUTE JUNCTIONS. WHEN THE INSTALLATION AT A JUNCTION IS WITHIN ONE-EIGHTH MILE OF THE NORMAL MAINLINE SIGN (35), THE LATTER MAY BE ELIMINATED.
ALL SIGNS SHALL BE POST MOUNTED AND IN ACCORDANCE WITH STANDARD PLAN 616.10 AND 903.03.

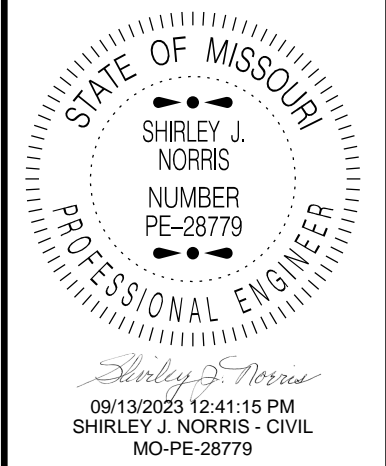

DATE PREPARED 9/12/2023	
ROUTE AP	STATE MO
DISTRICT SL	SHEET NO. 11
COUNTY FRANKLIN	
JOB NO. JSL0031	
CONTRACT ID.	
PROJECT NO.	
BRIDGE NO.	

DESCRIPTION	DATE

MISSOURI HIGHWAYS AND TRANSPORTATION COMMISSION	105 WEST CAPITOL JEFFERSON CITY, MO 65102 1-888-ASK-MODOT (1-888-275-6636)
---	--

TRAFFIC CONTROL SHEET
UNEVEN LANE SIGNING
FOR WORKZONE
SHEET 3 OF 6

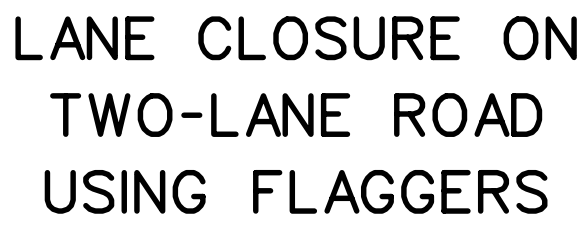

SPEED	SIGN SPACING (ft.)		TAPER LENGTH (ft.)		OPTIONAL	CHANNELIZER SPACING (ft.)	
PERM. POSTED (MPH)	UNDIVIDED (S)	DIVIDED (S)	SHOULDER (1) (T1)	LANE (2) (T2)	BUFFER LENGTH (ft) (B)	TAPERS	BUFFER/ WORK AREAS
0-35	200	—	—	—	280	—	40
40-45	350	—	—	—	400	—	80

1. Shoulder taper length based on 10 ft. (standard shoulder width) offset.
2. Lane taper length based on 12 ft. (standard lane width) offset.

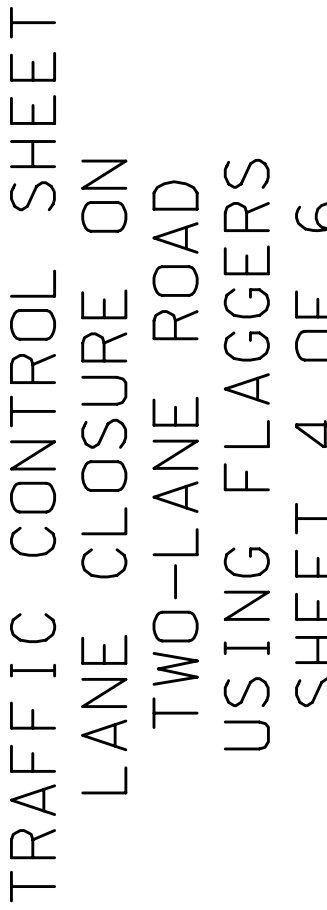



W020-1
(2)

WO20-4
7

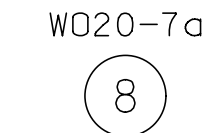

W03-4

(11)



DISCLAIMER

THE PROFESSIONAL WHOSE SIGNATURE AND PERSONAL SEAL APPEAR HEREON ASSUMES RESPONSIBILITY ONLY FOR WHAT APPEARS ON THIS PAGE, AND DISCLAIMS (PURSUANT TO SECTION 327.411 RSMO) SPECIFICATION, ESTIMATES, REPORTS, OR OTHER DOCUMENTS OR INSTRUMENTS NOT SEALED BY THE UNDERSIGNED PROFESSIONAL RELATING TO OR INTENDED TO BE USED FOR ANY PART OR PARTS OF THE PROJECT TO WHICH THIS PAGE REFERS.

IF RUMBLE STRIPS ARE USED, REVIEW 616.6.87 RUMBLE STRIPS.

SPEED	SIGN SPACING (ft.)		TAPER LENGTH (ft.)		OPTIONAL	CHANNELIZER SPACING (ft.)	
PERM. POSTED (MPH)	UNDIVIDED (S)	DIVIDED (S)	SHOULDER (1) (T1)	LANE (2) (T2)	BUFFER LENGTH (ft) (B)	TAPERS	BUFFER/ WORK AREAS
0-35	200	—	—	—	—	—	—
40-45	350	—	—	—	—	—	—
1. Shoulder taper length based on 10 ft. (standard shoulder width) offset. 2. Lane taper length based on 12 ft. (standard lane width) offset.							

TRAFFIC CONTROL SHEET
MOBILE OPERATION
ON TWO-LANE HIGHWAYS
SHEET 5 OF 6

NOT TO SCALE

CENTER LINE / EDGE LINE STRIPING ON TWO-LANE HIGHWAYS

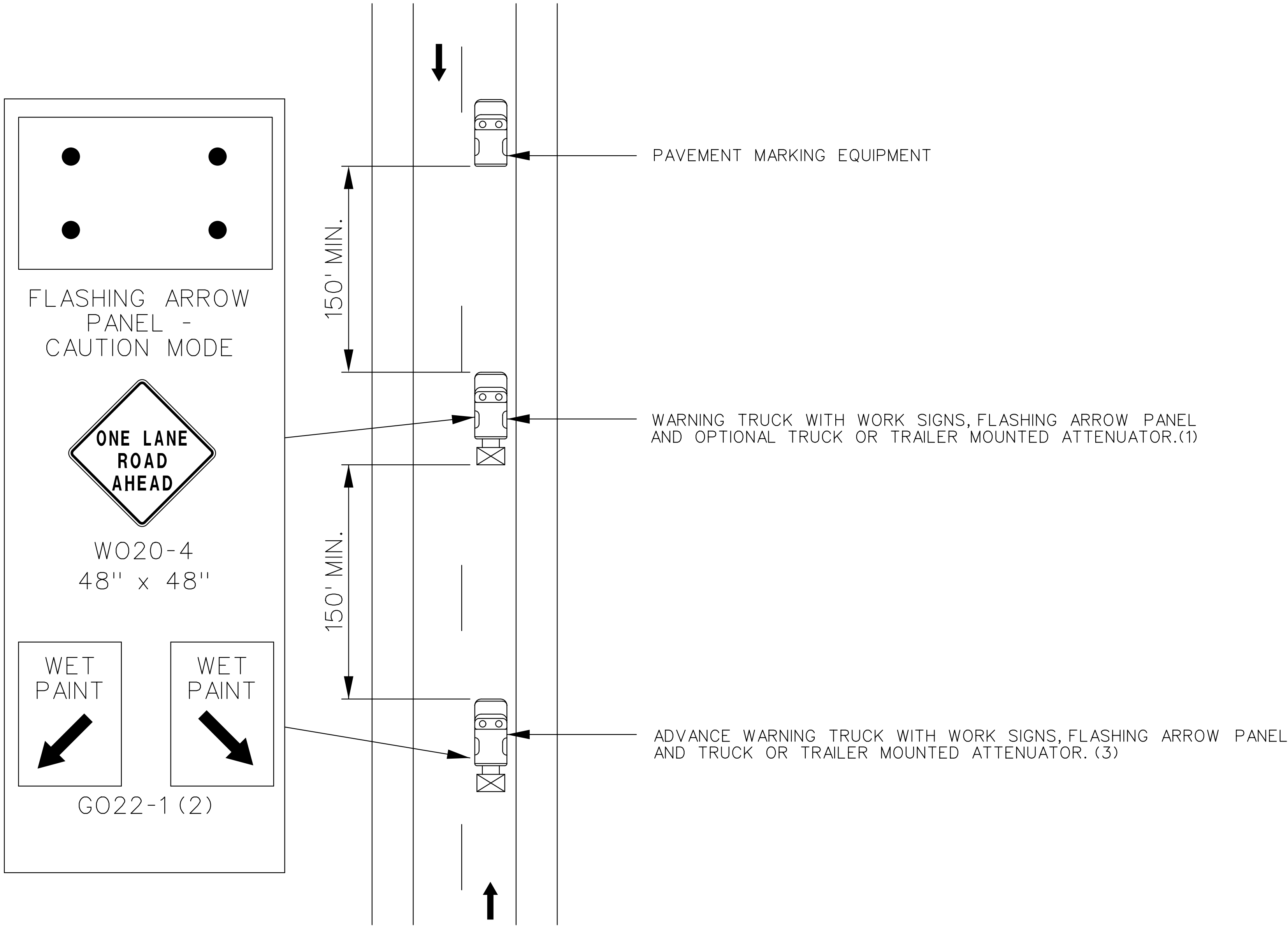

TWO-LANE UNDIVIDED HIGHWAY

DISCLAIMER

THE PROFESSIONAL WHOSE SIGNATURE AND PERSONAL SEAL APPEAR HEREON ASSUMES RESPONSIBILITY ONLY FOR WHAT APPEARS ON THIS PAGE, AND DISCLAIMS (PURSUANT TO SECTION 327.411 RSMO) SPECIFICATION, ESTIMATES, REPORTS, OR OTHER DOCUMENTS OR INSUMENTS NOT SEALED BY THE UNDERSIGNED PROFESSIONAL RELATING TO OR INTENDED TO BE USED FOR ANY PART OR PARTS OF THE PROJECT TO WHICH THIS PAGE REFERS.

NOT TO SCALE

NOTES:

UPON APPROVAL OF THE ENGINEER, THE CONTRACTOR MAY PROVIDE ADDITIONAL PROTECTIVE TRUCKS EQUIPPED WITH PROPER WARNING DEVICES.

PROTECTIVE TRUCK AND WORK VEHICLES SHALL DISPLAY HIGH-INTENSITY ROTATING, FLASHING, OSCILLATING, OR STROBE LIGHTS.

VEHICLE HAZARD WARNING LIGHTS SHALL NOT BE USED INSTEAD OF THE VEHICLE'S HIGH-INTENSITY ROTATING, FLASHING, OSCILLATING, OR STROBE LIGHTS.

(1) TRUCK IS OPTIONAL ON TWO-LANE UNDIVIDED HIGHWAYS IF SIGNING AND ARROW BOARD IS MOUNTED ON THE PAVEMENT MARKING EQUIPMENT.

(2) WET PAINT SIGNS ARE INSTALLED TO INDICATE THE SIDE IN WHICH THE PAVEMENT MARKING MATERIAL IS BEING APPLIED. AT THE CONTRACTOR'S OPTION, A FRONT FACING WET PAINT SIGN MAY BE INSTALLED ON THE LEFT SIDE OF THE PAVEMENT MARKING EQUIPMENT.

(3) ADVANCE WARNING TRUCK IS POSITIONED AT THE NO TRACK POINT OF THE PAVEMENT MARKING MATERIAL OR SPACING SHOWN, WHICHEVER IS GREATER.

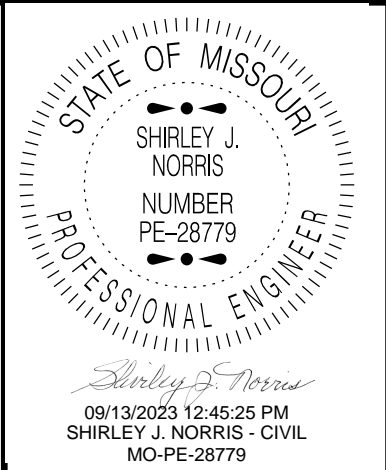

DATE PREPARED 9/12/2023	
ROUTE AP	STATE MO
DISTRICT SL	SHEET NO. 14
COUNTY FRANKLIN	
JOB NO. JSL0031	
CONTRACT ID.	
PROJECT NO.	
BRIDGE NO.	

DESCRIPTION	DATE

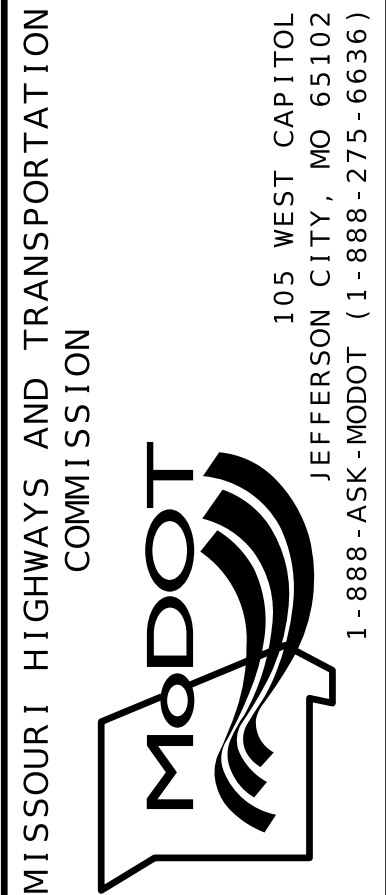

TRAFFIC CONTROL SHEET
CENTER LINE /
EDGE LINE STRIPING
ON TWO-LANE HIGHWAYS
SHEET 6 OF 6

[illegible]

DATE PREPARED	
9/12/2023	
ROUTE	STATE
AP	MO
DISTRICT	SHEET NO.
SL	16
COUNTY	
FRANKLIN	
JOB NO.	
JSL0031	
CONTRACT ID.	

PROJECT NO.
BRIDGE NO.

[illegible]

MISSOURI HIGHWAYS AND TRANSPORTATION
COMMISSION

The logo for the Missouri Department of Transportation (MoDOT) features the word "MoDOT" in a stylized, bold, sans-serif font. The letters are white and set against a dark blue background. The "M" and "D" are larger and more prominent, with the "o" and "T" being smaller and positioned between them. The logo is enclosed in a dark blue rectangular border.

105 WEST CAPITOL
JEFFERSON CITY, MO 65102
1-888-ASK-MODOT (1-888-275-6636)

D - 30

1 LOG MILES ARE BASED ON RTE. AP EB LOG MILES UNLESS OTHERWISE NOTED
2 SIGN REMOVED AND NOT REPLACED
3 RTE NN - NB LOG MILE
4 RTE NN - SB LOG MILE
5 ORANGE, YELLOW & YELLOW/GREEN SIGNS

DISCLAIMER

THE PROFESSIONAL WHOSE SIGNATURE AND PERSONAL SEAL APPEAR HEREON ASSUMES RESPONSIBILITY ONLY FOR WHAT APPEARS ON THIS PAGE, AND DISCLAIMS (PURSUANT TO SECTION 327.411 RSMO) SPECIFICATION, ESTIMATES, REPORTS, OR OTHER DOCUMENTS OR INSTRUMENTS NOT SEALED BY THE UNDERSIGNED PROFESSIONAL RELATING TO OR INTENDED TO BE USED FOR ANY PART OR PARTS OF THE PROJECT TO WHICH THIS PAGE REFERS.