

GENERAL NOTES:

1. ANY EXISTING SIGNS THAT CONFLICT WITH THE TRAFFIC CONTROL SIGNING SHALL BE COMPLETELY COVERED OR REMOVED.
2. TEMPORARY SIGNING SHOWN IS FOR WORK ON ONE SIDE OF THE ROAD. FOR WORK ON THE OTHER SIDE, REVERSE ORDER OF THE SIGNS AND CHANNELIZERS.
3. SIGNING SHOWN SHALL REMAIN IN PLACE UNTIL CONSTRUCTION IS COMPLETE.
4. ALTERNATE TRAFFIC CONTROL MAY BE USED AS NEEDED AT THE APPROVAL OF THE ENGINEER.
5. REFER TO STANDARD DRAWING 616.10, 619.10, AND 620.10 FOR ADDITIONAL DETAILS AND 903.03 FOR SIGN AND SIGN MOUNTING REQUIREMENTS.
6. SPEED LIMIT SIGNS INDICATING THE NORMAL SPEED LIMIT SHALL BE INSTALLED AT THE END OF THE WORK ZONE, PROVIDED NO FURTHER WORK ZONES WILL BE ENCOUNTERED WITHIN THE NEXT 1/2 MILE.
7. TEMPORARY SPEED LIMIT SIGNS SHALL BE COVERED OR REMOVED WHEN THE CONDITIONS REQUIRING REDUCED SPEEDS DO NOT EXIST.
8. NO DIRECT PAYMENT WILL BE MADE FOR THE RELOCATION OF CHANNELIZERS, CONSTRUCTION SIGNS, OR FLASHING ARROW PANEL.
9. ALL SIGNS, EXCEPT "RATE OUR WORK ZONES" SHALL BE PORTABLE MOUNT AND ARE TO BE MOVED AS WORK PROGRESSES, UNLESS OTHERWISE NOTED. ALL TRAFFIC CONTROL ITEMS SHALL BE REMOVED FROM THE ROADWAY DURING NON-WORKING HOURS.
10. THE CONTRACTOR SHALL BE RESPONSIBLE FOR IMPLEMENTING AND MAINTAINING PROPER TRAFFIC CONTROL SETUPS THROUGHOUT CONSTRUCTION AS DESCRIBED IN THESE PLANS OR AS APPROVED BY THE ENGINEER.
11. WHERE MINIMUM LANE WIDTHS CANNOT BE ACHIEVED ON THE SIDE STREETS, THE CONTRACTOR SHALL CLOSE HALF OF THE APPROACH AND POSITION A FLAGGER AT EACH END OF THE WORK AREA. LOCATION TO BE DETERMINED BY THE ENGINEER. ADVANCE FLAGGER SIGNING SHALL BE INSTALLED AS OUTLINED IN THE MUTCD.
12. THE CONTRACTOR SHALL MAINTAIN PUBLIC ACCESS TO ALL BUSINESSES AND STREETS. NO STREET OR ENTRANCE SHALL BE COMPLETELY BLOCKED.
13. SPACING & DISTANCES OF TRAFFIC CONTROL DEVICES ARE APPROXIMATE. THE EXACT LOCATIONS SHALL BE DETERMINED IN THE FIELD & APPROVED BY THE ENGINEER.
14. TRAFFIC CONTROL SHALL CONFORM TO THE LATEST EDITION OF THE MANUAL ON UNIFORM TRAFFIC CONTROL DEVICES (MUTCD).
15. ADJUST ADVANCE WARNING SIGN SPACING TO AVOID SIGN PLACEMENT WITHIN THE LIMITS OF THE RAILROAD RIGHT OF WAY.

REVISED: 4/18/2023

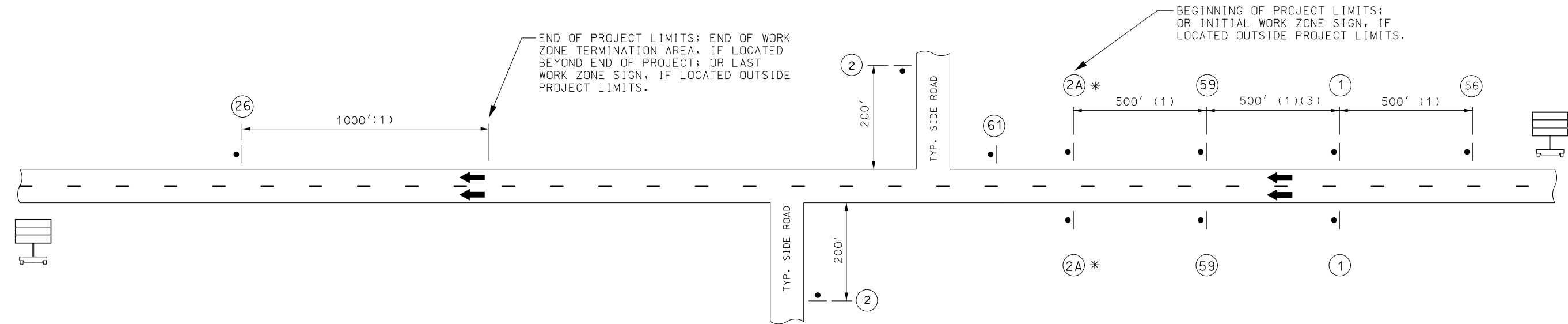

TYPICAL BEGINNING AND END OF PROJECT
(DIVIDED HIGHWAY)

- (1) DISTANCE MAY BE ADJUSTED ACCORDING TO FIELD CONDITIONS. WHERE TRAFFIC BACKUPS ARE EXPECTED BEYOND THE ADVANCE WARNING AREA, ADDITIONAL SIGNING MAY BE NEEDED.
- (2) SIGN CONST-7-72 IS PLACED 500 FEET BEFORE THE BEGINNING OF PROJECT LIMITS OR THE ROAD WORK AHEAD SIGN OR ROAD WORK NEXT XX MILES SIGN OR WORK ZONE NO PONE ZONE SIGN, IF USED, WHEN THESE SIGNS ARE LOCATED OUTSIDE THE PROJECT LIMITS.
- (3) THE "WORK ZONE NO PHONE ZONE" SIGN IS PLACED A MINIMUM OF 500 FEET BEFORE THE ROAD WORK AHEAD SIGN.
- (4) CMS PLACEMENT SHALL BE APPROVED BY THE ENGINEER.



CONST-8-48 (3)

(59)

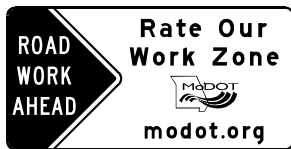

CONST-7-72 (2)

(56)



G020-1

(1)



W020-1



(2A)*

* SIGN (2A) WITH AWRS MUST BE GROUND OR SKID MOUNTED.

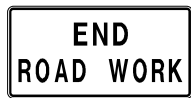

G020-2

(26)



W020-1

(2)

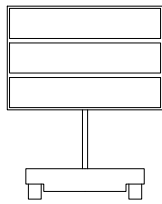

CMS (4)

NOT TO SCALE

TRAFFIC CONTROL
SHEET 1 OF 7

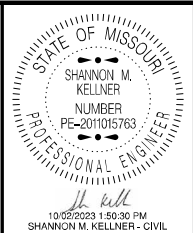

DATE PREPARED

10/2/2023

ROUTE VAR STATE MO

DISTRICT SW SHEET NO. 2

COUNTY VARIOUS

JOB NO. JSR0117

CONTRACT ID.

PROJECT NO.

BRIDGE NO.

DESCRIPTION

DATE

MISSOURI HIGHWAYS AND TRANSPORTATION COMMISSION

105 WEST CAPITOL JEFFERSON CITY, MO 65102

1-888-ASK-MODOT (1-888-275-6636)

MODOT

REVISÉD: 4/18/2023

GENERAL NOTES:

1. ANY EXISTING SIGNS THAT CONFLICT WITH THE TRAFFIC CONTROL SIGNING SHALL BE COMPLETELY COVERED OR REMOVED.
2. TEMPORARY SIGNING SHOWN IS FOR WORK ON ONE SIDE OF THE ROAD. FOR WORK ON THE OTHER SIDE, REVERSE ORDER OF THE SIGNS AND CHANNELIZERS.
3. SIGNING SHOWN SHALL REMAIN IN PLACE UNTIL CONSTRUCTION IS COMPLETE.
4. ALTERNATE TRAFFIC CONTROL MAY BE USED AS NEEDED AT THE APPROVAL OF THE ENGINEER.
5. REFER TO STANDARD DRAWING 616.10, 619.10, AND 620.10 FOR ADDITIONAL DETAILS AND 903.03 FOR SIGN AND SIGN MOUNTING REQUIREMENTS.
6. SPEED LIMIT SIGNS INDICATING THE NORMAL SPEED LIMIT SHALL BE INSTALLED AT THE END OF THE WORK ZONE, PROVIDED NO FURTHER WORK ZONES WILL BE ENCOUNTERED WITHIN THE NEXT 1/2 MILE.
7. TEMPORARY SPEED LIMIT SIGNS SHALL BE COVERED OR REMOVED WHEN THE CONDITIONS REQUIRING REDUCED SPEEDS DO NOT EXIST.
8. NO DIRECT PAYMENT WILL BE MADE FOR THE RELOCATION OF CHANNELIZERS, CONSTRUCTION SIGNS, OR FLASHING ARROW PANEL.
9. ALL SIGNS, EXCEPT "RATE OUR WORK ZONES" SHALL BE PORTABLE MOUNT AND ARE TO BE MOVED AS WORK PROGRESSES, UNLESS OTHERWISE NOTED. ALL TRAFFIC CONTROL ITEMS SHALL BE REMOVED FROM THE ROADWAY DURING NON-WORKING HOURS.
10. THE CONTRACTOR SHALL BE RESPONSIBLE FOR IMPLEMENTING AND MAINTAINING PROPER TRAFFIC CONTROL SETUPS THROUGHOUT CONSTRUCTION AS DESCRIBED IN THESE PLANS OR AS APPROVED BY THE ENGINEER.
11. WHERE MINIMUM LANE WIDTHS CANNOT BE ACHIEVED ON THE SIDE STREETS, THE CONTRACTOR SHALL CLOSE HALF OF THE APPROACH AND POSITION A FLAGGER AT EACH END OF THE WORK AREA. LOCATION TO BE DETERMINED BY THE ENGINEER. ADVANCE FLAGGER SIGNING SHALL BE INSTALLED AS OUTLINED IN THE MUTCD.
12. THE CONTRACTOR SHALL MAINTAIN PUBLIC ACCESS TO ALL BUSINESSES AND STREETS. NO STREET OR ENTRANCE SHALL BE COMPLETELY BLOCKED.
13. SPACING & DISTANCES OF TRAFFIC CONTROL DEVICES ARE APPROXIMATE. THE EXACT LOCATIONS SHALL BE DETERMINED IN THE FIELD & APPROVED BY THE ENGINEER.
14. TRAFFIC CONTROL SHALL CONFORM TO THE LATEST EDITION OF THE MANUAL ON UNIFORM TRAFFIC CONTROL DEVICES (MUTCD).
15. ADJUST ADVANCE WARNING SIGN SPACING TO AVOID SIGN PLACEMENT WITHIN THE LIMITS OF THE RAILROAD RIGHT OF WAY.

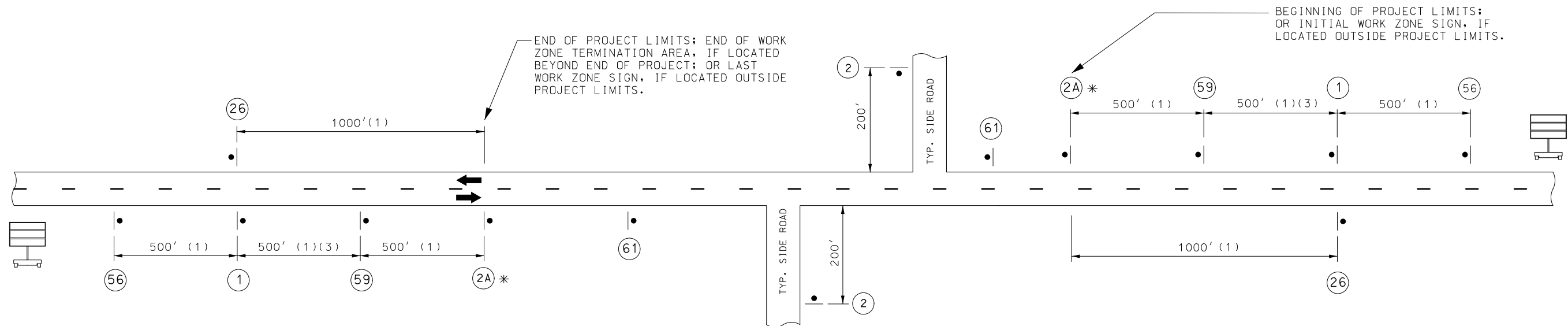

TYPICAL BEGINNING AND END OF PROJECT
(UNDIVIDED HIGHWAY)

- (1) DISTANCE MAY BE ADJUSTED ACCORDING TO FIELD CONDITIONS. WHERE TRAFFIC BACKUPS ARE EXPECTED BEYOND THE ADVANCE WARNING AREA, ADDITIONAL SIGNING MAY BE NEEDED.
- (2) SIGN CONST-7-72 IS PLACED 500 FEET BEFORE THE BEGINNING OF PROJECT LIMITS OR THE ROAD WORK AHEAD SIGN OR ROAD WORK NEXT XX MILES SIGN OR WORK ZONE NO PONE ZONE SIGN, IF USED, WHEN THESE SIGNS ARE LOCATED OUTSIDE THE PROJECT LIMITS.
- (3) THE "WORK ZONE NO PHONE ZONE" SIGN IS PLACED A MINIMUM OF 500 FEET BEFORE THE ROAD WORK AHEAD SIGN.
- (4) CMS PLACEMENT SHALL BE APPROVED BY THE ENGINEER.

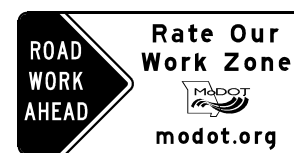

CONST-7-72 (2)

56



CONST-8-48 (3)

(59)



G020-1

①



W020-1

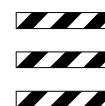

(2A)*

* SIGN ^(2A) WITH AWRS MUST
BE GROUND OR SKID MOUNTED.

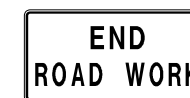

G020-2

(26)



W020-1

②

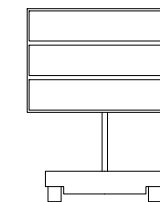

CMS (4)

NOT TO SCALE

TRAFFIC CONTROL
SHEET 2 OF 7

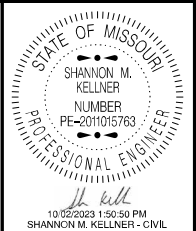

DATE PREPARED

| 10/2/2025 | |
|-----------|-------|
| ROUTE | STATE |

| | |
|----------|-----------|
| DISTRICT | SHEET NO. |
|----------|-----------|

COUNTY

VARIOUS

JSR0117

CONTRACT ID.

PROJECT NO.

BRIDGE NO.

[illegible]

MISSOURI HIGHWAYS AND TRANSPORTATION
COMMISSION

105 WEST CAPITOL
JEFFERSON CITY, MO 65102
1-888-ASK-MODOT (1-888-275-6636)

EXIT RAMP CLOSURE

| TAPER LENGTH AND SPACING | | | | | | | |
|---|--------------------|-------------------------------------|----------------------|------------------|-------------------------------|---------------------------|-----------------------|
| SPEED | SIGN SPACING (FT.) | | TAPER LENGTH (FT.) | | OPTIONAL | CHANNELIZER SPACING (FT.) | |
| PERMANENT POSTED (mph) | UNDIVIDID (S) | DIVIDED (S) | SHOULDER (1) (T1) | LANE (2) (T2) | BUFFER LENGTH (FT.) (B) | TAPERS | BUFFER/ WORK AREAS |
| 0-35 | - | 200 | 70 | 245 | 280 | 35 | 40 |
| 40-45 | - | 500 | 150 | 540 | 400 | 40 | 80 |
| 50-55 | - | 1000 | 185 | 660 | 560 | 50 | 80 |
| 60-70 | - | SA - 1000 SB - 1500 SC - 2640 | 235 | 840 | 840 | 60 | 120 |
| 1. Shoulder taper length based on 10 ft (standard shoulder width) offset. | | | | | | | |
| 2. Lane taper length based on 12 ft. (standard lane width) offset. | | | | | | | |

*POSTED SPEED LIMIT.
*TAPER LENGTHS MAY BE ADJUSTED.
*SPACING MAY BE ADJUSTED FOR FIELD CONDITIONS.
*BASED ON 10FT SHOULDER WIDTH
*BASED ON 12FT LANE WIDTH
*SPACING REDUCED TO½AT INTERSECTIONS.
*SPACING MAY BE REDUCED TO½AT INTERSECTIONS.

| ADVANCE WARNING SIGN MINIMUM SPACING | |
|--------------------------------------|------------------------------------|
| SPEED LIMIT ¹ , MPH | SIGN SPACING ² , FT (S) |
| | DIVIDED HIGHWAY |
| 0-35 | 200 ³ |
| 40-45 | 500 |
| 50-55 | 1000 |
| 60-70 | SA-1000 |
| | SB-1500 |
| | SC-2640 |

¹POSTED SPEED LIMIT.
²SPACING MAY BE ADJUSTED FOR FIELD CONDITIONS.
³FOR URBAN LOW SPEED, MINIMUM RECOMMENDED SPACING IS 100 FT.

NOTES:
TEMPORARY PAVEMENT MARKINGS OPTIONAL FOR SHORT TERM OPERATIONS.

FOR FLAGS AND ADVANCE WARNING RAIL SYSTEM, REFER TO EPG 616.6.87 RUMBLE STRIPS.

REVIEW EPG 616.6.63 CHANNELIZING DEVICES FOR DIFFERENT TYPES AND GUIDELINES FOR THE DEVICES.

LEGEND



TYPE 3 MOVEABLE BARRICADES W/ LIGHTS



SIGN (SINGLE SIDED)



WORK ZONE



TRUCK MOUNTED ATTENUATOR



CHANNELIZER



W020-1

2

BRIDGE

OR

RAMP



R11-2

29



E05-2a

55

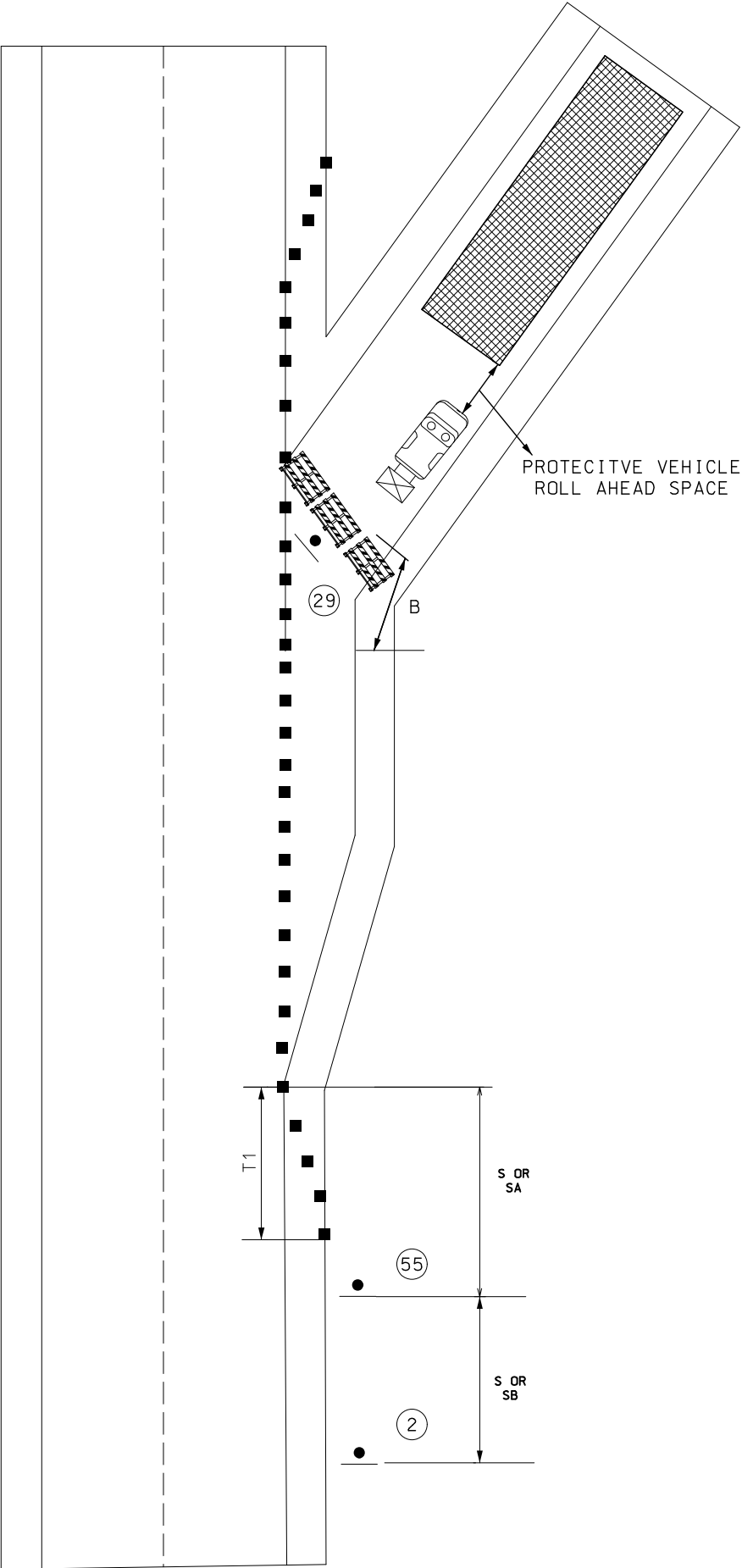

STATE OF MISSOURI

SHANNON M. KELLNER

NUMBER

PE-2011015763

PROFESSIONAL ENGINEER

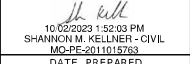

10/02/2023 1:52:03 PM
SHANNON M. KELLNER - CIVIL
MO-PE-2011015763

DATE PREPARED

10/2/2023

ROUTE

VAR

STATE

MO

DISTRICT

SW

SHEET NO.

7

COUNTY

VARIOUS

JOB NO.

JSR0117

CONTRACT ID.

PROJECT NO.

BRIDGE NO.

DESCRIPTION

DATE

MISSOURI HIGHWAYS AND TRANSPORTATION COMMISSION



105 WEST CAPITOL
JEFFERSON CITY, MO 65102
1-888-ASK-MODOT (1-888-275-6636)

