

COLE COUNTY ROUTES

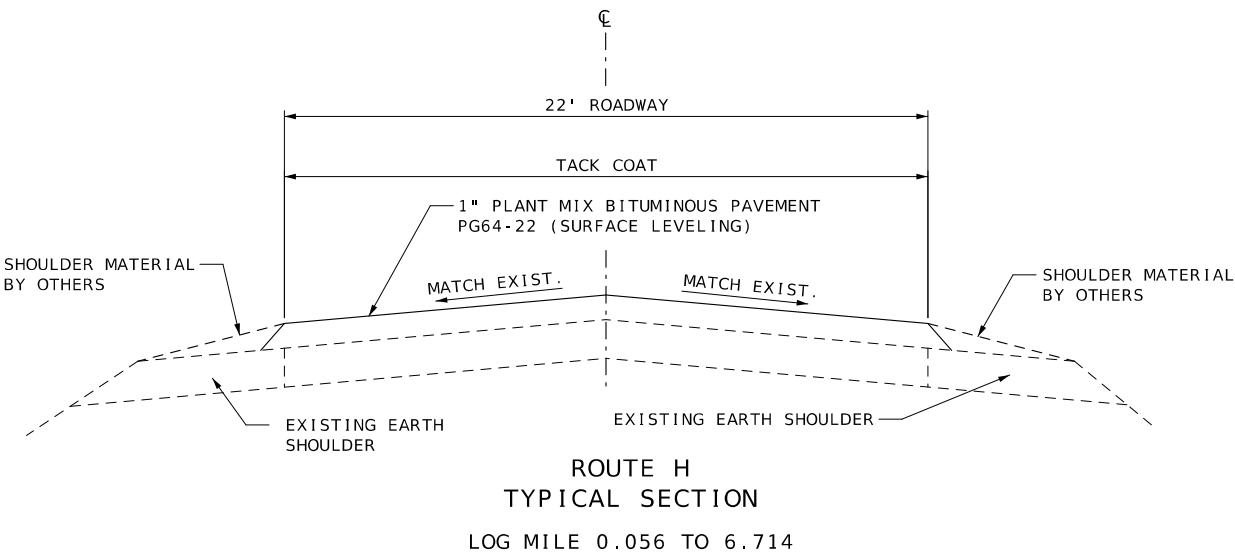
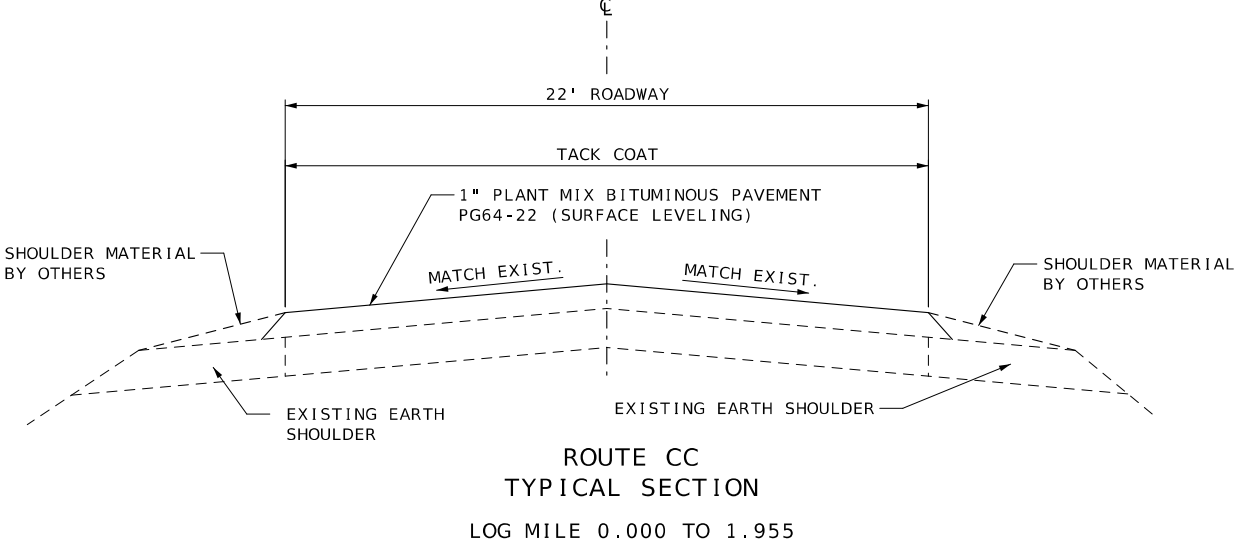
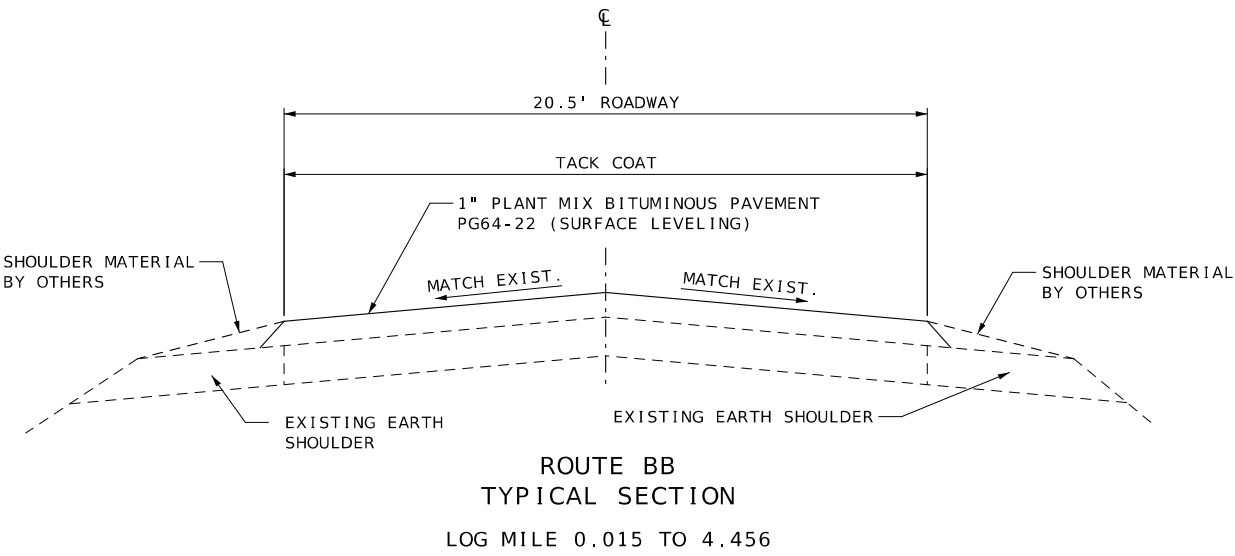

NOTE:
SURFACE PLACEMENT SHALL BE ONE PASS PER LANE
NO S.E. CORRECTION.

ESTIMATE FACTORS
BPM PG64-22 (SURFACE LEVELING) = 1.987 TONS/CY
TACK (EXIST. ASPHALT SURFACE) = 0.08 GAL/SY
TACK (COLDMILLED ASPHALT) = 0.10 GAL/SY

TYPICAL SECTION
SHEET 1 OF 1

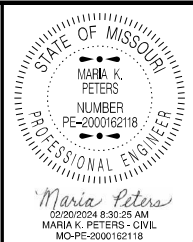

DATE PREPARED 2/15/2024	
ROUTE BB/CC/H	STATE MO
DISTRICT CD	SHEET NO. 2
COUNTY COLE	
JOB NO. JCD0043	
CONTRACT ID.	
PROJECT NO.	
BRIDGE NO.	

DESCRIPTION	DATE

MISSOURI HIGHWAYS AND TRANSPORTATION COMMISSION

105 WEST CAPITOL
JEFFERSON CITY, MO 65102
1-888-ASK-MODOT (1-888-275-6636)

TYPICAL SECTIONS SHEET
SHEET 1 OF 1

BITUMINOUS PAVEMENT RTE BB								
LOG MILE FROM	LOG MILE TO	LOCATION	LENGTH FT.	WIDTH FT.	AREA SQ. FT.	BPM PG64-22 (SURFACE LEVELING) TONS	TACK COAT GAL	REMARKS
0.015	0.017	ROUTE BB	10	VARIES	219.96	1.35	2.44	COLDMILL START PROJECT ON RTE BB - APPROX. 24.44 SQ. YDS.
0.017	4.446	ROUTE BB	23385.12	20.5	479394.96	2939.98	4261.29	START TO END OF PROJECT ON RTE BB
4.446	4.456	ROUTE BB	52.8	VARIES	3272.04	20.07	36.36	RTE BB AND ROUTE H INTERSECTION - APPROX. 363.56 SQ. YDS.
0.015	4.456	ROUTE BB - Lt.	125	2	250	1.53	2.78	PRIVATE ENTRANCES AND COUNTY ROADS
0.015	4.456	ROUTE BB - Rt.	146	2	292	1.79	3.24	PRIVATE ENTRANCES AND COUNTY ROADS
						444.71		15% FOR IRREGULARITIES
		TOTAL				3409.43	4306.11	
		USE				3409.4	4306	

BITUMINOUS PAVEMENT RTE CC								
LOG MILE FROM	LOG MILE TO	LOCATION	LENGTH FT.	WIDTH FT.	AREA SQ. FT.	BPM PG64-22 (SURFACE LEVELING) TONS	TACK COAT GAL	REMARKS
0.000	0.002	ROUTE CC	10	VARIES	1427.13	8.75	15.86	COLDMILL START PROJECT ON RTE CC - APPROX. 158.57 SQ. YDS.
0.002	0.022	ROUTE CC	105.6	VARIES	4002.3	24.54	35.58	START OF PROJECT ON RTE CC - APPROX. 444.70 SQ. YDS.
0.022	1.950	ROUTE CC	10179.84	22	223956.48	1373.46	2488.41	
1.950	1.955	ROUTE CC	25	22	550	3.37	6.11	MOD. COLDMILL END PROJECT ON RTE CC
0.000	1.955	ROUTE CC - Lt.	758	2	1516	9.30	16.84	PRIVATE ENTRANCES AND COUNTY ROADS
0.000	1.955	ROUTE CC - Rt.	805	2	1610	9.87	17.89	PRIVATE ENTRANCES AND COUNTY ROADS
						142.93		10% FOR IRREGULARITIES
		TOTAL				1572.22	2580.69	
		USE				1572.2	2581	

BITUMINOUS PAVEMENT RTE H								
LOG MILE FROM	LOG MILE TO	LOCATION	LENGTH FT.	WIDTH FT.	AREA SQ. FT.	BPM PG64-22 (SURFACE LEVELING) TONS	TACK COAT GAL	REMARKS
0.056	0.061	ROUTE H	25	22	550	3.37	6.11	COLDMILL START PROJECT ON RTE H
0.061	2.023	ROUTE H	10359.36	22	227905.92	1397.68	2025.83	START OF PROJECT ON ROUTE H
2.023	2.028	ROUTE H	25	22	550	3.37	4.89	COLDMILL BEFORE BRIDGE EXCEPTION
2.028	2.091	ROUTE H	332.64	22				BRIDGE R0250 EXCEPTION
2.091	2.096	ROUTE H	25	22	550	3.37	4.89	COLDMILL AFTER BRIDGE EXCEPTION
2.096	6.709	ROUTE H	24356.64	22	535846.08	3286.18	4763.08	
6.709	6.714	ROUTE H	25	22	550	3.37	4.89	MOD COLDMILL END PROJECT ON RTE H
0.056	6.714	ROUTE H - Lt.	425	2	850	5.21	9.44	PRIVATE ENTRANCES AND COUNTY ROADS
0.056	6.714	ROUTE H - Rt.	574	2	1148	7.04	12.76	PRIVATE ENTRANCES AND COUNTY ROADS
						706.44		15% FOR IRREGULARITIES
		TOTAL				5416.03	6831.89	
		USE				5416.0	6832	

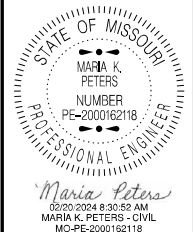

DATE PREPARED 2/15/2024	
ROUTE BB/CC/H	STATE MO
DISTRICT CD	SHEET NO. 3
COUNTY COLE	
JOB NO. JCD0043	
CONTRACT ID.	

PROJECT NO.
BRIDGE NO.

DESCRIPTION	DATE						

MISSOURI HIGHWAYS AND TRANSPORTATION COMMISSION

105 WEST CAPITOL
JEFFERSON CITY, MO 65102
1-888-ASK-MODOT (1-888-275-6636)

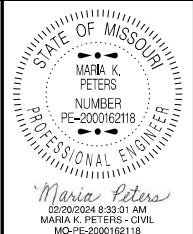

DATE PREPARED	
2/15/2024	
ROUTE	STATE
BB/CC/H	MO
DISTRICT	SHEET NO.
CD	3
COUNTY	
COLE	
JOB NO.	
JCD0043	
CONTRACT ID.	
PROJECT NO.	
BRIDGE NO.	

DESCRIPTION									
DATE									

MISSOURI HIGHWAYS AND TRANSPORTATION COMMISSION



105 WEST CAPITOL
JEFFERSON CITY, MO 65102
1-888-ASK-MODOT (1-888-275-6636)

QUANTITY SHEET
SHEET 2 OF 5

MODIFIED COLDMILLING						
LOG MILE FROM	LOG MILE TO	LOCATION	LENGTH FT	WIDTH FT	MODIFIED COLDMILLING (DEPTH TRANSITIONS) SQYD	REMARKS
0.015	0.017	ROUTE BB	10	22	24.44	START PROJECT RTE BB
0.000	0.002	ROUTE CC	10	VARIES	158.57	START PROJECT RTE CC - IRREGULAR AREA
1.95	1.955	ROUTE CC	25	22	61.11	END PROJECT RTE CC
0.056	0.061	ROUTE H	25	22	61.11	START PROJECT RTE H
2.023	2.028	ROUTE H	25	22	61.11	BEFORE BR. EX. R0250
2.091	2.096	ROUTE H	25	22	61.11	AFTER BR. EX. R0250
6.709	6.714	ROUTE H	25	20	55.56	END PROJECT RTE H
0.015	4.456	ROUTE BB - Lt.	125	2	27.78	PRIVATE ENTRANCES AND COUNTY ROADS
0.015	4.456	ROUTE BB - Rt.	146	2	32.44	PRIVATE ENTRANCES AND COUNTY ROADS
0.000	1.955	ROUTE CC - Lt.	758	2	168.44	PRIVATE ENTRANCES AND COUNTY ROADS
0.000	1.955	ROUTE CC - Rt.	805	2	178.89	PRIVATE ENTRANCES AND COUNTY ROADS
0.056	6.714	ROUTE H - Lt.	425	2	94.44	PRIVATE ENTRANCES AND COUNTY ROADS
0.056	6.714	ROUTE H - Rt.	574	2	127.56	PRIVATE ENTRANCES AND COUNTY ROADS
			TOTAL		1112.6	
			USE		1113	

GRAVEL (A), CRUSHED STONE (B)				
LOG MILE FROM	LOG MILE TO	LOCATION	GRAVEL (A) OR CRUSHED STONE (B) TONS	REMARKS
0.015	4.456	ROUTE BB	280.00	ROUTE BB GRAVEL ENTRANCES WITHIN OVERLAY LIMITS
0.000	1.955	ROUTE CC	295.00	ROUTE CC GRAVEL ENTRANCES WITHIN OVERLAY LIMITS
0.056	6.714	ROUTE H	380.00	ROUTE H GRAVEL ENTRANCES WITHIN OVERLAY LIMITS
		TOTAL	955.0	
		USE	955	

PAVEMENT MARKING RTE BB									
LOG MILE FROM	LOG MILE TO	LOCATION	LENGTH (FT)	STANDARD WATERBORNE PAV. MARK. PAINT, TYPE P BEADS			PREFORMED THERMOPLASTIC INTERSECTION MARKING		REMARKS
				4" SOLID YELLOW (FT)	4" INTERMITTENT YELLOW (FT)	4" SOLID WHITE (FT)	24" WHITE (FT)	8" WHITE (FT)	
0.015	4.446	ROUTE BB	23396	46792.0		46792.0			NO PASS
4.446	4.456	ROUTE BB	53	45.2		161.0			RTE BB AND RTE H INTERSECTION RADIUS
			SUBTOTAL 1	46837.2	0.0	46953.0	0.0	0.0	
			USE	46837		46953	0	0	

MOBILIZATION
1 LUMP SUM

PAVEMENT MARKING RTE CC									
LOG MILE FROM	LOG MILE TO	LOCATION	LENGTH (FT)	STANDARD WATERBORNE PAV. MARK. PAINT, TYPE P BEADS			PREFORMED THERMOPLASTIC INTERSECTION MARKING		REMARKS
				4" SOLID YELLOW (FT)	4" INTERMITTENT YELLOW (FT)	4" SOLID WHITE (FT)	24" WHITE (FT)	8" WHITE (FT)	
0.000	0.022	ROUTE CC	116	86.0			12	72.0	RTE CC AND RTE C INTERSECTION
0.022	1.955	ROUTE CC	10206	20412.0		20382.0			NO PASS
			SUBTOTAL 2	20498.0	0.0	20382.0	12.0	72.0	
			USE		20498	20382	12	72	

PAVEMENT MARKING RTE H									
LOG MILE FROM	LOG MILE TO	LOCATION	LENGTH (FT)	STANDARD WATERBORNE PAV. MARK. PAINT, TYPE P BEADS			PREFORMED THERMOPLASTIC INTERSECTION MARKING		REMARKS
				4" SOLID YELLOW (FT)	4" INTERMITTENT YELLOW (FT)	4" SOLID WHITE (FT)	24" WHITE (FT)	8" WHITE (FT)	
0.056	0.473	ROUTE H	2202	4404.0		4404.0			NO PASS
0.473	0.612	ROUTE H	734	734.0	183.5	1468.0			SB LANE CAN PASS - NB CANNOT
0.612	0.652	ROUTE H	211	422.0		422.0			NO PASS
0.652	0.772	ROUTE H	634	634.0	158.5	1268.0			NB LANE CAN PASS - SB CANNOT
0.772	2.276	ROUTE H	7941	15882.0		15882.0			NO PASS
2.276	2.375	ROUTE H	523	523.0	130.8	1046.0			SB LANE CAN PASS - NB CANNOT
2.375	2.395	ROUTE H	106	212.0		212.0			NO PASS
2.395	2.534	ROUTE H	734	734.0	183.5	1468.0			NB LANE CAN PASS - SB CANNOT
2.534	2.951	ROUTE H	2202	4404.0		4404.0			NO PASS
2.951	3.109	ROUTE H	834	834.0	208.5	1668.0			SB LANE CAN PASS - NB CANNOT
3.109	3.129	ROUTE H	106		26.5	212.0			BOTH LANES CAN PASS
3.129	3.289	ROUTE H	845	845.0	211.25	1690.0			NB LANE CAN PASS - SB CANNOT
3.289	5.033	ROUTE H	9208	18416.0		18416.0			NO PASS
5.033	5.158	ROUTE H	660	660.0	165	1320.0			SB LANE CAN PASS - NB CANNOT
5.158	5.218	ROUTE H	317		79.25	634.0			BOTH LANES CAN PASS
5.218	5.338	ROUTE H	634	634.0	158.5	1268.0			NB LANE CAN PASS - SB CANNOT
5.338	5.911	ROUTE H	3025	6050.0		6050.0			NO PASS
5.911	6.079	ROUTE H	887	887.0	221.75	1774.0			SB LANE CAN PASS - NB CANNOT
6.079	6.098	ROUTE H	100	200.0		200.0			NO PASS
6.098	6.238	ROUTE H	739	739.0	184.75	1478.0			NB LANE CAN PASS - SB CANNOT
6.238	6.704	ROUTE H	2460	4920.0		4920.0			NO PASS
			SUBTOTAL 3	62134.0	1911.8	70204.0	0.0	0.0	
			SUBTOTAL 2	20498.0	0.0	20382.0	12.0	72.0	
			SUBTOTAL 1	46837.2	0.0	46953.0	0.0	0.0	
			TOTAL	129469.2	1911.8	137539.0	12.0	72.0	
			USE		131381	137539	12	72	

STATE OF MISSOURI

MARIA K. PETERS
NUMBER
PE-2000162118
PROFESSIONAL ENGINEER

Maria Peters
02/20/2024 8:34:30 AM
MARIA K. PETERS - CIVIL
MO-PE-2000162118

DATE PREPARED
2/15/2024

ROUTE
BB/CC/H

STATE
MO

DISTRICT
CD

SHEET NO.
3

COUNTY
COLE

JOB NO.
JCD0043

CONTRACT ID.

PROJECT NO.

BRIDGE NO.

DESCRIPTION	DATE								

MISSOURI HIGHWAYS AND TRANSPORTATION
COMMISSION



105 WEST CAPITOL
JEFFERSON CITY, MO 65102
1-888-ASK-MODOT (1-888-275-6636)

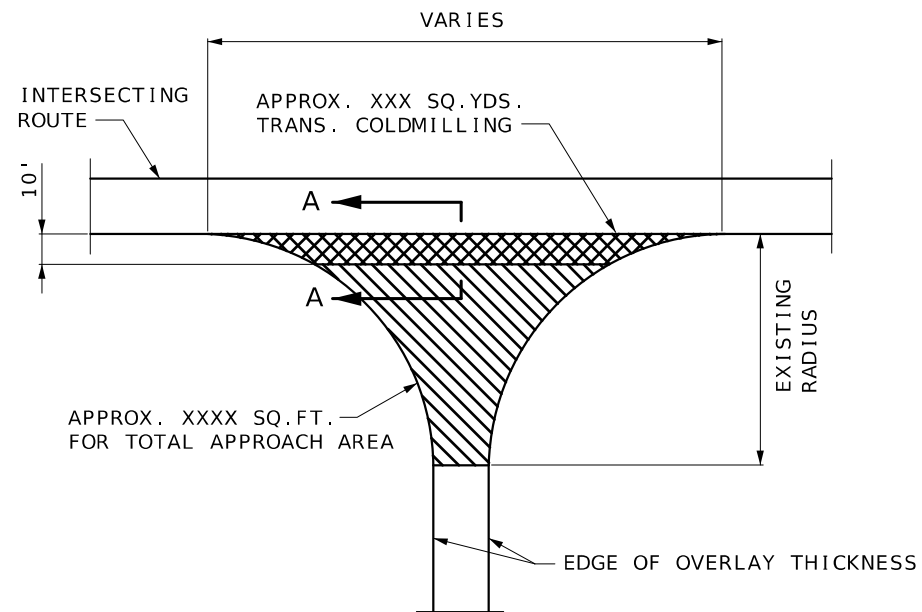

BEGINNING OF PROJECT
AT INTERSECTING ROUTE

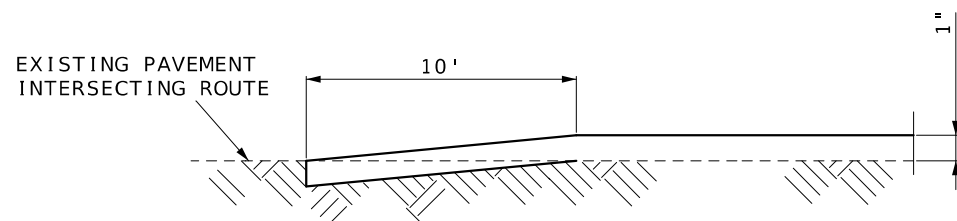

SECTION A-A
DEPTH TRANSITION
BEGINNING OF PROJECT
AT INTERSECTING ROUTE

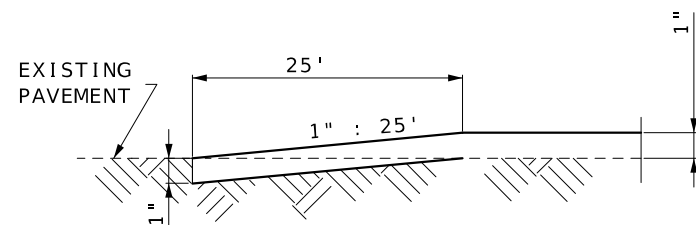

TYPICAL TRAVELWAY DEPTH TRANSITIONS
AT EXCEPTIONS AND BEGIN/END OF PROJECT

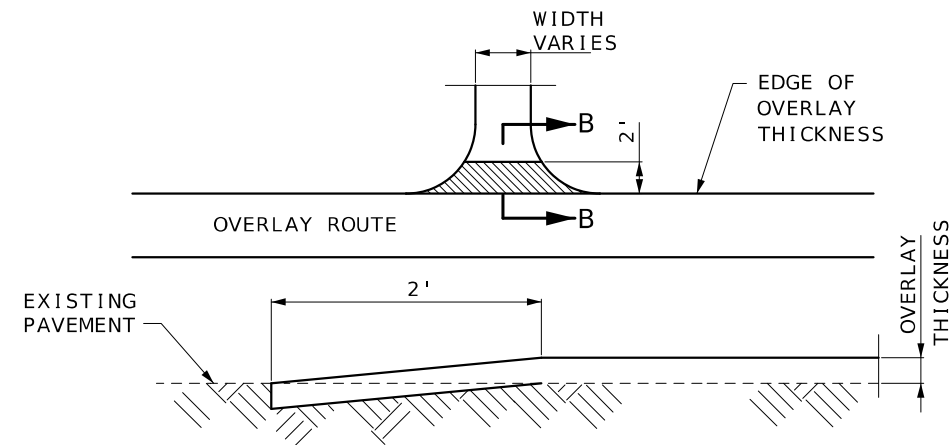

SECTION B-B
TYPICAL PAVED ENTRANCE
(PRIVATE OR COUNTY ROAD)

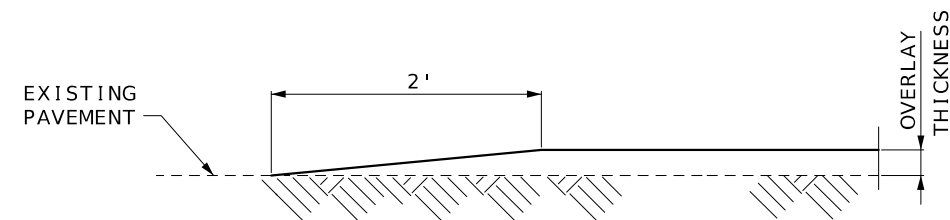

ALTERNATE SECTION B-B
TYPICAL GRAVEL ENTRANCE
(FIELD, PRIVATE OR COUNTY ROAD)
* TAPER AT 1:1 FOR FIELD ENTRANCE

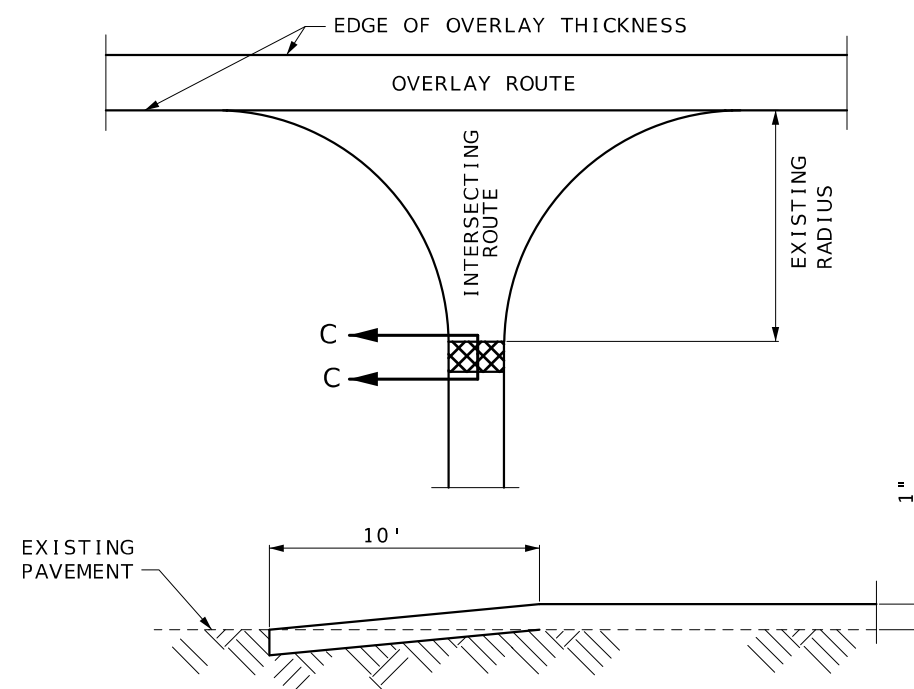

SECTION C-C
AT INTERSECTION RADIUS
DEPTH TRANSITION

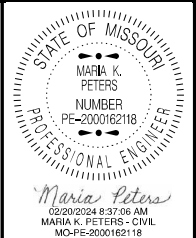

DATE PREPARED	2/15/2024
ROUTE	STATE
BB/CC/H	MO
DISTRICT	SHEET NO.
CD	4
COUNTY	
COLE	
JOB NO.	
JCD0043	
CONTRACT ID.	
PROJECT NO.	
BRIDGE NO.	

DESCRIPTION	DATE

MISSOURI HIGHWAYS AND TRANSPORTATION COMMISSION

105 WEST CAPITOL
JEFFERSON CITY, MO 65102
1-888-ASK-MODOT (1-888-275-6636)



STATE BRIDGE R0250



SPECIAL SHEET
3 OF 3

SPECIAL SHEET
SHEET 3 OF 3

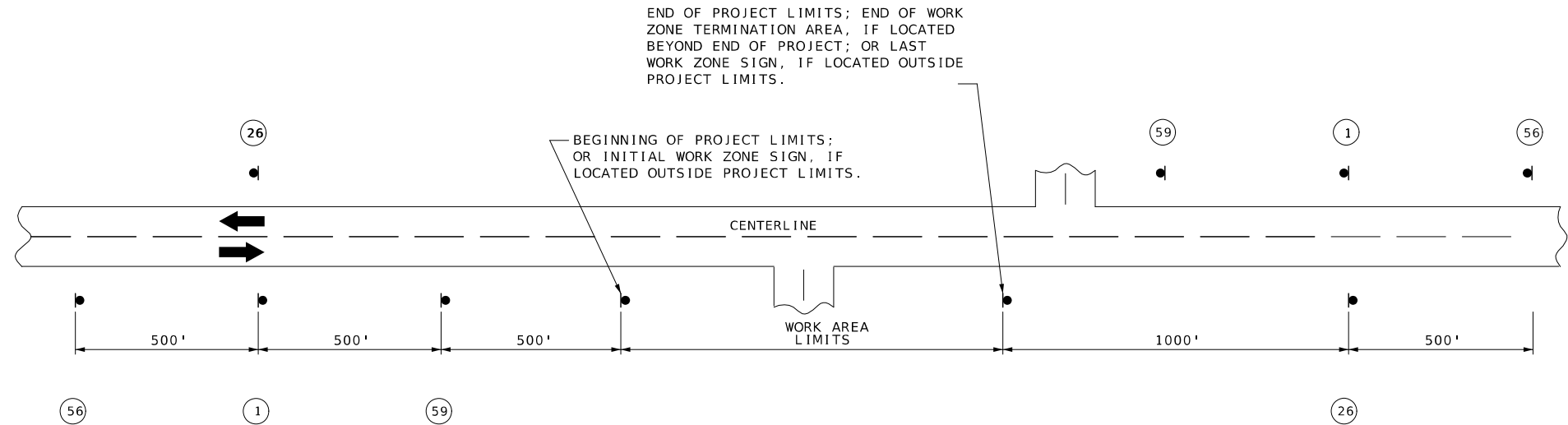
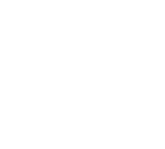

NOTES:

SIGN (1) AND (26) ARE ONLY USED ON PROJECT LENGTHS 2 MILES OR GREATER.

PROVIDE SIGNS IN EACH DIRECTION ON TWO-WAY HIGHWAY.

DISTANCE MAY BE ADJUSTED ACCORDING TO FIELD CONDITIONS.

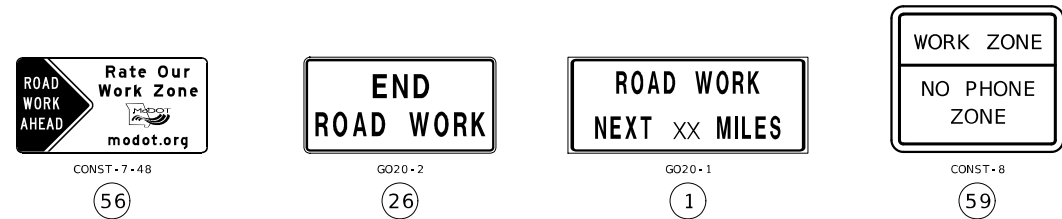

XX = 4 MILES FOR BB
XX = 2 MILES FOR CC
XX = 7 MILES FOR H

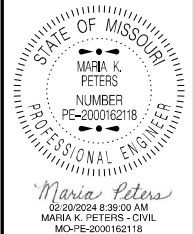

DATE PREPARED
2/15/2024

ROUTE BB/CC/H	STATE MO
DISTRICT CD	SHEET NO. 7

COUNTY
COLE

JOB NO.
JCD0043

CONTRACT ID.

PROJECT NO.

BRIDGE NO.

DESCRIPTION	DATE

MISSOURI HIGHWAYS AND TRANSPORTATION COMMISSION

105 WEST CAPITOL
JEFFERSON CITY, MO 65102
1-888-ASK-MODOT (1-888-275-6636)

MODOT

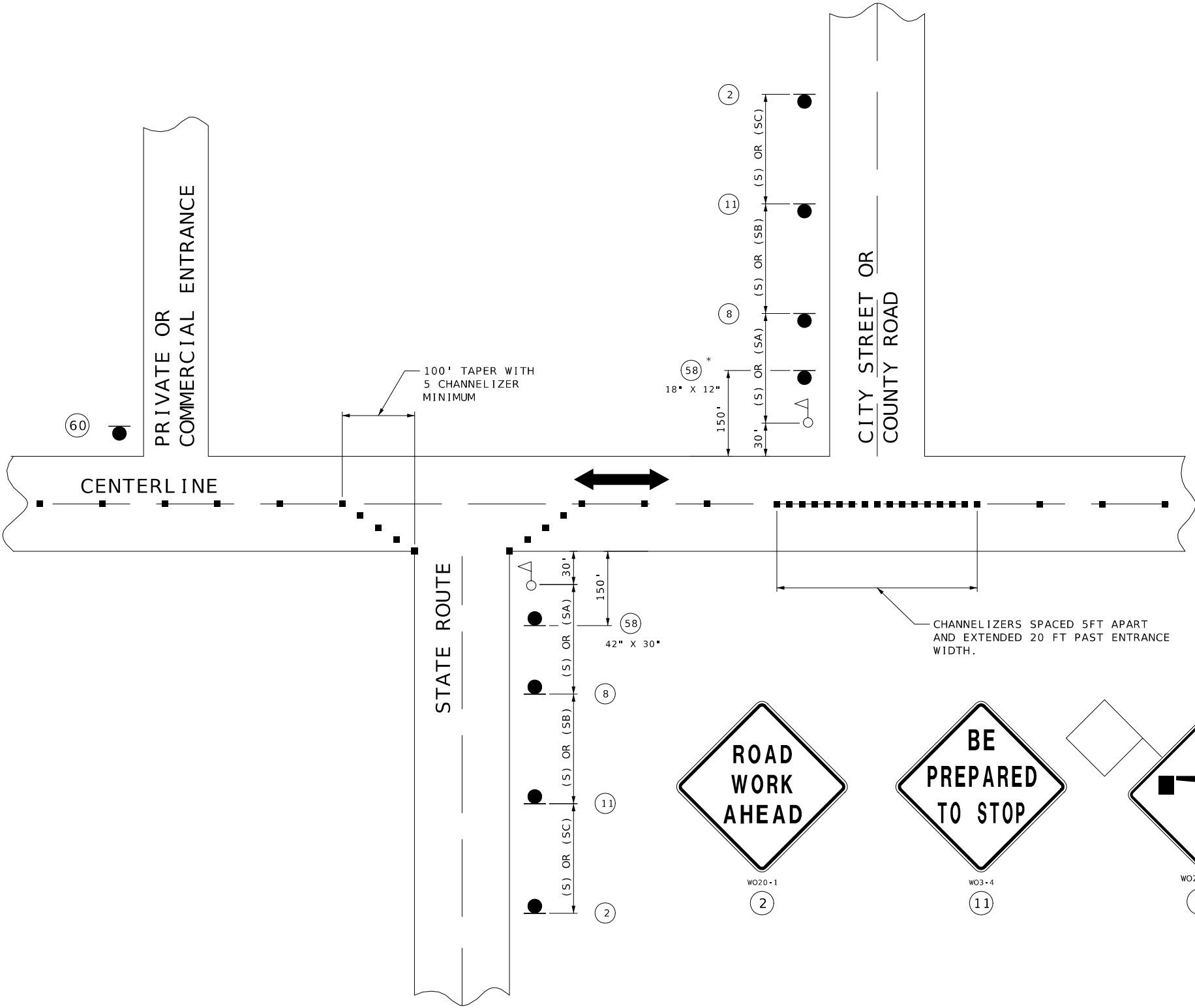

SPEED	SIGN SPACING (FT.)	
PERMANENT POSTED (MPH)	NON-DIVIDED HIGHWAYS (S)	DIVIDED HIGHWAYS (S)
0-35	200	200
40-45	350	500
50-55	500	1000
60-70	1000	(SA)-1000 (SB)-1500 (SC)-2640

DISTANCE MAY BE ADJUSTED ACCORDING TO FIELD CONDITIONS.

NOTES:
WARNING SIGNS SHALL BE ERECTED AT EACH INTERSECTION WITH ANOTHER STATE HIGHWAY WITHIN THE WORK ZONE.

ADDITIONAL WARNING SIGNS SHALL BE ERECTED AT OTHER INTERSECTIONS WITHIN THE WORK ZONE, AS DIRECTED BY THE ENGINEER.

■ - CHANNELIZERS (AS SPECIFIED)

△ - FLAGGER

SHALL BE USED ON ALL STATE ROUTES AND MAY BE USED ON ANY NON-STATE ROUTES, AS DETERMINED BY THE ENGINEER.

* THE SMALLER 18" X 12" SIGN 58 IS USED ON ALL OTHER NON-STATE ROUTES (CITY STREETS, COUNTY ROADS, ETC.).

SHALL ONLY BE USED AT PRIVATE AND COMMERCIAL ENTRANCES. SEE STD PLAN 616.10



DATE PREPARED 2/15/2024	
ROUTE BB/CC/H	STATE MO
DISTRICT CD	SHEET NO. 9
COUNTY COLE	
JOB NO. JCD0043	
CONTRACT ID.	

PROJECT NO.
BRIDGE NO.

DESCRIPTION	DATE

MISSOURI HIGHWAYS AND TRANSPORTATION COMMISSION



105 WEST CAPITOL
JEFFERSON CITY, MO 65102
1-888-ASK-MODOT (1-888-275-6636)

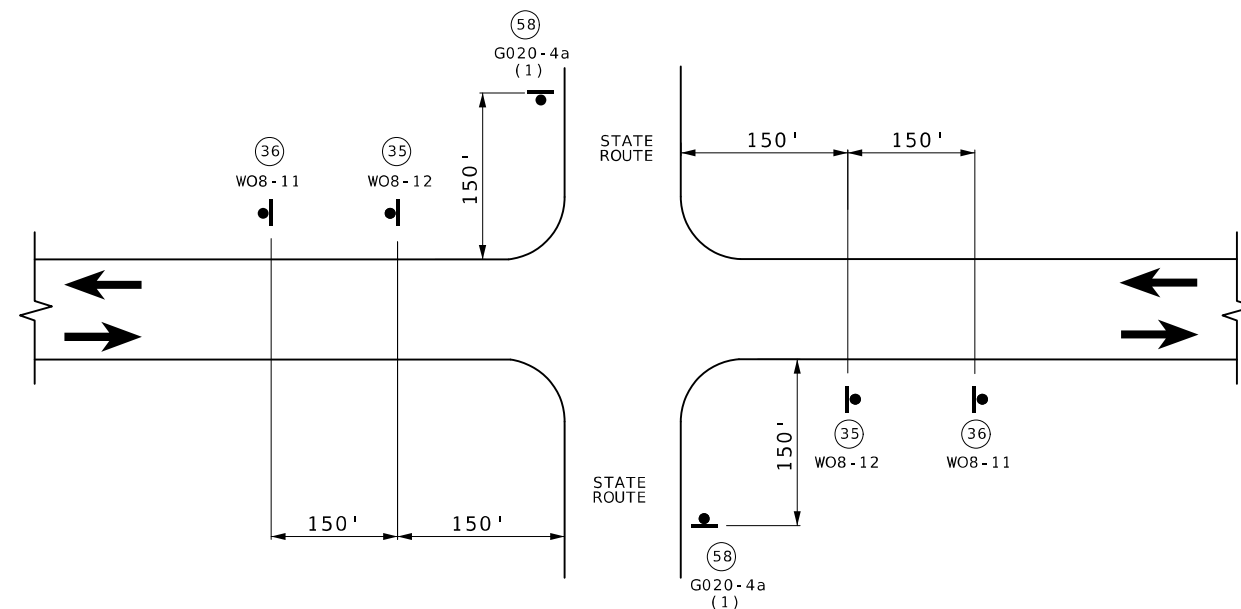
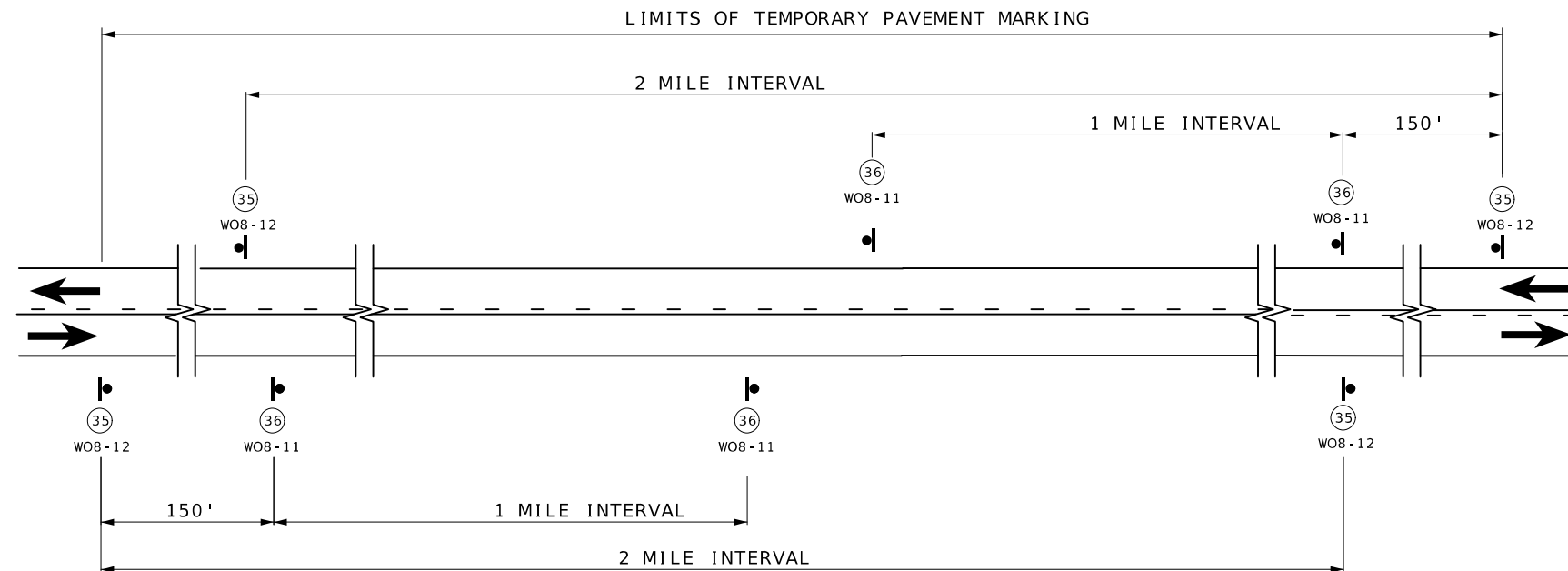

(1) ADDITIONAL SIDEROADS MAY BE SIGNED AS APPROVED BY THE ENGINEER.

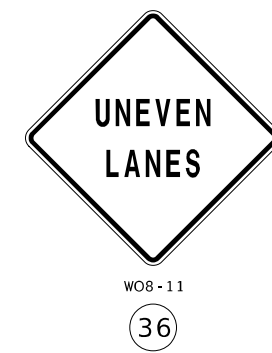

NOTES:

SIGN 35 AND TEMPORARY RAISED PAVEMENT MARKING (SEE STANDARD PLAN 620.10) INSTALLED WHERE CENTERLINE STRIPING HAS BEEN COVERED OR REMOVED. SIGNS ARE TO REMAIN IN PLACE UNTIL THE PERMANENT CENTERLINE PAVEMENT MARKINGS ARE IN PLACE. SIGNS SHALL BE COVERED OR REMOVED WHEN PAVEMENT CENTERLINE MARKING HAS BEEN INSTALLED.

SIGN (35) IS PLACED AT APPROXIMATELY TWO-MILE INTERVALS AND AT STATE ROUTE JUNCTIONS. WHEN THE INSTALLATION AT A JUNCTION IS WITHIN ONE-EIGHTH MILE OF THE NORMAL MAINLINE SIGN (35), THE LATTER MAY BE ELIMINATED.

ALL SIGNS SHALL BE POST MOUNTED AND IN ACCORDANCE WITH
STANDARD PLAN 616.10 AND 903.03.

NOT TO SCALE

TRAFFIC CONTROL
SHEET 4 OF 5



Maria Peters
02/20/2024 8:40:24 AM
MARIA K. PETERS - CIVIL
MO-PE-2000162118

ROUTE	STATE
-------	-------

DISTRICT	SHEET NO.
CD	10

COUNTY
COLE

JOB NO.
JCD0043
CONTRACT ID.

PROJECT NO.

BRIDGE NO.

[illegible]MISSOURI HIGHWAYS AND TRANSPORTATION
COMMISSION

JEFFERSON CITY, MO 65102
1-888-ASK-MODOT (1-888-275-6636)



TRAFFIC CONTROL
SHEET 5 OF 5

[illegible]