

ADRIAN
OLD RTE 71
A.A.D.T. - 2023 = 555
V = 35 M.P.H.
FUNCTIONAL CLASSIFICATION - LOCAL

ADRIAN
RTE 18
A.A.D.T. - 2023 = 1541
V = 25 M.P.H.
FUNCTIONAL CLASSIFICATION - MAJOR COLLECTOR

BUTLER
BU LOOP 49
A.A.D.T. - 2023 = 7600
V = 35 M.P.H.
FUNCTIONAL CLASSIFICATION - MAJOR COLLECTOR

BUTLER
RTE 52
A.A.D.T. - 2023 = 7183
V = 45 M.P.H.
FUNCTIONAL CLASSIFICATION - MAJOR COLLECTOR

NO NEW R/W REQUIRED

CONVENTIONAL SYMBOLS
(USED IN PLANS)

	EXISTING	NEW
BUILDINGS AND STRUCTURES		
GUARD RAIL		
GUARD CABLE		
CONCRETE RIGHT-OF-WAY MARKER		
STEEL RIGHT-OF-WAY MARKER		
LOCATION SURVEY MARKER		
UTILITIES		
FIBER OPTICS	-FO-	-FO-
OVERHEAD CABLE TV	-OTV-	-OTV-
UNDERGROUND CABLE TV	-UTV-	-UTV-
OVERHEAD TELEPHONE	-OT-	-OT-
UNDERGROUND TELEPHONE	-UT-	-UT-
OVERHEAD POWER	-OE-	-OE-
UNDERGROUND POWER	-UE-	-UE-
SANITARY SEWER	-S-	-S-
STORM SEWER	-SS-	-SS-
GAS	-G-	-G-
WATER	-W-	-W-
MANHOLE		
FIRE HYDRANT		
WATER VALVE		
WATER METER		
DROP INLET		
DITCH BLOCK		
GROUND MOUNTED SIGN		
LIGHT POLE		
H-FRAME POWER POLE		
TELEPHONE PEDESTAL		
FENCE		
CHAIN LINK		
WOVEN WIRE		
GATE POST		
BENCHMARK		

NOTE: DASHED OR OPEN SYMBOLS INDICATE EXISTING FEATURES

MISSOURI HIGHWAYS AND TRANSPORTATION COMMISSION

PLANS FOR PROPOSED

STATE HIGHWAY

BATES COUNTY

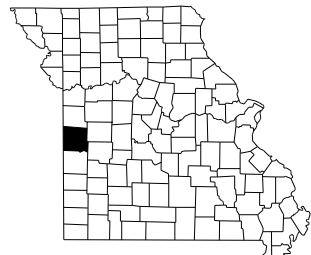

KEY MAP
LOCATION OF BATES COUNTY

OLD RTE 71
BEGIN LOG MILE
0.213 S

OLD RTE 71
END LOG MILE
0.234 S

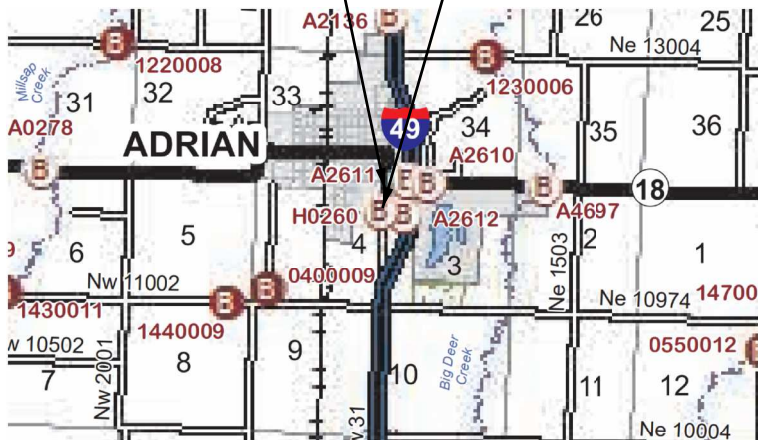

RTE 18
BEGIN LOG MILE
20.812 E

RTE 18
END LOG MILE
20.851 E

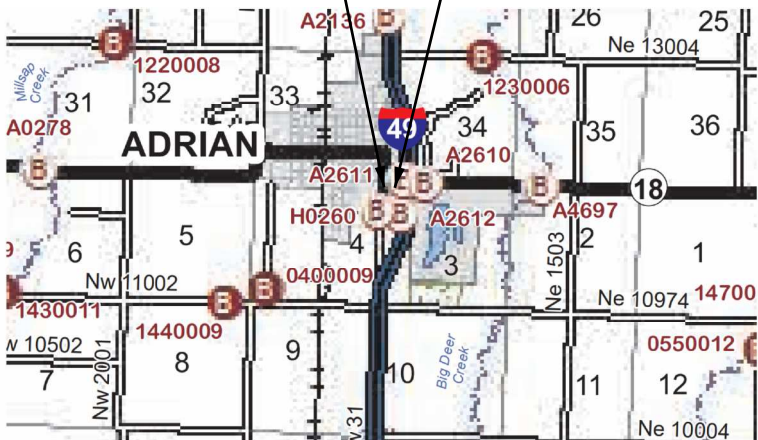

BU LOOP 49
BEGIN LOG MILE
1.507 N

BU LOOP 49
END LOG MILE
1.605 N

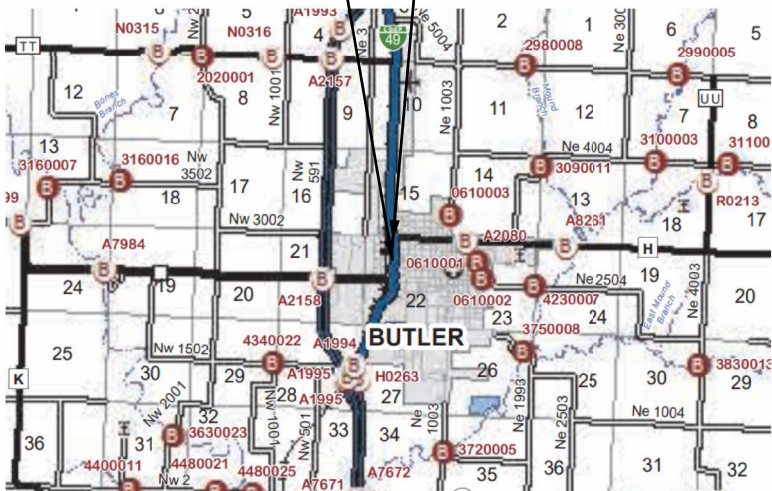

RTE 52
BEGIN LOG MILE
15.302 E

RTE 52
END LOG MILE
15.323 E

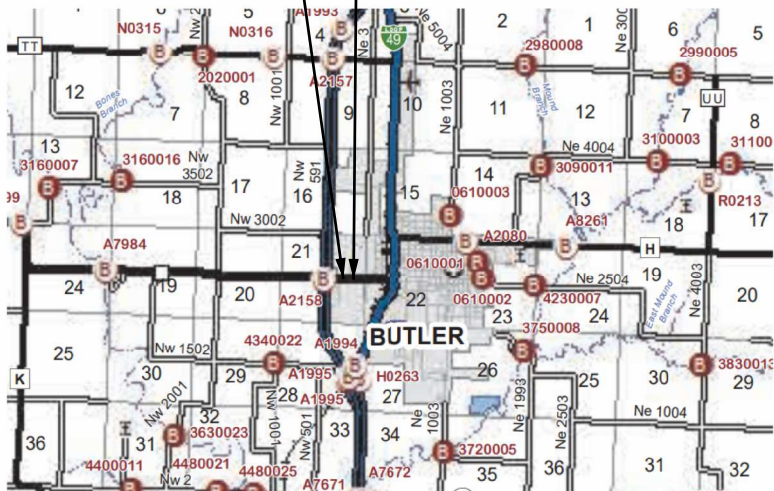

THE EXISTENCE AND APPROXIMATE LOCATION OF UTILITY FACILITIES KNOWN TO EXIST, AS SHOWN ON THE PLANS, ARE BASED ON THE BEST INFORMATION AVAILABLE TO THE COMMISSION AT THIS TIME. THIS INFORMATION IS PROVIDED BY THE COMMISSION "AS-IS" AND THE COMMISSION EXPRESSLY DISCLAIMS ANY REPRESENTATION OR WARRANTY AS TO THE COMPLETENESS, ACCURACY, OR SUITABILITY OF THE INFORMATION FOR ANY USE. RELIANCE UPON THIS INFORMATION IS DONE AT THE RISK AND PERIL OF THE USER, AND THE COMMISSION SHALL NOT BE LIABLE FOR ANY DAMAGES THAT MAY ARISE FROM ANY ERROR IN THE INFORMATION. IT IS, THEREFORE, THE RESPONSIBILITY OF THE CONTRACTOR TO VERIFY THE EXISTENCE, LOCATION AND STATUS OF ANY FACILITY. SUCH VERIFICATION INCLUDES DIRECT CONTACT WITH THE LISTED UTILITIES.

INDEX OF SHEETS

DESCRIPTION	SHEET NUMBER
TITLE SHEET -----	1
TYPICAL SECTIONS (TS) (6 SHEETS)---	2
QUANTITIES (QU) (2 SHEETS)-----	3
PLAN (PL)-----	4-7
TRAFFIC CONTROL SHEETS (TC)-----	8-10
SIGNAL SHEETS (SG)-----	11-15



THIS SHEET HAS BEEN
SIGNED, SEALED, AND DATED
ELECTRONICALLY

DATE PREPARED
3/18/2024

ROUTE
VAR MO

DISTRICT
SW

SHEET NO.
1

COUNTY
BATES

JOB NO.
J7P3511

CONTRACT ID.

PROJECT NO.

BRIDGE NO.

DESCRIPTION

DATE

DATE

DATE

DATE

DATE

DATE

DATE

DATE

DATE

DATE

DATE

DATE

DATE

DATE

DATE

DATE

DATE

DATE

DATE

DATE

DATE

DATE

DATE

DATE

DATE

DATE

DATE

DATE

DATE

DATE

LENGTH OF PROJECT

BEGINNING OF OLD RTE 71 LOG MILE - 0.213 S
END OF OLD RTE 71 LOG MILE - 0.234 S
APPARENT LENGTH 110.88 FEET

BEGINNING OF RTE 18 LOG MILE - 20.812 E
END OF RTE 18 LOG MILE - 20.851 E
APPARENT LENGTH 205.92 FEET

BEGINNING OF BU LOOP 49 LOG MILE - 1.507 N
END OF BU LOOP 49 LOG MILE - 1.605 N
APPARENT LENGTH 517.44 FEET

BEGINNING OF RTE 52 LOG MILE - 15.302 E
END OF RTE 52 LOG MILE - 15.323 E
APPARENT LENGTH 110.88 FEET

EQUATIONS AND EXCEPTIONS: NONE

TOTAL CORRECTIONS 0.00 FEET
NET LENGTH OF PROJECT 945.12 FEET
STATE LENGTH 0.179 MILES

FOR INFORMATION ONLY
ESTIMATED DISTURBED ACRES 0.1 ACRES

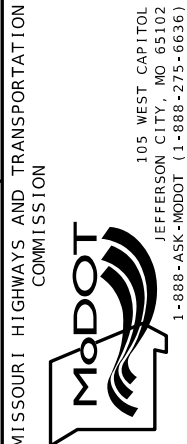

800 E 101st Terr., Ste. 200
Kansas City, MO 64131
Phone (816) 701-3100
Fax (816) 942-3013
Missouri Cert. of
Authority #2003007599

WILSON & COMPANY
ENGINEERS & ARCHITECTS

1. CONCRETE SIDEWALK, CURB RAMP AND DETECTABLE WARNING DEVICE (TRUNCATED DOMES) DETAILS SHALL CONFORM TO ADA REQUIREMENTS UNLESS NOTED OTHERWISE IN THESE PLANS. FOR SIDEWALK JOINT AND CURB DETAILS, SEE STANDARD PLAN 609.00.
2. TINTED CONCRETE SHALL NOT BE USED. TRUNCATED DOMES SHALL BE OF A COLOR CONTRASTING WITH UNTINTED CONCRETE AND APPROVED BY THE ENGINEER. TRUNCATED DOMES ARE REQ'D. AT STREET INTERSECTIONS AND COMMERCIAL ENTRANCES WITH TRAFFIC CONTROL ONLY. (STOP/YIELD SIGNS OR SIGNALS)
3. CONCRETE SHALL BE IN ACCORDANCE WITH SEC. 608 & SEC. 609. CURING COMPOUND SHALL BE TRANSPARENT.
4. ALL CONCRETE SIDEWALK AND CURB RAMP/TRANSITION/LANDING AREAS SHALL BE 4" THICK, WITH THE EXCEPTION OF THE BOTTOM TRANSITION WHICH TIES INTO THE EXISTING PAVED APPROACH AND ROADWAY. THIS TRANSITION, OR LANDING AREA, MUST BE 8" THICK IF IT FALLS WITHIN THE RADIUS OF THE APPROACH AND SITS AT THE BACK OF CURB OF THE ROADWAY. ALL CONCRETE SIDEWALK AND CURB RAMP/TRANSITION/LANDING AREAS SHALL BE ON 4" TYPE 1 AGGREGATE BASE.
5. AGGREGATE BASE DENSITY - CONTRACTOR SHALL EXERCISE GOOD COMPACTIVE EFFORT AS APPROVED BY THE ENGINEER. DENSITY REQUIREMENTS BY NUCLEAR METHOD WILL NOT BE REQUIRED DUE TO WORK AREA CONSTRAINTS.
6. CONCRETE CURB RAMP - WIDTH = 5' MIN. LENGTH = 5' MIN. TO 15' PREFERRED MAX. (16' MAX.)
RUNNING SLOPE = >5% (MIN.) TO 8.33% (MAX.) UNIFORMLY DOWN THE LENGTH OF THE RAMP.

CONCRETE LANDING - WIDTH = TO MATCH PROPOSED CURB RAMP AND SIDEWALK WIDTH LENGTH = 5' MIN.
SLOPE IN ALL DIRECTIONS = 1% PREFERRED (2% MAX.) UNLESS TIED TO ROADWAY EXCEPTION.
7. ALL EXISTING UTILITIES SHALL BE USED IN PLACE UNLESS OTHERWISE NOTED. ALL MANHOLE OR VALVE COVER, ETC. ELEVATIONS SHALL BE ADJUSTED AS REQUIRED IF THEY ARE LOCATED WITHIN THE IMPROVEMENT AREA.
8. "PREFORMED FIBER JOINT" SHALL BE IN ACCORDANCE WITH SEC. 1057 FOR PREFORMED FIBER JOINT EXPANSION JOINT FILLER.
9. REINFORCING STEEL TIE BARS SHALL BE IN ACCORDANCE WITH SECTION 706. ALL REINFORCING STEEL SHALL BE EPOXY COATED AND USED AS APPROVED BY THE ENGINEER. WHERE TIE BARS ARE USED, THE CONCRETE SHALL BE 8" THICK (NO DIRECT PAY).
10. CONSTRUCTION AND LENGTH OF EACH CURB RAMP INCLUDING LANDINGS AND TRANSITION AREAS SHALL BE AS SHOWN ON THE PLANS UNLESS DIFFERING FIELD CONDITIONS ARE FOUND OR AS APPROVED BY THE ENGINEER. CURB RAMP CROSS SLOPES SHALL BE 1% PREFERRED (2% MAX.) TOWARD THE STREET. CURB RAMPS ARE TO BE FORMED UP AND HAVE A TRUE AND STRAIGHT LINE.
11. SIDEWALK AND CONCRETE CURB SHALL BE POURED MONOLITHICALLY. THE CONTRACTOR SHALL MATCH EXISTING GROUND SLOPES ADJACENT TO THE CURB RAMPS OR USE AN ALTERNATE METHOD APPROVED BY THE ENGINEER.
12. S-CURB 12"-30" HIGH (MODIFIED S-CURB) WILL REQUIRE #4 REINFORC. BARS ON MAX. 12" CENTERS - SEE DETAIL (NO DIRECT PAY)
13. SODDED SLOPES AT EDGES OF SIDEWALK OR S-CURB SHOULD BE GRADED TO BE 6:1 MIN.

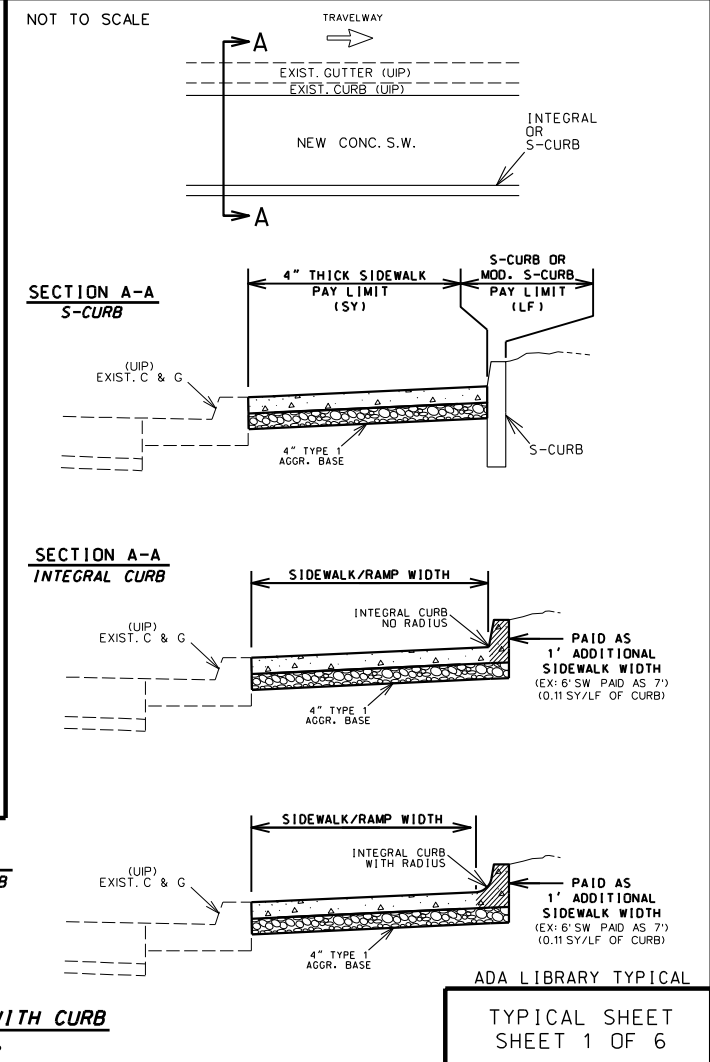
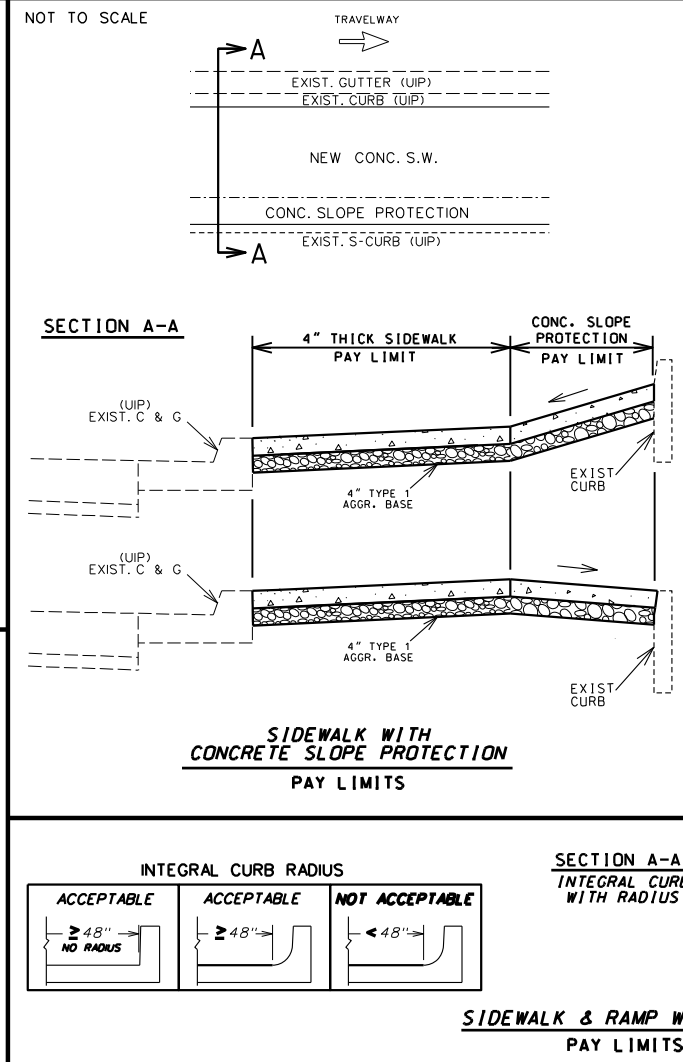
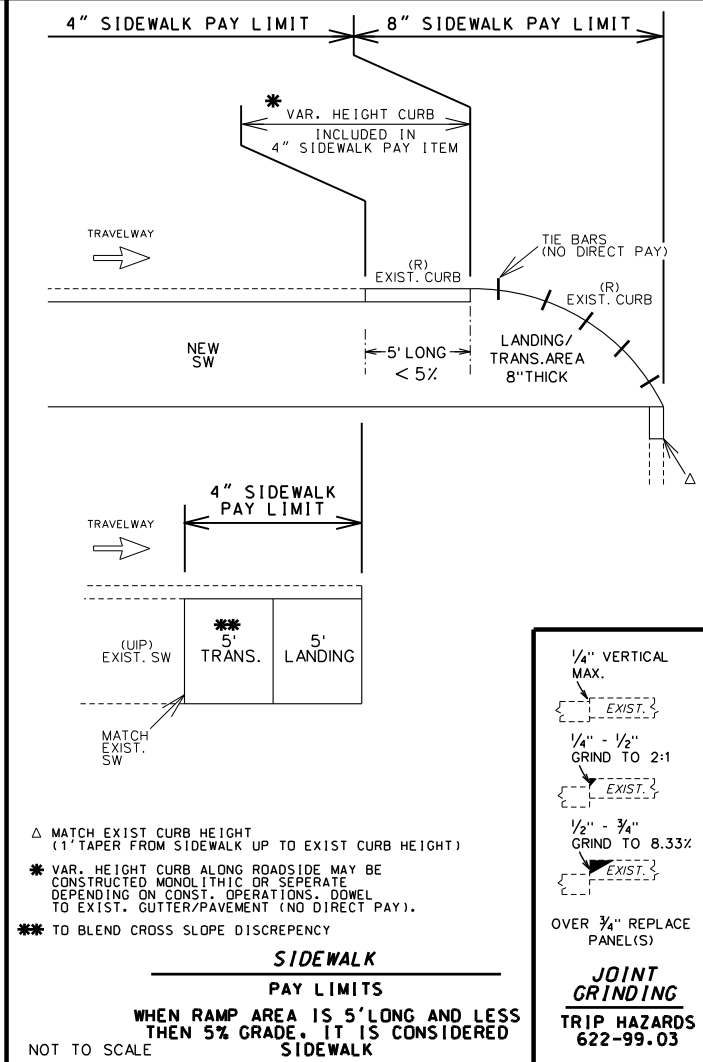
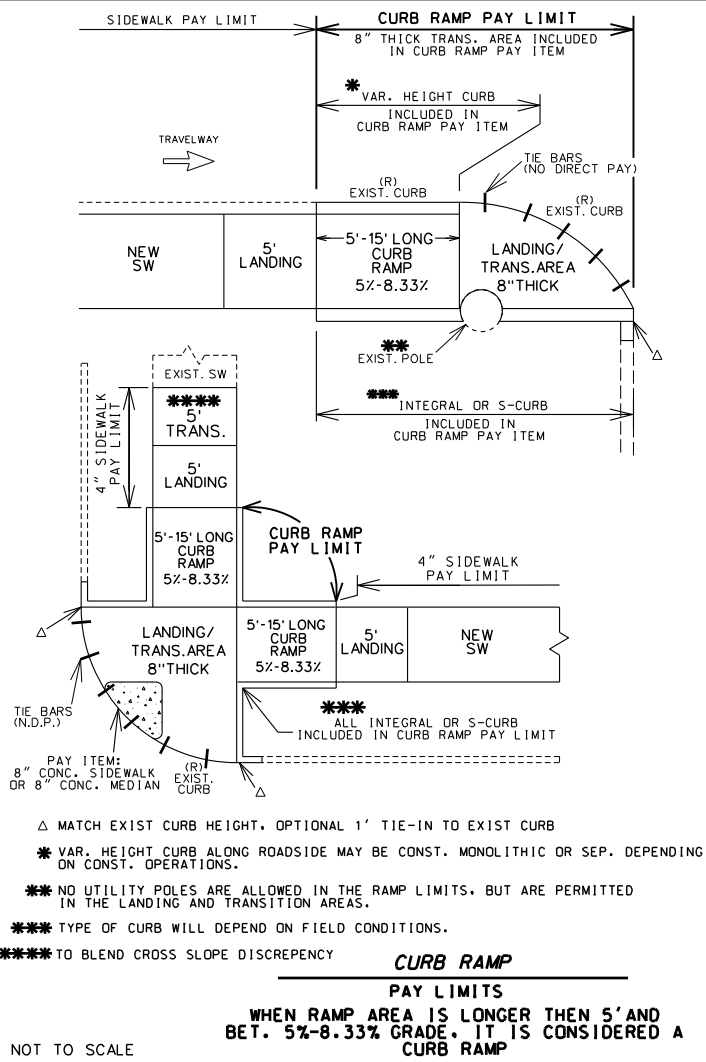
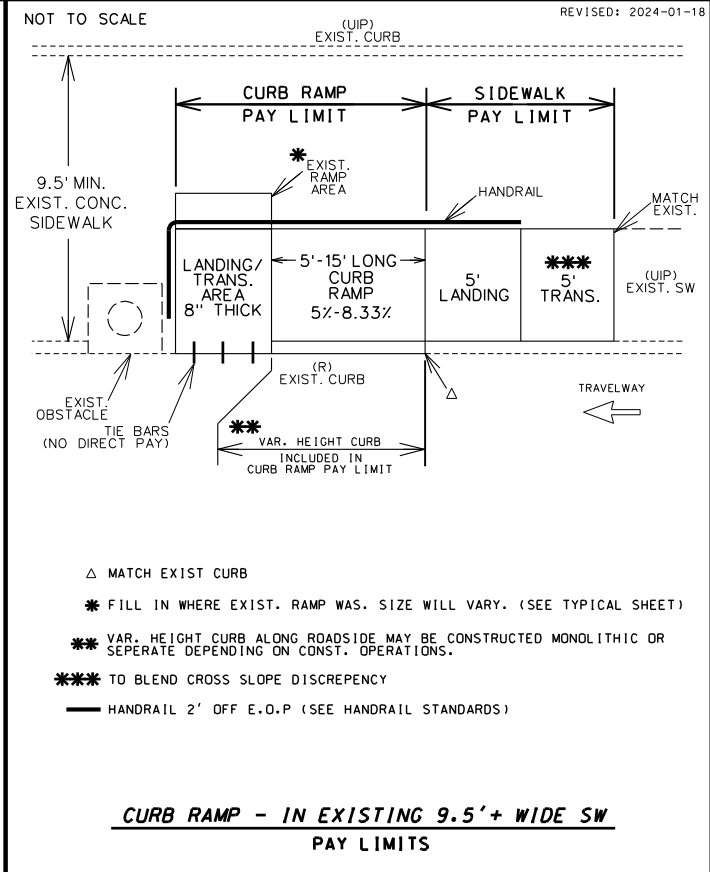
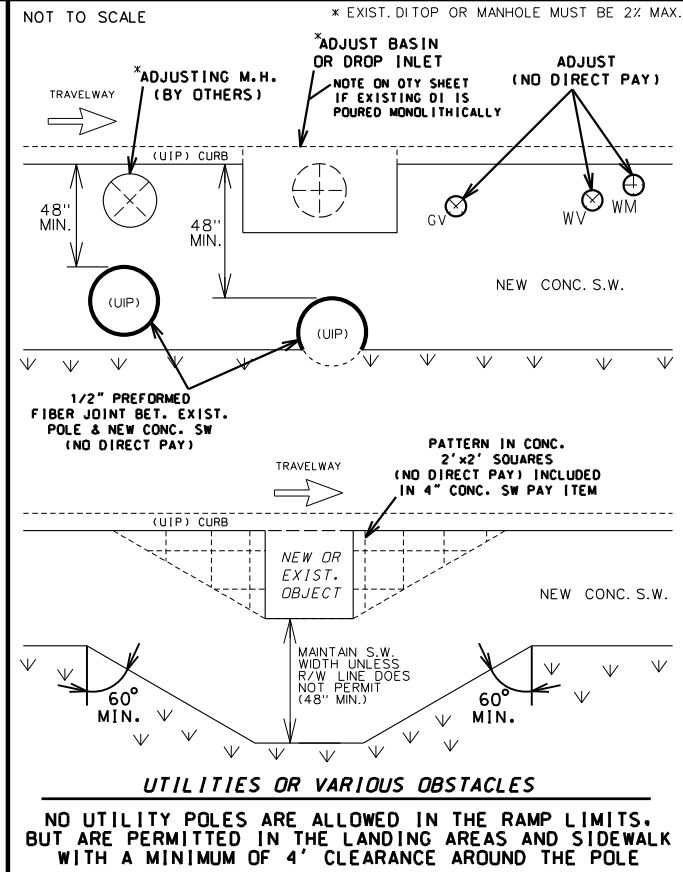

STATE OF MISSOURI

VESLEY A. O'NEAL

NUMBER PE-2018021231

PROFESSIONAL ENGINEER

THIS SHEET HAS BEEN SIGNED, SEALED, AND DATED ELECTRONICALLY

DATE PREPARED 3/18/2024

ROUTE VAR STATE MO

DISTRICT SW SHEET NO. 2

COUNTY BATES

JOB NO. J7P3511

CONTRACT ID.

PROJECT NO.

BRIDGE NO.

DESCRIPTION

DATE

MISSOURI HIGHWAYS AND TRANSPORTATION COMMISSION

MoDOT

105 WEST CAPITOL JEFFERSON CITY, MO 65102 1-888-ASK-MODOT (1-888-275-6636)

800 E 101st Terr., Ste. 200 Kansas City, MO 64131 Phone (816) 701-3100 Fax (816) 942-3013 Missouri Cert. of Authority #2003007599

WILSON & COMPANY

ENGINEERS & ARCHITECTS

PARALLEL - TYPE 2 (cont'd.)												
TYPE 2-G												
LENGTH (LF)	WIDTH (LF)	8			12			16			REMARKS	
		4	5	6	4	5	6	4	5	6		
TRUNCATED DOMES	SF	-	12.0	12.0	-	10.0	10.0	-	10.0	10.0		
CURB RAMP	SY	-	15.7	18.0	-	20.8	23.7	-	25.8	30.2		
CONC. SIDEWALK	SY	-	21.4	25.0	-	17.6	20.3	-	15.2	17.5		
TYPE 1 AGGREGATE	SY	-	37.1	43.0	-	38.4	44.0	-	41.0	47.7		
ADA LINEAR GRADING	LF	-	52.0	52.0	-	54.0	54.0	-	58.0	58.0		
SODDING	SY	-	13.6	13.6	-	13.7	13.5	-	14.5	14.9		

TYPE 2-H												
LENGTH (LF)	WIDTH (LF)	8			12			16			REMARKS	
		4	5	6	4	5	6	4	5	6		
TRUNCATED DOMES	SF	-	12.0	12.0	-	10.0	10.0	-	10.0	10.0		
CURB RAMP	SY	-	15.7	18.0	-	21.0	24.5	-	26.9	31.4		
CONC. SIDEWALK	SY	-	13.2	16.0	-	12.0	14.2	-	12.0	14.4		
TYPE 1 AGGREGATE	SY	-	28.9	34.0	-	33.0	38.6	-	38.9	45.8		
ADA LINEAR GRADING	LF	-	42.0	42.0	-	49.0	49.0	-	55.0	55.0		
SODDING	SY	-	11.1	11.2	-	12.5	12.5	-	14.5	14.9		

T* - IS STILL NEEDED EVEN IF THE EXISTING SIDEWALK IS THE SAME WIDTH AS THE NEW SIDEWALK. (IT WILL BLEND THE EXIST XSLOPE INTO THE NEW LANDING XSLOPE)

T - TRANSITION TO EXISTING SW

L - LANDING

R - RAMP

↓ ↓ - SOD SLOPE 6:1 MIN.

..... - TRUNCATED DOME LOCATION, IF DIST. IS <5' OR >5'

TRUNCATED DOMES ARE USED ONLY AT STREETS & ENTRANCES UTILIZING YIELD / STOP SIGNS OR SIGNALS

▨ - CURB RAMP PAY LIMITS

..... - INCLUDED IN 4" CONC. SIDEWALK PAY LIMIT

NOTE:
QUANTITIES ARE CALCULATED BY AREA AND MAY NOT MATCH EXACT FIELD CONDITIONS.

DATE PREPARED
3/18/2024

ROUTE
VAR

STATE
MO

DISTRICT
SW

SHEET NO.
2

COUNTY
BATES

JOB NO.
J7P3511

CONTRACT ID.
.

PROJECT NO.
.

BRIDGE NO.
.

DESCRIPTION

DATE

MISSOURI HIGHWAYS AND TRANSPORTATION COMMISSION

105 WEST CAPITOL
JEFFERSON CITY, MO 65102
1-888-ASK-MODOT (1-888-275-6636)

800 E 101st Terr., Ste. 200
Kansas City, MO 64131
Phone (816) 701-3100
Fax (816) 942-3013
Missouri Cert. of
Authority #2003007599

ADA LIBRARY TYPICAL

TYPE 2

PARALLEL CURB RAMPS

TYPICAL SHEET
4 OF 6

WILSON & COMPANY
ENGINEERS & ARCHITECTS

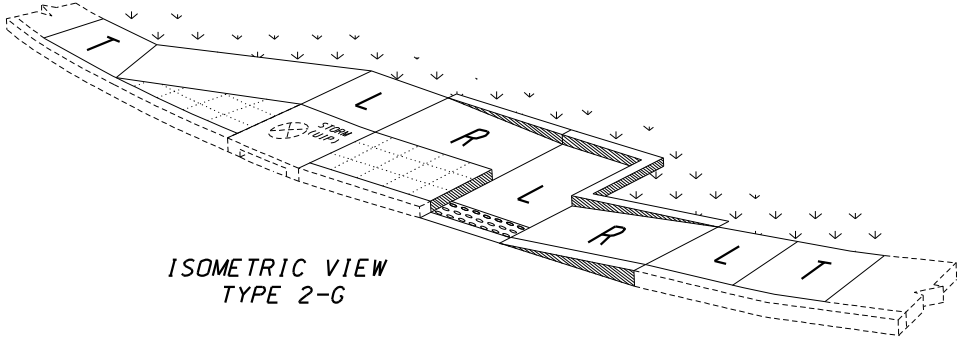

TYPE 2-G

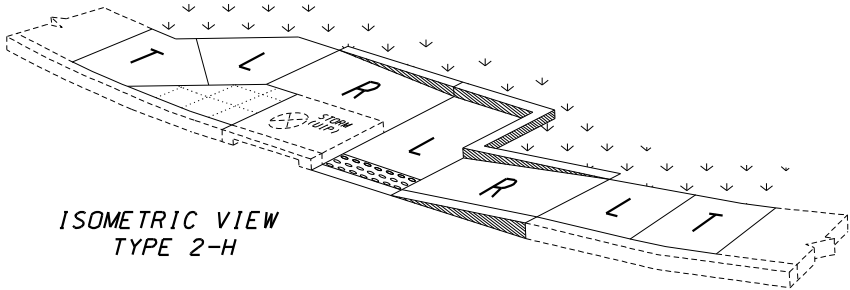

TYPE 2-H

DIAGONAL - TYPE 3											
TYPE 3-A											
LENGTH (LF) WIDTH (LF)		8			12			16			REMARKS
		4	5	6	4	5	6	4	5	6	
TRUNCATED DOMES	SF	-	24.0	28.0	-	20.6	25.0	-	20.6	25.0	
CURB RAMP	SY	-	24.4	27.0	-	26.9	31.2	-	32.2	37.4	
CONC. SIDEWALK	SY	-	11.2	12.8	-	9.8	11.4	-	9.8	11.4	
TYPE 1 AGGREGATE	SY	-	35.6	39.8	-	36.7	42.6	-	42.0	48.8	
ADA LINEAR GRADING	LF	-	51.0	51.0	-	59.0	59.0	-	67.0	67.0	
SODDING	SY	-	11.6	11.4	-	12.9	12.9	-	14.9	14.9	
8"SW OR MED STRIP	SY	-	3.0	2.2	-	3.0	2.2	-	3.0	2.2	
TYPE 3-B											
LENGTH (LF) WIDTH (LF)		8			12			16			REMARKS
		4	5	6	4	5	6	4	5	6	
TRUNCATED DOMES	SF	-	24.0	28.0	-	20.6	25.0	-	20.6	25.0	
CURB RAMP	SY	-	22.0	26.3	-	25.9	31.2	-	31.2	37.4	
CONC. SIDEWALK	SY	-	11.2	12.8	-	9.8	11.4	-	9.8	11.4	
TYPE 1 AGGREGATE	SY	-	33.2	39.1	-	35.7	42.6	-	41.0	48.8	
ADA LINEAR GRADING	LF	-	51.0	51.0	-	59.0	59.0	-	67.0	67.0	
SODDING	SY	-	15.2	15.3	-	17.1	17.5	-	20.1	20.5	
8"SW OR MED STRIP	SY	-	1.5	1.5	-	1.5	1.5	-	1.5	1.5	
TYPE 3-C											
LENGTH (LF) WIDTH (LF)		8			12			16			REMARKS
		4	5	6	4	5	6	4	5	6	
TRUNCATED DOMES	SF	-	20.0	24.0	-	20.0	24.0	-	20.0	24.0	
CURB RAMP	SY	-	20.7	26.8	-	25.1	31.5	-	30.4	37.7	
CONC. SIDEWALK	SY	-	11.2	12.8	-	9.8	11.4	-	9.8	11.4	
TYPE 1 AGGREGATE	SY	-	31.9	39.6	-	34.9	42.9	-	40.2	49.1	
ADA LINEAR GRADING	LF	-	51.0	51.0	-	58.0	58.0	-	67.0	67.0	
SODDING	SY	-	18.8	19.3	-	21.3	22.1	-	25.3	26.1	
8"SW OR MED STRIP	SY	-	1.0	1.6	-	1.0	1.6	-	1.0	1.6	
TYPE 3-D											
LENGTH (LF) WIDTH (LF)		8			12			16			REMARKS
		4	5	6	4	5	6	4	5	6	
TRUNCATED DOMES	SF	-	24.0	28.0	-	22.4	26.5	-	22.4	26.5	
CURB RAMP	SY	-	15.9	19.1	-	17.7	21.4	-	20.4	24.5	
CONC. SIDEWALK	SY	-	5.6	6.4	-	4.9	5.7	-	4.9	5.7	
TYPE 1 AGGREGATE	SY	-	21.5	25.5	-	22.6	27.1	-	25.3	30.2	
ADA LINEAR GRADING	LF	-	31.0	31.0	-	34.0	34.0	-	38.0	38.0	
SODDING	SY	-	12.6	12.9	-	13.5	14.0	-	15.5	16.0	
8"SW OR MED STRIP	SY	-	1.0	0.8	-	1.0	0.8	-	1.0	0.8	
TYPE 3-E											
LENGTH (LF) WIDTH (LF)		8			12			16			REMARKS
		4	5	6	4	5	6	4	5	6	
TRUNCATED DOMES	SF	-	20.0	24.0	-	20.0	24.0	-	20.0	24.0	
CURB RAMP	SY	-	17.2	19.8	-	17.7	21.4	-	20.4	24.5	
CONC. SIDEWALK	SY	-	8.4	10.7	-	7.3	9.4	-	7.3	9.4	
TYPE 1 AGGREGATE	SY	-	25.6	30.5	-	25.0	30.8	-	27.7	33.9	
ADA LINEAR GRADING	LF	-	30.0	30.0	-	35.5	35.5	-	39.5	39.5	
SODDING	SY	-	12.4	12.4	-	12.9	13.3	-	14.9	15.3	
8"SW OR MED STRIP	SY	-	1.6	1.6	-	1.6	1.6	-	1.6	1.6	

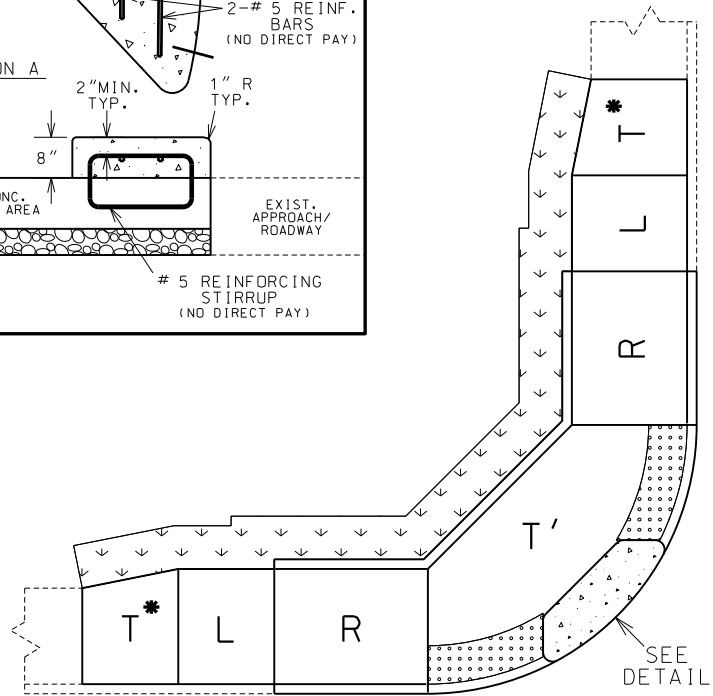
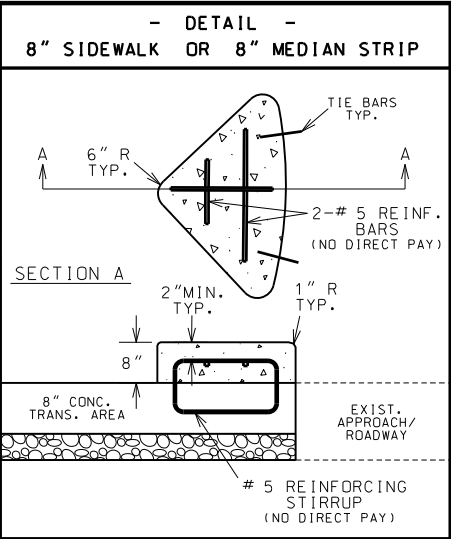

TYPE 3-A

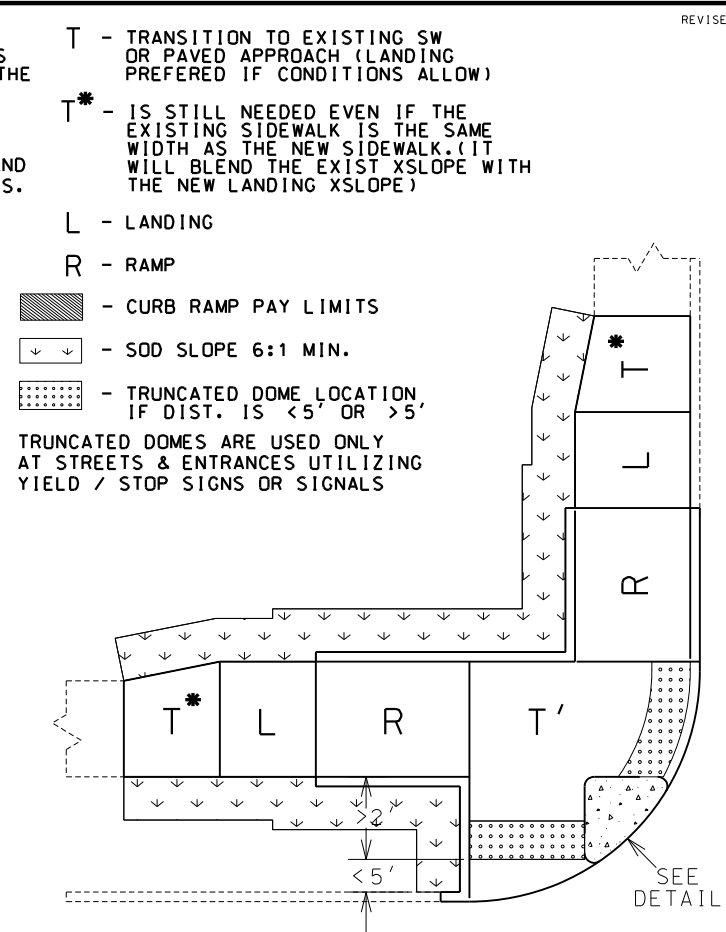

TYPE 3-B

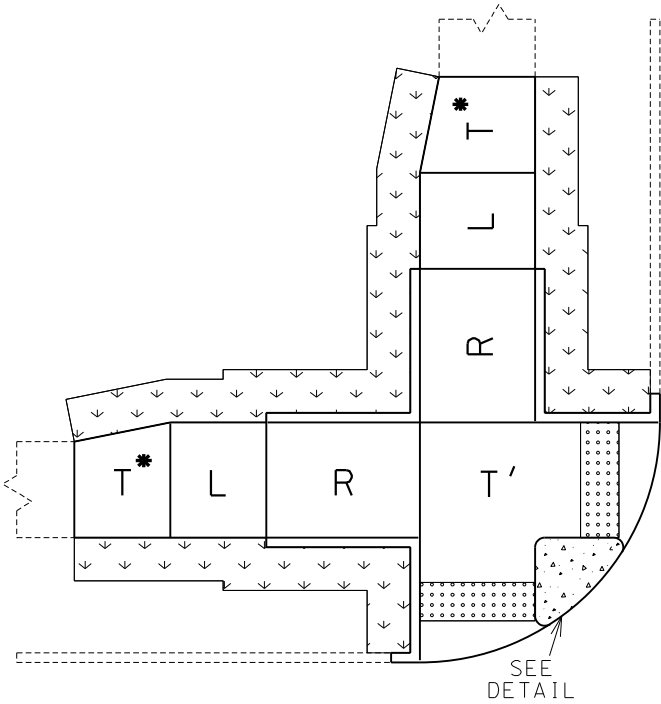

TYPE 3-C

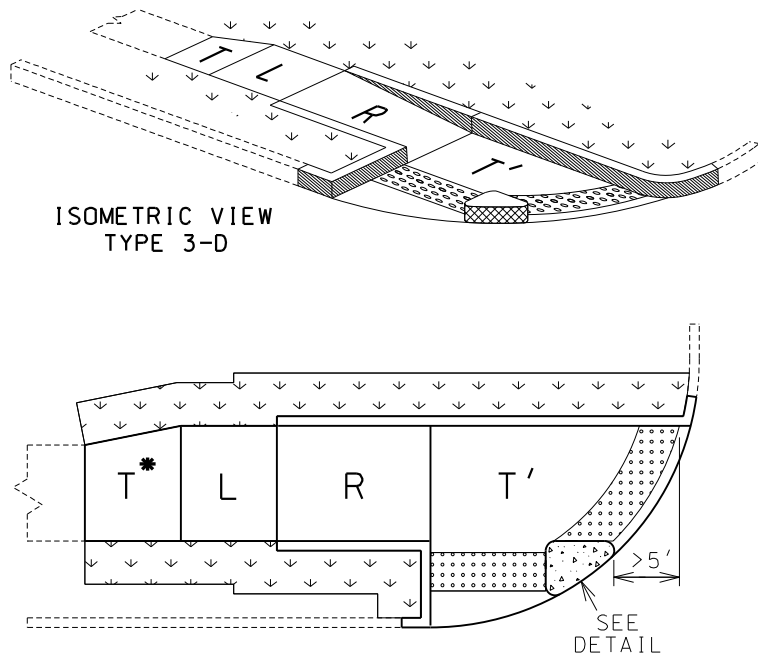

TYPE 3-D

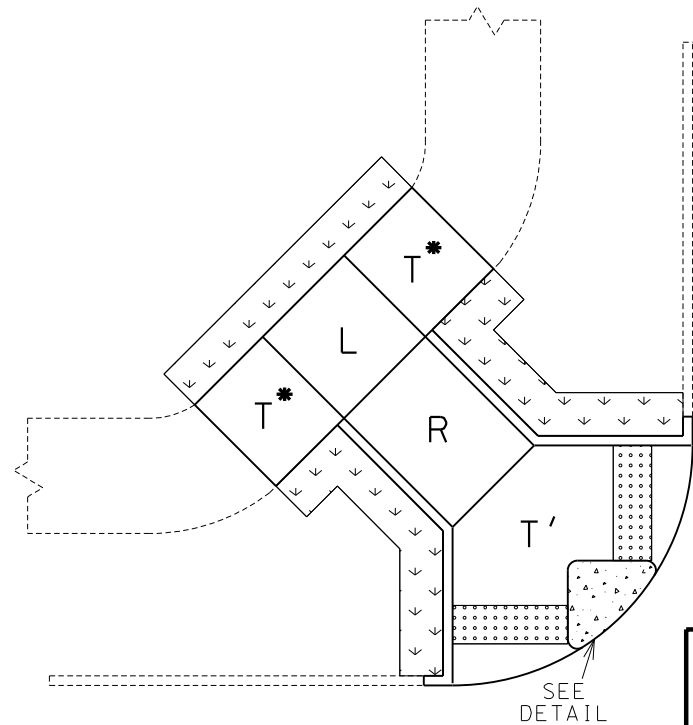

TYPE 3-E

ADA LIBRARY TYPICAL

TYPE 3

DIAGONAL CURB RAMPS

TYPICAL SHEET
5 OF 6

STATE OF MISSOURI
VESLEY A. O'NEAL
NUMBER
PE-2018021231
PROFESSIONAL ENGINEER
THIS SHEET HAS BEEN
SIGNED, SEALED, AND DATED
ELECTRONICALLY

DATE PREPARED
3/18/2024
ROUTE
VAR
STATE
MO
DISTRICT
SW
SHEET NO.
2
COUNTY
BATES
JOB NO.
J7P3511
CONTRACT ID.
PROJECT NO.
BRIDGE NO.

DESCRIPTION
DATE

MISSOURI HIGHWAYS AND TRANSPORTATION
COMMISSION
105 WEST CAPITOL
JEFFERSON CITY, MO 65102
1-888-ASK-MODOT (1-888-275-6636)
800 E 101st Terr., Ste. 200
Kansas City, MO 64131
Phone (816) 701-3100
Fax (816) 942-3013
Missouri Cert. of
Authority #2003007599
WILSON & COMPANY
ENGINEERS & ARCHITECTS

NOTES FOR MODIFIED SIDEWALK:

1. REMOVE EXIST. CURB & RAISED ISLAND WITHIN LIMITS SHOWN.
2. AREA INSIDE FINAL CURB TO BE REPAIRED OR REPLACED WITH EXISTING SURFACE MATERIAL. GRADE TO DRAIN.
3. CONSTRUCT 8" THICK CONC. SIDEWALK FLUSH WITH EXIST. CONC. PAVED APPROACH.
4. CONSTRUCT CURB ADJACENT TO MODIFIED SIDEWALK.
5. MODIFIED SIDEWALK PAID FOR AS 8" SIDEWALK.
6. 6' MINIMUM WIDTH.
7. NO DIRECT PAY FOR SAW CUTS AND TIE BARS (ON 12" CENTERS MAX.)
8. TRUNCATED DOMES ARE USED ONLY AT STREETS & ENTRANCES UTILIZING STOP SIGNS OR SIGNALS.
9. X-SLOPE 1% PREFERRED (2% MAX.)
10. USE S-CURB IF CONSTRUCTING CURB ON R/W LINE.

* INTEGRAL CURB IS PAID FOR WITH THE 8" CONC. SIDEWALK PAY ITEM.
INTEGRAL CURB IS PAID AS 1' ADDITIONAL SIDEWALK WIDTH (EX. 6'SIDEWALK PAID AS 7') (0.11 SY/LF OF CURB)

SECTION A-A
WITH S-CURB OR MODIFIED S-CURB

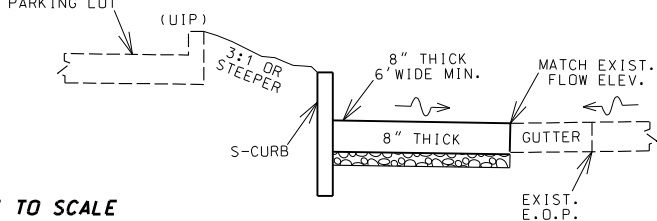

SECTION A-A
WITH INTEGRAL CURB

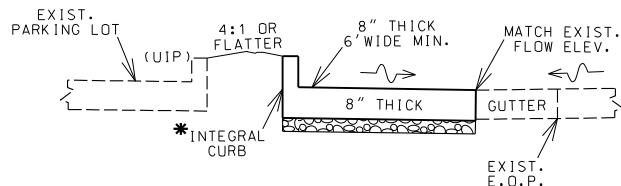

TYPICAL
MODIFIED SIDEWALK
8" THICK

** TRUNCATED DOMES ARE USED ONLY AT STREETS & ENTRANCES UTILIZING STOP/YIELD SIGNS OR SIGNALS.

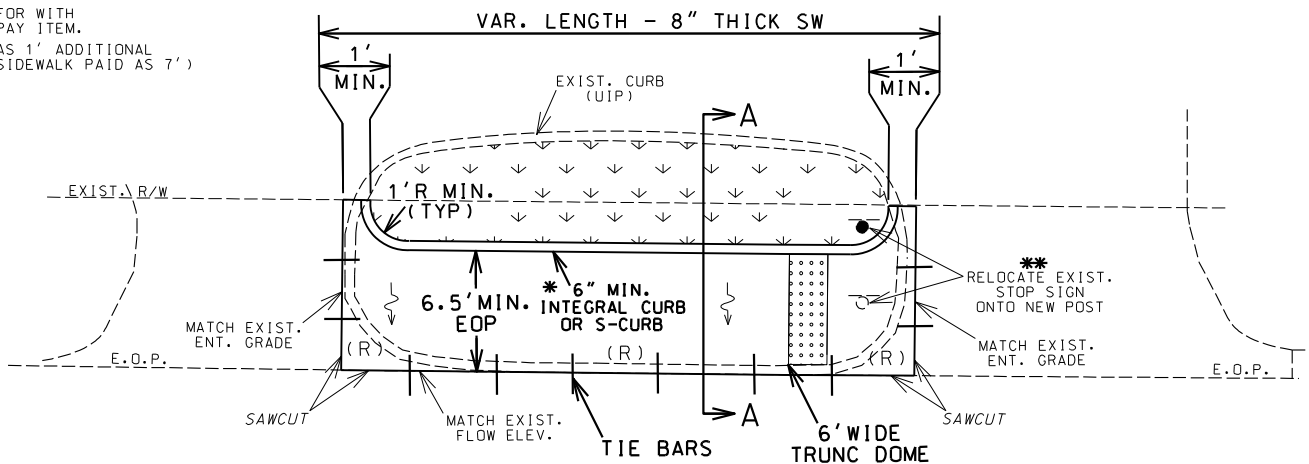

NOTES FOR CUT-THRU SIDEWALK:

1. REMOVE EXIST. CURB & RAISED ISLAND WITHIN LIMITS SHOWN.
2. AREA INSIDE FINAL CURB TO BE REPAIRED OR REPLACED WITH EXISTING SURFACE MATERIAL. GRADE TO DRAIN.
3. CONSTRUCT 4" THICK CONC. SIDEWALK FLUSH WITH EXIST. CONC. PAVED APPROACH.
4. CONSTRUCT CURB ON BOTH SIDES ADJACENT TO SIDEWALK.
5. CUT-THRU SIDEWALK PAID FOR AS 4" SIDEWALK.
6. 6' PREFERRED WIDTH (5' MIN.)
7. SAW CUTS (NO DIRECT PAY).
8. TRUNCATED DOMES ARE USED ONLY AT STREETS & ENTRANCES UTILIZING STOP SIGNS OR SIGNALS.
9. X-SLOPE 1% PREFERRED (2% MAX.)
10. USE S-CURB IF CONSTRUCTING CURB ON R/W LINE.

* INTEGRAL CURB IS PAID FOR AS 4" CONC. SIDEWALK PAY ITEM. S-CURB IS PAID FOR AS ITS OWN PAY ITEM.
(ALWAYS USE S-CURB IF AT R/W LINE.)
INTEGRAL CURB IS PAID AS 1' ADDITIONAL SIDEWALK WIDTH (EX. 6'SIDEWALK PAID AS 7') (0.11 SY/LF OF CURB)

TYPICAL
CUT-THRU SIDEWALK

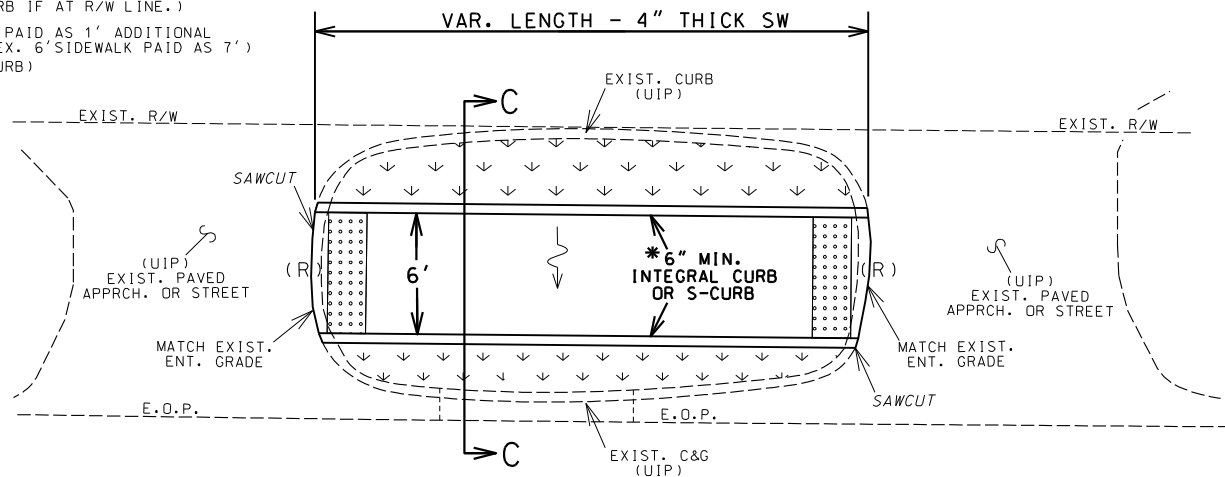

SECTION C-C
WITH S-CURB OR INTEGRAL

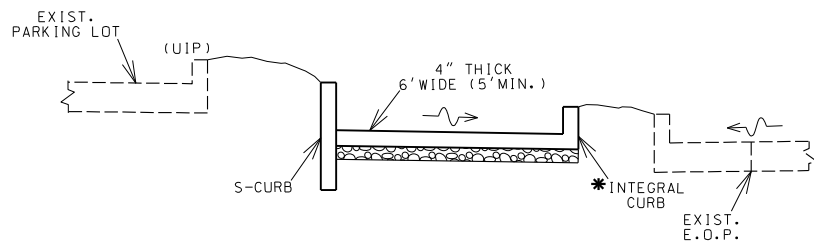

TYPICAL
ISLAND CUT-THRU SIDEWALK
X-SLOPE 2% MAX. CONSTRUCT TO DRAIN

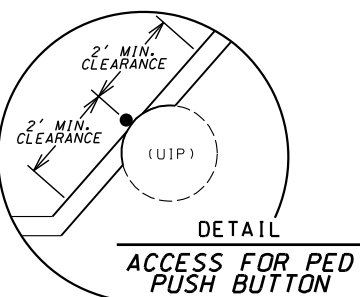
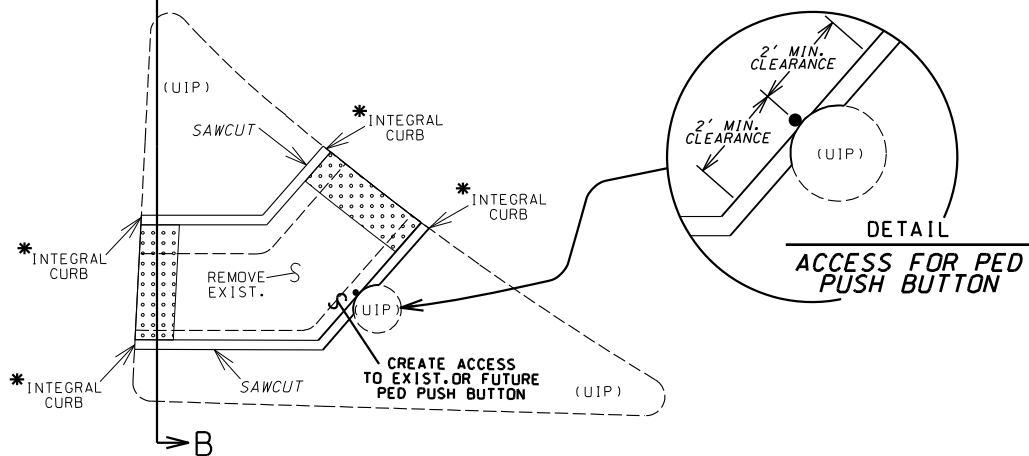

SECTION B-B
ISLAND CUT-THRU SIDEWALK
FOR EXISTING 'PINNED-ON' ISLAND

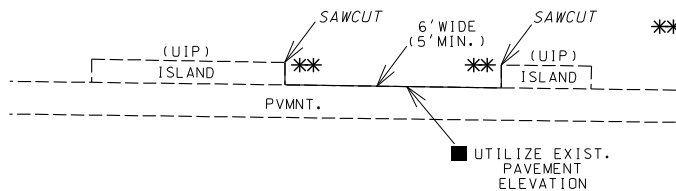

■ SMALL QTY. HAS BEEN INCLUDED FOR 8" THICK SIDEWALK TO ADDRESS ANY UNFORSEEN PVMNT. REPAIRS OR DIFFERENCES IN ELEVATION. (UNDERRUN IF FIELD CONDITIONS DO NOT WARRANT)

** NO INTEGRAL CURB, AGGR. OR LIN. GRADING REQUIRED IF THE ISLAND IS 'PINNED-ON'

* INTEGRAL CURB IS PAID FOR WITH THE 4" CONC. SIDEWALK PAY ITEM.
INTEGRAL CURB IS PAID AS 1' ADDITIONAL SIDEWALK WIDTH (EX. 6'SIDEWALK PAID AS 7') (0.11 SY/LF OF CURB)

SECTION B-B
ISLAND CUT-THRU SIDEWALK

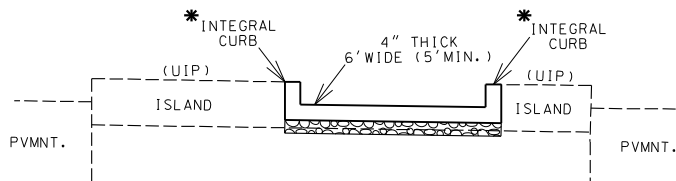

ADA LIBRARY TYPICAL

MODIFIED SIDEWALK
AND
SIDEWALK CUT-THRUS

TYPICAL SHEET
6 OF 6

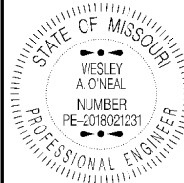

DATE PREPARED 3/18/2024	
ROUTE VAR	STATE MO
DISTRICT SW	SHEET NO. 2
COUNTY BATES	
JOB NO. J7P3511	
CONTRACT ID.	
PROJECT NO.	
BRIDGE NO.	

DESCRIPTION	DATE

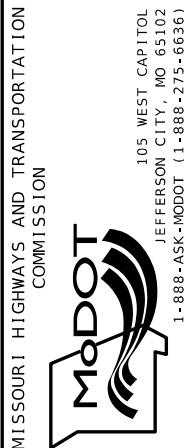

800 E 101st Terr., Ste. 200
Kansas City, MO 64131
Phone (816) 701-3100
Fax (816) 942-3013
Missouri Cert. of
Authority #2003007599



MOBILIZATION - 1 LUMP SUM

CONTRACTOR FURNISHED SURVEYING AND STAKING -1 LUMP SUM

CLEARING AND GRUBBING AT NO DIRECT PAY

CONCRETE SIDEWALK												
SHEET	LOCATION			CONCRETE CURB RAMP				CONCRETE SIDEWALK 4 " (SY)	TRUNCATED DOMES (SF)	4" TYPE 1 AGG BASE (SY)	ADA LINEAR GRADING CLASS 1 (STA)	REMARKS
				LENGTH	WIDTH	TYPE	SY					
4	OLD RTE 71 & RTE 18		ADRIAN					137.0	36.0	137.0	2.0	
5	LOOP 49	NW	BUTLER	6.5	5.0	3-C	6.6	10.2	20.0	14.7	0.1	
5	LOOP 49	SW	BUTLER	5.0	6.0	1-B	3.2	7.9	13.0	11.1	0.1	
5	LOOP 49	SW	BUTLER	6.0	5.0	1-C	3.6	2.2	10.0	5.8	0.1	
5	LOOP 49	NE	BUTLER	10.0	5.0	1-A	7.4	2.4	10.0	7.4	0.1	
5	LOOP 49	SE	BUTLER	9.5	5.0	1-A	3.7	2.8	10.0	6.5	0.1	
6	LOOP 49	NW	BUTLER	5.0	5.0	1-C	3.3	7.5	10.0	6.1	0.1	
6	LOOP 49	SW	BUTLER	4.0	5.0	1-C	2.2	7.8	10.0	5.0		
6	LOOP 49	NE	BUTLER	9.0	5.0	1-C	6.1	3.6	10.0	9.7	0.1	
6	LOOP 49	SE	BUTLER	13.0	5.0	1-C	8.5	5.3	10.0	11.3	0.1	
			TOTAL				44.7	186.6	139.0	231.3	2.8	
			USE							232		

SODDING			
SHEET	LOCATION	SODDING (SY)	REMARKS
4	ADRIAN	55.6	
5	BUTLER	42.8	
6	BUTLER	29.4	
	TOTAL	128.0	

SIGN RELOCATION					
SHEET	LOCATION			EXISTING SIGN RELOCATION (EA)	REMARKS
5	LOOP 49	LT	BUTLER	1.0	STOP SIGN
			TOTAL	1.0	

PAVEMENT MARKING						
SHEET	LOCATION			PREFORMED THERMOPLASTIC PAVEMENT MARKING 24 IN. STOP BAR (LF)	PREFORMED THERMOPLASTIC PAVEMENT MARKING 30 IN. MIDBLOCK (EA)	PAVEMENT MARKING REMOVAL (SY)
				(LF)	(EA)	(EA)
6	LOOP 49	LT	BUTLER		3.0	3.0
6	LOOP 49	RT	BUTLER		4.0	4.0
7	RTE 52		BUTLER	96.0	44.0	
			TOTAL	96.0	51.0	7.0

CURB				
SHEET	LOCATION			CONCRETE CURB 6 IN. AND UNDER TYPE S (LF)
				REMARKS
5	LOOP 49	LT	BUTLER	31.0
5	LOOP 49	RT	BUTLER	11.0
6	LOOP 49	LT	BUTLER	10.0
			TOTAL	52.0

CONCRETE					
SHEET	LOCATION			8 IN. CONCRETE (SY)	REMARKS
6	LOOP 49	RT	BUTLER	6.0	PARKING LOT TIE-IN
			TOTAL	6.0	

EROSION CONTROL INLET CHECK				
SHEET	LOCATION		INLET CHECK	REMARKS
5	LT	BUTLER	1	
6	RT	BUTLER	1	
		TOTAL	2	

REMOVAL OF IMPROVEMENTS			
SHEET	LOCATION	DESCRIPTION	REMARKS
4	ADRIAN	APPROX 137 SY SIDEWALK	
5-7	BUTLER	APPROX 30 SY SIDEWALK	
5-7	BUTLER	APPROX 10 SY BRICK SURFACING REMOVAL	
	TOTAL	LUMP SUM 1	ALL VERTICAL SAW CUTS SHALL BE INCIDENTAL TO REMOVALS

STATE OF MISSOURI

WESLEY A. O'NEAL

NUMBER PE-2016021231

PROFESSIONAL ENGINEER

THIS SHEET HAS BEEN SIGNED, SEALED, AND DATED ELECTRONICALLY

DATE PREPARED

3/18/2024

ROUTE

VAR

DISTRICT

SW

STATE

MO

SHEET NO.

3

COUNTY

BATES

JOB NO.

J7P3511

CONTRACT ID.

PROJECT NO.

BRIDGE NO.

DESCRIPTION

DATE

MISSOURI HIGHWAYS AND TRANSPORTATION COMMISSION

800 E 101st Terr., Ste. 200
Kansas City, MO 64131
Phone (816) 701-3100
Fax (816) 942-3013

105 WEST CAPITOL
JEFFERSON CITY, MO 65102
1-888-ASK-MODOT (1-888-275-6636)

WILSON & COMPANY

ENGINEERS & ARCHITECTS

Missouri Cert. of Authority #2003007599



LEGEND

- CONCRETE SIDEWALK
- TRUNCATED DOMES
- SIDEWALK SECTION
- RAMP
- TRANSITION
- LANDING

CP 1 - 5/8" REBAR WITH ALUMINUM CAP		
SW COR. OF E 1ST ST. & S OLD US HWY 71		
N 811,088.057 E 2,833,295.387 ELEV. 849.87		
1. STOP SIGN POST	±21.40' NW	
2. FENCE POST CORNER	±42.30' SW	
3. EDGE OF PAVEMENT	±11.70' E	

BATES COUNTY-ADRIAN
PLAN SHEET
SHEET 1 OF 4

STATE OF MISSOURI

VESLEY A. O'NEAL

NUMBER PE-018021231

PROFESSIONAL ENGINEER

THIS SHEET HAS BEEN SIGNED, SEALED, AND DATED ELECTRONICALLY

DATE PREPARED

3/18/2024

ROUTE

VAR

STATE

MO

DISTRICT

SW

SHEET NO.

4

COUNTY

BATES

JOB NO.

J7P3511

CONTRACT ID.

PROJECT NO.

BRIDGE NO.

DESCRIPTION

DATE

MISSOURI HIGHWAYS AND TRANSPORTATION COMMISSION

105 WEST CAPITOL

JEFFERSON CITY, MO 65102

1-888-ASK-MODOT (1-888-275-6636)

800 E 101st Terr., Ste. 200

Kansas City, MO 64131

Phone (816) 701-3100

Fax (816) 942-3013

Missouri Cert. of Authority #2003007599

WILSON & COMPANY

ENGINEERS & ARCHITECTS

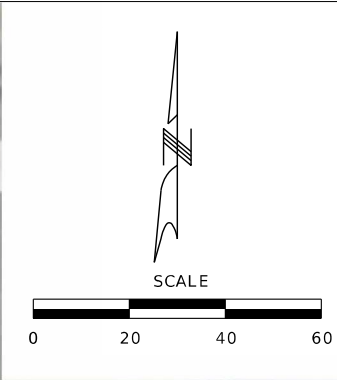

LEGEND

CONCRETE SIDEWALK

TRUNCATED DOMES

Ⓢ

SIDEWALK SECTION

Ⓡ

RAMP

Ⓣ

TRANSITION

Ⓛ

LANDING

CP 4 - 5/8" REBAR WITH ALUMINUM CAP
N SIDE OF W ENTRANCE TO 115 N ORANGE ST
N 762,229.971 E 2,833,747.549 ELEV. 844.49
1. BACK OF CURB ±3.10' W
2. PI IN CURB ±12.60' SSE
3. BACK OF CURB ±5.20' E
4. SW COR. CURB INLET ±37.40' N

BATES COUNTY-BUTLER
PLAN SHEET
SHEET 2 OF 4

STATE OF MISSOURI

VESLEY A. O'NEAL

NUMBER PE-016821231

PROFESSIONAL ENGINEER

THIS SHEET HAS BEEN SIGNED, SEALED, AND DATED ELECTRONICALLY.

DATE PREPARED 3/18/2024

ROUTE VAR

DISTRICT SW

STATE MO

SHEET NO. 5

COUNTY BATES

JOB NO. J7P3511

CONTRACT ID.

PROJECT NO.

BRIDGE NO.

DESCRIPTION

DATE

MISSOURI HIGHWAYS AND TRANSPORTATION COMMISSION

MoDOT

105 WEST CAPITOL JEFFERSON CITY, MO 65102 1-888-ASK-MODOT (1-888-275-6636)

800 E 101st Terr., Ste. 200 Kansas City, MO 64131 Phone (816) 701-3100 Fax (816) 942-3013 Missouri Cert. of Authority #2003007599

WILSON & COMPANY

ENGINEERS & ARCHITECTS

005_PL_01-04_J7P3511_120_002.dgn 10:32:37 AM 3/18/2024

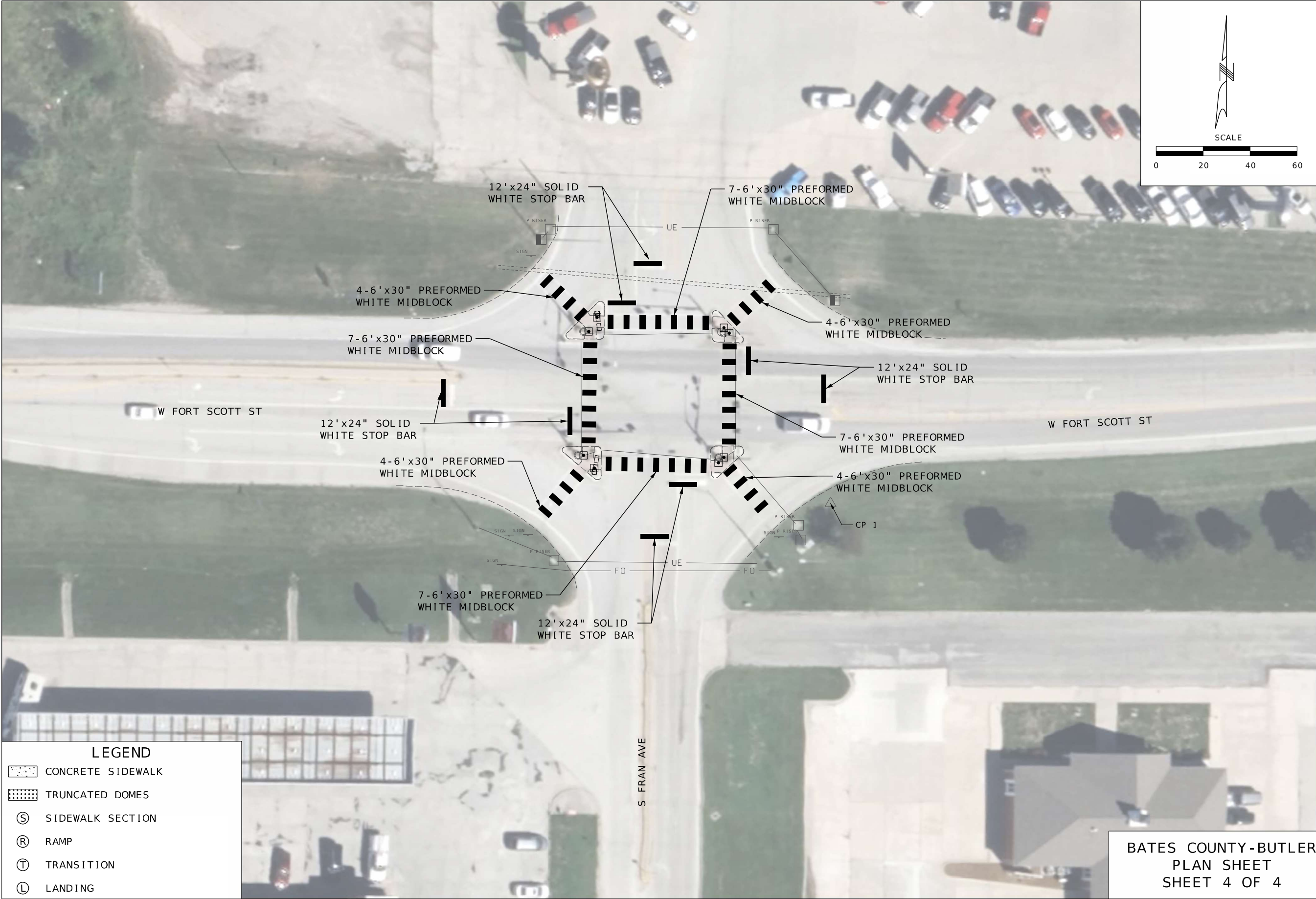

LEGEND

CONCRETE SIDEWALK

TRUNCATED DOMES

Ⓢ

SIDEWALK SECTION

Ⓐ

RAMP

Ⓣ

TRANSITION

Ⓛ

LANDING

BATES COUNTY-BUTLER
PLAN SHEET
SHEET 4 OF 4

STATE OF MISSOURI

VESLEY A. O'NEAL

NUMBER PE-016821231

PROFESSIONAL ENGINEER

THIS SHEET HAS BEEN SIGNED, SEALED, AND DATED ELECTRONICALLY.

DATE PREPARED 3/18/2024

ROUTE VAR

STATE MO

DISTRICT SW

SHEET NO. 7

COUNTY BATES

JOB NO. J7P3511

CONTRACT ID.

PROJECT NO.

BRIDGE NO.

DESCRIPTION

DATE

MISSOURI HIGHWAYS AND TRANSPORTATION COMMISSION

105 WEST CAPITOL

JEFFERSON CITY, MO 65102

1-888-ASK-MODOT (1-888-275-6636)

800 E 101st Terr., Ste. 200

Kansas City, MO 64131

Phone (816) 701-3100

Fax (816) 942-3013

Missouri Cert. of Authority #2003007599

WILSON & COMPANY

ENGINEERS & ARCHITECTS

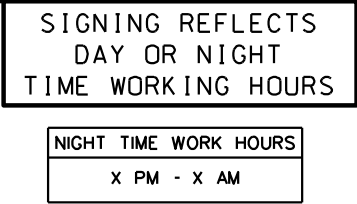

EFFECTIVE: 06-08-2016
REVISED (ADA): 01-23-2023

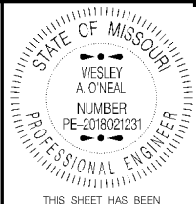

DATE PREPARED	
3/18/2024	
ROUTE	STATE
VAR	MO
DISTRICT	SHEET NO.
SW	9
COUNTY	
BATES	
JOB NO.	
J7P3511	
CONTRACT ID.	
.	
PROJECT NO.	
.	
BRIDGE NO.	

[illegible]

MISSOURI HIGHWAYS AND TRANSPORTATION
COMMISSION

105 WEST CAPITAL
JEFFERSON CITY, MO 65102
1-888-ASK-MODOT (1-888-275-6636)

WILSON
& COMPANY
ENGINEERS & ARCHITECTS

800 E 101st Terr., Ste. 2000
Kansas City, MO 64131
Phone (816) 701-3100
Fax (816) 942-3013

Missouri Cert. of
Authority #2003007599

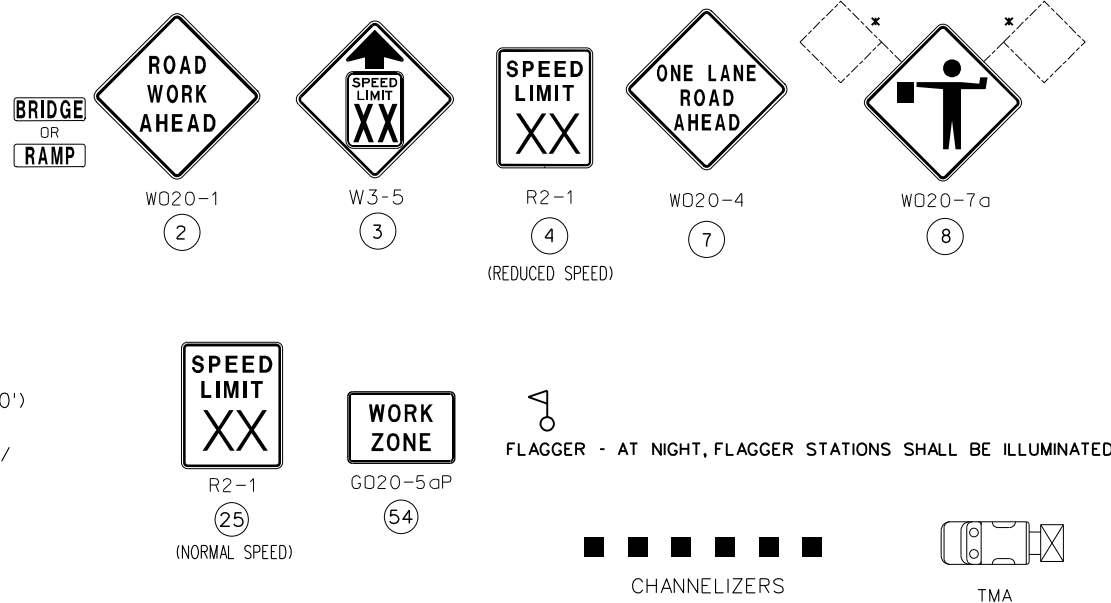

* SIGN W020-7A (FLAGGER SYMBOL) FLAGS ARE INCIDENTAL TO THE SIGN. NO DIRECT PAY.

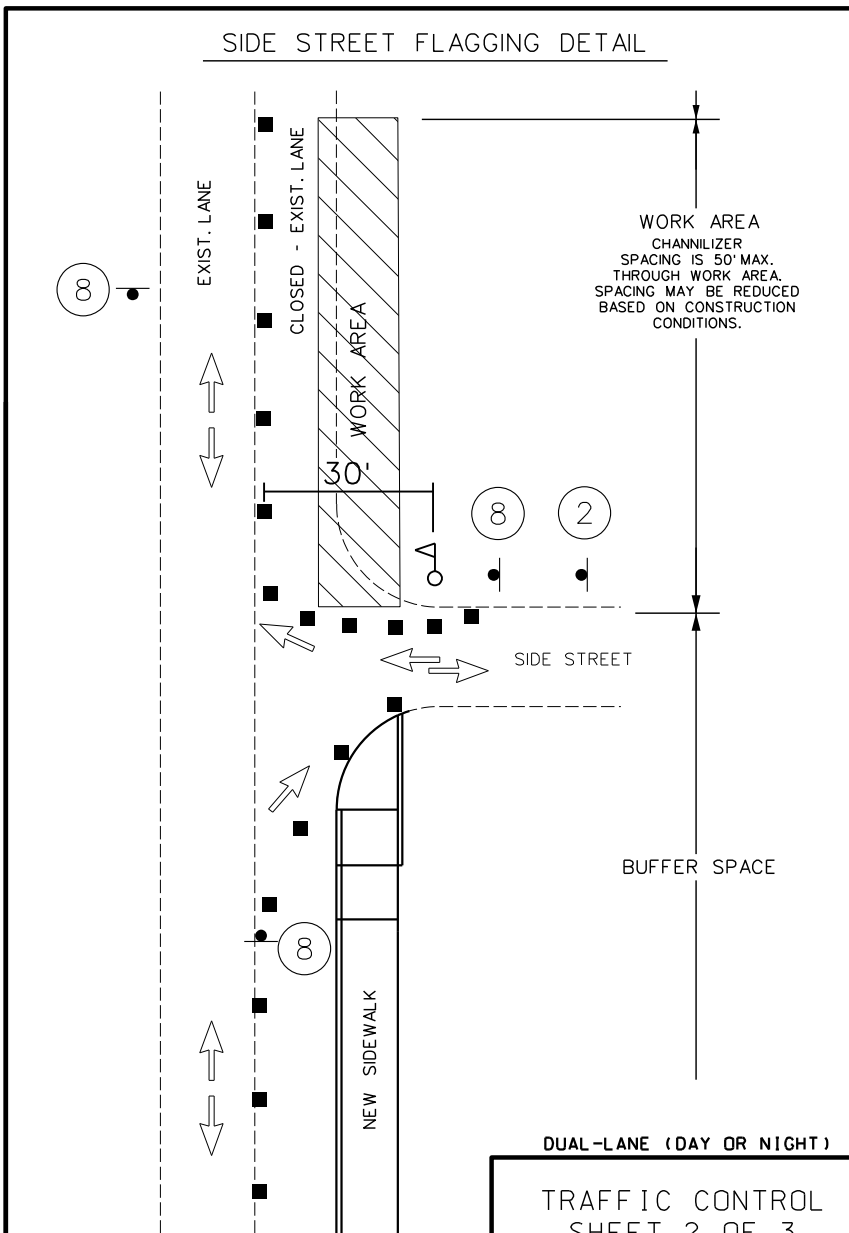

NOT TO SCALE

1. NO DIRECT PAYMENT WILL BE MADE FOR ORANGE SAFETY FENCE AS REQUIRED AROUND EXCAVATION OF SIDEWALK & CURB RAMP AREAS.
2. SEE JSP's FOR PEDESTRIAN TRAFFIC DEVICES.
3. WORKING AREAS SHALL BE GUARDED FROM PEDESTRIAN ACCESS BY BARRICADE FENCING 36" TO 48" IN HEIGHT WITH A GAP NO GREATER THAN 6" FROM THE GROUND AND HOLES NO GREATER THAN 4" IN ANY DIRECTION.
4. PEDESTRIAN ACCESS ON SIDEWALK SHALL BE PROVIDED WITH A WIDTH NOT LESS THAN 4' OF SMOOTH STABLE SURFACING ADJACENT TO BARRICADE FENCING FOR ACCESS TO THE MAIN BUILDING.
5. SIDEWALK RAMP CLOSURES FOR RECONSTRUCTION SHALL BE PERFORMED WITH ADA COMPLIANT MOVEABLE BARRICADES. TWO BARRICADES PER PEDESTRIAN APPROACH. ONE SIDEWALK CLOSED SIGN WILL BE PLACED UPON ONE BARRICADE FOR EACH APPROACH, NO MORE THAN ONE 5' SECTION OF SIDEWALK RAMP SHALL BE CLOSED LEADING TO THE MAIN BUILDING AT ANY TIME ADJACENT TO THE WORK AREA.

ORANGE PLASTIC SAFETY FENCE

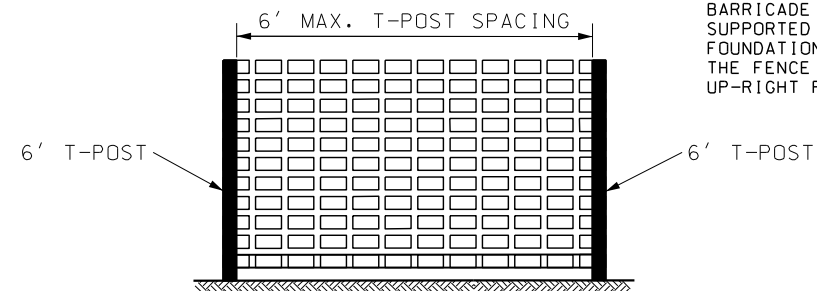

NO DIRECT PAY.
PLASTIC SAFETY NETTING USED FOR
BARRICADE FENCING SHALL BE
SUPPORTED WITH T-POST, ADEQUATE
FOUNDATIONS, AND BALLAST SO THAT
THE FENCE REMAINS TAUT AND IN AN
UP-RIGHT POSITION.

NOT TO SCALE

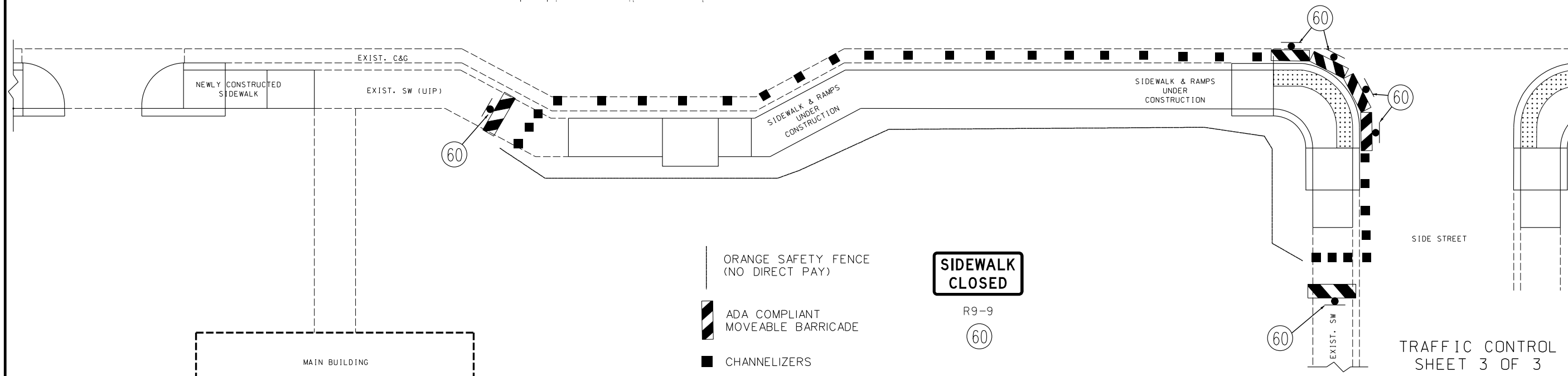
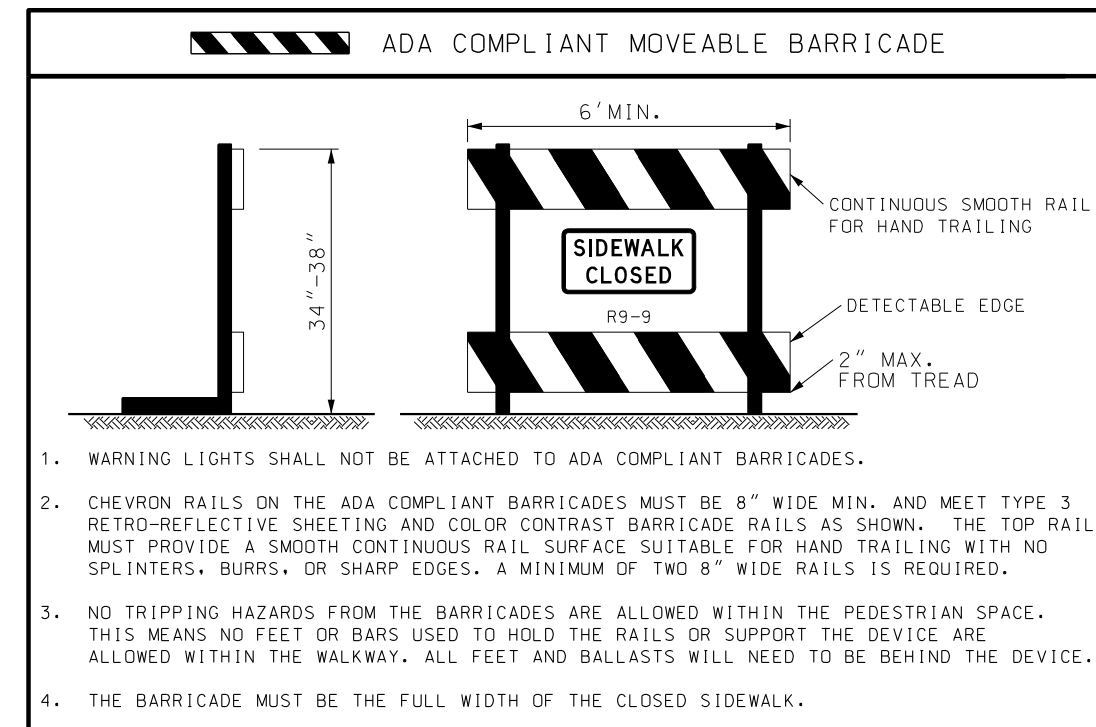
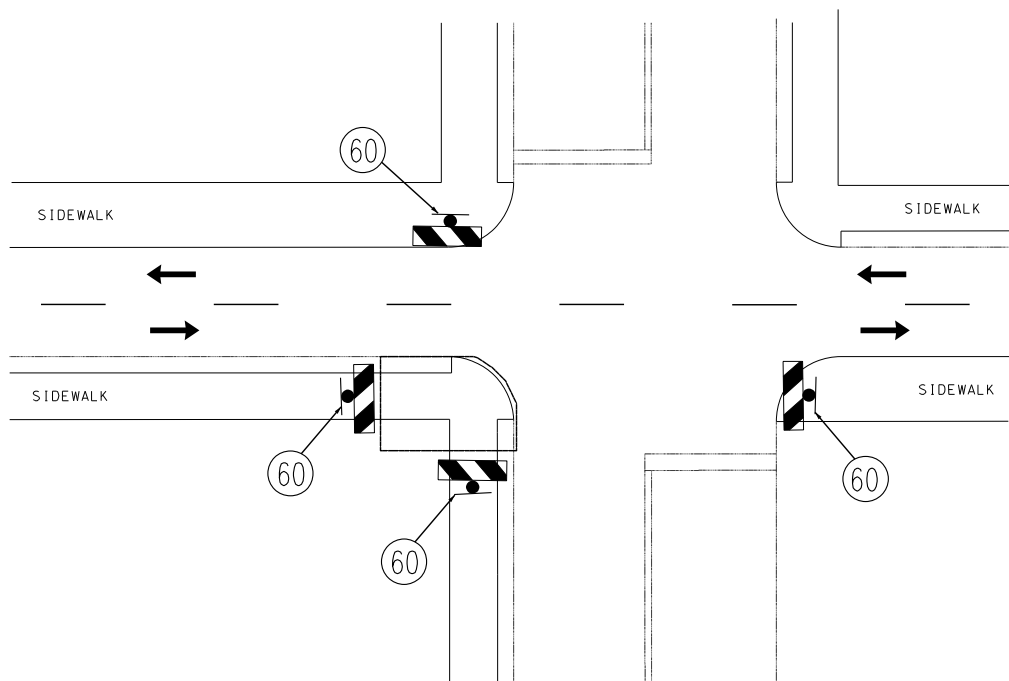

TRAFFIC CONTROL
SHEET 3 OF 3

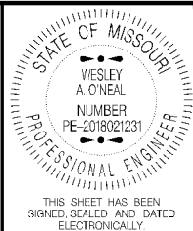

DATE PREPARED	
3/18/2024	
ROUTE	STATE
VAR	MO
DISTRICT	SHEET NO.
SW	10
COUNTY	
BATES	
JOB NO.	
J7P3511	
CONTRACT ID.	
.	
PROJECT NO.	
.	
BRIDGE NO.	

[illegible]MISSOURI HIGHWAYS AND TRANSPORTATION
COMMISSION

105 WEST CAPITOL
JEFFERSON CITY, MO 65102
1-888-ASK-MODOT (1-888-275-6636)

200 E 101st Terr., Ste. 200
Kansas City, MO 64131
Phone (816) 701-3100
Fax (816) 942-3013

Missouri Cert. of
Authority #2003007599

WILSON
& COMPANY
ENGINEERS & ARCHITECTS

[illegible]

3 / 18 / 2024

VAR	MO
-----	----

SW	1.3
----	-----

BATES

J7P3511

•

--	--	--	--	--	--

MISSOURI HIGHWAYS AND TRANSPORTATION

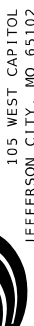

WILSON
& COMPANY
ENGINEERS & ARCHITECTS

INTERSECTION _____ RTE 52 & FRAN AVE _____ D-37B

POWER SUPPLY												
LOCATION			POWER SUPPLY ASSEMBLY		CIRCUIT BREAKER TRIP RATING*				LIGHTING CONTROL * (ON POWER SUPPLY)		SERVICE POLE	
APPROACH	STATION	OFFSET	DRAWING 902.15	DRAWING	CONTROLLER		POWER SUPPLY DISCONNECT				CONTRACT FURNISH	UTILITY COMPANY
					AUXILIARY BREAKER	CONT & SIGNAL LAMPS	MAIN BREAKER					
									SIGNALS	LIGHTING		
-	-	-	Type	-	15 Amps	- Amps	- Amps	- Amps		Amps	CL	Ft.
-	-	-	Type	-	15 Amps	- Amps	- Amps	- Amps		Amps	CL	Ft.

[illegible]

		NEMA DETECTOR ASSIGNMENT							
		CARD POSITION							
		1	2	3	4	5	6	7	8
C H A N N E L	1
	2

TOTAL NUMBER OF DETECTOR CARDS (2-CHANNEL) = (2)

[illegible]

* ITEMS FOR WHICH SEPARATE PAYMENT WILL NOT BE MADE.

*** USE D3-1 FOR ONE LINE. USE D3-1B FOR TWO LINE.

(1) MoDOT "D" PLUG SHALL BE WIRED INTO ALL NEMA CONTROLLERS WITH 7C HARDWIRE INTERCONNECT.

(2) PAYMENT IS MADE FOR THE NUMBER OF 2-CHANNEL DETECTOR CARDS AS SHOWN BELOW THE ASSIGNMENT CHART.

(3) PROVIDE NEMA TS1 CABINET AND BASE.

(4) PROVIDE NEMA M60 CONTROLLER.

(5) PAYMENT FOR CABINET AND BASE SHALL BE SUBSIDIARY TO CABINET.

[illegible][illegible][illegible]

TOTAL NUMBER OF DETECTOR CARDS (2-CHANNEL) = (2)

170 OUTPUT FILE ASSIGNMENTS							
FR1							MONITOR
FR2							
FR3							
FR4							

170 AUXILIARY OUTPUT FILE							
FR5							X
FR6							

[illegible]MISSOURI HIGHWAYS AND TRANSPORTATION
COMMISSION

105 WEST CAPITOL
JEFFERSON CITY, MO 65102
1-888-ASK-MODOT (1-888-275-6636)

00 E 101st Terr., Ste. 200
Kansas City, MO 64131
Phone (816) 701-3100
Fax (816) 942-3013

Missouri Cert. of
Authority #2003007599

WILSON
& COMPANY
ENGINEERS & ARCHITECTS

RTE 52 & FRAN AVE

INTERSECTION

D-37C

