

ROUTE OO      A.A.D.T. - 2024 = 1295  
T = 6.3%  
FUNCTIONAL CLASSIFICATION - MINOR COLLECTOR

ROUTE HH      A.A.D.T. - 2024 = 647  
T = 17.4%  
FUNCTIONAL CLASSIFICATION - MINOR COLLECTOR

ROUTE Z      A.A.D.T. - 2024 = 3147  
T = 11.2%  
FUNCTIONAL CLASSIFICATION - MAJOR COLLECTOR

### CONVENTIONAL SYMBOLS (USED IN PLANS)

NOTE: DASHED OR OPEN SYMBOLS INDICATE  
EXISTING FEATURES

**KEY MAP**  
LOCATION OF BOONE COUNTY

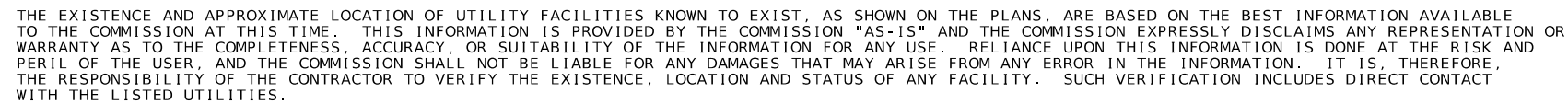

RTE. OO (BOONE COUNTY)		
BEGINNING OF PROJECT	L.M.	0.027
END OF PROJECT	L.M.	4.610
APPARENT LENGTH		24198.24 FEET
EQUATIONS AND EXCEPTIONS:		
RAILROAD EXCEPTION		
BEGINNING	L.M.	0.272
END	L.M.	0.274
STATE BRIDGE A8272		
BEGINNING	L.M.	1.537
END	L.M.	1.556
RTE. HH (BOONE COUNTY)		
BEGINNING OF PROJECT	L.M.	0.002
END OF PROJECT	L.M.	5.733
APPARENT LENGTH		30259.68 FEET
EQUATIONS AND EXCEPTIONS:		
RAILROAD EXCEPTION		
BEGINNING	L.M.	0.357
END	L.M.	0.360
STATE BRIDGE N0852		
BEGINNING	L.M.	1.652
END	L.M.	1.685
RTE. Z (BOONE COUNTY)		
BEGINNING OF PROJECT	L.M.	0.009
END OF PROJECT	L.M.	19.056
APPARENT LENGTH		100568.16 FEET
EQUATIONS AND EXCEPTIONS:		
ROUNDBABOUT EXCEPTION		
BEGINNING	L.M.	17.982
END	L.M.	18.041
STATE BRIDGE A8127		
BEGINNING	L.M.	19.001
END	L.M.	19.044
RANGELINE RD (BOONE COUNTY)		
BEGINNING OF PROJECT	L.M.	0.000
END OF PROJECT	L.M.	0.155
APPARENT LENGTH		818.40 FEET
TOTAL CORRECTIONS		
		839.52 FEET
NET LENGTH OF PROJECT		155004.96 FEET
STATE LENGTH		29.357 MILES
FOR INFORMATION ONLY		
ESTIMATED DISTURBED ACRES		0 ACRES

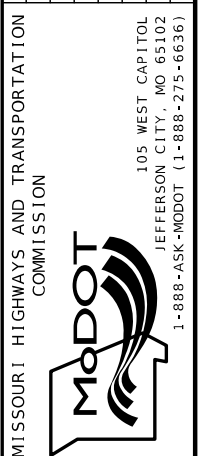

TITLE SHEET

BOONE COUNTY ROUTES

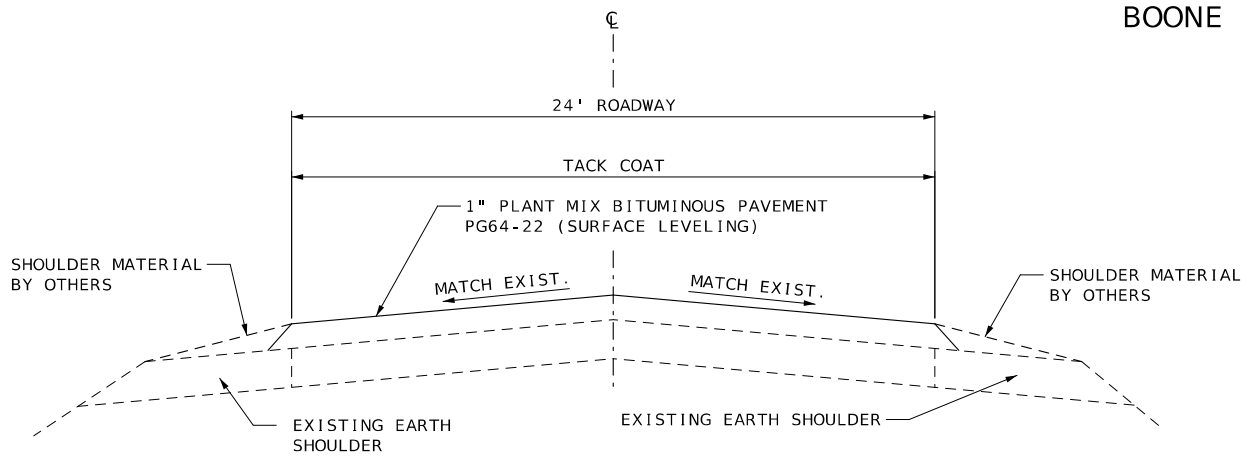

ROUTE HH  
TYPICAL SECTION  
LOG MILE 0.002 TO 0.446

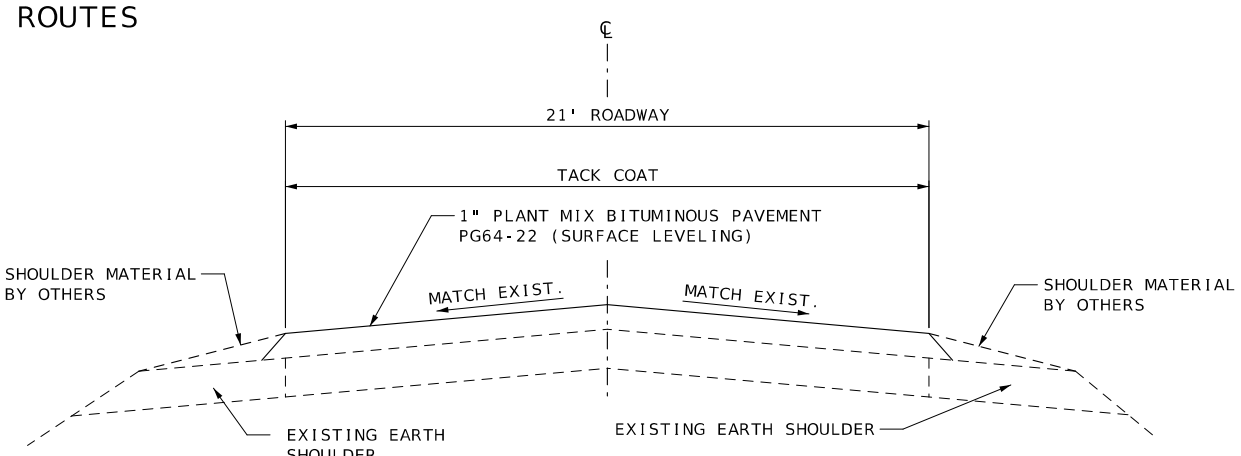

ROUTE HH  
TYPICAL SECTION  
LOG MILE 0.446 TO 5.733

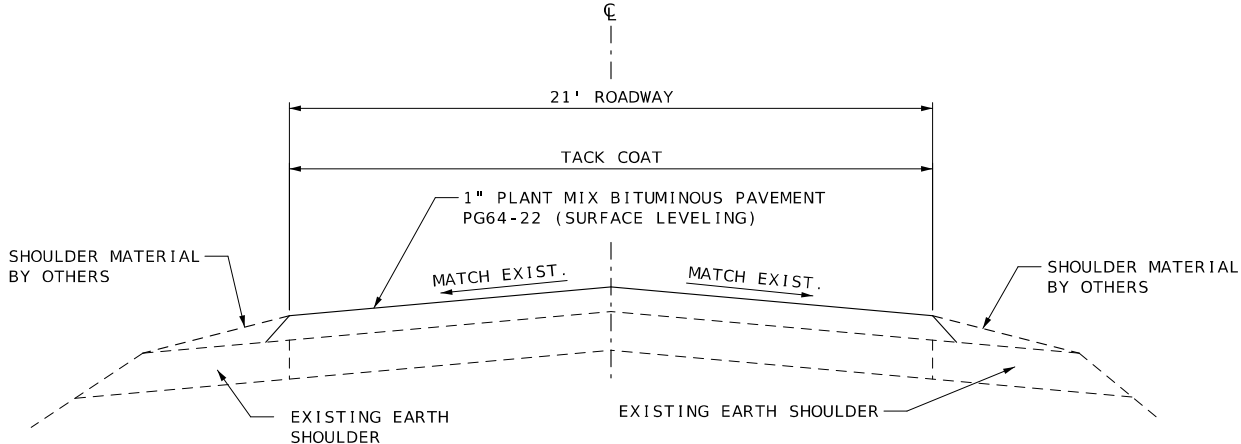

ROUTE Z  
TYPICAL SECTION  
LOG MILE 0.009 TO 17.982

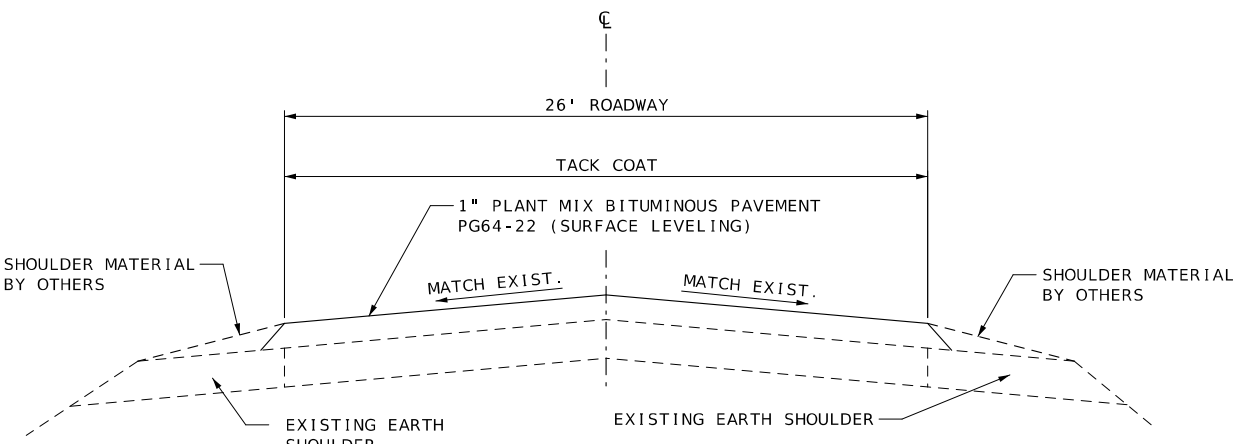

ROUTE Z  
TYPICAL SECTION  
LOG MILE 18.041 TO 19.056

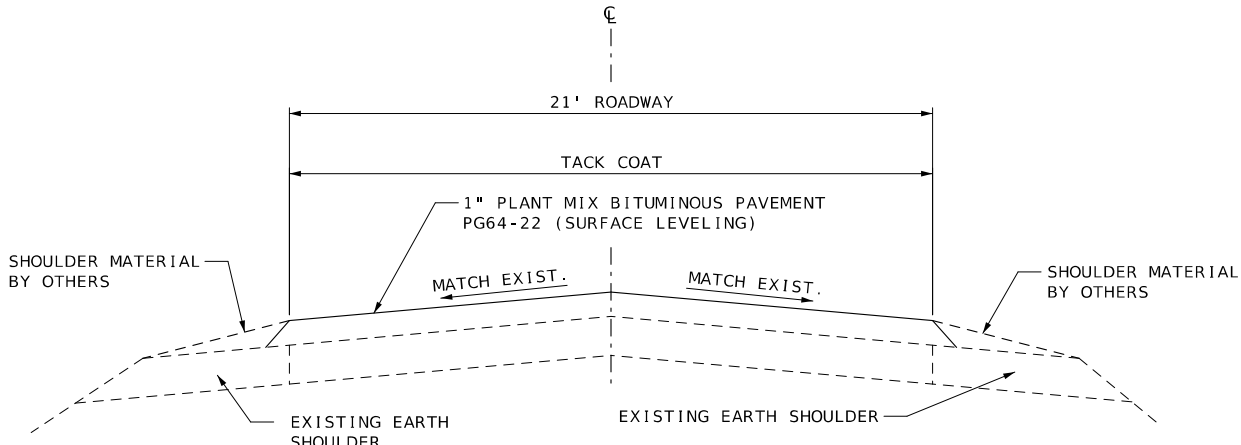

ROUTE OO  
TYPICAL SECTION  
LOG MILE 0.027 TO 4.610

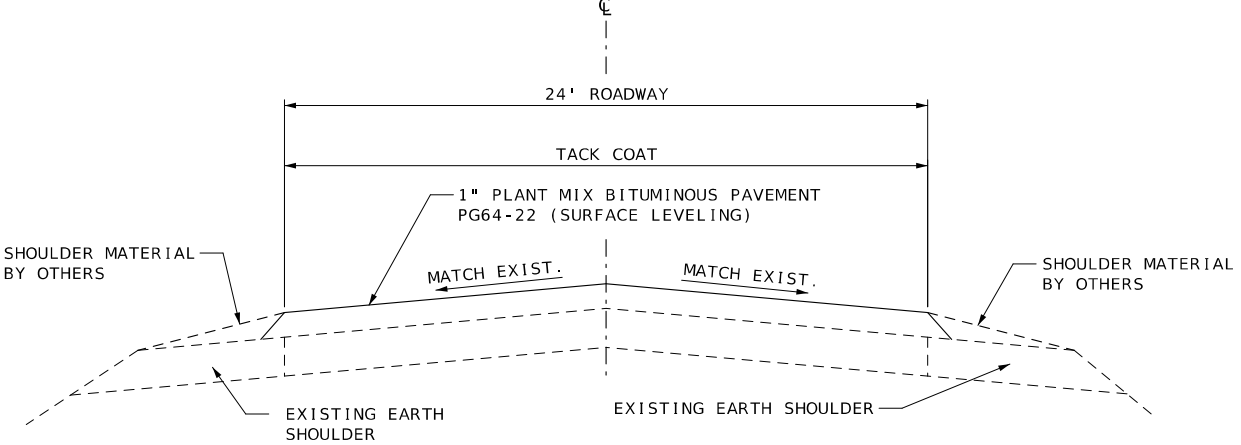

RANGELINE ROAD  
TYPICAL SECTION  
LOG MILE 0.000 TO 0.155

NOTE:  
SURFACE PLACEMENT SHALL BE ONE PASS PER LANE  
NO S.E. CORRECTION.

ESTIMATE FACTORS	
BITUMINOUS PAVEMENT MIXTURE PG64-22 (SURFACE LEVELING)	= 1.987 TONS/CY
TACK (EXIST. ASPHALT SURFACE)	= 0.08 GAL/SY
TACK (COLDMILLED ASPHALT)	= 0.10 GAL/SY

TYPICAL SECTION  
SHEET 1 OF 1

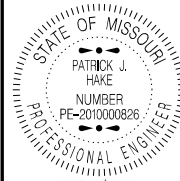

DATE PREPARED  
6/3/2024

ROUTE  
OO/HH/Z  
DISTRICT  
CD

STATE  
MO  
SHEET NO.  
2

COUNTY  
BOONE  
JOB NO.  
JCD0049  
CONTRACT ID.

PROJECT NO.

BRIDGE NO.

DESCRIPTION	DATE

MISSOURI HIGHWAYS AND TRANSPORTATION  
COMMISSION

105 WEST CAPITOL  
JEFFERSON CITY, MO 65102  
1-888-ASK-MODOT (1-888-275-6636)

TYPICAL SECTIONS SHEET  
SHEET 1 OF 1





BITUMINOUS SURFACE LEVELING - ROUTE Z								
LOG MILE FROM	LOG MILE TO	LOCATION	LENGTH FT.	WIDTH FT.	AREA SQ. FT.	SURFACE LEVELING PG 64-22 TONS	TACK COAT GAL	REMARKS
0.009	0.014	ROUTE Z	25	VARIES	658.35	4.04	7.32	MODIFIED COLDMILLING START OF RTE Z - APPROX 73.15 SQ. YDS.
0.014	3.974	ROUTE Z	20908.8	21	439084.80	2692.77	3902.98	
3.974	3.979	ROUTE Z	25	21	525.00	3.22	5.83	MODIFIED COLMILLING NORTH OF ENTRANCE MILL/FILL - APPROX 58.33 SQ. YDS.
3.979	4.021	ROUTE Z	221.76	21	4656.96	28.56	51.74	MILL/FILL IN FRONT OF PANHANDLE EASTERN ENTRANCE - APPROX 517.44 SQ. YDS.
4.021	4.025	ROUTE Z	25	21	525.00	3.22	5.83	MODIFIED COLMILLING SOUTH OF ENTRANCE MILL/FILL - APPROX 58.33 SQ. YDS.
4.025	17.956	ROUTE Z	73555.68	21	1544669.28	9472.98	13730.39	
17.956	17.961	ROUTE Z	25	VARIES	793.89	4.87	8.82	MODIFIED COLDMILLING NORTH OF ROUNDABOUT MILL/FILL - APPROX 88.21 SQ. YDS.
17.961	17.982	ROUTE Z	110.88	VARIES	5356.53	32.85	59.52	MILL/FILL NORTH OF ROUNDABOUT - APPROX 595.17 SQ. YDS.
17.982	18.041	ROUTE Z						ROUNDABOUT EXCEPTION
18.041	18.067	ROUTE Z	137.28	VARIES	5595.75	34.32	62.18	MILL/FILL SOUTH OF ROUNDABOUT - APPROX 621.75 SQ. YDS.
18.067	18.072	ROUTE Z	25	VARIES	797.49	4.89	8.86	MODIFIED COLDMILLING SOUTH OF ROUNDABOUT MILL/FILL - APPROX 88.61 SQ. YDS.
18.072	18.453	ROUTE Z	2011.68	26	52303.68	320.76	464.92	
18.453	18.458	ROUTE Z	25	26	650.00	3.99	7.22	MODIFIED COLDMILLING NORTH OF DRIVEWAY MILL/FILL - APPROX 72.22 SQ. YDS.
18.458	18.554	ROUTE Z	506.88	26	13178.88	80.82	146.43	OUTDOOR BRANDS DRIVEWAY MILL/FILL - APPROX 1464.32 SQ. YDS.
18.554	18.559	ROUTE Z	25	26	650.00	3.99	7.22	MODIFIED COLDMILLING SOUTH OF DRIVEWAY MILL/FILL - APPROX 72.22 SQ. YDS.
18.559	18.687	ROUTE Z	675.84	26	17571.84	107.76	156.19	
18.687	18.692	ROUTE Z	25	26	650.00	3.99	7.22	MODIFIED COLDMILLING NORTH OF CONCRETE EXCEPTION - APPROX 72.22 SQ. YDS.
18.692	18.826	ROUTE Z	707.52					CONCRETE EXCEPTION
18.826	19.001	ROUTE Z	924	33.5	30954.00	189.83	343.93	MILL/FILL AREA NORTH OF I-70 OVERPASS WIDTH VARIES - APPROX 3439.33 SQ. YDS.
19.001	19.043	ROUTE Z	221.76					STATE BRIDGE A8127 EXCEPTION
19.043	19.057	ROUTE Z	73.92	VARIES	4487.87	27.52	49.87	MILL/FILL SOUTH OF BRIDGE EXCEPTION - APPROX 498.65 SQ. YDS.
0.000	0.010	RANGELINE RD	52.8					MILL/FILL - QUANTITY INCLUDED ABOVE
0.010	0.015	RANGELINE RD	25	41	1025.00	6.29	11.39	MODIFIED COLDMILLING SOUTH OF MILL/FILL - APPROX 113.89 SQ. YDS.
0.015	0.070	RANGELINE RD	290.4	32.5	9438.00	57.88	83.89	WIDTH VARIES
0.070	0.150	RANGELINE RD	422.4	24	10137.60	62.17	90.11	
0.150	0.155	RANGELINE RD	25	24	600.00	3.68	6.67	MODIFIED COLDMILLING END OF PROJECT - APPROX 66.67 SQ. YDS.
SIDE ROADS & ENTRANCES								
3.305	3.305	ROUTE Z	VARIES	VARIES	5297.58	32.49	58.86	RTE Z AND RTE FF AND KROEGER RD INTERSECTION - APPROX 588.62 SQ. YDS.
5.131	5.131	ROUTE Z	VARIES	VARIES	4717.17	28.93	52.41	RTE Z AND OLD HWY 124 INTERSECTION - APPROX 524.13 SQ. YDS.
7.116	7.116	ROUTE Z	VARIES	VARIES	2956.14	18.13	32.85	RTE Z AND RTE D INTERSECTION - APPROX 328.46 SQ. YDS.
8.267	8.267	ROUTE Z	VARIES	VARIES	1266.12	7.76	14.07	RTE Z AND NIENABER LN INTERSECTION - APPROX 140.68 SQ. YDS.
10.287	10.287	ROUTE Z	VARIES	VARIES	1968.48	12.07	21.87	RTE Z AND MT ZION CHURCH RD AND TIMMONS RD INTERSECTION - APPROX 218.72 SQ. YDS.
12.003	12.003	ROUTE Z	VARIES	VARIES	2510.19	15.39	27.89	RTE Z AND ROB COOK RD INTERSECTION - APPROX 278.91 SQ. YDS.
14.065	14.065	ROUTE Z	VARIES	VARIES	2423.88	14.86	26.93	RTE Z AND MT HOPE RD FIRST INTERSECTION - APPROX 269.32 SQ. YDS.
14.198	14.198	ROUTE Z	VARIES	VARIES	2447.55	15.01	27.20	RTE Z AND MT HOPE RD SECOND INTERSECTION - APPROX 271.95 SQ. YDS.
14.933	14.933	ROUTE Z	VARIES	VARIES	1737.63	10.66	19.31	RTE Z AND PRAIRIE ELEMENTARY SCHOOL ENTRANCE INTERSECTION - APPROX 193.07 SQ. YDS. MOD COLDMILL
15.198	15.198	ROUTE Z	VARIES	VARIES	1994.85	12.23	22.17	RTE Z AND JUDY SCHOOL RD INTERSECTION - APPROX 221.65 SQ. YDS.
17.174	17.174	ROUTE Z	VARIES	VARIES	2363.31	14.49	26.26	RTE Z AND MEXICO GRAVEL RD INTERSECTION - APPROX 262.59 SQ. YDS.
17.956	17.956	ROUTE Z	VARIES	VARIES	1215.36	7.45	13.50	RTE Z AND ST CHARLES RD INTERSECTION - APPROX 135.04 SQ. YDS.
0.070	1.101	RANGELINE RD	VARIES	VARIES	6491.07	39.81	72.12	RANGELINE ROAD AND I-70 DRIVE INTERSECTION - APPROX 721.23 SQ. YDS.
0.009	19.056	ROUTE Z	711	2	1422	8.72	15.80	PRIVATE ENTRANCES
						3347.10		25% FOR IRREGULARITIES
						267.77		2% SAFETY EDGE
SUBTOTAL - ROUTE Z						17003.27	19649.77	
SUBTOTAL - ROUTE OO						4023.75	4624.82	
SUBTOTAL - ROUTE HH						5092.70	5925.50	
TOTAL						26119.72	30200.09	
USE						26119.7	30200	

STATE OF MISSOURI

PATRICK J. HAKE

NUMBER

PE-2010000826

PROFESSIONAL ENGINEER

8[Date] 8[Time]

PATRICK J. HAKE - CIVIL

MO-PE-2010000826

DATE PREPARED

6/3/2024

ROUTE

OO/HH/Z

DISTRICT

CD

STATE

MO

SHEET NO.

3

COUNTY

BOONE

JOB NO.

JCD0049

CONTRACT ID.

PROJECT NO.

BRIDGE NO.

DESCRIPTION

DATE

MISSOURI HIGHWAYS AND TRANSPORTATION COMMISSION

MoDOT

105 WEST CAPITOL

JEFFERSON CITY, MO 65102

1-888-ASK-MODOT (1-888-275-6636)

QUANTITY SHEET  
3 OF 6





PAVEMENT MARKING												
LOG MILE FROM	LOG MILE TO	LOCATION	LENGTH (FT)	STAND. WATERBORNE PVMT MARK. PAINT, TYPE P BEADS			PREFORMED THERMOPLASTIC INTERSECTION MARKING					REMARKS
				4" YELLOW LF	4" WHITE LF	8" WHITE LF	12" WHITE YIELD TRIANGLES EA	LEFT / RIGHT TURN ARROW EA	24" YELLOW HASH MARKS LF	24" WHITE STOP BAR LF	RR CROSSING MARKER EA	
0.027	4.610	ROUTE OO	24198	48396.0	48396.0							START OF RTE OO
0.239	0.250	ROUTE OO									1.0	RR CROSSING MARKER WEST OF RR
0.266	0.266	ROUTE OO								10.0		STOP BAR WEST OF RR
0.284	0.284	ROUTE OO								10.0		STOP BAR EAST OF RR
0.306	0.317	ROUTE OO									1.0	RR CROSSING MARKER EAST OF RR
0.002	0.059	ROUTE HH	300	600.0	900.0	250.5		3.0		12.0		PAINTED ISLANDS, 3-RIGHT TURN ARROWS
0.059	5.733	ROUTE HH	29959	59918.0	59918.0							
0.264	0.273	ROUTE HH									1.0	
0.354	0.354	ROUTE HH								12.0		
0.363	0.363	ROUTE HH								12.0		
0.452	0.461	ROUTE HH									1.0	
0.009	17.954	ROUTE Z	94750	189500.0	189500.0							
17.954	18.066	ROUTE Z	591	938.0	924.0		40		9.0			INCLUDES ROUNDABOUT CENTER CIRCLE
18.066	19.057	ROUTE Z	5232	11218.0	11114.0			4.0				INCLUDES 4-LEFT ARROWS ON BRIDGE
0	0.155	RANGELINE RD	818	2236.0	1636.0				62.0			
			TOTAL	312806.0	312388.0	250.5	40.0	7.0	71.0	56.0	4.0	
			USE	312806	312388	251	40	7	71	56	4	

CONSTRUCTION SIGNING (VARIES) RTE OO, HH, Z						
SIGN	SIZE IN.	AREA SQ.FT.	QTY EACH	TOTAL AREA SQ.FT.	SIGN NUM.	DESCRIPTION
WARNING SIGNS						
WO8-11	48X48	16	60	960	36	UNEVEN LANES
WO8-12	48X48	16	32	512	35	NO CENTER LINE
WO20-1	48X48	16	16	256	2	ROAD WORK AHEAD
WO20-4	48X48	16	6	96	7	ONE LANE ROAD AHEAD
WO20-7a	48X48	16	16	256	8	FLAGGER (SYMBOL, WITH FLAGS)
W03-4	48X48	16	12	192	11	BE PREPARED TO STOP
GO22-1	21X15	2.19	4	8.76		WET PAINT (ARROW PIVOTS)
GUIDE SIGNS						
GO20-1	60X24	10	6	60	1	ROAD WORK NEXT XX MILES 2@5, 2@6, 2@19
GO20-2	48X24	8	6	48	26	END ROAD WORK
GO20-4	36X18	4.5	1	4.5	53	PILOT CAR FOLLOW ME
GO20-4a	42X30	8.75	2	17.5	58	PILOT CAR IN USE WAIT & FOLLOW
GO20-4a	18X12	1.5	12	18	58	PILOT CAR IN USE WAIT & FOLLOW
MISCELLANEOUS SIGNS						
CONST-8	48X36	12	6	72	59	WORK ZONE NO PHONE ZONE
616.10.05 CONSTRUCTION SIGNS TOTAL				2501		

ADDITIONAL CONSTRUCTION ITEMS		
ITEM NO.	QUANTITY	DESCRIPTION
616-10.25	142	CHANNELIZERS (TRIM-LINE)
616-1098A	2	*CHANGEABLE MESSAGE SIGN WITHOUT COMMUNICATION INTERFACE, CONTRACTOR FURNISHED, CONTRACTOR RETAINED."



DATE PREPARED  
6/3/2024

ROUTE  
OO/HH/Z

STATE  
MO

DISTRICT  
CD

SHEET NO.  
3

COUNTY  
BOONE

JOB NO.  
JCD0049

CONTRACT ID.

PROJECT NO.

BRIDGE NO.

DESCRIPTION	DATE

MISSOURI HIGHWAYS AND TRANSPORTATION  
COMMISSION



105 WEST CAPITOL  
JEFFERSON CITY, MO 65102  
1-888-ASK-MODOT (1-888-275-6636)



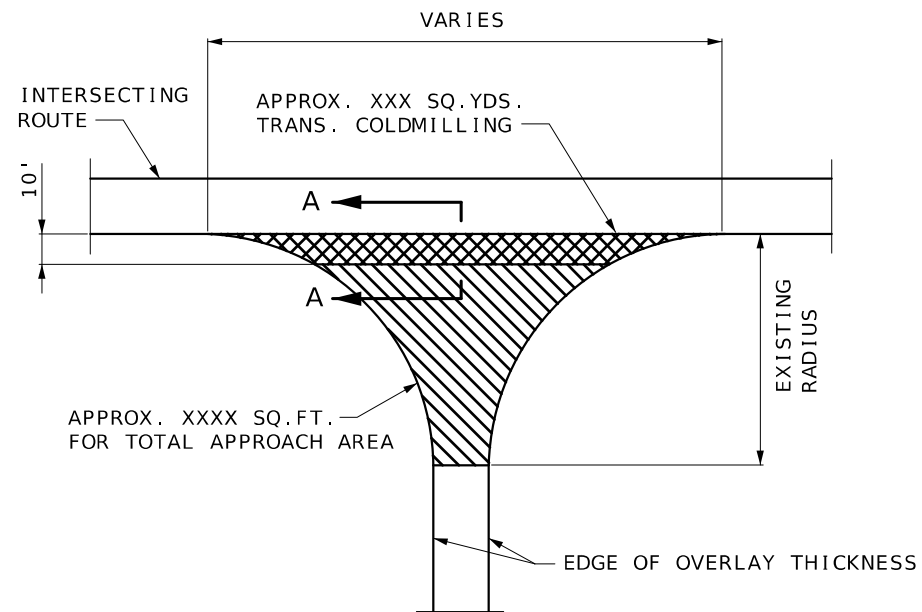

BEGINNING AND END OF PROJECT  
AT INTERSECTING ROUTE

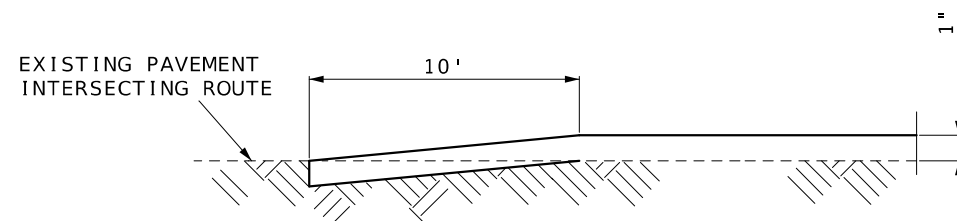

SECTION A-A  
DEPTH TRANSITIONS  
BEGINNING AND END OF PROJECT  
AT INTERSECTING ROUTE

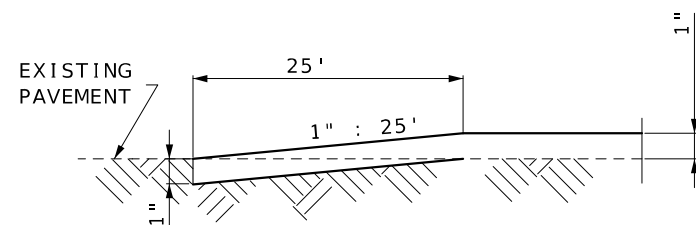

TYPICAL TRAVELWAY DEPTH TRANSITIONS  
AT EXCEPTIONS

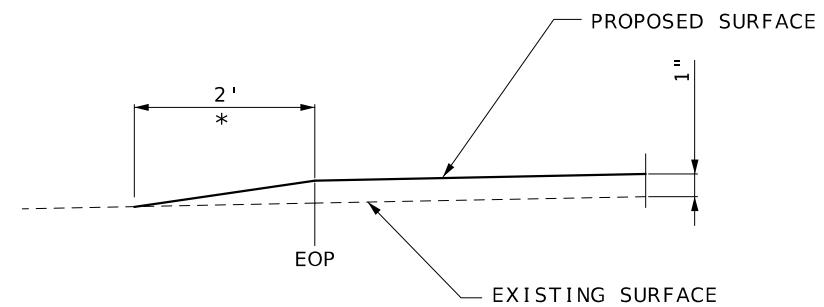
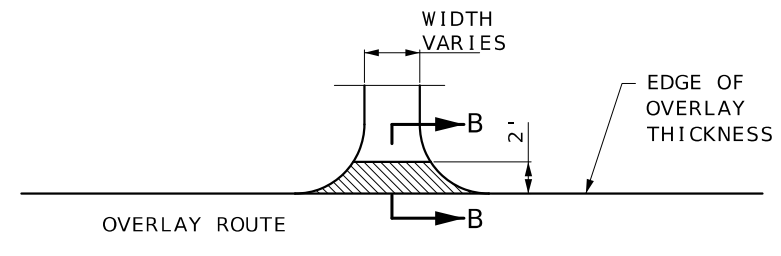

SECTION B-B  
TYPICAL PAVED ENTRANCE  
(FIELD, PRIVATE OR COUNTY ROAD)  
\* TAPER AT 1:1 FOR FIELD ENTRANCE

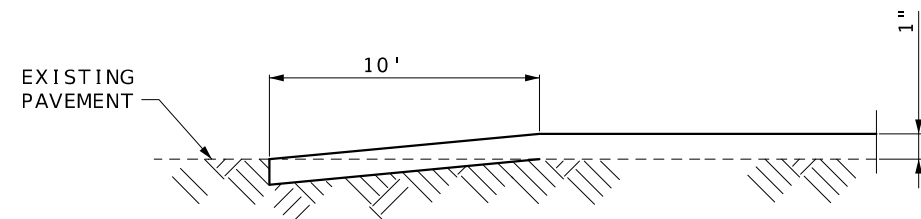
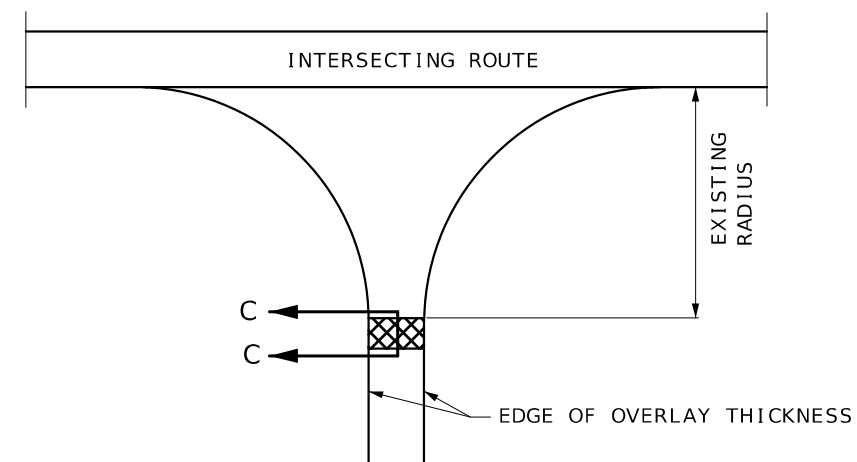

SECTION C-C  
BEGINNING AND END OF PROJECT  
AT INTERSECTION RADIUS  
DEPTH TRANSITION

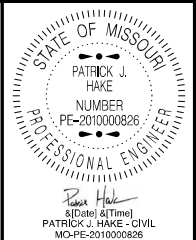

DATE PREPARED  
6/3/2024

ROUTE  
OO/HH/Z

STATE  
MO

DISTRICT  
CD

SHEET NO.  
4

COUNTY  
BOONE

JOB NO.  
JCD0049

CONTRACT ID.

PROJECT NO.

BRIDGE NO.

DESCRIPTION	DATE

MISSOURI HIGHWAYS AND TRANSPORTATION COMMISSION

105 WEST CAPITOL  
JEFFERSON CITY, MO 65102  
1-888-ASK-MODOT (1-888-275-6636)

MoDOT

SPECIAL SHEET  
SHEET 1 OF 12

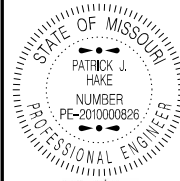

DATE PREPARED  
6/3/2024

ROUTE  
OO/HH/Z

STATE  
MO

DISTRICT  
CD

SHEET NO.  
5

COUNTY  
BOONE

JOB NO.  
JCD0049

CONTRACT ID.

PROJECT NO.

BRIDGE NO.

DESCRIPTION

DATE

MISSOURI HIGHWAYS AND TRANSPORTATION COMMISSION

105 WEST CAPITOL  
JEFFERSON CITY, MO 65102  
1-888-ASK-MODOT (1-888-275-6636)

MoDOT

SPECIAL SHEET  
SHEET 2 OF 12

NOT TO SCALE

ROUTE Z AND GANO CHANCE DR

ROUTE Z AND KROEGER RD. INTERSECTION

ROUTE Z AND PANHANDLE EASTERN ENTRANCE

ROUTE Z AND OLD HWY 124 INTERSECTION

ROUTE Z

ROUTE Z

ROUTE Z

ROUTE Z

ROUTE Z

ROUTE Z

ROUTE Z

ROUTE Z

ROUTE Z

ROUTE Z

ROUTE Z

ROUTE Z

ROUTE Z

ROUTE Z

ROUTE Z

ROUTE Z

ROUTE Z

ROUTE Z

ROUTE Z

ROUTE Z

ROUTE Z

ROUTE Z

ROUTE Z

ROUTE Z

ROUTE Z

ROUTE Z

ROUTE Z

ROUTE Z

ROUTE Z

ROUTE Z

ROUTE Z

ROUTE Z

ROUTE Z

ROUTE Z

ROUTE Z

ROUTE Z

ROUTE Z

ROUTE Z

ROUTE Z

ROUTE Z

ROUTE Z

ROUTE Z

ROUTE Z

ROUTE Z

ROUTE Z

ROUTE Z

ROUTE Z

ROUTE Z

ROUTE Z

ROUTE Z

ROUTE Z

ROUTE Z

ROUTE Z

ROUTE Z

ROUTE Z

ROUTE Z

ROUTE Z

ROUTE Z

ROUTE Z

ROUTE Z

ROUTE Z

ROUTE Z

ROUTE Z

ROUTE Z

ROUTE Z

ROUTE Z

ROUTE Z

ROUTE Z

ROUTE Z

ROUTE Z

ROUTE Z

ROUTE Z

ROUTE Z

ROUTE Z

ROUTE Z

ROUTE Z

ROUTE Z

ROUTE Z

ROUTE Z

ROUTE Z

ROUTE Z

ROUTE Z

ROUTE Z

ROUTE Z

ROUTE Z

ROUTE Z

ROUTE Z

ROUTE Z

ROUTE Z

ROUTE Z

ROUTE Z

ROUTE Z

ROUTE Z

ROUTE Z

ROUTE Z

ROUTE Z

ROUTE Z

ROUTE Z

ROUTE Z

ROUTE Z

ROUTE Z

ROUTE Z

ROUTE Z

ROUTE Z

ROUTE Z

ROUTE Z

ROUTE Z

ROUTE Z

ROUTE Z

ROUTE Z

ROUTE Z

ROUTE Z

ROUTE Z

ROUTE Z

ROUTE Z

ROUTE Z

ROUTE Z

ROUTE Z

ROUTE Z

ROUTE Z

ROUTE Z

ROUTE Z

ROUTE Z

ROUTE Z

ROUTE Z

ROUTE Z

ROUTE Z

ROUTE Z

ROUTE Z

ROUTE Z

ROUTE Z

ROUTE Z

ROUTE Z

ROUTE Z

ROUTE Z

ROUTE Z

ROUTE Z

ROUTE Z

ROUTE Z

ROUTE Z

ROUTE Z

ROUTE Z

ROUTE Z

ROUTE Z

ROUTE Z

ROUTE Z

ROUTE Z

ROUTE Z

ROUTE Z

ROUTE Z

ROUTE Z

ROUTE Z

ROUTE Z

ROUTE Z

ROUTE Z

ROUTE Z

ROUTE Z

ROUTE Z

ROUTE Z

ROUTE Z

ROUTE Z

ROUTE Z

ROUTE Z

ROUTE Z

ROUTE Z

ROUTE Z

ROUTE Z

ROUTE Z

ROUTE Z

ROUTE Z

ROUTE Z

ROUTE Z

ROUTE Z

ROUTE Z

ROUTE Z

ROUTE Z

ROUTE Z

ROUTE Z

ROUTE Z

ROUTE Z

ROUTE Z

ROUTE Z

ROUTE Z

ROUTE Z

ROUTE Z

ROUTE Z

ROUTE Z

ROUTE Z

ROUTE Z

ROUTE Z

ROUTE Z

ROUTE Z

ROUTE Z

ROUTE Z

ROUTE Z

ROUTE Z

ROUTE Z

ROUTE Z

ROUTE Z

ROUTE Z

ROUTE Z

ROUTE Z

ROUTE Z

ROUTE Z

ROUTE Z

ROUTE Z

ROUTE Z

ROUTE Z

ROUTE Z

ROUTE Z

ROUTE Z

ROUTE Z

ROUTE Z

ROUTE Z

ROUTE Z

ROUTE Z

ROUTE Z

ROUTE Z

ROUTE Z

ROUTE Z

ROUTE Z

ROUTE Z

ROUTE Z

ROUTE Z

ROUTE Z

ROUTE Z

ROUTE Z

ROUTE Z

ROUTE Z

ROUTE Z

ROUTE Z

ROUTE Z

ROUTE Z

ROUTE Z

ROUTE Z

ROUTE Z

ROUTE Z

ROUTE Z

ROUTE Z

ROUTE Z

ROUTE Z

ROUTE Z

ROUTE Z

ROUTE Z

ROUTE Z

ROUTE Z

ROUTE Z

ROUTE Z

ROUTE Z

ROUTE Z

ROUTE Z

ROUTE Z

ROUTE Z

ROUTE Z

ROUTE Z

ROUTE Z

ROUTE Z

ROUTE Z

ROUTE Z

ROUTE Z

ROUTE Z

ROUTE Z

ROUTE Z

ROUTE Z

ROUTE Z

ROUTE Z

ROUTE Z

ROUTE Z

ROUTE Z

ROUTE Z

ROUTE Z

ROUTE Z

ROUTE Z

ROUTE Z

ROUTE Z

ROUTE Z

ROUTE Z

ROUTE Z

ROUTE Z

ROUTE Z

ROUTE Z

ROUTE Z

ROUTE Z

ROUTE Z

ROUTE Z

ROUTE Z

ROUTE Z

ROUTE Z

ROUTE Z

ROUTE Z

ROUTE Z

ROUTE Z

ROUTE Z

ROUTE Z

ROUTE Z

ROUTE Z

ROUTE Z

ROUTE Z

ROUTE Z

ROUTE Z

ROUTE Z

ROUTE Z

ROUTE Z

ROUTE Z

ROUTE Z

ROUTE Z

ROUTE Z

ROUTE Z

ROUTE Z

ROUTE Z

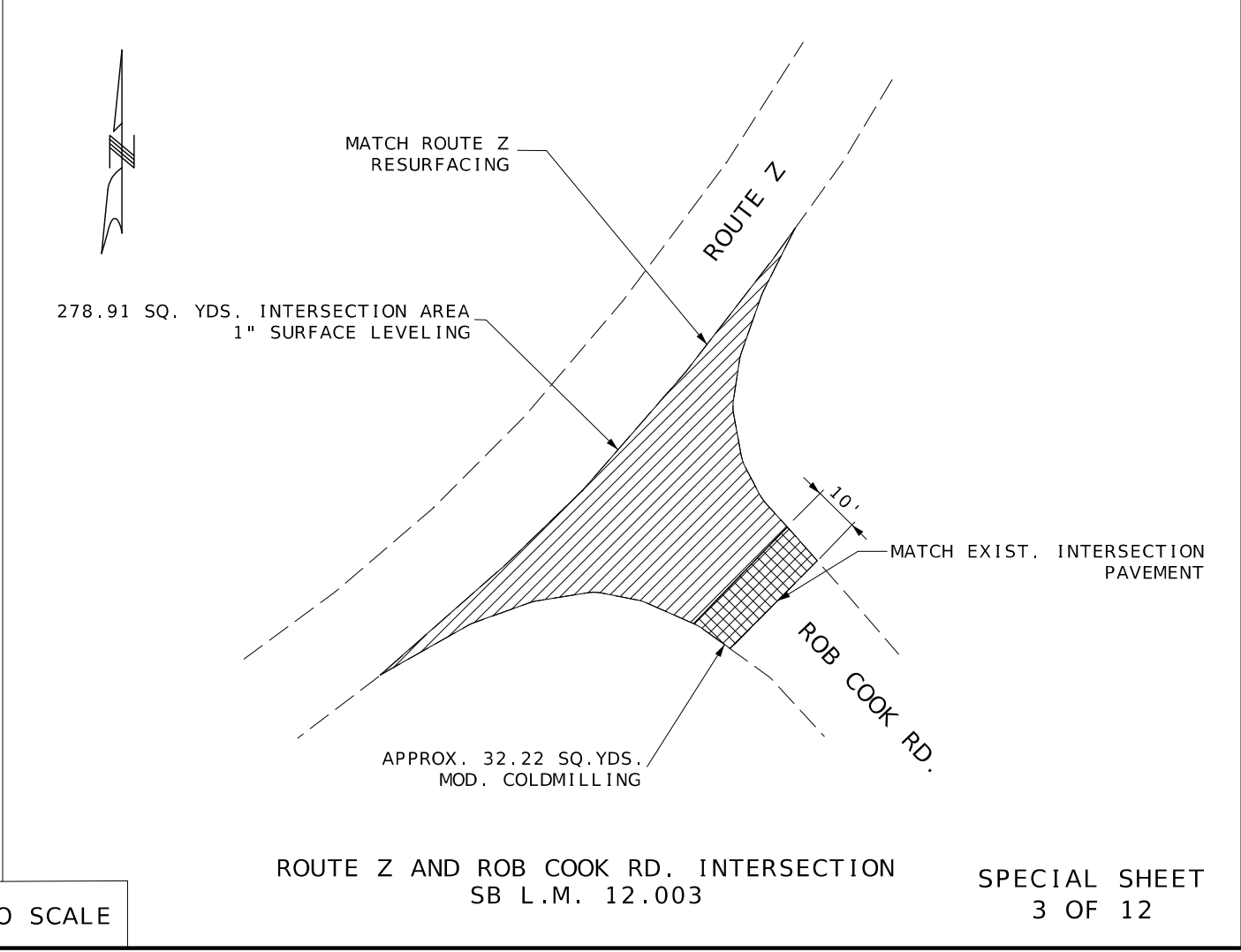
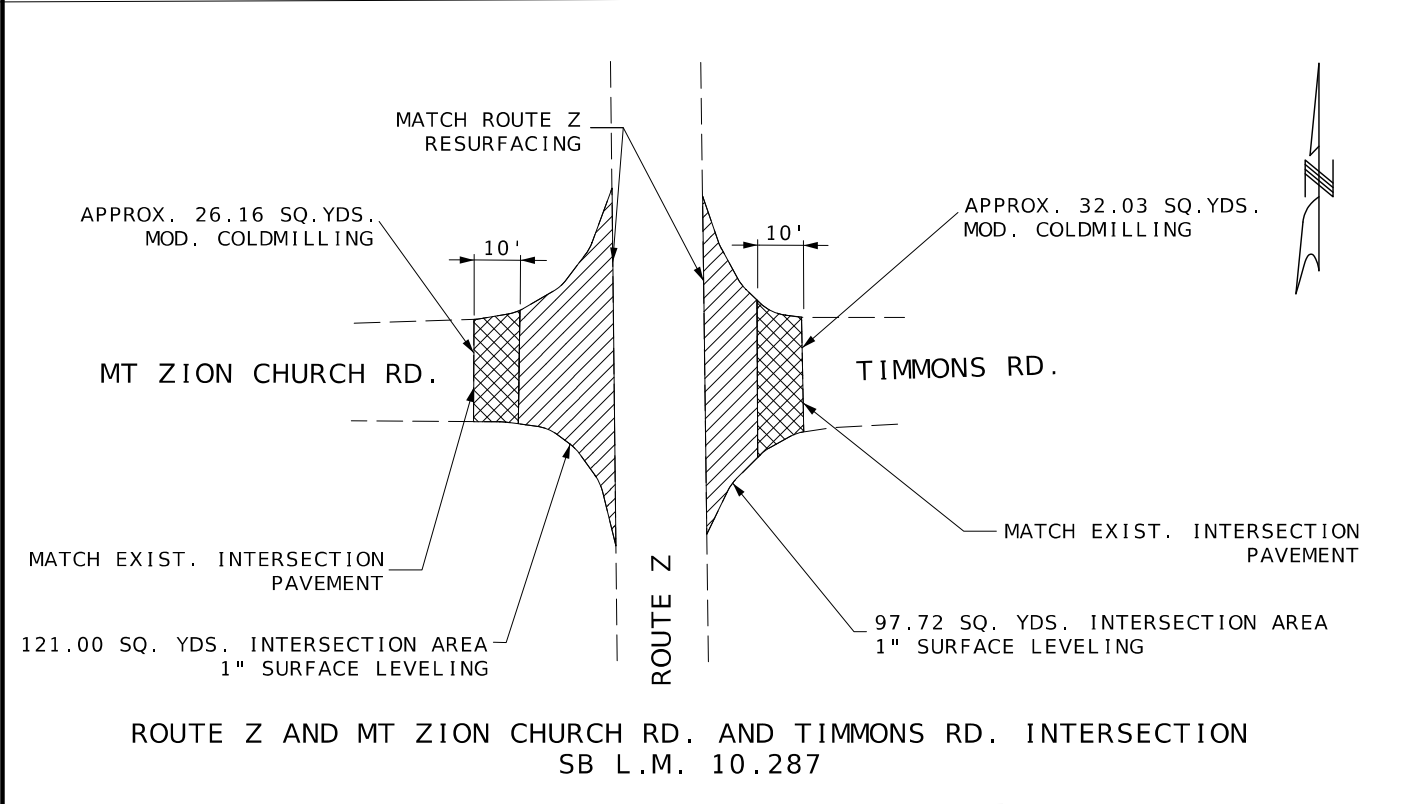
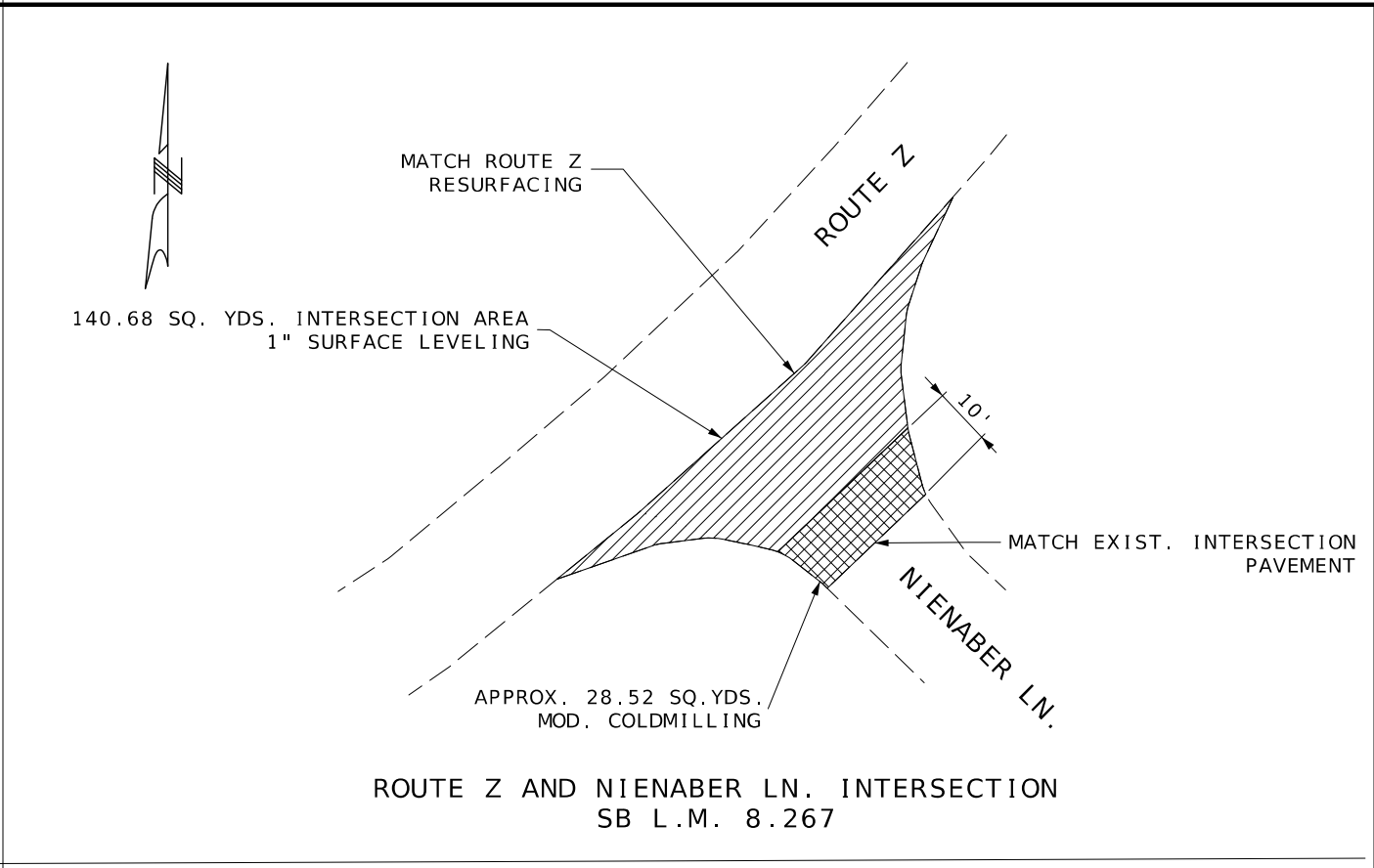
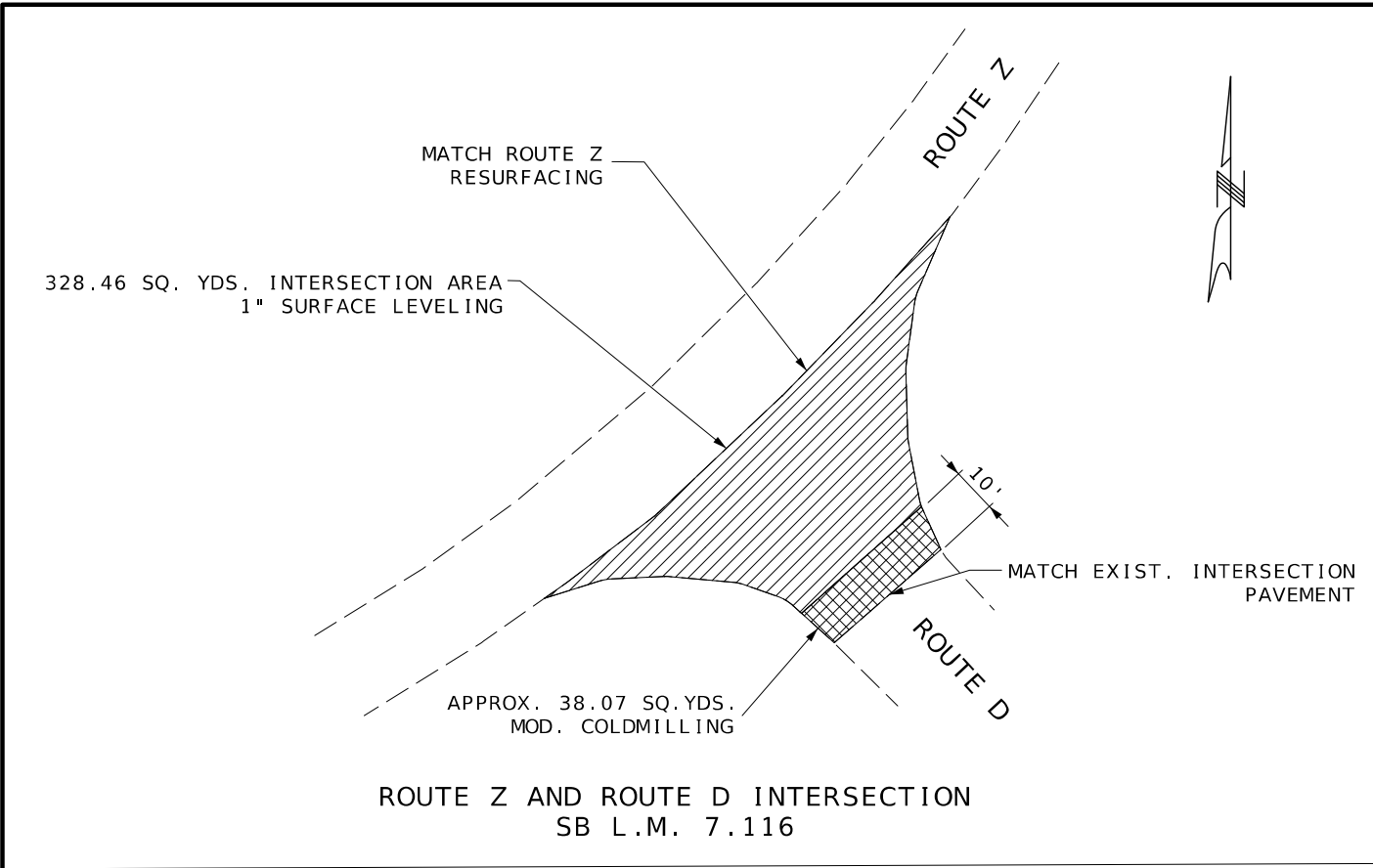

1" SURFACE LEVELING

MODIFIED COLDMILLING & 1" SURFACE LEVELING

COLDMILL 1" & 1" SURFACE LEVELING

NOT TO SCALE

SPECIAL SHEET  
3 OF 12

STATE OF MISSOURI

PATRICK J. HAKE

NUMBER

PE-2010000826

PROFESSIONAL ENGINEER

DATE PREPARED

6/3/2024

ROUTE

OO/HH/Z

DISTRICT

CD

STATE

MO

SHEET NO.

6

COUNTY

BOONE

JOB NO.

JCD0049

CONTRACT ID.

PROJECT NO.

BRIDGE NO.

DESCRIPTION

DATE



MISSOURI HIGHWAYS AND TRANSPORTATION COMMISSION

105 WEST CAPITOL  
JEFFERSON CITY, MO 65102  
1-888-ASK-MODOT (1-888-275-6636)

SPECIAL SHEET

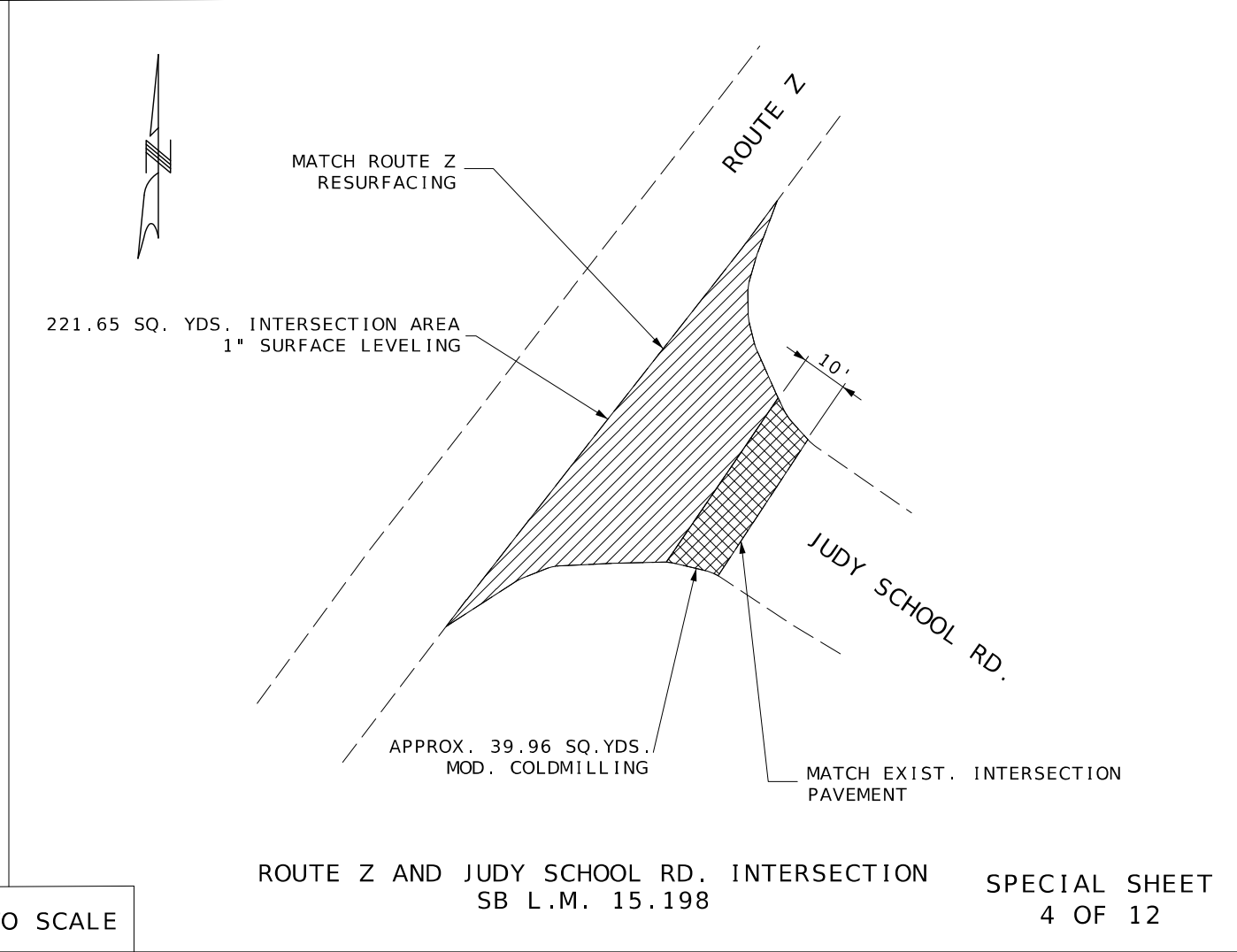
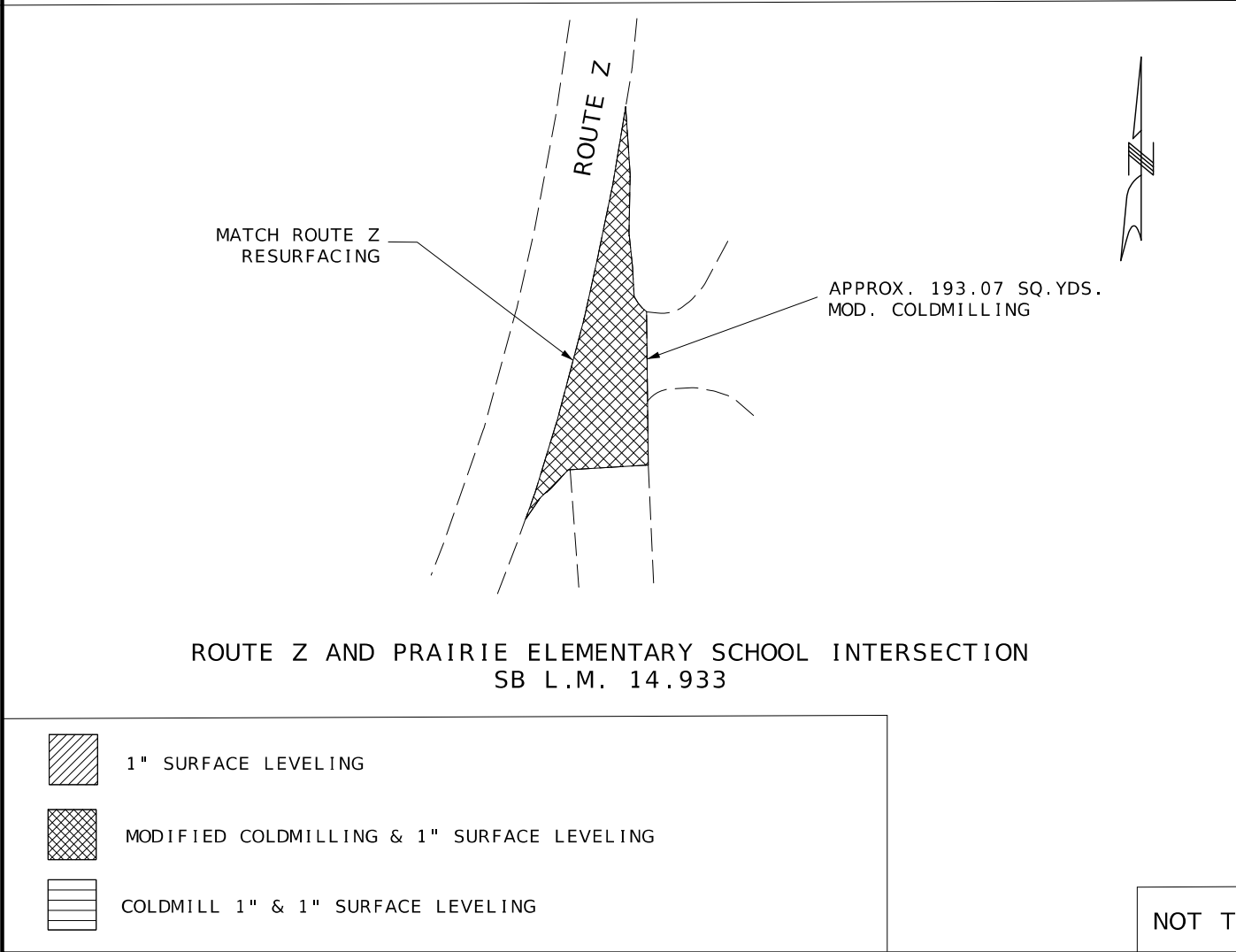
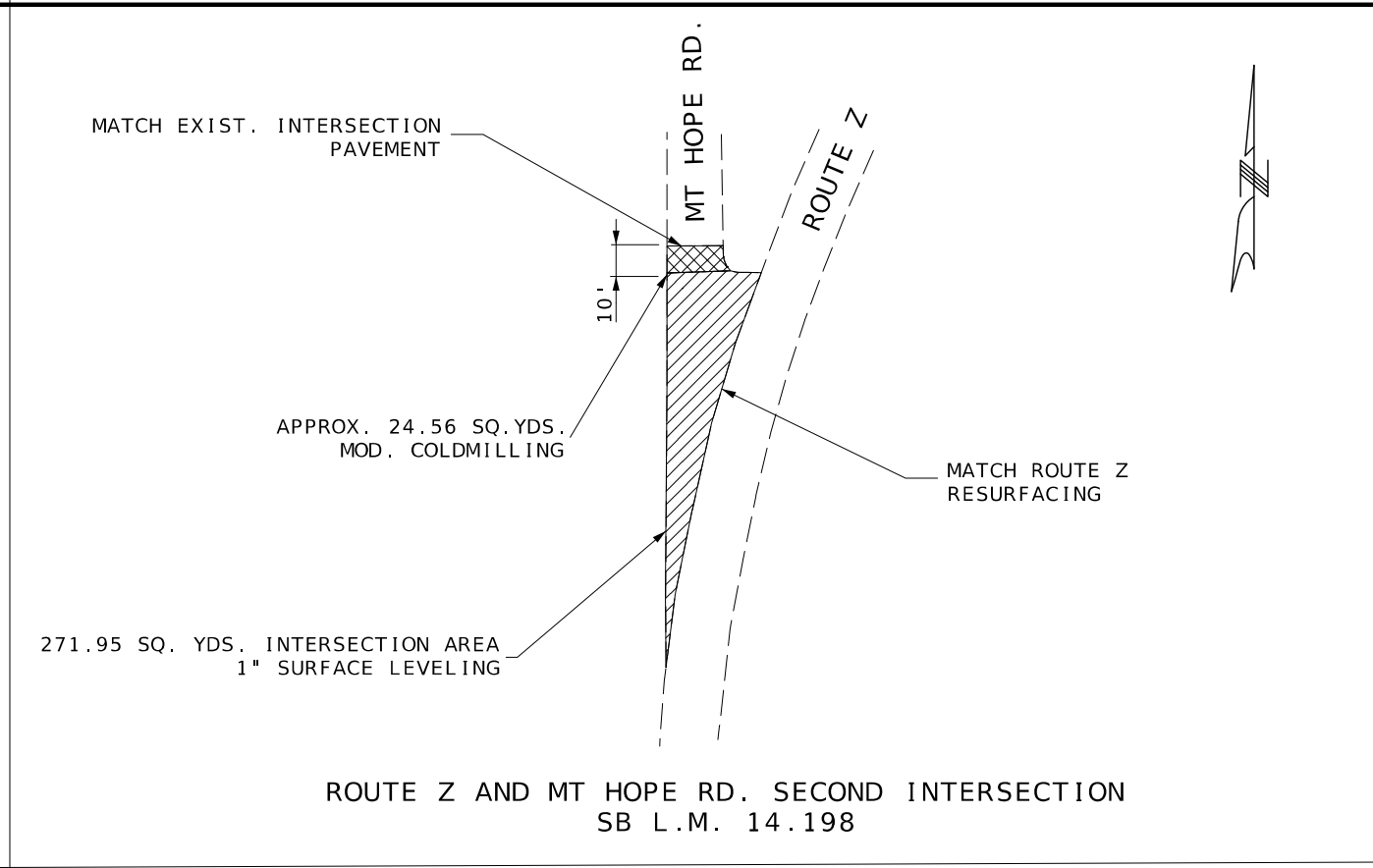
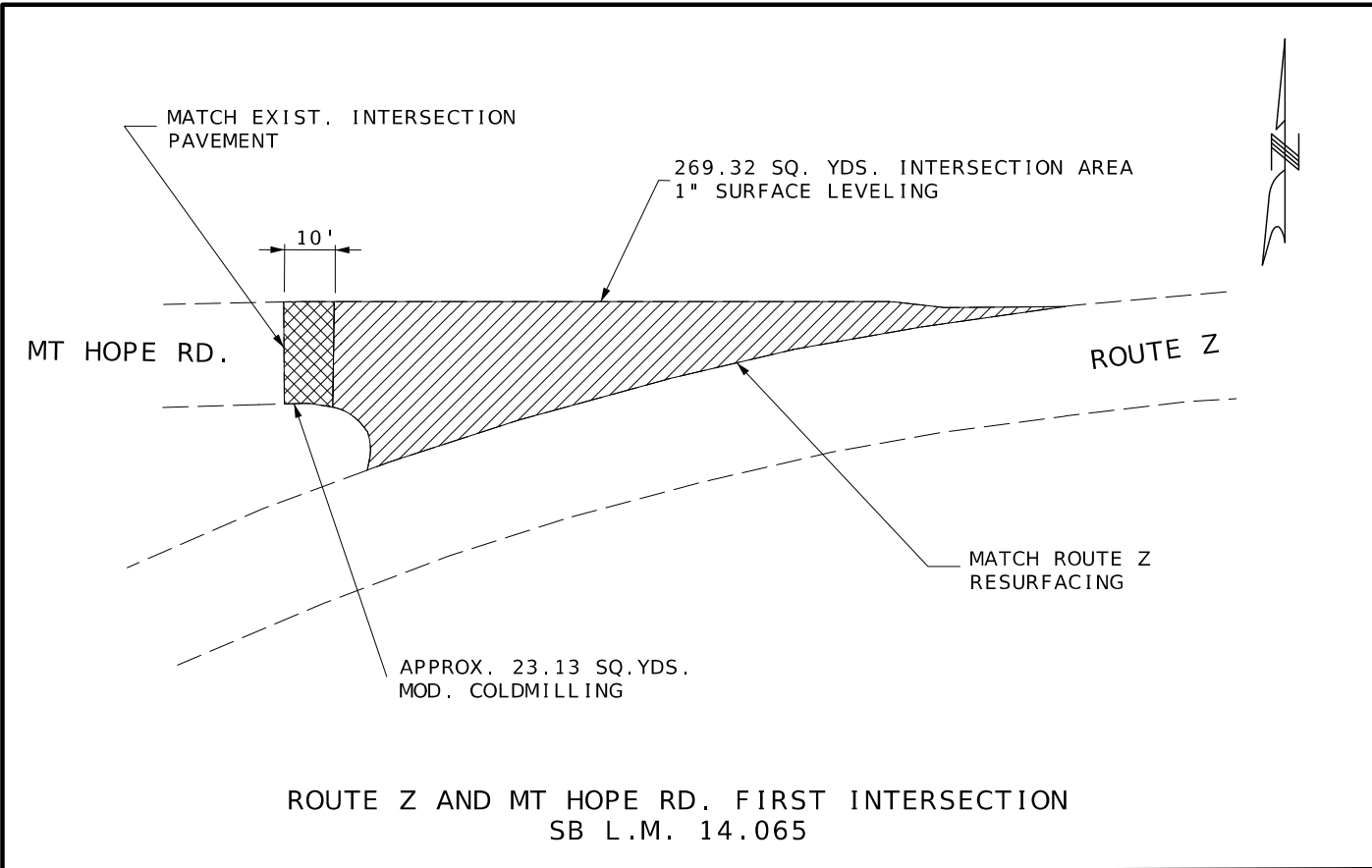
SHEET 3 OF 12

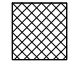

-  1" SURFACE LEVELING
-  MODIFIED COLDMILLING & 1" SURFACE LEVELING
-  COLDMILL 1" & 1" SURFACE LEVELING

NOT TO SCALE

SPECIAL SHEET  
4 OF 12



STATE OF MISSOURI  
PATRICK J. HAKE  
NUMBER  
PE-201000826  
PROFESSIONAL ENGINEER

DATE PREPARED 6/3/2024	
ROUTE OO/HH/Z	STATE MO
DISTRICT CD	SHEET NO. 7
COUNTY BOONE	
JOB NO. JCD0049	
CONTRACT ID.	
PROJECT NO.	
BRIDGE NO.	

DATE	DESCRIPTION

MISSOURI HIGHWAYS AND TRANSPORTATION COMMISSION



105 WEST CAPITOL  
JEFFERSON CITY, MO 65102  
1-888-ASK-MODOT (1-888-275-6636)

SPECIAL SHEET  
SHEET 4 OF 12

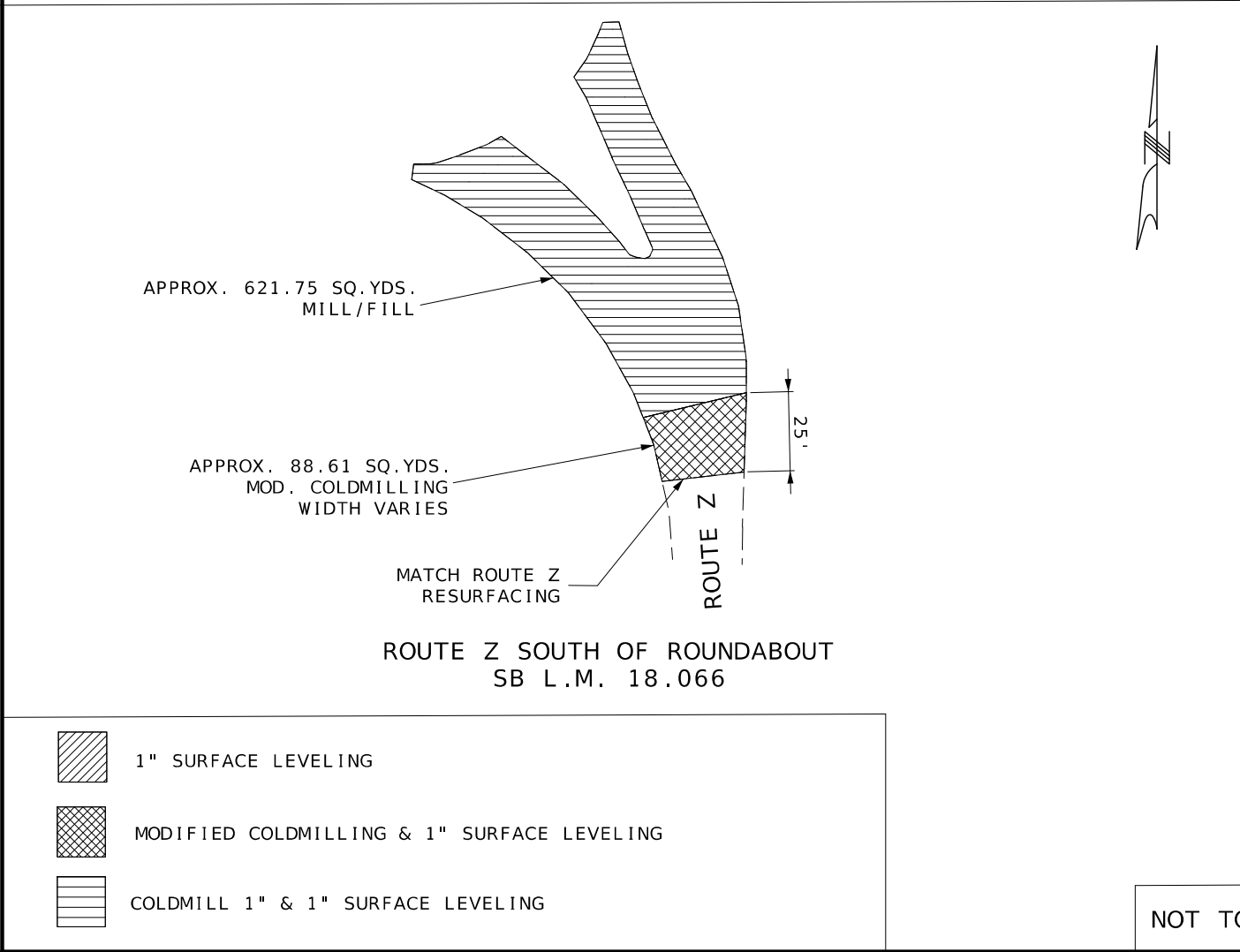
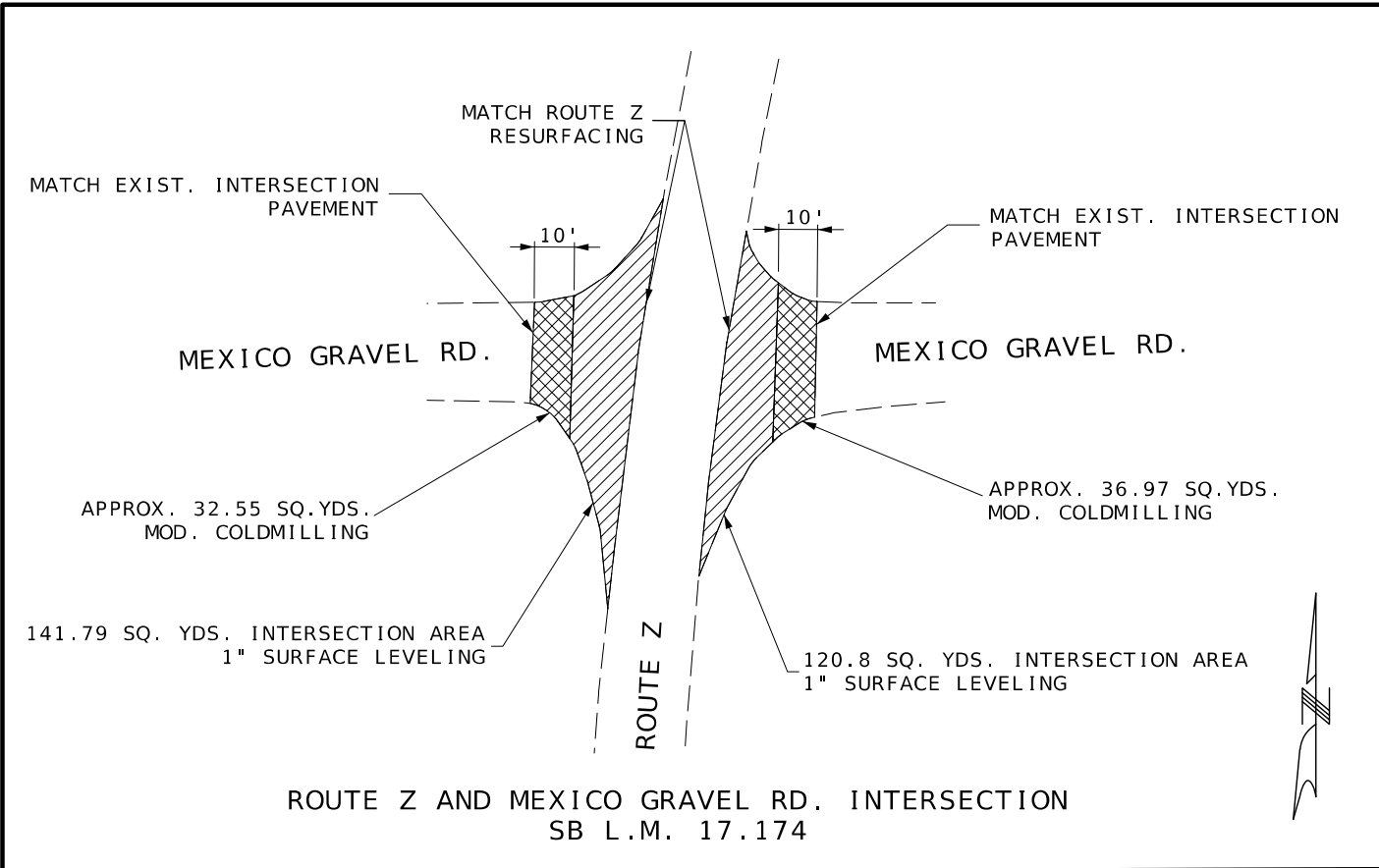

NOT TO SCALE

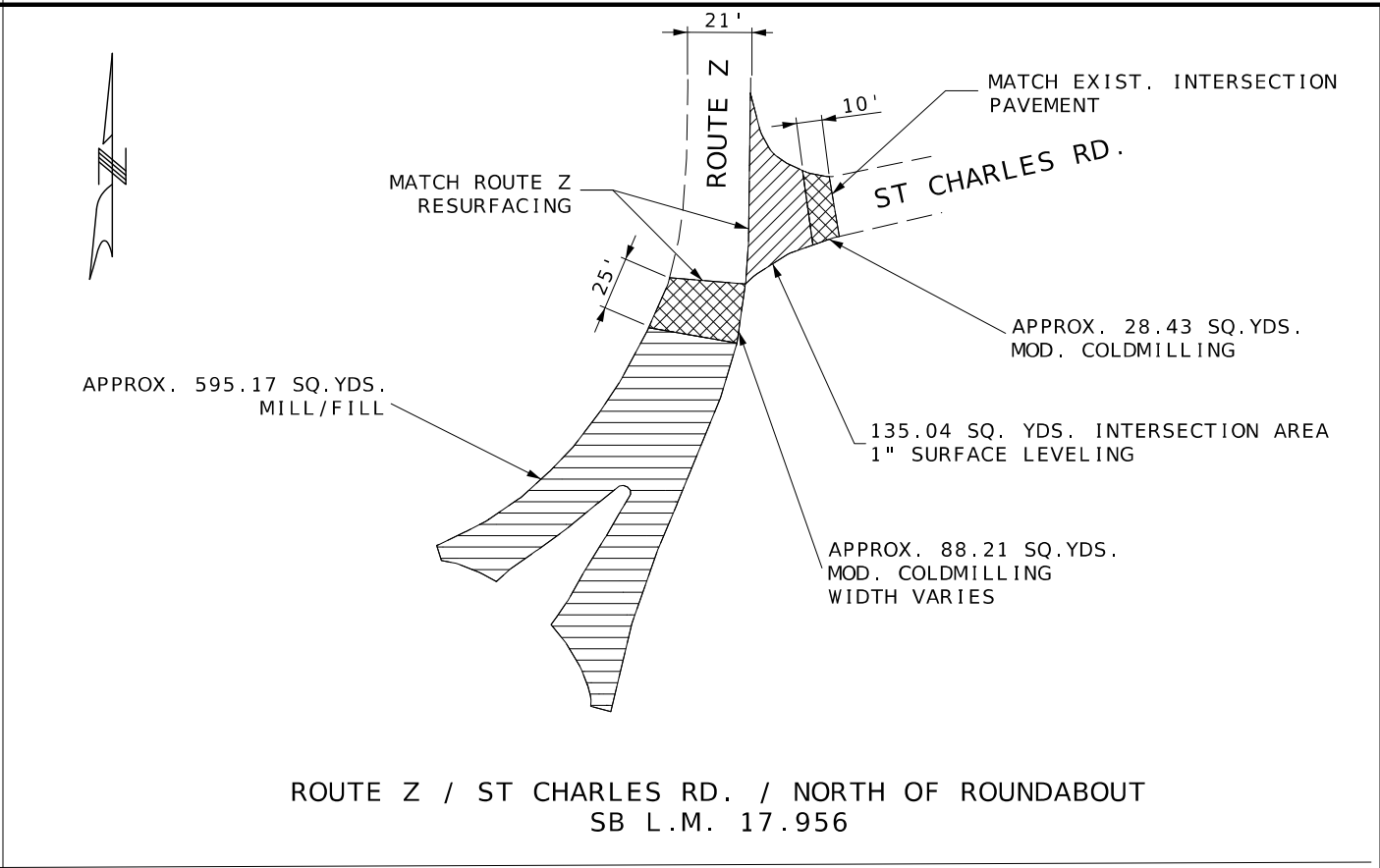

STATE OF MISSOURI  
PATRICK J. HAKE  
NUMBER  
PE-2010000826  
PROFESSIONAL ENGINEER

DATE PREPARED 6/3/2024	
ROUTE OO/HH/Z	STATE MO
DISTRICT CD	SHEET NO. 8
COUNTY BOONE	
JOB NO. JCD0049	
CONTRACT ID.	
PROJECT NO.	
BRIDGE NO.	

DATE	DESCRIPTION

MISSOURI HIGHWAYS AND TRANSPORTATION COMMISSION

105 WEST CAPITOL  
JEFFERSON CITY, MO 65102  
1-888-ASK-MODOT (1-888-275-6636)

SPECIAL SHEET  
SHEET 5 OF 12

SPECIAL SHEET  
5 OF 12

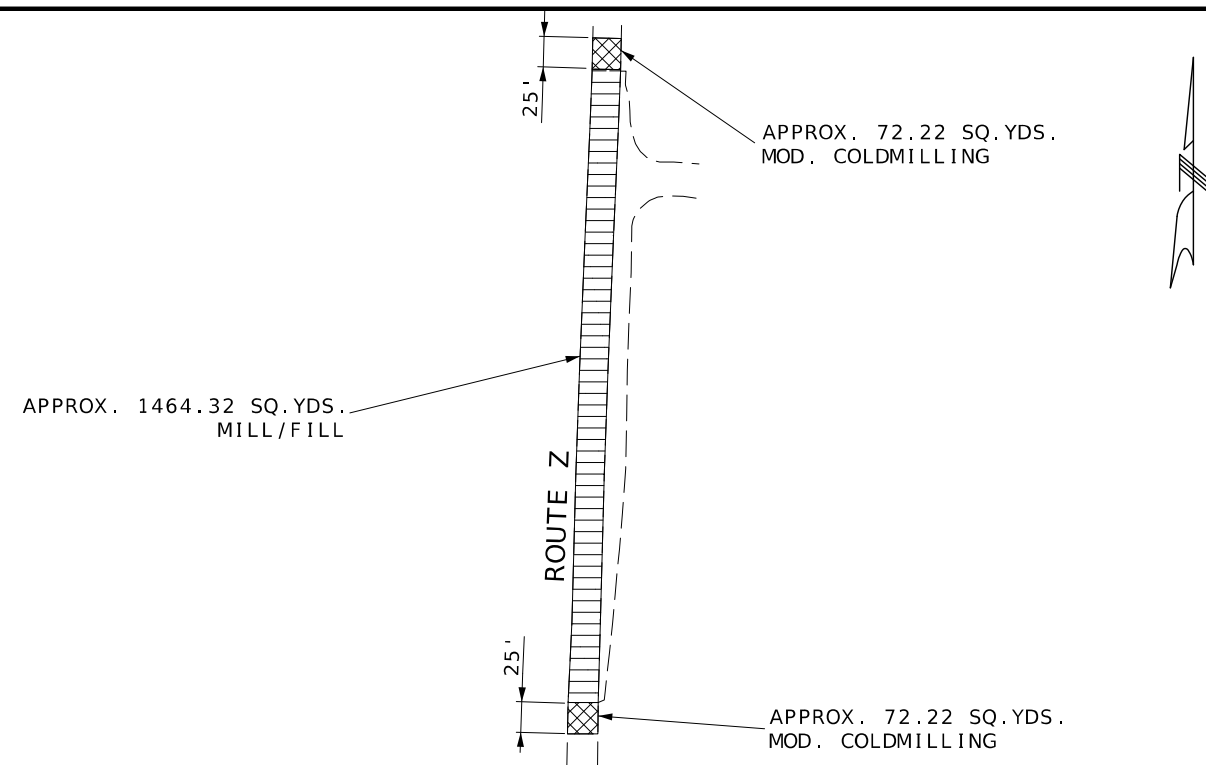

APPROX. 72.22 SQ. YDS.  
MOD. COLD MILLING

APPROX. 72.22 SQ.YDS.  
MOD. COLD MILLING

ROUTE Z AND SECOND OUTDOOR BRANDS DRIVEWAY INTERSECTION  
SB L.M. 18.458

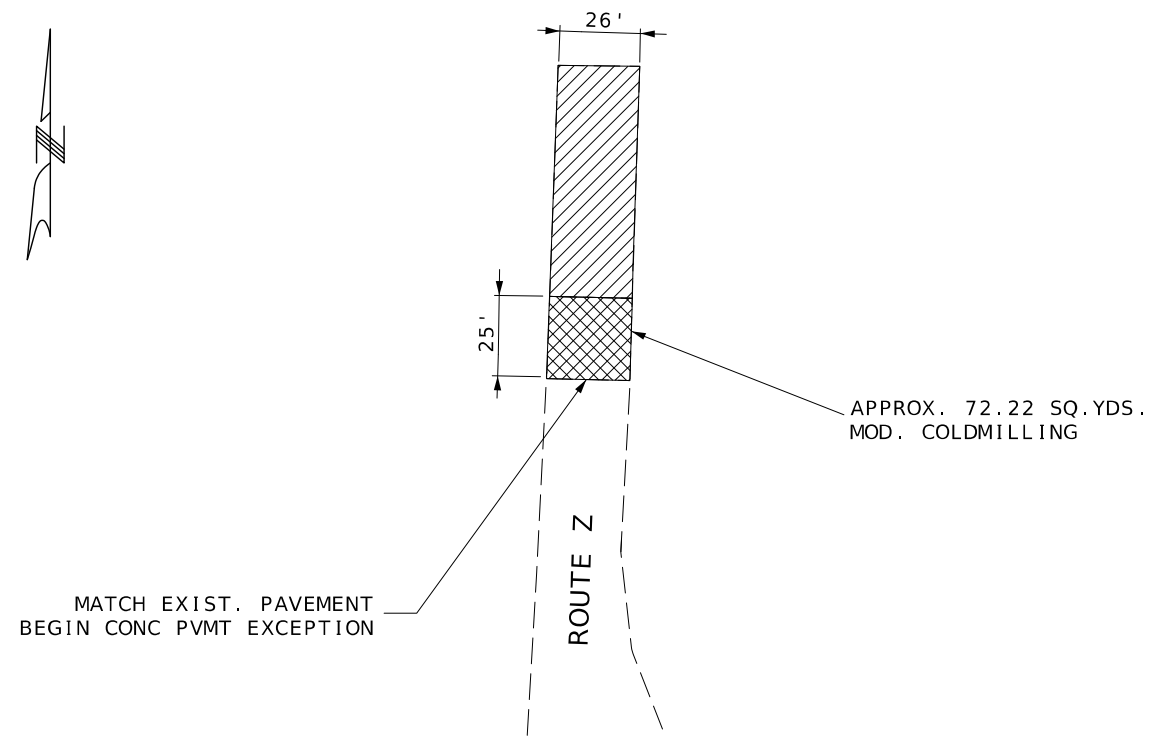

MATCH EXIST. PAVEMENT  
BEGIN CONC PVMT EXCEPTION

END OF ROUTE Z OVERLAY  
SB L.M. 18.692

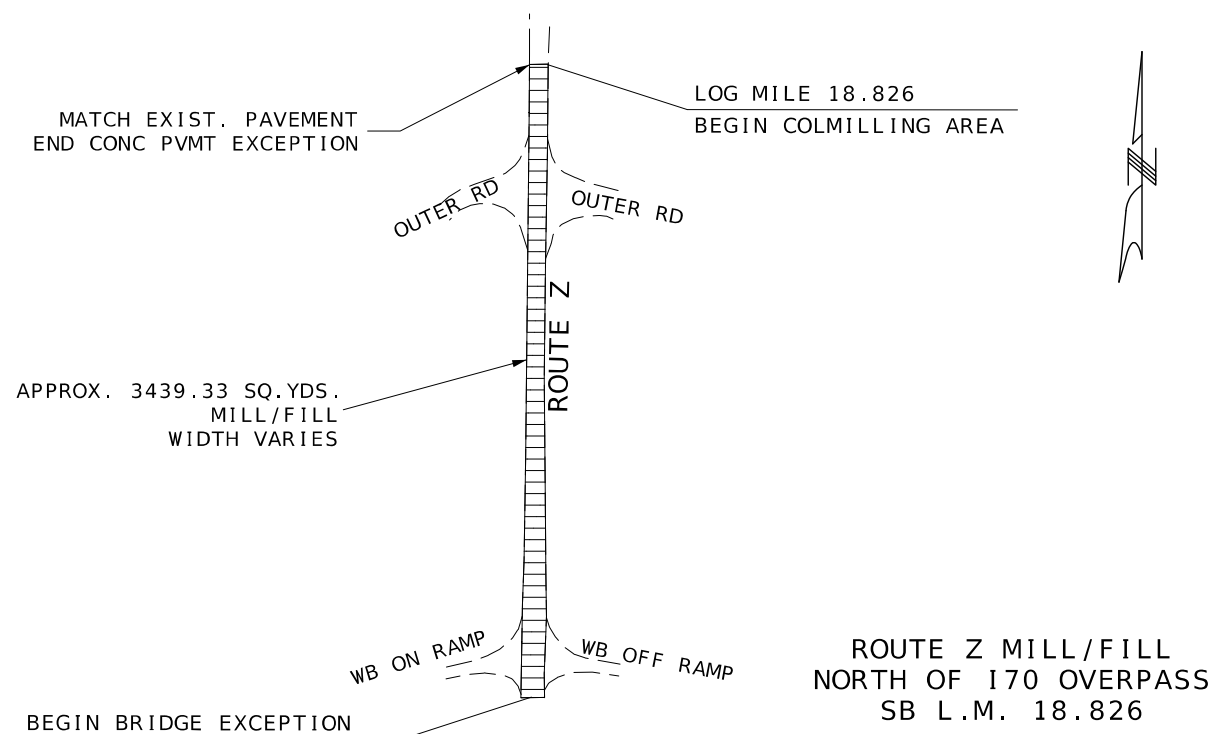

LOG MILE 18.826  
BEGIN COLMILLING AREA

APPROX. 3439.33 SQ.YDS.  
MILL/FILL  
WIDTH VARIES

ROUTE Z MILL/FILL  
NORTH OF I70 OVERPASS  
SB L.M. 18.826

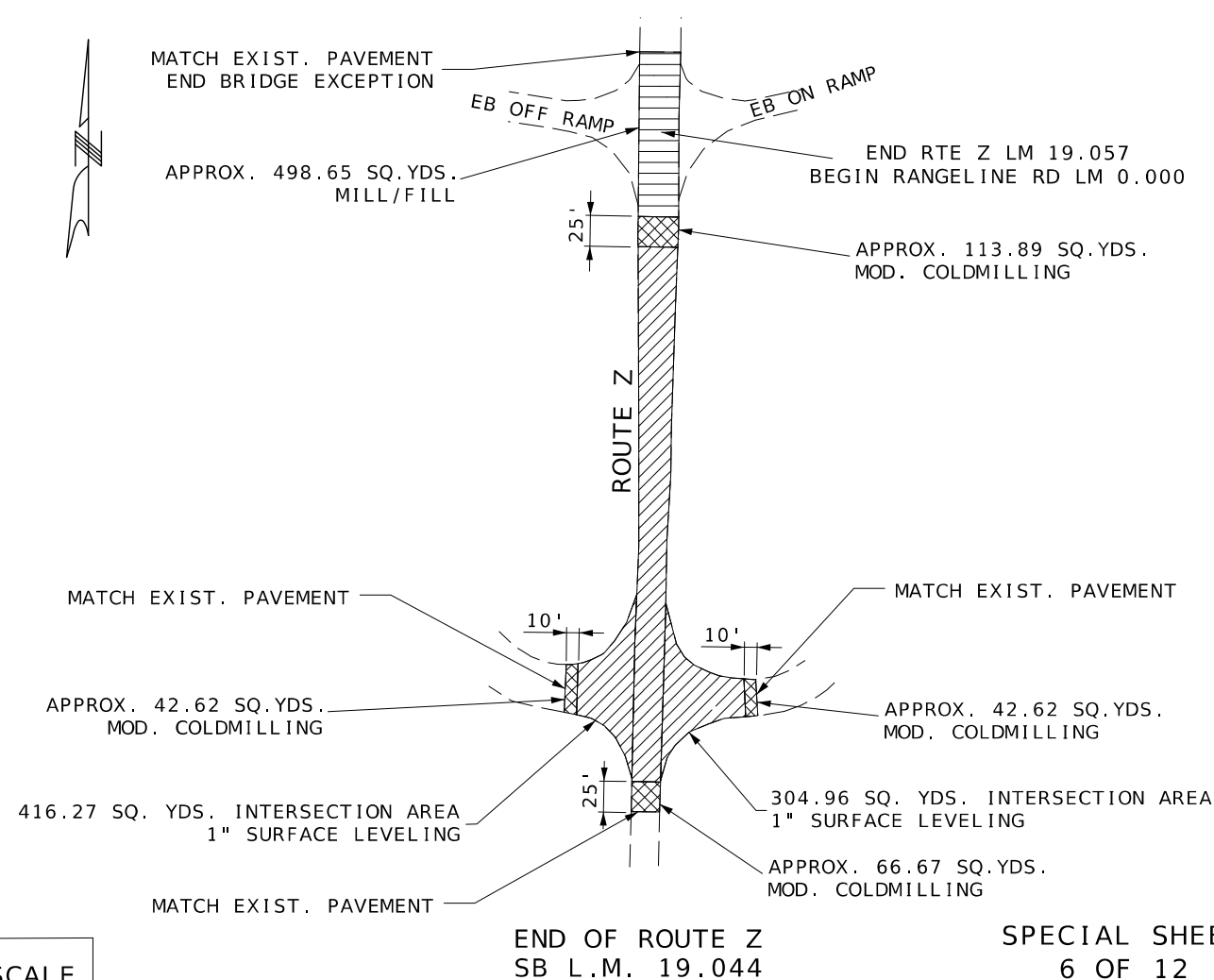

APPROX. 498.65 SQ.YDS.  
MILL/FILL

END RTE Z LM 19.057  
BEGIN RANGELINE RD LM 0.000

APPROX. 113.89 SQ.YDS.  
MOD. COLDMILLING

MATCH EXIST. PAVEMENT

APPROX. 42.62 SQ.YDS.  
MOD. COLDMILLING

— MATCH EXIST. PAVEMENT

— APPROX. 42.62 SQ.YDS.  
MOD. COLDMILLING

304.96 SQ. YDS. INTERSECTION AREA  
1" SURFACE LEVELING

APPROX. 66.67 SQ.YDS.  
MOD. COLD MILLING

END OF ROUTE Z  
SB L.M. 19.044

SPECIAL SHEET  
6 OF 12

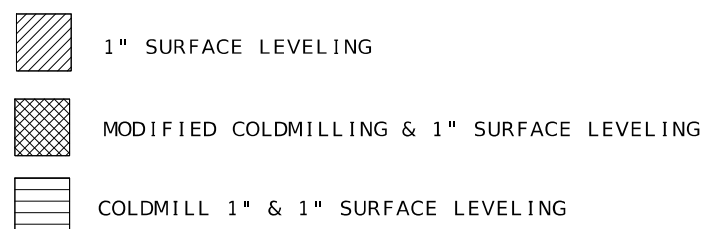

MODIFIED COLDMILLING & 1" SURFACE LEVELING

COLDMILL 1" & 1" SURFACE LEVELING

NOT TO SCALE

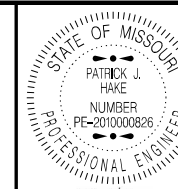

Patrick Hake  
&[Date] &[Time]  
PATRICK J. HAKE - CIVIL  
MO-PE-2010000826

ROUTE	STATE
00/HH/7	MO

DISTRICT	SHEET NO.
CD	9

COUNTY  
BOONE

JOB NO.  
JCD0049

CONTRACT ID.

PROJECT NO.

BRIDGE NO.

[illegible]MISSOURI HIGHWAYS AND TRANSPORTATION  
COMMISSION

SPECIAL SHEET  
SHEET 6 OF 12

[illegible]

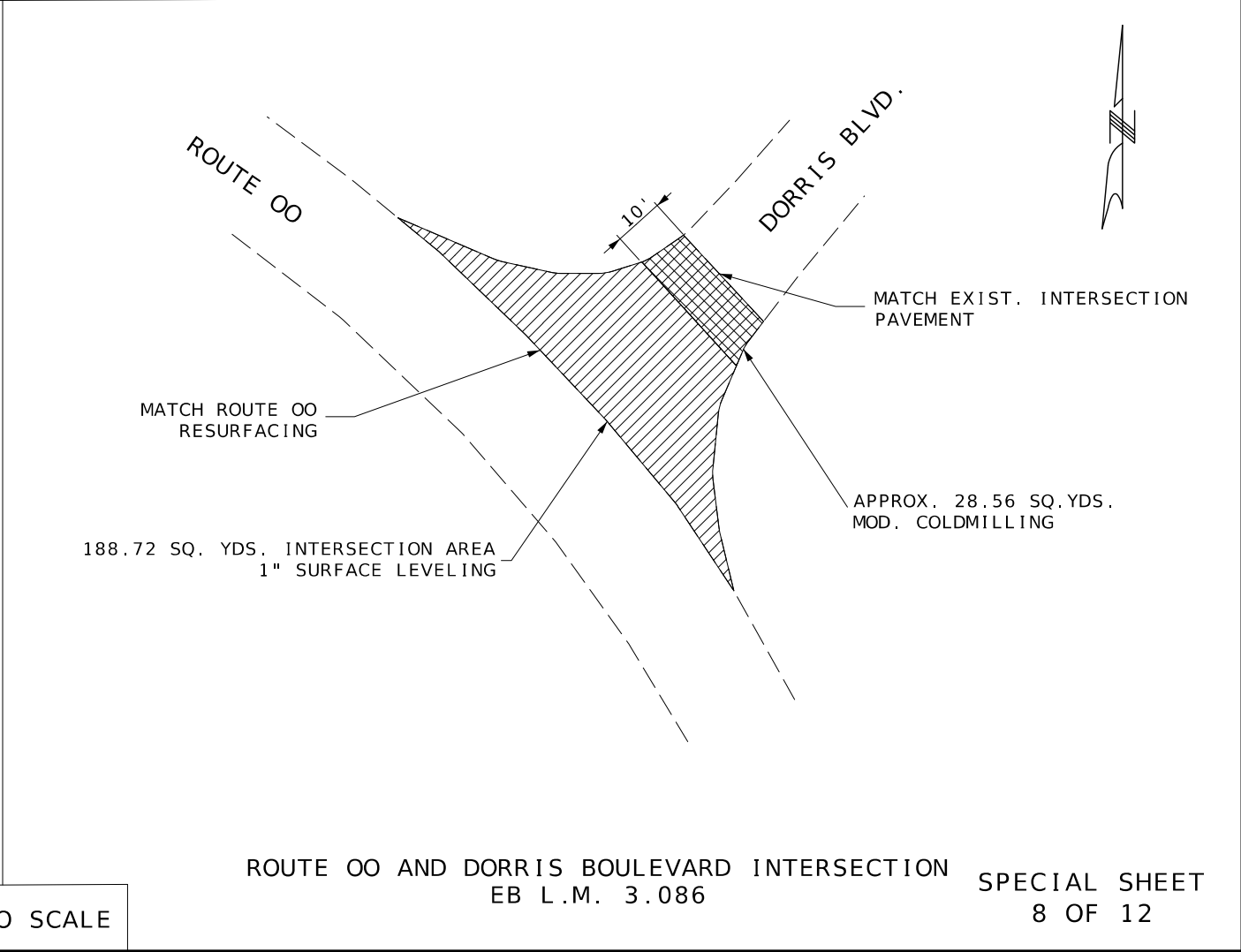
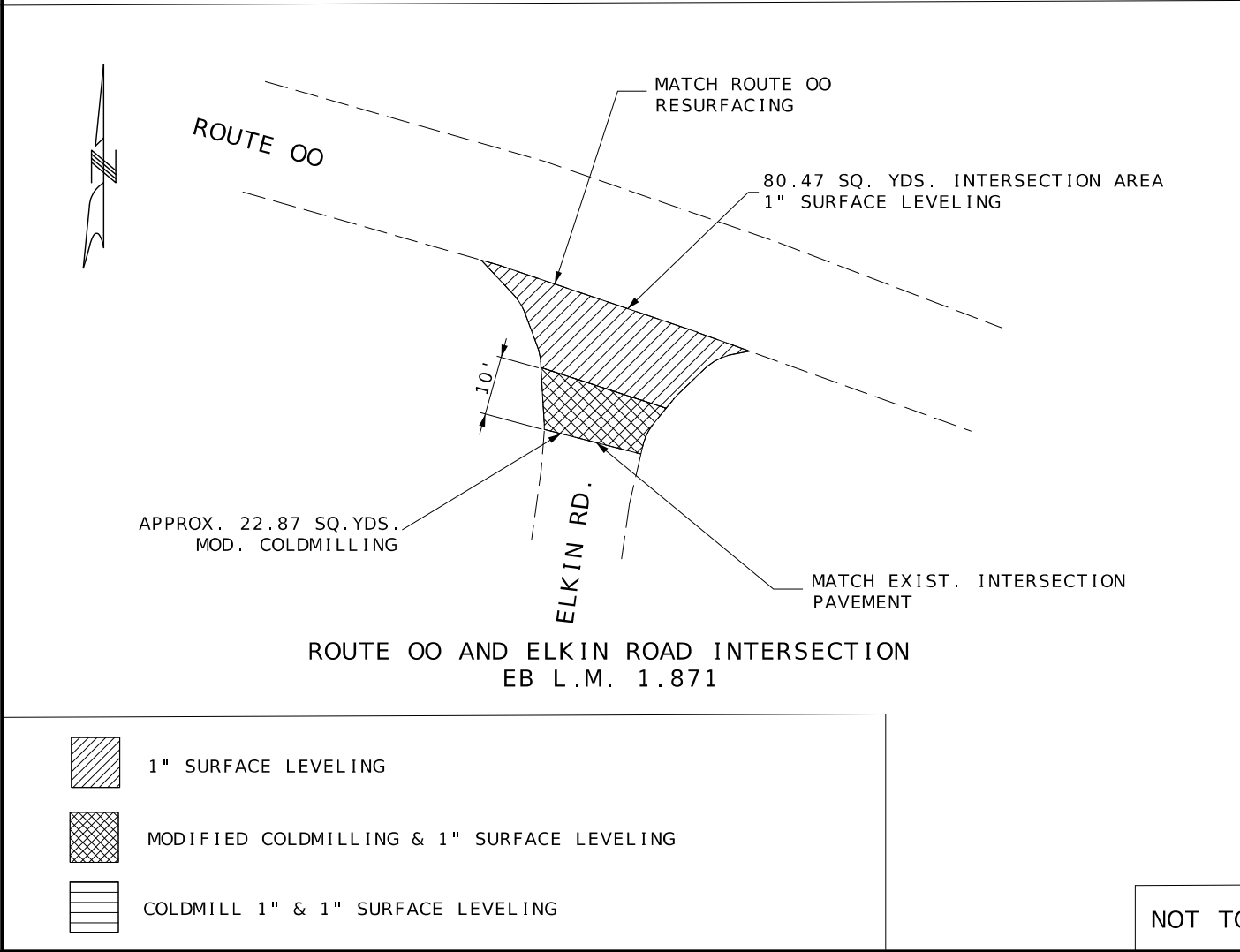
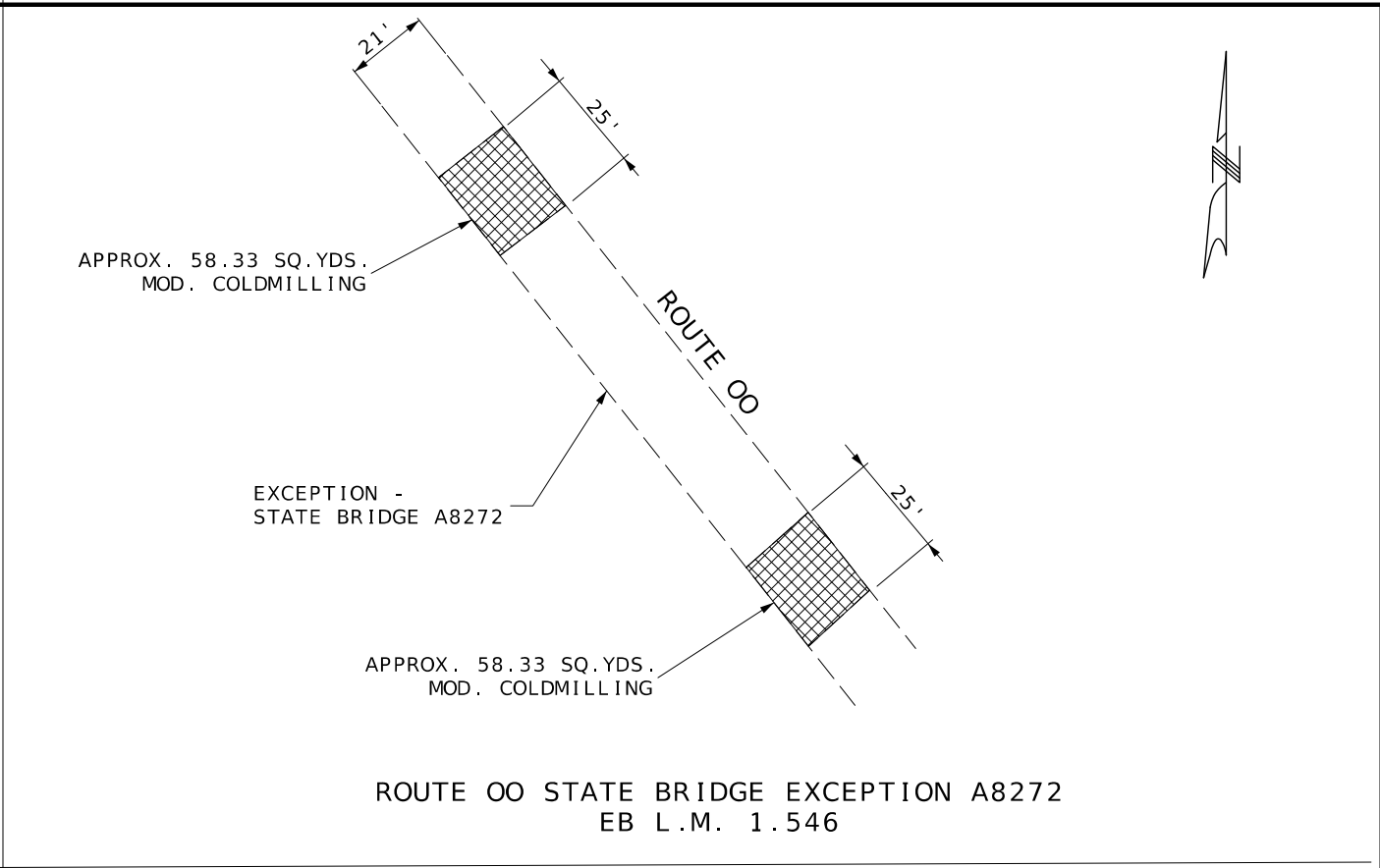
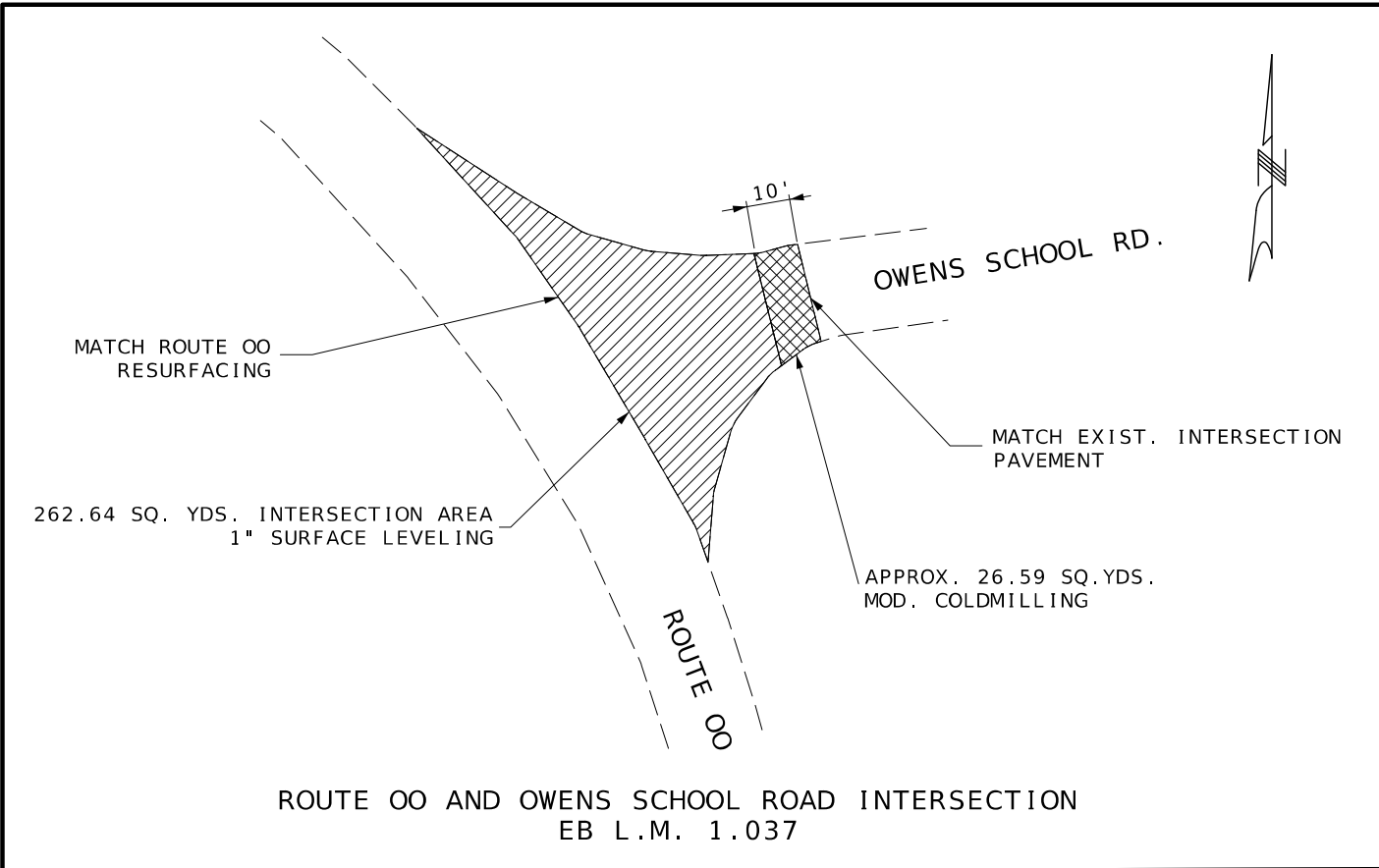

1" SURFACE LEVELING

MODIFIED COLDMILLING & 1" SURFACE LEVELING

COLDMILL 1" & 1" SURFACE LEVELING

NOT TO SCALE

SPECIAL SHEET  
8 OF 12

STATE OF MISSOURI

PATRICK J. HAKE

NUMBER

PE-2010000826

PROFESSIONAL ENGINEER

DATE PREPARED

6/3/2024

ROUTE

OO/HH/Z

DISTRICT

CD

STATE

MO

SHEET NO.

11

COUNTY

BOONE

JOB NO.

JCD0049

CONTRACT ID.

PROJECT NO.

BRIDGE NO.

DESCRIPTION

DATE

MISSOURI HIGHWAYS AND TRANSPORTATION COMMISSION

105 WEST CAPITOL  
JEFFERSON CITY, MO 65102  
1-888-ASK-MODOT (1-888-275-6636)



SPECIAL SHEET

SHEET 8 OF 12

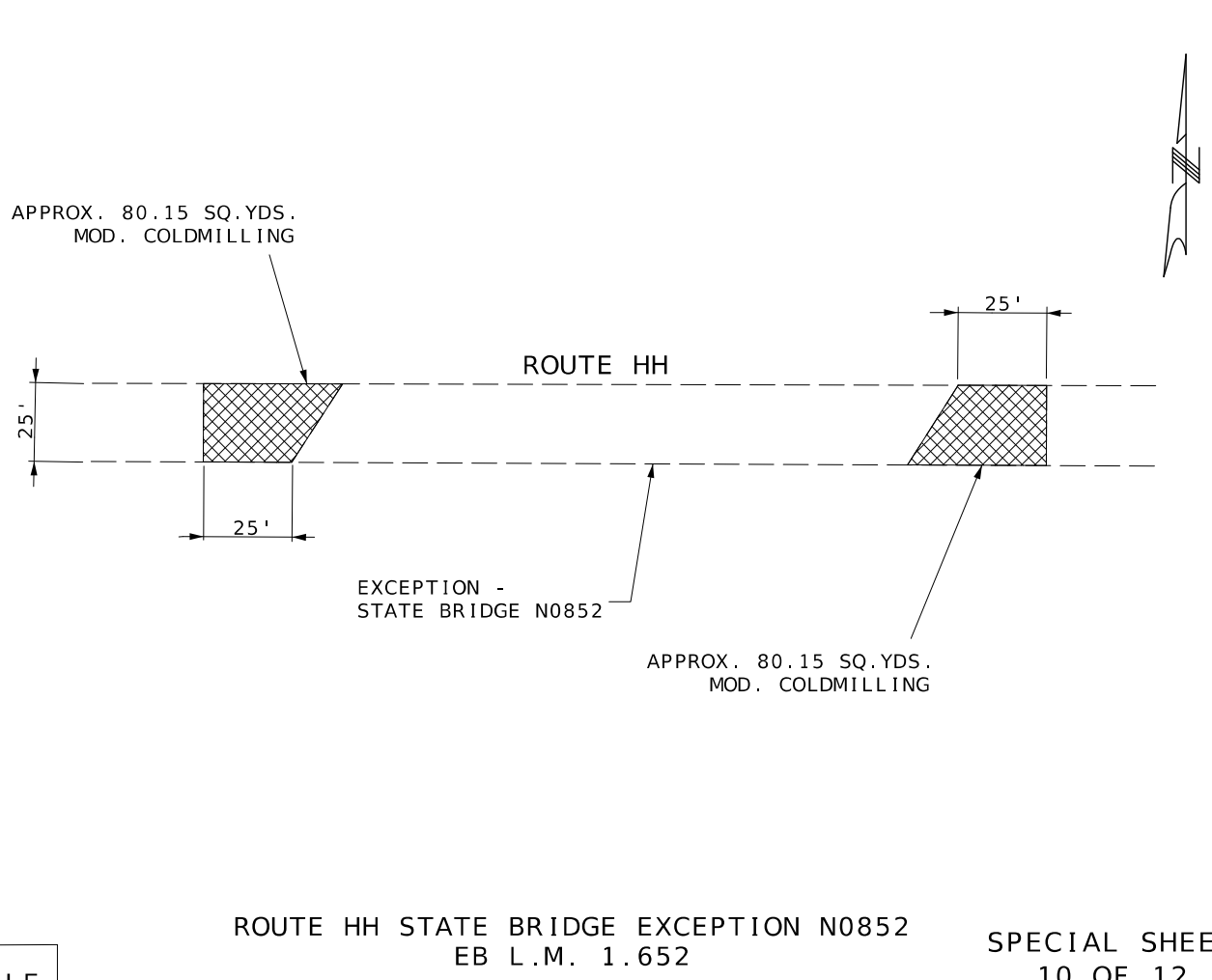
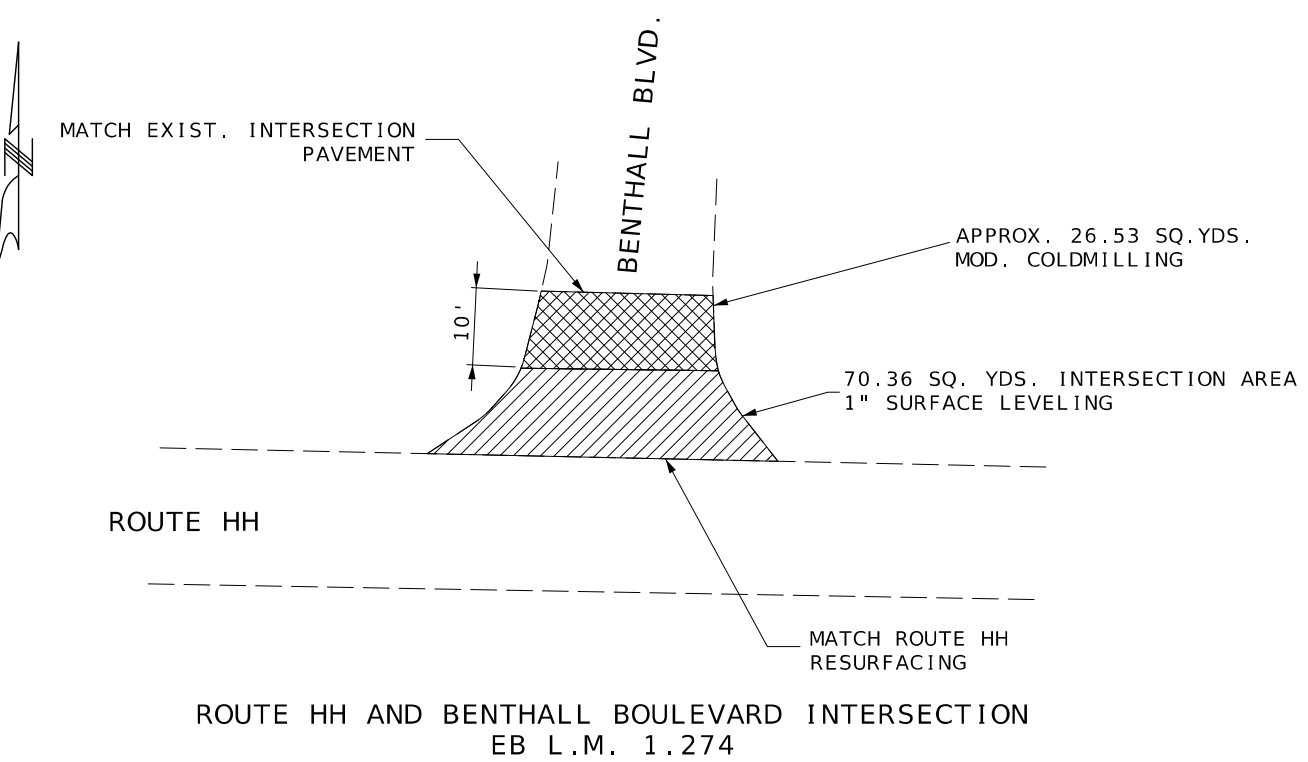
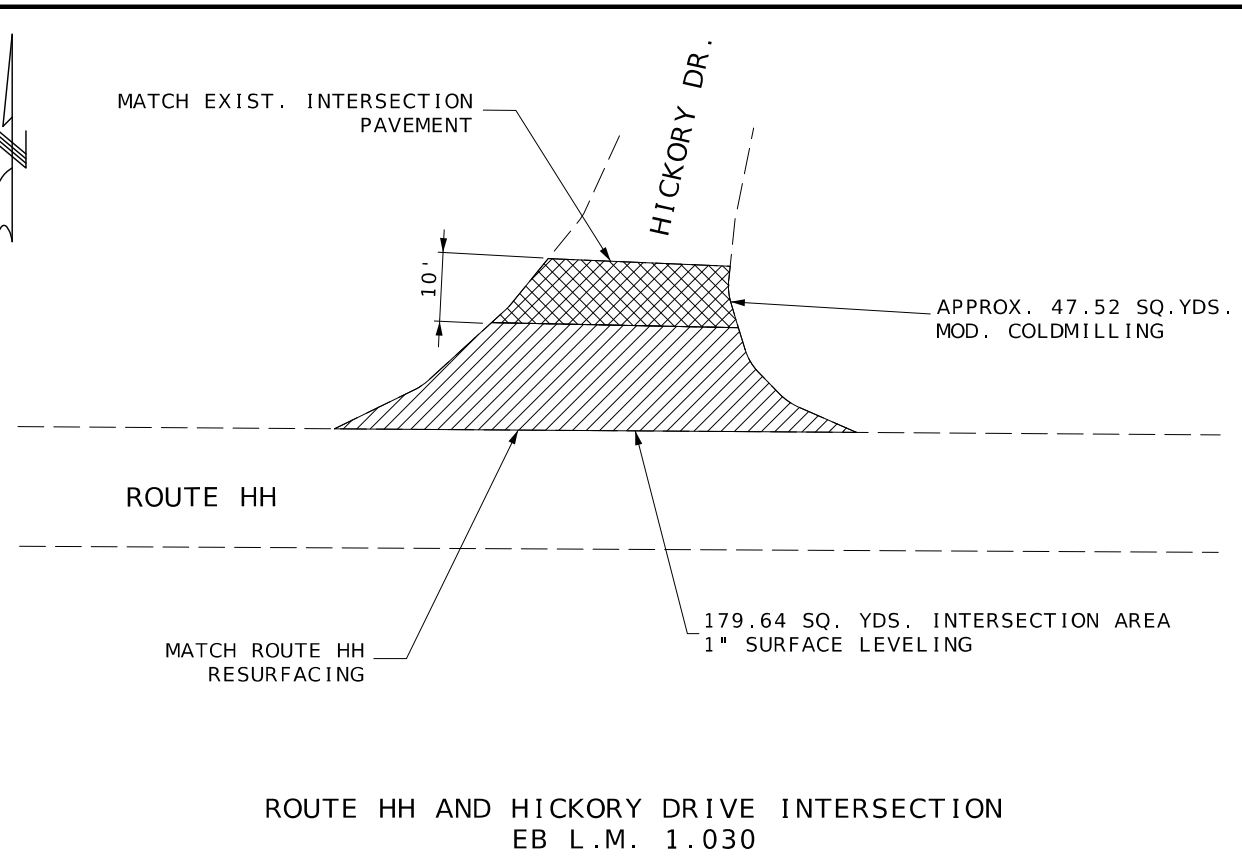
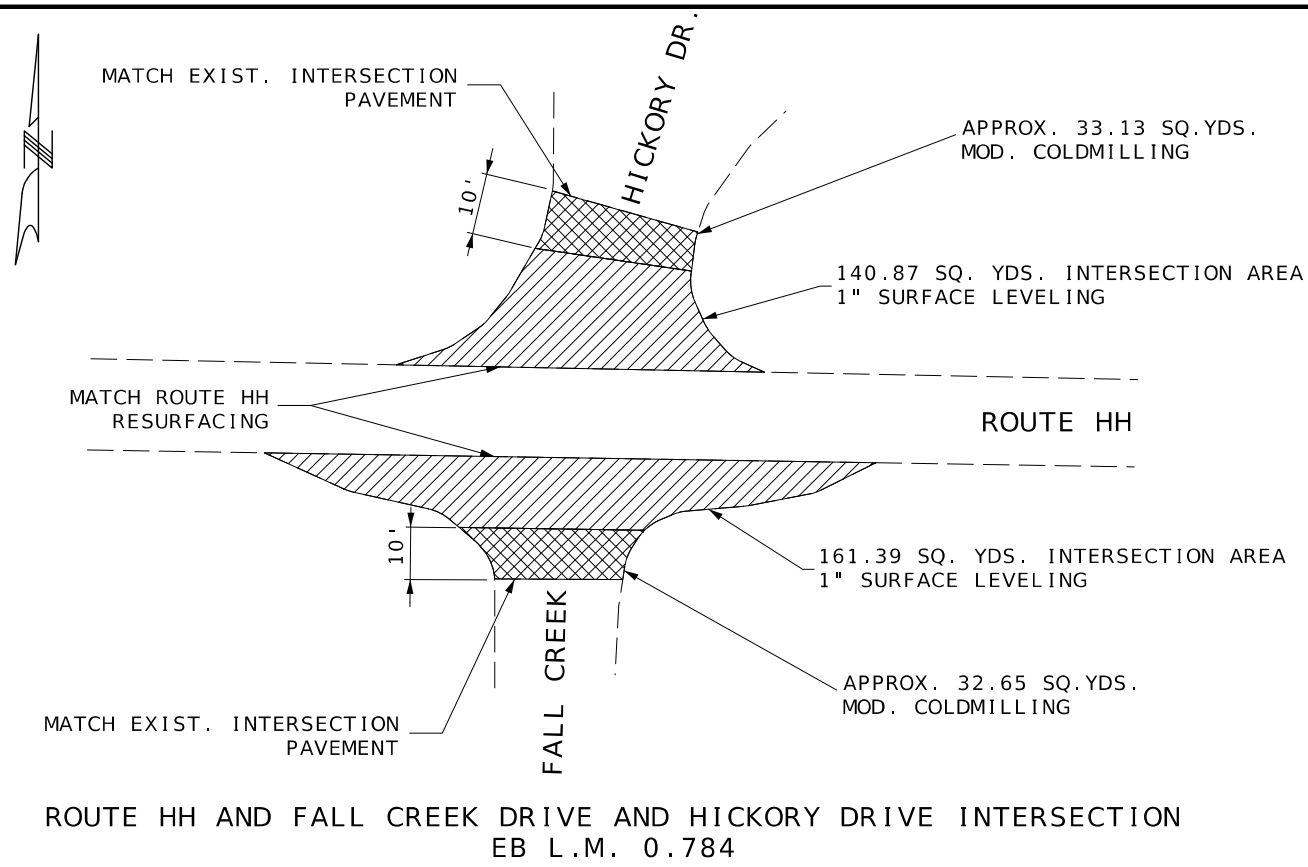

<div>STATE OF MISSOURI PATRICK J. HAKE NUMBER PE-2010000826 PROFESSIONAL ENGINEER</div> <div><i>Patrick Hake</i> [Signature] PATRICK J. HAKE - CIVIL MO-PE-2010000826</div>	
DATE PREPARED 6/3/2024	
ROUTE OO/HH/Z	STATE MO
DISTRICT CD	SHEET NO. 12
COUNTY BOONE	
JOB NO. JCD0049	
CONTRACT ID.	
PROJECT NO.	
BRIDGE NO.	
DATE	DESCRIPTION
MISSOURI HIGHWAYS AND TRANSPORTATION COMMISSION	
<div><div>105 WEST CAPITOL JEFFERSON CITY, MO 65102 1-888-ASK-MODOT (1-888-275-6636)</div></div>	
SPECIAL SHEET SHEET 9 OF 12	



-  1" SURFACE LEVELING
-  MODIFIED COLDMILLING & 1" SURFACE LEVELING
-  COLDMILL 1" & 1" SURFACE LEVELING

NOT TO SCALE

SPECIAL SHEET  
10 OF 12



STATE OF MISSOURI  
PATRICK J. HAKE  
NUMBER  
PE-2010000826  
PROFESSIONAL ENGINEER

DATE PREPARED 6/3/2024	
ROUTE OO/HH/Z	STATE MO
DISTRICT CD	SHEET NO. 13
COUNTY BOONE	
JOB NO. JCD0049	
CONTRACT ID.	
PROJECT NO.	
BRIDGE NO.	

DATE	DESCRIPTION

MISSOURI HIGHWAYS AND TRANSPORTATION COMMISSION



105 WEST CAPITOL  
JEFFERSON CITY, MO 65102  
1-888-ASK-MODOT (1-888-275-6636)

SPECIAL SHEET  
SHEET 10 OF 12

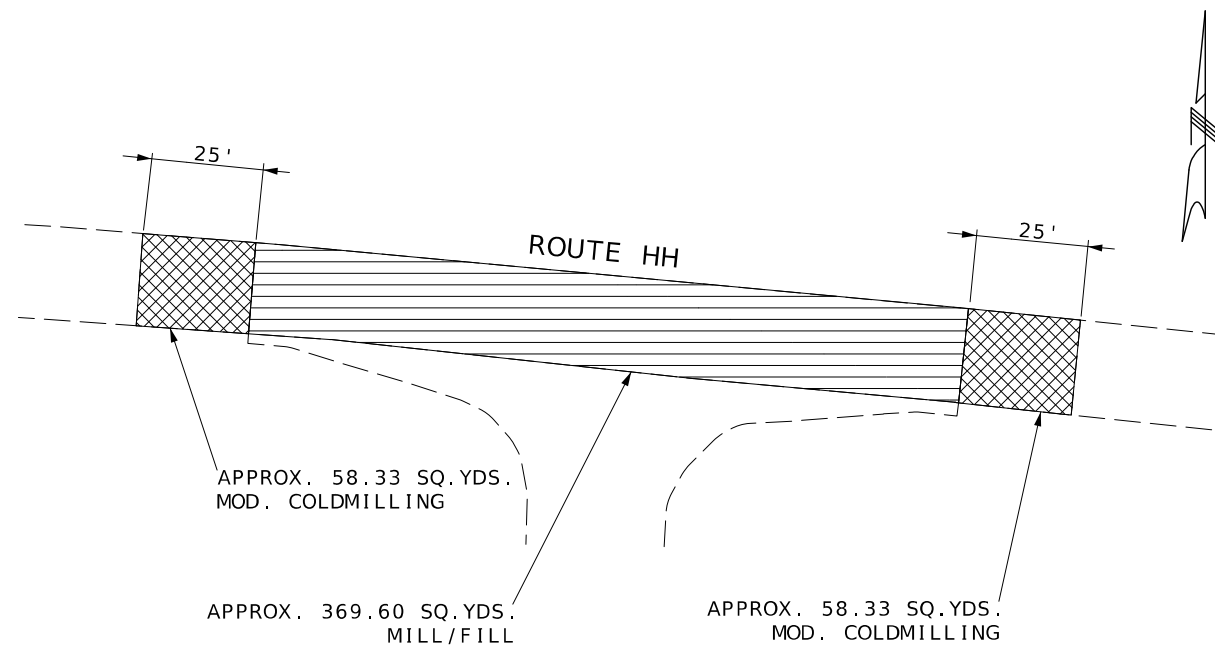

ROUTE HH FIRE STATION ENTRANCE  
EB L.M. 1.919

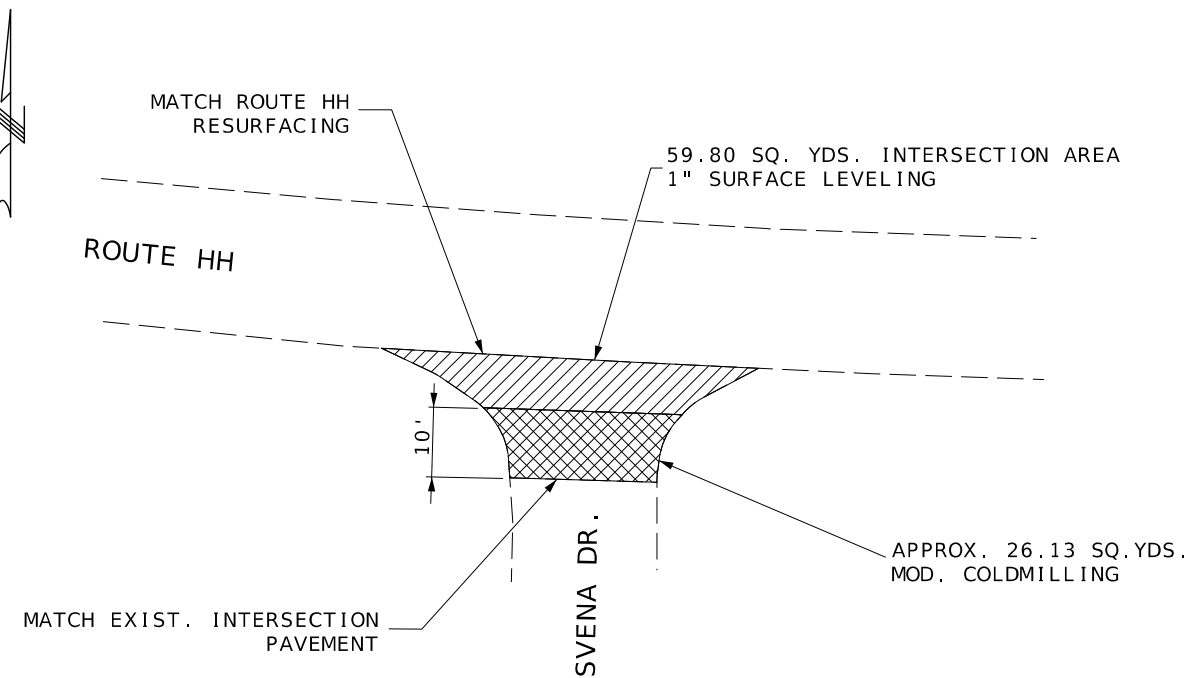

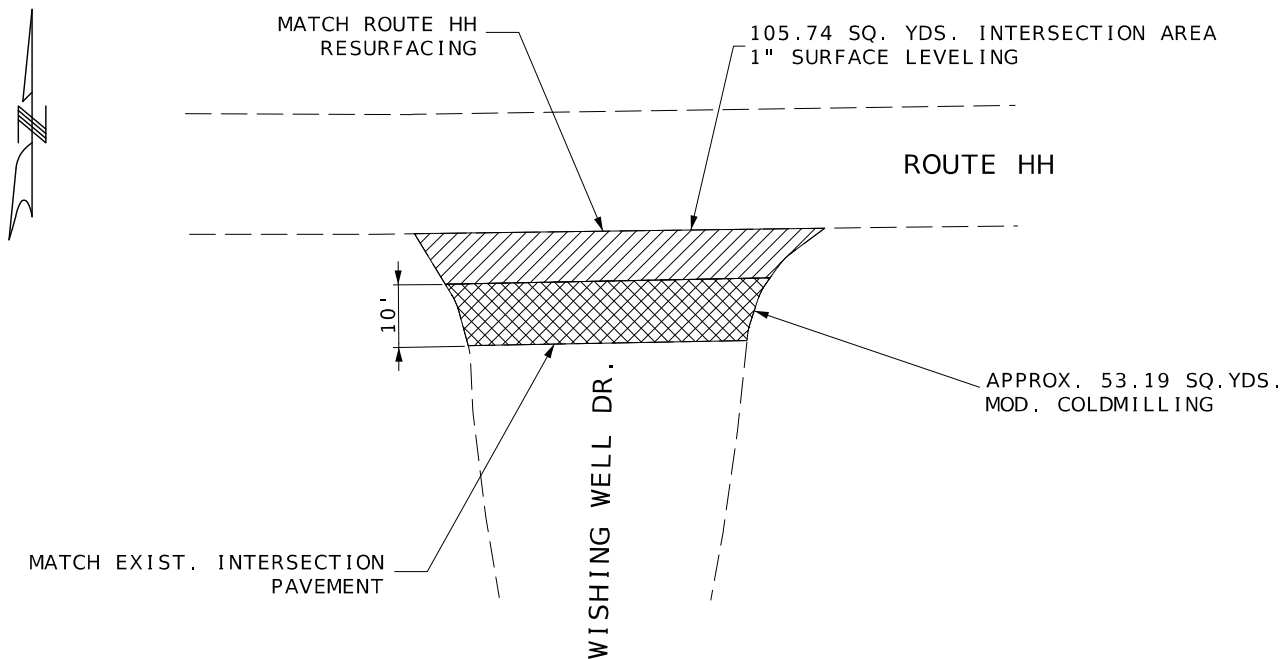

ROUTE HH AND SVENA DRIVE INTERSECTION  
EB L.M. 1.977

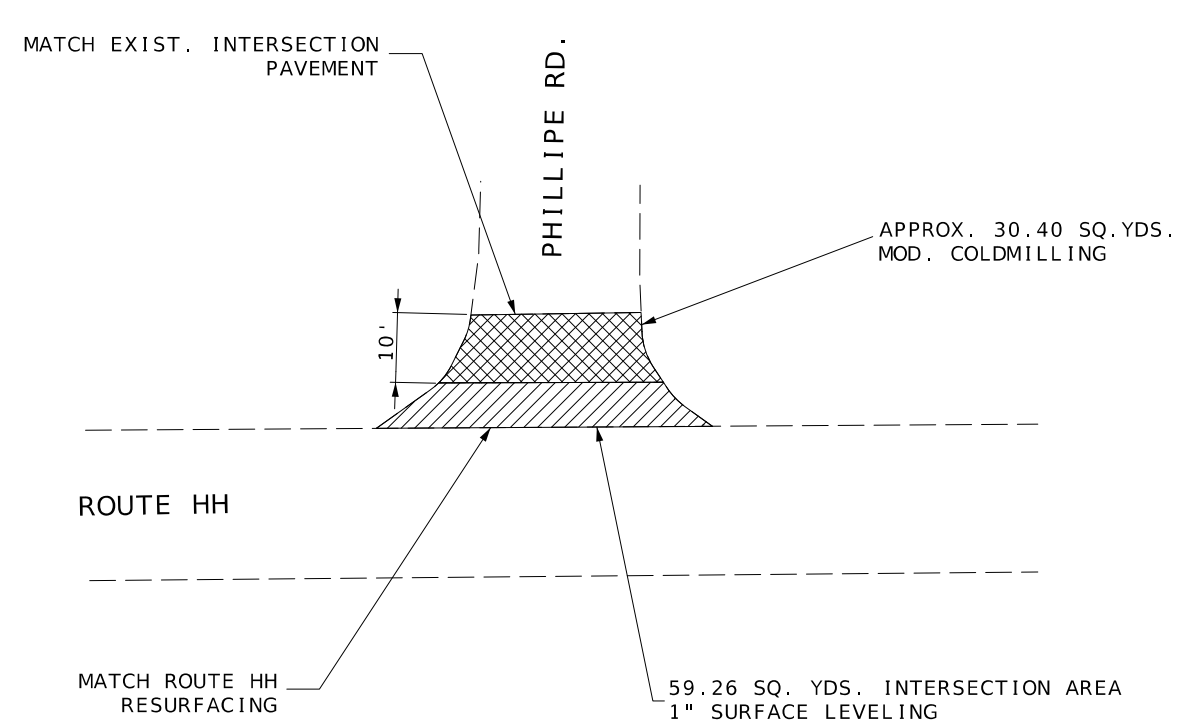

ROUTE HH AND WISHING WELL DRIVE INTERSECTION  
EB L.M. 2.050

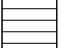

ROUTE HH AND PHILLIPE ROAD INTERSECTION  
EB L.M. 3.573

-  1" SURFACE LEVELING
-  MODIFIED COLDMILLING & 1" SURFACE LEVELING
-  COLDMILL 1" & 1" SURFACE LEVELING

NOT TO SCALE

SPECIAL SHEET  
11 OF 12

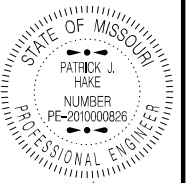

DATE PREPARED  
6/3/2024

ROUTE  
OO/HH/Z

STATE  
MO

DISTRICT  
CD

SHEET NO.  
14

COUNTY  
BOONE

JOB NO.  
JCD0049

CONTRACT ID.

PROJECT NO.

BRIDGE NO.

DESCRIPTION

DATE

MISSOURI HIGHWAYS AND TRANSPORTATION  
COMMISSION



105 WEST CAPITOL  
JEFFERSON CITY, MO 65102

1-888-ASK-MODOT (1-888-275-6636)

MoDOT

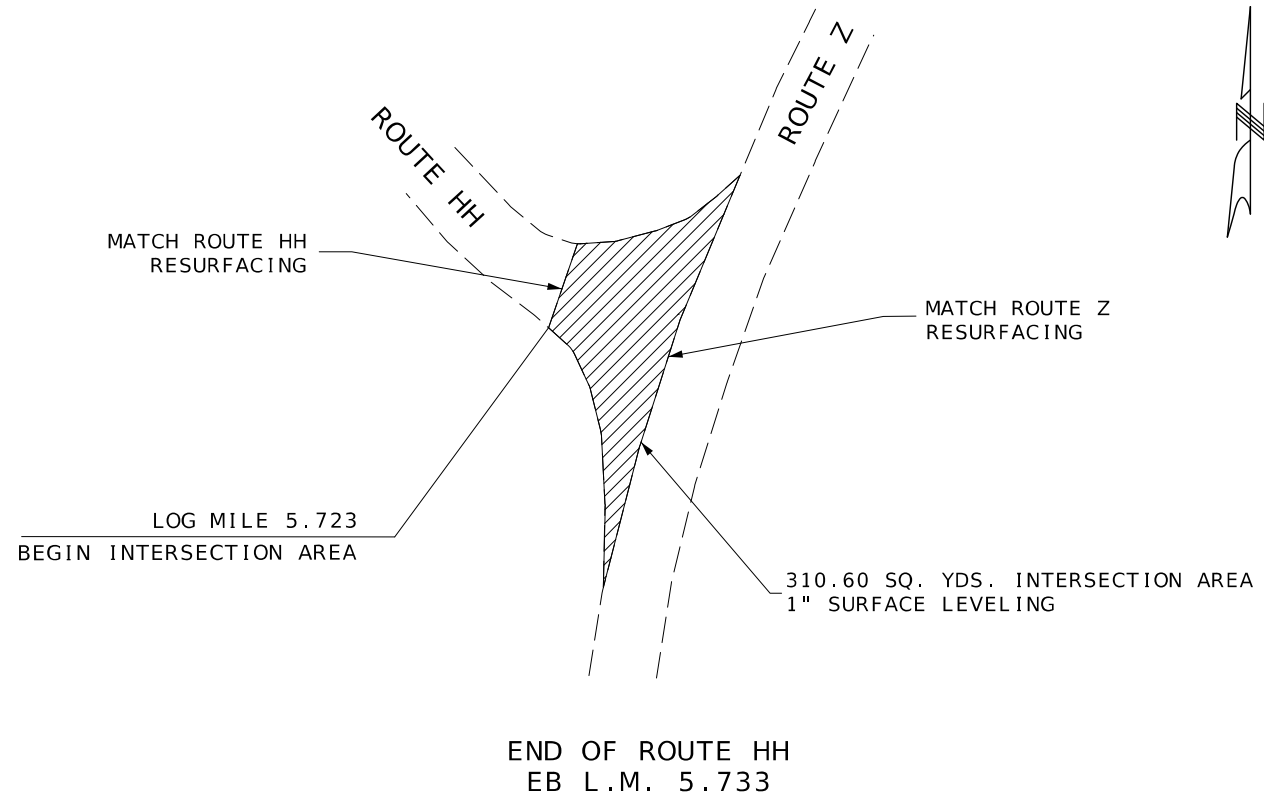
SPECIAL SHEET  
SHEET 11 OF 12

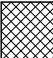

-  1" SURFACE LEVELING
-  MODIFIED COLDMILLING & 1" SURFACE LEVELING
-  COLDMILL 1" & 1" SURFACE LEVELING

NOT TO SCALE

SPECIAL SHEET  
12 OF 12

STATE OF MISSOURI

PATRICK J. HAKE

NUMBER

PE-2010000826

PROFESSIONAL ENGINEER



8[Date] 8[Time]

PATRICK J. HAKE - CIVIL

MO-PE-2010000826

DATE PREPARED

6/3/2024

ROUTE

STATE

OO/HH/Z

MO

DISTRICT

SHEET NO.

CD

15

COUNTY

BOONE

JOB NO.

JCD0049

CONTRACT ID.

PROJECT NO.

BRIDGE NO.

DESCRIPTION	DATE

MISSOURI HIGHWAYS AND TRANSPORTATION COMMISSION



105 WEST CAPITOL  
JEFFERSON CITY, MO 65102  
1-888-ASK-MODOT (1-888-275-6636)

SPECIAL SHEET  
SHEET 12 OF 12

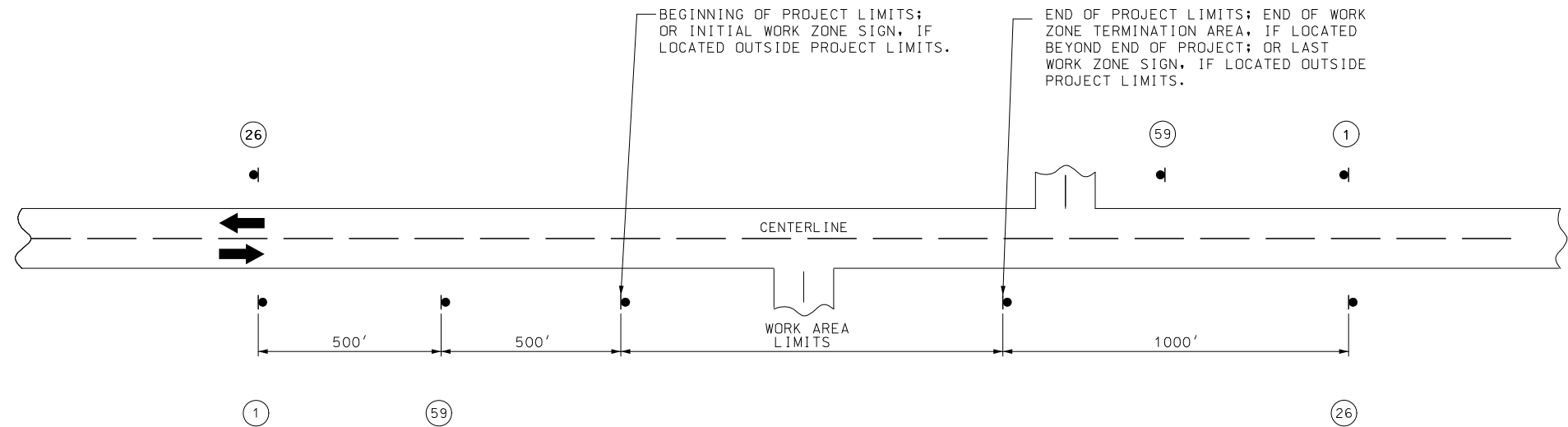

NOTES:

SIGN (1) AND (26) ARE ONLY USED ON PROJECT LENGTHS 2 MILES OR GREATER.

PROVIDE SIGNS IN EACH DIRECTION ON TWO-WAY HIGHWAY.

DISTANCE MAY BE ADJUSTED ACCORDING TO FIELD CONDITIONS.

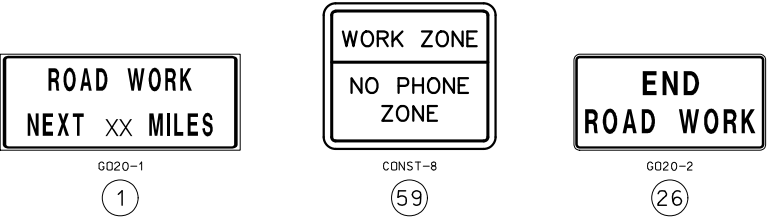

XX = 5 MILES FOR OO  
XX = 6 MILES FOR HH  
XX = 19 MILES FOR Z



DATE PREPARED  
6/3/2024

ROUTE  
OO/HH/Z

STATE  
MO

DISTRICT  
CD

SHEET NO.  
16

COUNTY  
BOONE

JOB NO.  
JCD0049

CONTRACT ID.

PROJECT NO.

BRIDGE NO.

DESCRIPTION

DATE

MISSOURI HIGHWAYS AND TRANSPORTATION COMMISSION

105 WEST CAPITOL  
JEFFERSON CITY, MO 65102  
1-888-ASK-MODOT (1-888-275-6636)

TRAFFIC CONTROL SHEET  
1 OF 5



A horizontal beam is shown with three supports. The supports are labeled 8, 7, and 2 from left to right. The beam is divided into three equal spans, each labeled (S). The beam is supported by a pin support at support 8 and roller supports at supports 7 and 2. The beam is labeled with a circled 8 above support 8, a circled 7 above support 7, and a circled 2 above support 2.

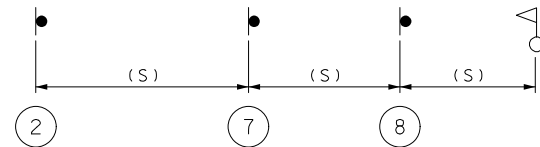

 - FLAGGER

SPACING MAY BE ADJUSTED AS NECESSARY TO MEET FIELD CONDITIONS.

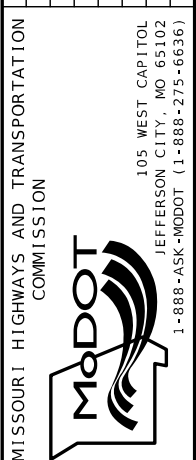

TRAFFIC CONTROL  
SHEET 2 OF 5

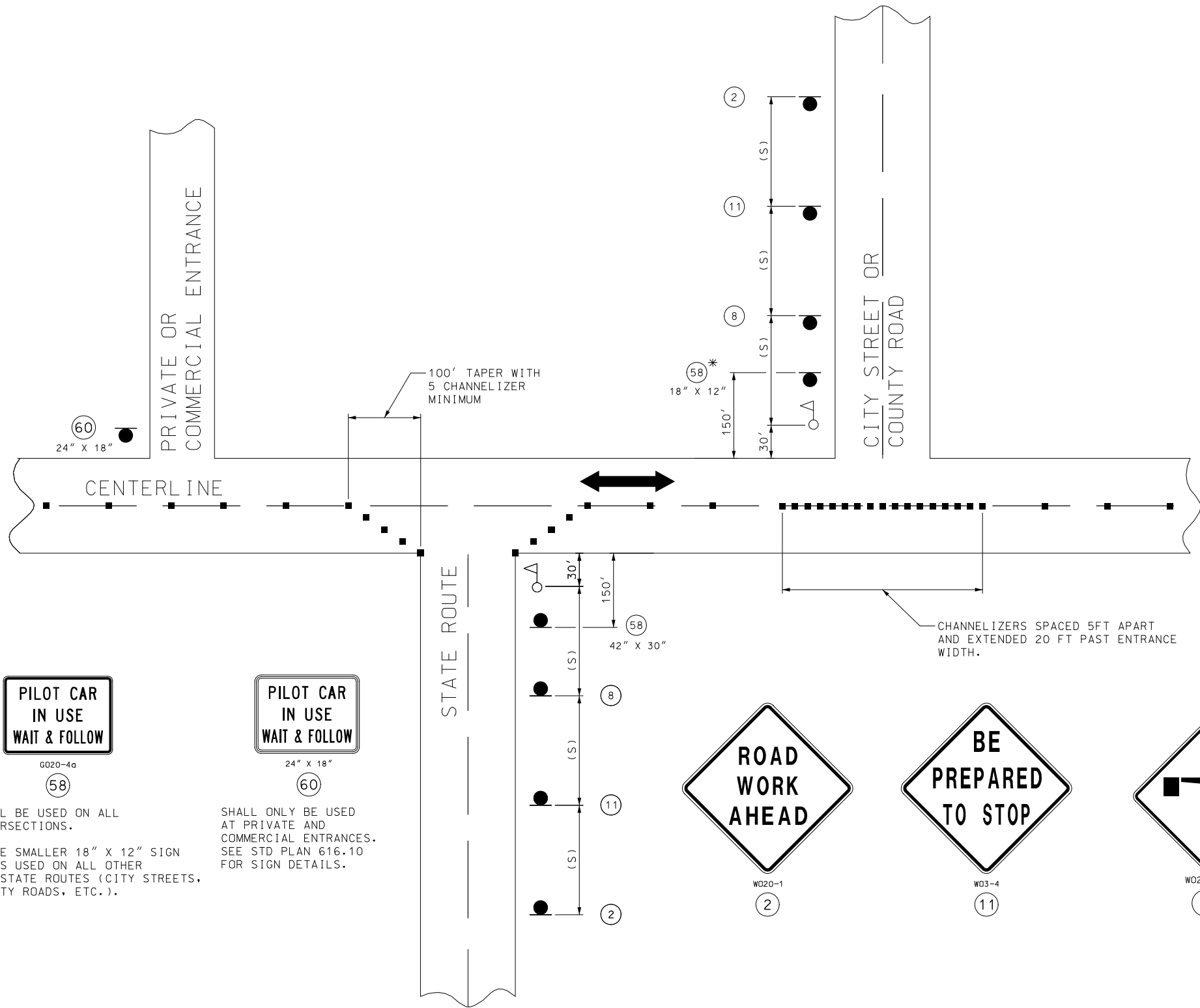

SIDE ROADS ENTERING WORK ZONES

SPEED	SIGN SPACING (FT) (1)	CHANNELIZER SPACING (FT)
PERMANENT POSTED (MPH)	NON-DIVIDED HIGHWAYS (S)	BUFFER/ WORK AREA (TYP.)
0-35	200	40
40-45	350	80
50-55	500	80
60-70	1000	120

(1) SPACING BETWEEN SIGNS, BETWEEN LAST SIGN AND FLAGGER, BEGINNING OF TAPER OR SIGNED CONDITION.

SPACING MAY BE ADJUSTED AS NECESSARY TO MEET FIELD CONDITIONS.

NOTES:  
WARNING SIGNS SHALL BE ERECTED AT EACH INTERSECTION WITH ANOTHER STATE HIGHWAY WITHIN THE WORK ZONE.

ADDITIONAL WARNING SIGNS SHALL BE ERECTED AT OTHER INTERSECTIONS WITHIN THE WORK ZONE, AS DIRECTED BY THE ENGINEER.

■ - CHANNELIZERS (AS SPECIFIED)

△ - FLAGGER

NOT TO SCALE

STATE OF MISSOURI

PATRICK J. HAKE

NUMBER  
PE-2010000826

PROFESSIONAL ENGINEER

6/3/2024

DATE PREPARED

ROUTE  
00/HH/Z

DISTRICT  
CD

STATE  
MO

SHEET NO.  
18

COUNTY  
BOONE

JOB NO.  
JCD0049

CONTRACT ID.

PROJECT NO.

BRIDGE NO.

DESCRIPTION	DATE

MISSOURI HIGHWAYS AND TRANSPORTATION  
COMMISSION

105 WEST CAPITOL  
JEFFERSON CITY, MO 65102  
1-888-ASK-MODOT (1-888-275-6636)

TRAFFIC CONTROL SHEET

3 OF 5

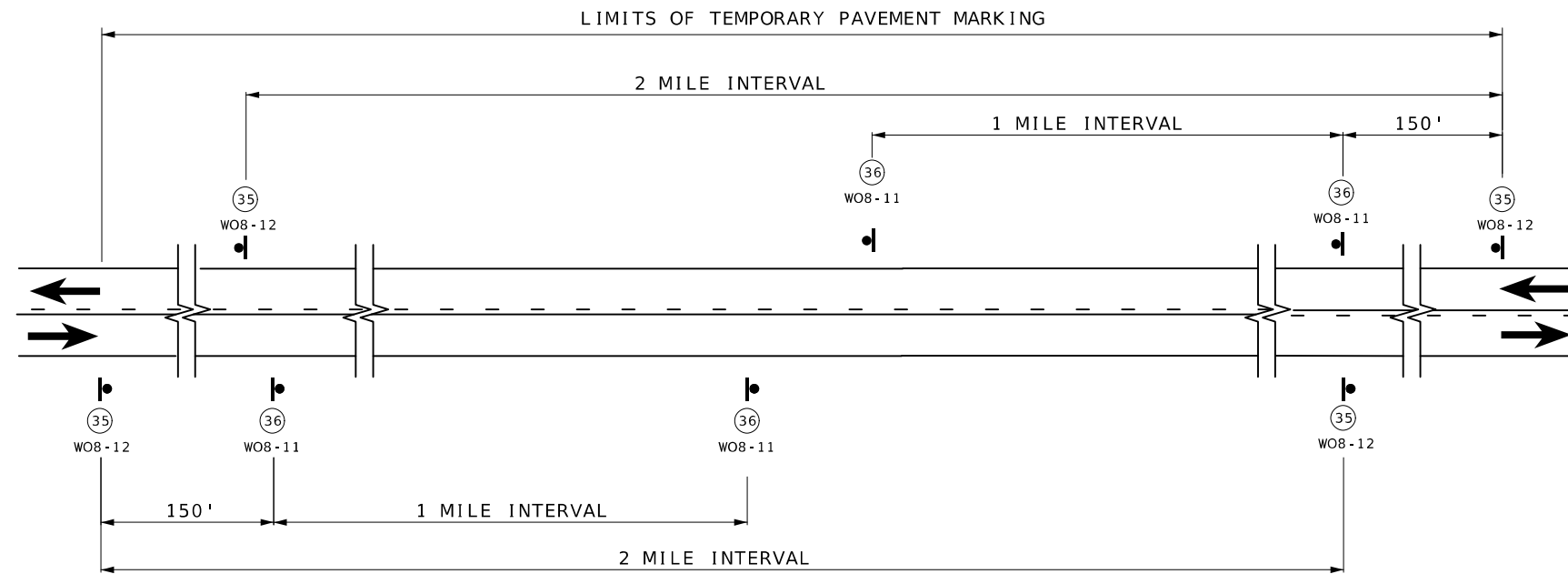

## SIGN SPACING AND TEMPORARY STRIPING FOR MAINLINE

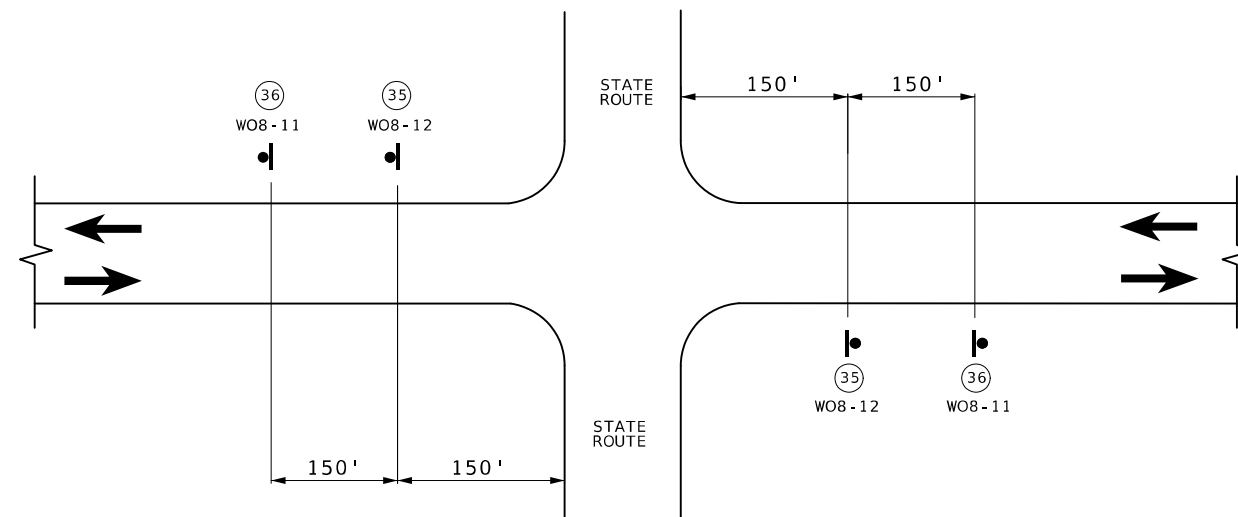

# SIGN SPACING AT STATE ROUTE INTERSECTIONS SHOWING TEMPORARY STRIPING FOR MAINLINE



NOTES :

SIGN 35 AND TEMPORARY RAISED PAVEMENT MARKING (SEE STANDARD PLAN 620.10) INSTALLED WHERE CENTERLINE STRIPING HAS BEEN COVERED OR REMOVED. SIGNS ARE TO REMAIN IN PLACE UNTIL THE PERMANENT CENTERLINE PAVEMENT MARKINGS ARE IN PLACE. SIGNS SHALL BE COVERED OR REMOVED WHEN PAVEMENT CENTERLINE MARKING HAS BEEN INSTALLED.

SIGN (35) IS PLACED AT APPROXIMATELY TWO-MILE INTERVALS AND AT STATE ROUTE JUNCTIONS. WHEN THE INSTALLATION AT A JUNCTION IS WITHIN ONE-EIGHTH MILE OF THE NORMAL MAINLINE SIGN (35), THE LATTER MAY BE ELIMINATED.

ALL SIGNS SHALL BE POST MOUNTED AND IN ACCORDANCE WITH  
STANDARD PLAN 616.10 AND 903.03.

NOT TO SCALE

TRAFFIC CONTROL  
SHEET 4 OF 5



*Patrick Hake*  
&[Date] &[Time]  
PATRICK J. HAKE - CIVIL  
MO-PE-2010000826

DATE PREPARED 6/3/2024	
ROUTE OO/HH/Z	STATE MO
DISTRICT CD	SHEET NO. 19

COUNTY  
BOONE

JOB NO.  
JCD0049

CONTRACT ID.
--------------

PROJECT NO.
-------------

BRIDGE NO.
------------

[illegible]

MISSOURI HIGHWAYS AND TRANSPORTATION  
COMMISSION

105 WEST CAPITOL  
JEFFERSON CITY, MO 65102  
1-888-ASK-MODOT (1-888-273-6636)

TRAFFIC CONTROL SHEET  
4 OF 5





(3) REAR WARNING TRUCK IS POSITIONED AT THE NO TRACK POINT OF THE PAVEMENT MARKING MATERIAL, OR VERTICAL OR HORIZONTAL CURVES THAT RESTRICT SIGHT DISTANCE, OR SPACING SHOWN, WHICHEVER IS GREATER.

NOT TO SCALE

TRAFFIC CONTROL  
SHEET 5 OF 5

[illegible]