

DESIGN DESIGNATION

FUNCTIONAL CLASSIFICATION- INTERSTATE, RAMPS

NO ADDITIONAL R/W TO BE ACQUIRED
WITHIN THIS PROJECT

**MISSOURI HIGHWAYS AND TRANSPORTATION COMMISSION
PLANS FOR PROPOSED
STATE HIGHWAY**



KEY MAP
LOCATION OF PLATTE COUNTY

PLATTE/CLAY COUNTIES



A0114N
A0114S

PLATTE COUNTY

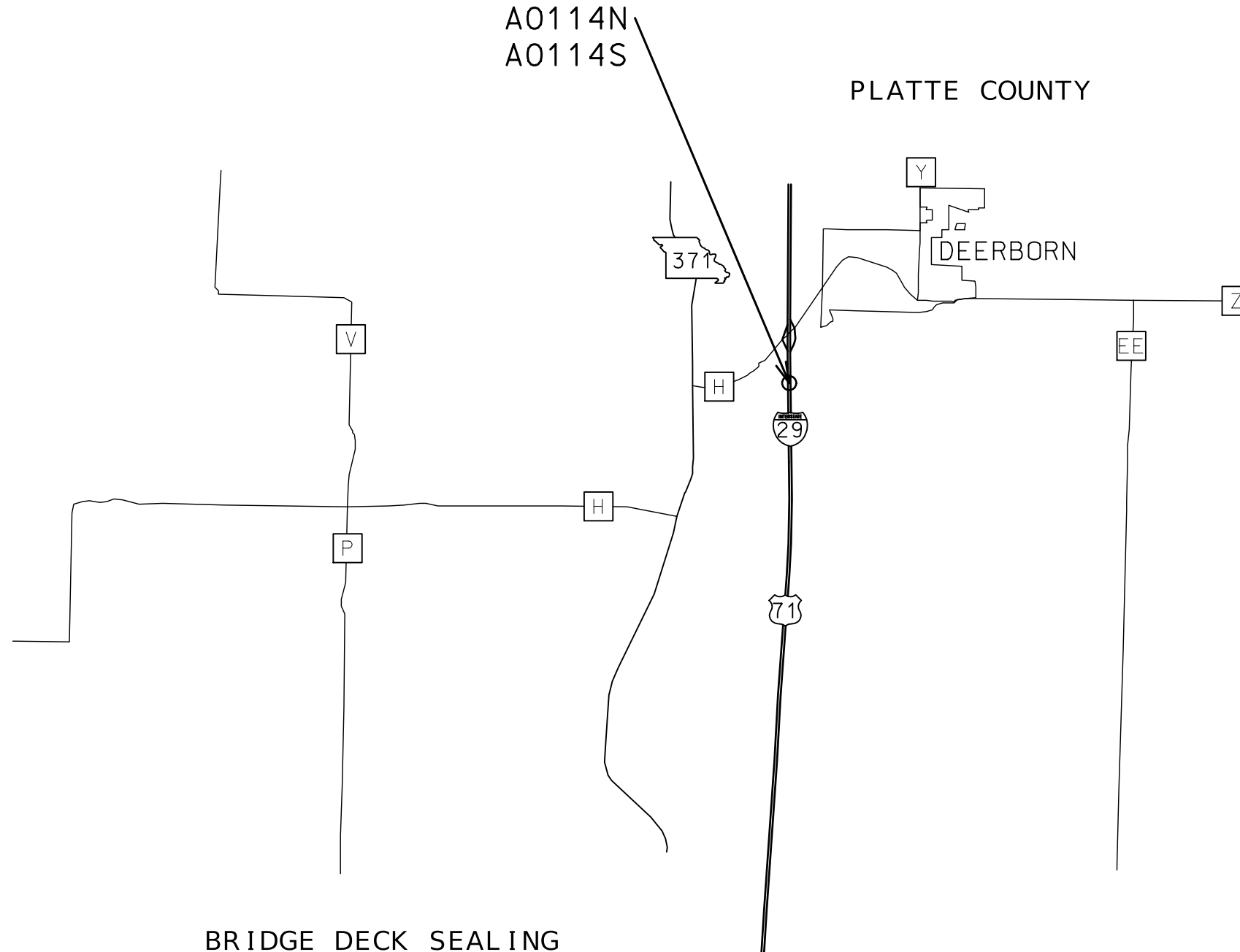

BRIDGE DECK SEALING

NOT TO SCALE
SHEET 3 OF 3

INDEX OF SHEETS

DESCRIPTION	SHEET NUMBER
TITLE SHEET (3 SHEETS)-----	1
QUANTITIES (QU) (2 SHEETS)-----	3
SPECIAL SHEET (SS)-----	4-7
TRAFFIC CONTROL SHEETS (TC)-----	8-11



DATE PREPARED
7/15/2024

ROUTE STATE
VAR MO
DISTRICT SHEET NO.
KC 1

COUNTY
PLATTE/CLAY

JOB NO.
JKU0165

CONTRACT ID.

PROJECT NO.

BRIDGE NO.

DATE	DESCRIPTION

**CONVENTIONAL SYMBOLS
(USED IN PLANS)**

	EXISTING	NEW
BUILDINGS AND STRUCTURES		
GUARD RAIL		
GUARD CABLE		
CONCRETE RIGHT-OF-WAY MARKER		
STEEL RIGHT-OF-WAY MARKER		
LOCATION SURVEY MARKER		
UTILITIES		
FIBER OPTICS	-FO-	-FO-
OVERHEAD CABLE TV	-OTV-	-OTV-
UNDERGROUND CABLE TV	-UTV-	-UTV-
OVERHEAD TELEPHONE	-OT-	-OT-
UNDERGROUND TELEPHONE	-UT-	-UT-
OVERHEAD POWER	-OE-	-OE-
UNDERGROUND POWER	-UE-	-UE-
SANITARY SEWER	-S-	-S-
STORM SEWER	-SS-	-SS-
GAS	-G-	-G-
WATER	-W-	-W-
MANHOLE		
FIRE HYDRANT		
WATER VALVE		
WATER METER		
DROP INLET		
DITCH BLOCK		
GROUND MOUNTED SIGN		
LIGHT POLE		
H-FRAME POWER POLE		
TELEPHONE PEDESTAL		
FENCE		
CHAIN LINK		
WOVEN WIRE		
GATE POST		
BENCHMARK		

NOTE: DASHED OR OPEN SYMBOLS INDICATE
EXISTING FEATURES

LENGTH OF PROJECT

APPARENT LENGTH	928 FEET
A0114N	464 FEET
A0114S	464 FEET

MISSOURI HIGHWAYS AND TRANSPORTATION COMMISSION

105 WEST CAPITOL
JEFFERSON CITY, MO 65102
1-888-ASK-MODOT (1-888-275-6636)

SIGN	SIZE	AREA	QTY	TOTAL	QTY	TOTAL	SIGN	DESCRIPTION
IN.	SQ.FT.	EACH	SQ.FT.	EACH	SQ.FT.	NUM.		
WARNING SIGNS								
WO1-1L	48X48	16.00						TURN (SYMBOL LEFT)
WO1-1R	48X48	16.00						TURN (SYMBOL RIGHT)
WO1-2L	48X48	16.00						CURVE (SYMBOL LEFT)
WO1-2R	48X48	16.00						CURVE (SYMBOL RIGHT)
WO1-3L	48X48	16.00						REVERSE TURN (SYMBOL LEFT)
WO1-3R	48X48	16.00						REVERSE TURN (SYMBOL RIGHT)
WO1-4L	48X48	16.00	2	32				REVERSE CURVE (SYMBOL LEFT)
WO1-4R	48X48	16.00	2	32				REVERSE CURVE (SYMBOL RIGHT)
WO1-4bL	48X48	16.00						DOUBLE ARROW REVERSE CURVE (SYMBOL LEFT)
WO1-4bR	48X48	16.00						DOUBLE ARROW REVERSE CURVE (SYMBOL RIGHT)
WO1-4cL	48X48	16.00						TRIPLE ARROW REVERSE CURVE (SYMBOL LEFT)
WO1-4cR	48X48	16.00						TRIPLE ARROW REVERSE CURVE (SYMBOL RIGHT)
WO1-6	60X30	12.50						HORIZONTAL ARROW (SYMBOL)
WO1-6a	72X36	18.00						HORIZ. ARROW (SYMBOL ON PERMANENT BARRICADE)
WO1-7	60X30	12.50						DOUBLE HEAD HORIZONTAL ARROW (SYMBOL)
WO1-7a	72X36	18.00						DOUBLE HEAD HORIZ. ARROW (SYMBOL ON PERM. BARR.)
WO1-8	18X24	3.00						CHEVRON (SYMBOL)
WO1-8a	30X36	7.50						CHEVRON (SYMBOL FOR DIVIDED HIGHWAYS)
WO3-1	48X48	16.00						STOP AHEAD (SYMBOL)
WO3-2	48X48	16.00	1	16				YIELD AHEAD (SYMBOL)
WO3-3	48X48	16.00						SIGNAL AHEAD (SYMBOL)
WO3-4	48X48	16.00						BE PREPARED TO STOP
WO3-5	48X48	16.00						SPEED LIMIT AHEAD
WO4-1L	48X48	16.00						MERGE (SYMBOL FROM LEFT)
WO4-1R	48X48	16.00	2	32				MERGE (SYMBOL FROM RIGHT)
WO4-1aL	48X48	16.00	1	16				MERGE (LEFT)
WO4-1aR	48X48	16.00	5	80				MERGE (RIGHT)
WO5-1	48X48	16.00	1	16				ROAD/BRIDGE/RAMP NARROWS
WO5-3	48X48	16.00						ONE LANE BRIDGE
WO5-5	48X48	16.00						NARROW LANES
WO6-1	48X48	16.00						DIVIDED HIGHWAY (SYMBOL)
WO6-2	48X48	16.00						DIVIDED HIGHWAY END (SYMBOL)
WO6-3	48X48	16.00						TWO WAY TRAFFIC (SYMBOL)
WO7-3a	30X24	5.00						NEXT XX MILES (PLAQUE)
WO8-1	48X48	16.00						BUMP
WO8-2	48X48	16.00						DIP
WO8-3	48X48	16.00						PAVEMENT ENDS
WO8-4	48X48	16.00						SOFT SHOULDER
WO8-5	48X48	16.00						SLIPPERY WHEN WET (SYMBOL)
WO8-6	48X48	16.00						TRUCK CROSSING
WO8-6c	48X48	16.00						TRUCK ENTRANCE
WO8-7	36X36	9.00						LOOSE GRAVEL
WO8-7a	36X36	9.00						FRESH OIL / LOOSE GRAVEL
WO8-9	48X48	16.00						LOW SHOULDER
WO8-11	48X48	16.00						UNEVEN LANES
WO8-12	48X48	16.00						NO CENTER LINE
WO8-15	48X48	16.00						GROOVED PAVEMENT
WO8-15P	30X24	5.00						MOTORCYCLE (PLAQUE)
WO8-17L	48X48	16.00						SHOULDER DROP-OFF (SYMBOL LEFT)
WO8-17R	48X48	16.00						SHOULDER DROP-OFF (SYMBOL RIGHT)
WO8-17P	30X24	5.00						SHOULDER DROP-OFF (PLAQUE)
WO10-1	42RND.	9.62						RAILROAD CROSSING
WO12-1	24X24	4.00						DOUBLE DOWN ARROW (SYMBOL)
WO12-2	48X48	16.00						LOW CLEARANCE (SYMBOL)
WO12-2x	24X18	3.00						LOW CLEARANCE (PLAQUE)
WO12-2a	84X24	14.00						OVERHEAD LOW CLEARANCE (FEET AND INCHES)
WO12-4	120X60	50.00						LOW CLEARANCE XX FT XX IN XX MILES AHEAD
WO12-5	120X60	50.00						WIDTH RESTRICTION XX FT XX IN XX MILES AHEAD
WO13-1	30X30	6.25	1	6.25				ADVISORY SPEED (PLAQUE)
WO16-2	30X24	5.00						XXX FEET (PLAQUE)
WO16-3	30X24	5.00						X MILE (PLAQUE)
WO20-1	48X48	16.00	8	128				ROAD/BRIDGE/RAMP WORK AHEAD
WO20-2	48X48	16.00						DETOUR AHEAD
WO20-3	48X48	16.00	1	16				ROAD CLOSED AHEAD
WO20-4	48X48	16.00						ONE LANE ROAD AHEAD
WO20-5	48X48	16.00	6	96				RIGHT/CENTER/LEFT LANE CLOSED AHEAD
WO20-5a	48X48	16.00	6	96				2 RIGHT/CENTER/LEFT LANES CLOSED AHEAD
WO20-6a	48X48	16.00	5	80				RIGHT/CENTER/LEFT LANE CLOSED
WO20-7a	48X48	16.00						FLAGGER (SYMBOL)
WO21-2	36X36	9.00						FRESH OIL
WO21-5	48X48	16.00						SHOULDER WORK / SHOULDER WORK AHEAD
WO22-1	48X48	16.00						BLASTING ZONE AHEAD
WO22-2	42X36	10.50						TURN OFF 2-WAY RADIO AND PHONE
WO22-3	42X36	10.50						END BLASTING ZONE
GO22-1	21X15	2.19						WET PAINT (ARROW PIVOTS)

SIGN	SIZE	AREA	QTY	TOTAL	QTY	TOTAL	SIGN	DESCRIPTION	
IN.	SQ.FT.	EACH	SQ.FT.	EACH	SQ.FT.	NUM.			
GUIDE SIGNS									
E05-1	36X48	12.00						GORE EXIT	
E05-2	48X36	12.00	2	24				EXIT OPEN	
E05-2a	48X36	12.00						EXIT CLOSED	
GO20-1	60X24	10.00						ROAD WORK NEXT XX MILES	
GO20-2	48X24	8.00	2	16				END ROAD WORK	
GO20-4	36X18	4.50						PILOT CAR FOLLOW ME	
GO20-4a	42X30	8.75						PILOT CAR IN USE WAIT & FOLLOW	
GO20-4a	18X12	1.50						PILOT CAR IN USE WAIT & FOLLOW	
GO20-5aP	36X24	6.00	2	12				WORK ZONE (PLAQUE)	
MO4-8a	24X18	3.00						END DETOUR	
MO4-9L	48X36	12.00						DETOUR (LEFT)	
MO4-9R	48X36	12.00						DETOUR (RIGHT)	
MO4-9P	48X12	4.00						STREET NAME (PLAQUE)	
MO4-10L	48X18	6.00						DETOUR ARROW (LEFT)	
MO4-10R	48X18	6.00						DETOUR ARROW (RIGHT)	
REGULATORY SIGNS									
R1-1	48X48	13.25						STOP	
R1-2	48TR1	6.93	1	6.93				YIELD	
R1-2a	36X36	9.00						TO ONCOMING TRAFFIC (PLAQUE)	
R1-3P	30X12	2.50						ALL WAY (PLAQUE)	
R2-1	36X48	12.00	4	48				SPEED LIMIT XX	
R3-1	48X48	16.00						NO RIGHT TURN (SYMBOL)	
R3-2	48X48	16.00						NO LEFT TURN (SYMBOL)	
R3-3	36X36	9.00						NO TURNS	
R3-4	48X48	16.00						NO U-TURN (SYMBOL)	
R3-7L	30X30	6.25						LEFT LANE MUST TURN LEFT	
R3-7R	30X30	6.25						RIGHT LANE MUST TURN RIGHT	
R4-1	36X48	12.00						DO NOT PASS	
R4-2	36X48	12.00						PASS WITH CARE	
R4-7a	36X48	12.00						KEEP RIGHT (HORIZONTAL ARROW)	
R4-8a	36X48	12.00						KEEP LEFT (HORIZONTAL ARROW)	
R5-1	30X30	6.25						DO NOT ENTER	
R5-1a	36X24	6.00						WRONG WAY	
R6-1L	54X18	6.75						ONE WAY ARROW (LEFT)	
R6-1R	54X18	6.75						ONE WAY ARROW (RIGHT)	
R6-2L	24X30	5.00						ONE WAY (LEFT)	
R6-2R	24X30	5.00						ONE WAY (RIGHT)	
R9-9	24X12	2.00						SIDEWALK CLOSED	
R9-11L	24X18	3.00						SIDEWALK CLOSED AHEAD, (ARROW LEFT) CROSS HERE	
R9-11R	24X18	3.00						SIDEWALK CLOSED AHEAD, (ARROW RIGHT) CROSS HERE	
R10-6	24X36	6.00						STOP HERE ON RED (45° ARROW)	
R11-2	48X30	10.00	2	20				ROAD CLOSED	
R11-3a	60X30	12.50						ROAD CLOSED XX MILES AHEAD	
R11-4	60X30	12.50						LOCAL TRAFFIC ONLY	
CONST-3A	60X48	20.00						ROAD CLOSED TO THRU TRAFFIC	
CONST-3X	56X12	4.67						FINE SIGN	
MISCELLANEOUS SIGNS									
CONST-5	48X36	12.00						POINT OF PRESENCE	
CONST-5	96X48	32.00						POINT OF PRESENCE	
CONST-8	48X36	12.00						WORK ZONE NO PHONE ZONE	
CONSTRUCTION SIGNS									
				TOTAL					
				773.2					
RELOCATED SIGNS									
				TOTAL					
				0					

ITEM	TOTAL	DESCRIPTION
NUMBER	QTY	
6122008		IMPACT ATTENUATOR 40 MPH (SAND BARRELS)
6122009		IMPACT ATTENUATOR 45 MPH (SAND BARRELS)
6122010		IMPACT ATTENUATOR 50 MPH (SAND BARRELS)
6122012		IMPACT ATTENUATOR 55 MPH (SAND BARRELS)
6122014		IMPACT ATTENUATOR 60 MPH (SAND BARRELS)
6122017		IMPACT ATTENUATOR 65 MPH (SAND BARRELS)
6122019		IMPACT ATTENUATOR 70 MPH (SAND BARRELS)
6122020		REPLACEMENT SAND BARREL
6122030		IMPACT ATTENUATOR (RELOCATION)
6123001		TRUCK MOUNTED ATTENUATOR (TMA)
6161008		ADVANCED WARNING RAIL SYSTEM
6161012		BUOYS (BOATS KEEP OUT)
6161013		BUOYS (NO WAKE)
6161014		SPECIAL SIGN ASSEMBLY (BOATS KEEP OUT)
6161025	180	CHANNELIZER (TRIM LINE)
6161030	5	TYPE III MOVEABLE BARRICADE
6161033	40	DIRECTION INDICATOR BARRICADE
6161040	3	FLASHING ARROW PANEL
6161047		TYPE III OBJECT MARKER
6161055		SEQUENTIAL FLASHING WARNING LIGHT
6161070		TUBULAR MARKER
6161095		RADAR SPEED ADVISORY SYSTEM
6161096		CHANGEABLE MESSAGE SIGN, COMMISSION FURNISHED/RETAINED
6161098A	2	CHANGEABLE MESSAGE SIGN W/O COMM. INTERFACE - CONTRACTOR FURNISHED/RETAINED
6161099		CHANGEABLE MESSAGE SIGN WITH COMM. INTERFACE - CONTRACTOR FURNISHED/RETAINED
6162000A		WORK ZONE TRAFFIC SIGNAL SYSTEM
6162002		TEMPORARY LONG-TERM RUMBLE STRIPS
6173600D		TEMPORARY TRAFFIC BARRIER CONTRACTOR FURNISHED/RETAINED
6173602B		TEMPORARY TRAFFIC BARRIER CONTRACTOR FURNISHED/COMMISSION RETAINED
6174000A		TEMP. TRAFFIC BARRIER HEIGHT TRANSITION
6175010A		RELOCATING TEMPORARY TRAFFIC BARRIER
6176000B		TEMPORARY TRAFFIC BARRIER COMMISSION FURNISHED/RETAINED
6177000B		TEMP. TRAFFIC BARRIER HEIGHT TRANSITION COMMISSION FURNISHED/RETAINED
6208064A		TEMPORARY RAISED PAVEMENT MARKER
9029400		TEMPORARY TRAFFIC SIGNALS
9029401		TEMPORARY TRAFFIC SIGNALS AND LIGHTING

*SIGNS BASE ON MULTIPLE LANE CLOSURES

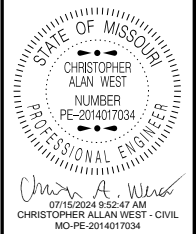

DATE PREPARED
7/15/2024

ROUTE **VAR** STATE **MO**

DISTRICT **KC** SHEET NO. **3**

COUNTY **PLATTE/CLAY**

JOB NO. **JKU0165**

CONTRACT ID.

PROJECT NO.

BRIDGE NO.

DESCRIPTION	DATE
	</

CLAY COUNTY



L0720: I-295 SB OVER US-69
L0721: I-295 NB OVER US-69

CLAY COUNTY

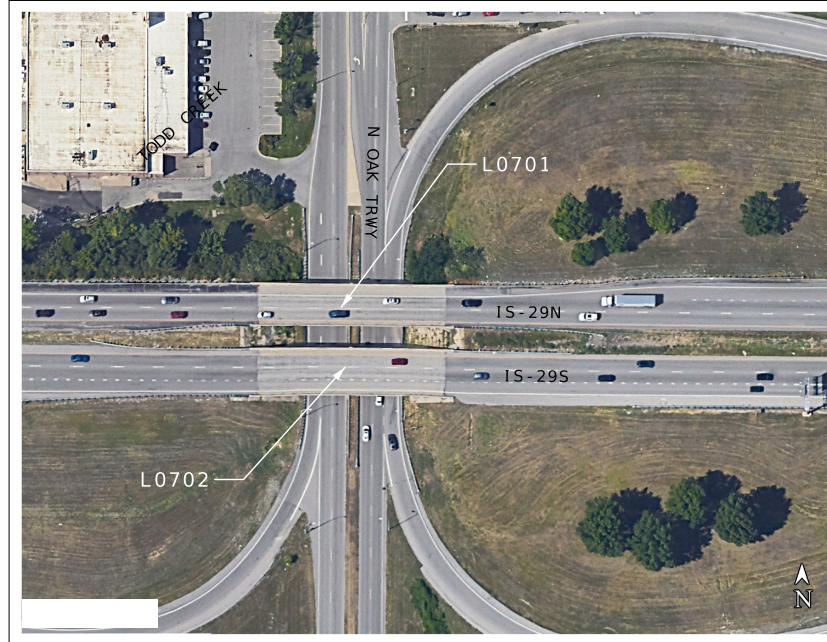

L0701: I-295 NB OVER N OAK TRWY
L0702: I-295 SB OVER N OAK TRWY

CLAY COUNTY



L0699: I-295 SB OVER NE DAVISON RD
L0700: I-295 NB OVER NE DAVISON RD

CLAY COUNTY



L0658: I-295 NB RAMP TO I-295 NB AT I-35 INTERCHANGE

NOT TO SCALE



CLAY COUNTY
SPECIAL SHEET
4 OF 4



Christopher Alan West
07/15/2024 10:53:23 AM
CHRISTOPHER ALLAN WEST - CIVIL
MO-PE-2014017034

DATE PREPARED
7/15/2024

ROUTE VAR STATE MO

DISTRICT KC SHEET NO. 7

COUNTY PLATTE/CLAY

JOB NO. JKU0165

CONTRACT ID.

PROJECT NO.

BRIDGE NO.

DESCRIPTION

DATE

DESCRIPTION

DATE

DESCRIPTION

DATE

DESCRIPTION

DATE

DESCRIPTION

DATE

DESCRIPTION

DATE

DESCRIPTION

DATE

DESCRIPTION

DATE

DESCRIPTION

DATE

DESCRIPTION

DATE

DESCRIPTION

DATE

DESCRIPTION

DATE

DESCRIPTION

DATE

DESCRIPTION

DATE

DESCRIPTION

DATE

DESCRIPTION

DATE

DESCRIPTION

DATE

DESCRIPTION

DATE

DESCRIPTION

DATE

DESCRIPTION

DATE

DESCRIPTION

DATE

DESCRIPTION

DATE

DESCRIPTION

DATE

DESCRIPTION

DATE

DESCRIPTION

MISSOURI HIGHWAYS AND TRANSPORTATION
COMMISSION
105 WEST CAPITOL
JEFFERSON CITY, MO 65102
1-888-ASK-MODOT (1-888-275-6636)



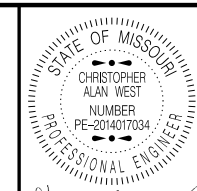

DATE PREPARED
7/15/2024

ROUTE STATE
VAR MO
DISTRICT SHEET NO.
KC 9

COUNTY
PLATTE/CLAY
JOB NO.
JKU0165
CONTRACT ID.

PROJECT NO.
BRIDGE NO.

DATE	DESCRIPTION

MISSOURI HIGHWAYS AND TRANSPORTATION COMMISSION

 105 WEST CAPITOL JEFFERSON CITY, MO 65102
 1-888-ASK-MODOT (1-888-275-6636)

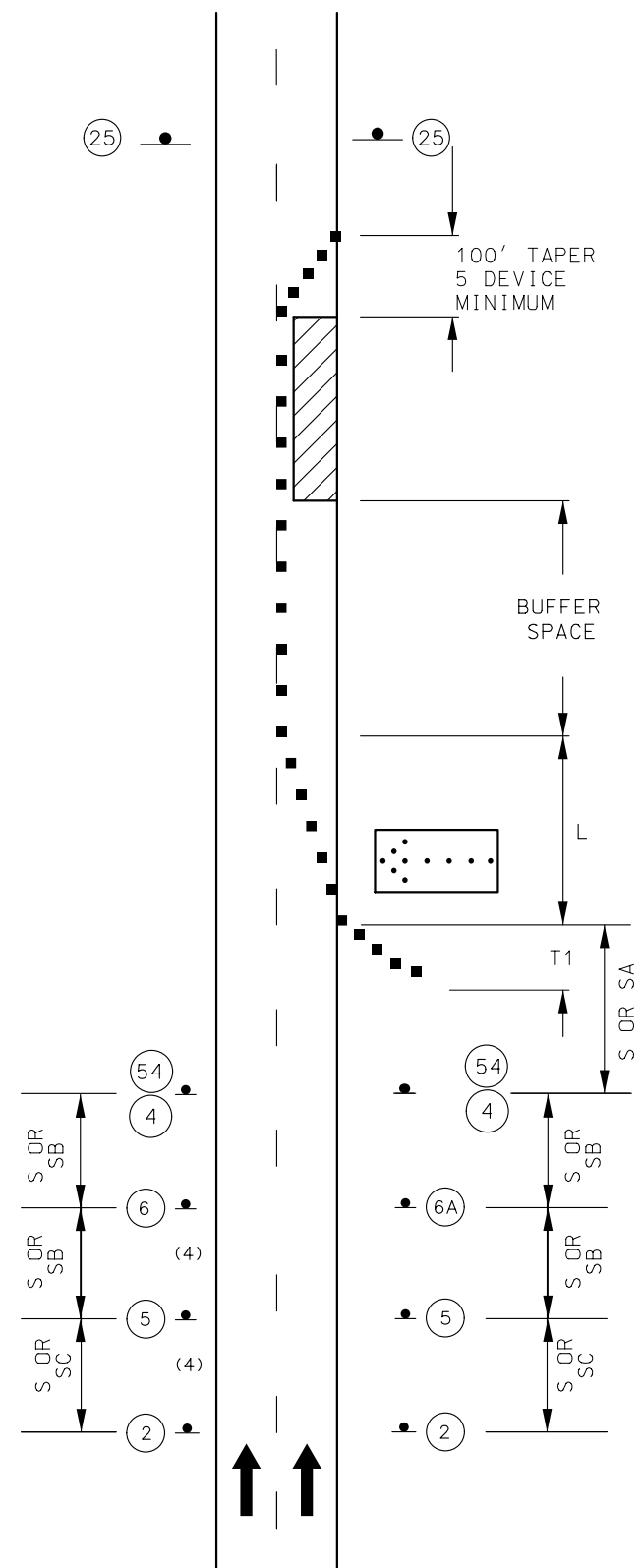

TWO-LANE DIVIDED HIGHWAY

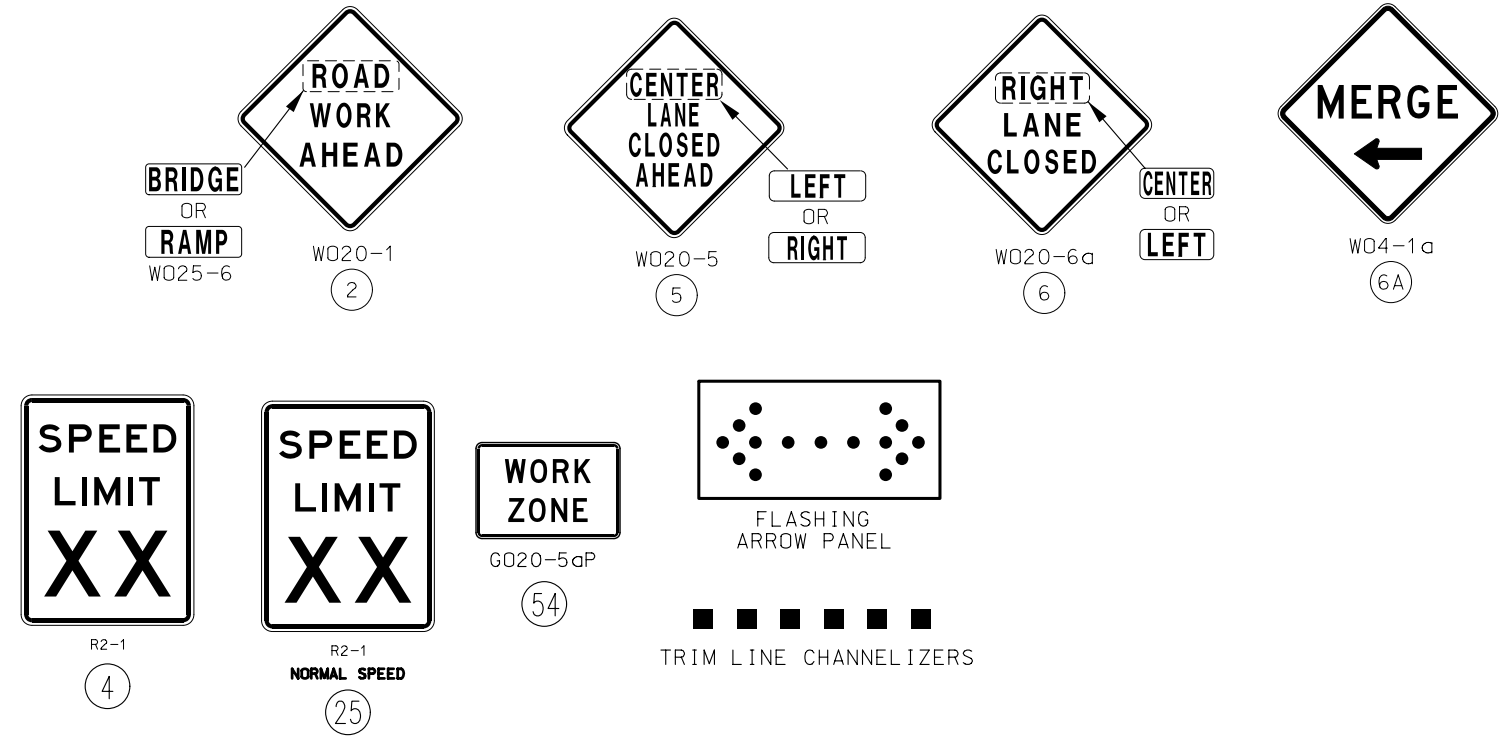

NOTES:

- SEE TRAFFIC CONTROL SHEET 1 FOR WORK ZONE SPEED LIMIT GUIDELINES.
- SEE TRAFFIC CONTROL SHEET 1 FOR SIGN SPACING, DEVICE SPACING AND CHANNELIZING TAPER LENGTHS.
- REMOVE AND/OR MODIFY ANY EXISTING PAVEMENT MARKING AS NEEDED.
- TEMPORARY PAVEMENT MARKING REQUIRED WITH LONG TERM CLOSURES.
- THIS INFORMATION ALSO SHALL BE USED WHEN WORK IS BEING PERFORMED IN THE LANE ADJACENT TO THE MEDIAN ON A DIVIDED HIGHWAY. IN THIS CASE, THE LEFT LANE CLOSED SIGNS AND THE CORRESPONDING MERGE OR LANE ENDS SIGN SHALL BE SUBSTITUTED.
- WHEN A SIDE ROAD INTERSECTS THE HIGHWAY WITHIN THE TTC ZONE ADDITIONAL TTC DEVICES SHALL BE PLACED AS NEEDED.
- SEE SHEET 3 OF 4 FOR A LANE CLOSURE WITH WIDTH RESTRICTIONS.
- AN ARROW BOARD SHALL BE USED WHEN A FREEWAY LANE IS CLOSED. WHEN MORE THAN ONE FREEWAY LANE IS CLOSED, A SEPARATE ARROW BOARD SHALL BE USED FOR EACH CLOSED LANE.
- SEE SHEET 1 OF 4 FOR CHANNELIZING DEVICES FOR DIFFERENT TYPES AND GUIDELINES FOR THE DEVICES

