

DESIGN DESIGNATION

A.A.D.T. - 2024 = 68,000

A.A.D.T. - 2034 = 72,000

V = 70 M.P.H.

FUNCTIONAL CLASSIFICATION- INTERSTATE

NO R/W TO BE ACQUIRED FOR PROJECT

MISSOURI HIGHWAYS AND TRANSPORTATION COMMISSION PLANS FOR PROPOSED STATE HIGHWAY CLAY COUNTY

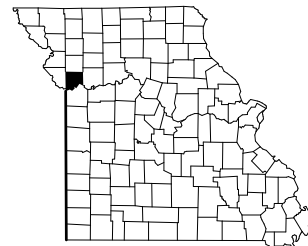

KEY MAP
LOCATION OF CLAY COUNTY

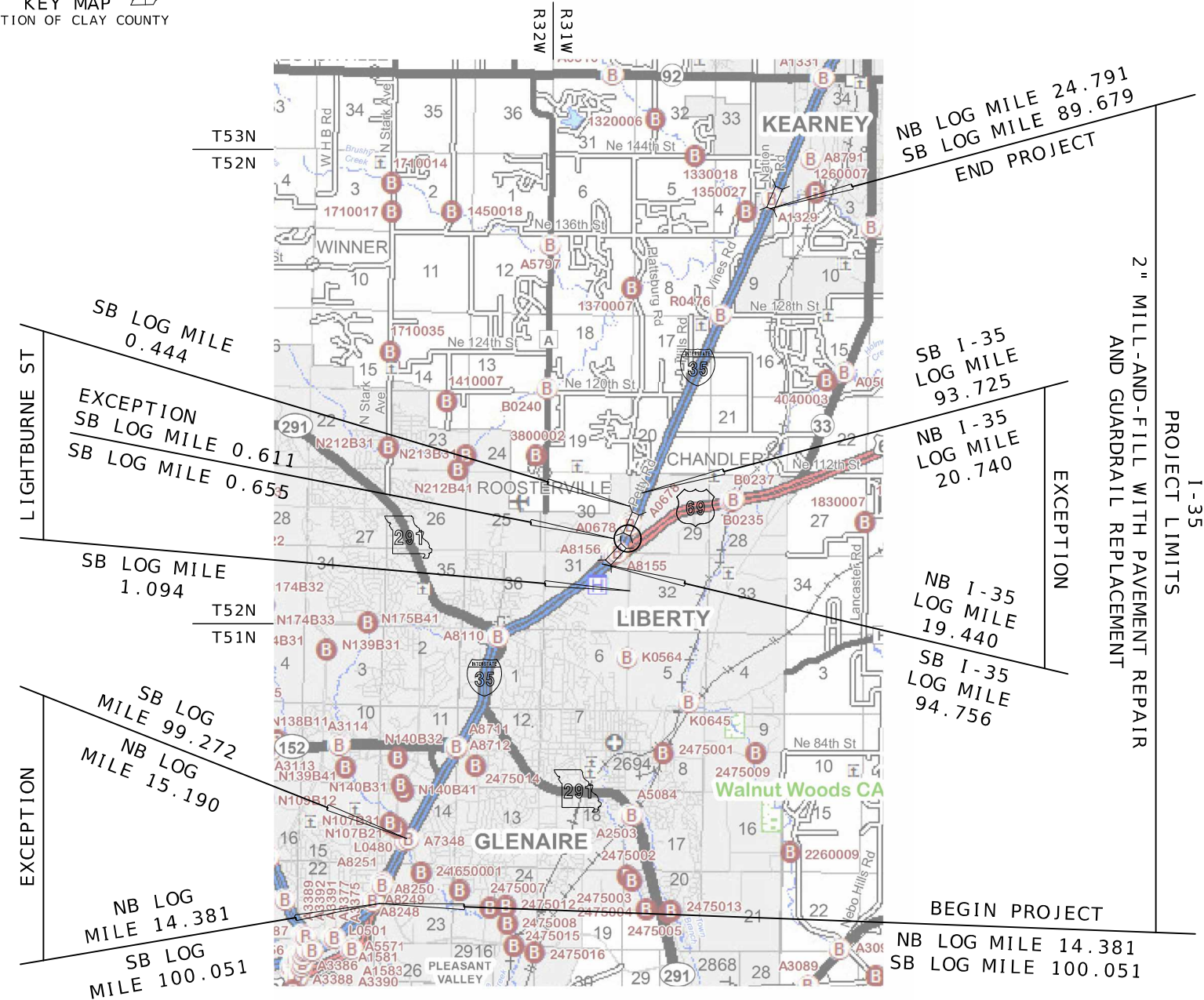

NOT TO SCALE

THE EXISTENCE AND APPROXIMATE LOCATION OF UTILITY FACILITIES KNOWN TO EXIST, AS SHOWN ON THE PLANS, ARE BASED ON THE BEST INFORMATION AVAILABLE TO THE COMMISSION AT THIS TIME. THIS INFORMATION IS PROVIDED BY THE COMMISSION "AS-IS" AND THE COMMISSION EXPRESSLY DISCLAIMS ANY REPRESENTATION OR WARRANTY AS TO THE COMPLETENESS, ACCURACY, OR SUITABILITY OF THE INFORMATION FOR ANY USE. RELIANCE UPON THIS INFORMATION IS DONE AT THE RISK AND PERIL OF THE USER, AND THE COMMISSION SHALL NOT BE LIABLE FOR ANY DAMAGES THAT MAY ARISE FROM ANY ERROR IN THE INFORMATION. IT IS, THEREFORE, THE RESPONSIBILITY OF THE CONTRACTOR TO VERIFY THE EXISTENCE, LOCATION AND STATUS OF ANY FACILITY. SUCH VERIFICATION INCLUDES DIRECT CONTACT WITH THE LISTED UTILITIES.

**CONVENTIONAL SYMBOLS
(USED IN PLANS)**

	EXISTING	NEW
BUILDINGS AND STRUCTURES		
GUARD RAIL		
GUARD CABLE		
CONCRETE RIGHT-OF-WAY MARKER		
STEEL RIGHT-OF-WAY MARKER		
LOCATION SURVEY MARKER		
UTILITIES		
FIBER OPTICS	-FO-	-FO-
OVERHEAD CABLE TV	-OTV-	-OTV-
UNDERGROUND CABLE TV	-UTV-	-UTV-
OVERHEAD TELEPHONE	-OT-	-OT-
UNDERGROUND TELEPHONE	-UT-	-UT-
OVERHEAD POWER	-OE-	-OE-
UNDERGROUND POWER	-UE-	-UE-
SANITARY SEWER	-S-	-S-
STORM SEWER	-SS-	-SS-
GAS	-G-	-G-
WATER	-W-	-W-
MANHOLE		
FIRE HYDRANT		
WATER VALVE		
WATER METER		
DROP INLET		
DITCH BLOCK		
GROUND MOUNTED SIGN		
LIGHT POLE		
H-FRAME POWER POLE		
TELEPHONE PEDESTAL		
FENCE		
CHAIN LINK	-V-	-V-
WOVEN WIRE	-X-	-X-
GATE POST		
BENCHMARK		

NOTE: DASHED OR OPEN SYMBOLS INDICATE EXISTING FEATURES

INDEX OF SHEETS

DESCRIPTION	SHEET NUMBER
TITLE SHEET	1
TYPICAL SECTIONS (TS) (3 SHEETS)	2
QUANTITIES (QU) (9 SHEETS)	3
SPECIAL SHEETS (SS)	4-9
TRAFFIC CONTROL SHEETS (TC)	10-16
SIGNING (SN)	17

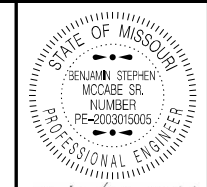

Benjamin Stephen McCabe, Sr.
09/05/2024 9:55:04 AM
BENJAMIN STEPHEN MCCABE SR - CIVIL
MO-PE-2003015005

DATE PREPARED
9/5/2024

ROUTE 35 STATE MO

DISTRICT KC SHEET NO. 1

COUNTY CLAY

JOB NO. JKU0060

CONTRACT ID.

PROJECT NO.

BRIDGE NO.

DESCRIPTION

DATE

DESCRIPTION

DATE

DESCRIPTION

DATE

DESCRIPTION

DATE

DESCRIPTION

DATE

DESCRIPTION

DATE

DESCRIPTION

DATE

DESCRIPTION

DATE

DESCRIPTION

DATE

DESCRIPTION

DATE

DESCRIPTION

DATE

DESCRIPTION

DATE

DESCRIPTION

DATE

DESCRIPTION

LENGTH OF PROJECT

BEGINNING OF PROJECT	1-35 NB LOG MILE 14.381
	1-35 SB LOG MILE 89.679
	LIGHTBURNE ST SB LOG MILE 0.444
END OF PROJECT	1-35 NB LOG MILE 24.791
	1-35 SB LOG MILE 100.051
	LIGHTBURNE ST SB LOG MILE 1.094
APPARENT LENGTH	113,160.94 FEET
EQUATIONS AND EXCEPTIONS:	
SB I-35	LOG MILE 93.725 TO 94.756
	LOG MILE 99.272 TO 100.051
NB I-35	LOG MILE 14.381 TO 15.190
	LOG MILE 19.440 TO 20.740
LIGHTBURNE ST	LOG MILE 0.611 TO 0.655
TOTAL CORRECTIONS	20,924.64 FEET
NET LENGTH OF PROJECT	92,236.30 FEET
STATE LENGTH	17.469 MILES
FOR INFORMATION ONLY	
ESTIMATED DISTURBED ACRES	0 ACRES

MISSOURI HIGHWAYS AND TRANSPORTATION COMMISSION

105 WEST CAPITOL
JEFFERSON CITY, MO 65102
1-888-ASK-MODOT (1-888-275-6636)

LIGHTBURNE ST. ASPHALT QUANTITIES

LOG MILE START	LOG MILE END	LENGTH (FT)	PAVEMENT WIDTH (FT)	SHOULDER WIDTH (FT) WITH MAINLINE PAVEMENT	SHOULDER WIDTH (FT) WITH SHOULDER TREATMENT	2" ASPHALTIC CONCRETE MIXTURE PG76-22, (SP125BSM MIX) (TONS)	2" BITUMINOUS PAVEMENT MIXTURE PG64-22, (BP-1) (TONS)	TACK COAT (GAL)	2" COLDMILLING (SY)	NOTES
SOUTHBOUND										
0.444	0.611	881.89	12	1.5	8.69	144.78	94.00	217.4	2174.3	
0.611	0.654	226.12	0	0	0	0.00	0.00	0.0	0.0	CONCRETE EXCEPTION
0.654	0.769	606.23	12.82	0	8.75	94.51	65.06	145.3	1452.9	WIDENS TO 2 LANES
0.769	0.826	298.39	25.08	0	6.32	91.00	23.13	104.1	1041.0	
0.826	0.906	422.68	32.5	0	0	167.05	0.00	152.6	1526.3	WIDENS TO 4 LANES
0.906	0.948	220.08	46.76	0	0	125.14	0.00	114.3	1143.4	UP TO 69 INTERSECTION
0.948	0.986	198.93	0	0	0	0.00	0.00	0.0	0.0	69 INTERSECTION
0.986	1.064	414.37	33.17	0	0	167.14	0.00	152.7	1527.2	WIDENS TO 3 LANES
1.064	1.094	158.74	34.55	0	0	66.69	0.00	60.9	609.4	ENDS
NORTHBOUND										
2.946	2.834	592.14	12	1.5	9.7	97.21	70.45	152.6	1526.4	
2.834	2.710	652.78	0	0	0	0.00	0.00	0.0	0.0	CONCRETE EXCEPTION
2.710	2.589	638.61	12	0	9.65	93.19	75.59	153.6	1536.2	
2.589	2.414	923.94	24.58	0	0	276.17	0.00	252.3	2523.4	2 LANES
2.414	2.373	218.84	0	0	0	0.00	0.00	0.0	0.0	69 INTERSECTION
2.373	2.308	345.21	54.29	0	0	227.91	0.00	208.2	2082.4	5 LANES
2.308	2.256	272.55	28.18	0	0	93.40	0.00	85.3	853.4	2 LANES
SUB TOTALS						1644.19	328.23	1799.3	17996.3	

COMMUTER LOT ASPHALT QUANTITIES

MAINLINE PAVEMENT AREA COMMUTER LOT (SY)	MAINLINE PAVEMENT AREA ACCESS ROAD (SY)	2" BITUMINOUS PAVEMENT MIXTURE PG64-22 (BP-1) (TONS)	TACK COAT (GAL)	2" COLDMILLING (SY)
3701.96	2181.93	648.54	588.4	5883.9
SUBTOTALS		648.54	588.4	5883.9

ASPHALT QUANTITIES

TABLE	2" ASPHALTIC CONCRETE MIXTURE PG76-22, (SP125BSM MIX) (TONS)	2" BITUMINOUS PAVEMENT MIXTURE PG64-22, (BP-1) (TONS)	TACK COAT (GAL)	<3" COLDMILLING (SY)
SOUTHBOUND I-35	17547.70	6439.47	19164.5	219493.0
NORTHBOUND I-35	16829.37	6114.10	18549.4	209251.4
LIGHTBURNE ST	1644.19	328.23	1799.3	17996.3
COMMUTER LOT	0.00	648.54	588.4	5883.9
PAY TOTALS	36021.3	13530.3	40102	452625

LIGHTBURNE PAVEMENT MARKINGS

LOG MILE START	LOG MILE END	LENGTH (FT)	6" WHITE HIGH BUILD WATERBORNE PAVEMENT MARKING PAINT, TYPE L BEADS (LF)	6" YELLOW HIGH BUILD WATERBORNE PAVEMENT MARKING PAINT, TYPE L BEADS (LF)	PERFORMED THERMOPLASTIC PAVEMENT MARKING LEFT/RIGHT ARROW (EACH)
SOUTHBOUND					
0.444	0.654	1108.800	2217.6	277.2	
0.654	0.715	321.91	643.8	643.8	
0.715	0.767	276.74	830.2	553.5	
0.767	0.821	283.54	921.5	1134.2	
0.821	0.910	468.47	936.9	468.5	
0.910	0.943	174.05	696.2	174.1	2 RIGHT, 2 LEFT
0.943	0.981	198.31	0.0	0.0	
0.981	1.009	148.23	185.3	148.2	
1.009	1.091	432.36	864.7	432.4	
NORTHBOUND					
2.946	2.877	364.97	729.9	365.0	
2.877	2.838	205.79	823.2	205.8	4 LEFT, 2 RIGHT
2.838	2.800	203.18	0.0	0.0	
2.800	2.679	636.66	795.8	636.7	
TOTAL			9645.1	5039.4	10

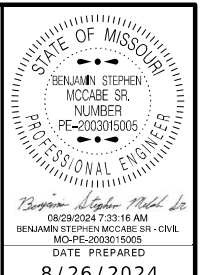

8/26/2024

ROUTE 35	STATE MO
DISTRICT KC	SHEET NO. 3
COUNTY CLAY	
JOB NO. JKU0060	
CONTRACT ID.	
PROJECT NO.	
BRIDGE NO.	

DESCRIPTION	DATE

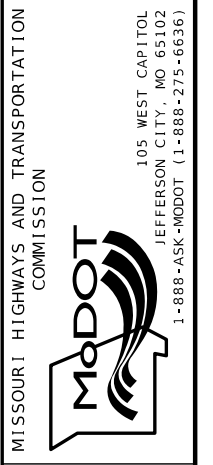

I-35 PAVEMENT MARKING

LOG MILE START	LOG MILE END	LENGTH (FT)	6" WHITE HIGH BUILD WATERBORNE PAVEMENT MARKING PAINT, TYPE L BEADS (LF)	6" YELLOW HIGH BUILD WATERBORNE PAVEMENT MARKING PAINT, TYPE L BEADS (LF)	12" WHITE HIGH BUILD WATERBORNE PAVEMENT MARKING PAINT, TYPE L BEADS (LF)	PERFORMED THERMOPLASTIC PAVEMENT MARKING LEFT/RIGHT ARROW (EACH)
SOUTHBOUND						
89.598	91.520	10148.2	12685.3	10148.2	0	0
91.520	91.560	211.2	316.8	211.2	0	0
91.560	91.600	211.2	264.0	211.2	422.4	0
91.600	91.820	1161.6	1452.0	1161.6	0	0
91.820	91.880	316.8	396.0	316.8	633.6	0
91.880	91.940	316.8	475.2	316.8	0	0
91.940	93.681	9192.5	11490.6	9192.5	0	0
93.681	93.741	316.8	475.2	316.8	0	0
93.741	93.801	316.8	396.0	316.8	633.6	0
93.801	94.842	5496.5	6870.6	5496.5	0	0
94.842	94.902	316.8	396.0	316.8	633.6	0
94.902	94.962	316.8	475.2	316.8	0	0
94.962	95.963	5285.3	6606.6	5285.3	0	0
95.963	96.063	528.0	792.0	528.0	0	0
96.063	96.123	316.8	396.0	316.8	633.6	0
96.123	96.460	1779.4	2224.3	1779.4	0	0
96.460	96.520	316.8	396.0	316.8	633.6	0
96.520	96.640	633.6	950.4	633.6	0	0
96.640	97.462	4340.2	5425.3	4340.2	0	0
97.462	97.642	950.4	1425.6	950.4	0	0
97.642	97.702	316.8	396.0	316.8	633.6	0
97.702	98.002	1584.0	1980.0	1584.0	0	0
98.002	98.062	316.8	396.0	316.8	633.6	0
98.062	98.322	1372.8	2059.2	1372.8	0	0
98.322	99.323	5285.3	6606.6	5285.3	0	0
99.323	99.383	316.8	396.0	316.8	79.2	0
99.383	99.463	422.4	528.0	422.4	844.8	0
99.463	100.033	3009.6	3762.0	3009.6	0	0
LOCATIONS	LOG MILE	6" WHITE HIGH BUILD WATERBORNE PAVEMENT MARKING PAINT, TYPE L BEADS (LF)	6" YELLOW HIGH BUILD WATERBORNE PAVEMENT MARKING PAINT, TYPE L BEADS (LF)	12" WHITE HIGH BUILD WATERBORNE PAVEMENT MARKING PAINT, TYPE L BEADS (LF)	PERFORMED THERMOPLASTIC PAVEMENT MARKING LEFT/RIGHT ARROW (EACH)	
RAMPS						
EXIT TO LIGHTBURNE	93.801	1514.6	952.6	0.0	0	
EXIT FROM RTE 69	94.842	3043.4	2686.3	0.0	0	
EXIT TO RTE 291	96.103	1886.2	1009.26	0.0	6 RIGHT, 3 LEFT	
EXIT FROM RTE 291	96.460	1041.0	745.3	0.0	0	
EXIT TO 152	97.702	1573.2	736.7	0.0	6 RIGHT, 3 LEFT	
EXIT FROM 152	98.002	1197.2	744.5	0.0	0	
EXIT TO NE PLEASANT VALLEY RD	99.463	4307.6	2956.0	0.0	4 STRAIGHT, 2 RIGHT, 4 LEFT	
EXIT TO SB REST AREA	91.568	580.6	469.2	0.0		
EXIT FROM SB REST AREA	91.820	251.5	66.6	0.0		
SUBTOTALS		85428.2	65463.5	5781.6	28	

SUMMARY OF QUANTITIES
SHEET 4 OF 9

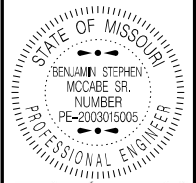

Benjamin Stephen McCabe Sr.
 08/29/2024 7:34:14 AM
 BENJAMIN STEPHEN MCCABE SR - CIVIL
 MO-PE-2003015005
 DATE PREPARED
 8/26/2024
 ROUTE 35 STATE MO
 DISTRICT KC SHEET NO. 3
 COUNTY CLAY
 JOB NO. JKU0060
 CONTRACT ID.
 PROJECT NO.
 BRIDGE NO.

DATE	DESCRIPTION

MISSOURI HIGHWAYS AND TRANSPORTATION COMMISSION

105 WEST CAPITOL
 JEFFERSON CITY, MO 65102
 1-888-ASK-MODOT (1-888-275-6636)

Table with columns: SIGN, SIZE, AREA, QTY, TOTAL AREA, QTY RELOC, TOTAL RELOC, SIGN NUM., DESCRIPTION. Includes sections for WARNING SIGNS, GUIDE SIGNS, REGULATORY SIGNS, and MISCELLANEOUS SIGNS.

Table with columns: SIGN, SIZE, AREA, QTY, TOTAL, RELOC, SIGN NUM., DESCRIPTION. Includes sections for GUIDE SIGNS, REGULATORY SIGNS, and MISCELLANEOUS SIGNS.

Table with columns: ITEM NUMBER, TOTAL QTY, DESCRIPTION. Lists various traffic signs and materials with their respective quantities.

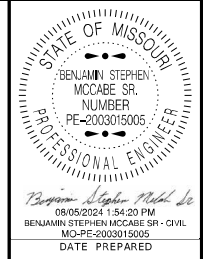



Project Information Form: ROUTE 35, STATE MO, DISTRICT KC, SHEET NO. 3, COUNTY CLAY, JOB NO. JKU0060, CONTRACT ID., PROJECT NO., BRIDGE NO.

Table with columns: DATE, DESCRIPTION. Contains a vertical list of dates and descriptions for project milestones or activities.

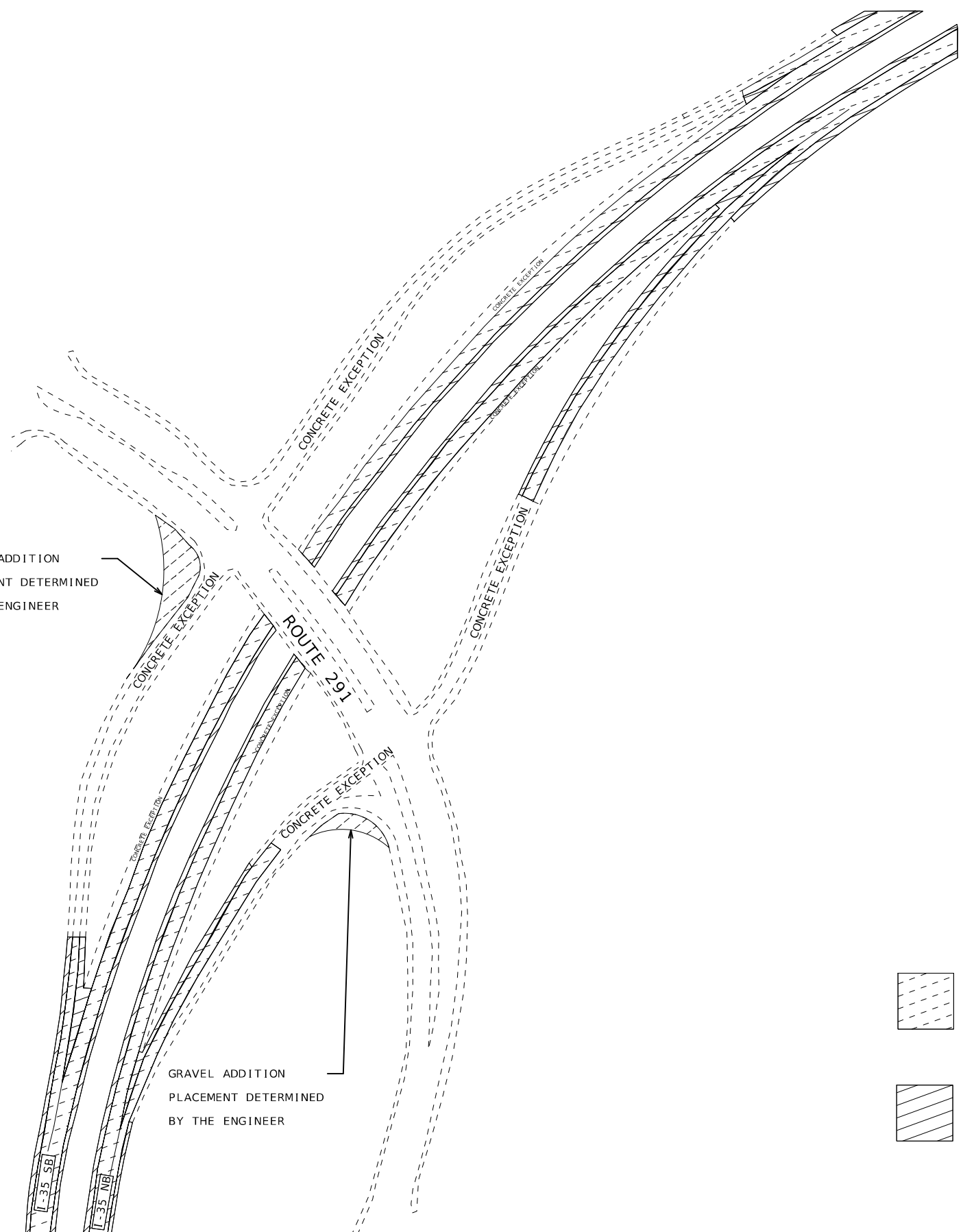



 MAINLINE PAVEMENT AREA
 SHOULDER PAVEMENT AREA

SPECIAL SHEET
 I-35 AND MO 291 INTERCHANGE DETAIL
 SHEET 2 OF 6



Benjamin Stephen McCabe Sr.
 08/05/2024 1:50:53 PM
 BENJAMIN STEPHEN MCCABE SR - CIVIL
 MO-PE-2003015005



DATE PREPARED	
8/5/2024	
ROUTE	STATE
35	MO
DISTRICT	SHEET NO.
KC	5
COUNTY	
CLAY	
JOB NO.	
JKU0060	
CONTRACT ID.	
PROJECT NO.	
BRIDGE NO.	

DATE	DESCRIPTION

MISSOURI HIGHWAYS AND TRANSPORTATION
 COMMISSION

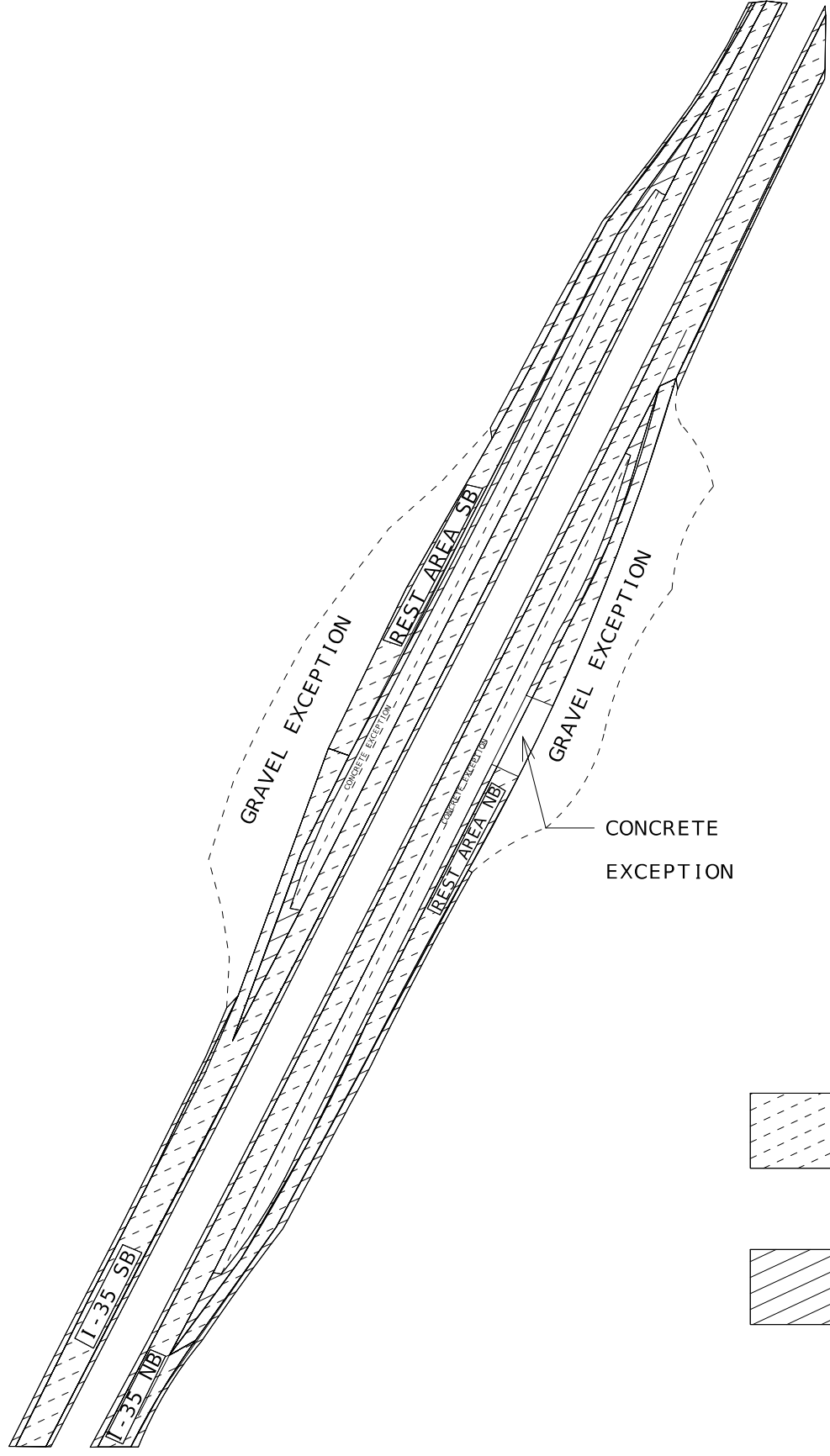
 105 WEST CAPITOL
 JEFFERSON CITY, MO 65102
 1-888-ASK-MODOT (1-888-273-6636)

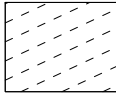

 MAINLINE PAVEMENT AREA
 SHOULDER PAVEMENT AREA

SPECIAL SHEET
 I-35 TRUCK PARKING DETAIL
 SHEET 4 OF 6

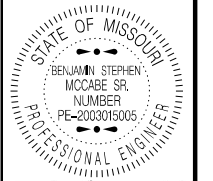

Benjamin Stephen McCabe Sr.
 08/05/2024 1:47:04 PM
 BENJAMIN STEPHEN MCCABE SR. - CIVIL
 MO-PE-2003015005

DATE PREPARED
 8/5/2024
 ROUTE 35 STATE MO
 DISTRICT KC SHEET NO. 7
 COUNTY CLAY
 JOB NO. JKU0060
 CONTRACT ID.
 PROJECT NO.
 BRIDGE NO.

DATE	DESCRIPTION

MISSOURI HIGHWAYS AND TRANSPORTATION
 COMMISSION

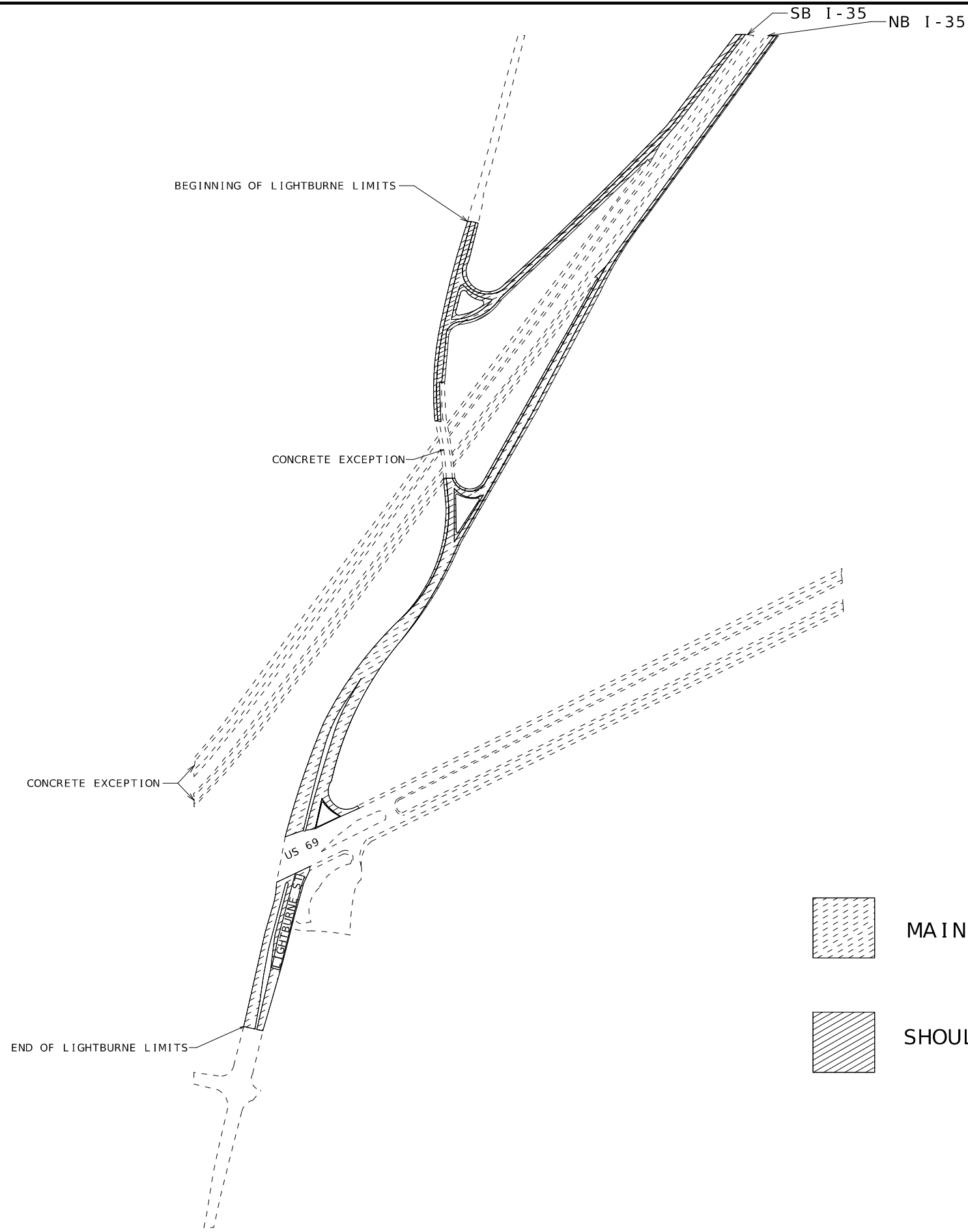
 105 WEST CAPITOL
 JEFFERSON CITY, MO 65102
 1-888-ASK-MODOT (1-888-275-6636)



Benjamin Stephen McCabe Sr.
 08/05/2024 1:30:46 PM
 BENJAMIN STEPHEN MCCABE SR - CIVIL
 MO-PE-2003015005

DATE PREPARED	
8/5/2024	
ROUTE	STATE
35	MO
DISTRICT	SHEET NO.
KC	8
COUNTY	
CLAY	
JOB NO.	
JKU0060	
CONTRACT ID.	
PROJECT NO.	
BRIDGE NO.	

DATE	DESCRIPTION

MISSOURI HIGHWAYS AND TRANSPORTATION COMMISSION



105 WEST CAPITOL
 JEFFERSON CITY, MO 65102
 1-888-ASK-MODOT (1-888-273-6636)

SPECIAL SHEET
 LIGHTBURNE ST. DETAIL
 SHEET 5 OF 6

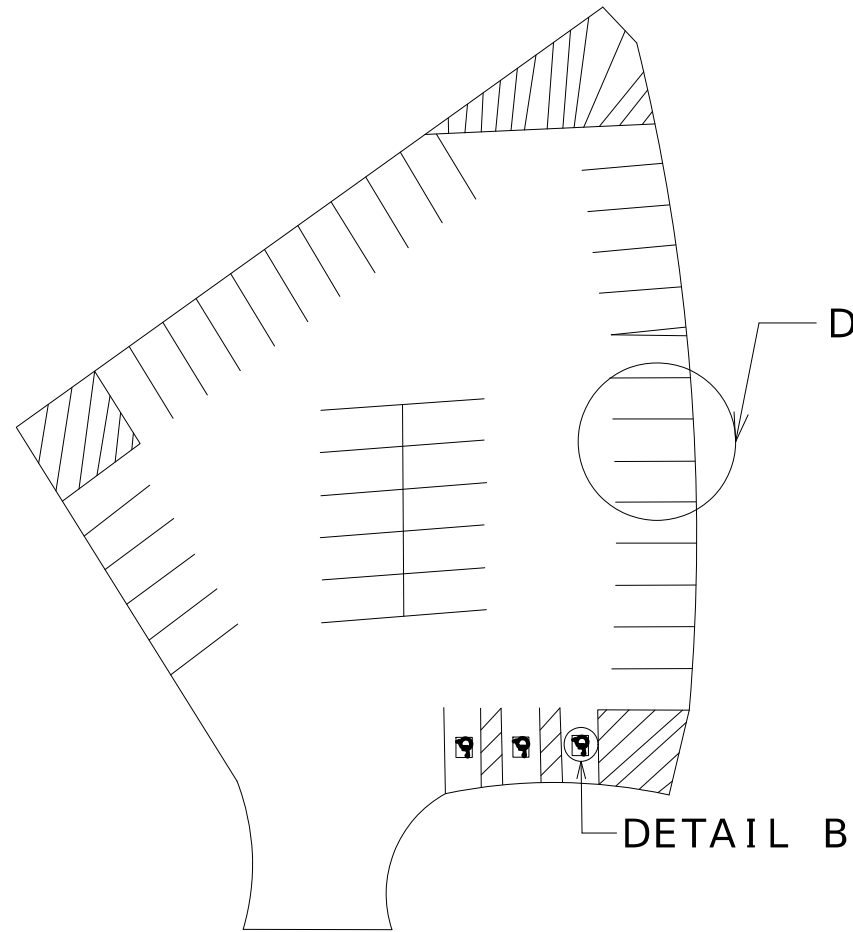

DETAIL A

DETAIL B

PAVEMENT STRIPING

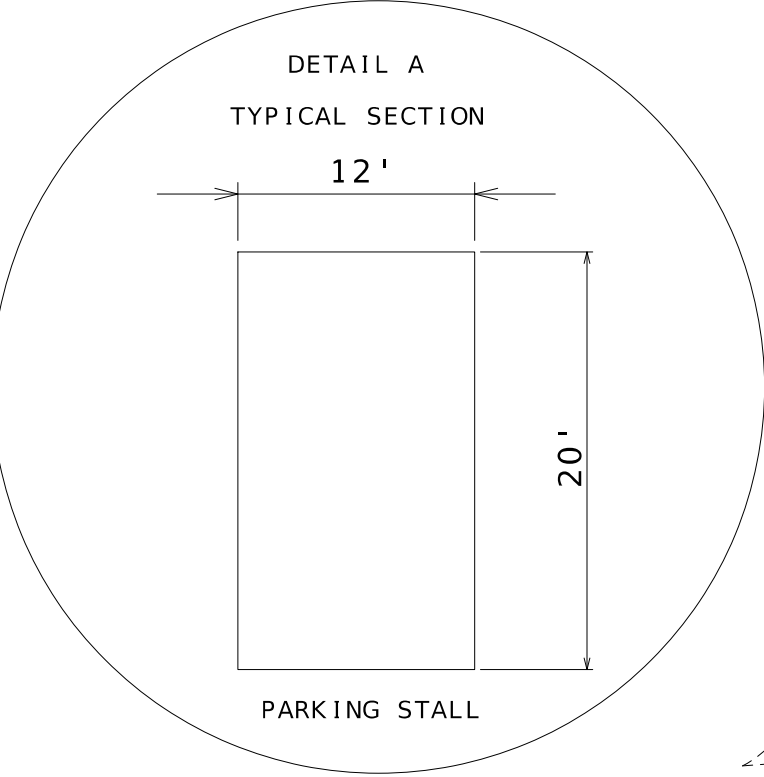

***NOTE: ALL WHITE PAVEMENT MARKING IS WITH 4" TYPE P BEADS**

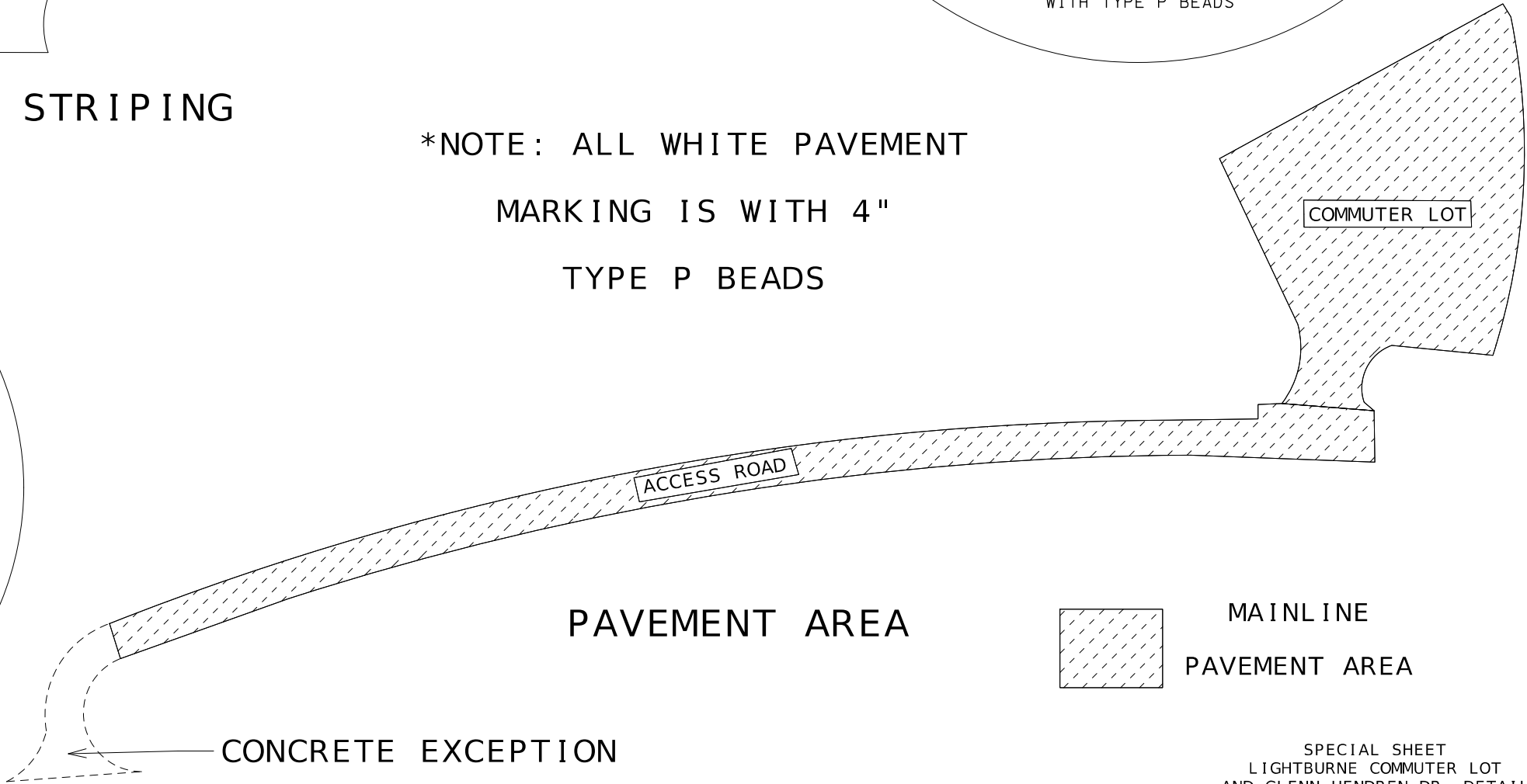
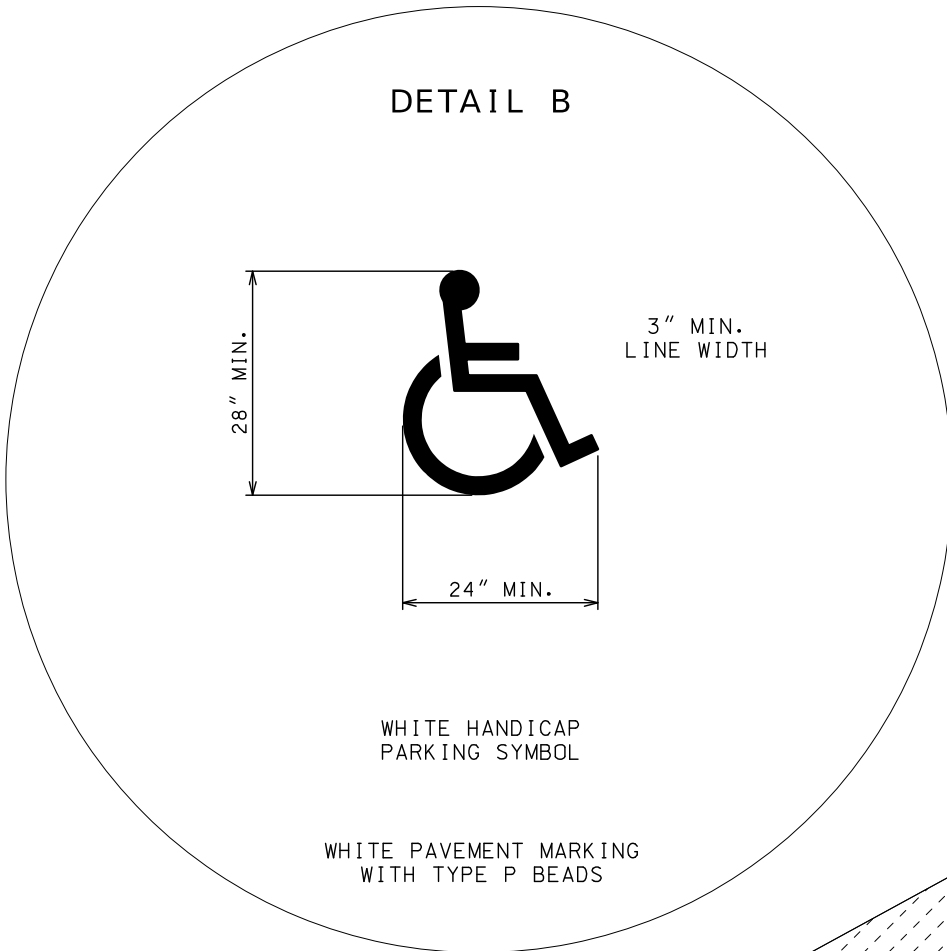

SPECIAL SHEET
LIGHTBURNE COMMUTER LOT
AND GLENN HENDREN DR. DETAIL
SHEET 6 OF 6

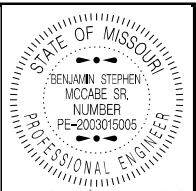

Benjamin Stephen McCabe Sr.
08/05/2024 1:29:11 PM
BENJAMIN STEPHEN MCCABE SR - CIVIL
MO-PE-2003015005

DATE PREPARED
8/5/2024
ROUTE 35 STATE MO
DISTRICT KC SHEET NO. 9
COUNTY CLAY
JOB NO. JKU0060
CONTRACT ID.
PROJECT NO.
BRIDGE NO.

DATE	DESCRIPTION

MISSOURI HIGHWAYS AND TRANSPORTATION COMMISSION
MoDOT
105 WEST CAPITOL
JEFFERSON CITY, MO 65102
1-888-ASK-MODOT (1-888-275-6636)

SPACING AND TAPER LENGTHS FOR WORK ZONE SIGNS, CHANNELIZERS AND CONCRETE BARRIER

SIGN SPACING FOR ADVANCE SIGN SERIES (1) (2)		
PERMANENT POSTED SPEED MPH	UNDIVIDED HIGHWAYS	DIVIDED HIGHWAYS
0-35	200'	200'
40-45	350'	500'
50-55	500'	1000'
60-70	1000'	SA - 1000' SB - 1500' SC - 2640'

TAPER LENGTHS AND END TREATMENTS FOR CONCRETE BARRIER				
PERMANENT POSTED SPEED MPH	MINIMUM LANE TAPER LENGTH (3)			END TREATMENT (4)
MPH	10'	11'	12'	END TREATMENT (4)
< 40	160'	168'	176'	BARRIER HEIGHT TRANSITION
> 40	160'	168'	176'	APPROVED CRASH CUSHION

TAPER LENGTHS AND SPACING FOR CHANNELIZERS							
PERMANENT POSTED SPEED MPH	MINIMUM LANE TAPER LENGTH (3)			MINIMUM SHOULDER TAPER LENGTH BASED ON 10' SHOULDER	BUFFER LENGTH FT	MAXIMUM CHANNELIZER SPACING	
	10'	11'	12'			THROUGH TAPER	THROUGH WORK AREA
0-35	205'	225'	245'	70'	280'	35'	40'
40-45	450'	495'	540'	150'	400'	40'	80'
50-55	550'	605'	660'	185'	560'	50'	80'
60-70	700'	770'	840'	235'	840'	60'	120'

- NOTE:**
- (1) SPACING BETWEEN SIGNS AND SPACING BETWEEN LAST SIGN AND FLAGGER, BEGINNING OF TAPER, OF SIGNED CONDITION.
 - (2) SPACING MAY BE ADJUSTED AS NECESSARY TO MEET FIELD CONDITIONS.
 - (3) TAPER LENGTHS SHOWN INCLUDE LENGTH REQUIRED FOR LANE AND 10' SHOULDER
 - (4) CONCRETE BARRIER MAY BE INSTALLED AT 8:1 FLARE RATE FROM THE SHOULDER POINT OF THE LIMITS OF THE CLEAR ZONE WHERE THE SIDE SLOPE IS 6:1 OR FLATTER



Benjamin Stephen McCabe Sr.
08/05/2024 1:27:38 PM
BENJAMIN STEPHEN MCCABE SR - CIVIL
MO-PE-2003015005

DATE PREPARED 8/5/2024	
ROUTE 35	STATE MO
DISTRICT KC	SHEET NO. 10
COUNTY CLAY	
JOB NO. JKU0060	
CONTRACT ID.	
PROJECT NO.	
BRIDGE NO.	

DATE	DESCRIPTION

MISSOURI HIGHWAYS AND TRANSPORTATION COMMISSION

105 WEST CAPITOL
JEFFERSON CITY, MO 65102
1-888-ASK-MODOT (1-888-275-6636)

NOT TO SCALE

NOTES:

UPON APPROVAL OF THE ENGINEER, THE CONTRACTOR MAY PROVIDE ADDITIONAL PROTECTIVE TRUCKS EQUIPPED WITH PROPER WARNING DEVICES.

PROTECTIVE TRUCKS AND WORK VEHICLES SHALL DISPLAY HIGH-INTENSITY ROTATING, FLASHING, OSCILLATING, OR STROBE LIGHTS.

VEHICLE HAZARD WARNING SIGNALS SHALL NOT BE USED INSTEAD OF THE VEHICLE'S HIGH-INTENSITY ROTATING, FLASHING, OSCILLATING, OR STROBE LIGHTS.

VEHICLE-MOUNTED SIGNS SHALL BE MOUNTED IN A MANNER SUCH THAT THEY ARE NOT OBSCURED BY EQUIPMENT OR SUPPLIES. SIGN LEGENDS ON VEHICLE-MOUNTED SIGNS SHALL BE COVERED OR TURNED FROM VIEW WHEN WORK IS NOT IN PROGRESS.

FLASHING ARROW PANELS SHALL BE INCIDENTAL TO TRUCK MOUNTED ATTENUATORS, WHEREVER USED. NO ADDITIONAL PAYMENT WILL BE MADE.

FLASHING ARROW PANELS SHALL, AS A MINIMUM, BE TYPE B, WITH A SIZE OF 60 X 30 INCHES.

A FLASHING ARROW BOARD SHALL BE USED WHEN A FREEWAY LANE IS CLOSED. WHEN MORE THAN ONE LANE CLOSED, A SEPARATE FLASHING ARROW BOARD SHALL BE USED FOR EACH CLOSED LANE.

(1) WET PAINT SIGNS ARE INSTALLED TO INDICATE THE SIDE IN WHICH THE PAVEMENT MARKING MATERIAL IS BEING APPLIED. AT THE CONTRACTOR'S OPTION, A FRONT FACING WET PAINT SIGN MAY BE INSTALLED ON THE LEFT SIDE OF THE PAVEMENT MARKING EQUIPMENT.

(2) WARNING TRUCK IS POSITIONED AT THE NO TRACK POINT OF THE PAVEMENT MARKING MATERIAL, OR SPACING SHOWN, WHICH EVER IS GREATER.

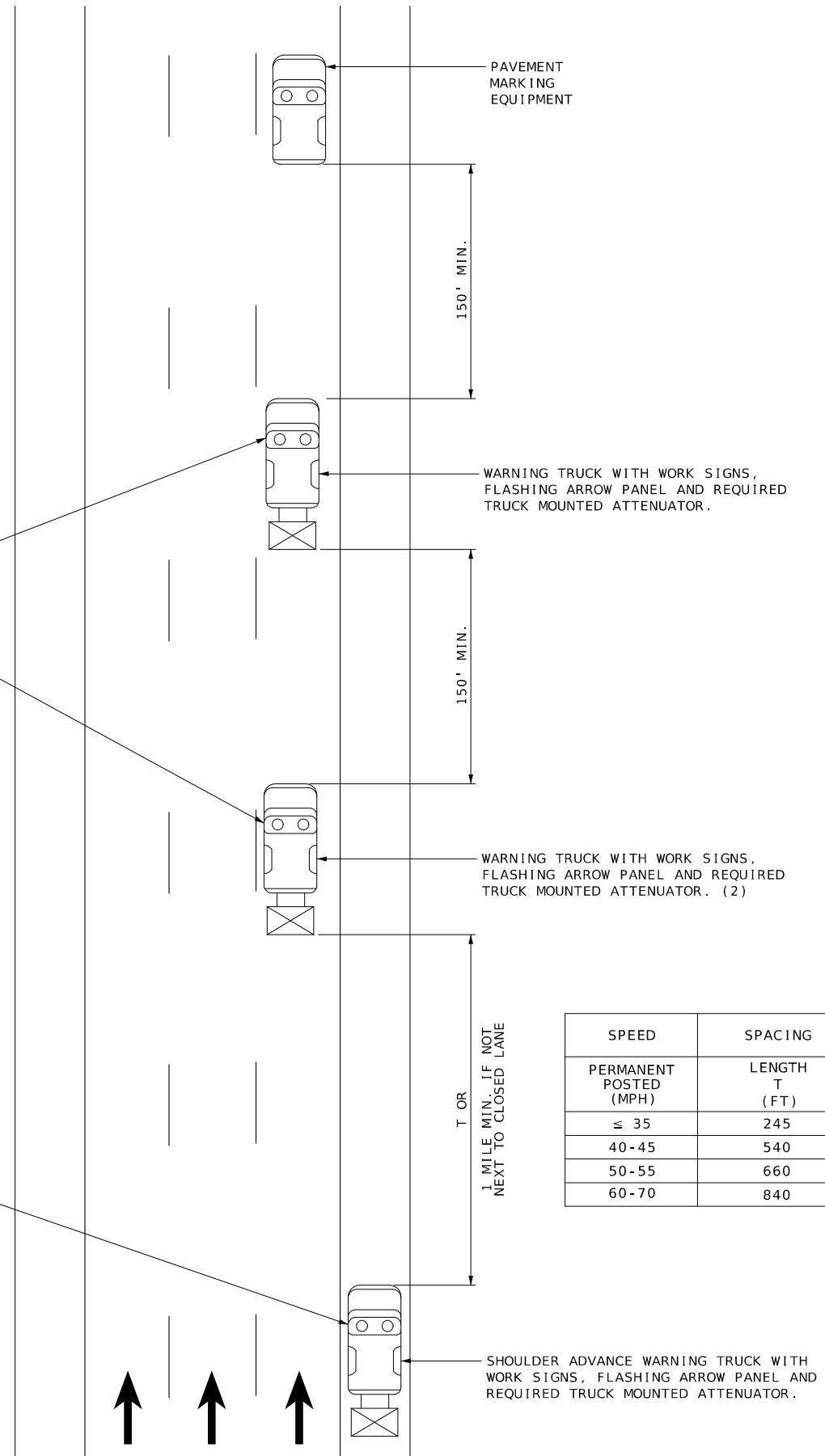
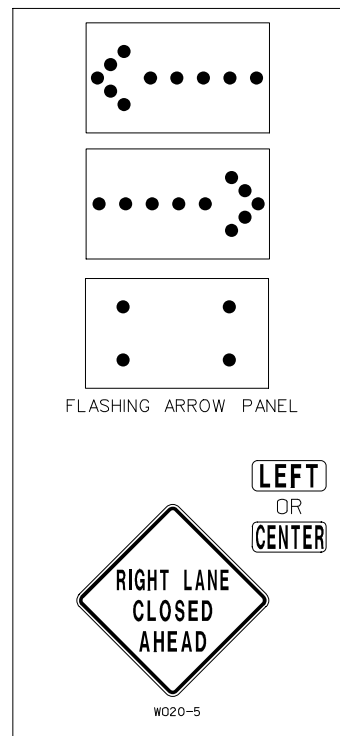
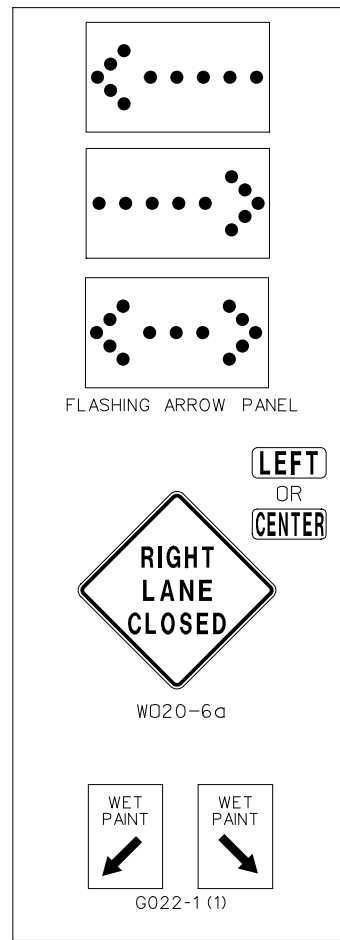

STRIPING ON MULTI-LANE HIGHWAY



Benjamin Stephen McCabe Sr.
08/05/2024 1:20:53 PM
BENJAMIN STEPHEN MCCABE SR - CIVIL
MO-PE-2003015005
DATE PREPARED

8/5/2024

ROUTE	STATE
35	MO
DISTRICT	SHEET NO.
KC	14
COUNTY	
CLAY	
JOB NO.	
JKU0060	
CONTRACT ID.	
PROJECT NO.	
BRIDGE NO.	

DATE	DESCRIPTION

MISSOURI HIGHWAYS AND TRANSPORTATION COMMISSION

105 WEST CAPITOL
JEFFERSON CITY, MO 65102
1-888-ASK-MODOT (1-888-275-6636)

END OF PROJECT LIMITS; END OF WORK ZONE TERMINATION AREA, IF LOCATED BEYOND END OF PROJECT; OR LAST WORK ZONE SIGN, IF LOCATED OUTSIDE PROJECT LIMITS.

BEGINNING OF PROJECT LIMITS; OR INITIAL WORK ZONE SIGN, IF LOCATED OUTSIDE PROJECT LIMITS.

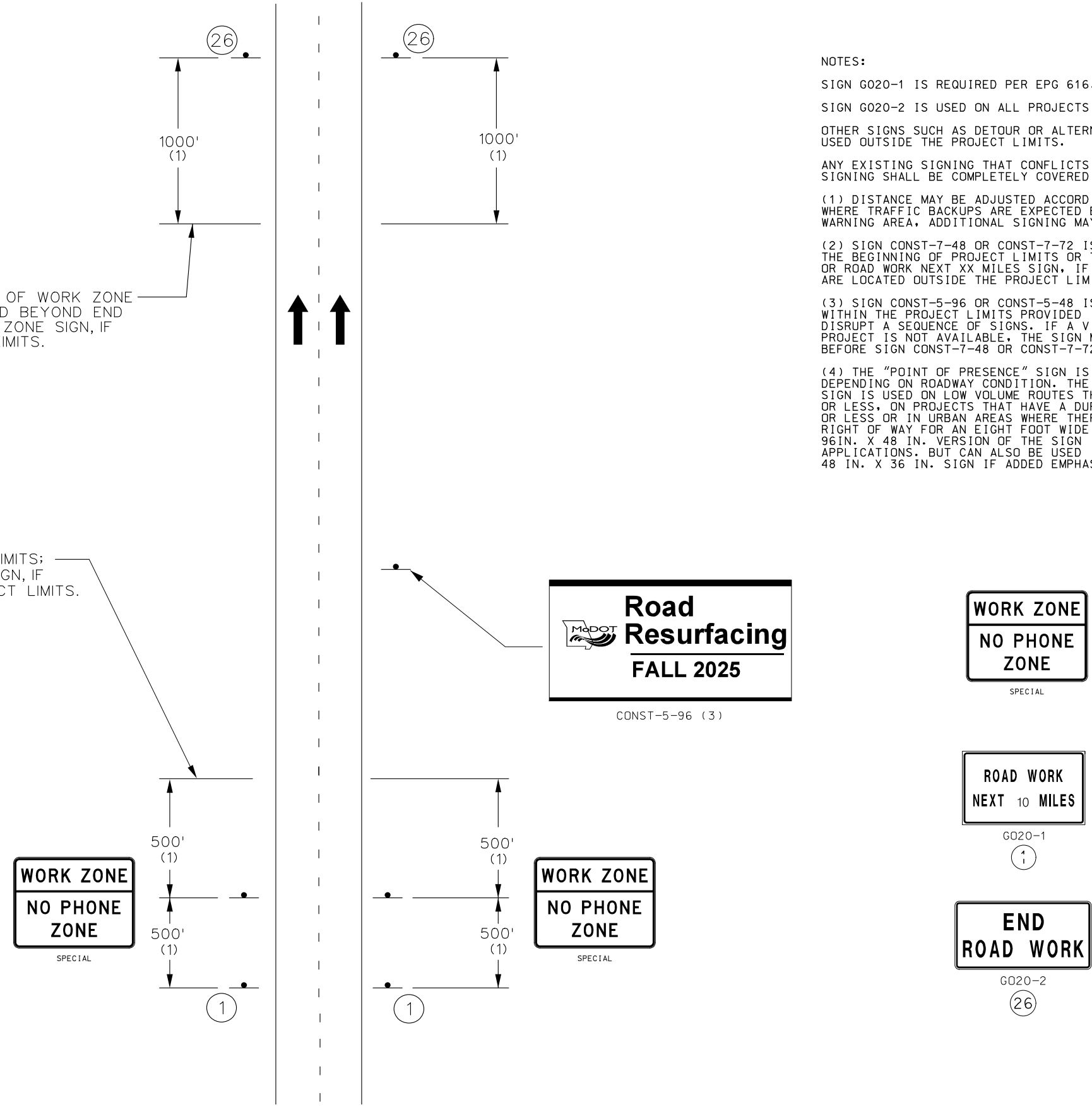

MULTI-LANE DIVIDED
BEGIN/END OF PROJECT SIGNING
(FOR USE ON ALL PROJECTS)

NOTES:

SIGN G020-1 IS REQUIRED PER EPG 616.6.56.

SIGN G020-2 IS USED ON ALL PROJECTS WHERE SIGN G020-1 IS USED.

OTHER SIGNS SUCH AS DETOUR OR ALTERNATE ROUTE SIGNING MAY BE USED OUTSIDE THE PROJECT LIMITS.

ANY EXISTING SIGNING THAT CONFLICTS WITH THE TRAFFIC CONTROL SIGNING SHALL BE COMPLETELY COVERED OR REMOVED.

(1) DISTANCE MAY BE ADJUSTED ACCORDING TO FIELD CONDITIONS. WHERE TRAFFIC BACKUPS ARE EXPECTED BEYOND THE ADVANCE WARNING AREA, ADDITIONAL SIGNING MAY BE NEEDED.

(2) SIGN CONST-7-48 OR CONST-7-72 IS PLACED 500 FEET BEFORE THE BEGINNING OF PROJECT LIMITS OR THE ROAD WORK AHEAD SIGN OR ROAD WORK NEXT XX MILES SIGN, IF USED, WHEN THESE SIGNS ARE LOCATED OUTSIDE THE PROJECT LIMITS.

(3) SIGN CONST-5-96 OR CONST-5-48 IS PLACED IN A VISIBLE AREA WITHIN THE PROJECT LIMITS PROVIDED ITS PLACEMENT DOES NOT DISRUPT A SEQUENCE OF SIGNS. IF A VISIBLE LOCATION WITHIN THE PROJECT IS NOT AVAILABLE, THE SIGN MAY BE PLACED 500 FEET BEFORE SIGN CONST-7-48 OR CONST-7-72.

(4) THE "POINT OF PRESENCE" SIGN IS AVAILABLE IN TWO SIZES DEPENDING ON ROADWAY CONDITION. THE 48 IN. X 36 IN. SIGN IS USED ON LOW VOLUME ROUTES THAT CARRY 400 AADT OR LESS, ON PROJECTS THAT HAVE A DURATION OF 4 WEEKS OR LESS OR IN URBAN AREAS WHERE THERE IS INSUFFICIENT RIGHT OF WAY FOR AN EIGHT FOOT WIDE SIGN. THE 96 IN. X 48 IN. VERSION OF THE SIGN IS USED IN ALL OTHER APPLICATIONS. BUT CAN ALSO BE USED IN PLACE OF THE 48 IN. X 36 IN. SIGN IF ADDED EMPHASIS IS DEEMED NECESSARY.

BEGIN/END
TEMPORARY
TRAFFIC CONTROL
SHEET 6 OF 7

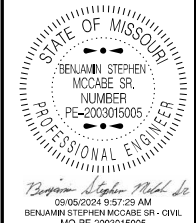

DATE PREPARED		9/5/2024	
ROUTE	STATE	MO	
35			
DISTRICT	SHEET NO.	KC	15
COUNTY			
CLAY			
JOB NO.			
JKU0060			
CONTRACT ID.			
PROJECT NO.			
BRIDGE NO.			

DATE	DESCRIPTION

MISSOURI HIGHWAYS AND TRANSPORTATION
COMMISSION

105 WEST CAPITOL
JEFFERSON CITY, MO 65102
1-888-ASK-MODOT (1-888-275-6636)

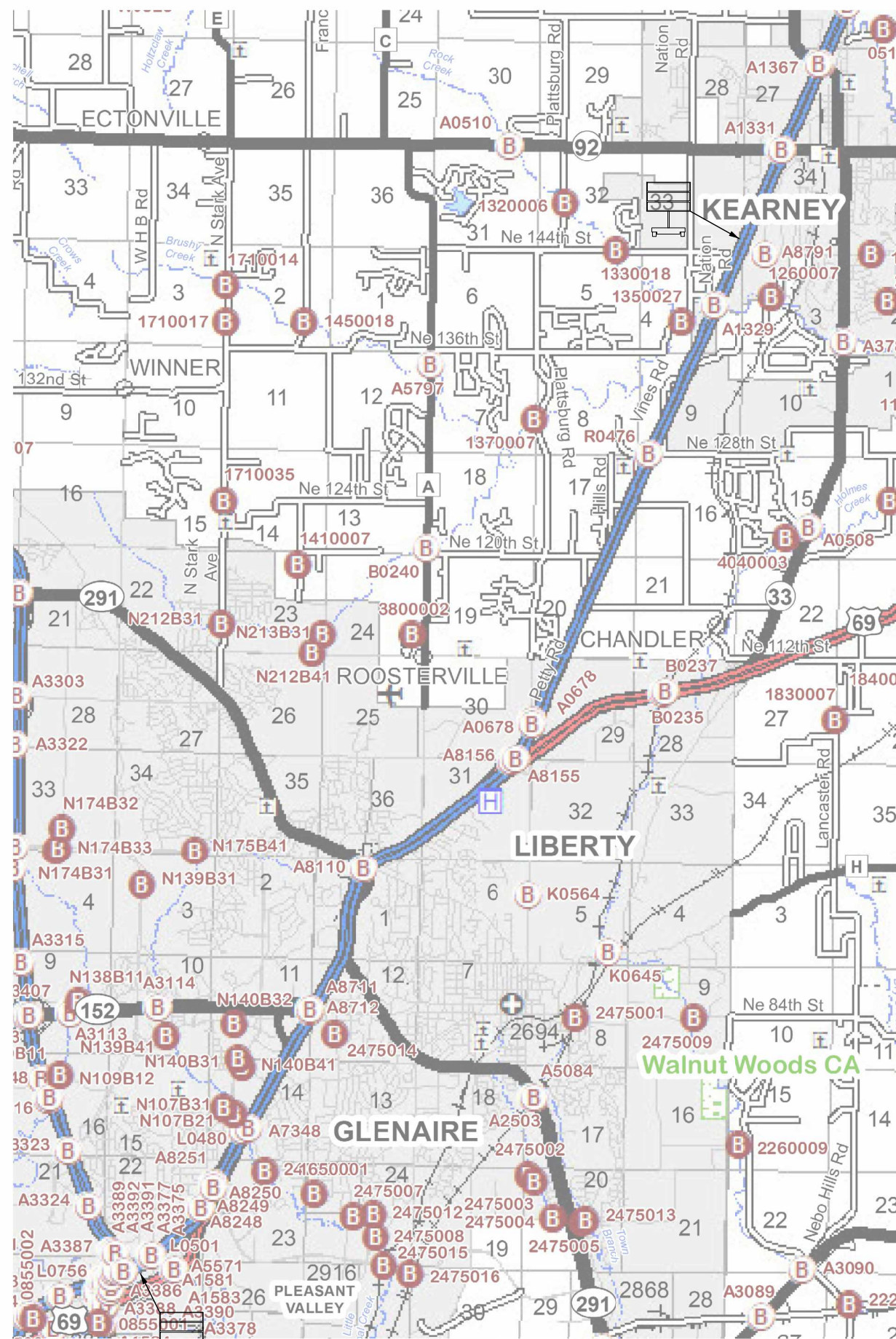

NOT TO SCALE

NOTE:
SEE TRAFFIC CONTROL SHEET 1 FOR CMS SPACING
CMS NUMBER, MESSAGE, AND PLACEMENT TO BE DETERMINED AND APPROVED BY THE ENGINEER

- CHANGEABLE MESSAGE BOARD

TRAFFIC CONTROL SHEET
CMS PLACEMENT
SHEET 7 OF 7



Benjamin Stephen McCabe Sr.
08/05/2024 11:43:04 PM
BENJAMIN STEPHEN MCCABE SR - CIVIL
MO-PE-2003015005

DATE PREPARED
8/5/2024
ROUTE 35 STATE MO
DISTRICT KC SHEET NO. 16
COUNTY CLAY
JOB NO. JKU0060
CONTRACT ID.
PROJECT NO.
BRIDGE NO.

DATE	DESCRIPTION

MISSOURI HIGHWAYS AND TRANSPORTATION COMMISSION

105 WEST CAPITOL
JEFFERSON CITY, MO 65102
1-888-ASK-MODOT (1-888-275-6636)

