

### DESIGN DESIGNATION

A.A.D.T. - 2024(1S 35) = 120,000  
 A.A.D.T. - 2044(1S 35) = 144,000

D.H.V. = 9%  
 T = 12%  
 V = 55 M.P.H.

FUNCTIONAL CLASSIFICATION- INTERSTATE

A.A.D.T. - 2024(MO 291) = 35,000  
 A.A.D.T. - 2044(MO 291) = 42,000

D.H.V. = 9%  
 T = 6%  
 V = 55 M.P.H.

FUNCTIONAL CLASSIFICATION- FREEWAY

# MISSOURI HIGHWAYS AND TRANSPORTATION COMMISSION PLANS FOR PROPOSED STATE HIGHWAY JACKSON COUNTY



KEY MAP  
 LOCATION OF JACKSON COUNTY

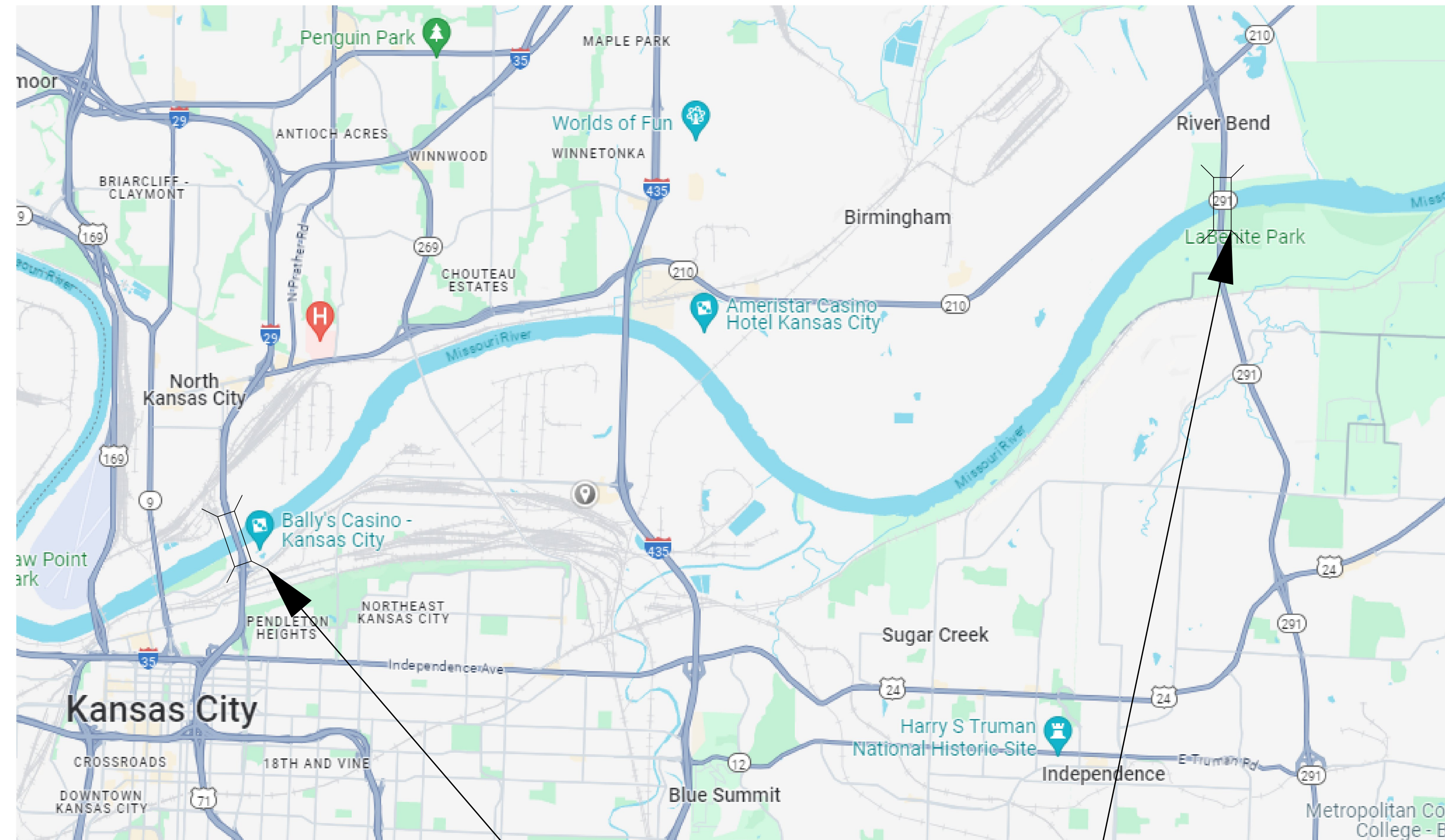

BRIDGE WASHING  
 BR A7650(NB & SB) 29/35  
 OVER MO RIVER  
 LOG MI 108.983 1S 35 SB

BRIDGE WASHING  
 BR A4757 ON SB 291  
 OVER MO RIVER  
 LOG MI 12.651 291 SB

THE EXISTENCE AND APPROXIMATE LOCATION OF UTILITY FACILITIES KNOWN TO EXIST, AS SHOWN ON THE PLANS, ARE BASED ON THE BEST INFORMATION AVAILABLE TO THE COMMISSION AT THIS TIME. THIS INFORMATION IS PROVIDED BY THE COMMISSION "AS-IS" AND THE COMMISSION EXPRESSLY DISCLAIMS ANY REPRESENTATION OR WARRANTY AS TO THE COMPLETENESS, ACCURACY, OR SUITABILITY OF THE INFORMATION FOR ANY USE. RELIANCE UPON THIS INFORMATION IS DONE AT THE RISK AND PERIL OF THE USER, AND THE COMMISSION SHALL NOT BE LIABLE FOR ANY DAMAGES THAT MAY ARISE FROM ANY ERROR IN THE INFORMATION. IT IS, THEREFORE, THE RESPONSIBILITY OF THE CONTRACTOR TO VERIFY THE EXISTENCE, LOCATION AND STATUS OF ANY FACILITY. SUCH VERIFICATION INCLUDES DIRECT CONTACT WITH THE LISTED UTILITIES.

### INDEX OF SHEETS

DESCRIPTION	SHEET NUMBER
TITLE SHEET -----	1
TYPICAL SECTIONS (TS) (1 SHEET)--	2
QUANTITIES (QU) (2 SHEETS)-----	3
TRAFFIC CONTROL SHEETS (TC)-----	4-17

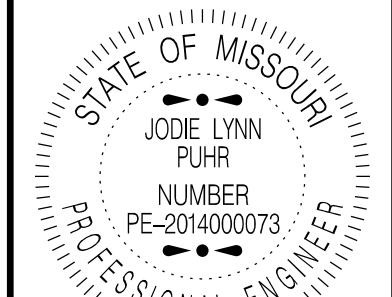

DATE PREPARED  
**8/14/2024**

ROUTE	STATE
<b>29/291</b>	<b>MO</b>
DISTRICT	SHEET NO.
<b>KC</b>	<b>1</b>

COUNTY  
**JACKSON**

JOB NO.  
**J4P3485**

CONTRACT ID.

PROJECT NO.

BRIDGE NO.

DESCRIPTION	DATE

### CONVENTIONAL SYMBOLS (USED IN PLANS)

	EXISTING	NEW
BUILDINGS AND STRUCTURES		
GUARD RAIL		
GUARD CABLE		
CONCRETE RIGHT-OF-WAY MARKER		
STEEL RIGHT-OF-WAY MARKER		
LOCATION SURVEY MARKER		
UTILITIES		
FIBER OPTICS	-FO-	-FO-
OVERHEAD CABLE TV	-OTV-	-OTV-
UNDERGROUND CABLE TV	-UTV-	-UTV-
OVERHEAD TELEPHONE	-OT-	-OT-
UNDERGROUND TELEPHONE	-UT-	-UT-
OVERHEAD POWER	-OE-	-OE-
UNDERGROUND POWER	-UE-	-UE-
SANITARY SEWER	-S-	-S-
STORM SEWER	-SS-	-SS-
GAS	-G-	-G-
WATER	-W-	-W-
MANHOLE		
FIRE HYDRANT		
WATER VALVE		
WATER METER		
DROP INLET		
DITCH BLOCK		
GROUND MOUNTED SIGN		
LIGHT POLE		
H-FRAME POWER POLE		
TELEPHONE PEDESTAL		
FENCE		
CHAIN LINK	-V-	-V-
WOVEN WIRE	-X-	-X-
GATE POST		
BENCHMARK		

NOTE: DASHED OR OPEN SYMBOLS INDICATE EXISTING FEATURES

### LENGTH OF PROJECT

BEGINNING OF PROJECT (1S 35)	LOG MILE 108.983 1S 35 SB
END OF PROJECT (1S 35)	LOG MILE 109.296 1S 35 SB
APPARENT LENGTH	1652.64 FEET
BEGINNING OF PROJECT (1S 35)	LOG MILE 5.135 1S 35 NB
END OF PROJECT (1S 35)	LOG MILE 5.461 1S 35 SB
APPARENT LENGTH	1721.28 FEET

BEGINNING OF PROJECT (MO 291)	LOG MILE 12.651 MO 291 SB
END OF PROJECT	LOG MILE 13.027 MO 291 SB
APPARENT LENGTH	1985.28 FEET

EQUATIONS AND EXCEPTIONS:

TOTAL CORRECTIONS	0 FEET
NET LENGTH OF PROJECT	5359.2 FEET
STATE LENGTH	1.015 MILES
FOR INFORMATION ONLY ESTIMATED DISTURBED ACRES	0 ACRES

MISSOURI HIGHWAYS AND TRANSPORTATION COMMISSION

105 WEST CAPITOL  
 JEFFERSON CITY, MO 65102  
 1-888-ASK-MODOT (1-888-275-6636)

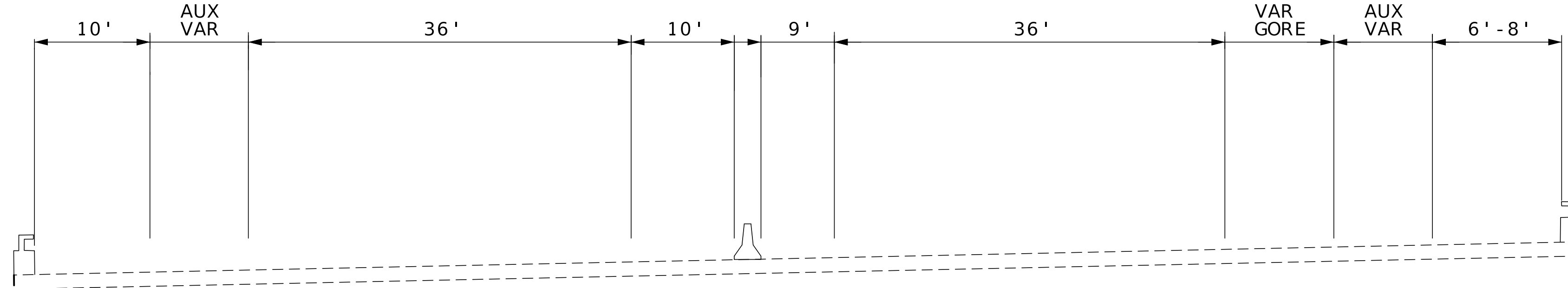

IS 35/29  
 LOG MI 108.983 TO LOG MI 109.296 IS 35 SB

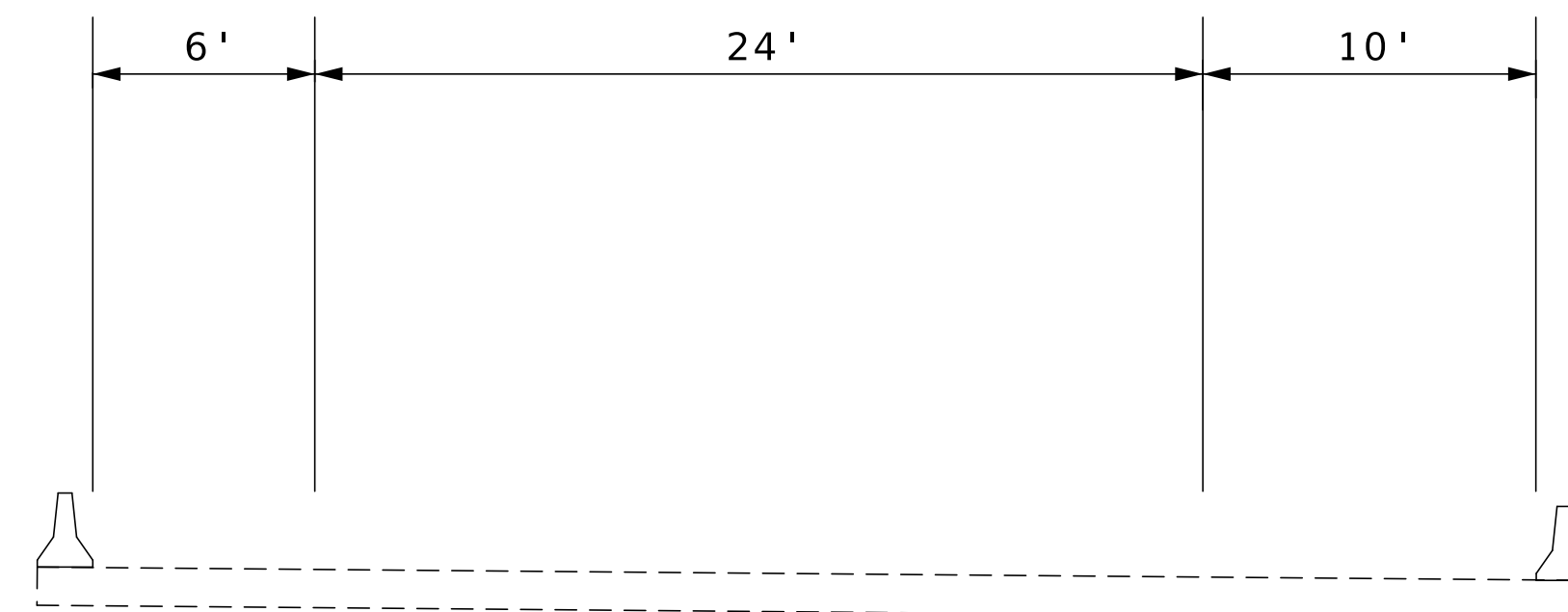

MO-291  
 LOG MI 12.651 TO LOG MI 13.027 SB

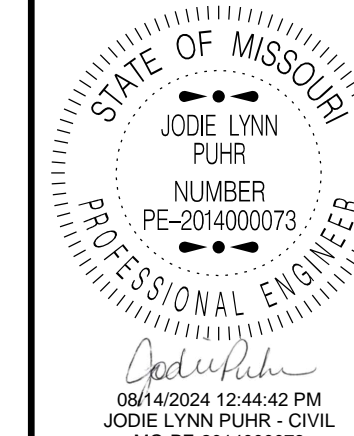

DATE PREPARED  
 8/14/2024

ROUTE STATE  
 29/291 MO  
 DISTRICT SHEET NO.  
 KC 2

COUNTY  
 JACKSON

JOB NO.  
 J4P3485

CONTRACT ID.

PROJECT NO.

BRIDGE NO.

DATE	DESCRIPTION

MISSOURI HIGHWAYS AND TRANSPORTATION COMMISSION

105 WEST CAPITOL  
 JEFFERSON CITY, MO 65102  
 1-888-ASK-MODOT (1-888-275-6636)

MOBILIZATION
1 LUMP SUM

BRIDGE WASHING			
LOCATION	BRIDGE A7650	BRIDGE A4757	REMARKS
I-29	X		BOTH DIRECTIONS OVER MISSOURI RIVER
MO-291 SB		X	ONLY SB OVER MISSOURI RIVER
PAY TOTAL	1 LUMP SUM		

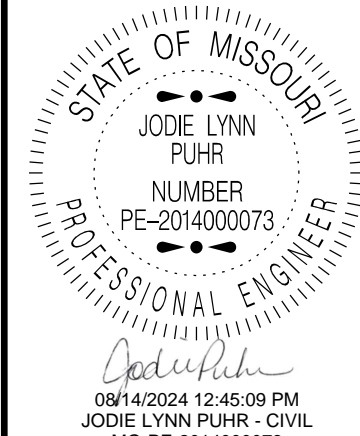

DATE PREPARED  
8/14/2024

ROUTE STATE  
29/291 MO

DISTRICT SHEET NO.  
KC 3

COUNTY  
JACKSON

JOB NO.  
J4P3485

CONTRACT ID.

PROJECT NO.

BRIDGE NO.

DATE	DESCRIPTION

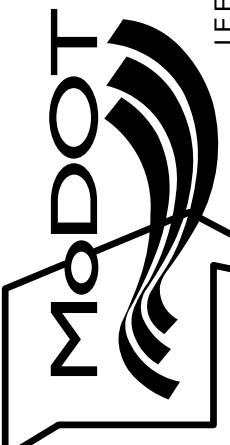
MISSOURI HIGHWAYS AND TRANSPORTATION COMMISSION  
  
 105 WEST CAPITOL  
 JEFFERSON CITY, MO 65102  
 1-888-ASK-MODOT (1-888-275-6636)

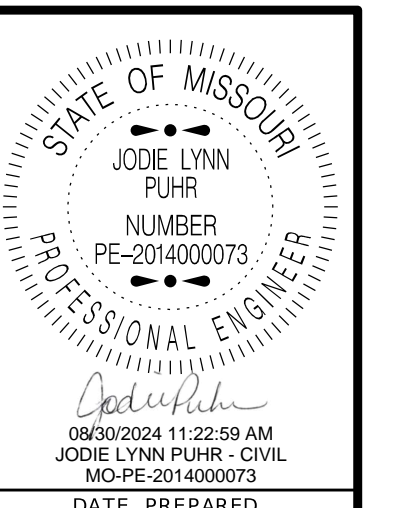

DATE PREPARED: 8/23/2024

ROUTE: 29/291 STATE: MO DISTRICT: KC SHEET NO.: 3

COUNTY: JACKSON JOB NO.: J4P3485 CONTRACT ID.:

PROJECT NO.: BRIDGE NO.:

Table with 2 columns: DESCRIPTION, DATE

MISSOURI HIGHWAYS AND TRANSPORTATION COMMISSION 105 WEST CAPITOL JEFFERSON CITY, MO 65102 1-888-ASK-MODOT (1-888-275-6636)

Table with columns: SIGN, SIZE, AREA, QTY, TOTAL AREA, QTY RELOC, TOTAL RELOC, SIGN NUM., DESCRIPTION

Table with columns: SIGN, SIZE, AREA, QTY, TOTAL AREA, QTY RELOC, TOTAL RELOC, SIGN NUM., DESCRIPTION

Summary table for 616-10.05 CONSTRUCTION SIGNS and 616-10.10 RELOCATED SIGNS

Table with columns: ITEM NUMBER, TOTAL QTY, DESCRIPTION

# Sign Spacing, Device Spacing and Channelizing Taper Lengths

SIGN SPACING (S) FOR ADVANCE SIGN SERIES (1) (2)		
SPEED MPH	UNDIVIDED HIGHWAYS	DIVIDED HIGHWAYS
0-35	200	200
40-45	350	500
50-55	500	1000
60-70	1000	SA-1000 SB-1500 SC-2640

LONGITUDINAL BUFFER SPACE (B)	
SPEED MPH	BUFFER SPACE
0-35	250
40-45	360
50-55	495
60-70	730

TAPER LENGTHS AND SPACING OF CHANNELIZING DEVICES					
SPEED MPH	MINIMUM TAPER LENGTHS (L) FOR LANE WIDTHS (W)			MAXIMUM CHANNELIZER SPACING	
	10 FT	11 FT	12 FT	THROUGH TAPER	THROUGH WORK AREA
0-35	205	225	245	35	40
40-45	450	495	540	40	80
50-55	550	605	660	50	80
60-70	700	770	840	60	120

TAPER LENGTH (L):  
 $L = WS$  FOR 40 MPH OR MORE  
 $L = \frac{WS^2}{60}$  FOR 35 MPH OR LESS  
 FOR SHOULDER TAPER USE  $L/3$

WHERE:  
 L = TAPER LENGTH IN FEET  
 W = LATERAL SHIFT IN FEET  
 S = POSTED SPEED IN MPH

NOTES:

- DIMENSIONS IN FEET UNLESS OTHERWISE NOTED.
- SPACING BETWEEN SIGNS AND SPACING BETWEEN LAST SIGN AND FLAGGER, BEGINNING OF TAPER, OR SIGNED CONDITION
  - SPACINGS MAY BE ADJUSTED AS NECESSARY TO MEET FIELD CONDITIONS

## TRAFFIC CONTROL DEVICES

GENERAL NOTES:

- SEE STANDARD PLAN 616.10 FOR DETAILS AND ITEMS NOT SHOWN
- EXISTING SIGNS SHALL BE COVERED DURING WORKING HOURS ONLY IF IN CONFLICT WITH TRAFFIC CONTROL PLANS.
- NO DIRECT PAYMENT WILL BE MADE FOR RELOCATING, COVERING, UNCOVERING OR REMOVING SIGNS.
- CONES ALLOWABLE FOR DAYTIME OPERATIONS ONLY.
- LOCATE FLASHING ARROW PANEL AT BEGINNING OF TAPER WHEN FEASIBLE, ARROW PANELS ARE ALWAYS LOCATED BEHIND CHANNELIZERS OR CONES.

TRAFFIC CONTROL LEGEND

- SIGN (SINGLE SIDED)
- ◄ SIGN (DOUBLE SIDED)
- △ FLAGGER
- ▲ DIRECTIONAL INDICATOR BARRICADE
- CHANNELIZER
- ⌌ BARRICADE
- ⌌ CHANGEABLE MESSAGE BOARD
- TMA TRUCK MOUNTED ATTENUATOR W/ FLASHING ARROW

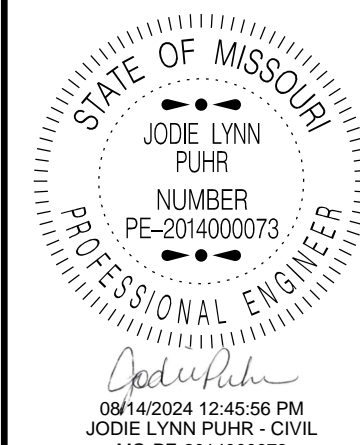

DATE PREPARED		8/14/2024	
ROUTE	STATE	ROUTE	STATE
29/291	MO	29/291	MO
DISTRICT	SHEET NO.	DISTRICT	SHEET NO.
KC	4	KC	4
COUNTY			
JACKSON			
JOB NO.			
J4P3485			
CONTRACT ID.			
PROJECT NO.			
BRIDGE NO.			

DESCRIPTION	DATE

MISSOURI HIGHWAYS AND TRANSPORTATION COMMISSION

105 WEST CAPITOL  
JEFFERSON CITY, MO 65102  
1-888-ASK-MODOT (1-888-275-6636)

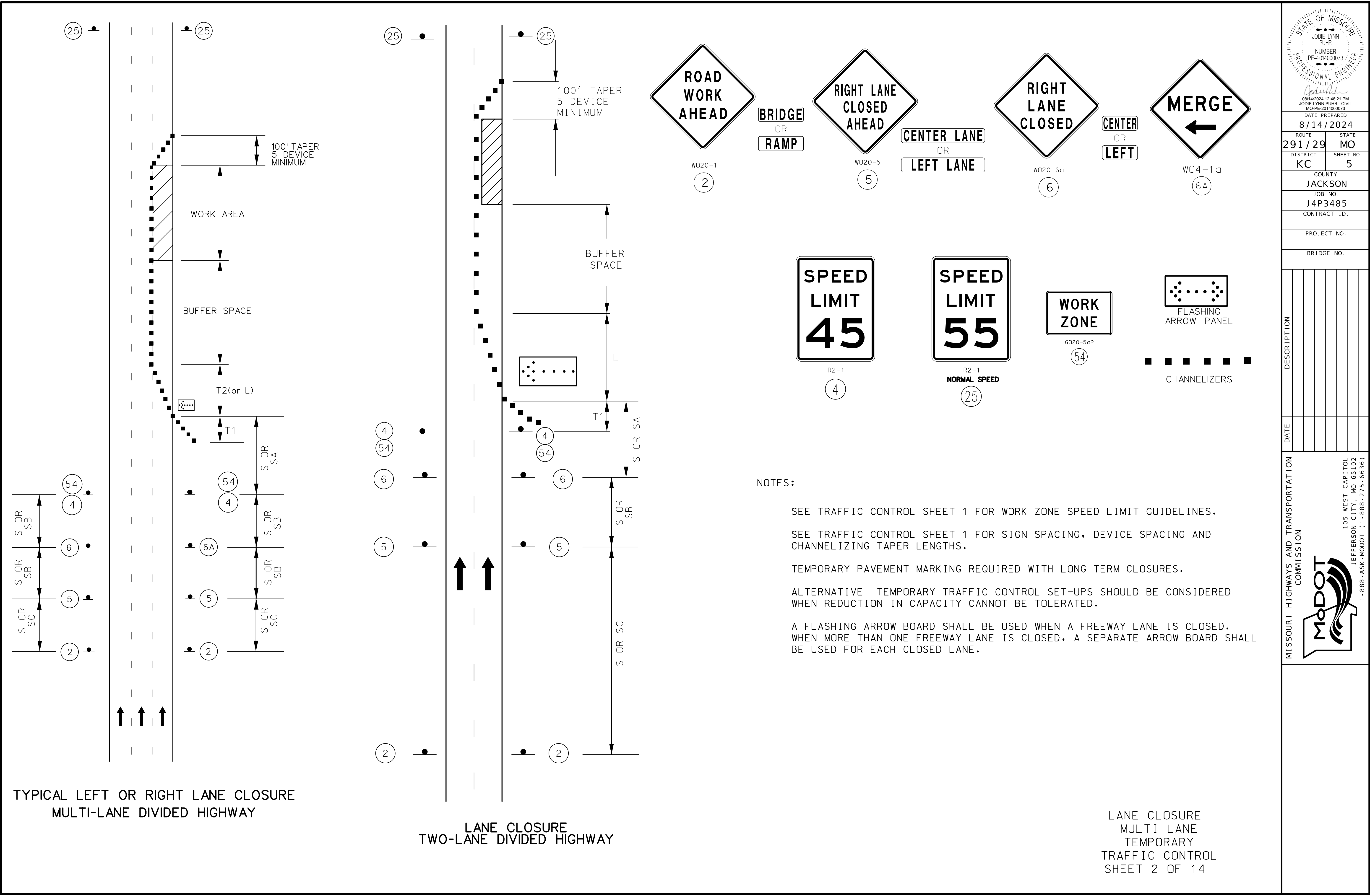

TYPICAL LEFT OR RIGHT LANE CLOSURE  
MULTI-LANE DIVIDED HIGHWAY

LANE CLOSURE  
TWO-LANE DIVIDED HIGHWAY

LANE CLOSURE  
MULTI LANE  
TEMPORARY  
TRAFFIC CONTROL  
SHEET 2 OF 14

NOTES:

- SEE TRAFFIC CONTROL SHEET 1 FOR WORK ZONE SPEED LIMIT GUIDELINES.
- SEE TRAFFIC CONTROL SHEET 1 FOR SIGN SPACING, DEVICE SPACING AND CHANNELIZING TAPER LENGTHS.
- TEMPORARY PAVEMENT MARKING REQUIRED WITH LONG TERM CLOSURES.
- ALTERNATIVE TEMPORARY TRAFFIC CONTROL SET-UPS SHOULD BE CONSIDERED WHEN REDUCTION IN CAPACITY CANNOT BE TOLERATED.
- A FLASHING ARROW BOARD SHALL BE USED WHEN A FREEWAY LANE IS CLOSED. WHEN MORE THAN ONE FREEWAY LANE IS CLOSED, A SEPARATE ARROW BOARD SHALL BE USED FOR EACH CLOSED LANE.

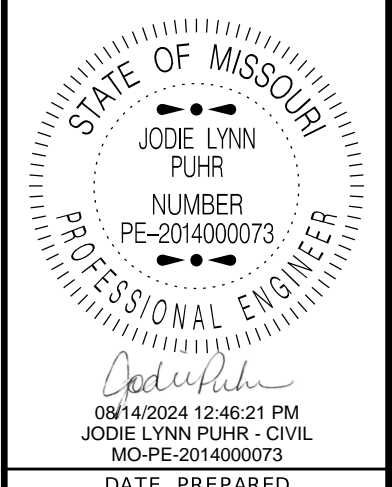

DATE PREPARED  
8/14/2024  
ROUTE  
291/29  
DISTRICT  
KC  
STATE  
MO  
SHEET NO.  
5  
COUNTY  
JACKSON  
JOB NO.  
J4P3485  
CONTRACT ID.  
PROJECT NO.  
BRIDGE NO.

DATE	DESCRIPTION

MISSOURI HIGHWAYS AND TRANSPORTATION COMMISSION  
105 WEST CAPITOL JEFFERSON CITY, MO 65102  
1-888-ASK-MODOT (1-888-275-6636)

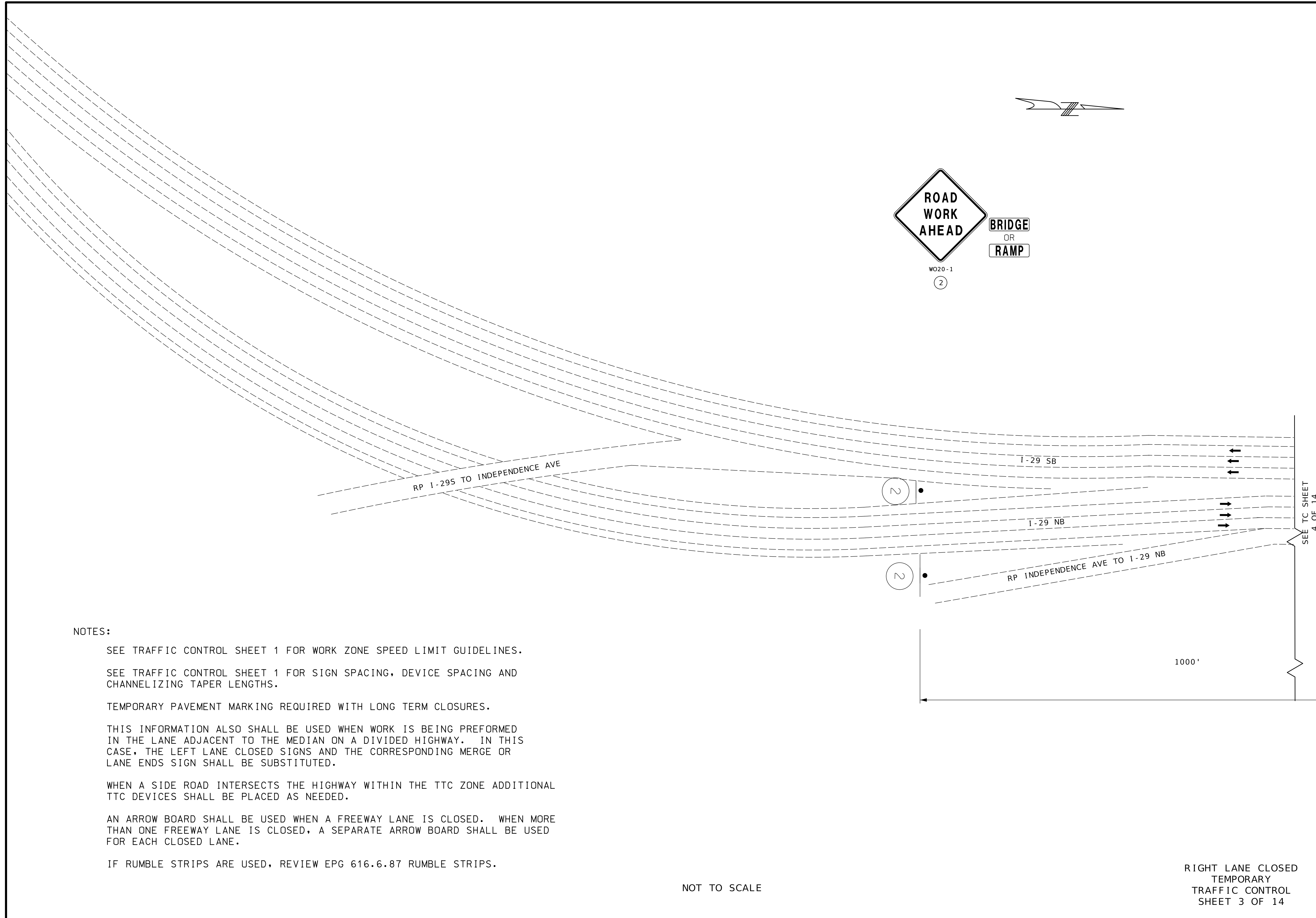

**NOTES:**

- SEE TRAFFIC CONTROL SHEET 1 FOR WORK ZONE SPEED LIMIT GUIDELINES.
- SEE TRAFFIC CONTROL SHEET 1 FOR SIGN SPACING, DEVICE SPACING AND CHANNELIZING TAPER LENGTHS.
- TEMPORARY PAVEMENT MARKING REQUIRED WITH LONG TERM CLOSURES.
- THIS INFORMATION ALSO SHALL BE USED WHEN WORK IS BEING PREFORMED IN THE LANE ADJACENT TO THE MEDIAN ON A DIVIDED HIGHWAY. IN THIS CASE, THE LEFT LANE CLOSED SIGNS AND THE CORRESPONDING MERGE OR LANE ENDS SIGN SHALL BE SUBSTITUTED.
- WHEN A SIDE ROAD INTERSECTS THE HIGHWAY WITHIN THE TTC ZONE ADDITIONAL TTC DEVICES SHALL BE PLACED AS NEEDED.
- AN ARROW BOARD SHALL BE USED WHEN A FREEWAY LANE IS CLOSED. WHEN MORE THAN ONE FREEWAY LANE IS CLOSED, A SEPARATE ARROW BOARD SHALL BE USED FOR EACH CLOSED LANE.
- IF RUMBLE STRIPS ARE USED, REVIEW EPG 616.6.87 RUMBLE STRIPS.

NOT TO SCALE

RIGHT LANE CLOSED  
TEMPORARY  
TRAFFIC CONTROL  
SHEET 3 OF 14

DATE PREPARED	
8/14/2024	
ROUTE	STATE
291/29	MO
DISTRICT	SHEET NO.
KC	6
COUNTY	
JACKSON	
JOB NO.	
J4P3485	
CONTRACT ID.	
PROJECT NO.	
BRIDGE NO.	

DATE	DESCRIPTION

MISSOURI HIGHWAYS AND TRANSPORTATION COMMISSION

105 WEST CAPITOL  
JEFFERSON CITY, MO 65102  
1-888-ASK-MODOT (1-888-275-6636)



WO20-5  
⑤

CENTER LANE  
OR  
LEFT LANE

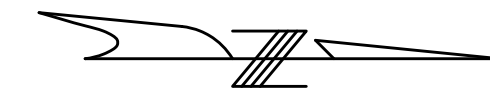

NOTES:

SEE TRAFFIC CONTROL SHEET 1 FOR WORK ZONE SPEED LIMIT GUIDELINES.  
SEE TRAFFIC CONTROL SHEET 1 FOR SIGN SPACING, DEVICE SPACING AND CHANNELIZING TAPER LENGTHS.

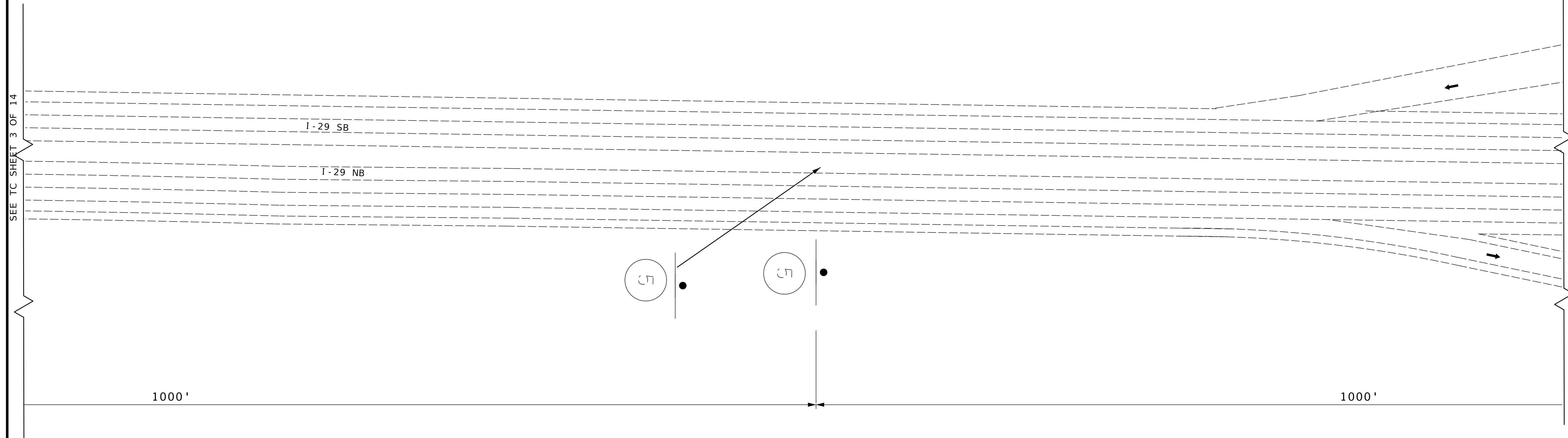

NOTES:

SEE TRAFFIC CONTROL SHEET 1 FOR WORK ZONE SPEED LIMIT GUIDELINES.  
SEE TRAFFIC CONTROL SHEET 1 FOR SIGN SPACING, DEVICE SPACING AND CHANNELIZING TAPER LENGTHS.

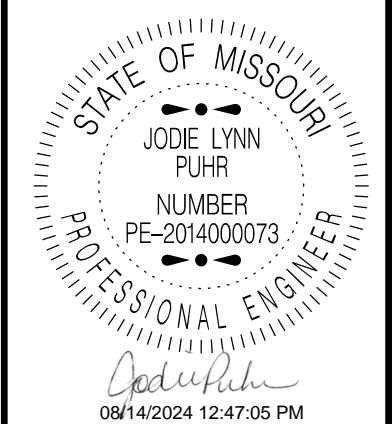

DATE PREPARED  
8/14/2024

ROUTE STATE  
291/29 MO

DISTRICT SHEET NO.  
KC 7

COUNTY  
JACKSON

JOB NO.  
J4P3485

CONTRACT ID.

PROJECT NO.

BRIDGE NO.

DATE	DESCRIPTION

SEE TC SHEET 5 OF 14

MISSOURI HIGHWAYS AND TRANSPORTATION COMMISSION

105 WEST CAPITOL  
JEFFERSON CITY, MO 65102  
1-888-ASK-MODOT (1-888-275-6636)

NOT TO SCALE



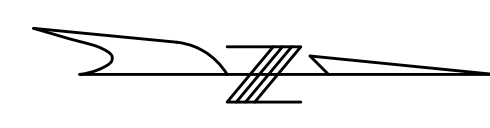

■ ■ ■ ■ ■ ■ ■ ■  
CHANNELIZERS



W020-6a  
6

CENTER  
OR  
LEFT

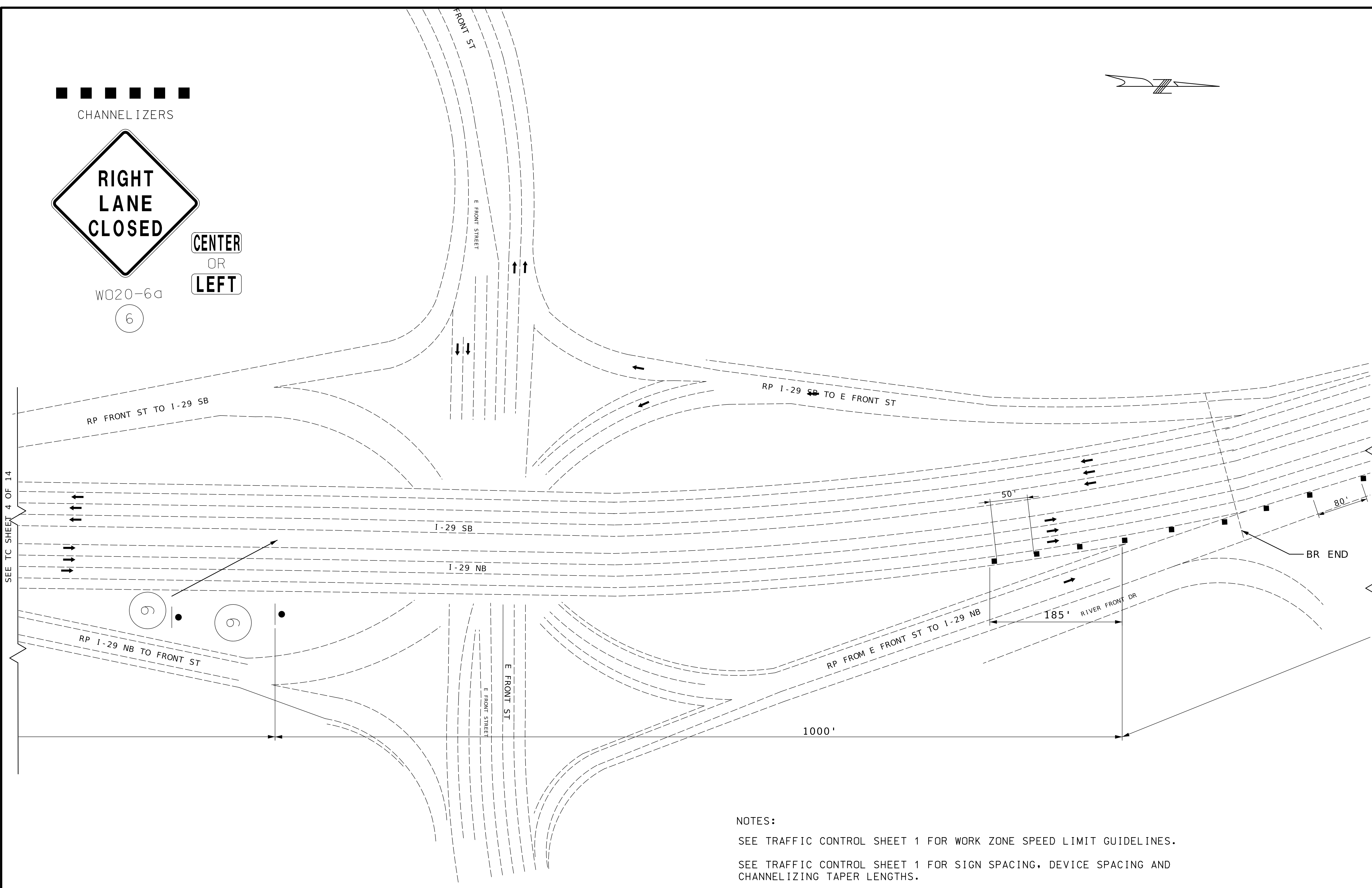

SEE TC SHEET 4 OF 14

SEE TC SHEET 6 OF 14

**NOTES:**

SEE TRAFFIC CONTROL SHEET 1 FOR WORK ZONE SPEED LIMIT GUIDELINES.

SEE TRAFFIC CONTROL SHEET 1 FOR SIGN SPACING, DEVICE SPACING AND CHANNELIZING TAPER LENGTHS.

SEE TRAFFIC CONTROL 8 OF 14 FOR RAMP CLOSURE DETAILS ON FRONT STREET.

NOT TO SCALE

RIGHT LANE CLOSED  
TEMPORARY  
TRAFFIC CONTROL  
SHEET 5 OF 14

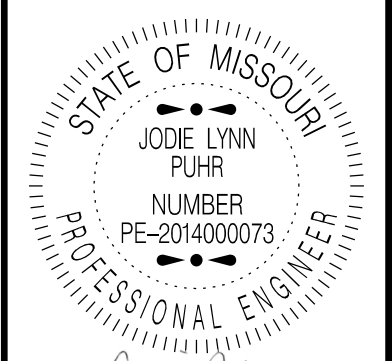

DATE PREPARED  
8/14/2024

ROUTE	STATE
291/29	MO

DISTRICT	SHEET NO.
KC	8

COUNTY  
JACKSON

JOB NO.  
J4P3485

CONTRACT ID.

PROJECT NO.

BRIDGE NO.

DATE	DESCRIPTION

MISSOURI HIGHWAYS AND TRANSPORTATION COMMISSION

105 WEST CAPITOL  
JEFFERSON CITY, MO 65102  
1-888-ASK-MODOT (1-888-275-6636)

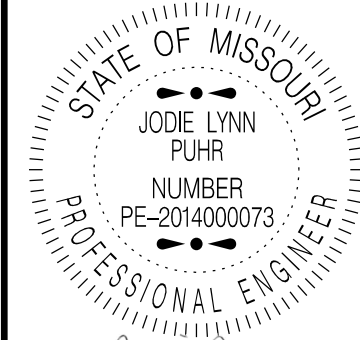

DATE PREPARED  
8/14/2024

ROUTE	STATE
291/29	MO

DISTRICT	SHEET NO.
KC	9

COUNTY  
JACKSON

JOB NO.  
J4P3485

CONTRACT ID.

PROJECT NO.

BRIDGE NO.

DATE	DESCRIPTION

MISSOURI HIGHWAYS AND TRANSPORTATION COMMISSION



105 WEST CAPITOL  
JEFFERSON CITY, MO 65102  
1-888-ASK-MODOT (1-888-275-6636)

■ ■ ■ ■ ■ ■ ■ ■ ■ ■  
CHANNELIZERS

LEVEE RD

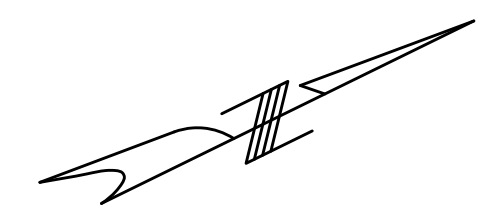

SEE TC SHEET 5 OF 14

SEE TC SHEET 7 OF 14

1943'  
CHANNELIZERS @ 80' SPACING

80'

NOTES:

SEE TRAFFIC CONTROL SHEET 1 FOR WORK ZONE SPEED LIMIT GUIDELINES.

SEE TRAFFIC CONTROL SHEET 1 FOR SIGN SPACING, DEVICE SPACING AND CHANNELIZING TAPER LENGTHS.

NOT TO SCALE

RIGHT LANE CLOSED  
TEMPORARY  
TRAFFIC CONTROL  
SHEET 6 OF 14

■■■■■■  
CHANNELIZERS

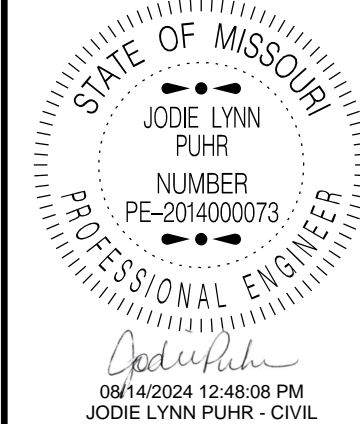

DATE PREPARED  
8/14/2024

ROUTE STATE  
291/29 MO

DISTRICT SHEET NO.  
KC 10

COUNTY  
JACKSON

JOB NO.  
J4P3485

CONTRACT ID.

PROJECT NO.

BRIDGE NO.

DESCRIPTION	DATE

MISSOURI HIGHWAYS AND TRANSPORTATION COMMISSION  
  
105 WEST CAPITOL  
JEFFERSON CITY, MO 65102  
1-888-ASK-MODOT (1-888-275-6636)

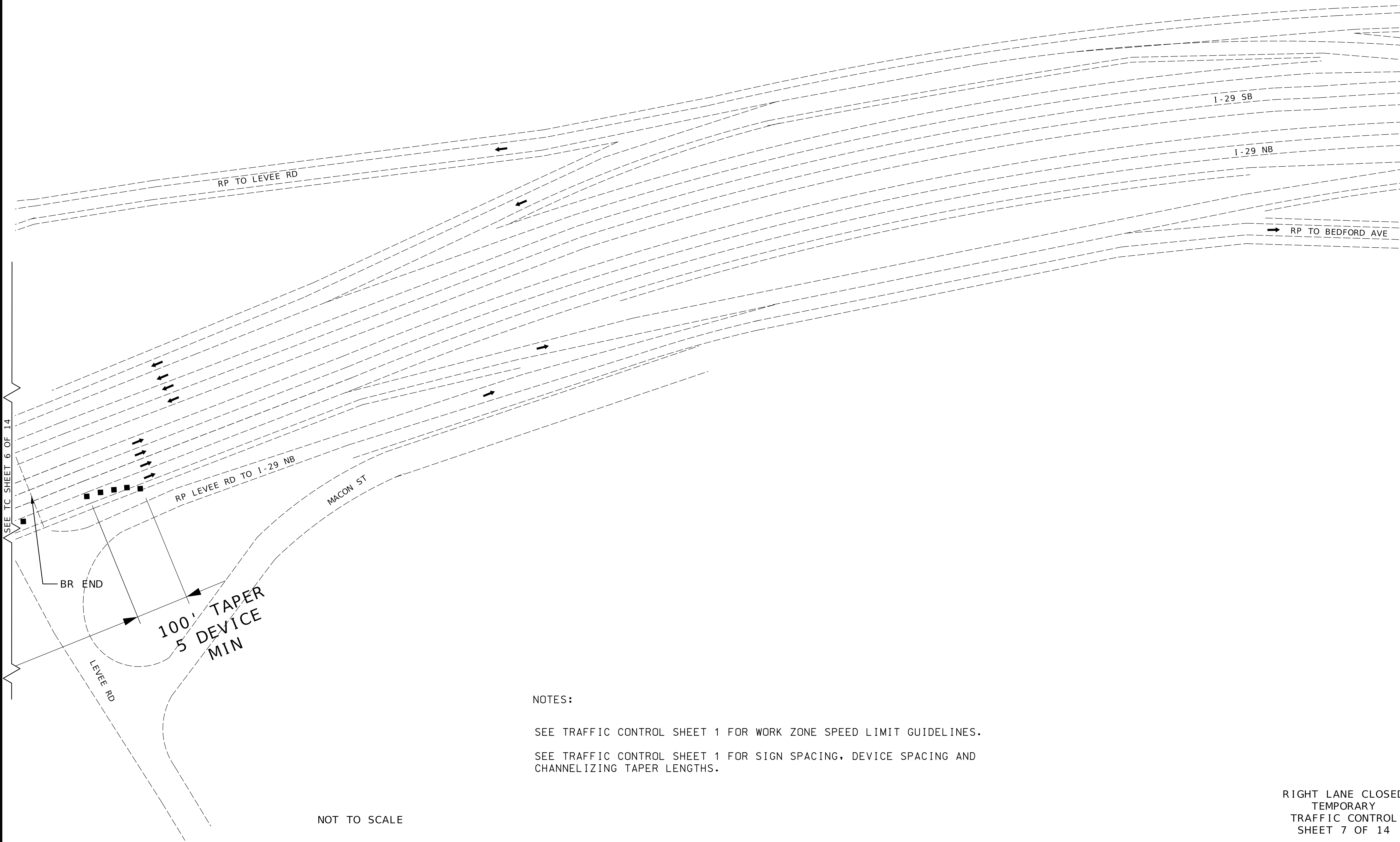

NOTES:  
SEE TRAFFIC CONTROL SHEET 1 FOR WORK ZONE SPEED LIMIT GUIDELINES.  
SEE TRAFFIC CONTROL SHEET 1 FOR SIGN SPACING, DEVICE SPACING AND CHANNELIZING TAPER LENGTHS.

NOT TO SCALE

RIGHT LANE CLOSED  
TEMPORARY  
TRAFFIC CONTROL  
SHEET 7 OF 14

SEE TC SHEET 6 OF 14



W020-1

(2)

BRIDGE  
OR  
RAMP



W020-3

(20)

BRIDGE  
OR  
RAMP



R11-2

(29)

BRIDGE  
OR  
RAMP

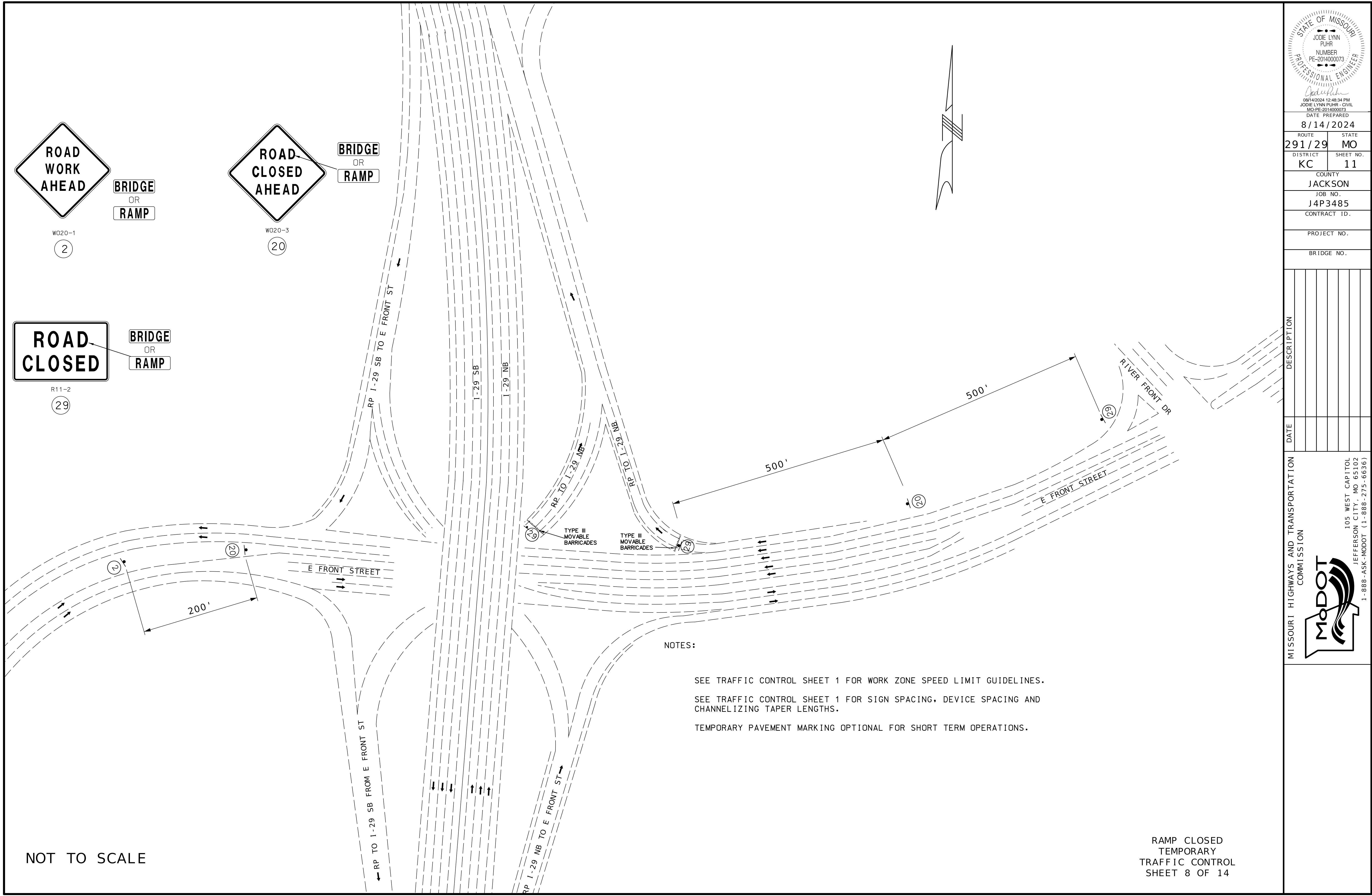

NOTES:

- SEE TRAFFIC CONTROL SHEET 1 FOR WORK ZONE SPEED LIMIT GUIDELINES.
- SEE TRAFFIC CONTROL SHEET 1 FOR SIGN SPACING, DEVICE SPACING AND CHANNELIZING TAPER LENGTHS.
- TEMPORARY PAVEMENT MARKING OPTIONAL FOR SHORT TERM OPERATIONS.

NOT TO SCALE

RAMP CLOSED  
TEMPORARY  
TRAFFIC CONTROL  
SHEET 8 OF 14

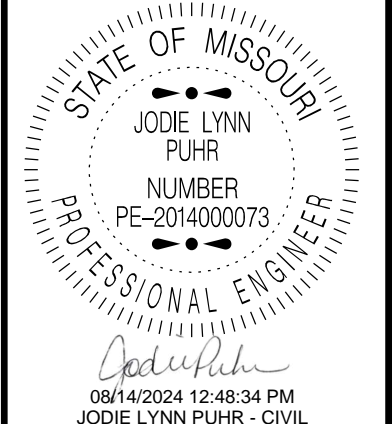

DATE PREPARED  
8/14/2024

ROUTE	STATE
291/29	MO
DISTRICT	SHEET NO.
KC	11

COUNTY  
JACKSON

JOB NO.  
J4P3485

CONTRACT ID.

PROJECT NO.

BRIDGE NO.

DATE	DESCRIPTION

MISSOURI HIGHWAYS AND TRANSPORTATION COMMISSION

105 WEST CAPITOL  
JEFFERSON CITY, MO 65102  
1-888-ASK-MODOT (1-888-275-6636)

■ ■ ■ ■ ■ ■ ■ ■  
CHANNELIZERS

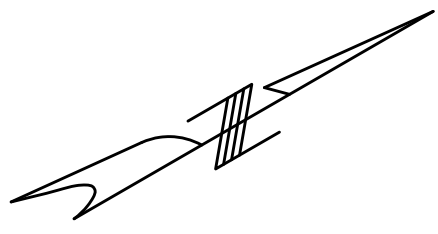

2208'  
CHANNELIZERS @ 80' SPACING

100' TAPER  
5 DEVICE  
MINIMUM

80'

I-29 SB

I-29 NB

← RP I-29 SB TO E FRONT ST

RIVER FRONT DR

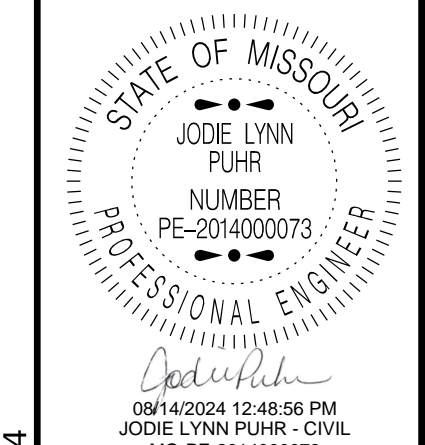

DATE PREPARED  
8/14/2024

ROUTE STATE  
291/29 MO

DISTRICT SHEET NO.  
KC 12

COUNTY  
JACKSON

JOB NO.  
J4P3485

CONTRACT ID.

PROJECT NO.

BRIDGE NO.

SEE TC SHEET 10 OF 14

DATE	DESCRIPTION

MISSOURI HIGHWAYS AND TRANSPORTATION  
COMMISSION

105 WEST CAPITOL  
JEFFERSON CITY, MO 65102  
1-888-ASK-MODOT (1-888-275-6636)

RIGHT LANE CLOSED  
TEMPORARY  
TRAFFIC CONTROL  
SHEET 9 OF 14

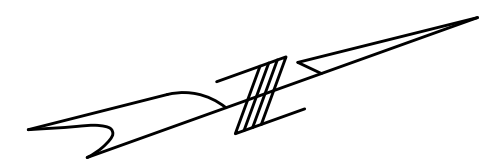

■ ■ ■ ■ ■ ■ ■ ■  
CHANNELIZERS

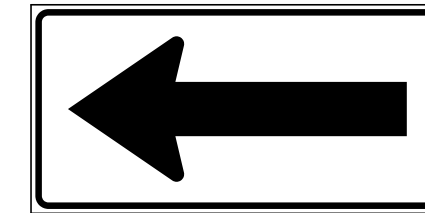

WO1-6  
7

2208'  
CHANNELIZERS @ 80' SPACING

660'

RP TO LEVEE RD

50'

80'

LEVEE RD

I-29 SB

I-29 NB

RP LEVEE RD TO I-29 NB

MACON ST

LEVEE RD

SEE TC SHEET 11 OF 14

SEE TC SHEET 9 OF 14

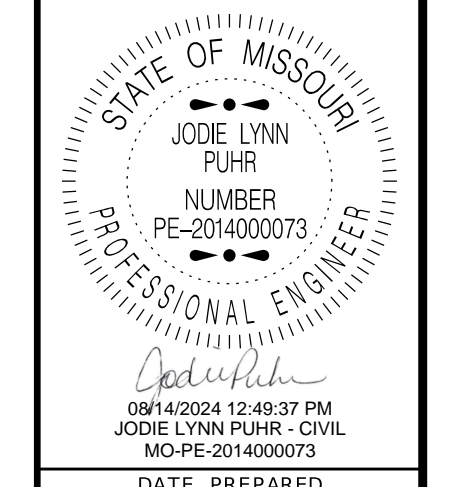

DATE PREPARED  
8/14/2024  
ROUTE 291/29 STATE MO  
DISTRICT KC SHEET NO. 13  
COUNTY JACKSON  
JOB NO. J4P3485  
CONTRACT ID.

PROJECT NO.  
BRIDGE NO.

DATE	DESCRIPTION

MISSOURI HIGHWAYS AND TRANSPORTATION COMMISSION  
MoDOT  
105 WEST CAPITOL  
JEFFERSON CITY, MO 65102  
1-888-ASK-MODOT (1-888-275-6636)

RIGHT LANE CLOSED  
TEMPORARY  
TRAFFIC CONTROL  
SHEET 10 OF 14

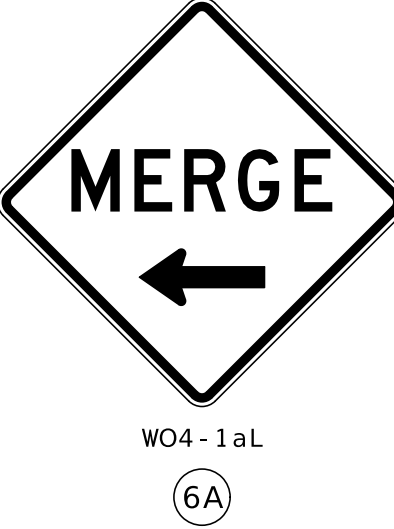
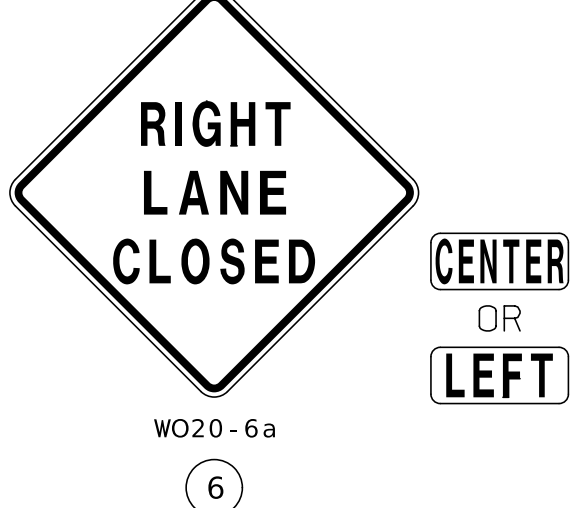
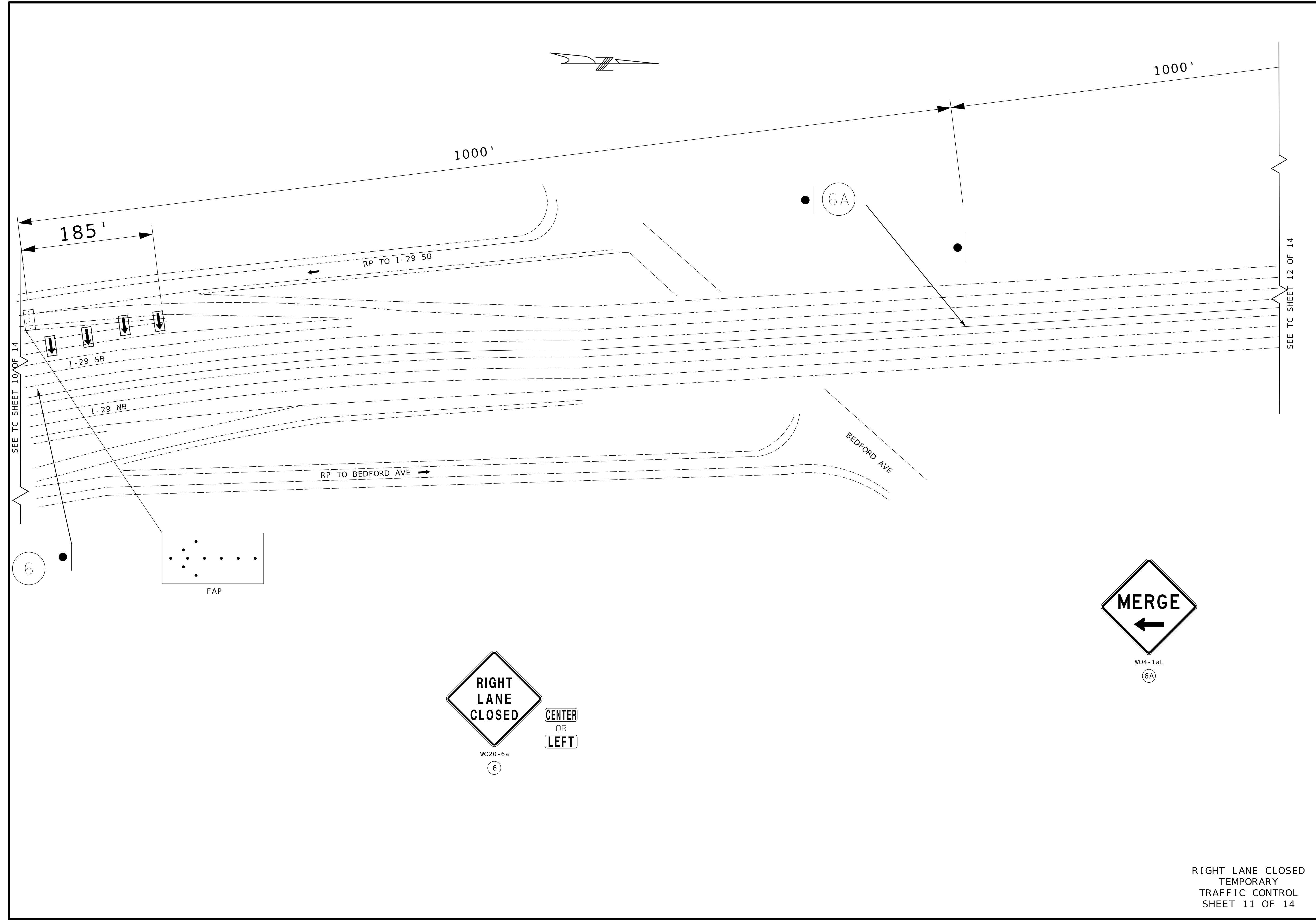

RIGHT LANE CLOSED  
TEMPORARY  
TRAFFIC CONTROL  
SHEET 11 OF 14

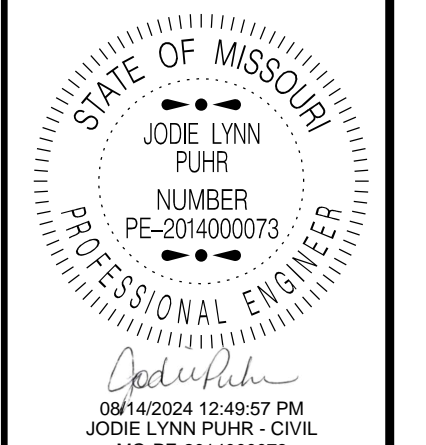

DATE PREPARED  
8/14/2024

ROUTE	STATE
291/29	MO
DISTRICT	SHEET NO.
KC	14
COUNTY	
JACKSON	
JOB NO.	
J4P3485	
CONTRACT ID.	
PROJECT NO.	
BRIDGE NO.	

DATE	DESCRIPTION

MISSOURI HIGHWAYS AND TRANSPORTATION  
COMMISSION

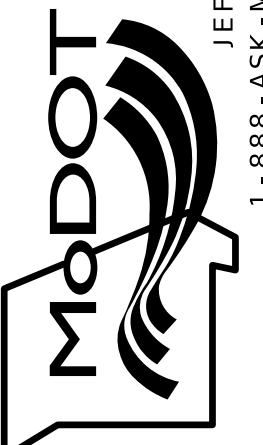

105 WEST CAPITOL  
JEFFERSON CITY, MO 65102  
1-888-ASK-MODOT (1-888-275-6636)

SEE TC SHEET 10 OF 14

SEE TC SHEET 12 OF 14

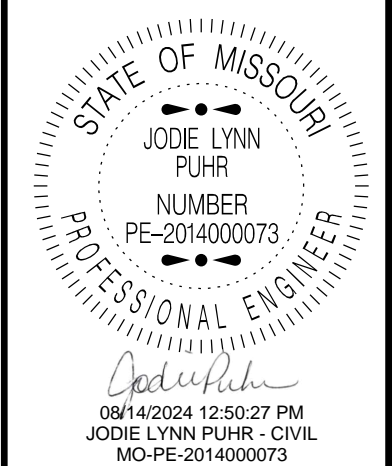

DATE PREPARED  
8/14/2024

ROUTE STATE  
291/29 MO

DISTRICT SHEET NO.  
KC 15

COUNTY  
JACKSON

JOB NO.  
J4P3485

CONTRACT ID.

PROJECT NO.

BRIDGE NO.

DATE	DESCRIPTION

MISSOURI HIGHWAYS AND TRANSPORTATION COMMISSION

105 WEST CAPITOL  
JEFFERSON CITY, MO 65102  
1-888-ASK-MODOT (1-888-275-6636)

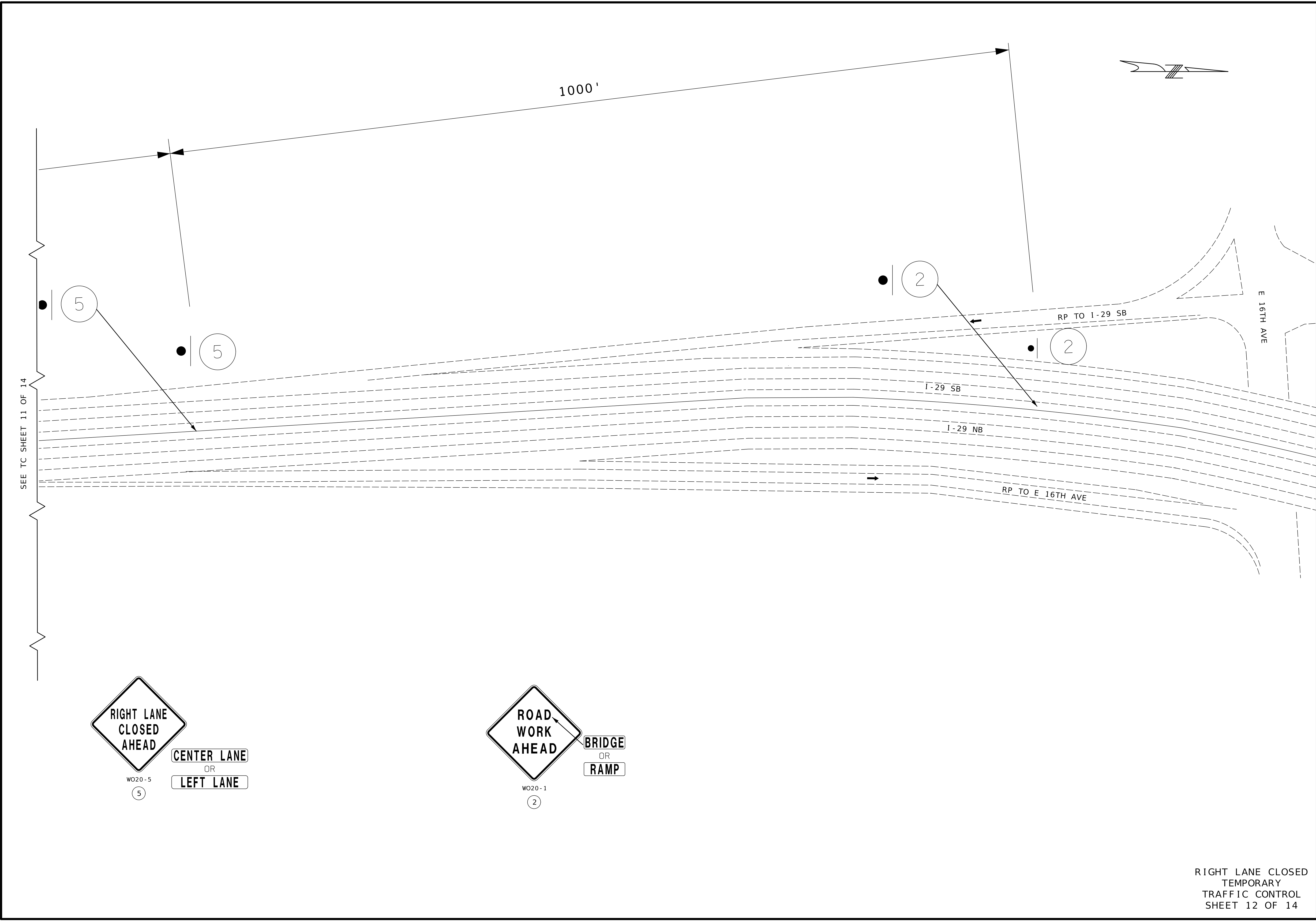

SEE TC SHEET 11 OF 14

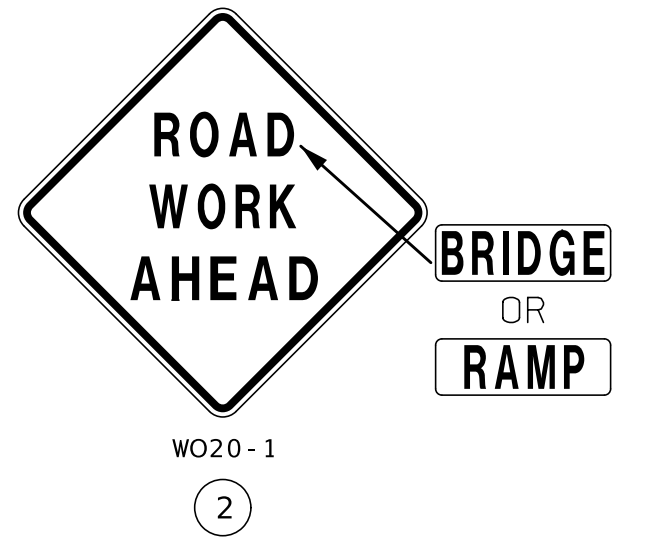
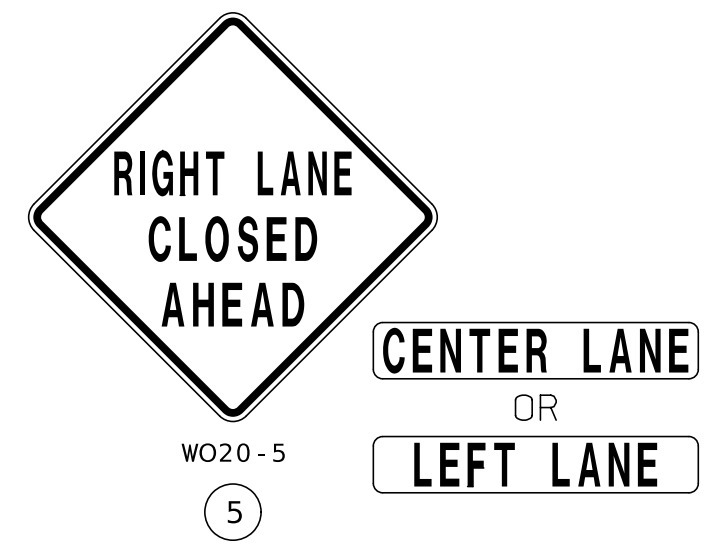

RIGHT LANE CLOSED  
TEMPORARY  
TRAFFIC CONTROL  
SHEET 12 OF 14



**ROAD  
CLOSED**

R11-2

29

BRIDGE  
OR  
RAMP

**ROAD  
CLOSED  
AHEAD**

W020-3

20

BRIDGE  
OR  
RAMP

**ROAD  
WORK  
AHEAD**

W020-1

2

BRIDGE  
OR  
RAMP



CHANNELIZERS

SEE TRAFFIC CONTROL SHEET 1 FOR WORK ZONE SPEED LIMIT GUIDELINES.  
SEE TRAFFIC CONTROL SHEET 1 FOR SIGN SPACING, DEVICE SPACING AND CHANNELIZING TAPER LENGTHS.  
REMOVE AND/OR MODIFY ANY EXISTING PAVEMENT MARKING AS NEEDED.  
TEMPORARY PAVEMENT MARKING REQUIRED WITH LONG TERM CLOSURES.

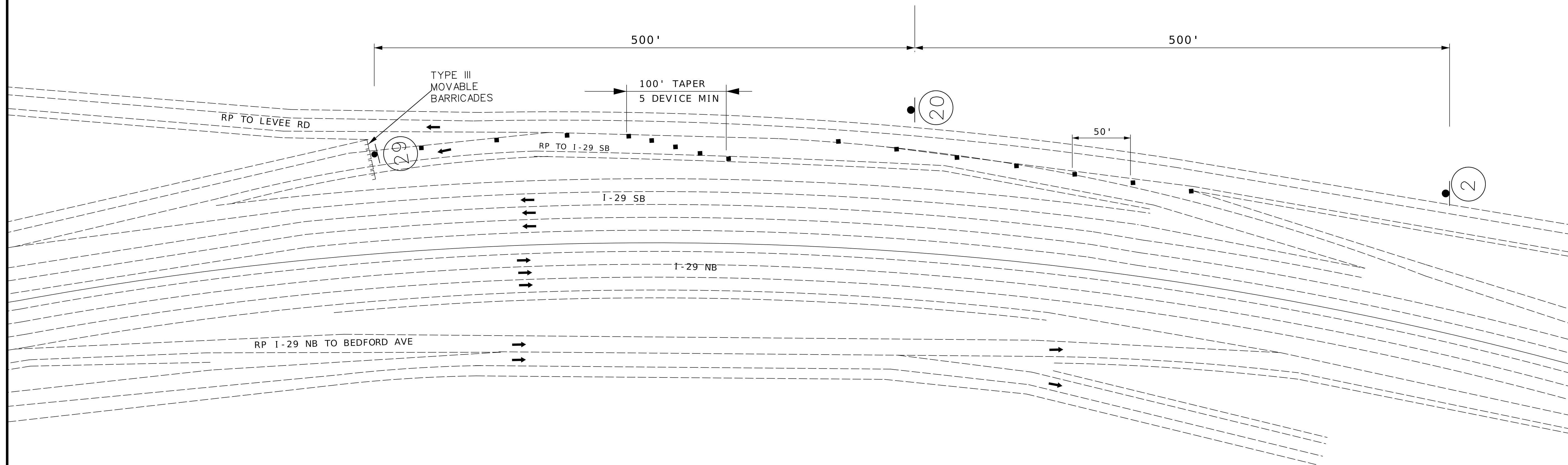

NOT TO SCALE

RAMP TO I-29 SB CLOSED  
TEMPORARY  
TRAFFIC CONTROL SHEET  
SHEET 13 OF 14

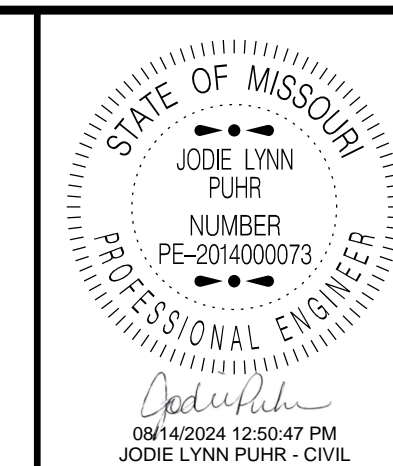

DATE PREPARED  
8/14/2024

ROUTE STATE  
291/29 MO

DISTRICT SHEET NO.  
KC 16

COUNTY  
JACKSON

JOB NO.  
J4P3485

CONTRACT ID.

PROJECT NO.

BRIDGE NO.

DATE	DESCRIPTION

MISSOURI HIGHWAYS AND TRANSPORTATION COMMISSION

105 WEST CAPITOL  
JEFFERSON CITY, MO 65102  
1-888-ASK-MODOT (1-888-275-6636)

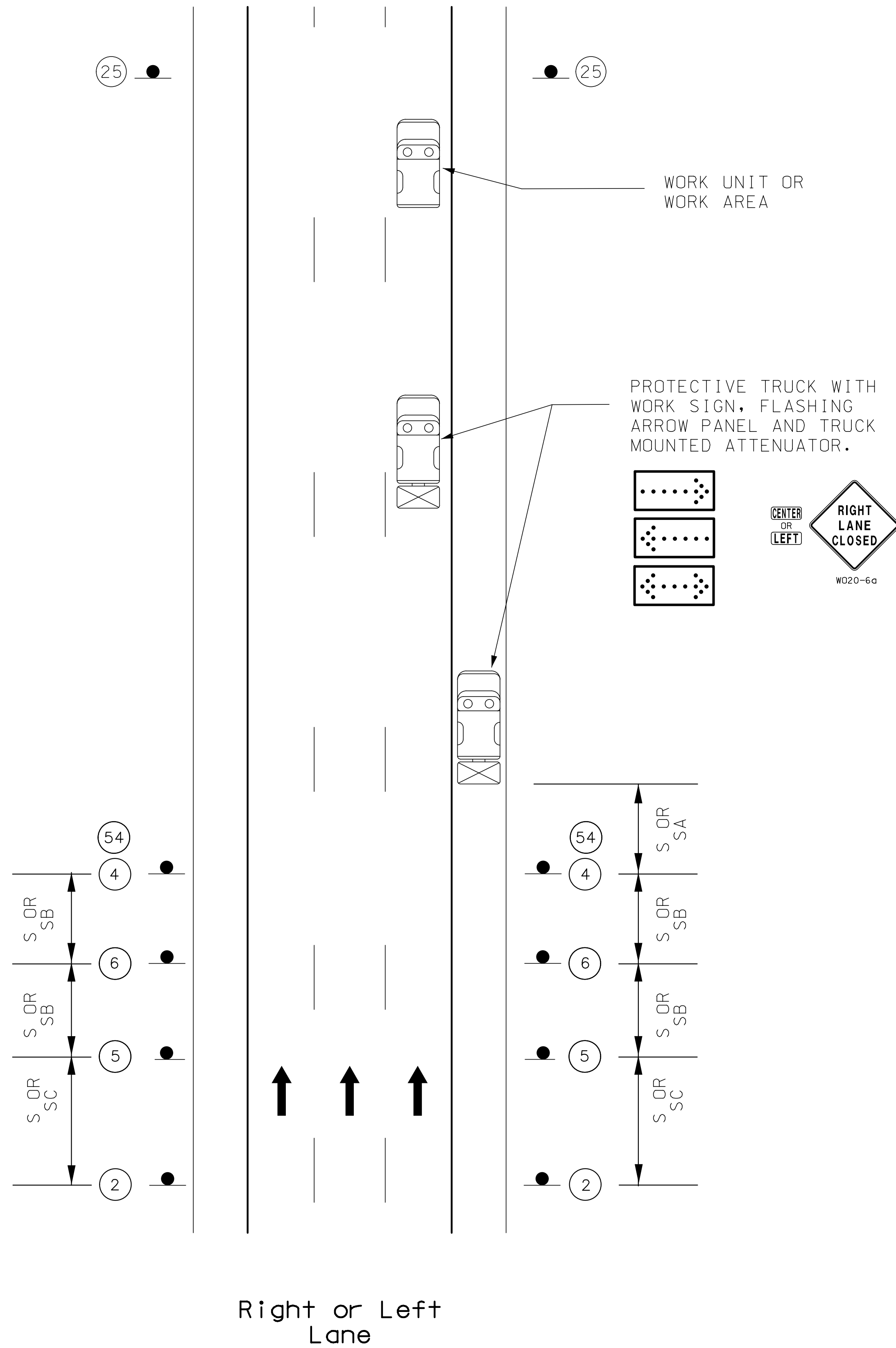

**MOVING OPERATION ON  
MULTI-LANE DIVIDED HIGHWAY  
OPEN TO TRAFFIC**

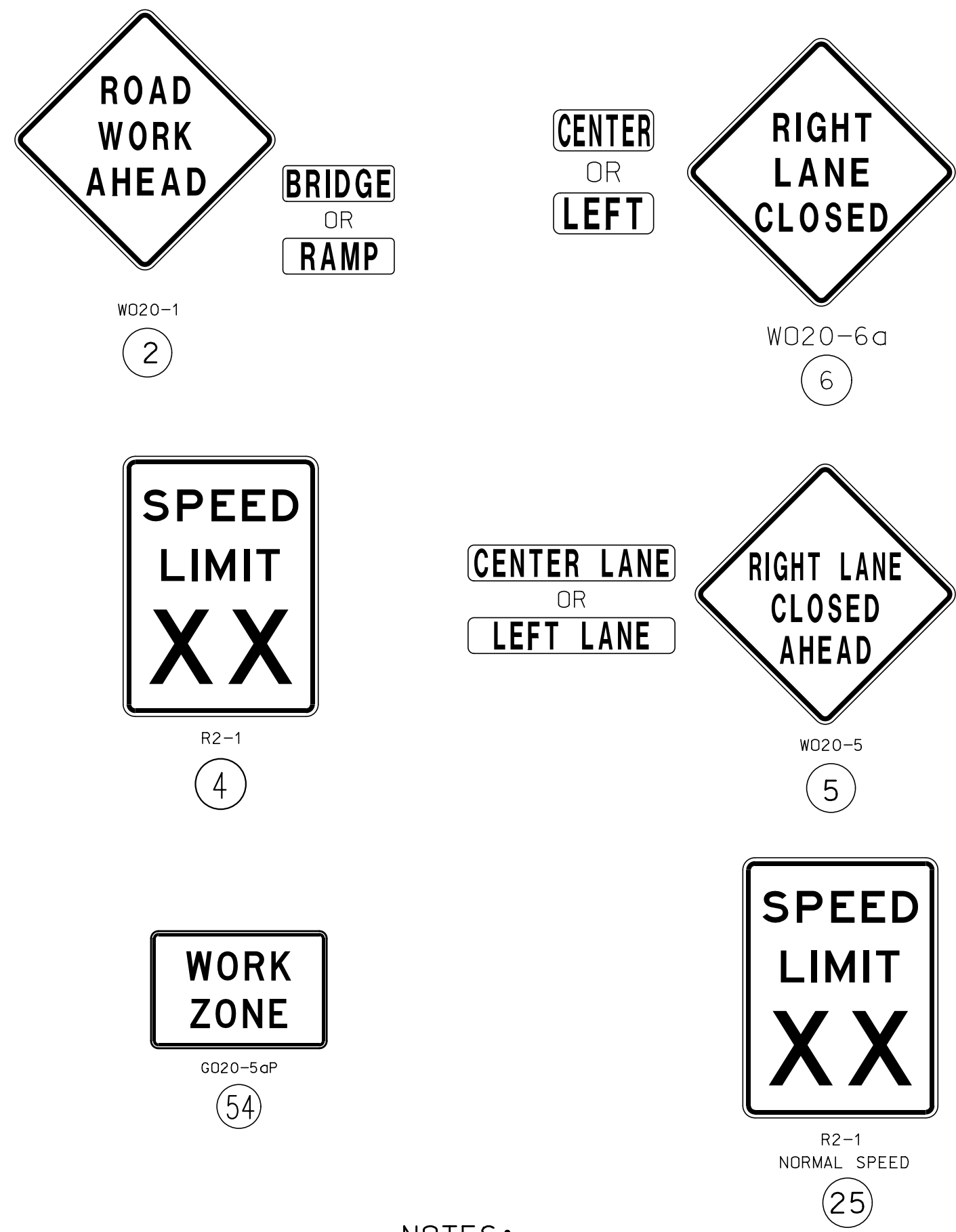

**NOTES:**

SEE TRAFFIC CONTROL SHEET 1 FOR WORK ZONE SPEED LIMIT GUIDELINES.

SEE TRAFFIC CONTROL SHEET 1 FOR SIGN SPACING, DEVICE SPACING CHANNELIZING TAPER LENGTHS.

UPON APPROVAL OF THE ENGINEER, THE CONTRACTOR MAY PROVIDE ADDITIONAL PROTECTIVE TRUCKS EQUIPPED WITH PROPER WARNING DEVICES.

PROTECTIVE TRUCK AND WORK VEHICLES SHALL DISPLAY HIGH-INTENSITY ROTATING, FLASHING, OSCILLATING OR STROBE LIGHTS.

VEHICLE HAZARD WARNING SIGNALS SHALL NOT BE USED INSTEAD OF THE VEHICLE'S HIGH -INTENSITY ROTATING FLASHING, FLASHING, OSCILLATING, OR STROBE LIGHTS.

FLASHING ARROW PANELS SHALL, AS A MINIMUM, BE TYPE B, WITH A SIZE OF 60 X 30 INCHES.

VEHICLE-MOUNTED SIGNS SHALL BE MOUNTED IN A MANNER SUCH THAT THEY ARE NOT OBSCURED BY EQUIPMENT OR SUPPLIES. SIGN LEGENDS ON VEHICLE-MOUNTED SIGNS SHALL BE COVERED OR TURNED FROM VIEW WHEN WORK IS NOT IN PROGRESS.

A FLASHING ARROW BOARD SHALL BE USED WHEN A FREEWAY LANE IS CLOSED, WHEN MORE THAN ONE LANE IS CLOSED A SEPARATE FLASHING ARROW BOARD SHALL BE USED FOR EACH CLOSED LANE.

DATE PREPARED <b>8/14/2024</b>	
ROUTE <b>29/291</b>	STATE <b>MO</b>
DISTRICT <b>KC</b>	SHEET NO. <b>17</b>
COUNTY <b>JACKSON</b>	
JOB NO. <b>J4P3485</b>	
CONTRACT ID.	
PROJECT NO.	
BRIDGE NO.	
DESCRIPTION	DATE

MISSOURI HIGHWAYS AND TRANSPORTATION  
COMMISSION

105 WEST CAPITOL  
JEFFERSON CITY, MO 65102  
1-888-ASK-MODOT (1-888-275-6636)