

**DESIGN DESIGNATION**

CAPE GIRARDEAU COUNTY RTE KK  
A.A.D.T. - 2025 = 664  
A.A.D.T. - 2045 = 824  
D.H.V. = 10.68%  
T = 16.23%  
V = 55 M.P.H.  
D = 49.7%/50.3%  
MAJOR COLLECTOR

PERRY COUNTY RTE T  
A.A.D.T. - 2025 = 2151  
A.A.D.T. - 2038 = 2801  
D.H.V. = 9.38%  
T = 11.21%  
V = 55 M.P.H.  
D = 49.5%/50.5%  
MAJOR COLLECTOR

STE. GENEVIEVE COUNTY RTE N  
A.A.D.T. - 2025 = 1665  
A.A.D.T. - 2045 = 1873  
D.H.V. = 11.05%  
T = 10.75%  
V = 55 M.P.H.  
D (N/S) = 49.5%/50.5%  
MAJOR/MINOR COLLECTOR

**NO NEW R/W REQUIRED**

**MISSOURI HIGHWAYS AND TRANSPORTATION COMMISSION  
PLANS FOR PROPOSED  
STATE HIGHWAY**

**CAPE GIRARDEAU, PERRY & STE. GENEVIEVE COUNTIES**

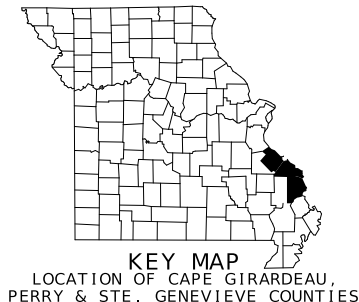
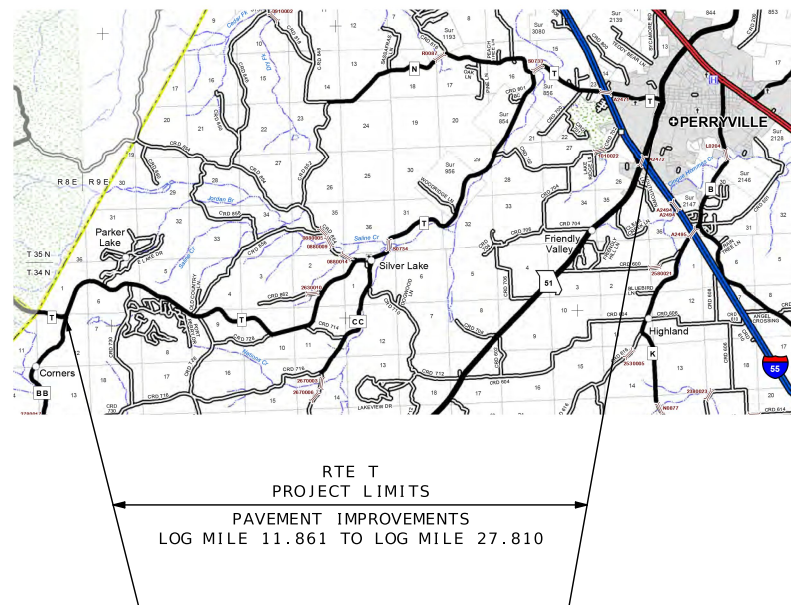
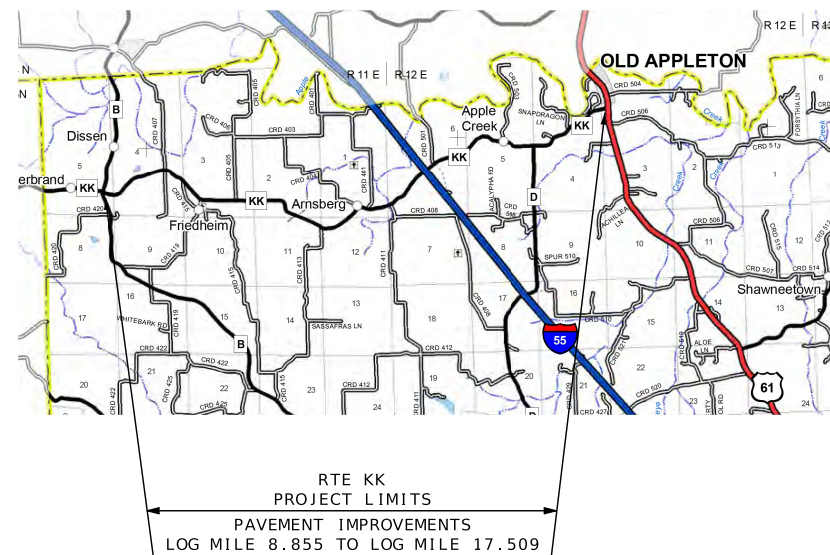
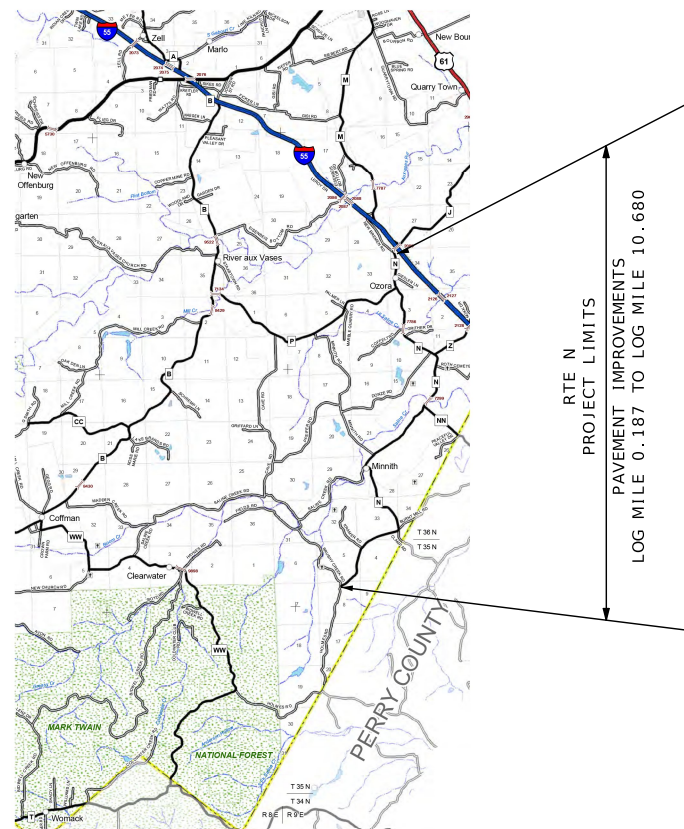

**CONVENTIONAL SYMBOLS (USED IN PLANS)**

EXISTING		NEW	
BUILDINGS AND STRUCTURES			
GUARD RAIL			
GUARD CABLE			
CONCRETE RIGHT-OF-WAY MARKER			
STEEL RIGHT-OF-WAY MARKER			
LOCATION SURVEY MARKER			
UTILITIES			
FIBER OPTICS	-FO-	-FO-	
OVERHEAD CABLE TV	-OTV-	-OTV-	
UNDERGROUND CABLE TV	-UTV-	-UTV-	
OVERHEAD TELEPHONE	-OT-	-OT-	
UNDERGROUND TELEPHONE	-UT-	-UT-	
OVERHEAD POWER	-OE-	-OE-	
UNDERGROUND POWER	-UE-	-UE-	
SANITARY SEWER	-S-	-S-	
STORM SEWER	-SS-	-SS-	
GAS	-G-	-G-	
WATER	-W-	-W-	
MANHOLE	SAN		
FIRE HYDRANT	HYD		
WATER VALVE	WV		
WATER METER	WM		
DROP INLET			
DITCH BLOCK			
GROUND MOUNTED SIGN	SIGN		
LIGHT POLE			
H-FRAME POWER POLE			
TELEPHONE PEDESTAL	PED		
FENCE			
CHAIN LINK	-V-		
WOVEN WIRE	-X-		
GATE POST			
BENCHMARK	BM		

NOTE: DASHED OR OPEN SYMBOLS INDICATE EXISTING FEATURES

THE EXISTENCE AND APPROXIMATE LOCATION OF UTILITY FACILITIES KNOWN TO EXIST, AS SHOWN ON THE PLANS, ARE BASED ON THE BEST INFORMATION AVAILABLE TO THE COMMISSION AT THIS TIME. THIS INFORMATION IS PROVIDED BY THE COMMISSION "AS-IS" AND THE COMMISSION EXPRESSLY DISCLAIMS ANY REPRESENTATION OR WARRANTY AS TO THE COMPLETENESS, ACCURACY, OR SUITABILITY OF THE INFORMATION FOR ANY USE. RELIANCE UPON THIS INFORMATION IS DONE AT THE RISK AND PERIL OF THE USER, AND THE COMMISSION SHALL NOT BE LIABLE FOR ANY DAMAGES THAT MAY ARISE FROM ANY ERROR IN THE INFORMATION. IT IS, THEREFORE, THE RESPONSIBILITY OF THE CONTRACTOR TO VERIFY THE EXISTENCE, LOCATION AND STATUS OF ANY FACILITY. SUCH VERIFICATION INCLUDES DIRECT CONTACT WITH THE LISTED UTILITIES.

**INDEX OF SHEETS**

DESCRIPTION	SHEET NUMBER
TITLE SHEET .....	1
TYPICAL SECTIONS (TS) (2 SHEETS)--	2
QUANTITIES (QU) (2 SHEETS)-----	3

**LENGTH OF PROJECT**

CAPE GIRARDEAU COUNTY ROUTE KK			
BEGINNING OF PROJECT	LOG MILE	8.855	
END OF PROJECT	LOG MILE	17.509	
APPARENT LENGTH			8.654 MILES
EQUATIONS AND EXCEPTIONS:			
BRIDGE P0893		0.022 MILES	
BRIDGE A2490		0.049 MILES	
PERRY COUNTY ROUTE T			
BEGINNING OF PROJECT	LOG MILE	11.861	
END OF PROJECT	LOG MILE	27.810	
APPARENT LENGTH			15.949 MILES
EQUATIONS AND EXCEPTIONS:			
BRIDGE S0734		0.043 MILES	
BRIDGE A7963		0.042 MILES	
BRIDGE A2471		0.051 MILES	
STE. GENEVIEVE COUNTY ROUTE N			
BEGINNING OF PROJECT	LOG MILE	0.187	
END OF PROJECT	LOG MILE	10.680	
APPARENT LENGTH			10.493 MILES
EQUATIONS AND EXCEPTIONS:			
BRIDGE P0631		0.025 MILES	
BRIDGE N0849		0.043 MILES	
TOTAL CORRECTIONS			0.275 MILES
NET LENGTH OF PROJECT			34.821 MILES
STATE LENGTH			34.821 MILES
FOR INFORMATION ONLY ESTIMATED DISTURBED ACRES			0 ACRES



DATE PREPARED  
**7/30/2024**

ROUTE STATE  
**VAR MO**

DISTRICT SHEET NO.  
**SE 1**

COUNTY  
**VARIOUS**

JOB NO.  
**JSE0047**

CONTRACT ID.

PROJECT NO.

BRIDGE NO.

DESCRIPTION	DATE

MISSOURI HIGHWAYS AND TRANSPORTATION COMMISSION

**MoDOT**

105 WEST CAPITOL  
JEFFERSON CITY, MO 65102  
1-888-ASK-MODOT (1-888-275-6636)









DATE PREPARED  
7/30/2024

ROUTE STATE  
VAR MO  
DISTRICT SHEET NO.  
SE 3

COUNTY  
VARIOUS  
JOB NO.  
JSE0047  
CONTRACT ID.

PROJECT NO.

BRIDGE NO.

Table with 2 columns: DATE, DESCRIPTION

Table with 2 columns: DATE, DESCRIPTION

Table with 2 columns: DATE, DESCRIPTION

Table with 2 columns: DATE, DESCRIPTION

Table with 2 columns: DATE, DESCRIPTION

Table with 2 columns: DATE, DESCRIPTION

Table with 2 columns: DATE, DESCRIPTION

Table with 2 columns: DATE, DESCRIPTION

Table with 2 columns: DATE, DESCRIPTION

Table with 2 columns: DATE, DESCRIPTION

Table with 2 columns: DATE, DESCRIPTION

Table with 2 columns: DATE, DESCRIPTION

Table with 2 columns: DATE, DESCRIPTION

Table with 2 columns: DATE, DESCRIPTION

Table with 2 columns: DATE, DESCRIPTION

Table with 2 columns: DATE, DESCRIPTION

Table with 2 columns: DATE, DESCRIPTION

Table with 2 columns: DATE, DESCRIPTION

Main table with columns: SIGN, SIZE, AREA, QTY, TOTAL AREA, QTY RELOC, TOTAL RELOC, SIGN NUM., DESCRIPTION

Main table with columns: SIGN, SIZE, AREA, QTY, TOTAL AREA, QTY RELOC, TOTAL RELOC, SIGN NUM., DESCRIPTION

Table with columns: ITEM NUMBER, TOTAL QTY, DESCRIPTION

SEE STANDARD 616.20 FOR TEMPORARY TRAFFIC CONTROL FOR TWO-LANE ROADWAYS

\* FRESH OIL/LOOSE GRAVEL SIGN -SHALL BE PLACED AT THE BEGINNING OF THE PROJECT. -SHALL BE INSTALLED IN LEIU OF "UNEVEN LANES" SIGN PER STANDARD PLAN 616.20B(AFTER STATE ROUTE INTERSECTIONS AND AT 1-MILE INTERVALS).

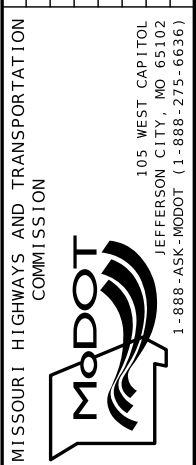

MISSOURI HIGHWAYS AND TRANSPORTATION COMMISSION  
105 WEST CAPITOL JEFFERSON CITY, MO 65102  
1-888-ASK-MODOT (1-888-275-6636)