

DESIGN DESIGNATION
A.A.D.T. - 2024 = 1323
V = 55 M.P.H.

MISSOURI HIGHWAYS AND TRANSPORTATION COMMISSION
PLANS FOR PROPOSED
STATE HIGHWAY
COOPER AND MONITEAU COUNTY

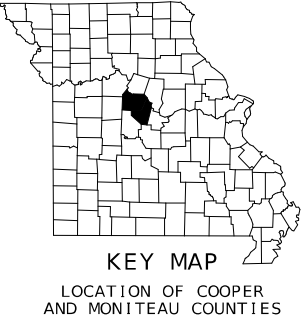
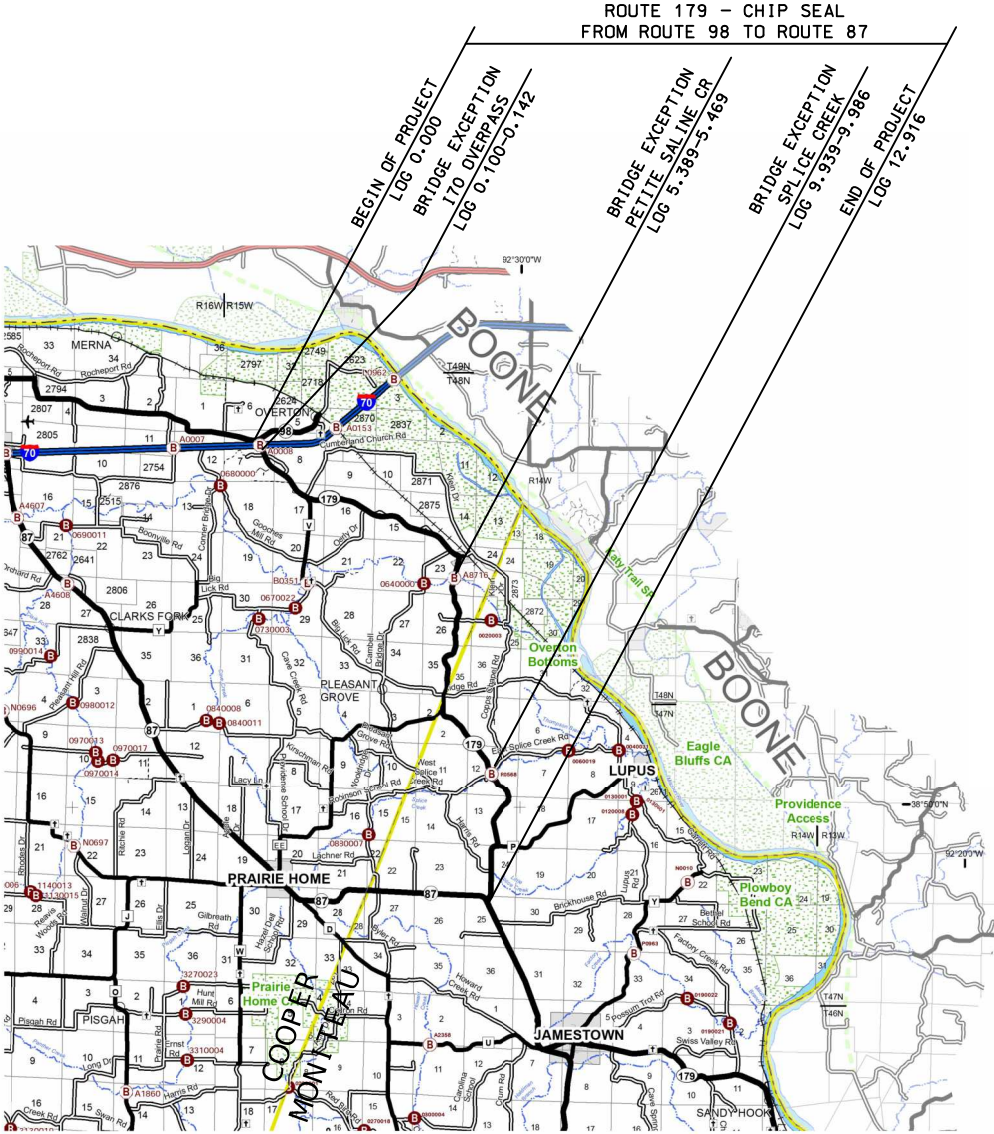

NOT TO SCALE

INDEX OF SHEETS

DESCRIPTION	SHEET NUMBER
TITLE SHEET -----	1
TYPICAL SECTIONS (TS) (1 SHEET)----	2
QUANTITIES (QU) (1 SHEET)-----	3
TRAFFIC CONTROL SHEETS (TC)-----	4-8

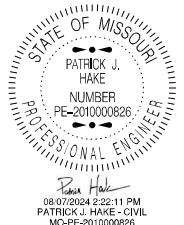

DATE PREPARED
8/7/2024
ROUTE 179 STATE MO
DISTRICT CD SHEET NO. 1
COUNTY COOPER/MONITEAU
JOB NO. JCD0051
CONTRACT ID.

PROJECT NO.
BRIDGE NO.

DESCRIPTION	DATE

LENGTH OF PROJECT

BEGINNING OF PROJECT	LOG MILE	0.000
END OF PROJECT	LOG MILE	12.916

APPARENT LENGTH 68196.48 FEET

EXCEPTIONS:

BRIDGE-A0008 (OVER I-70)	
LOG MILE	0.100-0.142 220 FEET
BRIDGE-A8716 (OVER PETITE SALINE CR.)	
LOG MILE	5.389-5.469 425 FEET
BRIDGE-R0568 (OVER SPLICE CR.)	
LOG MILE	9.939-9.986 250 FEET

TOTAL CORRECTIONS	895 FEET
NET LENGTH OF PROJECT	67301.48 FEET
STATE LENGTH	12.746 MILES

FOR INFORMATION ONLY
ESTIMATED DISTURBED ACRES 0 ACRES

MISSOURI HIGHWAYS AND TRANSPORTATION COMMISSION

105 WEST CAPITOL
JEFFERSON CITY, MO 65102
1-888-ASK-MODOT (1-888-275-6636)



DATE PREPARED
8/7/2024

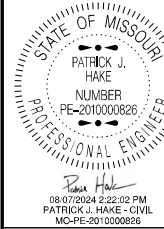

DATE PREPARED
8/7/2024

ROUTE
179

STATE
MO

DISTRICT
CD

SHEET NO.
2

COUNTY
COOPER/MONITEAU

JOB NO.
JCD0051

CONTRACT ID.

PROJECT NO.

BRIDGE NO.

DESCRIPTION

DATE

DATE

DATE

DATE

DATE

DATE

DATE

DATE

DATE

DATE

DATE

DATE

DATE

DATE

DATE

DATE

DATE

DATE

DATE

DATE

DATE

DATE

DATE

DATE

DATE

DATE

DATE

DATE

DATE

DATE

DATE

DATE

DATE

DATE

DATE

DATE

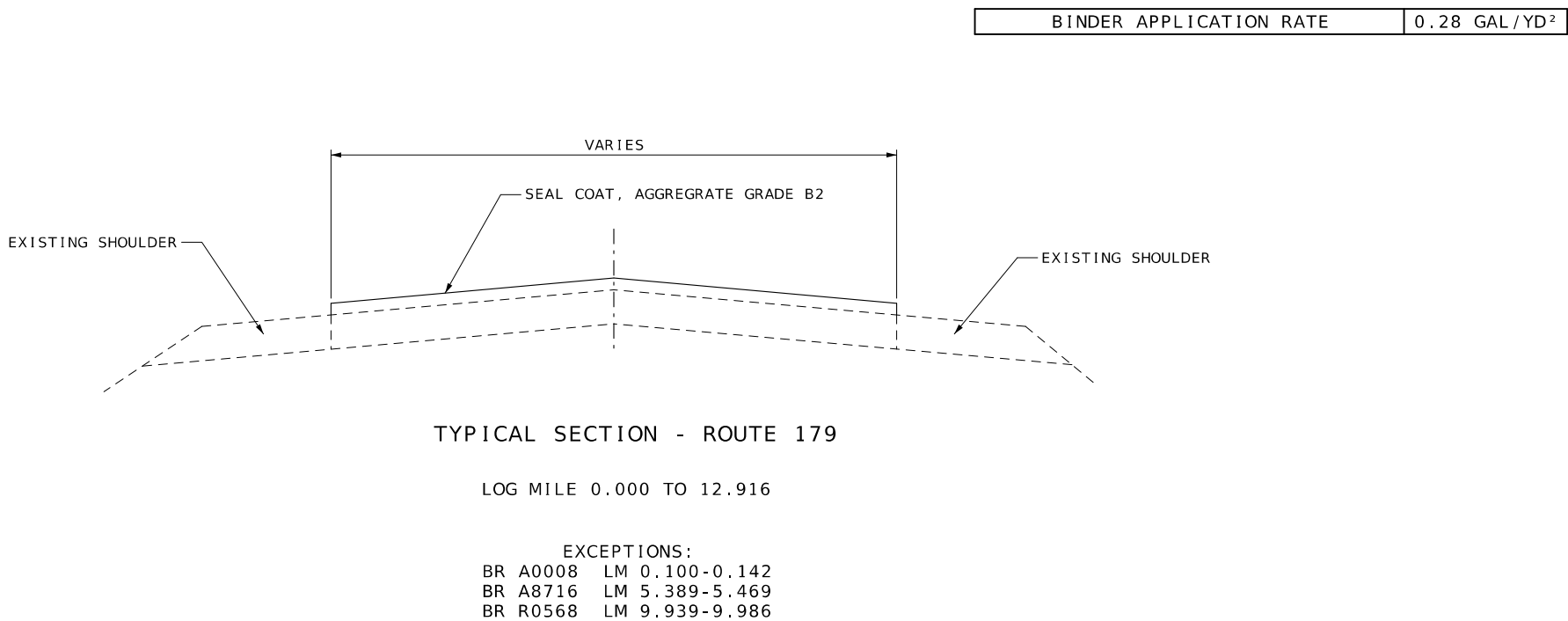

BITUMINOUS PAVEMENT SEAL COAT, GRADE B2									
LOG MI	LOG MI	LOCATION	LENGTH MI	LENGTH FT	AVG WIDTH FT	AREA SF	SEAL COAT B2 SY	EMULS. ASPHALT GAL (0.28 GAL/SY)	REMARKS
0.000	0.018	RTE 179 - COOPER COUNTY	0.018	95.04	VAR	4204.00	467.11	130.79	
0.018	0.061	RTE 179 - COOPER COUNTY	0.043	227.04	22.5	5108.40	567.60	158.93	
0.061	0.100	RTE 179 - COOPER COUNTY	0.039	205.92	22.5	4633.20	514.80	144.14	
0.100	0.142	RTE 179 - COOPER COUNTY	0.042	220.00					BRIDGE EXCEPTION - I70 OVERPASS
0.142	0.174	RTE 179 - COOPER COUNTY	0.032	168.96	22.5	3801.60	422.40	118.27	
0.174	0.750	RTE 179 - COOPER COUNTY	0.576	3041.28	21.5	65387.52	7265.28	2034.28	
0.750	1.660	RTE 179 - COOPER COUNTY	0.910	4804.80	22	105705.60	11745.07	3288.62	
1.660	4.994	RTE 179 - COOPER COUNTY	3.334	17603.52	21.5	378475.68	42052.85	11774.80	
4.994	5.014	RTE 179 - COOPER COUNTY	0.020	105.60	VAR	4668.17	518.69	145.23	WOOLDRIDGE INTERSECTION
5.014	5.389	RTE 179 - COOPER COUNTY	0.375	1980.00	21.5	42570.00	4730.00	1324.40	
5.389	5.469	RTE 179 - COOPER COUNTY	0.080	425.00					BRIDGE EXCEPTION - PETITE SALINE CR
5.469	8.028	RTE 179 - COOPER COUNTY	2.559	13511.52	21.5	290497.68	32277.52	9037.71	
8.028	9.939	RTE 179 - MONITEAU COUNTY	1.911	10090.08	21.5	216936.72	24104.08	6749.14	
9.939	9.986	RTE 179 - MONITEAU COUNTY	0.047	250.00					BRIDGE EXCEPTION - SPLICE CR
9.986	10.725	RTE 179 - MONITEAU COUNTY	0.739	3901.92	22.5	87793.20	9754.80	2731.34	
10.725	11.676	RTE 179 - MONITEAU COUNTY	0.951	5021.28	21.5	107957.52	11995.28	3358.68	
11.676	11.718	RTE 179 - MONITEAU COUNTY	0.042	221.76	VAR	10239.68	1137.74	318.57	INTERSECTION AT ROUTE P
11.718	12.892	RTE 179 - MONITEAU COUNTY	1.174	6198.72	21.5	133272.48	14808.05	4146.25	
12.892	12.916	RTE 179 - MONITEAU COUNTY	0.024	126.72	VAR	5811.00	645.67	180.79	
TOTALS							163006.94	45641.94	
USE							163007	45642	

MOBILIZATION
1 LUMP SUM

STATE OF MISSOURI
PATRICK J. HAKE
NUMBER
PE-2010000826
PROFESSIONAL ENGINEER
08/07/2024 2:23:00 PM
PATRICK J. HAKE - CIVIL
MO-PE-2010000826

DATE PREPARED
8/7/2024

ROUTE 179	STATE MO
DISTRICT CD	SHEET NO. 3

COUNTY
COOPER / MONITEAU

JOB NO.
JCD0051

CONTRACT ID.

PROJECT NO.

BRIDGE NO.[illegible]

MISSOURI HIGHWAYS AND TRANSPORTATION
COMMISSION

105 WEST CAPITOL
JEFFERSON CITY, MO 65102
1-888-ASK-MODOT (1-888-275-6636)

PAVEMENT MARKING						
LOG MI	LOG MI	LOCATION	LENGTH FT	WATERBORNE PAVEMENT MARKING PAINT, TYPE P BEADS		REMARKS
				4 IN. WHITE LF	4 IN. YELLOW LF	
0.000	8.047	ROUTE 179	42488.16	84976.32	84976.32	
8.047	12.916	ROUTE 179	25708.32	51416.64	51416.64	
			TOTAL	136392.96	136392.96	
			USE	136393	136393	

NOTE: ALL PAVEMENT MARKING TO MATCH EXISTING UNLESS OTHERWISE SHOWN IN THE PLANS. LOCATE BEFORE RESURFACING.

TEMPORARY TRAFFIC CONTROL						
SIGN	SIZE IN.	AREA SQ.FT.	QTY EACH	TOTAL AREA SQ.FT.	SIGN NUM.	DESCRIPTION
CONSTRUCTION SIGNS						
GO20-1	60X24	10.00	2	20	1	ROAD WORK NEXT X MILES 2@12
WO20-1	48X48	16.00	17	272	2	ROAD WORK AHEAD
WO20-4	48X48	16.00	6	96	7	ONE LANE ROAD AHEAD
WO20-7a	48X48	16.00	17	272	8	FLAGGER (SYMBOL, WITH FLAGS)
WO3-4	48X48	16.00	13	208	11	BE PREPARED TO STOP
GO20-2	48X24	8.00	2	16	26	END ROAD WORK
WO8-12	48X48	16.00	15	240	35	NO CENTER LINE
GO20-4	36X18	4.50	1	4.5	53	PILOT CAR FOLLOW ME
WO8-7a	36X36	9.00	30	270	57	FRESH OIL LOOSE GRAVEL
GO20-4a	42X30	8.75	13	113.75	58	PILOT CAR IN USE WAIT & FOLLOW
CONST-8	48X36	12.00	2	24	59	WORK ZONE NO PHONE ZONE
GO20-4a	18X12	1.50	27	40.5	60	PILOT CAR IN USE WAIT & FOLLOW
GO22-1	21X15	2.19	4	8.76		WET PAINT (ARROW PIVOTS)
CONSTRUCTION SIGNS TOTAL				1585.51		
ADDITIONAL TRAFFIC CONTROL ITEMS						
		616-1025	270	CHANNELIZERS (TRIM-LINE)		
		619-1098A	2 *	CHANGEABLE MESSAGE SIGN WITHOUT COMMUNICATION INTERFACE		
CONTRACTOR FURNISHED, CONTRACTOR RETAINED						
TEMPORARY TRAFFIC CONTROL TOTAL				1 LUMP SUM		

* NOT INCLUDED IN LUMP SUM TRAFFIC CONTROL

NOTE: ALL TRAFFIC CONTROL ITEMS ARE INCLUDED IN PAY ITEM 616-99.01, LUMP SUM TEMPORARY TRAFFIC CONTROL, UNLESS OTHERWISE NOTED IN THE PLANS. THE QUANTITIES SHOWN ARE ONLY AN ESTIMATE AND ARE SUBJECT TO CHANGE BASED UPON FIELD CONDITIONS AND CONTRACTOR'S OPERATIONS.

NO DIRECT PAY WILL BE MADE FOR RELOCATION OF CONSTRUCTION SIGNS OR DEVICES.

SUMMARY OF QUANTITIES
SHEET 1 OF 1

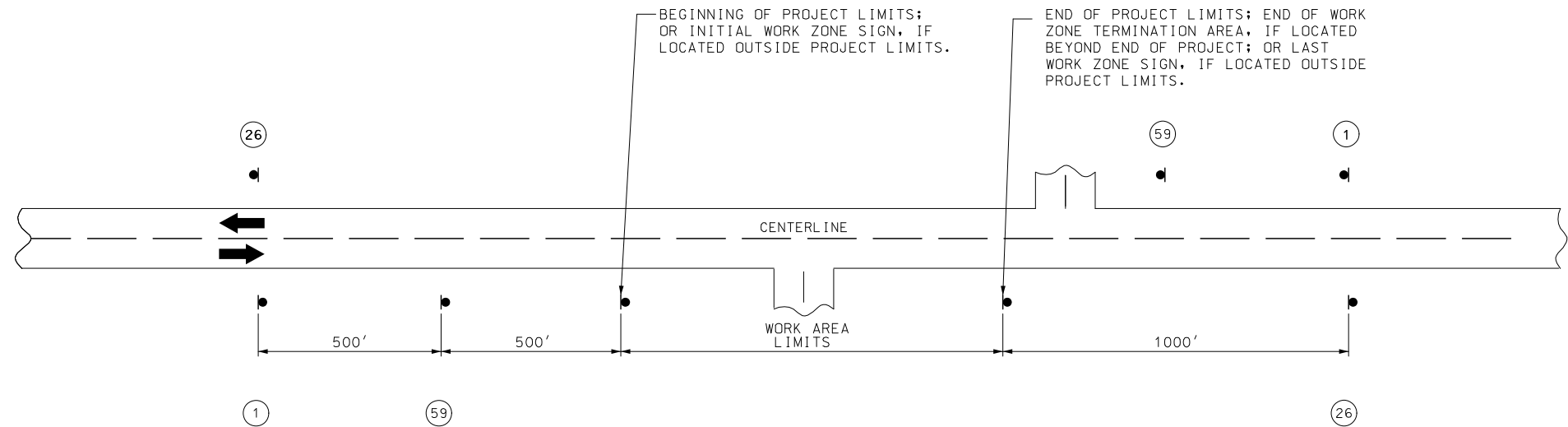

NOTES:

SIGN (1) AND (26) ARE ONLY USED ON PROJECT LENGTHS 2 MILES OR GREATER.

PROVIDE SIGNS IN EACH DIRECTION ON TWO-WAY HIGHWAY.

DISTANCE MAY BE ADJUSTED ACCORDING TO FIELD CONDITIONS.

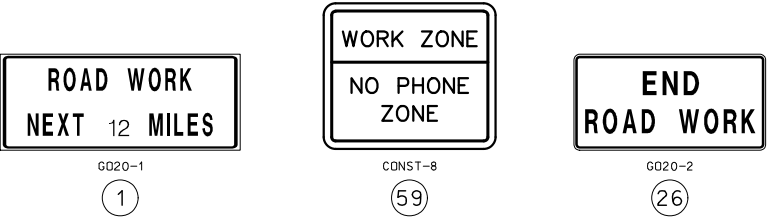

STATE OF MISSOURI
PATRICK J. HAKE
NUMBER
PE-2010000826
PROFESSIONAL ENGINEER

08/07/2024 2:22:56 PM
PATRICK J. HAKE - CIVIL
MO-PE-2010000826

DATE PREPARED
8/7/2024

ROUTE
179

STATE
MO

DISTRICT
CD

SHEET NO.
4

COUNTY
COOPER/MONITEAU

JOB NO.
JCD0051

CONTRACT ID.

PROJECT NO.

BRIDGE NO.

DESCRIPTION	DATE

MISSOURI HIGHWAYS AND TRANSPORTATION
COMMISSION

105 WEST CAPITOL
JEFFERSON CITY, MO 65102
1-888-ASK-MODOT (1-888-275-6636)

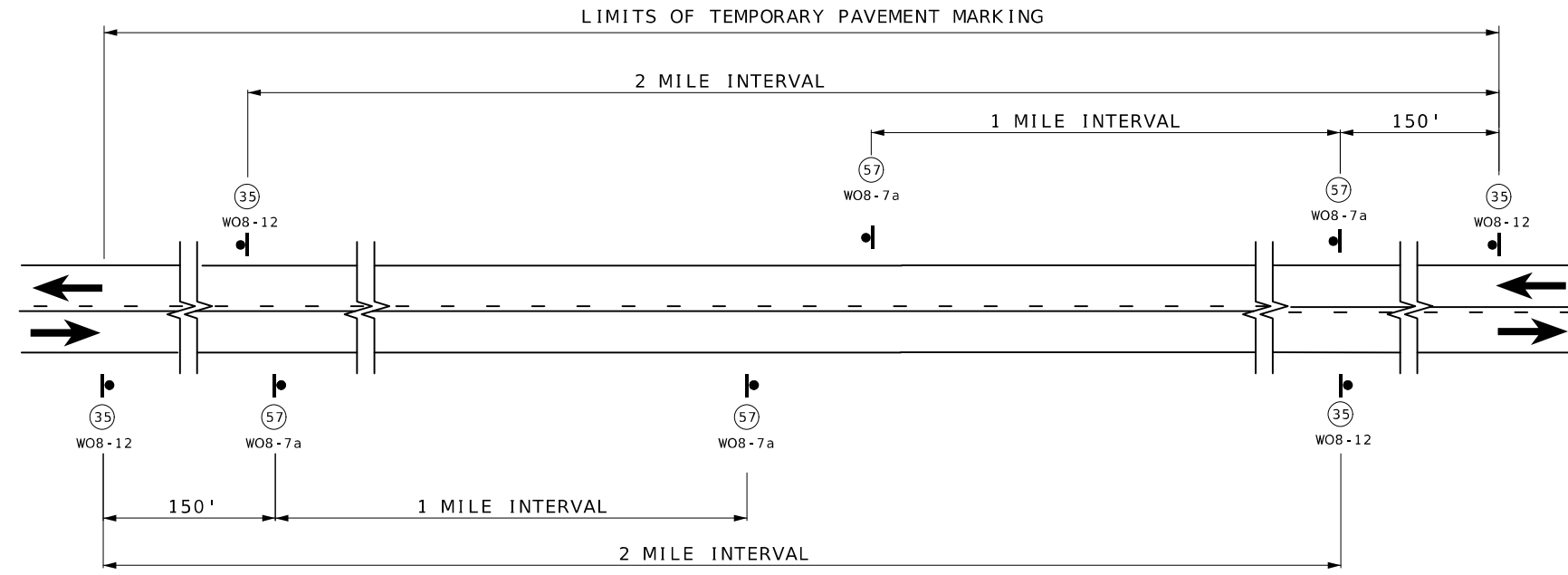

SIGN SPACING AND TEMPORARY STRIPING FOR MAINLINE

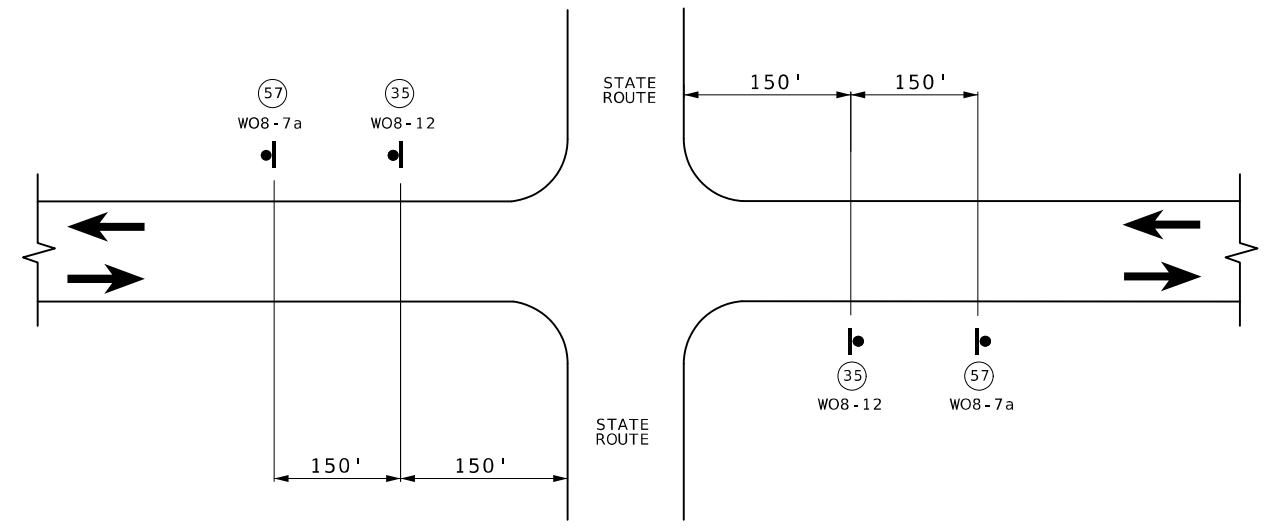

SIGN SPACING AT STATE ROUTE INTERSECTIONS
SHOWING TEMPORARY STRIPING FOR MAINLINE



NOTES:

SIGN (35) AND TEMPORARY RAISED PAVEMENT MARKING (SEE STANDARD PLAN 620.10) INSTALLED WHERE CENTERLINE STRIPING HAS BEEN COVERED OR REMOVED. SIGNS ARE TO REMAIN IN PLACE UNTIL THE PERMANENT CENTERLINE PAVEMENT MARKINGS ARE IN PLACE. SIGNS SHALL BE COVERED OR REMOVED WHEN PAVEMENT CENTERLINE MARKING HAS BEEN INSTALLED.

SIGN (35) IS PLACED AT APPROXIMATELY TWO-MILE INTERVALS AND AT STATE ROUTE JUNCTIONS. WHEN THE INSTALLATION AT A JUNCTION IS WITHIN ONE-EIGHTH MILE OF THE NORMAL MAINLINE SIGN (35), THE LATTER MAY BE ELIMINATED.

ALL SIGNS SHALL BE POST MOUNTED AND IN ACCORDANCE WITH STANDARD PLAN 616.10 AND 903.03.

STATE OF MISSOURI

PATRICK J. HAKE

NUMBER

PE-2010000826

PROFESSIONAL ENGINEER

DATE PREPARED

8/7/2024

ROUTE

179

STATE

MO

DISTRICT

CD

SHEET NO.

7

COUNTY

COOPER/MONITEAU

JOB NO.

JCD0051

CONTRACT ID.

PROJECT NO.

BRIDGE NO.

DESCRIPTION



DATE

MISSOURI HIGHWAYS AND TRANSPORTATION COMMISSION

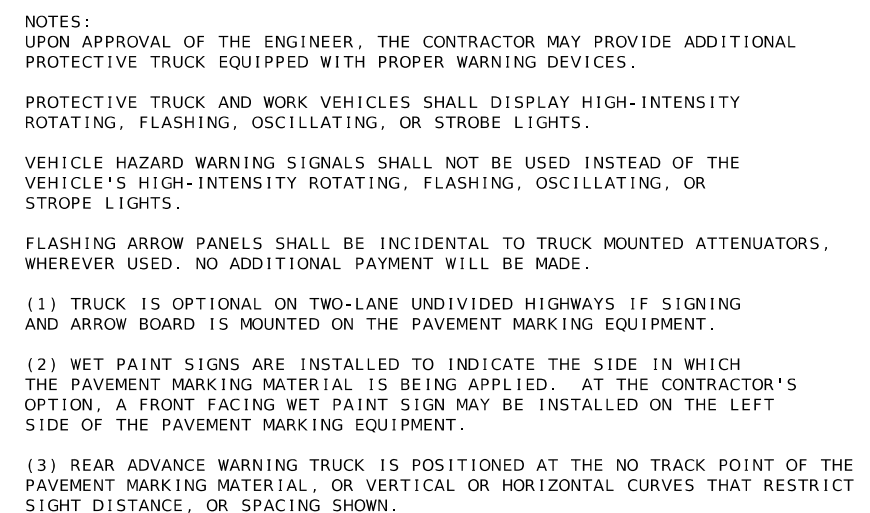
105 WEST CAPITOL
JEFFERSON CITY, MO 65102
1-888-ASK-MODOT (1-888-275-6636)



TRAFFIC CONTROL
SHEET 5 OF 5

MISSOURI HIGHWAYS AND TRANSPORTATION COMMISSION					
					
105 WEST CAPITOL JEFFERSON CITY, MO 65102 1-888-ASK-MODOT (1-888-275-6636)					
DATE		DESCRIPTION			
<div><div><div>STATE OF MISSOURI</div><div>PATRICK J. HAKE</div><div>NUMBER</div><div>PE-2010000826</div><div></div><div>Ronan Hale</div><div>0807/03/24 2:22:24 PM</div><div>PATRICK J. HAKE - CIVIL</div><div>MO-PE-2010000826</div></div><div>DATE PREPARED</div><div>8/7/2024</div></div> <div><div>ROUTE</div><div>179</div><div>DISTRICT</div><div>CD</div></div> <div><div>STATE</div><div>MO</div><div>SHEET NO.</div><div>8</div></div> <div>COUNTY</div> <div>COOPER / MONI TEAU</div> <div>JOB NO.</div> <div>JCD0051</div> <div>CONTRACT ID.</div> <div></div> <div>PROJECT NO.</div> <div></div> <div>BRIDGE NO.</div> <div></div>					

A.A.D.T. - 2024 = 1076
V = 55 M.P.H.

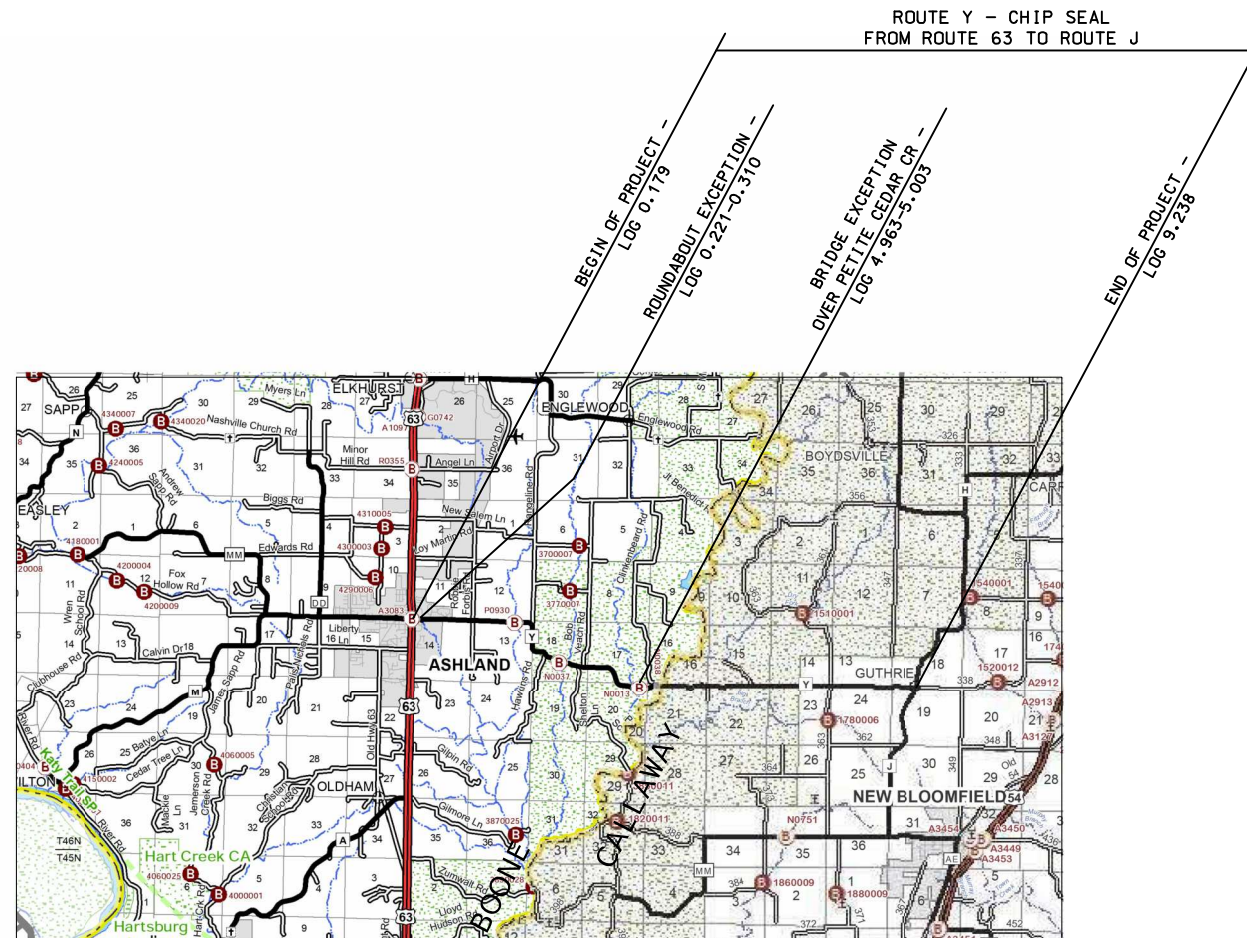

KEY MAP 
LOCATION OF BOONE AND CALLAWAY COUNTY

DESCRIPTION	NUMBER
TITLE SHEET -----	1
TYPICAL SECTIONS (TS) (1 SHEET)----	2
QUANTITIES (QU) (1 SHEET)-----	3
TRAFFIC CONTROL SHEETS (TC)-----	4-8



08/07/2024 2:26:59 PM
PATRICK J. HAKE - CIVIL
MO-PE-2010000826

DATE PREPARED
8/7/2024

ROUTE Y	STATE MO
------------	-------------

DISTRICT CD	SHEET NO. 1
----------------	----------------

COUNTY
BOONE / CALLAWAY

JOB NO.
JCD0068

CONTRACT ID.

PROJECT NO.

PROJECT NO.:

BRIDGE NO.

[illegible]TRANSPORTATION
105 WEST CAPITOL
N CITY, MO 65102
(1-888-275-6636)

MISSOURI HIGHWAYS AND TRANSPORTATION COMMISSION
JEFFERSON
1-888-ASK-MODOT

BEGINNING OF PROJECT	LOG MILE	0.179
END OF PROJECT	LOG MILE	9.238

APPARENT LENGTH	47831.52	FEET
-----------------	----------	------

EXCEPTIONS:

ROUNDAABOUT
LOG MILE 0.221-0.310 470 FEET

BRIDGE-N0038 (OVER CEDAR CR.)
LOG MILE 4.963-5.003 211 FEET

TOTAL CORRECTIONS	681 FEET
-------------------	----------

NET LENGTH OF PROJECT	47150.52	FEET
-----------------------	----------	------

STATE LENGTH	8.930 MILES
--------------	-------------

FOR INFORMATION ONLY	
ESTIMATED DISTURBED ACRES	0 ACRES

MISSOURI HIGHWAYS AND TRANSPORTATION
COMMISSION

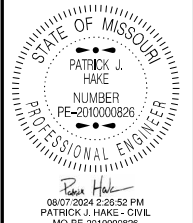
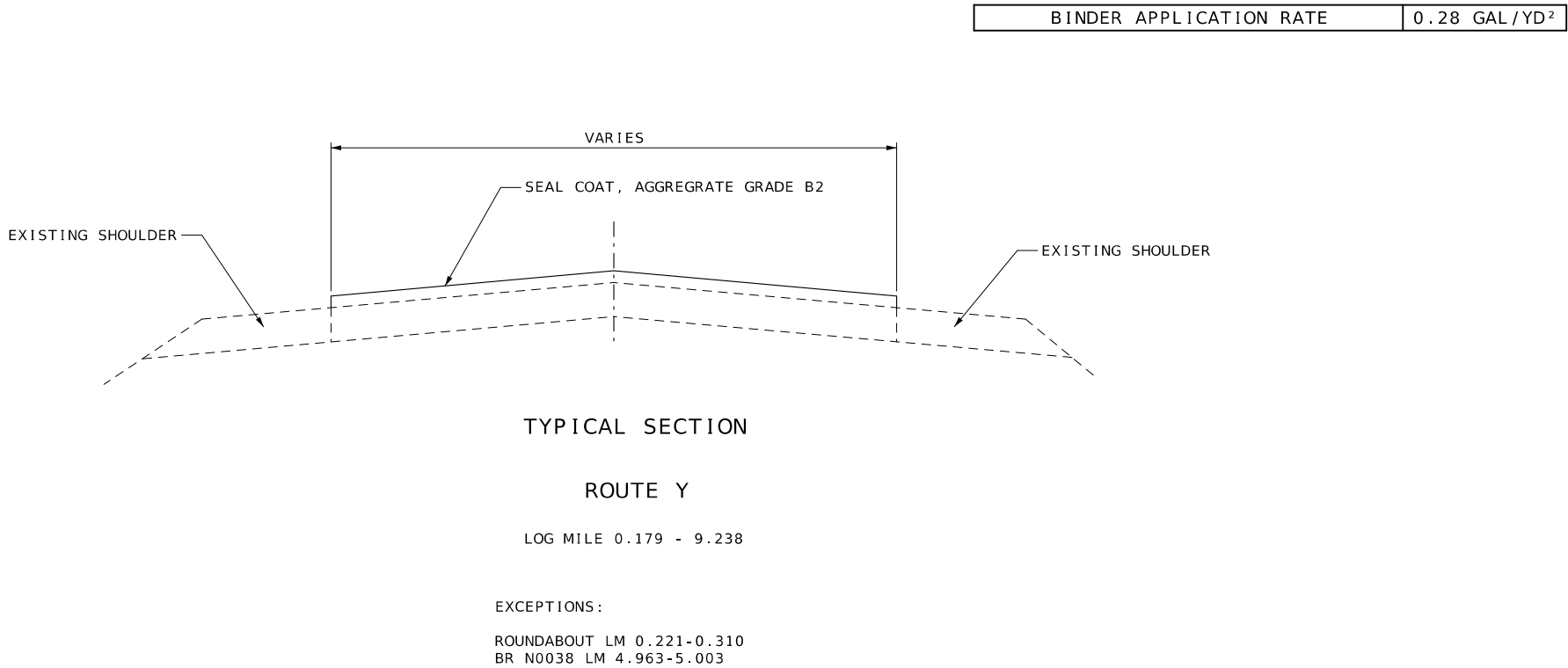

DATE PREPARED 8/7/2024	
ROUTE Y	STATE MO
DISTRICT CD	SHEET NO. 2
COUNTY BOONE / CALLAWAY	
JOB NO. JCD0068	
CONTRACT ID.	
PROJECT NO.	
BRIDGE NO.	

DESCRIPTION	DATE

MISSOURI HIGHWAYS AND TRANSPORTATION COMMISSION



105 WEST CAPITOL
JEFFERSON CITY, MO 65102
1-888-ASK-MODOT (1-888-275-6636)

26

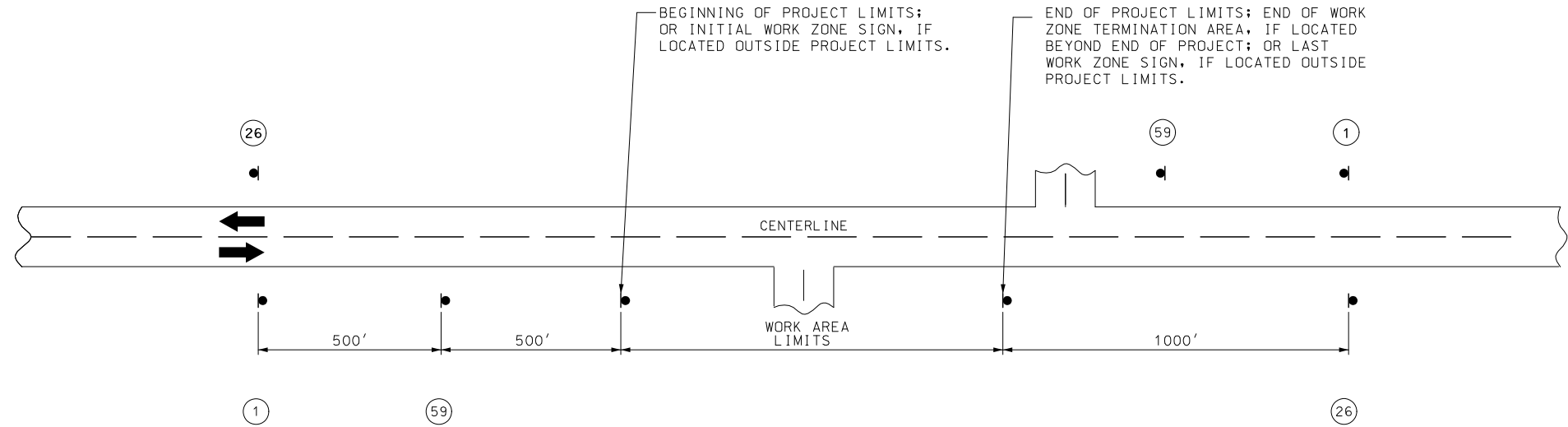

NOTES:

SIGN (1) AND (26) ARE ONLY USED ON PROJECT LENGTHS 2 MILES OR GREATER.

PROVIDE SIGNS IN EACH DIRECTION ON TWO-WAY HIGHWAY.

DISTANCE MAY BE ADJUSTED ACCORDING TO FIELD CONDITIONS.

ROAD WORK
NEXT 9 MILES

G020-1
(1)

WORK ZONE
NO PHONE
ZONE

CONST-8
(59)

END
ROAD WORK

G020-2
(26)

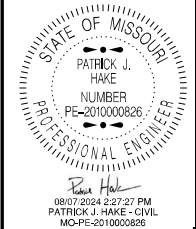

DATE PREPARED
8/7/2024

ROUTE Y STATE MO
DISTRICT CD SHEET NO. 4

COUNTY
BOONE / CALLAWAY

JOB NO.
JCD0068

CONTRACT ID.

PROJECT NO.

BRIDGE NO.

DESCRIPTION	DATE

MISSOURI HIGHWAYS AND TRANSPORTATION
COMMISSION

105 WEST CAPITOL
JEFFERSON CITY, MO 65102
1-888-ASK-MODOT (1-888-275-6636)

MoDOT

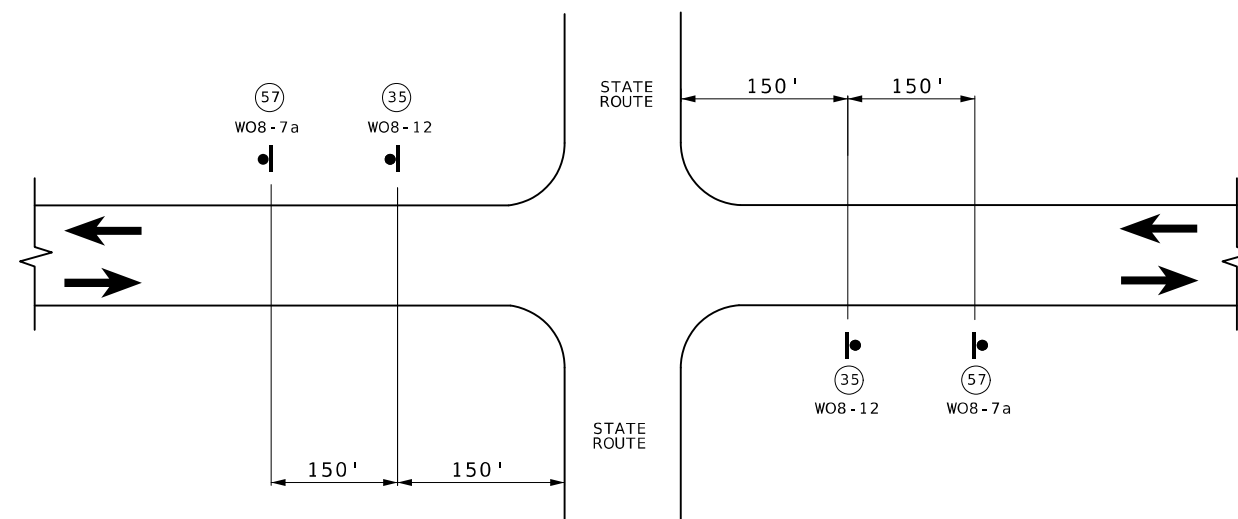
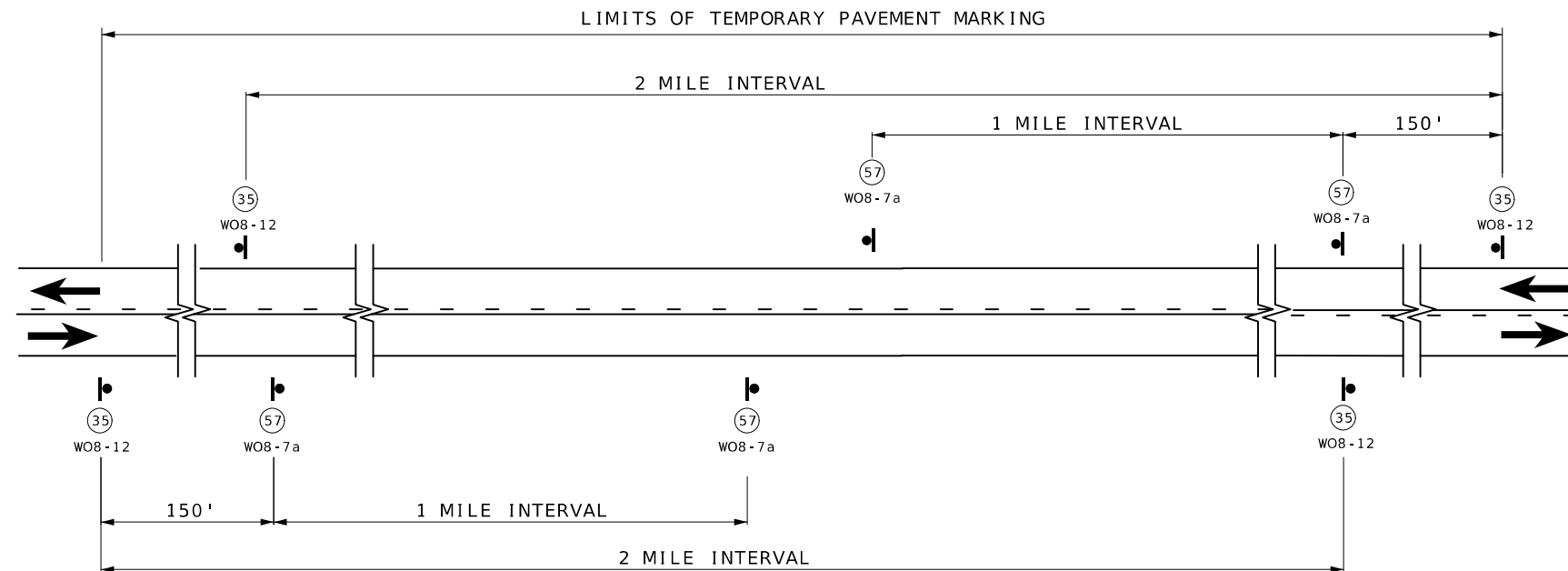

NOTES:

SIGN (35) AND TEMPORARY RAISED PAVEMENT MARKING (SEE STANDARD PLAN 620.10) INSTALLED WHERE CENTERLINE STRIPING HAS BEEN COVERED OR REMOVED. SIGNS ARE TO REMAIN IN PLACE UNTIL THE PERMANENT CENTERLINE PAVEMENT MARKINGS ARE IN PLACE. SIGNS SHALL BE COVERED OR REMOVED WHEN PAVEMENT CENTERLINE MARKING HAS BEEN INSTALLED.

SIGN (35) IS PLACED AT APPROXIMATELY TWO-MILE INTERVALS AND AT STATE ROUTE JUNCTIONS. WHEN THE INSTALLATION AT A JUNCTION IS WITHIN ONE-EIGHTH MILE OF THE NORMAL MAINLINE SIGN (35), THE LATTER MAY BE ELIMINATED.

ALL SIGNS SHALL BE POST MOUNTED AND IN ACCORDANCE WITH
STANDARD PLAN 616.10 AND 903.03.

NOT TO SCALE

TRAFFIC CONTROL
SHEET 4 OF 5



08/07/2024 2:27:17 PM
PATRICK J. HAKE - CIVIL
MO-PE-2010000826
DATE PREPARED

8/7/2024

ROUTE	STATE
V	MO

Y	MO
DISTRICT	SHEET NO.

CD 7

COUNTY

BOONE / CALLAWAY
LOB NO

JCD0068

CONTRACT ID.

		PROJECT NO.	
		BRIDGE NO.	
DATE		DESCRIPTION	

MISSOURI HIGHWAYS AND TRANSPORTATION
COMMISSION

103 WEST CAPITOL
JEFFERSON CITY, MO 65102
1-888-ASK-MODOT (1-888-275-6636)

