

TYPICAL SECTION
 RTE 61
 LOG MILE 331.052 TO LOG MILE 331.181

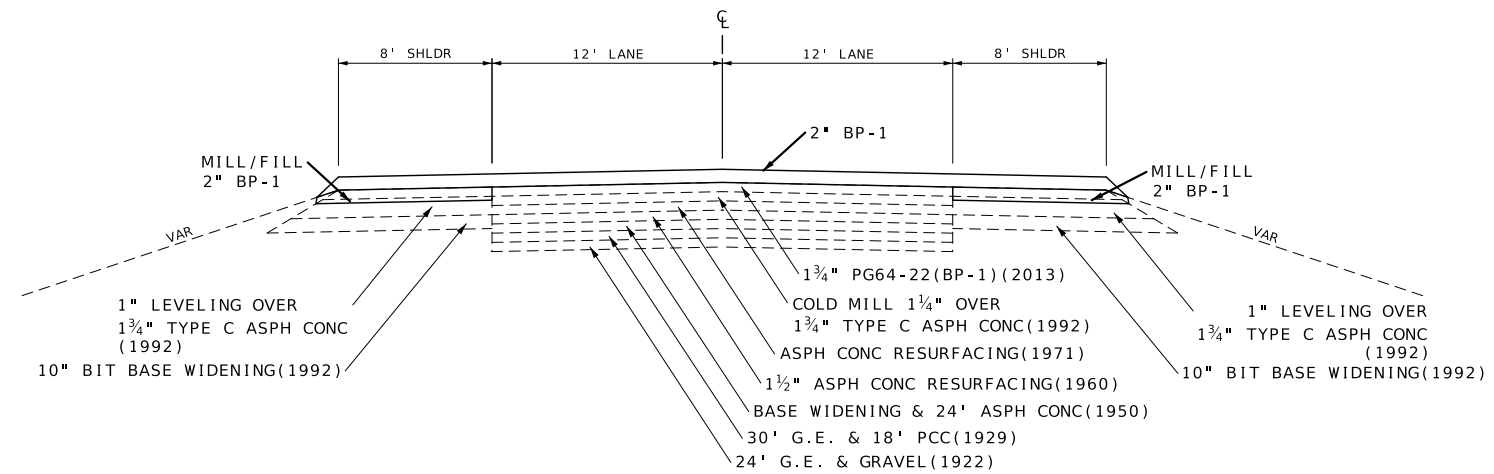

TYPICAL SECTION
 RTE 61
 LOG MILE 334.845 TO LOG MILE 336.120



Donna Rene Philpot
 MISSOURI REGISTERED PROFESSIONAL ENGINEER
 LICENSE NUMBER: PE-2019000205
 EXPIRES: 12/31/2024

DATE PREPARED
 8/1/2024

ROUTE 61 STATE MO
 DISTRICT SE SHEET NO. 2

COUNTY
 NEW MADRID
 JOB NO.
 J9S3516
 CONTRACT ID.

PROJECT NO.
 BRIDGE NO.

DATE	DESCRIPTION

MISSOURI HIGHWAYS AND TRANSPORTATION COMMISSION

105 WEST CAPITOL
 JEFFERSON CITY, MO 65102
 1-888-ASK-MODOT (1-888-275-6636)

TYPICAL SECTION
 SHEET 2 OF 5

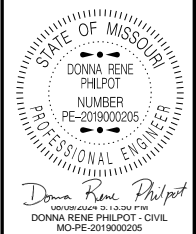

DATE PREPARED
8/1/2024

ROUTE 61 STATE MO

DISTRICT SE SHEET NO. 2

COUNTY
NEW MADRID

JOB NO.
19S3516

CONTRACT ID.

PROJECT NO.

BRIDGE NO.

** ASPHALT CURB
LT
LOG MILE 339.524 - LOG MILE 339.579
LOG MILE 345.079 - LOG MILE 345.200
LOG MILE 345.444 - LOG MILE 345.490

RT
LOG MILE 339.816 - LOG MILE 339.918
LOG MILE 345.079 - LOG MILE 345.212
LOG MILE 345.444 - LOG MILE 345.490

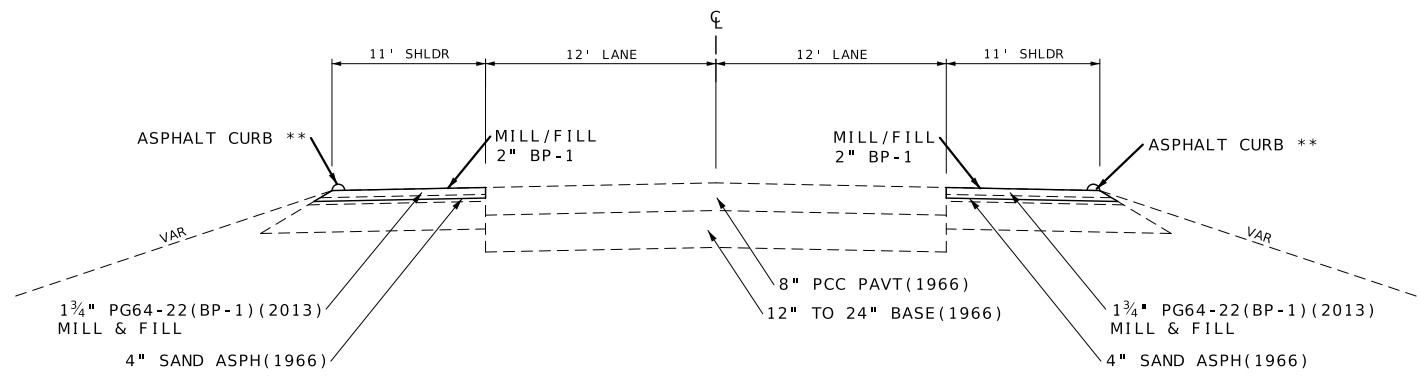

TYPICAL SECTION
RTE 61

LOG MILE 339.410 TO LOG MILE 339.579
LOG MILE 339.816 TO LOG MILE 340.246
LOG MILE 345.012 TO LOG MILE 345.212
LOG MILE 345.444 TO LOG MILE 345.573

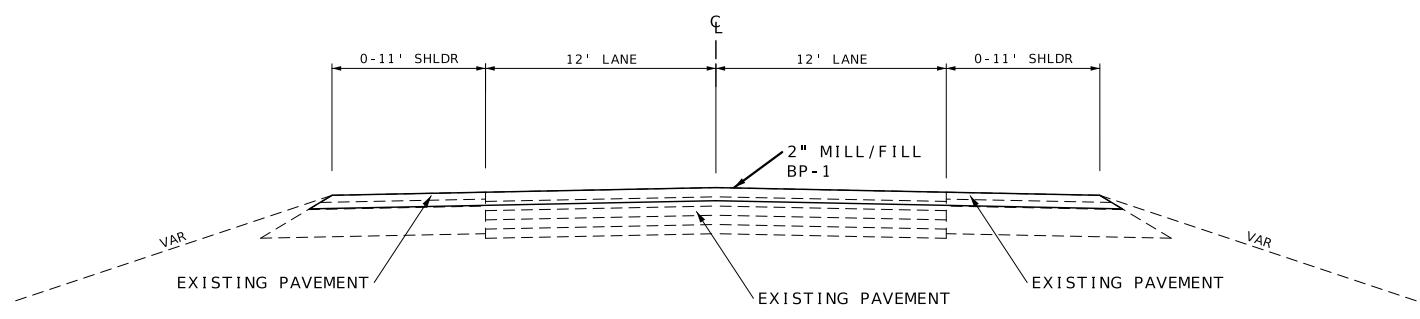

TYPICAL SECTION
RTE 61

LOG MILE 339.579 TO LOG MILE 339.671
LOG MILE 339.723 TO LOG MILE 339.816
LOG MILE 345.212 TO LOG MILE 345.295
LOG MILE 345.346 TO LOG MILE 345.444

DATE	DESCRIPTION

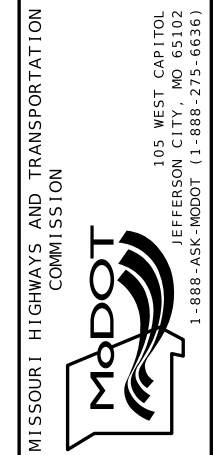

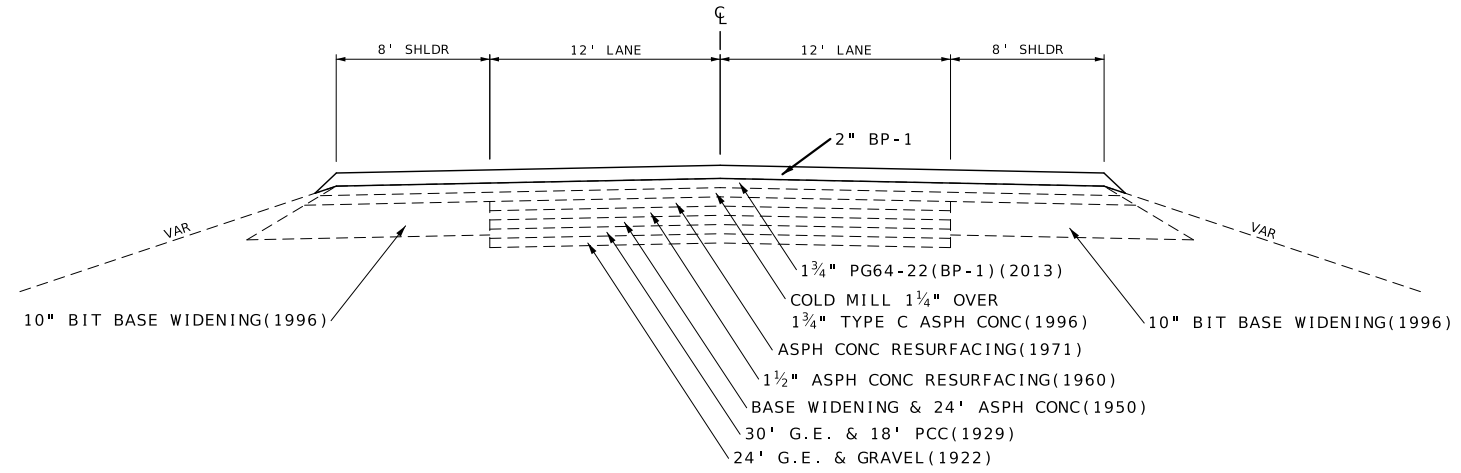

TYPICAL SECTION
 RTE 61
 LOG MILE 340.246 TO LOG MILE 342.278
 LOG MILE 343.984 TO LOG MILE 345.012

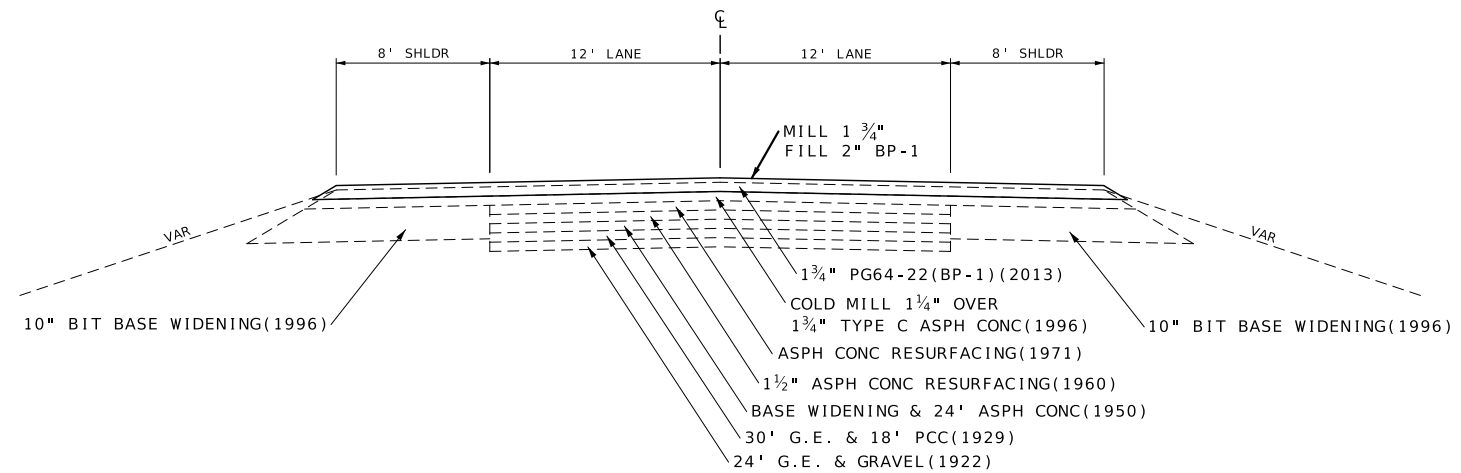

TYPICAL SECTION
 RTE 61
 LOG MILE 342.278 TO LOG MILE 343.037
 LOG MILE 343.168 TO LOG MILE 343.984

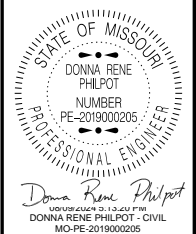

DATE PREPARED
 8/1/2024
 ROUTE 61 STATE MO
 DISTRICT SE SHEET NO. 2
 COUNTY NEW MADRID
 JOB NO. J9S3516
 CONTRACT ID.
 PROJECT NO.
 BRIDGE NO.

DATE	DESCRIPTION

MISSOURI HIGHWAYS AND TRANSPORTATION COMMISSION

 105 WEST CAPITOL
 JEFFERSON CITY, MO 65102
 1-888-ASK-MODOT (1-888-275-6636)

TYPICAL SECTION
 SHEET 4 OF 5

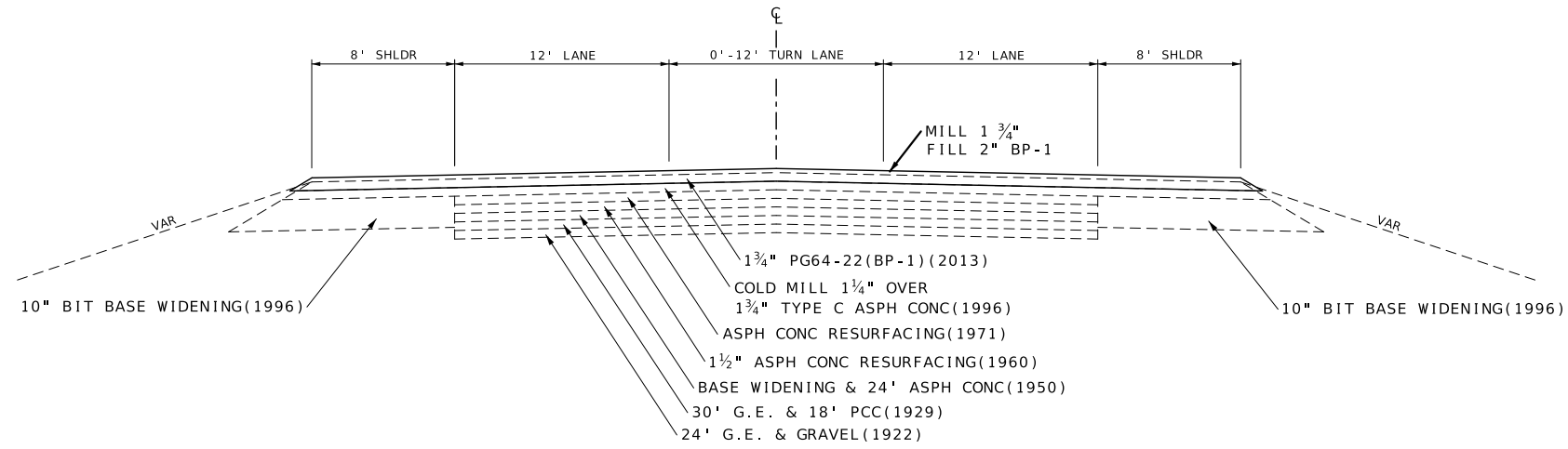

TYPICAL SECTION
RTE 61
LOG MILE 343.037 TO LOG MILE 343.168

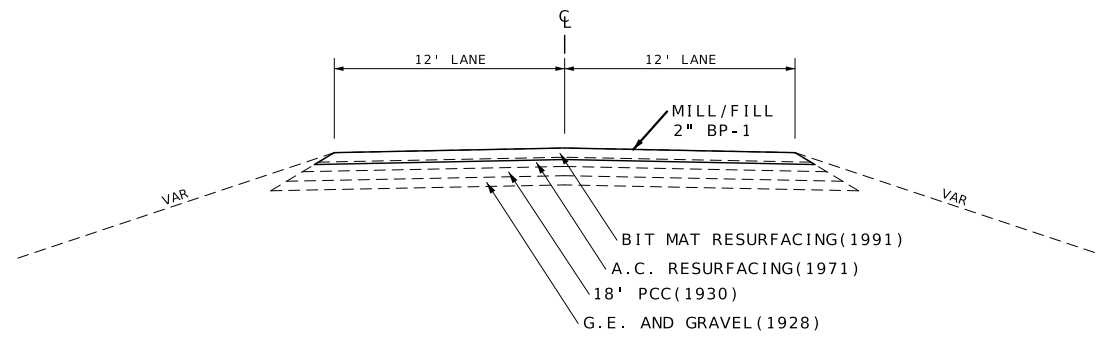

TYPICAL SECTION
SPUR 61 (SCOTT ST)
LOG MILE 0.000 TO LOG MILE 0.428



Donna Rene Philpot
DONNA RENE PHILPOT - CIVIL
MO-PE-2019000205

DATE PREPARED
8/1/2024

ROUTE 61 STATE MO

DISTRICT SE SHEET NO. 2

COUNTY NEW MADRID

JOB NO. J9S3516

CONTRACT ID.

PROJECT NO.

BRIDGE NO.

DATE	DESCRIPTION

MISSOURI HIGHWAYS AND TRANSPORTATION COMMISSION



105 WEST CAPITOL
JEFFERSON CITY, MO 65102
1-888-ASK-MODOT (1-888-275-6636)

MOBILIZATION
LUMP SUM 1

AGGREGATE EDGE DROP OFF TREATMENT						
LOG MI	LOG MI	LOC	LENGTH FT	ASSUMED AGGR DEPTH IN	PERM AGG EDGE TREATMENT TONS	REMARKS
325.060	334.845	LT/RT	51664.80	3.00	1850.0	
334.845	336.120	LT/RT	6732.00	5.00	673.7	SHLDR WEDGING
336.120	339.410	LT/RT	17371.20	3.00	622.0	
340.246	342.278	LT/RT	10728.96	3.00	384.2	
342.278	343.984	LT/RT	9007.68	1.25	55.9	
343.984	345.012	LT/RT	5427.84	3.00	194.4	
			TOTAL		3780.2	

LOG MILES ARE APPROXIMATE. EXACT LOCATIONS TO BE DETERMINED BY ENGINEER.

ASPHALT CURB					
LOG MI	LOG MI	LOC	LENGTH FT	ASPHALT CURB 4 INCH FT	REMARKS
339.524	339.579	LT	290.40	290.4	
339.816	339.918	RT	538.56	538.6	
345.079	345.200	LT	638.88	638.9	
345.079	345.212	RT	702.24	702.2	
345.444	345.490	LT	242.88	242.9	
345.444	345.490	RT	242.88	242.9	
			TOTAL	2656	

LOG MILES ARE APPROXIMATE. EXACT LOCATIONS TO BE DETERMINED BY ENGINEER.

REMOVAL OF IMPROVEMENTS					
LOG MI	LOG MI	LOC	DESCRIPTION	REMARKS	
339.506		RT	680.5' GUARDRAIL, 1 CRASHWORTHY, 1 TURNDOWN	RTE 61 AND WEST OUTER ROAD	
339.819		LT	525.0' GUARDRAIL, 1 CRASHWORTHY	RTE 61 AND WEST OUTER ROAD	
345.132		LT	400.0' GUARDRAIL, 1 CRASHWORTHY	RTE 61 AND EAST OUTER ROAD	
			LUMP SUM 1		

COLDMILLING								
LOG MI	LOG MI	LOC	LENGTH FT	WIDTH FT	MEASURED AREA SF	MODIFIED COLDMILLING DEPTH TRANSITIONS SY	COLDMILLING BIT PVMT (3" THICK OR LESS) SY	REMARKS
324.219	324.274	LT	290.40	10.00			322.7	SHLDR
324.324	324.436	LT	591.36	10.00			657.1	SHLDR
324.463	324.527	LT	337.92	10.00			375.5	SHLDR
324.231	324.299	RT	359.04	10.00			398.9	SHLDR
324.332	324.442	RT	580.80	10.00			645.3	SHLDR
324.478	324.530	RT	274.56	10.00			305.1	SHLDR
325.060	325.079	CL	100.00	40.00		444.4		
331.033	331.052		100.00	40.00		444.4		
331.052	331.181	CL	681.12	VAR	28900.00		3211.1	RTE H /RTE 80
331.181	331.200		100.00	40.00		444.4		
334.845	336.120	LT/RT	6732.00	16.00			11968.0	SHLDR WEDGING
339.391	339.410	CL	100.00	40.00		444.4		
339.410	339.579	LT/RT	892.32	22.00			2181.2	SHLDRS
339.579	339.671	CL	485.76	VAR	25770.00		2863.3	
339.723	339.816	CL	491.04	VAR	27400.00		3044.4	
339.816	340.246	LT/RT	2270.40	22.00			5549.9	SHLDRS
340.246	340.265	CL	100.00	40.00		444.4		
342.259	342.278	CL	100.00	40.00		444.4		
342.278	343.037	CL	4007.52	40.00			17811.2	
343.037	343.168	CL	691.68	VAR	30970.00		3441.1	TURN LANE
343.168	343.984	CL	4308.48	40.00			19148.8	
343.984	344.003	CL	100.00	40.00		444.4		
344.843	344.862	CL	100.00	40.00		444.4		
344.862	344.870	CL	VAR	VAR	1090.00		121.1	RR CROSSING
344.865	344.873	CL	VAR	VAR	1110.00		123.3	RR CROSSING
344.873	344.892	CL	100.00	40.00		444.4		
344.993	345.012	CL	100.00	40.00		444.4		
345.012	345.212	LT/RT	1056.00	22.00			2581.3	SHLDRS
345.212	345.295	CL	438.24	VAR	26135.00		2903.9	
345.346	345.444	CL	517.44	VAR	31415.00		3490.6	
345.444	345.573	LT/RT	681.12	22.00			1665.0	SHLDRS
333.648		RT	100.00	20.00		222.2		RTE HH
337.107		RT	100.00	22.00		244.4		RTE W
337.203		LT	100.00	22.00		244.4		RTE P
339.579		RT	VAR	VAR	1225.00		136.1	WEST OUTER ROAD
342.326		LT	VAR	VAR	9470.00		1052.2	RTE U
342.326		RT	VAR	VAR	11200.00		1244.4	RTE U
0.000	0.428	CL	2259.84	24.00			6026.2	SPUR (SCOTT ST)
345.206		LT	VAR	VAR	1350.00		150.0	EAST OUTER ROAD
324.231	345.573	CL	2.00	VAR		408.0		34 PAVED ENTRANCES; AVG W = 54'
324.231	345.573	CL	10.00	VAR		895.6		13 PAVED CRD/ST; AVG W = 62'
			TOTAL			6459	91418	

LOG MILES ARE APPROXIMATE. EXACT LOCATIONS TO BE DETERMINED BY ENGINEER.

GUARDRAIL								
SHEET NUM	LOG MI	LOC	MGS GUARDRAIL FT	TYPE A CRASHWORTHY END TERMINAL (MASH) EA	MODIFIED SHAPING SLOPES CLASS III FT	MGS END ANCHOR EA	REMARKS	
5	339.506	RT	662.5	2	160.0		RTE 61 AND WEST OUTER ROAD	
5	339.819	LT	512.5	1	80.0	1		
5	345.132	LT	350.0	2	160.0		RTE 61 AND EAST OUTER ROAD	
			TOTAL		1525	400	1	

LOG MILES ARE APPROXIMATE. EXACT LOCATIONS TO BE DETERMINED BY ENGINEER.

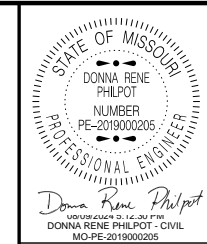

STATE OF MISSOURI
DONNA RENE PHIPOT
NUMBER PE-2019000205
PROFESSIONAL ENGINEER

Donna Rene Phipot

DATE PREPARED
8/5/2024

ROUTE **61** STATE **MO**

DISTRICT **SE** SHEET NO. **3**

COUNTY
NEW MADRID

JOB NO.
19S3516

CONTRACT ID.

PROJECT NO.

BRIDGE NO.

DATE	DESCRIPTION

MISSOURI HIGHWAYS AND TRANSPORTATION
COMMISSION

105 WEST CAPITOL
JEFFERSON CITY, MO 65102
1-888-ASK-MODOT (1-888-275-6636)

FULL DEPTH PAVEMENT REPAIRS (CON'TD)

LOG MI	DIR	LENGTH FT	WIDTH FT	FURNISHING AND PLACING MATERIAL FOR FULL DEPTH PVMT REPAIR SY	SUBGRADE COMPACTION 6 IN DEPTH PVMT REPAIR SY	TYPE 1 OR 5 AGGR FOR BASE 4 IN THICK PVMT REPAIR SY	FULL DEPTH PVMT REPAIR SAW CUT FT	DOWEL BARS DRILLING, FURNISHING AND INSTALLATION FOR FULL DEPTH PVMT REPAIR EA	DOWEL BARS FURNISHING AND INSTALLATION WITH BASKETS FOR FULL DEPTH PVMT REPAIR EA	TIE BAR DRILLING, FURNISHING AND INSTALLATION FOR FULL DEPTH PVMT REPAIR TYPE L JOINTS EA	REMARKS
324.420	LT	45	12	60.00	6.0	6.0	114.0	24	24	17	NORTHBOUND DRIVING
324.420	LT	22	12	29.33	2.9	2.9	68.0	24			NORTHBOUND DRIVING AND PASSING
324.460	LT	5	12	6.67	0.7	0.7	34.0	24			NORTHBOUND PASSING
324.460	LT	5	12	6.67	0.7	0.7	34.0	24			NORTHBOUND DRIVING
324.480	LT	5	12	6.67	0.7	0.7	34.0	24			NORTHBOUND DRIVING
324.500	LT	6	12	8.00	0.8	0.8	36.0	24			NORTHBOUND PASSING
325.460	LT	14	12	18.67	1.9	1.9	52.0	24			NORTHBOUND LANE
325.600	LT	25	12	33.33	3.3	3.3	74.0	24			NORTHBOUND LANE
325.790	LT	23	12	30.67	3.1	3.1	70.0	24			NORTHBOUND LANE
326.030	LT	18	12	24.00	2.4	2.4	60.0	24			NORTHBOUND LANE
326.190	LT	25	12	33.33	3.3	3.3	74.0	24			NORTHBOUND LANE
327.640	LT	21	12	28.00	2.8	2.8	66.0	24			NORTHBOUND LANE
330.820	LT	7	12	9.33	0.9	0.9	38.0	24			NORTHBOUND LANE
331.670	LT	8	12	10.67	1.1	1.1	40.0	24			NORTHBOUND LANE
334.160	LT	25	12	33.33	3.3	3.3	74.0	24			NORTHBOUND LANE
334.480	LT	15	12	20.00	2.0	2.0	54.0	24			NORTHBOUND LANE
335.120	LT	13	12	17.33	1.7	1.7	50.0	24			NORTHBOUND LANE
335.420	LT	10	12	13.33	1.3	1.3	44.0	24			NORTHBOUND LANE
337.070	LT	12	12	16.00	1.6	1.6	48.0	24			NORTHBOUND LANE
337.300	LT	10	12	13.33	1.3	1.3	44.0	24			NORTHBOUND LANE
337.510	LT	10	12	13.33	1.3	1.3	44.0	24			NORTHBOUND LANE
337.610	LT	10	12	13.33	1.3	1.3	44.0	24			NORTHBOUND LANE
337.720	LT	6	12	8.00	0.8	0.8	36.0	24			NORTHBOUND LANE
338.020	LT	15	12	20.00	2.0	2.0	54.0	24			NORTHBOUND LANE
338.690	LT	10	12	13.33	1.3	1.3	44.0	24			NORTHBOUND LANE
338.950	LT	5	12	6.67	0.7	0.7	34.0	24			NORTHBOUND LANE
339.310	LT	9	12	12.00	1.2	1.2	42.0	24			NORTHBOUND LANE
339.450	LT	26	12	34.67	3.5	3.5	76.0	24			NORTHBOUND LANE
339.470	LT	24	12	32.00	3.2	3.2	72.0	24			NORTHBOUND LANE
339.490	LT	45	12	60.00	6.0	6.0	114.0	24	24	17	NORTHBOUND LANE
339.870	LT	11	12	14.67	1.5	1.5	46.0	24			NORTHBOUND LANE
339.960	LT	45	12	60.00	6.0	6.0	114.0	24	24	17	NORTHBOUND LANE
340.310	LT	5	12	6.67	0.7	0.7	34.0	24			NORTHBOUND LANE
340.400	LT	9	12	12.00	1.2	1.2	42.0	24			NORTHBOUND LANE
340.790	LT	10	12	13.33	1.3	1.3	44.0	24			NORTHBOUND LANE
340.870	LT	12	12	16.00	1.6	1.6	48.0	24			NORTHBOUND LANE
341.190	LT	10	12	13.33	1.3	1.3	44.0	24			NORTHBOUND LANE
341.240	LT	10	12	13.33	1.3	1.3	44.0	24			NORTHBOUND LANE
341.310	LT	10	12	13.33	1.3	1.3	44.0	24			NORTHBOUND LANE
341.410	LT	9	12	12.00	1.2	1.2	42.0	24			NORTHBOUND LANE
341.580	LT	10	12	13.33	1.3	1.3	44.0	24			NORTHBOUND LANE
341.770	LT	8	12	10.67	1.1	1.1	40.0	24			NORTHBOUND LANE
341.900	LT	10	12	13.33	1.3	1.3	44.0	24			NORTHBOUND LANE
342.120	LT	9	12	12.00	1.2	1.2	42.0	24			NORTHBOUND LANE
342.260	LT	10	12	13.33	1.3	1.3	44.0	24			NORTHBOUND LANE
342.490	LT	6	12	8.00	0.8	0.8	36.0	24			NORTHBOUND LANE
342.660	LT	8	12	10.67	1.1	1.1	40.0	24			NORTHBOUND LANE
342.810	LT	9	12	12.00	1.2	1.2	42.0	24			NORTHBOUND LANE
342.850	LT	9	12	12.00	1.2	1.2	42.0	24			NORTHBOUND LANE
342.950	LT	10	12	13.33	1.3	1.3	44.0	24			NORTHBOUND LANE
343.190	LT	8	12	10.67	1.1	1.1	40.0	24			NORTHBOUND LANE
344.290	LT	10	12	13.33	1.3	1.3	44.0	24			NORTHBOUND LANE
344.580	LT	9	12	12.00	1.2	1.2	42.0	24			NORTHBOUND LANE
345.010	LT	15	12	20.00	2.0	2.0	54.0	24			NORTHBOUND LANE
				SUB TOTAL 2	981.31	97.9	2768.0	1296	72	51	
				SUB TOTAL 1	1058.66	105.8	2860.0	1272	180	133	
				USE	2040.0	204	5628	2568	252	184	

SUBGRADE COMPACTION AND PVMT REPAIR AND 4" TYPE 1 OR 5 AGGR BASE FOR PVMT REPAIR QUANTITIES ARE CALCULATED AT 10% OF THE TOTAL AREA OF FULL DEPTH PVMT REPAIR.
 ALL LOCATIONS AND PVMT REPAIR SIZES ARE APPROXIMATE AND MAY BE ADJUSTED AS DIRECTED BY THE ENGINEER.
 LOG MILES ARE APPROXIMATE. EXACT LOCATIONS TO BE DETERMINED BY THE ENGINEER.

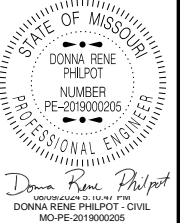

DATE PREPARED
8/5/2024

ROUTE **61** STATE **MO**

DISTRICT **SE** SHEET NO. **3**

COUNTY **NEW MADRID**

JOB NO. **J9S3516**

CONTRACT ID.

PROJECT NO.

BRIDGE NO.

DATE	DESCRIPTION



SUMMARY OF QUANTITIES
 SHEET 4 OF 7



Donna Rene Philpot
 DONNA RENE PHILPOT - CIVIL
 MO-PE-2019000205

DATE PREPARED
 8/5/2024

ROUTE 61 STATE MO

DISTRICT SE SHEET NO. 3

COUNTY
 NEW MADRID

JOB NO.
 J9S3516

CONTRACT ID.

PROJECT NO.

BRIDGE NO.

DATE	DESCRIPTION

MISSOURI HIGHWAYS AND TRANSPORTATION COMMISSION
 105 WEST CAPITOL
 JEFFERSON CITY, MO 65102
 1-888-ASK-MODOT (1-888-275-6636)

SUMMARY OF QUANTITIES
 SHEET 5 OF 7

PARITAL DEPTH PAVEMENT REPAIR

LOG MI	LOC	LENGTH FT	WIDTH FT	DEPTH IN	FURNISHING AND PLACING BITUMINOUS MATERIAL FOR CLASS B TONS	REMOVAL FOR CLASS B SY	REMARKS	
325.442	LT	7	12	4	2.13	9.33	NORTHBOUND LANE	
325.941	LT	15	12	4	4.56	20.00	NORTHBOUND LANE	
326.745	LT	8	12	4	2.43	10.67	NORTHBOUND LANE	
327.460	LT	28	12	4	8.50	37.33	NORTHBOUND LANE	
328.081	LT	12	12	4	3.64	16.00	NORTHBOUND LANE	
328.425	LT	10	12	4	3.04	13.33	NORTHBOUND LANE	
330.364	LT	5	12	4	1.52	6.67	NORTHBOUND LANE	
330.544	LT	5	12	4	1.52	6.67	NORTHBOUND LANE	
330.599	LT	6	12	4	1.82	8.00	NORTHBOUND LANE	
331.196	LT	20	12	4	6.07	26.67	NORTHBOUND LANE	
331.243	LT	125	12	4	37.96	166.67	NORTHBOUND LANE	
331.337	LT	6	12	4	1.82	8.00	NORTHBOUND LANE	
331.668	LT	9	12	4	2.73	12.00	NORTHBOUND LANE	
331.808	LT	10	12	4	3.04	13.33	NORTHBOUND LANE	
332.533	LT	6	12	4	1.82	8.00	NORTHBOUND LANE	
333.237	LT	6	12	4	1.82	8.00	NORTHBOUND LANE	
333.282	LT	5	12	4	1.52	6.67	NORTHBOUND LANE	
333.661	LT	10	12	4	3.04	13.33	NORTHBOUND LANE	
333.771	LT	5	12	4	1.52	6.67	NORTHBOUND LANE	
333.949	LT	5	12	4	1.52	6.67	NORTHBOUND LANE	
334.170	LT	30	12	4	9.11	40.00	NORTHBOUND LANE	
334.363	LT	5	12	4	1.52	6.67	NORTHBOUND LANE	
334.438	LT	5	12	4	1.52	6.67	NORTHBOUND LANE	
334.630	LT	5	12	4	1.52	6.67	NORTHBOUND LANE	
336.645	LT	9	12	4	2.73	12.00	NORTHBOUND LANE	
336.707	LT	7	12	4	2.13	9.33	NORTHBOUND LANE	
337.033	LT	7	12	4	2.13	9.33	NORTHBOUND LANE	
337.789	LT	8	12	4	2.43	10.67	NORTHBOUND LANE	
337.895	LT	6	12	4	1.82	8.00	NORTHBOUND LANE	
338.319	LT	6	12	4	1.82	8.00	NORTHBOUND LANE	
338.585	LT	7	12	4	2.13	9.33	NORTHBOUND LANE	
338.828	LT	5	12	4	1.52	6.67	NORTHBOUND LANE	
338.884	LT	9	12	4	2.73	12.00	NORTHBOUND LANE	
338.947	LT	12	12	4	3.64	16.00	NORTHBOUND LANE	
338.969	LT	40	12	4	12.15	53.33	NORTHBOUND LANE	
338.988	LT	22	12	4	6.68	29.33	NORTHBOUND LANE	
339.140	LT	75	12	4	22.78	100.00	NORTHBOUND LANE	
339.161	LT	23	12	4	6.99	30.67	NORTHBOUND LANE	
339.213	LT	8	12	4	2.43	10.67	NORTHBOUND LANE	
339.312	LT	11	12	4	3.34	14.67	NORTHBOUND LANE	
340.290	LT	20	12	4	6.07	26.67	NORTHBOUND LANE	
340.942	LT	9	12	4	2.73	12.00	NORTHBOUND LANE	
340.571	LT	18	12	4	5.47	24.00	NORTHBOUND LANE	
340.622	LT	23	12	4	6.99	30.67	NORTHBOUND LANE	
340.681	LT	5	12	4	1.52	6.67	NORTHBOUND LANE	
341.095	LT	7	12	4	2.13	9.33	NORTHBOUND LANE	
342.178	LT	20	12	4	6.07	26.67	NORTHBOUND LANE	
342.406	LT	15	12	4	4.56	20.00	NORTHBOUND LANE	
342.552	LT	8	12	4	2.43	10.67	NORTHBOUND LANE	
342.704	LT	6	12	4	1.82	8.00	NORTHBOUND LANE	
342.962	LT	6	12	4	1.82	8.00	NORTHBOUND LANE	
343.719	LT	126	12	4	38.27	168.00	NORTHBOUND LANE	
344.519	LT	15	12	4	4.56	20.00	NORTHBOUND LANE	
					SUB TOTAL 2	267.58	1174.70	
					SUB TOTAL 1	223.22	980.00	
					USE	490.8	2154.7	

BP-1 RATE OF 2.050 TONS/CY
 ALL LOCATIONS AND PVMT REPAIR SIZES ARE APPROXIMATE AND MAY BE ADJUSTED AS DIRECTED BY THE ENGINEER.
 LOG MILES ARE APPROXIMATE. EXACT LOCATIONS TO BE DETERMEINED BY THE ENGINEER.

PARITAL DEPTH PAVEMENT REPAIR

LOG MI	LOC	LENGTH FT	WIDTH FT	DEPTH IN	FURNISHING AND PLACING BITUMINOUS MATERIAL FOR CLASS B TONS	REMOVAL FOR CLASS B SY	REMARKS	
325.458	RT	25	12	4	7.59	33.33	SOUTHBOUND LANE	
325.752	RT	45	12	4	13.67	60.00	SOUTHBOUND LANE	
325.795	RT	29	12	4	8.81	38.67	SOUTHBOUND LANE	
325.918	RT	162	12	4	49.20	216.00	SOUTHBOUND LANE	
326.994	RT	15	12	4	4.56	20.00	SOUTHBOUND LANE	
326.849	RT	6	12	4	1.82	8.00	SOUTHBOUND LANE	
326.503	RT	39	12	4	11.84	52.00	SOUTHBOUND LANE	
326.326	RT	6	12	4	1.82	8.00	SOUTHBOUND LANE	
327.069	RT	9	12	4	2.73	12.00	SOUTHBOUND LANE	
327.142	RT	6	12	4	1.82	8.00	SOUTHBOUND LANE	
327.242	RT	6	12	4	1.82	8.00	SOUTHBOUND LANE	
327.285	RT	10	12	4	3.04	13.33	SOUTHBOUND LANE	
327.463	RT	15	12	4	4.56	20.00	SOUTHBOUND LANE	
327.891	RT	10	12	4	3.04	13.33	SOUTHBOUND LANE	
329.359	RT	6	12	4	1.82	8.00	SOUTHBOUND LANE	
329.600	RT	6	12	4	1.82	8.00	SOUTHBOUND LANE	
329.650	RT	5	12	4	1.52	6.67	SOUTHBOUND LANE	
329.767	RT	5	12	4	1.52	6.67	SOUTHBOUND LANE	
330.130	RT	7	12	4	2.13	9.33	SOUTHBOUND LANE	
330.246	RT	150	12	4	45.56	200.00	SOUTHBOUND LANE	
331.811	RT	55	12	4	16.70	73.33	SOUTHBOUND LANE	
333.082	RT	5	12	4	1.52	6.67	SOUTHBOUND LANE	
333.393	RT	8	12	4	2.43	10.67	SOUTHBOUND LANE	
333.661	RT	10	12	4	3.04	13.33	SOUTHBOUND LANE	
334.434	RT	4	12	4	1.21	5.33	SOUTHBOUND LANE	
336.834	RT	7	12	4	2.13	9.33	SOUTHBOUND LANE	
339.312	RT	11	12	4	3.34	14.67	SOUTHBOUND LANE	
339.396	RT	12	12	4	3.64	16.00	SOUTHBOUND LANE	
340.290	RT	20	12	4	6.07	26.67	SOUTHBOUND LANE	
340.942	RT	9	12	4	2.73	12.00	SOUTHBOUND LANE	
341.236	RT	15	12	4	4.56	20.00	SOUTHBOUND LANE	
341.518	RT	11	12	4	3.34	14.67	SOUTHBOUND LANE	
344.284	RT	6	12	4	1.82	8.00	SOUTHBOUND LANE	
					SUB TOTAL 1	223.22	980.00	

BP-1 RATE OF 2.050 TONS/CY
 ALL LOCATIONS AND PVMT REPAIR SIZES ARE APPROXIMATE AND MAY BE ADJUSTED AS DIRECTED BY THE ENGINEER.
 LOG MILES ARE APPROXIMATE. EXACT LOCATIONS TO BE DETERMEINED BY THE ENGINEER.

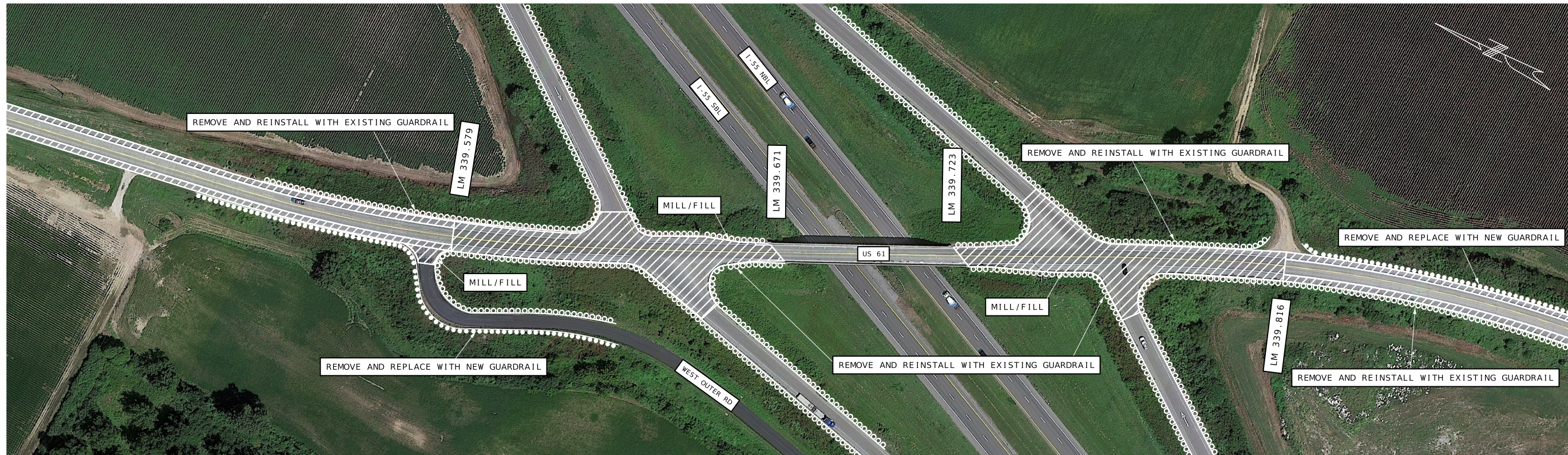

I-55 INTERCHANGES

I-55 EXIT 49

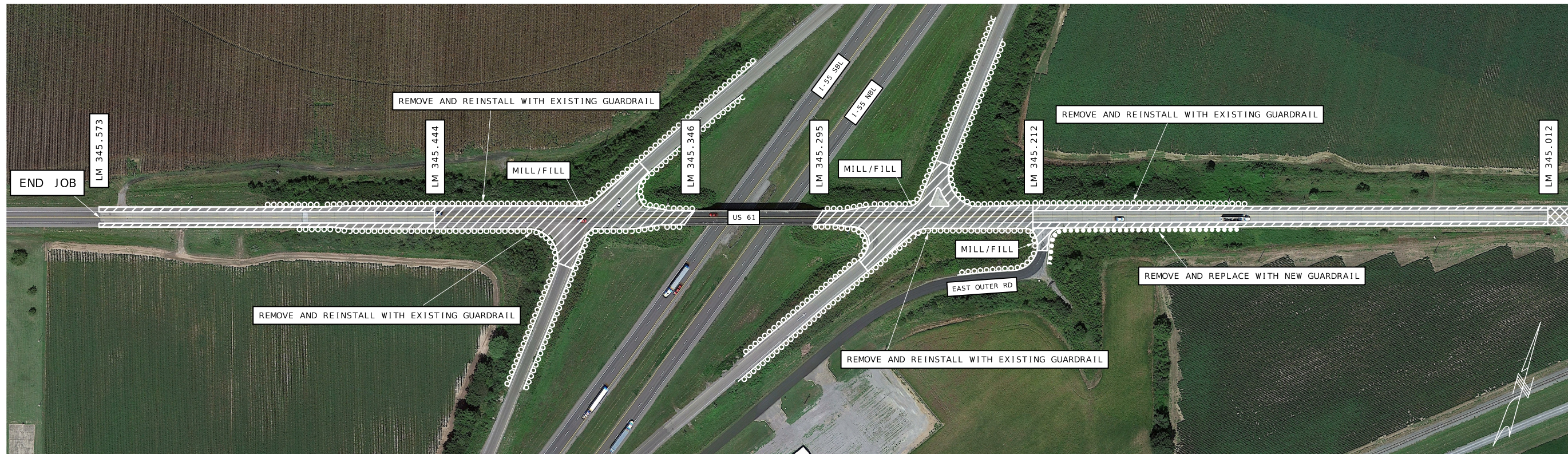

I-55 EXIT 44



-  MILL/FILL
-  MODIFIED COLDMILLING

NOTE: IN MILL/FILL AREAS EXISTING GUARDRAIL IS TO BE REMOVED AND REINSTALLED AS NEEDED



Donna Rene Philpot
 MISSOURI REGISTERED PROFESSIONAL ENGINEER
 LICENSE NUMBER PE-2019000205

DATE PREPARED: 8/1/2024
 ROUTE: 61 STATE: MO
 DISTRICT: SE SHEET NO.: 5
 COUNTY: NEW MADRID
 JOB NO.: J9S3516
 CONTRACT ID.:

PROJECT NO.:
 BRIDGE NO.:

DATE	DESCRIPTION

MISSOURI HIGHWAYS AND TRANSPORTATION COMMISSION

 105 WEST CAPITOL
 JEFFERSON CITY, MO 65102
 1-888-ASK-MODOT (1-888-275-6636)

SPECIAL SHEET
 SHEET 2 OF 5

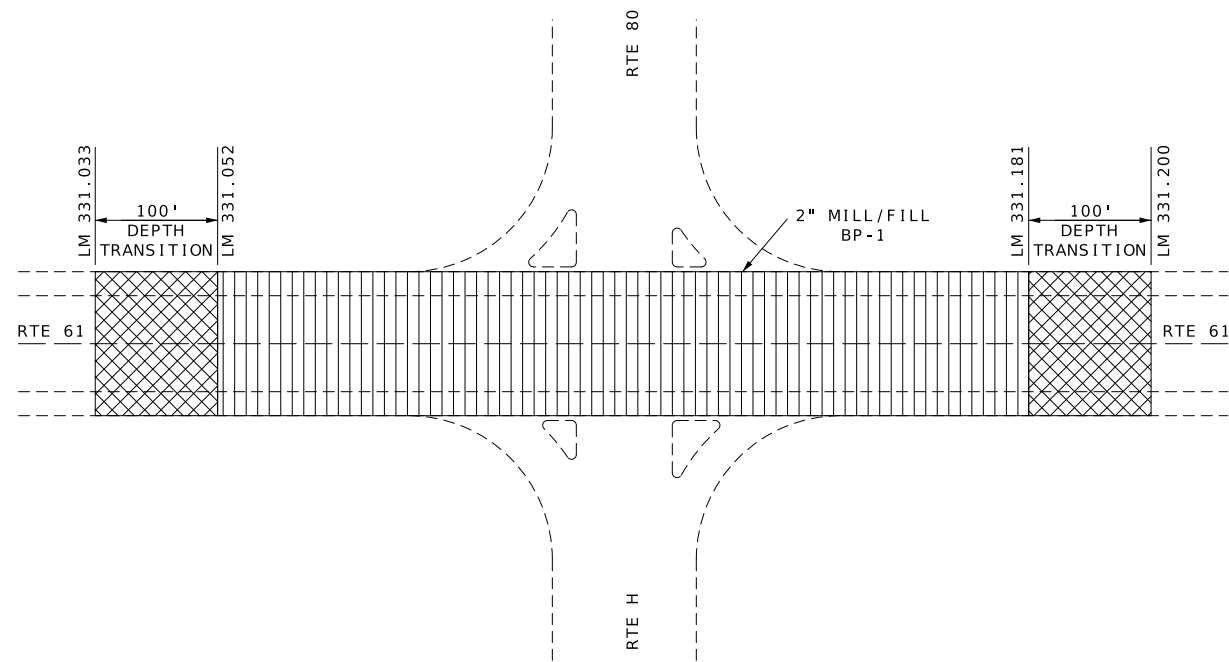

RTE 80 / RTE H
 RTE 80 / RTE H - LOG MILE 331.117

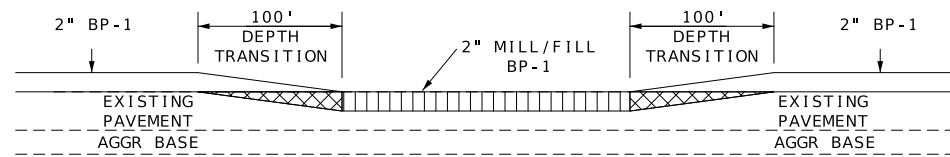

PLAN VIEW AT
 RTE 80 / RTE H



TYPICAL
 RTE 61

-  OVERLAY
-  MILL/FILL
-  DEPTH TRANSITION

RTE HH
 RTE HH - LOG MILE 336.648

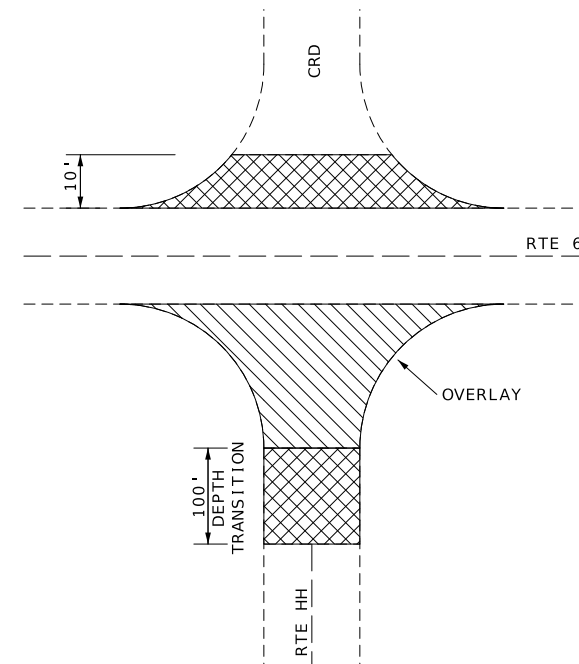

PLAN VIEW AT RTE HH

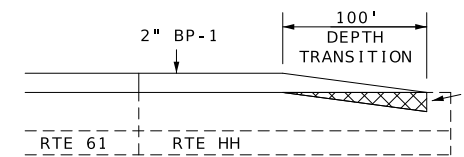

TYPICAL
 RTE HH

SHOULDER WEDGING

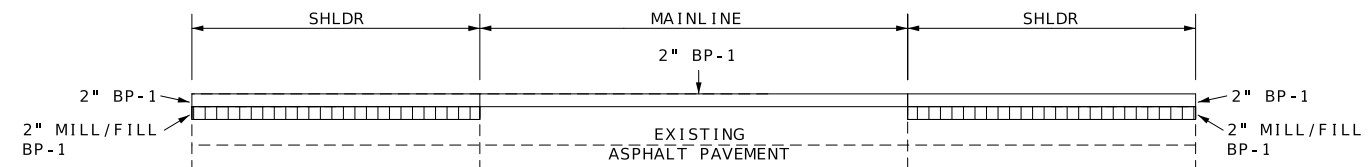

TYPICAL
 LOG MILE 334.845 TO LOG MILE 336.120



DATE PREPARED
 8/1/2024

ROUTE 61 STATE MO
 DISTRICT SE SHEET NO. 6
 COUNTY NEW MADRID
 JOB NO. J9S3516
 CONTRACT ID.

PROJECT NO.
 BRIDGE NO.

DATE	DESCRIPTION

MISSOURI HIGHWAYS AND TRANSPORTATION COMMISSION
 105 WEST CAPITOL
 JEFFERSON CITY, MO 65102
 1-888-ASK-MODOT (1-888-275-6636)

SPECIAL SHEET
 SHEET 3 OF 5



W020-1
2



W020-4
7



W020-7a
8



W021-5
21

**TRAFFIC CONTROL
LEGEND**

- SIGN (SINGLE SIDED)
- CHANNELIZER
- ◁ FLAGGER

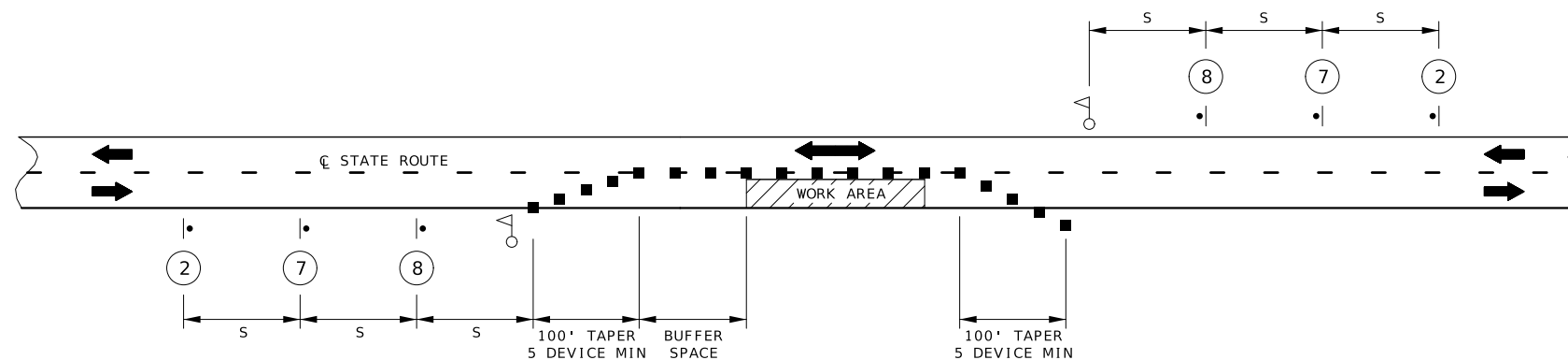

LANE CLOSURE WITH FLAGGER CONTROL

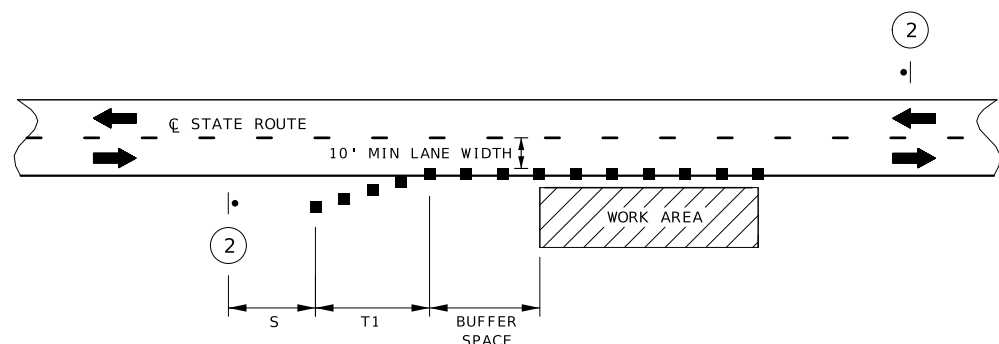

SHOULDER WORK WITH MINOR ENCROACHMENT

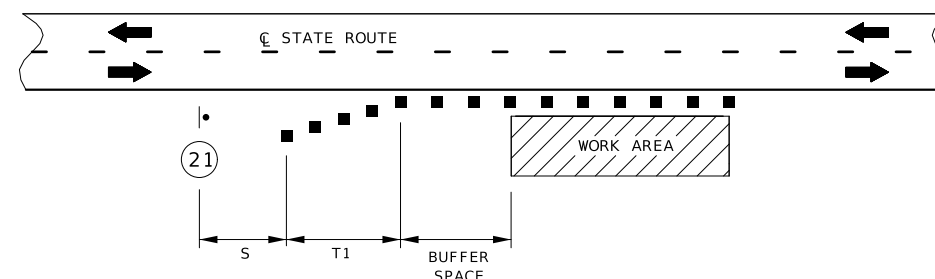

SHOULDER WORK

NOTES:

- DAYLIGHT FLAGGING OPERATIONS ONLY.
- DISTANCE MAY BE ADJUSTED ACCORDING TO FIELD CONDITIONS.
- NO PAYMENT WILL BE MADE FOR RELOCATION OF CONSTRUCTION SIGNS.
- ANY EXISTING SIGNING THAT CONFLICTS WITH THE TRAFFIC CONTROL SIGNING SHALL BE COMPLETELY COVERED OR REMOVED.
- AUTOMATED FLAGGER ASSISTANCE DEVICES AND PORTABLE SIGNAL FLAGGING DEVICES MAY BE USED AS AN ALTERNATIVE FLAGGING OPERATION.
- FOR ADDITIONAL TRAFFIC CONTROL PLANS FOR THIS PROJECT, USE STANDARD PLANS 616.20 (SHEETS 1 THROUGH 5).

DRAWING NOT TO SCALE. FOLLOW DIMENSIONS.

PERMANENT POSTED SPEED (MPH)	SIGN SPACING (1) (FT)	
	NON-DIVIDED HIGHWAYS (S)	DIVIDED HIGHWAYS (S)
0 - 35	200 FT	200 FT
40 - 45	350 FT	500 FT
50 - 55	500 FT	1000 FT
60 - 70	1000 FT	SA - 1000 FT SB - 1500 FT SC - 2640 FT

(1) SPACING BETWEEN SIGNS, BETWEEN LAST SIGN AND FLAGGER, BEGINNING OF TAPER OR SIGNED CONDITION. SPACINGS MAY BE ADJUSTED AS NECESSARY TO MEET FIELD CONDITIONS.

PERMANENT POSTED SPEED (MPH)	TAPER LENGTH T1 SHOULDER (1)	TAPER LENGTH L FOR LATERAL SHIFTS (2)			BUFFER SPACE LENGTH	CHANNELIZER SPACING (3)	
		10 FT	11 FT	12 FT		TAPERS	BUFFER SPACE WORK AREA
		0 - 35	70 FT	205 FT		225 FT	245 FT
40 - 45	150 FT	450 FT	495 FT	540 FT	400 FT	40 FT (4)	80 FT (4)
50 - 55	185 FT	550 FT	605 FT	660 FT	560 FT	50 FT (5)	80 FT (5)
60 - 70	235 FT	700 FT	770 FT	840 FT	840 FT	60 FT (5)	120 FT (5)

- (1) SHOULDER TAPER LENGTH BASED ON 10' (STANDARD SHOULDER WIDTH) OFFSET.
- (2) TAPER LENGTHS MAY BE ADJUSTED TO ACCOMMODATE CROSSROADS, CURVES, RAMPS, INTERSECTIONS, OR OTHER GEOMETIC FEATURES.
- (3) SPACING MAY BE REDUCED TO DISCOURAGE TRAFFIC ENCROACHMENT.
- (4) SPACING REDUCED TO ONE-HALF AT INTERSECTIONS.
- (5) SPACING MAY BE REDUCED TO ONE-HALF AT INTERSECTIONS.

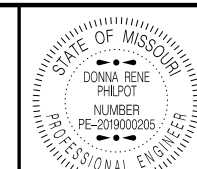

Donna Rene Philpot
DONNA RENE PHILPOT - CIVIL
MO-PE-2019000205

DATE PREPARED
8/8/2024

ROUTE 61	STATE MO
DISTRICT SE	SHEET NO. 9
COUNTY NEW MADRID	
JOB NO. J9S3516	
CONTRACT ID.	
PROJECT NO.	
BRIDGE NO.	

DESCRIPTION	DATE

MISSOURI HIGHWAYS AND TRANSPORTATION COMMISSION

105 WEST CAPITOL
JEFFERSON CITY, MO 65102
1-888-ASK-MODOT (1-888-275-6636)



WO20-1
②



WO20-4
⑦

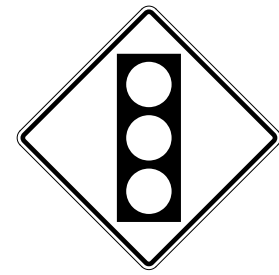

WO3-3
⑫



R10-6L
④⑦

TRAFFIC CONTROL LEGEND

- SIGN (SINGLE SIDED)
- CHANNELIZER
- ◀▶ PORTABLE TRAFFIC SIGNAL



STATE OF MISSOURI
DONNA RENE PHILPOT
NUMBER
PE-2019000205
PROFESSIONAL ENGINEER

DATE PREPARED
10/7/2024

ROUTE 61	STATE MO
DISTRICT SE	SHEET NO. 10
COUNTY NEW MADRID	
JOB NO. J9S3516	
CONTRACT ID.	
PROJECT NO.	
BRIDGE NO.	

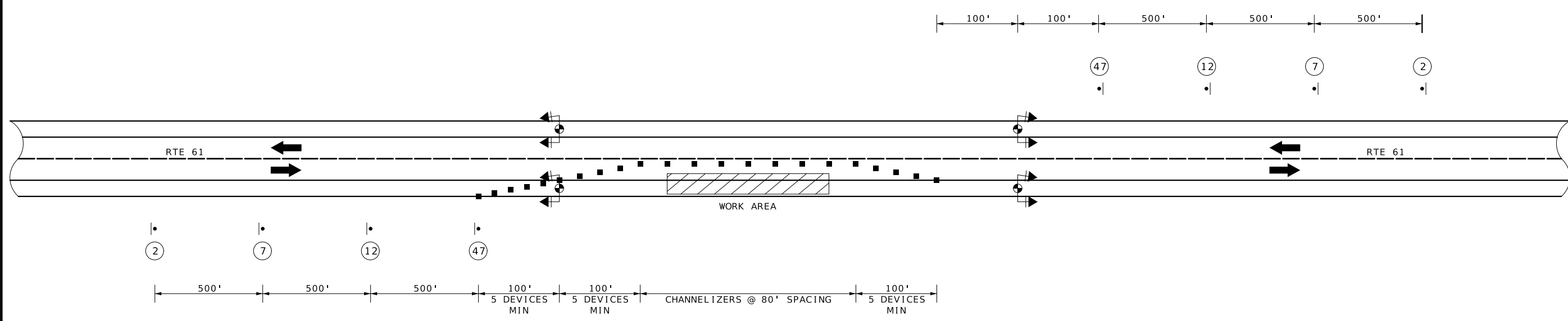

TEMPORARY LANE CLOSURE WITH SIGNALS
FOR PAVEMENT REPAIR

NOTES:

DISTANCE MAY BE ADJUSTED ACCORDING TO FIELD CONDITIONS.

TEMPORARY LANE CLOSURE WITH SIGNALS SHALL NOT EXCEED 3 DAYS PER LOCATION.

ANY EXISTING SIGNING THAT CONFLICTS WITH THE TRAFFIC CONTROL SIGNING SHALL BE COMPLETELY COVERED OR REMOVED.

NO PAYMENT WILL BE MADE FOR RELOCATION OF CONSTRUCTION SIGNS.

CONTRACTOR SHALL CONSULT WITH THE ENGINEER REGARDING PHASING, INTERCONNECTION AND OPERATION OF SIGNALS PRIOR TO ENGINEER'S APPROVAL OF SIGNAL INSTALLATIONS

DRAWING NOT TO SCALE. FOLLOW DIMENSIONS

DESCRIPTION	DATE

MISSOURI HIGHWAYS AND TRANSPORTATION COMMISSION

105 WEST CAPITOL
JEFFERSON CITY, MO 65102
1-888-ASK-MODOT (1-888-275-6636)

TRAFFIC CONTROL
SHEET 2 OF 2

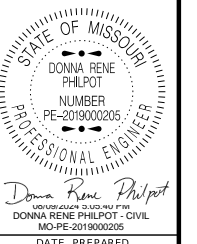

Main data table with columns for SIGN NO., SIGN SIZE, LOG MILE, LOCATION, CONCRETE FOOTINGS EMBEDDED, STRUCTURAL STEEL POSTS *, PIPE POSTS *, BACKING BARS **, U-CHANNEL POST, and PERFORATED SQUARE STEEL TUBE (2 IN. POST, 2.5 IN. POST). Includes subtotals and totals at the bottom.

DATE PREPARED: 8/8/2024
ROUTE: 61, STATE: MO
DISTRICT: SE, SHEET NO.: 11
COUNTY: NEW MADRID
JOB NO.: J9S3516
CONTRACT ID.:
PROJECT NO.:
BRIDGE NO.:

DESCRIPTION and DATE columns for the project details.

MISSOURI HIGHWAYS AND TRANSPORTATION COMMISSION
105 WEST CAPITOL
JEFFERSON CITY, MO 65102
1-888-ASK-MODOT (1-888-275-6636)

* BREAKAWAY ASSEMBLY IS INCIDENTAL FOR STRUCTURAL STEEL AND PIPE POSTS.
** BACKING BARS ARE TOTALED WITH STRUCTURAL STEEL OR PIPE POSTS.

ROUND PIPE POST AND FOOTING DATA TABLE

NOM. SIZE	WEIGHT	STUB LENGTH	FOOTING	CONCRETE
(IN.)	LBS/FT	LBS/IN	DIA. DEPTH	C.Y.
2 1/2	5.79	0.48	4" - 3 1/2"	12" 4-6" 0.13
4	10.79	0.90	5" - 3 1/2"	18" 5-6" 0.36

STRUCTURAL STEEL POST AND FOOTING DATA TABLE

POST DES. NO.	NOM. SIZE	POST WEIGHT		STUB LENGTH	DIA.	FOOTING							
		LBS/FT	LBS/IN			LEVEL GROUND		6:1 GRADE		4:1 GRADE		3:1 OR 2:1 GRADE	
						DEPTH	C.Y.	DEPTH	C.Y.	DEPTH	C.Y.	DEPTH	C.Y.
1	W6	9.0	0.75	3'-0"	15"	3'-0"	0.14	3'-2"	0.15	3'-3"	0.16	3'-6"	0.17
2	W6	15.0	1.25	4'-0"	24"	4'-0"	0.47	4'-2"	0.50	4'-3"	0.51	4'-6"	0.54
3	W8	18.0	1.50	4'-6"	28"	4'-6"	0.71	4'-8"	0.73	4'-9"	0.74	5'-0"	0.78
4	W10	22.0	1.83	5'-0"	36"	5'-0"	1.31	5'-2"	1.36	5'-3"	1.39	5'-6"	1.45
5	W10	26.0	2.17	5'-0"	36"	5'-0"	1.31	5'-3"	1.37	5'-5"	1.43	5'-9"	1.52
6	W12	35.0	2.92	5'-6"	36"	5'-6"	1.44	5'-9"	1.52	5'-11"	1.56	6'-3"	1.65

