

3 REVISED

EARTHWORK						
ROUTE	STA.	STA.	CLASS A EXCAVATION	COMPACTING EMBANKMENT	EMBANKMENT IN PLACE	REMARKS
			CY	CY	CY	
LOOP RAMP DETENTION BASIN			12403.3	216.5	0.0	
SOUTH DETENTION BASINS			3915.2	3319.3	0.0	
ROUTE AC	142+10.94	164+30.81	10215.5	9885.2	0.0	
LOMONE ST	301+01.54	302+95.95	544.1	516.6	0.0	
LENIOR ST.	391+66.35	410+35.40	3949.5	3949.5	8523.1	
LOOP RAMP	252+00.25	257+53.04	3835.7	4086.1	0.0	
OFF RAMP FROM ROUTE 63	325+80.75	335+41.20	5007.7	5007.7	185.7	
ROUTE 63 AND ACCELERATION LANES	21+54.24	39+00.56	17416.3	17416.3	1920.3	
TOTALS			60287.3	44397.2	10629.1	
USE			60287	44397	10629	

CONCRETE BOX CULVERT						
ROUTE	LOCATION	STA.	CONCRETE	STEEL	CLASS 4 EXCAVATION	REMARKS
			CY	LB	CY	
US 63 ON RAMP	LT	14+50.84	30	3475	27	2 REVISED
LENOIR	LT/RT	404+84.00	127.3	28648	238.8	
TOTALS			157.3	32123	265.8	
USE			157.3	32120	266	

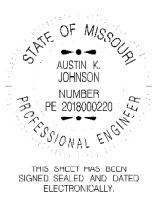

DATE PREPARED  
10/16/24

ROUTE AC STATE MO

DISTRICT CD SHEET NO. 3

COUNTY BOONE

JOB NO. J5P3433

CONTRACT ID.

PROJECT NO.

BRIDGE NO.

DATE	DESCRIPTION	REVISED QUANTITIES	REVISED QUANTITIES
10/05/24			
10/16/24			

MISSOURI HIGHWAYS AND TRANSPORTATION COMMISSION

MoDOT

105 WEST CAPITOL JEFFERSON CITY, MO 65102

1-888-ASK-MODOT (1-888-275-6636)

**Bartlett & West**

601 MONROE ST. SUITE 201 - JEFFERSON CITY, MO 65101

PHONE 872-66-5181

CERTIFICATE OF AUTHORITY NO. 000707 - ENGINEERING

WWW.BARTLETTWEST.COM

IF A SEAL IS PRESENT ON THIS SHEET IT HAS BEEN ELECTRONICALLY SEALED AND DATED.

TEMPORARY EROSION AND SEDIMENT CONTROL DEVICES										
ROUTE	LOC.	STA.	STA.	CURB INLET CHECK	ALTERNATE DITCH CHECK	ROCK DITCH CHECK	SEDIMENT TRAP	SILT FENCE	SEDIMENT REMOVAL	REMARKS
				EA	LF	LF	CY	LF	CY	
LENOIR	RT.	390+91.73	406+26.57	15					15	
LENOIR	LT.	391+43.29	410+04.01	6		14		20	9	
LENOIR	RT.	404+48.69	410+16.35					602	7	
LOMONE	LT.	300+72.77	300+92.57	2					2	
LEMONRE	RT.	300+75.90	302+31.80	3					3	
AC	LT.	OFF RAMP	LENOIR	21					21	
AC	RT.	OFF RAMP	LENOIR	7				696	14	
AC	LT.	LENOIR	END	3	30	8	5		15	
AC	RT.	LENOIR	END	1		8		745	10	
LOOP RAMP	RT.	254+71.00	257+41.00			16			2	
US 63 WIDEN	LT.	4+51.92	13+11.12					1012	11	
TOTALS				58	30	46	5	3075	109	

NOTE: SEDIMENT REMOVAL IS BASED ON 1 CY PER DITCH CHECK, 1 CY PER SEDIMENT TRAP, 1 CY PER CURB INLET CHECK, AND 1 CY PER 100' OF SILT FENCE

CURB AND GUTTER								
ROUTE	STA.	STA.	LOCATION	TYPE B CURB AND GUTTER	TYPE S CURB	MODIFIED TYPE S CURB	4" TYPE 5 AGGREGATE BASE	REMARKS
				LF	LF	LF	SY	
LENOIR ST	390+63.66	392+59.85	LT	220			73	
LENOIR ST	390+76.85	392+59.72	RT	172			57	
LENOIR ST	393+01.72	410+20.30	RT	1705			568	
LENOIR ST	393+01.85	409+50.06	LT	1605			535	
LOMONE IND BLVD	300+66.53	302+95.59	RT	162			54	
LOMONE IND BLVD	300+67.93	302+96.09	LT	240			80	
ROUTE AC	143+41.42	145+16.95	LT	198			66	
ROUTE AC	146+43.33	148+84.39	LT	242			81	
ROUTE AC	146+35.19	148+46.23	RT	198			66	
ROUTE AC	149+48.94	153+70.26	LT	423			141	
ROUTE AC	148+94.66	153+84.35	RT	461			154	
ROUTE AC	152+23.89	153+79.45	LT	260			87	
ROUTE AC	154+87.77	155+35.12	LT	99			33	
ROUTE AC / SCHOOL DRIVE			LT	55			18	2 DELETED
MOBILE HOME DRIVE				336			112	2 DELETED
ROUTE AC	144+72.63	145+16.60	LT		51			2 DELETED
LOMONE IND BLVD	300+78.56	301+74.99	RT			113		
ROUTE AC	149+34.26	149+61.03	LT		72			2 DELETED
ROUTE AC					244			2 DELETED
ROUTE AC	156+50.93	157+28.26	LT	112				2 ADDED
ROUTE AC	301+30.38	301+38.35	LT	11				2 ADDED
TOTALS				6039	367	113	2013	

NOTE:

2 REVISED

5717 0 1995

PAVED APPROACH					
ROUTE	STA.	LOCATION	PAVED APPROACH	TYPE 5 AGGREGATE	REMARKS
			8 IN	FOR BASE 4 IN.	
LOMONE INDUSTRIAL	301+94.03	RT	125.4	125	
BOONE AC	148+70.45	RT	295.3	295	
BOONE AC	148+96.93	LT	451.1	451	2 REVISED
BOONE AC	150+50.14	LT	124.9	125	2 ADDED
BOONE AC	154+45.27	LT	1850.1	1850	2 ADDED
BOONE AC	160+07.05	LT	1021.0	1021	2 ADDED
LENOIR ST	392+80.72	RT	145.7	146	
LENOIR ST	392+80.85	LT	159.5	159	
LENOIR ST	409+68.27	LT	175.4	175	
TOTAL			1097.0	1196	

2 REVISED 4093.0 4093

SETTLEMENT GAGE  
TOTAL = 9 EACH

SUMMARY OF QUANTITIES  
SHEET 2 OF 10

SIGN	SIZE IN.	AREA SQ.FT.	QTY EACH	TOTAL AREA SQ.FT.	QTY RELOC EACH	TOTAL RELOC SQ.FT.	SIGN NUM.	DESCRIPTION
<b>WARNING SIGNS</b>								
W01-1L	48X48	16.00						TURN (SYMBOL LEFT)
W01-1R	48X48	16.00						TURN (SYMBOL RIGHT)
W01-2L	48X48	16.00						CURVE (SYMBOL LEFT)
W01-2R	48X48	16.00						CURVE (SYMBOL RIGHT)
W01-3L	48X48	16.00						REVERSE TURN (SYMBOL LEFT)
W01-3R	48X48	16.00						REVERSE TURN (SYMBOL RIGHT)
W01-4L	48X48	16.00						REVERSE CURVE (SYMBOL LEFT)
W01-4R	48X48	16.00	1					REVERSE CURVE (SYMBOL RIGHT)
W01-4bL	48X48	16.00						DOUBLE ARROW REVERSE CURVE (SYMBOL LEFT)
W01-4bR	48X48	16.00						DOUBLE ARROW REVERSE CURVE (SYMBOL RIGHT)
W01-4cL	48X48	16.00						TRIPLE ARROW REVERSE CURVE (SYMBOL LEFT)
W01-4cR	48X48	16.00						TRIPLE ARROW REVERSE CURVE (SYMBOL RIGHT)
W01-6	60X30	12.50						HORIZONTAL ARROW (SYMBOL)
W01-6a	72X36	18.00						HORIZ. ARROW (SYMBOL ON PERMANENT BARRICADE)
W01-7	60X30	12.50						DOUBLE HEAD HORIZONTAL ARROW (SYMBOL)
W01-7a	72X36	18.00						DOUBLE HEAD HORIZ. ARROW (SYMBOL ON PERM. BARR.)
W01-8	18X24	3.00						CHEVRON (SYMBOL)
W01-8a	30X36	7.50						CHEVRON (SYMBOL FOR DIVIDED HIGHWAYS)
W03-1	48X48	16.00						STOP AHEAD (SYMBOL)
W03-2	48X48	16.00						YIELD AHEAD (SYMBOL)
W03-3	48X48	16.00	3	48.00			12	SIGNAL AHEAD (SYMBOL)
W03-4	48X48	16.00						BE PREPARED TO STOP
W03-5	48X48	16.00						SPEED LIMIT AHEAD
W04-1L	48X48	16.00						MERGE (SYMBOL FROM LEFT)
W04-1R	48X48	16.00						MERGE (SYMBOL FROM RIGHT)
W04-1aL	48X48	16.00	1	16.00			6A	MERGE (LEFT)
W04-1aR	48X48	16.00	1	16.00			6B	MERGE (RIGHT)
W05-1	48X48	16.00						ROAD/BRIDGE/RAMP NARROWS
W05-3	48X48	16.00						ONE LANE BRIDGE
W05-5	48X48	16.00	2	32.00			34	NARROW LANES
W06-1	48X48	16.00						DIVIDED HIGHWAY (SYMBOL)
W06-2	48X48	16.00						DIVIDED HIGHWAY END (SYMBOL)
W06-3	48X48	16.00						TWO WAY TRAFFIC (SYMBOL)
W07-3a	30X24	5.00						NEXT XX MILES (PLAQUE)
W08-1	48X48	16.00						BUMP
W08-2	48X48	16.00						DIP
W08-3	48X48	16.00						PAVEMENT ENDS
W08-4	48X48	16.00						SOFT SHOULDER
W08-5	48X48	16.00						SLIPPERY WHEN WET (SYMBOL)
W08-6	48X48	16.00						TRUCK CROSSING
W08-6c	48X48	16.00						TRUCK ENTRANCE
W08-7	36X36	9.00						LOOSE GRAVEL
W08-7a	36X36	9.00						FRESH OIL / LOOSE GRAVEL
W08-9	48X48	16.00						LOW SHOULDER
W08-11	48X48	16.00						UNEVEN LANES
W08-12	48X48	16.00						NO CENTER LINE
W08-15	48X48	16.00						GROOVED PAVEMENT
W08-15P	30X24	5.00						MOTORCYCLE (PLAQUE)
W08-17L	48X48	16.00						SHOULDER DROP-OFF (SYMBOL LEFT)
W08-17R	48X48	16.00						SHOULDER DROP-OFF (SYMBOL RIGHT)
W08-17P	30X24	5.00						SHOULDER DROP-OFF (PLAQUE)
W10-1	42RND.	9.62						RAILROAD CROSSING
W012-1	24X24	4.00						DOUBLE DOWN ARROW (SYMBOL)
W012-2	48X48	16.00						LOW CLEARANCE (SYMBOL)
W012-2x	24X18	3.00						LOW CLEARANCE (PLAQUE)
W012-2a	84X24	14.00						OVERHEAD LOW CLEARANCE (FEET AND INCHES)
W012-4	120X60	50.00						LOW CLEARANCE XX FT XX IN XX MILES AHEAD
W012-5	120X60	50.00						WIDTH RESTRICTION XX FT XX IN XX MILES AHEAD
W013-1	30X30	6.25						ADVISORY SPEED (PLAQUE)
W016-2	30X24	5.00	2	10.00			20	500 FEET (PLAQUE)
W016-3	30X24	5.00						X MILE (PLAQUE)
W020-1	48X48	16.00	4	64.00			2	ROAD/BRIDGE/RAMP WORK AHEAD
W020-2	48X48	16.00						DETOUR AHEAD
W020-3	48X48	16.00	2	32.00			20	ROAD CLOSED AHEAD
W020-4	48X48	16.00	2	32.00			7	ONE LANE ROAD AHEAD
W020-5	48X48	16.00	2	32.00			4	RIGHT/CENTER/LEFT LANE CLOSED AHEAD
W020-5a	48X48	16.00						2 RIGHT/CENTER/LEFT LANES CLOSED AHEAD
W020-6a	48X48	16.00	2	32.00			5	RIGHT/CENTER/LEFT LANE CLOSED
W020-7a	48X48	16.00						FLAGGER (SYMBOL)
W021-2	36X36	9.00						FRESH OIL
W021-5	48X48	16.00	2	32.00			21	SHOULDER WORK / SHOULDER WORK AHEAD
W022-1	48X48	16.00						BLASTING ZONE AHEAD
W022-2	42X36	10.50						TURN OFF 2-WAY RADIO AND PHONE
W022-3	42X36	10.50						END BLASTING ZONE
GO22-1	21X15	2.19	2	4.02			52	WET PAINT (ARROW PIVOTS)

SIGN	SIZE IN.	AREA SQ.FT.	QTY EACH	TOTAL AREA SQ.FT.	QTY RELOC EACH	TOTAL RELOC SQ.FT.	SIGN NUM.	DESCRIPTION
<b>GUIDE SIGNS</b>								
E05-1	36X48	12.00						GORE EXIT
E05-2	48X36	12.00						EXIT OPEN
E05-2a	48X36	12.00						EXIT CLOSED
GO20-1	60X24	10.00					1	ROAD WORK NEXT 2 MILES
GO20-2	48X24	8.00	6	48.00			26	END ROAD WORK
GO20-4	36X18	4.50						PILOT CAR FOLLOW ME
GO20-4a	42X30	8.75						PILOT CAR IN USE WAIT & FOLLOW
GO20-4a	18X12	1.50						PILOT CAR IN USE WAIT & FOLLOW
GO20-5aP	36X24	6.00						WORK ZONE (PLAQUE)
MO4-8a	24X18	3.00						END DETOUR
MO4-9L	48X36	12.00						DETOUR (LEFT)
MO4-9R	48X36	12.00						DETOUR (RIGHT)
MO4-9P	48X12	4.00						STREET NAME (PLAQUE)
MO4-10L	48X18	6.00						DETOUR ARROW (LEFT)
MO4-10R	48X18	6.00						DETOUR ARROW (RIGHT)
<b>REGULATORY SIGNS</b>								
R1-1	48X48	13.25						STOP
R1-2	48TR1	6.93	1	6.93			13	YIELD
R1-2a	36X36	9.00						TO ONCOMING TRAFFIC (PLAQUE)
R1-3P	30X12	2.50						ALL WAY (PLAQUE)
R2-1	36X48	12.00	4	48.00			4	SPEED LIMIT 2-65 MPH; 2-80 MPH
R3-1	48X48	16.00						NO RIGHT TURN (SYMBOL)
R3-2	48X48	16.00						NO LEFT TURN (SYMBOL)
R3-3	36X36	9.00						NO TURNS
R3-4	48X48	16.00						NO U-TURN (SYMBOL)
R3-7L	30X30	6.25						LEFT LANE MUST TURN LEFT
R3-7R	30X30	6.25						RIGHT LANE MUST TURN RIGHT
R4-1	36X48	12.00						DO NOT PASS
R4-2	36X48	12.00						PASS WITH CARE
R4-7a	36X48	12.00						KEEP RIGHT (HORIZONTAL ARROW)
R4-8a	36X48	12.00						KEEP LEFT (HORIZONTAL ARROW)
R5-1	30X30	6.25						DO NOT ENTER
R5-1a	36X24	6.00						WRONG WAY
R6-1L	54X18	6.75						ONE WAY ARROW (LEFT)
R6-1R	54X18	6.75						ONE WAY ARROW (RIGHT)
R6-2L	24X30	5.00						ONE WAY (LEFT)
R6-2R	24X30	5.00						ONE WAY (RIGHT)
R9-9	24X12	2.00						SIDEWALK CLOSED
R9-11L	24X18	3.00						SIDEWALK CLOSED AHEAD, (ARROW LEFT) CROSS HERE
R9-11R	24X18	3.00						SIDEWALK CLOSED AHEAD, (ARROW RIGHT) CROSS HERE
R10-6	24X36	6.00						STOP HERE ON RED (45° ARROW)
R11-2	48X30	10.00	2	20.00			2	ROAD CLOSED
R11-3a	60X30	12.50						ROAD CLOSED XX MILES AHEAD
R11-4	60X30	12.50						LOCAL TRAFFIC ONLY
CONST-3A	60X48	20.00						ROAD CLOSED TO THRU TRAFFIC
CONST-3X	56X12	4.67						FINE SIGN
<b>MISCELLANEOUS SIGNS</b>								
CONST-5	48X36	12.00						POINT OF PRESENCE
CONST-5	96X48	32.00	2	64.00			71	POINT OF PRESENCE
CONST-8	48X36	12.00	2	24.00			55	WORK ZONE NO PHONE ZONE
WO21-5aL	48X48	16.00	2	32.00			21A-L	LEFT SHOULDER CLOSED
WO21-5aR	48X48	16.00	2	32.00			21A-R	RIGHT SHOULDER CLOSED
WO21-5bL	48X48	16.00	2	32.00			21B-L	LEFT SHOULDER CLOSED AHEAD
WO21-5bR	48X48	16.00	2	32.00			21B-R	RIGHT SHOULDER CLOSED AHEAD
R10-6R	24X36	6.00	2	12.00			47	STOP HERE ON RED (45° ARROW R)
R10-6L	24X36	6.00						STOP HERE ON RED (45° ARROW L)
<b>CONSTRUCTION SIGNS</b>								
						TOTAL		
616-10.05						721		
<b>RELOCATED SIGNS</b>								
						TOTAL		
616-10.10						0		

ITEM NUMBER	TOTAL QTY	DESCRIPTION
6122008		IMPACT ATTENUATOR 40 MPH (SAND BARRELS)
6122009		IMPACT ATTENUATOR 45 MPH (SAND BARRELS)
6122010		IMPACT ATTENUATOR 50 MPH (SAND BARRELS)
6122012		IMPACT ATTENUATOR 55 MPH (SAND BARRELS)
6122014	2	IMPACT ATTENUATOR 60 MPH (SAND BARRELS)
6122017		IMPACT ATTENUATOR 65 MPH (SAND BARRELS)
6122019		IMPACT ATTENUATOR 70 MPH (SAND BARRELS)
6122020	4	REPLACEMENT SAND BARREL
6122030	1	IMPACT ATTENUATOR (RELOCATION)
6123001		TRUCK MOUNTED ATTENUATOR (TMA)
6161008	6	ADVANCED WARNING RAIL SYSTEM
6161012		BUOYS (BOATS KEEP OUT)
6161013		BUOYS (NO WAKE)
6161014		SPECIAL SIGN ASSEMBLY (BOATS KEEP OUT)
6161025	63	CHANNELIZER (TRIM LINE)
6161030	5	TYPE III MOVEABLE BARRICADE
6161033		DIRECTION INDICATOR BARRICADE
6161040	2	FLASHING ARROW PANEL
6161047		TYPE III OBJECT MARKER
6161055		SEQUENTIAL FLASHING WARNING LIGHT
6161070		TUBULAR MARKER
6161095		RADAR SPEED ADVISORY SYSTEM
6161096		CHANGEABLE MESSAGE SIGN, COMMISSION FURNISHED/RETAINED
6161098A		CHANGEABLE MESSAGE SIGN W/O COMM. INTERFACE - CONTRACTOR FURNISHED/RETAINED
6161099	3	CHANGEABLE MESSAGE SIGN WITH COMM. INTERFACE - CONTRACTOR FURNISHED/RETAINED
6162000A	2	WORK ZONE TRAFFIC SIGNAL SYSTEM 3
6162002		TEMPORARY LONG-TERM RUMBLE STRIPS
6173600D	3750	TEMPORARY TRAFFIC BARRIER CONTRACTOR FURNISHED/RETAINED
6173602B		TEMPORARY TRAFFIC BARRIER CONTRACTOR FURNISHED/COMMISSION RETAINED
6174000A		TEMP. TRAFFIC BARRIER HEIGHT TRANSITION
6175010A		RELOCATING TEMPORARY TRAFFIC BARRIER
6176000B		TEMPORARY TRAFFIC BARRIER COMMISSION FURNISHED/

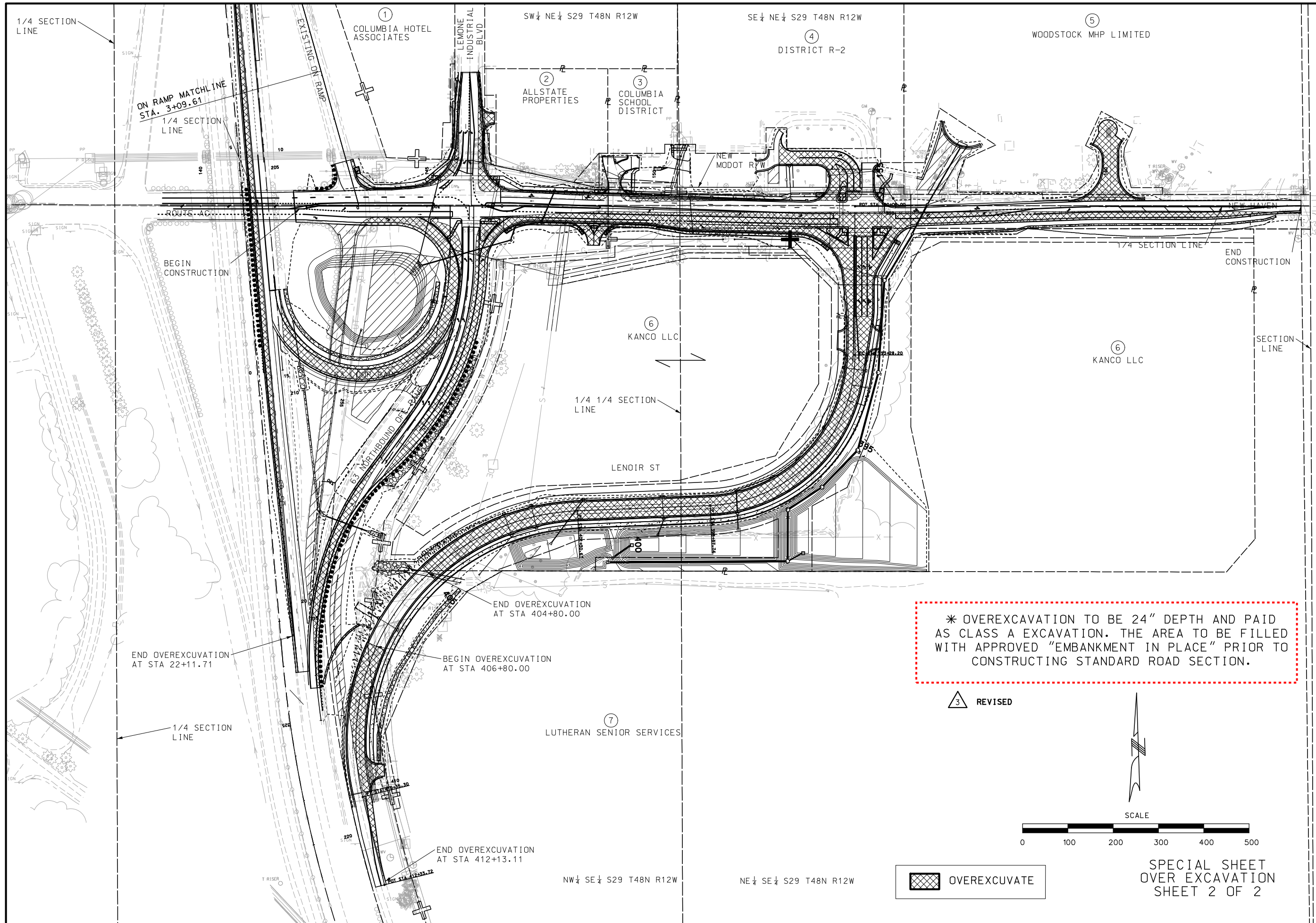

\* OVEREXCAVATION TO BE 24" DEPTH AND PAID AS CLASS A EXCAVATION. THE AREA TO BE FILLED WITH APPROVED "EMBANKMENT IN PLACE" PRIOR TO CONSTRUCTING STANDARD ROAD SECTION.

3 REVISED

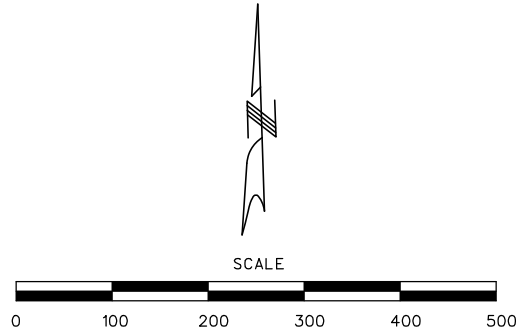

OVEREXCUVATE

SPECIAL SHEET  
OVER EXCAVATION  
SHEET 2 OF 2

DATE PREPARED  
10/14/2024

ROUTE AC	STATE MO
DISTRICT CD	SHEET NO. 59

COUNTY  
BOONE

JOB NO.  
J5P3433

CONTRACT ID.

PROJECT NO.

BRIDGE NO.

DATE	DESCRIPTION
10/14/24	REVISED

MISSOURI HIGHWAYS AND TRANSPORTATION COMMISSION

105 WEST CAPITOL  
JEFFERSON CITY, MO 65102  
1-888-ASK-MODOT (1-888-275-6636)

**Bartlett & West**  
601 MONROE ST., SUITE 201 - JEFFERSON CITY, MO 65101  
PHONE 873-634-5181  
CERTIFICATE OF AUTHORITY NO. 000707 - ENGINEERING  
WWW.BARTLETTWEST.COM