

DESIGN DESIGNATION

EB I-44 AT LITTLE PINEY CREEK
 A.A.D.T. - 2022 = 15,883
 A.A.D.T. - 2042 = 30,178
 T = 42%
 V = 70 M.P.H.
 FUNCTIONAL CLASSIFICATION- INTERSTATE

NO NEW RIGHT OF WAY

MISSOURI HIGHWAYS AND TRANSPORTATION COMMISSION
 CONSTRUCTION PLANS FOR PROPOSED
 STATE HIGHWAY
 PHELPS COUNTY
 S24 T37N R10W



INDEX OF SHEETS

DESCRIPTION	SHEET NUMBER
TITLE SHEET -----	1
TYPICAL SECTIONS (TS) -----	2
QUANTITIES (QU) (2 SHEETS)-----	3
PLAN (PL)-----	4
TRAFFIC CONTROL SHEETS (TC)-----	5-18
BRIDGE DRAWINGS (G04188)-----	1

NAME: STEPHEN SICHMELER
 DISCIPLINE: TRANSPORTATION
 LICENSE NO: 2074017802
 EXPIRATION DATE: 12/31/2024
 DATE PREPARED
11/12/2024
 ROUTE 44 STATE MO
 DISTRICT CD SHEET NO. 1
 COUNTY PHELPS
 JOB NO. J513561
 CONTRACT ID.

PROJECT NO.
 BRIDGE NO.

CONVENTIONAL SYMBOLS
 (USED IN PLANS)

	EXISTING	NEW
BUILDINGS AND STRUCTURES	[Symbol]	[Symbol]
GUARD RAIL	[Symbol]	[Symbol]
GUARD CABLE	[Symbol]	[Symbol]
CONCRETE RIGHT-OF-WAY MARKER	[Symbol]	[Symbol]
STEEL RIGHT-OF-WAY MARKER	[Symbol]	[Symbol]
LOCATION SURVEY MARKER	[Symbol]	[Symbol]
UTILITIES		
FIBER OPTICS	-FO-	-FN-
OVERHEAD CABLE TV	-OTV-	-ONTV-
UNDERGROUND CABLE TV	-UTV-	-UNTV-
OVERHEAD TELEPHONE	-OT-	-ONT-
UNDERGROUND TELEPHONE	-UT-	-UNT-
OVERHEAD POWER	-OE-	-ONE-
UNDERGROUND POWER	-UE-	-UNE-
SANITARY SEWER	-S-	-NS-
STORM SEWER	-SS-	-NSS-
GAS	-G-	-NG-
WATER	-W-	-NW-
MANHOLE	[Symbol]	[Symbol]
FIRE HYDRANT	[Symbol]	[Symbol]
WATER VALVE	[Symbol]	[Symbol]
WATER METER	[Symbol]	[Symbol]
DROP INLET	[Symbol]	[Symbol]
DITCH BLOCK	[Symbol]	[Symbol]
GROUND MOUNTED SIGN	[Symbol]	[Symbol]
LIGHT POLE	[Symbol]	[Symbol]
H-FRAME POWER POLE	[Symbol]	[Symbol]
TELEPHONE PEDESTAL	[Symbol]	[Symbol]
FENCE	[Symbol]	[Symbol]
CHAIN LINK	[Symbol]	[Symbol]
WOVEN WIRE	[Symbol]	[Symbol]
GATE POST	[Symbol]	[Symbol]
BENCHMARK	[Symbol]	[Symbol]

NOTE: DASHED OR OPEN SYMBOLS INDICATE EXISTING FEATURES

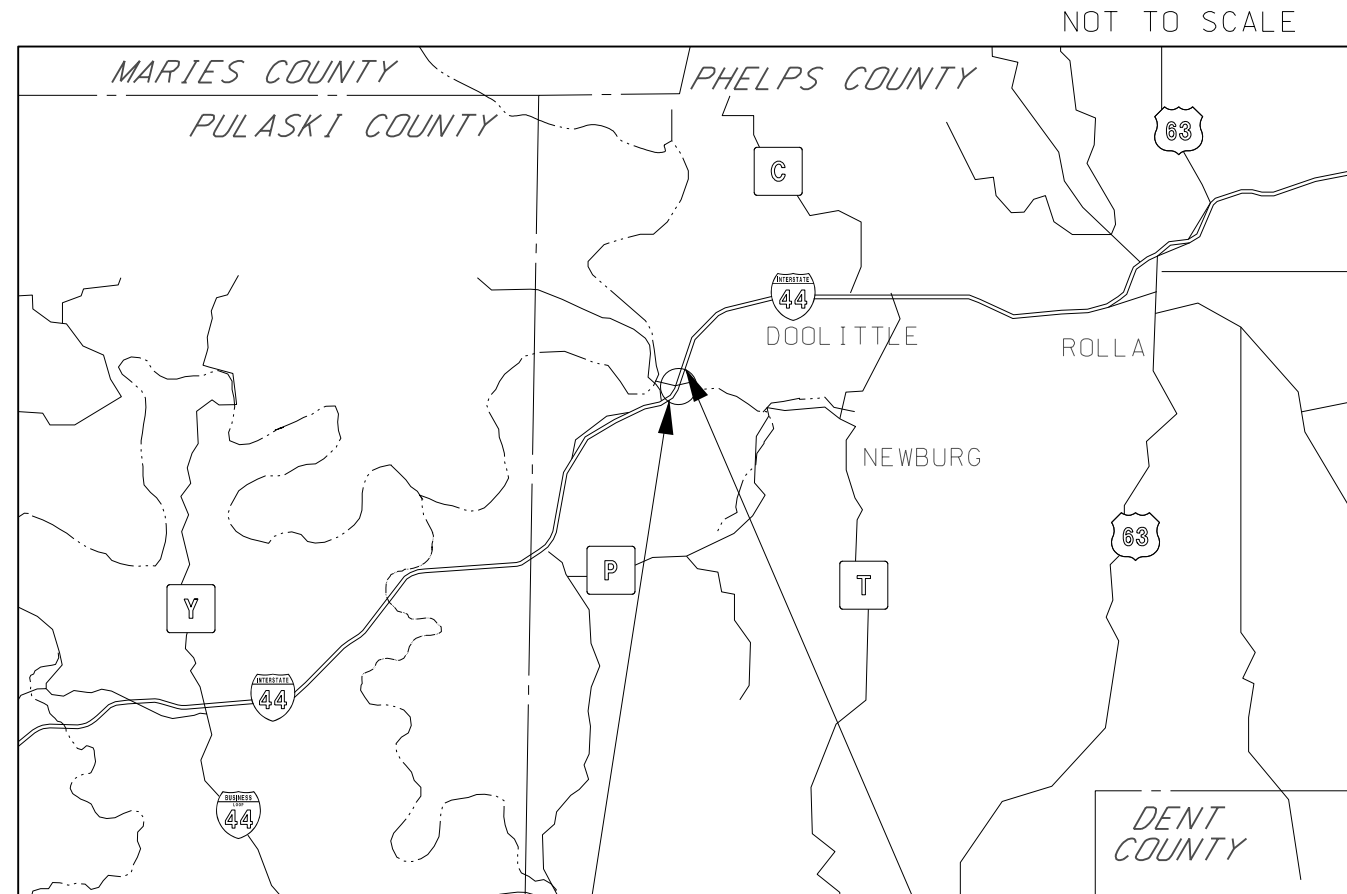

BEGIN PROJECT
 STA. 258+30.97
 END PROJECT
 STA. 278+98.85
 EB I-44 OVER
 LITTLE PINEY
 CREEK
 BRIDGE REPAIRS
 G0418

THE EXISTENCE AND APPROXIMATE LOCATION OF UTILITY FACILITIES KNOWN TO EXIST, AS SHOWN ON THE PLANS, ARE BASED ON THE BEST INFORMATION AVAILABLE TO THE COMMISSION AT THIS TIME. THIS INFORMATION IS PROVIDED BY THE COMMISSION "AS-IS" AND THE COMMISSION EXPRESSLY DISCLAIMS ANY REPRESENTATION OR WARRANTY AS TO THE COMPLETENESS, ACCURACY, OR SUITABILITY OF THE INFORMATION FOR ANY USE. RELIANCE UPON THIS INFORMATION IS DONE AT THE RISK AND PERIL OF THE USER, AND THE COMMISSION SHALL NOT BE LIABLE FOR ANY DAMAGES THAT MAY ARISE FROM ANY ERROR IN THE INFORMATION. IT IS, THEREFORE, THE RESPONSIBILITY OF THE CONTRACTOR TO VERIFY THE EXISTENCE, LOCATION AND STATUS OF ANY FACILITY. SUCH VERIFICATION INCLUDES DIRECT CONTACT WITH THE LISTED UTILITIES.

LENGTH OF PROJECT

BEGINNING OF PROJECT	STA. 258+30.97
END OF PROJECT	STA. 278+98.85
APPARENT LENGTH	2067.88 FEET
EQUATIONS AND EXCEPTIONS:	

TOTAL CORRECTIONS	0.00 FEET
NET LENGTH OF PROJECT	2067.88 FEET
STATE LENGTH	0.392 MILES
FOR INFORMATION ONLY ESTIMATED DISTURBED ACRES	0 ACRES

DATE	DESCRIPTION

MISSOURI HIGHWAYS AND TRANSPORTATION COMMISSION

105 WEST CAPITOL
 JEFFERSON CITY, MO 65102
 1-888-ASK-MODOT (1-888-275-6636)

HORNER SHIFRIN

401 S. 18TH ST., STE. 400 SAINT LOUIS, MO 63103-2286
 314-531-4321 • FAX 314-431-6866 • WWW.HORNERSHIFRIN.COM
 DISCIPLINE: PROFESSIONAL ENGINEERING
 CERTIFICATE OF AUTHORITY: 000159
 EXPIRATION DATE: DECEMBER 31, 2024

IF A SEAL IS PRESENT ON THIS SHEET IT HAS BEEN ELECTRONICALLY SEALED AND DATED.

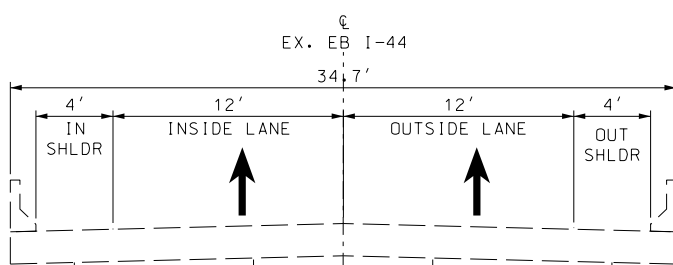

EXISTING TYPICAL SECTION AT EB I-44 OVER LITTLE PINEY CREEK BRIDGE
STA. 264+86.00 TO 275+78.00

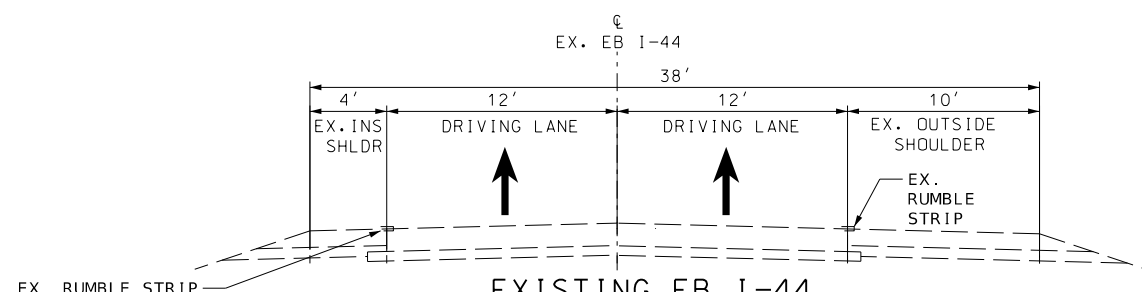

EXISTING EB I-44
OUTSIDE OF LITTLE PINEY RIVER BRIDGE LIMITS
STA. 258+30.97 TO 264+86.00
STA. 275+78.00 TO 278+98.95

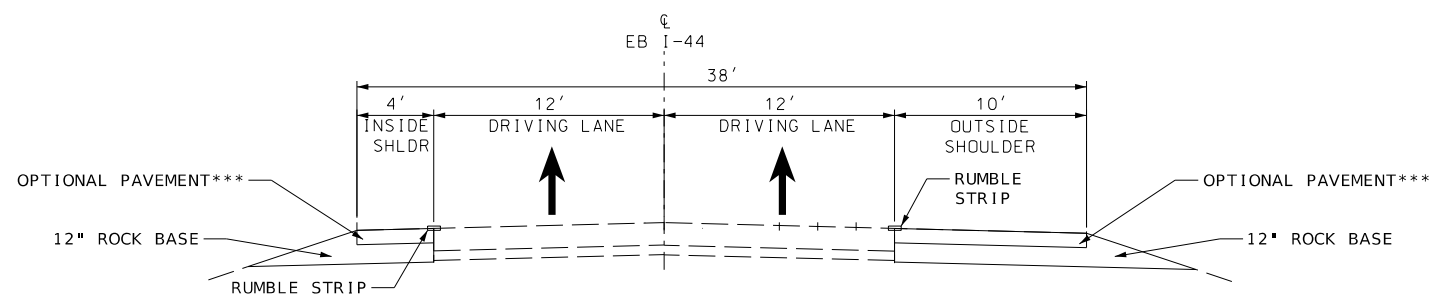

PROPOSED EB I-44 OUTSIDE OF LITTLE PINEY RIVER BRIDGE LIMITS
STA. 258+30.97 TO 264+86.00
STA. 275+78.00 TO 278+98.85
STA. 262+04.30 TO 264+86.00
STA. 275+78.00 TO 277+94.33

***NOTE: SHOULDER OPTIONS CONSIST OF:
9" PCCP WITH 12 FT. JOINT SPACING AND 1.25" DOWELS ON 12" ROCK BASE
OR 2" SP125C WITH PG 70-22 OVER 2" SP125C PG 70-22 OVER 6.5" SP250C
PG 70-22 WITH PG 64-22 ON 12" ROCK BASE

NOT TO SCALE

NAME: STEPHEN SICHMELLER
DISCIPLINE: TRANSPORTATION
LICENSE NO: 2034017802
EXPIRATION DATE: 12/31/2024

DATE PREPARED
11/12/2024

ROUTE STATE
44 MO

DISTRICT SHEET NO.
CD 2

COUNTY
PHELPS

JOB NO.
J513561

CONTRACT ID.

PROJECT NO.

BRIDGE NO.

DESCRIPTION	DATE

DESCRIPTION	DATE

MISSOURI HIGHWAYS AND TRANSPORTATION COMMISSION



105 WEST CAPITOL
JEFFERSON CITY, MO 65102
1-888-ASK-MODOT (1-888-273-6636)

HORNER SHIFRIN

401 S. 18TH ST., STE. 400 SAINT LOUIS, MO 63103-2296
314-531-4321 • FAX 314-431-6866 • WWW.HORNERSHIFRIN.COM
DISCIPLINE: PROFESSIONAL ENGINEERING
CERTIFICATE OF AUTHORITY: 000159
EXPIRATION DATE: DECEMBER 31, 2024

I-44
TYPICAL SECTIONS
SHEET 1 OF 1

IF A SEAL IS PRESENT ON THIS SHEET IT HAS BEEN ELECTRONICALLY SEALED AND DATED.

MOBILIZATION
LUMP SUM = 1

REMOVAL OF IMPROVEMENTS					
STATION	STATION	LOCATION	SIDE	REMOVALS	REMARKS
258+30.97	264+86.00	I-44 EB	RIGHT	648 SY SHOULDER	STAGE 1
275+78.00	278+98.85	I-44 EB	RIGHT	360 SY SHOULDER	STAGE 1
262+04.30	264+86.00	I-44 EB	LEFT	124 SY SHOULDER	STAGE 2
275+78.00	277+94.33	I-44 EB	LEFT	96 SY SHOULDER	STAGE 2
TOTAL =				1.0 LUMP SUM	

OPTIONAL PAVEMENT									
STATION	STATION	LOCATION	SIDE	OPTIONAL PAVEMENT	FURNISHING ROCK BASE MATERIAL	PLACING ROCK BASE (12 IN. THICK)	OPTIONAL SHOULDER RUMBLE STRIP	SUBGRADING AND SHOULDERING CLASS 1	REMARKS
				SY	SY	SY	STA	100 FT	
258+30.97	264+86.00	I-44 EB	RIGHT	647.9	647.9	647.9	6.6	6.6	STAGE 1
275+78.00	278+98.85	I-44 EB	RIGHT	360.1	360.1	360.1	3.2	3.2	STAGE 1
262+04.30	264+86.00	I-44 EB	LEFT	124.0	124.0	124.0	2.8	2.8	STAGE 2
275+78.00	277+94.33	I-44 EB	LEFT	96.0	96.0	96.0	2.2	2.2	STAGE 2
TOTALS				1228.0	1228.0	1228.0	14.8	14.8	
PAY TOTALS				1228	1228	1228	15	15	

PAVEMENT MARKING									
STATION	STATION	LOCATION	SIDE	HIGH BUILD WATERBORNE PAINT WITH TYPE L BEADS		PAVEMENT MARKING REMOVAL	4 IN. WHITE TEMPORARY MARKING PAINT	4 IN. YELLOW TEMPORARY MARKING PAINT	REMARKS
				6" WHITE	6" YELLOW				
				LENGTH (LF)	LENGTH (LF)				
245+46.30	280+98.00	I-44 EB - Stage 2				210		3552	Remove I.W for 840' taper
258+30.97	279+95.70	I-44 EB - Stage 2				2165	2165		Remove S.W.
245+46.30	253+86.30	I-44 EB - Stage 3					210		Replace I.W removed in Stage 2
255+12.24	277+94.30	I-44 EB - Stage 3				210	2282		Remove I.W for 840' taper
262+04.30	277+94.30	I-44 EB - Stage 3				1590		1590	Remove S.Y.
262+04.30	277+94.30	I-44 EB	LEFT		1590				Left Edge Line
245+46.30	263+52.24	I-44 EB	CENTER	451					Dashed Lane Line
258+30.97	279+95.70	I-44 EB	RIGHT	2165					Right Edge Line
TOTALS				2616	1590	4175	4657	5142	
PAY TOTALS				2616	1590	4175	9799		

*CONTRAST MARKING WILL BE REQUIRED FOR THE CONCRETE PAVEMENT MARKING OPTION AT NO DIRECT PAY.

I - 44
QUANTITIES
SHEET 1 OF 2

NAME: STEPHEN SICHMELLER DISCIPLINE: TRANSPORTATION LICENSE NO: 2024017802 EXPIRATION DATE: 12/31/2024 DATE PREPARED: 11/12/2024	
ROUTE 44	STATE MO
DISTRICT CD	SHEET NO. 3
COUNTY PHELPS	
JOB NO. J513561	
CONTRACT ID.	
PROJECT NO.	
BRIDGE NO.	
DESCRIPTION	DATE
MISSOURI HIGHWAYS AND TRANSPORTATION COMMISSION	
 105 WEST CAPITOL JEFFERSON CITY, MO 65102 1-888-ASK-MODOT (1-888-275-6636)	
HORNER SHIFERIN 401 S. 18TH ST., STE. 400 SAINT LOUIS, MO 63103-2296 314-531-4321 • FAX 314-431-6866 • WWW.HORNERSHIFERIN.COM DISCIPLINE: PROFESSIONAL ENGINEERING CERTIFICATE OF AUTHORITY: 000159 EXPIRATION DATE: DECEMBER 31, 2024	

IF A SEAL IS PRESENT ON THIS SHEET IT HAS BEEN ELECTRONICALLY SEALED AND DATED.

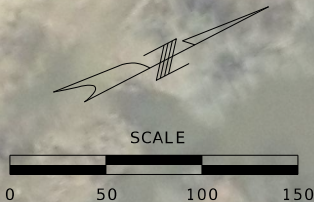
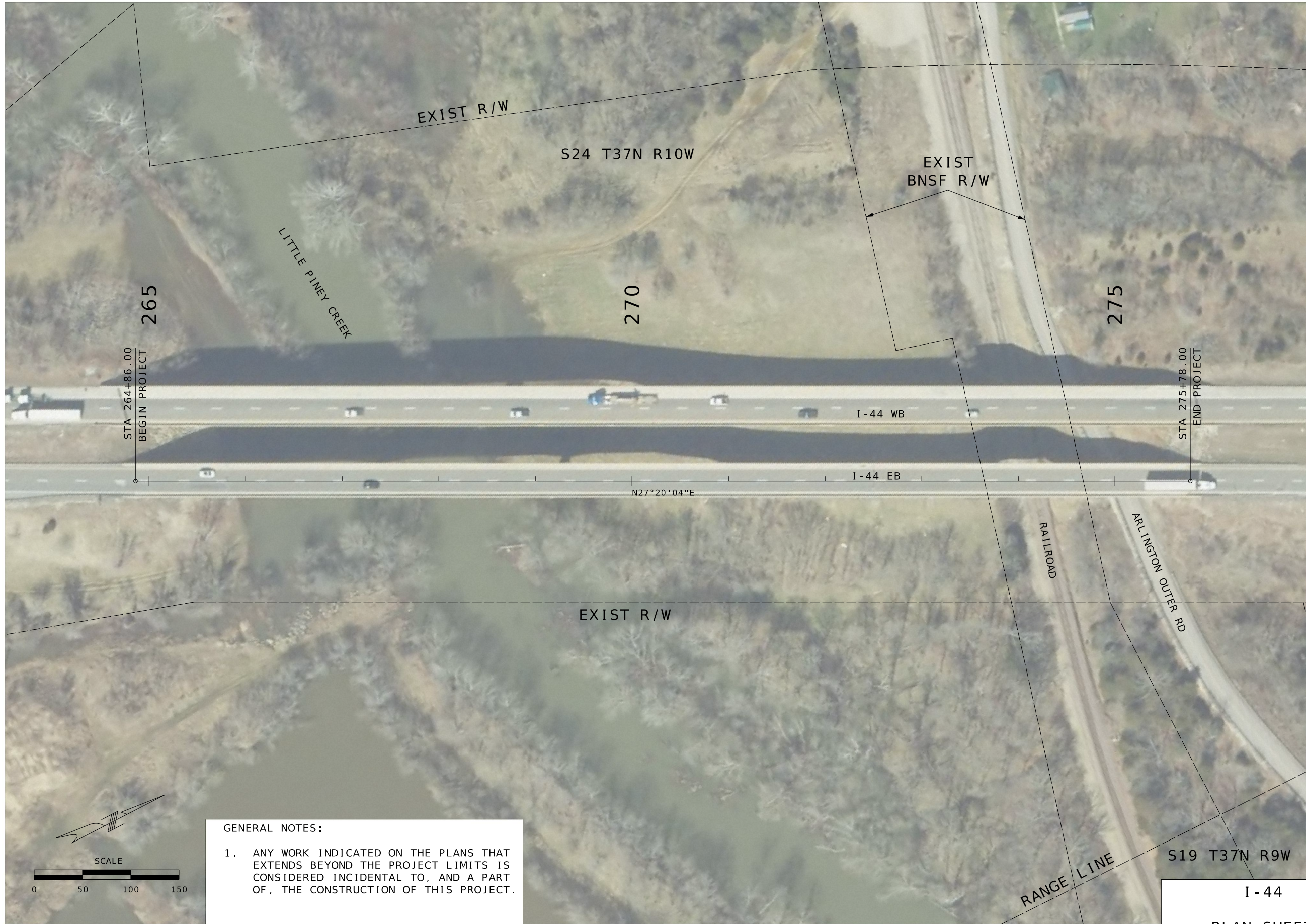

GENERAL NOTES:

1. ANY WORK INDICATED ON THE PLANS THAT EXTENDS BEYOND THE PROJECT LIMITS IS CONSIDERED INCIDENTAL TO, AND A PART OF, THE CONSTRUCTION OF THIS PROJECT.

I - 44
PLAN SHEET
SHEET 1 OF 1

NAME: STEPHEN SICHMELLER
 DISCIPLINE: TRANSPORTATION
 LICENSE NO: 203401783
 EXPIRATION DATE: 12/31/2024
 DATE PREPARED
 11/12/2024
 ROUTE 44 STATE MO
 DISTRICT CD SHEET NO. 4
 COUNTY PHELPS
 JOB NO. J513561
 CONTRACT ID.

PROJECT NO.
 BRIDGE NO.

DATE	DESCRIPTION

MISSOURI HIGHWAYS AND TRANSPORTATION COMMISSION

 105 WEST CAPITOL
 JEFFERSON CITY, MO 65102
 1-888-ASK-MODOT (1-888-273-6636)

HORNER SHIFERIN

 401 S. 18TH ST., STE. 400 SAINT LOUIS, MO 63103-2296
 314-531-4321 • FAX 314-431-6866 • WWW.HORNERSHIFERIN.COM
 DISCIPLINE: PROFESSIONAL ENGINEERING
 CERTIFICATE OF AUTHORITY: 000159
 EXPIRATION DATE: DECEMBER 31, 2024

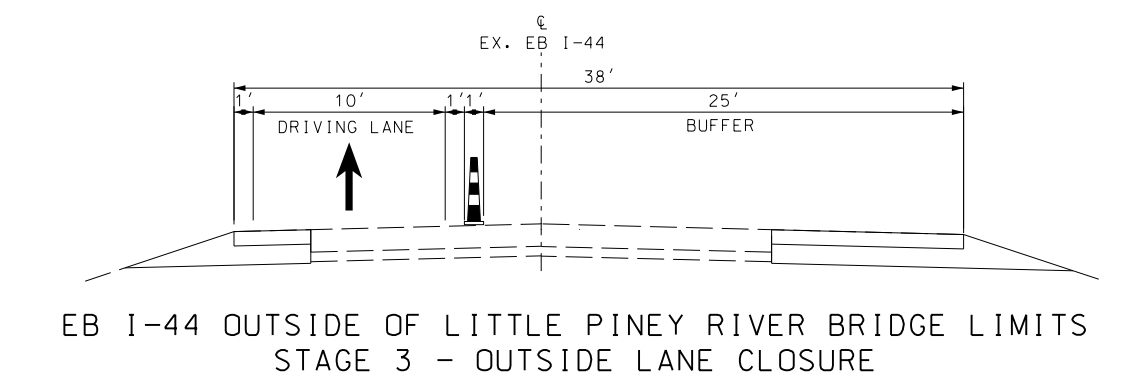
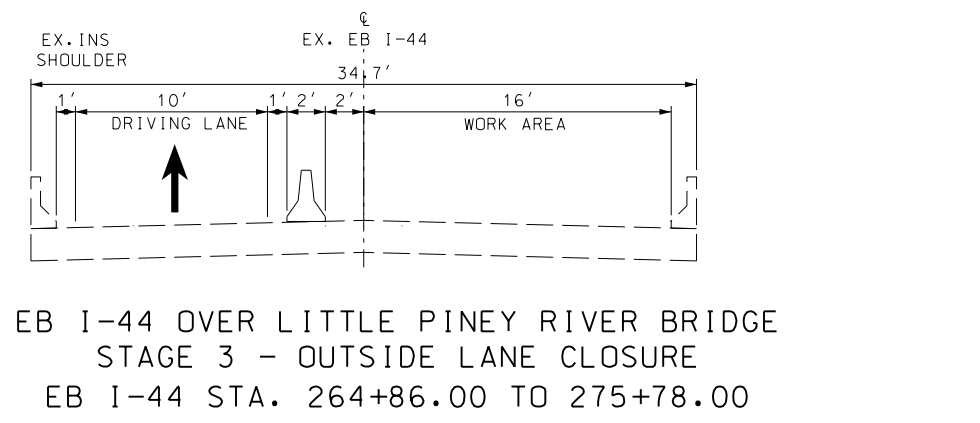
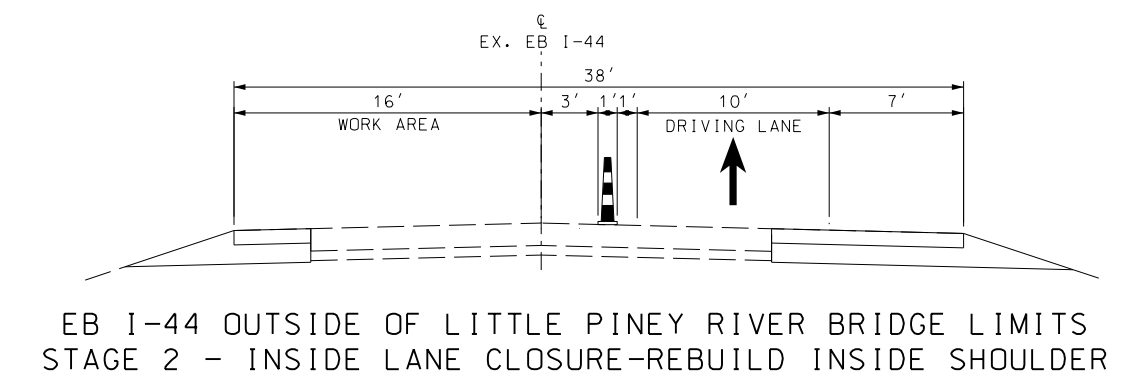
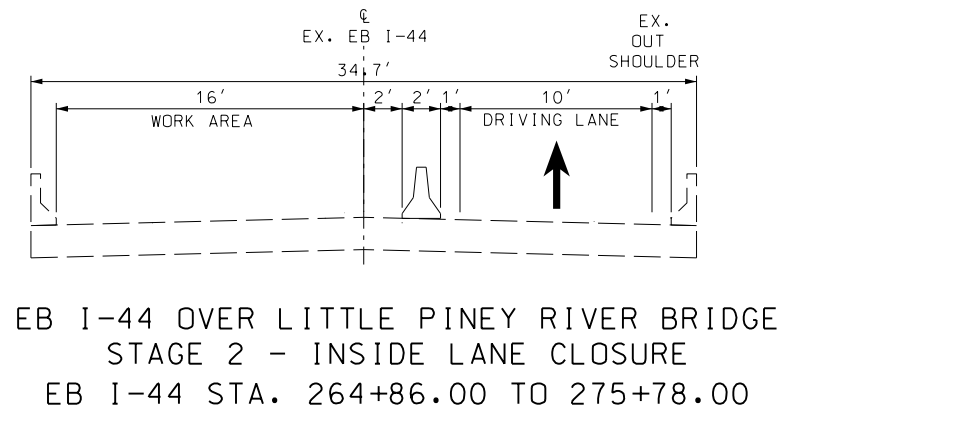
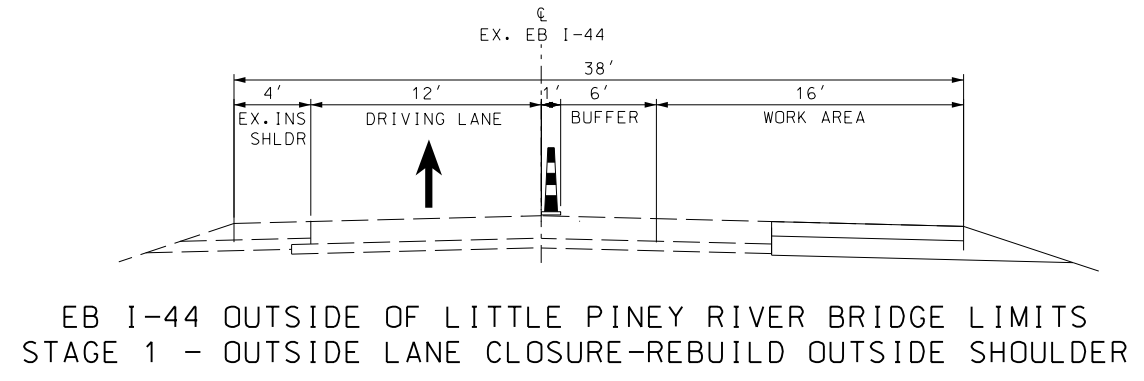
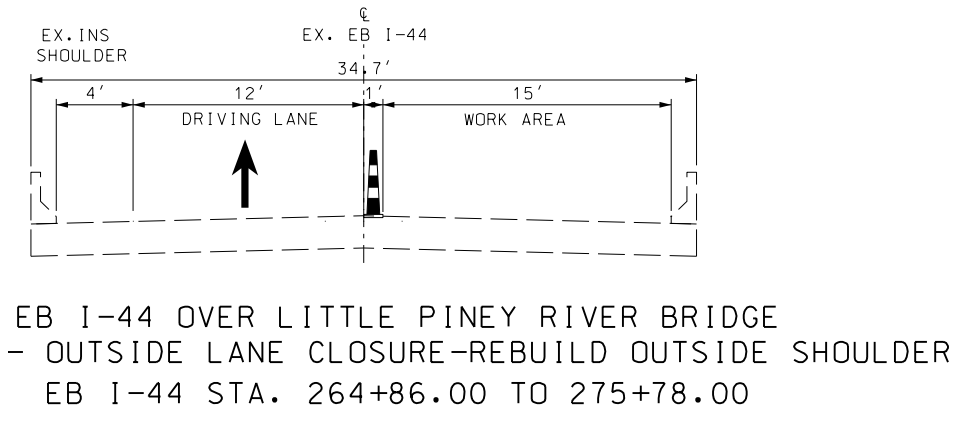
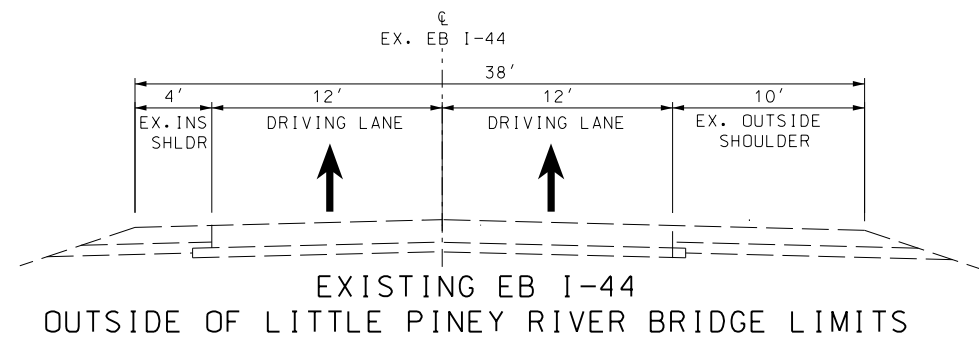
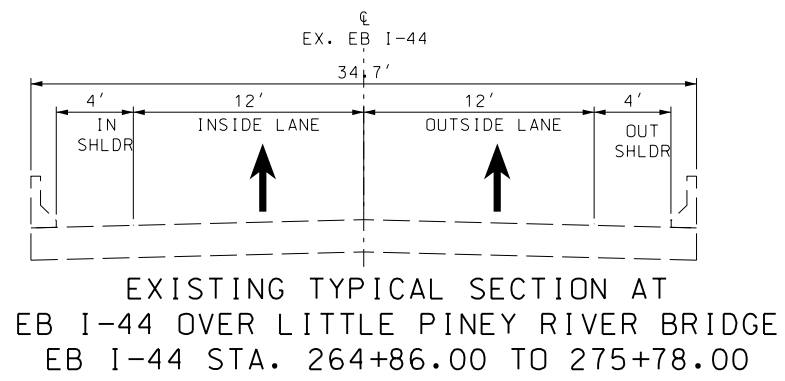
IF A SEAL IS PRESENT ON THIS SHEET IT HAS BEEN ELECTRONICALLY SEALED AND DATED.



NOT TO SCALE

I-44
TRAFFIC CONTROL
TYPICAL SECTIONS
SHEET 1 OF 14

NAME: STEPHEN SICHMELLER DISCIPLINE: TRANSPORTATION LICENSE NO: 2024017802 EXPIRATION DATE: 12/31/2024	
DATE PREPARED 11/12/2024	
ROUTE 44	STATE MO
DISTRICT CD	SHEET NO. 5
COUNTY PHELPS	
JOB NO. J513561	
CONTRACT ID.	
PROJECT NO.	
BRIDGE NO.	
DESCRIPTION	DATE
MISSOURI HIGHWAYS AND TRANSPORTATION COMMISSION	105 WEST CAPITOL JEFFERSON CITY, MO 65102 1-888-ASK-MODOT (1-888-275-6636)
HORNER SHIFRIN	401 S. 18TH ST., STE. 400 SAINT LOUIS, MO 63103-2296 314-531-4321 • FAX 314-431-6866 • WWW.HORNERSHIFRIN.COM DISCIPLINE: PROFESSIONAL ENGINEERING CERTIFICATE OF AUTHORITY: 000159 EXPIRATION DATE: DECEMBER 31, 2024

IF A SEAL IS PRESENT ON THIS SHEET IT HAS BEEN ELECTRONICALLY SEALED AND DATED.



WO20 - 1

2



GO20 - 5aP

54



R2 - 1

4



WO20 - 5

5

OR
LEFT LANE



WO20 - 6a

6

OR
LEFT



WO4 - 1aL

6A

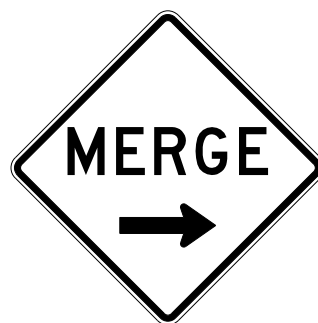

WO4 - 1aR

6B

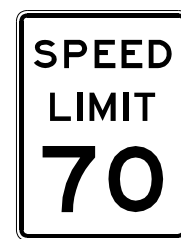

R2 - 1





25



WO5 - 1

43

TRAFFIC CONTROL LEGEND

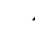
-  SIGN (SINGLE SIDED)
-  WORK AREA
-  CHANNELIZER (TRIM-LINE) WITH LIGHT
-  FLASHING ARROW PANEL
-  DIRECTIONAL INDICATOR BARRICADES WITH SEQUENTIAL FLASHING WARNING LIGHTS

GENERAL NOTES:

- 1) ALL SIGNING AND ANY REQUIRED TRAFFIC CONTROL SHALL BE IN ACCORDANCE WITH THE CURRENT EDITION OF THE MANUAL ON UNIFORM TRAFFIC CONTROL DEVICES.
- 2) SIGN LOCATIONS TO BE APPROVED BY ENGINEER.
- 3) DISTANCE MAY BE ADJUSTED ACCORDING TO FIELD CONDITIONS WITH PERMISSION OF THE ENGINEER.
- 4) ANY EXISTING SIGNS THAT CONFLICT WITH TEMPORARY TRAFFIC CONTROL SHALL BE COVERED OR REMOVED.
- 5) ALL TRAFFIC CONTROL ITEMS WHICH ARE NOT INCLUDED IN THE PAY ITEMS ARE TO BE CONSIDERED INCIDENTAL.
- 6) NO DIRECT PAYMENT WILL BE MADE FOR RELOCATION OF TCP SIGNS AND DEVICES.

NAME: STEPHEN SICHMELER
DISCIPLINE: TRANSPORTATION
LICENSE NO: 2024017802
EXPIRATION DATE: 12/31/2024

DATE PREPARED
11/12/2024

ROUTE STATE
44 MO

DISTRICT SHEET NO.
CD 6

COUNTY
PHELPS

JOB NO.
J513561

CONTRACT ID.

PROJECT NO.

BRIDGE NO.

DESCRIPTION

DATE

MISSOURI HIGHWAYS AND TRANSPORTATION
COMMISSION

105 WEST CAPITOL
JEFFERSON CITY, MO 65102
1-888-ASK-MODOT (1-888-273-6636)



HORNER
SHIFRIN

401 S. 18TH ST., STE. 400 SAINT LOUIS, MO 63103-2296
314-531-4321 • FAX 314-431-6866 • WWW.HORNERSHIFRIN.COM
DISCIPLINE: PROFESSIONAL ENGINEERING
CERTIFICATE OF AUTHORITY: 000159
EXPIRATION DATE: DECEMBER 31, 2024

I - 44
TRAFFIC CONTROL

SHEET 2 OF 14

IF A SEAL IS PRESENT ON THIS SHEET IT HAS BEEN ELECTRONICALLY SEALED AND DATED.



NOTES:
 SEE JOB SPECIAL PROVISION FOR RESTRICTIONS.
 SEE SHEET 6 FOR LEGEND, SIGN DETAILS, AND GENERAL NOTES.

**STAGE 1: OUTSIDE LANE CLOSURE ON EB I-44 FOR EB I-44 OVER LITTLE PINEY CREEK BRIDGE REPAIRS
 MAINTAIN ONE LANE OF TRAFFIC ON EB I-44.**

I - 44
TRAFFIC CONTROL
SHEET 3 OF 14

NAME: STEPHEN SICHMELLER
 DISCIPLINE: TRANSPORTATION
 LICENSE NO: 203401782
 EXPIRATION DATE: 12/31/2024
 DATE PREPARED
11/12/2024
 ROUTE STATE
44 MO
 DISTRICT SHEET NO.
CD 7
 COUNTY
PHELPS
 JOB NO.
J513561
 CONTRACT ID.

PROJECT NO.

BRIDGE NO.

DATE	DESCRIPTION

MISSOURI HIGHWAYS AND TRANSPORTATION
 COMMISSION



105 WEST CAPITOL
 JEFFERSON CITY, MO 65102
 1-888-ASK-MODOT (1-888-273-6636)



401 S. 18TH ST., STE. 400 SAINT LOUIS, MO 63103-2296
 314-531-4321 • FAX 314-431-6866 • WWW.HORNERSHIFFRIN.COM
 DISCIPLINE: PROFESSIONAL ENGINEERING
 CERTIFICATE OF AUTHORITY: 000159
 EXPIRATION DATE: DECEMBER 31, 2024

IF A SEAL IS PRESENT ON THIS SHEET IT HAS BEEN ELECTRONICALLY SEALED AND DATED.

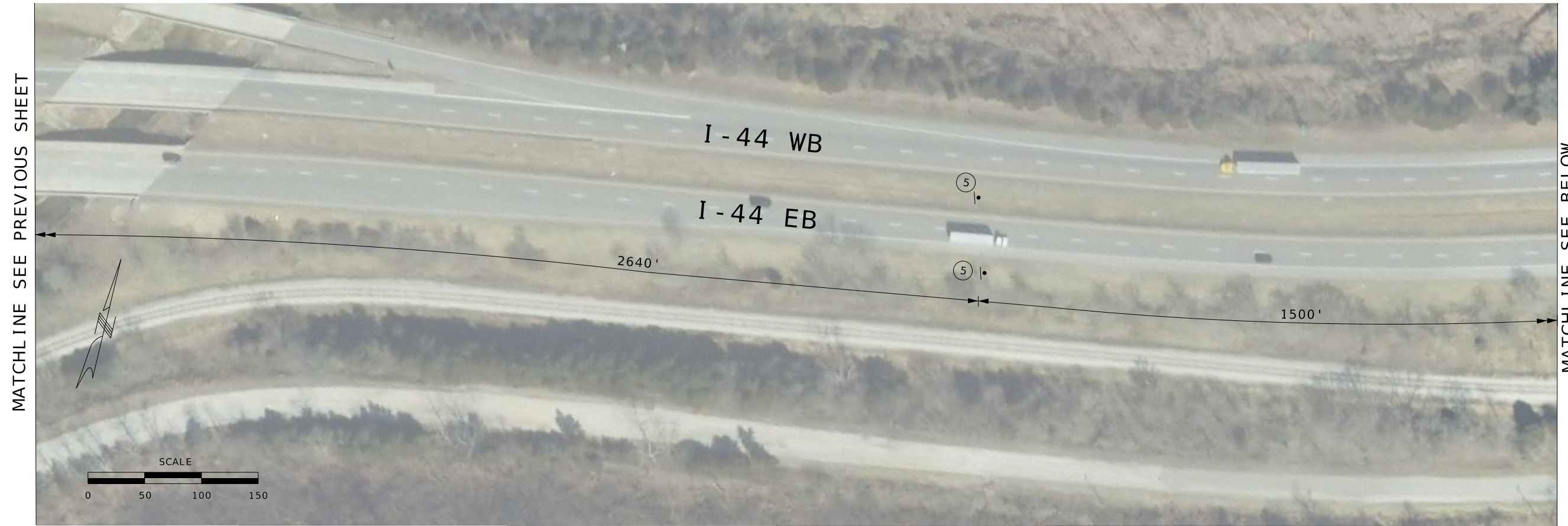

NOTES:
 SEE JOB SPECIAL PROVISION FOR RESTRICTIONS.
 SEE SHEET 6 FOR LEGEND, SIGN DETAILS, AND GENERAL NOTES.

**STAGE 1: OUTSIDE LANE CLOSURE ON EB I-44 FOR EB I-44 OVER LITTLE PINEY CREEK BRIDGE REPAIRS
 MAINTAIN ONE LANE OF TRAFFIC ON EB I-44.**

I - 44
TRAFFIC CONTROL
SHEET 4 OF 14

NAME: STEPHEN SICHMELLER
 DISCIPLINE: TRANSPORTATION
 LICENSE NO: 2034017802
 EXPIRATION DATE: 12/31/2024

DATE PREPARED
11/12/2024

ROUTE STATE
44 MO

DISTRICT SHEET NO.
CD 8

COUNTY
PHELPS

JOB NO.
J513561

CONTRACT ID.

PROJECT NO.

BRIDGE NO.

DATE	DESCRIPTION

MISSOURI HIGHWAYS AND TRANSPORTATION COMMISSION

105 WEST CAPITOL
 JEFFERSON CITY, MO 65102
 1-888-ASK-MODOT (1-888-275-6636)

HORNER SHIFRIN

401 S. 18TH ST., STE. 400 SAINT LOUIS, MO 63103-2296
 314-531-4321 • FAX 314-431-6866 • WWW.HORNERSHIFRIN.COM
 DISCIPLINE: PROFESSIONAL ENGINEERING
 CERTIFICATE OF AUTHORITY: 000159
 EXPIRATION DATE: DECEMBER 31, 2024

IF A SEAL IS PRESENT ON THIS SHEET IT HAS BEEN ELECTRONICALLY SEALED AND DATED.



NOTES:
 SEE JOB SPECIAL PROVISION FOR RESTRICTIONS.
 SEE SHEET 6 FOR LEGEND, SIGN DETAILS, AND GENERAL NOTES.
 ALL DIRECTIONAL INDICATOR BARRICADES SHALL INCLUDE SEQUENTIAL FLASHING WARNING LIGHTS.

STAGE 1: OUTSIDE LANE CLOSURE ON EB I-44 FOR EB I-44 OVER LITTLE PINEY CREEK BRIDGE REPAIRS
 MAINTAIN ONE LANE OF TRAFFIC ON EB I-44.

I - 44
 TRAFFIC CONTROL
 SHEET 5 OF 14

NAME: STEPHEN SICHMELLER DISCIPLINE: TRANSPORTATION LICENSE NO: 2024017802 EXPIRATION DATE: 12/31/2024	
DATE PREPARED 11/12/2024	
ROUTE 44	STATE MO
DISTRICT CD	SHEET NO. 9
COUNTY PHELPS	
JOB NO. J513561	
CONTRACT ID.	
PROJECT NO.	
BRIDGE NO.	
DATE	DESCRIPTION
MISSOURI HIGHWAYS AND TRANSPORTATION COMMISSION 	
105 WEST CAPITOL JEFFERSON CITY, MO 65102 1-888-ASK-MODOT (1-888-273-6636)	
401 S. 18TH ST., STE. 400 SAINT LOUIS, MO 63103-2296 314-531-4321 • FAX 314-431-6866 • WWW.HORNORSHIFFRIN.COM DISCIPLINE: PROFESSIONAL ENGINEERING CERTIFICATE OF AUTHORITY: 000159 EXPIRATION DATE: DECEMBER 31, 2024	

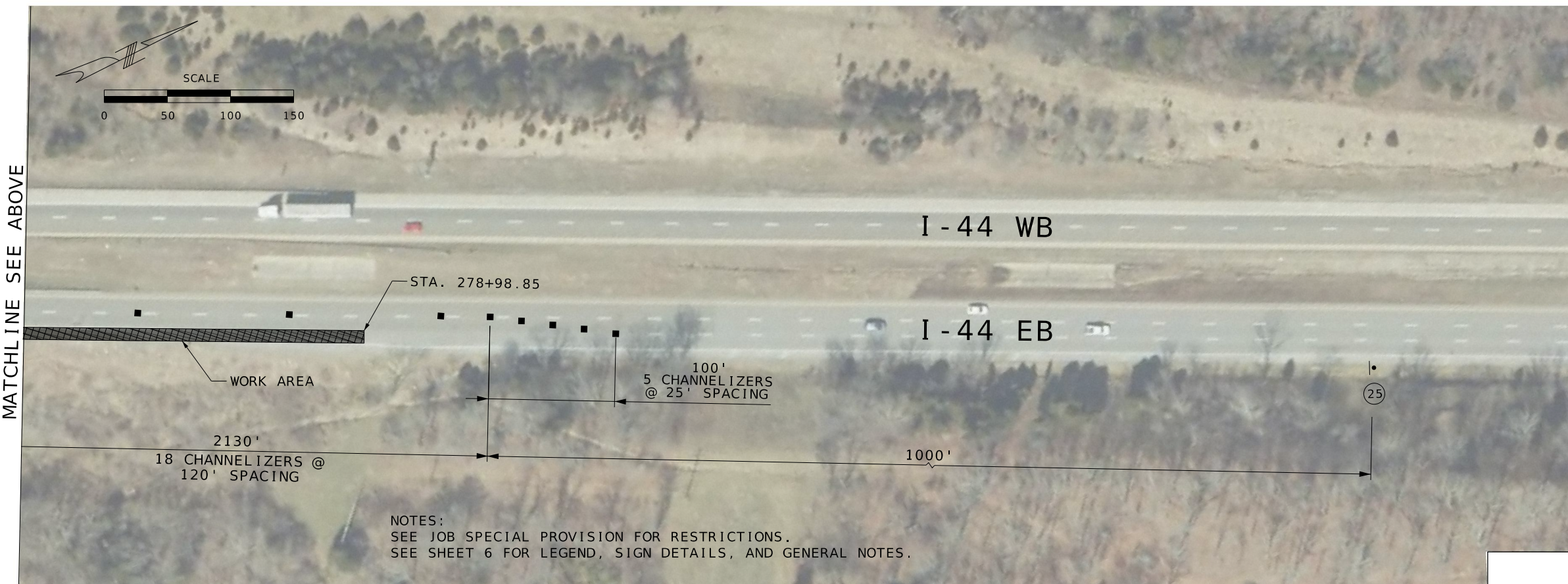
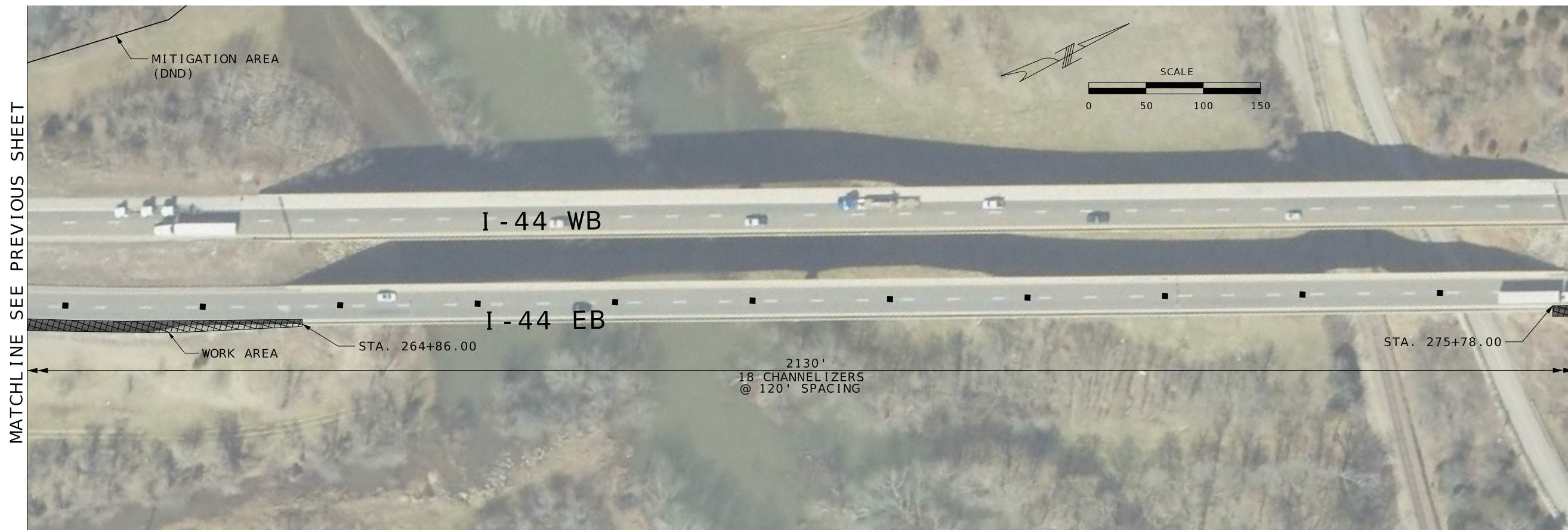

IF A SEAL IS PRESENT ON THIS SHEET IT HAS BEEN ELECTRONICALLY SEALED AND DATED.



NOTES:
 SEE JOB SPECIAL PROVISION FOR RESTRICTIONS.
 SEE SHEET 6 FOR LEGEND, SIGN DETAILS, AND GENERAL NOTES.

STAGE 1: OUTSIDE LANE CLOSURE ON EB I-44 FOR EB I-44 OVER LITTLE PINEY CREEK BRIDGE REPAIRS
 MAINTAIN ONE LANE OF TRAFFIC ON EB I-44.

I - 44
 TRAFFIC CONTROL
 SHEET 6 OF 14

NAME: STEPHEN SICHMELER DISCIPLINE: TRANSPORTATION LICENSE NO: 2024017802 EXPIRATION DATE: 12/31/2024	
DATE PREPARED: 11/12/2024	
ROUTE: 44	STATE: MO
DISTRICT: CD	SHEET NO.: 10
COUNTY: PHELPS	
JOB NO.: J513561	
CONTRACT ID.:	
PROJECT NO.:	
BRIDGE NO.:	
DATE	DESCRIPTION
MISSOURI HIGHWAYS AND TRANSPORTATION COMMISSION  105 WEST CAPITOL JEFFERSON CITY, MO 65102 1-888-ASK-MODOT (1-888-273-6636)	
 401 S. 18TH ST., STE. 400 SAINT LOUIS, MO 63103-2296 314-531-4321 • FAX 314-431-6866 • WWW.HORNERSHIFFRIN.COM DISCIPLINE: PROFESSIONAL ENGINEERING CERTIFICATE OF AUTHORITY: 000159 EXPIRATION DATE: DECEMBER 31, 2024	

IF A SEAL IS PRESENT ON THIS SHEET IT HAS BEEN ELECTRONICALLY SEALED AND DATED.

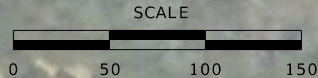

MATCHLINE SEE BELOW

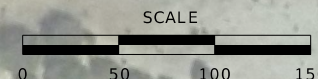

MATCHLINE SEE ABOVE

MATCHLINE SEE NEXT SHEET

NOTES:
SEE JOB SPECIAL PROVISION FOR RESTRICTIONS.
SEE SHEET 6 FOR LEGEND, SIGN DETAILS, AND GENERAL NOTES.

**STAGE 2: INSIDE LANE CLOSURE ON EB I-44 FOR EB I-44 OVER LITTLE PINEY CREEK BRIDGE REPAIRS
MAINTAIN ONE LANE OF TRAFFIC ON EB I-44.**

I - 44
TRAFFIC CONTROL
SHEET 7 OF 14

NAME: STEPHEN SICHMELLER
DISCIPLINE: TRANSPORTATION
LICENSE NO: 202401782
EXPIRATION DATE: 12/31/2024
DATE PREPARED
11/12/2024
ROUTE: **44** STATE: **MO**
DISTRICT: **CD** SHEET NO.: **11**
COUNTY: **PHELPS**
JOB NO.: **J513561**
CONTRACT ID.:

PROJECT NO.:
BRIDGE NO.:

DATE	DESCRIPTION

MISSOURI HIGHWAYS AND TRANSPORTATION COMMISSION
MoDOT
105 WEST CAPITOL
JEFFERSON CITY, MO 65102
1-888-ASK-MODOT (1-888-275-6636)

HORNER SHIFFRIN
401 S. 18TH ST., STE. 400 SAINT LOUIS, MO 63103-2296
314-531-4321 • FAX 314-431-6866 • WWW.HORNERSHIFFRIN.COM
DISCIPLINE: PROFESSIONAL ENGINEERING
CERTIFICATE OF AUTHORITY: 000159
EXPIRATION DATE: DECEMBER 31, 2024

IF A SEAL IS PRESENT ON THIS SHEET IT HAS BEEN ELECTRONICALLY SEALED AND DATED.



NOTES:
 SEE JOB SPECIAL PROVISION FOR RESTRICTIONS.
 SEE SHEET 6 FOR LEGEND, SIGN DETAILS, AND GENERAL NOTES.

STAGE 2: INSIDE LANE CLOSURE ON EB I-44 FOR EB I-44 OVER LITTLE PINEY CREEK BRIDGE REPAIRS
 MAINTAIN ONE LANE OF TRAFFIC ON EB I-44.

I - 44
 TRAFFIC CONTROL
 SHEET 8 OF 14

NAME: STEPHEN SICHMELLER
 DISCIPLINE: TRANSPORTATION
 LICENSE NO: 2024017802
 EXPIRATION DATE: 12/31/2024
 DATE PREPARED
 11/12/2024
 ROUTE STATE
 44 MO
 DISTRICT SHEET NO.
 CD 12
 COUNTY
 PHELPS
 JOB NO.
 J513561
 CONTRACT ID.

PROJECT NO.
 BRIDGE NO.

DATE	DESCRIPTION

MISSOURI HIGHWAYS AND TRANSPORTATION
 COMMISSION
 MoDOT
 105 WEST CAPITOL
 JEFFERSON CITY, MO 65102
 1-888-ASK-MODOT (1-888-273-6636)

HORNER SHIFERIN
 401 S. 18TH ST., STE. 400 SAINT LOUIS, MO 63103-2296
 314-531-4321 • FAX 314-431-6866 • WWW.HORNERSHIFERIN.COM
 DISCIPLINE: PROFESSIONAL ENGINEERING
 CERTIFICATE OF AUTHORITY: 000159
 EXPIRATION DATE: DECEMBER 31, 2024

IF A SEAL IS PRESENT ON THIS SHEET IT HAS BEEN ELECTRONICALLY SEALED AND DATED.



MATCHLINE SEE PREVIOUS SHEET

MATCHLINE SEE BELOW

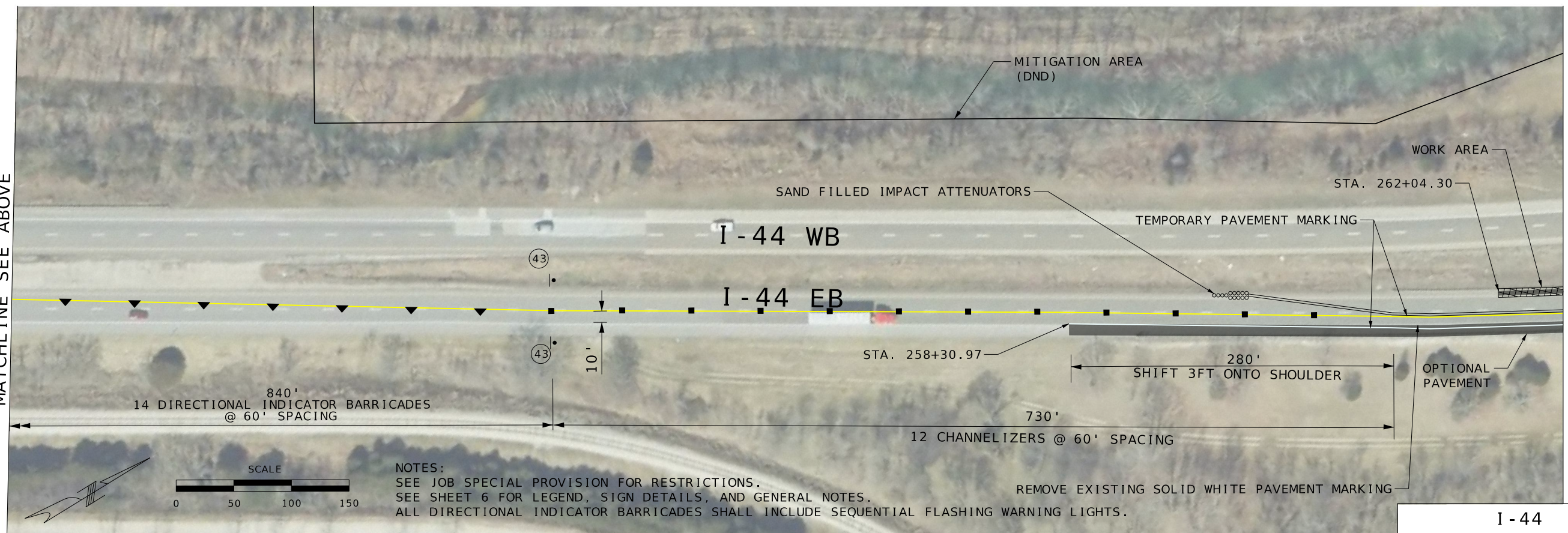
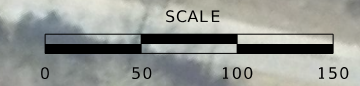

MATCHLINE SEE ABOVE

MATCHLINE SEE NEXT SHEET

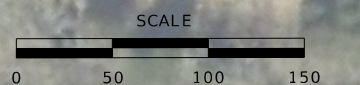

NOTES:
 SEE JOB SPECIAL PROVISION FOR RESTRICTIONS.
 SEE SHEET 6 FOR LEGEND, SIGN DETAILS, AND GENERAL NOTES.
 ALL DIRECTIONAL INDICATOR BARRICADES SHALL INCLUDE SEQUENTIAL FLASHING WARNING LIGHTS.

STAGE 2: INSIDE LANE CLOSURE ON EB I-44 FOR EB I-44 OVER LITTLE PINEY CREEK BRIDGE REPAIRS
 MAINTAIN ONE LANE OF TRAFFIC ON EB I-44.

I - 44
 TRAFFIC CONTROL
 SHEET 9 OF 14

NAME: STEPHEN SCHMELER DISCIPLINE: TRANSPORTATION LICENSE NO: 202401782 EXPIRATION DATE: 12/31/2024	
DATE PREPARED 11/12/2024	
ROUTE 44	STATE MO
DISTRICT CD	SHEET NO. 13
COUNTY PHELPS	
JOB NO. J513561	
CONTRACT ID.	
PROJECT NO.	
BRIDGE NO.	
DATE	DESCRIPTION
MISSOURI HIGHWAYS AND TRANSPORTATION COMMISSION 	
105 WEST CAPITOL JEFFERSON CITY, MO 65102 1-888-ASK-MODOT (1-888-275-6636)	
HORNER SHIFERIN 401 S. 18TH ST., STE. 400 SAINT LOUIS, MO 63103-2296 314-531-4321 • FAX 314-431-6866 • WWW.HORNERSHIFERIN.COM DISCIPLINE: PROFESSIONAL ENGINEERING CERTIFICATE OF AUTHORITY: 000159 EXPIRATION DATE: DECEMBER 31, 2024	

IF A SEAL IS PRESENT ON THIS SHEET IT HAS BEEN ELECTRONICALLY SEALED AND DATED.

MATCHLINE SEE PREVIOUS SHEET

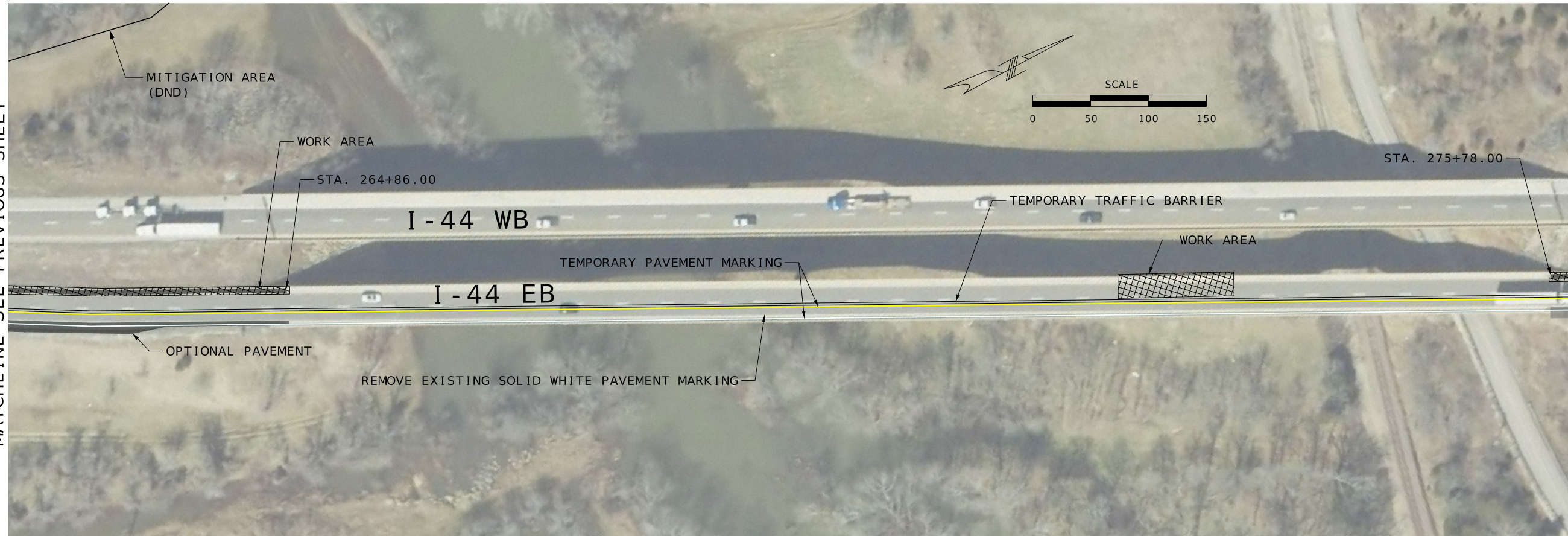

MATCHLINE SEE BELOW

NAME: STEPHEN SICHMELLER
DISCIPLINE: TRANSPORTATION
LICENSE NO: 2024017802
EXPIRATION DATE: 12/31/2024

DATE PREPARED

11/12/2024

ROUTE STATE

44 MO

DISTRICT SHEET NO.

CD 14

COUNTY

PHELPS

JOB NO.

J513561

CONTRACT ID.

PROJECT NO.

BRIDGE NO.

DATE	DESCRIPTION

MISSOURI HIGHWAYS AND TRANSPORTATION COMMISSION

105 WEST CAPITOL
JEFFERSON CITY, MO 65102
1-888-ASK-MODOT (1-888-273-6636)

401 S. 18TH ST., STE. 400 SAINT LOUIS, MO 63103-2296
314-531-4321 • FAX 314-431-6866 • WWW.HORNORSHIFERIN.COM
DISCIPLINE: PROFESSIONAL ENGINEERING
CERTIFICATE OF AUTHORITY: 000159
EXPIRATION DATE: DECEMBER 31, 2024

MATCHLINE SEE ABOVE

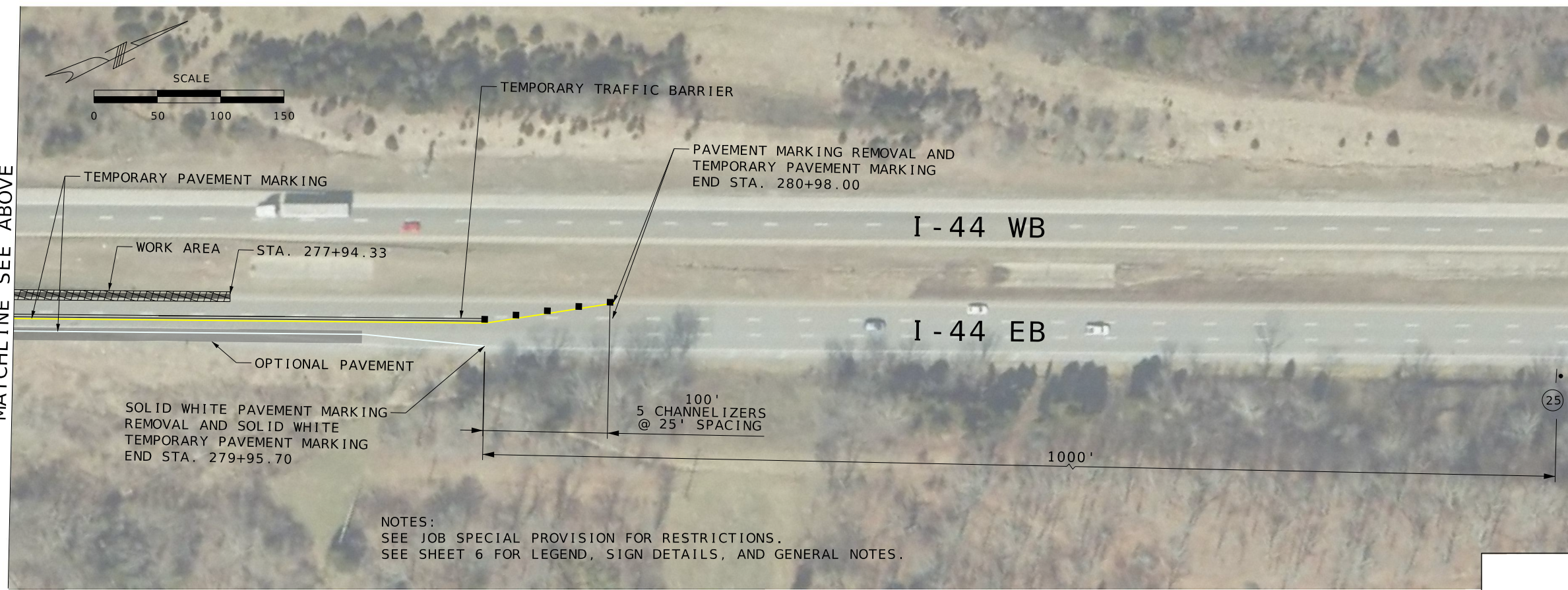

STAGE 2: INSIDE LANE CLOSURE ON EB I-44 FOR EB I-44 OVER LITTLE PINEY CREEK BRIDGE REPAIRS
MAINTAIN ONE LANE OF TRAFFIC ON EB I-44.

I - 44
TRAFFIC CONTROL
SHEET 10 OF 14



IF A SEAL IS PRESENT ON THIS SHEET IT HAS BEEN ELECTRONICALLY SEALED AND DATED.



NOTES:
 SEE JOB SPECIAL PROVISION FOR RESTRICTIONS.
 SEE SHEET 6 FOR LEGEND, SIGN DETAILS, AND GENERAL NOTES.

STAGE 3: OUTSIDE LANE CLOSURE ON EB I-44 FOR EB I-44 OVER LITTLE PINEY CREEK BRIDGE REPAIRS
 MAINTAIN ONE LANE OF TRAFFIC ON EB I-44.

I - 44
 TRAFFIC CONTROL
 SHEET 11 OF 14

NAME: STEPHEN SICHMELLER DISCIPLINE: TRANSPORTATION LICENSE NO: 203407802 EXPIRATION DATE: 12/31/2024	
DATE PREPARED: 11/12/2024	
ROUTE: 44	STATE: MO
DISTRICT: CD	SHEET NO.: 15
COUNTY: PHELPS	
JOB NO.: J513561	
CONTRACT ID.:	
PROJECT NO.:	
BRIDGE NO.:	
DATE	DESCRIPTION
MISSOURI HIGHWAYS AND TRANSPORTATION COMMISSION  105 WEST CAPITOL JEFFERSON CITY, MO 65102 1-888-ASK-MODOT (1-888-273-6636)	
 401 S. 18TH ST., STE. 400 SAINT LOUIS, MO 63103-2296 314-531-4321 • FAX 314-431-6866 • WWW.HORNORSHIFFRIN.COM DISCIPLINE: PROFESSIONAL ENGINEERING CERTIFICATE OF AUTHORITY: 000159 EXPIRATION DATE: DECEMBER 31, 2024	

IF A SEAL IS PRESENT ON THIS SHEET IT HAS BEEN ELECTRONICALLY SEALED AND DATED.



MATCHLINE SEE PREVIOUS SHEET

MATCHLINE SEE BELOW



MATCHLINE SEE ABOVE

MATCHLINE SEE NEXT SHEET

NOTES:
 SEE JOB SPECIAL PROVISION FOR RESTRICTIONS.
 SEE SHEET 6 FOR LEGEND, SIGN DETAILS, AND GENERAL NOTES.

STAGE 3: OUTSIDE LANE CLOSURE ON EB I-44 FOR EB I-44 OVER LITTLE PINEY CREEK BRIDGE REPAIRS
 MAINTAIN ONE LANE OF TRAFFIC ON EB I-44.

I - 44
 TRAFFIC CONTROL
 SHEET 12 OF 14

NAME: STEPHEN SICHMELLER
 DISCIPLINE: TRANSPORTATION
 LICENSE NO: 2034017802
 EXPIRATION DATE: 12/31/2024
 DATE PREPARED: 11/12/2024
 ROUTE: 44 STATE: MO
 DISTRICT: CD SHEET NO.: 16
 COUNTY: PHELPS
 JOB NO.: J513561
 CONTRACT ID:

PROJECT NO.
 BRIDGE NO.

DATE	DESCRIPTION

MISSOURI HIGHWAYS AND TRANSPORTATION COMMISSION

 105 WEST CAPITOL
 JEFFERSON CITY, MO 65102
 1-888-ASK-MODOT (1-888-273-6636)

401 S. 18TH ST., STE. 400 SAINT LOUIS, MO 63103-2296
 314-531-4321 • FAX 314-431-6866 • WWW.HORNORSHIFRIN.COM
 DISCIPLINE: PROFESSIONAL ENGINEERING
 CERTIFICATE OF AUTHORITY: 000159
 EXPIRATION DATE: DECEMBER 31, 2024

IF A SEAL IS PRESENT ON THIS SHEET IT HAS BEEN ELECTRONICALLY SEALED AND DATED.



NAME: STEPHEN SICHMELLER
 DISCIPLINE: TRANSPORTATION
 LICENSE NO: 2024017802
 EXPIRATION DATE: 12/31/2024
 DATE PREPARED
 11/12/2024
 ROUTE 44 STATE MO
 DISTRICT CD SHEET NO. 17
 COUNTY PHELPS
 JOB NO. J513561
 CONTRACT ID.
 PROJECT NO.
 BRIDGE NO.

DATE	DESCRIPTION

IF A SEAL IS PRESENT ON THIS SHEET IT HAS BEEN ELECTRONICALLY SEALED AND DATED.

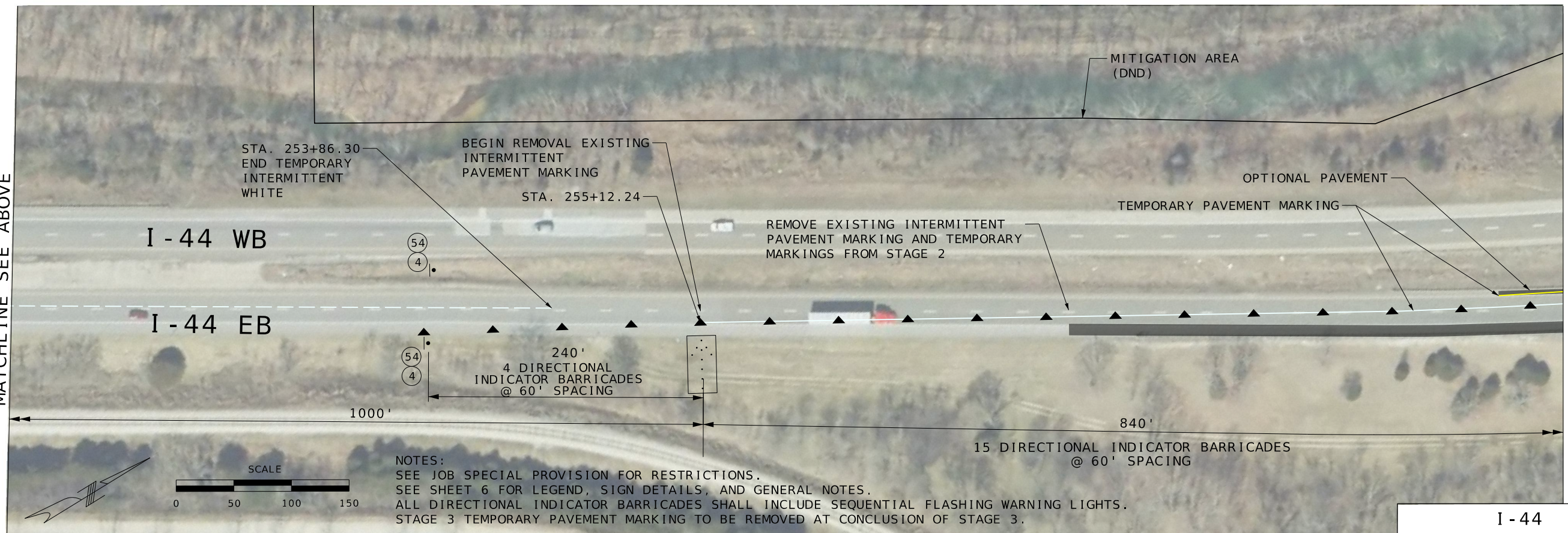

MISSOURI HIGHWAYS AND TRANSPORTATION COMMISSION
 MoDOT
 105 WEST CAPITOL
 JEFFERSON CITY, MO 65102
 1-888-ASK-MODOT (1-888-273-6636)

HORNER SHIFERIN
 401 S. 18TH ST., STE. 400 SAINT LOUIS, MO 63103-2296
 314-531-4321 • FAX 314-431-6866 • WWW.HORNERSHIFERIN.COM
 DISCIPLINE: PROFESSIONAL ENGINEERING
 CERTIFICATE OF AUTHORITY: 000159
 EXPIRATION DATE: DECEMBER 31, 2024

**STAGE 3: OUTSIDE LANE CLOSURE ON EB I-44 FOR EB I-44 OVER LITTLE PINEY CREEK BRIDGE REPAIRS
 MAINTAIN ONE LANE OF TRAFFIC ON EB I-44.**

I - 44
TRAFFIC CONTROL
SHEET 13 OF 14

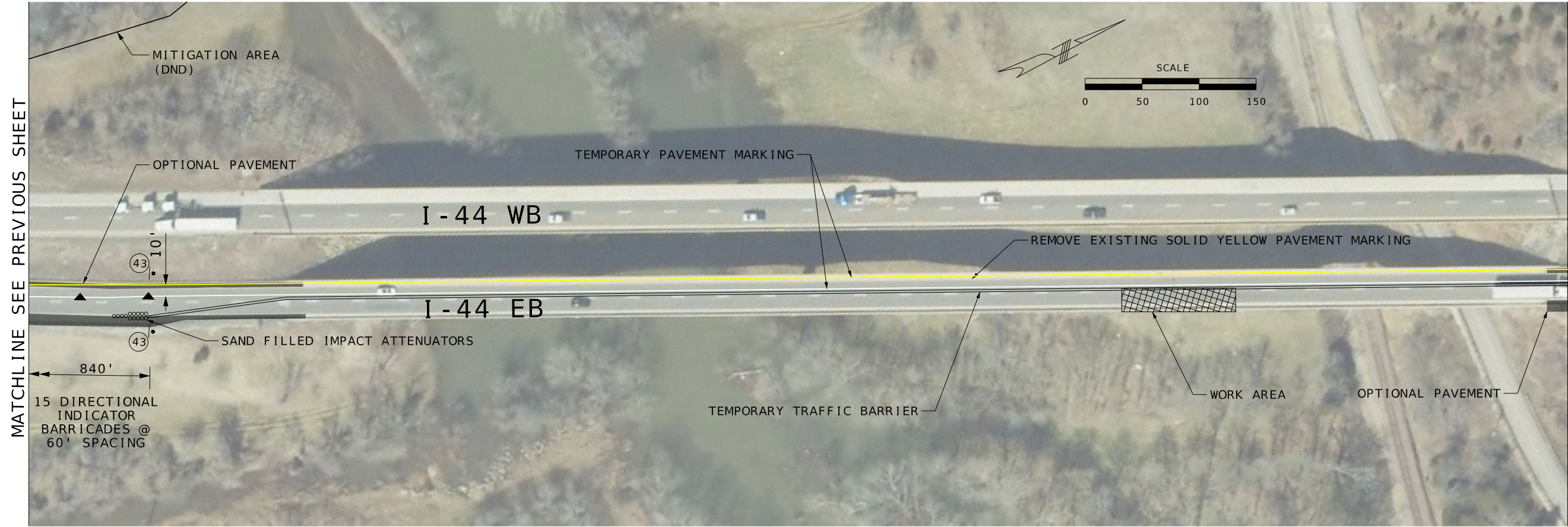

MATCHLINE SEE PREVIOUS SHEET

MATCHLINE SEE BELOW

NAME: STEPHEN SICHMELLER
 DISCIPLINE: TRANSPORTATION
 LICENSE NO: 2024017892
 EXPIRATION DATE: 12/31/2024

DATE PREPARED
 11/12/2024

ROUTE	STATE
44	MO
DISTRICT	SHEET NO.
CD	18

COUNTY
 PHELPS

JOB NO.
 J513561

CONTRACT ID.

PROJECT NO.

BRIDGE NO.

DATE	DESCRIPTION

MISSOURI HIGHWAYS AND TRANSPORTATION COMMISSION

105 WEST CAPITOL
 JEFFERSON CITY, MO 65102
 1-888-ASK-MODOT (1-888-275-6636)

HORNER SHIFERIN

401 S. 18TH ST., STE. 400 SAINT LOUIS, MO 63103-2296
 314-531-4321 • FAX 314-431-6866 • WWW.HORNERSHIFERIN.COM
 DISCIPLINE: PROFESSIONAL ENGINEERING
 CERTIFICATE OF AUTHORITY: 000159
 EXPIRATION DATE: DECEMBER 31, 2024

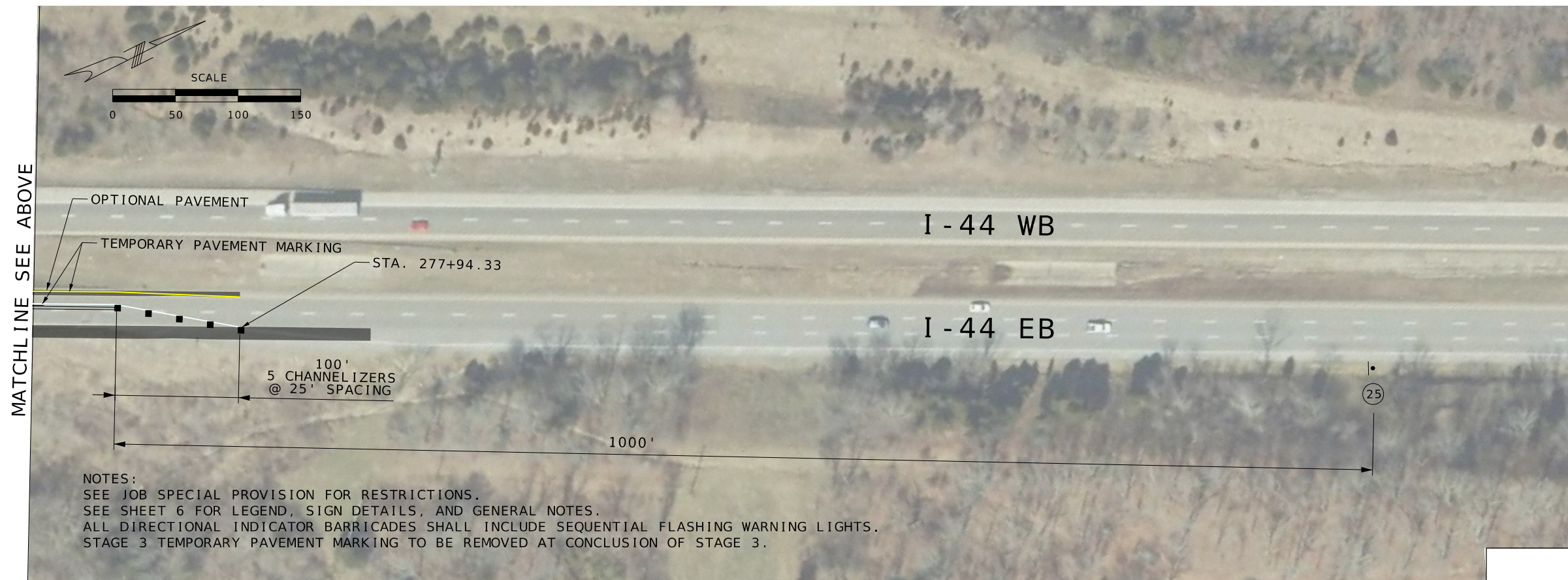

MATCHLINE SEE ABOVE

NOTES:
 SEE JOB SPECIAL PROVISION FOR RESTRICTIONS.
 SEE SHEET 6 FOR LEGEND, SIGN DETAILS, AND GENERAL NOTES.
 ALL DIRECTIONAL INDICATOR BARRICADES SHALL INCLUDE SEQUENTIAL FLASHING WARNING LIGHTS.
 STAGE 3 TEMPORARY PAVEMENT MARKING TO BE REMOVED AT CONCLUSION OF STAGE 3.

STAGE 3: OUTSIDE LANE CLOSURE ON EB I-44 FOR EB I-44 OVER LITTLE PINEY CREEK BRIDGE REPAIRS
 MAINTAIN ONE LANE OF TRAFFIC ON EB I-44.

I - 44
 TRAFFIC CONTROL
 SHEET 14 OF 14

IF A SEAL IS PRESENT ON THIS SHEET IT HAS BEEN ELECTRONICALLY SEALED AND DATED.

**U.I.P. AND REHABILITATE EXISTING (95') (5'-140'-190'-190'-140'-5')
(95'-135'-95') CONTINUOUS COMPOSITE PLATE GIRDER SPANS**

SEC/SUR 24 TWP 37N RGE 10W



DATE
DATE PREPARED
9/6/2024
ROUTE I-44 STATE MO
DISTRICT BR SHEET NO. 1
COUNTY PHELPS
JOB NO. J513561
CONTRACT ID.
PROJECT NO.

BRIDGE NO. G04188

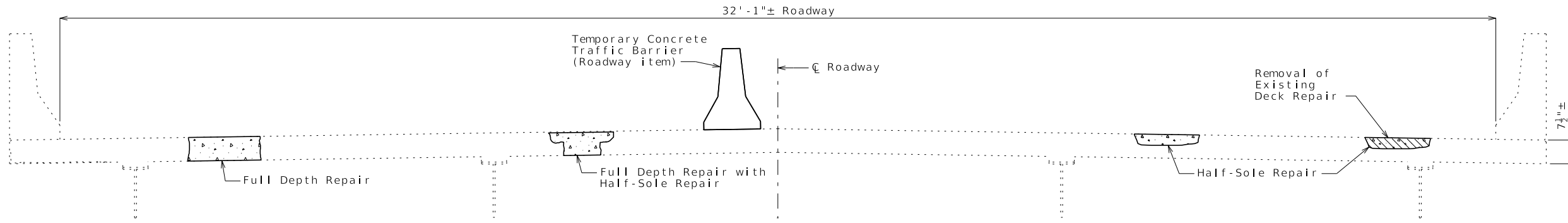

TYPICAL SECTION THRU EXISTING DECK
Precast Temporary Barrier:
Temporary barrier shall not be attached to the bridge.

Estimated Quantities		
Item		Total
Removal of Existing Deck Repair	sq. foot	20
Substructure Repair (Formed)	sq. foot	120
Substructure Repair (Unformed)	sq. foot	20
Half-Sole Repair	sq. foot	20
Full Depth Repair	sq. foot	20
* Epoxy Pressure Injecting	linear foot	3
Protective Coating - Concrete Bents and Piers (Epoxy)	lump sum	1
Surface Preparation for Recoating Structural Steel	sq. foot	3,700
Field Application of Inorganic Zinc Primer	sq. foot	3,700
Intermediate Field Coat (System G)	sq. foot	4,100
Finish Field Coat (System G)	sq. foot	4,100

General Notes:

Design Specifications:
2002 AASHTO LFD (17th Ed.) Standard Specifications
Seismic Performance Category A
Bridge Deck Rating=7

Design Loading:
HS20-44 Modified (1964 & 2002) and Military 24,000lb Tandem Axle (1964 & 2002)

Design Unit Stresses:
Class B-2 Concrete (Half-Sole and Full Depth Repair) $f'c = 4,000$ psi

Miscellaneous:
All concrete repairs shall be in accordance with Sec 704, unless otherwise noted.
Outline of existing work is indicated by light dashed lines. Heavy lines indicate new work.
Concrete Protective Coatings:
Protective Coating for Concrete Bents and Piers (Epoxy) shall be applied as shown on the bridge plans and in accordance with Sec 711.
Traffic Handling:
Traffic to be maintained during construction. See roadway plans for traffic control.
Structural Steel Protective Coating:
All existing steel within 10' of the expansion joint near Bent No. 1, 2, 6, & 9 shall be recoated with System G in accordance with Sec 1081.
Surface preparation of the existing steel shall be in accordance with Sec 1081 for Recoating of Structural Steel (System G). The cost of surface preparation will be considered completely covered by the contract unit price per sq. foot for Surface Preparation for Recoating Structural Steel.
The cost of the prime coat will be considered completely covered by the contract unit price per sq. foot for Field Application of Inorganic Zinc Primer.
The color of the field coat(s) shall be Gray (Federal Standard #26373). The cost of the intermediate field coat will be considered completely covered by the contract unit price per sq. foot for Intermediate Field Coat (System G). The cost of the finish field coat will be considered completely covered by the contract unit price per sq. foot for Finish Field Coat (System G).

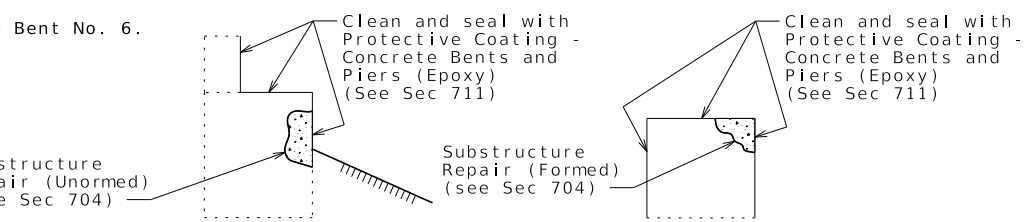

TYPICAL SECTION THRU END BENTS NO. 1 & 9 SHOWING PROTECTIVE COATING
TYPICAL SECTION THRU INT. BENTS NO. 2 & 6 SHOWING PROTECTIVE COATING
Note: If Substructure Repair (Formed or Unformed) is required on a bent receiving Protective Coating, repaired concrete must be properly cured in accordance with the specifications prior to applying the coating.

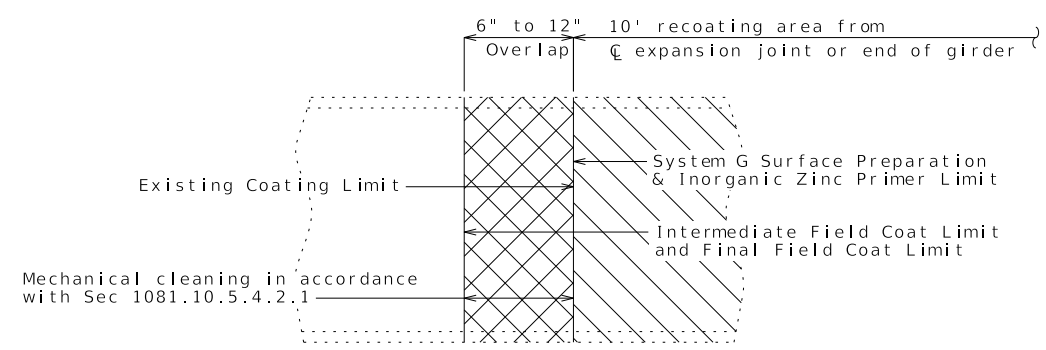

PART ELEVATION SHOWING LIMITS OF PAINT OVERLAP
(Vertical or horizontal paint limit. Horizontal limit shown)

Limits of Paint Overlap: System G shall overlap the existing coating between 6 inches and 12 inches in order to achieve maximum coverage at the paint limit of each complete system near the expansion and contraction areas. The final field coating shall be masked to provide crisp, straight lines and to prevent overspray beyond the overlap required.

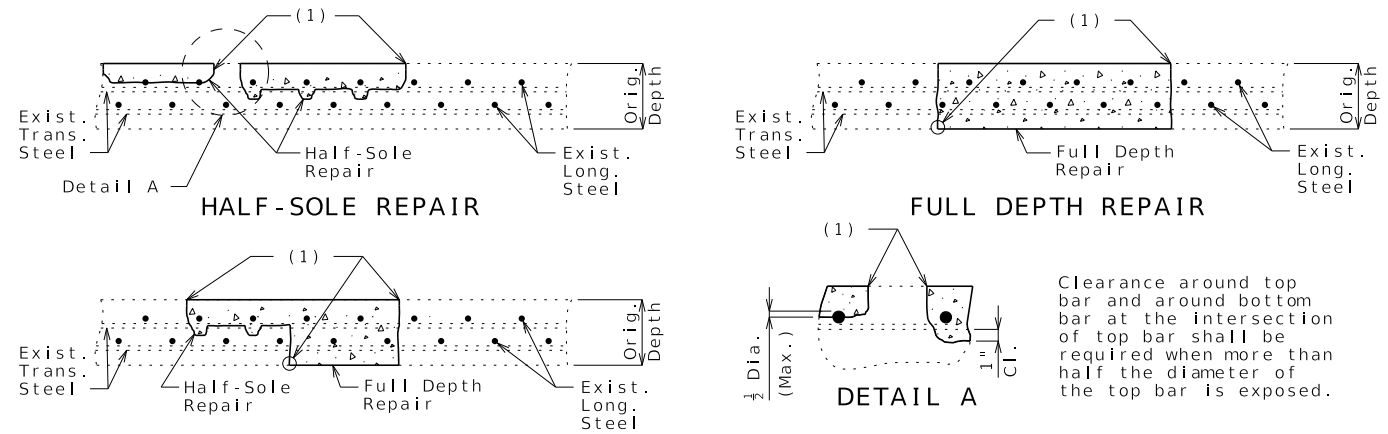

FULL DEPTH REPAIR WITH HALF-SOLE REPAIR

(1) 1" vertical side shall be established outside the deteriorated area.

Note: Contractor shall sound the concrete in the vicinity of the expansion joint near Intermediate Bent No. 6 to determine if Half-Sole and/or Full Depth Repair is needed.

REPAIRS TO BRIDGE:
ROUTE EB I-44 OVER
LITTLE PINEY RIVER & BNSF RR
ROUTE EB I-44 FROM ROUTE J TO ROUTE T
ABOUT 4.8 MILES EAST OF ROUTE J
BEGINNING STATION 264+86.00± (MATCH EXISTING)

REHAB DETAILS

Designed: Aug. 2024
Detailed: Aug. 2024
Checked: Aug. 2024

DESCRIPTION
DATE
MISSOURI HIGHWAYS AND TRANSPORTATION COMMISSION
MoDOT
105 WEST CAPITOL
JEFFERSON CITY, MO 65102
1-888-ASK-MODOT (1-888-275-6636)

HORNER SHIFRIN
401 S. 18TH ST., STE. 400 ST. LOUIS, MO 63103
314-531-4321 • FAX 314-531-6886
WWW.HORNERSHIFRIN.COM
DISCIPLINE: PROFESSIONAL ENGINEERING
CERTIFICATE OF AUTHORITY: 000109
EXPIRATION DATE: DECEMBER 31, 2024

REHAB DETAILS
I-44 EB OVER
LITTLE PINEY
RIVER & BNSF RR