

DATE PREPARED
10/21/2024

ROUTE STATE
D MO

DISTRICT SHEET NO.
NW 1

COUNTY
CALDWELL

JOB NO.
J153414

CONTRACT ID.

PROJECT NO.

BRIDGE NO.

DESCRIPTION

DATE

MISSOURI HIGHWAYS AND TRANSPORTATION COMMISSION

105 WEST CAPITOL
JEFFERSON CITY, MO 65102
1-888-ASK-MODOT (1-888-275-6636)

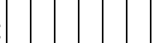

Bartlett & West

601 MONROE ST. SUITE 201 - JEFFERSON CITY, MO 65101
PHONE 873-634-5181
CERTIFICATE OF AUTHORITY NO. 000707 - ENGINEERING
WWW.BARTLETTWEST.COM

CROSS SECTIONS
SHEET 1 OF 14

IF A SEAL IS PRESENT ON THIS SHEET IT HAS BEEN ELECTRONICALLY SEALED AND DATED.

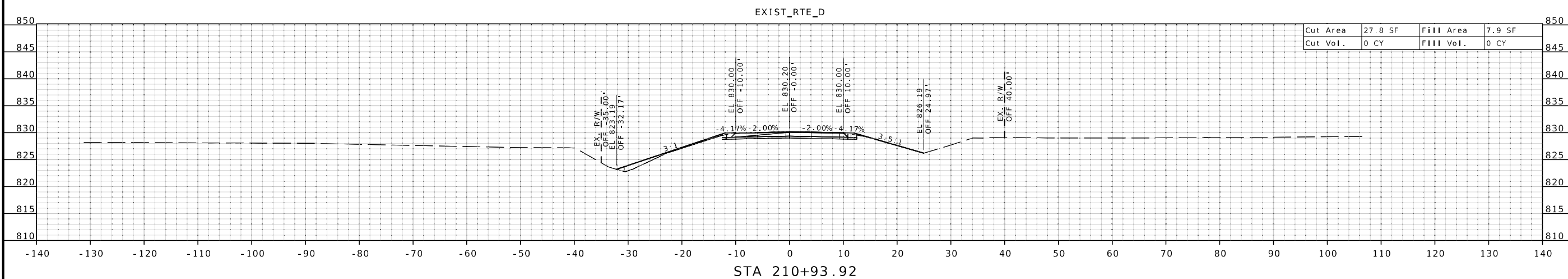
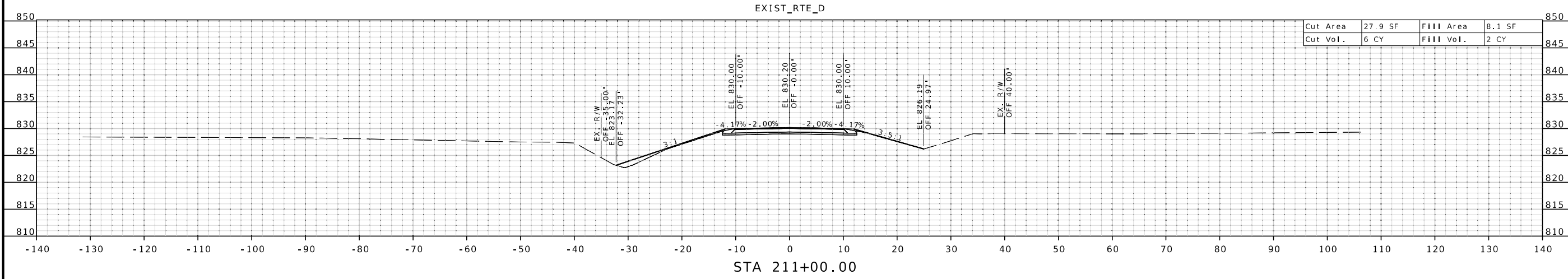
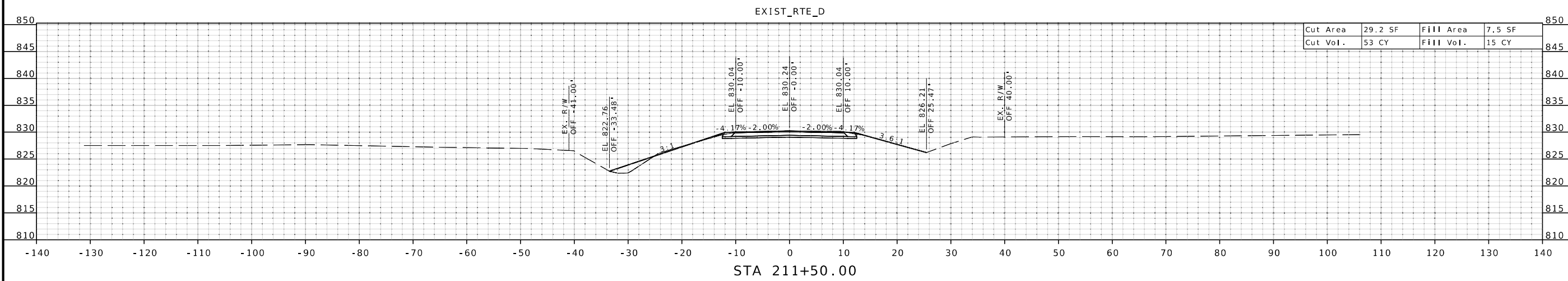



THIS SHEET HAS BEEN SIGNED, SEALED AND DATED ELECTRONICALLY.

DATE PREPARED
10/21/2024

ROUTE STATE
D MO

DISTRICT SHEET NO.
NW 5

COUNTY
CALDWELL

JOB NO.
J153414

CONTRACT ID.

PROJECT NO.

BRIDGE NO.

DESCRIPTION

DATE

DATE

DATE

DATE

DATE

DATE

DATE

DATE

DATE

DATE

DATE

DATE

DATE

DATE

DATE

DATE

DATE

DATE

DATE

DATE

DATE

DATE

DATE

DATE

DATE

DATE

DATE

DATE

DATE

DATE

DATE

DATE

DATE

DATE

IF A SEAL IS PRESENT ON THIS SHEET IT HAS BEEN ELECTRONICALLY SEALED AND DATED.

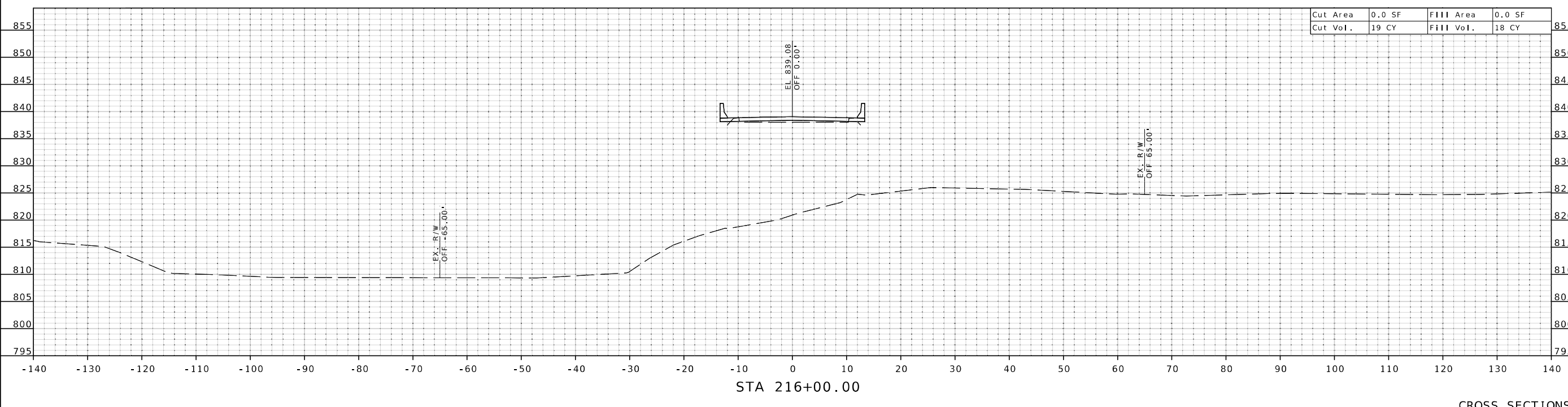
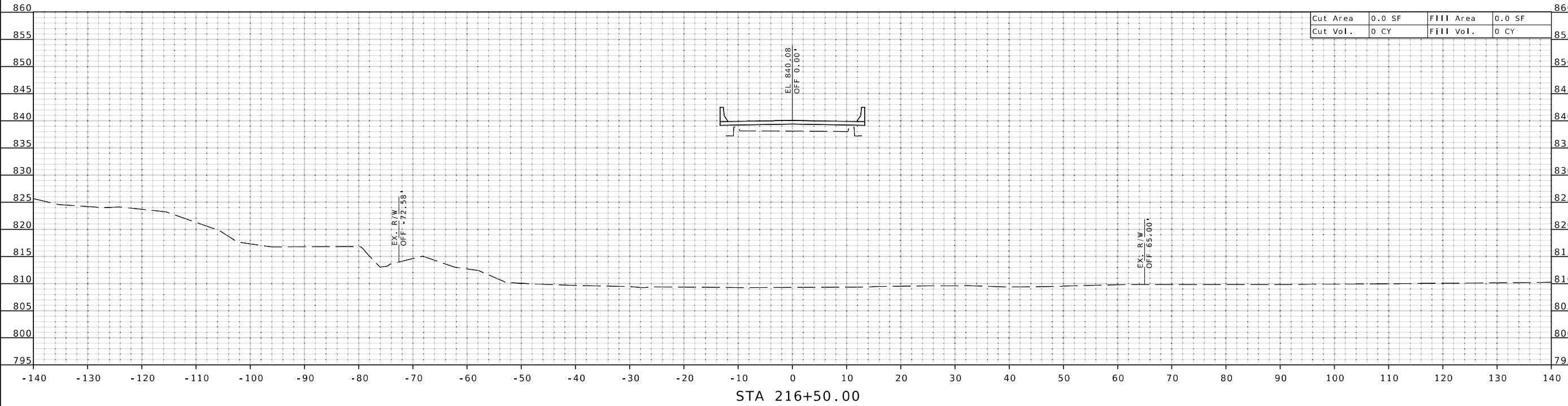

CROSS SECTIONS
SHEET 5 OF 14

MISSOURI HIGHWAYS AND TRANSPORTATION COMMISSION
MoDOT
105 WEST CAPITOL
JEFFERSON CITY, MO 65102
1-888-ASK-MODOT (1-888-275-6636)

Bartlett & West
601 MONROE ST. SUITE 201 - JEFFERSON CITY, MO 65101
PHONE 873-634-5181
CERTIFICATE OF AUTHORITY NO. 000707 - ENGINEERING
WWW.BARTLETTWEST.COM



THIS SHEET HAS BEEN SIGNED, SEALED AND DATED ELECTRONICALLY.

DATE PREPARED
10/21/2024

ROUTE STATE
D MO

DISTRICT SHEET NO.
NW 8

COUNTY
CALDWELL

JOB NO.
J153414

CONTRACT ID.

PROJECT NO.

BRIDGE NO.

DESCRIPTION

DATE

DATE

DATE

DATE

DATE

DATE

DATE

DATE

DATE

DATE

DATE

DATE

DATE

DATE

DATE

DATE

DATE

DATE

DATE

DATE

DATE

DATE

DATE

DATE

DATE

DATE

DATE

DATE

DATE

DATE

DATE

DATE

DATE

DATE

IF A SEAL IS PRESENT ON THIS SHEET IT HAS BEEN ELECTRONICALLY SEALED AND DATED.

MISSOURI HIGHWAYS AND TRANSPORTATION COMMISSION
105 WEST CAPITOL
JEFFERSON CITY, MO 65102
1-888-ASK-MODOT (1-888-275-6636)

Bartlett & West
601 MONROE ST., SUITE 201 - JEFFERSON CITY, MO 65101
PHONE 672-63-3181
CERTIFICATE OF AUTHORITY NO. 000707 - ENGINEERING
WWW.BARTLETTWEST.COM

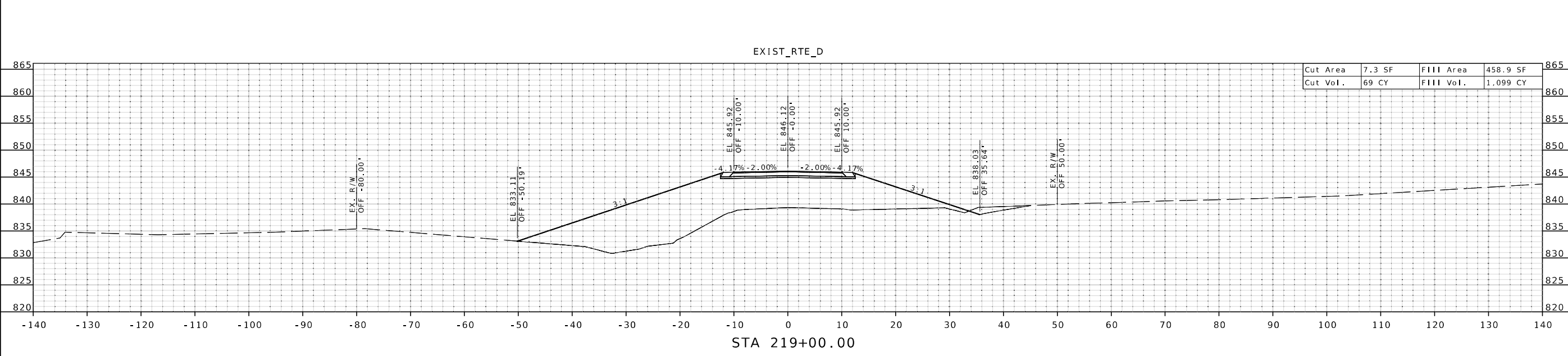
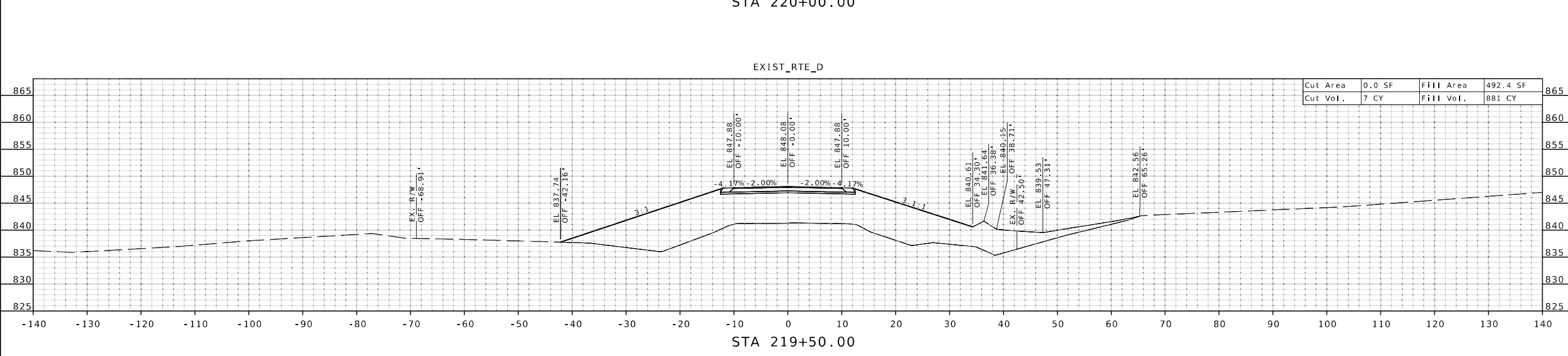
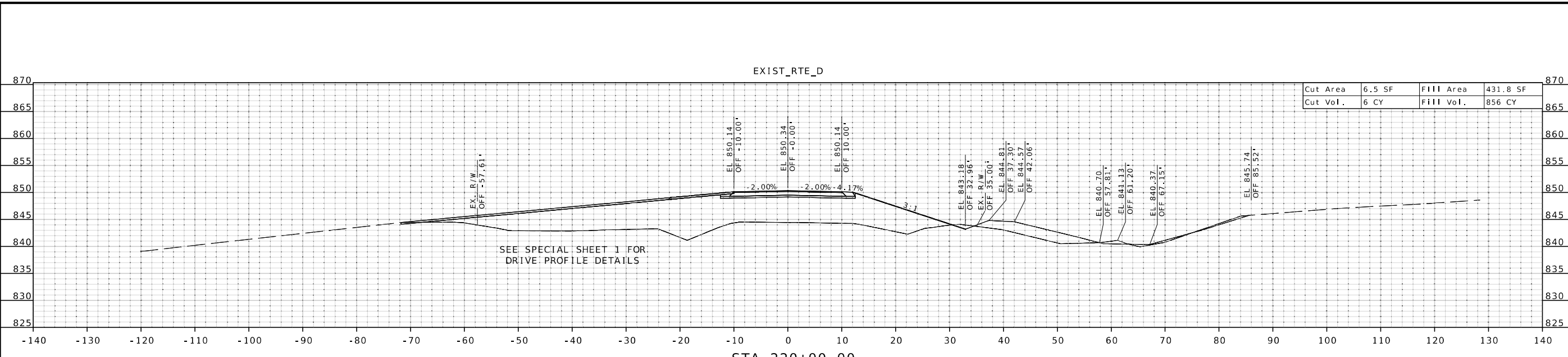

CROSS SECTIONS
SHEET 8 OF 14



THIS SHEET HAS BEEN SIGNED, SEALED AND DATED ELECTRONICALLY.

DATE PREPARED
10/21/2024

ROUTE STATE
D MO
DISTRICT SHEET NO.
NW 9

COUNTY
CALDWELL

JOB NO.
J153414

CONTRACT ID.

PROJECT NO.

BRIDGE NO.

| DATE | DESCRIPTION |
|------|-------------|
| | |
| | |
| | |
| | |
| | |

MISSOURI HIGHWAYS AND TRANSPORTATION COMMISSION



105 WEST CAPITOL
JEFFERSON CITY, MO 65102
1-888-ASK-MODOT (1-888-275-6636)

Bartlett & West
601 MONROE ST., SUITE 201 - JEFFERSON CITY, MO 65101
PHONE 672-63-5181
CERTIFICATE OF AUTHORITY NO. 000707 - ENGINEERING
WWW.BARTLETTWEST.COM

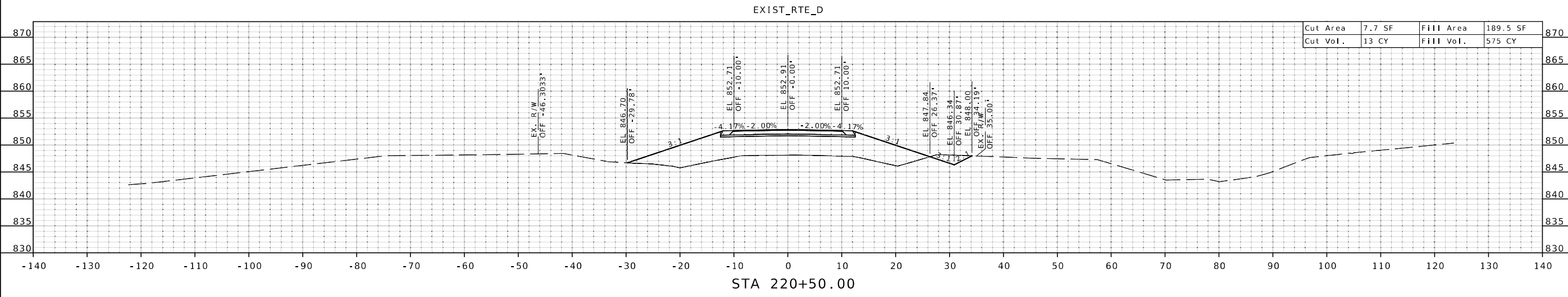
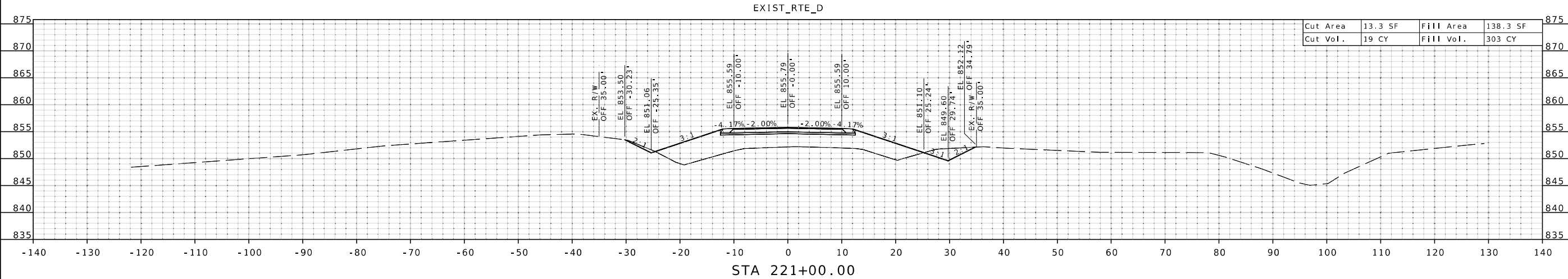
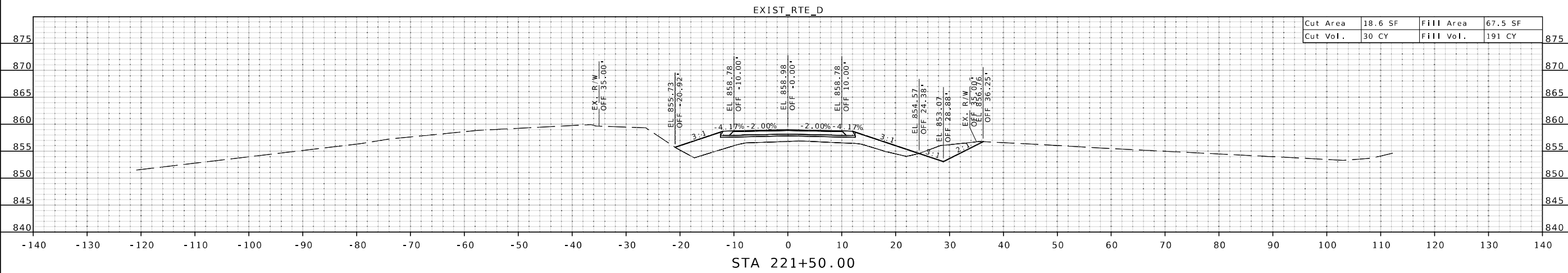

IF A SEAL IS PRESENT ON THIS SHEET IT HAS BEEN ELECTRONICALLY SEALED AND DATED.



THIS SHEET HAS BEEN SIGNED, SEALED AND DATED ELECTRONICALLY.

DATE PREPARED
10/21/2024

ROUTE STATE
D MO

DISTRICT SHEET NO.
NW 10

COUNTY
CALDWELL

JOB NO.
J153414

CONTRACT ID.

PROJECT NO.

BRIDGE NO.

| DESCRIPTION | DATE |
|-------------|------|
| | |
| | |
| | |
| | |
| | |
| | |
| | |
| | |
| | |
| | |

MISSOURI HIGHWAYS AND TRANSPORTATION COMMISSION
105 WEST CAPITOL
JEFFERSON CITY, MO 65102
1-888-ASK-MODOT (1-888-275-6636)

Bartlett & West
601 MONROE ST. SUITE 201 - JEFFERSON CITY, MO 65101
PHONE 673-63-5181
CERTIFICATE OF AUTHORITY NO. 000707 - ENGINEERING
WWW.BARTLETTWEST.COM

IF A SEAL IS PRESENT ON THIS SHEET IT HAS BEEN ELECTRONICALLY SEALED AND DATED.

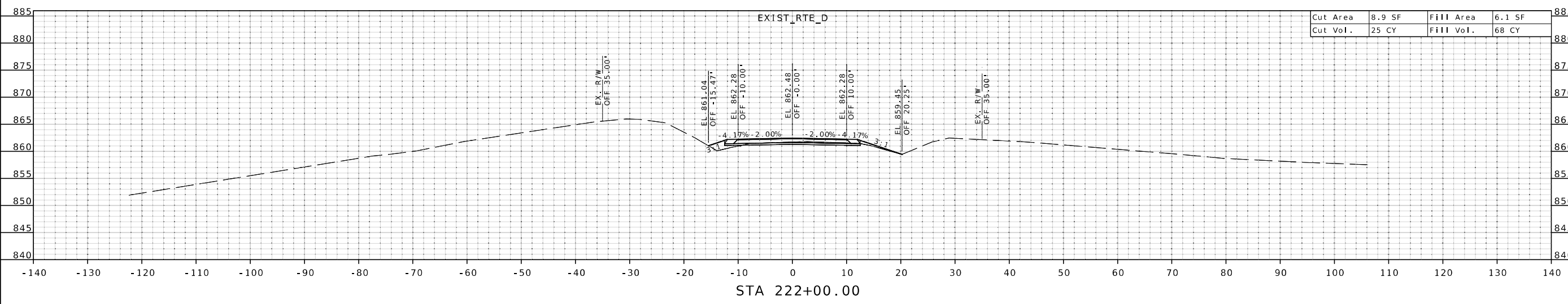
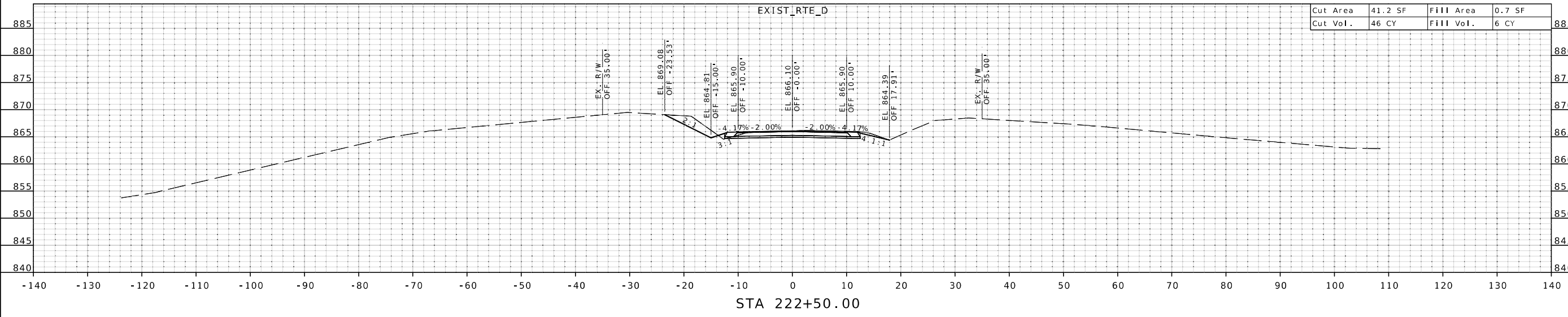

CROSS SECTIONS SHEET 10 OF 14



THIS SHEET HAS BEEN SIGNED, SEALED AND DATED ELECTRONICALLY.

DATE PREPARED
10/21/2024

| | |
|-------|-------|
| ROUTE | STATE |
| D | MO |

| | |
|----------|-----------|
| DISTRICT | SHEET NO. |
| NW | 11 |

COUNTY
CALDWELL

JOB NO.
J1S3414

CONTRACT ID.

PROJECT NO.

BRIDGE NO.

| DATE | DESCRIPTION |
|------|-------------|
| | |
| | |
| | |
| | |
| | |
| | |
| | |
| | |
| | |
| | |

MISSOURI HIGHWAYS AND TRANSPORTATION COMMISSION

105 WEST CAPITOL
JEFFERSON CITY, MO 65102
1-888-ASK-MODOT (1-888-275-6636)

Bartlett & West

601 MONROE ST. SUITE 201 - JEFFERSON CITY, MO 65101
PHONE 672-66-5181
CERTIFICATE OF AUTHORITY NO. 000707 - ENGINEERING
WWW.BARTLETTWEST.COM

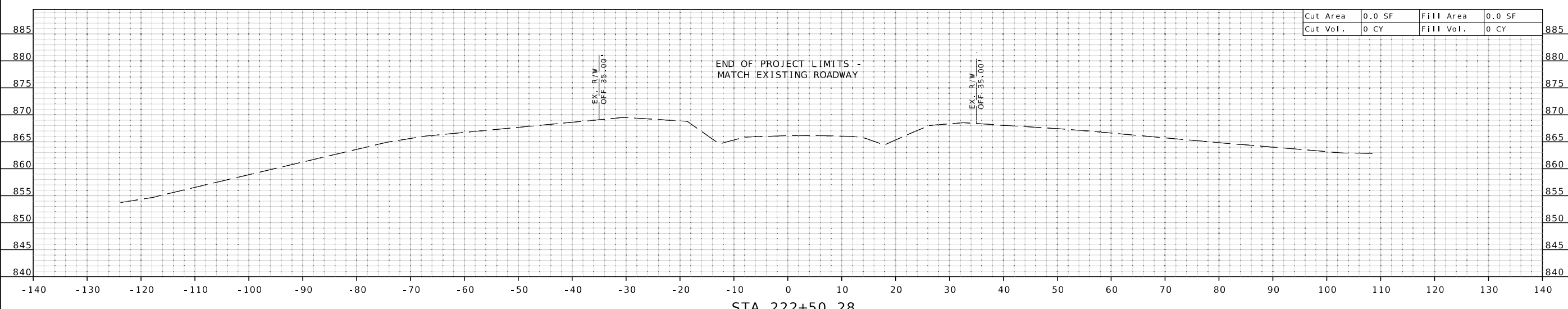

| | | | |
|----------|--------|-----------|--------|
| Cut Area | 0.0 SF | Fill Area | 0.0 SF |
| Cut Vol. | 0 CY | Fill Vol. | 0 CY |

STA 222+50.28

CROSS SECTIONS
SHEET 11 OF 14

IF A SEAL IS PRESENT ON THIS SHEET IT HAS BEEN ELECTRONICALLY SEALED AND DATED.



THIS SHEET HAS BEEN SIGNED, SEALED AND DATED ELECTRONICALLY.

DATE PREPARED
10/21/2024

ROUTE STATE
D MO

DISTRICT SHEET NO.
NW 12

COUNTY
CALDWELL

JOB NO.
J153414

CONTRACT ID.

PROJECT NO.

BRIDGE NO.

STINSON ROAD

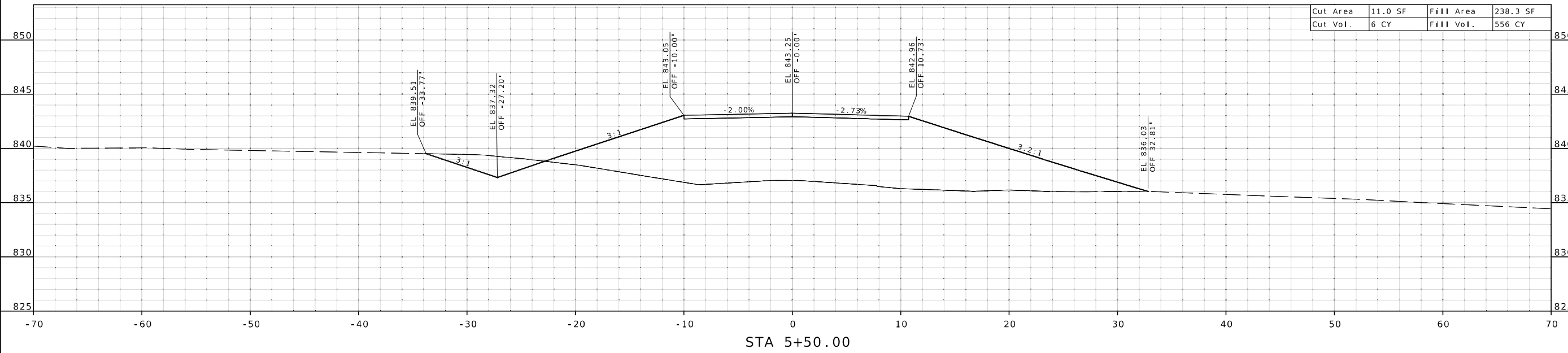

STINSON ROAD

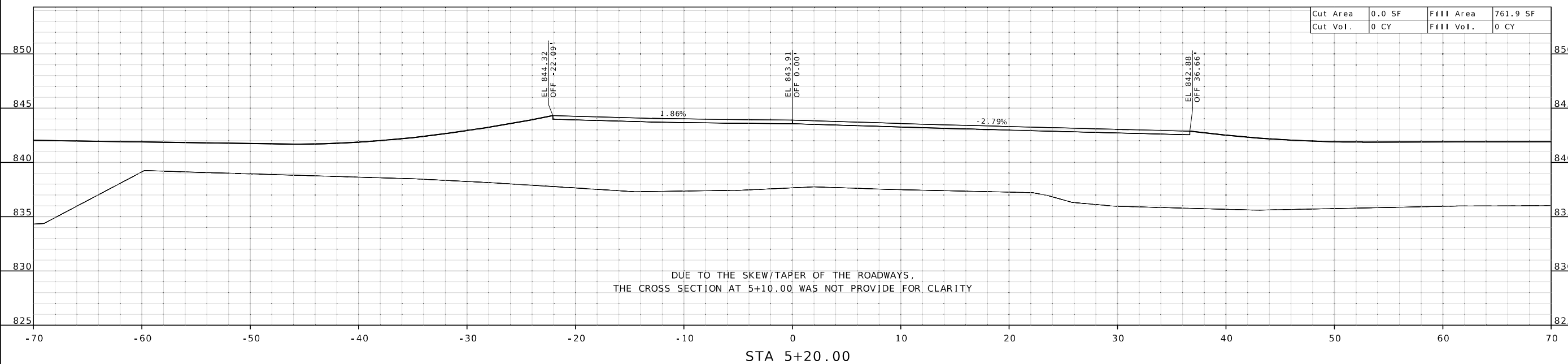

DUE TO THE SKEW/TAPER OF THE ROADWAYS,
THE CROSS SECTION AT 5+10.00 WAS NOT PROVIDE FOR CLARITY

CROSS SECTIONS
SHEET 12 OF 14

| DATE | DESCRIPTION |
|------|-------------|
| | |
| | |
| | |
| | |
| | |

MISSOURI HIGHWAYS AND TRANSPORTATION COMMISSION



105 WEST CAPITOL
JEFFERSON CITY, MO 65102
1-888-ASK-MODOT (1-888-275-6636)

Bartlett & West

601 MONROE ST., SUITE 201 - JEFFERSON CITY, MO 65101
PHONE 672-634-5181
CERTIFICATE OF AUTHORITY NO. 000707 - ENGINEERING
WWW.BARTLETTWEST.COM

IF A SEAL IS PRESENT ON THIS SHEET IT HAS BEEN ELECTRONICALLY SEALED AND DATED.



THIS SHEET HAS BEEN SIGNED, SEALED AND DATED ELECTRONICALLY.

DATE PREPARED
10/21/2024

ROUTE STATE
D MO

DISTRICT SHEET NO.
NW 13

COUNTY
CALDWELL

JOB NO.
J153414

CONTRACT ID.

PROJECT NO.

BRIDGE NO.

| DATE | DESCRIPTION |
|------|-------------|
| | |
| | |
| | |
| | |
| | |
| | |
| | |
| | |
| | |
| | |

MISSOURI HIGHWAYS AND TRANSPORTATION COMMISSION

105 WEST CAPITOL
JEFFERSON CITY, MO 65102
1-888-ASK-MODOT (1-888-275-6636)

Bartlett & West

601 MONROE ST., SUITE 201 - JEFFERSON CITY, MO 65101
PHONE 672-63-5181
CERTIFICATE OF AUTHORITY NO. 000707 - ENGINEERING
WWW.BARTLETTWEST.COM

STINSON_ROAD

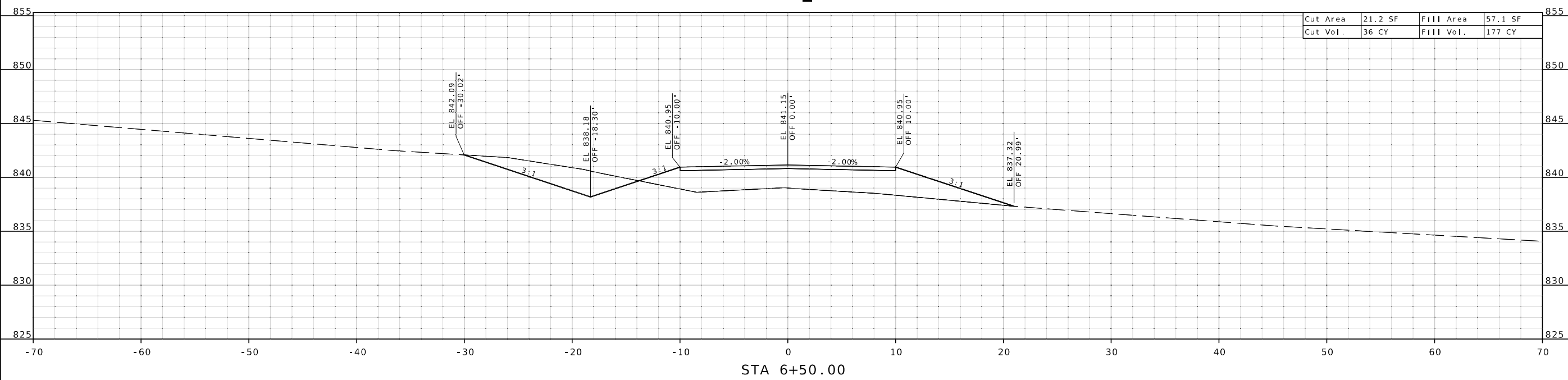

STINSON_ROAD

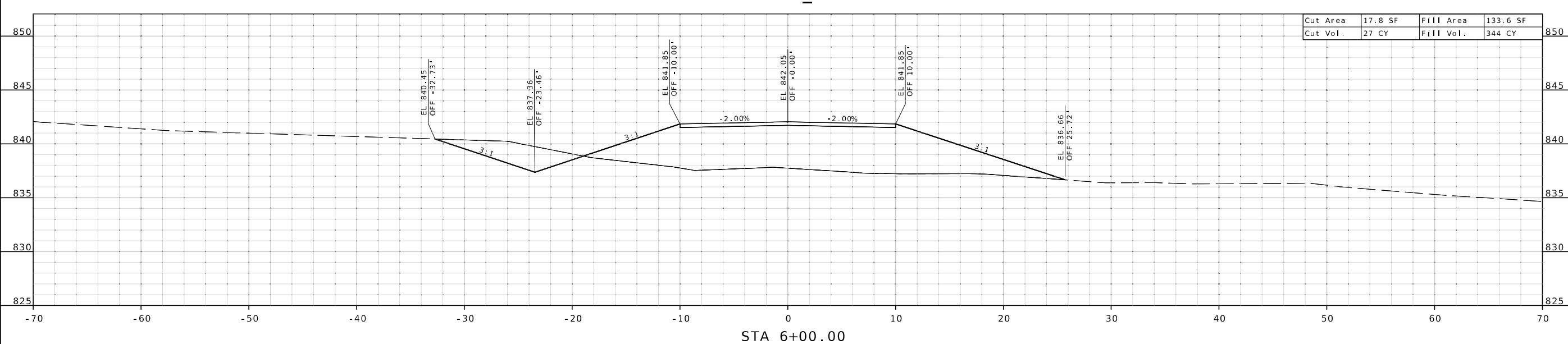

CROSS SECTIONS
SHEET 13 OF 14

IF A SEAL IS PRESENT ON THIS SHEET IT HAS BEEN ELECTRONICALLY SEALED AND DATED.



THIS SHEET HAS BEEN SIGNED, SEALED AND DATED ELECTRONICALLY.

DATE PREPARED
10/21/2024

ROUTE STATE
D MO

DISTRICT SHEET NO.
NW 14

COUNTY
CALDWELL

JOB NO.
J1S3414

CONTRACT ID.

PROJECT NO.

BRIDGE NO.

| DATE | DESCRIPTION |
|------|-------------|
| | |
| | |
| | |
| | |
| | |
| | |
| | |
| | |
| | |
| | |

MISSOURI HIGHWAYS AND TRANSPORTATION COMMISSION



105 WEST CAPITOL
JEFFERSON CITY, MO 65102
1-888-ASK-MODOT (1-888-275-6636)

Bartlett & West
601 MONROE ST., SUITE 201 - JEFFERSON CITY, MO 65101
PHONE 672-63-5181
CERTIFICATE OF AUTHORITY NO. 000707 - ENGINEERING
WWW.BARTLETTWEST.COM

STINSON_DRIVE

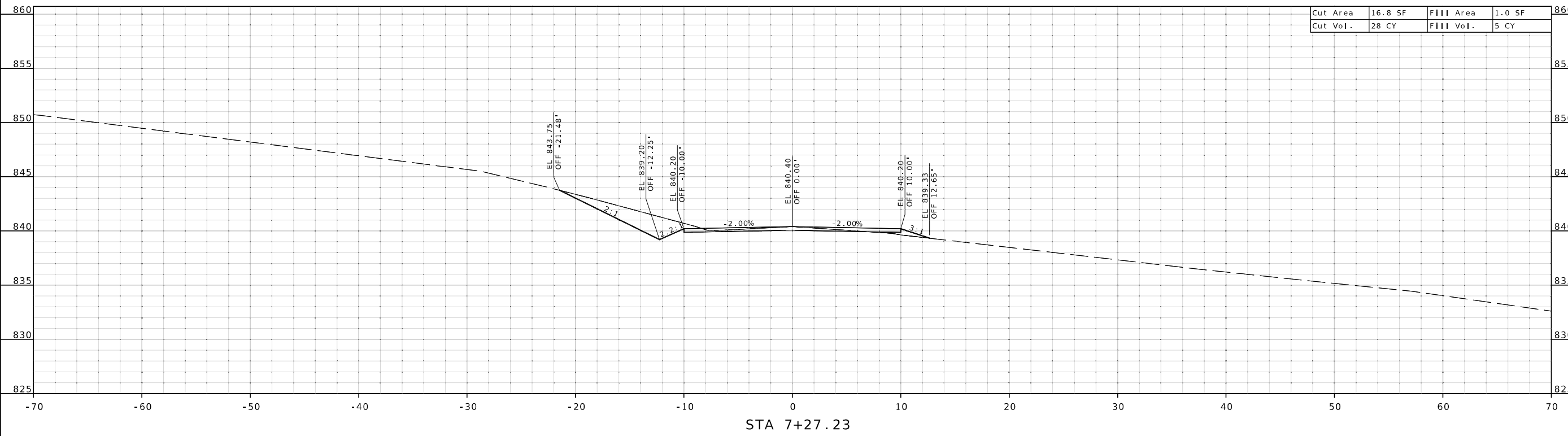

STINSON_ROAD

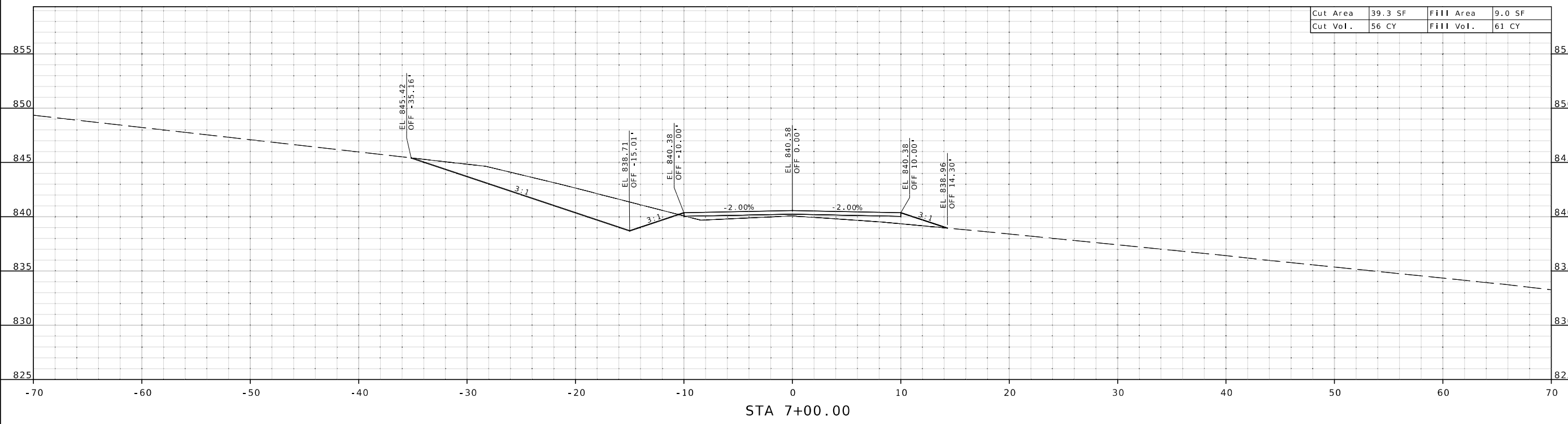

IF A SEAL IS PRESENT ON THIS SHEET IT HAS BEEN ELECTRONICALLY SEALED AND DATED.