

DESIGN DESIGNATION

A.A.D.T. - 2025 = 2824
 A.A.D.T. - 2035 = 2968
 D.H.V. = 11%
 T = 22%
 V = 55 M.P.H.
 D = 51%

FUNCTIONAL CLASSIFICATION-PRINCIPAL ARTERIAL

NORMAL ACCESS RIGHT OF WAY

MISSOURI HIGHWAYS AND TRANSPORTATION COMMISSION

R/W PLANS FOR PROPOSED STATE HIGHWAY

BOLLINGER COUNTY

INDEX OF SHEETS

DESCRIPTION	SHEET NUMBER
TITLE SHEET	1
TYPICAL SECTIONS (TS) (01 SHEET)---	2
QUANTITIES (QU) (05 SHEETS)-----	3
PLAN PROFILE (PP)-----	4-10
REFERENCE POINTS (RP)-----	11
COORDINATE POINTS (CP)-----	12
SPECIAL SHEETS (SS)-----	13-19
TRAFFIC CONTROL SHEETS (TC)-----	20-24
EROSION CONTROL SHEETS (EC)-----	25-26
LIGHTING (LT)-----	27
SIGNING (SN)-----	28-33
PAVEMENT MARKING (PM)-----	34-37
CULVERT SECTIONS (CS)-----	38-39
CROSS SECTIONS (XS)-----	1-37

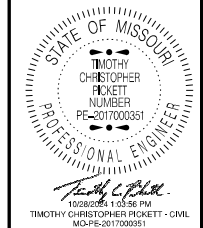

DATE PREPARED	10/22/2024
ROUTE	72/51
STATE	MO
DISTRICT	SE
SHEET NO.	1
COUNTY	BOLLINGER
JOB NO.	J9P3842
CONTRACT ID.	
PROJECT NO.	
BRIDGE NO.	

PROJECT LOCATION
 INTERSECTION IMPROVEMENTS/ROUNDBOUT

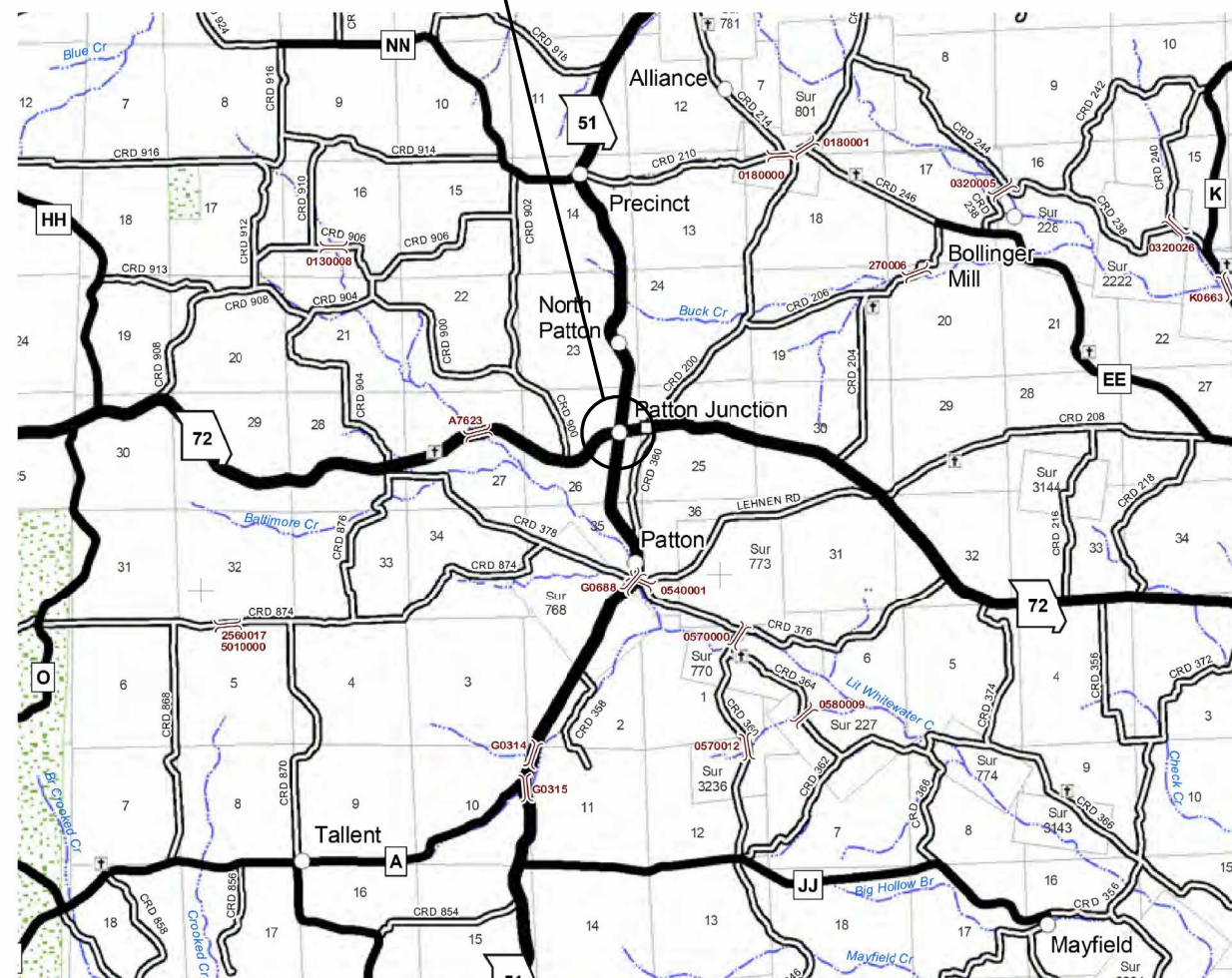

T 33 N
T 32 N

R 8 E | R 9 E

R 9 E | R 10 E

CONVENTIONAL SYMBOLS
 (USED IN PLANS)

	EXISTING	NEW
BUILDINGS AND STRUCTURES	[Symbol]	[Symbol]
GUARD RAIL	[Symbol]	[Symbol]
GUARD CABLE	[Symbol]	[Symbol]
CONCRETE RIGHT-OF-WAY MARKER	[Symbol]	[Symbol]
STEEL RIGHT-OF-WAY MARKER	[Symbol]	[Symbol]
LOCATION SURVEY MARKER	[Symbol]	[Symbol]
UTILITIES		
FIBER OPTICS	-FO-	-FO-
OVERHEAD CABLE TV	-OTV-	-OTV-
UNDERGROUND CABLE TV	-UTV-	-UTV-
OVERHEAD TELEPHONE	-OT-	-OT-
UNDERGROUND TELEPHONE	-UT-	-UT-
OVERHEAD POWER	-OE-	-OE-
UNDERGROUND POWER	-UE-	-UE-
SANITARY SEWER	-S-	-S-
STORM SEWER	-SS-	-SS-
GAS	-G-	-G-
WATER	-W-	-W-
MANHOLE	[Symbol]	[Symbol]
FIRE HYDRANT	[Symbol]	[Symbol]
WATER VALVE	[Symbol]	[Symbol]
WATER METER	[Symbol]	[Symbol]
DROP INLET	[Symbol]	[Symbol]
DITCH BLOCK	[Symbol]	[Symbol]
GROUND MOUNTED SIGN	[Symbol]	[Symbol]
LIGHT POLE	[Symbol]	[Symbol]
H-FRAME POWER POLE	[Symbol]	[Symbol]
TELEPHONE PEDESTAL	[Symbol]	[Symbol]
FENCE	[Symbol]	[Symbol]
CHAIN LINK	[Symbol]	[Symbol]
WOVEN WIRE	[Symbol]	[Symbol]
GATE POST	[Symbol]	[Symbol]
BENCHMARK	[Symbol]	[Symbol]

NOTE: DASHED OR OPEN SYMBOLS INDICATE EXISTING FEATURES

LENGTH OF PROJECT

RTE 72	
BEGINNING OF PROJECT STA.	417 + 05.46
END OF PROJECT STA.	431 + 00.00
APPARENT LENGTH	1394.54 FEET
EQUATIONS AND EXCEPTIONS:	
429+75.00 BK = 429+46.00 AH	+29.00 FEET
RTE 51	
BEGINNING OF PROJECT STA.	321 + 00.00
END OF PROJECT STA.	332 + 75.96
APPARENT LENGTH	1175.96 FEET
EQUATIONS AND EXCEPTIONS:	
TOTAL CORRECTIONS	+29.00 FEET
NET LENGTH OF PROJECT	2599.5 FEET
STATE LENGTH	0.492 MILES
FOR INFORMATION ONLY ESTIMATED DISTURBED ACRES	1.6 ACRES

THE EXISTENCE AND APPROXIMATE LOCATION OF UTILITY FACILITIES KNOWN TO EXIST, AS SHOWN ON THE PLANS, ARE BASED ON THE BEST INFORMATION AVAILABLE TO THE COMMISSION AT THIS TIME. THIS INFORMATION IS PROVIDED BY THE COMMISSION "AS-IS" AND THE COMMISSION EXPRESSLY DISCLAIMS ANY REPRESENTATION OR WARRANTY AS TO THE COMPLETENESS, ACCURACY, OR SUITABILITY OF THE INFORMATION FOR ANY USE. RELIANCE UPON THIS INFORMATION IS DONE AT THE RISK AND PERIL OF THE USER, AND THE COMMISSION SHALL NOT BE LIABLE FOR ANY DAMAGES THAT MAY ARISE FROM ANY ERROR IN THE INFORMATION. IT IS, THEREFORE, THE RESPONSIBILITY OF THE CONTRACTOR TO VERIFY THE EXISTENCE, LOCATION AND STATUS OF ANY FACILITY. SUCH VERIFICATION INCLUDES DIRECT CONTACT WITH THE LISTED UTILITIES.

MISSOURI HIGHWAYS AND TRANSPORTATION COMMISSION
 105 WEST CAPITOL JEFFERSON CITY, MO 65102
 1-888-ASK-MODOT (1-888-275-6636)

WARNING SIGNS										GUIDE SIGNS										EFFECTIVE: 07-01-2024		STATE OF MISSOURI	
SIGN	SIZE IN.	AREA SQ.FT.	QTY EACH	TOTAL AREA SQ.FT.	QTY RELOC EACH	TOTAL RELOC SQ.FT.	SIGN NUM.	DESCRIPTION	SIGN	SIZE IN.	AREA SQ.FT.	QTY EACH	TOTAL SQ.FT.	QTY RELOC EACH	TOTAL RELOC SQ.FT.	SIGN NUM.	DESCRIPTION	ITEM NUMBER	TOTAL QTY	DESCRIPTION	ROUTE	STATE	
WO1-1L	48X48	16.00						TURN (SYMBOL LEFT)	E05-1	36X48	12.00						GORE EXIT	6122008		IMPACT ATTENUATOR 40 MPH (SAND BARRELS)	72/51	MO	
WO1-1R	48X48	16.00						TURN (SYMBOL RIGHT)	E05-2	48X36	12.00						EXIT OPEN	6122009		IMPACT ATTENUATOR 45 MPH (SAND BARRELS)	SE	3	
WO1-2L	48X48	16.00						CURVE (SYMBOL LEFT)	E05-2a	48X36	12.00						EXIT CLOSED	6122010		IMPACT ATTENUATOR 50 MPH (SAND BARRELS)			
WO1-2R	48X48	16.00						CURVE (SYMBOL RIGHT)	GO20-1	60X24	10.00						ROAD WORK NEXT XX MILES	6122012		IMPACT ATTENUATOR 55 MPH (SAND BARRELS)			
WO1-3L	48X48	16.00						REVERSE TURN (SYMBOL LEFT)	GO20-2	48X24	8.00						END ROAD WORK	6122014		IMPACT ATTENUATOR 60 MPH (SAND BARRELS)			
WO1-3R	48X48	16.00						REVERSE TURN (SYMBOL RIGHT)	GO20-4	36X18	4.50						PILOT CAR FOLLOW ME	6122017		IMPACT ATTENUATOR 65 MPH (SAND BARRELS)			
WO1-4L	48X48	16.00						REVERSE CURVE (SYMBOL LEFT)	GO20-4a	42X30	8.75						PILOT CAR IN USE WAIT & FOLLOW	6122019		IMPACT ATTENUATOR 70 MPH (SAND BARRELS)			
WO1-4R	48X48	16.00						REVERSE CURVE (SYMBOL RIGHT)	GO20-4a	18X12	1.50						PILOT CAR IN USE WAIT & FOLLOW	6122020		REPLACEMENT SAND BARREL			
WO1-4bL	48X48	16.00						DOUBLE ARROW REVERSE CURVE (SYMBOL LEFT)	GO20-5aP	36X24	6.00	4	24.00				WORK ZONE (PLAQUE)	6122030		IMPACT ATTENUATOR (RELOCATION)			
WO1-4bR	48X48	16.00						DOUBLE ARROW REVERSE CURVE (SYMBOL RIGHT)	MO4-8a	24X18	3.00						END DETOUR	6123001		TRUCK MOUNTED ATTENUATOR (TMA)			
WO1-4cL	48X48	16.00						TRIPLE ARROW REVERSE CURVE (SYMBOL LEFT)	MO4-9L	48X36	12.00	1	12.00				DETOUR (LEFT)	6161008		ADVANCED WARNING RAIL SYSTEM			
WO1-4cR	48X48	16.00						TRIPLE ARROW REVERSE CURVE (SYMBOL RIGHT)	MO4-9R	48X36	12.00	1	12.00				DETOUR (RIGHT)	6161012		BUOYS (BOATS KEEP OUT)			
WO1-6	60X30	12.50						HORIZONTAL ARROW (SYMBOL)	MO4-9P	48X12	4.00						STREET NAME (PLAQUE)	6161013		BUOYS (NO WAKE)			
WO1-6a	72X36	18.00						HORIZ. ARROW (SYMBOL ON PERMANENT BARRICADE)	MO4-10L	48X18	6.00						DETOUR ARROW (LEFT)	6161014	100	SPECIAL SIGN ASSEMBLY (BOATS KEEP OUT)			
WO1-7	60X30	12.50						DOUBLE HEAD HORIZONTAL ARROW (SYMBOL)	MO4-10R	48X18	6.00						DETOUR ARROW (RIGHT)	6161025	35	CHANNELIZER (TRIM LINE)			
WO1-7a	72X36	18.00						DOUBLE HEAD HORIZ. ARROW (SYMBOL ON PERM. BARR.)	REGULATORY SIGNS								6161030		TYPE III MOVEABLE BARRICADE				
WO1-8	18X24	3.00						CHEVRON (SYMBOL)	R1-1	48X48	13.25						STOP	6161033		DIRECTION INDICATOR BARRICADE			
WO1-8a	30X36	7.50						CHEVRON (SYMBOL FOR DIVIDED HIGHWAYS)	R1-2	48TRI.	6.93						YIELD	6161040		FLASHING ARROW PANEL			
WO3-1	48X48	16.00						STOP AHEAD (SYMBOL)	R1-2a	36X36	9.00						TO ONCOMING TRAFFIC (PLAQUE)	6161047		TYPE III OBJECT MARKER			
WO3-2	48X48	16.00						YIELD AHEAD (SYMBOL)	R1-3P	30X12	2.50						ALL WAY (PLAQUE)	6161055		SEQUENTIAL FLASHING WARNING LIGHT			
WO3-3	48X48	16.00	4	64.00				SIGNAL AHEAD (SYMBOL)	R2-1	36X48	12.00	10	120.00				SPEED LIMIT 4@35, 4@55, 2@25	6161070		TUBULAR MARKER			
WO3-4	48X48	16.00						BE PREPARED TO STOP	R3-1	48X48	16.00						NO RIGHT TURN (SYMBOL)	6161095		RADAR SPEED ADVISORY SYSTEM			
WO3-5	48X48	16.00	4	64.00				SPEED LIMIT AHEAD	R3-2	48X48	16.00						NO LEFT TURN (SYMBOL)	6161096		CHANGEABLE MESSAGE SIGN, COMMISSION FURNISHED/RETAINED			
WO4-1L	48X48	16.00						MERGE (SYMBOL FROM LEFT)	R3-3	36X36	9.00						NO TURNS	6161098A	* 4	CHANGEABLE MESSAGE SIGN WITHOUT COMM. INTERFACE- CONTRACTOR FURNISHED/RETAINED			
WO4-1R	48X48	16.00						MERGE (SYMBOL FROM RIGHT)	R3-4	48X48	16.00						NO U-TURN (SYMBOL)	6161099		CHANGEABLE MESSAGE SIGN WITH COMM. INTERFACE- CONTRACTOR FURNISHED/RETAINED			
WO4-1aL	48X48	16.00						MERGE (LEFT)	R3-7L	30X30	6.25						LEFT LANE MUST TURN LEFT	6162000A		WORK ZONE TRAFFIC SIGNAL SYSTEM			
WO4-1aR	48X48	16.00						MERGE (RIGHT)	R3-7R	30X30	6.25						RIGHT LANE MUST TURN RIGHT	6162002	2	TEMPORARY LONG-TERM RUMBLE STRIPS			
WO5-1	48X48	16.00						ROAD/BRIDGE/RAMP NARROWS	R4-1	36X48	12.00						DO NOT PASS	61736000	*1300	CONTRACTOR FURNISHED/RETAINED			
WO5-3	48X48	16.00						ONE LANE BRIDGE	R4-2	36X48	12.00						PASS WITH CARE	6173602B		TEMPORARY TRAFFIC BARRIER CONTRACTOR FURNISHED/COMMISSION RETAINED			
WO5-5	48X48	16.00						NARROW LANES	R4-7a	36X48	12.00						KEEP RIGHT (HORIZONTAL ARROW)	6174000A	* 2	TEMP. TRAFFIC BARRIER HEIGHT TRANSITION			
WO6-1	48X48	16.00						DIVIDED HIGHWAY (SYMBOL)	R4-8a	36X48	12.00						KEEP LEFT (HORIZONTAL ARROW)	6175010A	***	RELOCATING TEMPORARY TRAFFIC BARRIER			
WO6-2	48X48	16.00						DIVIDED HIGHWAY END (SYMBOL)	R5-1	30X30	6.25						DO NOT ENTER	6177000B		TEMPORARY TRAFFIC BARRIER COMMISSION FURNISHED/RETAINED			
WO6-3	48X48	16.00						TWO WAY TRAFFIC (SYMBOL)	R5-1a	36X24	6.00	2	12.00				WRONG WAY	6208064A		TEMPORARY RAISED PAVEMENT MARKER			
WO7-3a	30X24	5.00						NEXT XX MILES (PLAQUE)	R6-1L	54X18	6.75						ONE WAY ARROW (LEFT)	9029400		TEMPORARY TRAFFIC SIGNALS			
WO8-1	48X48	16.00						BUMP	R6-1R	54X18	6.75	2	13.50				ONE WAY ARROW (RIGHT)	9029401		TEMPORARY TRAFFIC SIGNALS AND LIGHTING			
WO8-2	48X48	16.00						DIP	R6-2L	24X30	5.00						ONE WAY (LEFT)						
WO8-3	48X48	16.00						PAVEMENT ENDS	R6-2R	24X30	5.00						ONE WAY (RIGHT)	6176000B		COMMISSION FURNISHED/RETAINED			
WO8-4	48X48	16.00						SOFT SHOULDER	R9-9	24X12	2.00						SIDEWALK CLOSED						
WO8-5	48X48	16.00						SLIPPERY WHEN WET (SYMBOL)	R9-11L	24X18	3.00						SIDEWALK CLOSED AHEAD, (ARROW LEFT) CROSS HERE	6177000B		TEMP. TRAFFIC BARRIER HEIGHT TRANSITION			
WO8-6	48X48	16.00						TRUCK CROSSING	R10-6	24X36	6.00	4	24.00				STOP HERE ON RED (45^ ARROW)	6208064A		COMMISSION FURNISHED/RETAINED			
WO8-6c	48X48	16.00						TRUCK ENTRANCE	R11-2	48X30	10.00	11	110.00				ROAD CLOSED	9029400		TEMPORARY RAISED PAVEMENT MARKER			
WO8-7	36X36	9.00						LOOSE GRAVEL	R11-3a	60X30	12.50						ROAD CLOSED XX MILES AHEAD	9029401		TEMPORARY TRAFFIC SIGNALS			
WO8-7a	36X36	9.00						FRESH OIL / LOOSE GRAVEL	R11-4	60X30	12.50						LOCAL TRAFFIC ONLY						
WO8-9	48X48	16.00						LOW SHOULDER	CONST-3A	60X48	20.00						ROAD CLOSED TO THRU TRAFFIC						
WO8-11	48X48	16.00	2	32.00				UNEVEN LANES	CONST-3X	56X12	4.67						FINE SIGN						
WO8-12	48X48	16.00	2	32.00				NO CENTER LINE	MISCELLANEOUS SIGNS														
WO8-15	48X48	16.00						GROOVED PAVEMENT	CONST-5	48X36	12.00						POINT OF PRESENCE						
WO8-15P	30X24	5.00						MOTORCYCLE (PLAQUE)	CONST-5	96X48	32.00						POINT OF PRESENCE						
WO8-17L	48X48	16.00						SHOULDER DROP-OFF (SYMBOL LEFT)	CONST-8	48X36	12.00						WORK ZONE NO PHONE ZONE						
WO8-17R	48X48	16.00						SHOULDER DROP-OFF (SYMBOL RIGHT)		60X36	15.00	15	225.00				DETOUR BLANK						
WO8-17P	30X24	5.00						SHOULDER DROP-OFF (PLAQUE)															
W10-1	42RND.	9.62						RAILROAD CROSSING															
WO12-1	24X24	4.00						DOUBLE DOWN ARROW (SYMBOL)															
WO12-2	48X48	16.00						LOW CLEARANCE (SYMBOL)															
WO12-2x	24X18	3.00						LOW CLEARANCE (PLAQUE)															
WO12-2a	84X24	14.00						OVERHEAD LOW CLEARANCE (FEET AND INCHES)															
WO12-4	120X60	50.00						LOW CLEARANCE XX FT XX IN XX MILES AHEAD															
WO12-5	120X60	50.00						WIDTH RESTRICTION XX FT XX IN XX MILES AHEAD															
WO13-1	30X30	6.25						ADVISORY SPEED (PLAQUE)															
WO16-2	30X24	5.00						XXX FEET (PLAQUE)															
WO16-3	30X24	5.00						X MILE (PLAQUE)															
WO20-1	48X48	16.00	6	96.00				ROAD/BRIDGE/RAMP WORK AHEAD															
WO20-2	48X48	16.00	3	48.00				DETOUR AHEAD															
WO20-3	48X48	16.00	4	64.00				ROAD CLOSED 2@1000FT, 2@500FT															
WO20-4	48X48	16.00	6	96.00				ONE LANE ROAD AHEAD															
WO20-5	48X48	16.00						RIGHT/CENTER/LEFT LANE CLOSED AHEAD															
WO20-5a	48X48	16.00						2 RIGHT/CENTER/LEFT LANES CLOSED AHEAD															
WO20-6a	48X48	16.00						RIGHT/CENTER/LEFT LANE CLOSED															
WO20-7a	48X48	16.00	2	32.00				FLAGGER (SYMBOL)															
WO21-2	36X36	9.00						FRESH OIL															
WO21-5	48X48	16.00						SHOULDER WORK / SHOULDER WORK AHEAD															
WO22-1	48X48	16.00						BLASTING ZONE AHEAD															
WO22-2	42X36	10.50						TURN OFF 2-WAY RADIO AND PHONE															
WO22-3	42X36	10.50						END BLASTING ZONE															
GO22-1	21X15	2.19						WET PAINT (ARROW PIVOTS)															
									616-10.05 CONSTRUCTION SIGNS								TOTAL 1081						
									616-10.10 RELOCATED SIGNS								TOTAL ***						

TEMPORARY TRAFFIC CONTROL
 616-99.01
 LUMP SUM 1

* ITEMS NOT INCLUDED IN LUMP SUM TEMPORARY TRAFFIC CONTROL.
 ** PORTABLE TRAFFIC SIGNAL SYSTEM SHALL BE PAID FOR AS EACH FOR THE ENTIRE PROJECT, REGARDLESS OF HOW MANY SIGNALS ARE USED. ANY REQUIREMENT TO RELOCATE THE SIGNALS DUE TO STAGING SHALL BE CONSIDERED AS INCIDENTAL TO CONSTRUCTION.
 *** NO DIRECT PAY FOR RELOCATING TEMPORARY TRAFFIC CONTROL DEVICES.



DATE PREPARED: 11/6/2024

ROUTE: 72/51 STATE: MO

DISTRICT: SE SHEET NO.: 3

COUNTY: BOLLINGER

JOB NO.: J9P3842

CONTRACT ID.

PROJECT NO.

BRIDGE NO.

DESCRIPTION

DATE

MISSOURI HIGHWAYS AND TRANSPORTATION COMMISSION



105 WEST CAPITOL JEFFERSON CITY, MO 65102
1-888-ASK-MODOT (1-888-275-6636)

SUMMARY OF QUANTITIES
SHEET 5 OF 5

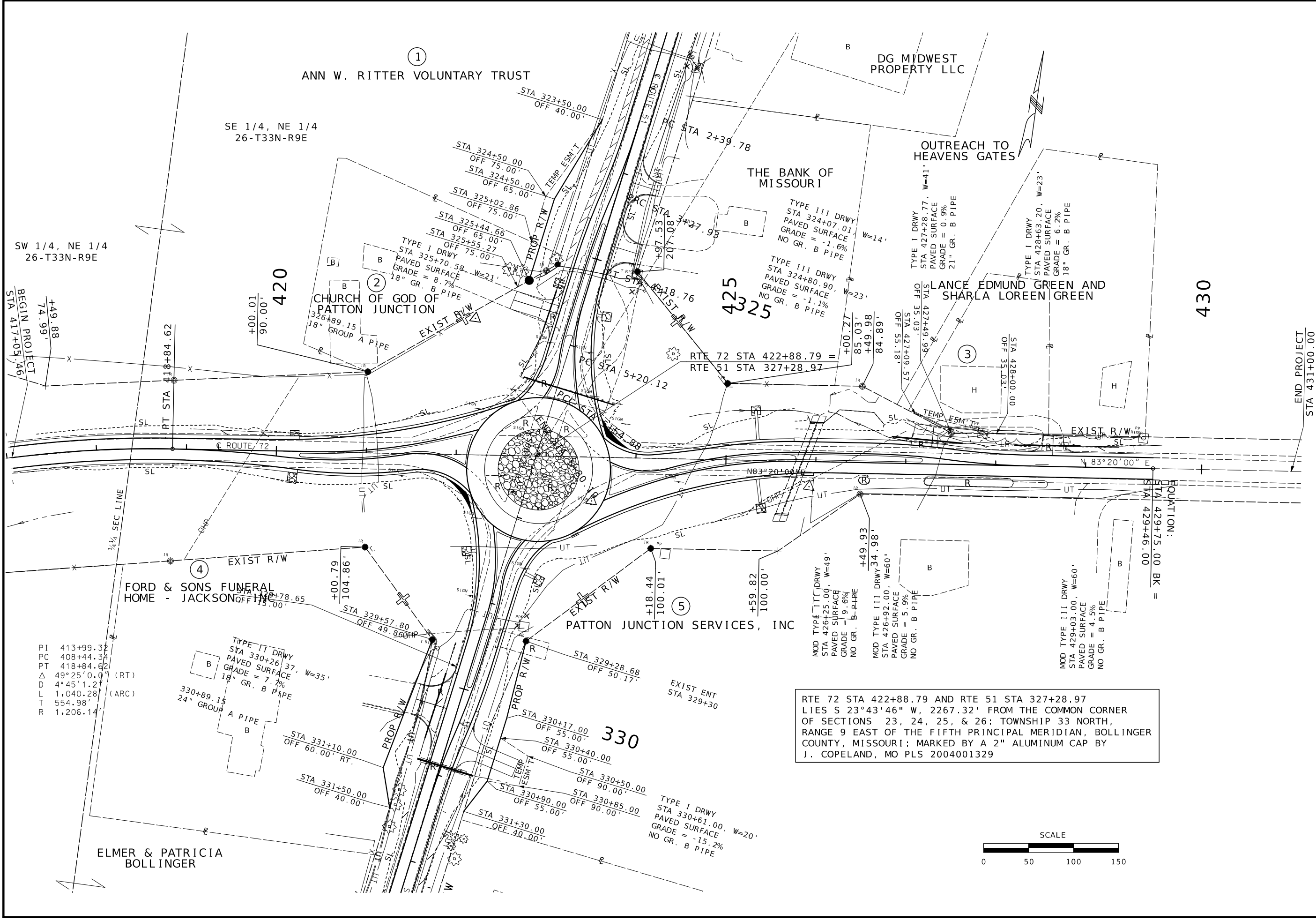

SW 1/4, NE 1/4
26-T33N-R9E

SE 1/4, NE 1/4
26-T33N-R9E

ANN W. RITTER VOLUNTARY TRUST

CHURCH OF GOD OF PATTON JUNCTION

PATTON JUNCTION SERVICES, INC

FORD & SONS FUNERAL HOME - JACKSON

ELMER & PATRICIA BOLLINGER

DG MIDWEST PROPERTY LLC

THE BANK OF MISSOURI

OUTREACH TO HEAVENS GATES

LANCE EDMUND GREEN AND SHARLA LOREEN GREEN

RTE 72 STA 422+88.79 AND RTE 51 STA 327+28.97 LIES S 23°43'46" W, 2267.32' FROM THE COMMON CORNER OF SECTIONS 23, 24, 25, & 26: TOWNSHIP 33 NORTH, RANGE 9 EAST OF THE FIFTH PRINCIPAL MERIDIAN, BOLLINGER COUNTY, MISSOURI; MARKED BY A 2" ALUMINUM CAP BY J. COPELAND, MO PLS 2004001329

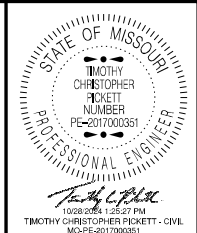
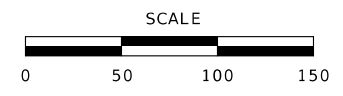

DATE PREPARED		10/22/2024	
ROUTE	STATE	DISTRICT	SHEET NO.
72/51	MO	SE	4
COUNTY		BOLLINGER	
CONTRACT ID.			
PROJECT NO.			
BRIDGE NO.			

DATE	DESCRIPTION

MISSOURI HIGHWAYS AND TRANSPORTATION COMMISSION

105 WEST CAPITOL
JEFFERSON CITY, MO 65102
1-888-ASK-MODOT (1-888-275-6636)

RTE 72
PLAN SHEET
1 OF 2

COORDINATE POINTS (ALIGNMENTS)			
LOC	STA	Y-N	X-E
RAS_CL (BL FOR RTE 51 SOUTH LEG)			
POT	0+00.00	613517.1765	960676.0429
PI	3+96.79	613908.6527	960740.7374
PC	3+64.48	613876.782	960735.4705
PCC	4+28.54	613940.5609	960735.7031
CC		613909.3913	960538.1468
PI	4+45.71	613957.5287	960733.0259
PCC	4+28.54	613940.5609	960735.7031
PT	4+62.86	613974.1094	960728.5366
CC		613891.0013	960421.5887
RAS_IEOP_51 (BL FOR RTE 51 SOUTH LEG)			
PI	0+44.79	613696.7821	960705.7241
PC	0+00.00	613652.5900	960698.4210
PRC	0+89.49	613739.8826	960717.9146
CC		613522.1529	961487.7157
PI	1+34.28	613782.9832	960730.1052
PRC	0+89.49	613739.8826	960717.9146
PT	1+78.98	613827.1752	960737.4082
CC		613957.6124	959948.1135
PI	2+44.63	613891.9472	960748.1123
PC	2+27.61	613875.1516	960745.3367
PRC	2+61.58	613908.9707	960748.1464
CC		613909.3913	960538.1468
PI	2+91.33	613938.7195	960748.2060
PRC	2+61.58	613908.9707	960748.1464
PT	3+19.04	613962.5725	960765.9833
CC		613908.7904	960838.1462
RASE_BL_51 (BL FOR RTE 51 SOUTH LEG)			
POT	0+00.00	613515.2200	960687.8823
PI	1+81.37	613694.1626	960717.4540
PC	1+37.25	613650.6335	960710.2605
PRC	2+25.40	613736.6167	960729.4617
CC		613522.1529	961487.7157
PI	2+70.86	613780.3638	960741.8350
PRC	2+25.40	613736.6167	960729.4617
PT	3+16.23	613825.2187	960749.2477
CC		613957.6124	959948.1135
PI	4+17.06	613924.7017	960765.6880
PC	3+99.19	613907.0700	960762.7742
PCC	4+34.67	613940.7192	960773.6129
CC		613887.5045	960881.1684
PI	4+51.88	613956.1432	960781.2442
PCC	4+34.67	613940.7192	960773.6129
PT	4+68.45	613966.4495	960795.0252
CC		613908.7904	960838.1462

COORDINATE POINTS (ALIGNMENTS)			
LOC	STA	Y-N	X-E
RASW_BL_51 (BL FOR RTE 51 SOUTH LEG)			
POT	0+00.00	613519.1331	960664.2035
PI	4+13.03	613926.6338	960731.5462
PC	3+27.33	613842.0873	960717.5742
PT	4+94.28	614005.8041	960698.7534
CC		613891.0013	960421.5887
RASE_BL_72 (BL FOR RTE 72 EAST LEG)			
POT	0+00.00	614124.5874	961448.1933
PI	5+10.58	614065.3125	960941.0641
PC	3+57.77	614083.0530	961092.8431
PT	6+57.03	613977.1305	960816.2622
CC		613487.1099	961162.4988
RAE_CL (BL FOR RTE 72 EAST LEG)			
POT	0+00.00	614136.5063	961446.8002
PI	4+75.67	614081.2838	960974.3416
PC	3+94.92	614090.6592	961054.5528
PCC	5+55.05	614047.1333	960901.1604
CC		613594.0400	961112.5992
PI	5+86.13	614033.9902	960872.9959
PCC	5+55.05	614047.1333	960901.1604
PT	6+17.16	614018.0877	960846.2922
CC		613487.1099	961162.4988
RAE_IEOP_72 (BL FOR RTE 72 EAST LEG)			
PI	0+44.79	614115.4815	961266.9214
PC	0+00.00	614120.6814	961311.4099
PRC	0+89.49	614115.2802	961222.1304
CC		614915.2721	961218.5356
PI	1+34.28	614115.0789	961177.3395
PRC	0+89.49	614115.2802	961222.1304
PT	1+78.98	614109.8790	961132.8509
CC		613315.2883	961225.7252
PI	3+32.12	614092.1005	960980.7467
PC	2+58.98	614100.5915	961053.3919
PRC	4+04.27	614063.5354	960913.4159
CC		613594.0400	961112.5992
PI	4+39.55	614049.7561	960880.9366
PRC	4+04.27	614063.5354	960913.4159
PT	4+71.52	614061.7204	960847.7458
CC		614146.3876	960878.2658
RTE51PRO (EXIST CL FOR RTE 51)			
POT	318+00.00 R1	614973.3812	960916.6921
POT	336+87.69 R1	613110.9557	960608.9117

COORDINATE POINTS (ALIGNMENTS)			
LOC	STA	Y-N	X-E
RANE_BL_72 (BL FOR RTE 72 EAST LEG)			
POT	0+00.00	614148.4251	961445.4071
PI	1+80.43	614127.4783	961266.1956
PC	1+36.31	614132.6003	961310.0168
PRC	2+24.46	614127.2801	961222.0765
CC		614915.2721	961218.5356
PI	2+69.92	614127.0758	961176.6137
PRC	2+24.46	614127.2801	961222.0765
PT	3+15.29	614121.7978	961131.4578
CC		613315.2883	961225.7252
PI	4+40.97	614107.2073	961006.6277
PC	3+95.29	614112.5104	961051.9988
PRC	4+86.42	614094.1044	960962.8674
CC		613594.0400	961112.5992
PI	5+22.05	614083.8835	960928.7326
PRC	4+86.42	614094.1044	960962.8674
PCC	5+57.65	614076.1182	960893.9569
CC		615052.0821	960676.0249
PI	5+89.26	614069.2295	960863.1074
PCC	5+57.65	614076.1182	960893.9569
PT	6+17.22	614087.2771	960837.1569
CC		614146.3876	960878.2658
RANE_BL_51 (BL FOR RTE 51 NORTH LEG)			
POT	0+00.00	614675.4391	960879.6176
PI	5+09.85	614172.4130	960796.4886
PC	4+15.50	614265.5010	960811.8721
PT	5+98.32	614087.2771	960837.1569
CC		614216.5871	961107.8577
RAN_CL (BL FOR RTE 51 NORTH LEG)			
POT	0+00.00	614677.3957	960867.7782
PI	4+84.95	614198.9357	960788.7089
PC	4+52.65	614230.8063	960793.9758
PCC	5+16.70	614167.0275	960793.7433
CC		614198.1970	960991.2995
PI	5+44.42	614139.6413	960798.0641
PCC	5+16.70	614167.0275	960793.7433
PT	5+72.01	614113.4160	960807.0592
CC		614216.5871	961107.8577
RTE72PRO (EXIST CL FOR RTE 72)			
POT	403+24.89 R1	613053.8748	959213.0507
PI	413+99.32 R1	613945.4921	959812.5692
PC	408+44.34 R1	613484.9458	959502.9004
PT	418+84.62 R1	614009.9208	960363.7920
CC		612811.9356	960503.8164
STA EQ	429+75.00 R1	614136.5063	961446.8002
STA EQ	429+46.00 R2	614136.5063	961446.8002
POT	431+97.61 R2	614165.7168	961696.7121

COORDINATE POINTS (ALIGNMENTS)			
LOC	STA	Y-N	X-E
RAN_IEOP_51 (BL FOR RTE 51 NORTH LEG)			
PI	0+44.79	614396.6275	960821.3791
PC	0+00.00	614440.8195	960828.6821
PRC	0+89.49	614353.5269	960809.1885
CC		614571.2567	960039.3874
PI	1+34.28	614310.4263	960796.9980
PRC	0+89.49	614353.5269	960809.1885
PT	1+78.98	614266.2343	960789.6949
CC		614135.7972	961578.9897
PI	2+62.42	614183.9094	960776.0901
PC	2+45.22	614200.8831	960778.8951
PRC	2+79.55	614166.7055	960776.0850
CC		614166.6433	960986.0850
PI	3+03.32	614142.9290	960776.0780
PRC	2+79.55	614166.7055	960776.0850
PT	3+26.04	614122.2584	960764.3287
CC		614166.7322	960686.0850
RANW_BL_51 (BL FOR RTE 51 NORTH LEG)			
POT	0+00.00	614679.3523	960855.9388
PI	2+83.90	614399.2470	960809.6492
PC	2+39.78	614442.7761	960816.8427
PRC	3+27.93	614356.7929	960797.6415
CC		614571.2567	960039.3874
PI	3+73.40	614313.0458	960785.2681
PRC	3+27.93	614356.7929	960797.6415
PT	4+18.76	614268.1909	960777.8555
CC		614135.7972	961578.9897
PI	5+37.62	614150.9250	960758.4764
PC	5+20.12	614168.1946	960761.3303
PCC	5+54.88	614135.1903	960750.8083
CC		614187.7602	960642.9361
PI	5+67.67	614123.6937	960745.2056
PCC	5+54.88	614135.1903	960750.8083
PT	5+80.19	614114.8299	960735.9865
CC		614166.7322	960686.0850
RANW_BL_72 (BL FOR RTE 72 WEST LEG)			
PI	0+86.52	614010.1040	960268.4384
PC	0+00.00	613987.4512	960184.9325
PT	1+72.76	614020.7247	960354.3079
CC		612811.9356	960503.8164
PI	4+31.70	614052.5091	960611.2875
PC	2+94.14	614035.6244	960474.7726
PT	5+66.59	614114.0219	960734.3224
CC		614829.5745	960376.5733

COORDINATE POINTS (ALIGNMENTS)			
LOC	STA	Y-N	X-E
RAW_CL (BL FOR RTE 72 WEST LEG)			
PI	0+89.74	613999.3634	960274.6796
PC	0+00.00	613975.8698	960188.0742
PT	1+79.14	614009.7811	960363.8083
CC		612811.9356	960503.8164
PI	4+02.11	614035.8055	960585.2499
PC	3+35.09	614028.0254	960518.6868
PCC	4+68.57	614058.0800	960648.4561
CC		614623.9684	960449.0311
PI	4+95.25	614066.9464	960673.6154
PCC	4+68.57	614058.0800	960648.4561
PT	5+21.90	614077.4332	960698.1436
CC		614829.5745	960376.5733
RAW_IEOP_72 (BL FOR RTE 72 WEST LEG)			
PI	1+03.44	614016.2013	960381.8321
PC	0+00.00	613997.0199	960280.1846
PRC	2+06.38	614017.7928	960485.2614
CC		612811.9356	960503.8164
PI	2+76.90	614018.8778	960555.7743
PRC	2+06.38	614017.7928	960485.2614
PRC	3+46.50	614039.4232	960623.2364
CC		614517.7337	960477.5686
PI	3+83.00	614050.0577	960658.1554
PRC	3+46.50	614039.4232	960623.2364
PT	4+15.85	614033.3637	960690.6169
CC		613953.3273	960649.4566
RASW_BL_72 (BL FOR RTE 72 WEST LEG)			
PI	1+58.34	614005.7440	960344.0357
PC	0+00.00	613964.	

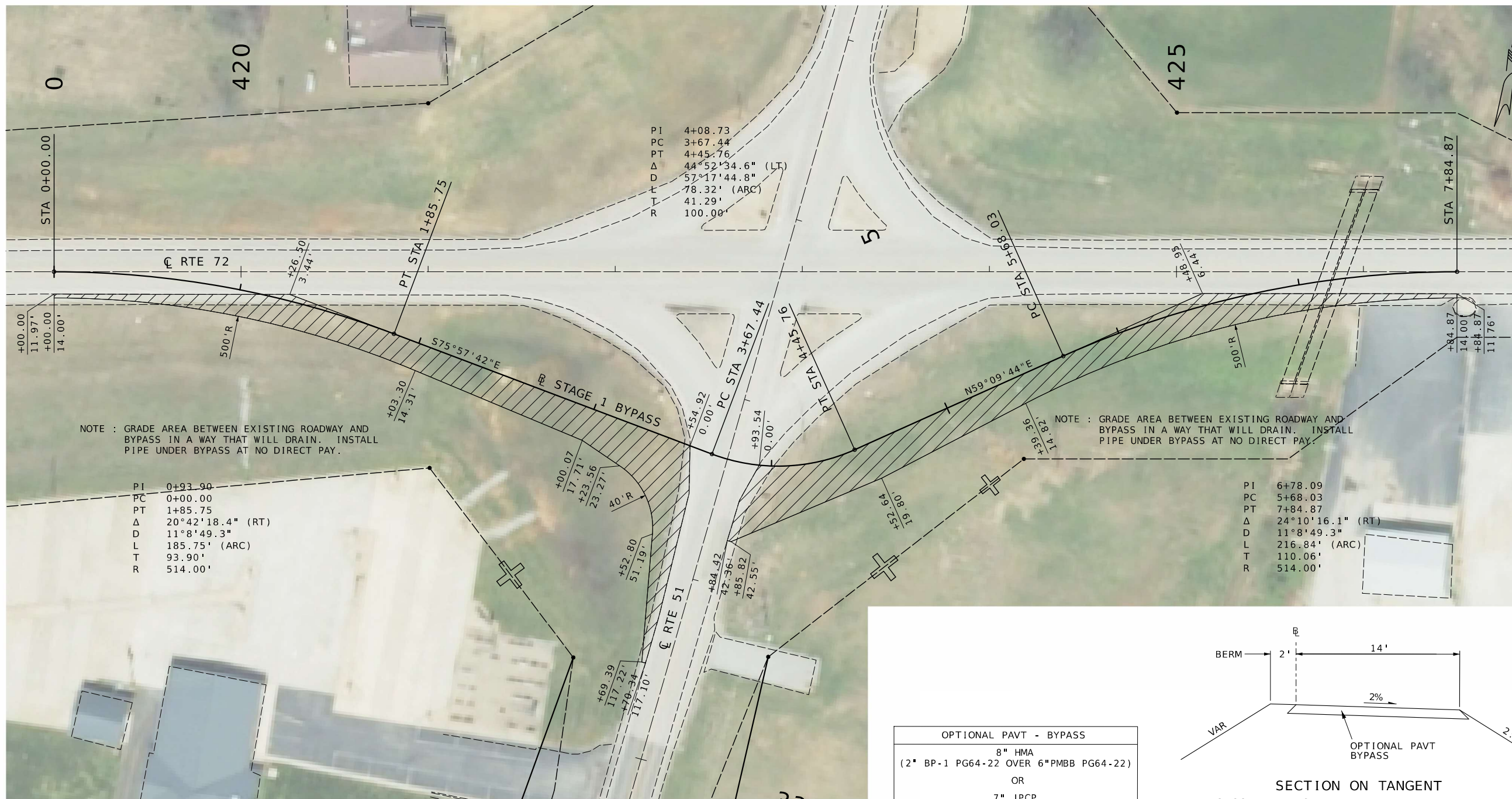

NOTE : GRADE AREA BETWEEN EXISTING ROADWAY AND BYPASS IN A WAY THAT WILL DRAIN. INSTALL PIPE UNDER BYPASS AT NO DIRECT PAY.

NOTE : GRADE AREA BETWEEN EXISTING ROADWAY AND BYPASS IN A WAY THAT WILL DRAIN. INSTALL PIPE UNDER BYPASS AT NO DIRECT PAY.

OPTIONAL PAVT BYPASS

OPTIONAL PAVT - BYPASS
 8" HMA
 (2" BP-1 PG64-22 OVER 6" PMBB PG64-22)
 OR
 7" JPCP
 (10' TRANSVERSE JOINT WITH NO DOWELS)

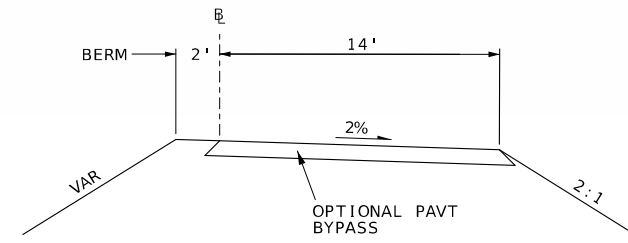

SECTION ON TANGENT
 PROPOSED TYPICAL SECTION - STAGE 1 BYPASS
 STA 0+00.00 TO STA STA 7+84.87

DRAWING NOT TO SCALE. FOLLOW DIMENSIONS.

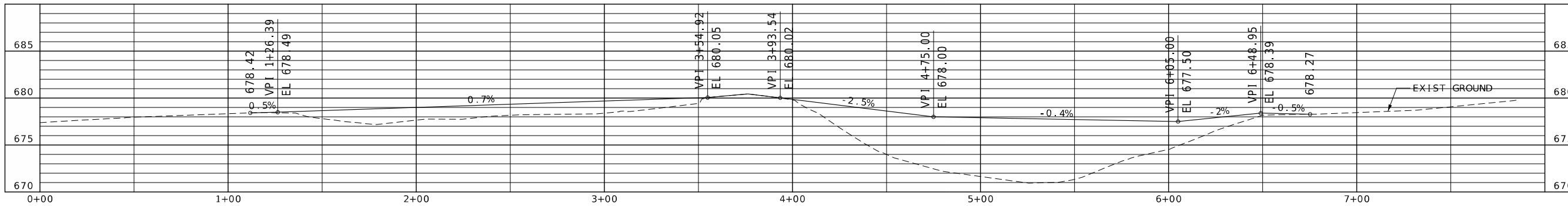

PROFILE - STAGE 1 BYPASS

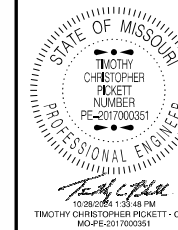

DATE PREPARED
 10/25/2024

ROUTE STATE
 72/51 MO

DISTRICT SHEET NO.
 SE 17

COUNTY
 BOLLINGER

JOB NO.
 J9P3842

CONTRACT ID.

PROJECT NO.

BRIDGE NO.

DATE	DESCRIPTION

MISSOURI HIGHWAYS AND TRANSPORTATION COMMISSION

 105 WEST CAPITOL JEFFERSON CITY, MO 65102
 1-888-ASK-MODOT (1-888-273-6636)

BYPASS 1 DETAILS
 SPECIAL SHEET 5 OF 7

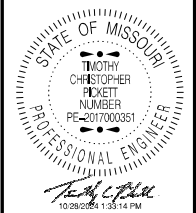

DATE PREPARED
10/25/2024
ROUTE 72/51 STATE MO
DISTRICT SE SHEET NO. 18
COUNTY BOLLINGER
JOB NO. J9P3842
CONTRACT ID.
PROJECT NO.
BRIDGE NO.

DATE	DESCRIPTION

MISSOURI HIGHWAYS AND TRANSPORTATION COMMISSION

 105 WEST CAPITOL JEFFERSON CITY, MO 65102
 1-888-ASK-MODOT (1-888-275-6636)

BYPASS 2 DETAILS
SPECIAL SHEET 6 OF 7



- MILL/FILL
- MODIFIED COLDMILLING (DEPTH TRANSITION)
- OPTIONAL PAVT BYPASS BASE WIDENING

OPTIONAL PAVT - BYPASS BASE WIDENING
 4" HMA
 (4" PMBB PG64-22)
 OR
 4" JPCP
 (10' TRANSVERSE JOINT WITH NO DOWELS)

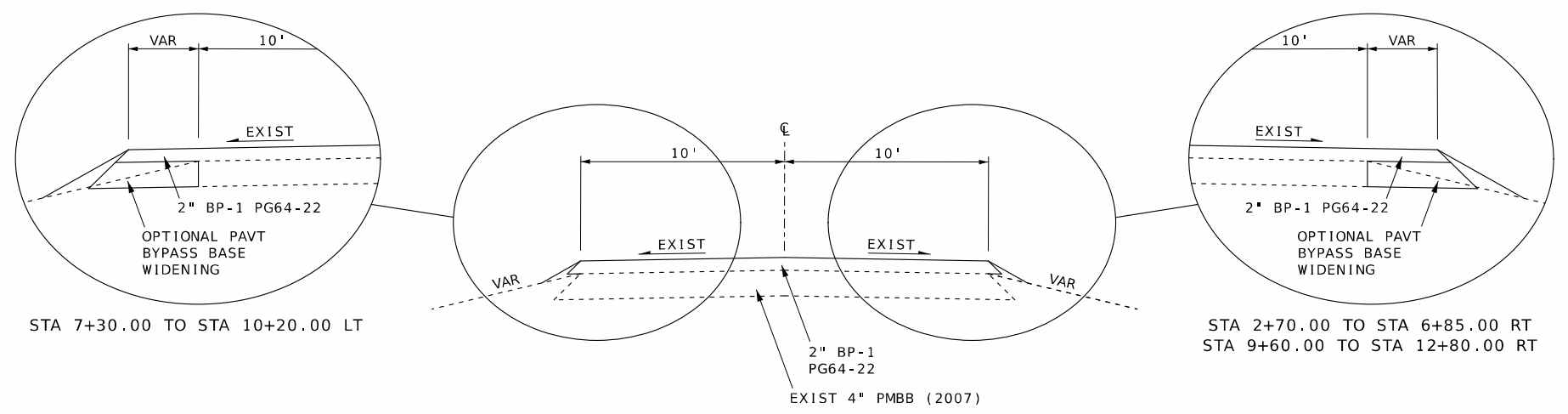

SECTION ON TANGENT
PROPOSED TYPICAL SECTION - BYPASS 2
STA 0+10.34 TO STA STA 19+40.35

DRAWING NOT TO SCALE. FOLLOW DIMENSIONS.

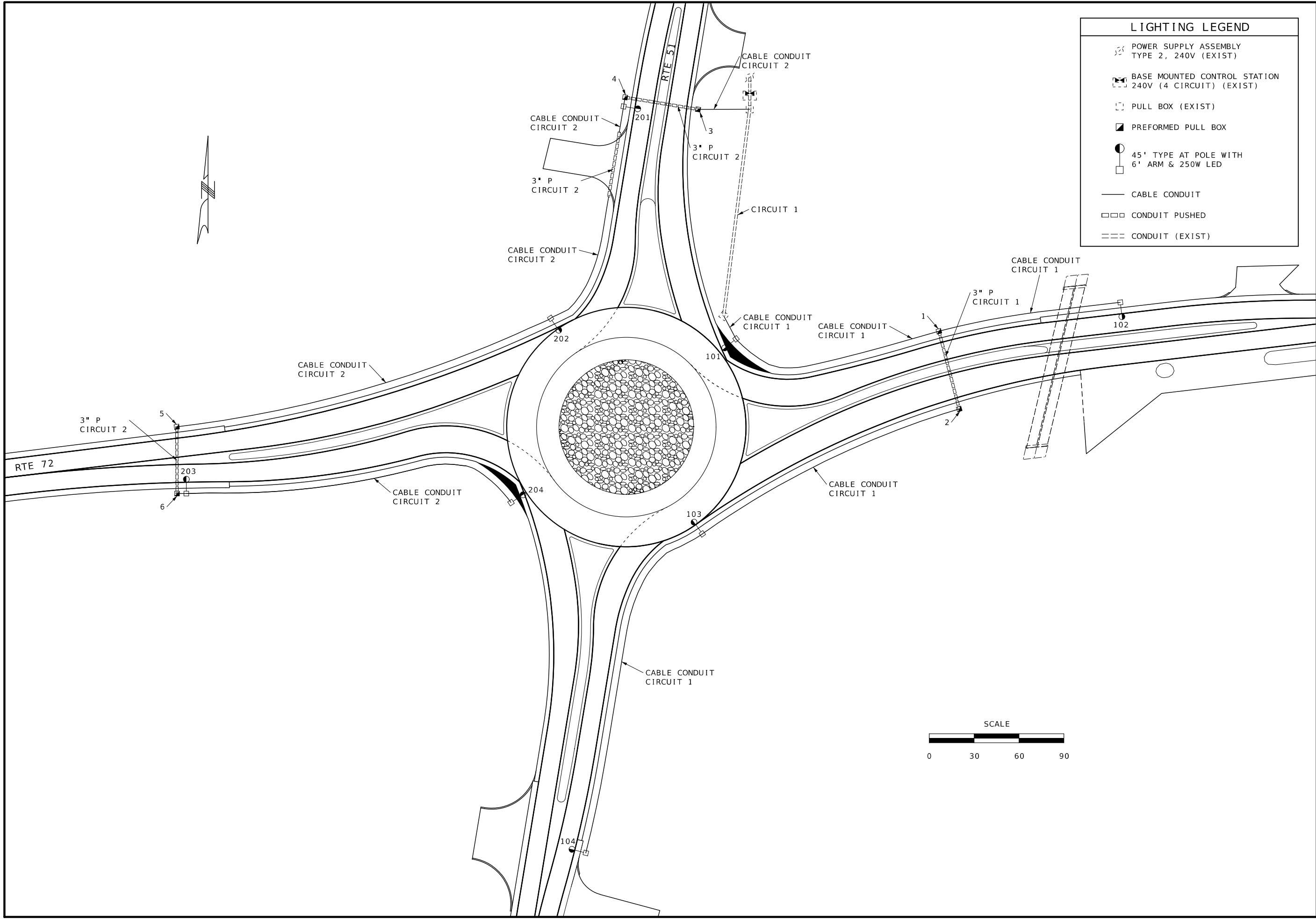

LIGHTING LEGEND

- POWER SUPPLY ASSEMBLY TYPE 2, 240V (EXIST)
- BASE MOUNTED CONTROL STATION 240V (4 CIRCUIT) (EXIST)
- PULL BOX (EXIST)
- PREFORMED PULL BOX
- 45' TYPE AT POLE WITH 6' ARM & 250W LED
- CABLE CONDUIT
- CONDUIT PUSHED
- CONDUIT (EXIST)

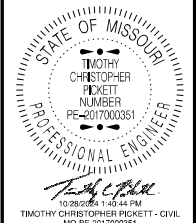

DATE PREPARED
10/23/2024

ROUTE STATE
72 / 51 MO

DISTRICT SHEET NO.
SE 27

COUNTY
BOLLINGER

JOB NO.
J9P3842

CONTRACT ID.

PROJECT NO.

BRIDGE NO.

DATE	DESCRIPTION

MISSOURI HIGHWAYS AND TRANSPORTATION COMMISSION

105 WEST CAPITOL
JEFFERSON CITY, MO 65102
1-888-ASK-MODOT (1-888-273-6636)

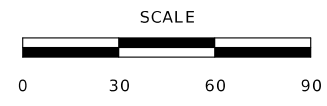

LIGHTING SHEET
SHEET 1 OF 1

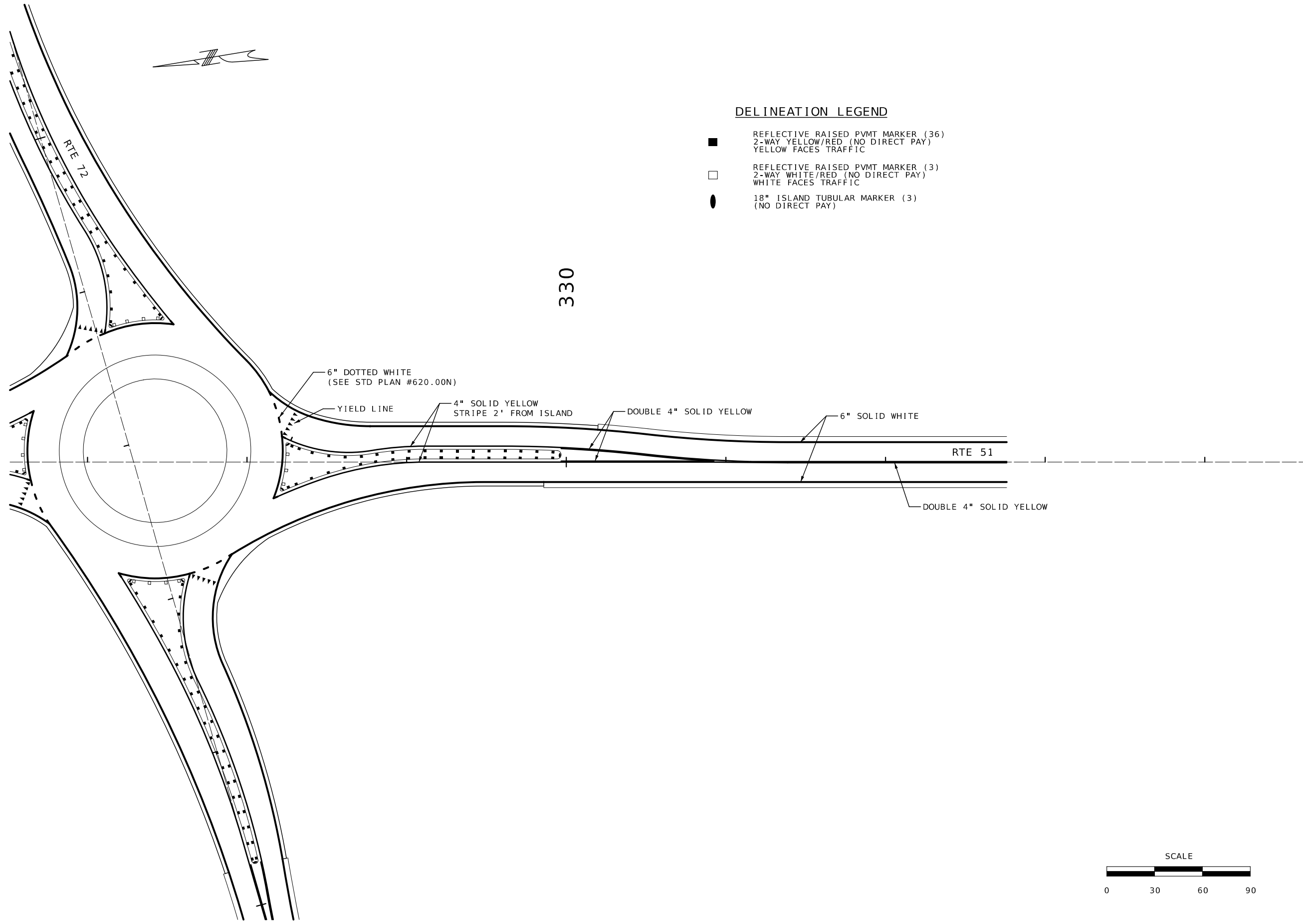

DELINEATION LEGEND

- REFLECTIVE RAISED PVMT MARKER (36)
2-WAY YELLOW/RED (NO DIRECT PAY)
YELLOW FACES TRAFFIC
- REFLECTIVE RAISED PVMT MARKER (3)
2-WAY WHITE/RED (NO DIRECT PAY)
WHITE FACES TRAFFIC
- 18" ISLAND TUBULAR MARKER (3)
(NO DIRECT PAY)

6" DOTTED WHITE
(SEE STD PLAN #620.00N)

YIELD LINE

4" SOLID YELLOW
STRIPE 2' FROM ISLAND

DOUBLE 4" SOLID YELLOW

6" SOLID WHITE

RTE 51

DOUBLE 4" SOLID YELLOW

330

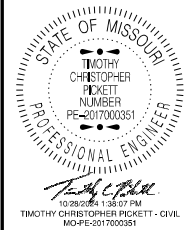
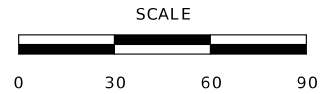

DATE PREPARED	
10/24/2024	
ROUTE	STATE
72/51	MO
DISTRICT	SHEET NO.
SE	37
COUNTY	
BOLLINGER	
JOB NO.	
J9P3842	
CONTRACT ID.	
PROJECT NO.	
BRIDGE NO.	

DATE	DESCRIPTION

MISSOURI HIGHWAYS AND TRANSPORTATION COMMISSION

105 WEST CAPITOL
JEFFERSON CITY, MO 65102
1-888-ASK-MODOT (1-888-273-6636)

RTE 51 (SOUTH LEG)
PAVEMENT MARKING
SHEET 4 OF 4

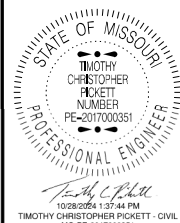

DATE PREPARED
10/23/2024

ROUTE STATE
72/51 MO

DISTRICT SHEET NO.
SE 39

COUNTY
BOLLINGER

JOB NO.
J9P3842

CONTRACT ID.

PROJECT NO.

BRIDGE NO.

DESCRIPTION

DATE

DESCRIPTION

DATE

DESCRIPTION

DATE

DESCRIPTION

DATE

DESCRIPTION

DATE

DESCRIPTION

DATE

DESCRIPTION

DATE

DESCRIPTION

DATE

DESCRIPTION

DATE

DESCRIPTION

DATE

DESCRIPTION

DATE

DESCRIPTION

DATE

DESCRIPTION

DATE

DESCRIPTION

DATE

DESCRIPTION

DATE

DESCRIPTION

DATE

DESCRIPTION

DATE

DESCRIPTION

MISSOURI HIGHWAYS AND TRANSPORTATION
COMMISSION



105 WEST CAPITOL
JEFFERSON CITY, MO 65102
1-888-ASK-MODOT (1-888-273-6636)

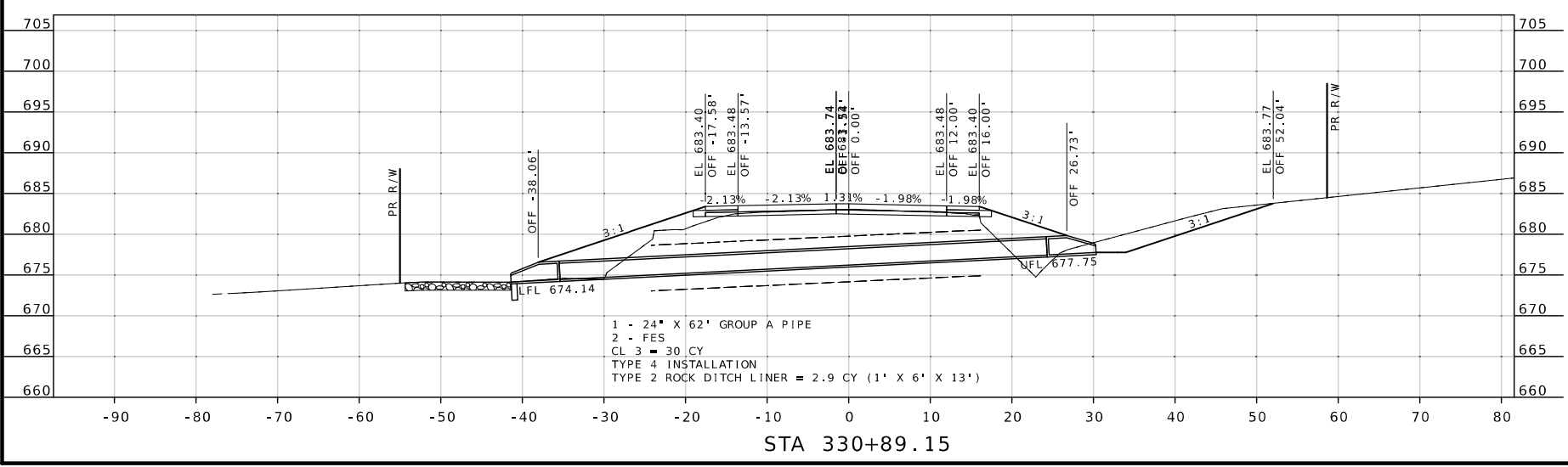

CULVERT SECTION
2 OF 2