

THIS SHEET HAS BEEN SIGNED, SEALED AND DATED ELECTRONICALLY.

DATE PREPARED
10/18/2024

ROUTE STATE
137 MO

DISTRICT SHEET NO.
SE 4

COUNTY
TEXAS

JOB NO.
JSE0027

CONTRACT ID.

PROJECT NO.

BRIDGE NO.
A9393

DESCRIPTION

DATE

MISSOURI HIGHWAYS AND TRANSPORTATION COMMISSION

105 WEST CAPITOL JEFFERSON CITY, MO 65102

1-888-ASK-MODOT (1-888-275-6636)

MISSOURI HIGHWAYS AND TRANSPORTATION COMMISSION

105 WEST CAPITOL JEFFERSON CITY, MO 65102

1-888-ASK-MODOT (1-888-275-6636)

MISSOURI HIGHWAYS AND TRANSPORTATION COMMISSION

105 WEST CAPITOL JEFFERSON CITY, MO 65102

1-888-ASK-MODOT (1-888-275-6636)

MISSOURI HIGHWAYS AND TRANSPORTATION COMMISSION

105 WEST CAPITOL JEFFERSON CITY, MO 65102

1-888-ASK-MODOT (1-888-275-6636)

MISSOURI HIGHWAYS AND TRANSPORTATION COMMISSION

105 WEST CAPITOL JEFFERSON CITY, MO 65102

1-888-ASK-MODOT (1-888-275-6636)

MISSOURI HIGHWAYS AND TRANSPORTATION COMMISSION

105 WEST CAPITOL JEFFERSON CITY, MO 65102

1-888-ASK-MODOT (1-888-275-6636)

MISSOURI HIGHWAYS AND TRANSPORTATION COMMISSION

105 WEST CAPITOL JEFFERSON CITY, MO 65102

1-888-ASK-MODOT (1-888-275-6636)

MISSOURI HIGHWAYS AND TRANSPORTATION COMMISSION

105 WEST CAPITOL JEFFERSON CITY, MO 65102

1-888-ASK-MODOT (1-888-275-6636)

MISSOURI HIGHWAYS AND TRANSPORTATION COMMISSION

105 WEST CAPITOL JEFFERSON CITY, MO 65102

1-888-ASK-MODOT (1-888-275-6636)

MISSOURI HIGHWAYS AND TRANSPORTATION COMMISSION

105 WEST CAPITOL JEFFERSON CITY, MO 65102

1-888-ASK-MODOT (1-888-275-6636)

MISSOURI HIGHWAYS AND TRANSPORTATION COMMISSION

105 WEST CAPITOL JEFFERSON CITY, MO 65102

1-888-ASK-MODOT (1-888-275-6636)

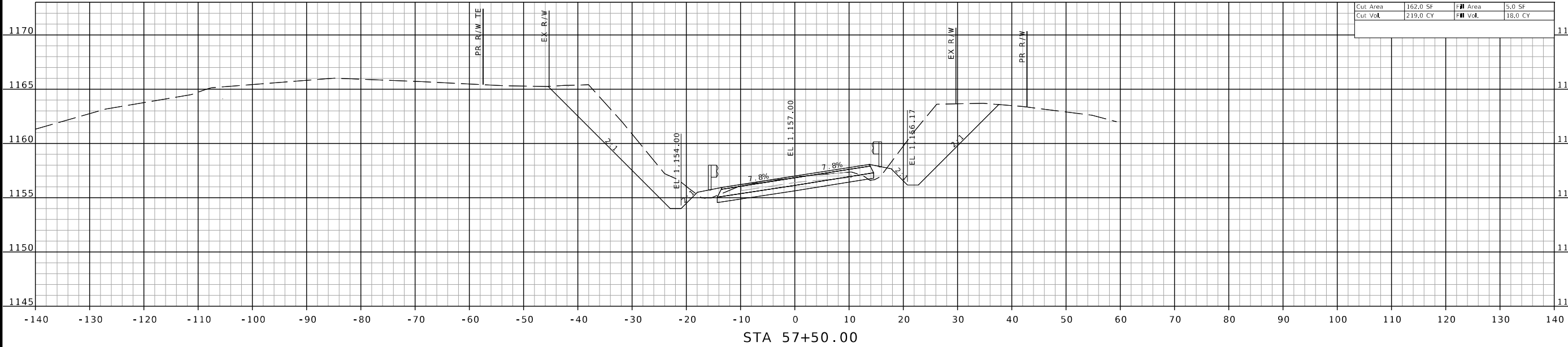
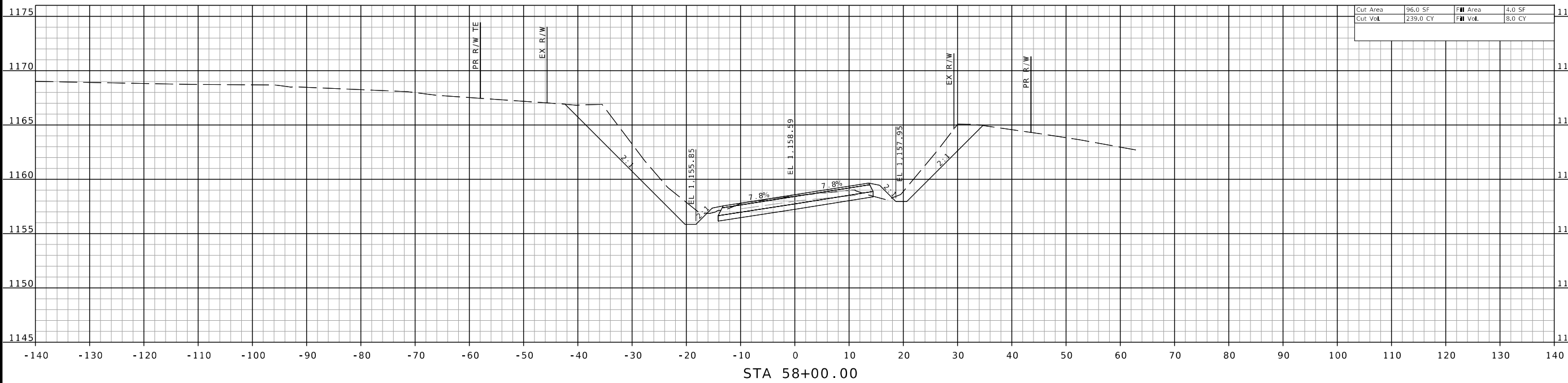

IF A SEAL IS PRESENT ON THIS SHEET IT HAS BEEN ELECTRONICALLY SEALED AND DATED.



St. Louis
720 Olive, Suite 700
St. Louis, MO 63101
314.588.8381

St. Charles
820 South Main, Suite 309
St. Charles, MO 63301
636.453.6277

Collinsville
100 Lamar Court, Suite 1
Collinsville, MO 62234
618.945.2200

Belleville
1 South Church, Suite 200
Belleville, IL 62220
618.616.6688
www.oatesassociates.com

MISSOURI DESIGN FIRM PE-001166

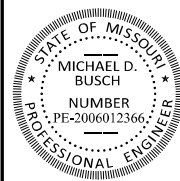

THIS SHEET HAS BEEN SIGNED, SEALED AND DATED ELECTRONICALLY.

DATE PREPARED
10/18/2024

ROUTE 137 STATE MO

DISTRICT SE SHEET NO. 5

COUNTY TEXAS

JOB NO. JSE0027

CONTRACT ID.

PROJECT NO.

BRIDGE NO. A9393

DESCRIPTION

DATE

MISSOURI HIGHWAYS AND TRANSPORTATION COMMISSION

105 WEST CAPITOL JEFFERSON CITY, MO 65102

1-888-ASK-MODOT (1-888-275-6636)

St. Louis 720 Olive, Suite 700 St. Louis, MO 63101 314.588.8381

St. Charles 820 South Main, Suite 309 St. Charles, MO 63301 636.453.6277

Collinsville 100 Lamar Court, Suite 1 Collinsville, MO 62234 618.945.2200

Belleville 1 South Church, Suite 200 Belleville, IL 62220 618.416.4685 www.oatesassociates.com

MISSOURI DESIGN FIRM PE-001166

OATES ASSOCIATES

IF A SEAL IS PRESENT ON THIS SHEET IT HAS BEEN ELECTRONICALLY SEALED AND DATED.

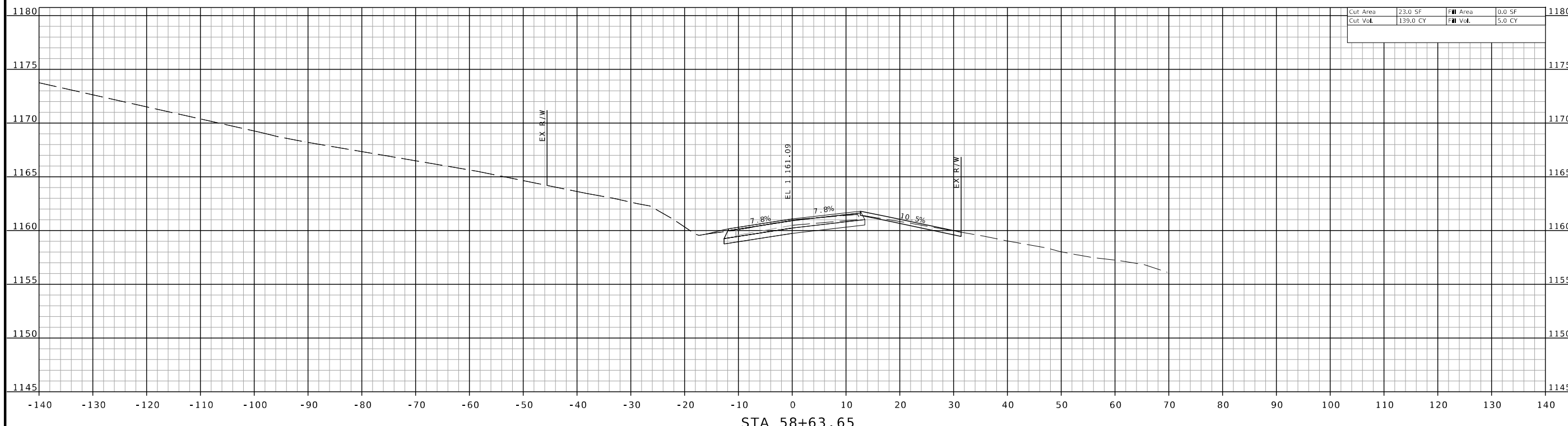
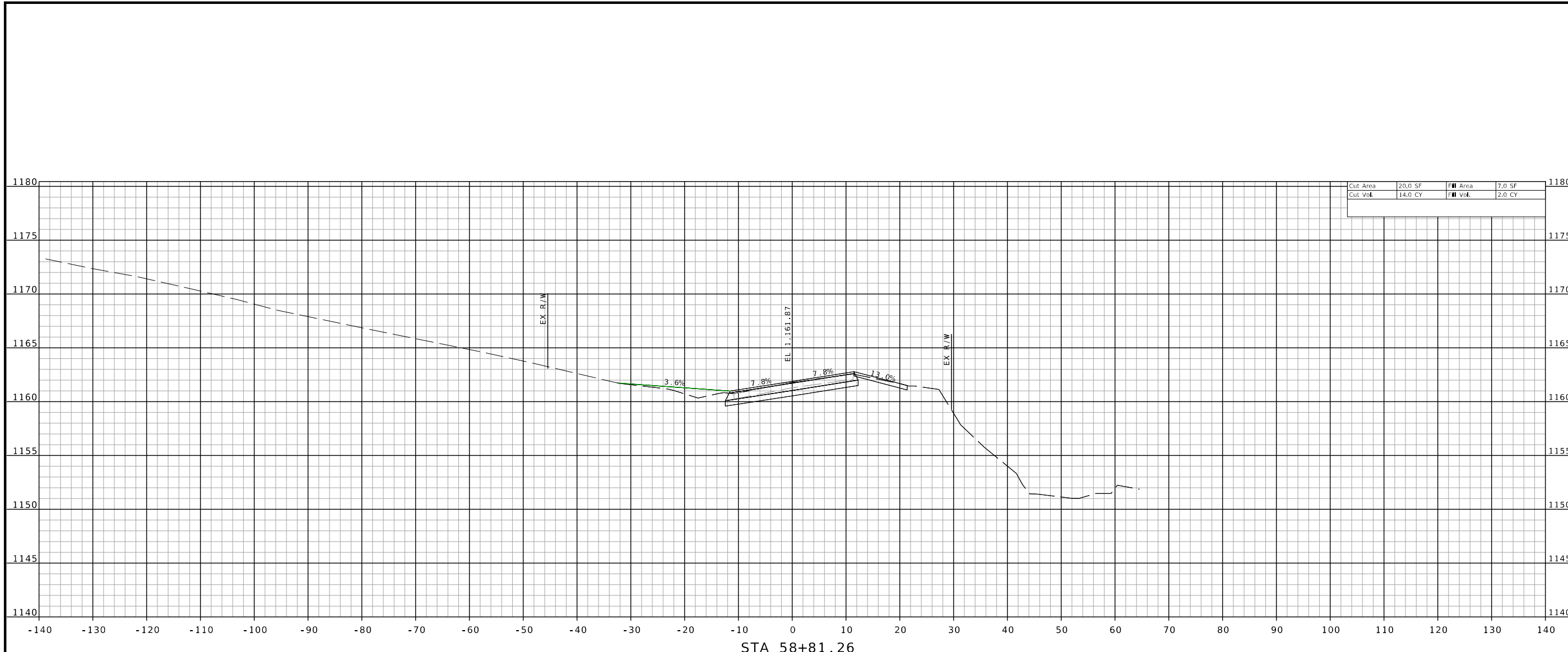



THIS SHEET HAS BEEN SIGNED, SEALED AND DATED ELECTRONICALLY.

DATE PREPARED
10/18/2024

ROUTE 137 STATE MO

DISTRICT SE SHEET NO. 6

COUNTY TEXAS

JOB NO. JSE0027

CONTRACT ID.

PROJECT NO.

BRIDGE NO. A9393

DESCRIPTION

| DATE | DESCRIPTION |
|------|-------------|
| | |
| | |
| | |
| | |

MISSOURI HIGHWAYS AND TRANSPORTATION COMMISSION



105 WEST CAPITOL
JEFFERSON CITY, MO 65102
1-888-ASK-MODOT (1-888-275-6636)

St. Louis
720 Olive, Suite 700
St. Louis, MO 63101
314.588.8381

St. Charles
820 South Main, Suite 309
St. Charles, MO 63301
636.453.6277

Collinsville
100 Lamar Court, Suite 1
Collinsville, MO 62234
618.945.2200

Belleville
1 South Church, Suite 200
Belleville, IL 62220
618.616.6685
www.oatesassociates.com



MISSOURI DESIGN FIRM PE-001166

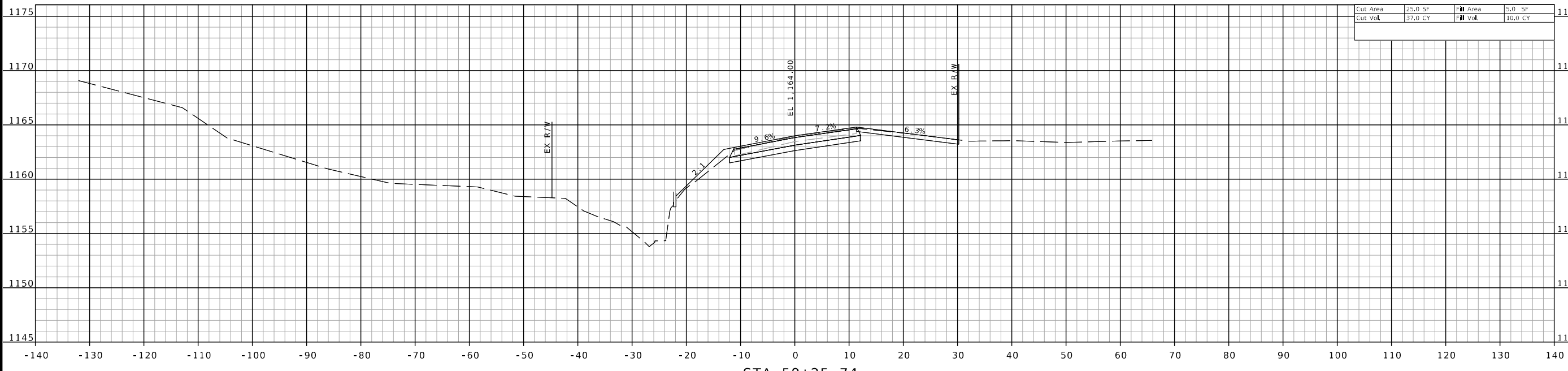
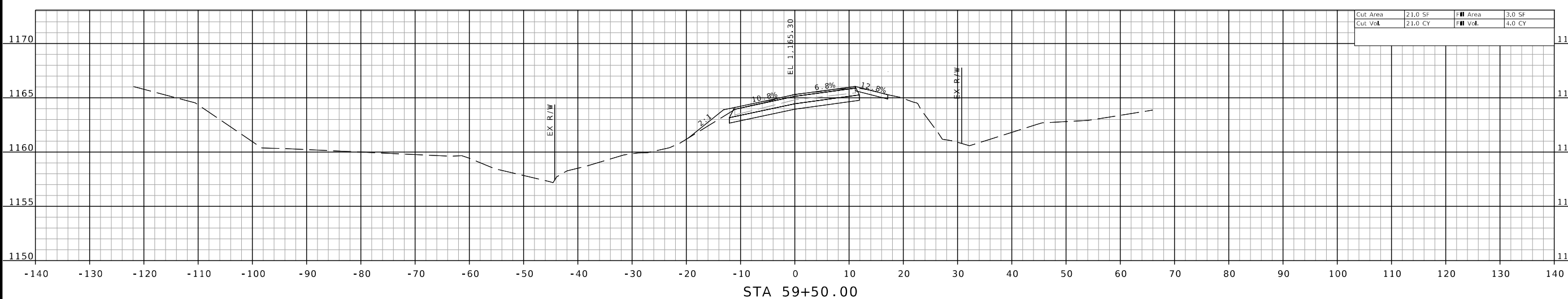
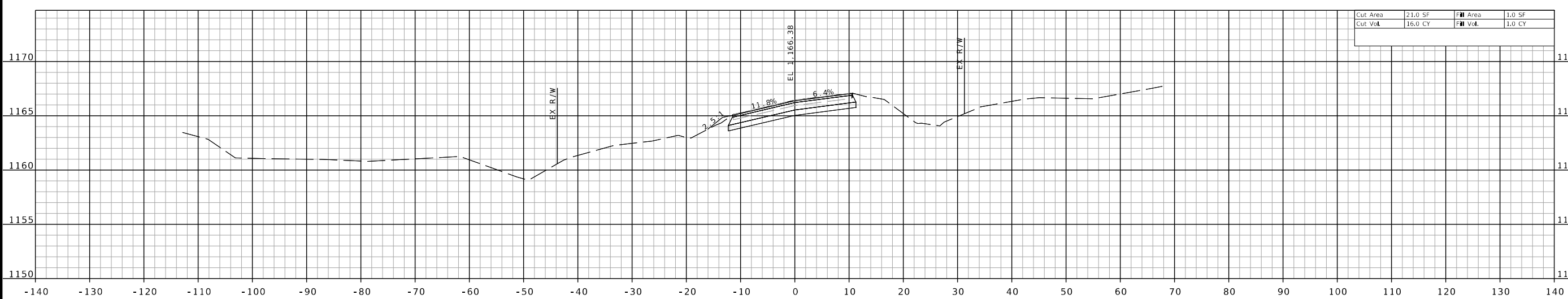

IF A SEAL IS PRESENT ON THIS SHEET IT HAS BEEN ELECTRONICALLY SEALED AND DATED.



THIS SHEET HAS BEEN SIGNED, SEALED AND DATED ELECTRONICALLY.

DATE PREPARED
10/18/2024

ROUTE STATE
137 MO

DISTRICT SHEET NO.
SE 3

COUNTY
TEXAS

JOB NO.
JSE0028

CONTRACT ID.

PROJECT NO.

BRIDGE NO.
A9394

DESCRIPTION

| DATE | DESCRIPTION |
|------|-------------|
| | |
| | |
| | |
| | |

DATE

DESCRIPTION

DATE

DESCRIPTION

DATE

DESCRIPTION

DATE

DESCRIPTION

DATE

DESCRIPTION

DATE

DESCRIPTION

DATE

DESCRIPTION

DATE

DESCRIPTION

DATE

DESCRIPTION

DATE

DESCRIPTION

DATE

DESCRIPTION

DATE

DESCRIPTION

DATE

DESCRIPTION

DATE

DESCRIPTION

DATE

DESCRIPTION

IF A SEAL IS PRESENT ON THIS SHEET IT HAS BEEN ELECTRONICALLY SEALED AND DATED.

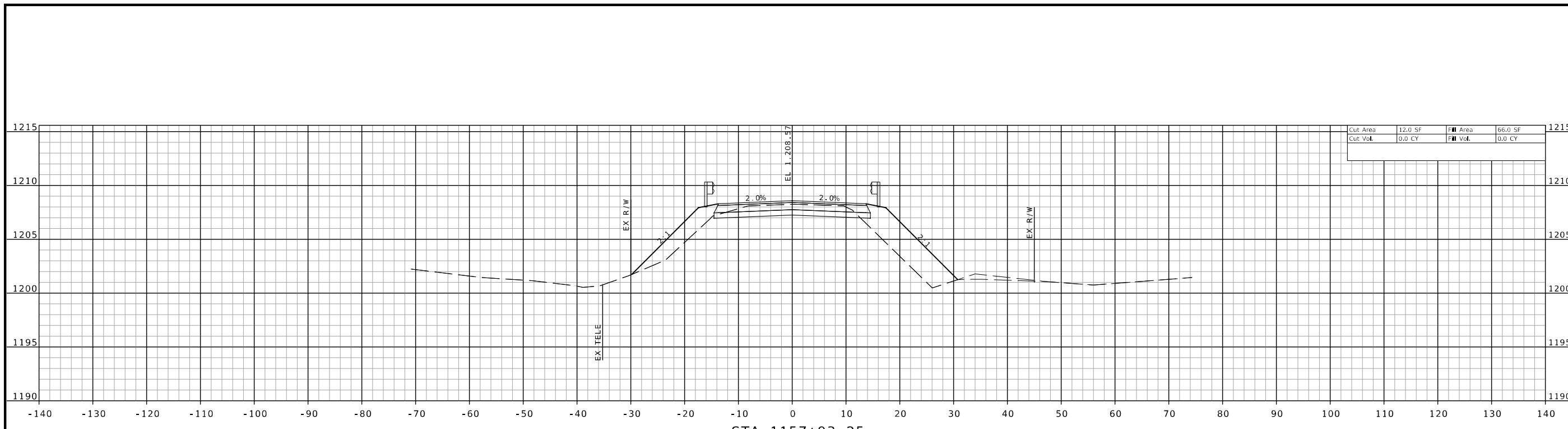

STA 1157+93.25 (BRIDGE OMISSION STA. 1156+59.75 TO STA. 1157+73.25)

| | | | |
|----------|---------|-----------|---------|
| Cut Area | 12.0 SF | Fill Area | 66.0 SF |
| Cut Vol. | 0.0 CY | Fill Vol. | 0.0 CY |

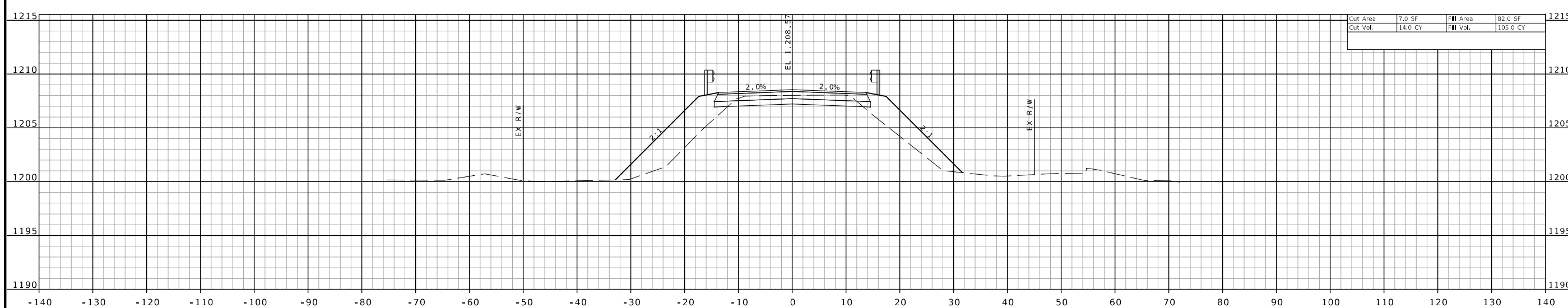

STA 1156+39.75

| | | | |
|----------|---------|-----------|----------|
| Cut Area | 7.0 SF | Fill Area | 82.0 SF |
| Cut Vol. | 14.0 CY | Fill Vol. | 105.0 CY |

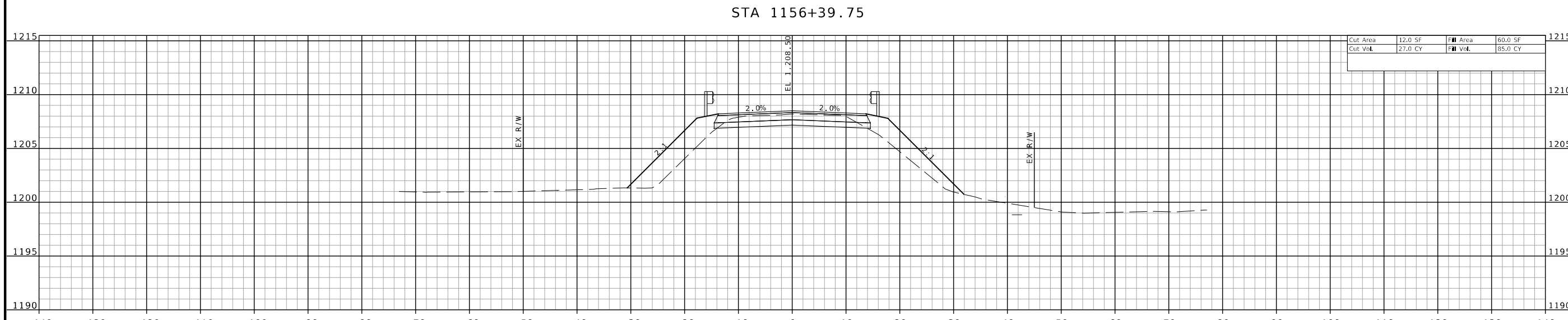

STA 1156+00.00 STA 1156+00.00 TO STA 1157+93.25

| | | | |
|----------|---------|-----------|---------|
| Cut Area | 12.0 SF | Fill Area | 60.0 SF |
| Cut Vol. | 27.0 CY | Fill Vol. | 85.0 CY |

MISSOURI HIGHWAYS AND TRANSPORTATION COMMISSION

105 WEST CAPITOL JEFFERSON CITY, MO 65102
1-888-ASK-MODOT (1-888-275-6636)

St. Louis
720 Olive Suite 700
St. Louis, MO 63101
314.588.8381

St. Charles
820 South Main, Suite 309
St. Charles, MO 63301
636.453.6277

Collinsville
100 Lamar Court, Suite 1
Collinsville, MO 62234
618.945.2200

Belleville
1 South Church, Suite 200
Belleville, IL 62220
618.616.6685
www.oatesassociates.com

MISSOURI DESIGN FIRM PE-001166



THIS SHEET HAS BEEN SIGNED, SEALED AND DATED ELECTRONICALLY.

DATE PREPARED
10/18/2024

ROUTE 137 STATE MO
DISTRICT SE SHEET NO. 4

COUNTY TEXAS
JOB NO. JSE0028

CONTRACT ID.
PROJECT NO.

BRIDGE NO. A9394

| DESCRIPTION | DATE |
|-------------|------|
| | |
| | |
| | |
| | |
| | |

MISSOURI HIGHWAYS AND TRANSPORTATION COMMISSION

 105 WEST CAPITOL JEFFERSON CITY, MO 65102
 1-888-ASK-MODOT (1-888-275-6636)

St. Louis 720 Olive, Suite 700 St. Louis, MO 63101 314.588.8381
 Collinsville 100 Lamar Court, Suite 1 Collinsville, MO 62234 618.945.2200
 Belleville 1 South Church, Suite 200 Belleville, IL 62220 618.416.6685
 St. Charles 820 South Main, Suite 309 St. Charles, MO 63301 636.453.6277
 www.oatesassociates.com
 MISSOURI DESIGN FIRM PE-001166

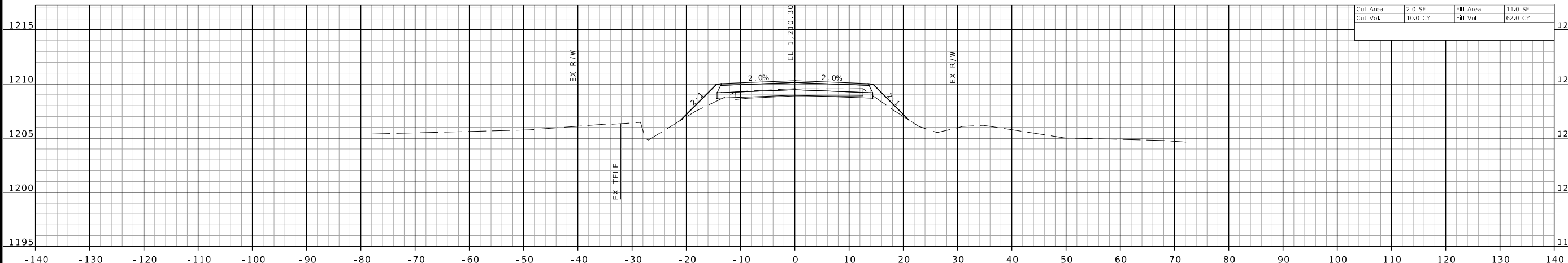

STA 1160+00.00 R2

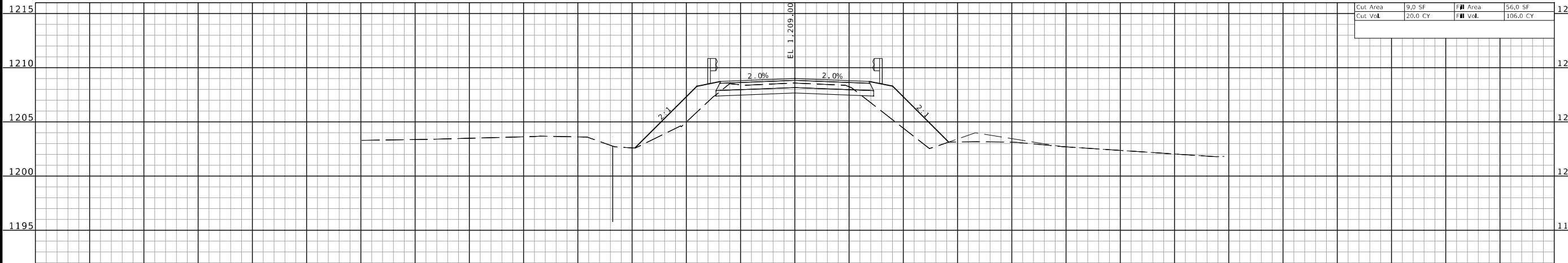

STA 1158+50.00

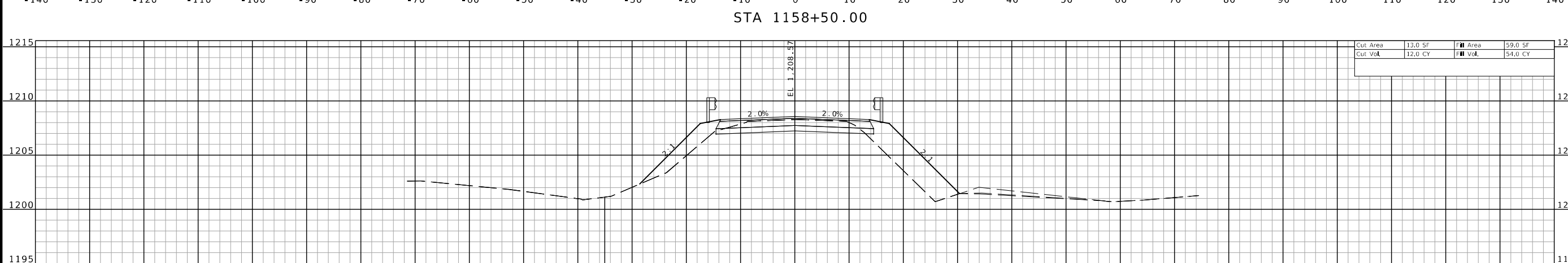

STA 1158+00.00

STA 1158+00.00 TO STA 1166+00.00 R2
 CROSS SECTION SHEET
 SHEET 4 OF 5

IF A SEAL IS PRESENT ON THIS SHEET IT HAS BEEN ELECTRONICALLY SEALED AND DATED.

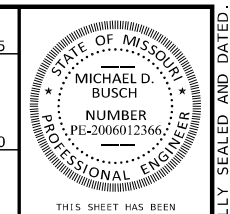
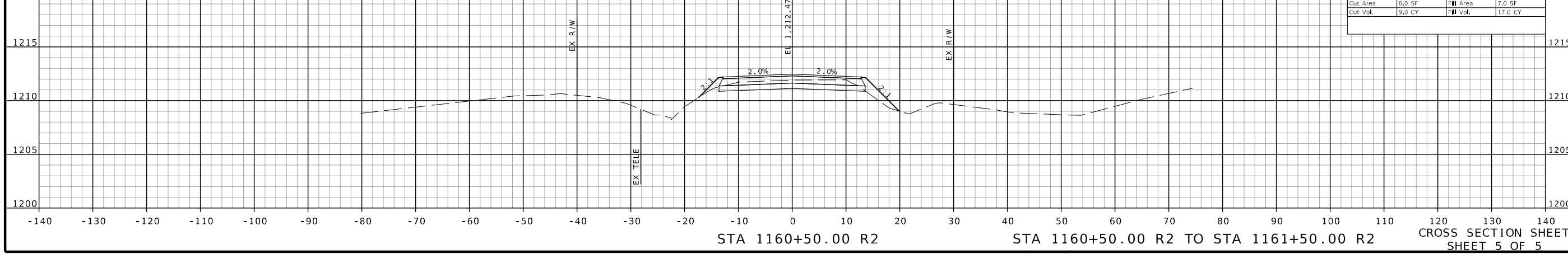
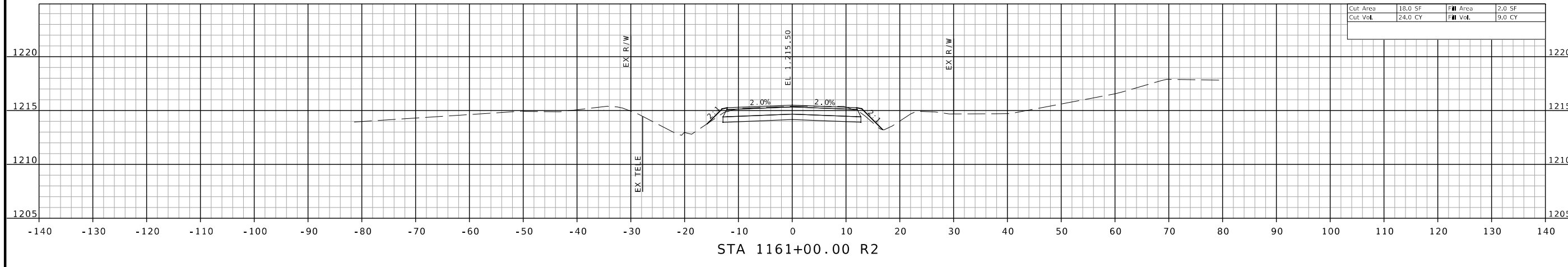
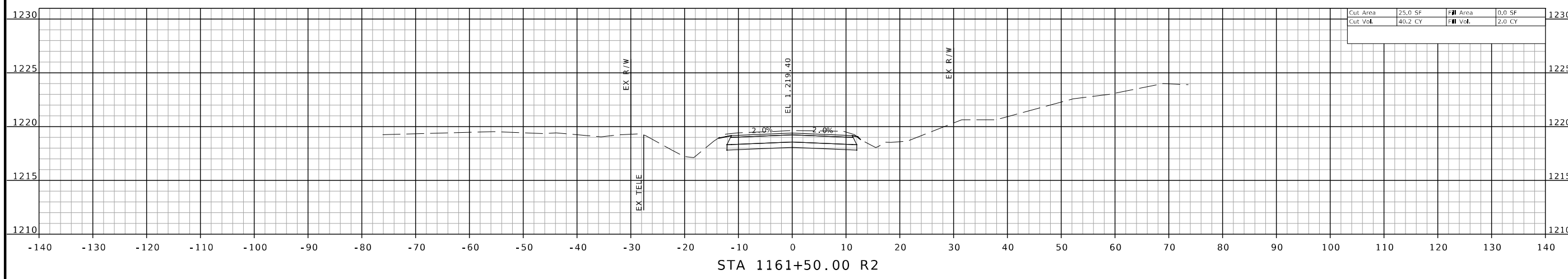
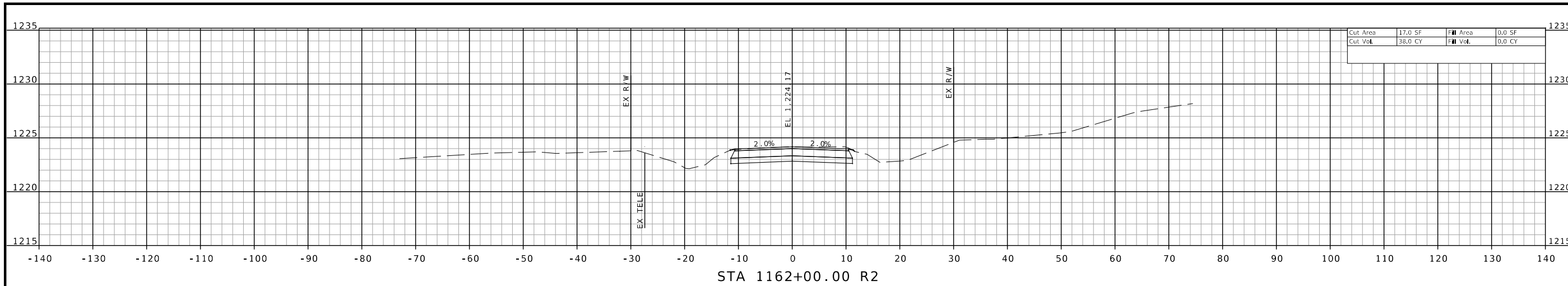

THIS SHEET HAS BEEN SIGNED, SEALED AND DATED ELECTRONICALLY.

DATE PREPARED
10/18/2024

ROUTE 137 STATE MO
DISTRICT SE SHEET NO. 5

COUNTY TEXAS
JOB NO. JSE0028
CONTRACT ID.

PROJECT NO.
BRIDGE NO. A9394

| DATE | DESCRIPTION |
|------|-------------|
| | |
| | |
| | |
| | |

MISSOURI HIGHWAYS AND TRANSPORTATION COMMISSION

105 WEST CAPITOL JEFFERSON CITY, MO 65102
1-888-ASK-MODOT (1-888-275-6636)

St. Louis 720 Olive, Suite 700 St. Louis, MO 63101 314.588.8381
 Collinsville 100 Linn Court, Suite 1 Collinsville, MO 62234 618.945.2200
 Belleville 1 South Church, Suite 200 Belleville, IL 62220 618.616.6688
 St. Charles 820 South Main, Suite 309 St. Charles, MO 63301 636.453.6277

MISSOURI DESIGN FIRM PE-001166

OATES ASSOCIATES

IF A SEAL IS PRESENT ON THIS SHEET IT HAS BEEN ELECTRONICALLY SEALED AND DATED.

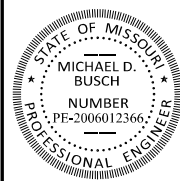

THIS SHEET HAS BEEN SIGNED, SEALED AND DATED ELECTRONICALLY.

DATE PREPARED
10/18/2024

ROUTE STATE
137 MO

DISTRICT SHEET NO.
SE 1

COUNTY
TEXAS

JOB NO.
JSE0029

CONTRACT ID.

PROJECT NO.

BRIDGE NO.
A9395

DESCRIPTION

DATE

MISSOURI HIGHWAYS AND TRANSPORTATION COMMISSION

105 WEST CAPITOL JEFFERSON CITY, MO 65102

1-888-ASK-MODOT (1-888-275-6636)

St. Louis

720 Olive St., Ste 700 St. Louis, MO 63101 314.588.8381

St. Charles

820 South Main, Ste 309 St. Charles, MO 63301 636.453.6277

Collinsville

100 S. Court, Ste 1 Collinsville, IL 62234 618.345.2200

Belleville

1 South Church, Ste 200 Belleville, IL 62220 618.316.8688 www.oatesassociates.com

MISSOURI DESIGN FIRM PE-001166

OATES ASSOCIATES

REV.

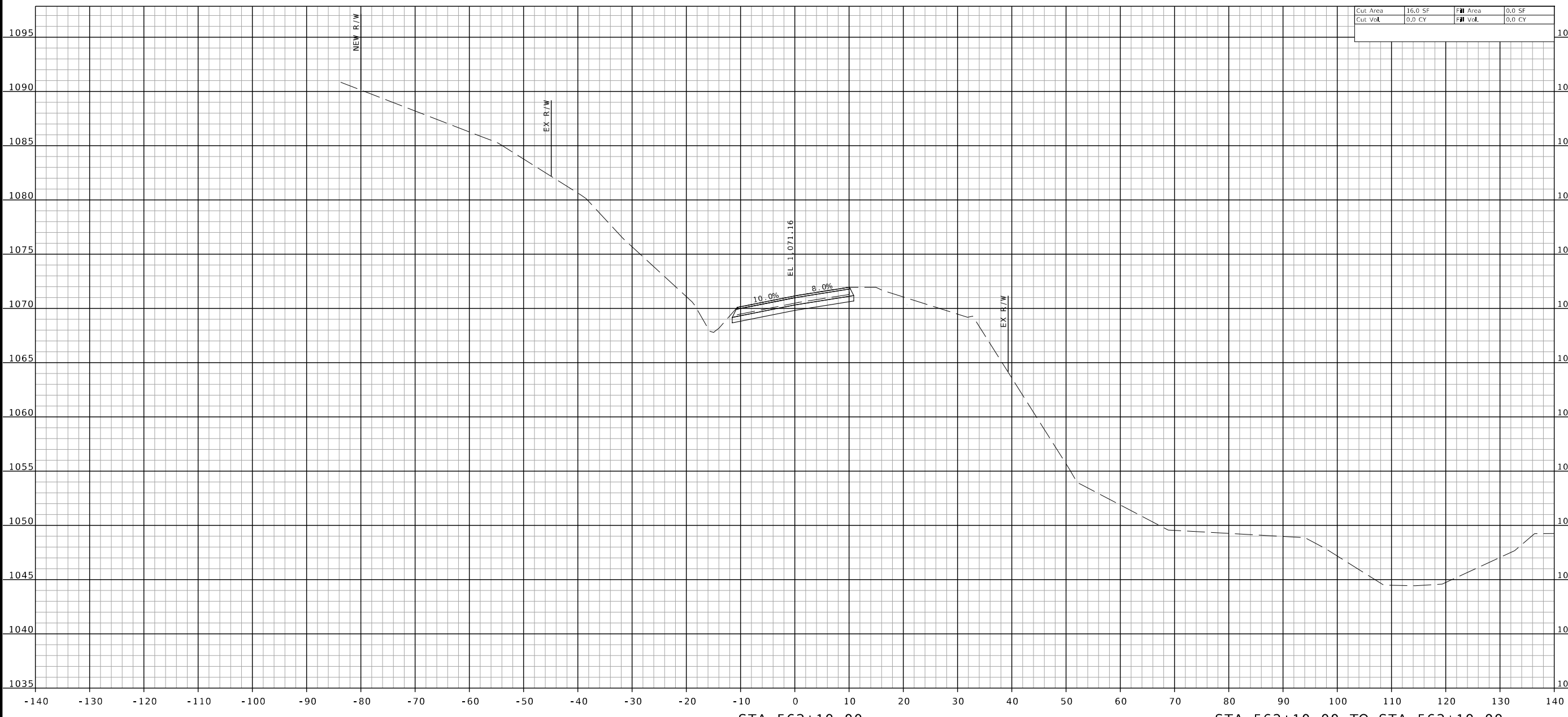

STA 562+10.00

STA 562+10.00 TO STA 562+10.00

IF A SEAL IS PRESENT ON THIS SHEET IT HAS BEEN ELECTRONICALLY SEALED AND DATED.

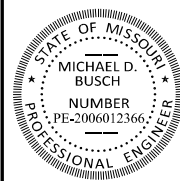

THIS SHEET HAS BEEN SIGNED, SEALED AND DATED ELECTRONICALLY.

DATE PREPARED
10/18/2024

ROUTE 137 STATE MO

DISTRICT SE SHEET NO. 3

COUNTY TEXAS

JOB NO. JSE0029

CONTRACT ID.

PROJECT NO.

BRIDGE NO. A9395

| | | | |
|----------|----------|------|--------|
| Cut Area | 222.0 SF | Area | 3.0 SF |
| Cut Vol. | 272.0 CY | Vol. | 7.0 CY |

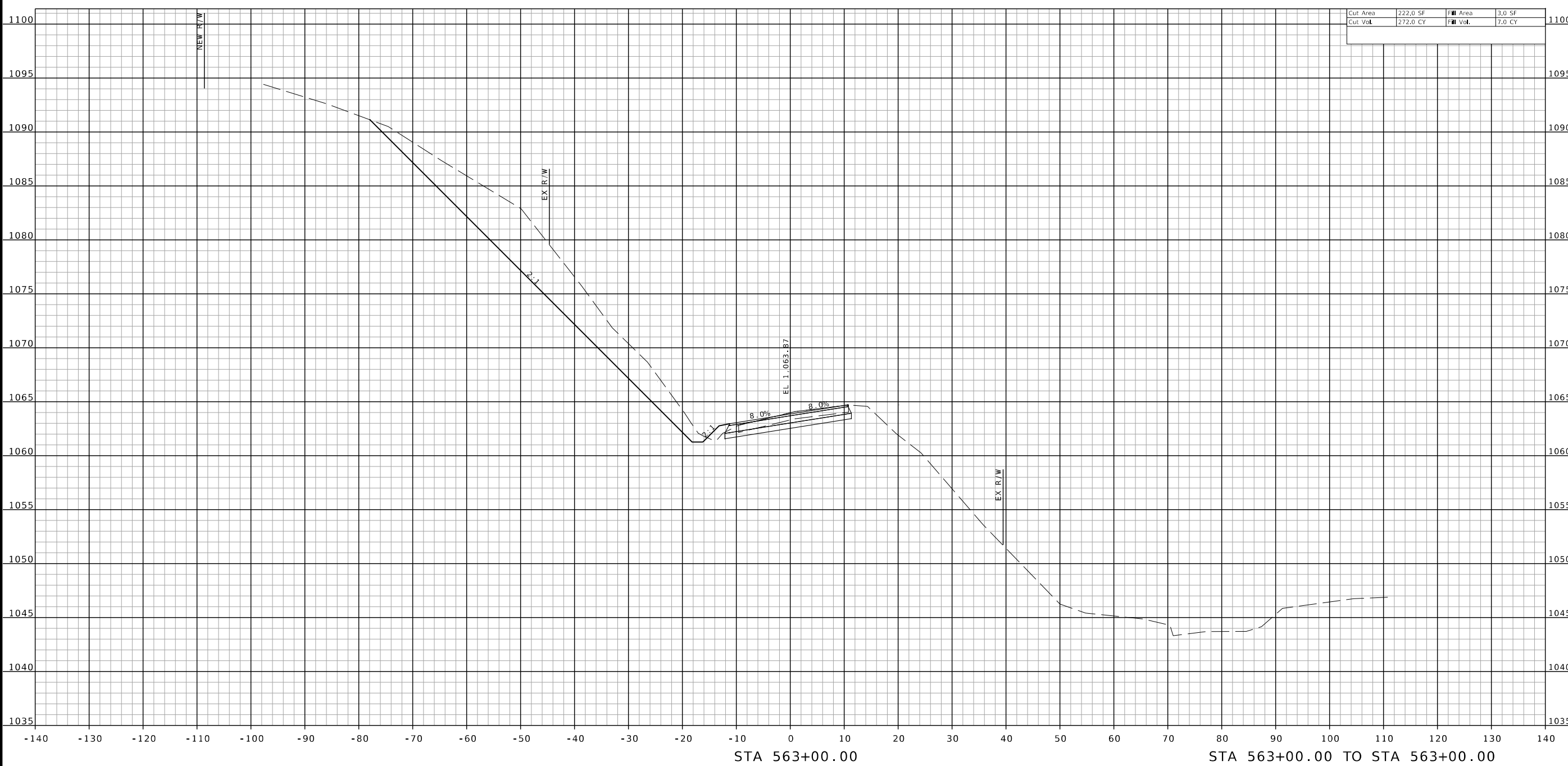

| DATE | DESCRIPTION |
|------|-------------|
| | |
| | |
| | |
| | |

MISSOURI HIGHWAYS AND TRANSPORTATION COMMISSION

105 WEST CAPITOL JEFFERSON CITY, MO 65102
1-888-ASK-MODOT (1-888-275-6636)

St. Louis
720 Olive St., Suite 700
St. Louis, MO 63101
314.588.8381

St. Charles
820 South Main, Suite 309
St. Charles, MO 63301
636.453.6277

Collinsville
100 West Court, Suite 1
Collinsville, IL 62234
618.345.2200

Belleville
1 South Church, Suite 200
Belleville, IL 62220
618.316.8688
www.oatesassociates.com

MISSOURI DESIGN FIRM PE-001166

OATES ASSOCIATES

STA 563+00.00 STA 563+00.00 TO STA 563+00.00

IF A SEAL IS PRESENT ON THIS SHEET IT HAS BEEN ELECTRONICALLY SEALED AND DATED.

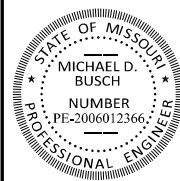

THIS SHEET HAS BEEN SIGNED, SEALED AND DATED ELECTRONICALLY.

DATE PREPARED
10/18/2024

ROUTE 137 STATE MO

DISTRICT SE SHEET NO. 4

COUNTY TEXAS

JOB NO. JSE0029

CONTRACT ID.

PROJECT NO.

BRIDGE NO. A9395

| | | | |
|----------|----------|------|--------|
| Cut Area | 421.0 SF | Area | 1.0 SF |
| Cut Vol. | 595.0 CY | Vol. | 4.0 CY |

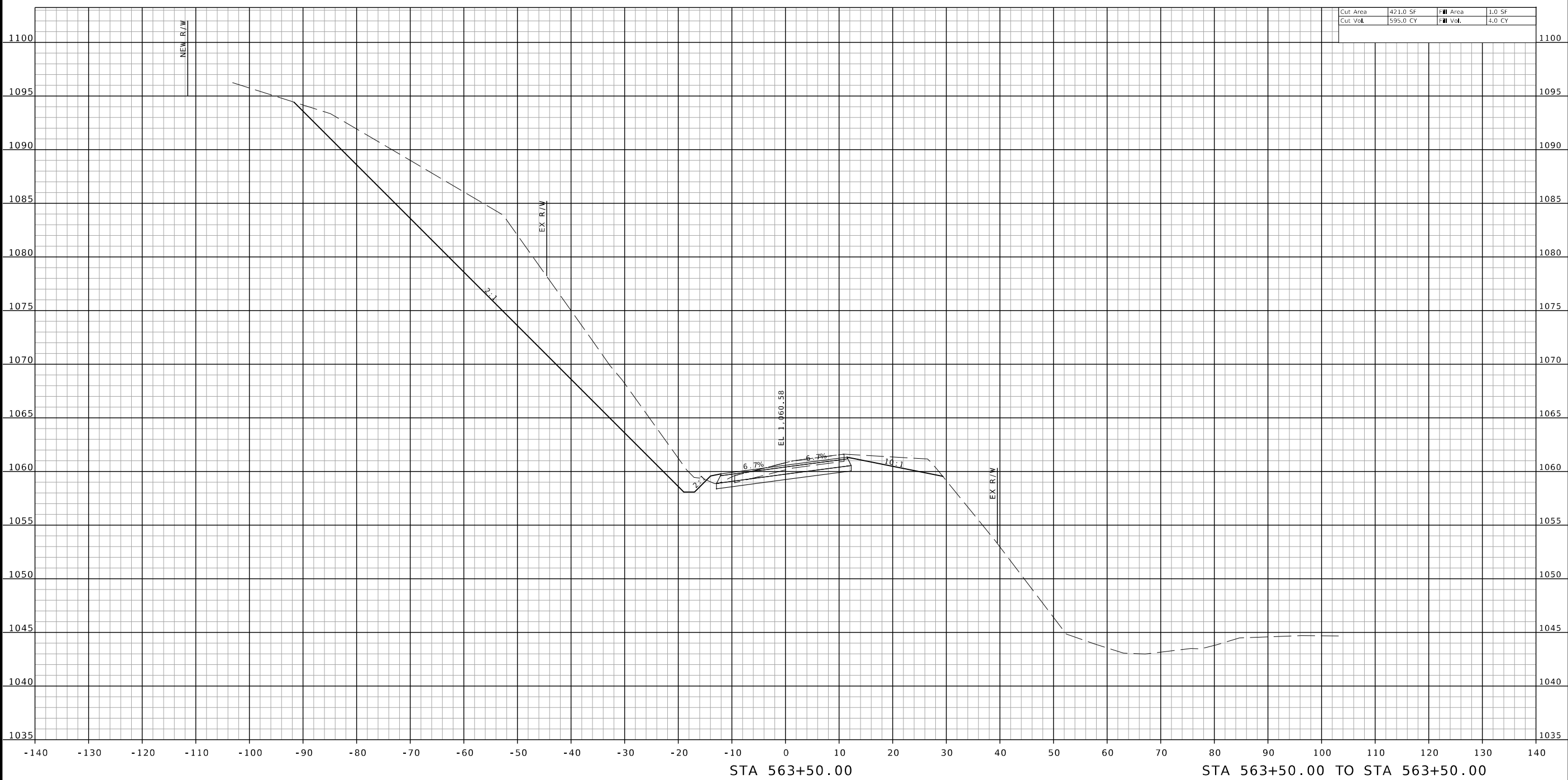

| DATE | DESCRIPTION |
|------|-------------|
| | |
| | |
| | |
| | |

MISSOURI HIGHWAYS AND TRANSPORTATION COMMISSION

105 WEST CAPITOL JEFFERSON CITY, MO 65102
1-888-ASK-MODOT (1-888-275-6636)

St. Louis
720 Olive St., Suite 700
St. Louis, MO 63101
314.588.8381

St. Charles
820 South Main, Suite 309
St. Charles, MO 63301
636.453.6277

Collinsville
100 S. Main, Suite 1
Collinsville, IL 62234
618.345.2200

Bellefonte
1 South Church, Suite 200
Bellefonte, IL 62220
618.316.8688
www.oatesassociates.com

MISSOURI DESIGN FIRM PE-001166



IF A SEAL IS PRESENT ON THIS SHEET IT HAS BEEN ELECTRONICALLY SEALED AND DATED.



THIS SHEET HAS BEEN SIGNED, SEALED AND DATED ELECTRONICALLY.

DATE PREPARED
10/18/2024

ROUTE 137 STATE MO
DISTRICT SE SHEET NO. 6

COUNTY TEXAS
JOB NO. JSE0029
CONTRACT ID.

PROJECT NO.

BRIDGE NO. A9395

| DATE | DESCRIPTION |
|------|-------------|
| | |
| | |
| | |
| | |
| | |

MISSOURI HIGHWAYS AND TRANSPORTATION COMMISSION

 105 WEST CAPITOL JEFFERSON CITY, MO 65102
 1-888-ASK-MODOT (1-888-275-6636)

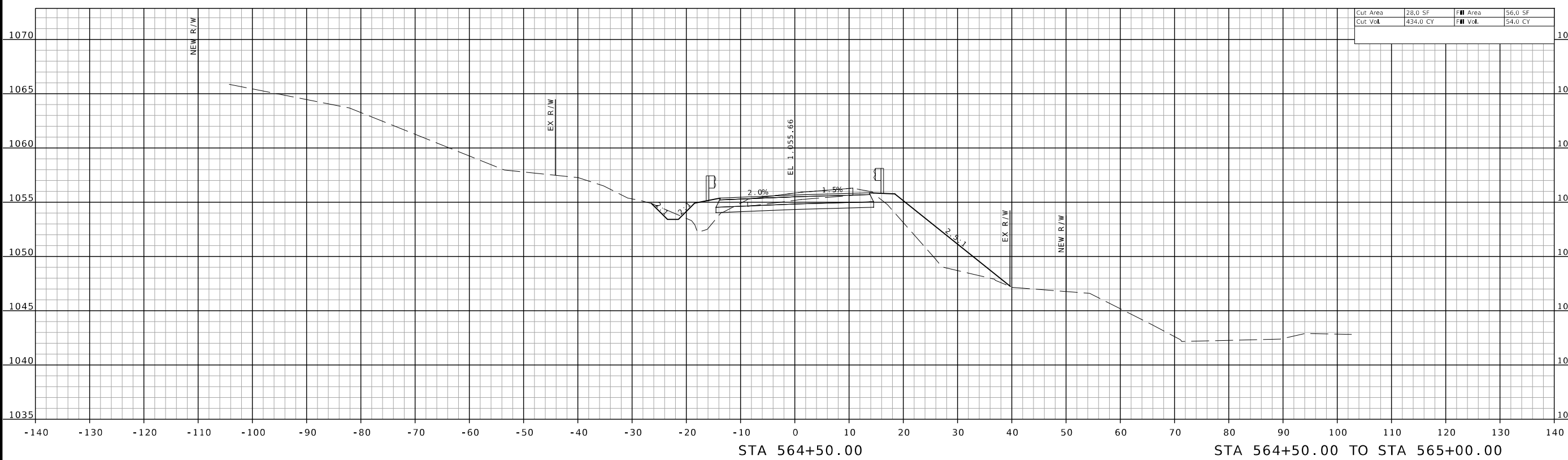
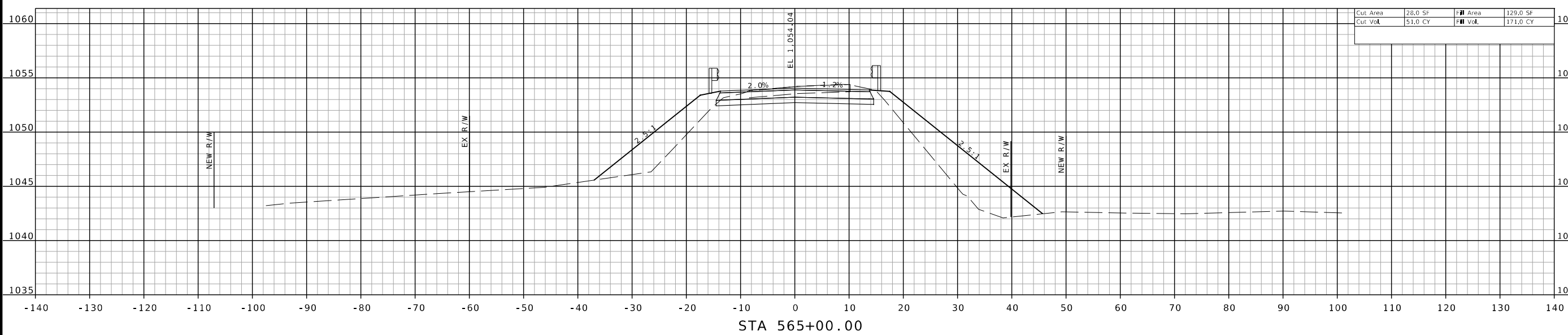
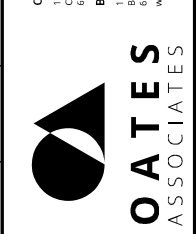
St. Louis 720 Olive St., Suite 700 St. Louis, MO 63101 314.588.8381
 St. Charles 820 South Main, Suite 309 St. Charles, MO 63301 636.453.6277
 Collinsville 100 West Court, Suite 1 Collinsville, IL 62234 618.345.2200
 Belleville 1 South Church, Suite 200 Belleville, IL 62220 618.316.8688
 www.oatesassociates.com
 MISSOURI DESIGN FIRM PE-001166

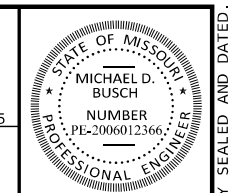
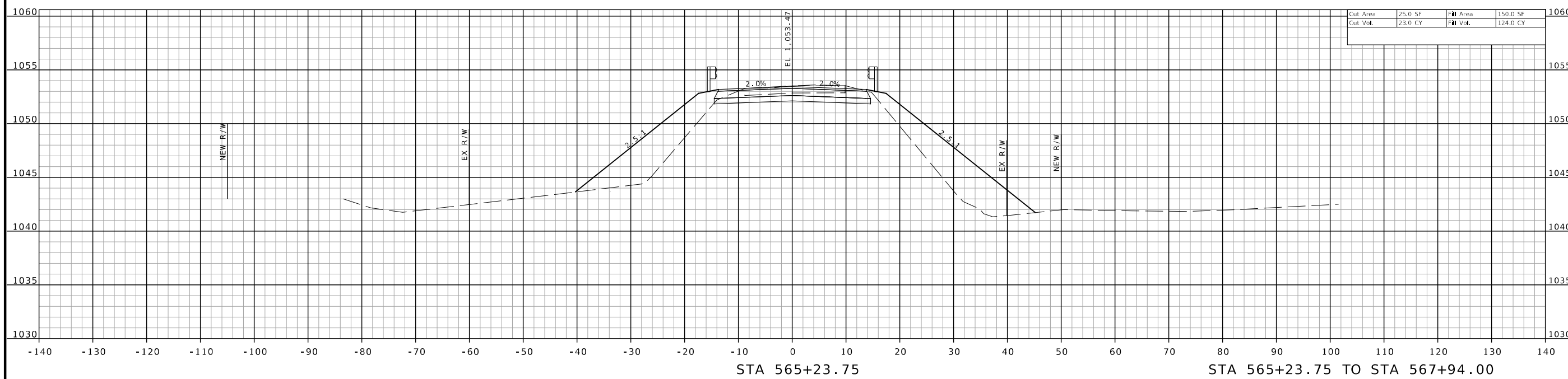
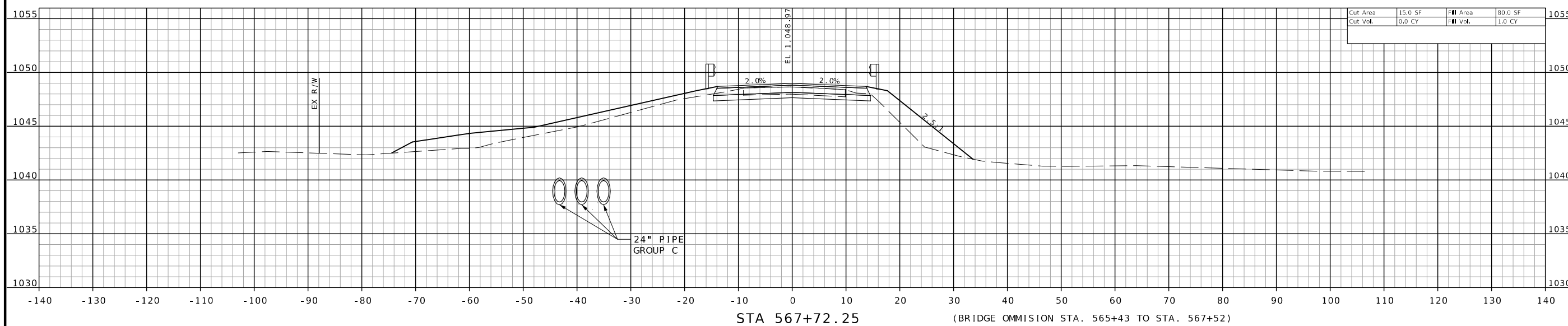
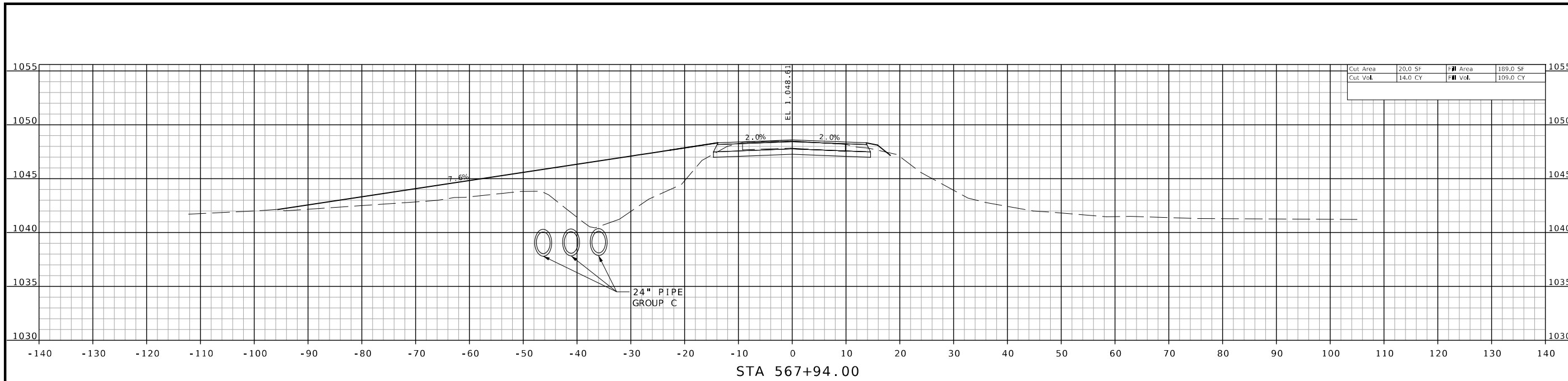



THIS SHEET HAS BEEN SIGNED, SEALED AND DATED ELECTRONICALLY.

DATE PREPARED
10/18/2024

ROUTE STATE
137 MO

DISTRICT SHEET NO.
SE 7

COUNTY
TEXAS

JOB NO.
JSE0029

CONTRACT ID.

PROJECT NO.

BRIDGE NO.
A9395

| DATE | DESCRIPTION |
|------|-------------|
| | |
| | |
| | |
| | |

MISSOURI HIGHWAYS AND TRANSPORTATION COMMISSION

105 WEST CAPITOL JEFFERSON CITY, MO 65102

1-888-ASK-MODOT (1-888-275-6636)

St. Louis
720 Olive St., Suite 700
St. Louis, MO 63101
314.588.8381

St. Charles
820 South Main, Suite 300
St. Charles, MO 63301
636.453.6277

Collinsville
100 S. Main, Suite 1
Collinsville, IL 62234
618.345.2200

Bellefonte
1 South Church, Suite 200
Bellefonte, IL 62220
618.816.8688
www.oatesassociates.com

MISSOURI DESIGN FIRM PE-001166

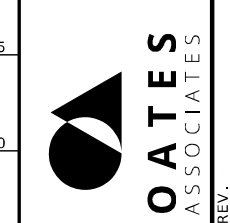



THIS SHEET HAS BEEN SIGNED, SEALED AND DATED ELECTRONICALLY.

DATE PREPARED
10/18/2024

ROUTE 137 STATE MO
DISTRICT SE SHEET NO. 8

COUNTY TEXAS
JOB NO. JSE0029
CONTRACT ID.

PROJECT NO.

BRIDGE NO. A9395

| DESCRIPTION | DATE |
|-------------|------|
| | |
| | |
| | |
| | |
| | |

MISSOURI HIGHWAYS AND TRANSPORTATION COMMISSION

 105 WEST CAPITOL JEFFERSON CITY, MO 65102
 1-888-ASK-MODOT (1-888-275-6636)

St. Louis 720 Olive St., Suite 700 St. Louis, MO 63101 314.588.8381
 Collinsville 100 S. Main St., Suite 1 Collinsville, IL 62234 618.345.2200
 Belleville 820 South Main, Suite 309 St. Charles, MO 63301 636.453.6277
 St. Charles 820 South Main, Suite 309 St. Charles, MO 63301 636.453.6277
 www.oatesassociates.com

OATES ASSOCIATES
 MISSOURI DESIGN FIRM PE-001166

