



THIS SHEET HAS BEEN SIGNED, SEALED AND DATED ELECTRONICALLY.

DATE PREPARED
10/24/2024

ROUTE STATE
K MO

DISTRICT SHEET NO.
NE 1

COUNTY
MONTGOMERY

JOB NO.
JNE0053

CONTRACT ID.

PROJECT NO.

BRIDGE NO.

DESCRIPTION

DATE

MISSOURI HIGHWAYS AND TRANSPORTATION COMMISSION

105 WEST CAPITOL JEFFERSON CITY, MO 65102

1-888-ASK-MODOT (1-888-275-6636)

MONTGOMERY

JNE0053

PROJECT NO.

BRIDGE NO.

DATE

MISSOURI HIGHWAYS AND TRANSPORTATION COMMISSION

105 WEST CAPITOL JEFFERSON CITY, MO 65102

1-888-ASK-MODOT (1-888-275-6636)

MONTGOMERY

JNE0053

PROJECT NO.

BRIDGE NO.

DATE

MISSOURI HIGHWAYS AND TRANSPORTATION COMMISSION

105 WEST CAPITOL JEFFERSON CITY, MO 65102

1-888-ASK-MODOT (1-888-275-6636)

MONTGOMERY

JNE0053

PROJECT NO.

BRIDGE NO.

DATE

MISSOURI HIGHWAYS AND TRANSPORTATION COMMISSION

105 WEST CAPITOL JEFFERSON CITY, MO 65102

1-888-ASK-MODOT (1-888-275-6636)

MONTGOMERY

JNE0053

PROJECT NO.

BRIDGE NO.

DATE

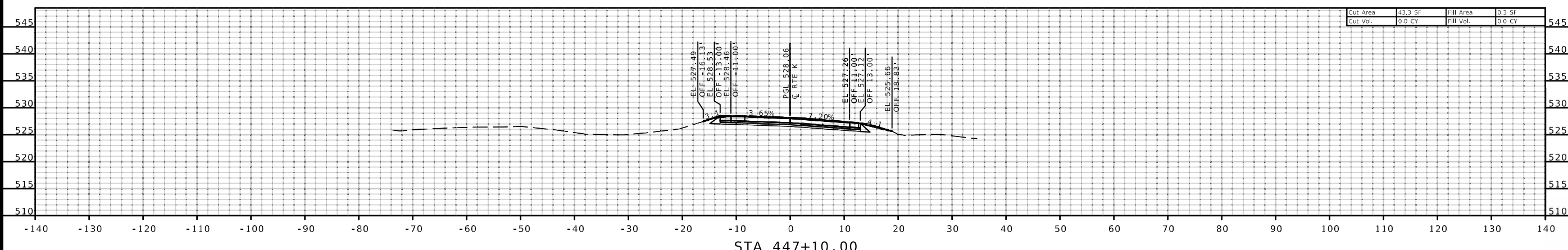
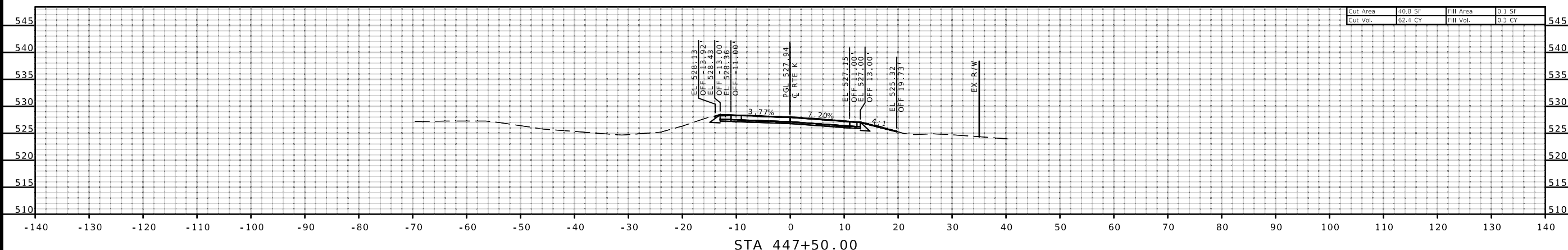
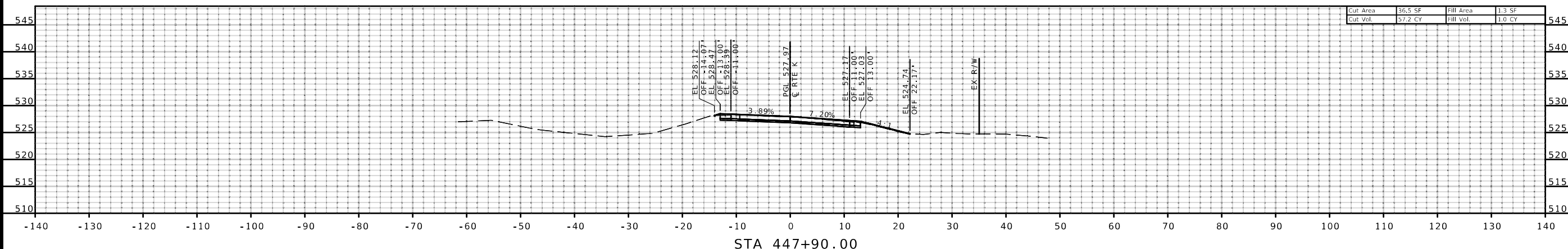

GARVER, LLC.
7509 NW TIFFANY SPRINGS
PARKWAY, SUITE 200
KANSAS CITY, MO 64153
PHONE: (816) 298-6465
CERTIFICATE OF AUTHORITY
NO. 2008013090



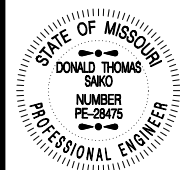

THIS SHEET HAS BEEN SIGNED, SEALED AND DATED ELECTRONICALLY.

DATE PREPARED
10/24/2024

ROUTE STATE
K MO

DISTRICT SHEET NO.
NE 3

COUNTY
MONTGOMERY

JOB NO.
JNE0053

CONTRACT ID.

PROJECT NO.

BRIDGE NO.

DESCRIPTION

DATE

DATE

DATE

DATE

DATE

DATE

DATE

DATE

DATE

DATE

DATE

DATE

DATE

DATE

DATE

DATE

DATE

DATE

DATE

DATE

DATE

DATE

DATE

DATE

DATE

DATE

DATE

DATE

DATE

DATE

DATE

DATE

DATE

DATE

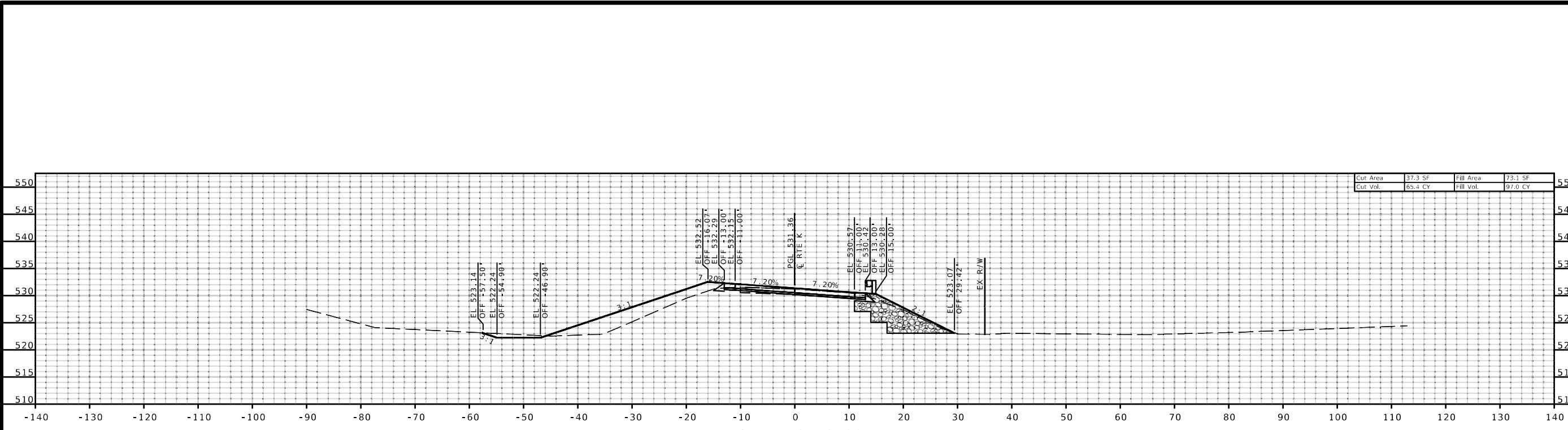

STA 450+50.00

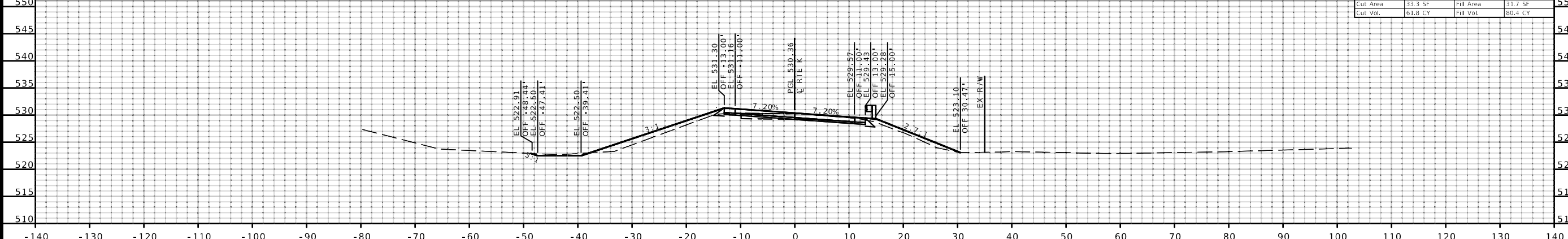

STA 450+00.00

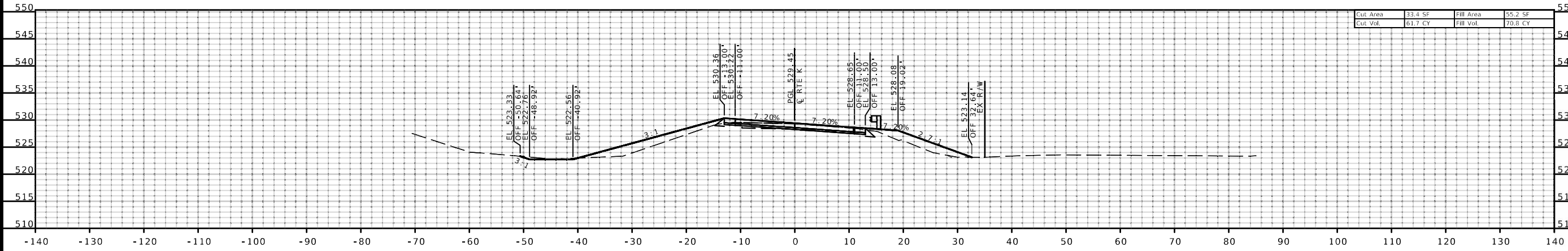

STA 449+50.00

MISSOURI HIGHWAYS AND TRANSPORTATION COMMISSION

GARVER, LLC.
7509 NW TIFFANY SPRINGS
PARKWAY, SUITE 200
KANSAS CITY, MO 64153
PHONE: (816) 298-6465
CERTIFICATE OF AUTHORITY
NO. 2008013090



105 WEST CAPITOL
JEFFERSON CITY, MO 65102
1-888-ASK-MODOT (1-888-275-6636)



THIS SHEET HAS BEEN SIGNED, SEALED AND DATED ELECTRONICALLY.

DATE PREPARED
10/24/2024

ROUTE STATE
K MO

DISTRICT SHEET NO.
NE 6

COUNTY
MONTGOMERY

JOB NO.
JNE0053

CONTRACT ID.

PROJECT NO.

BRIDGE NO.

DESCRIPTION

DATE

MISSOURI HIGHWAYS AND TRANSPORTATION COMMISSION

105 WEST CAPITOL JEFFERSON CITY, MO 65102

1-888-ASK-MODOT (1-888-275-6636)



GARVER, LLC.

7509 NW TIFFANY SPRINGS PARKWAY, SUITE 200

KANSAS CITY, MO 64153

PHONE: (816) 298-6465

CERTIFICATE OF AUTHORITY NO. 2008013090

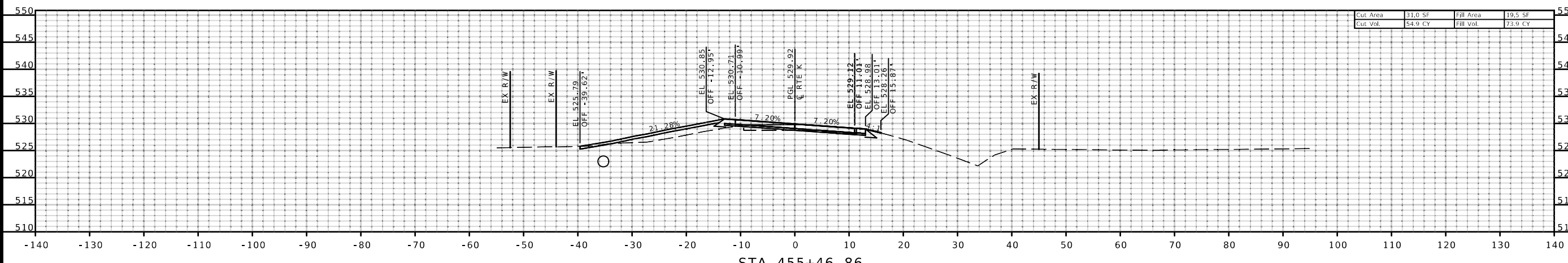

STA 455+46.86

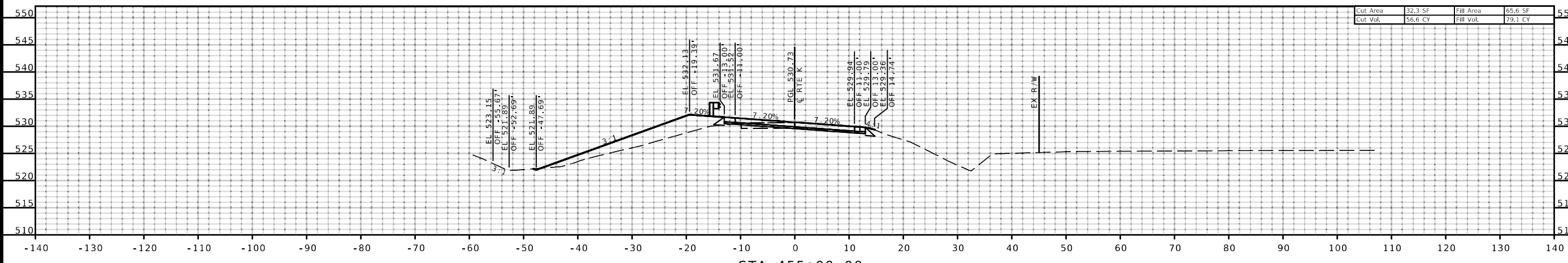

STA 455+00.00

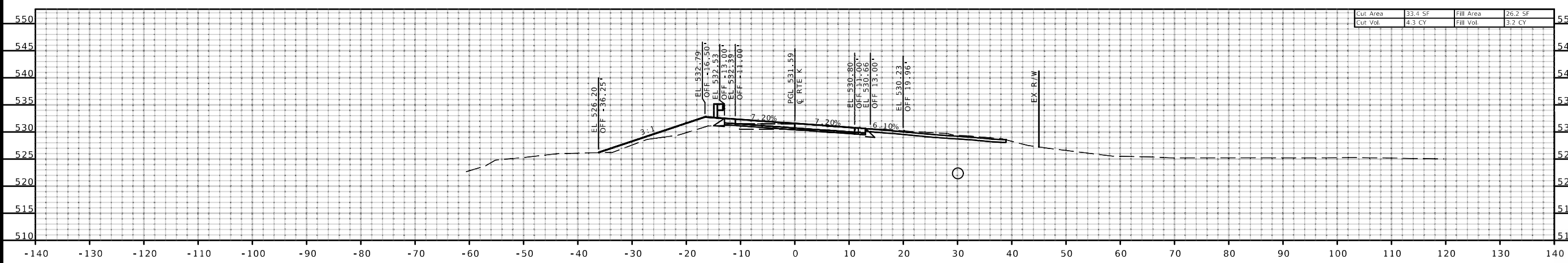

STA 454+53.51

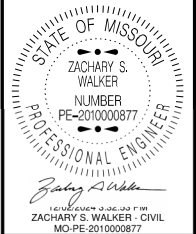

DATE PREPARED
 12/2/2024
 ROUTE K STATE MO
 DISTRICT NE SHEET NO. 2
 COUNTY MONTGOMERY
 JOB NO. JNE0154
 CONTRACT ID.
 PROJECT NO.
 BRIDGE NO.

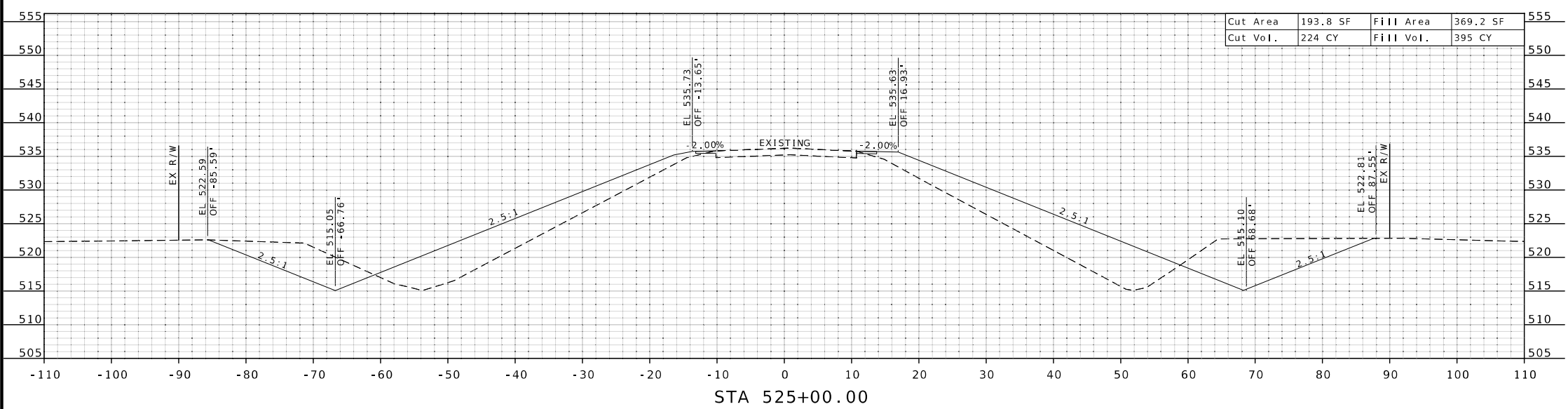
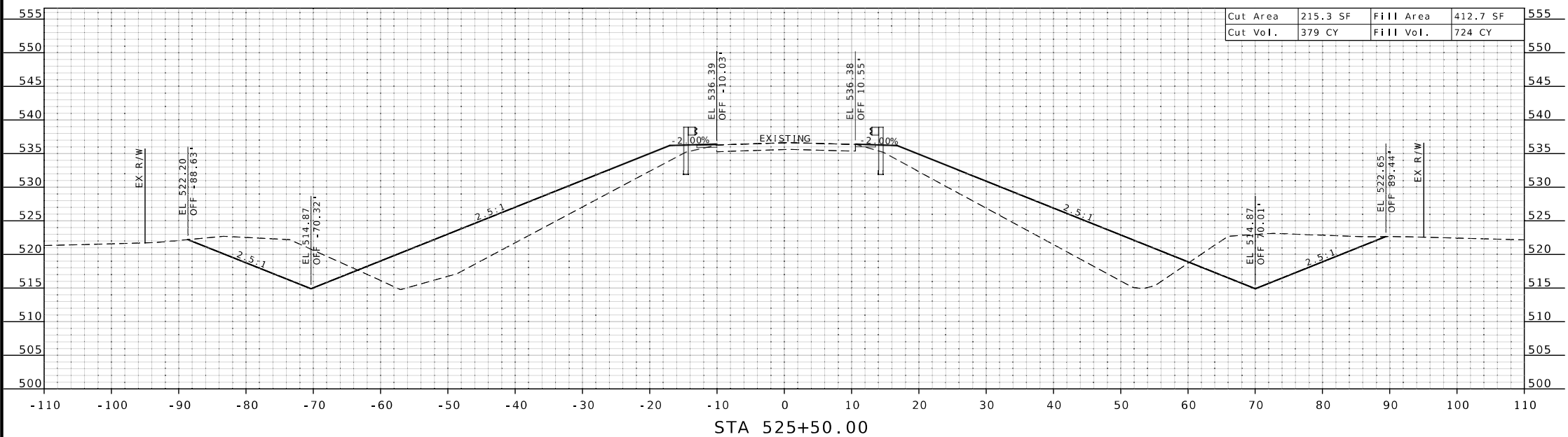

DATE	DESCRIPTION

MISSOURI HIGHWAYS AND TRANSPORTATION COMMISSION

 105 WEST CAPITOL
 JEFFERSON CITY, MO 65102
 1-888-ASK-MODOT (1-888-275-6636)

XS SHEETS

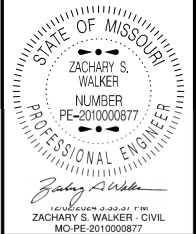

DATE PREPARED
12/2/2024

ROUTE K	STATE MO
DISTRICT NE	SHEET NO. 3
COUNTY MONTGOMERY	
JOB NO. JNE0154	
CONTRACT ID.	
PROJECT NO.	
BRIDGE NO.	

WEST SPILL FILL ADD YARDAGE: CUT: 715 CY FILL: 378 CY

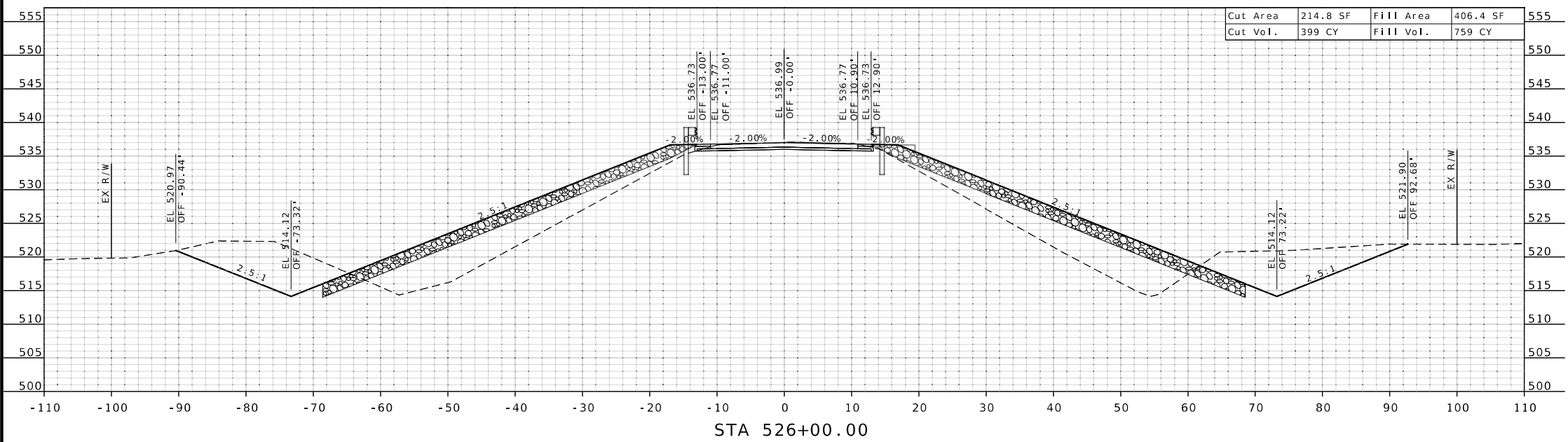
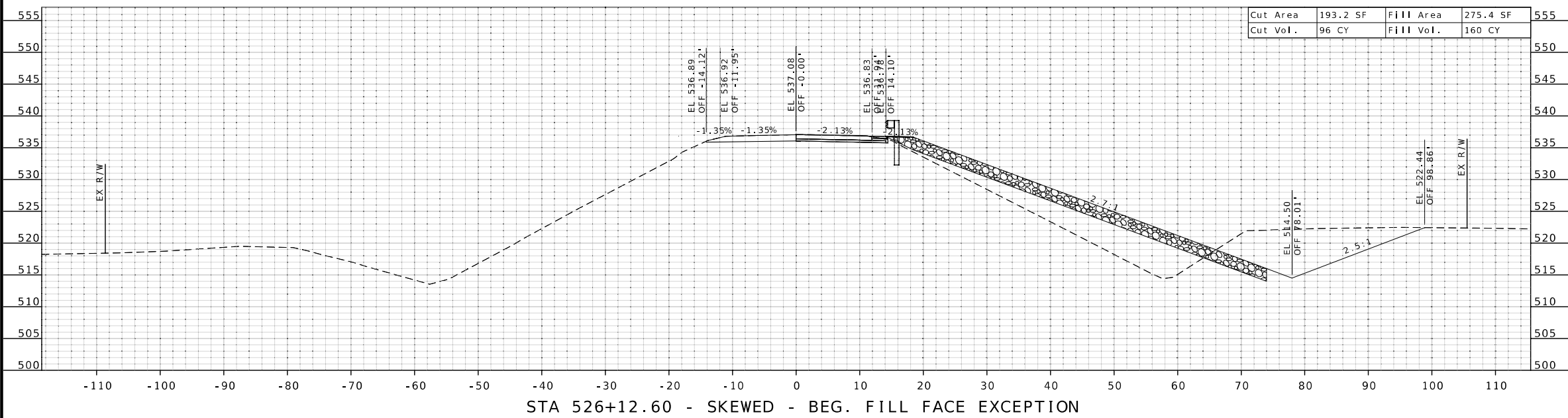

DATE	DESCRIPTION

MISSOURI HIGHWAYS AND TRANSPORTATION COMMISSION

105 WEST CAPITOL
JEFFERSON CITY, MO 65102
1-888-ASK-MODOT (1-888-275-6636)

XS SHEETS

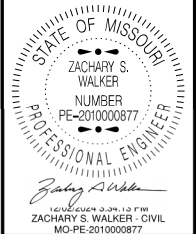

DATE PREPARED
 12/2/2024
 ROUTE K STATE MO
 DISTRICT NE SHEET NO. 4
 COUNTY MONTGOMERY
 JOB NO. JNE0154
 CONTRACT ID.

PROJECT NO.
 BRIDGE NO.

DATE	DESCRIPTION

MISSOURI HIGHWAYS AND TRANSPORTATION COMMISSION
 105 WEST CAPITOL JEFFERSON CITY, MO 65102
 1-888-ASK-MODOT (1-888-273-6636)

XS SHEETS

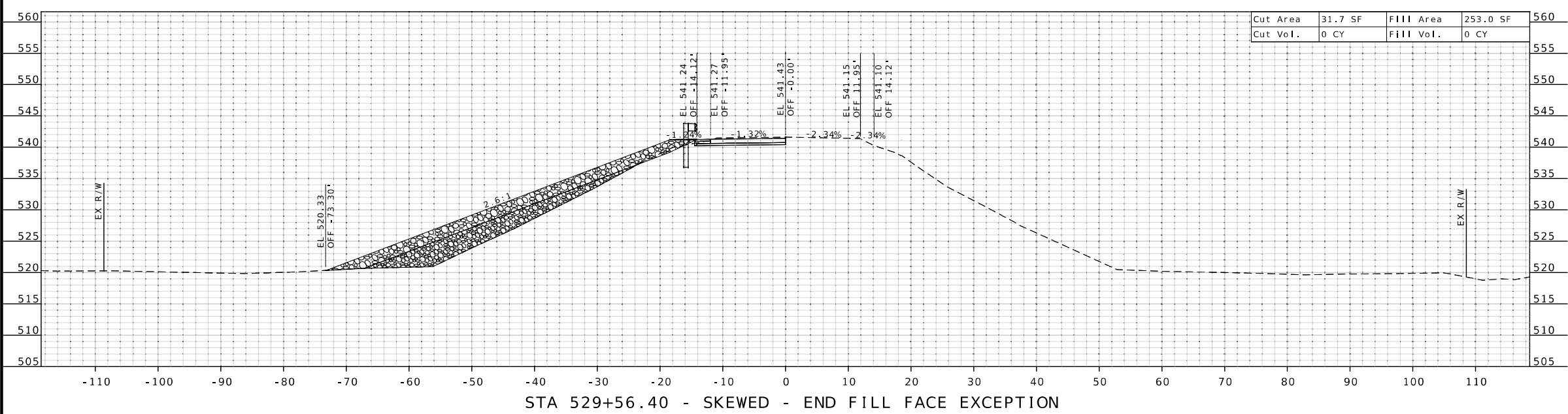
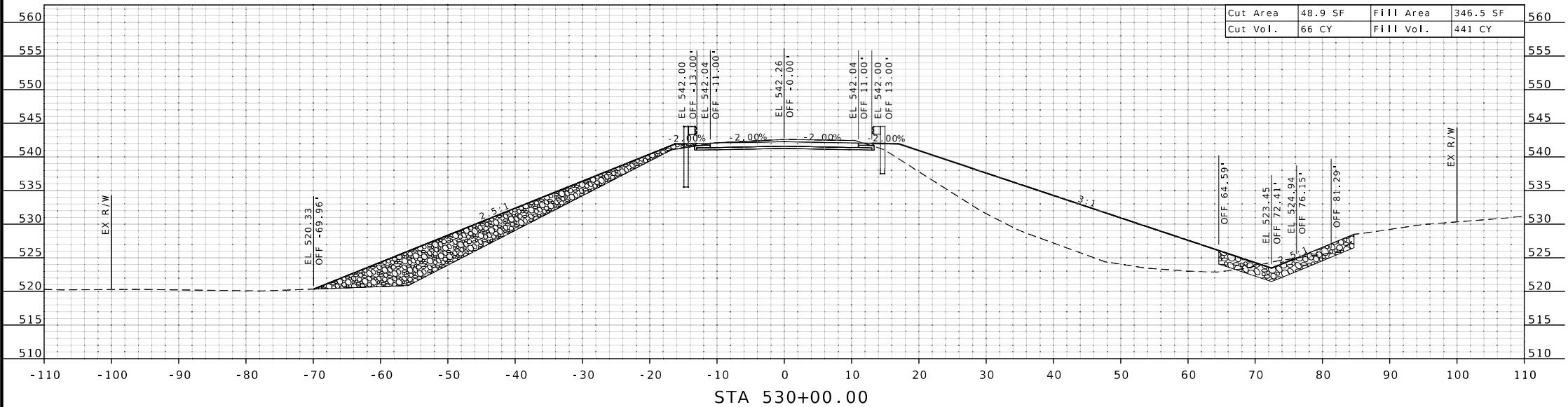

EAST SPILL FILL ADD YARDAGE: CUT: 501 CY FILL: 376 CY

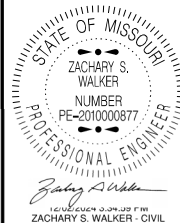

DATE PREPARED
12/2/2024

ROUTE	STATE
K	MO
DISTRICT	SHEET NO.
NE	5

COUNTY
MONTGOMERY

JOB NO.
JNE0154

CONTRACT ID.

PROJECT NO.
 BRIDGE NO.

DATE	DESCRIPTION

MISSOURI HIGHWAYS AND TRANSPORTATION COMMISSION



105 WEST CAPITOL
 JEFFERSON CITY, MO 65102
 1-888-ASK-MODOT (1-888-275-6636)

XS SHEETS

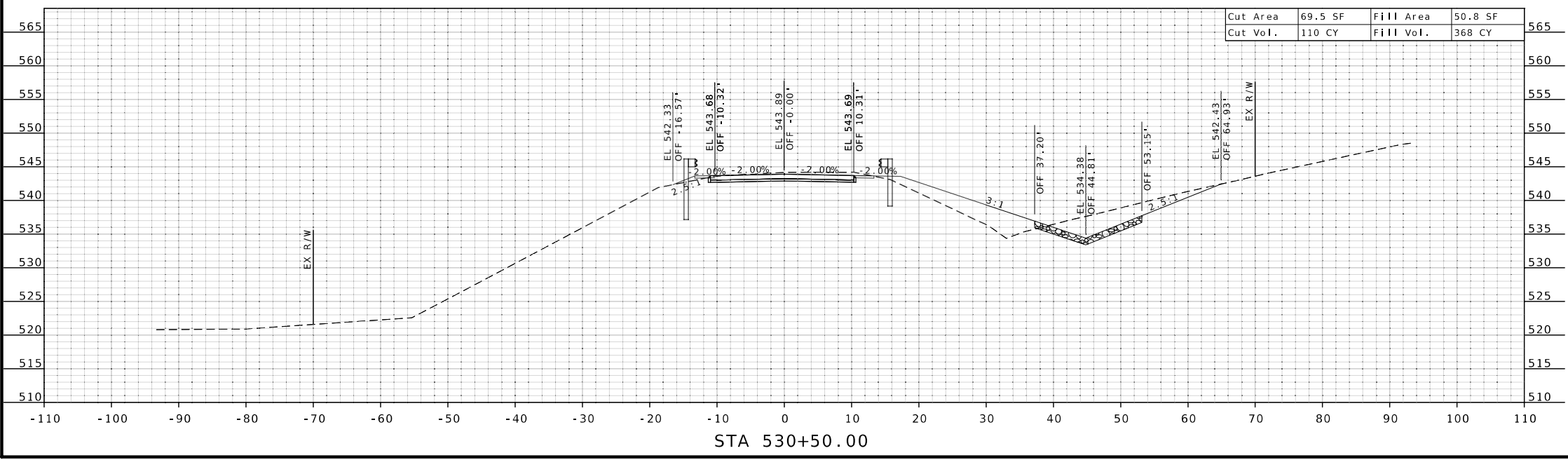
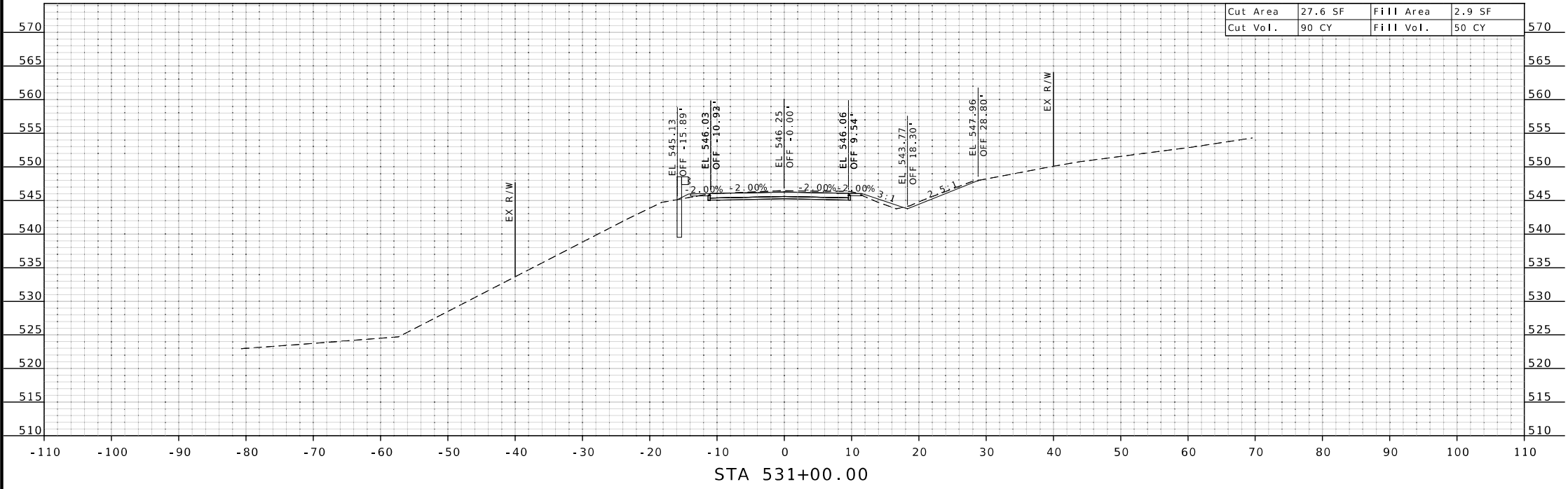

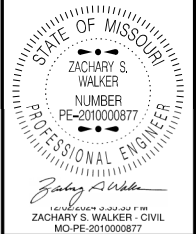

DATE PREPARED
 12/2/2024
 ROUTE K STATE MO
 DISTRICT NE SHEET NO. 6
 COUNTY MONTGOMERY
 JOB NO. JNE0154
 CONTRACT ID.
 PROJECT NO.
 BRIDGE NO.

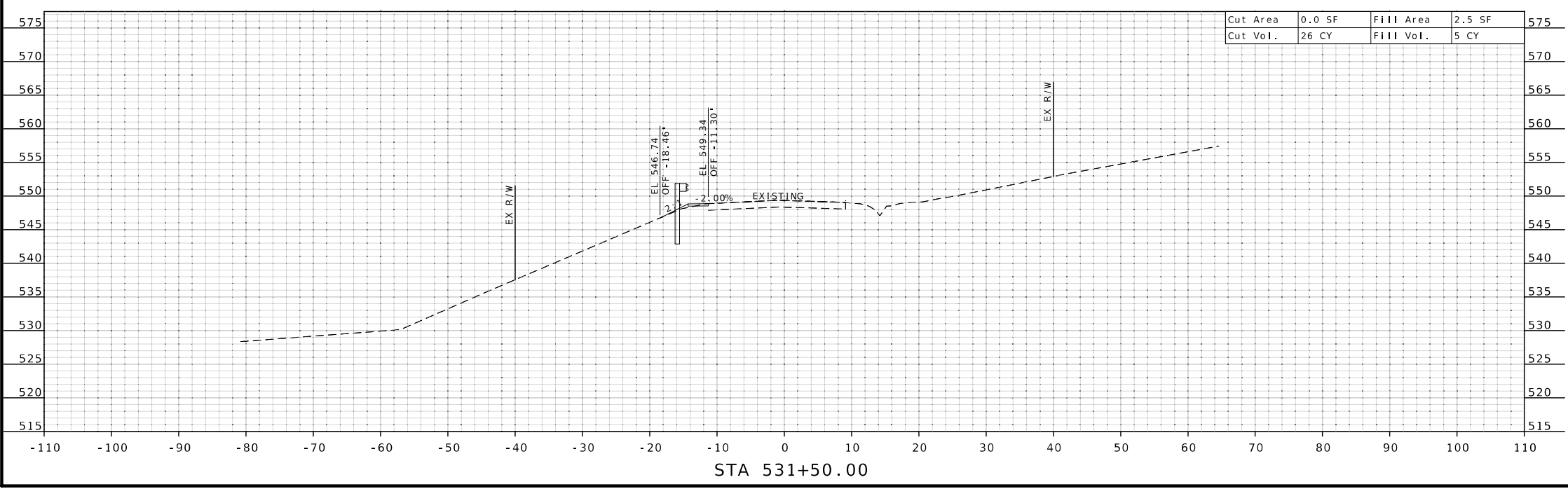
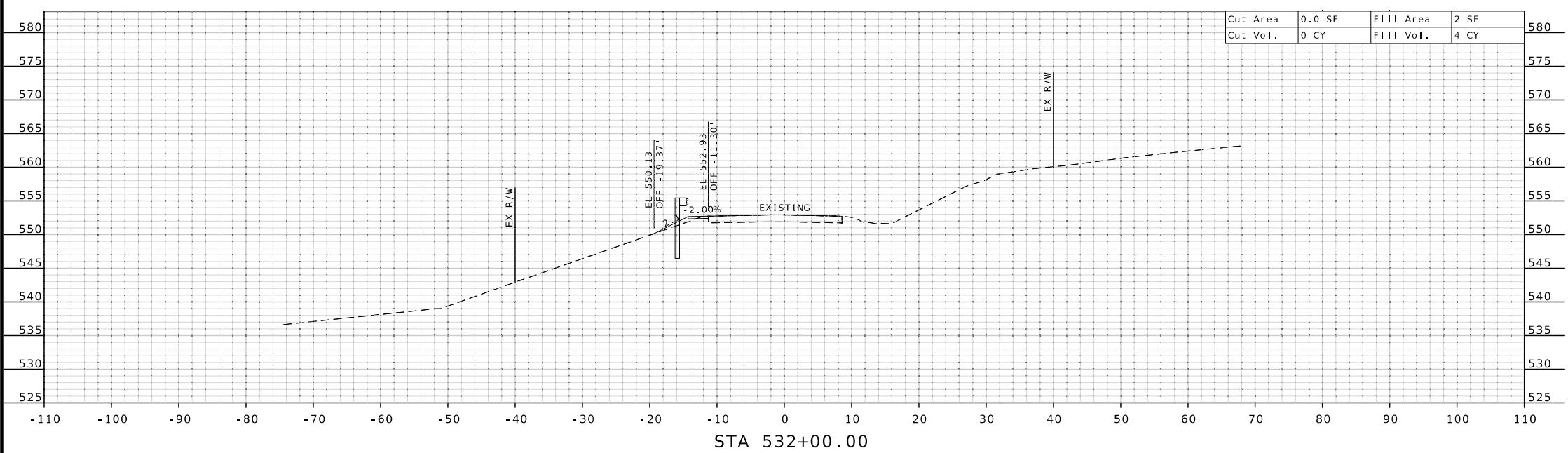

DATE	DESCRIPTION

MISSOURI HIGHWAYS AND TRANSPORTATION COMMISSION
 MoDOT
 105 WEST CAPITOL
 JEFFERSON CITY, MO 65102
 1-888-ASK-MODOT (1-888-275-6636)

XS SHEETS

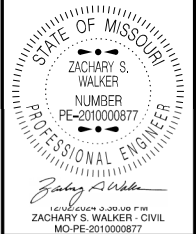

DATE PREPARED
 12/2/2024
 ROUTE K STATE MO
 DISTRICT NE SHEET NO. 7
 COUNTY MONTGOMERY
 JOB NO. JNE0154
 CONTRACT ID.
 PROJECT NO.
 BRIDGE NO.

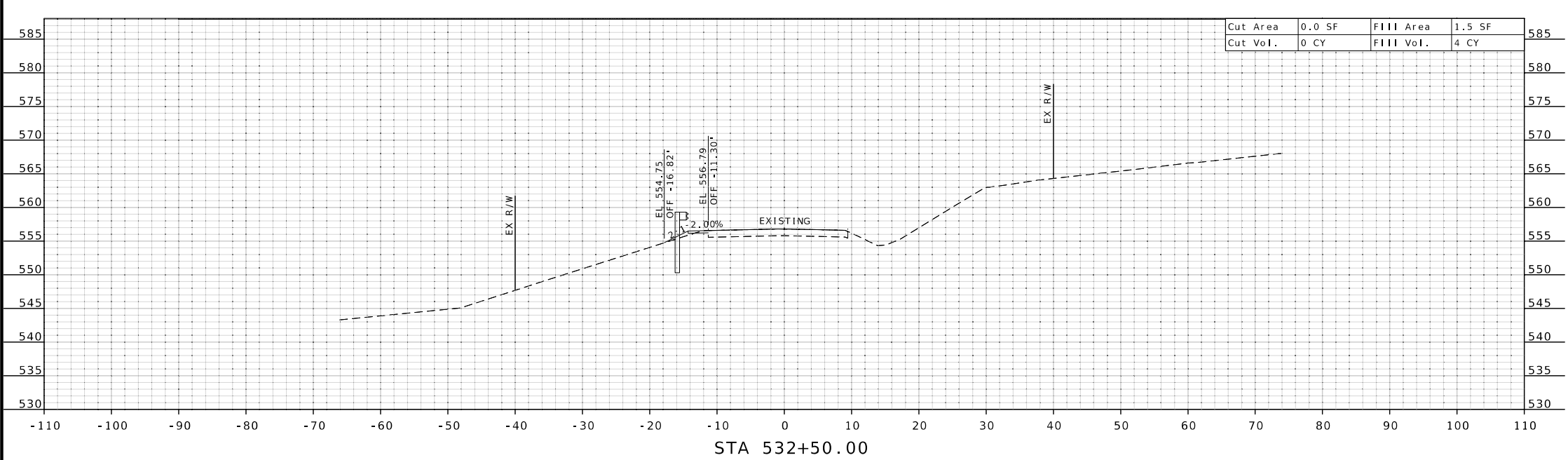
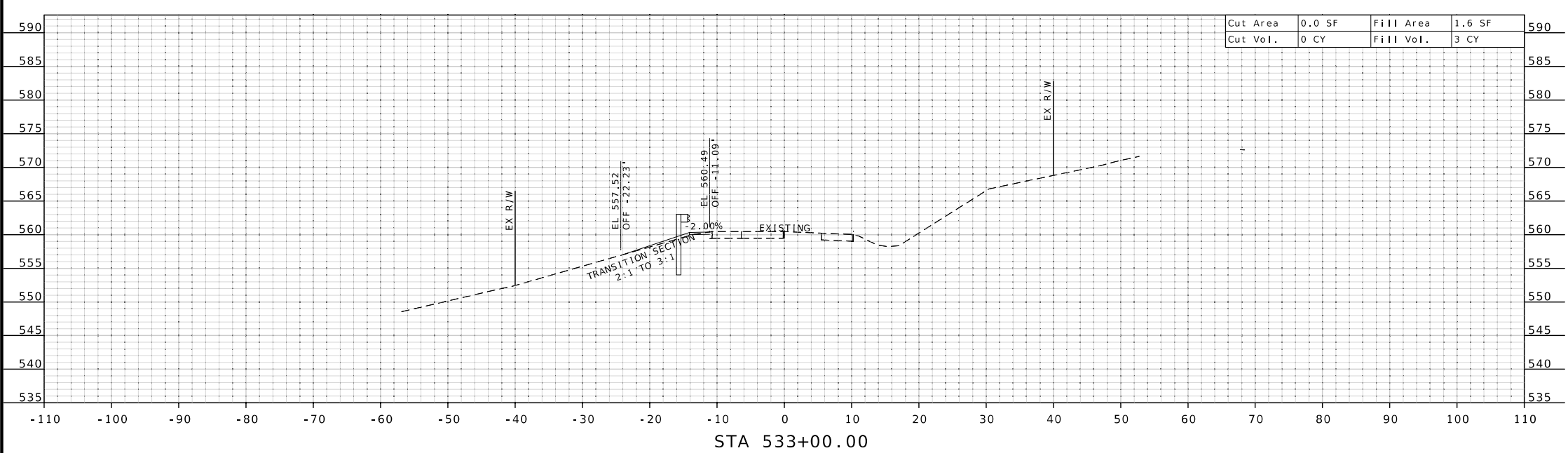

DATE	DESCRIPTION

MISSOURI HIGHWAYS AND TRANSPORTATION COMMISSION
 MoDOT
 105 WEST CAPITOL
 JEFFERSON CITY, MO 65102
 1-888-ASK-MODOT (1-888-275-6636)

XS SHEETS

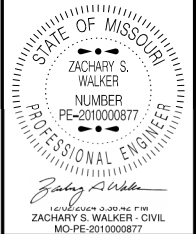

DATE PREPARED
12/2/2024

ROUTE	STATE
K	MO
DISTRICT	SHEET NO.
NE	8

COUNTY
MONTGOMERY

JOB NO.
JNE0154

CONTRACT ID.

PROJECT NO.

BRIDGE NO.

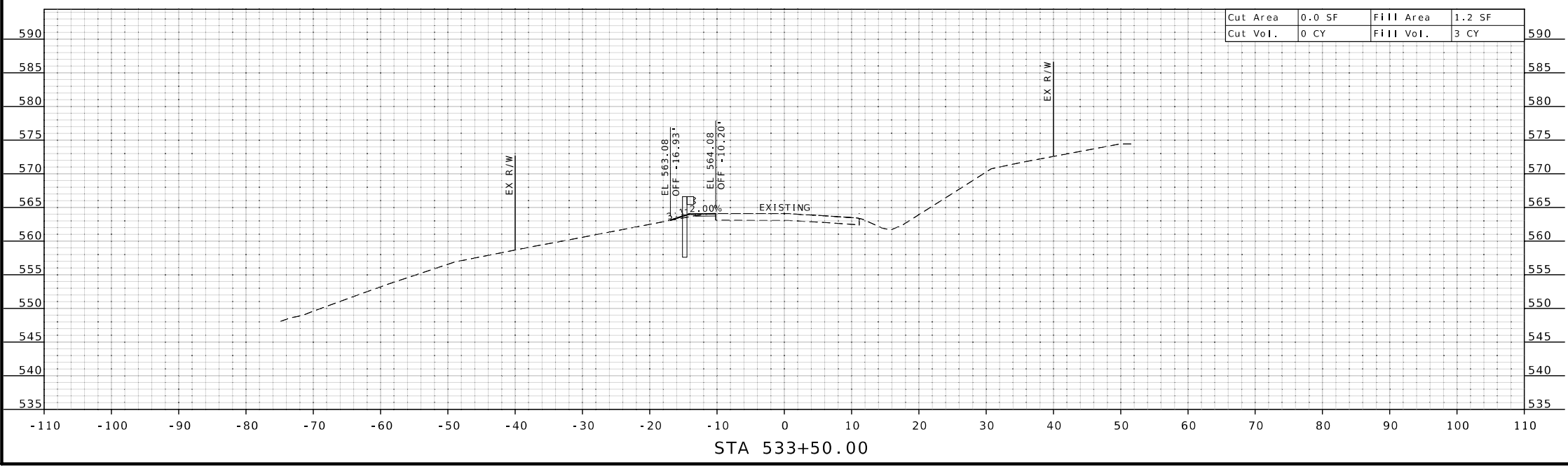
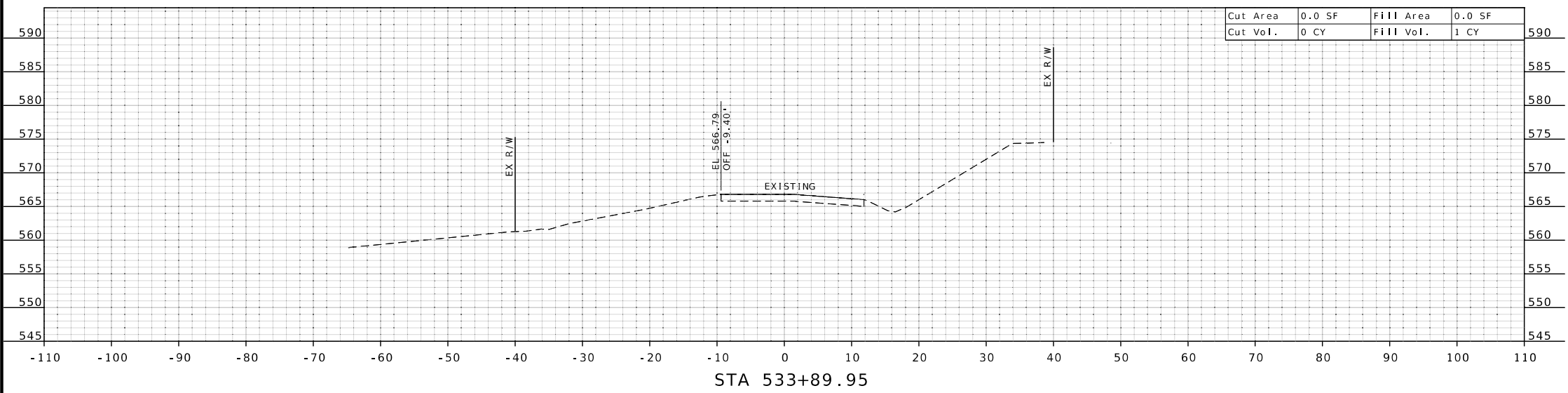

DATE	DESCRIPTION

MISSOURI HIGHWAYS AND TRANSPORTATION COMMISSION



105 WEST CAPITOL
 JEFFERSON CITY, MO 65102
 1-888-ASK-MODOT (1-888-275-6636)

XS SHEETS