

DISCLAIMER
 THE PROFESSIONAL WHOSE SIGNATURE AND PERSONAL SEAL APPEAR HEREON ASSUMES RESPONSIBILITY ONLY FOR WHAT APPEARS ON THIS PAGE, AND DISCLAIMS (PURSUANT TO SECTION 327.411 RSMO) SPECIFICATION, ESTIMATES, REPORTS, OR OTHER DOCUMENTS OR INSTRUMENTS NOT SEALED BY THE UNDERSIGNED PROFESSIONALS RELATING TO OR INTENDED TO BE USED FOR ANY PART OR PARTS OF THE PROJECT TO WHICH THIS PAGE REFERS.



11/27/2024 1:30:40 PM
 Nicholas Michael Correnti - Civil
 MO PE-2010000809

DATE PREPARED
 11/27/2024

ROUTE	STATE
SOR 44E	MO
DISTRICT	SHEET NO.
CD	1

COUNTY
 LACLEDE

JOB NO.
 JCD0101

CONTRACT ID.

PROJECT NO.

BRIDGE NO.

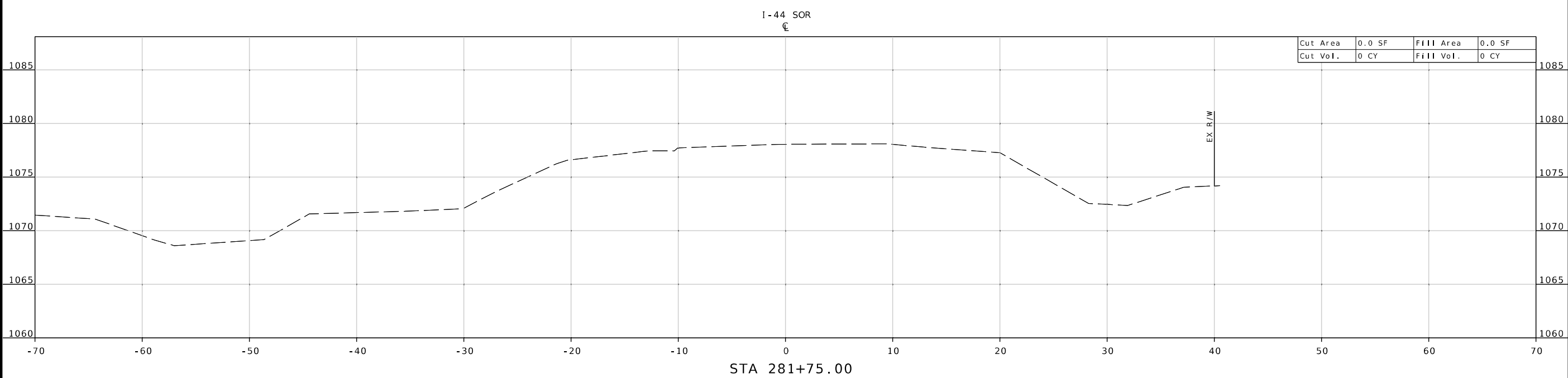
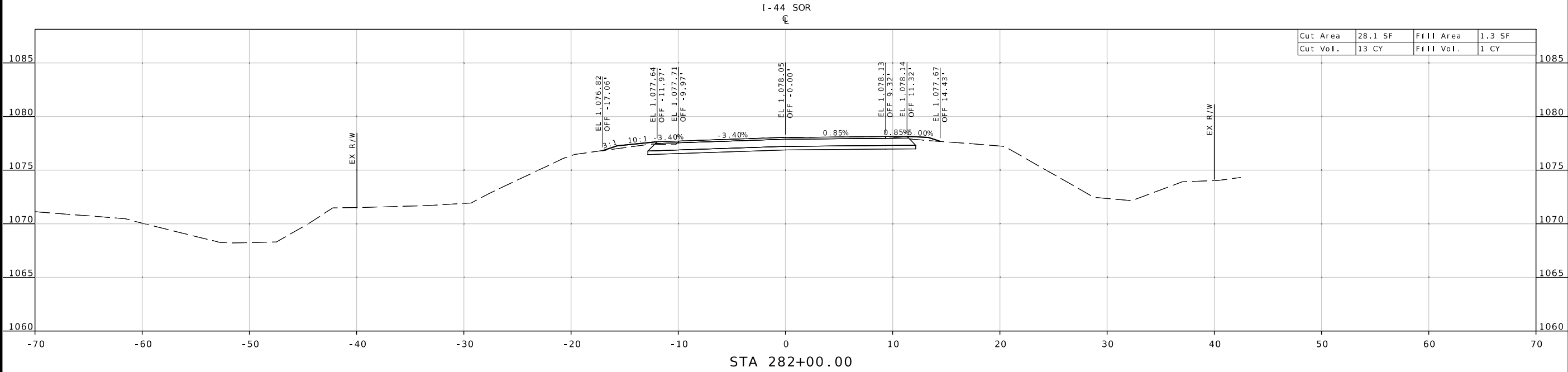

DESCRIPTION	DATE

MISSOURI HIGHWAYS AND TRANSPORTATION
 COMMISSION

105 WEST CAPITOL
 JEFFERSON CITY, MO 65102
 1-888-ASK-MODOT (1-888-275-6636)

EFK Moen
 Civil Engineering Design

13523 Barrett Parkway Dr
 Suite 250
 St. Louis, MO 63021
 Phone 314-394-3100
 Fax 314-394-3199
 Missouri Certificate of Authority: 001578

DISCLAIMER
 THE PROFESSIONAL WHOSE SIGNATURE AND PERSONAL SEAL APPEAR HEREON ASSUMES RESPONSIBILITY ONLY FOR WHAT APPEARS ON THIS PAGE, AND DISCLAIMS (PURSUANT TO SECTION 327.411 RSMO) SPECIFICATION, ESTIMATES, REPORTS, OR OTHER DOCUMENTS OR INSTRUMENTS NOT SEALED BY THE UNDERSIGNED PROFESSIONAL RELATING TO OR INTENDED TO BE USED FOR ANY PART OR PARTS OF THE PROJECT TO WHICH THIS PAGE REFERS.

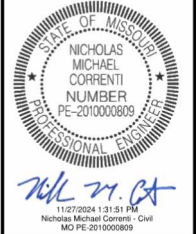

DATE PREPARED
 11/27/2024
 ROUTE STATE
 SOR 44E MO
 DISTRICT SHEET NO.
 CD 2
 COUNTY
 LACLEDE
 JOB NO.
 JCD0101
 CONTRACT ID.
 PROJECT NO.
 BRIDGE NO.

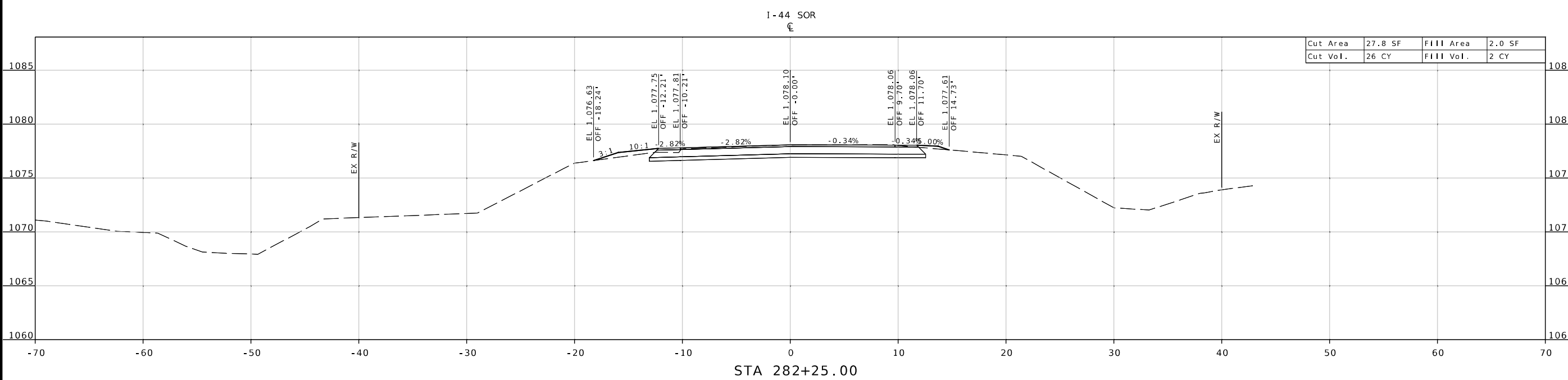
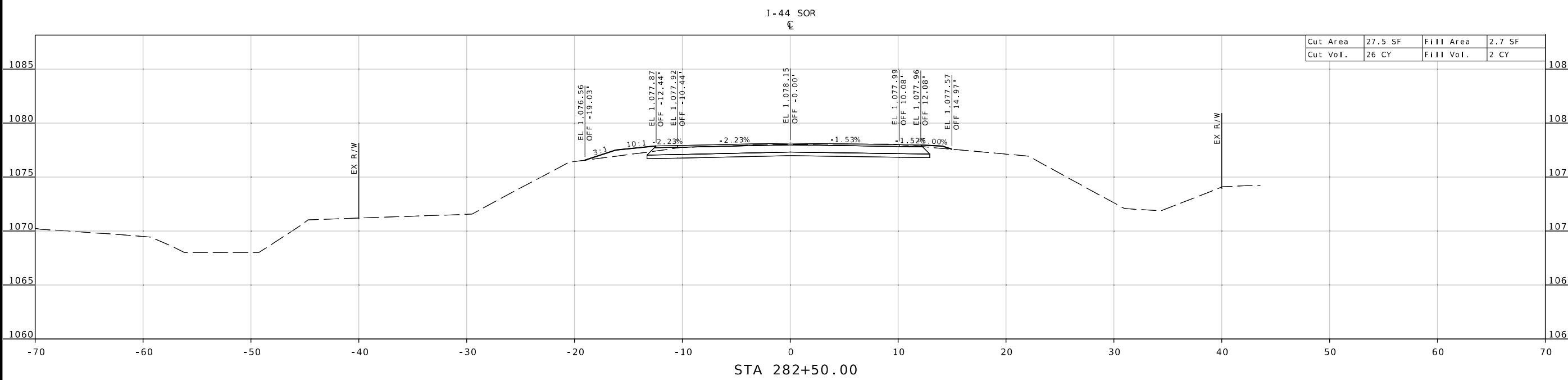

DESCRIPTION	DATE

MISSOURI HIGHWAYS AND TRANSPORTATION COMMISSION



105 WEST CAPITOL
 JEFFERSON CITY, MO 65102
 1-888-ASK-MODOT (1-888-275-6636)

EFK Moen
 Civil Engineering Design
 13523 Barrett Parkway Dr
 Suite 250
 St. Louis, MO 63021
 Phone 314-394-3100
 Fax 314-394-3199
 Missouri Certificate of Authority: 001578

DISCLAIMER
 THE PROFESSIONAL WHOSE SIGNATURE AND PERSONAL SEAL APPEAR HEREON ASSUMES RESPONSIBILITY ONLY FOR WHAT APPEARS ON THIS PAGE, AND DISCLAIMS (PURSUANT TO SECTION 327.411 RSMO) SPECIFICATION, ESTIMATES, REPORTS, OR OTHER DOCUMENTS OR INSTRUMENTS NOT SEALED BY THE UNDERSIGNED PROFESSIONALS RELATING TO OR INTENDED TO BE USED FOR ANY PART OR PARTS OF THE PROJECT TO WHICH THIS PAGE REFERS.



Nick M. Correnti
 11/27/2024 1:32:54 PM
 Nicholas Michael Correnti - Civil
 MO PE-2010000809

DATE PREPARED	11/27/2024	
ROUTE	SOR 44E	STATE MO
DISTRICT	CD	SHEET NO. 3
COUNTY	LACLEDE	
JOB NO.	JCD0101	
CONTRACT ID.		
PROJECT NO.		
BRIDGE NO.		

Cut Area	23.2 SF	Fill Area	11.1 SF
Cut Vol.	23 CY	Fill Vol.	8 CY

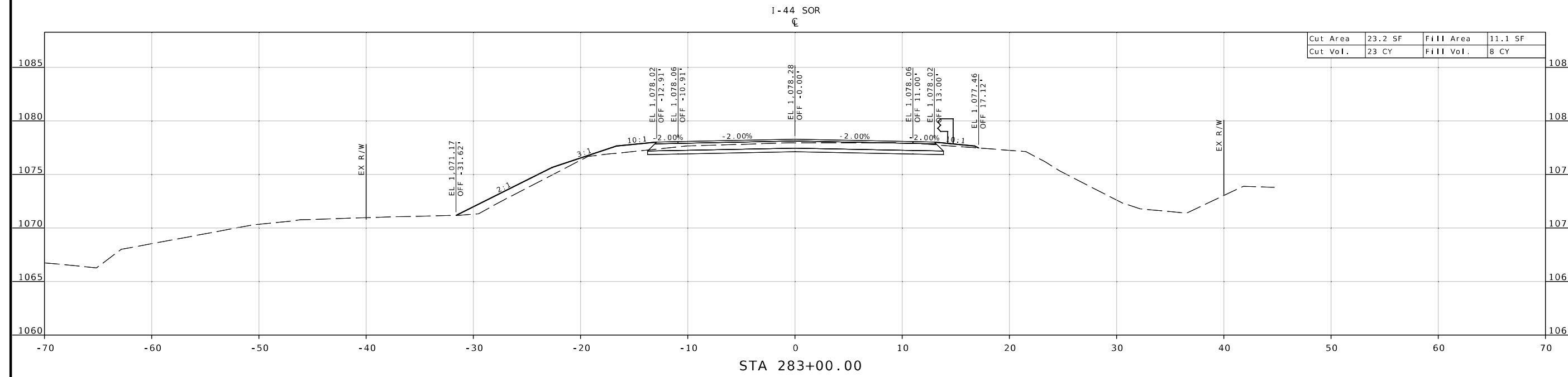

Cut Area	26.4 SF	Fill Area	6.8 SF
Cut Vol.	25 CY	Fill Vol.	4 CY

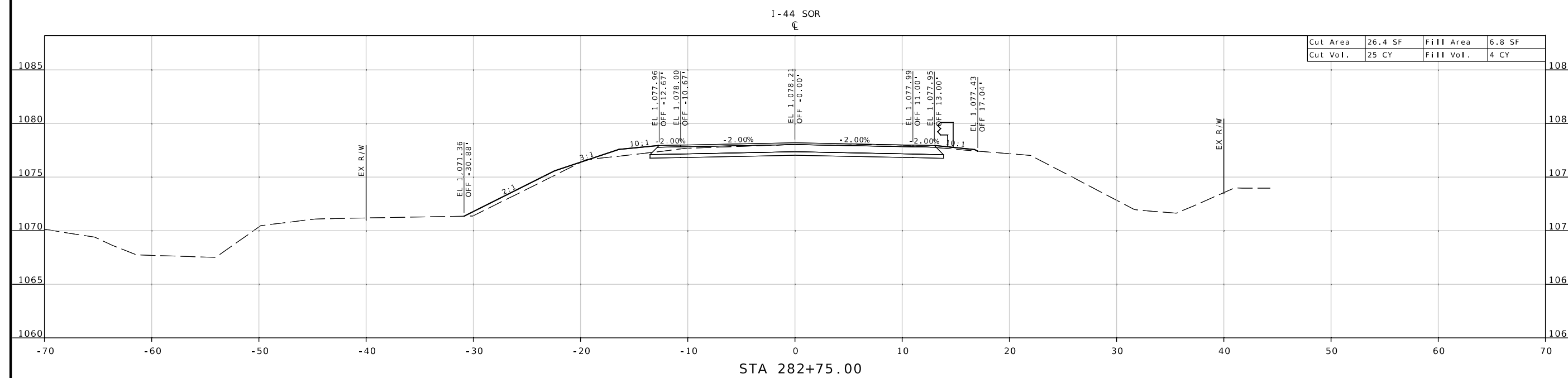

DESCRIPTION	DATE	REVISION

MISSOURI HIGHWAYS AND TRANSPORTATION COMMISSION

MoDOT

105 WEST CAPITOL
 JEFFERSON CITY, MO 65102
 1-888-ASK-MODOT (1-888-275-6636)

EFK Moen
 Civil Engineering Design
 13523 Barrett Parkway Dr
 Suite 250
 St. Louis, MO 63021
 Phone 314-394-3100
 Fax 314-394-3199
 Missouri Certificate of Authority: 001578

DISCLAIMER
THE PROFESSIONAL WHOSE SIGNATURE AND PERSONAL SEAL APPEAR HEREON ASSUMES RESPONSIBILITY ONLY FOR WHAT APPEARS ON THIS PAGE, AND DISCLAIMS (PURSUANT TO SECTION 327.411 RSMO) SPECIFICATION, ESTIMATES, REPORTS, OR OTHER DOCUMENTS OR INSTRUMENTS NOT SEALED BY THE UNDERSIGNED PROFESSIONAL RELATING TO OR INTENDED TO BE USED FOR ANY PART OR PARTS OF THE PROJECT TO WHICH THIS PAGE REFERS.



Nick M. Correnti
11/27/2024 1:33:44 PM
Nicholas Michael Correnti - CIVIL
MO PE-2010000809

DATE PREPARED	11/27/2024
ROUTE	SOR 44E
STATE	MO
DISTRICT	CD
SHEET NO.	4
COUNTY	LACLEDE
JOB NO.	JCD0101
CONTRACT ID.	
PROJECT NO.	
BRIDGE NO.	

I-44 SOR
€

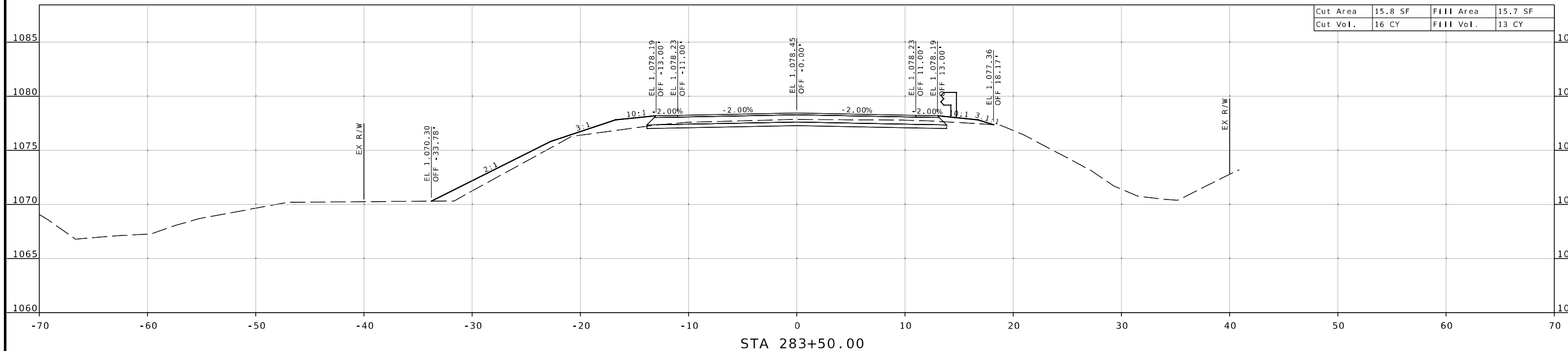

I-44 SOR
€

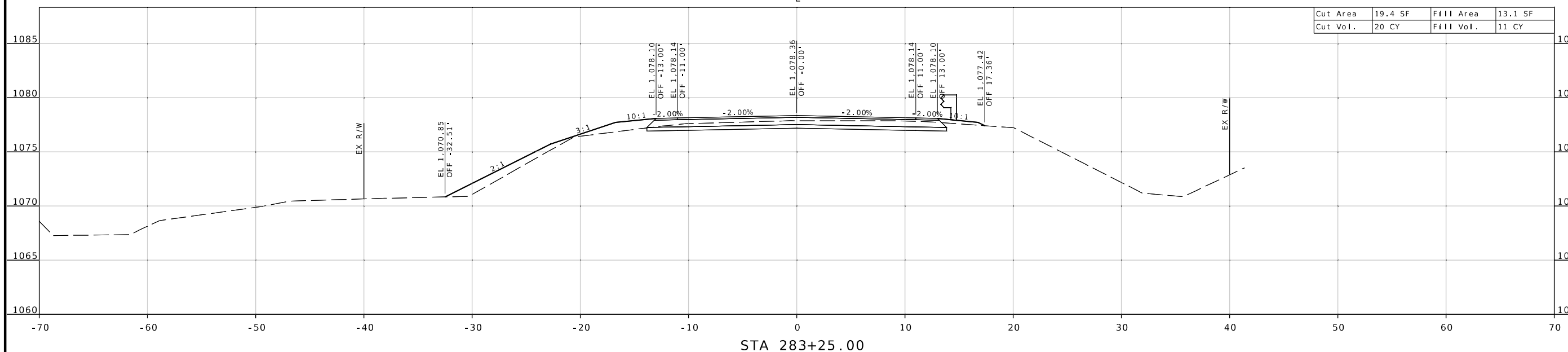

DESCRIPTION	DATE

MISSOURI HIGHWAYS AND TRANSPORTATION COMMISSION
MoDOT logo
105 WEST CAPITOL
JEFFERSON CITY, MO 65102
1-888-ASK-MODOT (1-888-275-6636)

EFK Moen
Civil Engineering Design
13523 Barrett Parkway Dr
Suite 250
St. Louis, MO 63021
Phone 314-394-3100
Fax 314-394-3199
Missouri Certificate of Authority: 001578

DISCLAIMER
 THE PROFESSIONAL WHOSE SIGNATURE AND PERSONAL SEAL APPEAR HEREON ASSUMES RESPONSIBILITY ONLY FOR WHAT APPEARS ON THIS PAGE, AND DISCLAIMS (PURSUANT TO SECTION 327.411 RS MO) SPECIFICATION, ESTIMATES, REPORTS, OR OTHER DOCUMENTS OR INSTRUMENTS NOT SEALED BY THE UNDERSIGNED PROFESSIONAL RELATING TO OR INTENDED TO BE USED FOR ANY PART OR PARTS OF THE PROJECT TO WHICH THIS PAGE REFERS.



DATE PREPARED
 11/27/2024

ROUTE STATE
 SOR 44E MO
 DISTRICT SHEET NO.
 CD 5

COUNTY
 LACLEDE
 JOB NO.
 JCD0101

CONTRACT ID.
 PROJECT NO.
 BRIDGE NO.

DATE	DESCRIPTION

MISSOURI HIGHWAYS AND TRANSPORTATION COMMISSION



105 WEST CAPITOL
 JEFFERSON CITY, MO 65102
 1-888-ASK-MODOT (1-888-275-6636)

EFK Moen
 Civil Engineering Design
 13523 Barrett Parkway Dr
 Suite 250
 St. Louis, MO 63021
 Phone 314-394-3100
 Fax 314-394-3199
 Missouri Certificate of Authority: 001578

I-44 SOR
 ☺

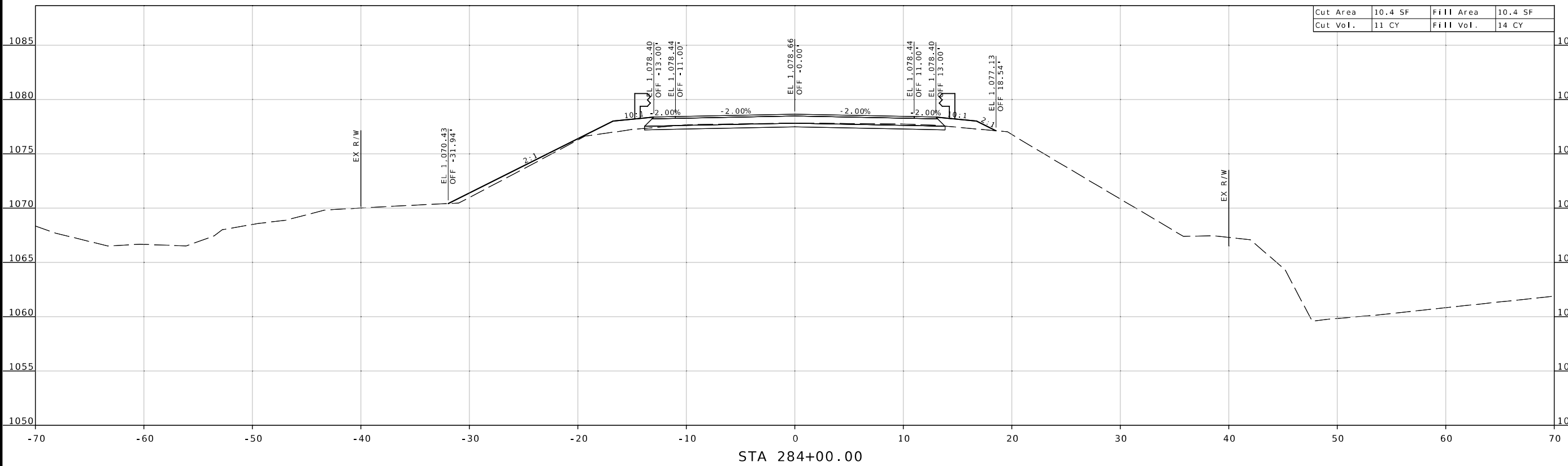

I-44 SOR
 ☺

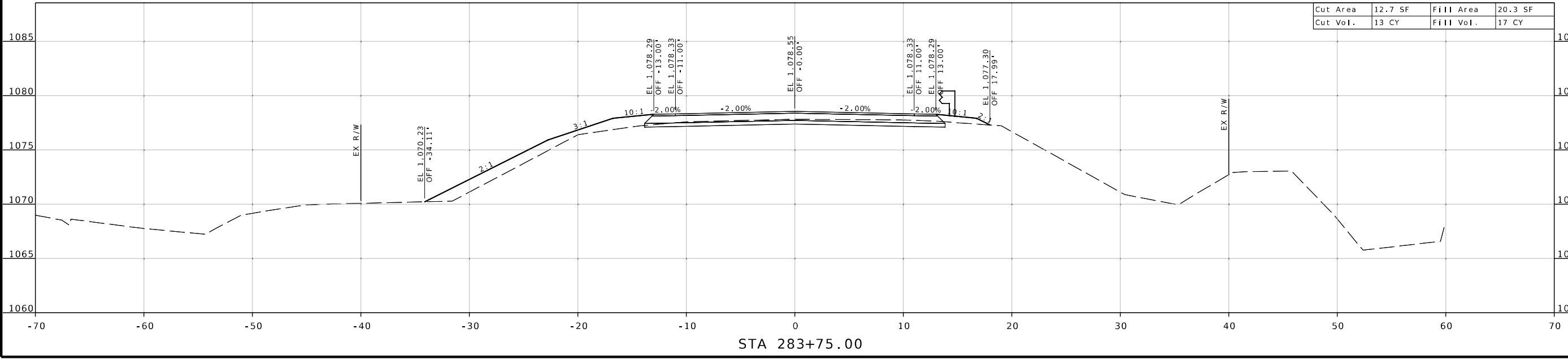

STA 283+75.00

DISCLAIMER
 THE PROFESSIONAL WHOSE SIGNATURE AND PERSONAL SEAL APPEAR HEREON ASSUMES RESPONSIBILITY ONLY FOR WHAT APPEARS ON THIS PAGE, AND DISCLAIMS (PURSUANT TO SECTION 327.411 RSMO) SPECIFICATION, ESTIMATES, REPORTS, OR OTHER DOCUMENTS OR INSTRUMENTS NOT SEALED BY THE UNDERSIGNED PROFESSIONAL RELATING TO OR INTENDED TO BE USED FOR ANY PART OR PARTS OF THE PROJECT TO WHICH THIS PAGE REFERS.



Nick M. Correnti
 11/27/2024 1:25:18 PM
 Nicholas Michael Correnti - Civil
 MO PE-2010000809

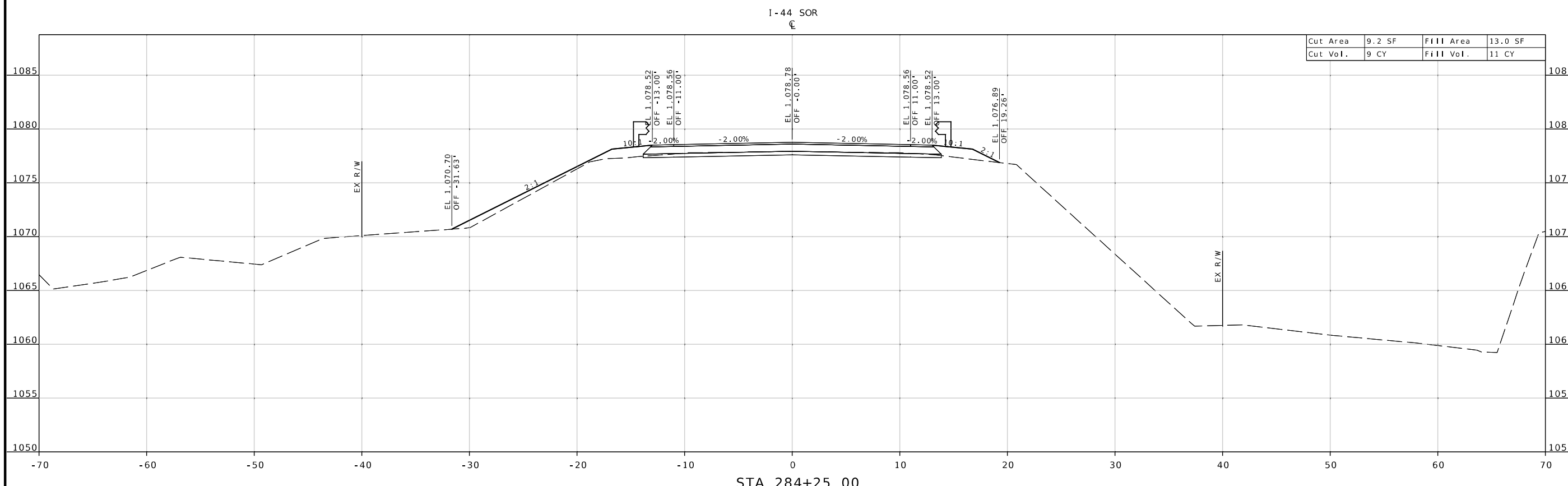
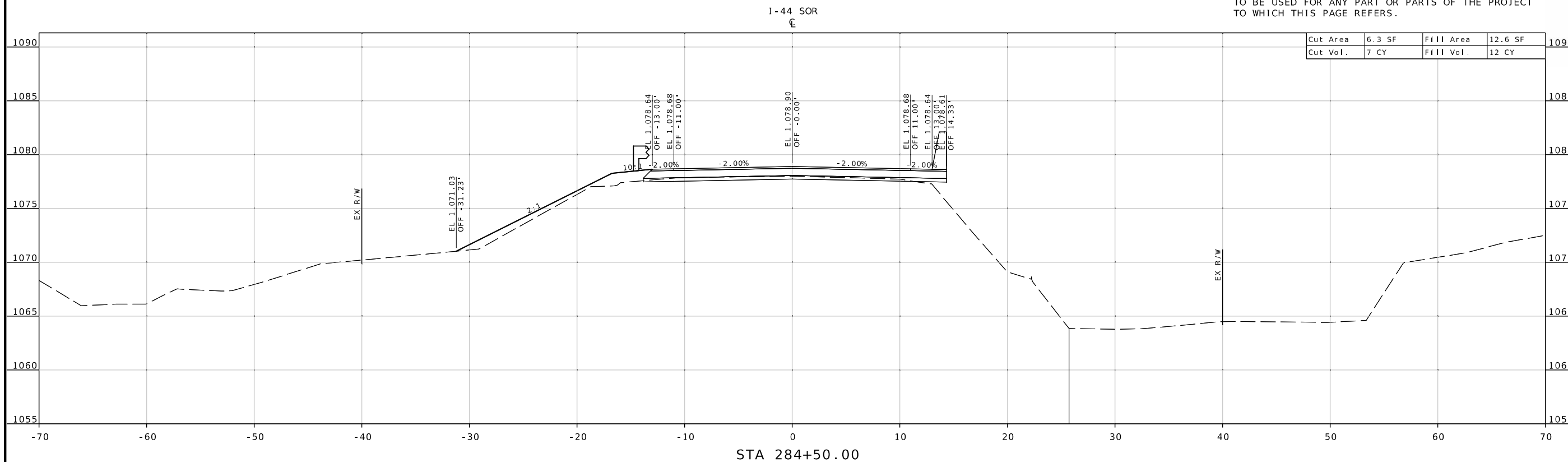

DATE PREPARED		11/27/2024	
ROUTE	STATE	SOR 44E MO	
DISTRICT	SHEET NO.	CD	6
COUNTY			
LACLEDE			
JOB NO.			
JCD0101			
CONTRACT ID.			
PROJECT NO.			
BRIDGE NO.			

DATE	DESCRIPTION

MISSOURI HIGHWAYS AND TRANSPORTATION COMMISSION



105 WEST CAPITOL
 JEFFERSON CITY, MO 65102
 1-888-ASK-MODOT (1-888-273-6636)

EFK Moen
 Civil Engineering Design
 13523 Barrett Parkway Dr
 Suite 250
 St. Louis, MO 63021
 Phone 314-394-3100
 Fax 314-394-3199
 Missouri Certificate of Authority: 001578

DISCLAIMER
THE PROFESSIONAL WHOSE SIGNATURE AND PERSONAL SEAL APPEAR HEREON ASSUMES RESPONSIBILITY ONLY FOR WHAT APPEARS ON THIS PAGE, AND DISCLAIMS (PURSUANT TO SECTION 327.411 RSMO) SPECIFICATION, ESTIMATES, REPORTS, OR OTHER DOCUMENTS OR INSTRUMENTS NOT SEALED BY THE UNDERSIGNED PROFESSIONAL RELATING TO OR INTENDED TO BE USED FOR ANY PART OR PARTS OF THE PROJECT TO WHICH THIS PAGE REFERS.



11/27/2024 1:26:06 PM
Nicholas Michael Correnti - Civil
MO PE-2010000809

DATE PREPARED
11/27/2024

ROUTE STATE
SOR 44E MO

DISTRICT SHEET NO.
CD 7

COUNTY
LACLEDE

JOB NO.
JCD0101

CONTRACT ID.

PROJECT NO.

BRIDGE NO.

DATE	DESCRIPTION

MISOURI HIGHWAYS AND TRANSPORTATION COMMISSION



EFK Moen
Civil Engineering Design
13523 Barrett Parkway Dr
Suite 250
St. Louis, MO 63021
Phone 314-394-3100
Fax 314-394-3199
Missouri Certificate of Authority: 001578

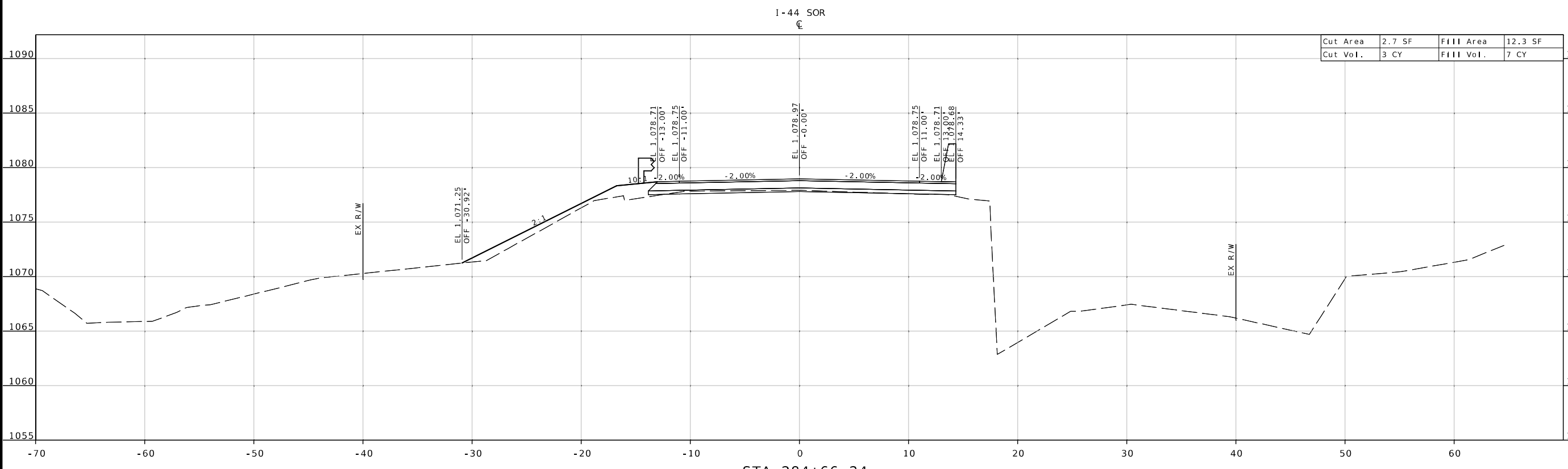
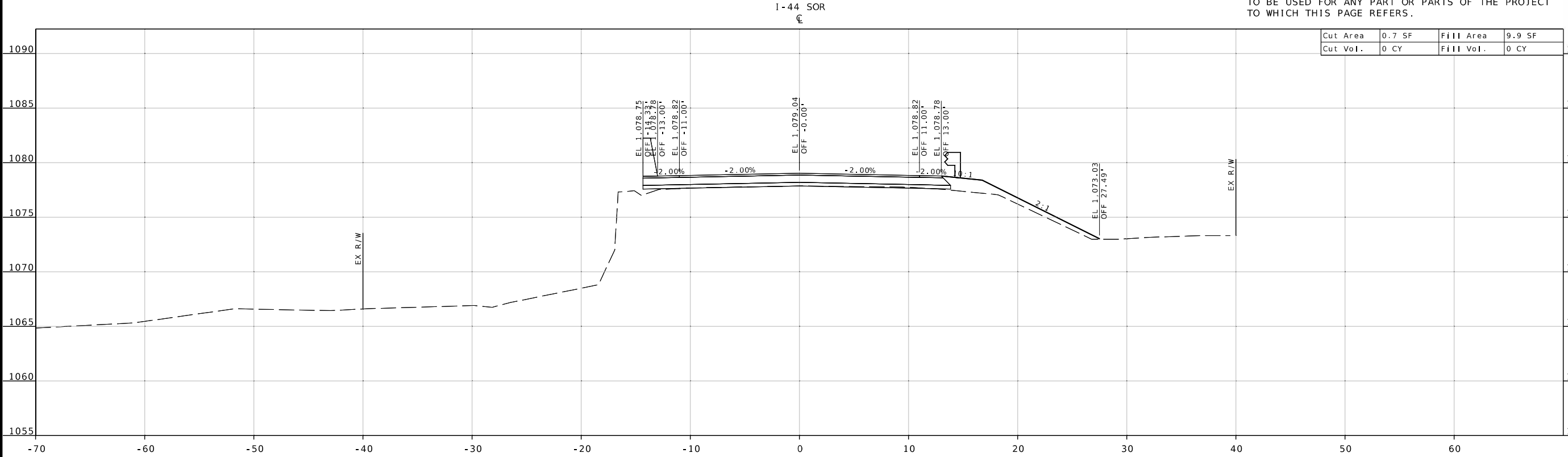

DISCLAIMER
 THE PROFESSIONAL WHOSE SIGNATURE AND PERSONAL SEAL APPEAR HEREON ASSUMES RESPONSIBILITY ONLY FOR WHAT APPEARS ON THIS PAGE, AND DISCLAIMS (PURSUANT TO SECTION 327.411 RSMO) SPECIFICATION, ESTIMATES, REPORTS, OR OTHER DOCUMENTS OR INSTRUMENTS NOT SEALED BY THE UNDERSIGNED PROFESSIONAL RELATING TO OR INTENDED TO BE USED FOR ANY PART OR PARTS OF THE PROJECT TO WHICH THIS PAGE REFERS.



N.M. Correnti
 11/27/2024 1:26:34 PM
 Nicholas Michael Correnti - Civil
 MO PE-2010000809

DATE PREPARED
11/27/2024

ROUTE	STATE
SOR 44E	MO
DISTRICT	SHEET NO.
CD	8
COUNTY	
LACLEDE	
JOB NO.	
JCD0101	
CONTRACT ID.	
PROJECT NO.	
BRIDGE NO.	

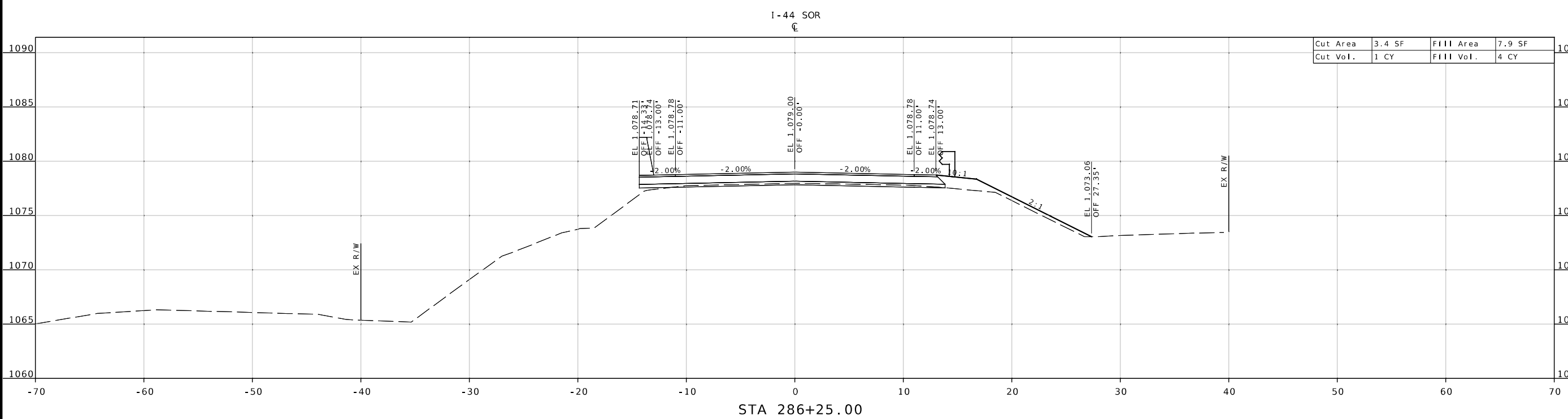
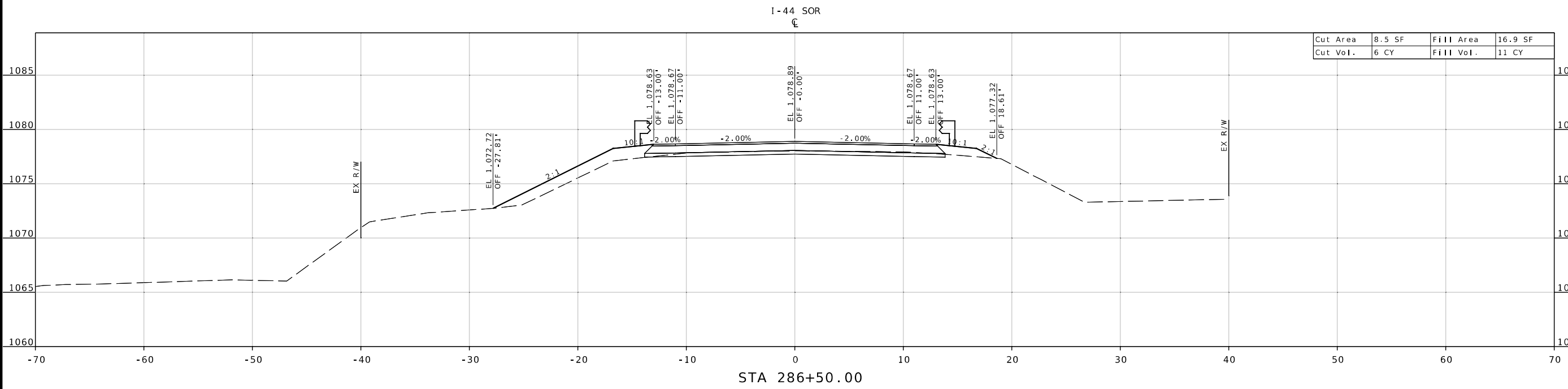

DATE	DESCRIPTION

MISSOURI HIGHWAYS AND TRANSPORTATION COMMISSION

105 WEST CAPITOL
 JEFFERSON CITY, MO 65102
 1-888-ASK-MODOT (1-888-275-6636)

EFK Moen
 Civil Engineering Design
 13523 Barrett Parkway Dr
 Suite 250
 St. Louis, MO 63021
 Phone 314-394-3100
 Fax 314-394-3199
 Missouri Certificate of Authority: 001578

DISCLAIMER
 THE PROFESSIONAL WHOSE SIGNATURE AND PERSONAL SEAL APPEAR HEREON ASSUMES RESPONSIBILITY ONLY FOR WHAT APPEARS ON THIS PAGE, AND DISCLAIMS (PURSUANT TO SECTION 327.411 RSMO) SPECIFICATION, ESTIMATES, REPORTS, OR OTHER DOCUMENTS OR INSTRUMENTS NOT SEALED BY THE UNDERSIGNED PROFESSIONAL RELATING TO OR INTENDED TO BE USED FOR ANY PART OR PARTS OF THE PROJECT TO WHICH THIS PAGE REFERS.

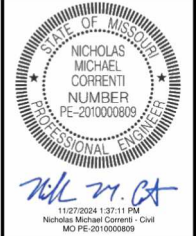

DATE PREPARED
 11/27/2024
 ROUTE STATE
 SOR 44E MO
 DISTRICT SHEET NO.
 CD 9
 COUNTY
 LACLEDE
 JOB NO.
 JCD0101
 CONTRACT ID.

PROJECT NO.
 BRIDGE NO.

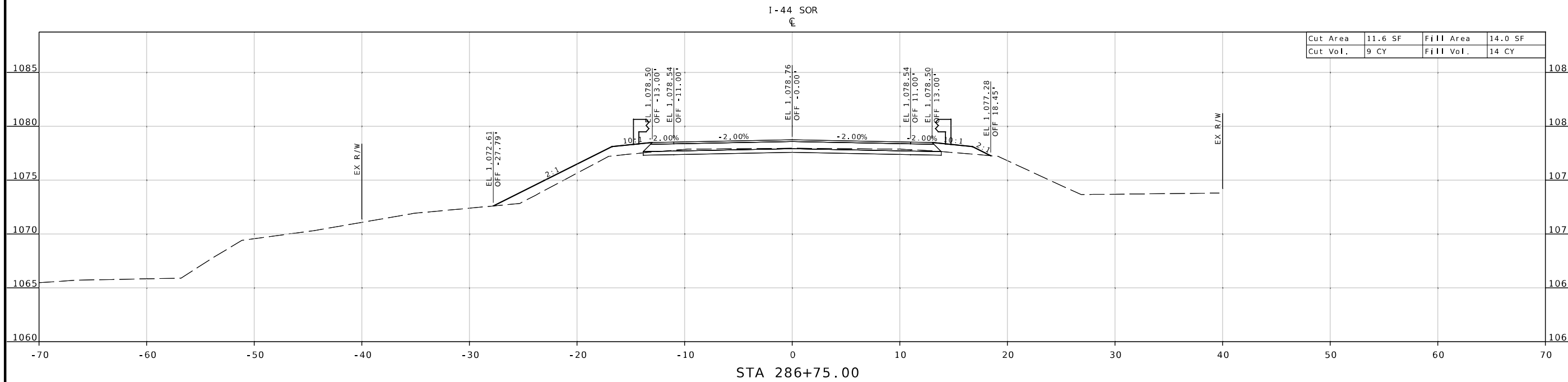
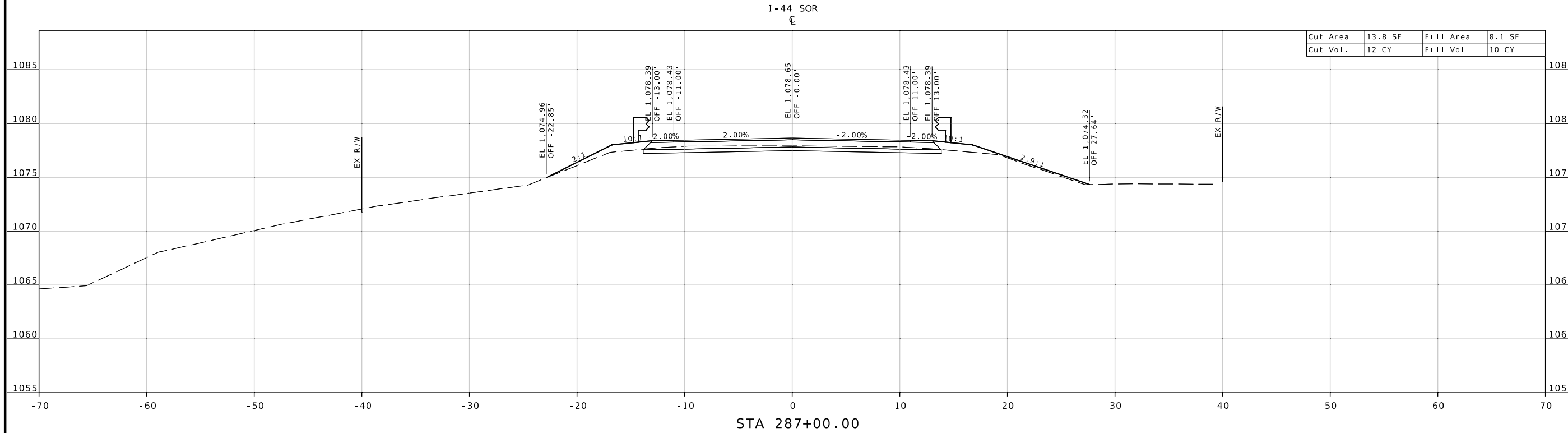

DATE	DESCRIPTION

MISSOURI HIGHWAYS AND TRANSPORTATION COMMISSION
 MoDOT
 105 WEST CAPITOL
 JEFFERSON CITY, MO 65102
 1-888-ASK-MODOT (1-888-275-6636)

EFK Moen
 Civil Engineering Design
 13523 Barrett Parkway Dr
 Suite 250
 St. Louis, MO 63021
 Phone 314-394-3100
 Fax 314-394-3199
 Missouri Certificate of Authority: 001578

DISCLAIMER
 THE PROFESSIONAL WHOSE SIGNATURE AND PERSONAL SEAL APPEAR HEREON ASSUMES RESPONSIBILITY ONLY FOR WHAT APPEARS ON THIS PAGE, AND DISCLAIMS (PURSUANT TO SECTION 327.411 RSMO) SPECIFICATION, ESTIMATES, REPORTS, OR OTHER DOCUMENTS OR INSTRUMENTS NOT SEALED BY THE UNDERSIGNED PROFESSIONAL RELATING TO OR INTENDED TO BE USED FOR ANY PART OR PARTS OF THE PROJECT TO WHICH THIS PAGE REFERS.

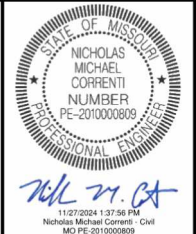

DATE PREPARED
 11/27/2024

ROUTE STATE
 SOR 44E MO

DISTRICT SHEET NO.
 CD 10

COUNTY
 LACLEDE

JOB NO.
 JCD0101

CONTRACT ID.

PROJECT NO.

BRIDGE NO.

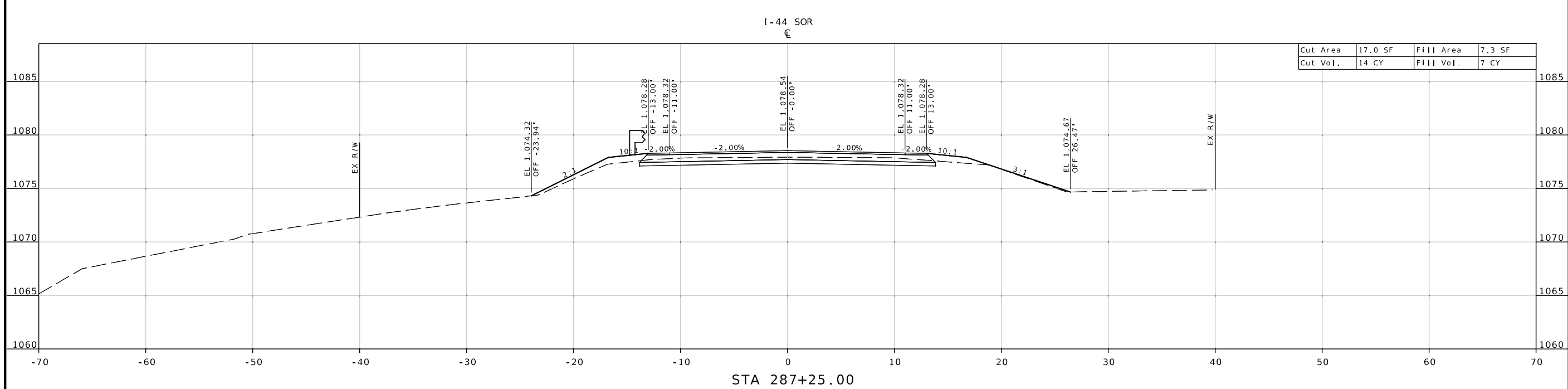
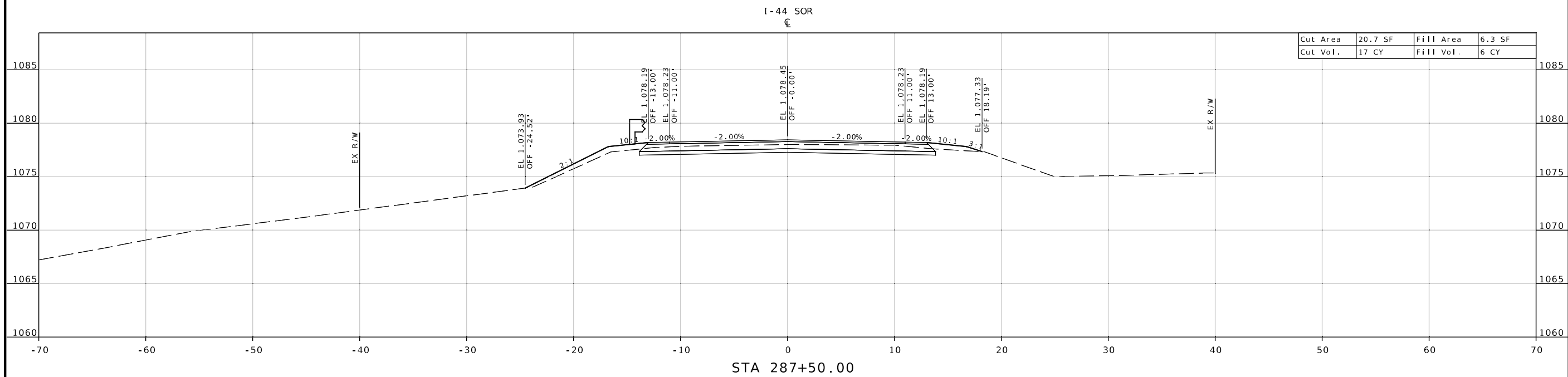

DESCRIPTION	DATE

MISSOURI HIGHWAYS AND TRANSPORTATION COMMISSION



105 WEST CAPITOL
 JEFFERSON CITY, MO 65102
 1-888-ASK-MODOT (1-888-275-6636)

EFK Moen
 Civil Engineering Design

13523 Barrett Parkway Dr
 Suite 250
 St. Louis, MO 63021

Phone 314-394-3100
 Fax 314-394-3199

Missouri Certificate of Authority: 001578

DISCLAIMER
THE PROFESSIONAL WHOSE SIGNATURE AND PERSONAL SEAL APPEAR HEREON ASSUMES RESPONSIBILITY ONLY FOR WHAT APPEARS ON THIS PAGE, AND DISCLAIMS (PURSUANT TO SECTION 327.411 RSMO) SPECIFICATION, ESTIMATES, REPORTS, OR OTHER DOCUMENTS OR INSTRUMENTS NOT SEALED BY THE UNDERSIGNED PROFESSIONAL RELATING TO OR INTENDED TO BE USED FOR ANY PART OR PARTS OF THE PROJECT TO WHICH THIS PAGE REFERS.



Nick M. Correnti
11/27/2024 1:28:47 PM
Nicholas Michael Correnti - Civil
MO PE-2010000809

DATE PREPARED
11/27/2024

ROUTE	STATE
SOR 44E	MO
DISTRICT	SHEET NO.
CD	11
COUNTY	
LACLEDE	
JOB NO.	
JCD0101	
CONTRACT ID.	
PROJECT NO.	
BRIDGE NO.	

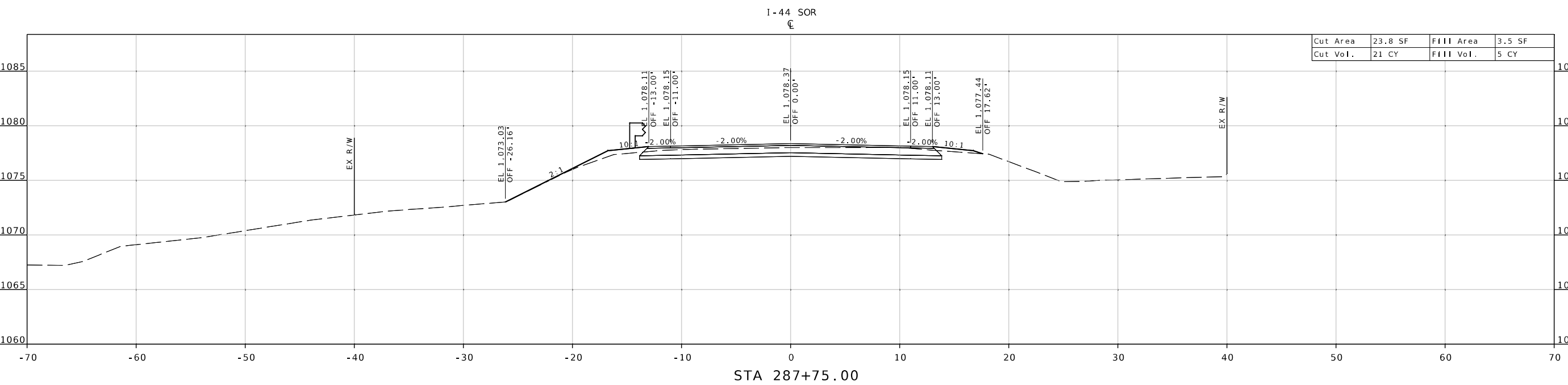
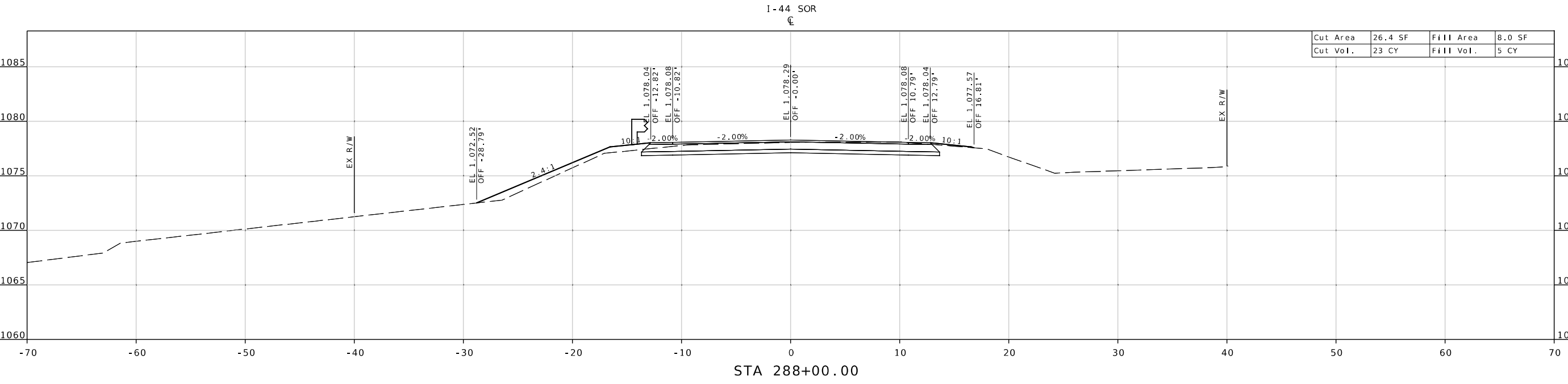

DATE	DESCRIPTION

MISSOURI HIGHWAYS AND TRANSPORTATION COMMISSION

105 WEST CAPITOL
JEFFERSON CITY, MO 65102
1-888-ASK-MODOT (1-888-275-6636)

EFK Moen
Civil Engineering Design
13523 Barrett Parkway Dr
Suite 250
St. Louis, MO 63021
Phone 314-394-3100
Fax 314-394-3199
Missouri Certificate of Authority: 001578

DISCLAIMER
 THE PROFESSIONAL WHOSE SIGNATURE AND PERSONAL SEAL APPEAR HEREON ASSUMES RESPONSIBILITY ONLY FOR WHAT APPEARS ON THIS PAGE, AND DISCLAIMS (PURSUANT TO SECTION 327.411 RSMO) SPECIFICATION, ESTIMATES, REPORTS, OR OTHER DOCUMENTS OR INSTRUMENTS NOT SEALED BY THE UNDERSIGNED PROFESSIONAL RELATING TO OR INTENDED TO BE USED FOR ANY PART OR PARTS OF THE PROJECT TO WHICH THIS PAGE REFERS.

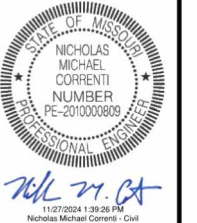

DATE PREPARED
 11/27/2024

ROUTE STATE
 SOR 44E MO

DISTRICT SHEET NO.
 CD 12

COUNTY
 LACLEDE

JOB NO.
 JCD0101

CONTRACT ID.

PROJECT NO.

BRIDGE NO.

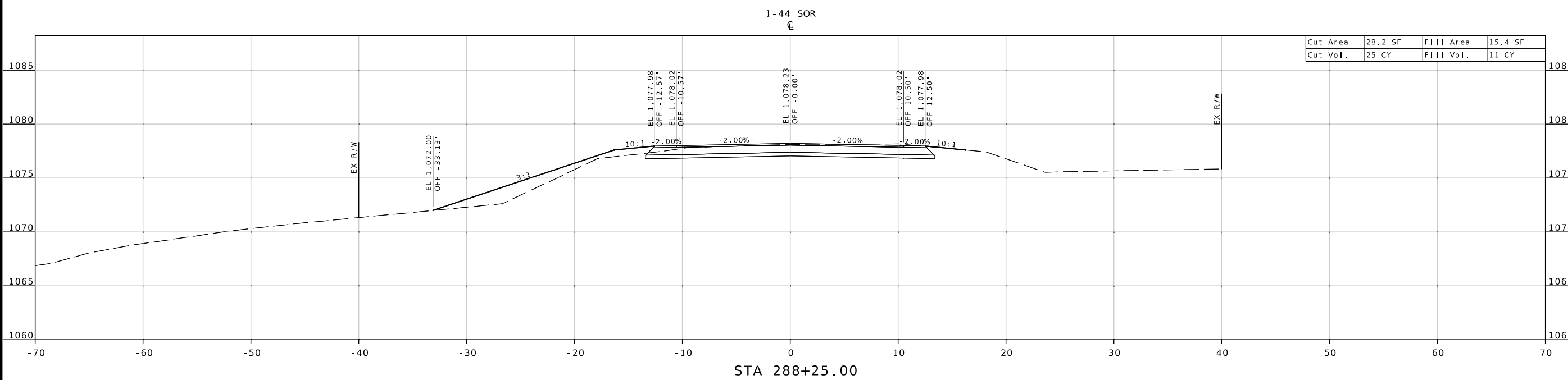
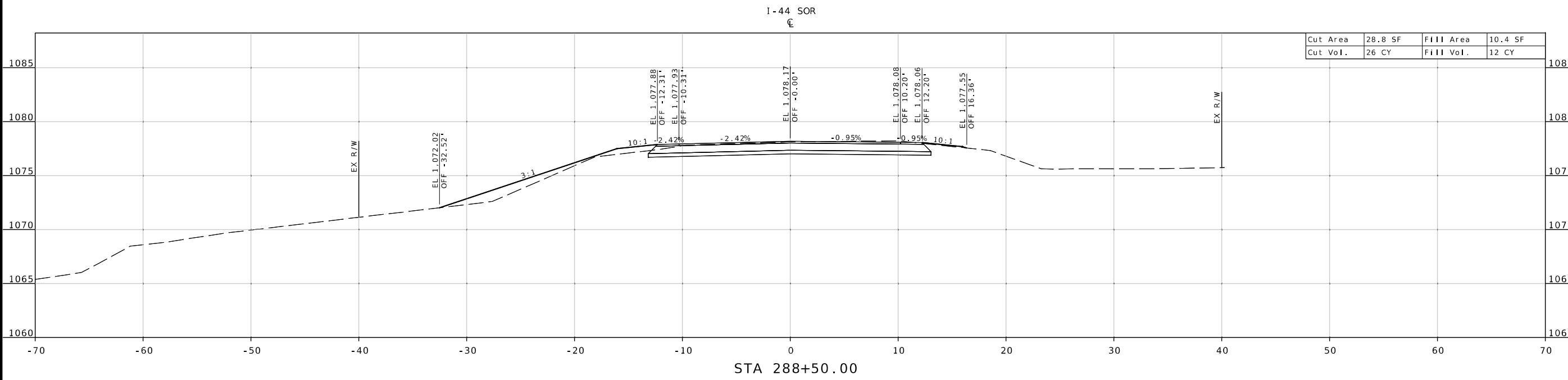

DESCRIPTION	DATE

MISSOURI HIGHWAYS AND TRANSPORTATION COMMISSION

MoDOT

105 WEST CAPITOL
 JEFFERSON CITY, MO 65102
 1-888-ASK-MODOT (1-888-275-6636)

EFK Moen
 Civil Engineering Design
 13523 Barrett Parkway Dr
 Suite 250
 St. Louis, MO 63021
 Phone 314-394-3100
 Fax 314-394-3199
 Missouri Certificate of Authority: 001578

DISCLAIMER
 THE PROFESSIONAL WHOSE SIGNATURE AND PERSONAL SEAL APPEAR HEREON ASSUMES RESPONSIBILITY ONLY FOR WHAT APPEARS ON THIS PAGE, AND DISCLAIMS (PURSUANT TO SECTION 327.411 RSMO) SPECIFICATION, ESTIMATES, REPORTS, OR OTHER DOCUMENTS OR INSTRUMENTS NOT SEALED BY THE UNDERSIGNED PROFESSIONAL RELATING TO OR INTENDED TO BE USED FOR ANY PART OR PARTS OF THE PROJECT TO WHICH THIS PAGE REFERS.

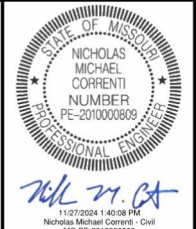

DATE PREPARED
11/27/2024

ROUTE	STATE
SOR 44E	MO
DISTRICT	SHEET NO.
CD	13
COUNTY	
LACLEDE	
JOB NO.	
JCD0101	
CONTRACT ID.	

PROJECT NO.
 BRIDGE NO.

DATE	DESCRIPTION

MISSOURI HIGHWAYS AND TRANSPORTATION COMMISSION

105 WEST CAPITOL
 JEFFERSON CITY, MO 65102
 1-888-ASK-MODOT (1-888-275-6636)

EFK Moen
 Civil Engineering Design
 13523 Barrett Parkway Dr
 Suite 250
 St. Louis, MO 63021
 Phone 314-394-3100
 Fax 314-394-3199
 Missouri Certificate of Authority: 001578

