

THIS SHEET HAS BEEN
SIGNED, SEALED AND DATED
ELECTRONICALLY.

DATE PREPARED
11/7/2024

ROUTE C STATE MO
DISTRICT CD SHEET NO. 1

COUNTY
WASHINGTON

JOB NO.
J5S3506

CONTRACT ID.

PROJECT NO.

BRIDGE NO.

DATE	DESCRIPTION

MISSOURI HIGHWAYS AND TRANSPORTATION
COMMISSION

105 WEST CAPITOL
JEFFERSON CITY, MO 65102
1-888-ASK-MODOT (1-888-275-6636)

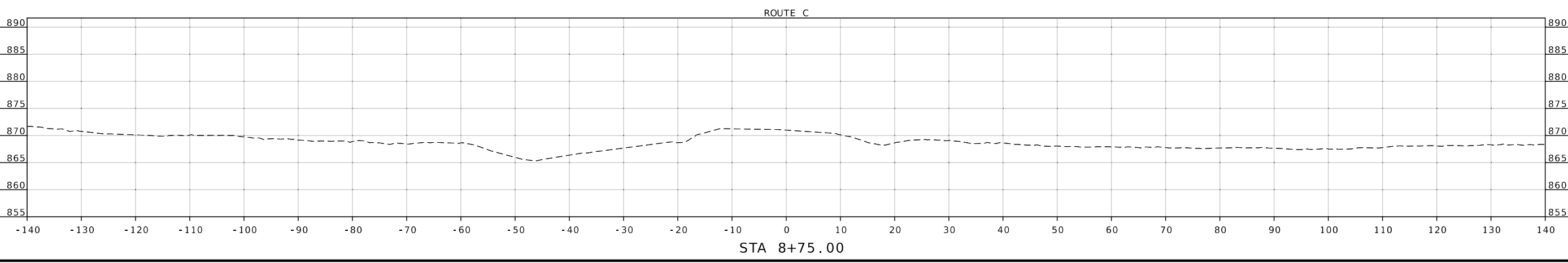
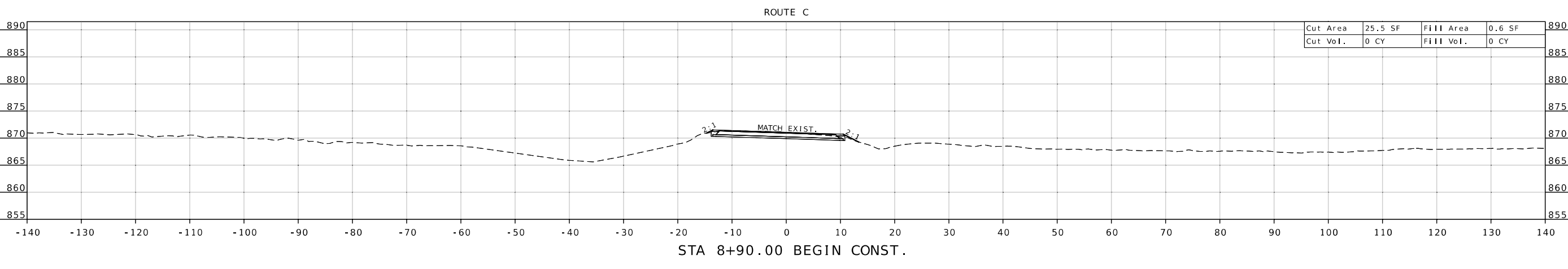
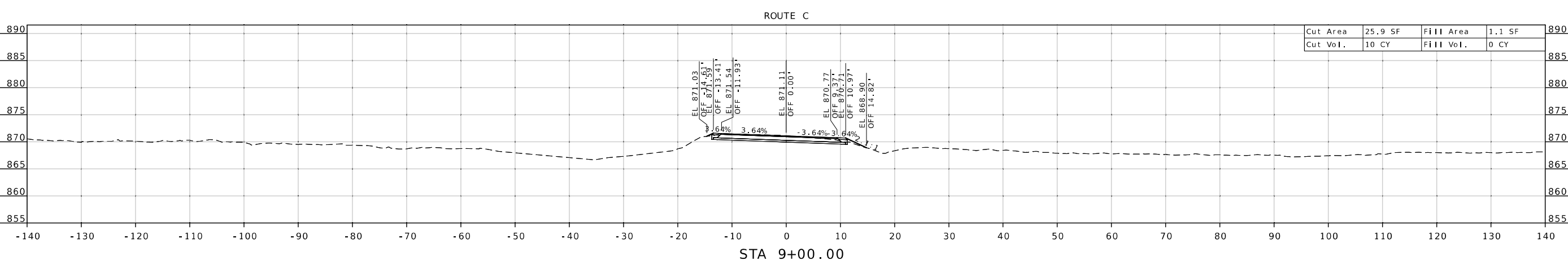



THIS SHEET HAS BEEN
SIGNED SEALED AND DATED
ELECTRONICALLY.

DATE PREPARED
11/7/2024

ROUTE	STATE
C	MO
DISTRICT	SHEET NO.
CD	2

COUNTY
WASHINGTON

JOB NO.
J5S3506

CONTRACT ID.

PROJECT NO.

BRIDGE NO.

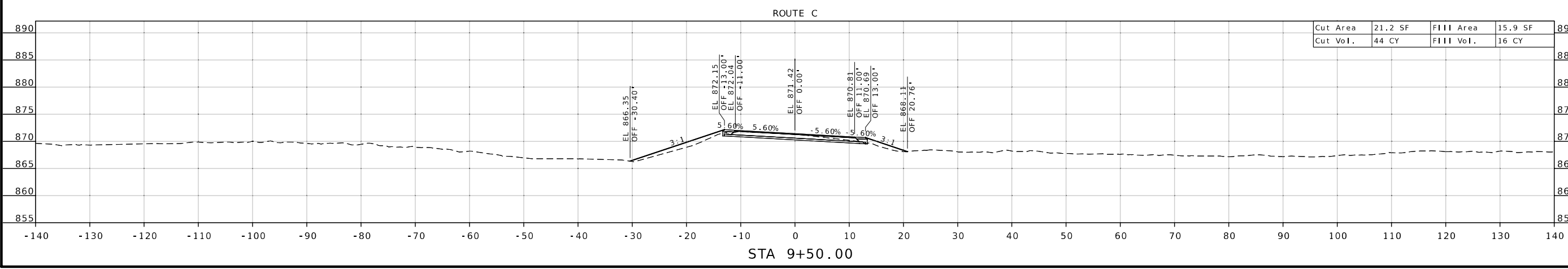
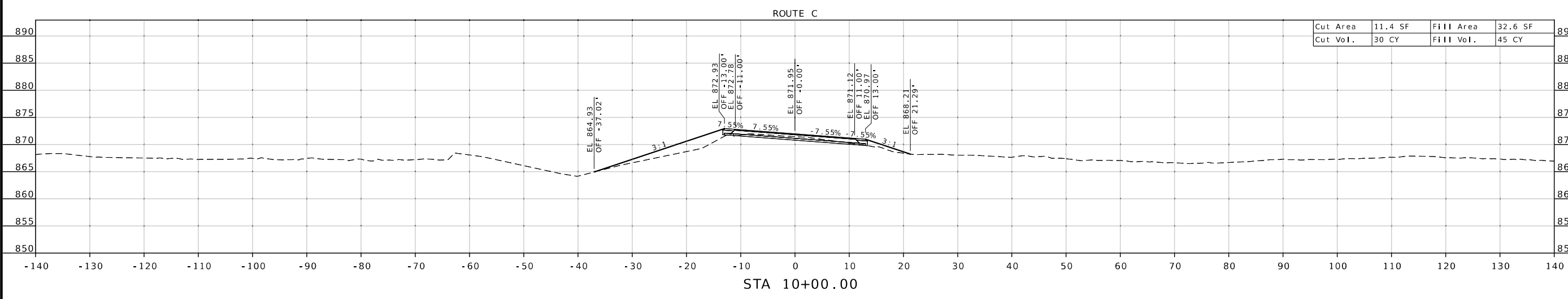
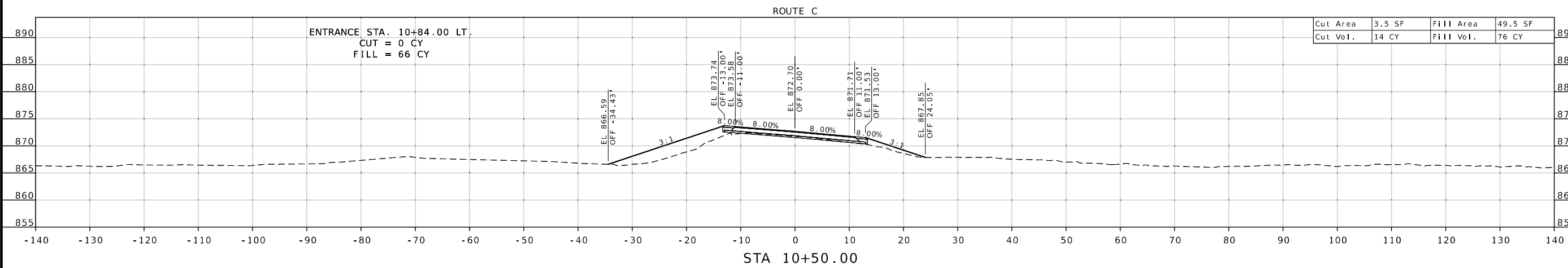

DESCRIPTION

DATE

MISSOURI HIGHWAYS AND TRANSPORTATION COMMISSION

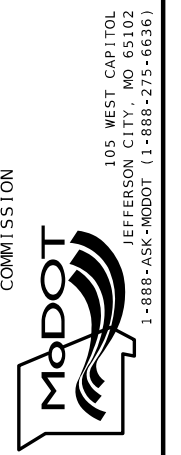

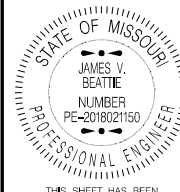

THIS SHEET HAS BEEN SIGNED, SEALED AND DATED ELECTRONICALLY.

DATE PREPARED	
11/7/2024	
ROUTE	STATE
C	MO
DISTRICT	SHEET NO.
CD	3
COUNTY	
WASHINGTON	
JOB NO.	
J5S3506	
CONTRACT ID.	
PROJECT NO.	
BRIDGE NO.	

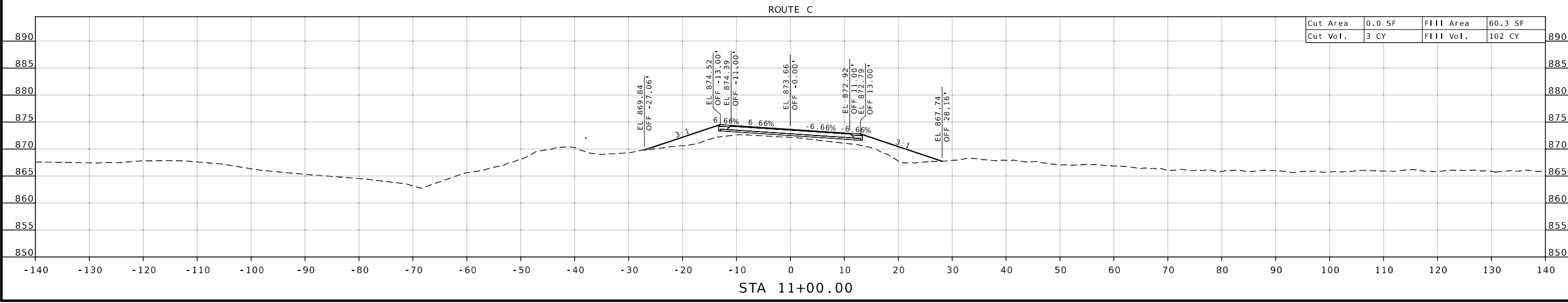
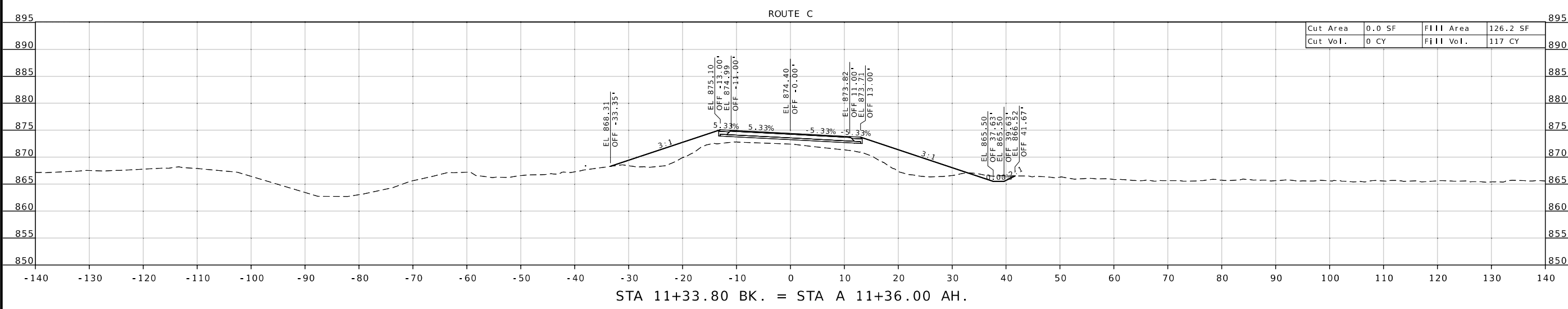
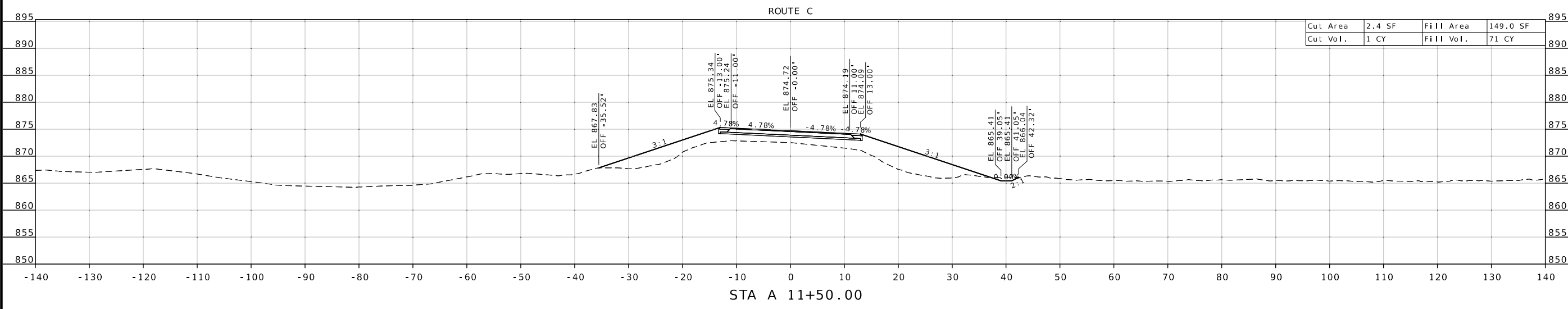

DESCRIPTION

DATE

MISSOURI HIGHWAYS AND TRANSPORTATION COMMISSION



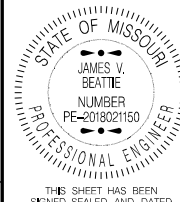

THIS SHEET HAS BEEN
SIGNED, SEALED AND DATED
ELECTRONICALLY.

DATE PREPARED

11/7/2024

ROUTE STATE

C MO

DISTRICT SHEET NO.

CD 4

COUNTY

WASHINGTON

JOB NO.

J5S3506

CONTRACT ID.

PROJECT NO.

BRIDGE NO.

DESCRIPTION

DATE

MISSOURI HIGHWAYS AND TRANSPORTATION COMMISSION

105 WEST CAPITOL

JEFFERSON CITY, MO 65102

1-888-ASK-MODOT (1-888-275-6636)

1

2

3

4

5

6

7

8

9

10

11

12

13

14

15

16

17

18

19

20

21

22

23

24

25

26

27

28

29

30

31

32

33

34

35

36

37

38

39

40

41

42

43

44

45

46

47

48

49

50

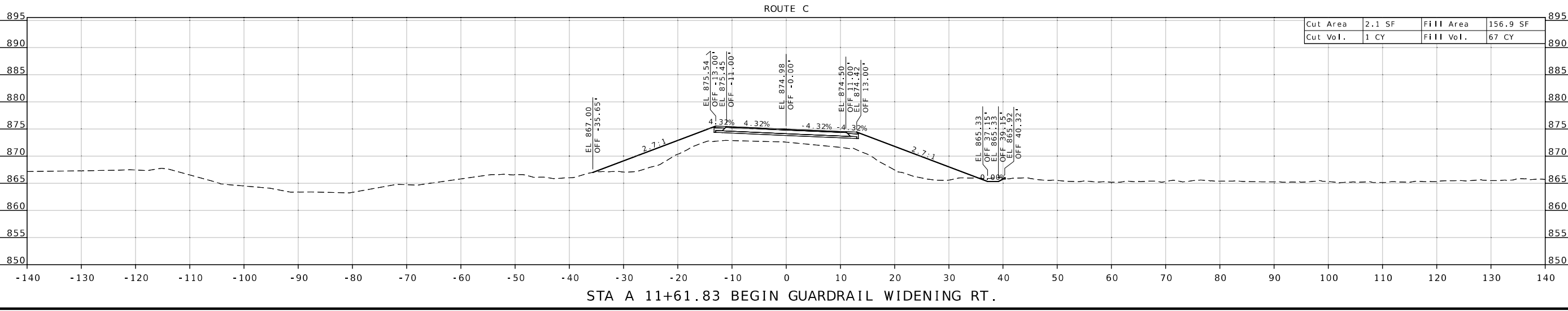
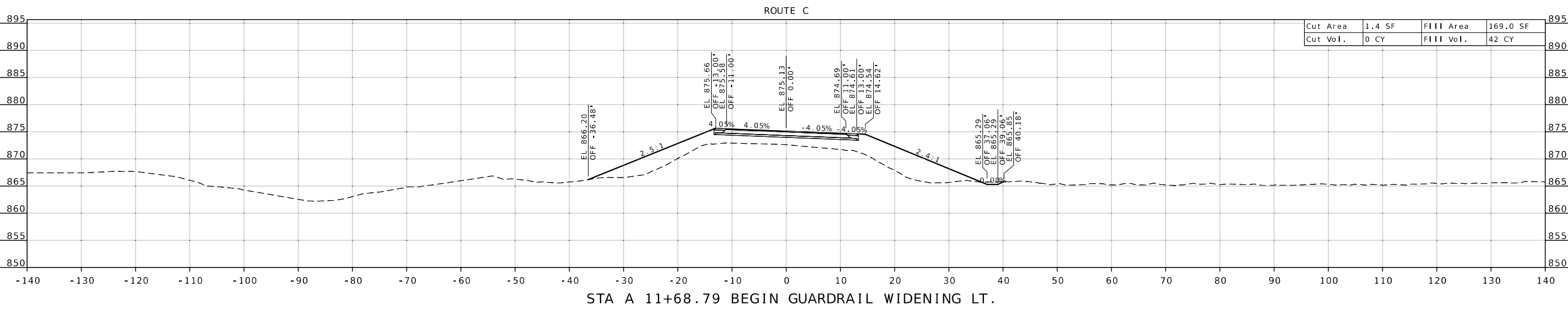
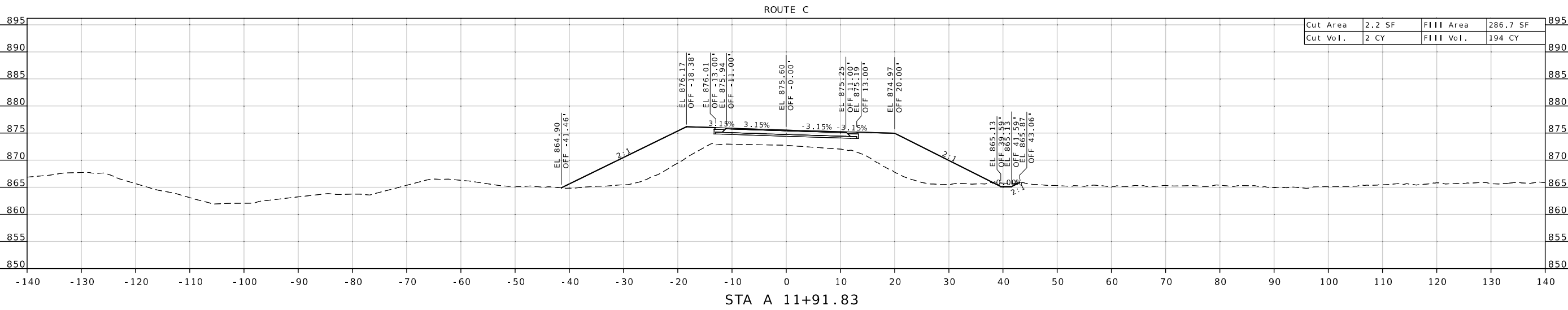

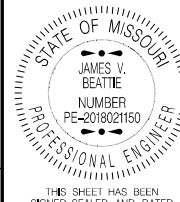

THIS SHEET HAS BEEN SIGNED, SEALED AND DATED ELECTRONICALLY.

DATE PREPARED 11/7/2024

ROUTE C STATE MO

DISTRICT CD SHEET NO. 5

COUNTY WASHINGTON

JOB NO. J5S3506

CONTRACT ID.

PROJECT NO.

BRIDGE NO.

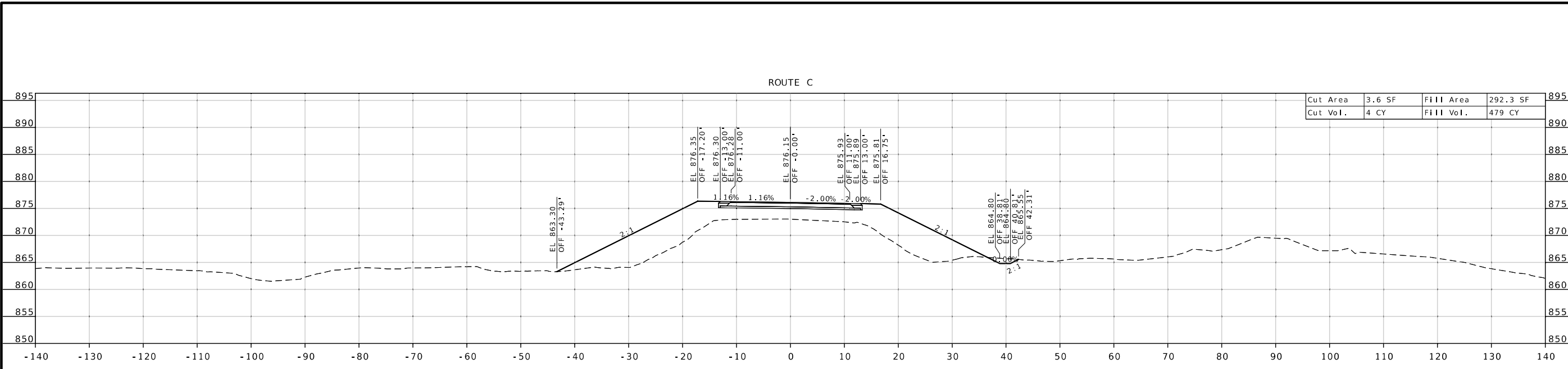

STA A 12+42.62

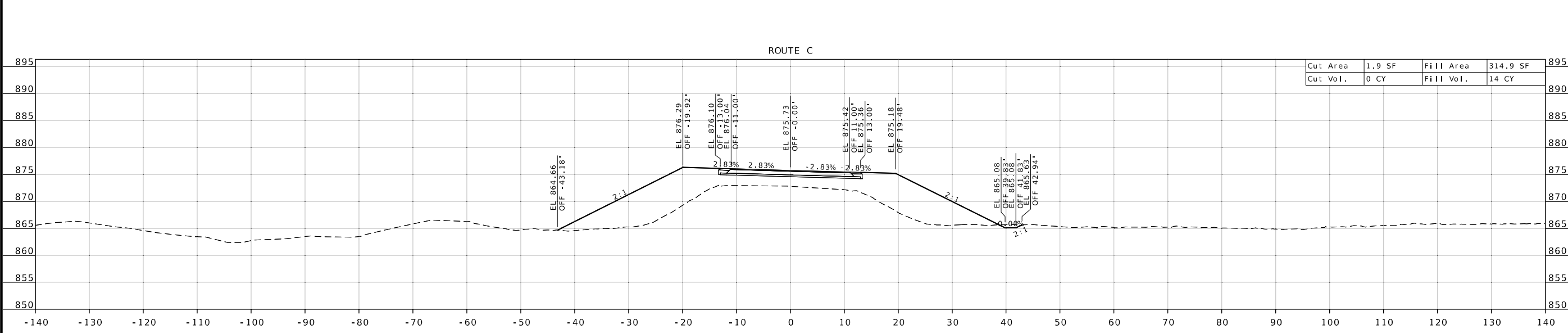

STA A 12+00.00

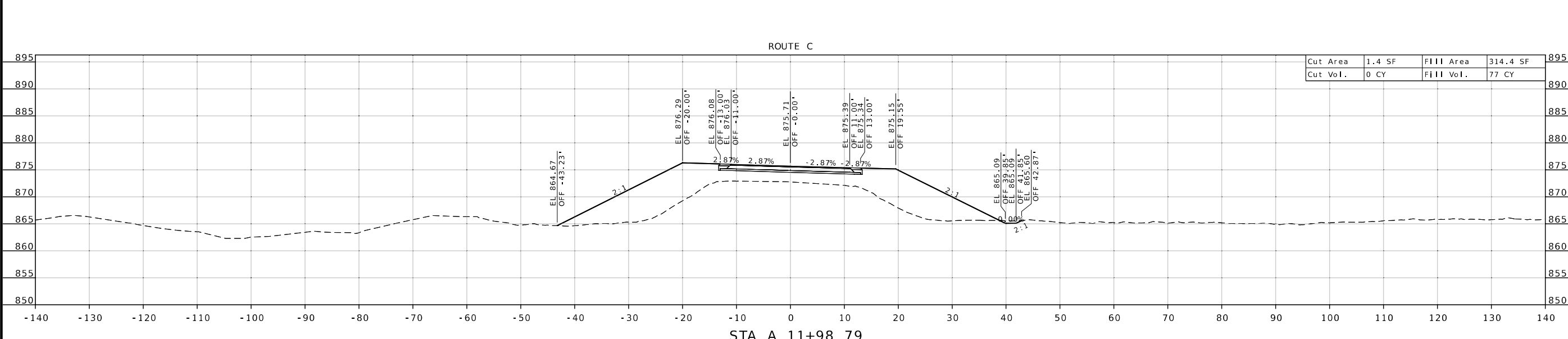

STA A 11+98.79

DESCRIPTION

DATE

MISSOURI HIGHWAYS AND TRANSPORTATION COMMISSION

105 WEST CAPITOL
JEFFERSON CITY, MO 65102
1-888-ASK-MODOT (1-888-275-6636)



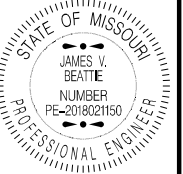

THIS SHEET HAS BEEN
SIGNED, SEALED AND DATED
ELECTRONICALLY.

DATE PREPARED
11/7/2024

ROUTE	STATE
C	MO
DISTRICT	SHEET NO.
CD	6
COUNTY	
WASHINGTON	
JOB NO.	
J553506	
CONTRACT ID.	
PROJECT NO.	
BRIDGE NO.	

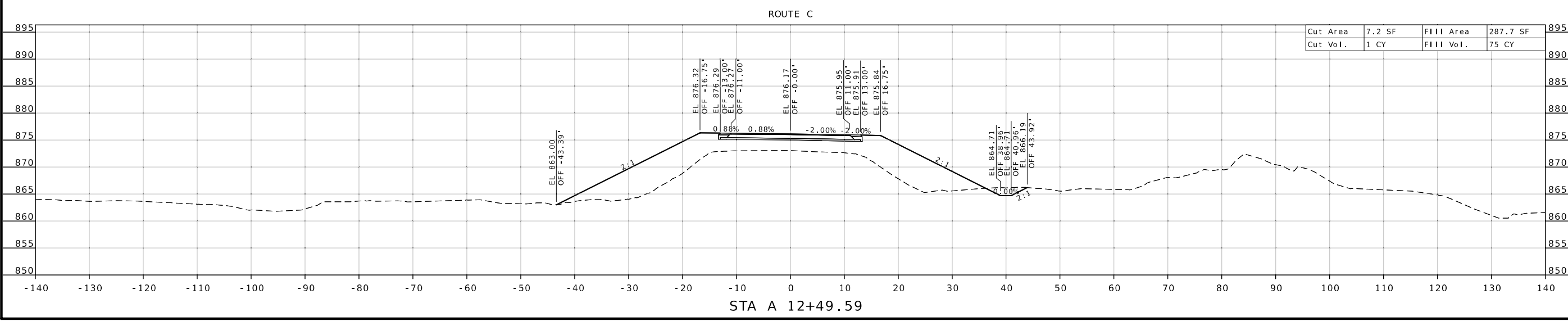
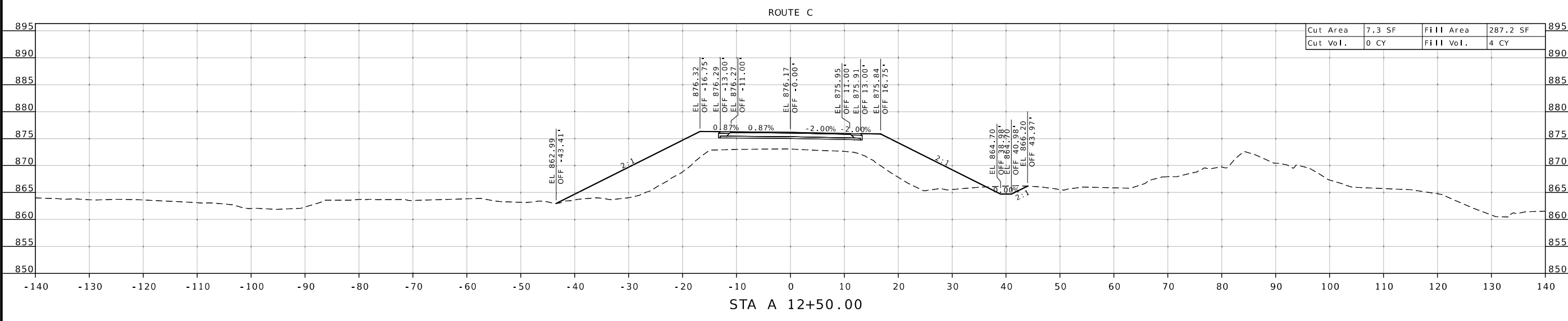

DATE	DESCRIPTION

MISSOURI HIGHWAYS AND TRANSPORTATION
COMMISSION

105 WEST CAPITOL
 JEFFERSON CITY, MO 65102
 1-888-ASK-MODOT (1-888-275-6636)

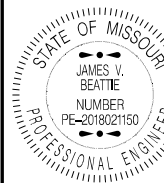

THIS SHEET HAS BEEN SIGNED, SEALED AND DATED ELECTRONICALLY.

DATE PREPARED
11/7/2024

ROUTE STATE
C MO

DISTRICT SHEET NO.
CD 7

COUNTY
WASHINGTON

JOB NO.
J553506

CONTRACT ID.

PROJECT NO.

BRIDGE NO.

BRIDGE SPILL FILL
CUT = 0 CY
FILL = 123 CY

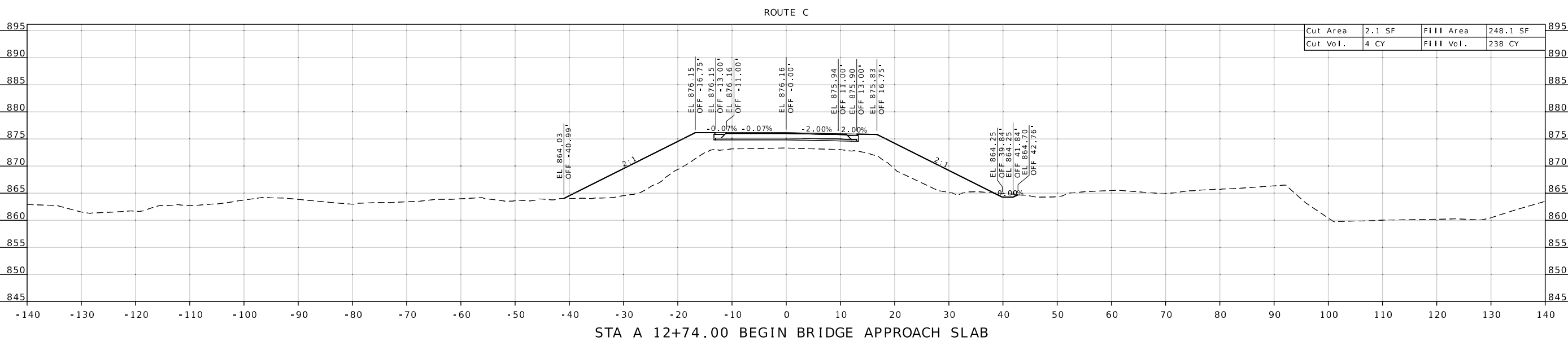
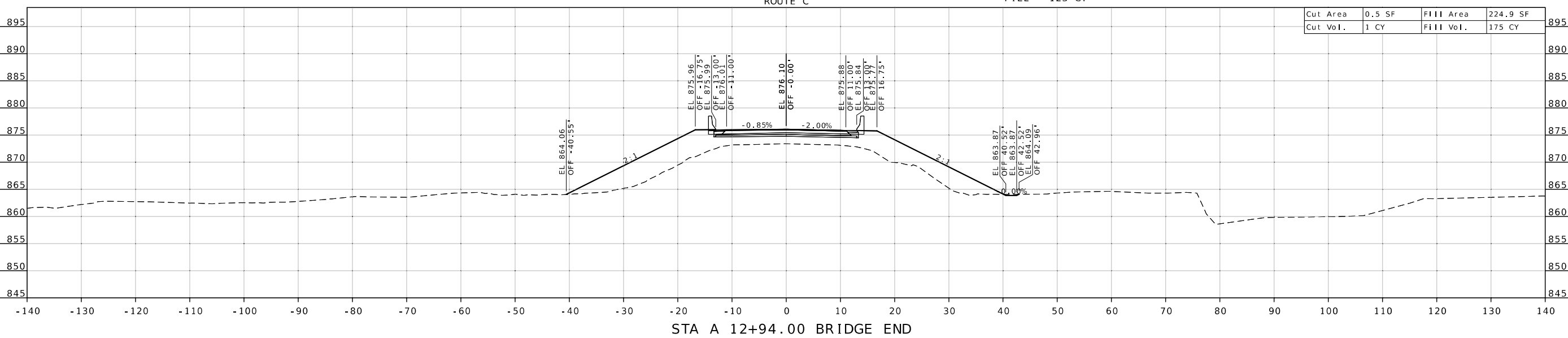

DESCRIPTION
DATE
MISSOURI HIGHWAYS AND TRANSPORTATION COMMISSION



105 WEST CAPITOL
JEFFERSON CITY, MO 65102
1-888-ASK-MODOT (1-888-275-6636)



THIS SHEET HAS BEEN
SIGNED, SEALED AND DATED
ELECTRONICALLY.

DATE PREPARED
11/7/2024

ROUTE STATE
C MO

DISTRICT SHEET NO.
CD 8

COUNTY
WASHINGTON

JOB NO.
J5S3506

CONTRACT ID.

PROJECT NO.

BRIDGE NO.

DESCRIPTION

DATE

MISSOURI HIGHWAYS AND TRANSPORTATION
COMMISSION

105 WEST CAPITOL
JEFFERSON CITY, MO 65102
1-888-ASK-MODOT (1-888-275-6636)

MoDOT

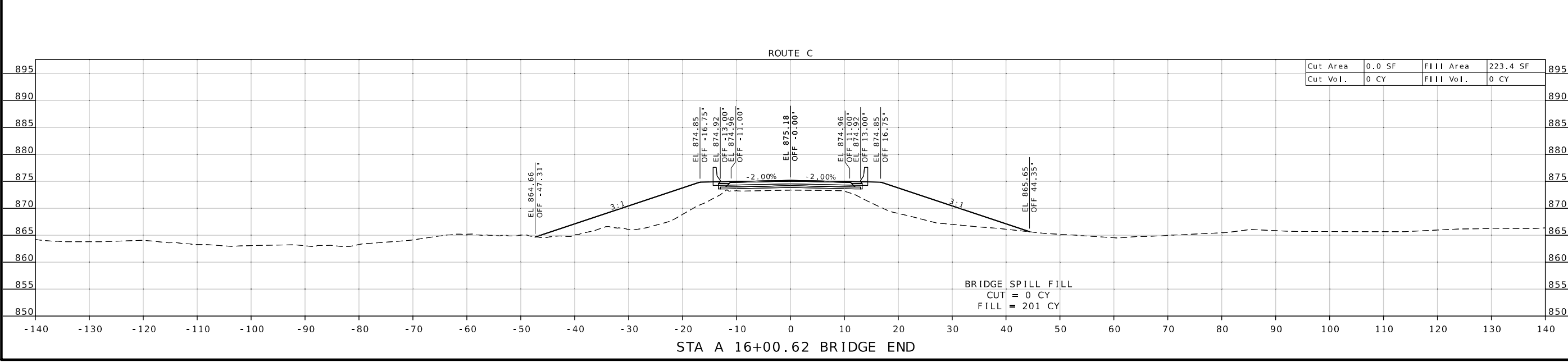
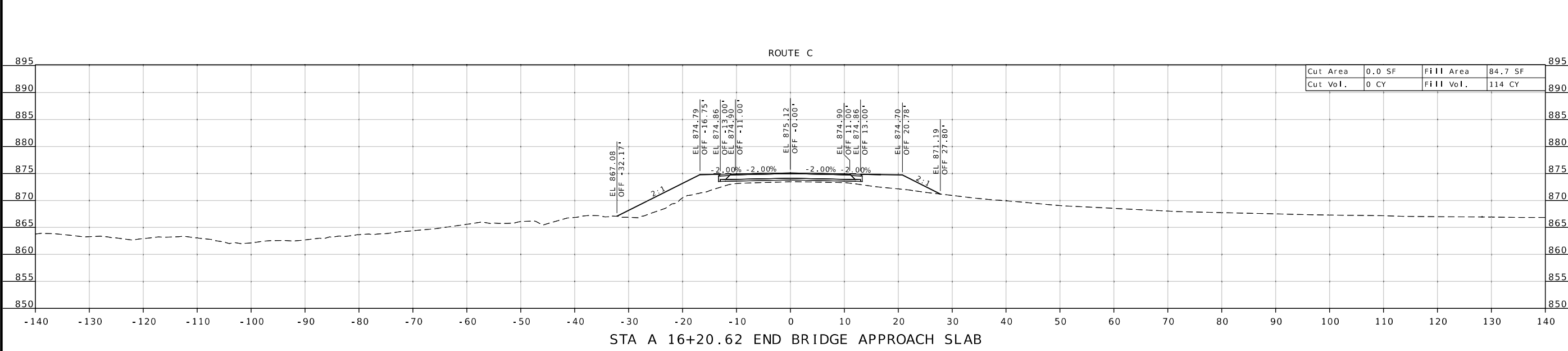
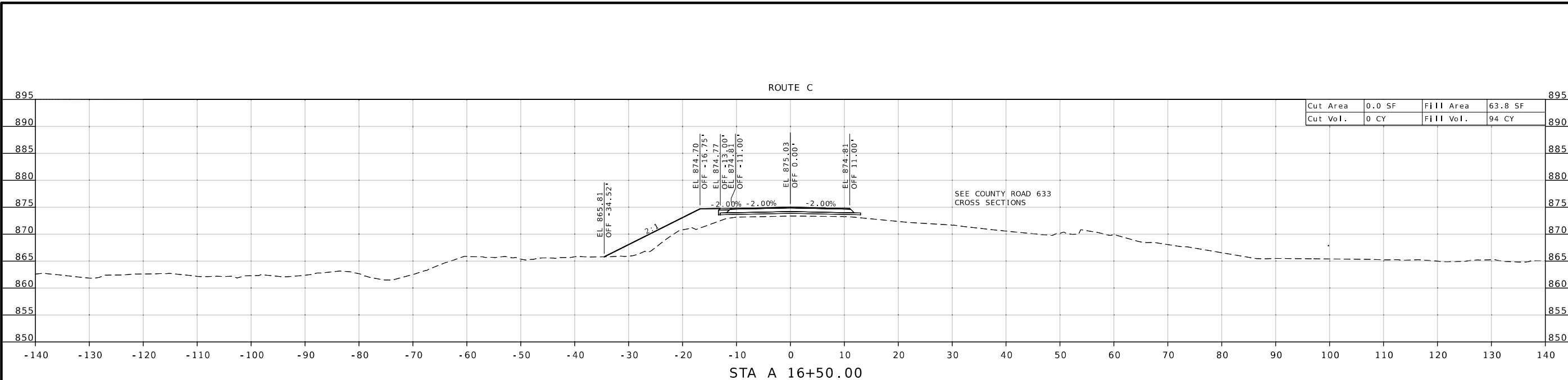

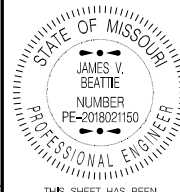

THIS SHEET HAS BEEN SIGNED, SEALED AND DATED ELECTRONICALLY.

DATE PREPARED 11/7/2024

ROUTE C STATE MO

DISTRICT CD SHEET NO. 9

COUNTY WASHINGTON

JOB NO. J5S3506

CONTRACT ID.

PROJECT NO.

BRIDGE NO.

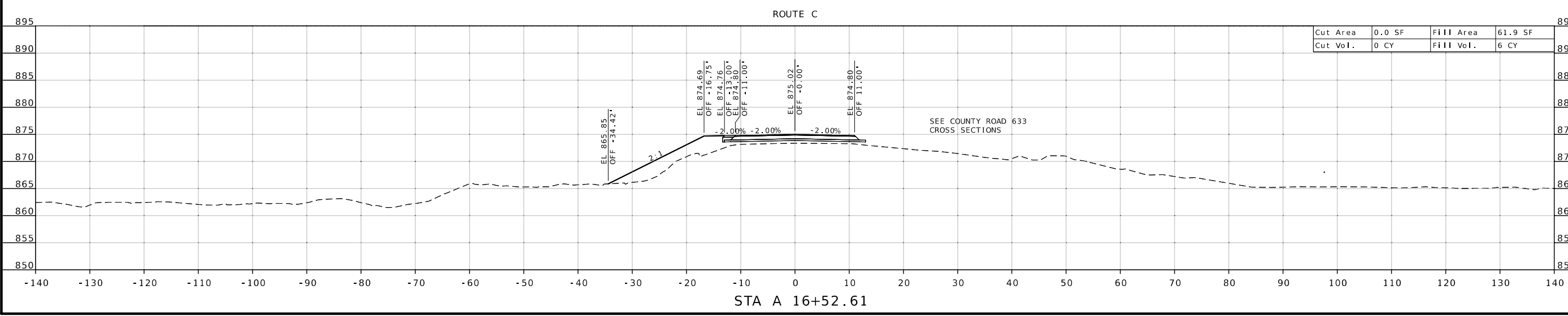
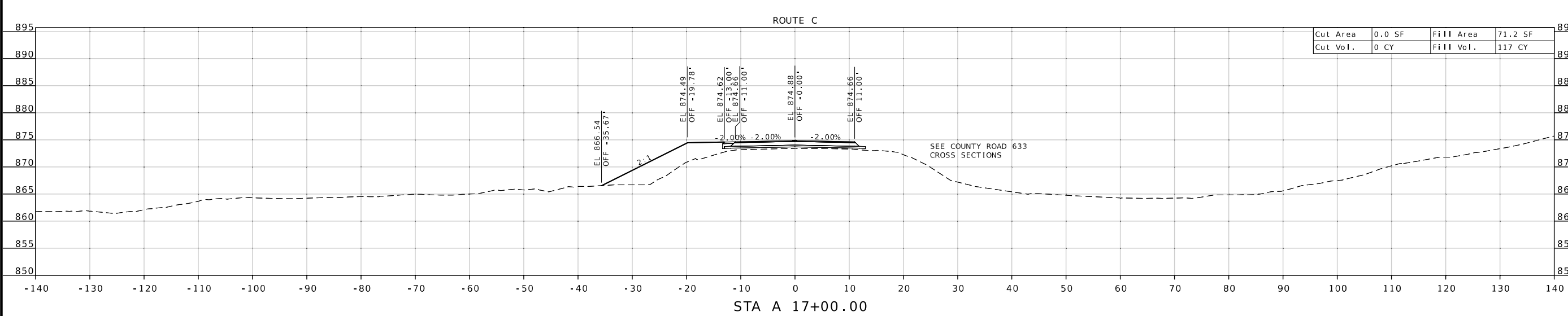
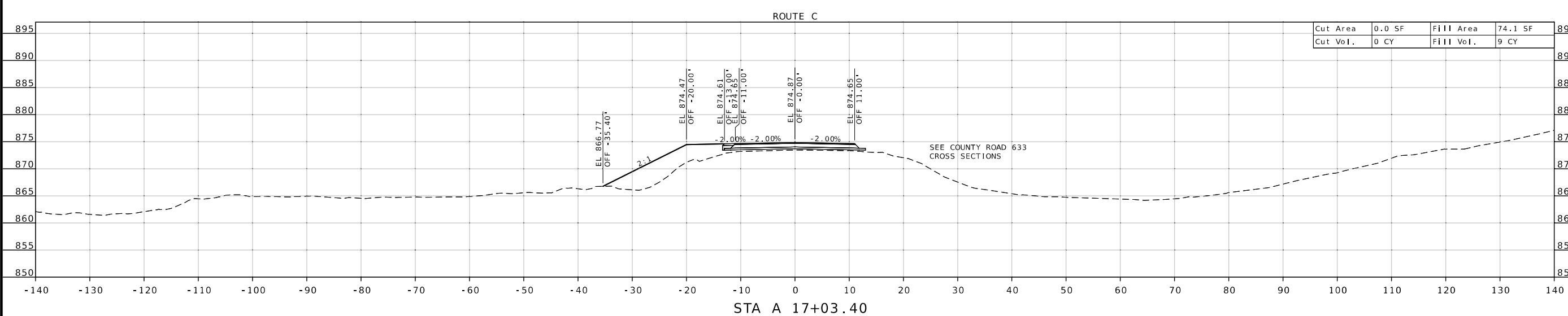

DESCRIPTION	DATE

MISSOURI HIGHWAYS AND TRANSPORTATION COMMISSION

105 WEST CAPITOL JEFFERSON CITY, MO 65102
1-888-ASK-MODOT (1-888-275-6636)

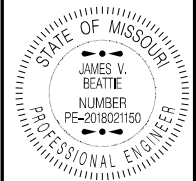

THIS SHEET HAS BEEN SIGNED, SEALED AND DATED ELECTRONICALLY.

DATE PREPARED 11/7/2024	
ROUTE C	STATE MO
DISTRICT CD	SHEET NO. 10
COUNTY WASHINGTON	
JOB NO. J553506	
CONTRACT ID.	
PROJECT NO.	
BRIDGE NO.	

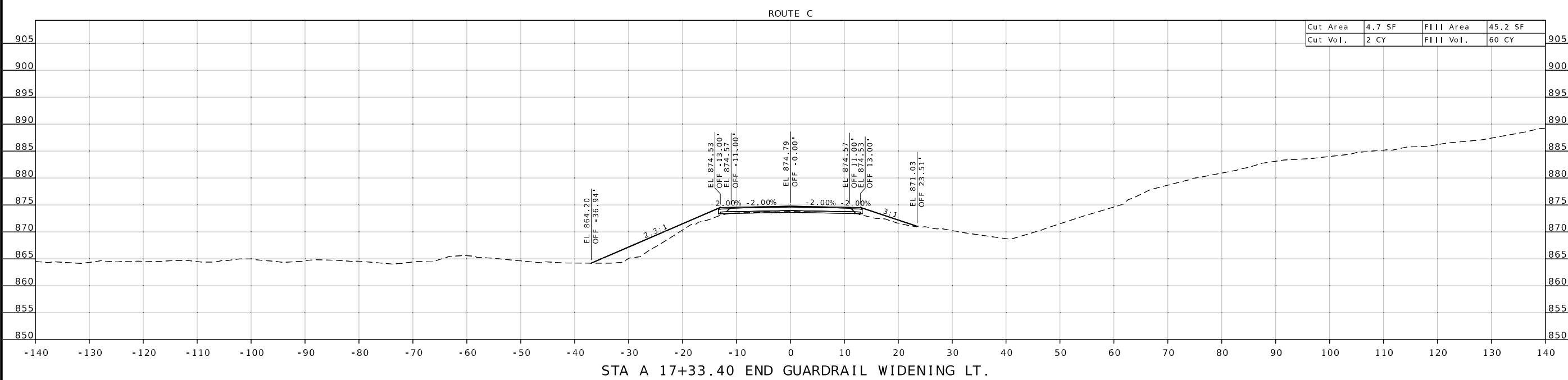
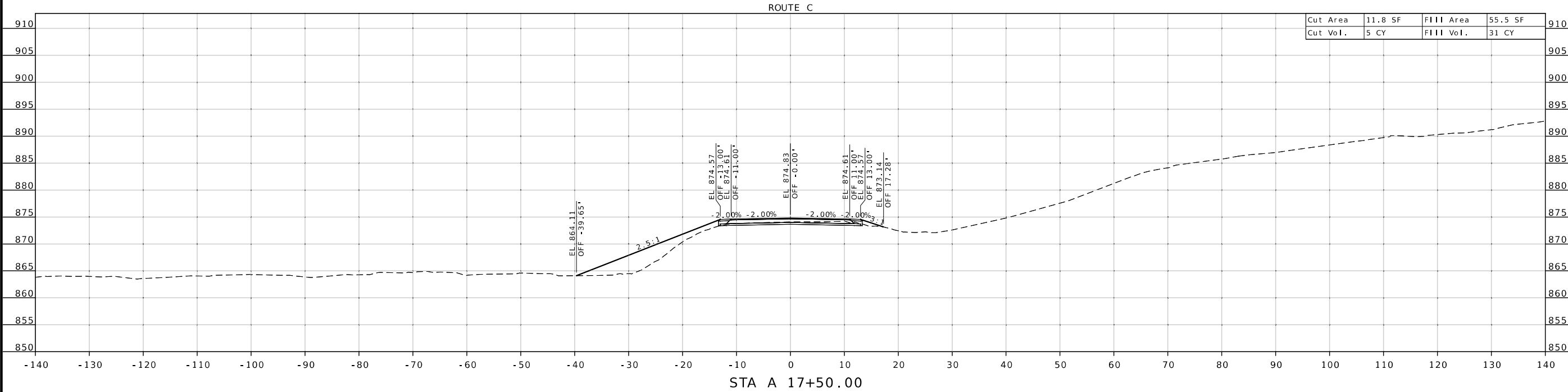

DESCRIPTION	DATE

MISSOURI HIGHWAYS AND TRANSPORTATION COMMISSION
 105 WEST CAPITOL JEFFERSON CITY, MO 65102
 1-888-ASK-MODOT (1-888-275-6636)



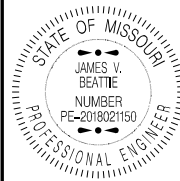

THIS SHEET HAS BEEN SIGNED, SEALED AND DATED ELECTRONICALLY.

DATE PREPARED
11/7/2024

ROUTE	STATE
C	MO
DISTRICT	SHEET NO.
CD	11

COUNTY
WASHINGTON

JOB NO.
J5S3506

CONTRACT ID.

PROJECT NO.

BRIDGE NO.

DESCRIPTION	DATE

MISSOURI HIGHWAYS AND TRANSPORTATION COMMISSION

105 WEST CAPITOL
JEFFERSON CITY, MO 65102
1-888-ASK-MODOT (1-888-275-6636)

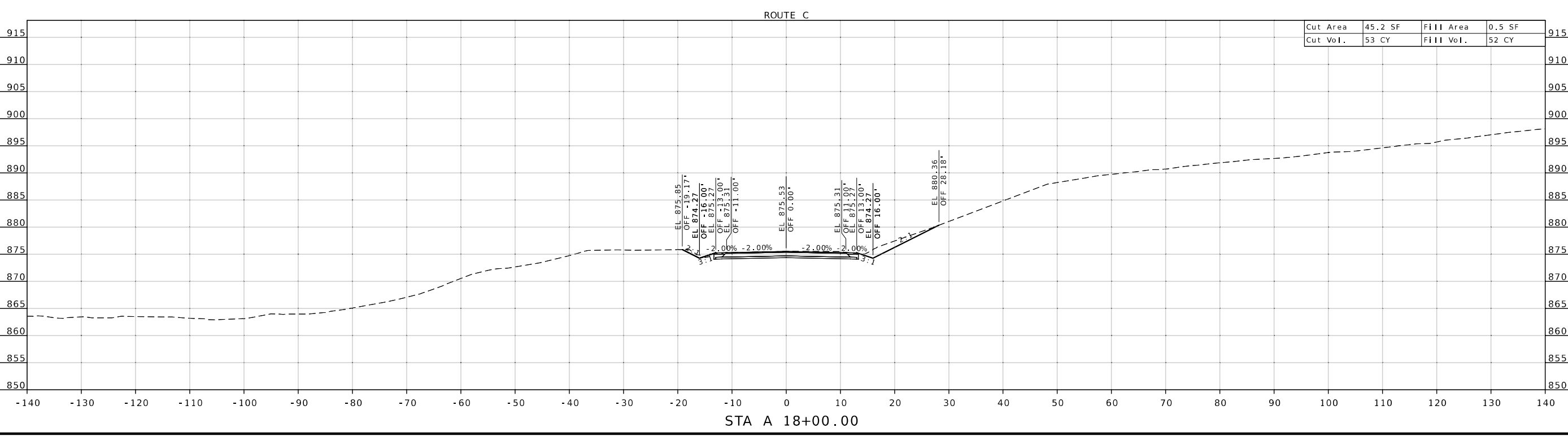
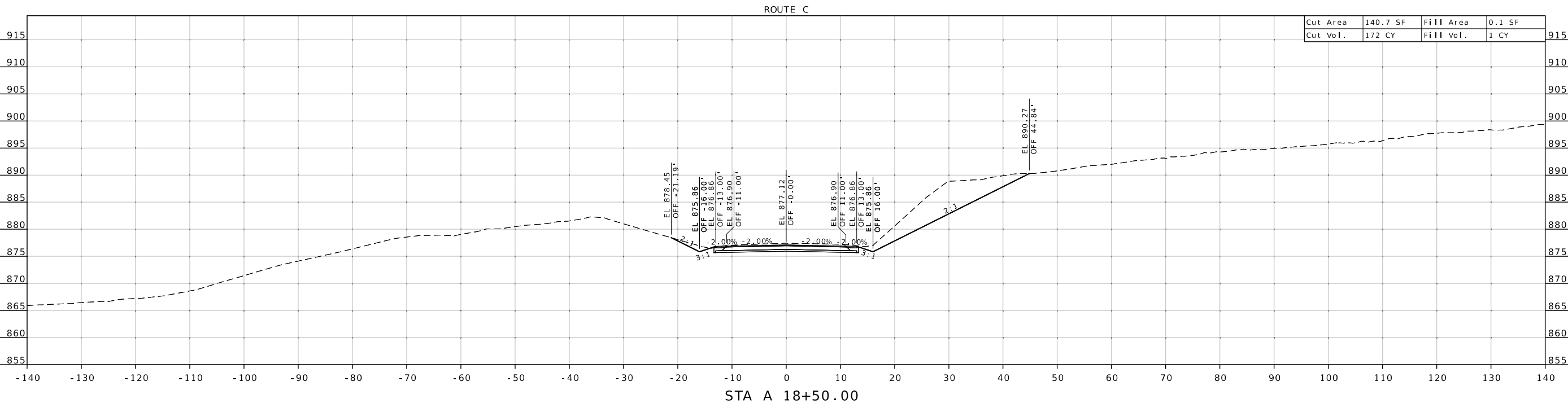

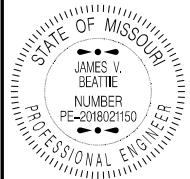

THIS SHEET HAS BEEN SIGNED, SEALED AND DATED ELECTRONICALLY.

DATE PREPARED 11/7/2024

ROUTE C STATE MO

DISTRICT CD SHEET NO. 12

COUNTY WASHINGTON

JOB NO. J553506

CONTRACT ID.

PROJECT NO.

BRIDGE NO.

DESCRIPTION

DATE

MISSOURI HIGHWAYS AND TRANSPORTATION COMMISSION

105 WEST CAPITOL JEFFERSON CITY, MO 65102

1-888-ASK-MODOT (1-888-275-6636)

MoDOT

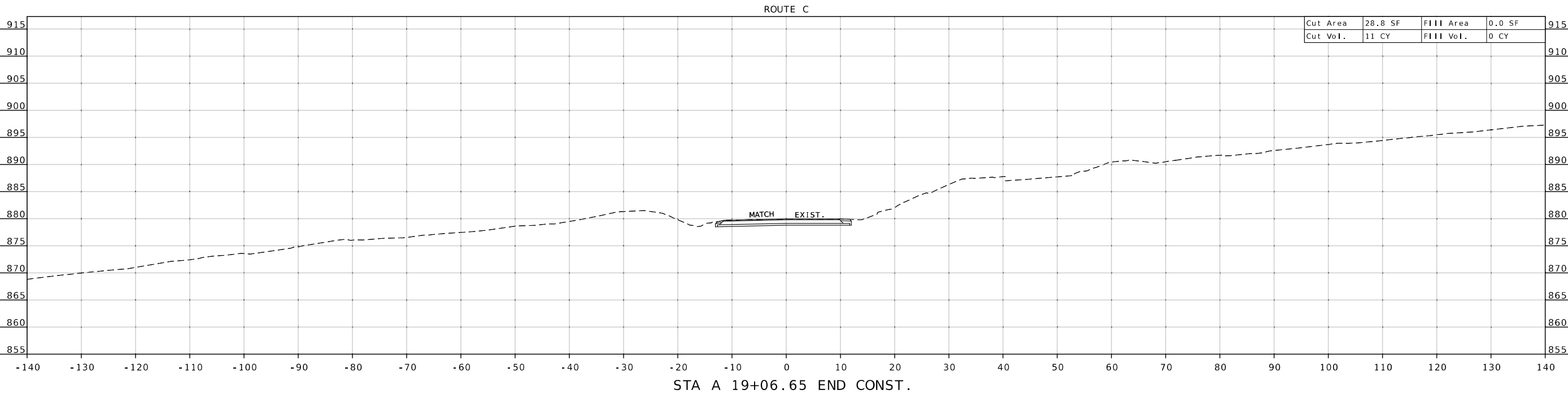

STA A 19+06.65 END CONST.

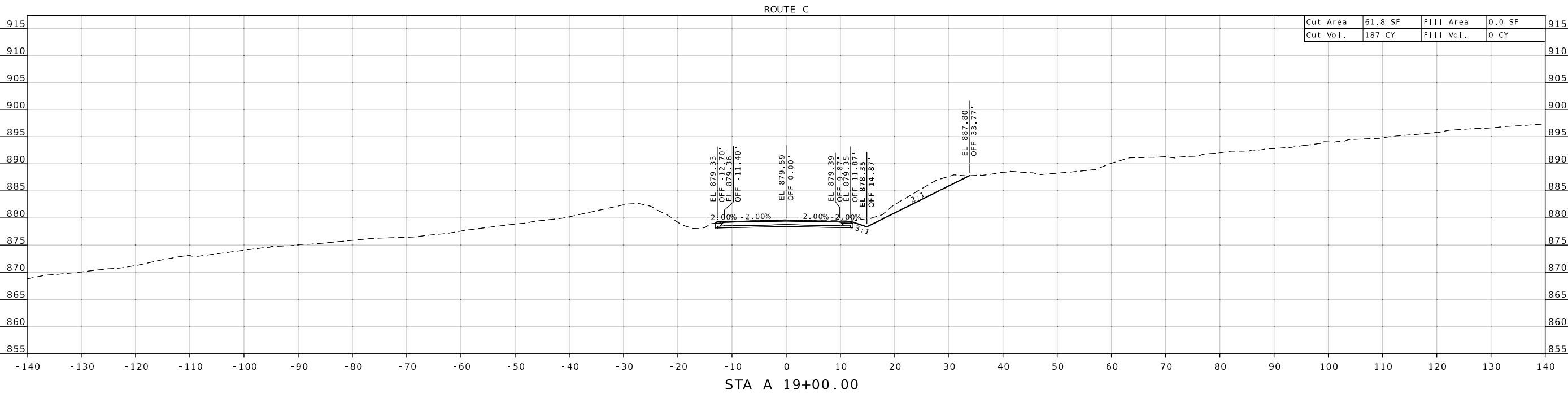

STA A 19+00.00



THIS SHEET HAS BEEN SIGNED SEALED AND DATED ELECTRONICALLY.

DATE PREPARED	
11/7/2024	
ROUTE	STATE
C	MO
DISTRICT	SHEET NO.
CD	13
COUNTY	
WASHINGTON	
JOB NO.	
J5S3506	
CONTRACT ID.	
PROJECT NO.	
BRIDGE NO.	

DATE	DESCRIPTION

MISSOURI HIGHWAYS AND TRANSPORTATION COMMISSION



105 WEST CAPITOL
JEFFERSON CITY, MO 65102
1-888-ASK-MODOT (1-888-275-6636)

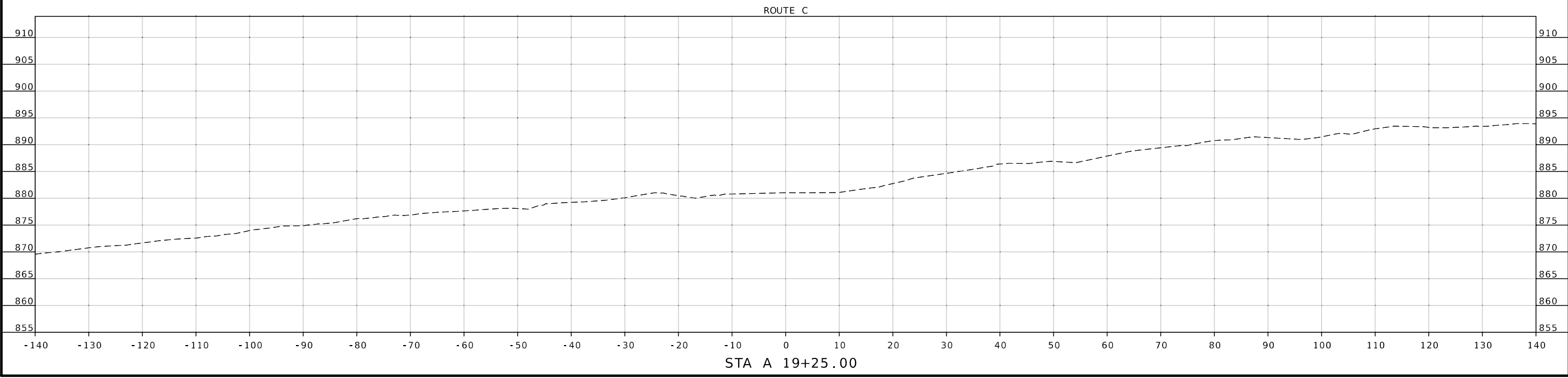

STA A 19+25.00

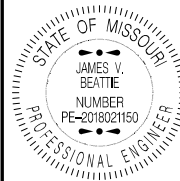

THIS SHEET HAS BEEN SIGNED, SEALED AND DATED ELECTRONICALLY.

DATE PREPARED 11/7/2024

ROUTE C STATE MO

DISTRICT CD SHEET NO. 14

COUNTY WASHINGTON

JOB NO. J553506

CONTRACT ID.

PROJECT NO.

BRIDGE NO.

DESCRIPTION	DATE

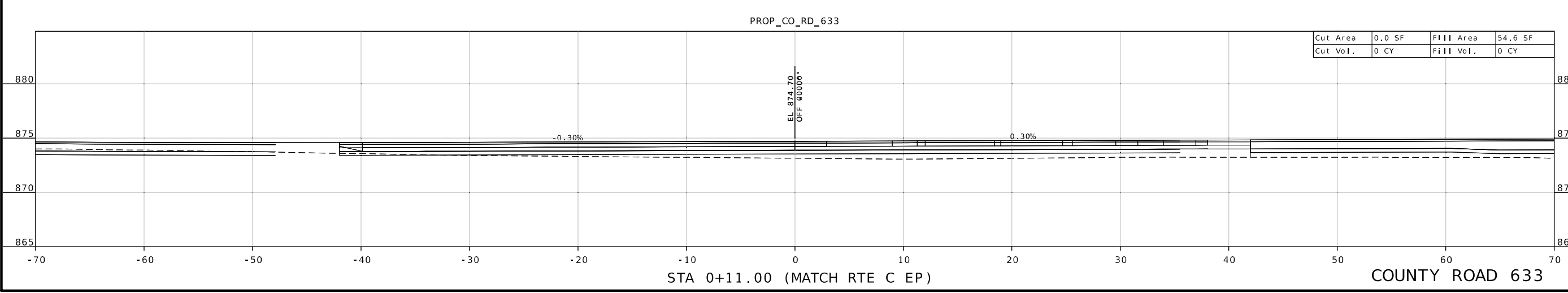
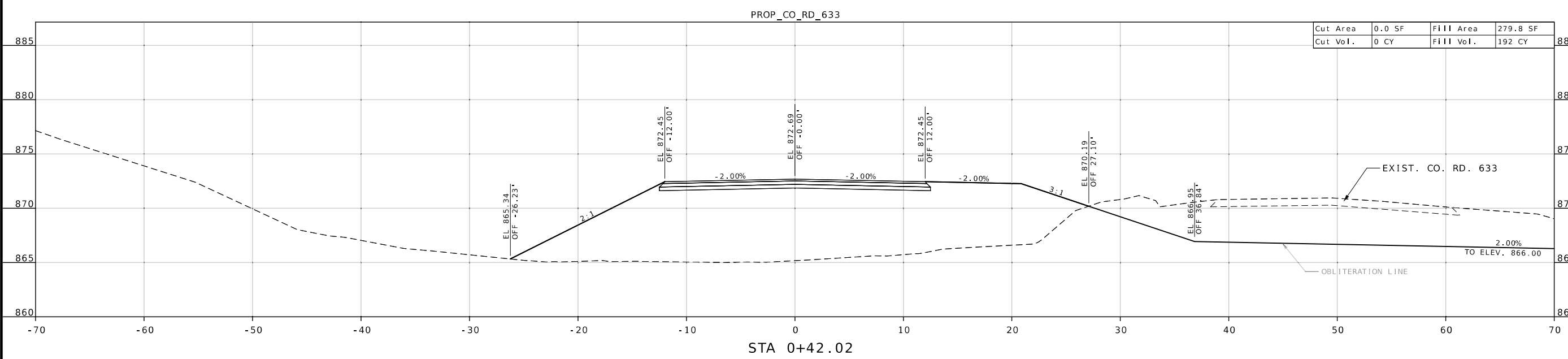

MISSOURI HIGHWAYS AND TRANSPORTATION COMMISSION

MoDOT

105 WEST CAPITOL
JEFFERSON CITY, MO 65102
1-888-ASK-MODOT (1-888-275-6636)

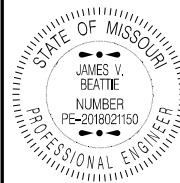

THIS SHEET HAS BEEN SIGNED, SEALED AND DATED ELECTRONICALLY.

DATE PREPARED 11/7/2024

ROUTE C STATE MO

DISTRICT CD SHEET NO. 15

COUNTY WASHINGTON

JOB NO. J5S3506

CONTRACT ID.

PROJECT NO.

BRIDGE NO.

DESCRIPTION

DATE

MISSOURI HIGHWAYS AND TRANSPORTATION COMMISSION

105 WEST CAPITOL

JEFFERSON CITY, MO 65102

1-888-ASK-MODOT (1-888-273-6636)

MoDOT

PROP_CO_RD_633

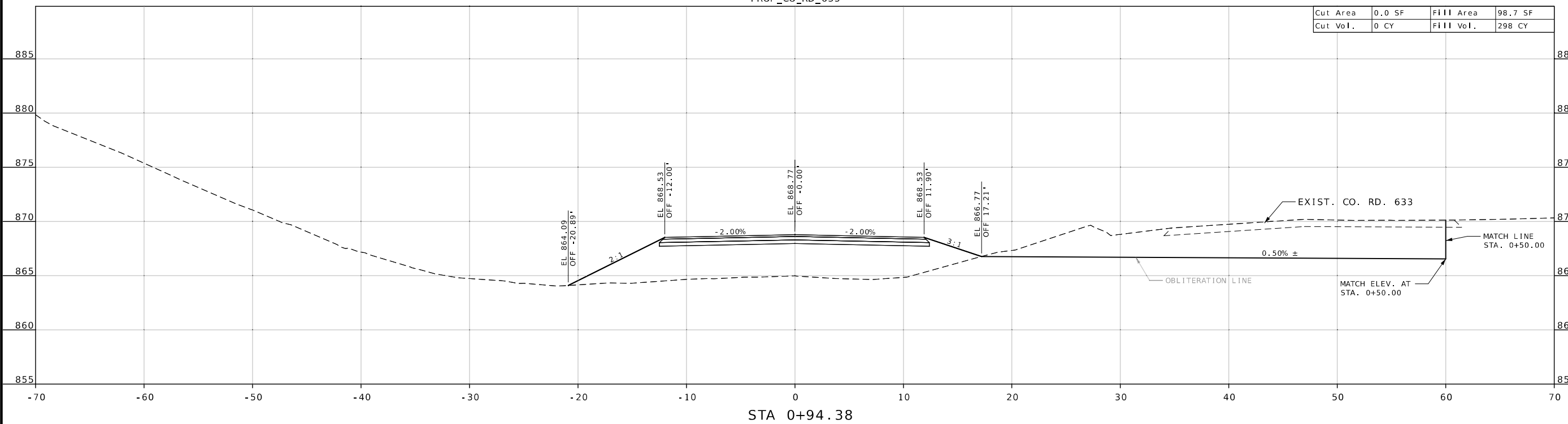

Cut Area	0.0 SF	Fill Area	98.7 SF
Cut Vol.	0 CY	Fill Vol.	298 CY

STA 0+94.38

PROP_CO_RD_633

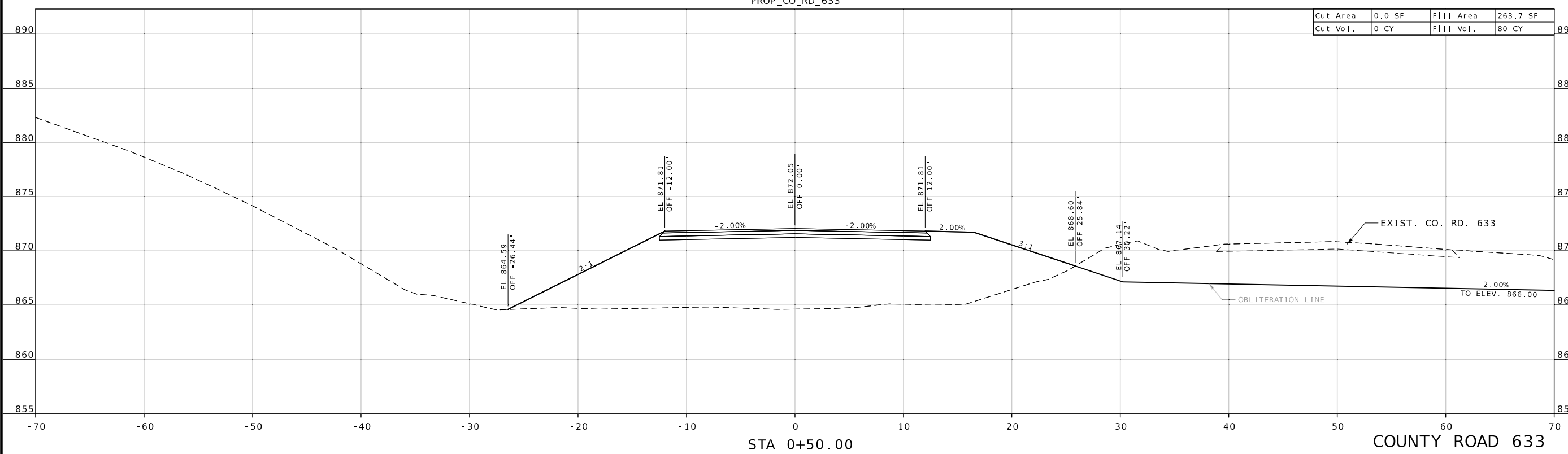

Cut Area	0.0 SF	Fill Area	263.7 SF
Cut Vol.	0 CY	Fill Vol.	80 CY

STA 0+50.00

COUNTY ROAD 633

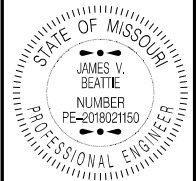

THIS SHEET HAS BEEN
SIGNED SEALED AND DATED
ELECTRONICALLY.

DATE PREPARED	11/7/2024		
ROUTE	C	STATE	MO
DISTRICT	CD	SHEET NO.	16
COUNTY	WASHINGTON		
JOB NO.	J5S3506		
CONTRACT ID.			

PROJECT NO.	
BRIDGE NO.	

DESCRIPTION

MISSOURI HIGHWAYS AND TRANSPORTATION COMMISSION
105 WEST CAPITOL
JEFFERSON CITY, MO 65102
1-888-ASK-MODOT (1-888-275-6636)

PROP_CO_RD_633

Cut Area	6.3 SF	Fill Area	6.0 SF
Cut Vol.	4 CY	Fill Vol.	50 CY

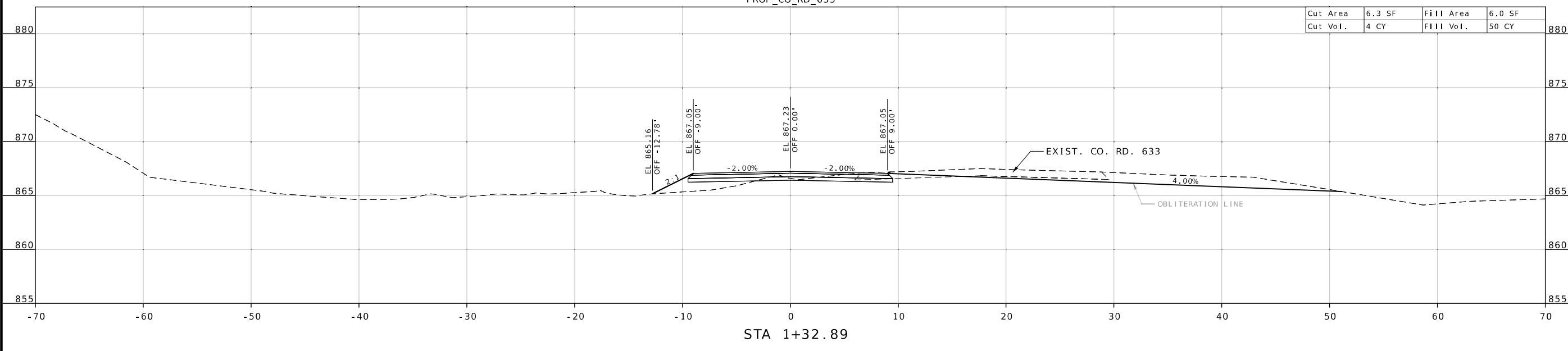

PROP_CO_RD_633

Cut Area	0.0 SF	Fill Area	75.3 SF
Cut Vol.	0 CY	Fill Vol.	18 CY

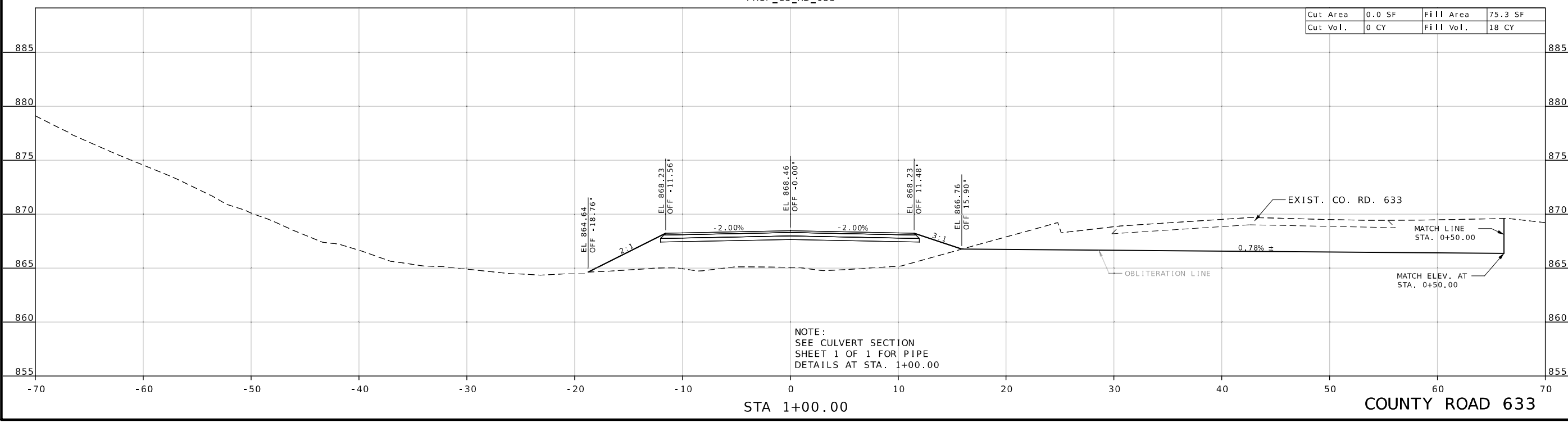

NOTE:
SEE CULVERT SECTION
SHEET 1 OF 1 FOR PIPE
DETAILS AT STA. 1+00.00

STA 1+00.00

COUNTY ROAD 633

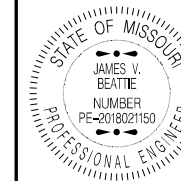

THIS SHEET HAS BEEN SIGNED, SEALED AND DATED ELECTRONICALLY.

DATE PREPARED
11/7/2024

ROUTE	STATE
C	MO

DISTRICT	SHEET NO.
CD	17

COUNTY
WASHINGTON

JOB NO.
J5S3506

CONTRACT ID.

PROJECT NO.

BRIDGE NO.

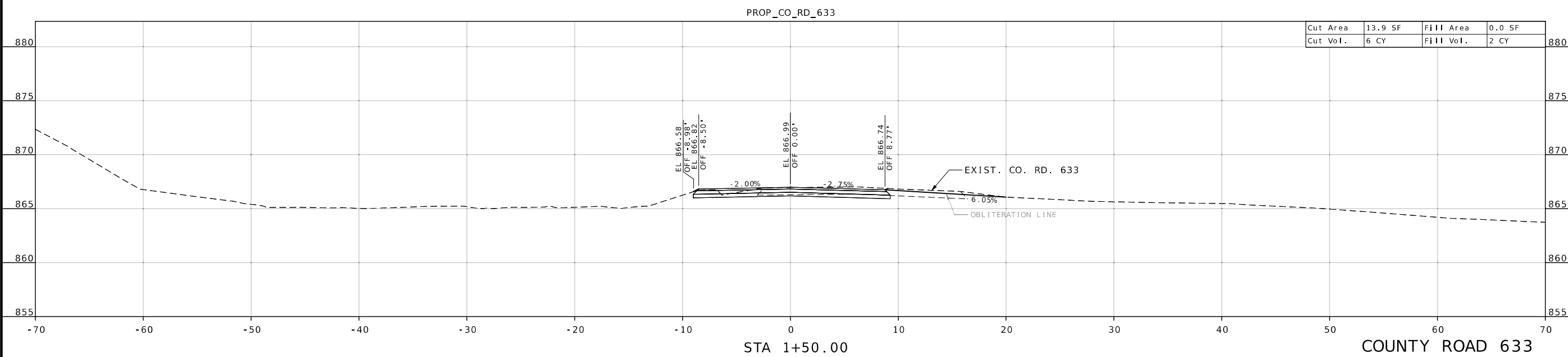
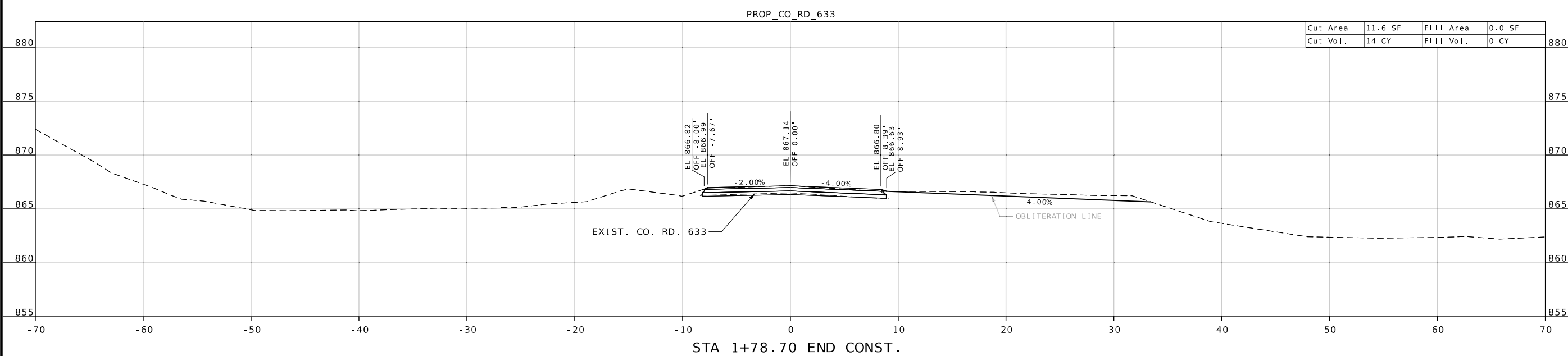

COUNTY ROAD 633

MISSOURI HIGHWAYS AND TRANSPORTATION COMMISSION

MoDOT

105 WEST CAPITOL
JEFFERSON CITY, MO 65102
1-888-ASK-MODOT (1-888-275-6636)

DESCRIPTION	DATE

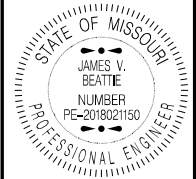

THIS SHEET HAS BEEN
SIGNED, SEALED AND DATED
ELECTRONICALLY.

DATE PREPARED
12/17/2024

ROUTE STATE
C MO

DISTRICT SHEET NO.
CD 18

COUNTY
WASHINGTON

JOB NO.
J5S3506

CONTRACT ID.

PROJECT NO.

BRIDGE NO.

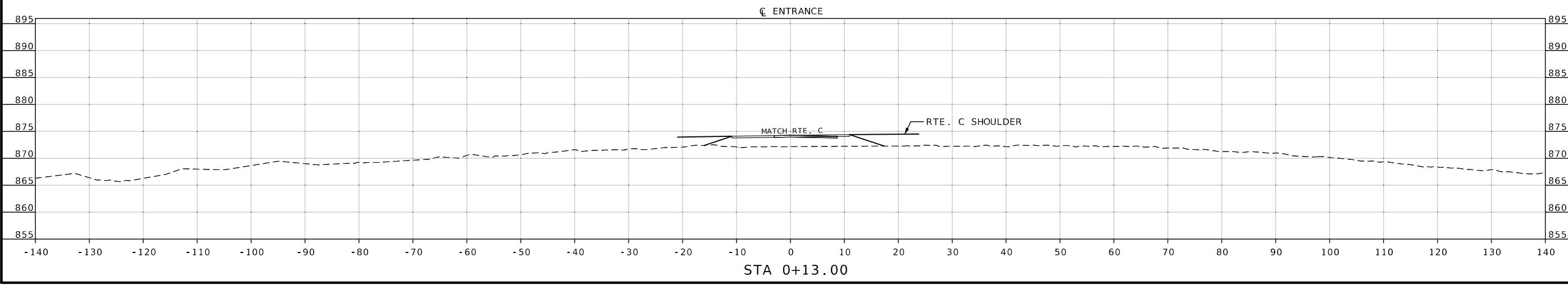
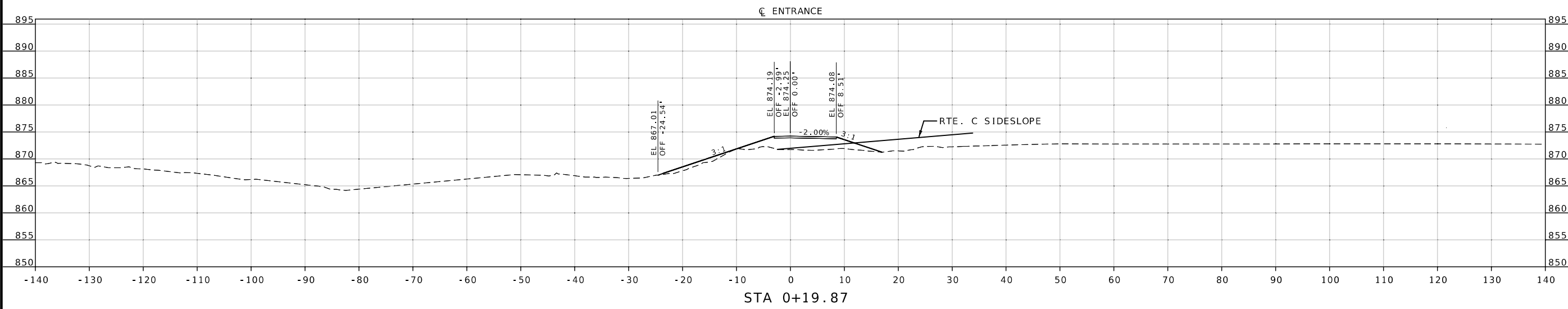
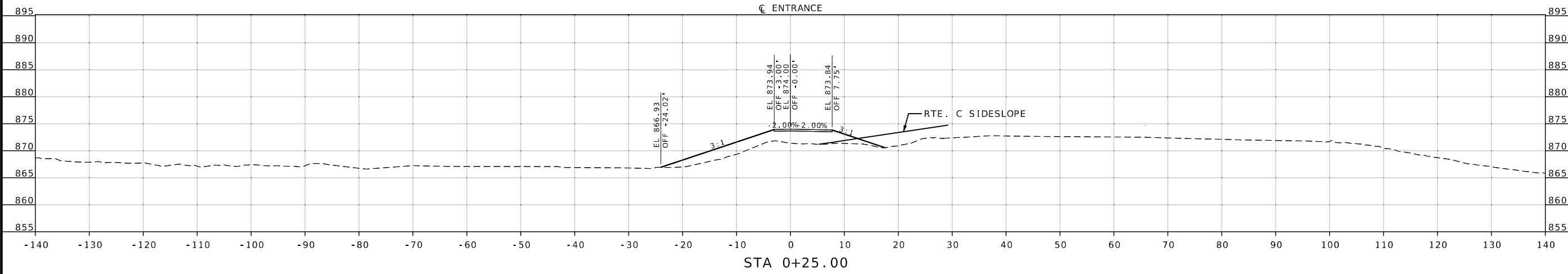

DESCRIPTION	DATE

MISSOURI HIGHWAYS AND TRANSPORTATION
COMMISSION

MoDOT

105 WEST CAPITOL
JEFFERSON CITY, MO 65102
1-888-ASK-MODOT (1-888-275-6636)

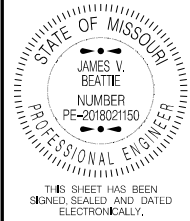

THIS SHEET HAS BEEN SIGNED SEALED AND DATED ELECTRONICALLY.

DATE PREPARED
11/13/2024

ROUTE STATE
C MO

DISTRICT SHEET NO.
CD 19

COUNTY
WASHINGTON

JOB NO.
J5S3506

CONTRACT ID.

PROJECT NO.

BRIDGE NO.

DESCRIPTION

DATE

MISSOURI HIGHWAYS AND TRANSPORTATION COMMISSION

105 WEST CAPITOL JEFFERSON CITY, MO 65102
1-888-ASK-MODOT (1-888-275-6636)

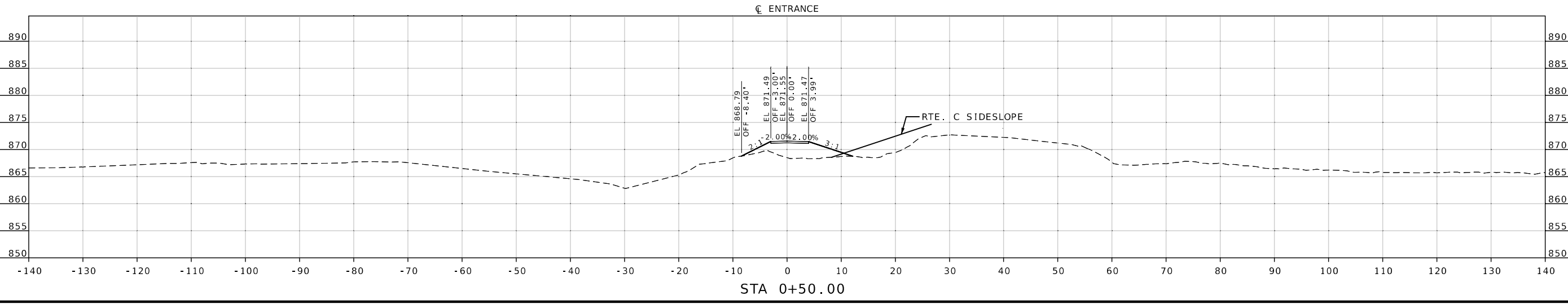
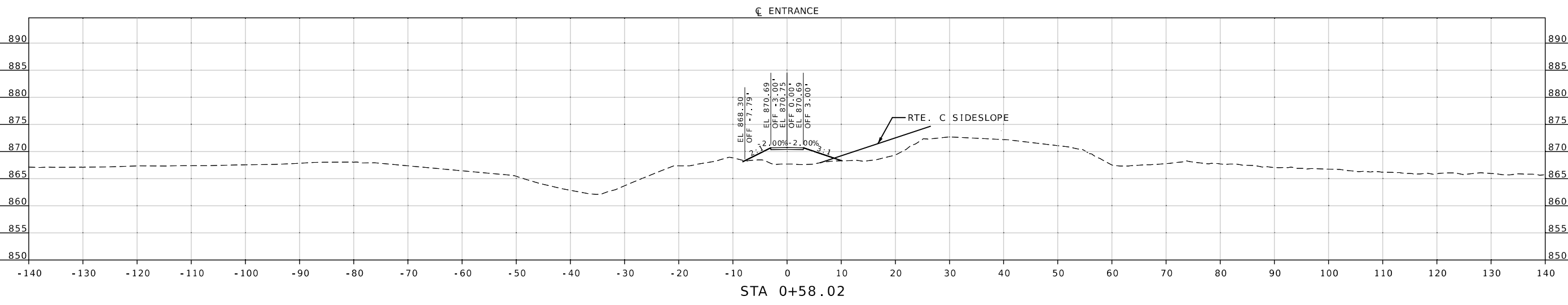
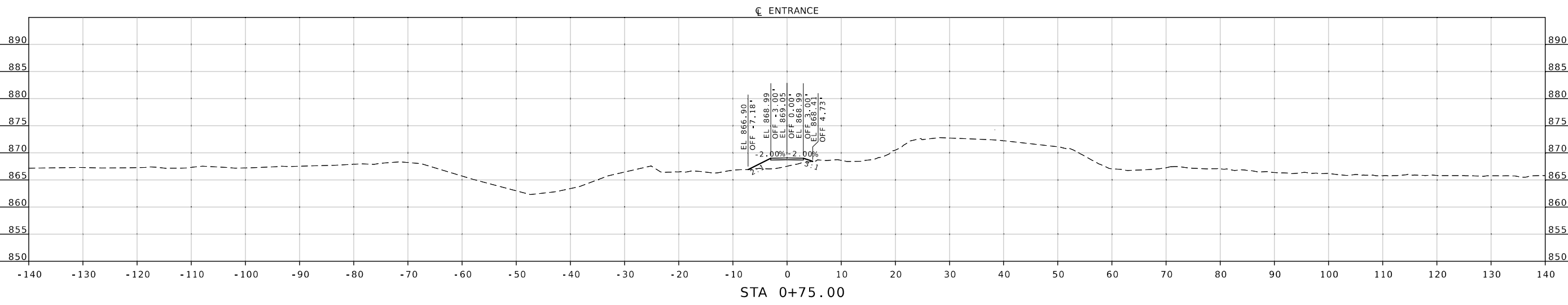

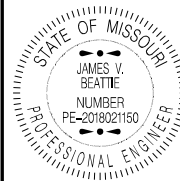

THIS SHEET HAS BEEN
SIGNED SEALED AND DATED
ELECTRONICALLY.

DATE PREPARED
11/13/2024

ROUTE STATE
C MO

DISTRICT SHEET NO.
CD 20

COUNTY
WASHINGTON

JOB NO.
J5S3506

CONTRACT ID.

PROJECT NO.

BRIDGE NO.

DATE	DESCRIPTION

MISSOURI HIGHWAYS AND TRANSPORTATION
COMMISSION

105 WEST CAPITOL
JEFFERSON CITY, MO 65102
1-888-ASK-MODOT (1-888-273-6636)