

DISCLAIMER
 THE PROFESSIONAL WHOSE SIGNATURE AND PERSONAL SEAL APPEAR HEREON ASSUMES RESPONSIBILITY ONLY FOR WHAT APPEARS ON THIS PAGE, AND DISCLAIMS (PURSUANT TO SECTION 327.411 RSMO) SPECIFICATION, ESTIMATES, REPORTS, OR OTHER DOCUMENTS OR INSTRUMENTS NOT SEALED BY THE UNDERSIGNED PROFESSIONAL RELATING TO OR INTENDED TO BE USED FOR ANY PART OR PARTS OF THE PROJECT TO WHICH THIS PAGE REFERS.

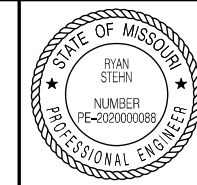

THIS SHEET HAS BEEN SIGNED, SEALED AND DATED ELECTRONICALLY.

DATE PREPARED
 12/20/2024

ROUTE STATE
 CRD 127 MO

DISTRICT SHEET NO.
 SW 4

COUNTY
 GREENE

JOB NO.
 J8S3156

CONTRACT ID.

PROJECT NO.

BRIDGE NO.

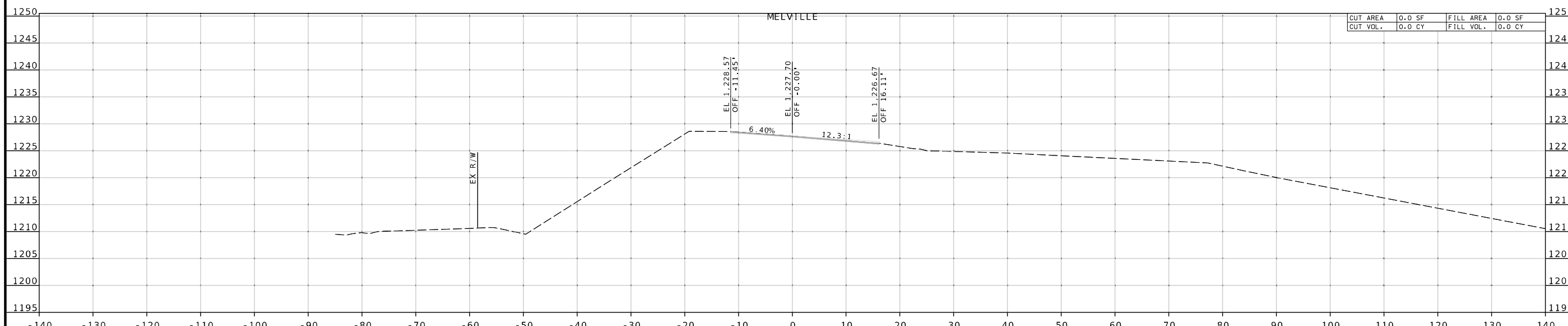
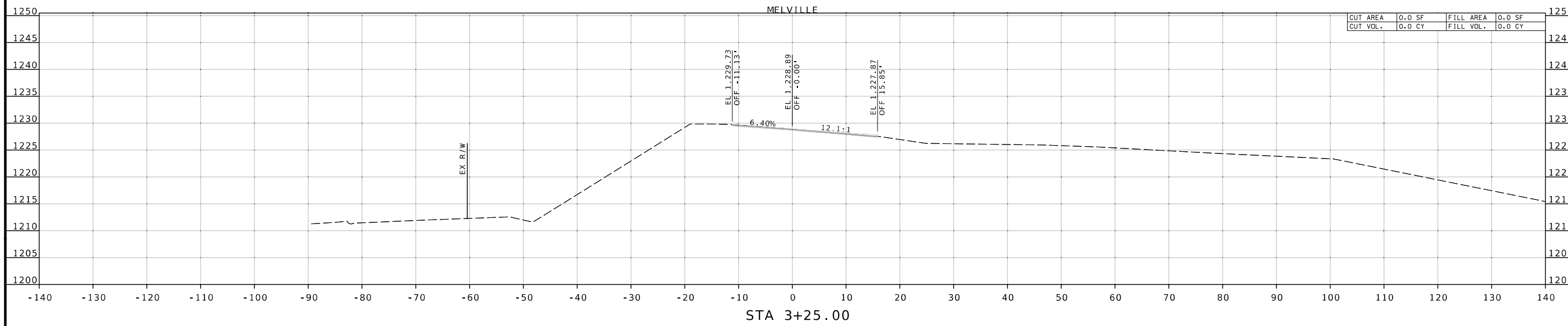

CUT AREA	FILL AREA
0.0 SF	0.0 SF
0.0 CY	0.0 CY

CUT AREA	FILL AREA
0.0 SF	0.0 SF
0.0 CY	0.0 CY

DESCRIPTION	DATE

MISSOURI HIGHWAYS AND TRANSPORTATION COMMISSION
 MoDOT
 105 WEST CAPITOL JEFFERSON CITY, MO 65102
 1-888-ASK-MODOT (1-888-278-6636)

CMT
 © Copyright CMT, Inc.
 CRAWFORD, MURPHY & TILLY, INC.
 631 WEST ELINDALE STREET
 SPRINGFIELD, MO 65807 (417) 869-6009
 ENGINEERING CORPORATION - 000631

CROSS SECTIONS
 CRD 127 (MELVILLE RD.)

IF A SEAL IS PRESENT ON THIS SHEET IT HAS BEEN ELECTRONICALLY SEALED AND DATED.

DISCLAIMER
 THE PROFESSIONAL WHOSE SIGNATURE AND PERSONAL SEAL APPEAR HEREON ASSUMES RESPONSIBILITY ONLY FOR WHAT APPEARS ON THIS PAGE, AND DISCLAIMS (PURSUANT TO SECTION 327.411 RSMO) SPECIFICATION, ESTIMATES, REPORTS, OR OTHER DOCUMENTS OR INSTRUMENTS NOT SEALED BY THE UNDERSIGNED PROFESSIONAL RELATING TO OR INTENDED TO BE USED FOR ANY PART OR PARTS OF THE PROJECT TO WHICH THIS PAGE REFERS.

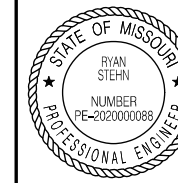

THIS SHEET HAS BEEN SIGNED, SEALED AND DATED ELECTRONICALLY.

DATE PREPARED
 12/20/2024

ROUTE STATE
 CRD 127 MO

DISTRICT SHEET NO.
 SW 15

COUNTY
 GREENE

JOB NO.
 J8S3156

CONTRACT ID.

PROJECT NO.

BRIDGE NO.

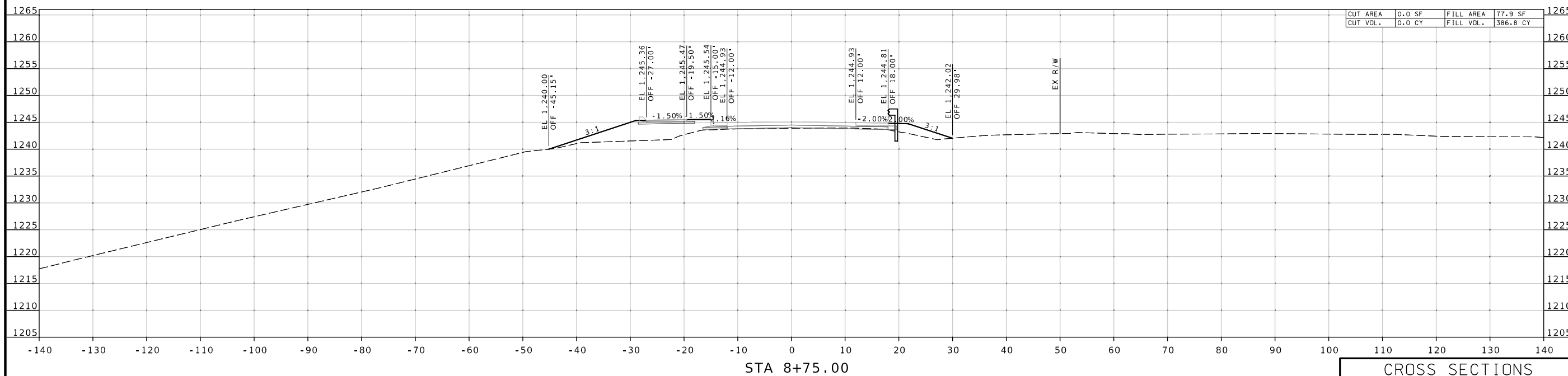
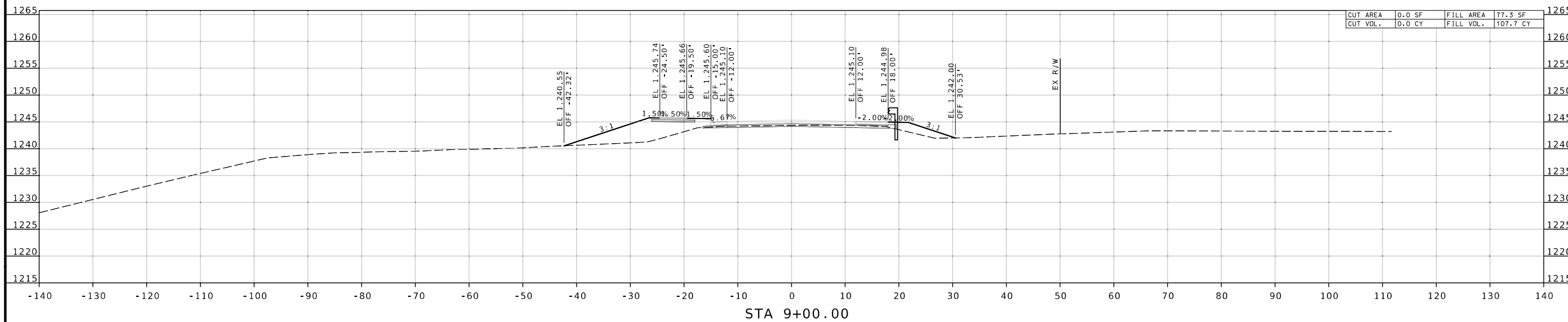

CROSS SECTIONS
 CRD 127 (MELVILLE RD.)

DATE	DESCRIPTION

MISSOURI HIGHWAYS AND TRANSPORTATION COMMISSION
 105 WEST CAPITOL JEFFERSON CITY, MO 65102
 1-888-ASK-MODOT (1-888-278-6636)

CMT
 © Copyright CMT, Inc.
 CRAWFORD, MURPHY & TILLY, INC.
 631 WEST ELINDALE STREET
 SPRINGFIELD, MO 65807 (417) 869-6009
 ENGINEERING CORPORATION - 000631

IF A SEAL IS PRESENT ON THIS SHEET IT HAS BEEN ELECTRONICALLY SEALED AND DATED.

DISCLAIMER
 THE PROFESSIONAL WHOSE SIGNATURE AND PERSONAL SEAL APPEAR HEREON ASSUMES RESPONSIBILITY ONLY FOR WHAT APPEARS ON THIS PAGE, AND DISCLAIMS (PURSUANT TO SECTION 327.411 RSMO) SPECIFICATION, ESTIMATES, REPORTS, OR OTHER DOCUMENTS OR INSTRUMENTS NOT SEALED BY THE UNDERSIGNED PROFESSIONAL RELATING TO OR INTENDED TO BE USED FOR ANY PART OR PARTS OF THE PROJECT TO WHICH THIS PAGE REFERS.

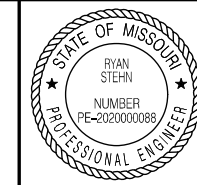

THIS SHEET HAS BEEN SIGNED, SEALED AND DATED ELECTRONICALLY.

DATE PREPARED
 12/20/2024

ROUTE STATE
 CRD 127 MO

DISTRICT SHEET NO.
 SW 17

COUNTY
 GREENE

JOB NO.
 J8S3156

CONTRACT ID.

PROJECT NO.

BRIDGE NO.

DESCRIPTION

DATE

MISSOURI HIGHWAYS AND TRANSPORTATION COMMISSION

105 WEST CAPITOL JEFFERSON CITY, MO 65102

1-888-ASK-MODOT (1-888-275-6636)

MoDOT

CMT

© Copyright CMT, Inc.

CRAWFORD, MURPHY & TILLY, INC.

631 WEST ELINDALE STREET SPRINGFIELD, MO 65807 (417) 869-6009

ENGINEERING CORPORATION - 000631

REV.

MELVILLE

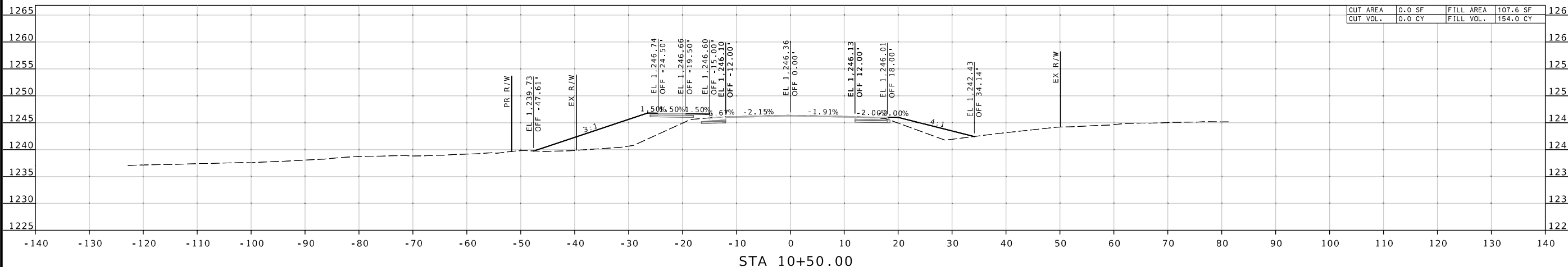

MELVILLE

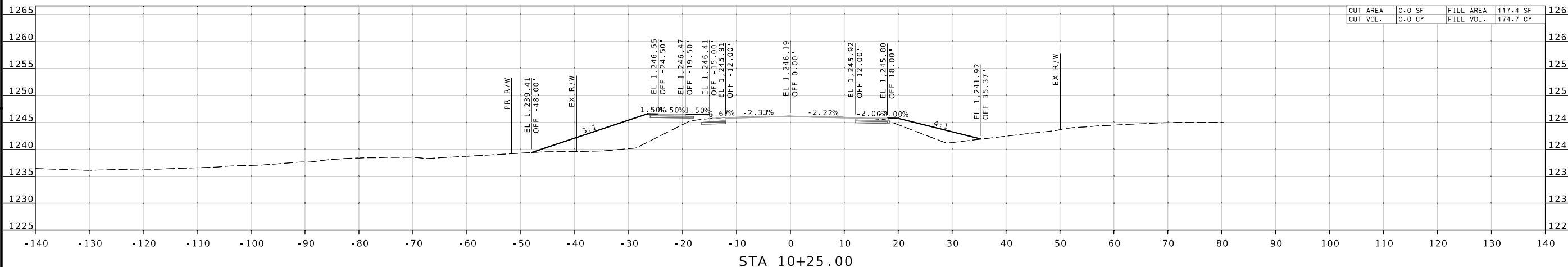

MELVILLE

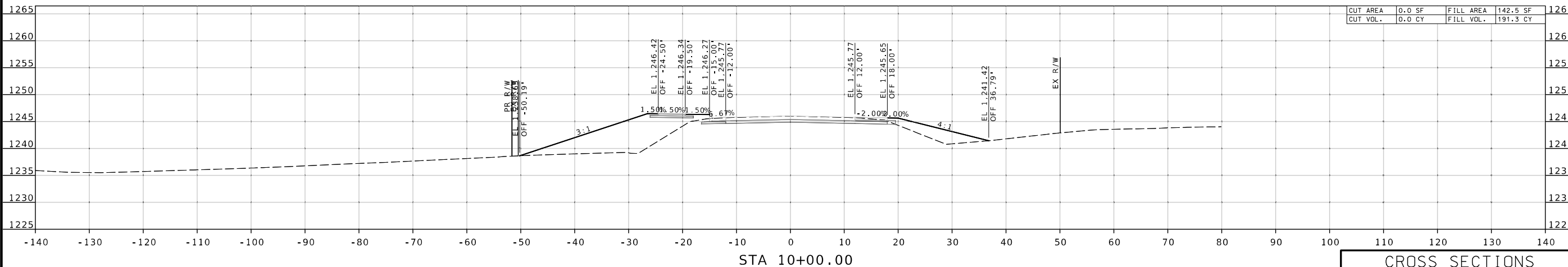

CROSS SECTIONS
 CRD 127 (MELVILLE RD.)

DISCLAIMER
 THE PROFESSIONAL WHOSE SIGNATURE AND PERSONAL SEAL APPEAR HEREON ASSUMES RESPONSIBILITY ONLY FOR WHAT APPEARS ON THIS PAGE, AND DISCLAIMS (PURSUANT TO SECTION 327.411 RSMO) SPECIFICATION, ESTIMATES, REPORTS, OR OTHER DOCUMENTS OR INSTRUMENTS NOT SEALED BY THE UNDERSIGNED PROFESSIONAL RELATING TO OR INTENDED TO BE USED FOR ANY PART OR PARTS OF THE PROJECT TO WHICH THIS PAGE REFERS.



THIS SHEET HAS BEEN SIGNED, SEALED AND DATED ELECTRONICALLY.

DATE PREPARED
 12/20/2024

ROUTE STATE
 CRD 127 MO

DISTRICT SHEET NO.
 SW 20

COUNTY
 GREENE

JOB NO.
 J8S3156

CONTRACT ID.

PROJECT NO.

BRIDGE NO.

DESCRIPTION

DATE

MISSOURI HIGHWAYS AND TRANSPORTATION COMMISSION

105 WEST CAPITOL JEFFERSON CITY, MO 65102

1-888-ASK-MODOT (1-888-278-6636)

MoDOT

CMT

© Copyright CMT, Inc.
 CRAWFORD, MURPHY & TILLY, INC.
 631 WEST ELINDALE STREET
 SPRINGFIELD, MO 65807 (417) 869-6009

ENGINEERING CORPORATION - 000631

REV.

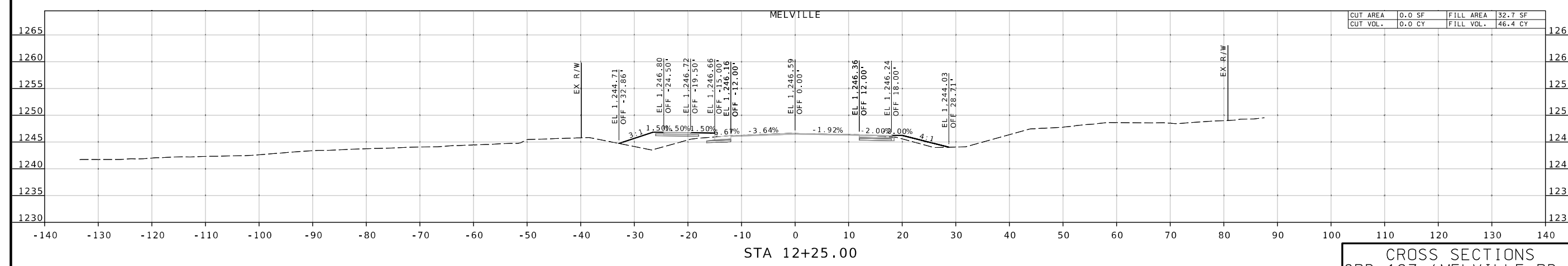
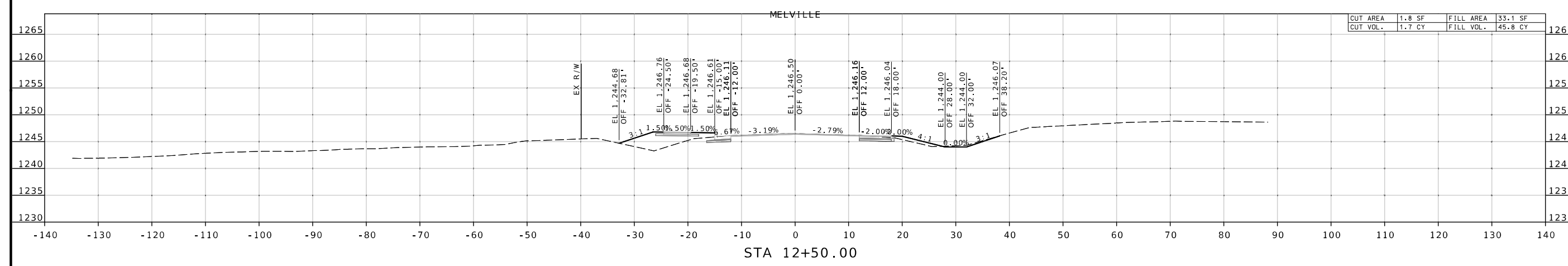
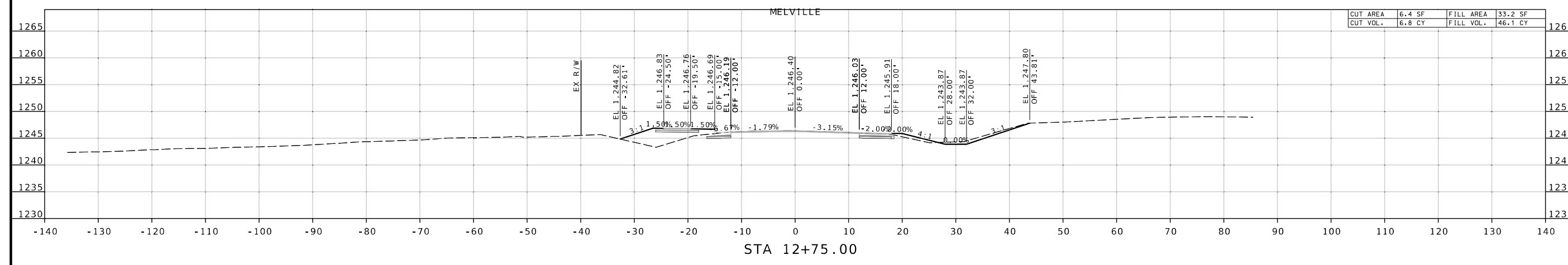

CROSS SECTIONS
 CRD 127 (MELVILLE RD.)

DISCLAIMER
 THE PROFESSIONAL WHOSE SIGNATURE AND PERSONAL SEAL APPEAR HEREON ASSUMES RESPONSIBILITY ONLY FOR WHAT APPEARS ON THIS PAGE, AND DISCLAIMS (PURSUANT TO SECTION 327.411 RSMO) SPECIFICATION, ESTIMATES, REPORTS, OR OTHER DOCUMENTS OR INSTRUMENTS NOT SEALED BY THE UNDERSIGNED PROFESSIONAL RELATING TO OR INTENDED TO BE USED FOR ANY PART OR PARTS OF THE PROJECT TO WHICH THIS PAGE REFERS.

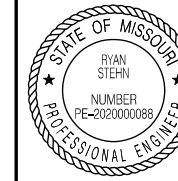

THIS SHEET HAS BEEN SIGNED, SEALED AND DATED ELECTRONICALLY.

DATE PREPARED
 12/20/2024

ROUTE STATE
 CRD 127 MO

DISTRICT SHEET NO.
 SW 23

COUNTY
 GREENE

JOB NO.
 J8S3156

CONTRACT ID.

PROJECT NO.

BRIDGE NO.

DESCRIPTION

DATE

MISSOURI HIGHWAYS AND TRANSPORTATION COMMISSION

105 WEST CAPITOL JEFFERSON CITY, MO 65102 1-888-ASK-MODOT (1-888-278-6636)

MoDOT

© Copyright CMT, Inc.

CRAWFORD, MURPHY & TILLY, INC.

633 WEST ELINDALE STREET SPRINGFIELD, MO 65807 (417) 869-6009

ENGINEERING CORPORATION - 000631

REV.

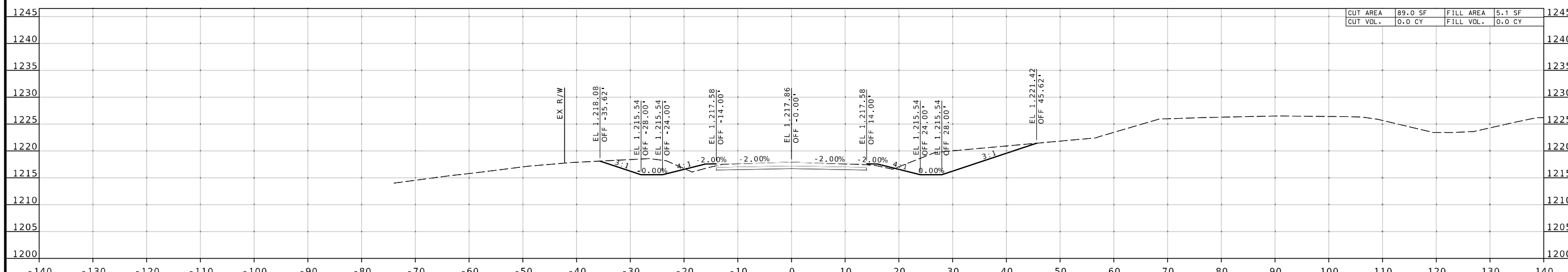
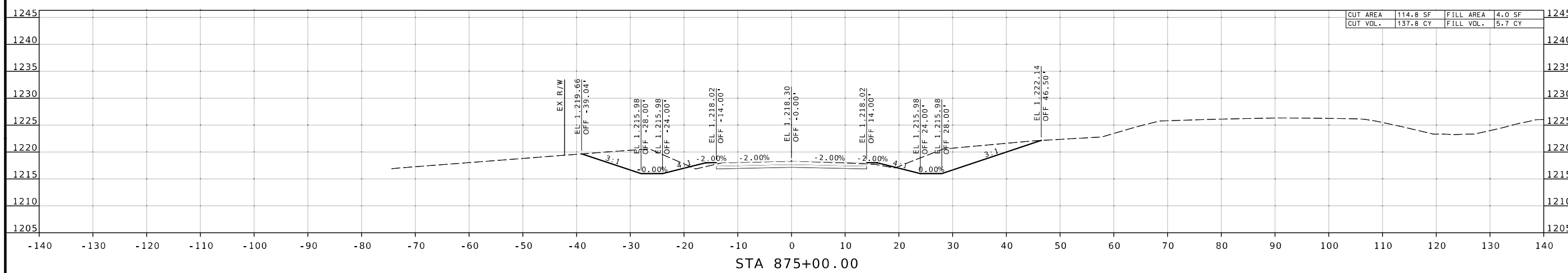
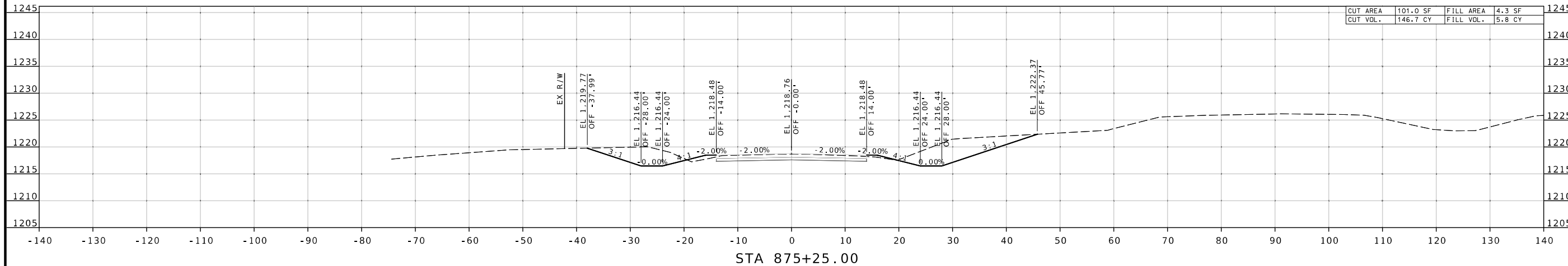

CROSS SECTIONS
 NORTON RD.

DISCLAIMER
 THE PROFESSIONAL WHOSE SIGNATURE AND PERSONAL SEAL APPEAR HEREON ASSUMES RESPONSIBILITY ONLY FOR WHAT APPEARS ON THIS PAGE, AND DISCLAIMS (PURSUANT TO SECTION 327.411 RSMO) SPECIFICATION, ESTIMATES, REPORTS, OR OTHER DOCUMENTS OR INSTRUMENTS NOT SEALED BY THE UNDERSIGNED PROFESSIONAL RELATING TO OR INTENDED TO BE USED FOR ANY PART OR PARTS OF THE PROJECT TO WHICH THIS PAGE REFERS.

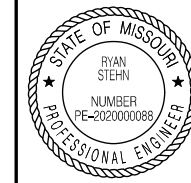

THIS SHEET HAS BEEN SIGNED, SEALED AND DATED ELECTRONICALLY.

DATE PREPARED
 12/20/2024

ROUTE STATE
 CRD 127 MO

DISTRICT SHEET NO.
 SW 27

COUNTY
 GREENE

JOB NO.
 J8S3156

CONTRACT ID.

PROJECT NO.

BRIDGE NO.

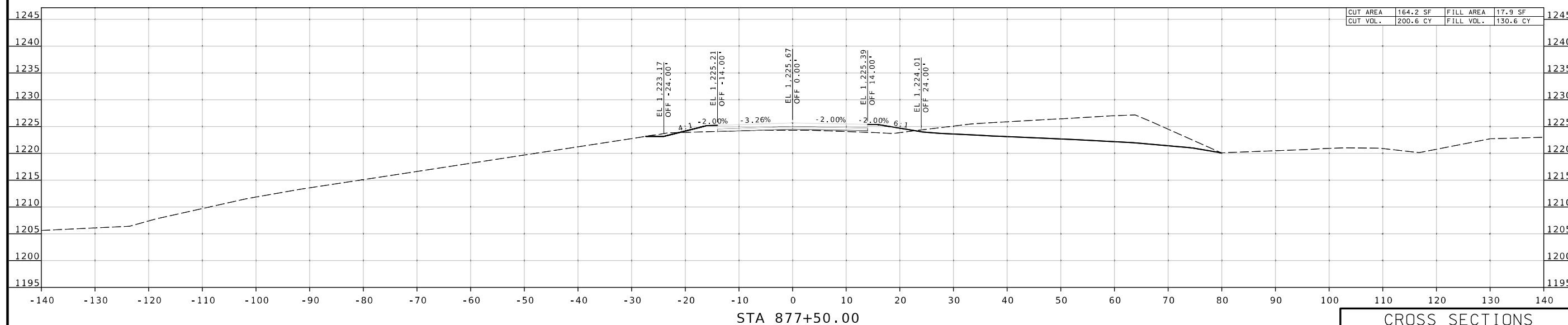
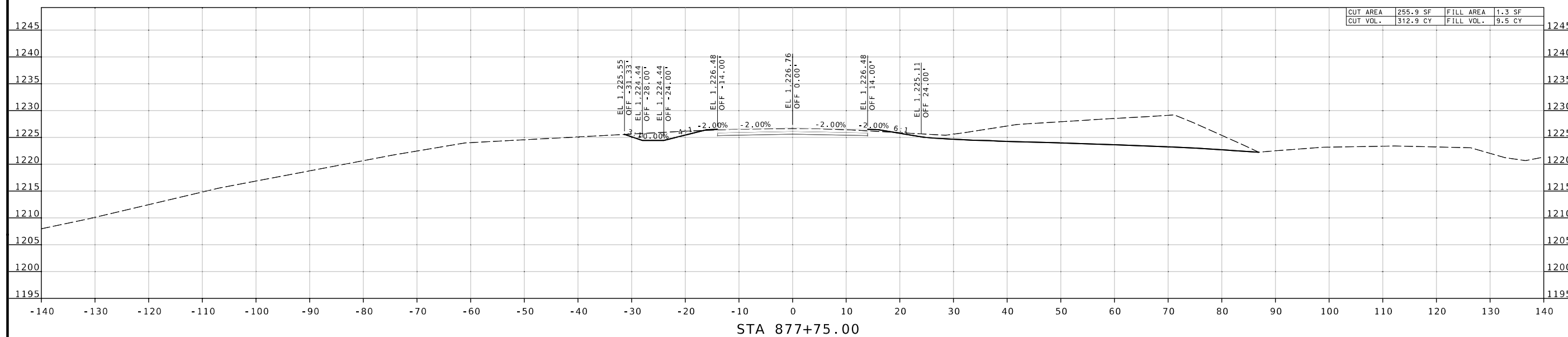

CROSS SECTIONS
 NORTON RD.

DESCRIPTION	DATE

MISSOURI HIGHWAYS AND TRANSPORTATION COMMISSION

 105 WEST CAPITOL
 JEFFERSON CITY, MO 65102
 1-888-ASK-MODOT (1-888-278-6636)

© Copyright CMT, Inc.
 CRAWFORD, MURPHY & TILLY, INC.
 631 WEST ELM ST. SUITE 101
 SPRINGFIELD, MO 65807 (417) 869-6009
 ENGINEERING CORPORATION - 000631

IF A SEAL IS PRESENT ON THIS SHEET IT HAS BEEN ELECTRONICALLY SEALED AND DATED. REV.

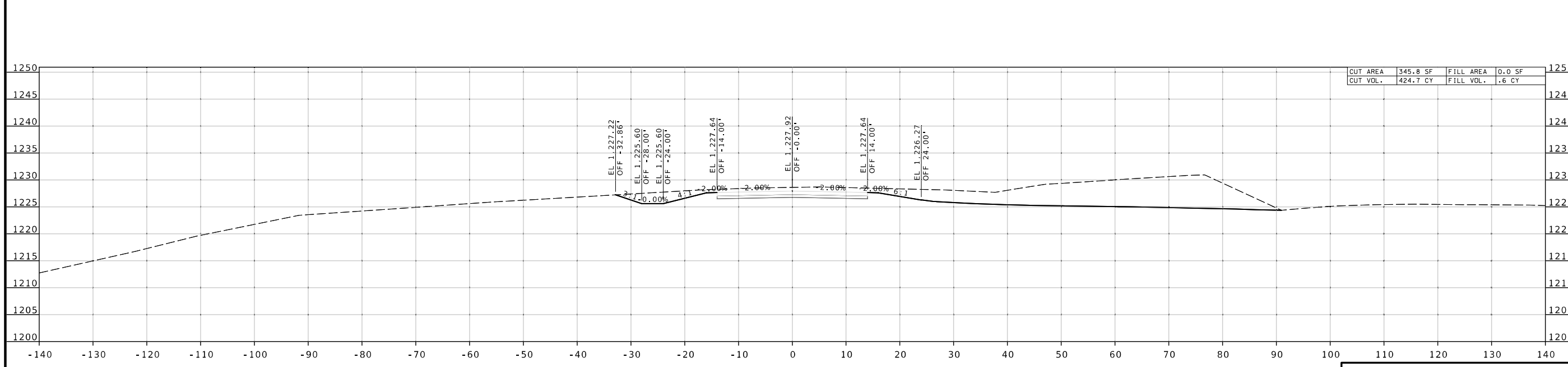
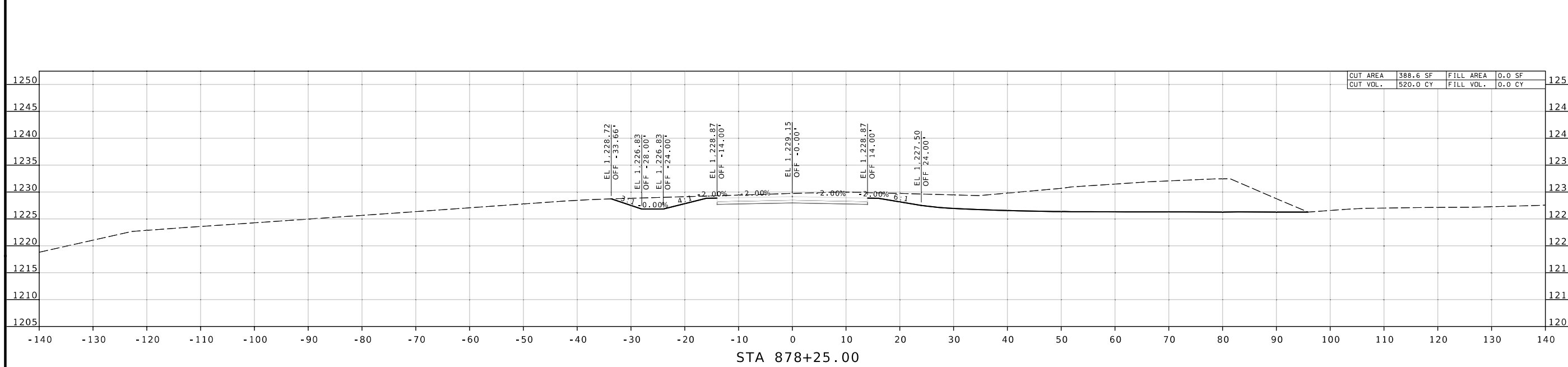
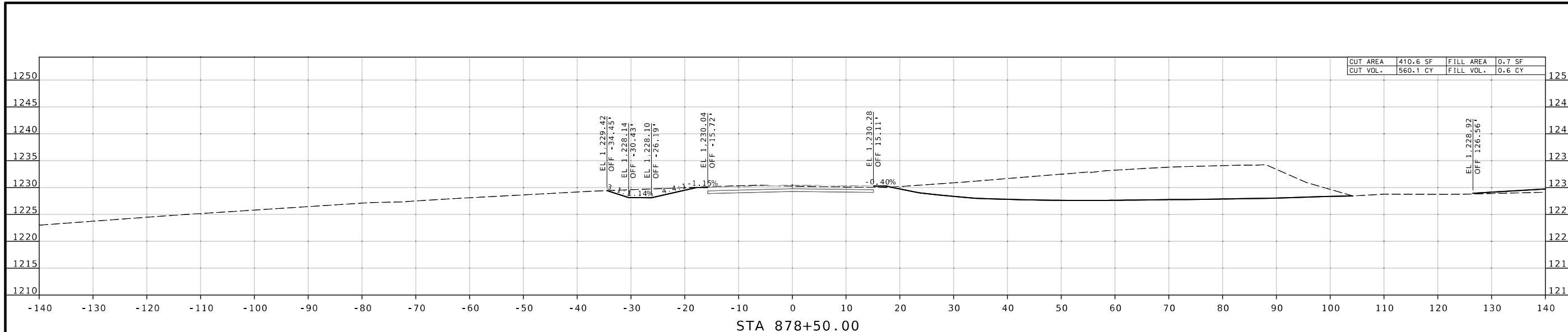

CROSS SECTIONS
NORTON RD.



THIS SHEET HAS BEEN
SIGNED, SEALED AND DATED
ELECTRONICALLY.

DATE PREPARED
12/20/2024

ROUTE STATE
CRD 127 MO

DISTRICT SHEET NO.
SW 28

COUNTY
GREENE

JOB NO.
J8S3156

CONTRACT ID.

PROJECT NO.

BRIDGE NO.

DESCRIPTION	DATE

MISSOURI HIGHWAYS AND TRANSPORTATION
COMMISSION



105 WEST CAPITOL
JEFFERSON CITY, MO 65102
1-888-ASK-MODOT (1-888-278-6636)

CMT
© Copyright CMT, Inc.
CRAWFORD, MURPHY & TILLY, INC.
631 WEST ELINDALE STREET
SPRINGFIELD, MO 65807 (417) 869-6009
ENGINEERING CORPORATION - 000631

IF A SEAL IS PRESENT ON THIS SHEET IT HAS BEEN ELECTRONICALLY SEALED AND DATED. REV.

DISCLAIMER
 THE PROFESSIONAL WHOSE SIGNATURE AND PERSONAL SEAL APPEAR HEREON ASSUMES RESPONSIBILITY ONLY FOR WHAT APPEARS ON THIS PAGE, AND DISCLAIMS (PURSUANT TO SECTION 327.411 RSMO) SPECIFICATION, ESTIMATES, REPORTS, OR OTHER DOCUMENTS OR INSTRUMENTS NOT SEALED BY THE UNDERSIGNED PROFESSIONAL RELATING TO OR INTENDED TO BE USED FOR ANY PART OR PARTS OF THE PROJECT TO WHICH THIS PAGE REFERS.

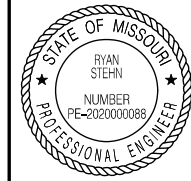

THIS SHEET HAS BEEN SIGNED, SEALED AND DATED ELECTRONICALLY.

DATE PREPARED
 12/20/2024

ROUTE STATE
 CRD 127 MO

DISTRICT SHEET NO.
 SW 33

COUNTY
 GREENE

JOB NO.
 J8S3156

CONTRACT ID.

PROJECT NO.

BRIDGE NO.

DESCRIPTION	DATE

MISSOURI HIGHWAYS AND TRANSPORTATION COMMISSION
 MoDOT
 105 WEST CAPITOL JEFFERSON CITY, MO 65102
 1-888-ASK-MODOT (1-888-278-6636)

CMT
 © Copyright CMT, Inc.
 CRAWFORD, MURPHY & TILLY, INC.
 633 WEST ELINDALE STREET
 SPRINGFIELD, MO 65807 (417) 869-6009
 ENGINEERING CORPORATION - 000631

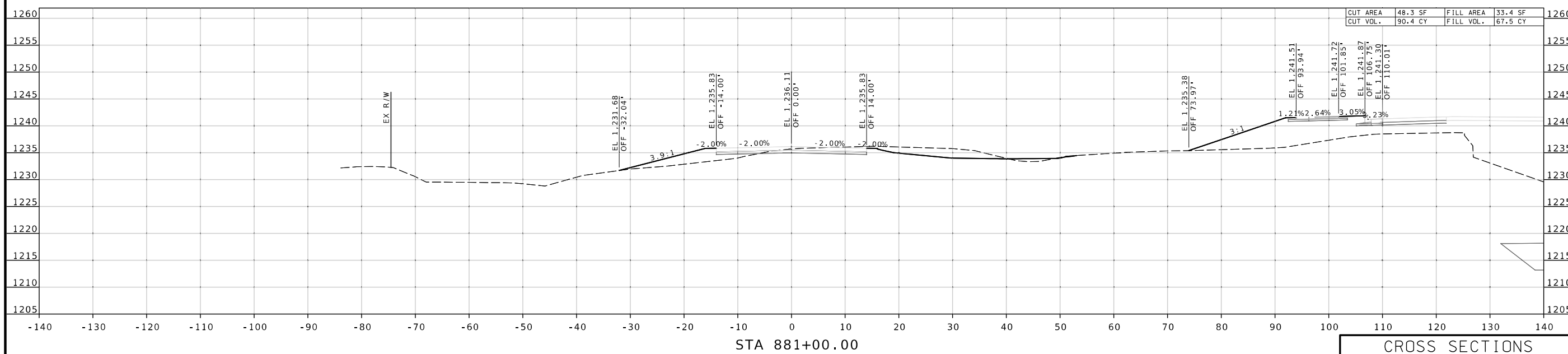
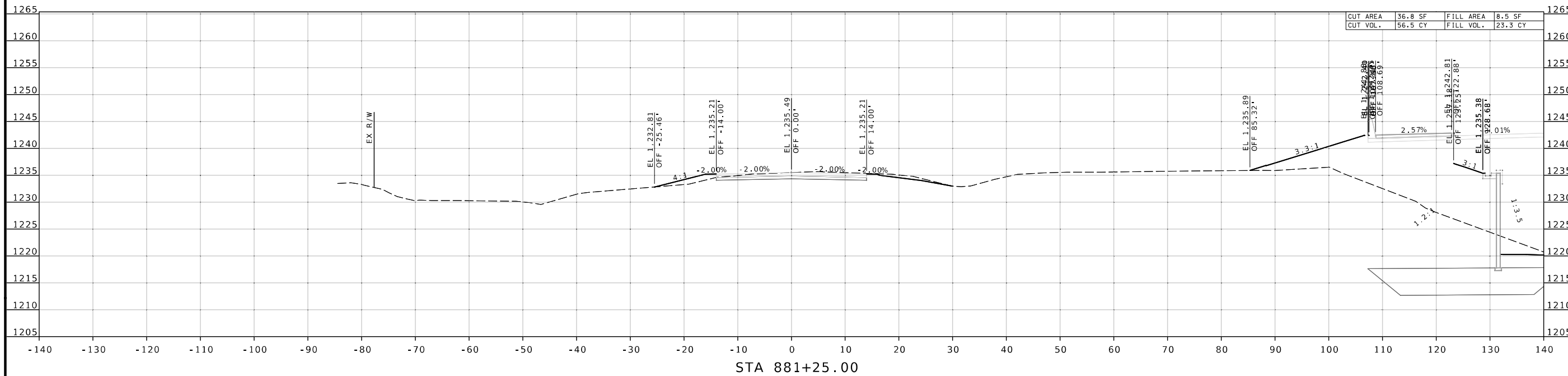

CROSS SECTIONS
 NORTON RD.

IF A SEAL IS PRESENT ON THIS SHEET IT HAS BEEN ELECTRONICALLY SEALED AND DATED.

DISCLAIMER
THE PROFESSIONAL WHOSE SIGNATURE AND PERSONAL SEAL APPEAR HEREON ASSUMES RESPONSIBILITY ONLY FOR WHAT APPEARS ON THIS PAGE, AND DISCLAIMS (PURSUANT TO SECTION 327.411 RSMO) SPECIFICATION, ESTIMATES, REPORTS, OR OTHER DOCUMENTS OR INSTRUMENTS NOT SEALED BY THE UNDERSIGNED PROFESSIONAL RELATING TO OR INTENDED TO BE USED FOR ANY PART OR PARTS OF THE PROJECT TO WHICH THIS PAGE REFERS.



THIS SHEET HAS BEEN SIGNED, SEALED AND DATED ELECTRONICALLY.

DATE PREPARED
12/20/2024

ROUTE	STATE
CRD 127	MO
DISTRICT	SHEET NO.
SW	34

COUNTY
GREENE
JOB NO.
J8S3156
CONTRACT ID.

PROJECT NO.

BRIDGE NO.

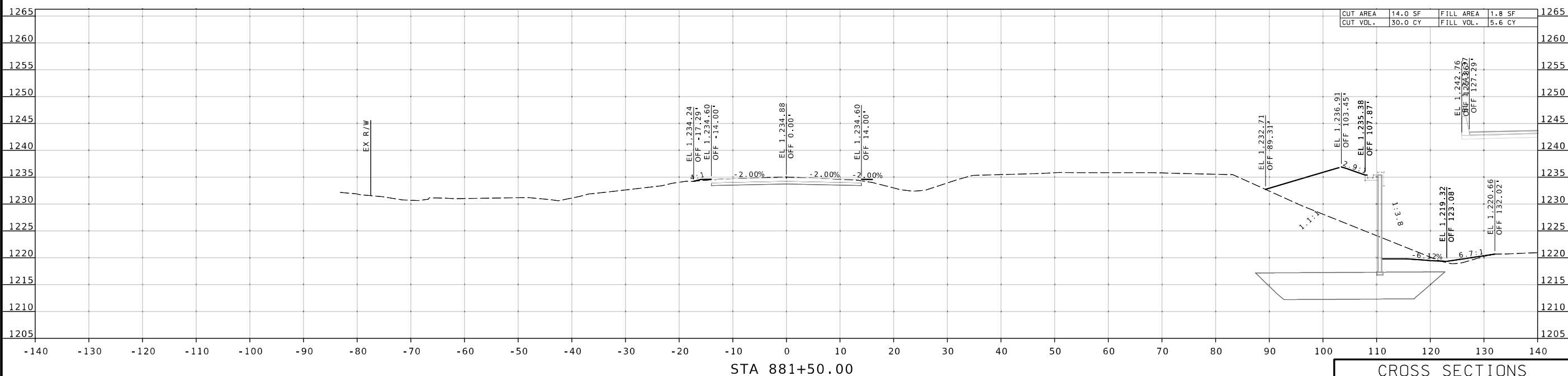
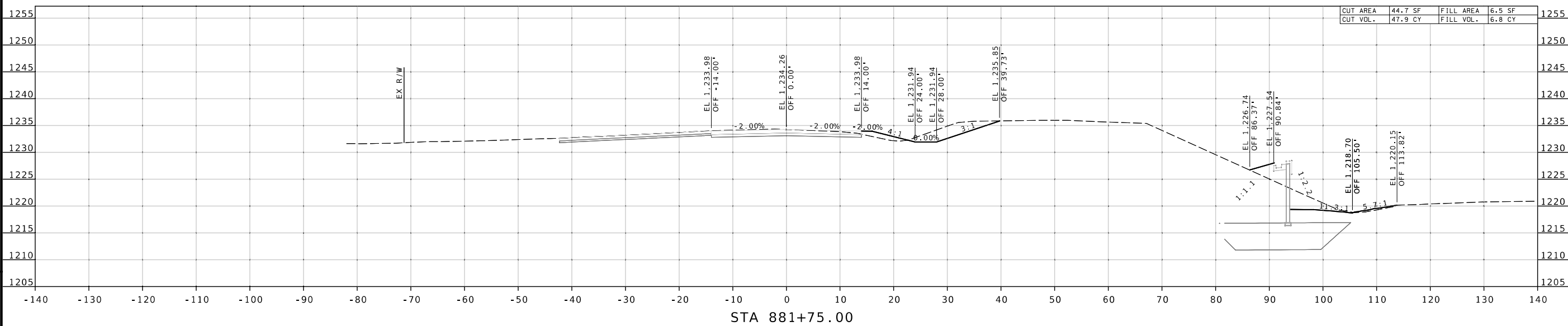

CROSS SECTIONS
NORTON RD.

DESCRIPTION

DATE

MISSOURI HIGHWAYS AND TRANSPORTATION COMMISSION

105 WEST CAPITOL
JEFFERSON CITY, MO 65102
1-888-ASK-MODOT (1-888-278-6636)



CMT
© Copyright CMT, Inc.
CRAWFORD, MURPHY & TILLY, INC.
651 WEST LINDALE STREET
SPRINGFIELD, MO 65807 (417) 869-6009
ENGINEERING CORPORATION - 000631

IF A SEAL IS PRESENT ON THIS SHEET IT HAS BEEN ELECTRONICALLY SEALED AND DATED.

DISCLAIMER
 THE PROFESSIONAL WHOSE SIGNATURE AND PERSONAL SEAL APPEAR HEREON ASSUMES RESPONSIBILITY ONLY FOR WHAT APPEARS ON THIS PAGE, AND DISCLAIMS (PURSUANT TO SECTION 327.411 RSMO) SPECIFICATION, ESTIMATES, REPORTS, OR OTHER DOCUMENTS OR INSTRUMENTS NOT SEALED BY THE UNDERSIGNED PROFESSIONAL RELATING TO OR INTENDED TO BE USED FOR ANY PART OR PARTS OF THE PROJECT TO WHICH THIS PAGE REFERS.

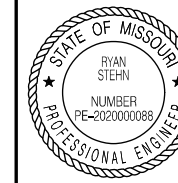

THIS SHEET HAS BEEN SIGNED, SEALED AND DATED ELECTRONICALLY.

DATE PREPARED
12/20/2024

ROUTE STATE
CRD 127 MO

DISTRICT SHEET NO.
SW 35

COUNTY
GREENE

JOB NO.
J8S3156

CONTRACT ID.

PROJECT NO.

BRIDGE NO.

DATE	DESCRIPTION

MISSOURI HIGHWAYS AND TRANSPORTATION COMMISSION



© Copyright CMT, Inc.

CMT
 CRAWFORD, MURPHY & TILLY, INC.
 631 WEST ELINDALE STREET
 SPRINGFIELD, MO 65807 (417) 869-6009
 ENGINEERING CORPORATION - 000631

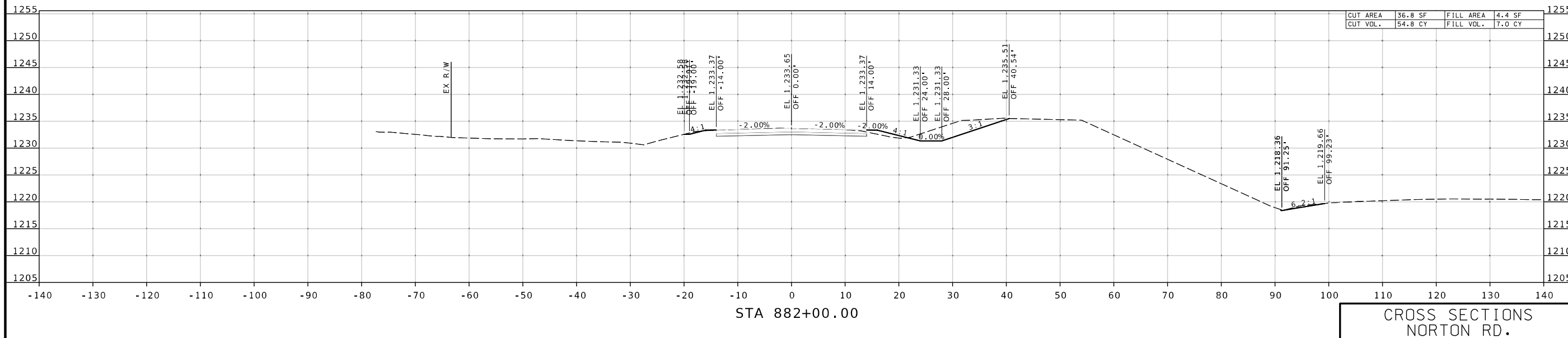
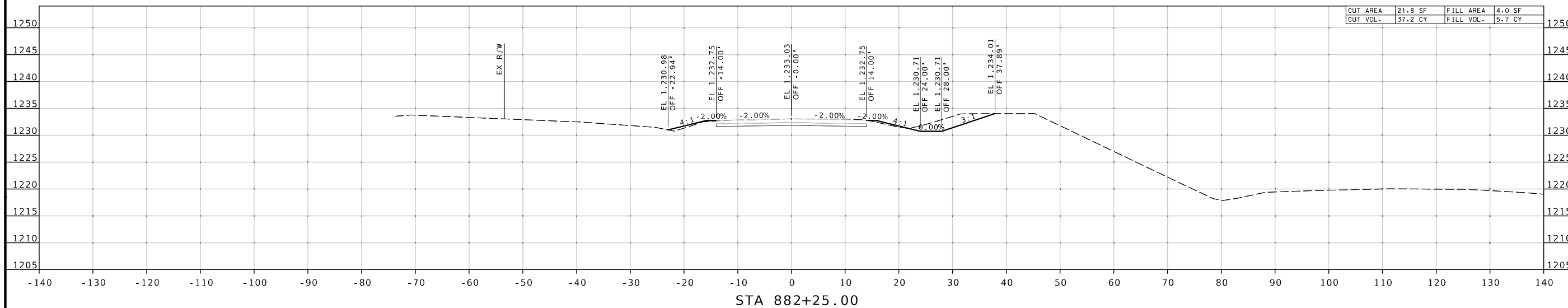

CROSS SECTIONS
NORTON RD.

IF A SEAL IS PRESENT ON THIS SHEET IT HAS BEEN ELECTRONICALLY SEALED AND DATED.

DISCLAIMER
 THE PROFESSIONAL WHOSE SIGNATURE AND PERSONAL SEAL APPEAR HEREON ASSUMES RESPONSIBILITY ONLY FOR WHAT APPEARS ON THIS PAGE, AND DISCLAIMS (PURSUANT TO SECTION 327.411 RSMO) SPECIFICATION, ESTIMATES, REPORTS, OR OTHER DOCUMENTS OR INSTRUMENTS NOT SEALED BY THE UNDERSIGNED PROFESSIONAL RELATING TO OR INTENDED TO BE USED FOR ANY PART OR PARTS OF THE PROJECT TO WHICH THIS PAGE REFERS.



THIS SHEET HAS BEEN SIGNED, SEALED AND DATED ELECTRONICALLY.

DATE PREPARED
1/9/2025

ROUTE STATE
CRD 127 MO

DISTRICT SHEET NO.
SW 36

COUNTY
GREENE

JOB NO.
J8S3156

CONTRACT ID.

PROJECT NO.

BRIDGE NO.

DESCRIPTION

DATE

MISSOURI HIGHWAYS AND TRANSPORTATION COMMISSION

105 WEST CAPITOL JEFFERSON CITY, MO 65102

1-888-ASK-MODOT (1-888-275-6636)

MoDOT

CMT

© Copyright CMT, Inc.

CRAWFORD, MURPHY & TILLY, INC.

631 WEST ELINDALE STREET

SPRINGFIELD, MO 65807 (417) 869-6009

ENGINEERING CORPORATION - 000631

REV.

IF A SEAL IS PRESENT ON THIS SHEET IT HAS BEEN ELECTRONICALLY SEALED AND DATED.

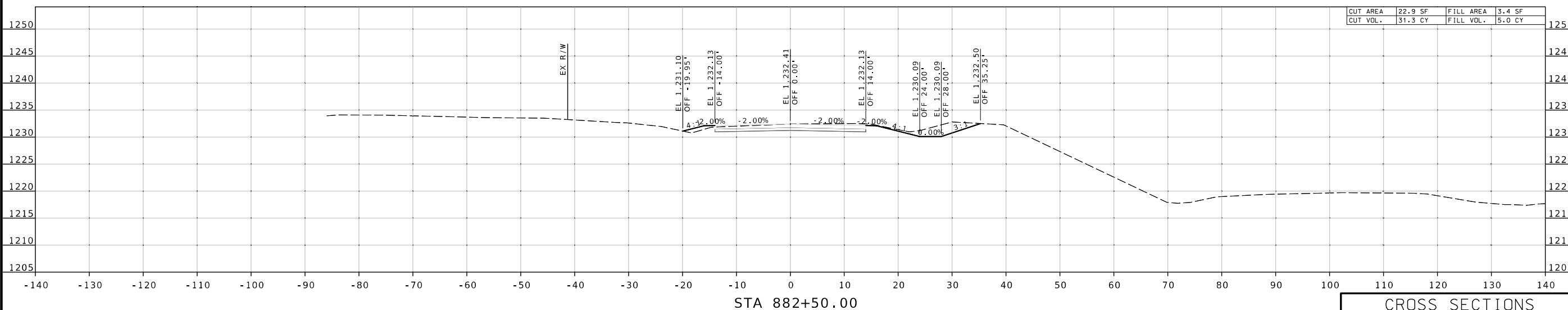
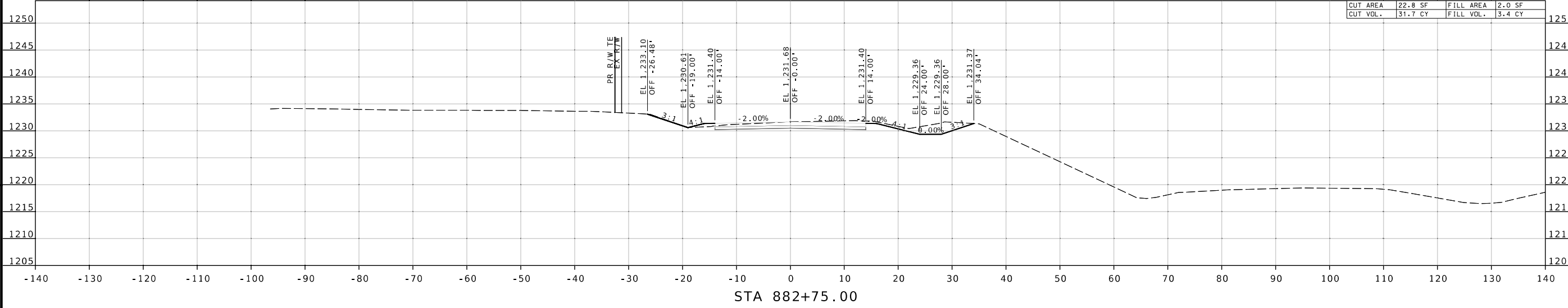

CROSS SECTIONS
NORTON RD.

DISCLAIMER
 THE PROFESSIONAL WHOSE SIGNATURE AND PERSONAL SEAL APPEAR HEREON ASSUMES RESPONSIBILITY ONLY FOR WHAT APPEARS ON THIS PAGE, AND DISCLAIMS (PURSUANT TO SECTION 327.411 RSMO) SPECIFICATION, ESTIMATES, REPORTS, OR OTHER DOCUMENTS OR INSTRUMENTS NOT SEALED BY THE UNDERSIGNED PROFESSIONAL RELATING TO OR INTENDED TO BE USED FOR ANY PART OR PARTS OF THE PROJECT TO WHICH THIS PAGE REFERS.

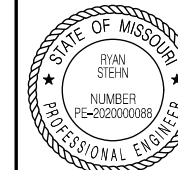

THIS SHEET HAS BEEN SIGNED, SEALED AND DATED ELECTRONICALLY.

DATE PREPARED
1/9/2025

ROUTE STATE
CRD 127 MO

DISTRICT SHEET NO.
SW 37

COUNTY
GREENE

JOB NO.
J8S3156

CONTRACT ID.

PROJECT NO.

BRIDGE NO.

DESCRIPTION

DATE

MISSOURI HIGHWAYS AND TRANSPORTATION COMMISSION

105 WEST CAPITOL JEFFERSON CITY, MO 65102

1-888-ASK-MODOT (1-888-278-6636)

MoDOT

CMT

© Copyright CMT, Inc.

CRAWFORD, MURPHY & TILLY, INC.

631 WEST ELINDALE STREET

SPRINGFIELD, MO 65807 (417) 869-6009

ENGINEERING CORPORATION - 000631

REV.

IF A SEAL IS PRESENT ON THIS SHEET IT HAS BEEN ELECTRONICALLY SEALED AND DATED.

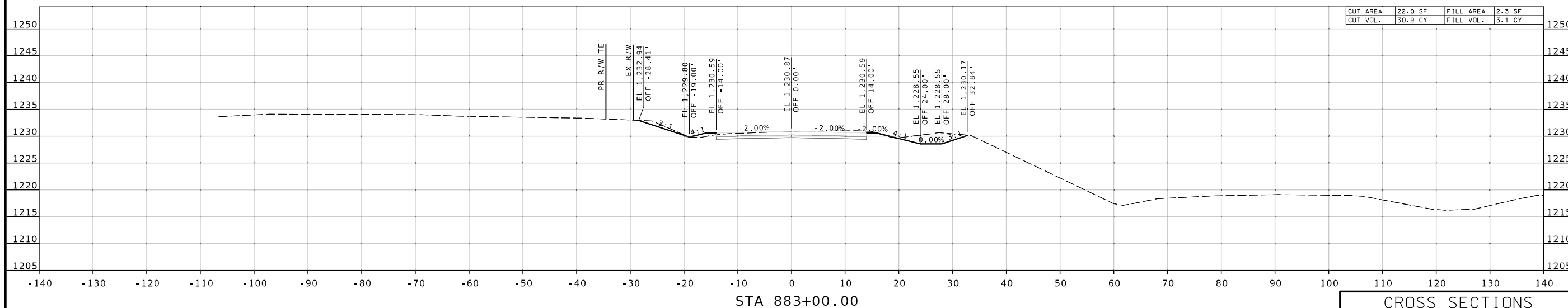
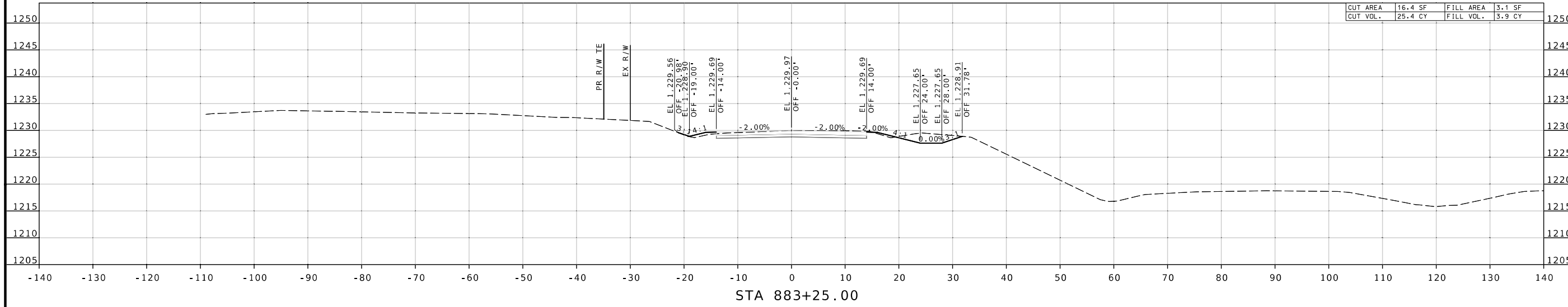

CROSS SECTIONS
NORTON RD.

DISCLAIMER
 THE PROFESSIONAL WHOSE SIGNATURE AND PERSONAL SEAL APPEAR HEREON ASSUMES RESPONSIBILITY ONLY FOR WHAT APPEARS ON THIS PAGE, AND DISCLAIMS (PURSUANT TO SECTION 327.411 RSMO) SPECIFICATION, ESTIMATES, REPORTS, OR OTHER DOCUMENTS OR INSTRUMENTS NOT SEALED BY THE UNDERSIGNED PROFESSIONAL RELATING TO OR INTENDED TO BE USED FOR ANY PART OR PARTS OF THE PROJECT TO WHICH THIS PAGE REFERS.

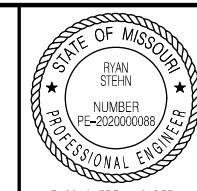

THIS SHEET HAS BEEN SIGNED, SEALED AND DATED ELECTRONICALLY.

DATE PREPARED
 1/9/2025
 ROUTE STATE
 CRD 127 MO
 DISTRICT SHEET NO.
 SW 38
 COUNTY
 GREENE
 JOB NO.
 J8S3156
 CONTRACT ID.
 PROJECT NO.
 BRIDGE NO.

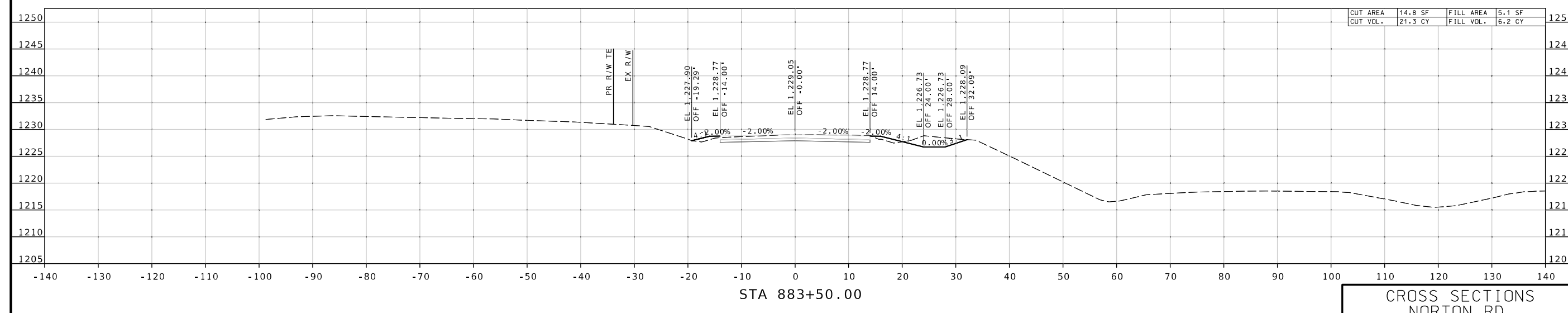
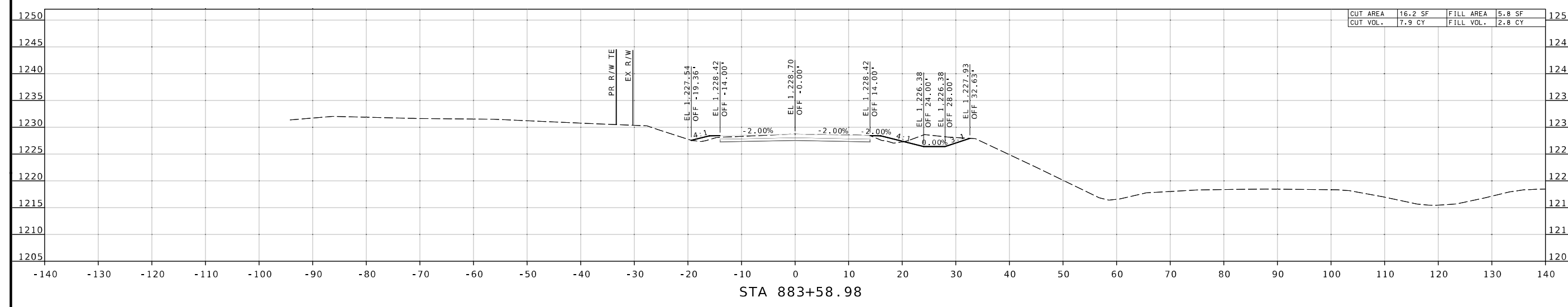

CROSS SECTIONS
 NORTON RD.

DESCRIPTION	DATE

MISSOURI HIGHWAYS AND TRANSPORTATION COMMISSION

105 WEST CAPITOL
 JEFFERSON CITY, MO 65102
 1-888-ASK-MODOT (1-888-278-6636)

CMT
 © Copyright CMT, Inc.
 CRAWFORD, MURPHY & TILLY, INC.
 651 WEST LINDALE STREET
 SPRINGFIELD, MO 65807 (417) 869-6009
 ENGINEERING CORPORATION - 000631

IF A SEAL IS PRESENT ON THIS SHEET IT HAS BEEN ELECTRONICALLY SEALED AND DATED. REV.

DISCLAIMER
 THE PROFESSIONAL WHOSE SIGNATURE AND PERSONAL SEAL APPEAR HEREON ASSUMES RESPONSIBILITY ONLY FOR WHAT APPEARS ON THIS PAGE, AND DISCLAIMS (PURSUANT TO SECTION 327.411 RSMO) SPECIFICATION, ESTIMATES, REPORTS, OR OTHER DOCUMENTS OR INSTRUMENTS NOT SEALED BY THE UNDERSIGNED PROFESSIONAL RELATING TO OR INTENDED TO BE USED FOR ANY PART OR PARTS OF THE PROJECT TO WHICH THIS PAGE REFERS.

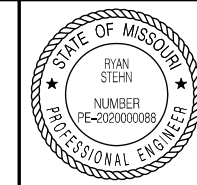

THIS SHEET HAS BEEN SIGNED, SEALED AND DATED ELECTRONICALLY.

DATE PREPARED
 12/20/2024
 ROUTE STATE
 CRD 127 MO
 DISTRICT SHEET NO.
 SW 39
 COUNTY
 GREENE
 JOB NO.
 J8S3156
 CONTRACT ID.
 PROJECT NO.
 BRIDGE NO.

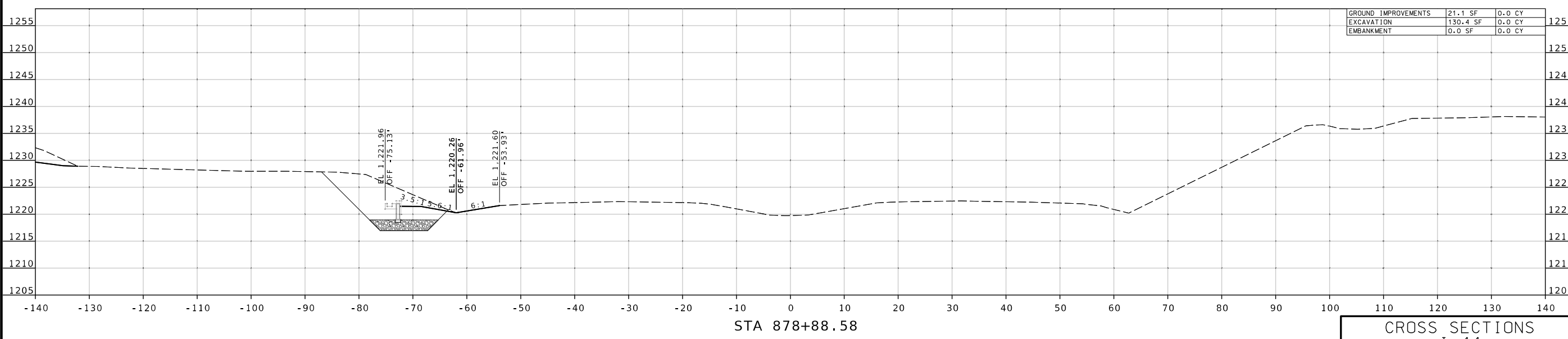
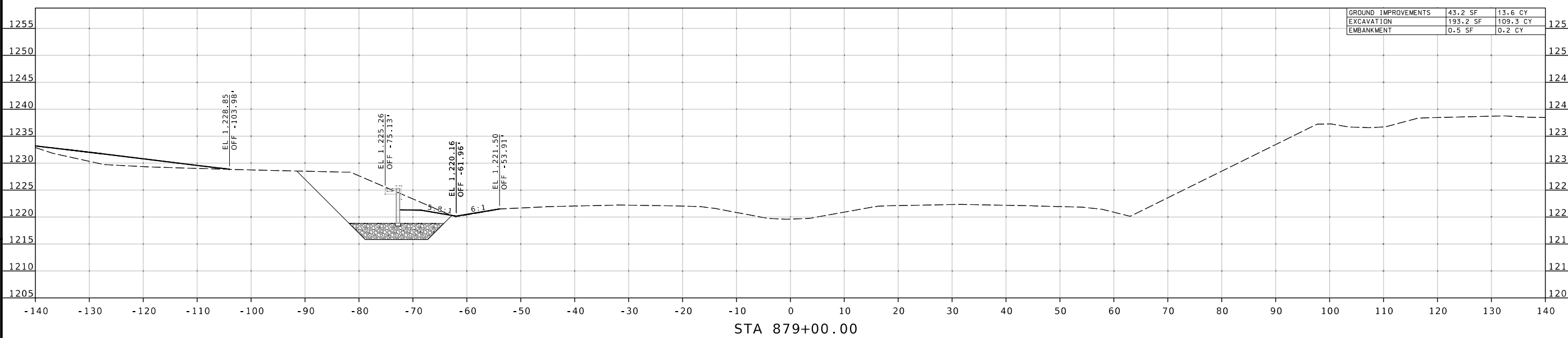

CROSS SECTIONS
 I-44

DESCRIPTION	DATE

MISSOURI HIGHWAYS AND TRANSPORTATION COMMISSION

105 WEST CAPITOL
 JEFFERSON CITY, MO 65102
 1-888-ASK-MODOT (1-888-278-6636)

CMT

© Copyright CMT, Inc.
 CRAWFORD, MURPHY & TILLY, INC.
 631 WEST ELINDALE STREET
 SPRINGFIELD, MO 65807 (417) 869-6009
 ENGINEERING CORPORATION - 000631

IF A SEAL IS PRESENT ON THIS SHEET IT HAS BEEN ELECTRONICALLY SEALED AND DATED.

DISCLAIMER
 THE PROFESSIONAL WHOSE SIGNATURE AND PERSONAL SEAL APPEAR HEREON ASSUMES RESPONSIBILITY ONLY FOR WHAT APPEARS ON THIS PAGE, AND DISCLAIMS (PURSUANT TO SECTION 327.411 RSMO) SPECIFICATION, ESTIMATES, REPORTS, OR OTHER DOCUMENTS OR INSTRUMENTS NOT SEALED BY THE UNDERSIGNED PROFESSIONAL RELATING TO OR INTENDED TO BE USED FOR ANY PART OR PARTS OF THE PROJECT TO WHICH THIS PAGE REFERS.



THIS SHEET HAS BEEN SIGNED, SEALED AND DATED ELECTRONICALLY.

DATE PREPARED
 12/20/2024

ROUTE STATE
 CRD 127 MO
 DISTRICT SHEET NO.
 SW 40

COUNTY
 GREENE
 JOB NO.
 J8S3156
 CONTRACT ID.

PROJECT NO.

BRIDGE NO.

GROUND IMPROVEMENTS	125.1 SF	110.0 CY
EXCAVATION	666.6 SF	800.2 CY
EMBANKMENT	107.9 SF	141.9 CY

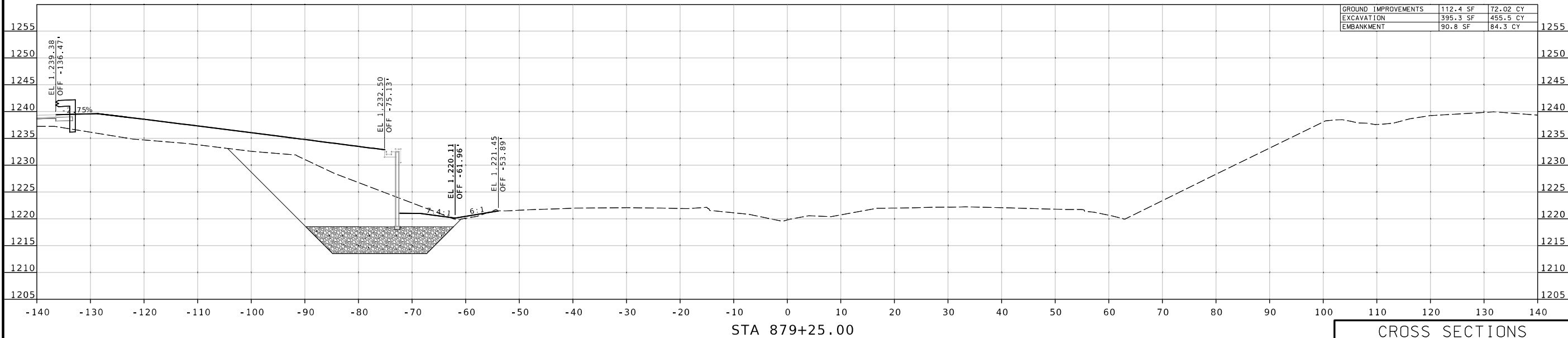
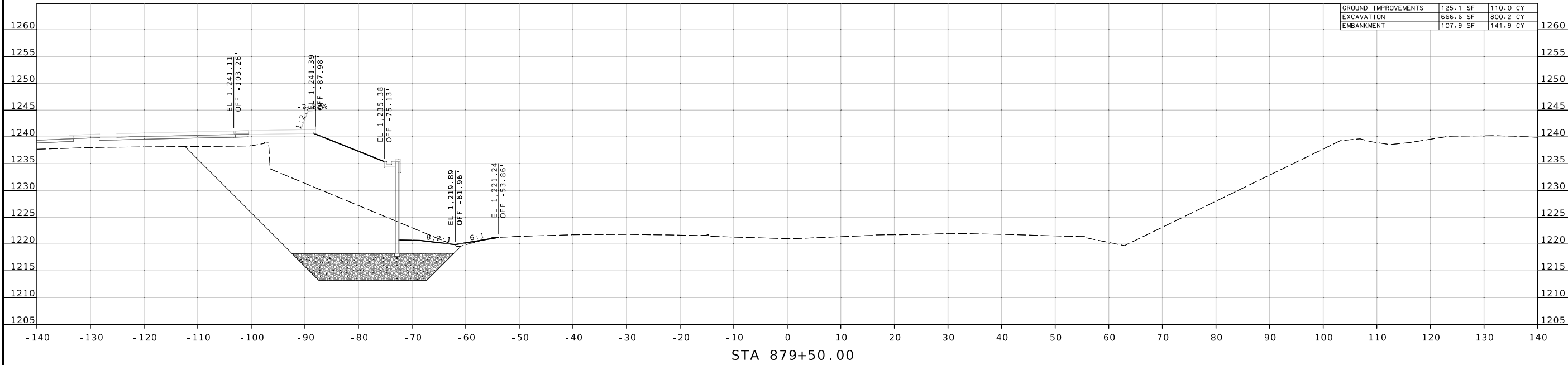

CROSS SECTIONS
 I-44

DESCRIPTION
 DATE

MISSOURI HIGHWAYS AND TRANSPORTATION COMMISSION



CMT

© Copyright CMT, Inc.
 CRAWFORD, MURPHY & TILLY, INC.
 651 WEST LINDALE STREET
 SPRINGFIELD, MO 65807 (417) 869-6009
 ENGINEERING CORPORATION - 000631

IF A SEAL IS PRESENT ON THIS SHEET IT HAS BEEN ELECTRONICALLY SEALED AND DATED.

DISCLAIMER
 THE PROFESSIONAL WHOSE SIGNATURE AND PERSONAL SEAL APPEAR HEREON ASSUMES RESPONSIBILITY ONLY FOR WHAT APPEARS ON THIS PAGE, AND DISCLAIMS (PURSUANT TO SECTION 327.411 RSMO) SPECIFICATION, ESTIMATES, REPORTS, OR OTHER DOCUMENTS OR INSTRUMENTS NOT SEALED BY THE UNDERSIGNED PROFESSIONAL RELATING TO OR INTENDED TO BE USED FOR ANY PART OR PARTS OF THE PROJECT TO WHICH THIS PAGE REFERS.

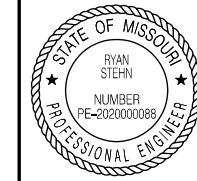

THIS SHEET HAS BEEN SIGNED, SEALED AND DATED ELECTRONICALLY.

DATE PREPARED
 12/20/2024

ROUTE STATE
 CRD 127 MO

DISTRICT SHEET NO.
 SW 41

COUNTY
 GREENE

JOB NO.
 J8S3156

CONTRACT ID.

PROJECT NO.

BRIDGE NO.

DESCRIPTION

DATE

DATE

DATE

DATE

DATE

DATE

DATE

DATE

DATE

DATE

DATE

DATE

DATE

DATE

DATE

DATE

DATE

DATE

DATE

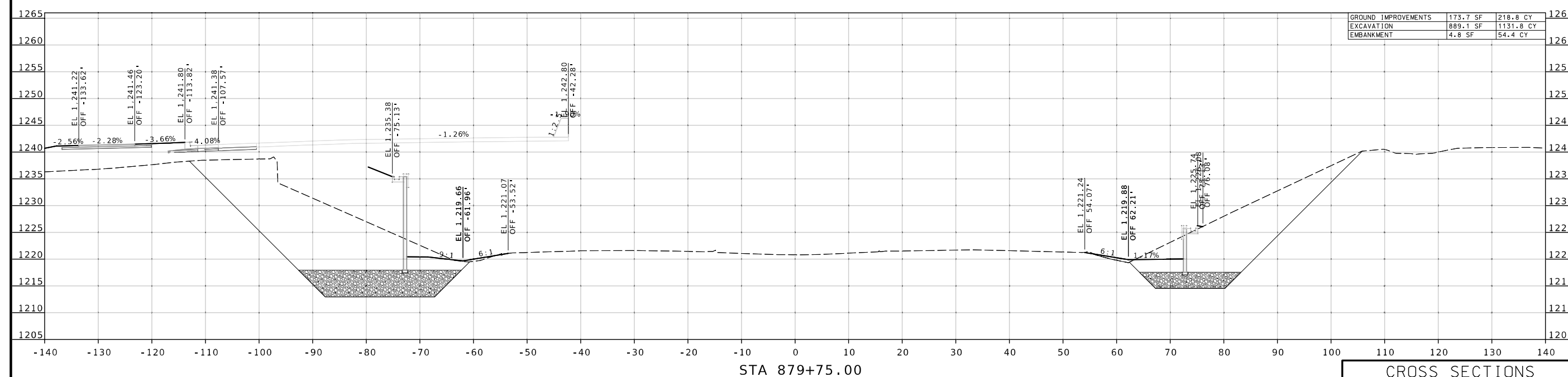
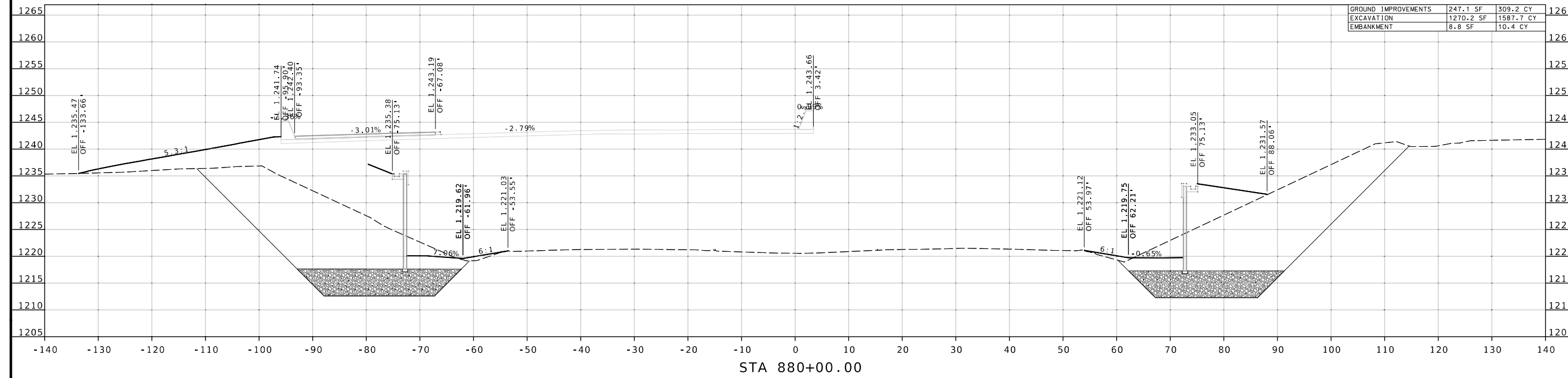

CROSS SECTIONS
 I-44

MISSOURI HIGHWAYS AND TRANSPORTATION COMMISSION
 105 WEST CAPITOL
 JEFFERSON CITY, MO 65102
 1-888-ASK-MODOT (1-888-278-6636)

CMT
 © Copyright CMT, Inc.
 CRAWFORD, MURPHY & TILLY, INC.
 651 WEST WINDALE STREET
 SPRINGFIELD, MO 65807 (417) 869-6009
 ENGINEERING CORPORATION - 000631

IF A SEAL IS PRESENT ON THIS SHEET IT HAS BEEN ELECTRONICALLY SEALED AND DATED.

DISCLAIMER
 THE PROFESSIONAL WHOSE SIGNATURE AND PERSONAL SEAL APPEAR HEREON ASSUMES RESPONSIBILITY ONLY FOR WHAT APPEARS ON THIS PAGE, AND DISCLAIMS (PURSUANT TO SECTION 327.411 RSMO) SPECIFICATION, ESTIMATES, REPORTS, OR OTHER DOCUMENTS OR INSTRUMENTS NOT SEALED BY THE UNDERSIGNED PROFESSIONAL RELATING TO OR INTENDED TO BE USED FOR ANY PART OR PARTS OF THE PROJECT TO WHICH THIS PAGE REFERS.

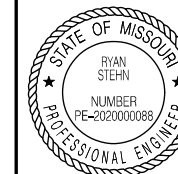

THIS SHEET HAS BEEN SIGNED, SEALED AND DATED ELECTRONICALLY.

DATE PREPARED
 12/20/2024

ROUTE STATE
 CRD 127 MO

DISTRICT SHEET NO.
 SW 42

COUNTY
 GREENE

JOB NO.
 J8S3156

CONTRACT ID.

PROJECT NO.

BRIDGE NO.

DESCRIPTION

DATE

MISSOURI HIGHWAYS AND TRANSPORTATION COMMISSION

105 WEST CAPITOL JEFFERSON CITY, MO 65102

1-888-ASK-MODOT (1-888-278-6636)

MoDOT

CMT

© Copyright CMT, Inc.
 CRAWFORD, MURPHY & TILLY, INC.
 631 WEST ELLIOTT STREET
 SPRINGFIELD, MO 65807 (417) 869-6009
 ENGINEERING CORPORATION - 000631

REV.

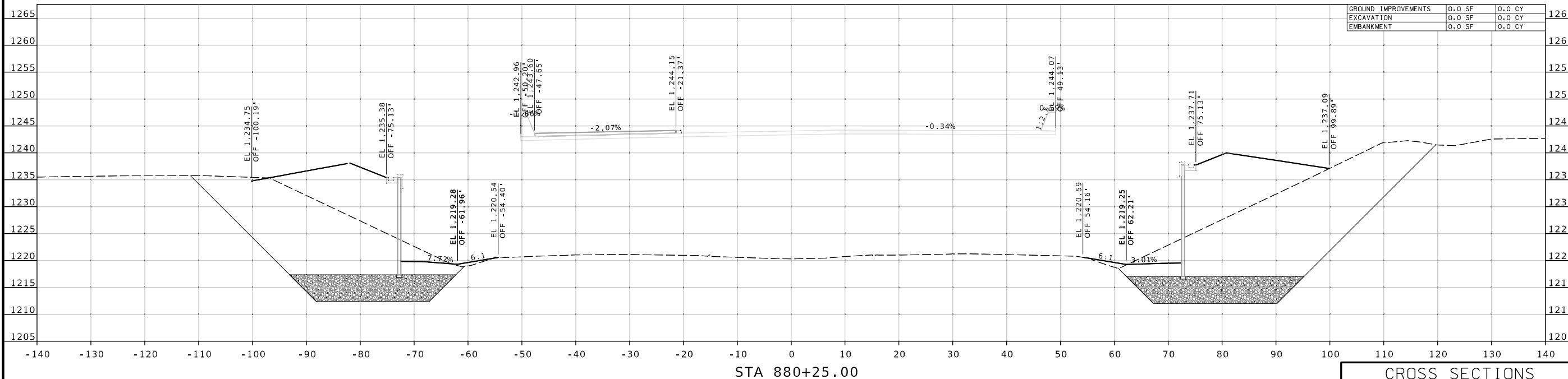
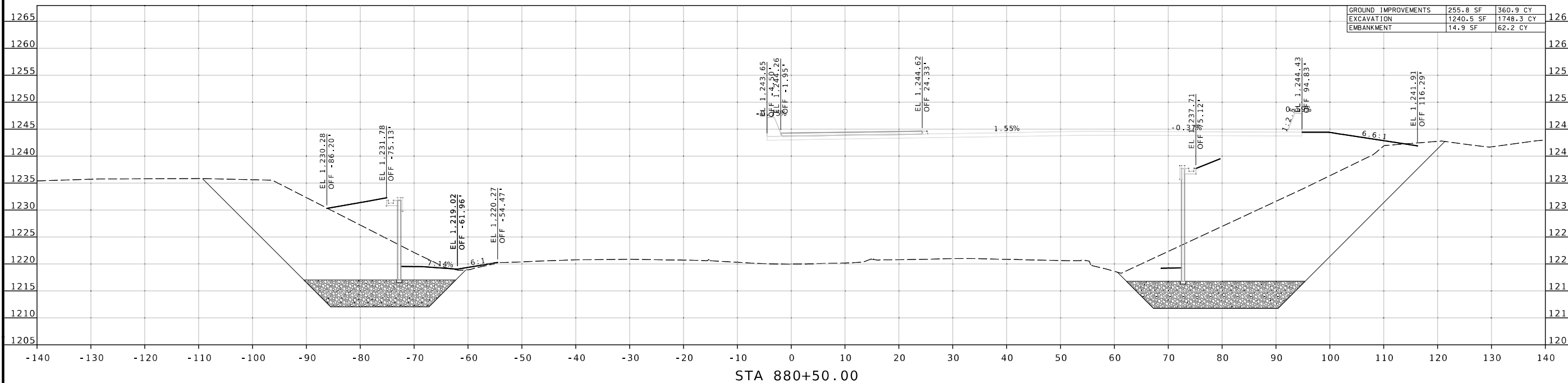

CROSS SECTIONS
 I-44

DISCLAIMER
THE PROFESSIONAL WHOSE SIGNATURE AND PERSONAL SEAL APPEAR HEREON ASSUMES RESPONSIBILITY ONLY FOR WHAT APPEARS ON THIS PAGE, AND DISCLAIMS (PURSUANT TO SECTION 327.411 RSMO) SPECIFICATION, ESTIMATES, REPORTS, OR OTHER DOCUMENTS OR INSTRUMENTS NOT SEALED BY THE UNDERSIGNED PROFESSIONAL RELATING TO OR INTENDED TO BE USED FOR ANY PART OR PARTS OF THE PROJECT TO WHICH THIS PAGE REFERS.

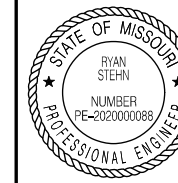

THIS SHEET HAS BEEN SIGNED, SEALED AND DATED ELECTRONICALLY.

DATE PREPARED
12/20/2024

ROUTE STATE
CRD 127 MO

DISTRICT SHEET NO.
SW 43

COUNTY
GREENE

JOB NO.
J8S3156

CONTRACT ID.

PROJECT NO.

BRIDGE NO.

DESCRIPTION

DATE

MISSOURI HIGHWAYS AND TRANSPORTATION COMMISSION

105 WEST CAPITOL JEFFERSON CITY, MO 65102

1-888-ASK-MODOT (1-888-275-6636)



CMT
© Copyright CMT, Inc.
CRAWFORD, MURPHY & TILLY, INC.
631 WEST ELINDALE STREET
SPRINGFIELD, MO 65807 (417) 869-6009
ENGINEERING CORPORATION - 000631

IF A SEAL IS PRESENT ON THIS SHEET IT HAS BEEN ELECTRONICALLY SEALED AND DATED.

REV.

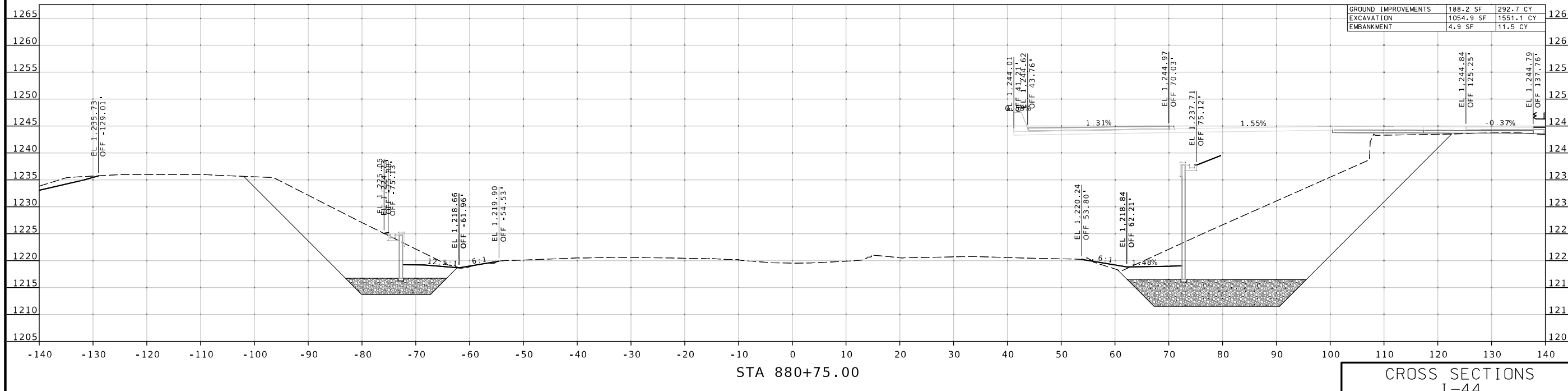
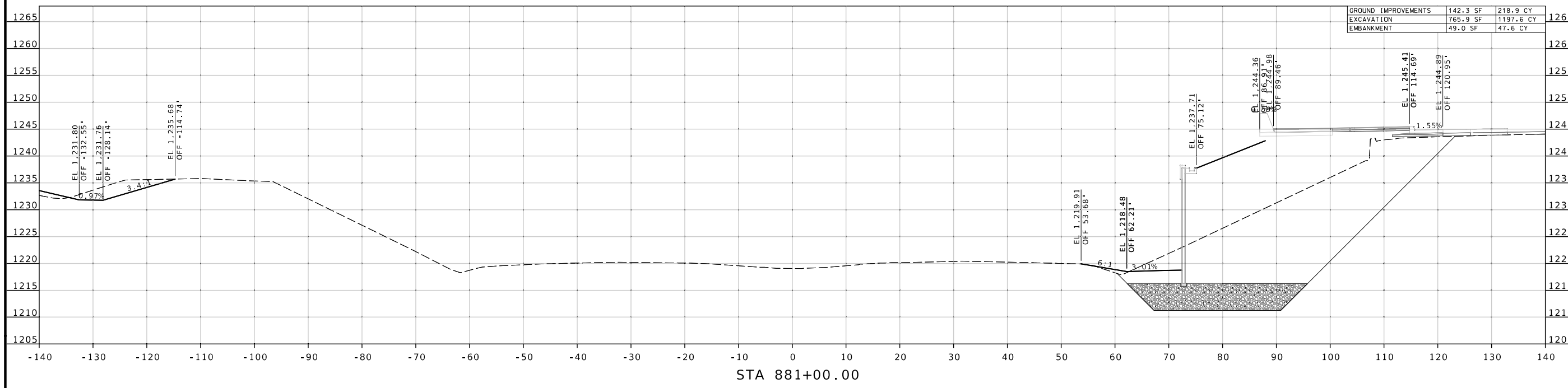

CROSS SECTIONS
I-44

DISCLAIMER
THE PROFESSIONAL WHOSE SIGNATURE AND PERSONAL SEAL APPEAR HEREON ASSUMES RESPONSIBILITY ONLY FOR WHAT APPEARS ON THIS PAGE, AND DISCLAIMS (PURSUANT TO SECTION 327.411 RSMO) SPECIFICATION, ESTIMATES, REPORTS, OR OTHER DOCUMENTS OR INSTRUMENTS NOT SEALED BY THE UNDERSIGNED PROFESSIONAL RELATING TO OR INTENDED TO BE USED FOR ANY PART OR PARTS OF THE PROJECT TO WHICH THIS PAGE REFERS.



THIS SHEET HAS BEEN SIGNED, SEALED AND DATED ELECTRONICALLY.

DATE PREPARED
12/20/2024

ROUTE STATE
CRD 127 MO

DISTRICT SHEET NO.
SW 44

COUNTY
GREENE

JOB NO.
J8S3156

CONTRACT ID.

PROJECT NO.

BRIDGE NO.

DESCRIPTION	DATE

MISSOURI HIGHWAYS AND TRANSPORTATION COMMISSION
105 WEST CAPITOL JEFFERSON CITY, MO 65102
1-888-ASK-MODOT (1-888-275-6636)

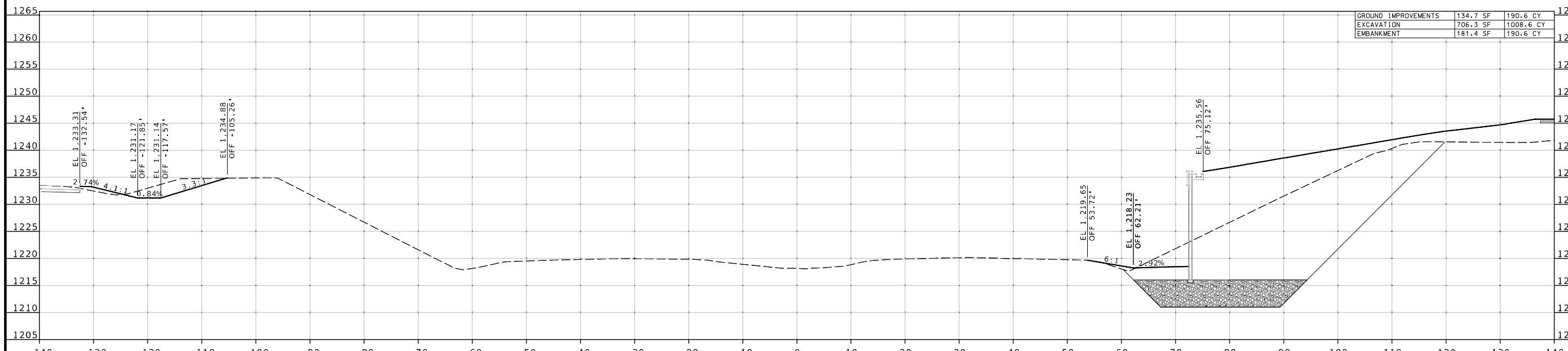
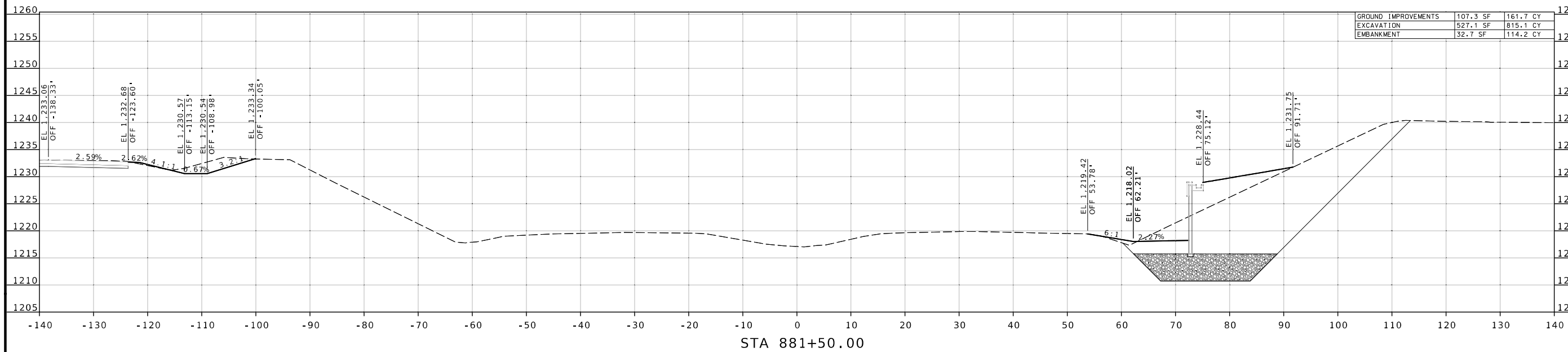

CROSS SECTIONS I-44

IF A SEAL IS PRESENT ON THIS SHEET IT HAS BEEN ELECTRONICALLY SEALED AND DATED.

DISCLAIMER
 THE PROFESSIONAL WHOSE SIGNATURE AND PERSONAL SEAL APPEAR HEREON ASSUMES RESPONSIBILITY ONLY FOR WHAT APPEARS ON THIS PAGE, AND DISCLAIMS (PURSUANT TO SECTION 327.411 RSMO) SPECIFICATION, ESTIMATES, REPORTS, OR OTHER DOCUMENTS OR INSTRUMENTS NOT SEALED BY THE UNDERSIGNED PROFESSIONAL RELATING TO OR INTENDED TO BE USED FOR ANY PART OR PARTS OF THE PROJECT TO WHICH THIS PAGE REFERS.



THIS SHEET HAS BEEN SIGNED, SEALED AND DATED ELECTRONICALLY.

DATE PREPARED
 12/20/2024

ROUTE STATE
 CRD 127 MO

DISTRICT SHEET NO.
 SW 45

COUNTY
 GREENE

JOB NO.
 J8S3156

CONTRACT ID.

PROJECT NO.

BRIDGE NO.

GROUND IMPROVEMENTS	21.8 SF	10.2 CY
EXCAVATION	201.3 SF	77.2 CY
EMBANKMENT	3.5 SF	1.1 CY

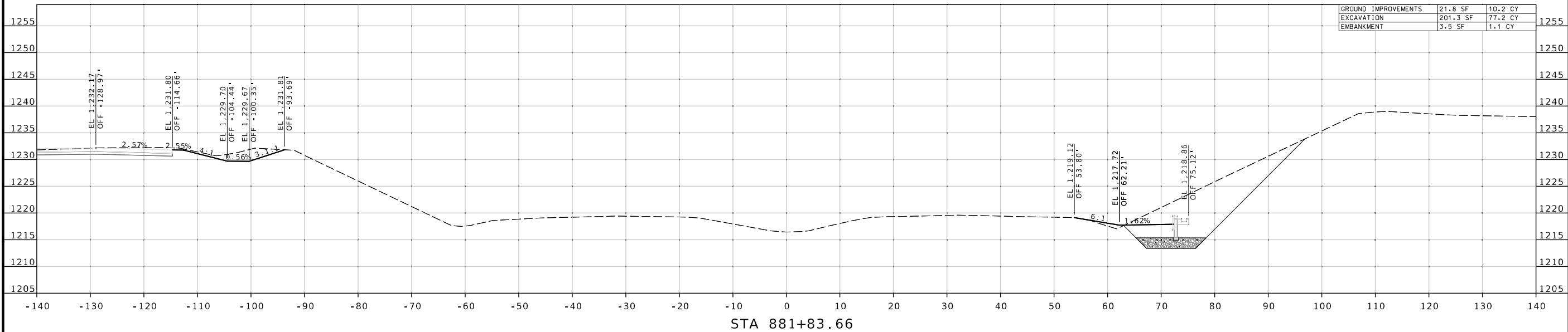

GROUND IMPROVEMENTS	41.7 SF	88.3 CY
EXCAVATION	279.8 SF	503.1 CY
EMBANKMENT	3.4 SF	18.2 CY

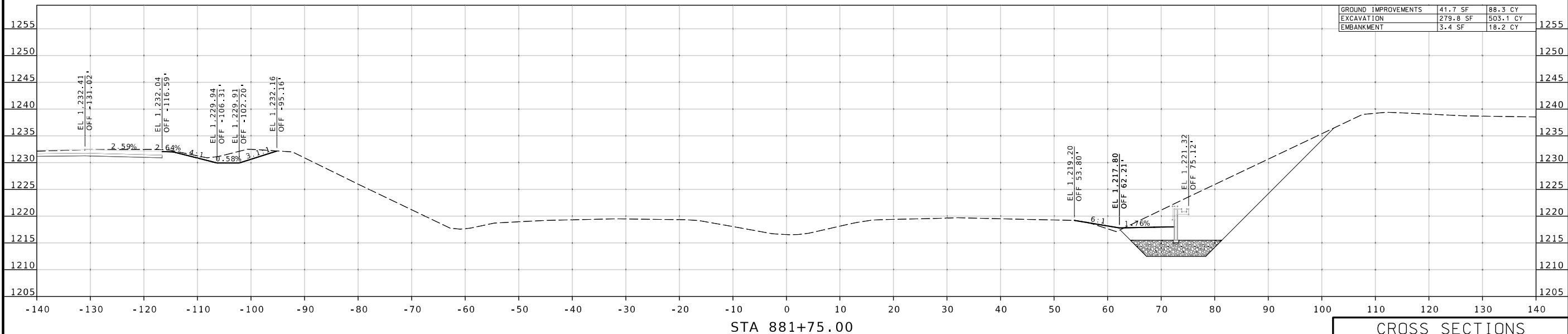

CROSS SECTIONS
 I-44

DESCRIPTION

DATE

MISSOURI HIGHWAYS AND TRANSPORTATION COMMISSION

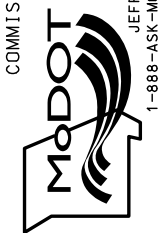

105 WEST CAPITOL
 JEFFERSON CITY, MO 65102
 1-888-ASK-MODOT (1-888-278-6636)



© Copyright CMT, Inc.
 CRAWFORD, MURPHY & TILLY, INC.
 651 WEST LINDALE STREET
 SPRINGFIELD, MO 65807 (417) 869-6009
 ENGINEERING CORPORATION - 000631

REV.