

A.A.D.T. - 2022 = 17,117
A.A.D.T. - 2042 = 17,899
D.H.V. = 10%
T = 4.7%
V = 35.45 M.P.H.
D = 50/50%

FUNCTIONAL CLASSIFICATION- PRINCIPAL ARTERIAL

CONVENTIONAL SYMBOLS

NOTE: DASHED OR OPEN SYMBOLS INDICATE
EXISTING FEATURES

[illegible]

DESCRIPTION	NUMBER
TITLE SHEET -----	1
TYPICAL SECTIONS (TS) (6 SHEETS)---	2
QUANTITIES (QU) (5 SHEETS)-----	3
PLAN SHEETS (PP)-----	4-22
SPECIAL SHEETS (SS)-----	23
TRAFFIC CONTROL SHEETS (TC)-----	24-32
SIGNING SHEETS (SN)-----	33-36

BEGINNING OF PROJECT	LM	0.018
END OF PROJECT	LM	4.477
APPARENT LENGTH	23,543.52	FEET
EQUATIONS AND EXCEPTIONS:		
RIDGE A5825 EXCEPTION:		
LM 0.575 TO LM 0.635	316.80	FEET

TOTAL CORRECTIONS	-316.80	FEET
NET LENGTH OF PROJECT	23,226.72	FEET
STATE LENGTH	4.399	MILES
FOR INFORMATION ONLY		
ESTIMATED DISTURBED ACRES	0	ACRES

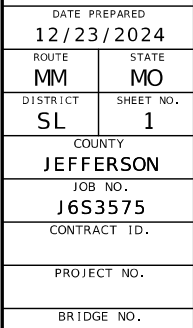
[illegible]

MISSOURI HIGHWAYS AND TRANSPORTATION
COMMISSION

105 WEST CAPITOL
JEFFERSON CITY, MO 65102
1-888-ASK-MODOT (1-888-275-6636)

TITLE SHEET

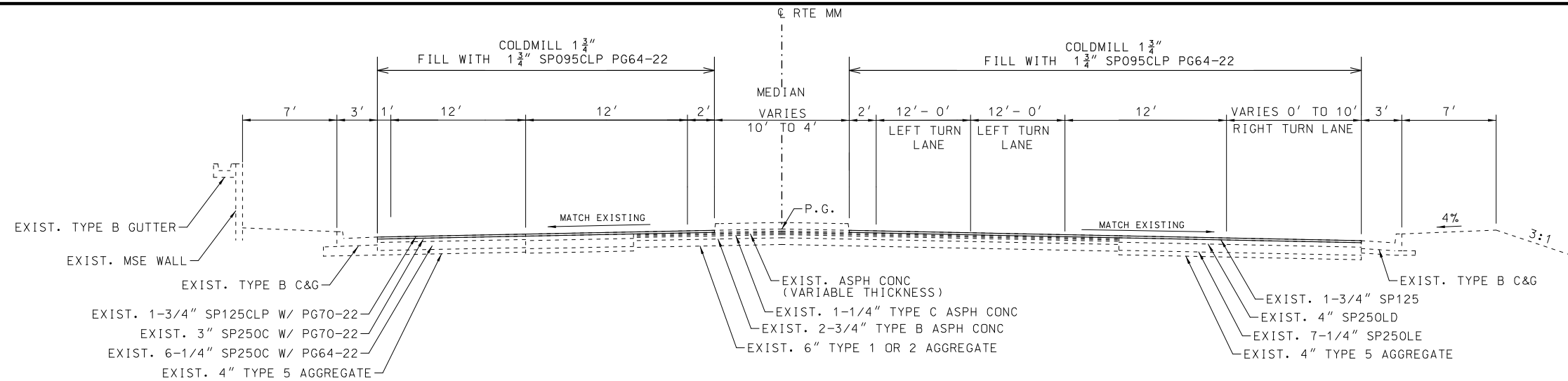

TYPICAL SECTION
RTE. MM
LOG MILE 0.018 TO LOG MILE 0.135

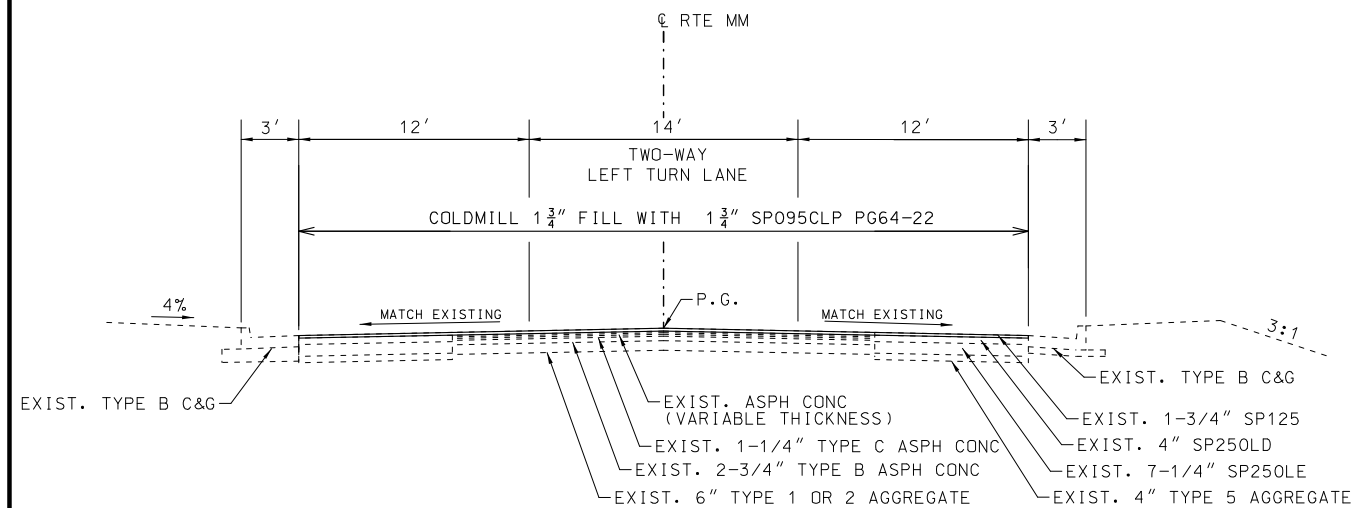

TYPICAL SECTION
RTE. MM
LOG MILE 0.135 TO LOG MILE 0.575
LOG MILE 0.635 TO LOG MILE 0.741

BRIDGE A5825 EXCEPTION
LOG MILE 0.575 TO LOG MILE 0.635

DISCLAIMER
 THE PROFESSIONAL WHOSE SIGNATURE AND PERSONAL SEAL APPEAR HEREON ASSUMES RESPONSIBILITY ONLY FOR WHAT APPEARS ON THIS PAGE, AND DISCLAIMS (PURSUANT TO SECTION 327.411 RSMO) SPECIFICATION, ESTIMATES, REPORTS, OR OTHER DOCUMENTS OR INSTRUMENTS NOT SEALED BY THE UNDERSIGNED PROFESSIONAL RELATING TO OR INTENDED TO BE USED FOR ANY PART OR PARTS OF THE PROJECT TO WHICH THIS PAGE REFERS.

APPLICATION RATES	
SP095CLP W/PG 64-22	= 1.950 TONS/CY
BP-1 W/PG 64-22	= 1.96 TONS/CY
TACK COAT	= 0.10 GAL/SY

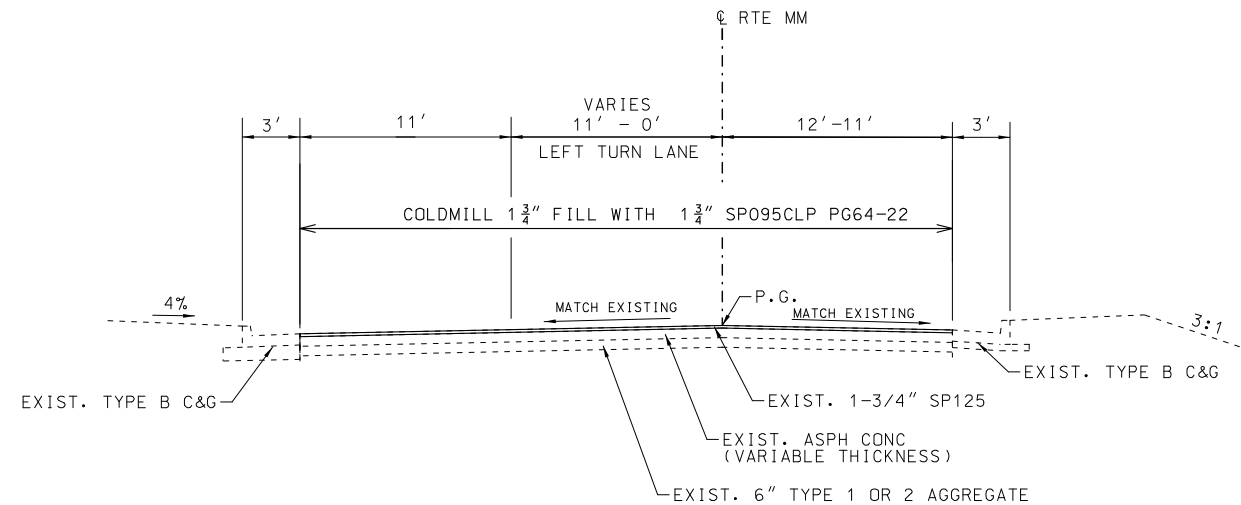

TYPICAL SECTION
RTE. MM
LOG MILE 0.741 TO LOG MILE 0.815

NOT TO SCALE

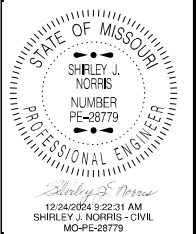

DATE PREPARED
12/23/2024

ROUTE **MM** STATE **MO**

DISTRICT **SL** SHEET NO. **2**

COUNTY
JEFFERSON

JOB NO.
J6S3575

CONTRACT ID.

PROJECT NO.

BRIDGE NO.

DESCRIPTION	DATE

MISSOURI HIGHWAYS AND TRANSPORTATION COMMISSION

MoDOT

105 WEST CAPITOL
 JEFFERSON CITY, MO 65102
 1-888-ASK-MODOT (1-888-275-6636)



DISCLAIMER

THE PROFESSIONAL WHOSE SIGNATURE AND PERSONAL SEAL APPEAR HEREON ASSUMES RESPONSIBILITY ONLY FOR WHAT APPEARS ON THIS PAGE, AND DISCLAIMS (PURSUANT TO SECTION 327.411 RSMO) SPECIFICATION, ESTIMATES, REPORTS, OR OTHER DOCUMENTS OR INSTRUMENTS NOT SEALED BY THE UNDERSIGNED PROFESSIONAL RELATING TO OR INTENDED TO BE USED FOR ANY PART OR PARTS OF THE PROJECT TO WHICH THIS PAGE REFERS.

NOT TO SCALE

MISSOURI HIGHWAYS AND TRANSPORTATION
COMMISSION

105 WEST CAPITAL
JEFFERSON CITY, MO 65102
1-888-ASK-MODOT (1-888-275-6636)

TYPICAL SECTION SHEET
SHEET 4 OF 6

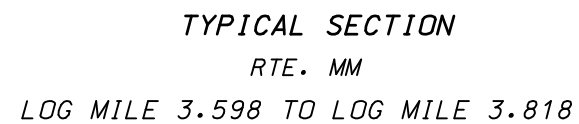
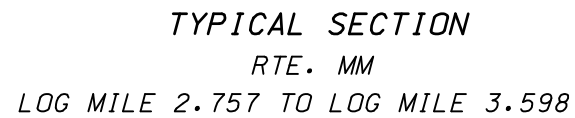

NOT TO SCALE



PAVEMENT													
PLAN SHEET NO.	LOG MILE	LOG MILE	ROADWAY	(MAINLINE) AREA	(SHOULDER) AREA	(MAINLINE) AREA	(SHOULDER) AREA	LINE: XXXX (MAINLINE) 1.75" SP095CLP W/ PG 64-22 (TON)	LINE: XXXX (SHOULDER) 1.75" BP-1 W/ PG 64-22 (TON)	LINE: XXXX TACK COAT FOR 1.75" SP095CLP (GAL)	LINE: XXXX TACK COAT FOR 1.75" BP-1 (GAL)	LINE: XXXX COLDMILLING BITUMINOUS PAVEMENT (3 IN. THICK OR LESS) (S.Y.)	REMARKS
				S.F.	S.F.	S.Y.	S.Y.						
4	0.018	0.246	ROUTE MM	64,579	-	7,175	-	680.2	-	717.5	-	7175.0	
5	0.246	0.490	ROUTE MM	56,171	-	6,241	-	591.6	-	624.1	-	6241.0	
6	0.490	0.740	ROUTE MM	62,358	-	6,929	-	656.8	-	692.9	-	6929.0	BRIDGE A5825 EXCEPTION
7	0.740	0.985	ROUTE MM	44,749	10,880	4,972	1,209	471.3	115.2	497.2	120.9	6181.0	
8	0.985	1.230	ROUTE MM	36,588	13,527	4,065	1,503	385.4	143.2	406.5	150.3	5568.0	
9	1.230	1.480	ROUTE MM	38,907	14,351	4,323	1,595	409.8	151.9	432.3	159.5	5918.0	
10	1.480	1.725	ROUTE MM	45,028	11,637	5,003	1,293	474.3	123.2	500.3	129.3	6296.0	
11	1.725	1.970	ROUTE MM	32,860	15,474	3,651	1,719	346.1	163.8	365.1	171.9	5370.0	
12	1.970	2.215	ROUTE MM	33,176	13,689	3,686	1,521	349.4	144.9	368.6	152.1	5207.0	
13	2.215	2.465	ROUTE MM	33,726	12,932	3,747	1,437	355.2	136.9	374.7	143.7	5184.0	
14	2.465	2.710	ROUTE MM	45,966	12,833	5,107	1,426	484.1	135.9	510.7	142.6	6533.0	
15	2.710	2.955	ROUTE MM	35,200	12,052	3,911	1,339	370.7	127.6	391.1	133.9	5250.0	
16	2.955	3.200	ROUTE MM	33,017	12,550	3,669	1,394	347.7	132.9	366.9	139.4	5063.0	
17	3.200	3.450	ROUTE MM	33,595	15,095	3,733	1,677	353.8	159.8	373.3	167.7	5410.0	
18	3.450	3.690	ROUTE MM	36,002	15,484	4,000	1,720	379.2	163.9	400.0	172.0	5720.0	
19	3.690	3.940	ROUTE MM	39,181	13,827	4,353	1,536	412.7	146.4	435.3	153.6	5889.0	
20	3.940	4.185	ROUTE MM	33,209	15,148	3,690	1,683	349.8	160.4	369.0	168.3	5373.0	
21	4.185	4.435	ROUTE MM	34,793	8,407	3,866	934	366.5	89.0	386.6	93.4	4800.0	
22	4.435	4.477	ROUTE MM	3,938	-	438	-	41.5	-	43.8	-	438.0	
ALL	0.018	4.477	ROUTE MM	74,304	19,789	8,256	2,199	782.6	209.5	26.7	26.7		Pavement Edge Treatment
ALL	0.018	4.477	ROUTE MM	74,304	19,789	8,256	2,199	782.6	209.5	825.6	219.9		10% for irregularities
								9391.3	2514.0	9108.2	2445.2	104545.0	
							PAY TOTAL	9391	2514	11553		104545	

PERMANENT PAVEMENT MARKINGS															
PLAN SHEET NO. LOG MILE LOG MILE ROADWAY				HIGH BUILD WATERBORNE PAVEMENT MARKING PAINT (TYPE L BEADS)				STANDARD WATERBORNE PAVEMENT MARKING PAINT (TYPE P BEADS)	PREFORMED THERMOPLASTIC PAVEMENT MARKINGS					PAVEMENT MARKING REMOVAL	REMARKS
				LINE: XXXX	LINE: XXXX	LINE: XXXX		LINE: XXXX		LINE: XXXX	LINE: XXXX	LINE: XXXX		LINE: XXXX	
				6" SOLID WHITE (L.F.)	6" INTERM. WHITE (L.F.)	4" SOLID YELLOW (L.F.)	4" INTERM. YELLOW (L.F.)	24" SOLID YELLOW (L.F.)	6" SOLID WHITE (L.F.)	24" SOLID WHITE STOP BAR (L.F.)	"ONLY" (EACH)	LEFT ARROW (EACH)	RIGHT ARROW (EACH)	PAVEMENT MARKING REMOVAL PAINT (L.F.)	
4	0.018	0.2462	MM	2901.0	297.0	2367.0	1189.0			36	2	7	3		
5	0.2462	0.490	MM	1408.0		2574.0	2574.0					6			
6	0.490	0.740	MM	2264.0		1893.0	1418.0		210.0	24		4			
6 - 7		MAIN ST/HILLSBORO-HOUSE SPRINGS RD		300.0		112.0			163.0	36				36	
7	0.740	0.985	MM	2610.0		3096.0		52.0		24		2			
8	0.985	1.230	MM	2381.0		3516.0		49.0							
9	1.230	1.480	MM	2739.0		3356.0		48.0				2			
10	1.480	1.725	MM	2608.0		3158.0	704.0	59.0				4			
11	1.725	1.970	MM	2588.0		2588.0									
12	1.970	2.215	MM	2588.0		2588.0									
13	2.215	2.465	MM	2503.0		2588.0									
14	2.465	2.710	MM	3099.0		2948.0		43.0				4			
15	2.710	2.955	MM	2539.0		3170.0		55.0							
16	2.955	3.200	MM	2376.0		2588.0									
17	3.200	3.450	MM	2483.0		2588.0									
18	3.450	3.690	MM	2388.0		2924.0		31.0				1			
19	3.690	3.940	MM	2711.0		3384.0		47.0				1			
20	3.940	4.185	MM	2418.0		2588.0									
21	4.185	4.435	MM	2037.0	454.0	1836.0									
22	4.435	4.477	MM	146.0											
				SUBTOTALS	44941	751	50008	5885	384	373	120	2	31	3	36
				PAY TOTALS	45129		51479		384	373	120	2	34		36

DISCLAIMER
THE PROFESSIONAL WHOSE SIGNATURE AND PERSONAL SEAL APPEAR HEREON ASSUMES RESPONSIBILITY ONLY FOR WHAT APPEARS ON THIS PAGE, AND DISCLAIMS (PURSUANT TO SECTION 327.411 RSMO) SPECIFICATION, ESTIMATES, REPORTS, OR OTHER DOCUMENTS OR INSTRUMENTS NOT SEALED BY THE UNDERSIGNED PROFESSIONAL RELATING TO OR INTENDED TO BE USED FOR ANY PART OR PARTS OF THE PROJECT TO WHICH THIS PAGE REFERS.



DATE PREPARED 12/24/2024	
ROUTE MM	STATE MO
DISTRICT SL	SHEET NO. 3
COUNTY JEFFERSON	
JOB NO. J6S3575	
CONTRACT ID.	

PROJECT NO.
BRIDGE NO.

DESCRIPTION	DATE								

MISSOURI HIGHWAYS AND TRANSPORTATION COMMISSION

105 WEST CAPITOL
JEFFERSON CITY, MO 65102
1-888-ASK-MODOT (1-888-275-6636)

GUARDRAIL											
PLAN SHEET NO.	ROADWAY	LOG MILE	LOG MILE	LOCATION	LINE: XXXX	LINE: XXXX	LINE: XXXX	LINE: XXXX	LINE: XXXX	LINE: XXXX	REMARKS
					MGS GUARDRAIL (L.F.)	MGS CRASHWORTHY END TERMINAL (EACH)	MGS END ANCHOR (EACH)	ROADSIDE GUARD CABLE 3-STRAND (16 T. POST SPACING) (L.F)	ANCHOR ASSEMBLY GUARD CABLE 3- STRAND TO GUARDRAIL TRANSITION (EACH)	ANCHOR ASSEMBLY GUARD CABLE 3-STRAND (EACH)	
4	ROUTE MM	0.0000	0.0850	RT	362.5	2					
4	ROUTE MM	0.1030	0.1470	LT	187.5	1	1				
10	ROUTE MM	1.4950	1.5420	LT	150.0	2					
10	ROUTE MM	1.4830	1.5160	RT	75.0	2					
10	ROUTE MM	1.6100	1.7100	RT	475.0	2					
11	ROUTE MM	1.7380	1.8040	RT				368		2	
12	ROUTE MM	1.9840	2.0810	RT	412.5	2					
13	ROUTE MM	2.2770	2.3860	RT	475.0	2					
15	ROUTE MM	2.8110	2.8800	RT	262.5	2					
15	ROUTE MM	2.9030	2.9550	RT	175.0	2					
16	ROUTE MM	3.0720	3.0920	LT	75.0	1	1				
17	ROUTE MM	3.2020	3.3110	RT	500.0	1		92.5	1	1	
17	ROUTE MM	3.2970	3.3090	LT	112.5	2					
17-18	ROUTE MM	3.3700	3.4520	RT	337.5	2					
18	ROUTE MM	3.4720	3.5240	RT	175.0	2					
19	ROUTE MM	3.8120	3.9020	LT	62.5	2					
19-20	ROUTE MM	3.9220	3.9990	RT	300.0	2					
20	ROUTE MM	3.9440	3.9730	LT	62.5	2					
20	ROUTE MM	3.9850	4.0240	LT	162.5	1	1				
21-22	ROUTE MM	4.4080	4.5430	RT	625.0	1	1				
				SUB TOTALS	4987.5	33.0	4.0	460.5	1.0	3.0	
				PAY TOTALS	4988	33	4	461	1	3	

CONCRETE SIDEWALK - CURB RAMPS						
PLAN SHEET NO.	ROADWAY	LOCATION	LINE: XXXX	LINE: XXXX	LINE: XXXX	LINE: XXXX
			4" CONCRETE SIDEWALK (S.Y.)	4" TYPE 5 AGGR. BASE (S.Y.)	CONCRETE CURB RAMP	
					TRUNCATED DOMES (S.F.)	MODIFIED COMPOUND PERPENDICULAR CURB RAMP (S.Y.)
23	MM	NE QUADRANT	13.2	13.2	11	19.3
			SUB TOTALS	13.2	11	19.3
			PAY TOTALS	13.2	11	19.3

PARTIAL DEPTH PAVEMENT REPAIRS					
ROUTE	REPAIR THICKNESS (IN)	AREA (SF)	VOLUME (CY)	FURNISHING AND PLACING BITUMINOUS MATERIAL FOR CLASS C PARTIAL DEPTH PAVEMENT REPAIR	REMOVALS FOR CLASS C PARTIAL DEPTH PAVEMENT REPAIR
				TONS	SY
				ROUTE MM	4
TOTAL				1656.92	7647.67
PAY TOTAL				1656.9	7647.7

DISCLAIMER
THE PROFESSIONAL WHOSE SIGNATURE AND PERSONAL SEAL APPEAR HEREON ASSUMES RESPONSIBILITY ONLY FOR WHAT APPEARS ON THIS PAGE, AND DISCLAIMS (PURSUANT TO SECTION 327.411 RSMO) SPECIFICATION, ESTIMATES, REPORTS, OR OTHER DOCUMENTS OR INSTRUMENTS NOT SEALED BY THE UNDERSIGNED PROFESSIONAL RELATING TO OR INTENDED TO BE USED FOR ANY PART OR PARTS OF THE PROJECT TO WHICH THIS PAGE REFERS.

STATE OF MISSOURI

SHIRLEY J. NORRIS

NUMBER PE-28779

PROFESSIONAL ENGINEER

Shirley J. Norris

01/30/2025 2:18:03 PM

SHIRLEY J. NORRIS - CIVIL

MO-PE-28779

DATE PREPARED

1/29/2025

ROUTE

MM

DISTRICT

SL

STATE

MO

SHEET NO.

3

COUNTY

JEFFERSON

JOB NO.

J6S3575

CONTRACT ID.

PROJECT NO.

BRIDGE NO.

DESCRIPTION

DATE

MISSOURI HIGHWAYS AND TRANSPORTATION COMMISSION

MoDOT

105 WEST CAPITOL

JEFFERSON CITY, MO 65102

1-888-ASK-MODOT (1-888-275-6636)

QUANTITY SHEET

SHEET 2 OF 5

INDUCTION LOOPS						
SHEET NO.	FROM	TO	ROADWAY	LINE: XXXX	LINE: XXXX	REMARKS
				CABLE LOOP DETECTOR IN-DUCT (LF)	CONDUIT 1 IN., LOOP DETECTOR WITH TRACER WIRE (LF)	
4			RTE. MM	576.00		REPLACE 6' X 30' LOOP
4			RTE. MM	576.00		REPLACE 6' X 30' LOOP
4			RTE. MM	576.00		REPLACE 6' X 30' LOOP
23	EX PB 1	DETECTOR 50	RTE. MM	218.00	14.00	REINSTALL 6' X 15' LOOP
23	EX PB 1	DETECTOR 21	RTE. MM	188.00	13.00	REINSTALL 6' X 15' LOOP
23	EX PB 1	DETECTOR 51	RTE. MM	182.00	15.00	REINSTALL 6' X 6' LOOP
23	EX PB 1	DETECTOR 22	RTE. MM	124.00	17.00	REINSTALL 6' X 6' LOOP
23	EX PB 7	DETECTOR 80	MAIN ST	196.00	5.00	REINSTALL 6' X 15' LOOP
23	EX PB 7	DETECTOR 81	MAIN ST	104.00	7.00	REINSTALL 6' X 6' LOOP
23	EX PB 8	DETECTOR 61	RTE. MM	172.00	9.00	REINSTALL 6' X 15' LOOP
23	EX PB 8	DETECTOR 10	RTE. MM	192.00	9.00	REINSTALL 6' X 15' LOOP
23	EX PB 8	DETECTOR 62	RTE. MM	126.00	10.00	REINSTALL 6' X 6' LOOP
23	EX PB 8	DETECTOR 11	RTE. MM	154.00	9.00	REINSTALL 6' X 6' LOOP
23	EX PB 9	DETECTOR 40	HHS RD	182.00	15.00	REINSTALL 6' X 15' LOOP
23	EX PB 9	DETECTOR 41	HHS RD	116.00	21.00	REINSTALL 6' X 6' LOOP
				SUB TOTAL	3682.00	144.00
				SUB TOTAL	184	5% FOR SNAKING
				PAY TOTAL	3870.0	144.0

AUDIBLE PED PUSH BUTTON						
SHEET NO.	POST #	ROADWAY	LOCATION	LINE: XXXX	LINE: XXXX	REMARKS
				REMOVE EXIST. PRESSURE ACTIVATED PED PUSH BUTTON (EA)	REPLACE WITH NEW AUDIBLE PED SIGNAL PUSH BUTTON (EA)	
23	5	HHS RD	SW QUADRANT	1	1	
23	6	RTE. MM	SW QUADRANT	1	1	
23	7	RTE. MM	NW QUADRANT	1	1	
23	8	MAIN ST	NW QUADRANT	1	1	
23	9	MAIN ST	NE QUADRANT	1	1	
23	10	RTE. MM	NE QUADRANT	1	1	
23	11	RTE. MM	SE QUADRANT	1	1	
23	12	HHS RD	SE QUADRANT	1	1	
				SUB TOTAL	8	
				PAY TOTAL	LUMP SUM*	8

RUMBLE STRIPS								
PLAN SHEET NO.	ROADWAY	BEGIN STATION	END STATION					REMARKS
				BITUMINOUS SHOULDER RUMBLE STRIP (LF)	BITUMINOUS SHOULDER RUMBLE STRIP (STA)	BITUMINOUS CENTERLINE RUMBLE STRIP (LF)	BITUMINOUS CENTERLINE RUMBLE STRIP (STA)	
7	ROUTE MM	0.740	0.985	764.0	8	322	3	NO RUMBLE STRIPS BEFORE PLAN SHEET 7
8	ROUTE MM	0.985	1.23	1623.0	16	802	8	
9	ROUTE MM	1.230	1.48	1756.0	18	711	7	
10	ROUTE MM	1.480	1.725	1958.0	20	38	0	
11	ROUTE MM	1.725	1.97	1671.0	17	1292	13	
12	ROUTE MM	1.970	2.215	2456.0	25	1296	13	
13	ROUTE MM	2.215	2.465	2261.0	23	1320	13	
14	ROUTE MM	2.465	2.71	2003.0	20	38	0	
15	ROUTE MM	2.710	2.955	2208.0	22	820	8	
16	ROUTE MM	2.955	3.2	1617.0	16	1296	13	
17	ROUTE MM	3.200	3.45	1855.0	19	1320	13	
18	ROUTE MM	3.450	3.69	1680.0	17	828	8	
19	ROUTE MM	3.690	3.94	2160.0	22	660	7	
20	ROUTE MM	3.940	4.185	2244.0	22	1296	13	
21	ROUTE MM	4.185	4.435	864.0	9	780	8	
22	ROUTE MM	4.435	4.477	0.0	0	0	0	
				TOTAL	274		127	
				PAY TOTAL	274		127	

DISCLAIMER
THE PROFESSIONAL WHOSE SIGNATURE AND PERSONAL SEAL APPEAR HEREON ASSUMES RESPONSIBILITY ONLY FOR WHAT APPEARS ON THIS PAGE, AND DISCLAIMS (PURSUANT TO SECTION 327.411 RSMO) SPECIFICATION, ESTIMATES, REPORTS, OR OTHER DOCUMENTS OR INSTRUMENTS NOT SEALED BY THE UNDERSIGNED PROFESSIONAL RELATING TO OR INTENDED TO BE USED FOR ANY PART OR PARTS OF THE PROJECT TO WHICH THIS PAGE REFERS.

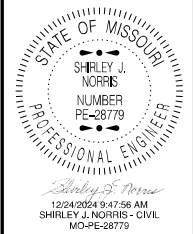

DATE PREPARED 12/24/2024	
ROUTE MO	STATE MO
DISTRICT SL	SHEET NO. 3
COUNTY JEFFERSON	
JOB NO. J6S3575	
CONTRACT ID.	

PROJECT NO.
BRIDGE NO.

DESCRIPTION	DATE								

MISSOURI HIGHWAYS AND TRANSPORTATION COMMISSION



105 WEST CAPITOL
JEFFERSON CITY, MO 65102
1-888-ASK-MODOT (1-888-275-6636)

WARNING SIGNS									GUIDE SIGNS									REGULATORY SIGNS									MISCELLANEOUS SIGNS								
WO1-1L	48X48	16.00						TURN (SYMBOL LEFT)	E05-1	36X48	12.00						GORE EXIT	6122008		IMPACT ATTENUATOR 40 MPH (SAND BARRELS)															
WO1-1R	48X48	16.00						TURN (SYMBOL RIGHT)	E05-2	48X36	12.00						EXIT OPEN	6122009		IMPACT ATTENUATOR 45 MPH (SAND BARRELS)															
WO1-2L	48X48	16.00						CURVE (SYMBOL LEFT)	E05-2a	48X36	12.00						EXIT CLOSED	6122010		IMPACT ATTENUATOR 50 MPH (SAND BARRELS)															
WO1-2R	48X48	16.00						CURVE (SYMBOL RIGHT)	GO20-1	60X24	10.00	2	20.00			1	ROAD WORK NEXT 4.4 MILES	6122012		IMPACT ATTENUATOR 55 MPH (SAND BARRELS)															
WO1-3L	48X48	16.00						REVERSE TURN (SYMBOL LEFT)	GO20-2	48X24	8.00	2	16.00			26	END ROAD WORK	6122014		IMPACT ATTENUATOR 60 MPH (SAND BARRELS)															
WO1-3R	48X48	16.00						REVERSE TURN (SYMBOL RIGHT)	GO20-4	36X18	4.50						PILOT CAR FOLLOW ME	6122017		IMPACT ATTENUATOR 65 MPH (SAND BARRELS)															
WO1-4L	48X48	16.00						REVERSE CURVE (SYMBOL LEFT)	GO20-4a	42X30	8.75	4	35.00			58	PILOT CAR IN USE WAIT & FOLLOW	6122019		IMPACT ATTENUATOR 70 MPH (SAND BARRELS)															
WO1-4R	48X48	16.00						REVERSE CURVE (SYMBOL RIGHT)	GO20-4a	24X18	1.50	19	28.50			60	PILOT CAR IN USE WAIT & FOLLOW	6122020		REPLACEMENT SAND BARREL															
WO1-4bL	48X48	16.00						DOUBLE ARROW REVERSE CURVE (SYMBOL LEFT)	GO20-5aP	36X24	6.00	2	12.00			54	WORK ZONE (PLAQUE)	6122030		IMPACT ATTENUATOR (RELOCATION)															
WO1-4bR	48X48	16.00						DOUBLE ARROW REVERSE CURVE (SYMBOL RIGHT)	MO4-8a	24X18	3.00						END DETOUR	6123001	1***	TRUCK MOUNTED ATTENUATOR (TMA)															
WO1-4cL	48X48	16.00						TRIPLE ARROW REVERSE CURVE (SYMBOL LEFT)	MO4-9L	48X36	12.00						DETOUR (LEFT)	6161008	2	ADVANCED WARNING RAIL SYSTEM															
WO1-4cR	48X48	16.00						TRIPLE ARROW REVERSE CURVE (SYMBOL RIGHT)	MO4-9R	48X36	12.00						DETOUR (RIGHT)	6161012		BUOYS (BOATS KEEP OUT)															
WO1-6	60X30	12.50						HORIZONTAL ARROW (SYMBOL)	MO4-9P	48X12	4.00						STREET NAME (PLAQUE)	6161013		BUOYS (NO WAKE)															
WO1-6a	72X36	18.00						HORIZ. ARROW (SYMBOL ON PERMANENT BARRICADE)	MO4-10L	48X18	6.00						DETOUR ARROW (LEFT)	6161014		SPECIAL SIGN ASSEMBLY (BOATS KEEP OUT)															
WO1-7	60X30	12.50						DOUBLE HEAD HORIZONTAL ARROW (SYMBOL)	MO4-10R	48X18	6.00						DETOUR ARROW (RIGHT)	6161025	86	CHANNELIZER (TRIM LINE)															
WO1-7a	72X36	18.00						DOUBLE HEAD HORIZ. ARROW (SYMBOL ON PERM. BARR.)	REGULATORY SIGNS									6161030	2	TYPE III MOVEABLE BARRICADE															
WO1-8	18X24	3.00						CHEVRON (SYMBOL)	R1-1	48X48	13.25						STOP	6161033		DIRECTION INDICATOR BARRICADE															
WO1-8a	30X36	7.50						CHEVRON (SYMBOL FOR DIVIDED HIGHWAYS)	R1-2	48TRI.	6.93						YIELD	6161040		FLASHING ARROW PANEL															
WO3-1	48X48	16.00						STOP AHEAD (SYMBOL)	R1-2a	36X36	9.00						TO ONCOMING TRAFFIC (PLAQUE)	6161047		TYPE III OBJECT MARKER															
WO3-2	48X48	16.00						YIELD AHEAD (SYMBOL)	R1-3P	30X12	2.50						ALL WAY (PLAQUE)	6161055		SEQUENTIAL FLASHING WARNING LIGHT															
WO3-3	48X48	16.00						SIGNAL AHEAD (SYMBOL)	R2-1	36X48	12.00	6	72.00				SPEED LIMIT 35 (4) 45 (2)	6161070		TUBULAR MARKER															
WO3-4	48X48	16.00	10	160.00			11	BE PREPARED TO STOP	R3-1	48X48	16.00						NO RIGHT TURN (SYMBOL)	6161095		RADAR SPEED ADVISORY SYSTEM															
WO3-5	48X48	16.00						SPEED LIMIT AHEAD	R3-2	48X48	16.00						NO LEFT TURN (SYMBOL)	6161096		CHANGEABLE MESSAGE SIGN, COMMISSION FURNISHED/RETAINED															
WO4-1L	48X48	16.00						MERGE (SYMBOL FROM LEFT)	R3-3	36X36	9.00						NO TURNS	6161098A	2**	CHANGEABLE MESSAGE SIGN WITHOUT COMM. INTERFACE- CONTRACTOR FURNISHED/RETAINED															
WO4-1R	48X48	16.00						MERGE (SYMBOL FROM RIGHT)	R3-4	48X48	16.00						NO U-TURN (SYMBOL)	6161099		CHANGEABLE MESSAGE SIGN WITH COMM. INTERFACE- CONTRACTOR FURNISHED/RETAINED															
WO4-1aL	48X48	16.00						MERGE (LEFT)	R3-7L	30X30	6.25						LEFT LANE MUST TURN LEFT	6162000A		WORK ZONE TRAFFIC SIGNAL SYSTEM															
WO4-1aR	48X48	16.00						MERGE (RIGHT)	R3-7R	30X30	6.25						RIGHT LANE MUST TURN RIGHT	6162002		TEMPORARY LONG-TERM RUMBLE STRIPS															
WO5-1	48X48	16.00						ROAD/BRIDGE/RAMP NARROWS	R4-1	36X48	12.00						DO NOT PASS	6173600D		TEMPORARY TRAFFIC BARRIER CONTRACTOR FURNISHED/RETAINED															
WO5-3	48X48	16.00						ONE LANE BRIDGE	R4-2	36X48	12.00						PASS WITH CARE	6173602B		CONTRACTOR FURNISHED/COMMISSION RETAINED															
WO5-5	48X48	16.00						NARROW LANES	R4-7a	36X48	12.00						KEEP RIGHT (HORIZONTAL ARROW)	6174000A		TEMP. TRAFFIC BARRIER HEIGHT TRANSITION															
WO6-1	48X48	16.00						DIVIDED HIGHWAY (SYMBOL)	R4-8a	36X48	12.00						KEEP LEFT (HORIZONTAL ARROW)	6175010A		RELOCATING TEMPORARY TRAFFIC BARRIER															
WO6-2	48X48	16.00						DIVIDED HIGHWAY END (SYMBOL)	R5-1	30X30	6.25						DO NOT ENTER	6176000B		TEMPORARY TRAFFIC BARRIER COMMISSION FURNISHED/RETAINED															
WO6-3	48X48	16.00						TWO WAY TRAFFIC (SYMBOL)	R5-1a	36X24	6.00						WRONG WAY	6177000B		TEMP. TRAFFIC BARRIER HEIGHT TRANSITION															
WO7-3a	30X24	5.00						NEXT XX MILES (PLAQUE)	R6-1L	54X18	6.75						ONE WAY ARROW (LEFT)	6208064A		TEMPORARY RAISED PAVEMENT MARKER															
WO8-1	48X48	16.00						BUMP	R6-1R	54X18	6.75						ONE WAY ARROW (RIGHT)	9029400		TEMPORARY TRAFFIC SIGNALS															
WO8-2	48X48	16.00						DIP	R6-2L	24X30	5.00						ONE WAY (LEFT)	9029401		TEMPORARY TRAFFIC SIGNALS AND LIGHTING															
WO8-3	48X48	16.00						PAVEMENT ENDS	R6-2R	24X30	5.00						ONE WAY (RIGHT)																		
WO8-4	48X48	16.00						SOFT SHOULDER	R9-9	24X12	2.00	1	2.00				SIDEWALK CLOSED																		
WO8-5	48X48	16.00						SLIPPERY WHEN WET (SYMBOL)	R9-11L	24X18	3.00	1	3.00				SIDEWALK CLOSED AHEAD, (ARROW LEFT) CROSS HERE																		
WO8-6	48X48	16.00						TRUCK CROSSING	R9-11R	24X18	3.00	1	3.00				SIDEWALK CLOSED AHEAD, (ARROW RIGHT) CROSS HERE																		
WO8-6c	48X48	16.00						TRUCK ENTRANCE	R10-6	24X36	6.00						STOP HERE ON RED (45° ARROW)																		
WO8-7	36X36	9.00						LOOSE GRAVEL	R11-2	48X30	10.00						ROAD CLOSED																		
WO8-7a	36X36	9.00						FRESH OIL / LOOSE GRAVEL	R11-3a	60X30	12.50						ROAD CLOSED XX MILES AHEAD																		
WO8-9	48X48	16.00						LOW SHOULDER	R11-4	60X30	12.50						LOCAL TRAFFIC ONLY																		
WO8-11	48X48	16.00	6	96.00			36	UNEVEN LANES	CONST-3A	60X48	20.00						ROAD CLOSED TO THRU TRAFFIC																		
WO8-12	48X48	16.00	6	96.00			35	NO CENTER LINE	CONST-3X	56X12	4.67						FINE SIGN																		
WO8-15	48X48	16.00						GROOVED PAVEMENT	MISCELLANEOUS SIGNS																										
WO8-15P	30X24	5.00						MOTORCYCLE (PLAQUE)	CONST-5	48X36	12.00						POINT OF PRESENCE																		
WO8-17L	48X48	16.00						SHOULDER DROP-OFF (SYMBOL LEFT)	CONST-5	96X48	32.00						POINT OF PRESENCE																		
WO8-17R	30X24	5.00						SHOULDER DROP-OFF (SYMBOL RIGHT)	CONST-8	48X36	12.00	2	24.00			57	WORK ZONE NO PHONE ZONE																		
W10-1	42RND.	9.62						RAILROAD CROSSING	W16-9P																										

ANY WORK INDICATED ON THE PLANS THAT EXTENDS BEYOND THE PROJECT LIMITS IS CONSIDERED INCIDENTAL TO AND A PART OF THE CONSTRUCTION OF THIS PROJECT.

CONTRACTOR IS RESPONSIBLE FOR LOCATING ALL UNDERGROUND UTILITIES. UTILITIES PLOTTED ARE APPROXIMATE ONLY. IT IS POSSIBLE THERE MAY BE OTHERS WHICH ARE NOT SHOWN ON PLANS.

SCALE



NOTES:

NO DIRECT PAY WILL BE MADE FOR ANY NECESSARY CLEARING AND GRUBBING.

PROJECT LOG MILES ARE BASED ON SB LOG MILES UNLESS OTHERWISE NOTED.

LEGEND

1.75" SP095CLP
W/ PG 64-22

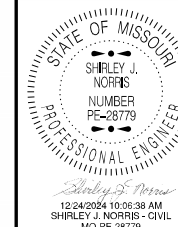

DATE PREPARED
12/24/2024

ROUTE STATE
MM MO

DISTRICT SHEET NO.
SL 4

COUNTY
JEFFERSON

JOB NO.
J6S3575

CONTRACT ID.

PROJECT NO.

BRIDGE NO.

DESCRIPTION

DATE

MISSOURI HIGHWAYS AND TRANSPORTATION
COMMISSION



105 WEST CAPITOL
JEFFERSON CITY, MO 65102
1-888-ASK-MODOT (1-888-275-6636)

PLAN SHEET
SHEET 1 OF 19

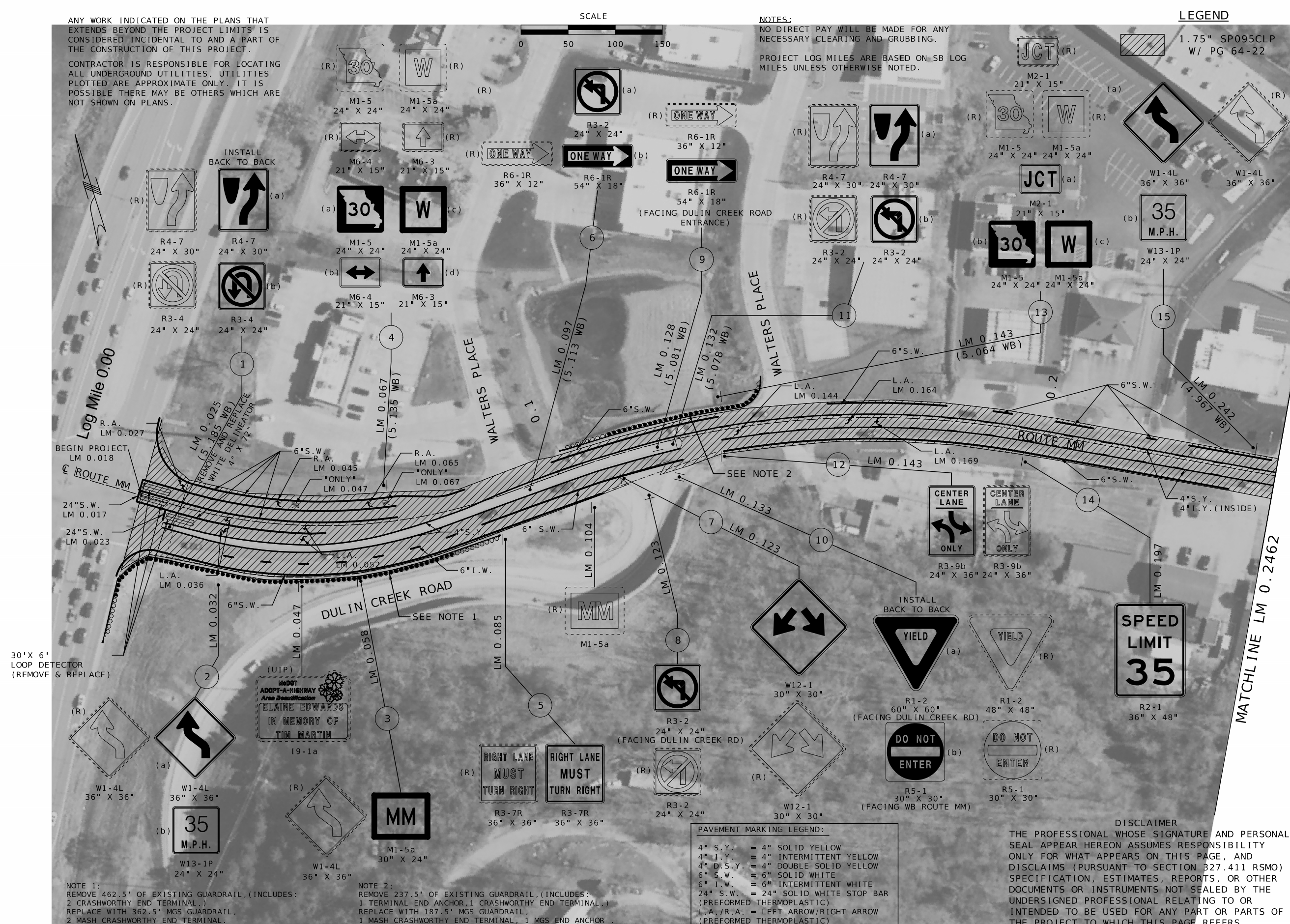

NOTE 1:
REMOVE 462.5' OF EXISTING GUARDRAIL, (INCLUDES:
2 CRASHWORTHY END TERMINAL.)
REPLACE WITH 362.5' MGS GUARDRAIL,
2 MASH CRASHWORTHY END TERMINAL.

NOTE 2:
REMOVE 237.5' OF EXISTING GUARDRAIL, (INCLUDES:
1 TERMINAL END ANCHOR, 1 CRASHWORTHY END TERMINAL.)
REPLACE WITH 187.5' MGS GUARDRAIL,
1 MASH CRASHWORTHY END TERMINAL, 1 MGS END ANCHOR.

PAVEMENT MARKING LEGEND:

4" S.Y. = 4" SOLID YELLOW
4" I.Y. = 4" INTERMITTENT YELLOW
4" D.S.Y. = 4" DOUBLE SOLID YELLOW
6" S.W. = 6" SOLID WHITE
6" I.W. = 6" INTERMITTENT WHITE
24" S.W. = 24" SOLID WHITE STOP BAR
(PREFORMED THERMOPLASTIC)
L.A./R.A. = LEFT ARROW/RIGHT ARROW
(PREFORMED THERMOPLASTIC)

DISCLAIMER

THE PROFESSIONAL WHOSE SIGNATURE AND PERSONAL SEAL APPEAR HEREON ASSUMES RESPONSIBILITY ONLY FOR WHAT APPEARS ON THIS PAGE, AND DISCLAIMS (PURSUANT TO SECTION 327.411 RSMO) SPECIFICATION, ESTIMATES, REPORTS, OR OTHER DOCUMENTS OR INSTRUMENTS NOT SEALED BY THE UNDERSIGNED PROFESSIONAL RELATING TO OR INTENDED TO BE USED FOR ANY PART OR PARTS OF THE PROJECT TO WHICH THIS PAGE REFERS.

DISCLAIMER
THE PROFESSIONAL WHOSE SIGNATURE AND PERSONAL SEAL APPEAR HEREON ASSUMES RESPONSIBILITY ONLY FOR WHAT APPEARS ON THIS PAGE, AND DISCLAIMS (PURSUANT TO SECTION 327.411 RSMO) SPECIFICATION, ESTIMATES, REPORTS, OR OTHER DOCUMENTS OR INSTRUMENTS NOT SEALED BY THE UNDERSIGNED PROFESSIONAL RELATING TO OR INTENDED TO BE USED FOR ANY PART OR PARTS OF THE PROJECT TO WHICH THIS PAGE REFERS.

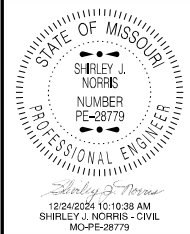

DATE PREPARED 12/24/2024	
ROUTE MM	STATE MO
DISTRICT SL	SHEET NO. 5
COUNTY JEFFERSON	
JOB NO. J6S3575	
CONTRACT ID.	
PROJECT NO.	
BRIDGE NO.	

DATE	DESCRIPTION

MISSOURI HIGHWAYS AND TRANSPORTATION COMMISSION

105 WEST CAPITOL
JEFFERSON CITY, MO 65102
1-888-ASK-MODOT (1-888-275-6636)



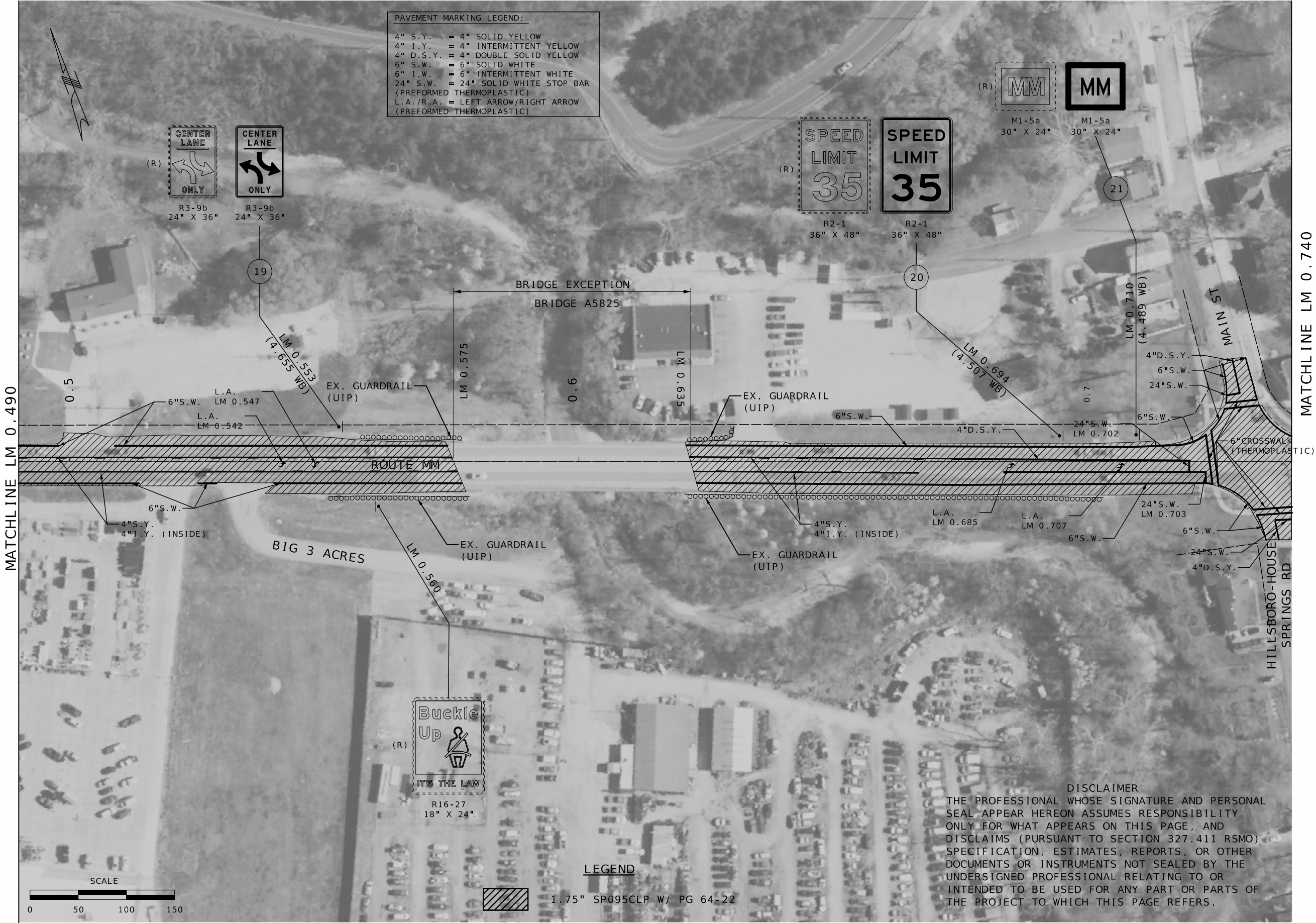

PAVEMENT MARKING LEGEND:

- 4" S.Y. = 4" SOLID YELLOW
- 4" I.Y. = 4" INTERMITTENT YELLOW
- 4" D.S.Y. = 4" DOUBLE SOLID YELLOW
- 6" S.W. = 6" SOLID WHITE
- 6" I.W. = 6" INTERMITTENT WHITE
- 24" S.W. = 24" SOLID WHITE STOP BAR (PREFORMED THERMOPLASTIC)
- L.A./R.A. = LEFT ARROW/RIGHT ARROW (PREFORMED THERMOPLASTIC)

LEGEND

1.75" SP095CLP W/ PG 64-22

DISCLAIMER

THE PROFESSIONAL WHOSE SIGNATURE AND PERSONAL SEAL APPEAR HEREON ASSUMES RESPONSIBILITY ONLY FOR WHAT APPEARS ON THIS PAGE, AND DISCLAIMS (PURSUANT TO SECTION 327.411 RSMO) SPECIFICATION, ESTIMATES, REPORTS, OR OTHER DOCUMENTS OR INSTRUMENTS NOT SEALED BY THE UNDERSIGNED PROFESSIONAL RELATING TO OR INTENDED TO BE USED FOR ANY PART OR PARTS OF THE PROJECT TO WHICH THIS PAGE REFERS.



DATE PREPARED
12/24/2024 10:14:19 AM
SHIRLEY J. NORRIS - CIVIL
MO-PE-28779

DATE PREPARED 12/24/2024	
ROUTE MM	STATE MO
DISTRICT SL	SHEET NO. 6
COUNTY JEFFERSON	
JOB NO. J6S3575	
CONTRACT ID.	

PROJECT NO.

BRIDGE NO.

DATE	DESCRIPTION

MISSOURI HIGHWAYS AND TRANSPORTATION COMMISSION

105 WEST CAPITOL
JEFFERSON CITY, MO 65102
1-888-ASK-MODOT (1-888-275-6636)

DATE PREPARED	
12/24/2024	
ROUTE	STATE
MM	MO
DISTRICT	SHEET #
SL	7
COUNTY	
JEFFERSON	
JOB NO.	
J6S3575	
CONTRACT ID.	

PROJECT NO.
BRIDGE NO.

[illegible]

MISSOURI HIGHWAYS AND TRANSPORTATION
COMMISSION

105 WEST CAPITOL
JEFFERSON CITY, MO. 65102

PLAN SHEET
SHEET 4 OF 19

PAVEMENT MARKING LEGEND:	
4" S.Y.	= 4" SOLID YELLOW
4" I.Y.	= 4" INTERMITTENT YELLOW
4" D.S.Y.	= 4" DOUBLE SOLID YELLOW
6" S.W.	= 6" SOLID WHITE
6" I.W.	= 6" INTERMITTENT WHITE
24" S.W.	= 24" SOLID WHITE STOP BAR (PREFORMED THERMOPLASTIC)
L.A./R.A.	= LEFT ARROW/RIGHT ARROW (PREFORMED THERMOPLASTIC)

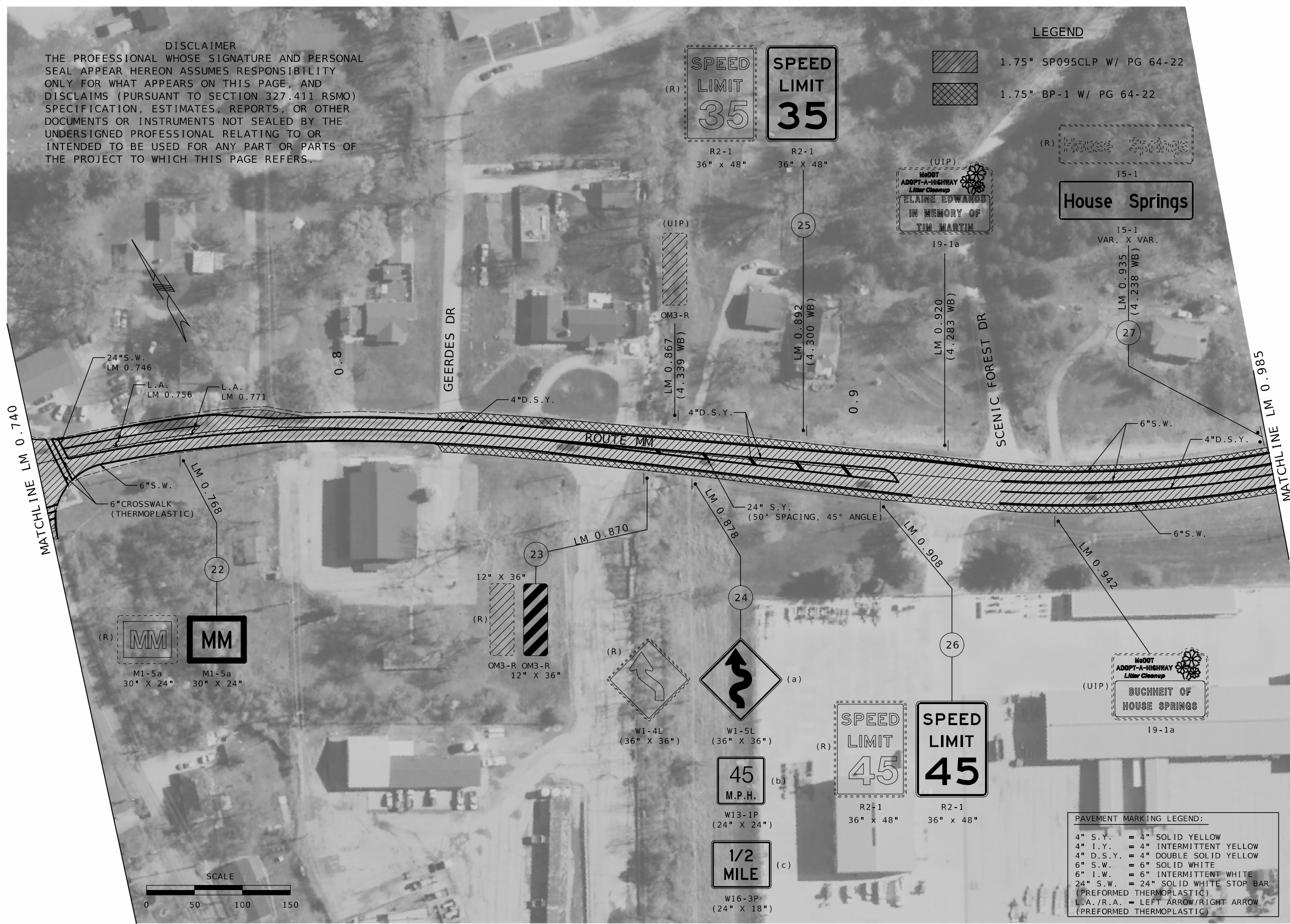



PAVEMENT MARKING LEGEND:	
4" S.Y.	= 4" SOLID YELLOW
4" I.Y.	= 4" INTERMITTENT YELLOW
4" D.S.Y.	= 4" DOUBLE SOLID YELLOW
6" S.W.	= 6" SOLID WHITE
6" I.W.	= 6" INTERMITTENT WHITE
24" S.W.	= 24" SOLID WHITE STOP BAR (PREFORMED THERMOPLASTIC)
L.A./R.A.	= LEFT ARROW/RIGHT ARROW (PREFORMED THERMOPLASTIC)

LEGEND	
	1.75" SP095CLP W/ PG 64-22
	1.75" BP-1 W/ PG 64-22

DISCLAIMER
THE PROFESSIONAL WHOSE SIGNATURE AND PERSONAL SEAL APPEAR HEREON ASSUMES RESPONSIBILITY ONLY FOR WHAT APPEARS ON THIS PAGE, AND DISCLAIMS (PURSUANT TO SECTION 327.411 RSMO) SPECIFICATION, ESTIMATES, REPORTS, OR OTHER DOCUMENTS OR INSTRUMENTS NOT SEALED BY THE UNDERSIGNED PROFESSIONAL RELATING TO OR INTENDED TO BE USED FOR ANY PART OR PARTS OF THE PROJECT TO WHICH THIS PAGE REFERS.

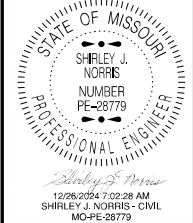

DATE PREPARED 12/24/2024	
ROUTE MM	STATE MO
DISTRICT SL	SHEET NO. 8
COUNTY JEFFERSON	
JOB NO. J6S3575	
CONTRACT ID.	
PROJECT NO.	
BRIDGE NO.	

DATE	DESCRIPTION

MISSOURI HIGHWAYS AND TRANSPORTATION COMMISSION

105 WEST CAPITOL
JEFFERSON CITY, MO 65102
1-888-ASK-MODOT (1-888-275-6636)



PAVEMENT MARKING LEGEND:	
4" S.Y.	= 4" SOLID YELLOW
4" I.Y.	= 4" INTERMITTENT YELLOW
4" D.S.Y.	= 4" DOUBLE SOLID YELLOW
6" S.W.	= 6" SOLID WHITE
6" I.W.	= 6" INTERMITTENT WHITE
24" S.W.	= 24" SOLID WHITE STOP BAR (PERFORMED THERMOPLASTIC)
L.A./R.A.	= LEFT ARROW/RIGHT ARROW (PERFORMED THERMOPLASTIC)

LEGEND	
	1.75" SP095CLP W/ PG 64-22
	1.75" BP-1 W/ PG 64-22

DISCLAIMER
THE PROFESSIONAL WHOSE SIGNATURE AND PERSONAL SEAL APPEAR HEREON ASSUMES RESPONSIBILITY ONLY FOR WHAT APPEARS ON THIS PAGE, AND DISCLAIMS (PURSUANT TO SECTION 327.411 RSMO) SPECIFICATION, ESTIMATES, REPORTS, OR OTHER DOCUMENTS OR INSTRUMENTS NOT SEALED BY THE UNDERSIGNED PROFESSIONAL RELATING TO OR INTENDED TO BE USED FOR ANY PART OR PARTS OF THE PROJECT TO WHICH THIS PAGE REFERS.

DATE PREPARED
12/24/2024

ROUTE
MM

DISTRICT
SL

STATE
MO

SHEET NO.
9

COUNTY
JEFFERSON

JOB NO.
J6S3575

CONTRACT ID.

PROJECT NO.

BRIDGE NO.

DESCRIPTION	DATE

MISSOURI HIGHWAYS AND TRANSPORTATION COMMISSION

105 WEST CAPITOL
JEFFERSON CITY, MO 65102
1-888-ASK-MODOT (1-888-275-6636)

PLAN SHEET
SHEET 6 OF 19

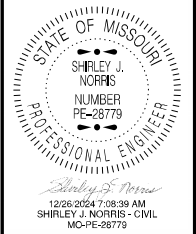
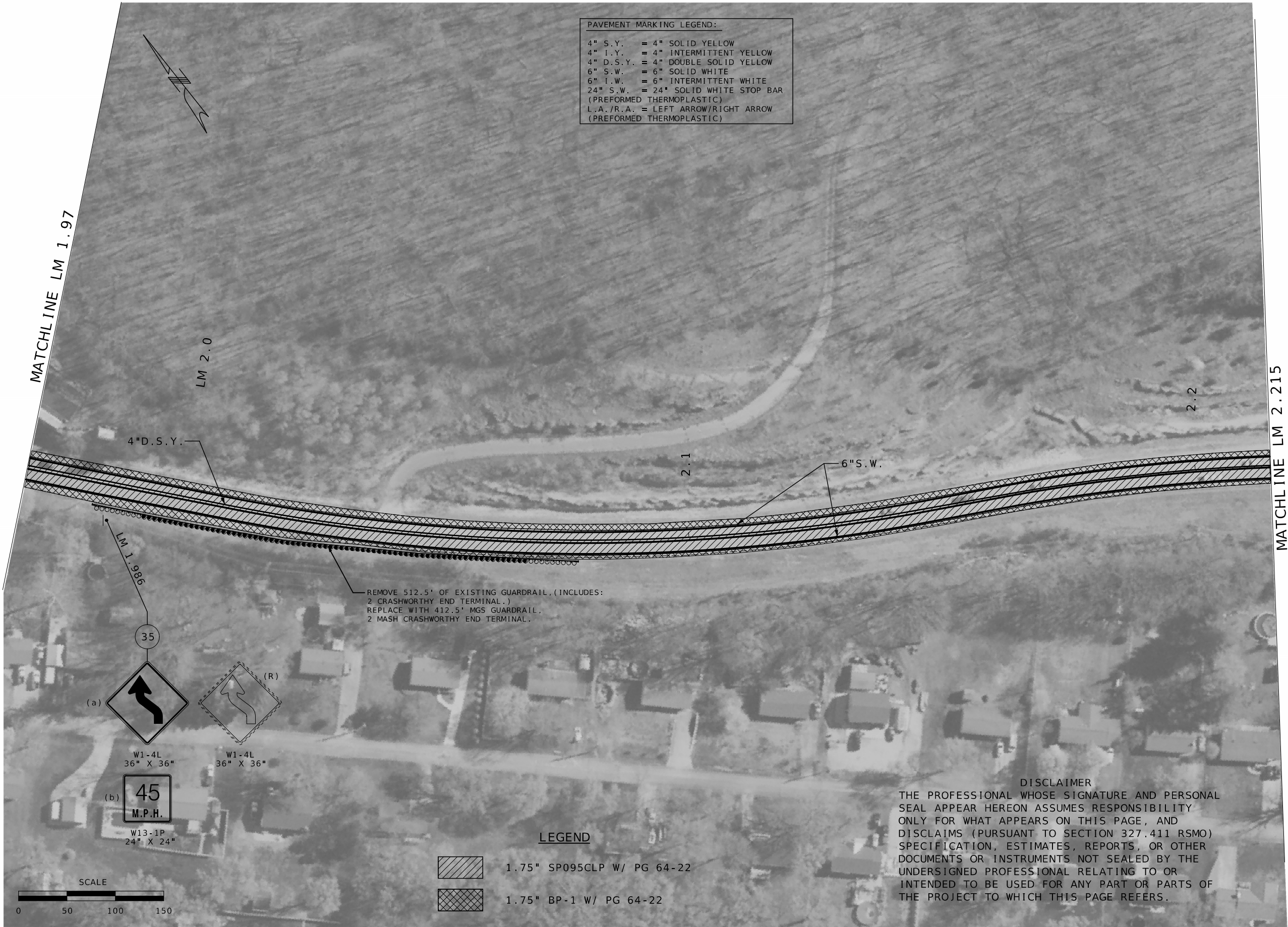

DATE PREPARED	
12/24/2024	
ROUTE	STATE
MM	MO
DISTRICT	SHEET NO.
SL	12
COUNTY	
JEFFERSON	
JOB NO.	
J6S3575	
CONTRACT ID.	
PROJECT NO.	
BRIDGE NO.	

DATE	DESCRIPTION

MISSOURI HIGHWAYS AND TRANSPORTATION COMMISSION

MoDOT

105 WEST CAPITOL
JEFFERSON CITY, MO 65102
1-888-ASK-MODOT (1-888-275-6636)



STATE OF MISSOURI

SHIRLEY J. NORRIS

NUMBER

PE-28779

PROFESSIONAL ENGINEER

12/26/2024 7:10:08 AM

SHIRLEY J. NORRIS - CIVIL

MO-PE-28779

DATE PREPARED

12/24/2024

ROUTE

MM

DISTRICT

SL

STATE

MO

SHEET NO.

13

COUNTY

JEFFERSON

JOB NO.

J6S3575

CONTRACT ID.

PROJECT NO.

BRIDGE NO.

DATE	DESCRIPTION

MISSOURI HIGHWAYS AND TRANSPORTATION COMMISSION

MoDOT

105 WEST CAPITOL

JEFFERSON CITY, MO 65102

1-888-ASK-MODOT (1-888-275-6636)

PLAN SHEET

SHEET 10 OF 19

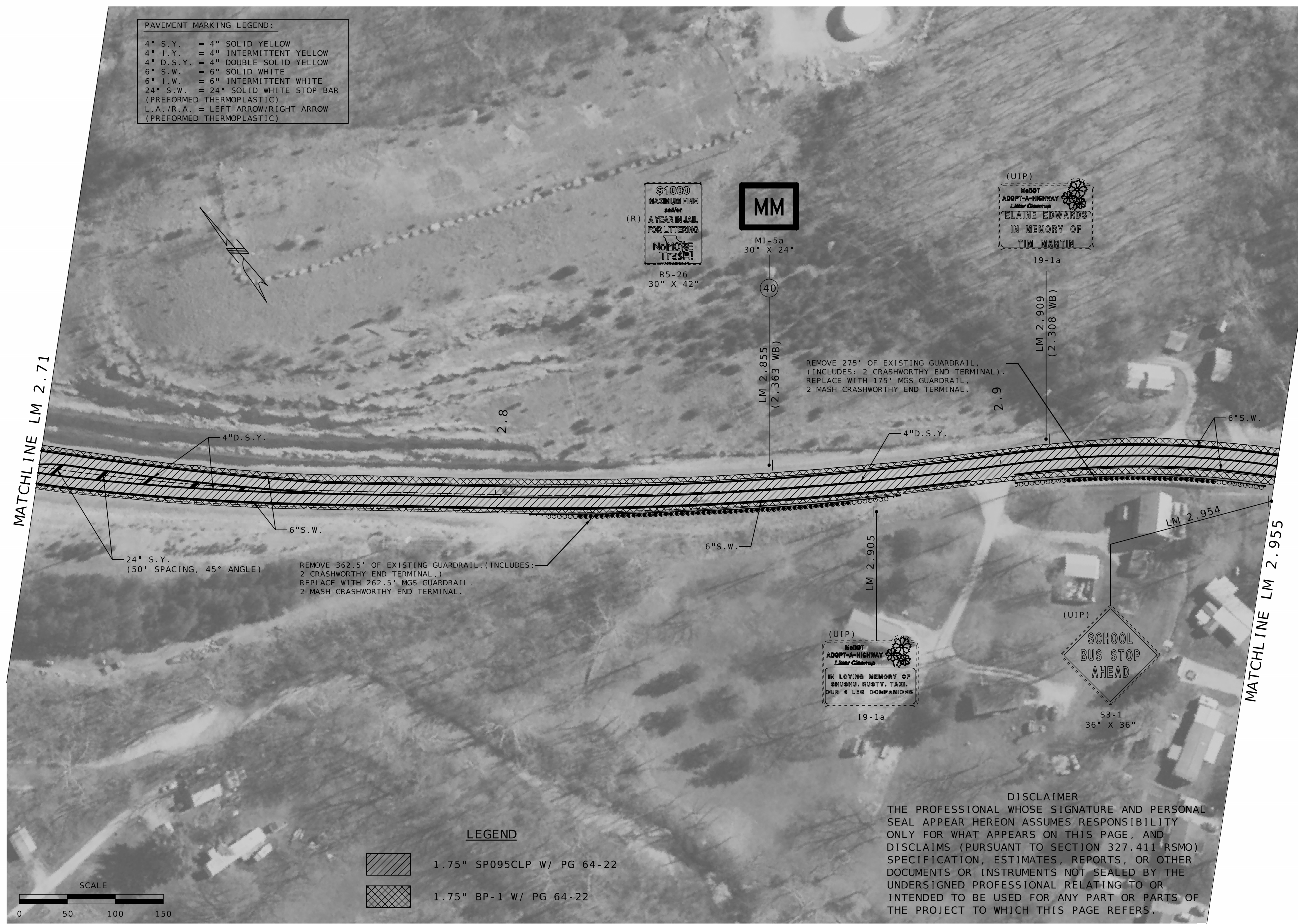

STATE OF MISSOURI

SHIRLEY J. NORRIS

NUMBER

PE-28779

PROFESSIONAL ENGINEER

DATE PREPARED

12/24/2024

ROUTE

MM

STATE

MO

DISTRICT

SL

SHEET NO.

15

COUNTY

JEFFERSON

JOB NO.

J6S3575

CONTRACT ID.

PROJECT NO.

BRIDGE NO.

DESCRIPTION

DATE

MISSOURI HIGHWAYS AND TRANSPORTATION

COMMISSION

105 WEST CAPITOL

JEFFERSON CITY, MO 65102

1-888-ASK-MODOT (1-888-273-6636)

PLAN SHEET

SHEET 12 OF 19



STATE OF MISSOURI

SHIRLEY J. NORRIS

NUMBER

PE-28779

PROFESSIONAL ENGINEER

DATE PREPARED

12/24/2024

ROUTE

MM

STATE

MO

DISTRICT

SL

SHEET NO.

16

COUNTY

JEFFERSON

JOB NO.

J6S3575

CONTRACT ID.

PROJECT NO.

BRIDGE NO.

DATE	DESCRIPTION

MISSOURI HIGHWAYS AND TRANSPORTATION COMMISSION

MODOT

105 WEST CAPITOL

JEFFERSON CITY, MO 65102

1-888-ASK-MODOT (1-888-275-6636)

PLAN SHEET

SHEET 13 OF 19

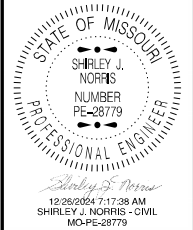
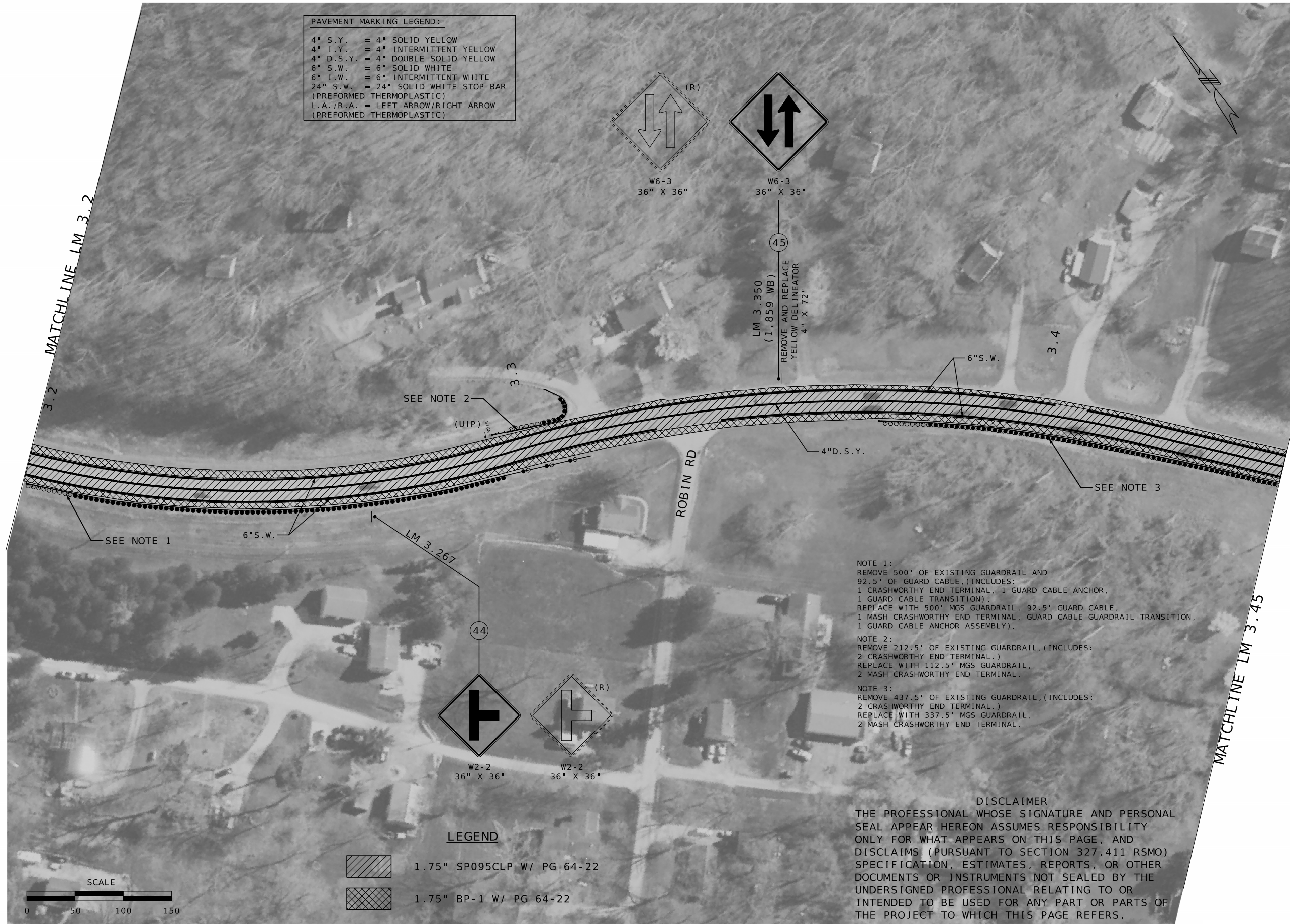

DATE PREPARED 12/24/2024	
ROUTE MM	STATE MO
DISTRICT SL	SHEET NO. 17
COUNTY JEFFERSON	
JOB NO. J6S3575	
CONTRACT ID.	
PROJECT NO.	
BRIDGE NO.	

DATE	DESCRIPTION





PAVEMENT MARKING LEGEND:	
4" S.Y.	= 4" SOLID YELLOW
4" I.Y.	= 4" INTERMITTENT YELLOW
4" D.S.Y.	= 4" DOUBLE SOLID YELLOW
6" S.W.	= 6" SOLID WHITE
6" I.W.	= 6" INTERMITTENT WHITE
24" S.W.	= 24" SOLID WHITE STOP BAR (PERFORMED THERMOPLASTIC)
L.A./R.A.	= LEFT ARROW/RIGHT ARROW (PERFORMED THERMOPLASTIC)

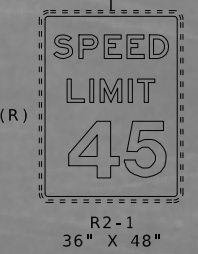
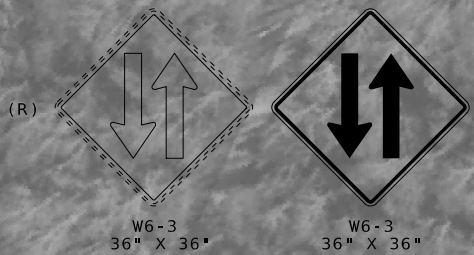

LEGEND	
	1.75" SP095CLP W/ PG 64-22
	1.75" BP-1 W/ PG 64-22

DISCLAIMER
THE PROFESSIONAL WHOSE SIGNATURE AND PERSONAL SEAL APPEAR HEREON ASSUMES RESPONSIBILITY ONLY FOR WHAT APPEARS ON THIS PAGE, AND DISCLAIMS (PURSUANT TO SECTION 327.411 RSMO) SPECIFICATION, ESTIMATES, REPORTS, OR OTHER DOCUMENTS OR INSTRUMENTS NOT SEALED BY THE UNDERSIGNED PROFESSIONAL RELATING TO OR INTENDED TO BE USED FOR ANY PART OR PARTS OF THE PROJECT TO WHICH THIS PAGE REFERS.

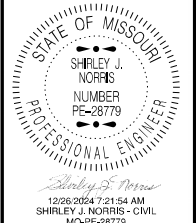

DATE PREPARED 12/24/2024	
ROUTE MM	STATE MO
DISTRICT SL	SHEET NO. 19
COUNTY JEFFERSON	
JOB NO. J6S3575	
CONTRACT ID.	
PROJECT NO.	
BRIDGE NO.	

DATE	DESCRIPTION

MISSOURI HIGHWAYS AND TRANSPORTATION COMMISSION

105 WEST CAPITOL
JEFFERSON CITY, MO 65102
1-888-ASK-MODOT (1-888-273-6636)

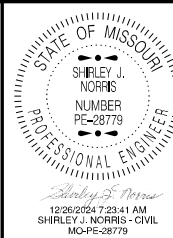

DATE PREPARED
12/24/2024

ROUTE	STATE
MM	MO

DISTRICT	SHEET NO
SL	20

COUNTY
JEFFERSON

JOB NO.
16S3575

CONTRACT ID.	
--------------	--

PROJECT NO.

BRIDGE NO.

[illegible]

MISSOURI HIGHWAYS AND TRANSPORTATION COMMISSION



105 WEST CAPITAL
JEFFERSON CITY, MO 65102

PLAN SHEET
SHEET 17 OF 19



PAVEMENT MARKING LEGEND:		
4" S.Y.	= 4"	SOLID YELLOW
4" I.Y.	= 4"	INTERMITTENT YELLOW
4" D.S.Y.	= 4"	DOUBLE SOLID YELLOW
6" S.W.	= 6"	SOLID WHITE
6" I.W.	= 6"	INTERMITTENT WHITE
24" S.W.	= 24"	SOLID WHITE STOP BAR (PERFORMED THERMOPLASTIC)
L.A./R.A.	=	LEFT ARROW/RIGHT ARROW (PERFORMED THERMOPLASTIC)

DISCLAIMER
THE PROFESSIONAL WHOSE SIGNATURE AND PERSONAL SEAL APPEAR HEREON ASSUMES RESPONSIBILITY ONLY FOR WHAT APPEARS ON THIS PAGE, AND DISCLAIMS (PURSUANT TO SECTION 327.411 RSMO) SPECIFICATION, ESTIMATES, REPORTS, OR OTHER DOCUMENTS OR INSTRUMENTS NOT SEALED BY THE UNDERSIGNED PROFESSIONAL RELATING TO OR INTENDED TO BE USED FOR ANY PART OR PARTS OF THE PROJECT TO WHICH THIS PAGE REFERS.

LEGEND
 1.75" SP095CLP W/ PG 64-22

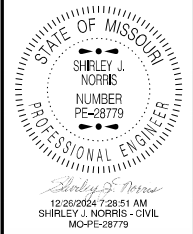
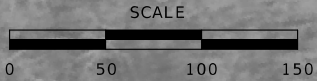

DATE PREPARED 12/24/2024	
ROUTE MM	STATE MO
DISTRICT SL	SHEET NO. 22
COUNTY JEFFERSON	
JOB NO. J6S3575	
CONTRACT ID.	
PROJECT NO.	
BRIDGE NO.	

DATE	DESCRIPTION

MISSOURI HIGHWAYS AND TRANSPORTATION COMMISSION



105 WEST CAPITOL
JEFFERSON CITY, MO 65102
1-888-ASK-MODOT (1-888-275-6636)

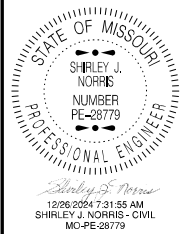

BRIDGE NO.

[illegible]

MISSOURI HIGHWAYS AND TRANSPORTATION
COMMISSION

105 WEST CAPITOL
JEFFERSON CITY, MO 65102
1-888-ASK-MODOT / 1-888-275-6626

SPECIAL SHEET
SIGNAL AND ADA

NOT TO SCALE

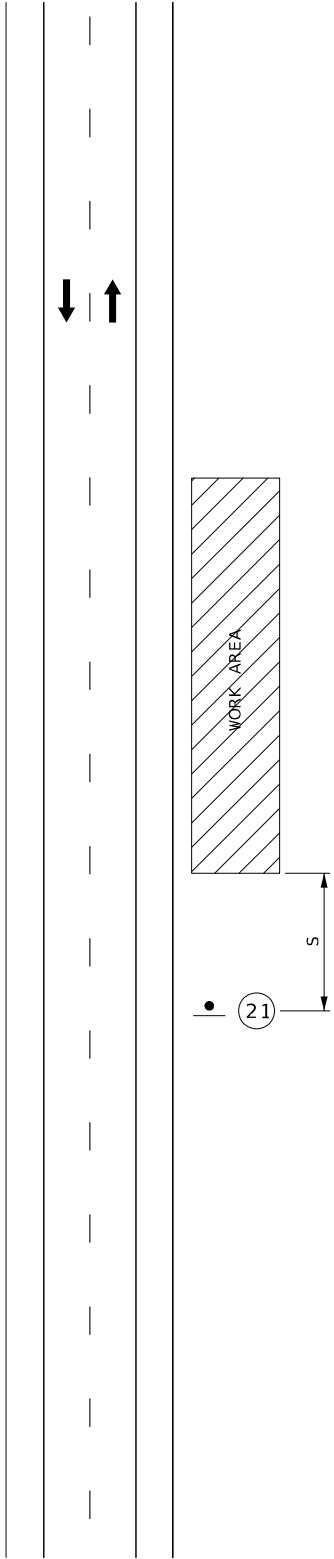

WO21-5
(21)

NOTES:

- ONLY APPLICABLE WHEN WORK IS WITHIN THE CLEAR ZONE.
- ON MULTI-LANE, DIVIDED HIGHWAYS, SIGNS ADVISING OF THE SHOULDER WORK OR THE CONDITION OF THE SHOULDER SHOULD BE PLACED ONLY ON THE SIDE OF THE AFFECTED SHOULDER.
- VEHICLE HAZARD WARNING SIGNALS SHALL NOT BE USED INSTEAD OF THE VEHICLE'S HIGH-INTENSITY ROTATING, FLASHING, OSCILLATING, OR STROBE LIGHTS.
- NO DIRECT PAY WILL BE MADE FOR THE RELOCATION OF CONSTRUCTION SIGNS OR DEVICES.
- SIGN AND DEVICE LOCATION WILL BE FIELD VERIFIED AND APPROVED BY THE ENGINEER.
- CMS LOCATIONS TO BE DETERMINED BY THE ENGINEER

SPEED	SIGN SPACING (ft.)		TAPER LENGTH (ft.)		OPTIONAL	CHANNELIZER SPACING (ft.)	
	UN -DIVIDED (S)	DIVIDED (S)	SHOULDER (1) (T1)	LANE (2) (T2)	BUFFER LENGTH (ft) (B)	TAPERS	BUFFER/ WORK AREAS
0-35	200	200	-	-	-	-	-
40-45	350	500	-	-	-	-	-

WORK BEYOND THE SHOULDER
(UNDIVIDED OR DIVIDED HIGHWAY)

TRAFFIC CONTROL LEGEND

SIGN (SINGLE SIDED)

WORK AREA

DISCLAIMER
THE PROFESSIONAL WHOSE SIGNATURE AND PERSONAL SEAL APPEAR HEREON ASSUMES RESPONSIBILITY ONLY FOR WHAT APPEARS ON THIS PAGE, AND DISCLAIMS (PURSUANT TO SECTION 327.411 RSMO) SPECIFICATION, ESTIMATES, REPORTS, OR OTHER DOCUMENTS OR INSTRUMENTS NOT SEALED BY THE UNDERSIGNED PROFESSIONAL RELATING TO OR INTENDED TO BE USED FOR ANY PART OR PARTS OF THE PROJECT TO WHICH THIS PAGE REFERS.

STATE OF MISSOURI

SHIRLEY J. NORRIS

NUMBER

PE-28779

PROFESSIONAL ENGINEER

12/28/2024 7:33:55 AM

SHIRLEY J. NORRIS - CIVIL

MO-PE-28779

DATE PREPARED

12/23/2024

ROUTE

STATE

MM

MO

DISTRICT

SHEET NO.

SL

24

COUNTY

JEFFERSON

JOB NO.

J6S3575

CONTRACT ID.

PROJECT NO.

BRIDGE NO.

DESCRIPTION

DATE

MISSOURI HIGHWAYS AND TRANSPORTATION COMMISSION

105 WEST CAPITOL

JEFFERSON CITY, MO 65102

1-888-ASK-MODOT (1-888-275-6636)

MoDOT

TRAFFIC CONTROL SHEET
WORK BEYOND THE SHOULDER

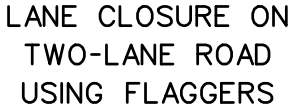

NOT TO SCALE

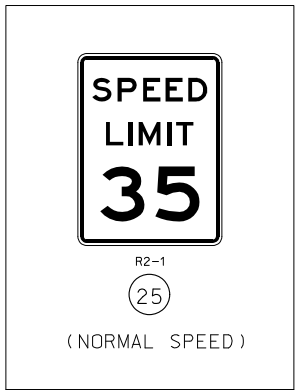

35 M.P.H. NORMAL SPEED
(SPEED WILL REMAIN 35 M.P.H.
THROUGH THE WORK ZONE)

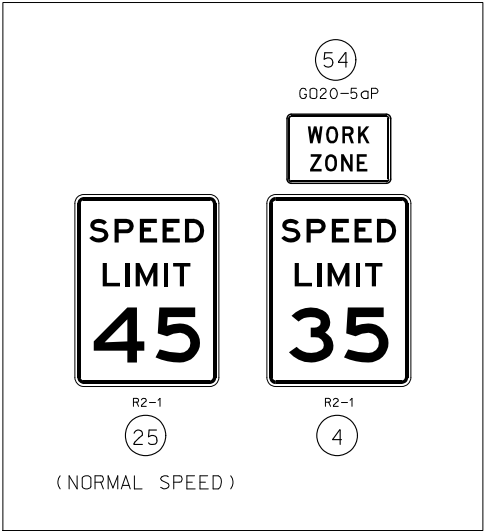

45 M.P.H. NORMAL SPEED

DISCLAIMER
THE PROFESSIONAL WHOSE SIGNATURE AND PERSONAL
SEAL APPEAR HEREON ASSUMES RESPONSIBILITY
ONLY FOR WHAT APPEARS ON THIS PAGE, AND
DISCLAIMS (PURSUANT TO SECTION 327.411 RSMO)
SPECIFICATION, ESTIMATES, REPORTS, OR OTHER
DOCUMENTS OR INSTRUMENTS NOT SEALED BY THE
UNDERSIGNED PROFESSIONAL RELATING TO OR
INTENDED TO BE USED FOR ANY PART OR PARTS OF
THE PROJECT TO WHICH THIS PAGE REFERS.

NOTES:

AUTOMATED FLAGGER ASSISTANCE DEVICES (AFAD) AND PORTABLE SIGNAL FLAGGING DEVICES (PSFD) MAY BE USED AS AN ALTERNATIVE FLAGGING OPERATION.

SEE EPG 616.12 WORK ZONE SPEED LIMITS FOR SPEED
LIMIT GUIDELINES.

IF RUMBLE STRIPS ARE USED, REVIEW 616.6.87 RUMBLE STRIPS.

IF USED AT NIGHT, THE FLAGGER STATIONS SHALL BE ILLUMINATED WITH AN AVERAGE MAINTAINED INTENSITY OF 0.6 FOOTCANDLES (6.5 LUX).

SPEED	SIGN SPACING (ft.)		TAPER LENGTH (ft.)		OPTIONAL	CHANNELIZER SPACING (ft.)	
PERM. POSTED (MPH)	UN -DIVIDED (S)	DIVIDED (S)	SHOULDER (1) (T1)	LANE (2) (T2)	BUFFER LENGTH (ft) (B)	TAPERS	BUFFER/ WORK AREAS
0-35	200	-	-	-	280	-	40
40-45	350	-	-	-	400	-	80

2. Lane taper length based on 12 ft. (standard lane width) offset.

TRAFFIC CONTROL LEGEND

-  SIGN (SINGLE SIDED)
 CHANNELIZER (TRIM-LINE)
 WORK AREA
 FLAGGER

[illegible]

NOT TO SCALE

PRIVATE OR COMMERCIAL ENTRANCE

CENTERLINE

STATE ROUTE

CITY STREET OR COUNTY ROAD

100' TAPER WITH 5 CHANNELIZER MINIMUM

24" X 18"

18" X 12"

150'

30'

2

11

8

58*

CHANNELIZERS SPACED 5FT APART AND EXTENDED 20 FT PAST ENTRANCE WIDTH.

PILOT CAR IN USE WAIT & FOLLOW

G020-4a

58

PILOT CAR IN USE WAIT & FOLLOW

24" X 18"

60

SHALL ONLY BE USED AT PRIVATE AND COMMERCIAL ENTRANCES. SEE STD PLAN 616.10 FOR SIGN DETAILS.

THE SMALLER 18" X 12" SIGN IS USED ON ALL OTHER STATE ROUTES (CITY STREETS, COUNTY ROADS, ETC.).

ROAD WORK AHEAD

W020-1

2

BE PREPARED TO STOP

W03-4



11

DISCLAIMER: THIS DIAGRAM IS FOR INFORMATIONAL PURPOSES ONLY AND SHOULD NOT BE USED FOR LEGAL OR PROFESSIONAL PURPOSES. THE SIGNAGE AND DIMENSIONS SHOWN ARE BASED ON THE LATEST AVAILABLE STANDARD SPECIFICATIONS FOR HIGHWAY CONSTRUCTION AND MAINTENANCE. ANY CHANGES TO THE SPECIFICATIONS OR THE NEED FOR ADJUSTMENTS TO THE DIAGRAM SHOULD BE DETERMINED BY THE APPROPRIATE AGENCY. THE USER OF THIS DIAGRAM ASSUMES ALL LIABILITY FOR ANY INJURY OR DAMAGE RESULTING FROM THE USE OF THIS DIAGRAM.

TRAFFIC CONTROL

SIDE ROADS ENTERING WORK ZONES

SPEED	SIGN SPACING (ft.)	
PERM. POSTED (MPH)	UN -DIVIDED (S)	DIVIDED (S)
0-35	200	200
40-45	350	500

 SIGN (SINGLE SIDED)
 CHANNELIZER (TRIM-LINE)
 FLAGGER



TRAFFIC CONTROL SHEET SIDE ROADS ENTERING WORK ZONES

FLAGGER CONTROL RESURFACING
OR MOVING OPERATION ONE LANE
TWO-WAY OPERATION

NOT TO SCALE



W020-1
2



W020-4
7



W020-7a
8



W03-4
11



G020-4
53

SIGN 53, "PILOT CAR FOLLOW ME" SHALL
BE THE CONTRACTOR'S RESPONSIBILITY WHEN
IN USE DURING OPERATION.

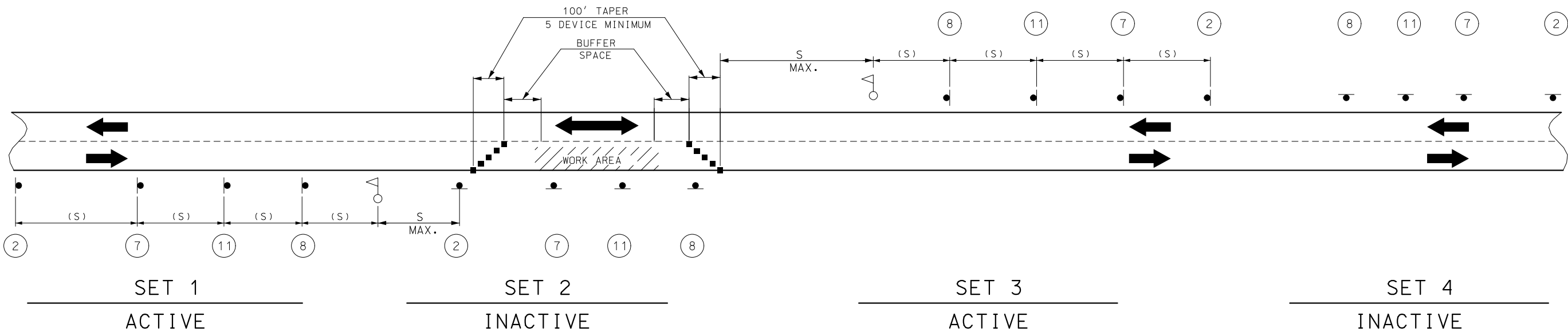

NOTES:

DAYLIGHT FLAGGING OPERATIONS ONLY.

CHANNELIZING DEVICES LOCATED DOWNSTREAM OF THE ONE-LANE, TWO-WAY TAPER ARE OPTIONAL. THESE DEVICES SHOULD BE ELIMINATED WHEN THEIR USE WILL REDUCE THE USABLE LANE WIDTH, INCLUDING ANY ACCEPTABLE SHOULDERS, TO LESS THAN 10' OR WILL SIGNIFICANTLY AFFECT THE RESURFACING OPERATION.

SIGN SETS 1 AND 3 ARE ACTIVE AND (I.E., SIGNS FACE ONCOMING TRAFFIC) SIGN SETS 2 AND 4 ARE INACTIVE (I.E., SIGNS DO NOT FACE EITHER DIRECTION OF TRAFFIC) WHEN THE RESURFACING OPERATION IS LOCATED BETWEEN SIGN SETS 1 AND 3.

WHEN SIGN SETS 2 AND 4 ARE ACTIVE, SIGN SETS 1 AND 3 BECOME INACTIVE AND ARE ADVANCED TO BECOME SETS 2 AND 4 WITH SIGN LEGENDS TURNED AWAY FROM BOTH DIRECTIONS OF TRAFFIC. WHEN THE RESURFACING OPERATION ADVANCES TO BETWEEN SIGN SETS 2 AND 4, SIGN SETS 2 AND 4 BECOME ACTIVE (I.E., NEW SIGN SETS 1 AND 3) AND SIGN SETS 1 AND 3 ADVANCED IN THE DIRECTION OF THE OPERATION (I.E., NEW SIGN SETS 2 AND 4).

SPACING MAY BE ADJUSTED AS NECESSARY TO MEET FIELD CONDITIONS.

NO DIRECT PAY WILL BE MADE FOR THE RELOCATION OF CONSTRUCTION SIGNS OR DEVICES.

SIGN AND DEVICE LOCATIO WILL BE FIELD VERIFIED AND APPROVED BY THE ENGINEER.

CMS LOCATIONS TO BE DETERMINED BY THE ENGINEER.

TRAFFIC CONTROL LEGEND

- SIGN (SINGLE SIDED)
- CHANNELIZER (TRIM-LINE)
- WORK AREA
- FLAGGER

SPEED	SIGN SPACING (ft.)		TAPER LENGTH (ft.)		OPTIONAL	CHANNELIZER SPACING (ft.)	
PERM. POSTED (MPH)	UN -DIVIDED (S)	DIVIDED (S)	SHOULDER (1) (T1)	LANE (2) (T2)	BUFFER LENGTH (ft) (B)	TAPERS	BUFFER/ WORK AREAS
0-35	200	-	-	-	280	-	40
40-45	350	-	-	-	400	-	80

1 Shoulder taper length based on 10 ft. (standard shoulder width) offset.
2. Lane taper length based on 12 ft. (standard lane width) offset.

DISCLAIMER
THE PROFESSIONAL WHOSE SIGNATURE AND PERSONAL SEAL APPEAR HEREON ASSUMES RESPONSIBILITY ONLY FOR WHAT APPEARS ON THIS PAGE, AND DISCLAIMS (PURSUANT TO SECTION 327.411 RSMO) SPECIFICATION, ESTIMATES, REPORTS, OR OTHER DOCUMENTS OR INSTRUMENTS NOT SEALED BY THE UNDERSIGNED PROFESSIONAL RELATING TO OR INTENDED TO BE USED FOR ANY PART OR PARTS OF THE PROJECT TO WHICH THIS PAGE REFERS.



DATE PREPARED
12/23/2024
ROUTE STATE
MM MO
DISTRICT SHEET NO.
SL 27
COUNTY
JEFFERSON
JOB NO.
J6S3575
CONTRACT ID.

PROJECT NO.
BRIDGE NO.

DESCRIPTION	DATE



MISSOURI HIGHWAYS AND TRANSPORTATION COMMISSION
105 WEST CAPITOL
JEFFERSON CITY, MO 65102
1-888-ASK-MODOT (1-888-275-6636)

TRAFFIC CONTROL SHEET
FLAGGER CONTROL
MOVING OPERATION

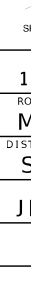

SPEED	SIGN SPACING (ft.)		TAPER LENGTH (ft.)		OPTIONAL	CHANNELIZER SPACING (ft.)	
PERM. POSTED (MPH)	UN -DIVIDED (S)	DIVIDED (S)	SHOULDER (1) (T1)	LANE (2) (T2)	BUFFER LENGTH (ft) (B)	TAPERS	BUFFER/ WORK AREAS
0-35	200	—	—	—	250	—	—
40-45	350	—	—	—	360	—	—

1. Shoulder taper length based on 10 ft. (standard shoulder width) offset.
2. Lane taper length based on 12 ft. (standard lane width) offset.

 <p>SHIRLEY J. NORRIS NUMBER PE-28779 PROFESSIONAL ENGINEER</p> <p><i>Shirley J. Norris</i> 12/26/2024 7:39:45 AM SHIRLEY J. NORRIS - CIVIL MO-PE-28779</p>	
DATE PREPARED 12/23/2024	
ROUTE MM	STATE MO
DISTRICT SL	SHEET NO. 28
COUNTY JEFFERSON	
JOB NO. J6S3575	
CONTRACT ID.	
PROJECT NO.	
BRIDGE NO.	
DESCRIPTION	
DATE	
MISSOURI HIGHWAYS AND TRANSPORTATION COMMISSION  <p>105 WEST CAPITOL JEFFERSON CITY, MO 65102 1-888-ASK-MODOT (1-888-275-6636)</p>	
TRAFFIC CONTROL SHEET MOBILE OPERATION ON TWO-LANE HIGHWAYS USING FLAGGERS	

BEGIN/END OF PROJECT SIGNING

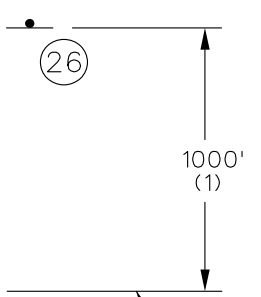
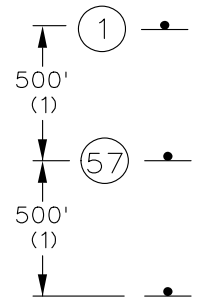
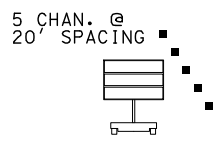

END OF PROJECT LIMITS; END OF WORK ZONE TERMINATION AREA, IF LOCATED BEYOND END OF PROJECT; OR LAST WORK ZONE SIGN, IF LOCATED OUTSIDE PROJECT LIMITS.

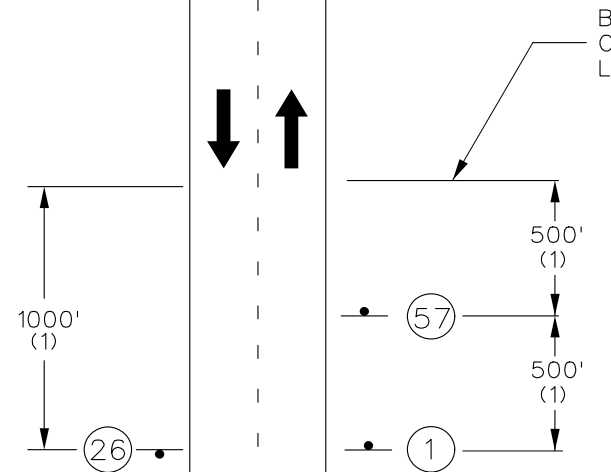

BEGINNING OF PROJECT LIMITS; OR INITIAL WORK ZONE SIGN, IF LOCATED OUTSIDE PROJECT LIMITS.

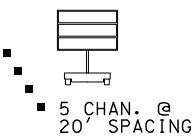

- TRAFFIC CONTROL LEGEND
- SIGN (SINGLE SIDED)
 - CHANNELIZER (TRIM-LINE)
 - CMS (CHANGEABLE MESSAGE BOARD)

NOTES:

SIGN G020-2 IS USED ON ALL PROJECTS WHERE SIGN G020-1 IS USED.

OTHER SIGNS SUCH AS DETOUR OR ALTERNATE ROUTE SIGNING MAY BE USED OUTSIDE THE PROJECT LIMITS.

ANY EXISTING SIGNING THAT CONFLICTS WITH THE TRAFFIC CONTROL SIGNING SHALL BE COMPLETELY COVERED OR REMOVED.

(1) DISTANCE MAY BE ADJUSTED ACCORDING TO FIELD CONDITIONS. WHERE TRAFFIC BACKUPS ARE EXPECTED BEYOND THE ADVANCE WARNING AREA, ADDITIONAL SIGNING MAY BE NEEDED.

SIGN CONST-7-72 OR CONST-7-48 IS PLACED 500 FEET BEFORE THE BEGINNING OF PROJECT LIMITS OR THE ROAD WORK AHEAD SIGN OR ROAD WORK NEXT XX MILES SIGN. IF USED, WHEN THESE SIGNS ARE LOCATED OUTSIDE THE PROJECT LIMITS.

THE "RATE OUR WORK ZONE" SIGN IS AVAILABLE IN TWO SIZES DEPENDING ON ROADWAY CONDITIONS. THE 48 IN. X 24 IN. SIGN IS USED ON LOW VOLUME ROUTES THAT CARRY 400 AADT OR LESS, ON PROJECTS THAT HAVE A DURATION OF 4 WEEKS OR LESS OR IN URBAN AREAS WHERE THERE IS INSUFFICIENT LIGHTS OF WAY FOR A SIX FOOT WIDE SIGN. THE 72 IN. X 36 IN. VERSION OF THE SIGN IS USED IN ALL OTHER APPLICATIONS, BUT CAN ALSO BE USED IN PLACE OF THE 48 IN. X 24 IN. SIGN IF ADDED EMPHASIS IS DEEMED NECESSARY.

THE "WORK ZONE NO PHONE ZONE" SIGN IS PLACED A MINIMUM OF 500 FEET BEFORE THE ROAD WORK AHEAD SIGN.

NO DIRECT PAY WILL BE MADE FOR THE RELOCATION OF CONSTRUCTION SIGNS OR DEVICES.

SIGN AND DEVICE LOCATION WILL BE FIELD VERIFIED AND APPROVED BY THE ENGINEER.

CMS LOCATIONS TO BE DETERMINED BY THE ENGINEER

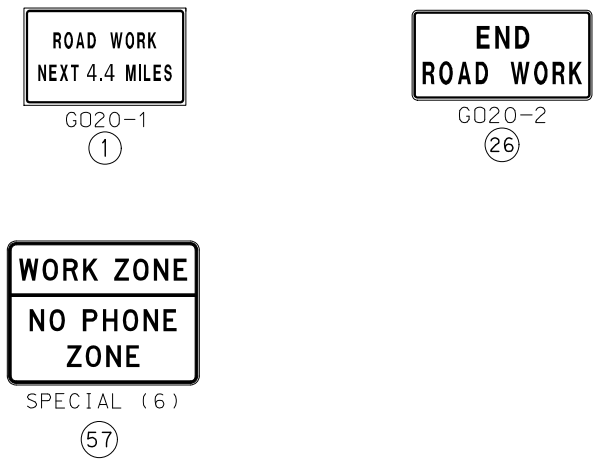

DISCLAIMER

THE PROFESSIONAL WHOSE SIGNATURE AND PERSONAL SEAL APPEAR HEREON ASSUMES RESPONSIBILITY ONLY FOR WHAT APPEARS ON THIS PAGE, AND DISCLAIMS (PURSUANT TO SECTION 327.411 RSMO) SPECIFICATION, ESTIMATES, REPORTS, OR OTHER DOCUMENTS OR INSTRUMENTS NOT SEALED BY THE UNDERSIGNED PROFESSIONAL RELATING TO OR INTENDED TO BE USED FOR ANY PART OR PARTS OF THE PROJECT TO WHICH THIS PAGE REFERS.

NOT TO SCALE

STATE OF MISSOURI

SHIRLEY J. NORRIS

NUMBER

PE-28779

PROFESSIONAL ENGINEER

12/28/2024 7:40:59 AM

SHIRLEY J. NORRIS - CIVIL

MO-PE-28779

DATE PREPARED

12/23/2024

ROUTE

MM

STATE

MO

DISTRICT

SL

SHEET NO.

29

COUNTY

JEFFERSON

JOB NO.

J6S3575

CONTRACT ID.

PROJECT NO.

BRIDGE NO.

DESCRIPTION

DATE

MISSOURI HIGHWAYS AND TRANSPORTATION COMMISSION

105 WEST CAPITOL

JEFFERSON CITY, MO 65102

1-888-ASK-MODOT (1-888-275-6636)

MoDOT

TRAFFIC CONTROL SHEET

BEGIN/END OF PROJECT SIGNING

FLASHING ARROW PANEL

LEFT
OR
CENTER

RIGHT LANE
CLOSED

W020-6a

WET
PAINT

WET
PAINT

G022-1 (1)

FLASHING ARROW PANEL

LEFT
OR
CENTER

RIGHT LANE
CLOSED
AHEAD

W020-5

NOT TO SCALE

STRIPING ON MULTI-LANE HIGHWAY

SPEED	SPACING
PERMANENT POSTED (MPH)	LENGTH T (FT)
≤ 35	245
40-45	540

NOTES:

UPON APPROVAL OF THE ENGINEER, THE CONTRACTOR MAY PROVIDE ADDITIONAL PROTECTIVE TRUCKS EQUIPPED WITH PROPER WARNING DEVICES.

PROTECTIVE TRUCKS AND WORK VEHICLES SHALL DISPLAY HIGH-INTENSITY ROTATING, FLASHING, OSCILLATING, OR STROBE LIGHTS.

VEHICLE HAZARD WARNING SIGNALS SHALL NOT BE USED INSTEAD OF THE VEHICLE'S HIGH-INTENSITY ROTATING, FLASHING, OSCILLATING, OR STROBE LIGHTS.

VEHICLE-MOUNTED SIGNS SHALL BE MOUNTED IN A MANNER SUCH THAT THEY ARE NOT OBSCURED BY EQUIPMENT OR SUPPLIES. SIGN LEGENDS ON VEHICLE-MOUNTED SIGNS SHALL BE COVERED OR TURNED FROM VIEW WHEN WORK IS NOT IN PROGRESS.

FLASHING ARROW PANELS SHALL BE INCIDENTAL TO TRUCK MOUNTED ATTENUATORS, WHEREVER USED. NO ADDITIONAL PAYMENT WILL BE MADE.

FLASHING ARROW PANELS SHALL, AS A MINIMUM, BE TYPE B, WITH A SIZE OF 60 X 30 INCHES.

A FLASHING ARROW BOARD SHALL BE USED WHEN A FREEWAY LANE IS CLOSED. WHEN MORE THAN ONE LANE CLOSED, A SEPARATE FLASHING ARROW BOARD SHALL BE USED FOR EACH CLOSED LANE.

(1) WET PAINT SIGNS ARE INSTALLED TO INDICATE THE SIDE IN WHICH THE PAVEMENT MARKING MATERIAL IS BEING APPLIED. AT THE CONTRACTOR'S OPTION, A FRONT FACING WET PAINT SIGN MAY BE INSTALLED ON THE LEFT SIDE OF THE PAVEMENT MARKING EQUIPMENT.

(2) WARNING TRUCK IS POSITIONED AT THE NO TRACK POINT OF THE PAVEMENT MARKING MATERIAL, OR SPACING SHOWN, WHICH EVER IS GREATER.

DISCLAIMER

THE PROFESSIONAL WHOSE SIGNATURE AND PERSONAL SEAL APPEAR HEREON ASSUMES RESPONSIBILITY ONLY FOR WHAT APPEARS ON THIS PAGE, AND DISCLAIMS (PURSUANT TO SECTION 327.411 RSMO) SPECIFICATION, ESTIMATES, REPORTS, OR OTHER DOCUMENTS OR INSTRUMENTS NOT SEALED BY THE UNDERSIGNED PROFESSIONAL RELATING TO OR INTENDED TO BE USED FOR ANY PART OR PARTS OF THE PROJECT TO WHICH THIS PAGE REFERS.

STATE OF MISSOURI

SHIRLEY J. NORRIS

NUMBER

PE-28779

PROFESSIONAL ENGINEER

12/28/2024 7:42:26 AM

SHIRLEY J. NORRIS - CIVIL

MO-PE-28779

DATE PREPARED

12/23/2024

ROUTE

STATE

MM

MO

DISTRICT

SHEET NO.

SL

30

COUNTY

JEFFERSON

JOB NO.

J6S3575

CONTRACT ID.

PROJECT NO.

BRIDGE NO.

DESCRIPTION

DATE

MISSOURI HIGHWAYS AND TRANSPORTATION COMMISSION

105 WEST CAPITOL

JEFFERSON CITY, MO 65102

1-888-ASK-MODOT (1-888-275-6636)

MoDOT

TRAFFIC CONTROL SHEET

CENTER LINE / EDGE LINE STRIPING

ON TWO-LANE HIGHWAYS

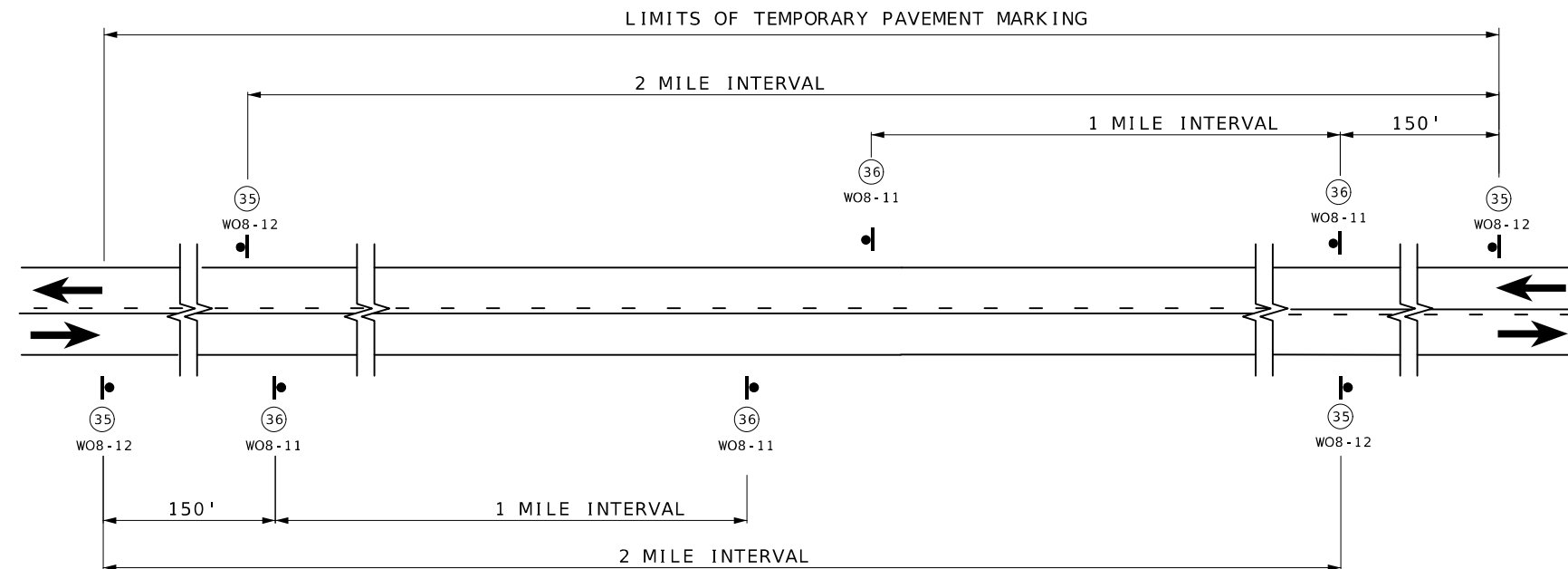

SIGN SPACING AND TEMPORARY STRIPING FOR MAINLINE

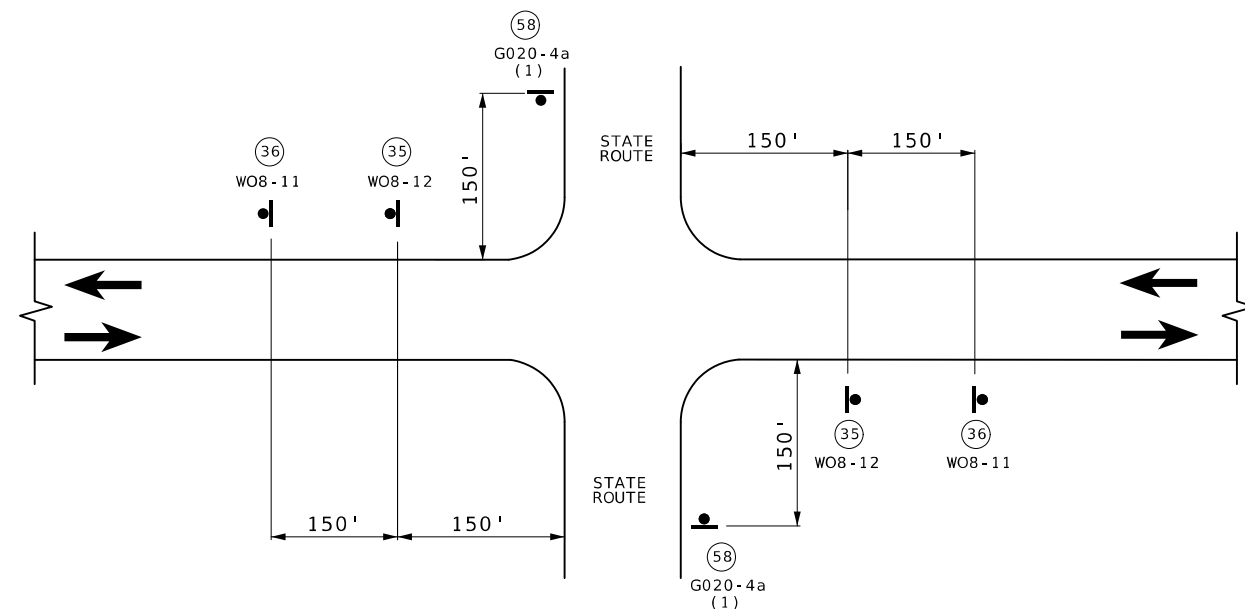

SIGN SPACING AT STATE ROUTE INTERSECTIONS
SHOWING TEMPORARY STRIPING FOR MAINLINE

(1) ADDITIONAL SIDEROADS MAY BE SIGNED AS APPROVED BY THE ENGINEER.

NOT TO SCALE

DISCLAIMER
THE PROFESSIONAL WHOSE SIGNATURE AND PERSONAL SEAL APPEAR HEREON ASSUMES RESPONSIBILITY ONLY FOR WHAT APPEARS ON THIS PAGE, AND DISCLAIMS (PURSUANT TO SECTION 327.411 RSMO) SPECIFICATION, ESTIMATES, REPORTS, OR OTHER DOCUMENTS OR INSTRUMENTS NOT SEALED BY THE UNDERSIGNED PROFESSIONAL RELATING TO OR INTENDED TO BE USED FOR ANY PART OR PARTS OF THE PROJECT TO WHICH THIS PAGE REFERS.

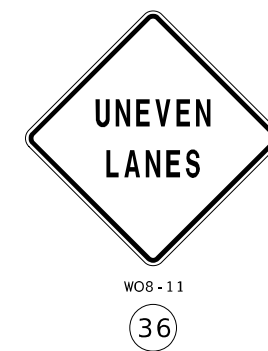

NOTES:

SIGN (35) AND TEMPORARY RAISED PAVEMENT MARKING (SEE STANDARD PLAN 620.10) INSTALLED WHERE CENTERLINE STRIPING HAS BEEN COVERED OR REMOVED. SIGNS ARE TO REMAIN IN PLACE UNTIL THE PERMANENT CENTERLINE PAVEMENT MARKINGS ARE IN PLACE. SIGNS SHALL BE COVERED OR REMOVED WHEN PAVEMENT CENTERLINE MARKING HAS BEEN INSTALLED.

SIGN (35) IS PLACED AT APPROXIMATELY TWO-MILE INTERVALS AND AT STATE ROUTE JUNCTIONS. WHEN THE INSTALLATION AT A JUNCTION IS WITHIN ONE-EIGHTH MILE OF THE NORMAL MAINLINE SIGN (35), THE LATTER MAY BE ELIMINATED.

ALL SIGNS SHALL BE POST MOUNTED AND IN ACCORDANCE WITH STANDARD PLAN 616.10 AND 903.03.

NO DIRECT PAY WILL BE MADE FOR THE RELOCATION OF CONSTRUCTION SIGNS OR DEVICES.

SIGN AND DEVICE LOCATION WILL BE FIELD VERIFIED AND APPROVED BY THE ENGINEER.

CMS LOCATIONS TO BE DETERMINED BY THE ENGINEER.

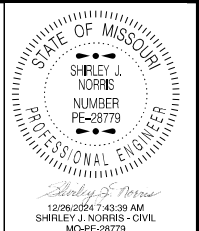

DATE PREPARED 12/23/2024	
ROUTE	STATE MO
DISTRICT	SHEET NO. 8
COUNTY	
JOB NO.	
CONTRACT ID.	
PROJECT NO.	
BRIDGE NO.	

DESCRIPTION	DATE





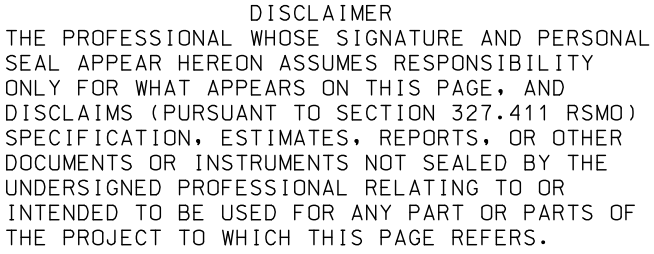

MISSOURI HIGHWAYS AND TRANSPORTATION COMMISSION

105 WEST CAPITOL
JEFFERSON CITY, MO 65102
1-888-ASK-MODOT (1-888-275-6636)



- NOTES:
1. WHEN CROSSWALKS OR OTHER PEDESTRIAN FACILITIES ARE CLOSED OR RELOCATED, TEMPORARY FACILITIES SHALL BE DETECTABLE AND SHALL INCLUDE ACCESSIBILITY FEATURES CONSISTENT WITH THE FEATURES PRESENT IN THE EXISTING PEDESTRIAN FACILITY.
 2. CURB PARKING SHALL BE PROHIBITED FOR AT LEAST 50 FEET IN ADVANCE OF THE MIDBLOCK CROSSWALK.
 3. AUDIBLE INFORMATION DEVICES SHOULD BE CONSIDERED WHERE MIDBLOCK CLOSINGS AND CHANGED CROSSWALK AREAS CAUSE INADEQUATE COMMUNICATION TO BE PROVIDED TO PEDESTRIANS WHO HAVE VISUAL DISABILITIES.
 4. PEDESTRIAN TRAFFIC SIGNALS DISPLAYS CONTROLLING CLOSED CROSSWALKS SHOULD BE COVERED OR DEACTIVATED.
 5. ONLY THE TTC DEVICES RELATED TO PEDESTRIANS ARE SHOWN. OTHER DEVICES, SUCH AS LANE CLOSURE SIGNING OR "ROAD NARROWS" SIGNS, MAY BE USED TO CONTROL VEHICULAR TRAFFIC.

TRAFFIC CONTROL LEGEND

	SIGN (SINGLE SIDED)
	WORK AREA
	TYPE III BARRICADE
	DIRECTION OF TRAFFIC
	TRAFFIC OR PEDESTRIAN SIGNAL
	ADVANCED WARNING RAILS
	CHANNELIZER (TRIM-LINE)

NOT TO SCALE

[illegible]

EFFECTIVE: 07-01-2024																																							
SIGNS							CONCRETE FOOTINGS EMBEDDED	STRUCTURAL STEEL POSTS**					PIPE POSTS **					BACKING BARS***				U- CHANNEL POST	PERFORATED SQUARE STEEL TUBE													REMARKS AND OTHER REQUIRED ITEMS			
902 SIGNAL SIGNS TABULATED ON D-37A SHEET								ITEM NO. 9031010 CY	POST DES NO.	POST NO.1 LF	POST NO.2 LF	POST NO.3 LF	LBS PER FT	TOTAL ITEM NO. 9031210 LBS	PIPE SIZE IN.	POST NO.1 LF	POST NO.2 LF	LBS PER FT	TOTAL ITEM NO. 9031220 LBS	2" X 3/8" BARS AT 2.55 LBS/FT				ITEM NO. 9031250A LF	2 IN. POST			2.5 IN. POST						BREAK - AWAY ASSEMBLY					
SIGN NO.	SIGN SIZE	LOG MILE	HORZ CLEAR IF NOT STD.	LOCATION (ROUTE)	LT OR RT	SIGN DTL. SHT. NO.														NO.	LGTH IN.		TOTAL LF		NO.	DRIVEN 12-GA. ITEM NO. 9031271A EA	DRIVEN 7-GA. ITEM NO. 9031273A EA	CONCRETE 7-GA. ITEM NO. 9031274 EA	POST NO.1 LF	POST NO.2 LF	TOTAL ITEM NO. 9031280 LF	2.25" INSERT (6 FT) ITEM NO. 9031272A EA	ANCHORS 7-GA. ITEM NO. 9031281A EA		CONCRETE 7-GA. ITEM NO. 9031285 EA		ITEM NO. 9031241 EA		
1	ASSEMBLY	5.185*		ROUTE MM	LT		0.13							2.5	14.00		5.79	81																					INSTALL BACK TO BACK
2	ASSEMBLY	0.032		ROUTE MM	RT																																	NO NEW POST	
3	30"x24"	0.058		ROUTE MM	RT																																	NO NEW POST	
4	ASSEMBLY	5.135*		ROUTE MM	LT		0.36							4	16.75		10.79	181	4	50	4.17	11																	
5	36"x36"	0.085		ROUTE MM	RT		0.13							2.5	15.00		5.79	87																					
6	ASSEMBLY	5.113*		ROUTE MM	LT		0.13							2.5	16.25		5.79	94	2	50	4.17	11																	
7	30"x30"	0.123		ROUTE MM	RT		0.13							2.5	15.00		5.79	87																					
8	24"x24"	0.123		ROUTE MM	RT		0.13							2.5	13.50		5.79	78																					
9	54"x18"	5.081*		ROUTE MM	LT		0.13							2.5	14.75		5.79	85	2	50	4.17	11																FACING DULIN CREEK ROAD	
10	ASSEMBLY	0.133		ROUTE MM	RT		0.36							4	17.75		10.79	192																				FACING DULIN CREEK ROAD ENTRANCE	
11	ASSEMBLY	5.078*		ROUTE MM	LT		0.13							2.5	16.50		5.79	96																				INSTALL BACK TO BACK	
12	24"x36"	0.143		ROUTE MM	RT		0.13							2.5	15.00		5.79	87																					
13	ASSEMBLY	5.064*		ROUTE MM	LT																																		
14	36"x48"	0.197		ROUTE MM	RT		0.13							2.5	15.50		5.79	90																					
15	ASSEMBLY	4.967*		ROUTE MM	RT																																		
16	24"x36"	4.861*		ROUTE MM	LT																																		
17	24"x36"	0.372		ROUTE MM	RT		0.13							2.5	14.50		5.79	84																					
18	36"x48"	0.412		ROUTE MM	RT		0.13							2.5	15.50		5.79	90																					
19	24"x36"	4.655*		ROUTE MM	LT																																		
20	36"x48"	4.507*		ROUTE MM	LT																																		
21	30"x24"	4.489*		ROUTE MM	LT																																		
22	30"x24"	0.768		ROUTE MM	RT																																		
23	12"x36"	0.870		ROUTE MM	RT																																		
24	ASSEMBLY	0.878		ROUTE MM	RT																																		
25	36"x48"	4.300*		ROUTE MM	LT																																		
26	36"x48"	0.908		ROUTE MM	RT																																		
27	VxV	4.238*		ROUTE MM	LT																																		
28	36"x48"	1.442		ROUTE MM	RT																																		
29	ASSEMBLY	1.490		ROUTE MM	RT																																		
30	ASSEMBLY	3.681*		ROUTE MM	LT																																		
31	36"x48"	3.657*		ROUTE MM	LT																																		
32	ASSEMBLY	1.621		ROUTE MM	RT																																		
33	ASSEMBLY	3.535*		ROUTE MM	LT																																		
34	ASSEMBLY	3.287*		ROUTE MM	LT																																		
35	ASSEMBLY	1.986		ROUTE MM	RT																																		
36	ASSEMBLY	2.833*		ROUTE MM	LT																																		
37	ASSEMBLY	2.377		ROUTE MM	RT																																		
38	ASSEMBLY	2.680		ROUTE MM	RT																																		
39	ASSEMBLY	2.527*		ROUTE MM	LT																																		
40><																																							

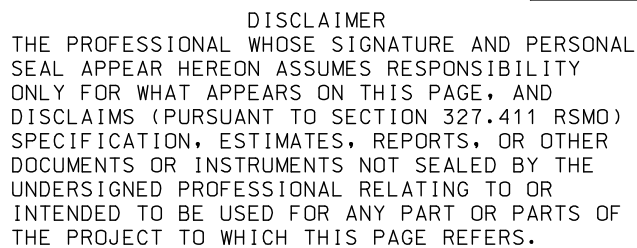

* ORANGE, YELLOW & YELLOW/GREEN

DATE PREPARED	
12/23/2024	
ROUTE	STATE
MM	MO
DISTRICT	SHEET NO.
SL	35
COUNTY	
JEFFERSON	
JOB NO.	
J6S3575	
CONTRACT ID.	
PROJECT NO.	
BRIDGE NO.	



MISSOURI HIGHWAYS AND TRANSPORTATION
COMMISSION

105 WEST CAPITOL
JEFFERSON CITY, MO 65102
1-888-ASK-MODOT (1-888-275-6636)

D - 30

SIGN NO.	27
STATION	4.238*
ROADWAY	ROUTE MM

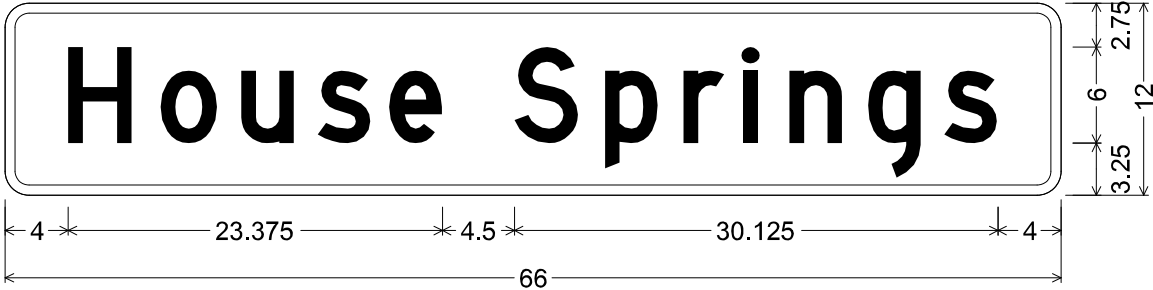

I5-1 SH-FLAT SHEET;
1.500" Radius, 0.625" Border, White on, Green;
"House Springs", D;
Table of letter and object lefts

H	o	u	s	e			
4.000	9.750	14.750	19.500	24.000			
S		p	r	i	n	g	s
31.875		37.500	42.375	46.125	49.000	54.000	58.750

DISCLAIMER
THE PROFESSIONAL WHOSE SIGNATURE AND PERSONAL
SEAL APPEAR HEREON ASSUMES RESPONSIBILITY
ONLY FOR WHAT APPEARS ON THIS PAGE, AND
DISCLAIMS (PURSUANT TO SECTION 327.411 RSMO)
SPECIFICATION, ESTIMATES, REPORTS, OR OTHER
DOCUMENTS OR INSTRUMENTS NOT SEALED BY THE
UNDERSIGNED PROFESSIONAL RELATING TO OR
INTENDED TO BE USED FOR ANY PART OR PARTS OF
THE PROJECT TO WHICH THIS PAGE REFERS.

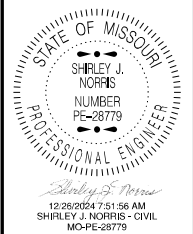

DATE PREPARED 12/23/2024	
ROUTE MM	STATE MO
DISTRICT SL	SHEET NO. 36
COUNTY JEFFERSON	
JOB NO. J6S3575	
CONTRACT ID.	
PROJECT NO.	
BRIDGE NO.	

DESCRIPTION	DATE

MISSOURI HIGHWAYS AND TRANSPORTATION
COMMISSION



105 WEST CAPITOL
JEFFERSON CITY, MO 65102
1-888-ASK-MODOT (1-888-275-6636)