

DESIGN DESIGNATION

A.A.D.T. - 2024 = VARIES
I-70 A.A.D.T. - 2044 = VARIES
I-70 A.A.D.T. - 2024 = 112722
I-470 A.A.D.T. - 2024 = 90066
I-29 A.A.D.T. - 2024 = 109405
US 169 A.A.D.T. - 2024 = 50089
MO 9 A.A.D.T. - 2024 = 17813
MO 152 A.A.D.T. - 2024 = 48898
T = VARIES
V = VARIES

I-70 FUNCTIONAL CLASSIFICATION- INTERSTATE
I-470 FUNCTIONAL CLASSIFICATION- INTERSTATE
I-29 FUNCTIONAL CLASSIFICATION- INTERSTATE
US 169 FUNCTIONAL CLASSIFICATION- FREEWAY
MO 9 FUNCTIONAL CLASSIFICATION- FREEWAY
MO 152 FUNCTIONAL CLASSIFICATION- FREEWAY

NO RIGHT OF WAY
WILL BE ACQUIRED

CONVENTIONAL SYMBOLS
(USED IN PLANS)

Table with 2 columns: EXISTING and NEW. Lists various symbols for buildings, guard rail, right-of-way markers, utilities (fiber optics, telephone, power, gas, water), manhole, fire hydrant, water valve, water meter, drop inlet, ditch block, ground mounted sign, light pole, h-frame power pole, telephone pedestal, fence, chain link, woven wire, gate post, and benchmark.

NOTE: DASHED OR OPEN SYMBOLS INDICATE EXISTING FEATURES

MISSOURI HIGHWAYS AND TRANSPORTATION COMMISSION
PLANS FOR PROPOSED
STATE HIGHWAY
JACKSON & CLAY COUNTIES

PROJECT LIMITS

I-70, I-470, US 169, MO 9, MO 152, I-29

HIGH FRICTION ASPHALT RESURFACING
INTERSECTION ENTRANCE AND EXIT RAMPs

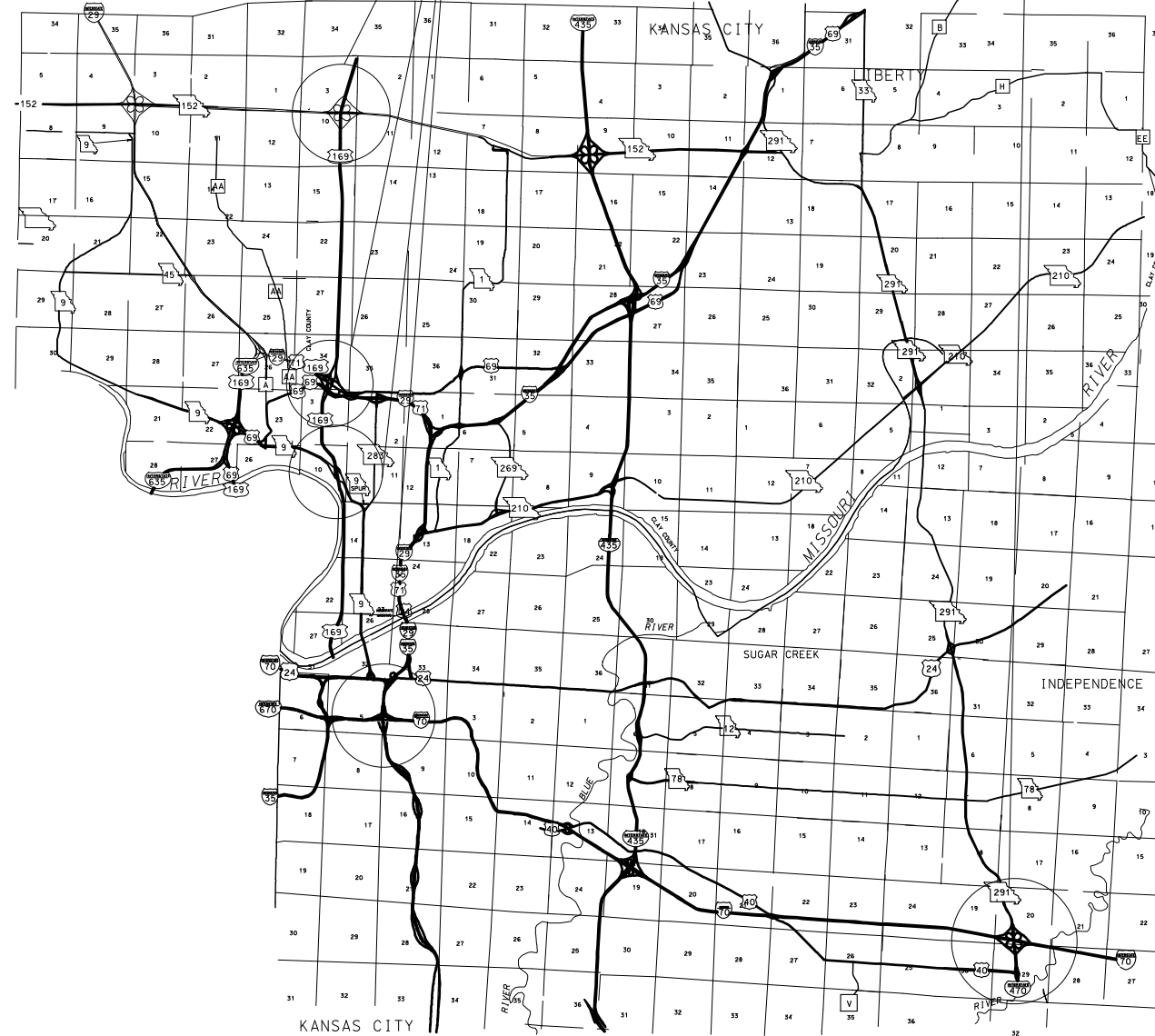

INDEX OF SHEETS

Table with 2 columns: DESCRIPTION and SHEET NUMBER. Lists sheets for Title Sheet, Typical Sections (TS), Quantities (QU), Plan Sheets (PP), and Traffic Control Sheets (TC).



Project information table including Date Prepared (11/19/2024), Route (VAR), State (MO), District (KC), Sheet No. (1), County (VARIOUS), Job No. (JKU0370), and Contract ID.

Table with 2 columns: DESCRIPTION and DATE. Contains multiple rows for project details.

LENGTH OF PROJECT

Table showing Jackson County Totals (3320 FEET) and Clay County Totals (1314 FEET).

Table showing Apparent Length (4634 FEET) and Equations and Exceptions.

Table showing Total Corrections (0.00 FEET), Net Length of Project (4634.00 FEET), and State Length (0.8776 MILES).

Missouri Highways and Transportation Commission logo and contact information: 105 WEST CAPITOL, JEFFERSON CITY, MO 65102, 1-888-ASK-MODOT (1-888-275-6636).

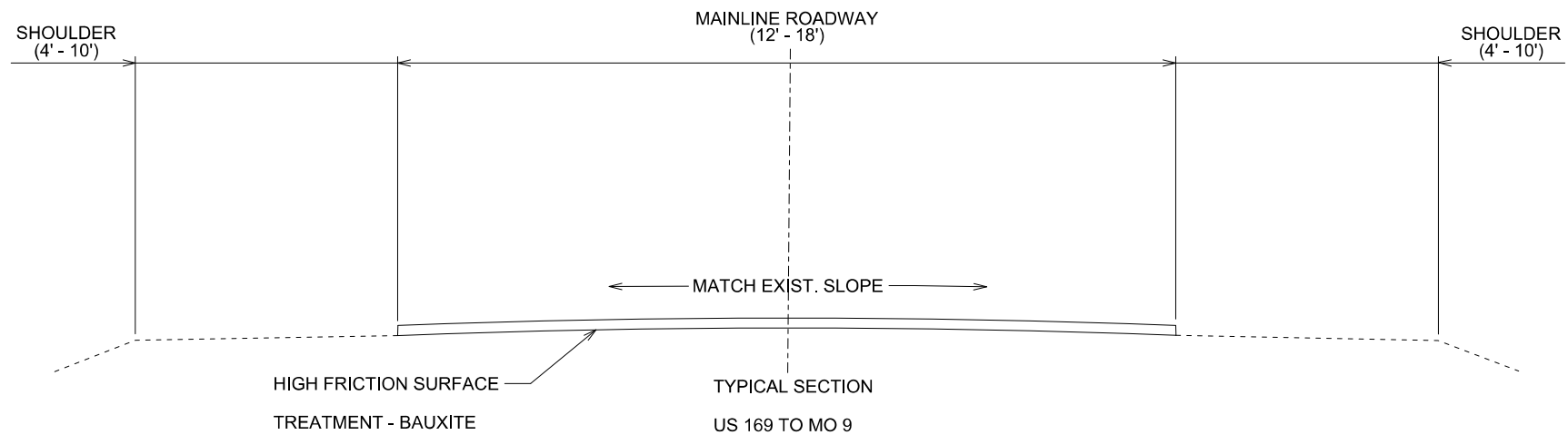
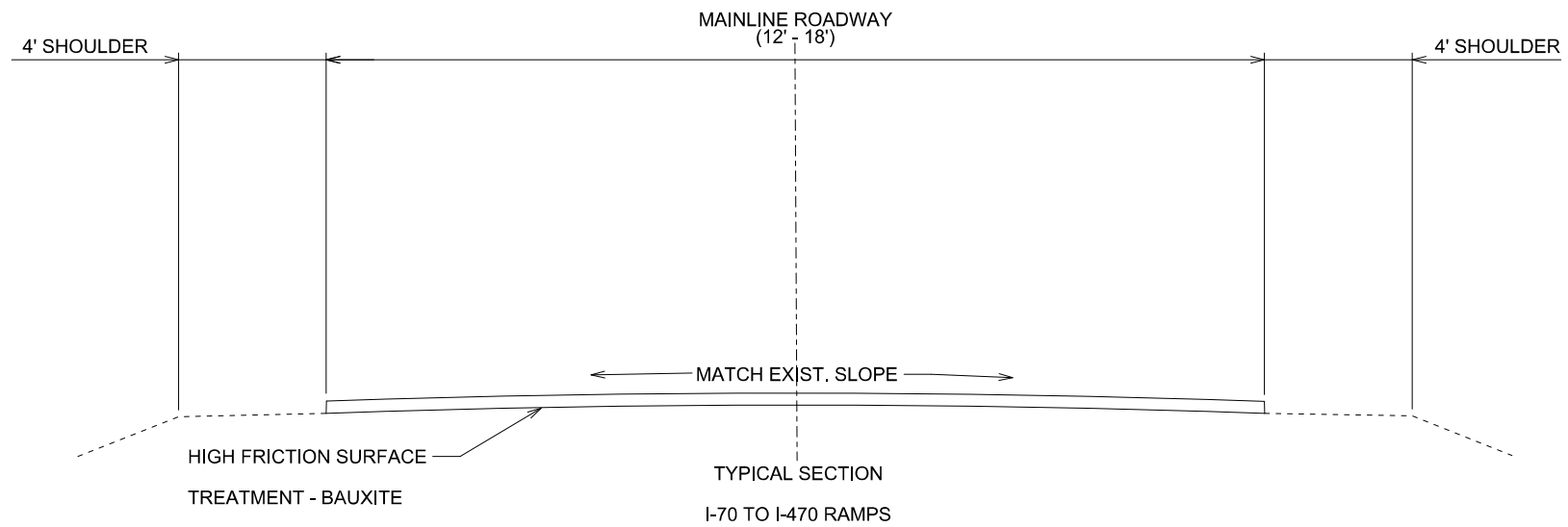
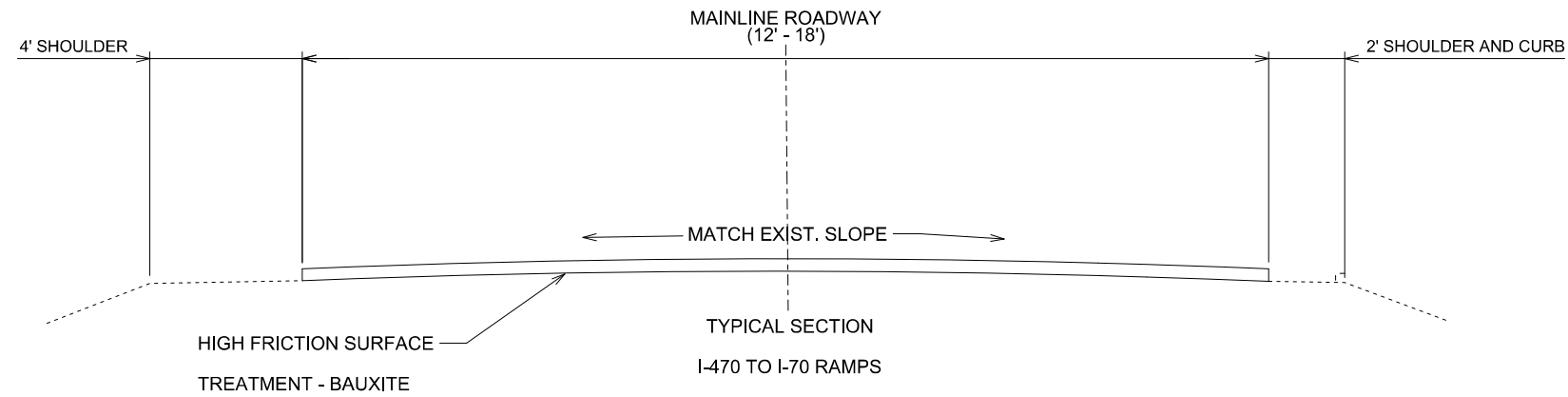

TYPICAL SHEET
SHEET 1 OF 2



DATE PREPARED
11/19/2024

ROUTE STATE
VAR MO

DISTRICT SHEET NO.
KC 2

COUNTY
VARIOUS

JOB NO.
JKU0370

CONTRACT ID.

PROJECT NO.

BRIDGE NO.

DATE	DESCRIPTION

MISSOURI HIGHWAYS AND TRANSPORTATION COMMISSION

105 WEST CAPITOL
JEFFERSON CITY, MO 65102
1-888-ASK-MODOT (1-888-275-6636)



Benjamin Stephen McCabe Sr.
11/22/2024 2:04:02 PM
BENJAMIN STEPHEN MCCABE SR. - CIVIL
MO-PE-2003015005

DATE PREPARED
11/19/2024

ROUTE STATE
VAR MO

DISTRICT SHEET NO.
KC 2

COUNTY
VARIOUS

JOB NO.
JKU0370

CONTRACT ID.

PROJECT NO.

BRIDGE NO.

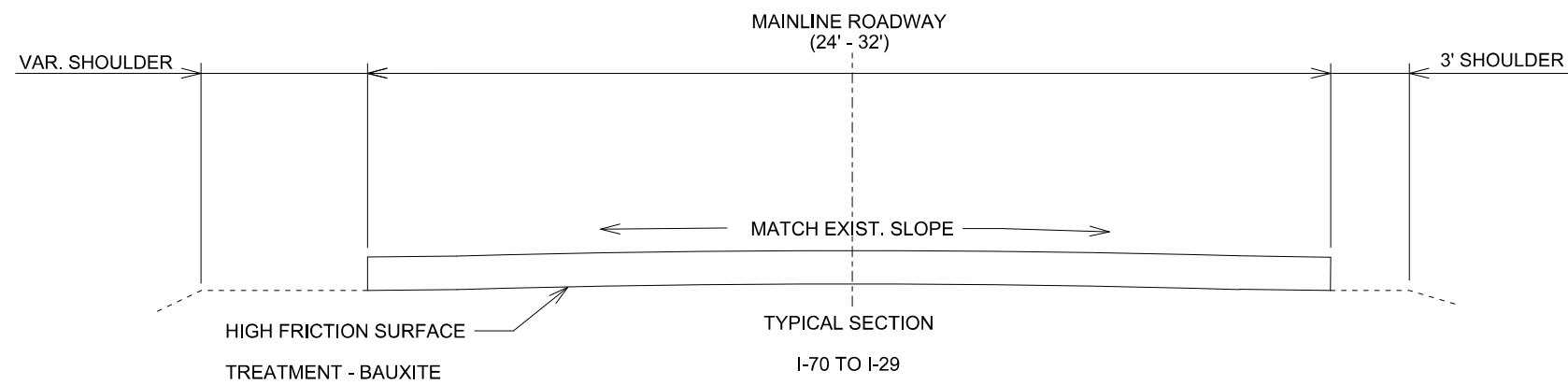
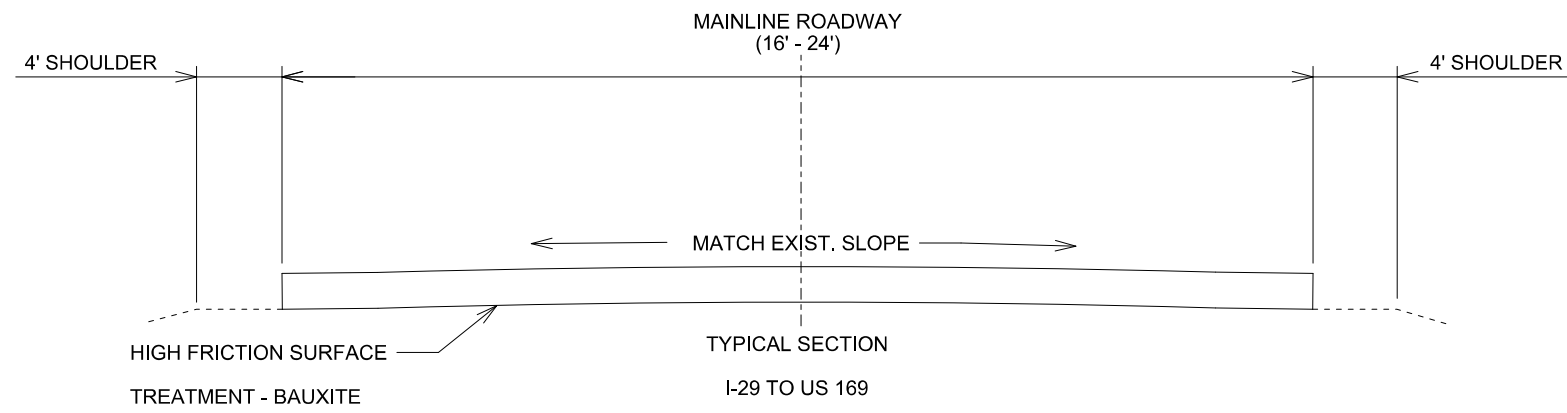
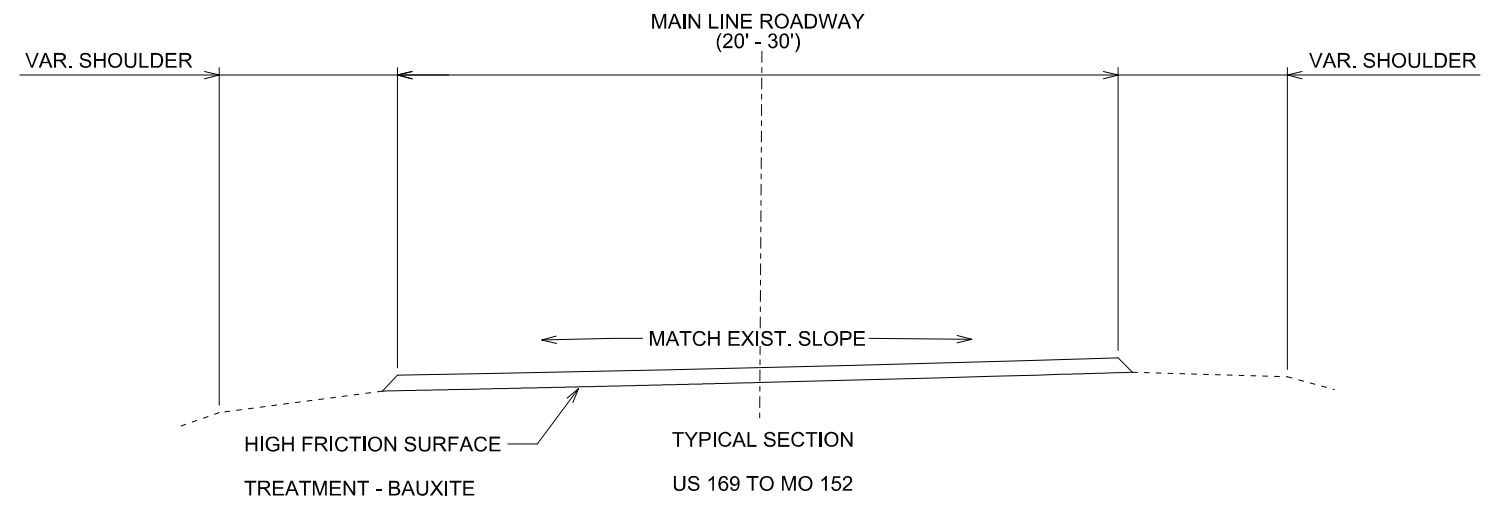

TYPICAL SHEET
SHEET 2 OF 2

DATE	DESCRIPTION

MISSOURI HIGHWAYS AND TRANSPORTATION COMMISSION

105 WEST CAPITOL
JEFFERSON CITY, MO 65102
1-888-ASK-MODOT (1-888-273-6636)

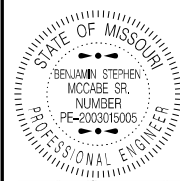

Benjamin Stephen McCabe Sr.
11/22/2024 2:05:32 PM
BENJAMIN STEPHEN MCCABE SR. - CIVIL
MO-PE-2003015005

DATE PREPARED
11/19/2024

ROUTE STATE
VAR MO

DISTRICT SHEET NO.
KC 3

COUNTY
VARIOUS

JOB NO.
JKU0370

CONTRACT ID.

PROJECT NO.

BRIDGE NO.

PAVEMENT MARKING				
LOCATION	6" YELLOW HIGH BUILD WATERBORNE PVMT MARKING LF	6" SOLID WHITE HIGH BUILD WATERBORNE PVMT MARKING LF	6" INTERMITTENT WHITE HIGH BUILD WATERBORNE PVMT MARKING LF	12" WHITE HIGH BUILD WATERBORNE PVMT MARKING LF
WB I - 70 TO SB I - 470	55	330	39	105
NB I - 470 TO WB I - 70	35	330	25	145
SB I - 470 TO EB I - 70	100	320	44	125
EB I - 70 TO NB I - 470	120	380	25	175
EB I - 70 TO SB I - 470 ENTRANCE	258	550	24	265
EB I - 70 TO SB I - 470 EXIT	525	750	29	190
SB US 169 TO SB MO 9	780	430	23	260
WB MO 152 TO SB US 169 ENTRANCE	145	430	0	287
SB I - 29 TO NB US 169 ONRAMP	130	454	72	111
WB I - 70 TO NB I - 29	454	167	0	228
NB I - 29 TO WB I - 70	206	200	41	63
TOTALS		4341	322	
PAY TOTALS	2808		4663	1954

HIGH FRICTION SURFACE TREATMENT			
LOCATION	WIDTH LF	LENGTH LF	HFST SY
WB I-70 TO SB I-470	14	330	513
NB I-470 TO WB I-70	14	330	513
SB I-470 TO EB I-70	14	320	498
EB I-70 TO NB I-470	14	380	591
EB I-70 TO SB I-470 ENTRANCE	17	550	1039
EB I-70 TO SB I-470 EXIT	16	750	1333
SB US 169 TO SB MO 9	28	430	1338
WB MO 152 TO SB US 169 ENTRANCE	21	430	1003
SB I-29 TO NB US 169	16	454	807
WB I-70 TO NB I-29	24	454	1211
NB I-29 TO WB I-70	24	206	549
TOTALS		9395	

MOBILIZATION
ONE LUMP SUM

DESCRIPTION	DATE





JACKSON COUNTY
WB I-70 TO SB I-470

- 513 SY. HIGH FRICTION SURFACE TREATMENT – BAUXITE
- 55 FT. 6" SOLID YELLOW PVMT. MARKING
- 39 FT. 6" INTERMITTENT WHITE PVMT. MARKING
- 330 FT. 6" SOLID WHITE PVMT. MARKING
- 105 FT. 12" SOLID WHITE PVMT. MARKING

MATCH EXISTING STRIPING

NOT TO SCALE

PLAN SHEETS
I-70 & I-470
INTERSECTION
SHEET 1 OF 11

Benjamin Stephen McCabe Sr.
11/22/2024 2:07:29 PM
BENJAMIN STEPHEN MCCABE SR - CIVIL
MO-PE-2003015005

DATE PREPARED	
11/19/2024	
ROUTE	STATE
VAR	MO
DISTRICT	SHEET NO.
KC	4
COUNTY	
VARIOUS	
JOB NO.	
JKU0370	
CONTRACT ID.	
PROJECT NO.	
BRIDGE NO.	

DATE	DESCRIPTION

MISSOURI HIGHWAYS AND TRANSPORTATION
COMMISSION

105 WEST CAPITOL
JEFFERSON CITY, MO 65102
1-888-ASK-MODOT (1-888-275-6636)



513 SY. HIGH FRICTION SURFACE TREATMENT - BAUXITE
 35 FT. 6" SOLID YELLOW PVMT. MARKING
 330 FT. 6" SOLID WHITE PVMT. MARKING
 25 FT. 6" INTERMITTENT WHITE PVMT. MARKING
 145 FT. 12" SOLID WHITE PVMT. MARKING

MATCH EXISTING STRIPING

JACKSON COUNTY
 NB I-470 TO WB I-70

NOT TO SCALE

PLAN SHEETS
 I-70 & I-470
 INTERSECTION
 SHEET 2 OF 11

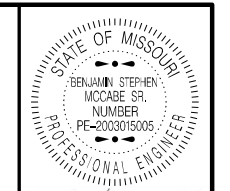

DATE PREPARED
 11/19/2024

ROUTE	STATE
VAR	MO
DISTRICT	SHEET NO.
KC	5

COUNTY
 VARIOUS
 JOB NO.
 JKU0370
 CONTRACT ID.

PROJECT NO.
 BRIDGE NO.

DATE	DESCRIPTION

MISSOURI HIGHWAYS AND TRANSPORTATION COMMISSION

105 WEST CAPITOL
 JEFFERSON CITY, MO 65102
 1-888-ASK-MODOT (1-888-275-6636)

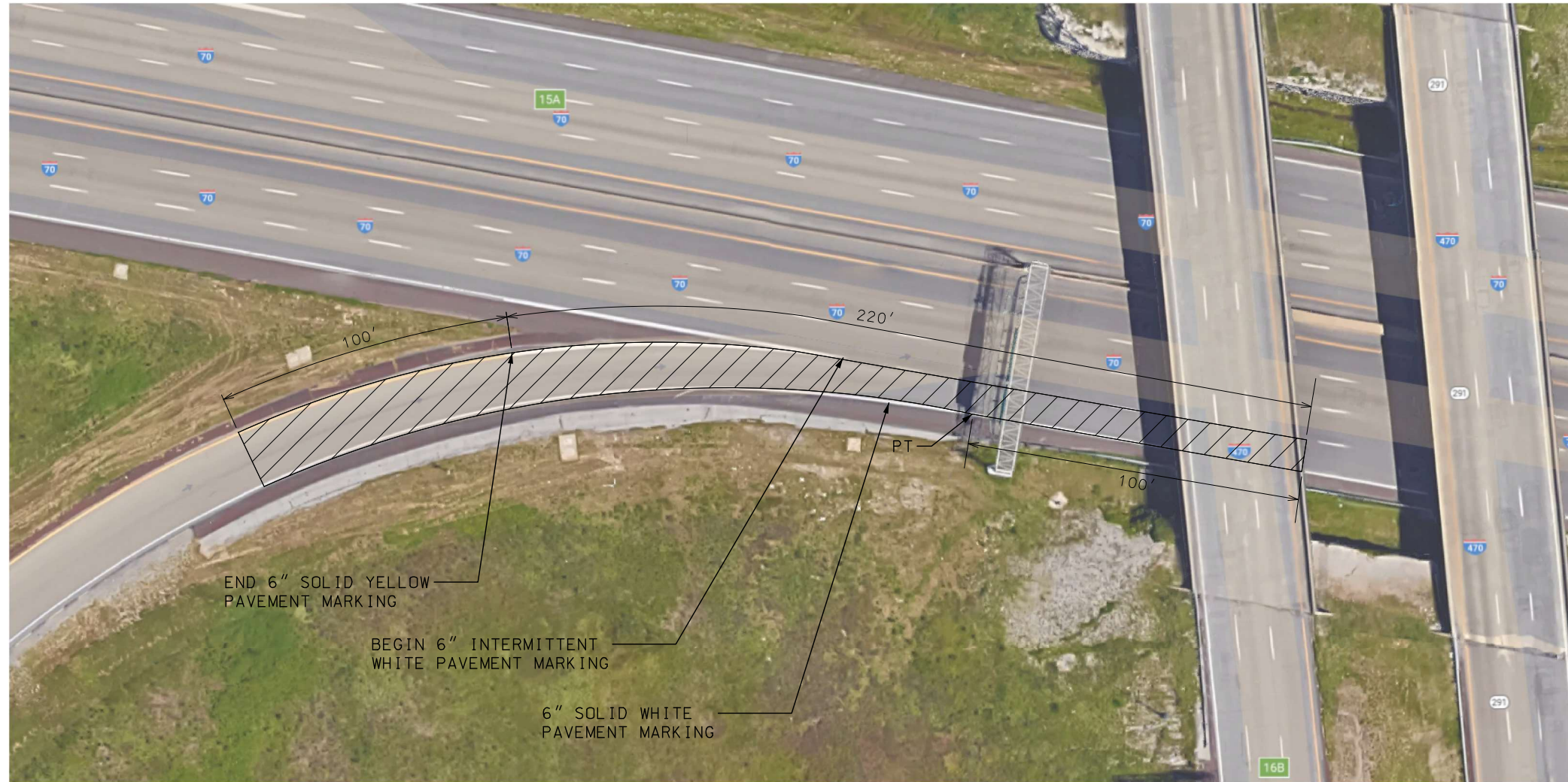

498 SY. HIGH FRICTION SURFACE TREATMENT - BAUXITE
 100 FT. 6" SOLID YELLOW PVMT. MARKING
 320 FT. 6" SOLID WHITE PVMT. MARKING
 44 FT. 6" INTERMITTENT WHITE PVMT. MARKING
 125 FT. 12" SOLID WHITE PVMT. MARKING

MATCH EXISTING STRIPING

JACKSON COUNTY
 SB I-470 TO EB I-70

NOT TO SCALE

PLAN SHEETS
 I-70 & I-470
 INTERSECTION
 SHEET 3 OF 11



Benjamin Stephen McCabe Sr.
 11/22/2024 2:59:26 PM
 BENJAMIN STEPHEN MCCABE SR - CIVIL
 MO-PE-2003015005

DATE PREPARED	
11/19/2024	
ROUTE	STATE
VAR	MO
DISTRICT	SHEET NO.
KC	6
COUNTY	
VARIOUS	
JOB NO.	
JKU0370	
CONTRACT ID.	
PROJECT NO.	
BRIDGE NO.	

DATE	DESCRIPTION

MISSOURI HIGHWAYS AND TRANSPORTATION COMMISSION



105 WEST CAPITOL
 JEFFERSON CITY, MO 65102
 1-888-ASK-MODOT (1-888-275-6636)



Benjamin Stephen McCabe, Sr.
 11/22/2024 2:10:32 PM
 BENJAMIN STEPHEN MCCABE, SR. - CIVIL
 MO-PE-2003015005

DATE PREPARED 11/19/2024	
ROUTE VAR	STATE MO
DISTRICT KC	SHEET NO. 7
COUNTY VARIOUS	
JOB NO. JKU0370	
CONTRACT ID.	
PROJECT NO.	
BRIDGE NO.	

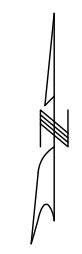

- 591 SY. HIGH FRICTION SURFACE TREATMENT - BAUXITE
 - 120 FT. 6" SOLID YELLOW PVMT. MARKING
 - 380 FT. 6" SOLID WHITE PVMT. MARKING
 - 25 FT. 6" INTERMITTENT WHITE PVMT. MARKING
 - 175 FT. 12" SOLID WHITE PVMT. MARKING
- MATCH EXISTING STRIPING

JACKSON COUNTY
 EB I-70 TO NB I-470

NOT TO SCALE

PLAN SHEETS
 I-70 & I-470
 INTERSECTION
 SHEET 4 OF 11

DATE	DESCRIPTION

MISSOURI HIGHWAYS AND TRANSPORTATION COMMISSION

105 WEST CAPITOL
 JEFFERSON CITY, MO 65102
 1-888-ASK-MODOT (1-888-275-6636)

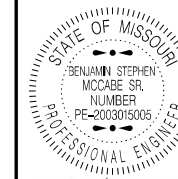

BENJAMIN STEPHEN MCCABE SR.
 11/22/2024 2:11:50 PM
 BENJAMIN STEPHEN MCCABE SR. - CIVIL
 MO-PE-2003015005

DATE PREPARED
 11/19/2024

ROUTE STATE
 VAR MO

DISTRICT SHEET NO.
 KC 8

COUNTY
 VARIOUS

JOB NO.
 JKU0370

CONTRACT ID.

PROJECT NO.

BRIDGE NO.

DESCRIPTION	DATE

MISSOURI HIGHWAYS AND TRANSPORTATION COMMISSION



105 WEST CAPITOL
 JEFFERSON CITY, MO 65102
 1-888-ASK-MODOT (1-888-275-6636)



1039 SY. HIGH FRICTION SURFACE TREATMENT - BAUXITE
 258 FT. 6" SOLID YELLOW PVMT. MARKING
 550 FT. 6" SOLID WHITE PVMT. MARKING
 24 FT. 6" INTERMITTENT WHITE PVMT. MARKING
 265 FT. 12" SOLID WHITE PVMT. MARKING
 MATCH EXISTING STRIPING

JACKSON COUNTY
 EB I-70 TO SB I-470 ENTRANCE

NOT TO SCALE

PLAN SHEETS
 I-70 & I-470
 INTERSECTION
 SHEET 5 OF 11



Benjamin Stephen McCabe Sr.
 11/22/2024 2:12:56 PM
 BENJAMIN STEPHEN MCCABE SR - CIVIL
 MO-PE-2003015005

DATE PREPARED
11/19/2024

ROUTE VAR	STATE MO
DISTRICT KC	SHEET NO. 9

COUNTY
VARIOUS
 JOB NO.
JKU0370
 CONTRACT ID.

PROJECT NO.
 BRIDGE NO.

DATE	DESCRIPTION

MISSOURI HIGHWAYS AND TRANSPORTATION COMMISSION



105 WEST CAPITOL
 JEFFERSON CITY, MO 65102
 1-888-ASK-MODOT (1-888-275-6636)



- 1333 SY. HIGH FRICTION SURFACE TREATMENT - BAUXITE
- 525 FT. 6" SOLID YELLOW PVMT. MARKING
- 750 FT. 6" SOLID WHITE PVMT. MARKING
- 29 FT. 6" INTERMITTENT WHITE PVMT. MARKING
- 190 FT. 12" SOLID WHITE PVMT. MARKING

MATCH EXISTING STRIPING

JACKSON COUNTY
 EB I-70 TO SB I-470

NOT TO SCALE

PLAN SHEETS
 I-70 & I-470
 INTERSECTION
 SHEET 6 OF 11





TOTALS:
 1338 SY HIGH FRICTION SURFACE TREATMENT - BAUXITE
 780 FT. 6" SOLID YELLOW PVMT. MARKING
 430 FT. 6" SOLID WHITE PVMT. MARKING
 23 FT. 6" INTERMITTENT WHITE PVMT. MARKING
 260 FT. 12" SOLID WHITE PVMT. MARKING

MATCH EXISTING STRIPING

CLAY COUNTY - SB US 169 TO SB MO 9

NOT TO SCALE



Benjamin Stephen McCabe Sr.
 11/22/2024 2:35:57 PM
 BENJAMIN STEPHEN MCCABE SR - CIVIL
 MO-PE-2003015005

DATE PREPARED
 11/19/2024
 ROUTE STATE
 VAR MO
 DISTRICT SHEET NO.
 KC 10
 COUNTY
 VARIOUS
 JOB NO.
 JKU0370
 CONTRACT ID.

DESCRIPTION	DATE

MISSOURI HIGHWAYS AND TRANSPORTATION
 COMMISSION

 105 WEST CAPITOL
 JEFFERSON CITY, MO 65102
 1-888-ASK-MODOT (1-888-275-6636)

PLAN SHEETS
 US 169 AND MO 9
 INTERSECTION
 SHEET 7 OF 11



1003 SY. HIGH FRICTION SURFACE TREATMENT – BAUXITE
 145 FT. 6" SOLID YELLOW PVMT. MARKING
 430 FT. 6" SOLID WHITE PVMT. MARKING
 287 FT. 12" SOLID WHITE PVMT. MARKING

MATCH EXISTING STRIPING

CLAY COUNTY
 WB MO 152 TO SB US 169 ENTRANCE

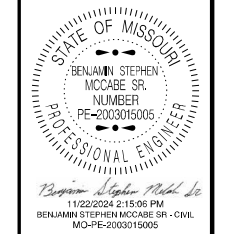

DATE PREPARED
11/19/2024

ROUTE VAR	STATE MO
DISTRICT KC	SHEET NO. 11
COUNTY VARIOUS	
JOB NO. JKU0370	
CONTRACT ID.	
PROJECT NO.	
BRIDGE NO.	

DATE	DESCRIPTION

MISSOURI HIGHWAYS AND TRANSPORTATION
 COMMISSION



105 WEST CAPITOL
 JEFFERSON CITY, MO 65102
 1-888-ASK-MODOT (1-888-273-6636)

NOT TO SCALE

PLAN SHEETS
 MO 152 & US 169
 INTERSECTION
 SHEET 8 OF 11

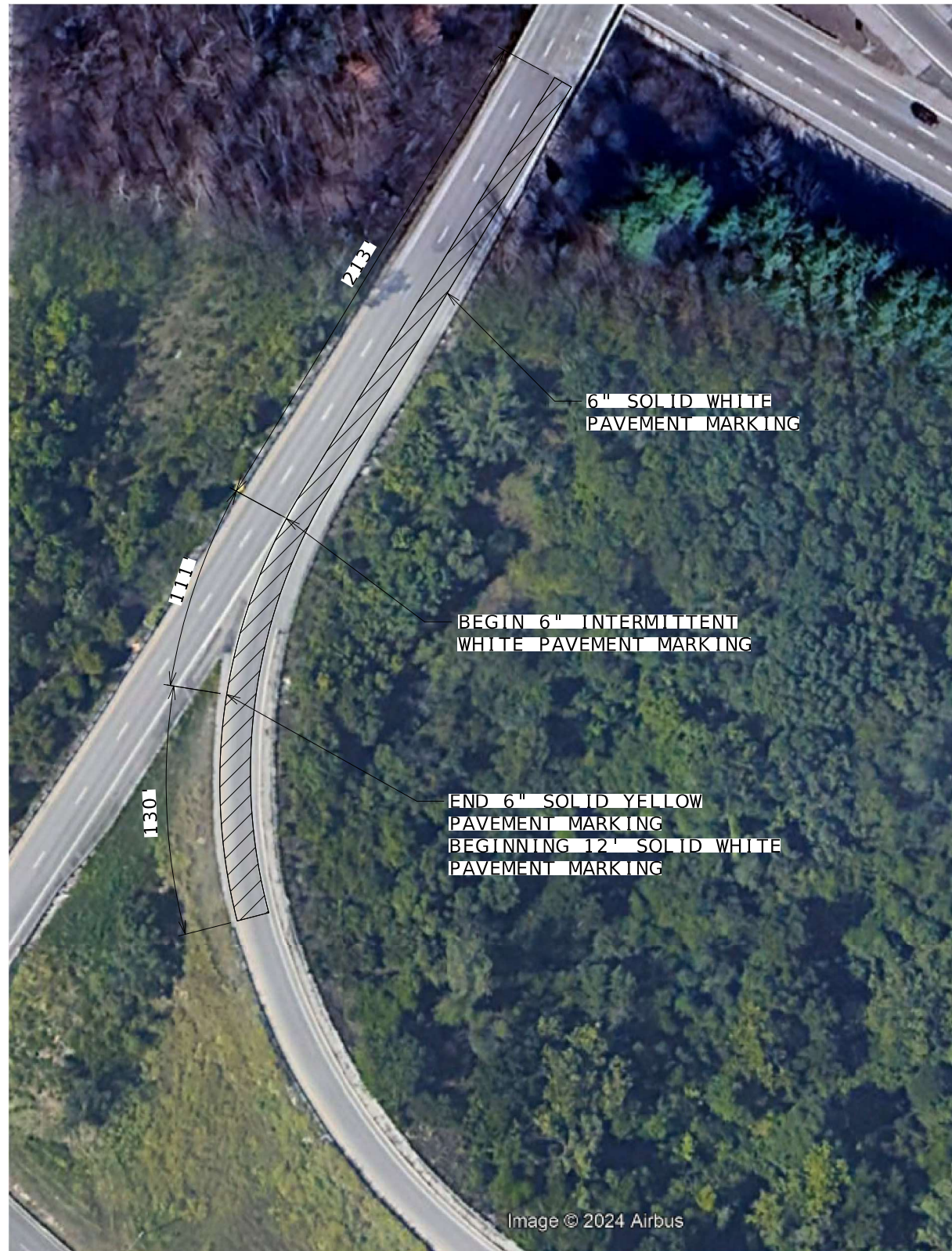

Image © 2024 Airbus

807 SY. HIGH FRICTION SURFACE TREATMENT
 130 FT. 6" SOLID YELLOW PVMT. MARKING
 72 FT. 6" INTERMITTENT WHITE PVMT. MARKING
 454 FT. 6" SOLID WHITE PVMT. MARKING
 111 FT. 12" SOLID WHITE PVMT. MARKING

CLAY COUNTY
 SB I-29 TO NB US 169

NOT TO SCALE

PLAN SHEETS
 I-29 AND US 169
 INTERSECTION
 SHEET 9 OF 11



Benjamin Stephen McCabe Sr.
 11/22/2024 2:16:00 PM
 BENJAMIN STEPHEN MCCABE SR - CIVIL
 MO-PE-2003015005

DATE PREPARED		11/19/2024	
ROUTE	STATE	VAR	MO
DISTRICT	SHEET NO.	KC	12
COUNTY			
VARIOUS			
JOB NO.			
JKU0370			
CONTRACT ID.			
PROJECT NO.			
BRIDGE NO.			

DATE	DESCRIPTION

MISSOURI HIGHWAYS AND TRANSPORTATION COMMISSION

105 WEST CAPITOL
 JEFFERSON CITY, MO 65102
 1-888-ASK-MODOT (1-888-275-6636)



NOT TO SCALE

1211 SY. HIGH FRICTION SURFACE TREATMENT – BAUXITE
 454 FT. 6" SOLID YELLOW PVMT. MARKING
 167 FT. 6" SOLID WHITE PVMT. MARKING
 228 FT. 12" SOLID WHITE PVMT. MARKING
 MATCH EXISTING STRIPING

JACKSON COUNTY
 WB I-70 TO NB I-29

PLAN SHEETS
 I-70 & I-29
 INTERSECTION
 SHEET 10 OF 11



STATE OF MISSOURI

BENJAMIN STEPHEN MCCABE SR.
NUMBER
PE-2003015005
PROFESSIONAL ENGINEER

Benjamin Stephen McCabe Sr.
11/22/2024 2:16:55 PM
BENJAMIN STEPHEN MCCABE SR - CIVIL
MO-PE-2003015005

DATE PREPARED
11/19/2024

<small>ROUTE</small> VAR	<small>STATE</small> MO
<small>DISTRICT</small> KC	<small>SHEET NO.</small> 13

COUNTY
VARIOUS

JOB NO.
JKU0370

CONTRACT ID.

PROJECT NO.

BRIDGE NO.

DATE	DESCRIPTION

MISSOURI HIGHWAYS AND TRANSPORTATION COMMISSION

105 WEST CAPITOL
JEFFERSON CITY, MO 65102
1-888-ASK-MODOT (1-888-275-6636)



549 SY. HIGH FRICTION SURFACE TREATMENT - BAUXITE
 206 FT. 6" SOLID YELLOW PVMT. MARKING
 200 FT. 6" SOLID WHITE PVMT. MARKING
 41 FT. 6" INTERMITTENT WHITE PVMT. MARKING
 63 FT. 12" SOLID WHITE PVMT. MARKING
 MATCH EXISTING STRIPING

JACKSON COUNTY
 NB I-29 TO WB I-70

NOT TO SCALE

PLAN SHEETS
 I-70 & I-29
 INTERSECTION
 SHEET 11 OF 11



STATE OF MISSOURI
 BENJAMIN STEPHEN MCCABE SR.
 NUMBER PE-2003015005
 PROFESSIONAL ENGINEER

Benjamin Stephen McCabe Sr.
 11/22/2024 2:17:54 PM
 BENJAMIN STEPHEN MCCABE SR - CIVIL
 MO-PE-2003015005

DATE PREPARED
 11/19/2024

ROUTE VAR	STATE MO
DISTRICT KC	SHEET NO. 14
COUNTY VARIOUS	
JOB NO. JKU0370	
CONTRACT ID.	
PROJECT NO.	
BRIDGE NO.	

DATE	DESCRIPTION

MISSOURI HIGHWAYS AND TRANSPORTATION COMMISSION

105 WEST CAPITOL
 JEFFERSON CITY, MO 65102
 1-888-ASK-MODOT (1-888-275-6636)

SPACING AND TAPER LENGTHS FOR WORK ZONE SIGNS, CHANNELIZERS AND CONCRETE BARRIER

SIGN SPACING FOR ADVANCE SIGN SERIES (1) (2)		
PERMANENT POSTED SPEED MPH	UNDIVIDED HIGHWAYS	DIVIDED HIGHWAYS
0-35	200'	200'
40-45	350'	500'
50-55	500'	1000'
60-70	1000'	SA - 1000' SB - 1500' SC - 2640'

TAPER LENGTHS AND END TREATMENTS FOR CONCRETE BARRIER				
PERMANENT POSTED SPEED MPH	MINIMUM LANE TAPER LENGTH (3)			END TREATMENT (4)
MPH	10'	11'	12'	END TREATMENT (4)
<40	160'	168'	176'	BARRIER HEIGHT TRANSITION
>40	160'	168'	176'	APPROVED CRASH CUSHION

TAPER LENGTHS AND SPACING FOR CHANNELIZERS							
PERMANENT POSTED SPEED MPH	MINIMUM LANE TAPER LENGTH (3)			MINIMUM SHOULDER TAPER LENGTH BASED ON 10' SHOULDER	BUFFER LENGTH FT	MAXIMUM CHANNELIZER SPACING	
MPH	10'	11'	12'	BASED ON 10' SHOULDER	FT	THROUGH TAPER	THROUGH WORK AREA
0-35	205'	225'	245'	70'	280'	35'	40'
40-45	450'	495'	540'	150'	400'	40'	80'
50-55	550'	605'	660'	185'	560'	50'	80'
60-70	700'	770'	840'	235'	840'	60'	120'



Benjamin Stephen McCabe Sr.
11/22/2024 2:18:52 PM
BENJAMIN STEPHEN MCCABE SR - CIVIL
MO-PE-2003015005

DATE PREPARED 11/19/2024	
ROUTE VAR	STATE MO
DISTRICT KC	SHEET NO. 15
COUNTY VARIOUS	
JOB NO. JKU0370	
CONTRACT ID.	
PROJECT NO.	
BRIDGE NO.	

DATE	DESCRIPTION

MISSOURI HIGHWAYS AND TRANSPORTATION COMMISSION

105 WEST CAPITOL
JEFFERSON CITY, MO 65102
1-888-ASK-MODOT (1-888-273-6636)

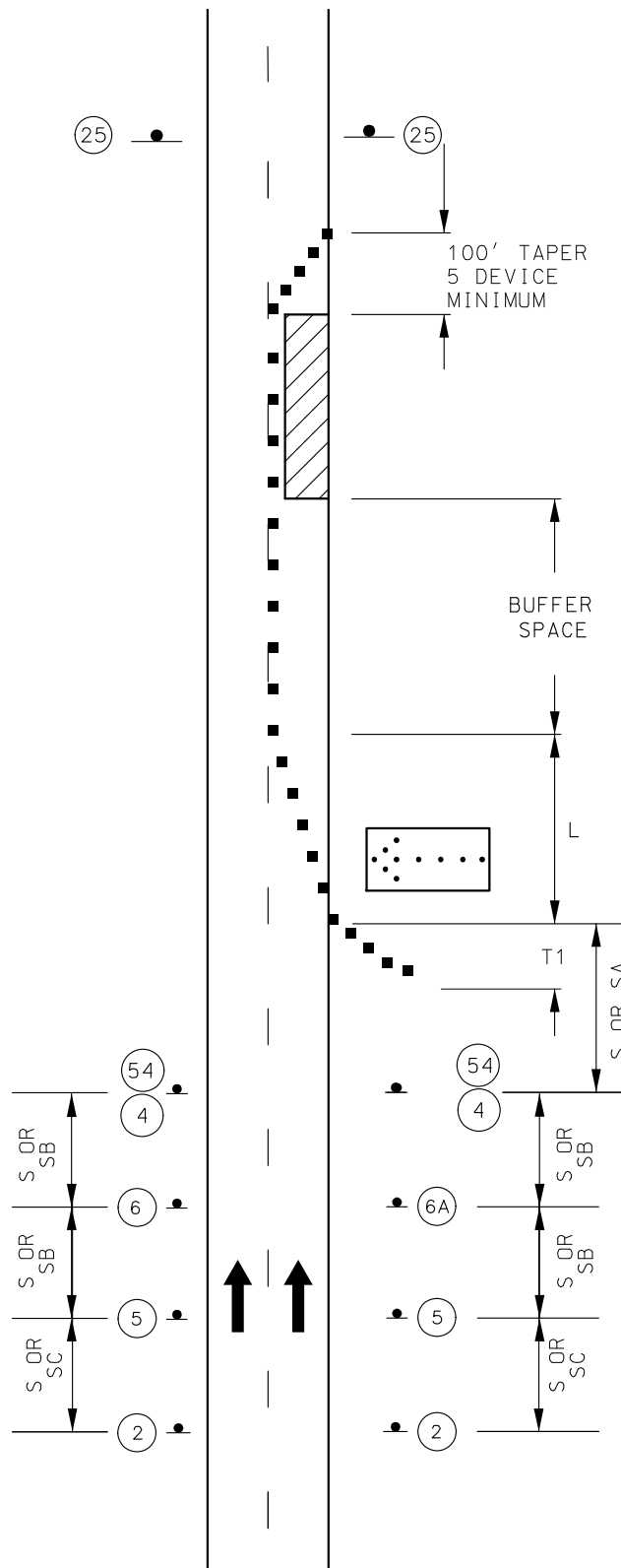

TWO-LANE DIVIDED HIGHWAY

- BRIDGE OR RAMP** (W025-6) (2)
- ROAD WORK AHEAD** (W020-1) (2)
- CENTER LANE CLOSED AHEAD** (W020-5) (5)
- RIGHT LANE CLOSED** (W020-6a) (6)
- MERGE** (W04-1a) (6A)
- SPEED LIMIT 55** (R2-1) (4)
- SPEED LIMIT 65** (R2-1) (25) - NORMAL SPEED
- WORK ZONE** (G020-5aP) (54)
- FLASHING ARROW PANEL**
- CHANNELIZERS**



Benjamin Stephen McCabe, Inc.
 11/22/2024 2:19:36 PM
 BENJAMIN STEPHEN MCCABE SR. - CIVIL
 MO-PE-2003015005

DATE PREPARED
 11/19/2024

ROUTE	STATE
VAR	MO
DISTRICT	SHEET NO.
KC	16

COUNTY
 VARIOUS

JOB NO.
 JKU0370

CONTRACT ID.

PROJECT NO.

BRIDGE NO.

DATE	DESCRIPTION

MISSOURI HIGHWAYS AND TRANSPORTATION COMMISSION

105 WEST CAPITOL
 JEFFERSON CITY, MO 65102
 1-888-ASK-MODOT (1-888-273-6636)

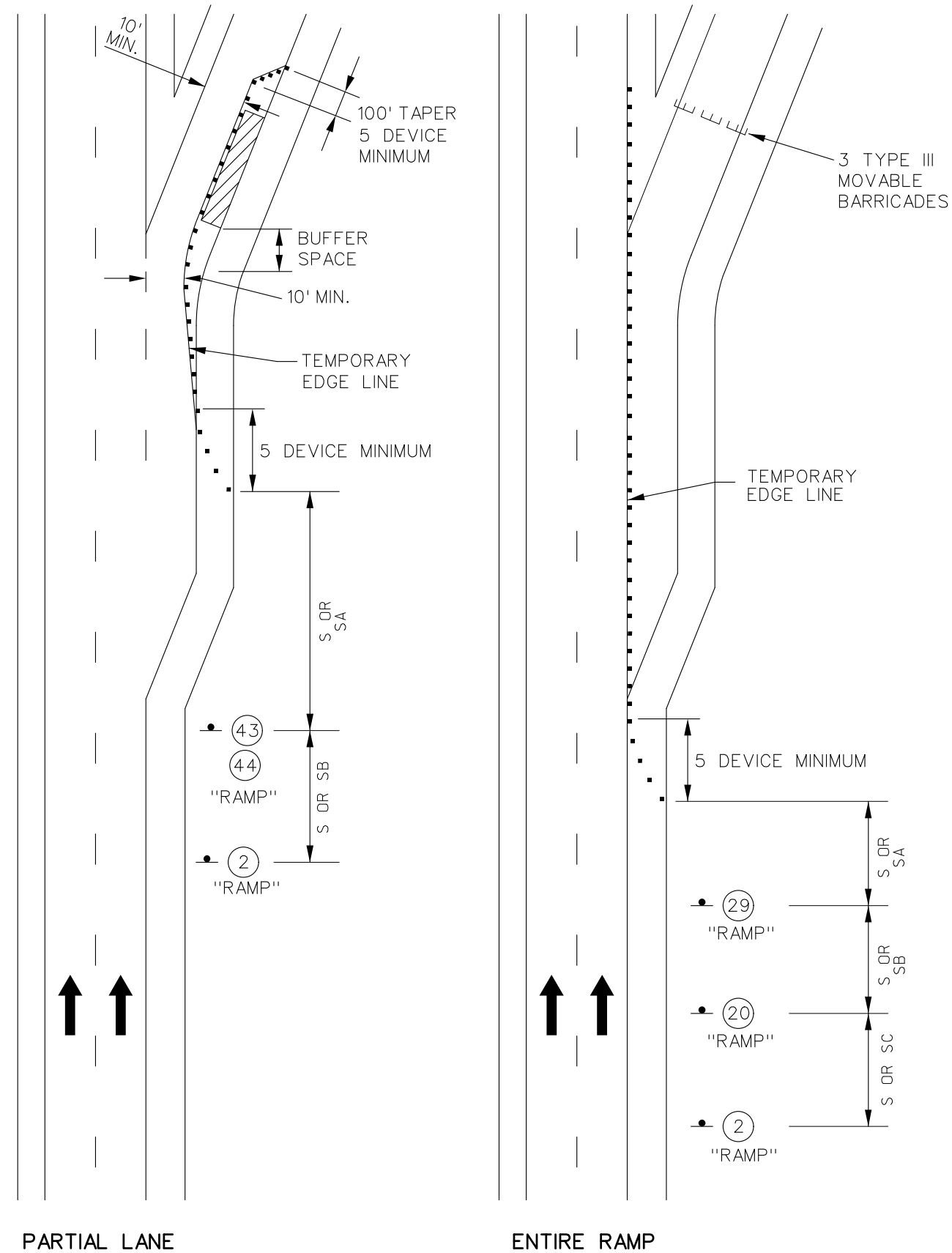

LANE CLOSURE
PARTIAL AND TOTAL RAMP CLOSURE

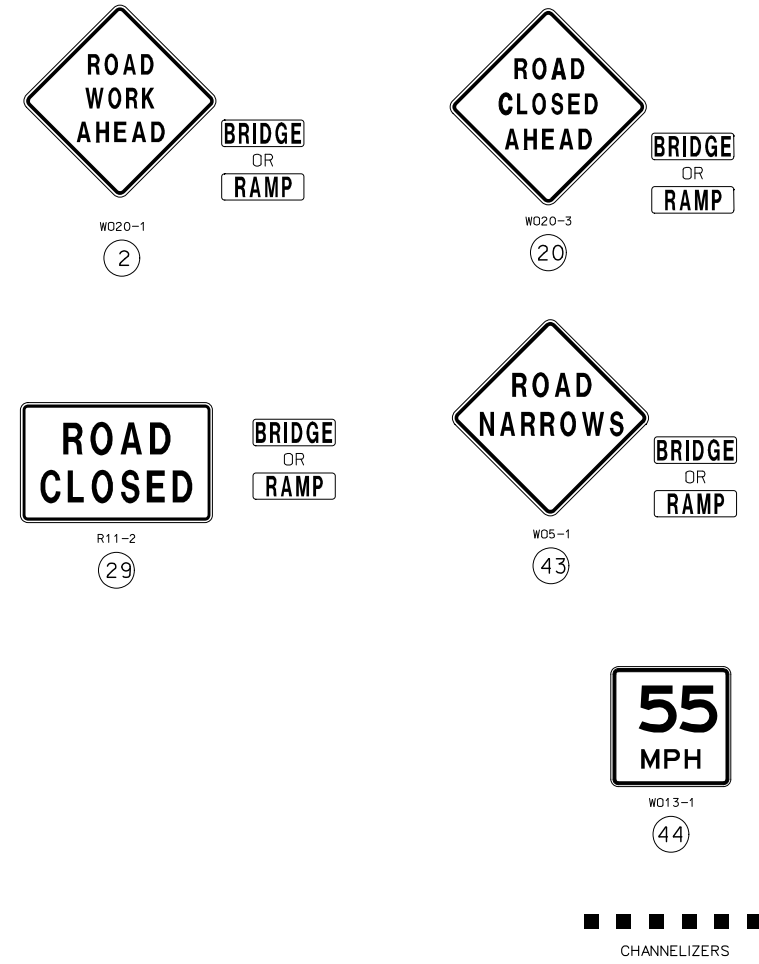

PARTIAL OR TOTAL
EXIT RAMP CLOSURE
TEMPORARY
TRAFFIC CONTROL
SHEET 3 OF 5

STATE OF MISSOURI
BENJAMIN STEPHEN MCCABE SR.
NUMBER PE-2003015005
PROFESSIONAL ENGINEER

Benjamin Stephen McCabe Sr.
11/22/2024 2:20:30 PM
BENJAMIN STEPHEN MCCABE SR - CIVIL
MO-PE-2003015005

DATE PREPARED
11/19/2024

ROUTE VAR	STATE MO
DISTRICT KC	SHEET NO. 17

COUNTY
VARIOUS

JOB NO.
JKU0370

CONTRACT ID.

PROJECT NO.

BRIDGE NO.

DATE	DESCRIPTION

MISSOURI HIGHWAYS AND TRANSPORTATION COMMISSION

MoDOT

105 WEST CAPITOL
JEFFERSON CITY, MO 65102
1-888-ASK-MODOT (1-888-275-6636)

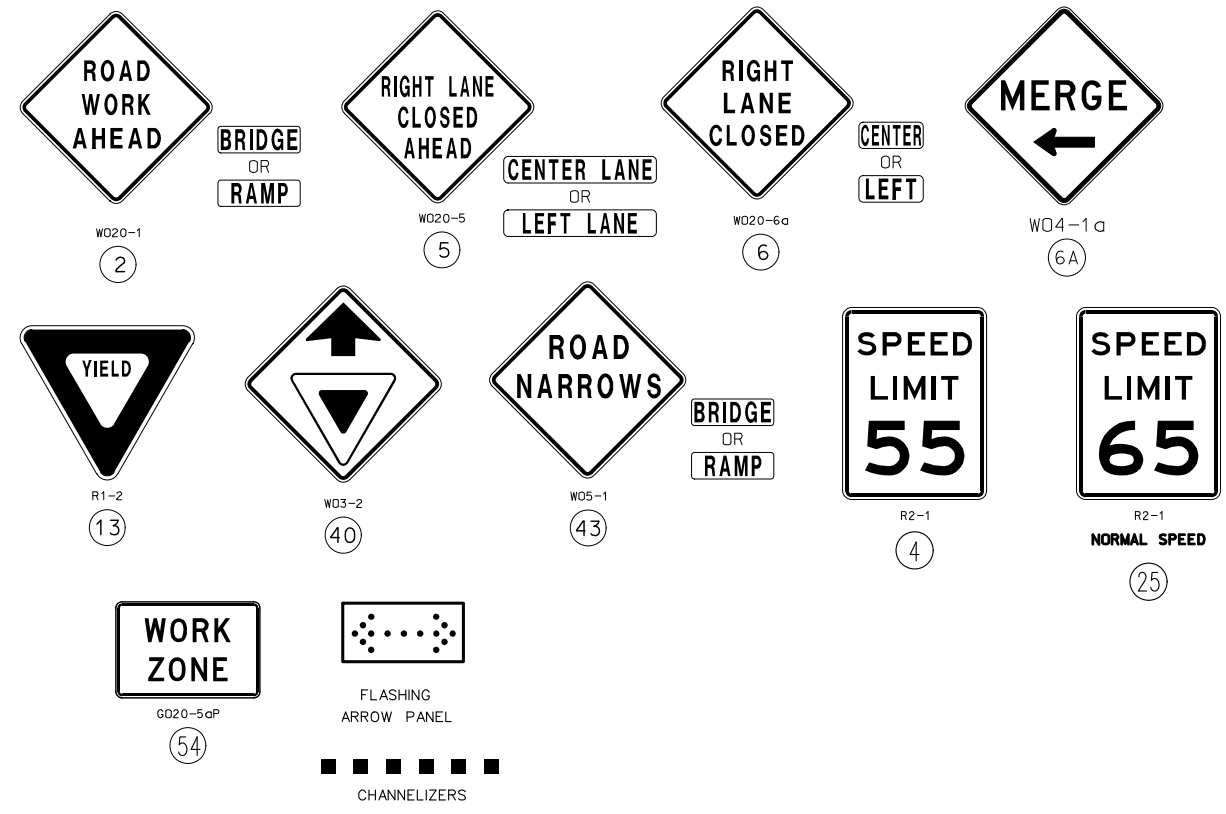
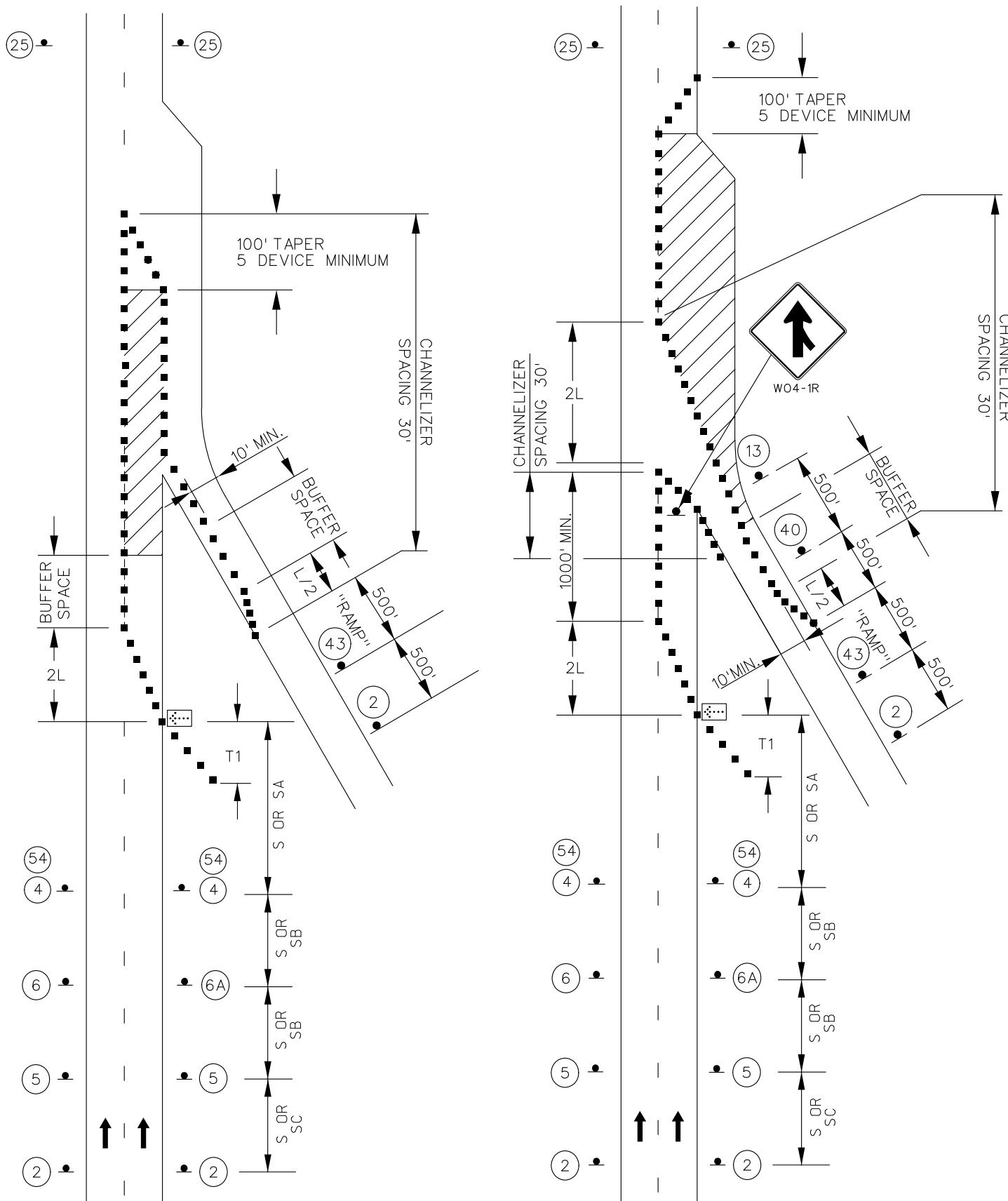

LANE CLOSURE
ENTRANCE RAMP AREAS

WORK IN VICINITY
OF ENTRANCE RAMP
TEMPORARY
TRAFFIC CONTROL
SHEET 4 OF 5

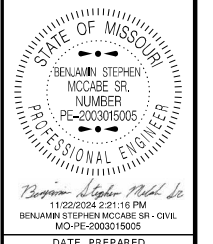

DATE PREPARED
11/19/2024

ROUTE VAR	STATE MO
DISTRICT KC	SHEET NO. 18
COUNTY VARIOUS	
JOB NO. JKU0370	
CONTRACT ID.	
PROJECT NO.	
BRIDGE NO.	

DATE	DESCRIPTION

MISSOURI HIGHWAYS AND TRANSPORTATION
COMMISSION

105 WEST CAPITOL
JEFFERSON CITY, MO 65102
1-888-ASK-MODOT (1-888-275-6636)

PAVEMENT MARKING EQUIPMENT

WARNING TRUCK WITH WORK SIGNS, FLASHING ARROW PANEL AND OPTIONAL TRUCK MOUNTED ATTENUATOR.

ADVANCE WARNING TRUCK WITH WORK SIGNS, FLASHING ARROW PANEL AND TRUCK MOUNTED ATTENUATOR. (2)

**MOVING OPERATION ON HIGHWAY
OPEN TO TRAFFIC
MULTI-LANE DIVIDED HIGHWAY**

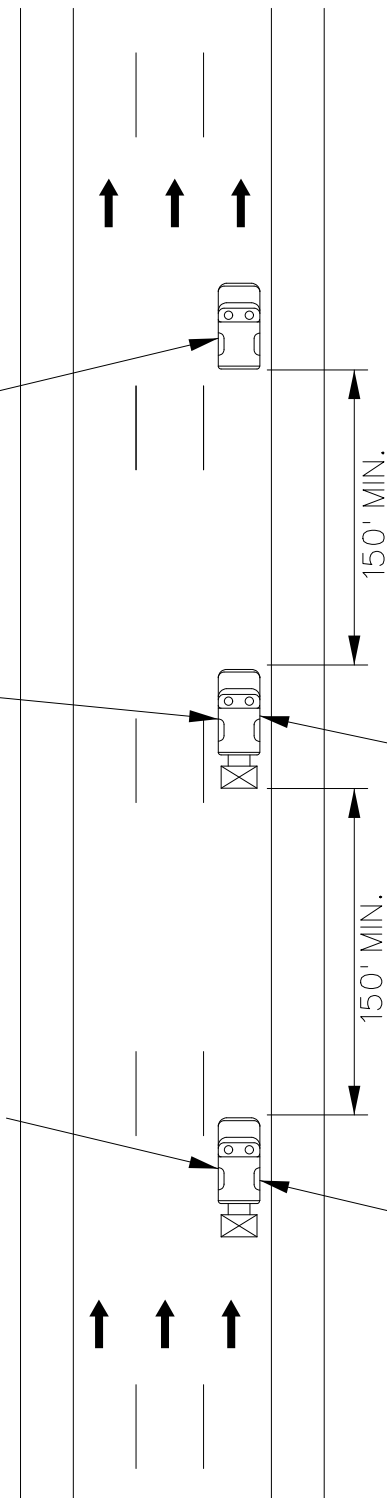

FLASHING ARROW PANEL - ARROW MODES

W020-6a
48" x 48"

W022-6e (1)
21" x 15"

CENTERLINE AND/OR
LANE LINE STRIPING
ON MULTI-LANE
UNDIVIDED HIGHWAYS
TEMPORARY
TRAFFIC CONTROL
SHEET 5 OF 5

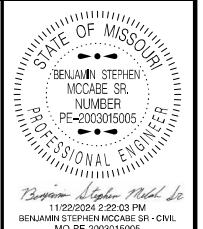

DATE PREPARED
11/19/2024

ROUTE STATE
VAR MO

DISTRICT SHEET NO.
KC 19

COUNTY
VARIOUS

JOB NO.
JKU0370

CONTRACT ID.

PROJECT NO.

BRIDGE NO.

DESCRIPTION	DATE

MISSOURI HIGHWAYS AND TRANSPORTATION COMMISSION

105 WEST CAPITOL
JEFFERSON CITY, MO 65102
1-888-ASK-MODOT (1-888-275-6636)