

**DESIGN DESIGNATION**

A.A.D.T. - 2020 = 1192  
 A.A.D.T. - 2040 = 1669  
 D.H.V. = 10%  
 T = 11.20%  
 V = 35 M.P.H.  
 D = 50%

FUNCTIONAL CLASSIFICATION- RURAL MAJOR COLLECTOR

NORMAL RIGHT OF WAY  
 REQUIRED FOR THIS PROJECT

# MISSOURI HIGHWAYS AND TRANSPORTATION COMMISSION PLANS FOR PROPOSED STATE HIGHWAY A CARTER COUNTY

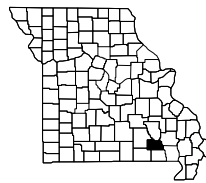

KEY MAP  
 SHOWING LOCATION OF COUNTY

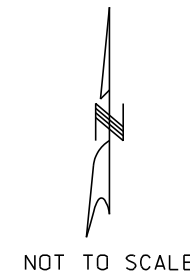

**CONVENTIONAL SYMBOLS  
 (USED IN PLANS)**

	EXISTING	NEW
BUILDINGS AND STRUCTURES		
GUARD RAIL		
GUARD CABLE		
CONCRETE RIGHT-OF-WAY MARKER		
STEEL RIGHT-OF-WAY MARKER		
LOCATION SURVEY MARKER		
UTILITIES		
FIBER OPTICS	-FO-	-FO-
OVERHEAD CABLE TV	-OTV-	-OTV-
UNDERGROUND CABLE TV	-UTV-	-UTV-
OVERHEAD TELEPHONE	-OT-	-OT-
UNDERGROUND TELEPHONE	-UT-	-UT-
OVERHEAD POWER	-OE-	-OE-
UNDERGROUND POWER	-UE-	-UE-
SANITARY SEWER	-S-	-S-
STORM SEWER	-SS-	-SS-
GAS	-G-	-G-
WATER	-W-	-W-
MANHOLE		
FIRE HYDRANT		
WATER VALVE		
WATER METER		
DROP INLET		
DITCH BLOCK		
GROUND MOUNTED SIGN		
LIGHT POLE		
H-FRAME POWER POLE		
TELEPHONE PEDESTAL		
FENCE		
CHAIN LINK		
WOVEN WIRE		
GATE POST		
BENCHMARK		

NOTE: DASHED OR OPEN SYMBOLS INDICATE EXISTING FEATURES

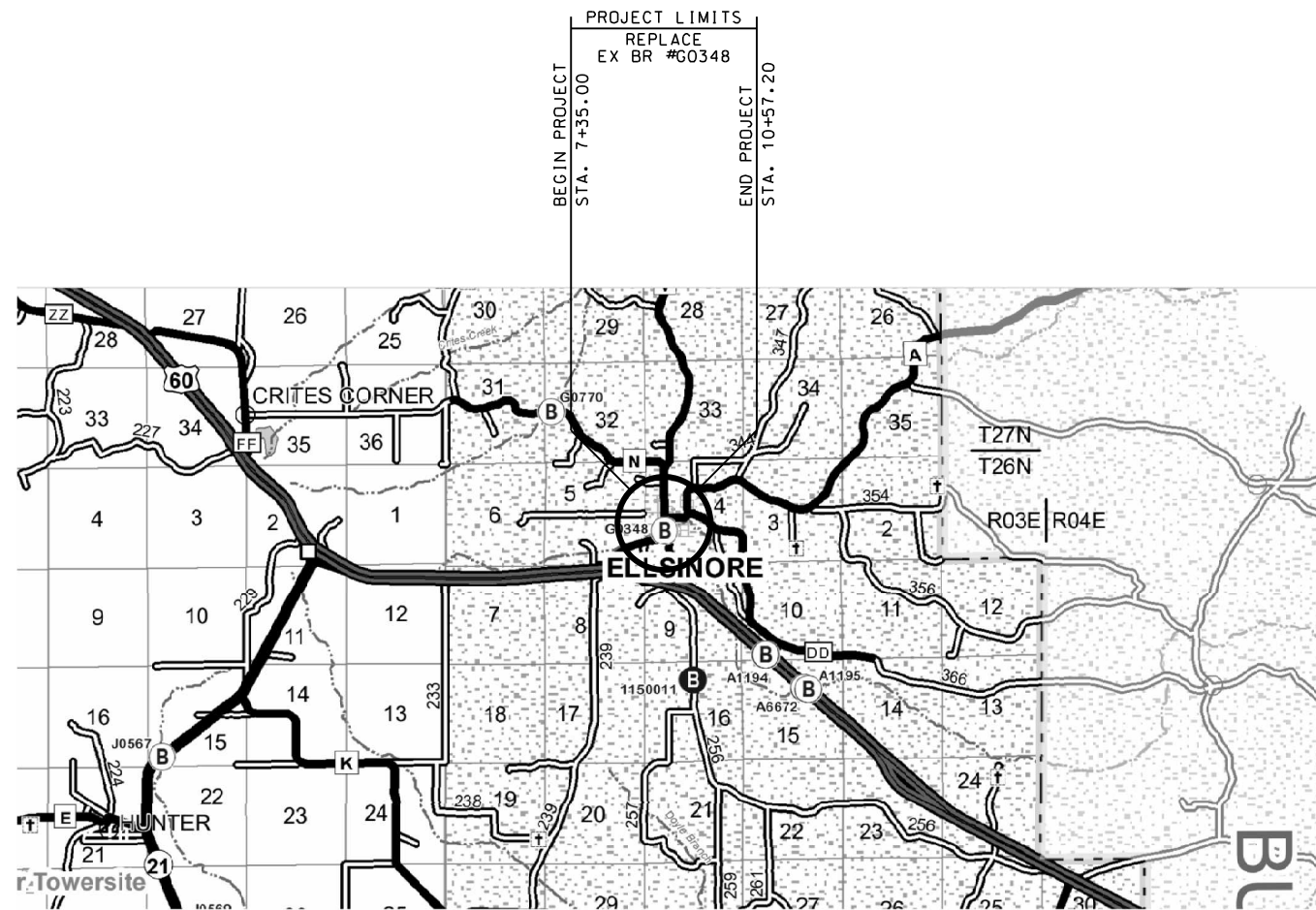

S4 T26N R3E

THE EXISTENCE AND APPROXIMATE LOCATION OF UTILITY FACILITIES KNOWN TO EXIST, AS SHOWN ON THE PLANS, ARE BASED ON THE BEST INFORMATION AVAILABLE TO THE COMMISSION AT THIS TIME. THIS INFORMATION IS PROVIDED BY THE COMMISSION "AS-IS" AND THE COMMISSION EXPRESSLY DISCLAIMS ANY REPRESENTATION OR WARRANTY AS TO THE COMPLETENESS, ACCURACY, OR SUITABILITY OF THE INFORMATION FOR ANY USE. RELIANCE UPON THIS INFORMATION IS DONE AT THE RISK AND PERIL OF THE USER, AND THE COMMISSION SHALL NOT BE LIABLE FOR ANY DAMAGES THAT MAY ARISE FROM ANY ERROR IN THE INFORMATION. IT IS, THEREFORE, THE RESPONSIBILITY OF THE CONTRACTOR TO VERIFY THE EXISTENCE, LOCATION AND STATUS OF ANY FACILITY. SUCH VERIFICATION INCLUDES DIRECT CONTACT WITH THE LISTED UTILITIES.

**INDEX OF SHEETS**

DESCRIPTION	SHEET NUMBER
TITLE SHEET -----	1
TYPICAL SECTIONS (TS) (1 SHEET)----	2
QUANTITIES (QU) (3 SHEETS)-----	3
PLAN-PROFILE (PP)-----	4-5
REF/COORD POINTS (RP/CP)-----	6
SPECIAL SHEETS (SS)-----	7
TRAFFIC CONTROL SHEETS (TC)-----	8-11
EROSION CONTROL SHEETS (EC)-----	12
BRIDGE DRAWINGS (B)	
A9213-----	1-2
CROSS SECTIONS (XS)-----	1-3



THIS SHEET HAS BEEN SIGNED, SEALED AND DATED ELECTRONICALLY.

DATE PREPARED	1/29/2025
ROUTE	A
STATE	MO
DISTRICT	SE
SHEET NO.	1
COUNTY	CARTER
JOB NO.	J9S3609
CONTRACT ID.	
PROJECT NO.	
BRIDGE NO.	A9213

DATE	DESCRIPTION

**LENGTH OF PROJECT**

BEGINNING OF PROJECT	STA. 7+35.00
END OF PROJECT	STA. 10+57.20
APPARENT LENGTH	322.20 FEET
EQUATIONS AND EXCEPTIONS:	

TOTAL CORRECTIONS	0 FEET
NET LENGTH OF PROJECT	322.20 FEET
STATE LENGTH	0.060 MILES
FOR INFORMATION ONLY ESTIMATED DISTURBED ACRES	0.35 ACRES

MISSOURI HIGHWAYS AND TRANSPORTATION COMMISSION

105 WEST CAPITOL  
 JEFFERSON CITY, MO 65102  
 1-888-ASK-MODOT (1-888-275-6636)

St. Louis  
 220 Olive, Suite 200  
 St. Charles, MO 63101  
 314.988.8381

St. Charles  
 820 South Main, Suite 200  
 St. Charles, MO 63101  
 636.493.6277

Callinsville  
 100 W. Hwy 100, Suite 1  
 Callinsville, MO 63011  
 618.545.2200

Belleville  
 1 South Church, Suite 200  
 Belleville, IL 62220  
 618.516.6688

MISSOURI DESIGN FIRM PE-001166

**OATES**  
 ASSOCIATES

IF A SEAL IS PRESENT ON THIS SHEET IT HAS BEEN ELECTRONICALLY SEALED AND DATED.







SIGN	SIZE IN.	AREA SQ.FT.	QTY EACH	TOTAL AREA SQ.FT.	QTY RELOC EACH	TOTAL RELOC SQ.FT.	SIGN NUM.	DESCRIPTION
WARNING SIGNS								
W01-1L	48X48	16.00						TURN (SYMBOL LEFT ARROW)
W01-1R	48X48	16.00						TURN (SYMBOL RIGHT ARROW)
W01-2L	48X48	16.00						CURVE (SYMBOL LEFT ARROW)
W01-2R	48X48	16.00						CURVE (SYMBOL RIGHT ARROW)
W01-3L	48X48	16.00						REVERSE TURN (SYMBOL LEFT ARROW)
W01-3R	48X48	16.00						REVERSE TURN (SYMBOL RIGHT ARROW)
W01-4L	48X48	16.00	1	16			31	REVERSE CURVE (SYMBOL LEFT ARROW)
W01-4R	48X48	16.00	1	16			30	REVERSE CURVE (SYMBOL RIGHT ARROW)
W01-4bL	48X48	16.00						DOUBLE ARROW REVERSE CURVE (SYMBOL LT ARROWS)
W01-4bR	48X48	16.00						DOUBLE ARROW REVERSE CURVE (SYMBOL RT ARROWS)
W01-4cL	48X48	16.00						TRIPLE ARROW REVERSE CURVE (SYMBOL LT ARROWS)
W01-4cR	48X48	16.00						TRIPLE ARROW REVERSE CURVE (SYMBOL RT ARROWS)
W01-6	60X30	12.50						HORIZONTAL ARROW (SYMBOL)
W01-6a	72X36	18.00						HORIZ. ARROW (SYMBOL ON PERMANENT BARRICADE)
W01-7	60X30	12.50						DOUBLE HEAD HORIZONTAL ARROW (SYMBOL)
W01-7a	72X36	18.00						DOUBLE HEAD HORIZ. ARROW (SYMBOL ON PERM. BARR.)
W01-8	18X24	3.00						CHEVRON (SYMBOL)
W01-8a	30X36	7.50						CHEVRON (SYMBOL FOR DIVIDED HIGHWAYS)
W03-1	48X48	16.00						STOP AHEAD (SYMBOL)
W03-2	48X48	16.00						YIELD AHEAD (SYMBOL)
W03-3	48X48	16.00						SIGNAL AHEAD (SYMBOL)
W03-4	48X48	16.00						BE PREPARED TO STOP
W03-5	48X48	16.00						SPEED LIMIT AHEAD
W04-1L	48X48	16.00						MERGE (SYMBOL FROM LEFT)
W04-1R	48X48	16.00						MERGE (SYMBOL FROM RIGHT)
W04-1aL	48X48	16.00						MERGE (ARROW SYMBOL)
W04-1aR	48X48	16.00						MERGE (ARROW SYMBOL)
W05-1	48X48	16.00						ROAD/BRIDGE/RAMP NARROWS
W05-3	48X48	16.00						ONE LANE BRIDGE
W05-5	48X48	16.00						NARROW LANES
W06-1	48X48	16.00						DIVIDED HIGHWAY (SYMBOL)
W06-2	48X48	16.00						DIVIDED HIGHWAY END (SYMBOL)
W06-3	48X48	16.00						TWO WAY TRAFFIC (SYMBOL)
W07-3a	30X24	5.00						NEXT XX MILES (PLAQUE)
W08-1	48X48	16.00						BUMP
W08-2	48X48	16.00						DIP
W08-3	48X48	16.00						PAVEMENT ENDS
W08-4	48X48	16.00						SOFT SHOULDER
W08-5	48X48	16.00						SLIPPERY WHEN WET (SYMBOL)
W08-6	48X48	16.00						TRUCK CROSSING (WITH FLAGS)
W08-6c	48X48	16.00						TRUCK ENTRANCE
W08-7	36X36	9.00						LOOSE GRAVEL
W08-7a	36X36	9.00						FRESH OIL/LOOSE GRAVEL
W08-9	48X48	16.00						LOW SHOULDER
W08-11	48X48	16.00						UNEVEN LANES
W08-12	48X48	16.00						NO CENTER LINE
W08-15	48X48	16.00						GROOVED PAVEMENT
W08-15P	30X24	5.00						MOTORCYCLE (PLAQUE)
W08-17	48X48	16.00						SHOULDER DROP-OFF (SYMBOL)
W08-17P	30X24	5.00						SHOULDER DROP-OFF (PLAQUE)
W10-1	42RND.	9.62						RAILROAD CROSSING
W012-1	24X24	4.00						DOUBLE DOWN ARROW (SYMBOL)
W012-2	48X48	16.00						LOW CLEARANCE (SYMBOL)
W012-2X	24X18	3.00						LOW CLEARANCE (PLAQUE)
W012-2a	84X24	14.00						OVERHEAD LOW CLEARANCE (FEET AND INCHES)
W012-4	120X60	50.00						LOW CLEARANCE XX FT XX IN XX MILES AHEAD
W012-5	120X60	50.00						WIDTH RESTRICTION XX FT XX IN XX MILES AHEAD
W013-1	30X30	6.25						ADVISORY SPEED (PLAQUE)
W016-2	30X24	5.00						XXX FEET (PLAQUE)
W016-3	30X24	5.00						X MILE (PLAQUE)
W020-1	48X48	16.00	2	32			20	ROAD/BRIDGE/RAMP WORK AHEAD
W020-2	48X48	16.00						DETOUR AHEAD
W020-3	48X48	16.00						ROAD CLOSED AHEAD
W020-4	48X48	16.00						ONE LANE ROAD AHEAD
W020-5	48X48	16.00						RIGHT/CENTER/LEFT LANE CLOSED AHEAD
W020-5a	48X48	16.00						2 RIGHT/CENTER/LEFT LANES CLOSED AHEAD
W020-6a	48X48	16.00						RIGHT/CENTER/LEFT LANE CLOSED
W020-7a	48X48	16.00						FLAGGER (SYMBOL, WITH FLAGS)
W021-2	36X36	9.00						FRESH OIL
W021-5	48X48	16.00						SHOULDER WORK AHEAD
W022-1	48X48	16.00						BLASTING ZONE AHEAD
W022-2	42X36	10.50						TURN OFF 2-WAY RADIO AND PHONE
W022-3	42X36	10.50						END BLASTING ZONE
G022-1	21X15	2.19						WET PAINT (ARROW PIVOTS)

SIGN	SIZE IN.	AREA SQ.FT.	QTY EACH	TOTAL SQ.FT.	QTY RELOC EACH	TOTAL RELOC SQ.FT.	SIGN NUM.	DESCRIPTION
GUIDE SIGNS								
E05-1	36X48	12.00						GORE EXIT
E05-2	48X36	12.00						EXIT OPEN
E05-2a	48X36	12.00						EXIT CLOSED
G020-1	60X24	10.00						ROAD WORK NEXT XX MILES
G020-2	48X24	8.00						END ROAD WORK
G020-4	36X18	4.50						PILOT CAR FOLLOW ME
G020-4a	42X30	8.75						PILOT CAR IN USE WAIT & FOLLOW
G020-4a	18X12	1.50						PILOT CAR IN USE WAIT & FOLLOW
G020-5aP	36X24	6.00						WORK ZONE (PLAQUE)
M04-8a	24X18	3.00						END DETOUR
M04-9L	48X36	12.00						DETOUR (LEFT ARROW)
M04-9R	48X36	12.00						DETOUR (RIGHT ARROW)
M04-9P	48X12	4.00						STREET NAME (PLAQUE)
M04-10L	48X18	6.00						DETOUR (ARROW LEFT)
M04-10R	48X18	6.00						DETOUR (ARROW RIGHT)
REGULATORY SIGNS								
R1-1	48X48	13.25	1	13	1	13	41	STOP
R1-2	48TR1.	6.93						YIELD
R1-2a	36X36	9.00						TO ONCOMING TRAFFIC (PLAQUE)
R1-3P	30X12	2.50						ALL WAY (PLAQUE)
R2-1	36X48	12.00	2	24			4	SPEED LIMIT XX
R3-1	48X48	16.00						NO RIGHT TURN (SYMBOL)
R3-2	48X48	16.00						NO LEFT TURN (SYMBOL)
R3-3	36X36	9.00						NO TURNS
R3-4	48X48	16.00						NO U-TURN (SYMBOL)
R3-7L	30X30	6.25						LEFT LANE MUST TURN LEFT
R3-7R	30X30	6.25						RIGHT LANE MUST TURN RIGHT
R4-1	36X48	12.00						DO NOT PASS
R4-2	36X48	12.00						PASS WITH CARE
R4-8a	36X48	12.00						KEEP LEFT (HORIZONTAL ARROW)
R4-7a	36X48	12.00						KEEP RIGHT (HORIZONTAL ARROW)
R5-1	30X30	6.25						DO NOT ENTER
R5-1a	36X24	6.00						WRONG WAY
R6-1L	54X18	6.75						ONE WAY ARROW (LEFT)
R6-1R	54X18	6.75						ONE WAY ARROW (RIGHT)
R6-2L	24X30	5.00						ONE WAY (LEFT)
R6-2R	24X30	5.00						ONE WAY (RIGHT)
R9-9	24X12	2.00	2	4			42	SIDEWALK CLOSED
R9-11L	24X18	3.00						SIDEWALK CLOSED AHEAD, (ARROW LEFT) CROSS HERE
R9-11R	24X18	3.00						SIDEWALK CLOSED AHEAD, (ARROW RIGHT) CROSS HERE
R10-6	24X36	6.00						STOP HERE ON RED (45° ARROW)
R11-2	48X30	10.00	2	20			29	ROAD CLOSED
R11-3a	60X30	12.50						ROAD CLOSED XX MILES AHEAD
R11-4	60X30	12.50						LOCAL TRAFFIC ONLY
CONST-3A	60X48	20.00						ROAD CLOSED TO THRU TRAFFIC
CONST-3X	56X12	4.67						FINE SIGN
								SPEEDING/PASSING (PLATE)
MISCELLANEOUS SIGNS								
CONST-5	48X36	12.00						POINT OF PRESENCE
CONST-5	96X48	32.00						POINT OF PRESENCE
CONST-7	48X24	8.00						RATE OUR WORK ZONE
CONST-7	72X36	18.00						RATE OUR WORK ZONE
CONST-8	48X36	12.00						WORK ZONE NO PHONE ZONE
				TOTAL				
616-10.05 CONSTRUCTION SIGNS				125				
616-10.10 RELOCATED SIGNS					TOTAL	13		

\* \* NO DIRECT PAY FOR RELOCATING TEMPORARY TRAFFIC CONTROL DEVICES

ITEM NUMBER	TOTAL QTY	DESCRIPTION
6122008		IMPACT ATTENUATOR 40 MPH (SAND BARRELS)
6122009		IMPACT ATTENUATOR 45 MPH (SAND BARRELS)
6122010		IMPACT ATTENUATOR 50 MPH (SAND BARRELS)
6122012		IMPACT ATTENUATOR 55 MPH (SAND BARRELS)
6122014		IMPACT ATTENUATOR 60 MPH (SAND BARRELS)
6122017		IMPACT ATTENUATOR 65 MPH (SAND BARRELS)
6122019		IMPACT ATTENUATOR 70 MPH (SAND BARRELS)
6122020	2	REPLACEMENT SAND BARREL
6122030		IMPACT ATTENUATOR (RELOCATION)
6123000A		TRUCK OR TRAILER MOUNTED ATTENUATOR (TMA)
6161008	2	ADVANCED WARNING RAIL SYSTEM
6161012		BUOYS (BOATS KEEP OUT)
6161013		BUOYS (NO WAKE)
6161014		SPECIAL SIGN ASSEMBLY (BOATS KEEP OUT)
6161025	62	CHANNELIZER (TRIM LINE)
6161030	8	TYPE III MOVEABLE BARRICADE
6161033		DIRECTION INDICATOR BARRICADE
6161040		FLASHING ARROW PANEL
6161047		TYPE III OBJECT MARKER
6161055		SEQUENTIAL FLASHING WARNING LIGHT
6161070		TUBULAR MARKER
6161095		RADAR SPEED ADVISORY SYSTEM
6161096		CHANGEABLE MESSAGE SIGN, COMMISSION FURNISHED/RETAINED
6161098A		CHANGEABLE MESSAGE SIGN W/O COMM. INTERFACE, CONTRACTOR FURNISHED/RETAINED
6161099		CHANGEABLE MESSAGE SIGN WITH COMM. INTERFACE, CONTRACTOR FURNISHED/RETAINED
6162000A		WORK ZONE TRAFFIC SIGNAL SYSTEM
6162002		TEMPORARY LONG-TERM RUMBLE STRIPS
6162004		TEMPORARY SHORT-TERM RUMBLE STRIPS
61736000	300	CONTRACTOR FURNISHED/RETAINED
6173602B		CONTRACTOR FURNISHED/COMMISSION RETAINED
6174000A		TEMP. TRAFFIC BARRIER HEIGHT TRANSITION
6175010A		RELOCATING TEMPORARY TRAFFIC BARRIER
6176000B		TEMPORARY TRAFFIC BARRIER COMMISSION FURNISHED/RETAINED
6177000B		TEMP. TRAFFIC BARRIER HEIGHT TRANSITION COMMISSION FURNISHED/RETAINED
6208064A		TEMPORARY RAISED PAVEMENT MARKER
9029400		TEMPORARY TRAFFIC SIGNALS
9029401		TEMPORARY TRAFFIC SIGNALS AND LIGHTING
6208063	1320	TEMPORARY PAVEMENT MARKING



DATE PREPARED  
1/29/2025

ROUTE A STATE MO

DISTRICT SE SHEET NO. 3

COUNTY CARTER

JOB NO. J9S3609

CONTRACT ID.

PROJECT NO.

BRIDGE NO. A9213

DESCRIPTION	DATE

ANY WORK INDICATED ON THE PLANS THAT EXTENDS BEYOND THE PROJECT LIMITS IS CONSIDERED INCIDENTAL TO AND A PART OF THE CONSTRUCTION OF THIS PROJECT.

**BENCHMARKS - USGS DATUM**

- B.M. A - CHISLED "+" ON FIRE HYDRANT BOLT BETWEEN "L" AND "L" IN "MUELLER" STA. 10+39.42' LT ELEV. 715.90
- B.M. B - CHISLED "+" ON SOUTHWEST FIRE HYDRANT BOLT STA. 6+15.21' LT ELEV. 746.00

**CURVE RTEA.3**  
 PI 7+24.61  
 PC 6+36.30  
 PT 8+12.87  
 $\Delta$  3° 22' 20.2" (LT)  
 D 1° 54' 35.5"  
 L 176.57'  
 T 88.31'  
 R 3,000.00'

**CURVE RTEA.6**  
 PI 11+15.56  
 PC 10+10.62  
 PT 12+18.40  
 $\Delta$  19° 50' 29.7" (LT)  
 D 9° 32' 57.5"  
 L 207.78'  
 T 104.94'  
 R 600.00'

- ① END FULL DEPTH PAVEMENT STA. 9+76.00
- ② EX BR #G0348 - REMOVE STA. 8+99.00 54'X20' BRIDGE #A913 TIE STA. 9+33.00 DA = 1.9 SO MI.
- ③ SIDEWALK, 6' WIDE W/ TRUNCATED DOMES
- ④ NEW STOP SIGN WHEN COMPLETE AND TEMPORARY PAVEMENT HAS BEEN REMOVED

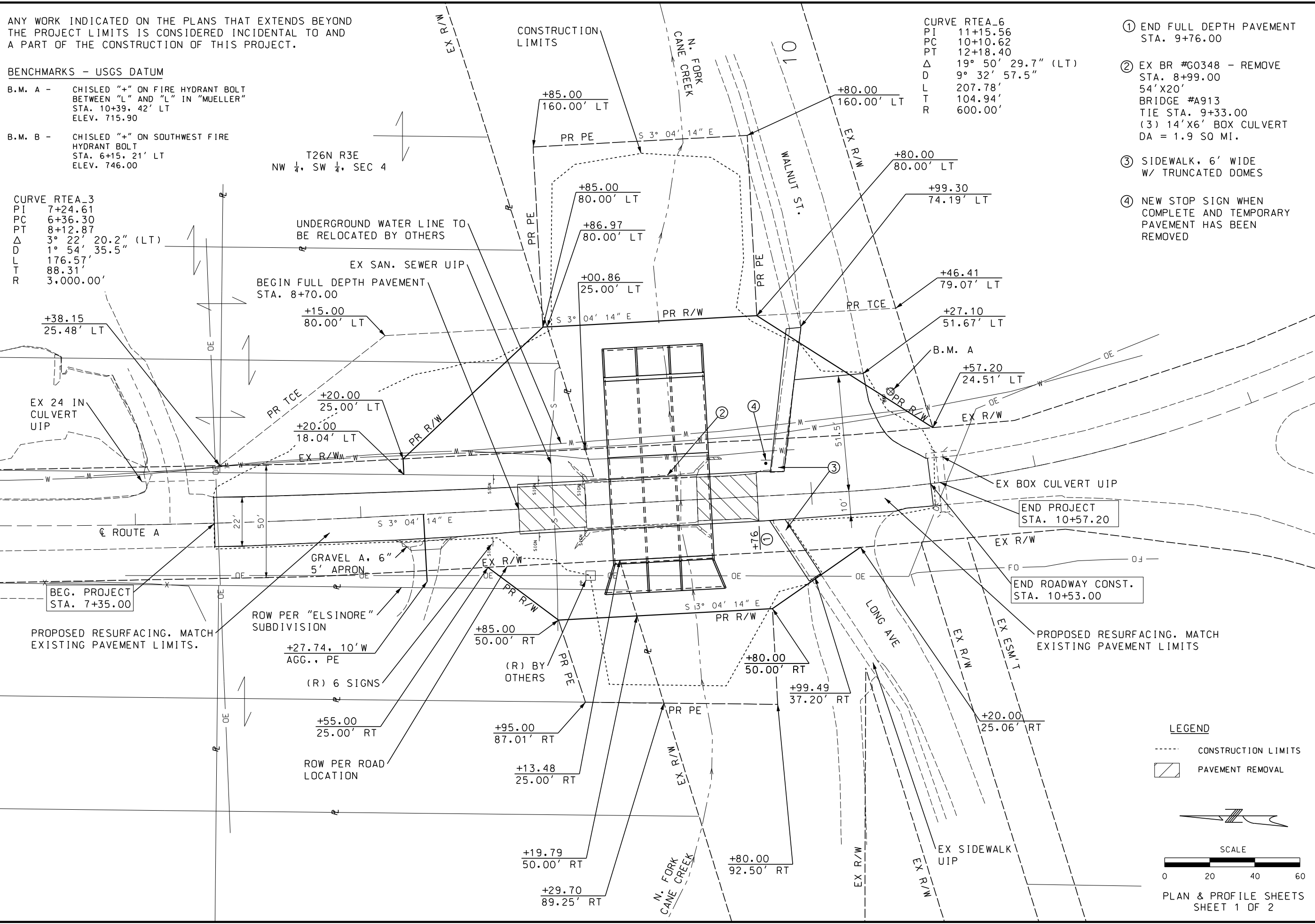

DATE PREPARED 1/29/2025	
ROUTE A	STATE MO
DISTRICT SE	SHEET NO. 4
COUNTY CARTER	
JOB NO. J9S3609	
CONTRACT ID.	
PROJECT NO.	
BRIDGE NO. A9213	

DATE	DESCRIPTION

MISSOURI HIGHWAYS AND TRANSPORTATION COMMISSION

105 WEST CAPITOL  
 JEFFERSON CITY, MO 65102  
 1-888-ASK-MODOT (1-888-275-6636)

St. Louis  
 220 Olive, Suite 200  
 618.545.2200  
 314.588.8381

St. Charles  
 820 South Main, Suite 200  
 St. Charles, MO 63011  
 636.493.6277

Callinsville  
 100 West Court, Suite 1  
 618.545.2200  
 618.545.2200

Bellville  
 1 South Church, Suite 200  
 Bellville, IL 62220  
 618.516.6688

MISSOURI DESIGN FIRM PE-001166

OATES ASSOCIATES

**LEGEND**

- CONSTRUCTION LIMITS
- ▨ PAVEMENT REMOVAL

SCALE  
 0 20 40 60

PLAN & PROFILE SHEETS  
 SHEET 1 OF 2

IF A SEAL IS PRESENT ON THIS SHEET IT HAS BEEN ELECTRONICALLY SEALED AND DATED.







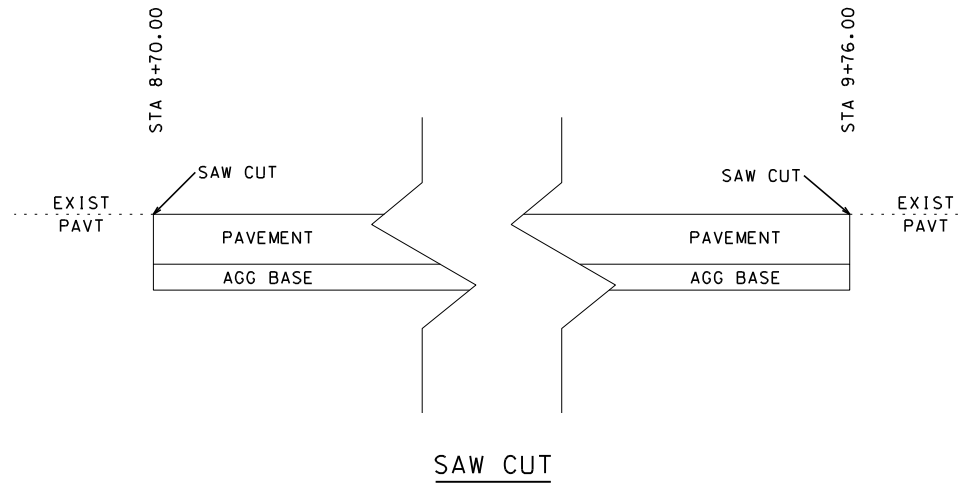

DRAWING NOT TO SCALE

SPECIAL SHEETS  
SHEET 1 OF 1



THIS SHEET HAS BEEN  
SIGNED, SEALED AND DATED  
ELECTRONICALLY.

DATE PREPARED  
1/29/2025

ROUTE STATE  
A MO  
DISTRICT SHEET NO.  
SE 7

COUNTY  
CARTER

JOB NO.  
J9S3609

CONTRACT ID.

PROJECT NO.

BRIDGE NO.  
A9213

DATE	DESCRIPTION

MISSOURI HIGHWAYS AND TRANSPORTATION  
COMMISSION

105 WEST CAPITOL  
JEFFERSON CITY, MO 65102  
1-888-ASK-MODOT (1-888-273-6636)

**St. Louis**  
220 Olive Street, 20th  
St. Louis, MO 63101  
314.388.8381

**St. Charles**  
820 South Main Street, 209  
St. Charles, MO 63301  
636.493.6277

**Callinsville**  
100 W. Main Street, Suite 1  
Callinsville, MO 67004  
618.345.2200

**Belleville**  
1 South Church Street, Suite 209  
Belleville, IL 62220  
618.616.6688  
www.oatesassociates.com

MISSOURI DESIGN FIRM PE-001166



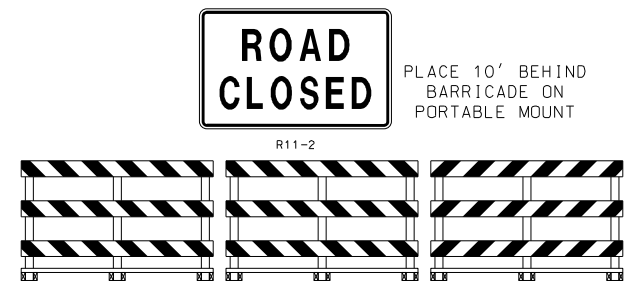

SEE STANDARD PLAN 616.10 FOR DETAILS

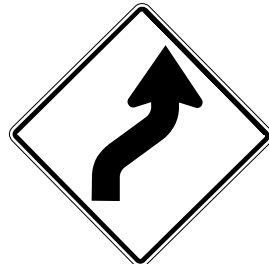
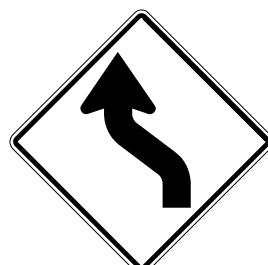

R9-9

42

W01-4R

30

4 IN. TEMPORARY PAVEMENT MARKING PAINT, YELLOW

EDGE OF TEMPORARY OPTIONAL PAVEMENT

20 LF OF 24 IN. TEMPORARY PIPE. CONNECT TO EXISTING CULVERT TO DIRECT WATER AWAY FROM TEMPORARY ROADWAY FILL. LOCATION TO BE APPROVED BY THE ENGINEER.

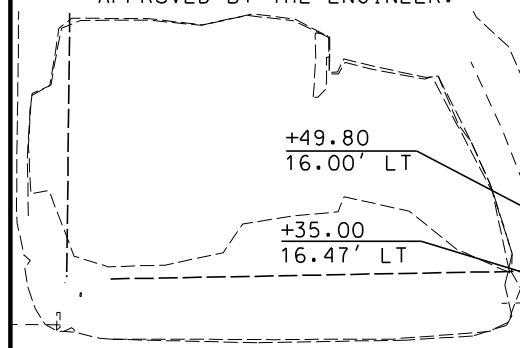

+49.80  
16.00' LT

+35.00  
16.47' LT

TEMPORARY SHORING (TYP)

PR TCE  
+31.60  
53.20' LT

+65.10  
53.20' LT

+94.20  
73.60' LT

ROUTE A

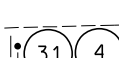

500'

NOTES:  
ALL SPACING AND DISTANCES OF TRAFFIC CONTROL DEVICES ARE APPROXIMATE. THEY MAY BE RELOCATED AS DIRECTED BY THE ENGINEER TO FIT FIELD CONDITIONS.

ANY EXISTING SIGNS THAT CONFLICT WITH THIS TRAFFIC CONTROL PLAN SHALL BE COVERED OR REMOVED.

SIGN SPACING IS 500'.

SIGN 20 TO BE PLACED 500' NORTH OF SIGN 31 AND 500' SOUTH OF SIGN 30.

4 IN. TEMPORARY PAVEMENT MARKING PAINT, WHITE

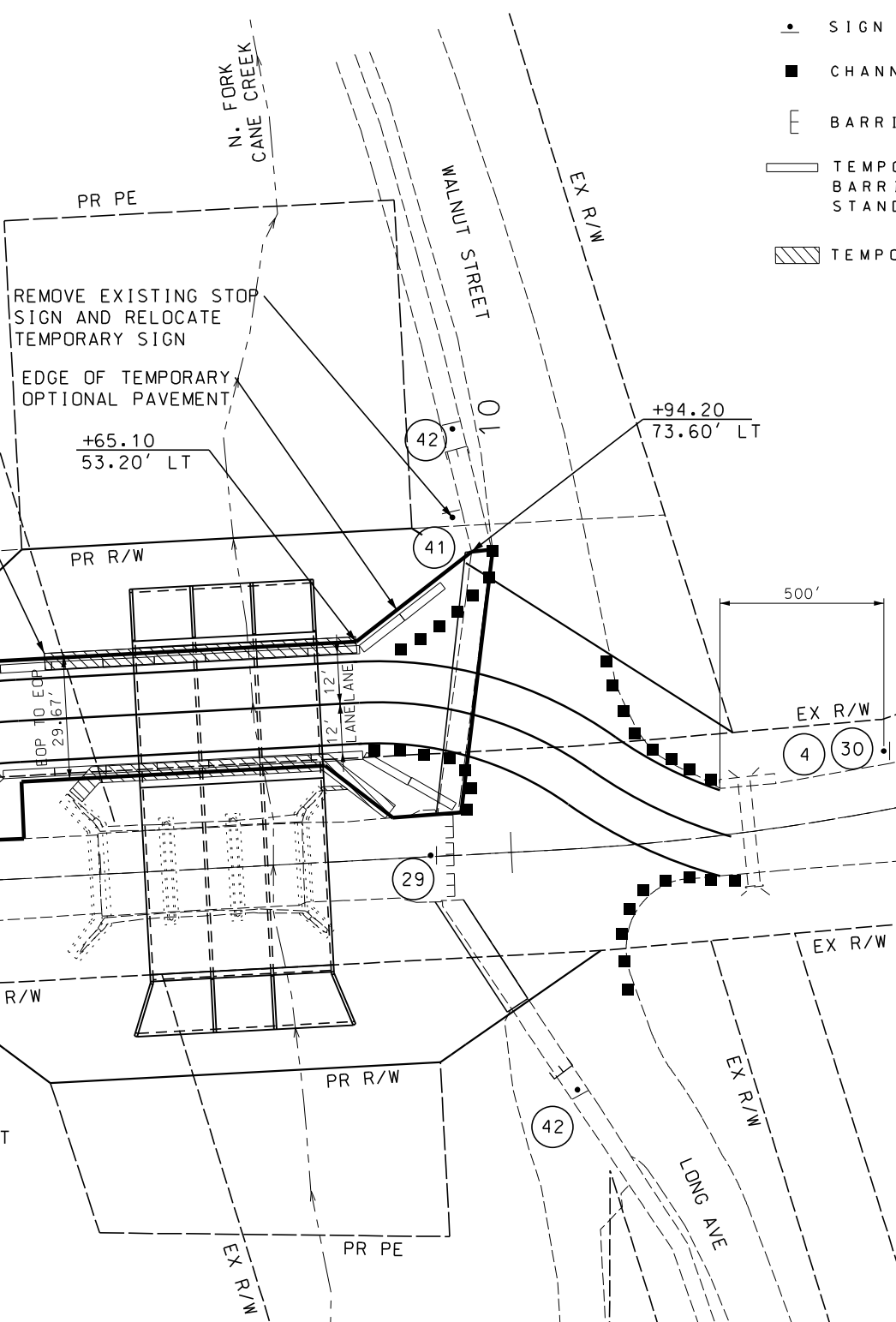

TEMPORARY CENTERLINE COORDINATE POINTS				
STA	D/S ( FT LT )	X-E	Y-N	Z-EL
7+35	0.0	747993.5217	400349.5217	733.48
7+50	3.2	747997.2133	400334.6540	732.12
7+75	11.1	748006.0328	400310.0168	729.57
8+00	21.8	748017.7536	400285.6617	727.02
8+25	30.5	748027.8022	400261.2629	724.72
8+50	35.9	7480345504	400236.5889	722.42
8+75	38.3	748038.2106	400211.7493	721.05
9+00	38.4	748039.6639	400186.7913	719.67
9+25	38.4	748041.0033	400161.8272	718.73
9+50	38.4	748042.3428	400136.8631	717.79
9+75	37.8	748043.0781	400111.8666	716.91
10+00	31.1	748037.7671	400086.5458	716.03
10+25	15.6	748023.7845	400061.1300	716.89
10+53	0.0	748011.0385	400032.0661	717.75

TRAFFIC CONTROL LEGEND

- SIGN ( SINGLE SIDED )
- CHANNELIZER
- E BARRICADE
- TEMPORARY TRAFFIC BARRIER ( PINNED PER STANDARD PLAN 617.20F )
- ▨ TEMPORARY SHORING

THIS SHEET HAS BEEN SIGNED, SEALED AND DATED ELECTRONICALLY.

DATE PREPARED: 1/29/2025

ROUTE A, DISTRICT SE, COUNTY CARTER, JOB NO. J9S3609, CONTRACT ID. PROJECT NO. BRIDGE NO. A9213

DATE	DESCRIPTION

MISSOURI HIGHWAYS AND TRANSPORTATION COMMISSION

105 WEST CAPITOL  
JEFFERSON CITY, MO 65102  
1-888-ASK-MODOT (1-888-273-6636)

St. Louis: 220 Olive, Suite 200, 63101, 314.588.8381  
St. Charles: 803 South Main, Suite 200, 63071, 636.493.6277  
Columbia: 500 West Capitol, Suite 1, 65102, 618.345.2200  
Belleville: 1 South Church, Suite 200, 63301, 618.316.6688

MISSOURI DESIGN FIRM PE-001166

OATES ASSOCIATES

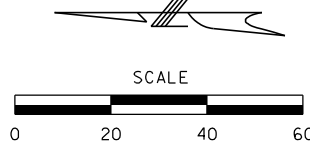

TRAFFIC CONTROL SHEETS SHEET 1 OF 4

IF A SEAL IS PRESENT ON THIS SHEET IT HAS BEEN ELECTRONICALLY SEALED AND DATED.

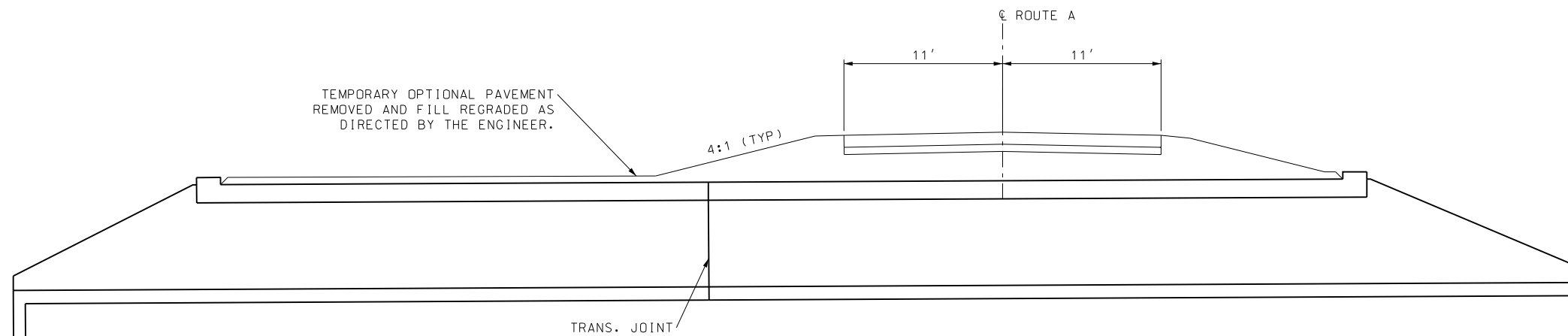

**PROPOSED TYPICAL SECTION**

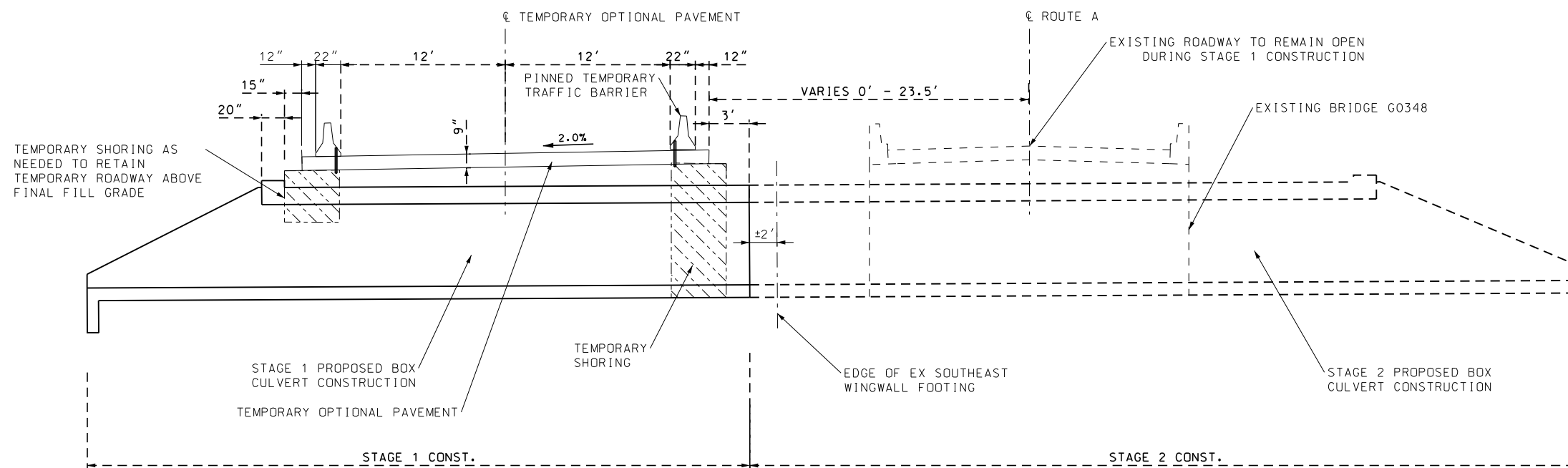

**STAGING TYPICAL SECTION**

NOTE: SEE STANDARD PLANS 617.20F FOR TEMPORARY TRAFFIC BARRIER PINNING REQUIREMENTS.



THIS SHEET HAS BEEN SIGNED, SEALED AND DATED ELECTRONICALLY.

DATE PREPARED  
1/29/2025

ROUTE A STATE MO

DISTRICT SE SHEET NO. 9

COUNTY CARTER

JOB NO. J9S3609

CONTRACT ID.

PROJECT NO.

BRIDGE NO. A9213

DESCRIPTION

DATE	DESCRIPTION

MISSOURI HIGHWAYS AND TRANSPORTATION COMMISSION

105 WEST CAPITOL JEFFERSON CITY, MO 65102  
1-888-ASK-MODOT (1-888-275-6636)

St. Louis  
220 Olive, Suite 200  
St. Charles  
820 South Main, Suite 200

St. Louis  
220 Olive, Suite 200  
St. Charles  
820 South Main, Suite 200

St. Louis  
220 Olive, Suite 200  
St. Charles  
820 South Main, Suite 200

St. Louis  
220 Olive, Suite 200  
St. Charles  
820 South Main, Suite 200

MISSOURI DESIGN FIRM PE-001166

OATES ASSOCIATES

IF A SEAL IS PRESENT ON THIS SHEET IT HAS BEEN ELECTRONICALLY SEALED AND DATED.



THIS SHEET HAS BEEN SIGNED, SEALED AND DATED ELECTRONICALLY.

DATE PREPARED  
10/6/2023

ROUTE A STATE MO

DISTRICT SE SHEET NO. 10

COUNTY CARTER

JOB NO. J9S3609

CONTRACT ID.

PROJECT NO.

BRIDGE NO. A9213

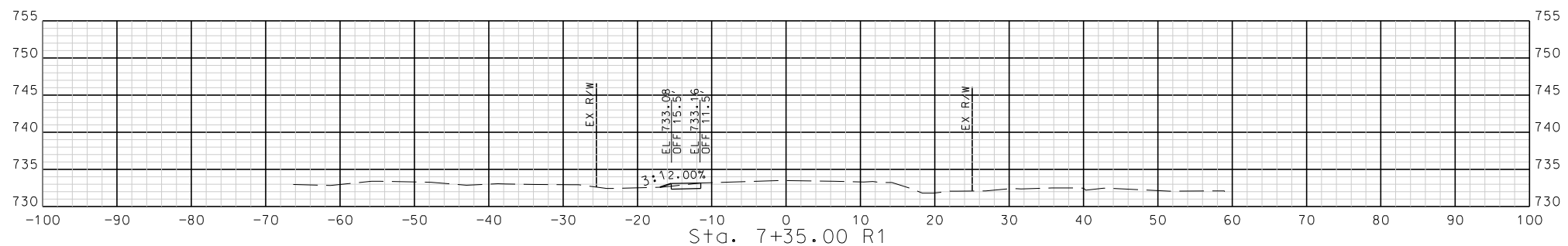
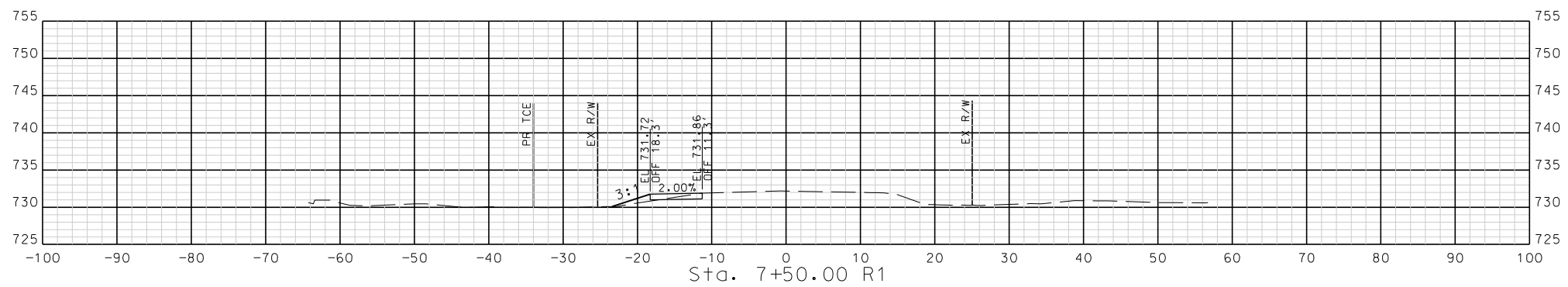
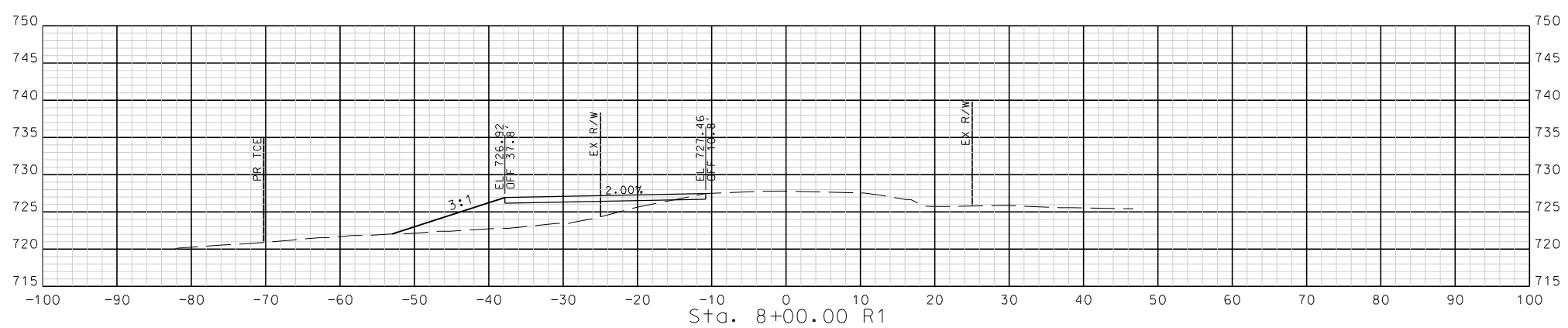
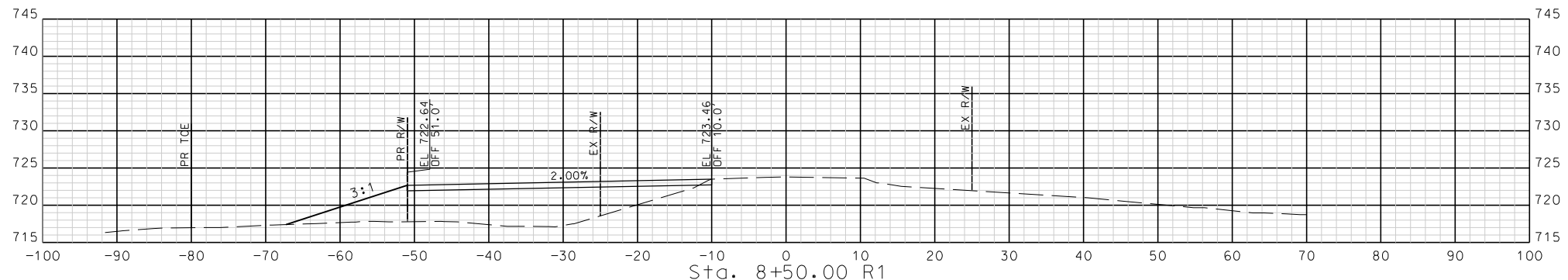

STA. 7+35.00 R1 TO STA. 8+50.00 R1

TRAFFIC CONTROL SHEETS  
STAGING CROSS SECTIONS  
SHEET 3 OF 4

DATE	DESCRIPTION

MISSOURI HIGHWAYS AND TRANSPORTATION COMMISSION

105 WEST CAPITOL  
JEFFERSON CITY, MO 65102  
1-888-ASK-MODOT (1-888-273-6636)

St. Louis  
220 Olive Street, Suite 200  
St. Charles  
820 South Main, Suite 200

Callinsville  
100 West Court, Suite 1  
Belleville  
1 South Church, Suite 200

MISSOURI DESIGN FIRM PE-001166

OATES ASSOCIATES

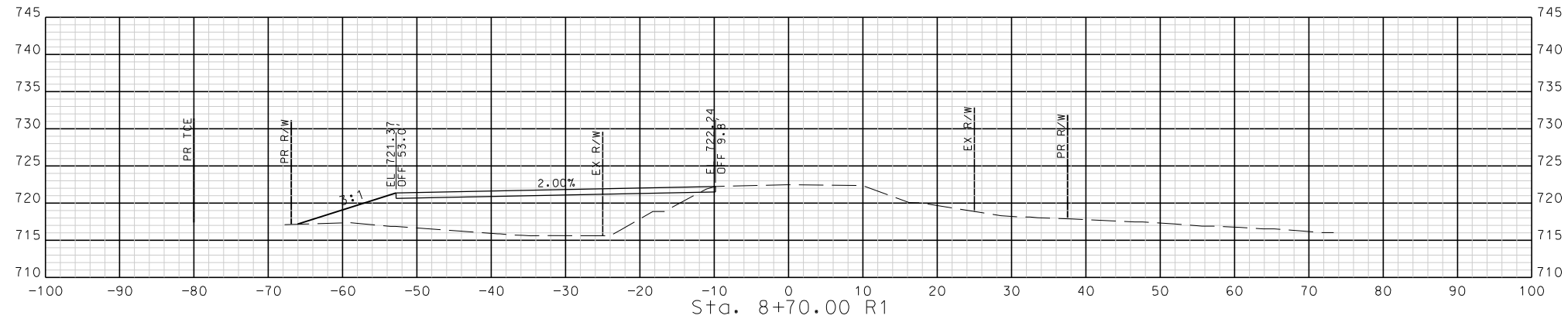
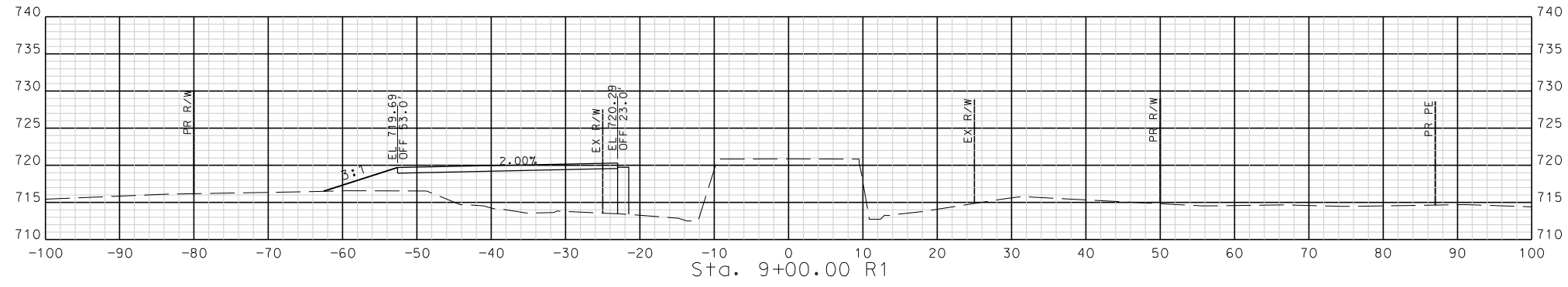
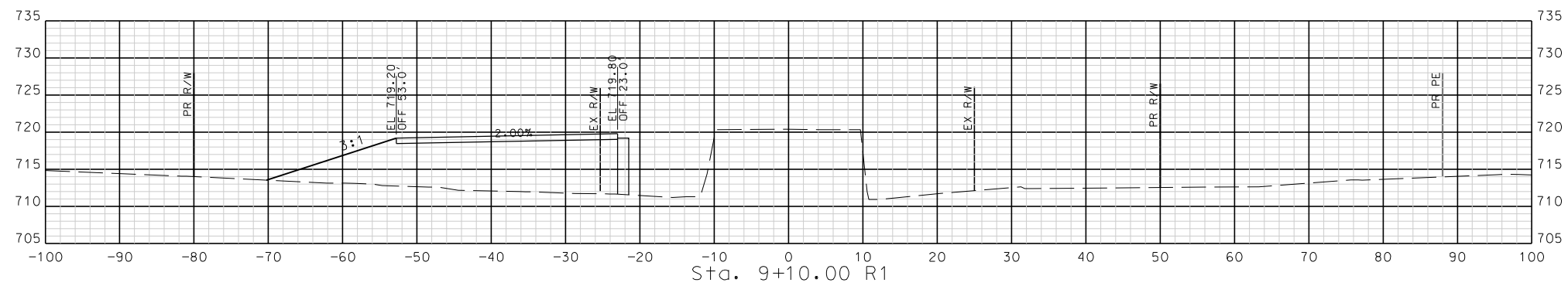
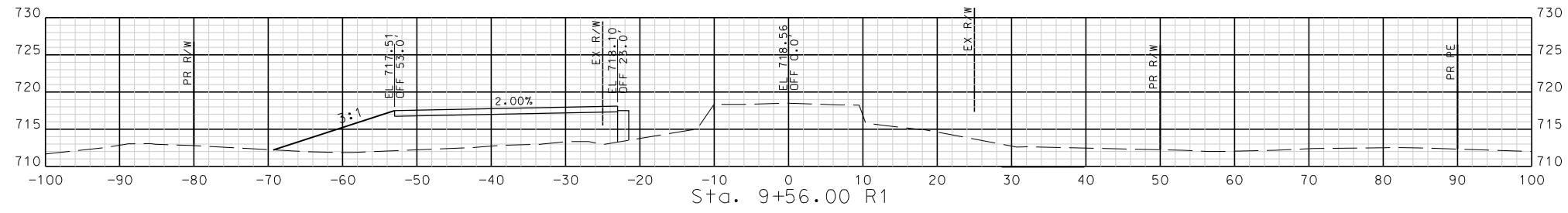
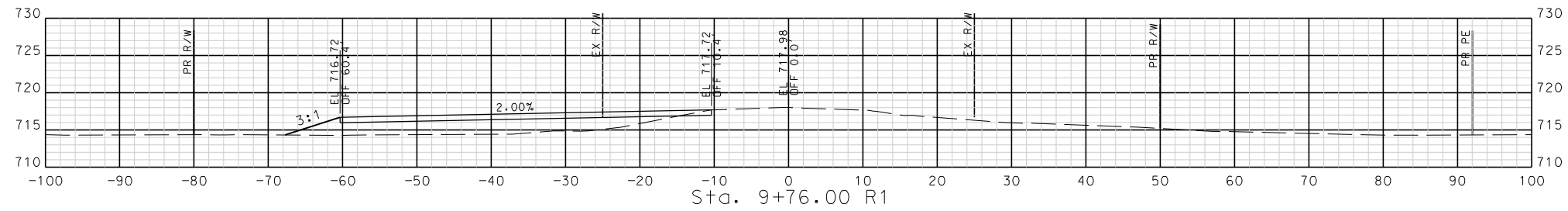

STA. 8+70.00 R1 TO STA. 9+76.00 R1

TRAFFIC CONTROL SHEETS  
STAGING CROSS SECTIONS  
SHEET 4 OF 4

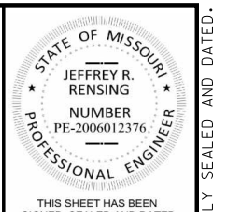

THIS SHEET HAS BEEN SIGNED, SEALED AND DATED ELECTRONICALLY.

DATE PREPARED 10/6/2023	
ROUTE A	STATE MO
DISTRICT SE	SHEET NO. 1-1
COUNTY CARTER	
JOB NO. J9S3609	
CONTRACT ID.	
PROJECT NO.	
BRIDGE NO. A9213	

DATE	DESCRIPTION

MISSOURI HIGHWAYS AND TRANSPORTATION COMMISSION

105 WEST CAPITOL  
JEFFERSON CITY, MO 65102  
1-888-ASK-MODOT (1-888-273-6636)

St. Louis  
220 Olive Street, Suite 200  
St. Charles  
314.588.8381  
St. Charles  
820 South Main, Suite 200  
St. Charles, MO 63301  
636.493.6277

Callinsville  
100 West Court, Suite 1  
618.545.2200  
618.545.2200  
618.545.2200

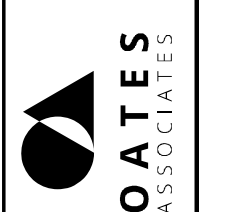

Bellville  
1 South Church, Suite 200  
Bellville, IL 62220  
618.516.6688  
www.oatesassociates.com

MISSOURI DESIGN FIRM PE-001166

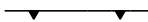
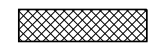

NOTE:  
 ROCK BLANKET LIMITS SHOWN  
 ARE APPROXIMATE. THE ACTUAL  
 LIMITS SHALL BE APPROVED  
 BY THE ENGINEER.

TEMPORARY EROSION CONTROL LEGEND

-  SILT FENCE
-  TYPE 2D HEAVY DOUBLE-NET  
EROSION CONTROL BLANKET
- PRIMARY RECEIVING WATERS: CANE CREEK
-  TYPE 1 ROCK BLANKET W/ PERMANENT  
EROSION CONTROL GEOTEXTILE

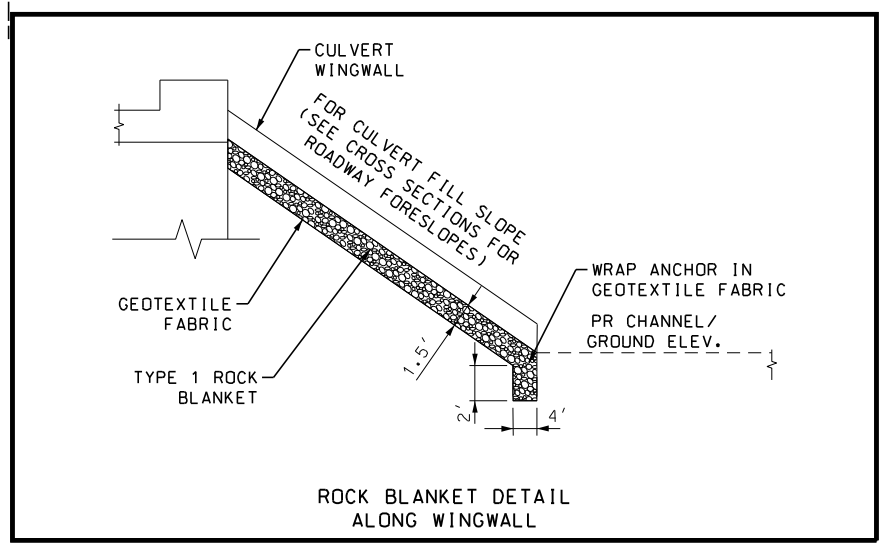
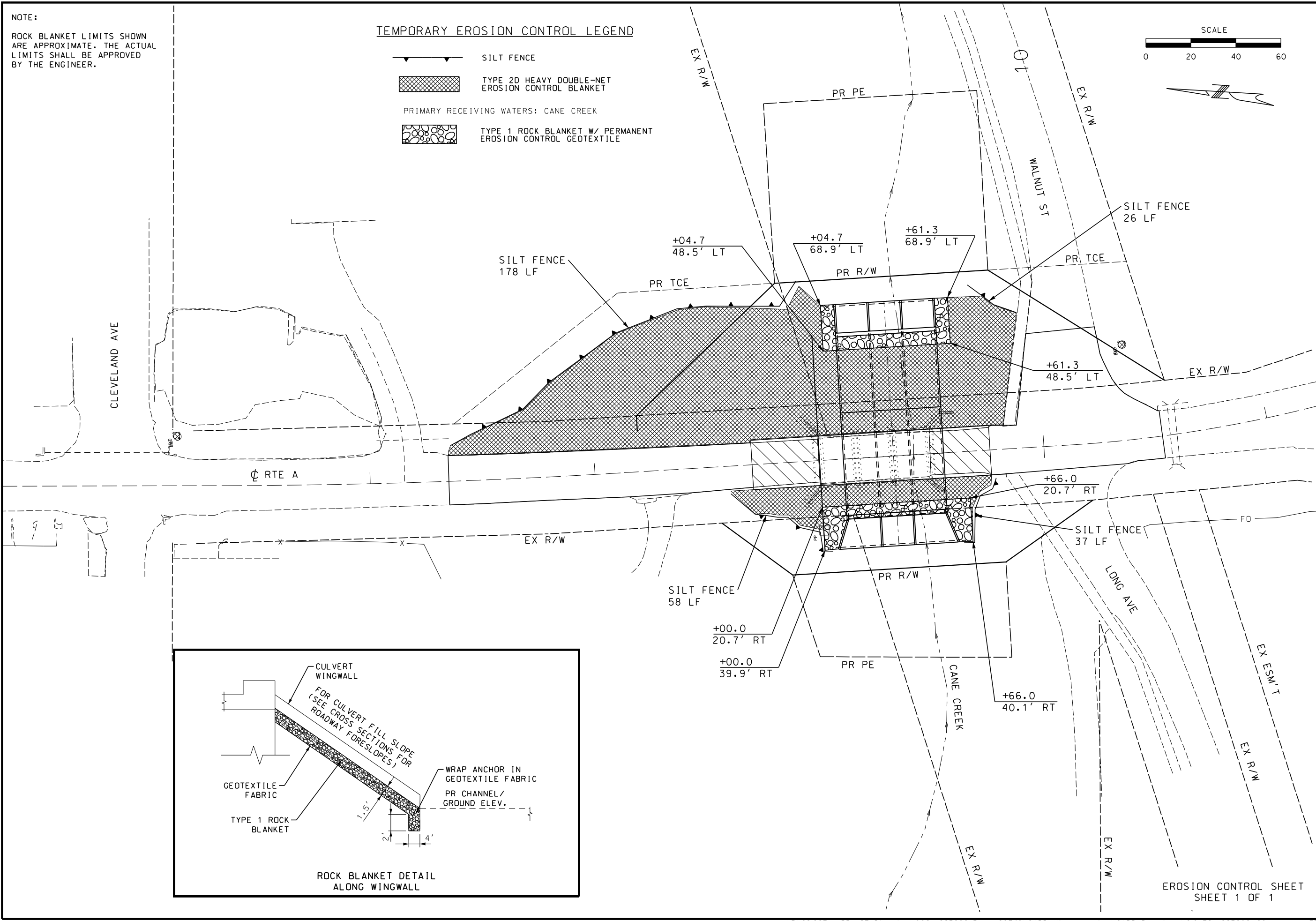
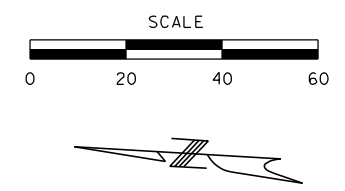

THIS SHEET HAS BEEN  
 SIGNED, SEALED AND DATED  
 ELECTRONICALLY.  
 DATE PREPARED  
 10/6/2023  
 ROUTE A MO  
 DISTRICT SE SHEET NO. 12  
 COUNTY CARTER  
 JOB NO. J9S3609  
 CONTRACT ID.  
 PROJECT NO.  
 BRIDGE NO. A9213

DATE	DESCRIPTION

MISSOURI HIGHWAYS AND TRANSPORTATION  
 COMMISSION  
 105 WEST CAPITOL  
 JEFFERSON CITY, MO 65102  
 1-888-ASK-MODOT (1-888-275-6636)

St. Louis  
 220 Olive, Suite 200  
 St. Charles  
 820 South Main, Suite 200  
 St. Charles, MO 63301  
 636-493-6277

Callinsville  
 100 W. Main, Suite 1  
 Callinsville, MO 62629  
 618-345-2200  
 Belleville  
 1 South Church, Suite 200  
 Belleville, IL 62220  
 618-516-6688  
 MISSOURI DESIGN FIRM PE-001166



3 (14' x 6') CONCRETE BOX CULVERT

SEC/SUR 4 TWP 26N RGE 3E

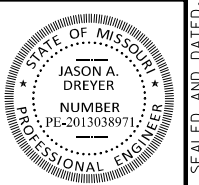

THIS SHEET HAS BEEN SIGNED, SEALED AND DATED ELECTRONICALLY.

DATE PREPARED

9/28/2023

ROUTE A MO

DISTRICT BR SHEET NO. 1

COUNTY CARTER

JOB NO. J9S3609

CONTRACT ID.

PROJECT NO.

BRIDGE NO. A9213

DESCRIPTION

DATE

MISSOURI HIGHWAYS AND TRANSPORTATION COMMISSION

105 WEST CAPITOL JEFFERSON CITY, MO 65102

1-888-ASK-MODOT (1-888-275-6636)

MISSOURI DESIGN FIRM PE-001166

Collinsville

100 Lamer Court, Suite 1

Collinsville, MO 63901

Belleville

820 South Main, Suite 500

Belleville, MO 63701

618-416-6888

www.oatesassociates.com

618-938-6277

618-938-6277

618-938-6277

618-938-6277

618-938-6277

618-938-6277

618-938-6277

618-938-6277

618-938-6277

618-938-6277

618-938-6277

618-938-6277

618-938-6277

618-938-6277

618-938-6277

618-938-6277

618-938-6277

618-938-6277

618-938-6277

618-938-6277

618-938-6277

618-938-6277

618-938-6277

618-938-6277

618-938-6277

618-938-6277

618-938-6277

618-938-6277

618-938-6277

618-938-6277

618-938-6277

618-938-6277

618-938-6277

618-938-6277

618-938-6277

618-938-6277

618-938-6277

Layout Dimensions

Var.	Equation	Dim.	Var.	Equation	Dim.	Var.	Equation	Dim.
S	---	14'-0"	C	---	41'-6"	Q	TX(cos 20°)	7 1/2"
HT	---	6'-0"	D	R + M + N + 20"	14'-10 1/2"	R	PI(cos 20°)	12'-6"
TS	---	15"	E	G + 23"	14'-5"	U	(R + M)(tan 20°)	4'-8 1/8"
BS	---	11"	F	3S + 2TX + 2TI	44'-8"	V	HT + TS - 12"	6'-3"
TX	---	8"	G	2V	12'-6"	W	2A + B + C + D + E	108'-9 1/2"
TI	---	8"	M	N(cos 20°)	4 1/8"	Y	TX(sin 20°)	2 3/4"
A	---	13'-0"	N	3" + TX(tan 10°)	4 3/8"	KK	3S/2 + TI + U	26'-4 1/8"
B	---	12'-0"	P	2V(sec 20°)	13'-3 5/8"	TW	Max{3'-4" or (BS + 12")}	(1)

Elevations

Upstream (Elev. 1) = 709.90
Downstream (Elev. 2) = 709.50
Pr. Gr. at Tie Sta. = 719.42

Fill Heights

€ Rdwy at € Culvert = 2.4 ft
Design (All units) = 2.0 ft

Hydrologic Data

Drainage Area = 1.9 mi <sup>2</sup>
Design Flood Frequency = 50 years
Design Flood Discharge = 420 cfs
Design Flood (D.F.) Elevation = 713.8
<b>Base Flood (100-year)</b>
Base Flood Elevation = 714.1
Base Flood Discharge = 490 cfs
Estimated Backwater = 0.2 ft
Outlet Velocity = 4.2 ft/s
<b>Roadway Overtopping</b>
Overtopping Flood Discharge = N/A
Overtopping Flood Frequency > 500 years
500-Year Flood Elevation = 714.8

Estimated Quantities

	Final
Class 4 Excavation	cu. yard 513
Dewatering	lump sum 1
Removal of Bridges	lump sum 1
Class B-1 Concrete (Culverts-Bridge)	cu. yard 402.0
Reinforcing Steel (Culverts-Bridge)	pound 58,050

General Notes:

**Design Specifications:**  
2010 AASHTO LRFD Bridge Design Specifications and 2010 Interim Revisions

**Design Loading:**  
Vehicular = HL-93 minus lane load, Earth = 120 lb/cf  
Equivalent Fluid Pressure = 30 lb/cf (Min.), 60 lb/cf (Max.)

**Design Unit Stresses:**  
Class B-1 Concrete (Box Culvert) f'c = 4,000 psi  
Reinforcing Steel (Grade 60) fy = 60,000 psi

**Standard Plans:**  
703.37, 703.81, 703.86, 703.87

**Miscellaneous:**  
MoDOT Construction personnel will indicate the type of box culvert constructed:  
 Precast Concrete Box used  
 Cast-in-Place Concrete Box used

When alternate precast concrete box sections are used, the minimum distance from inside face of headwalls to precast sections measured along the shortest wall shall be 3 feet. Reinforcement and dimensions for wings and headwalls shall be in accordance with Missouri Standard Plans.

Excavate rock 6 inches below bottom slab and backfill with suitable material for culverts on rock in accordance with Sec 206.

Channel bottom shall be graded within the right of way for transition of channel bed to culvert openings. Channel banks shall be tapered to match culvert openings. (Roadway Item)

**Traffic Handling:**  
Traffic to be maintained on existing structure during Unit 1 construction and on Unit 1 during Unit 2 construction. See roadway plans for traffic control and staged construction details.

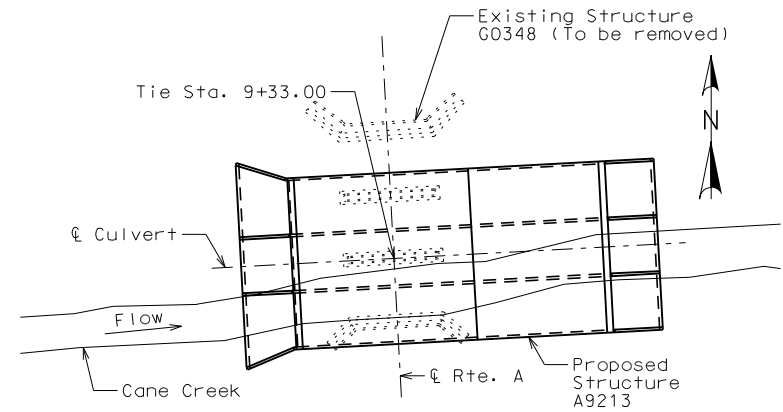

LOCATION SKETCH

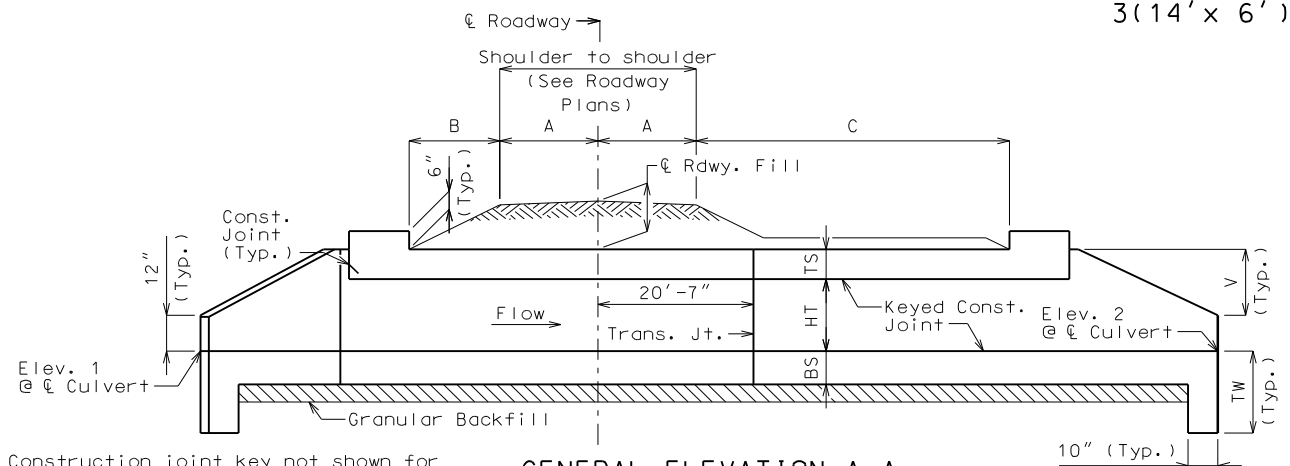

GENERAL ELEVATION A-A

Construction joint key not shown for clarity, see standard plans for details.

If any part of the barrel is exposed, the roadway fill shall be warped to provide 12 inches minimum cover. (Roadway Item)

If unsuitable material is encountered, excavation of unsuitable material and furnishing and placing of granular backfill shall be in accordance with Sec 206.

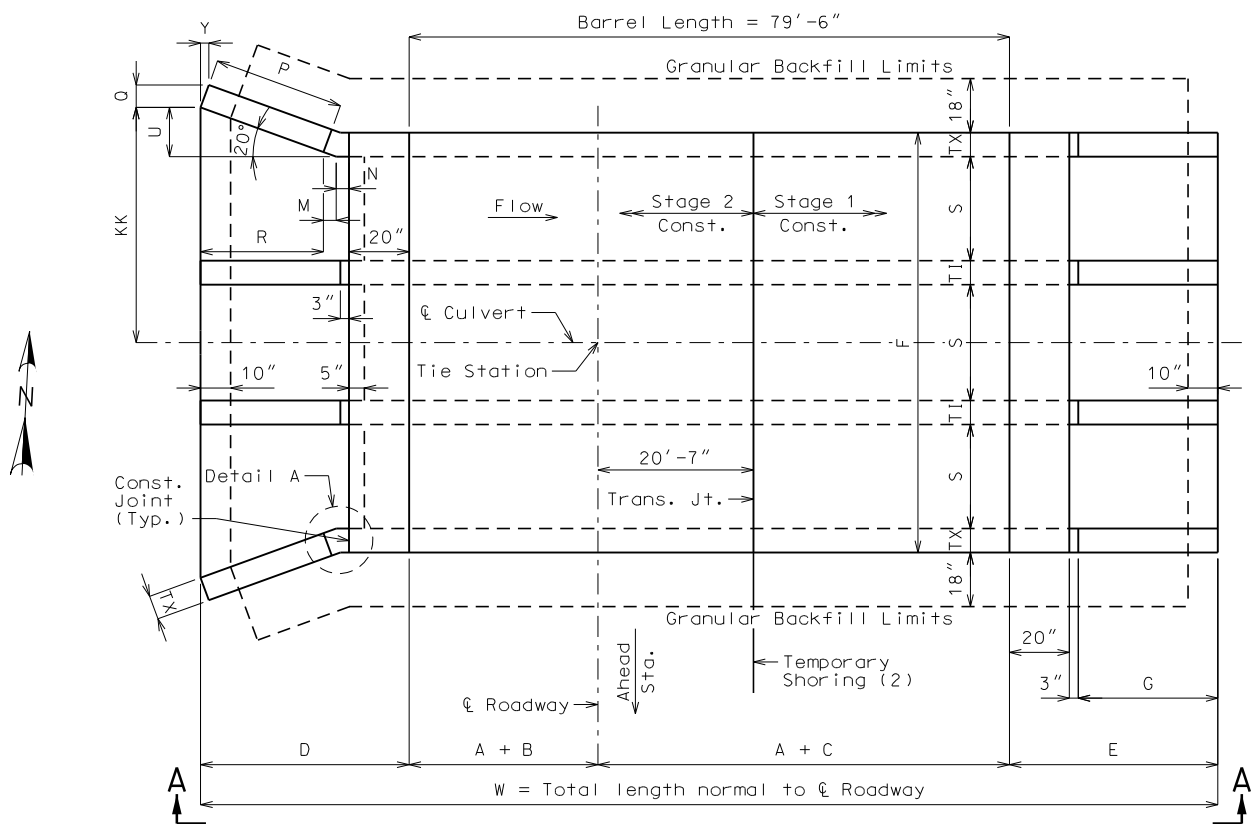

PLAN OF LAYOUT DIMENSIONS

Unit No.	Unit Length	Member Thickness		Top Slab Reinforcement												Bottom Slab Reinforcement				Wall Reinforcement						
		TS	BS	TX	TI	F	A1 Bars	J3 Bars	H2 Bars	A2 Bars	J4 Bars	H3 Bars	B1 Bars	B2 Bars												
1	33'-11"	15"	11"	8"	8"	2'-0"	#6 8"	#5 8"	69.3"	35"	#6 16"	137.5"	105.5"	#6 16"	45"	49"	#5 6.5"	#6 6"	54.8"	79"	#7 7"	60"	64"	#5 12"	#5 12"	12"
2	45'-7"	15"	11"	8"	8"	2'-0"	#6 8"	#5 8"	69.3"	35"	#6 16"	137.5"	105.5"	#6 16"	45"	49"	#5 6.5"	#6 6"	54.8"	79"	#7 7"	60"	64"	#5 12"	#5 12"	12"

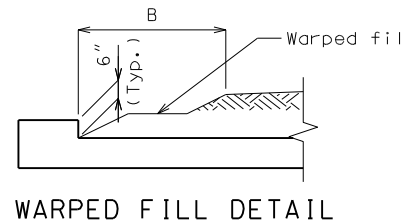

WARPED FILL DETAIL

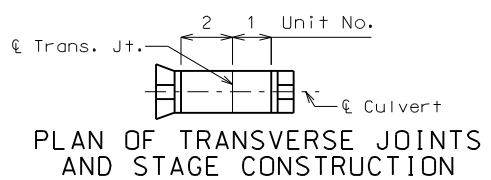

PLAN OF TRANSVERSE JOINTS AND STAGE CONSTRUCTION

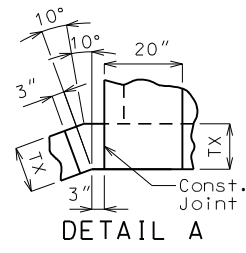

DETAIL A

Reference Notes:

- Top of bedrock varies, toe wall height limited to top of bedrock. Assumed 3'-4" for reinforcement in Bill of Reinforcing Steel.
- For Temporary Shoring, see Traffic Control Sheets.

B.M. A - CHISELED "+" ON FIRE HYDRANT BOLT BETWEEN "L" AND "L" IN "MUELLER" STA. 10+39.53, 42.57' LT. ELEV. 715.90

CULVERT-BRIDGE: ROUTE A OVER NORTH FORK OF CANE CREEK

ROUTE A FROM ROUTE 60 TO ROUTE N ABOUT 0.5 MILE NORTH OF ROUTE 60 TIE STA. 9+33.00

Designed Nov. 2022  
Detailed Nov. 2022  
Checked Dec. 2022

Note: This drawing is not to scale. Follow dimensions.

Sheet No. 1 of 2

