

FOR INFORMATION ONLY

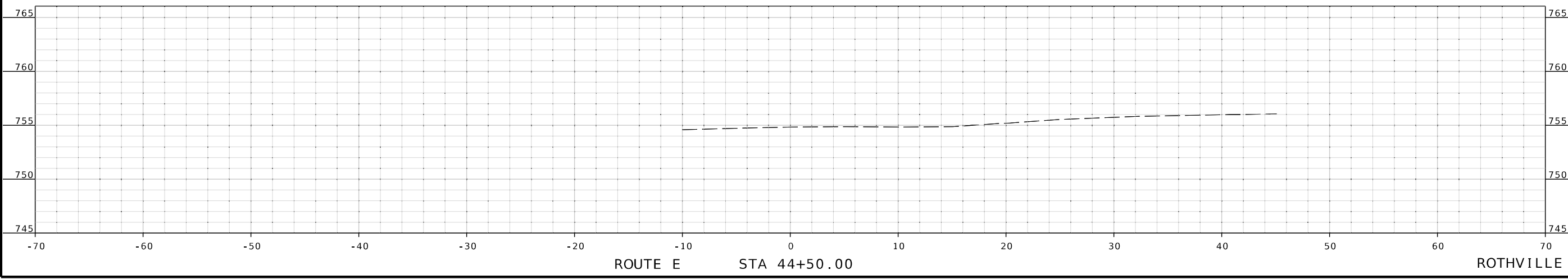

THIS SHEET HAS BEEN SIGNED, SEALED AND DATED ELECTRONICALLY.

DATE PREPARED	
1/24/2025	
ROUTE	STATE
VARIOUS	MO
DISTRICT	SHEET NO.
NW	1
COUNTY	
CHARITON / CARROLL	
JOB NO.	
JNW0030	
CONTRACT ID.	
PROJECT NO.	
BRIDGE NO.	

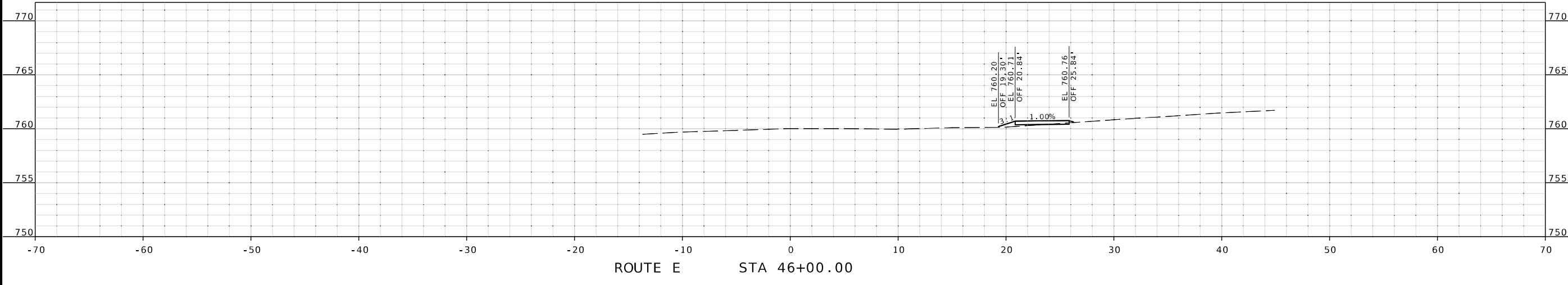
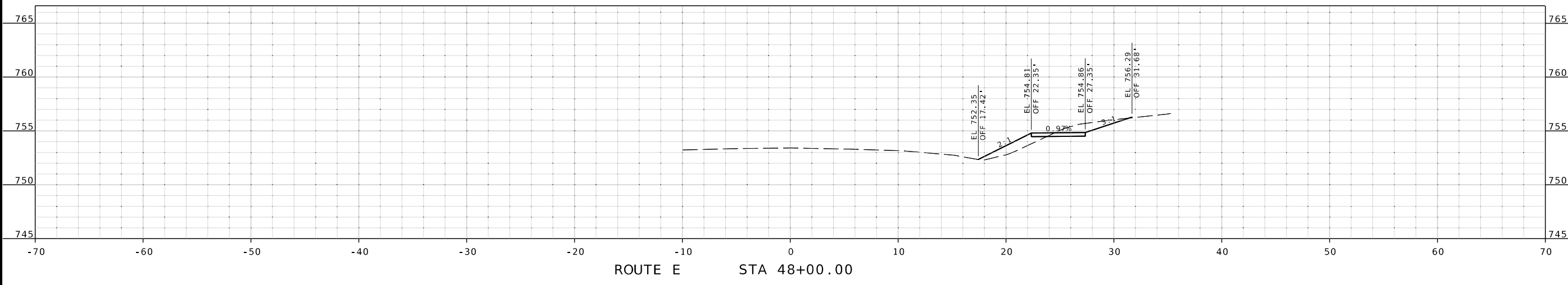

DESCRIPTION	DATE

MISSOURI HIGHWAYS AND TRANSPORTATION COMMISSION

105 WEST CAPITOL
JEFFERSON CITY, MO 65102
1-888-ASK-MODOT (1-888-275-6636)

2215 Fairlawn Dr
Carthage, MO 64836
417.358.9551
COA# 00062
wearoewn.com

IF A SEAL IS PRESENT ON THIS SHEET IT HAS BEEN ELECTRONICALLY SEALED AND DATED.

FOR INFORMATION ONLY



THIS SHEET HAS BEEN SIGNED, SEALED AND DATED ELECTRONICALLY.

DATE PREPARED
1/24/2025

ROUTE STATE
VARIOUS MO

DISTRICT SHEET NO.
NW 2

COUNTY
CHARITON/CARROLL

JOB NO.
JNW0030

CONTRACT ID.

PROJECT NO.

BRIDGE NO.

DESCRIPTION

DATE

MISSOURI HIGHWAYS AND TRANSPORTATION COMMISSION



105 WEST CAPITOL
JEFFERSON CITY, MO 65102
1-888-ASK-MODOT (1-888-273-6636)

2215 Fairlawn Dr
Carthage, MO 64836
417.358.9551
COAF# 00062
wearoown.com



IF A SEAL IS PRESENT ON THIS SHEET IT HAS BEEN ELECTRONICALLY SEALED AND DATED.

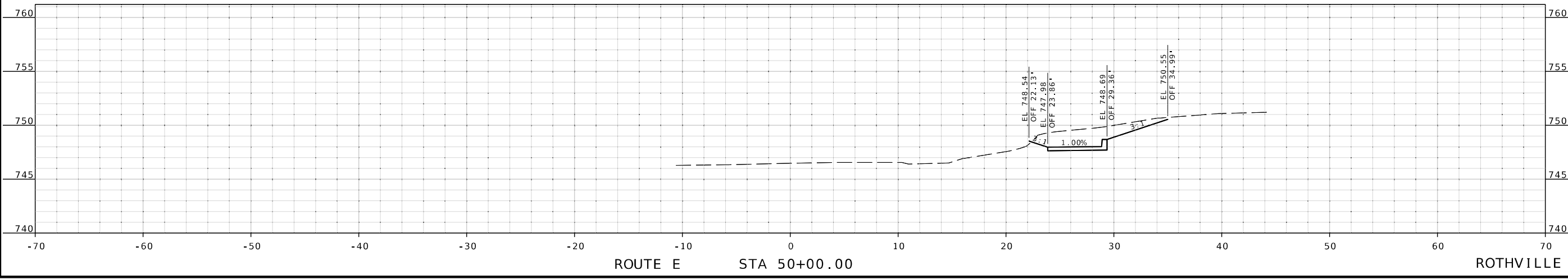
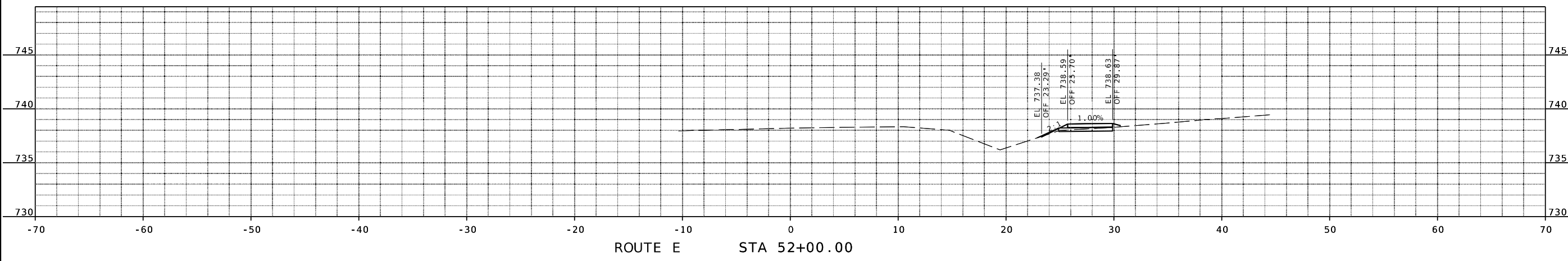
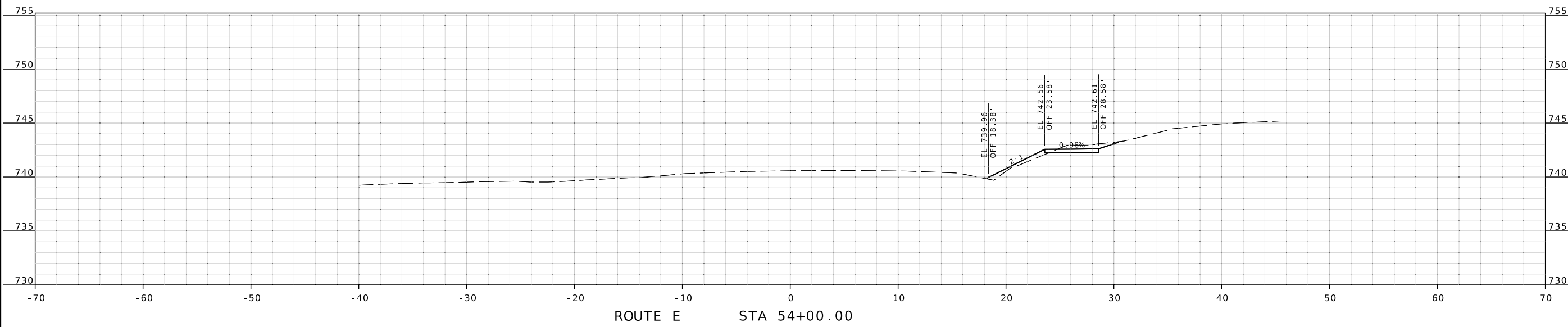

ROTHVILLE

FOR INFORMATION ONLY

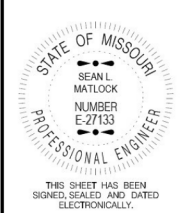

THIS SHEET HAS BEEN SIGNED, SEALED AND DATED ELECTRONICALLY.

DATE PREPARED
1/24/2025

ROUTE STATE
VARIOUS MO

DISTRICT SHEET NO.
NW 3

COUNTY
CHARITON / CARROLL

JOB NO.
JNW0030

CONTRACT ID.

PROJECT NO.

BRIDGE NO.

DESCRIPTION

DATE

MISSOURI HIGHWAYS AND TRANSPORTATION COMMISSION

105 WEST CAPITOL JEFFERSON CITY, MO 65102 1-888-ASK-MODOT (1-888-275-6636)

MoDOT

2215 Fairlawn Dr Carthage, MO 64836 417.358.9551 COA# 00062 wearown.com

OWN Engineering beyond.

ROTHVILLE

STA 60+00.00

ROUTE E

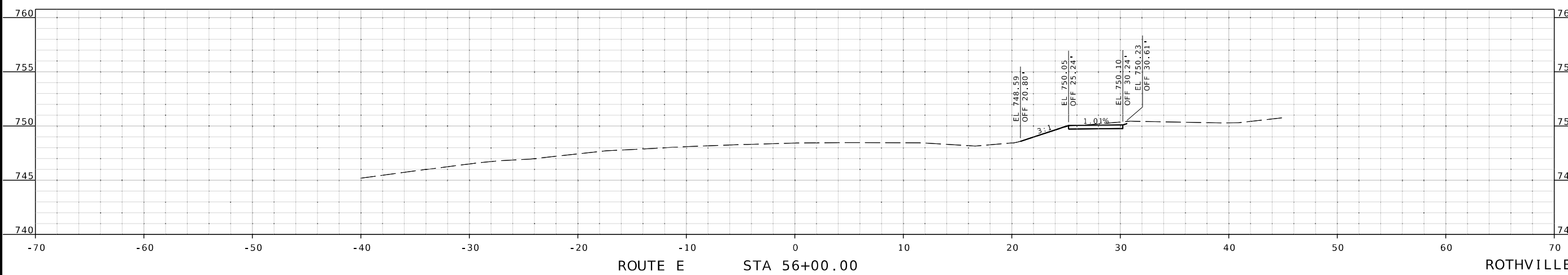
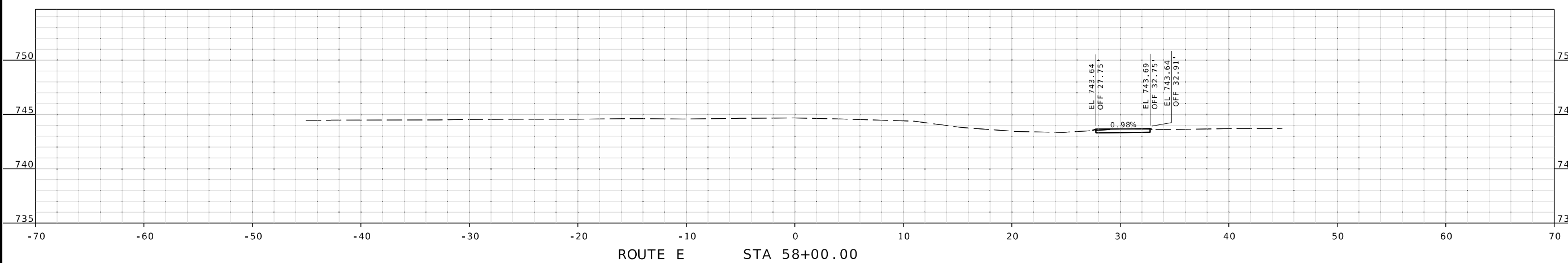
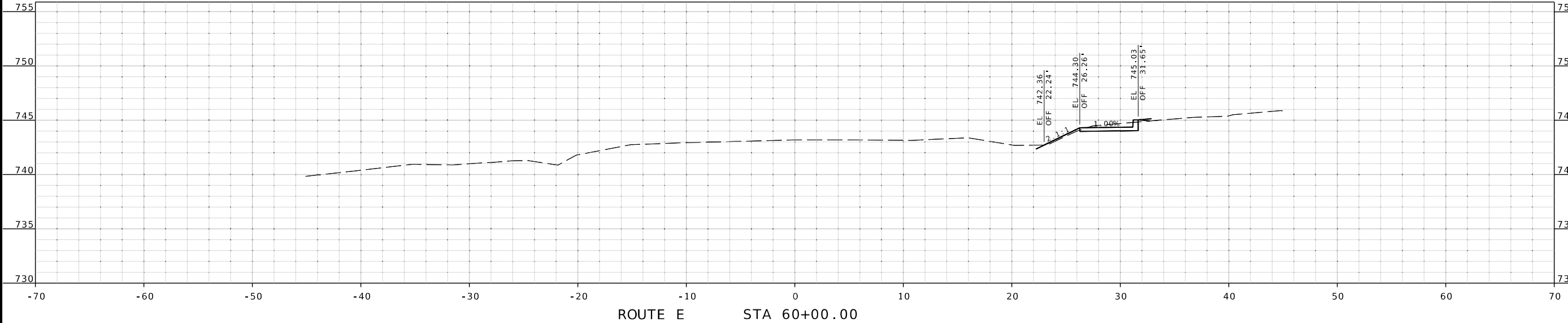

IF A SEAL IS PRESENT ON THIS SHEET IT HAS BEEN ELECTRONICALLY SEALED AND DATED.

FOR INFORMATION ONLY



THIS SHEET HAS BEEN
SIGNED, SEALED AND DATED
ELECTRONICALLY.

DATE PREPARED
1/24/2025

ROUTE	STATE
VARIOUS	MO

DISTRICT	SHEET NO.
NW	4

COUNTY
CHARITON / CARROLL

JOB NO.
JNW0030

CONTRACT ID.

PROJECT NO.

BRIDGE NO.

DATE	DESCRIPTION

MISSOURI HIGHWAYS AND TRANSPORTATION
COMMISSION



2215 Fairlawn Dr
Carthage, MO 64836
417.358.9551
COA# 00062
wearoan.com

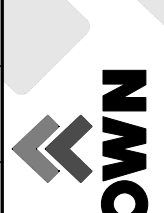

IF A SEAL IS PRESENT ON THIS SHEET IT HAS BEEN ELECTRONICALLY SEALED AND DATED.

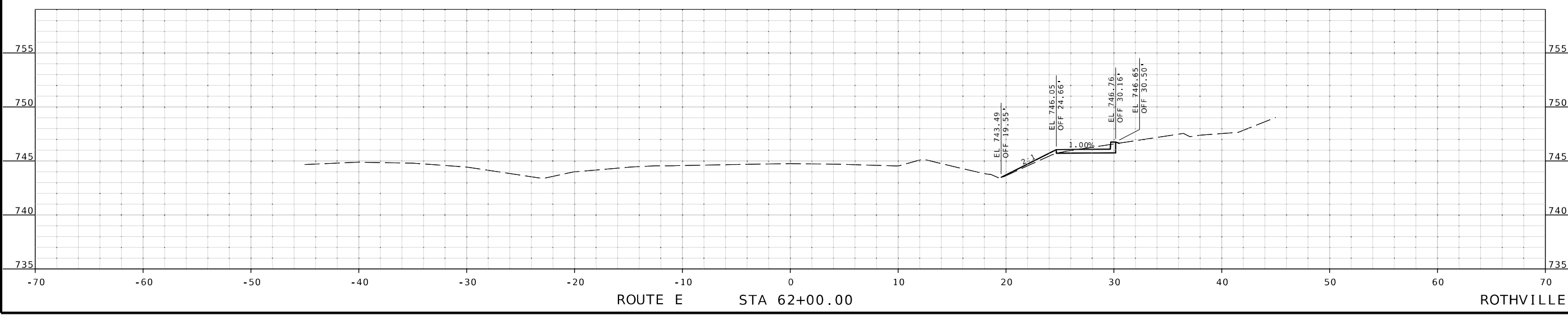
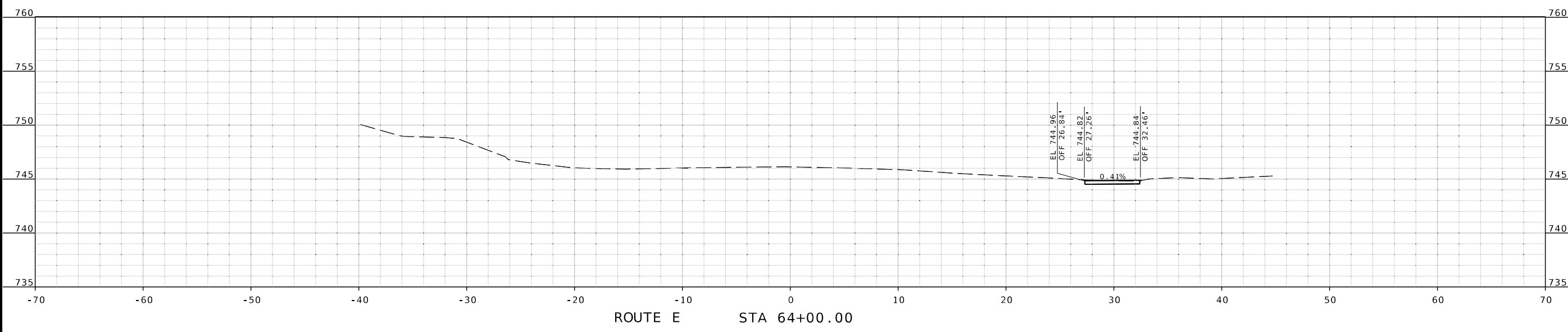

ROTHVILLE

FOR INFORMATION ONLY

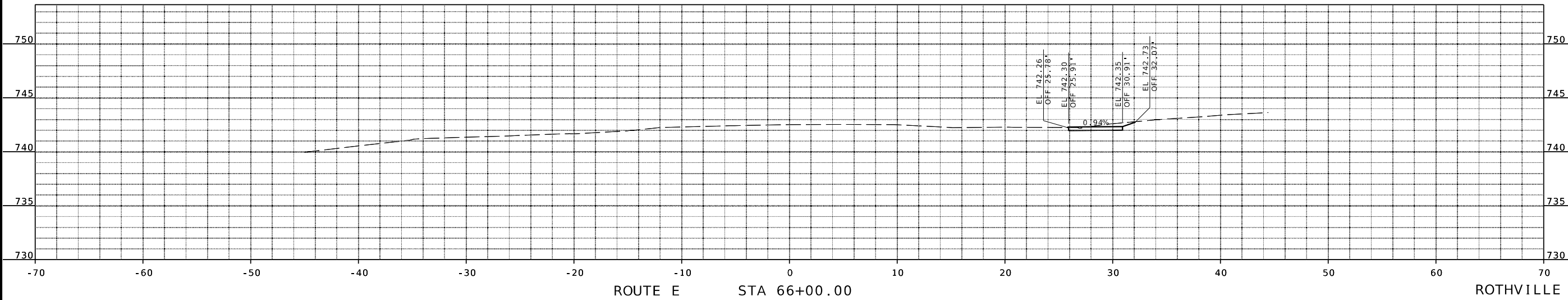
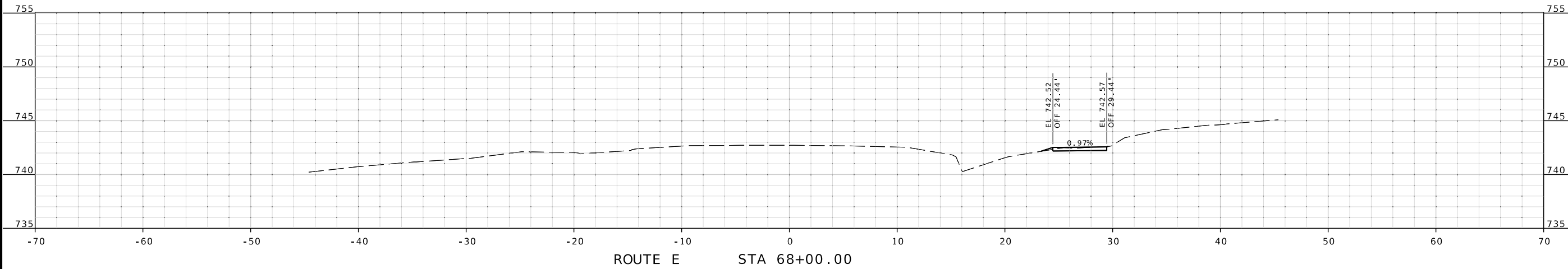
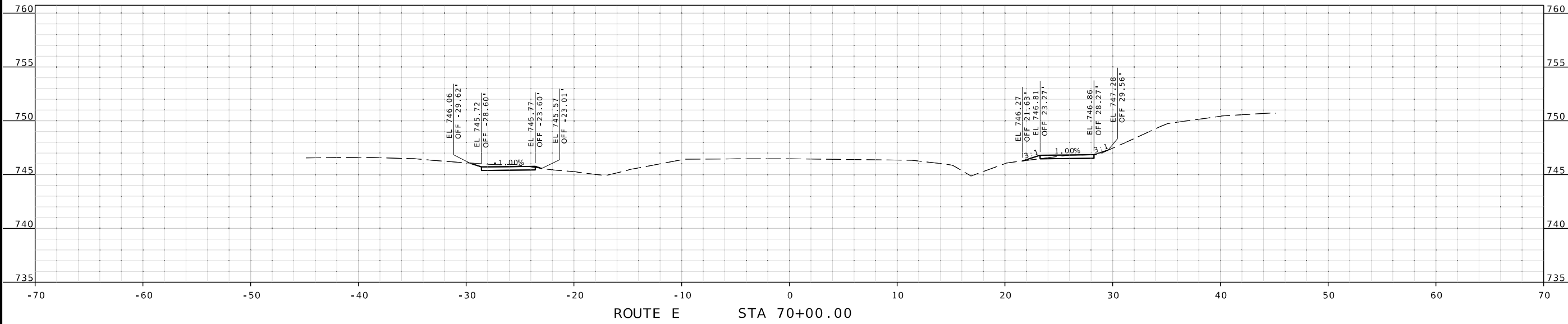

THIS SHEET HAS BEEN SIGNED, SEALED AND DATED ELECTRONICALLY.

DATE PREPARED
1/24/2025

ROUTE STATE
VARIOUS MO
DISTRICT SHEET NO.
NW 5

COUNTY
CHARITON / CARROLL
JOB NO.
JNW0030
CONTRACT ID.

PROJECT NO.
BRIDGE NO.

DESCRIPTION	DATE

MISSOURI HIGHWAYS AND TRANSPORTATION COMMISSION

105 WEST CAPITOL
JEFFERSON CITY, MO 65102
1-888-ASK-MODOT (1-888-275-6636)

2215 Fairlawn Dr
Carthage, MO 64836
417.358.9551
COA# 00062
wearoan.com

Engineering beyond.[™]

IF A SEAL IS PRESENT ON THIS SHEET IT HAS BEEN ELECTRONICALLY SEALED AND DATED.

FOR INFORMATION ONLY



DATE PREPARED 1/24/2025	
ROUTE VARIOUS	STATE MO
DISTRICT NW	SHEET NO. 6
COUNTY CHARITON / CARROLL	
JOB NO. JNW0030	
CONTRACT ID.	
PROJECT NO.	
BRIDGE NO.	

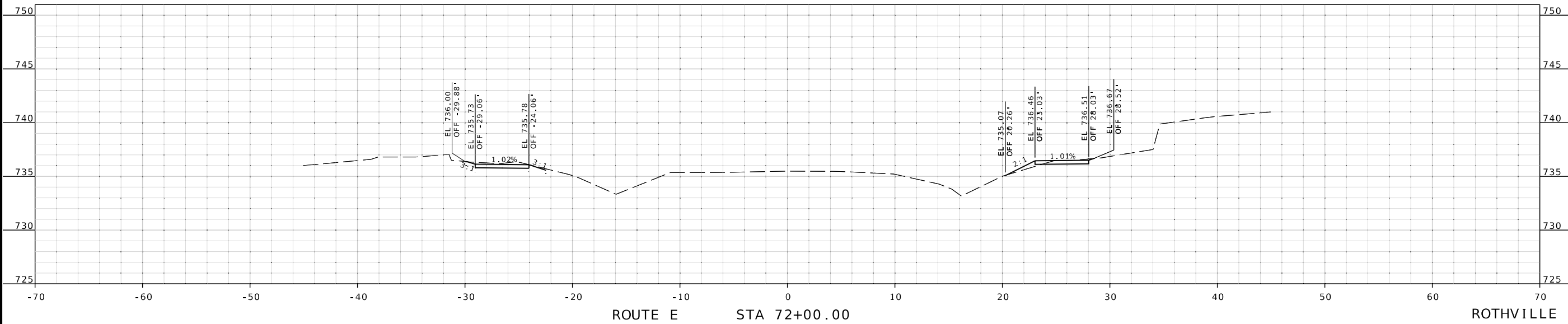
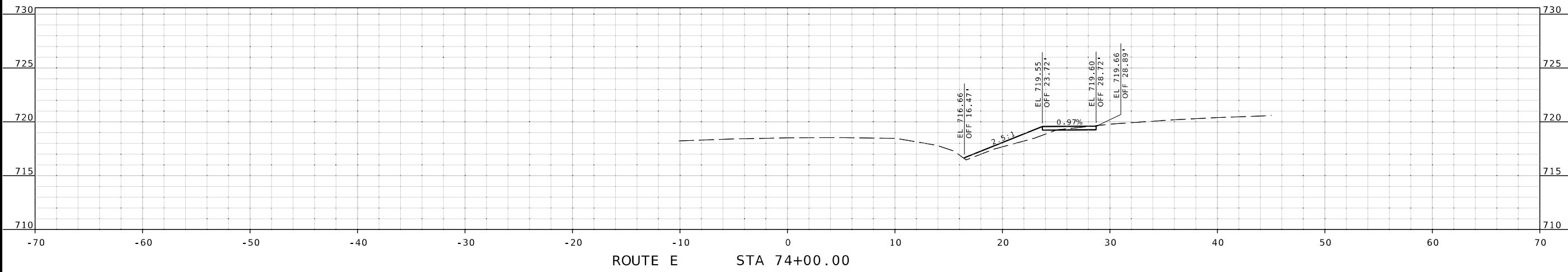

DATE	DESCRIPTION

MISSOURI HIGHWAYS AND TRANSPORTATION COMMISSION

105 WEST CAPITOL
JEFFERSON CITY, MO 65102
1-888-ASK-MODOT (1-888-275-6636)

2215 Fairlawn Dr
Carthage, MO 64836
417.358.9551
COA# 00062
weareown.com

IF A SEAL IS PRESENT ON THIS SHEET IT HAS BEEN ELECTRONICALLY SEALED AND DATED.