

ROUTE CC
A.A.D.T. - 2024 = 280
V = 45 - 55 M.P.H.

ROUTE H
A.A.D.T. - 2024 = 855
V = 30 - 55 M.P.H.

ROUTE J
A.A.D.T. - 2024 = 366
V = 55 M.P.H.

ROUTE O
A.A.D.T. - 2024 = 126
V = 55 M.P.H.

KEY MAP
LOCATION OF VARIOUS COUNTIES

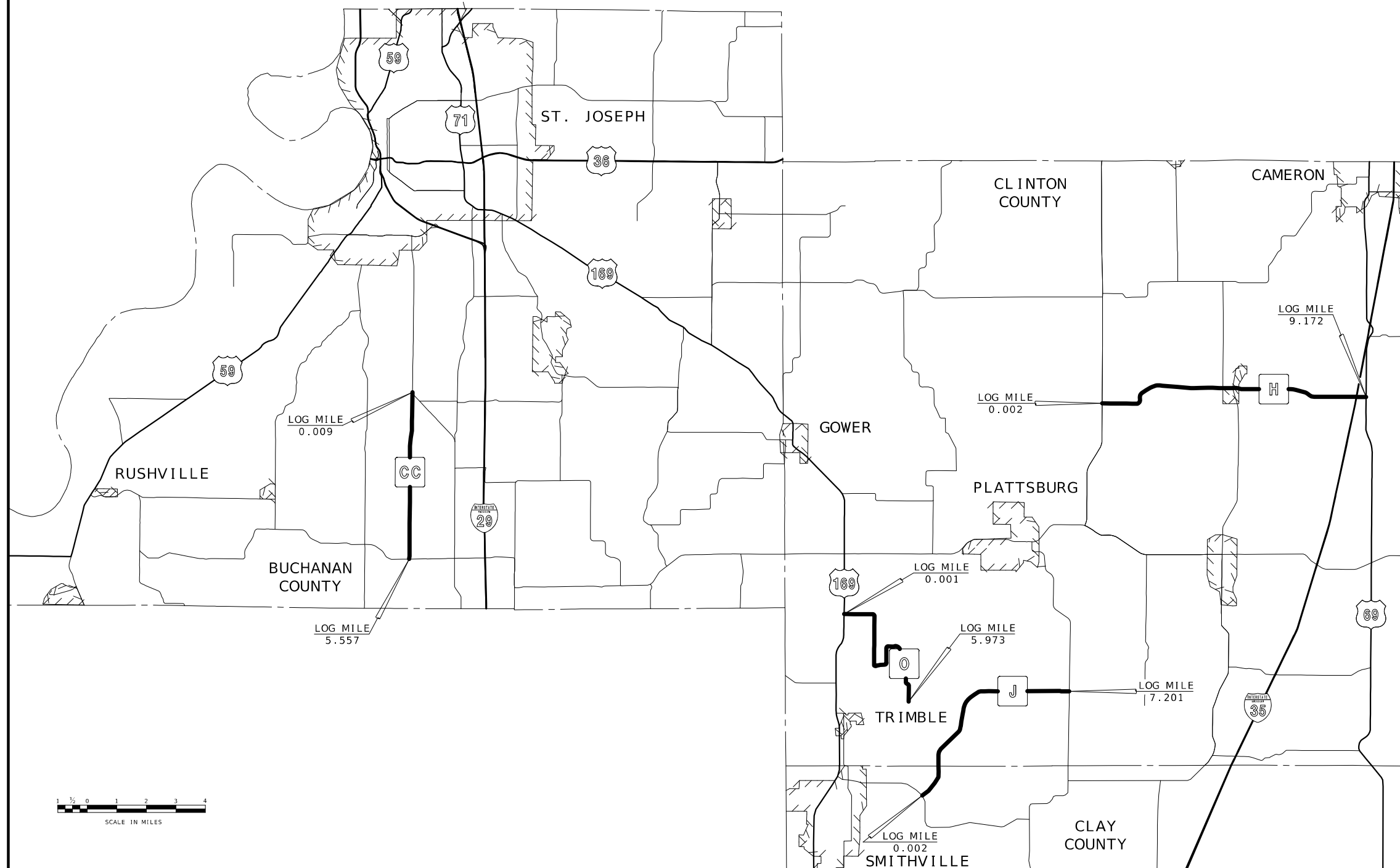

DESCRIPTION	NUMBER
TITLE SHEET	1
TYPICAL SECTIONS (TS) (1 SHEET)----	2
QUANTITIES (QU) (6 SHEETS)-----	3
SPECIAL SHEET (SS)-----	4
TRAFFIC CONTROL (TC) (6 SHEETS)----	5-10

STATE OF MISSOURI

RICHARD W.
ORR

NUMBER
PE-2002003397

PROFESSIONAL ENGINEER

THIS SHEET HAS BEEN
SIGNED, SEALED AND DATED
ELECTRONICALLY.

DATE PREPARED	
3/20/2025	
ROUTE	STATE
VAR.	MO
DISTRICT	SHEET NO.
NW	1
COUNTY	
VARIOUS	
JOB NO.	
JNW0029	
CONTRACT ID.	

PROJECT NO.
BRIDGE NO.

[illegible]

ROUTE CC		
BEGINNING	LOG MILE	0.009
END	LOG MILE	5.557
APPARENT LENGTH		5.548 MILES
EQUATIONS AND EXCEPTIONS:		
BRIDGE #A2565 OVER SOUTH FORK BEE CREEK		
LOG 1.980 TO LOG 2.011		-0.031 MILE

ROUTE H			
BEGINNING	LOG MILE	0.002	
END	LOG MILE	9.172	
APPARENT LENGTH		9.170	MILES
EQUATIONS AND EXCEPTIONS:			
BRIDGE #A6540 OVER LITTLE PLATTE RIVER			
LOG 1.829 TO LOG 1.870		-0.041	MILE
BRIDGE #P0838 OVER SHOAL CREEK			
LOG 6.997 TO LOG 7.026		-0.029	MILE
BRIDGE #A9110 OVER I-35			
LOG 8.806 TO LOG 8.921		-0.115	MILE

ROUTE J			
BEGINNING	LOG MILE	0.002	
END	LOG MILE	7.201	
APPARENT LENGTH		7.199	MILES
EQUATIONS AND EXCEPTIONS:		NONE	

ROUTE O	
BEGINNING	LOG MILE 0.001
	LOG MILE 5.973
APPARENT LENGTH	5.972 MILES
EQUATIONS AND EXCEPTIONS:	
BRIDGE #A3631 OVER ROBERTS BRANCH	
LOG 4.414 TO LOG 4.470	-0.056 MILE

NET LENGTH OF PROJECT	27.617	MILES
STATE LENGTH	27.617	MILES
FOR INFORMATION ONLY		
ESTIMATED DISTURBED ACRES	0	ACRES

 105 WEST CAPITOL
 JEFFERSON CITY, MO 65102
 1-888-ASK-MODOT (1-888-275-6636)

RESURFACING - ROUTE CC								
LOG MILE	LOG MILE	LENGTH	AVERAGE WIDTH	MODIFIED COLDMILLING (DEPTH TRANSITIONS)	TACK COAT	BITUMINOUS PAVEMENT MIXTURE PG58-28H (SURFACE LEVELING)	PERMANENT AGGREGATE EDGE TREATMENT	REMARKS
		L.F.	FT.	S.Y.	GAL	TON	TON	
0.009	0.014	25.00	20.00	55.6	5.6	3.02	0.43	FROM BEGINNING OF ROUTE TO END OF DEPTH TRANSITION
0.014	1.975	10354.08	20.00	--	1840.7	1252.72	178.96	FROM END OF DEPTH TRANSITION TO BEGINNING OF DEPTH TRANSITION
1.975	1.980	25.00	20.00	55.6	5.6	3.02	0.43	FROM BEGINNING OF DEPTH TRANSITION TO BRIDGE #A2565 EXCEPTION
2.011	2.016	25.00	20.00	55.6	5.6	3.02	0.43	FROM END OF BRIDGE #A2565 EXCEPTION TO END OF DEPTH TRANSITION
2.016	3.550	8099.52	20.00	--	1439.9	979.94	139.99	FROM END OF DEPTH TRANSITION TO BEGINNING OF DEPTH TRANSITION
3.550	3.555	25.00	20.00	55.6	4.4	3.02	0.43	FROM BEGINNING OF DEPTH TRANSITION TO CONCRETE DRIVE
3.555	3.559	23.00	20.00	51.1	4.1	2.78	--	MILL 1" AT CONCRETE DRIVE
3.559	3.564	25.00	20.00	55.6	4.4	3.02	0.43	FROM CONCRETE DRIVE TO END OF DEPTH TRANSITION
3.564	3.654	475.20	20.00	--	84.5	57.49	8.21	FROM END OF DEPTH TRANSITION TO BEGINNING OF DEPTH TRANSITION
3.654	3.659	25.00	20.00	55.6	4.4	3.02	0.43	FROM BEGINNING OF DEPTH TRANSITION TO CONCRETE DRIVE
3.659	3.664	25.00	20.00	55.6	4.4	3.02	0.43	MILL 1" AT CONCRETE DRIVE
3.664	3.669	25.00	20.00	55.6	4.4	3.02	0.43	FROM CONCRETE DRIVE TO END OF DEPTH TRANSITION
3.669	4.595	4889.28	20.00	--	869.2	591.54	84.51	FROM END OF DEPTH TRANSITION TO BEGINNING OF DEPTH TRANSITION
4.595	4.600	25.00	20.00	55.6	4.4	3.02	0.43	FROM BEGINNING OF DEPTH TRANSITION TO CONCRETE DRIVE
4.600	4.604	23.00	20.00	51.1	4.1	2.78	0.40	MILL 1" AT CONCRETE DRIVE
4.604	4.609	25.00	20.00	55.6	4.4	3.02	0.43	FROM CONCRETE DRIVE TO END OF DEPTH TRANSITION
4.609	5.539	4910.40	20.00	--	873.0	594.10	84.87	FROM END OF DEPTH TRANSITION TO BEGINNING OF RADII AT ROUTE 116
5.539	5.555	84.48	VARIES	--	37.9	25.76	1.68	FROM BEGINNING OF RADII AT ROUTE 116 TO BEGINNING OF DEPTH TRANSITION
5.555	5.557	10.00	VARIES	158.6	15.9	8.64	0.40	FROM BEGINNING OF DEPTH TRANSITION TO END OF PROJECT
--	--	--	--	--	--	1655.10	--	ADDITIONAL FOR SURFACE IRREGULARITIES (150 TONS/LANE MILE)
--	--	--	--	928.9	128.7	74.94	--	ADDITIONAL FOR JUNCTIONS AND ENTRANCES
SUBTOTALS				1745.7	5345.6	5275.99	503.32	
PAY TOTALS				*	*	5276.0	503.3	

* SEE "MODIFIED COLDMILLING AND TACK COAT TOTALS" TABLE ON SUMMARY OF QUANTITIES SHEET 2 OF 5 FOR PAY TOTALS

COLD MIX PATCHING - ROUTE CC		
ROUTE	REMOVAL OF DAMAGED PAVEMENT (S.Y.)	REPLACEMENT OF DAMAGED PAVEMENT (TONS)
CC	226.48	90.59
SUBTOTAL	226.5	90.6

RESURFACING - ROUTE H								
LOG MILE	LOG MILE	LENGTH	AVERAGE WIDTH	MODIFIED COLDMILLING (DEPTH TRANSITIONS)	TACK COAT	BITUMINOUS PAVEMENT MIXTURE PG58-28H (SURFACE LEVELING)	PERMANENT AGGREGATE EDGE TREATMENT	REMARKS
		L.F.	FT.	S.Y.	GAL	TON	TON	
0.002	0.004	10.00	VARIES	134.2	13.4	7.31	0.80	FROM BEGINNING OF ROUTE TO END OF DEPTH TRANSITION
0.004	0.014	52.80	VARIES	--	18.2	12.41	1.07	FROM END OF DEPTH TRANSITION TO END OF RADII AT ROUTE 33
0.014	1.410	7370.88	20.50	--	1343.1	914.08	127.40	FROM END OF RADII AT ROUTE 33 TO BEGINNING 26' WIDE PAVEMENT SECTION
1.410	1.824	2185.92	26.00	--	505.2	343.81	37.78	FROM BEGINNING OF 26' WIDE PAVEMENT SECTION TO BEGINNING OF DEPTH TRANSITION
1.824	1.829	25.00	26.00	72.2	7.2	3.93	0.43	FROM BEGINNING OF DEPTH TRANSITION TO BRIDGE #A6540 EXCEPTION
1.870	1.875	25.00	26.00	72.2	7.2	3.93	0.43	FROM END OF BRIDGE #A6540 EXCEPTION TO END OF DEPTH TRANSITION
1.875	1.962	459.36	26.00	--	106.2	72.25	7.94	FROM END OF DEPTH TRANSITION TO END OF 26' WIDE PAVEMENT SECTION
1.962	6.992	26558.40	20.50	--	4839.5	3293.57	459.03	FROM END OF 26' WIDE PAVEMENT SECTION TO BEGINNING OF DEPTH TRANSITION
6.992	6.997	25.00	20.50	56.9	5.7	3.10	0.43	FROM BEGINNING OF DEPTH TRANSITION TO BRIDGE #P0838 EXCEPTION
7.026	7.031	25.00	20.50	56.9	5.7	3.10	0.43	FROM END OF BRIDGE #P0838 EXCEPTION TO END OF DEPTH TRANSITION
7.031	8.801	9345.60	20.50	--	1703.0	1158.97	161.53	FROM END OF DEPTH TRANSITION TO BEGINNING OF DEPTH TRANSITION
8.801	8.806	25.00	20.50	56.9	5.7	3.10	0.43	FROM BEGINNING OF DEPTH TRANSITION TO BRIDGE #A9110 EXCEPTION
8.921	8.926	25.00	20.50	56.9	5.7	3.10	0.43	FROM END OF BRIDGE #A9110 EXCEPTION TO END OF DEPTH TRANSITION
8.926	9.159	1230.24	20.50	--	224.2	152.56	21.26	FROM END OF DEPTH TRANSITION TO BEGINNING OF RADII AT ROUTE 69
9.159	9.170	58.08	VARIES	--	25.7	17.47	1.33	FROM BEGINNING OF RADII AT ROUTE 69 TO BEGINNING OF DEPTH TRANSITION
9.170	9.172	10.00	VARIES	162.7	16.3	8.86	0.57	FROM BEGINNING OF DEPTH TRANSITION TO END OF PROJECT
--	--	VARIES	VARIES	81.7	56.9	37.58	3.52	ADDITIONAL FOR JUNCTIONS WITH ROUTE A
--	--	--	--	--	--	2695.50	--	ADDITIONAL FOR SURFACE IRREGULARITIES (150 TONS/LANE MILE)
--	--	--	--	165.6	83.6	54.63	--	ADDITIONAL FOR JUNCTIONS AND ENTRANCES
						8.48		2% FOR SAFETY EDGE
SUBTOTALS				916.2	8972.5	8797.74	824.81	
PAY TOTALS				*	*	8797.7	824.8	

* SEE "MODIFIED COLDMILLING AND TACK COAT TOTALS" TABLE ON SUMMARY OF QUANTITIES SHEET 2 OF 5 FOR PAY TOTALS

COLD MIX PATCHING - ROUTE H		
ROUTE	REMOVAL OF DAMAGED PAVEMENT (S.Y.)	REPLACEMENT OF DAMAGED PAVEMENT (TONS)
H	368.90	147.56
SUBTOTAL	368.9	147.6



DATE PREPARED 3/24/2025	
ROUTE VAR.	STATE MO
DISTRICT NW	SHEET NO. 3

COUNTY VARIOUS
JOB NO. JNW0029
CONTRACT ID.

PROJECT NO.

BRIDGE NO.

DESCRIPTION	DATE							

MISSOURI HIGHWAYS AND TRANSPORTATION COMMISSION

105 WEST CAPITOL
JEFFERSON CITY, MO 65102
1-888-ASK-MODOT (1-888-275-6636)

RESURFACING - ROUTE J								
LOG MILE	LOG MILE	LENGTH	AVERAGE WIDTH	MODIFIED COLDMILLING (DEPTH TRANSITIONS)	TACK COAT	BITUMINOUS PAVEMENT MIXTURE PG58-28H (SURFACE LEVELING)	PERMANENT AGGREGATE EDGE TREATMENT	REMARKS
		L.F.	FT.	S.Y.	GAL	TON	TON	
0.002	0.004	10.00	VARIES	97.7	9.8	5.32	0.55	FROM BEGINNING OF ROUTE TO END OF DEPTH TRANSITION
0.004	0.009	26.40	VARIES	--	9.6	6.53	0.62	FROM END OF DEPTH TRANSITION TO END OF RADII AT ROUTE W
0.009	7.186	37894.56	20.30	--	6837.9	4653.55	654.97	FROM END OF RADII AT ROUTE W TO BEGINNING OF RADII AT ROUTE C
7.186	7.199	68.64	VARIES	--	26.9	18.30	1.37	FROM BEGINNING OF RADII AT ROUTE C TO BEGINNING OF DEPTH TRANSITION
7.199	7.201	10.00	VARIES	132.2	13.2	7.20	0.49	FROM BEGINNING OF DEPTH TRANSITION TO END OF PROJECT
--	--	--	--	--	--	2159.70	--	ADDITIONAL FOR SURFACE IRREGULARITIES (150 TONS/LANE MILE)
--	--	--	--	275.6	92.1	58.93	--	ADDITIONAL FOR JUNCTIONS AND ENTRANCES
SUBTOTALS				505.5	6989.5	6909.53	658.00	
PAY TOTALS				*	*	6909.5	658.0	

* SEE "MODIFIED COLDMILLING AND TACK COAT TOTALS" TABLE ON SUMMARY OF QUANTITIES SHEET 2 OF 5 FOR PAY TOTALS

COLD MIX PATCHING - ROUTE J		
ROUTE	REMOVAL OF DAMAGED PAVEMENT (S.Y.)	REPLACEMENT OF DAMAGED PAVEMENT (TONS)
J	295.64	118.26
SUBTOTAL	295.6	118.3

RESURFACING - ROUTE O								
LOG MILE	LOG MILE	LENGTH	AVERAGE WIDTH	MODIFIED COLDMILLING (DEPTH TRANSITIONS)	TACK COAT	BITUMINOUS PAVEMENT MIXTURE PG58-28H (SURFACE LEVELING)	PERMANENT AGGREGATE EDGE TREATMENT	REMARKS
		L.F.	FT.	S.Y.	GAL	TON	TON	
0.001	0.003	10.00	VARIES	96.8	9.7	5.27	0.53	FROM BEGINNING OF ROUTE TO END OF DEPTH TRANSITION
0.003	0.011	42.24	VARIES	--	12.7	8.64	0.87	FROM END OF DEPTH TRANSITION TO END OF RADII AT ROUTE 169
0.011	4.409	23221.44	20.70	--	4272.7	2907.84	401.36	FROM END OF RADII AT ROUTE 169 TO BEGINNING OF DEPTH TRANSITION
4.409	4.414	25.00	20.70	57.5	5.8	3.13	0.43	FROM BEGINNING OF DEPTH TRANSITION TO BRIDGE #A3631 EXCEPTION
4.470	4.475	25.00	20.70	57.5	5.8	3.13	0.43	FROM END OF BRIDGE #A3631 EXCEPTION TO END OF DEPTH TRANSITION
4.475	5.968	7883.04	20.70	--	1450.5	987.13	136.25	FROM END OF DEPTH TRANSITION TO BEGINNING OF DEPTH TRANSITION
5.968	5.973	25.00	20.70	57.5	5.8	3.13	0.43	FROM BEGINNING OF DEPTH TRANSITION TO END OF PROJECT
--	--	--	--	--	--	1791.60	--	ADDITIONAL FOR SURFACE IRREGULARITIES (150 TONS/LANE MILE)
--	--	--	--	58.9	45.8	36.15	--	ADDITIONAL FOR JUNCTIONS AND ENTRANCES
SUBTOTALS				328.2	5808.8	5746.02	540.30	
PAY TOTALS				*	*	5746.0	540.3	

* SEE "MODIFIED COLDMILLING AND TACK COAT TOTALS" TABLE ON SUMMARY OF QUANTITIES SHEET 2 OF 5 FOR PAY TOTALS

COLD MIX PATCHING - ROUTE O		
ROUTE	REMOVAL OF DAMAGED PAVEMENT (S.Y.)	REPLACEMENT OF DAMAGED PAVEMENT (TONS)
O	242.91	97.16
SUBTOTAL	242.9	97.2

MODIFIED COLDMILLING AND TACK COAT TOTALS			
TABLE	SUMMARY OF QUANTITIES SHEET NUMBER	SUBTOTALS	
		MODIFIED COLDMILLING (DEPTH TRANSITIONS)	TACK COAT
		S.Y.	GAL
RESURFACING - ROUTE CC	1 OF 5	1745.7	5345.6
RESURFACING - ROUTE H	1 OF 5	916.2	8972.5
RESURFACING - ROUTE J	2 OF 5	505.5	6989.5
RESURFACING - ROUTE O	2 OF 5	328.2	5808.8
TOTALS		3495.6	27116.4
PAY TOTALS		3496	27116

COLD MIX PATCHING TOTALS		
ROUTE	REMOVAL OF DAMAGED PAVEMENT (S.Y.)	REPLACEMENT OF DAMAGED PAVEMENT (TONS)
CC	226.5	90.6
H	368.9	147.6
J	295.6	118.3
O	242.9	97.2
PAY TOTAL	1,133.9	453.7

SUMMARY OF QUANTITIES
SHEET 2 OF 6



DATE PREPARED 3/24/2025	
ROUTE VAR.	STATE MO
DISTRICT NW	SHEET NO. 3
COUNTY VARIOUS	
JOB NO. JNW0029	
CONTRACT ID.	

PROJECT NO.
BRIDGE NO.

DESCRIPTION									
DATE									

MISSOURI HIGHWAYS AND TRANSPORTATION COMMISSION

105 WEST CAPITOL
JEFFERSON CITY, MO 65102
1-888-ASK-MODOT (1-888-275-6636)

PAVEMENT MARKING - ROUTE J					
LOG MILE	LOG MILE	LENGTH L.F.	4 IN. YELLOW STANDARD WATERBORNE PAVEMENT MARKING PAINT, TYPE P BEADS		REMARKS
			INTERMITTENT LINE	SOLID LINE	
			L.F.	L.F.	
0.019	0.439	2217.60		4435.2	NO PASSING EASTBOUND, NO PASSING WESTBOUND
0.439	0.479	211.20	52.8	211.2	NO PASSING WESTBOUND, PASSING EASTBOUND
0.479	0.639	844.80	211.2		PASSING BOTH DIRECTIONS
0.639	0.719	422.40	105.6	422.4	PASSING WESTBOUND, NO PASSING EASTBOUND
0.719	1.182	2444.64		4889.3	NO PASSING EASTBOUND, NO PASSING WESTBOUND
1.182	1.342	844.80	211.2	844.8	PASSING WESTBOUND, NO PASSING EASTBOUND
1.342	1.462	633.60	158.4	633.6	NO PASSING WESTBOUND, PASSING EASTBOUND
1.462	1.502	211.20		422.4	NO PASSING EASTBOUND, NO PASSING WESTBOUND
1.502	1.622	633.60	158.4	633.6	PASSING WESTBOUND, NO PASSING EASTBOUND
1.622	1.999	1990.56		3981.1	NO PASSING EASTBOUND, NO PASSING WESTBOUND
1.999	2.179	950.40	237.6	950.4	NO PASSING WESTBOUND, PASSING EASTBOUND
2.179	2.359	950.40	237.6	950.4	PASSING WESTBOUND, NO PASSING EASTBOUND
2.359	2.479	633.60	158.4	633.6	NO PASSING WESTBOUND, PASSING EASTBOUND
2.479	2.519	211.20		422.4	NO PASSING EASTBOUND, NO PASSING WESTBOUND
2.519	2.639	633.60	158.4	633.6	PASSING WESTBOUND, NO PASSING EASTBOUND
2.639	2.700	322.08		644.2	NO PASSING EASTBOUND, NO PASSING WESTBOUND
2.700	2.860	844.80	211.2	844.8	NO PASSING WESTBOUND, PASSING EASTBOUND
2.860	2.940	422.40	105.6		PASSING BOTH DIRECTIONS
2.940	3.100	844.80	211.2	844.8	PASSING WESTBOUND, NO PASSING EASTBOUND
3.100	3.140	211.20		422.4	NO PASSING EASTBOUND, NO PASSING WESTBOUND
3.140	3.301	850.08	212.5	850.1	NO PASSING WESTBOUND, PASSING EASTBOUND
3.301	3.361	316.80	79.2		PASSING BOTH DIRECTIONS
3.361	3.521	844.80	211.2	844.8	PASSING WESTBOUND, NO PASSING EASTBOUND
3.521	3.721	1056.00		2112.0	NO PASSING EASTBOUND, NO PASSING WESTBOUND
3.721	3.820	522.72	130.7	522.7	NO PASSING WESTBOUND, PASSING EASTBOUND
3.820	3.880	316.80		633.6	NO PASSING EASTBOUND, NO PASSING WESTBOUND
3.880	4.001	638.88	159.7	638.9	PASSING WESTBOUND, NO PASSING EASTBOUND
4.001	4.938	4947.36		9894.7	NO PASSING EASTBOUND, NO PASSING WESTBOUND
4.938	5.038	528.00	132.0	528.0	NO PASSING WESTBOUND, PASSING EASTBOUND
5.038	5.118	422.40		844.8	NO PASSING EASTBOUND, NO PASSING WESTBOUND
5.118	5.198	422.40	105.6	422.4	PASSING WESTBOUND, NO PASSING EASTBOUND
5.198	5.657	2423.52		4847.0	NO PASSING EASTBOUND, NO PASSING WESTBOUND
5.657	5.837	950.40	237.6	950.4	NO PASSING WESTBOUND, PASSING EASTBOUND
5.837	6.018	955.68	238.9	955.7	PASSING WESTBOUND, NO PASSING EASTBOUND
6.018	6.117	522.72		1045.4	NO PASSING EASTBOUND, NO PASSING WESTBOUND
6.117	6.218	533.28	133.3	533.3	NO PASSING WESTBOUND, PASSING EASTBOUND
6.218	6.297	417.12		834.2	NO PASSING EASTBOUND, NO PASSING WESTBOUND
6.297	6.398	533.28	133.3	533.3	PASSING WESTBOUND, NO PASSING EASTBOUND
6.398	6.577	945.12		1890.2	NO PASSING EASTBOUND, NO PASSING WESTBOUND
6.577	6.677	528.00	132.0	528.0	NO PASSING WESTBOUND, PASSING EASTBOUND
6.677	6.737	316.80		633.6	NO PASSING EASTBOUND, NO PASSING WESTBOUND
6.737	6.837	528	132.0	528.0	PASSING WESTBOUND, NO PASSING EASTBOUND
6.837	7.197	1900.8		3801.6	NO PASSING EASTBOUND, NO PASSING WESTBOUND
		SUBTOTALS	4255.6	57192.9	

PAVEMENT MARKING - ROUTE O					
LOG MILE	LOG MILE	LENGTH L.F.	4 IN. YELLOW STANDARD WATERBORNE PAVEMENT MARKING PAINT, TYPE P BEADS		REMARKS
			INTERMITTENT LINE	SOLID LINE	
			L.F.	L.F.	
0.020	0.358	1784.64		3569.3	NO PASSING NORTHBOUND, NO PASSING SOUTHBOUND
0.358	0.459	533.28	133.3	533.3	NO PASSING NORTHOUN, PASSING SOUTHBOUND
0.459	0.538	417.12	104.3		PASSING BOTH DIRECTIONS
0.538	0.618	422.40	105.6	422.4	PASSING NORTHOUN,NO PASSING SOUTHBOUND
0.618	0.698	422.40	105.6	422.4	NO PASSING NORTHOUN, PASSING SOUTHBOUND
0.698	0.838	739.20	184.8	739.2	PASSING NORTHOUN,NO PASSING SOUTHBOUND
0.838	1.619	4123.68		8247.4	NO PASSING NORTHBOUND, NO PASSING SOUTHBOUND
1.619	1.738	628.32	157.1	628.3	NO PASSING NORTHOUN, PASSING SOUTHBOUND
1.738	1.758	105.60		211.2	NO PASSING NORTHBOUND, NO PASSING SOUTHBOUND
1.758	1.878	633.60	158.4	633.6	PASSING NORTHOUN,NO PASSING SOUTHBOUND
1.878	4.160	12048.96		24097.9	NO PASSING NORTHBOUND, NO PASSING SOUTHBOUND
4.160	4.220	316.80	79.2	316.8	NO PASSING NORTHOUN, PASSING SOUTHBOUND
4.220	4.579	1895.52	473.9		PASSING BOTH DIRECTIONS
4.579	4.738	839.52	209.9	839.5	PASSING NORTHOUN,NO PASSING SOUTHBOUND
4.738	5.879	6024.48		12049.0	NO PASSING NORTHBOUND, NO PASSING SOUTHBOUND
		SUBTOTALS	1712.1	52710.3	

PAVEMENT MARKING TOTALS		
ROUTE	4 IN. YELLOW STANDARD WATERBORNE PAVEMENT MARKING PAINT, TYPE P BEADS	4 IN. WHITE STANDARD WATERBORNE PAVEMENT MARKING PAINT, TYPE P BEADS
CC	45951	
H	83389	6716
J	61449	
O	54422	
PAY TOTAL	245,211	6,716

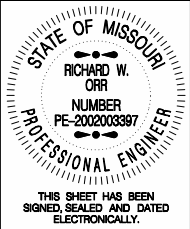

DATE PREPARED 3/24/2025	
ROUTE VAR.	STATE MO
DISTRICT NW	SHEET NO. 3
COUNTY VARIOUS	
JOB NO. JNW0029	
CONTRACT ID.	

PROJECT NO.
BRIDGE NO.

DESCRIPTION					

MISSOURI HIGHWAYS AND TRANSPORTATION
COMMISSION

105 WEST CAPITOL
JEFFERSON CITY, MO 65102
1-888-ASK-MODOT (1-888-275-6636)

SIGN	SIZE IN.	AREA SQ.FT.	QTY EACH	TOTAL AREA SQ.FT.	RELOC EACH	TOTAL RELOC SQ.FT.	SIGN NUM.	DESCRIPTION
WARNING SIGNS								
WO1-1L	48X48	16.00						TURN (SYMBOL LEFT)
WO1-1R	48X48	16.00						TURN (SYMBOL RIGHT)
WO1-2L	48X48	16.00						CURVE (SYMBOL LEFT)
WO1-2R	48X48	16.00						CURVE (SYMBOL RIGHT)
WO1-3L	48X48	16.00						REVERSE TURN (SYMBOL LEFT)
WO1-3R	48X48	16.00						REVERSE TURN (SYMBOL RIGHT)
WO1-4L	48X48	16.00						REVERSE CURVE (SYMBOL LEFT)
WO1-4R	48X48	16.00						REVERSE CURVE (SYMBOL RIGHT)
WO1-4bL	48X48	16.00						DOUBLE ARROW REVERSE CURVE (SYMBOL LEFT)
WO1-4bR	48X48	16.00						DOUBLE ARROW REVERSE CURVE (SYMBOL RIGHT)
WO1-4cL	48X48	16.00						TRIPLE ARROW REVERSE CURVE (SYMBOL LEFT)
WO1-4cR	48X48	16.00						TRIPLE ARROW REVERSE CURVE (SYMBOL RIGHT)
WO1-6	60X30	12.50						HORIZONTAL ARROW (SYMBOL)
WO1-6a	72X36	18.00						HORIZ. ARROW (SYMBOL ON PERMANENT BARRICADE)
WO1-7	60X30	12.50						DOUBLE HEAD HORIZONTAL ARROW (SYMBOL)
WO1-7a	72X36	18.00						DOUBLE HEAD HORIZ. ARROW (SYMBOL ON PERM. BARR.)
WO1-8	18X24	3.00						CHEVRON (SYMBOL)
WO1-8a	30X36	7.50						CHEVRON (SYMBOL FOR DIVIDED HIGHWAYS)
WO3-1	48X48	16.00						STOP AHEAD (SYMBOL)
WO3-2	48X48	16.00						YIELD AHEAD (SYMBOL)
WO3-3	48X48	16.00						SIGNAL AHEAD (SYMBOL)
WO3-4	48X48	16.00	7	112.00			11	BE PREPARED TO STOP
WO3-5	48X48	16.00						SPEED LIMIT AHEAD
WO4-1L	48X48	16.00						MERGE (SYMBOL FROM LEFT)
WO4-1R	48X48	16.00						MERGE (SYMBOL FROM RIGHT)
WO4-1aL	48X48	16.00						MERGE (LEFT)
WO4-1aR	48X48	16.00						MERGE (RIGHT)
WO5-1	48X48	16.00						ROAD/BIDGE/RAMP NARROWS
WO5-3	48X48	16.00						ONE LANE BRIDGE
WO5-5	48X48	16.00						NARROW LANES
WO6-1	48X48	16.00						DIVIDED HIGHWAY (SYMBOL)
WO6-2	48X48	16.00						DIVIDED HIGHWAY END (SYMBOL)
WO6-3	48X48	16.00						TWO WAY TRAFFIC (SYMBOL)
WO7-3a	30X24	5.00						NEXT XX MILES (PLAQUE)
WO8-1	48X48	16.00						BUMP
WO8-2	48X48	16.00						DIP
WO8-3	48X48	16.00						PAVEMENT ENDS
WO8-4	48X48	16.00						SOFT SHOULDER
WO8-5	48X48	16.00						SLIPPERY WHEN WET (SYMBOL)
WO8-6	48X48	16.00						TRUCK CROSSING
WO8-6c	48X48	16.00						TRUCK ENTRANCE
WO8-7	36X36	9.00						LOOSE GRAVEL
WO8-7a	36X36	9.00						FRESH OIL / LOOSE GRAVEL
WO8-9	48X48	16.00						LOW SHOULDER
WO8-11	48X48	16.00	2	32.00			36	UNEVEN LANES
WO8-12	48X48	16.00	4	64.00			35	NO CENTER LINE
WO8-15	48X48	16.00						GROOVED PAVEMENT
WO8-15P	30X24	5.00						MOTORCYCLE (PLAQUE)
WO8-17L	48X48	16.00						SHOULDER DROP-OFF (SYMBOL LEFT)
WO8-17R	48X48	16.00						SHOULDER DROP-OFF (SYMBOL RIGHT)
WO8-17P	30X24	5.00						SHOULDER DROP-OFF (PLAQUE)
W10-1	42RND.	9.62						RAILROAD CROSSING
WO12-1	24X24	4.00						DOUBLE DOWN ARROW (SYMBOL)
WO12-2	48X48	16.00						LOW CLEARANCE (SYMBOL)
WO12-2x	24X18	3.00						LOW CLEARANCE (PLAQUE)
WO12-2a	84X24	14.00						OVERHEAD LOW CLEARANCE (FEET AND INCHES)
WO12-4	120X60	50.00						LOW CLEARANCE XX FT XX IN XX MILES AHEAD
WO12-5	120X60	50.00						WIDTH RESTRICTION XX FT XX IN XX MILES AHEAD
WO13-1	30X30	6.25						ADVISORY SPEED (PLAQUE)
WO16-2	30X24	5.00						XXX FEET (PLAQUE)</

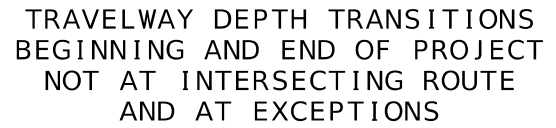
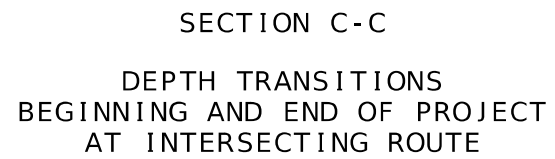
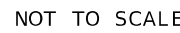
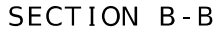
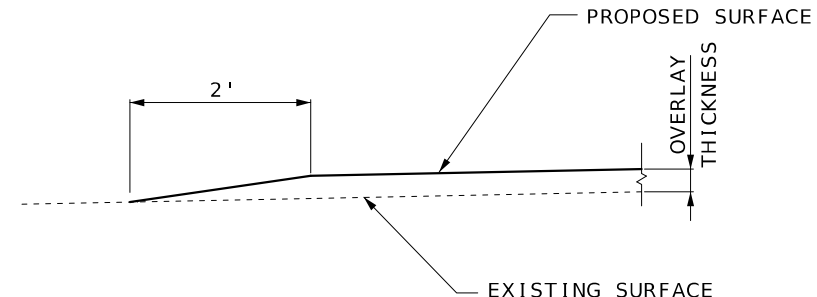
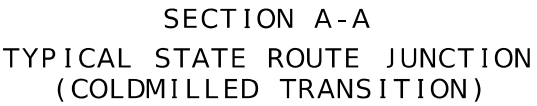

[illegible]



NOTE: ADDITIONAL SIDEROADS MAY BE SIGNED AS APPROVED BY THE ENGINEER.



ALL SIGNS SHALL BE POST MOUNTED AND IN ACCORDANCE WITH
STANDARD PLAN 616.10 AND 903.03.

TRAFFIC CONTROL
SHEET 3 OF 6



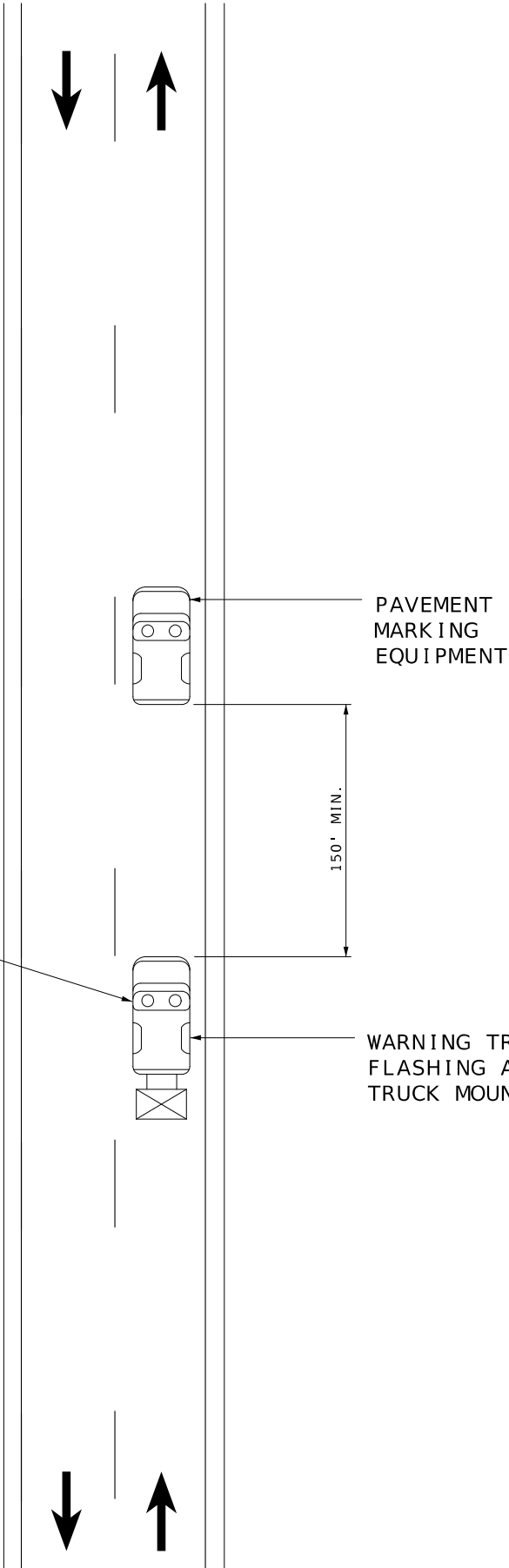
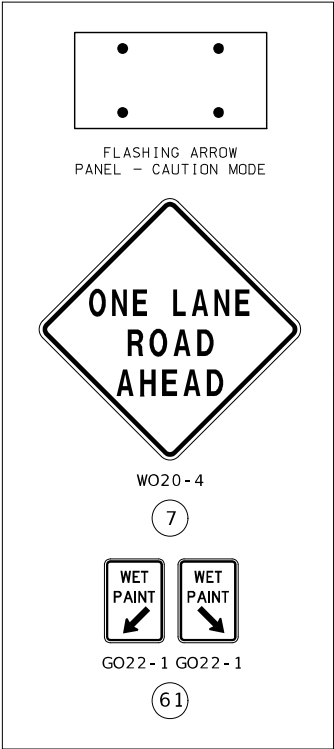

STRIPING OPERATIONS

NOTES:

UPON APPROVAL OF THE ENGINEER, THE CONTRACTOR MAY PROVIDE ADDITIONAL PROTECTIVE TRUCKS EQUIPPED WITH PROPER WARNING DEVICES.

PROTECTIVE TRUCKS AND WORK VEHICLES SHALL DISPLAY HIGH-INTENSITY ROTATING, FLASHING, OSCILLATING, OR STROBE LIGHTS.

VEHICLE HAZARD WARNING SIGNALS SHALL NOT BE USED INSTEAD OF THE VEHICLE'S HIGH-INTENSITY ROTATING, FLASHING, OSCILLATING, OR STROBE LIGHTS.

VEHICLE-MOUNTED SIGNS SHALL BE MOUNTED IN A MANNER SUCH THAT THEY ARE NOT OBSCURED BY EQUIPMENT OR SUPPLIES. SIGN LEGENDS ON VEHICLE-MOUNTED SIGNS SHALL BE COVERED OR TURNED FROM VIEW WHEN WORK IS NOT IN PROGRESS.

FLASHING ARROW PANELS SHALL BE INCIDENTAL TO TRUCK MOUNTED ATTENUATORS, WHEREVER USED. NO ADDITIONAL PAYMENT WILL BE MADE.

FLASHING ARROW PANELS SHALL, AS A MINIMUM, BE TYPE B, WITH A SIZE OF 60 X 30 INCHES.

A FLASHING ARROW BOARD SHALL BE USED WHEN A FREEWAY LANE IS CLOSED. WHEN MORE THAN ONE LANE CLOSED, A SEPARATE FLASHING ARROW BOARD SHALL BE USED FOR EACH CLOSED LANE.

(1) WET PAINT SIGNS ARE INSTALLED TO INDICATE THE SIDE IN WHICH THE PAVEMENT MARKING MATERIAL IS BEING APPLIED. AT THE CONTRACTOR'S OPTION, A FRONT FACING WET PAINT SIGN MAY BE INSTALLED ON THE LEFT SIDE OF THE PAVEMENT MARKING EQUIPMENT.

(2) WARNING TRUCK IS POSITIONED AT THE NO TRACK POINT OF THE PAVEMENT MARKING MATERIAL, OR SPACING SHOWN, WHICH EVER IS GREATER.

* TMA COST IS INCIDENTAL - NO DIRECT PAY

NOT TO SCALE

STATE OF MISSOURI
RICHARD W. ORR
NUMBER
PE-2002003397
PROFESSIONAL ENGINEER

THIS SHEET HAS BEEN
SIGNED, SEALED, AND DATED
ELECTRONICALLY.

DATE PREPARED
3/20/2025

ROUTE
VAR.

DISTRICT
NW

STATE
MO

SHEET NO.
8

COUNTY
VARIOUS

JOB NO.
JNW0029

CONTRACT ID.

PROJECT NO.

BRIDGE NO.

DESCRIPTION	DATE

MISSOURI HIGHWAYS AND TRANSPORTATION
COMMISSION

105 WEST CAPITOL
JEFFERSON CITY, MO 65102
1-888-ASK-MODOT (1-888-275-6636)

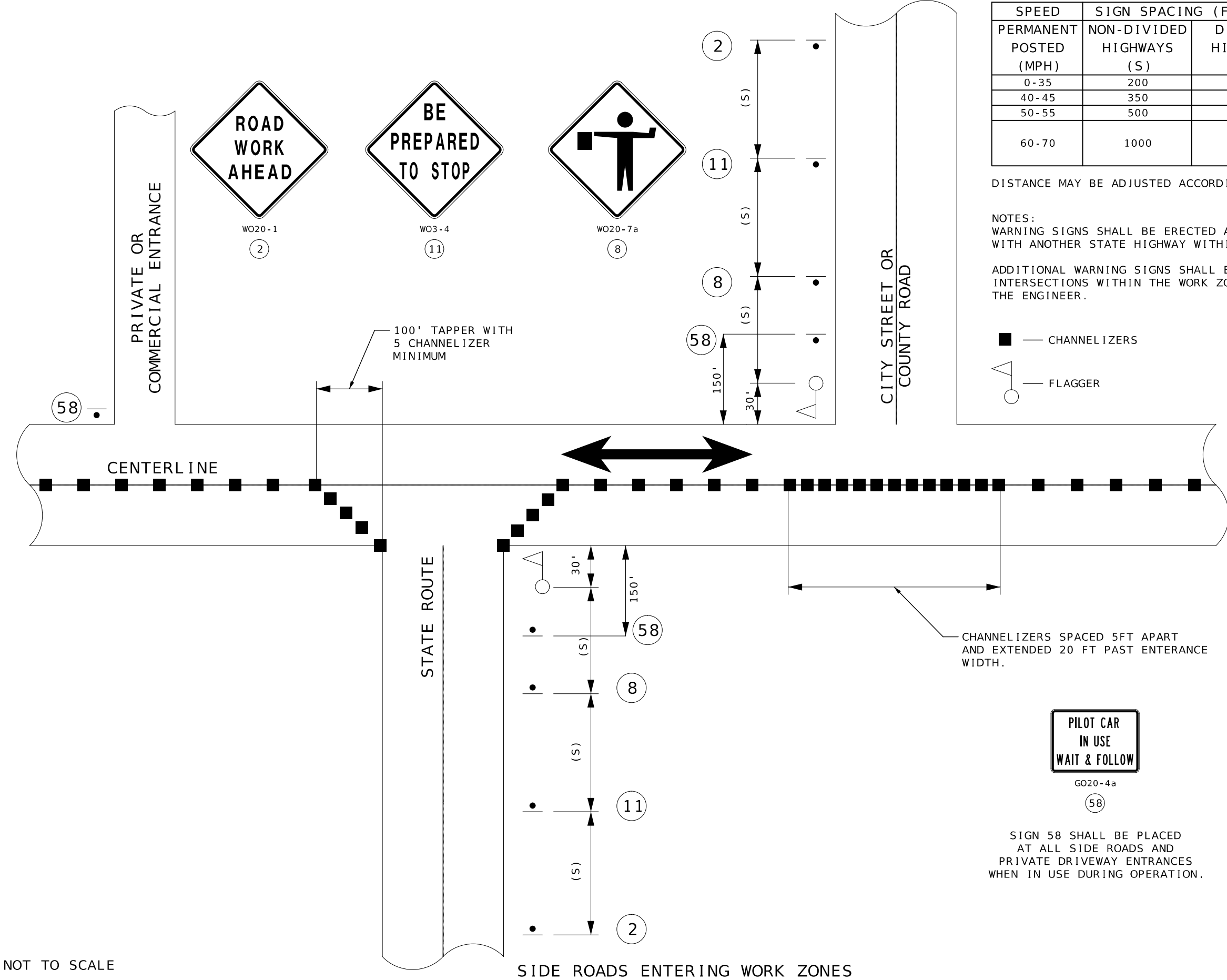

SPEED PERMANENT POSTED (MPH)	SIGN SPACING (FT.) (1)	
	NON-DIVIDED HIGHWAYS (S)	DIVIDED HIGHWAYS (S)
0-35	200	--
40-45	350	--
50-55	500	--
60-70	1000	--

DISTANCE MAY BE ADJUSTED ACCORDING TO FIELD CONDITIONS.

NOTES:
WARNING SIGNS SHALL BE ERECTED AT EACH INTERSECTION WITH ANOTHER STATE HIGHWAY WITHIN THE WORK ZONE.

ADDITIONAL WARNING SIGNS SHALL BE ERECTED AT OTHER INTERSECTIONS WITHIN THE WORK ZONE, AS DIRECTED BY THE ENGINEER.

- CHANNELIZERS
- △ FLAGGER

CHANNELIZERS SPACED 5 FT APART AND EXTENDED 20 FT PAST ENTRANCE WIDTH.

PILOT CAR
IN USE
WAIT & FOLLOW

GO20-4a

(58)

SIGN 58 SHALL BE PLACED AT ALL SIDE ROADS AND PRIVATE DRIVEWAY ENTRANCES WHEN IN USE DURING OPERATION.

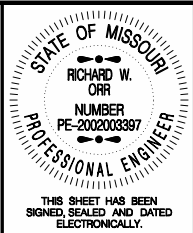

DATE PREPARED 3/20/2025	
ROUTE VAR.	STATE MO
DISTRICT NW	SHEET NO. 9
COUNTY VARIOUS	
JOB NO. JNW0029	
CONTRACT ID.	
PROJECT NO.	
BRIDGE NO.	

DATE	DESCRIPTION

MISSOURI HIGHWAYS AND TRANSPORTATION COMMISSION

105 WEST CAPITOL
JEFFERSON CITY, MO 65102
1-888-ASK-MODOT (1-888-275-6636)

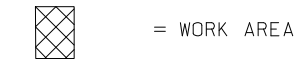
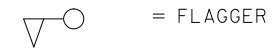
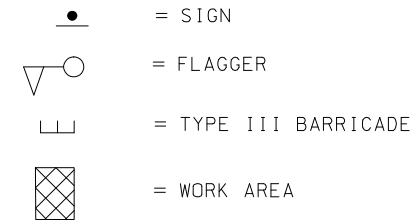
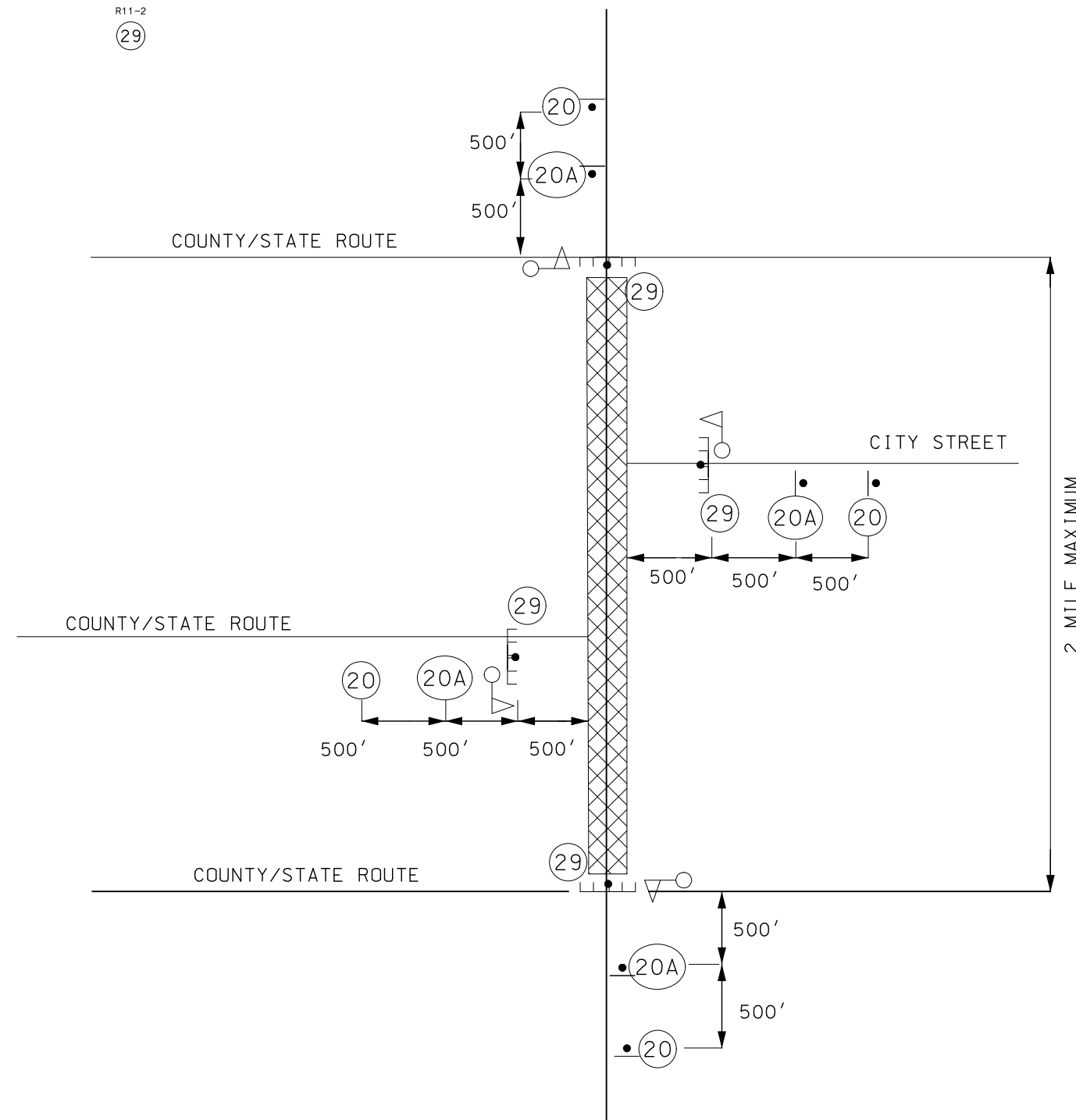

NOT TO SCALE

NOTE: THIS SHEET IS SUPPLEMENTAL TO STANDARD PLAN 616.20

OPTIONAL ROAD CLOSURE

OPTIONAL ROAD CLOSURE
TRAFFIC CONTROL
SHEET 6 OF 6



THIS SHEET HAS BEEN
SIGNED, SEALED AND DATED
ELECTRONICALLY.

DATE PREPARED
3/20/2025

ROUTE VAR .	STATE MO
----------------	-------------

DISTRICT NW	SHEET NO. 10
----------------	-----------------

COUNTY
VARIOUS

JOB NO.
JNW0029

CONTRACT ID.

PROJECT NO.

BRIDGE NO.

[illegible]

MISSOURI HIGHWAYS AND TRANSPORTATION
COMMISSION

105 WEST CAPITOL
JEFFERSON CITY, MO 65102
1-888-ASK-MODOT (1-888-273-6636)

MISSOURI HIGHWAYS AND TRANSPORTATION
COMMISSION

105 WEST CAPITOL
JEFFERSON CITY, MO 65102
1-888-ASK-MODOT (1-888-275-6636)