

DESIGN DESIGNATION
ROUTE 135
A.A.D.T. - 2024 = VARIES 465 - 1896
V=55 M.P.H

MISSOURI HIGHWAYS AND TRANSPORTATION COMMISSION
PLANS FOR PROPOSED
STATE HIGHWAY
COOPER COUNTY

INDEX OF SHEETS

DESCRIPTION	SHEET NUMBER
TITLE SHEET -----	1
TYPICAL SECTIONS (TS) (1 SHEET)----	2
QUANTITIES (QU) (1 SHEET)-----	3
SPECIAL SHEET (1 SHEET).....	4
TRAFFIC CONTROL SHEETS (TC)-----	5-9

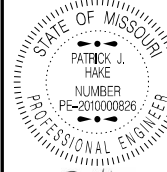

DATE PREPARED 6/2/2025	
ROUTE 135	STATE MO
DISTRICT CD	SHEET NO. 1
COUNTY COOPER	
JOB NO. JCD0192	
CONTRACT ID.	
PROJECT NO.	
BRIDGE NO.	

DESCRIPTION	DATE

LENGTH OF PROJECT

ROUTE 135	
BEGINNING OF PROJECT	00.000 MI
END OF PROJECT	20.497 MI
APPARENT LENGTH	108224.16 FT
EXCEPTIONS: BRIDGE - L0944 - I-70 LOG MI 0.014-0.052	-200.6 FT
EXCEPTIONS: BRIDGE-A7228-OVER LAMINE RIVER LOG MI 17.422-17.481	-311.5 FT
TOTAL CORRECTIONS	512.1 FT
NET LENGTH OF PROJECT	107712.06 FT
STATE LENGTH	20.400 MI

ESTIMATED DISTURBED 0.000 ACRES

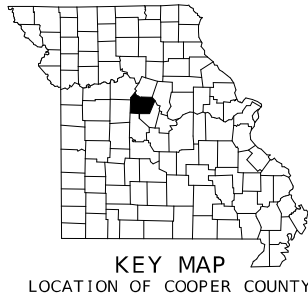
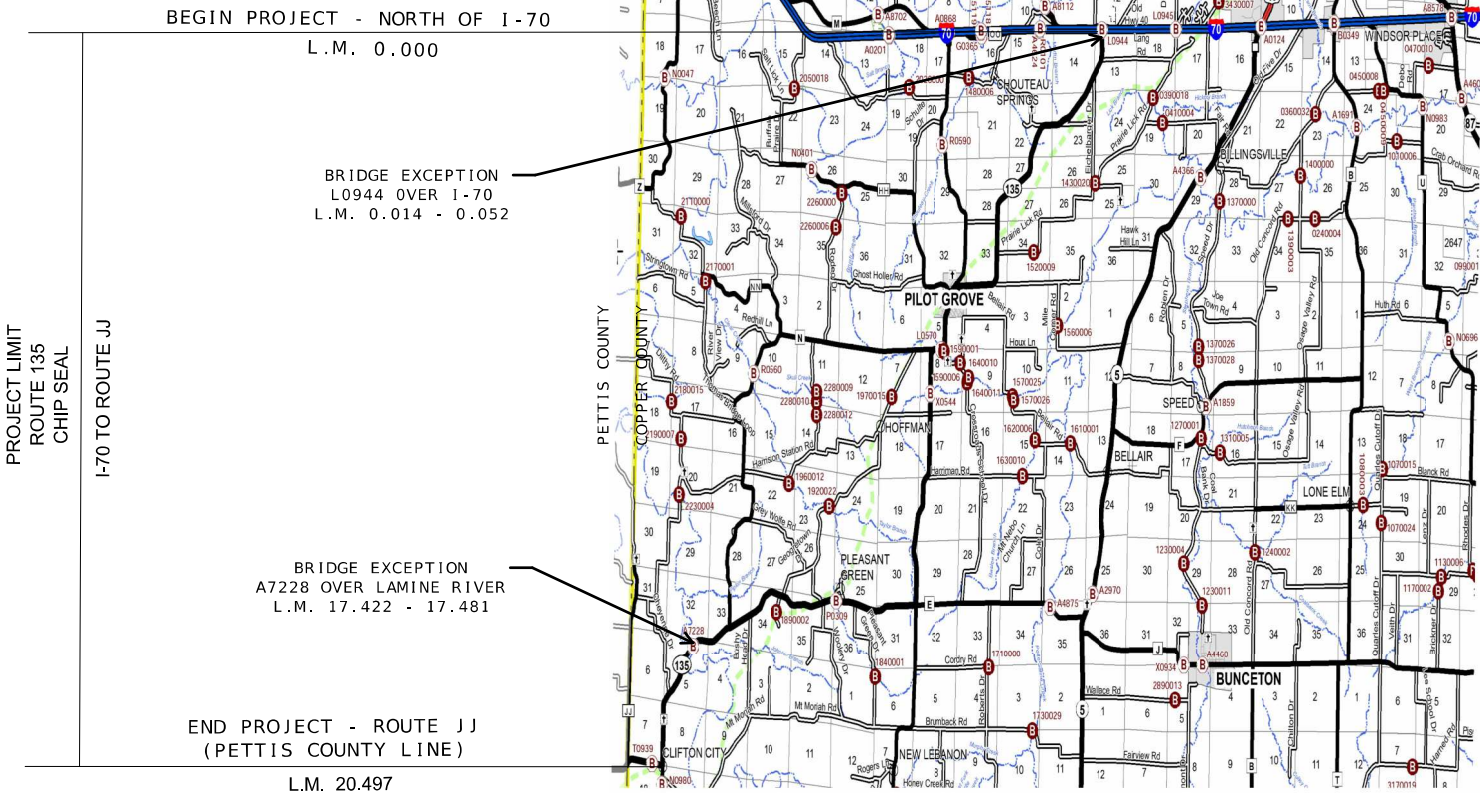

NOT TO SCALE

MISSOURI HIGHWAYS AND TRANSPORTATION COMMISSION

105 WEST CAPITOL
JEFFERSON CITY, MO 65102
1-888-ASK-MODOT (1-888-275-6636)

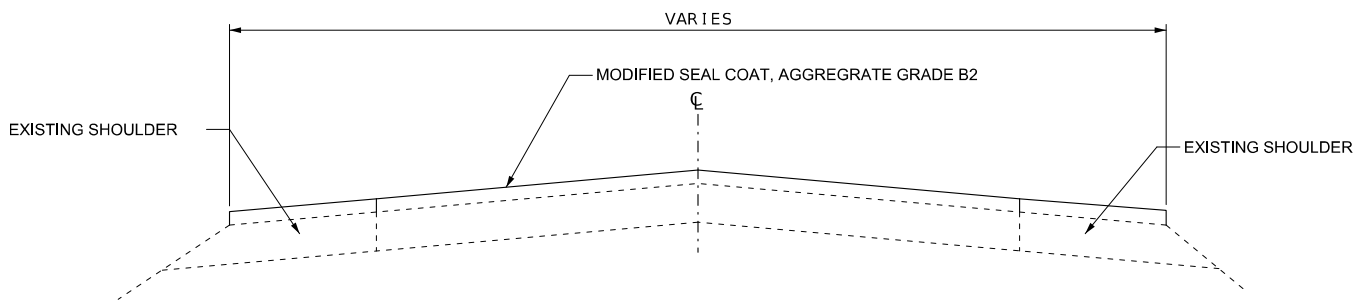

BRIDGE EXCEPTION (L0944) OVER I-70: LOG MILES 0.014-0.052
BRIDGE EXCEPTION (A7228) OVER LAMINE RIVER : LOG MILES 17.422-17.481

0.28 GAL/YD²

TYPICAL SECTION
SHEET 1 OF 1

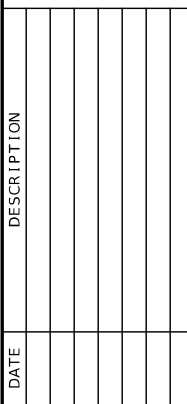

100 WEST CAPITOL
JEFFERSON CITY, MO 65102
1-888-ASK-MODOT (1-888-275-6636)

TEMPORARY TRAFFIC CONTROL						
SIGN	SIZE IN.	AREA SQ. FT.	QTY EACH	TOTAL AREA SQ. FT.	SIGN NUM.	DESCRIPTION
CONSTRUCTION SIGNS						
GO20-1	60X24	10.00	2	20	1	ROAD WORK NEXT X MILES 2 @ 20
WO20-1	48X48	16.00	19	304	2	ROAD WORK AHEAD
WO20-4	48X48	16.00	6	96	7	ONE LANE ROAD AHEAD
WO20-7a	48X48	16.00	19	304	8	FLAGGER (SYMBOL , WITH FLAGS)
WO3-4	48X48	16.00	15	240	11	BE PREPARED TO STOP
GO20-2	48X24	8.00	2	16	26	END ROAD WORK
WO8-12	48X48	16.00	23	368	35	NO CENTER LINE
GO20-4	36X18	4.50	1	4.5	53	PILOT CAR FOLLOW ME
WO8-7a	36X36	9.00	43	387	57	FRESH OIL LOOSE GRAVEL
GO20-4a	42X30	8.75	5	43.75	58	PILOT CAR IN USE WAIT & FOLLOW
GO20-4a	18X12	1.50	13	19.5	58	PILOT CAR IN USE WAIT & FOLLOW
CONST-8	48X36	12.00	2	24	59	WORK ZONE NO PHONE ZONE
GO22-1	21X15	2.19	4	8.76		WET PAINT (ARROW PIVOTS)
CONSTRUCTION SIGNS TOTAL				1835.51		
ADDITIONAL TRAFFIC CONTROL ITEMS						
		616-1025		323	CHANNELIZERS (TRIM-LINE)	
		619-1098A		2 *	CHANGEABLE MESSAGE SIGN WITHOUT COMMUNICATION INTERFACE CONTRACTOR FURNISHED, CONTRACTOR RETAINED	
TEMPORARY TRAFFIC CONTROL TOTAL				1 LUMP SUM		

* NOT INCLUDED IN LUMP SUM TRAFFIC CONTROL

NOTE: ALL TRAFFIC CONTROL ITEMS ARE INCLUDED IN PAY ITEM 616-99.01, LUMP SUM TEMPORARY TRAFFIC CONTROL, UNLESS OTHERWISE NOTED IN THE PLANS. THE QUANTITIES SHOWN ARE ONLY AN ESTIMATE AND ARE SUBJECT TO CHANGE BASED UPON FIELD CONDITIONS AND CONTRACTOR'S OPERATIONS.

NO DIRECT PAY WILL BE MADE FOR RELOCATION OF CONSTRUCTION SIGNS OR DEVICES.

BITUMINOUS PAVEMENT SEAL COAT, GRADE B2								
LOG MI	LOG MI	LOCATION	LENGTH FT	RDWY WIDTH FT	AREA SF	MODIFIED SEAL COAT AGGREGATE GRADE B2 SY	EMULSIFIED ASPHALT GAL (0.28 GAL/SY)	REMARKS
0.000	0.014	ROUTE 135	147.00	VAR	8578.74	953.19		INTERSECTION AREA BETWEEN WB RAMPs AND RTE 41
0.014	0.052	ROUTE 135	200.64		1995.84	221.76	62.09	EXCEPTION - BRIDGE L0944 OVER I-70
0.052	0.072	ROUTE 135	105.60	28	2956.8	328.53	91.99	
0.072	6.030	ROUTE 135	31458.24	26	817914.24	90879.36	25446.22	
6.030	6.197	ROUTE 135	881.76	22	19398.72	2155.41	603.51	
6.197	6.337	ROUTE 135	739.20	22.5	16632	1848.00	517.44	
6.337	6.340	ROUTE 135	15.00					EXCEPTION - CONCRETE CROSSWALK IN PILOT GROVE AT ROE ST
6.340	6.350	ROUTE 135	52.80	22.5	1188	132.00	36.96	
6.350	6.354	ROUTE 135	19.00					EXCEPTION - CROSSWALK AT ROE ST
6.354	6.821	ROUTE 135	2465.76	22.5	55479.6	6164.40	1726.03	
6.821	6.902	ROUTE 135	427.68	22	9408.96	1045.44	292.72	
6.902	11.750	ROUTE 135	25597.44	26	665533.44	73948.16	20705.48	
11.750	11.775	ROUTE 135	132.00	VAR	9684.68	1076.08	301.30	INTERSECTION OF ROUTE A & E
11.775	17.422	ROUTE 135	29816.16	26	775220.16	86135.57	24117.96	
17.422	17.481	ROUTE 135	311.52					EXCEPTION - BRIDGE A7228 OVER LAMINE RIVER
17.481	19.452	ROUTE 135	10406.88	26	270578.88	30064.32	8418.01	
19.452	19.628	ROUTE 135	929.28	22	20444.16	2271.57	636.04	
19.628	19.639	ROUTE 135	58.08	VAR	3700.00	411.11	115.11	ROUTE BB INTERSECTION-CLIFTON CITY
19.639	19.764	ROUTE 135	660.00	22	14520.00	1613.33	451.73	
19.764	20.497	ROUTE 135	3870.24	26	100626.24	11180.69	3130.59	END AT PETTIS COUNTY LINE
TOTAL						310428.92	86653.18	
USE						310429	86653	

REMOVAL OF IMPROVEMENTS						
LOG MI	LOG MI	LOCATION	DESCRIPTION	QUANTITY		REMARKS
0.014	0.024	RTE. 135 - RT	BRIDGE ATTACHMENT, GUARDRAIL, CRASHWORTHY END TREATMENT	181	LF	EXISTING BRIDGE END
0.014	0.024	RTE. 135 - LT	BRIDGE ATTACHMENT, GUARDRAIL, END ANCHOR	139	LF	EXISTING BRIDGE END
TOTAL				1 LUMP SUM		

PAVEMENT MARKING REMOVAL				
APPROX LOG MI	LOCATION	ITEM	QTY LF	REMARKS
45.889	ROUTE 41	PREFORMED THERMOPLASTIC 24" WHITE STOP BAR	35	TWO STOP BARS AT INTERSECTION
TOTAL			35	
USE			35	

PAVEMENT MARKING							
APPROX. LOG MI	APPROX. LOG MI	LOCATION	LENGTH FT	CLASS 1 PAVEMENT MARKING PAINT (18-MIL, TYPE P BEADS)			PREFORMED THERMOPLASTIC PAVEMENT MARKING
				4 IN. WHITE LF	4 IN. YELLOW LF	8 IN. WHITE LF	24 IN. WHITE LF
45.889		ROUTE 41				32.00	35.00
45.889	45.916	ROUTE 41	142.56	285.12	285.12		
0.000	20.497	ROUTE 135	108224.16	216448.32	216448.32		
TOTAL				216733.44	216733.44	32.00	35.00
USE				216733	216733	32	35
NOTE: ALL PAVEMENT MARKING TO MATCH EXISTING UNLESS OTHERWISE SHOWN IN THE PLANS. LOCATE BEFORE RESURFACING.							

GUARDRAIL											
LOG MI	LOG MI	ROUTE	TOTAL LENGTH	TYPE A GUARDRAIL FT	ASYMMETRICAL TRANSITION SECTION EA	MGS BLOCK AND HEIGHT TRANSITION EA	BRIDGE ANCHOR SECTION EA	TYPE A END ANCHOR EA	MASH CET EA	SHAPING SLOPES, CL 3 STA.	REMARK
0.014	0.024	ROUTE 135 - RT	181	87.5	1	1	1		1	2.1	BRIDGE L0944 I - 70 INTERCHANGE OVERPASS SOUTHWEST
0.014	0.024	ROUTE 135 - LT	139	112.5	1		1	1		1.6	BRIDGE L0944 I - 70 INTERCHANGE OVERPASS SOUTHEAST
TOTAL				200	2	1	2	1	1	3.7	
USE				200	2	1	2	1	1	4.0	

SUMMARY OF QUANTITIES
SHEET 1 OF 1

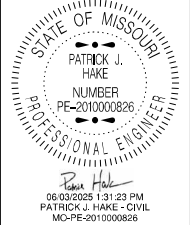

DATE PREPARED 6/2/2025	
ROUTE 135	STATE MO
DISTRICT CD	SHEET NO. 3
COUNTY COOPER	
JOB NO. JCD0192	
CONTRACT ID.	

PROJECT NO.
BRIDGE NO.

DESCRIPTION						
DATE						

MISSOURI HIGHWAYS AND TRANSPORTATION COMMISSION

105 WEST CAPITOL
JEFFERSON CITY, MO 65102
1-888-ASK-MODOT (1-888-275-6636)



INTERSECTION AREA BETWEEN I-70 WB RAMPS AND ROUTE 41

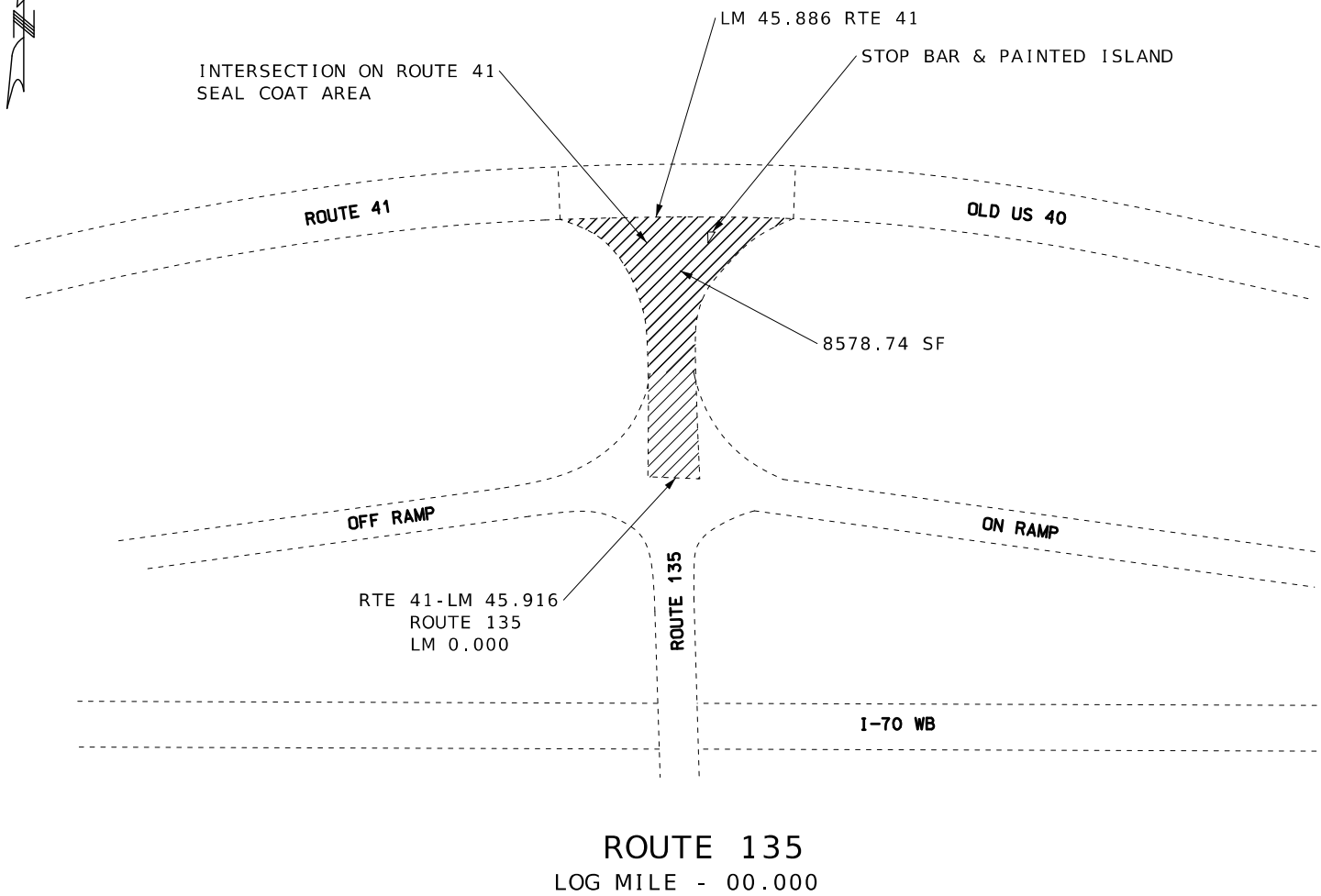

INTERSECTION ROUTE 135, ROUTE A & ROUTE E

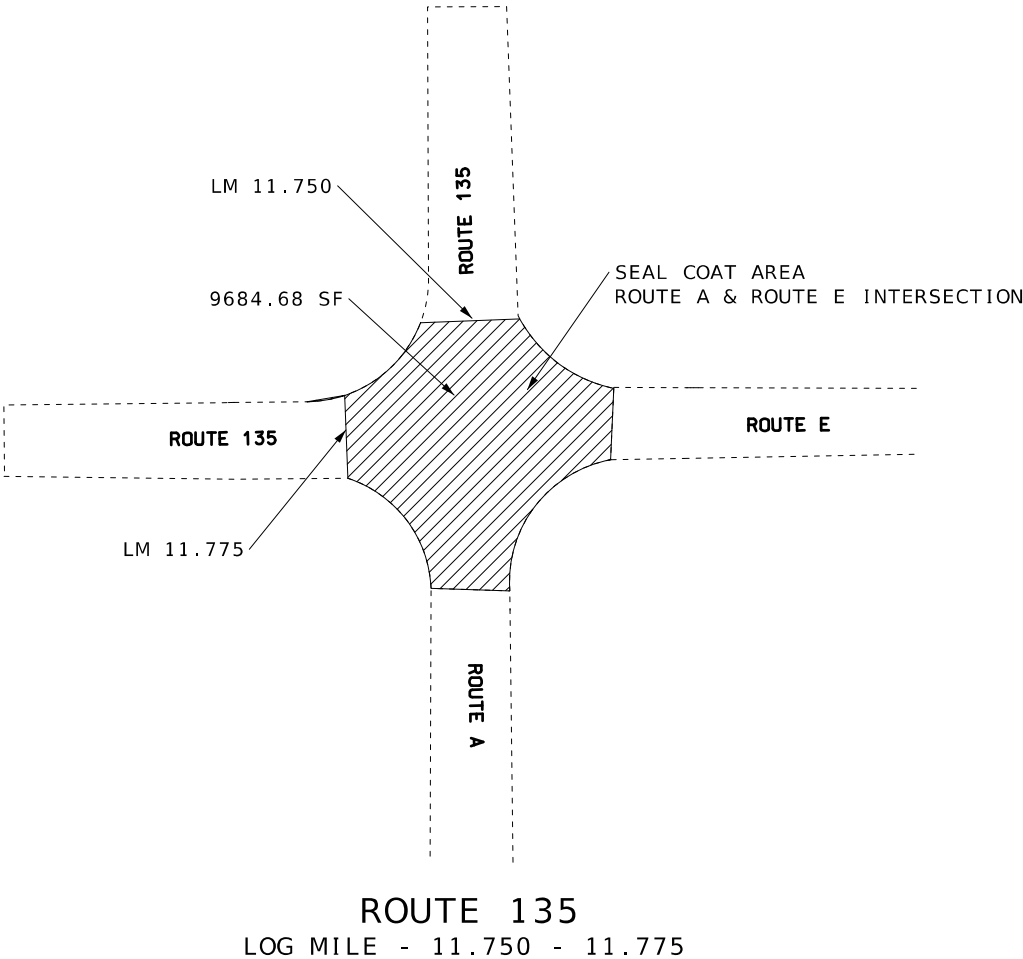

INTERSECTION ROUTE BB IN CLIFTON CITY

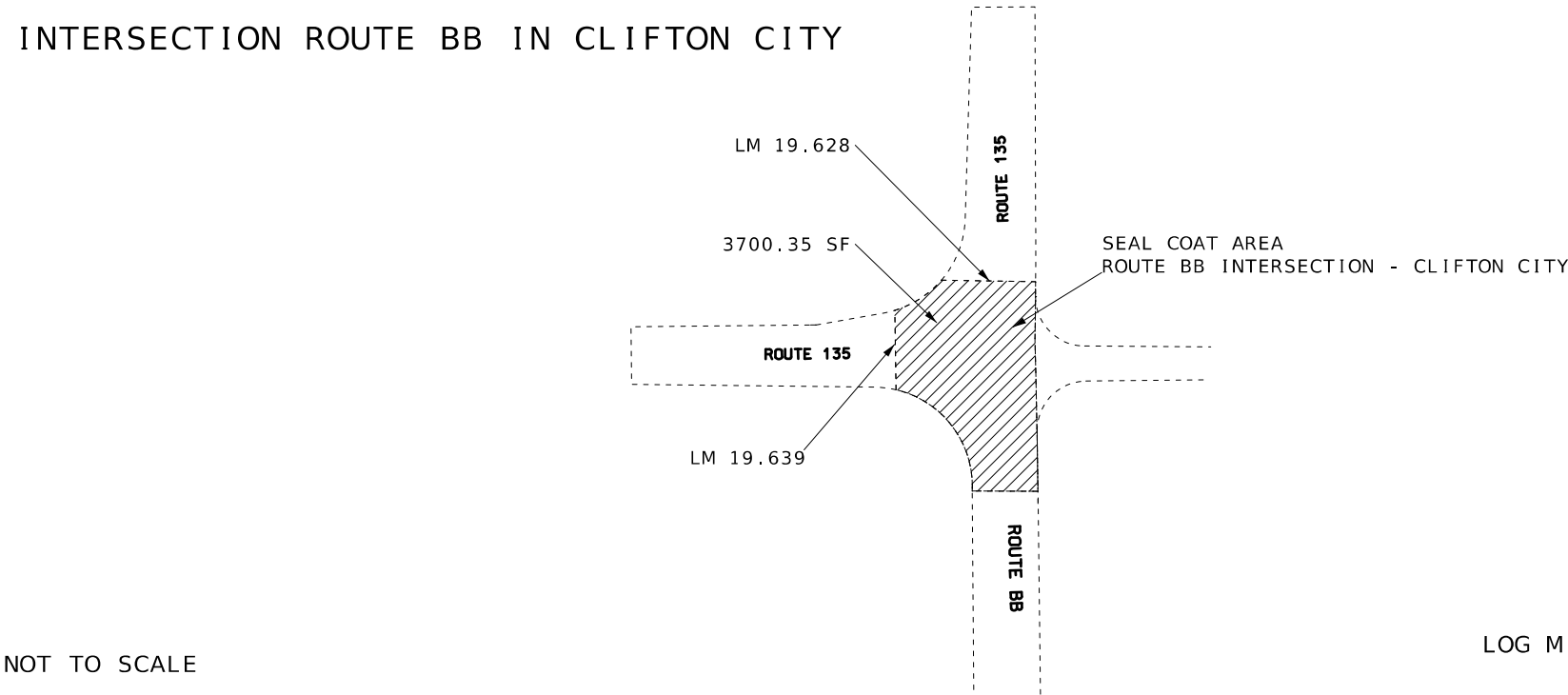

NOT TO SCALE

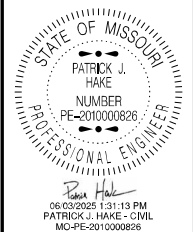

DATE PREPARED 6/2/2025	
ROUTE 135	STATE MO
DISTRICT CD	SHEET NO. 4
COUNTY COOPER	
JOB NO. JCD0192	
CONTRACT ID.	
PROJECT NO.	
BRIDGE NO.	

DATE	DESCRIPTION

MISSOURI HIGHWAYS AND TRANSPORTATION COMMISSION

105 WEST CAPITOL
JEFFERSON CITY, MO 65102
1-888-ASK-MODOT (1-888-275-6636)

SPECIAL SHEET
SHEET 1 OF 1

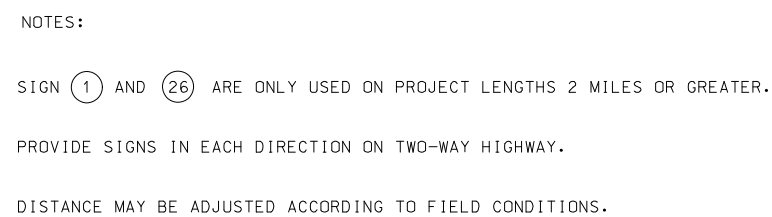

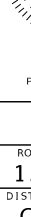
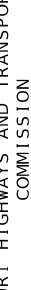
		DATE PREPARED 6/2/2025	
ROUTE 135		STATE MO	
DISTRICT CD		SHEET NO. 5	
COUNTY COOPER			
JOB NO. JCD0192			
CONTRACT ID.			
PROJECT NO.			
BRIDGE NO.			
DESCRIPTION			
DATE			
MISSOURI HIGHWAYS AND TRANSPORTATION COMMISSION			
			
105 WEST CAPITAL JEFFERSON CITY, MO 65102 1-888-ASK-MODOT (1-888-275-6636)			

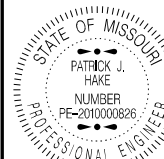

DATE PREPARED
6/2/2025

ROUTE
135

STATE
MO

DISTRICT
CD

SHEET NO.
6

COUNTY
COOPER

JOB NO.
JCD0192

CONTRACT ID.

PROJECT NO.

BRIDGE NO.

DESCRIPTION

DATE

DATE

DATE

DATE

DATE

DATE

DATE

DATE

DATE

DATE

DATE

DATE

DATE

DATE

DATE

DATE

DATE

DATE

DATE

DATE

DATE

DATE

DATE



SIGN 53, "PILOT CAR FOLLOW ME" SHALL BE THE CONTRACTOR'S RESPONSIBILITY WHEN IN USE DURING OPERATION.

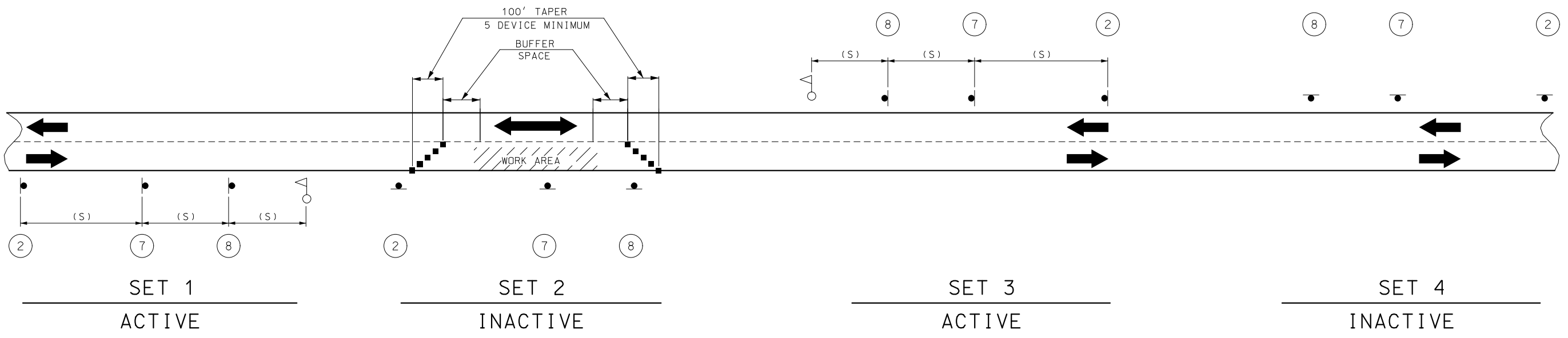

NOTES:

DAYLIGHT FLAGGING OPERATIONS ONLY.

CHANNELIZING DEVICES LOCATED DOWNSTREAM OF THE ONE-LANE, TWO-WAY TAPER ARE OPTIONAL. THESE DEVICES SHOULD BE ELIMINATED WHEN THEIR USE WILL REDUCE THE USABLE LANE WIDTH, INCLUDING ANY ACCEPTABLE SHOULDERS, TO LESS THAN 10' OR WILL SIGNIFICANTLY AFFECT THE RESURFACING OPERATION.

SIGN SETS 1 AND 3 ARE ACTIVE AND (I.E., SIGNS FACE ONCOMING TRAFFIC) SIGN SETS 2 AND 4 ARE INACTIVE (I.E., SIGNS DO NOT FACE EITHER DIRECTION OF TRAFFIC) WHEN THE RESURFACING OPERATION IS LOCATED BETWEEN SIGN SETS 1 AND 3.

WHEN SIGN SETS 2 AND 4 ARE ACTIVE, SIGN SETS 1 AND 3 BECOME INACTIVE AND ARE ADVANCED TO BECOME SETS 2 AND 4 WITH SIGN LEGENDS TURNED AWAY FROM BOTH DIRECTIONS OF TRAFFIC. WHEN THE RESURFACING OPERATION ADVANCES TO BETWEEN SIGN SETS 2 AND 4, SIGN SETS 2 AND 4 BECOME ACTIVE (I.E., NEW SIGN SETS 1 AND 3) AND SIGN SETS 1 AND 3 ADVANCED IN THE DIRECTION OF THE OPERATION (I.E., NEW SIGN SETS 2 AND 4).

■ - CHANNELIZERS

○ - FLAGGER

SPEED	SIGN SPACING (FT) (1)	BUFFER SPACE
PERMANENT POSTED (MPH)	NON-DIVIDED HIGHWAYS (S)	LENGTH (FT)
0-35	200	250
40-45	350	360
50-55	500	495
60-70	1000	730

(1) SPACING BETWEEN SIGNS, BETWEEN LAST SIGN AND FLAGGER, BEGINNING OF TAPER OR SIGNED CONDITION.

SPACING MAY BE ADJUSTED AS NECESSARY TO MEET FIELD CONDITIONS.

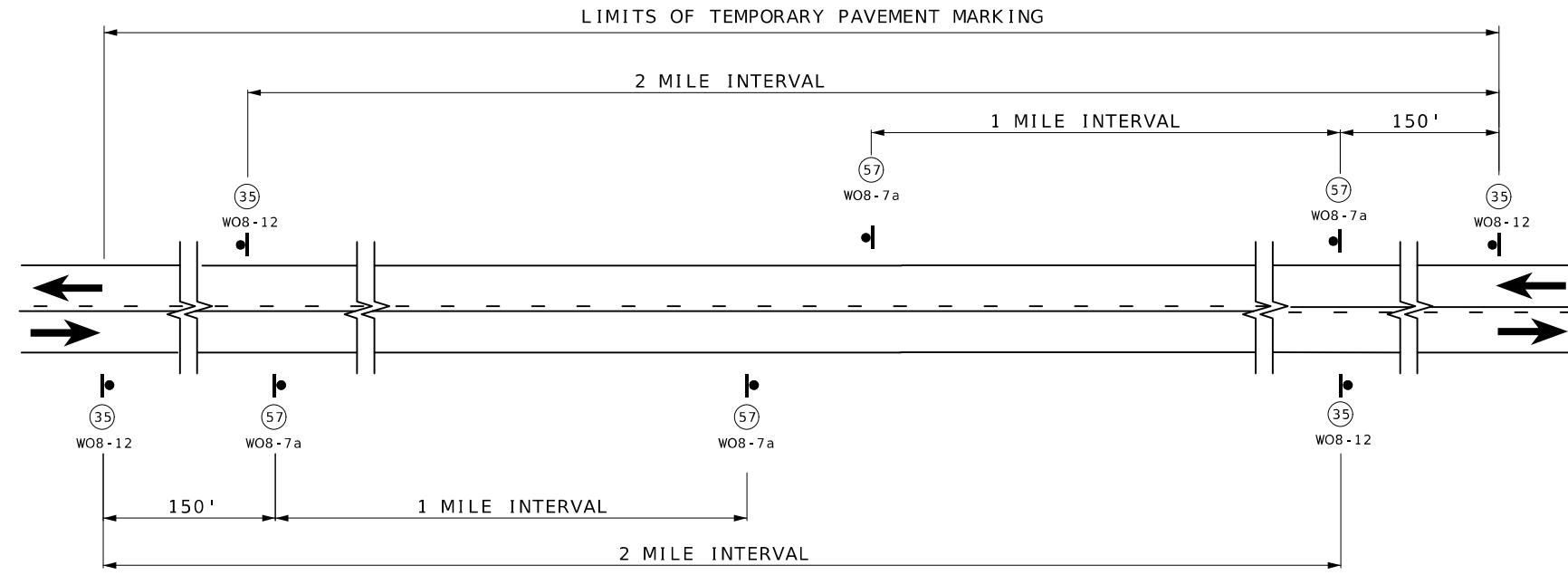

SIGN SPACING AND TEMPORARY STRIPING FOR MAINLINE

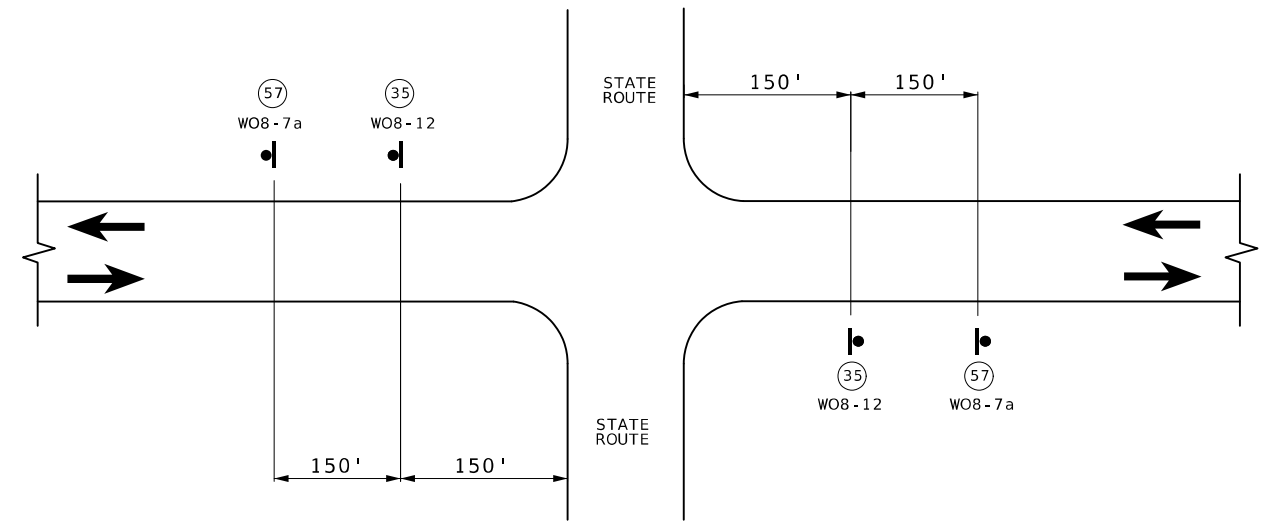

SIGN SPACING AT STATE ROUTE INTERSECTIONS
SHOWING TEMPORARY STRIPING FOR MAINLINE



NOTES:

SIGN 35 AND TEMPORARY RAISED PAVEMENT MARKING (SEE STANDARD PLAN 620.10) INSTALLED WHERE CENTERLINE STRIPING HAS BEEN COVERED OR REMOVED. SIGNS ARE TO REMAIN IN PLACE UNTIL THE PERMANENT CENTERLINE PAVEMENT MARKINGS ARE IN PLACE. SIGNS SHALL BE COVERED OR REMOVED WHEN PAVEMENT CENTERLINE MARKING HAS BEEN INSTALLED.

SIGN 35 IS PLACED AT APPROXIMATELY TWO-MILE INTERVALS AND AT STATE ROUTE JUNCTIONS. WHEN THE INSTALLATION AT A JUNCTION IS WITHIN ONE-EIGHTH MILE OF THE NORMAL MAINLINE SIGN 35, THE LATTER MAY BE ELIMINATED.

ALL SIGNS SHALL BE POST MOUNTED AND IN ACCORDANCE WITH STANDARD PLAN 616.10 AND 903.03.

NOT TO SCALE

TRAFFIC CONTROL
SHEET 4 OF 5

STATE OF MISSOURI

PATRICK J. HAKE

NUMBER

PE-2010000826

PROFESSIONAL ENGINEER

DATE PREPARED

6/2/2025

ROUTE

135

STATE

MO

DISTRICT

CD

SHEET NO.

8

COUNTY

COOPER

JOB NO.

JCD0192

CONTRACT ID.

PROJECT NO.

BRIDGE NO.

DESCRIPTION

DATE

MISSOURI HIGHWAYS AND TRANSPORTATION COMMISSION

105 WEST CAPITOL

JEFFERSON CITY, MO 65102

1-888-ASK-MODOT (1-888-275-6636)

