

DESIGN DESIGNATION

A.A.D.T. - 2024 = 1,177  
V = 55 M.P.H.

FUNCTIONAL CLASSIFICATION- MAJOR COLLECTOR  
MINOR ROADWAY

NO RIGHT OF WAY

CONVENTIONAL SYMBOLS  
(USED IN PLANS)

	EXISTING	NEW
BUILDINGS AND STRUCTURES		
GUARD RAIL		
GUARD CABLE		
CONCRETE RIGHT-OF-WAY MARKER		
STEEL RIGHT-OF-WAY MARKER		
LOCATION SURVEY MARKER		
UTILITIES		
FIBER OPTICS	-FO-	-FO-
OVERHEAD CABLE TV	-OTV-	-OTV-
UNDERGROUND CABLE TV	-UTV-	-UTV-
OVERHEAD TELEPHONE	-OT-	-OT-
UNDERGROUND TELEPHONE	-UT-	-UT-
OVERHEAD POWER	-OE-	-OE-
UNDERGROUND POWER	-UE-	-UE-
SANITARY SEWER	-S-	-S-
STORM SEWER	-SS-	-SS-
GAS	-G-	-G-
WATER	-W-	-W-
MANHOLE		
FIRE HYDRANT		
WATER VALVE		
WATER METER		
DROP INLET		
DITCH BLOCK		
GROUND MOUNTED SIGN		
LIGHT POLE		
H-FRAME POWER POLE		
TELEPHONE PEDESTAL		
FENCE		
CHAIN LINK	-V-	-V-
WOVEN WIRE	-X-	-X-
GATE POST		
BENCHMARK		

NOTE: DASHED OR OPEN SYMBOLS INDICATE  
EXISTING FEATURES

MISSOURI HIGHWAYS AND TRANSPORTATION COMMISSION  
PLANS FOR PROPOSED  
STATE HIGHWAY  
GASCONADE/PHELPS COUNTY

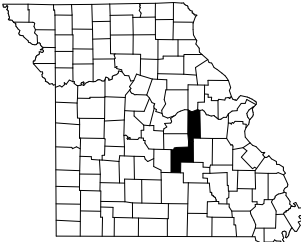

KEY MAP  
LOCATION OF  
GASCONADE & PHELPS COUNTIES

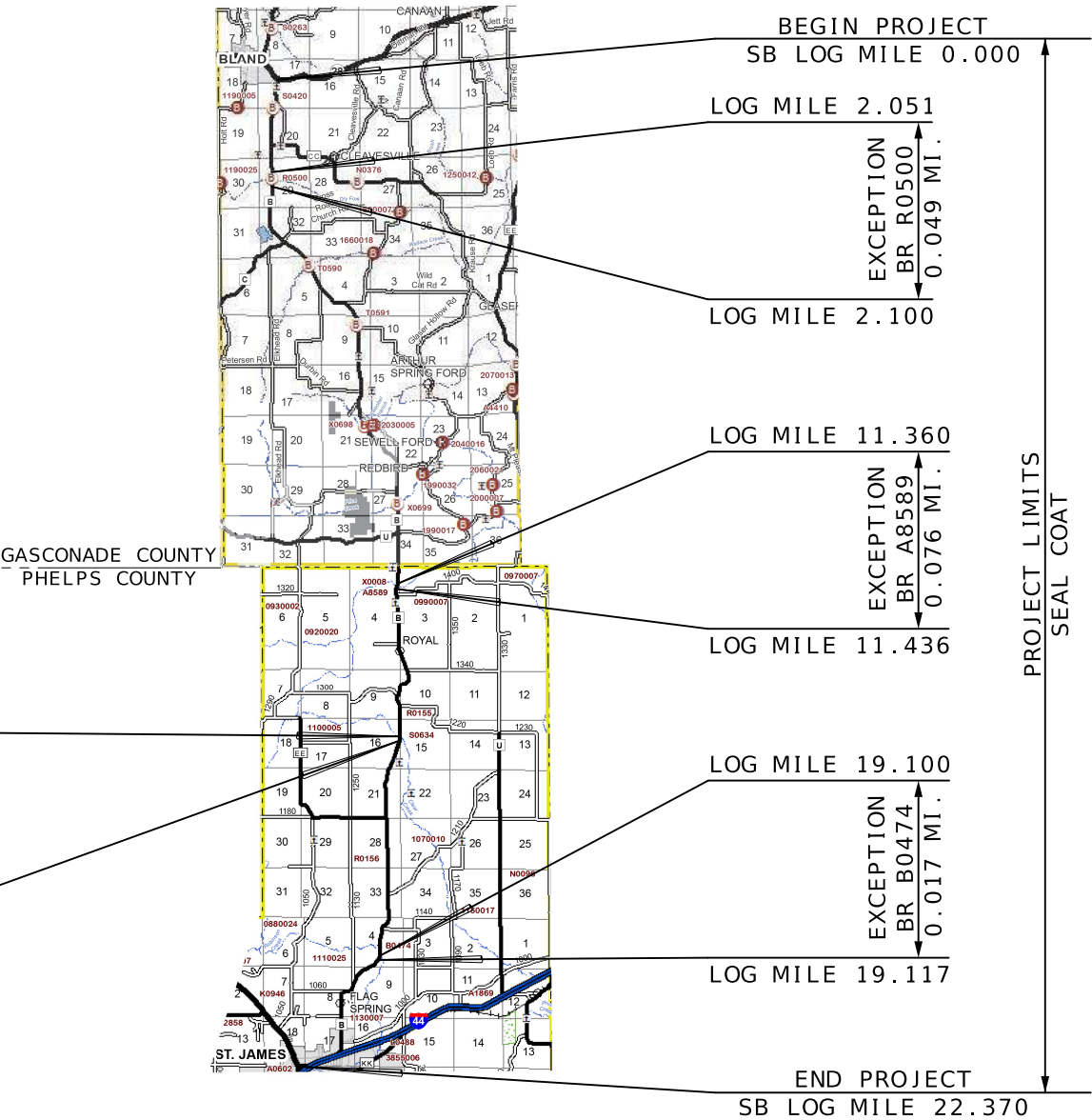

NOT TO SCALE

THE EXISTENCE AND APPROXIMATE LOCATION OF UTILITY FACILITIES KNOWN TO EXIST, AS SHOWN ON THE PLANS, ARE BASED ON THE BEST INFORMATION AVAILABLE TO THE COMMISSION AT THIS TIME. THIS INFORMATION IS PROVIDED BY THE COMMISSION "AS-IS" AND THE COMMISSION EXPRESSLY DISCLAIMS ANY REPRESENTATION OR WARRANTY AS TO THE COMPLETENESS, ACCURACY, OR SUITABILITY OF THE INFORMATION FOR ANY USE. RELIANCE UPON THIS INFORMATION IS DONE AT THE RISK AND PERIL OF THE USER, AND THE COMMISSION SHALL NOT BE LIABLE FOR ANY DAMAGES THAT MAY ARISE FROM ANY ERROR IN THE INFORMATION. IT IS, THEREFORE, THE RESPONSIBILITY OF THE CONTRACTOR TO VERIFY THE EXISTENCE, LOCATION AND STATUS OF ANY FACILITY. SUCH VERIFICATION INCLUDES DIRECT CONTACT WITH THE LISTED UTILITIES.

INDEX OF SHEETS

DESCRIPTION	SHEET NUMBER
TITLE SHEET .....	1
TYPICAL SECTIONS (TS) (2 SHEETS)---	2
QUANTITIES (QU) (3 SHEETS)-----	3
SPECIAL SHEETS (SS)-----	4-5
TRAFFIC CONTROL SHEETS (TC)-----	6-10
BRIDGE DRAWINGS (B)	
X06992 .....	1

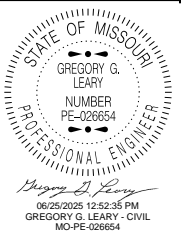

DATE PREPARED 6/10/2025	
ROUTE B	STATE MO
DISTRICT CD	SHEET NO. 1
COUNTY GASCONADE/PHELPS	
JOB NO. JCD0153	
CONTRACT ID.	
PROJECT NO.	
BRIDGE NO.	

DESCRIPTION	DATE

LENGTH OF PROJECT

BEGINNING OF PROJECT	SB L.M.	0.000
END OF PROJECT	SB L.M.	22.370
APPARENT LENGTH		22.370 MILES
EQUATIONS AND EXCEPTIONS:		
	BR. R0500 -	0.049 MILES
	BR. A8589 -	0.076 MILES
	BR. A9012 -	0.032 MILES
	BR. B0474 -	0.017 MILES
TOTAL EXCEPTIONS - 0.174 MILES		

TOTAL CORRECTIONS	0.174 MILES
NET LENGTH OF PROJECT	117,194.88 FEET
STATE LENGTH	22.196 MILES

FOR INFORMATION ONLY ESTIMATED DISTURBED ACRES	0 ACRES
---	---------

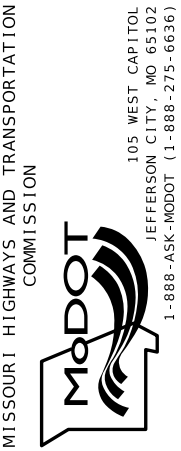



BINDER APPLICATION RATE	0.28 GAL/YD <sup>2</sup>
-------------------------	--------------------------

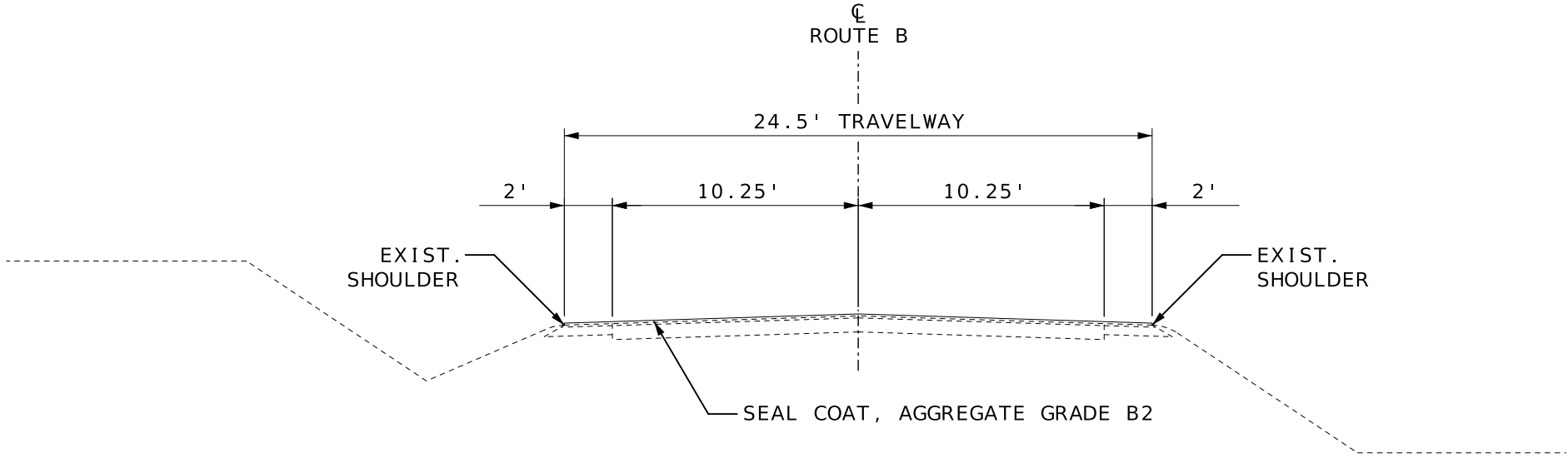

ROUTE B  
PROPOSED TYPICAL SECTION  
LOG MILE 0.000 TO LOG MILE 11.140  
LOG MILE 11.616 TO LOG MILE 21.303

EXCEPTIONS:  
BRIDGE R0500 LOG MILE 2.051 - 2.100  
BRIDGE A9012 LOG MILE 14.589 - 14.621  
BRIDGE B0474 LOG MILE 19.100 - 19.117

GASCONADE/PHELPS CO. LINE LOG MILE 10.996

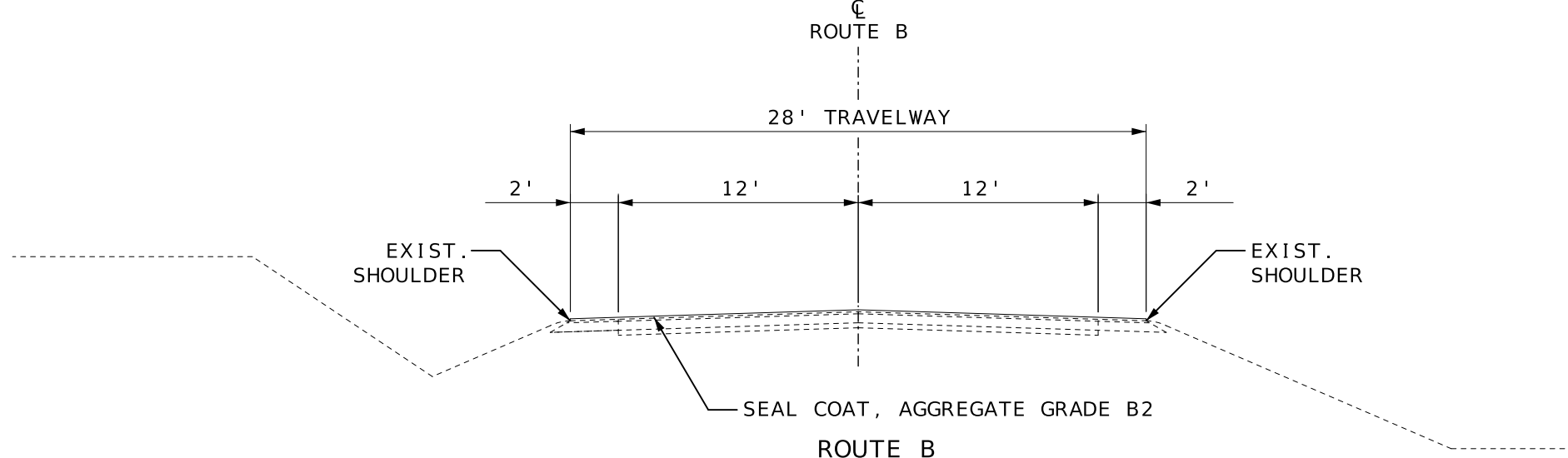

ROUTE B  
PROPOSED TYPICAL SECTION  
LOG MILE 11.140 TO LOG MILE 11.616  
EXCEPTIONS:  
BRIDGE A8589 LOG MILE 11.360 - 11.436

TYPICAL SECTIONS  
ROUTE B  
SHEET 1 OF 2

STATE OF MISSOURI

GREGORY G. LEARY

NUMBER PE-026654

PROFESSIONAL ENGINEER

06/25/2025 12:54:58 PM

GREGORY G. LEARY - CIVIL

MO-PE-026654

DATE PREPARED

6/10/2025

ROUTE	STATE
B	MO
DISTRICT	SHEET NO.
CD	2

COUNTY

GASCONADE / PHELPS

JOB NO.

JCD0153

CONTRACT ID.

####

PROJECT NO.

####

BRIDGE NO.

####

DESCRIPTION						
DATE						

MISSOURI HIGHWAYS AND TRANSPORTATION COMMISSION

105 WEST CAPITOL

JEFFERSON CITY, MO 65102

1-888-ASK-MODOT (1-888-273-6636)

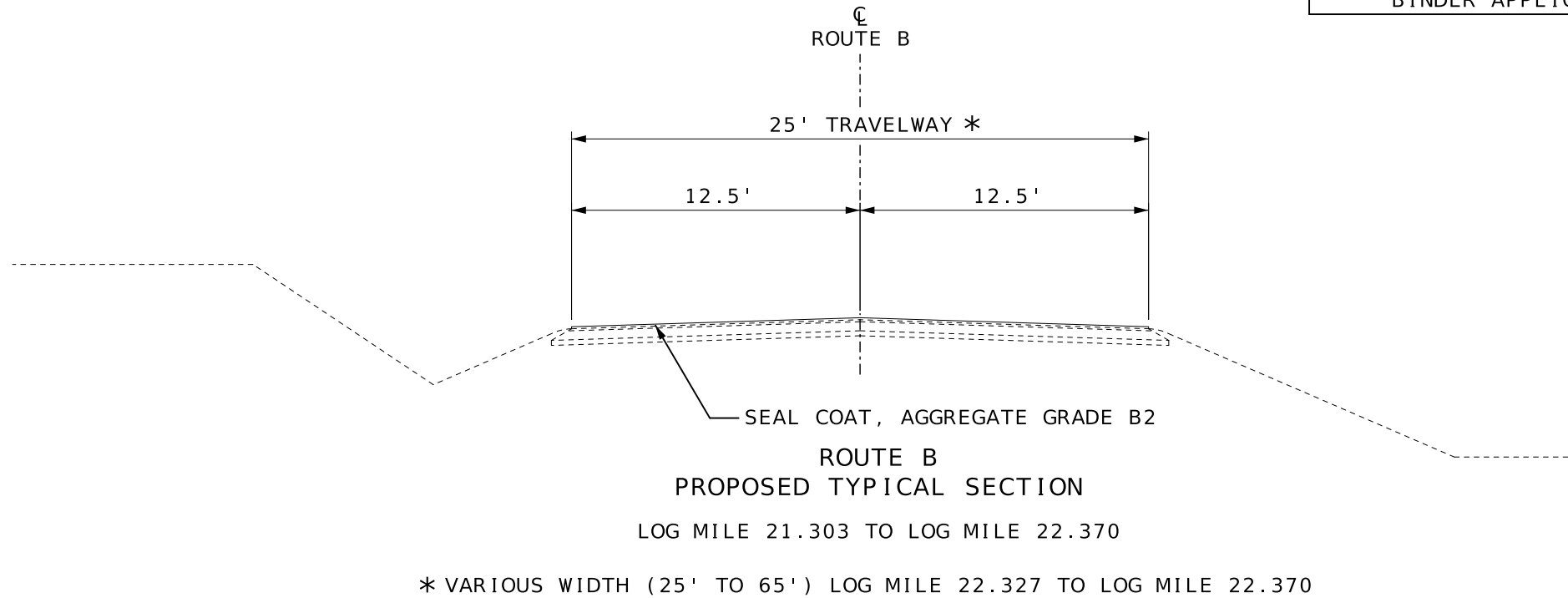

BINDER APPLICATION RATE	0.28 GAL/YD <sup>2</sup>
-------------------------	--------------------------

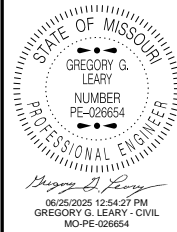

DATE PREPARED 6/10/2025	
ROUTE B	STATE MO
DISTRICT CD	SHEET NO. 2
COUNTY GASCONADE / PHELPS	
JOB NO. JCD0153	
CONTRACT ID. ####	
PROJECT NO. ####	
BRIDGE NO. ####	

DESCRIPTION	DATE

MISSOURI HIGHWAYS AND TRANSPORTATION  
COMMISSION

105 WEST CAPITOL  
JEFFERSON CITY, MO 65102  
1-888-ASK-MODOT (1-888-275-6636)

BITUMINOUS PAVEMENT SEAL COAT, GRADE B2									
LOG MI	LOG MI	LOCATION	LENGTH MI	LENGTH FT	AVG WIDTH FT	AREA SF	MODIFIED SEAL COAT AGGREGATE, GRADE B2 SY	EMULS. ASPHALT GAL (0.28 GAL/SY)	REMARKS
0.000	0.048	ROUTE B	0.048	253.44	VAR.	9,205.20	1,022.80	286.38	ROUTE 28 INTERSECTION
0.048	2.051	ROUTE B	2.003	10,575.84	24.5	259,108.08	28,789.79	8,061.14	TO BRIDGE R0500
2.100	11.140	ROUTE B	9.040	47,731.20	24.5	1,169,414.40	129,934.93	36,381.78	FROM BRIDGE R0500 TO WIDTH CHANGE
11.140	11.360	ROUTE B	0.220	1,161.60	28	32,524.80	3,613.87	1,011.88	TO BRIDGE A8589
11.436	11.616	ROUTE B	0.180	950.40	28	26,611.20	2,956.80	827.90	FROM BRIDGE A8589 TO WIDTH CHANGE
11.616	14.589	ROUTE B	2.973	15,697.44	24.5	384,587.28	42,731.92	11,964.94	TO BRIDGE A9012
14.621	19.100	ROUTE B	4.479	23,649.12	24.5	579,403.44	64,378.16	18,025.88	FROM BRIDGE A9012 TO BRIDGE B0474
19.117	21.303	ROUTE B	2.186	11,542.08	24.5	282,780.96	31,420.11	8,797.63	FROM BRIDGE B0474 TO END SHOULDERING
21.303	22.327	ROUTE B	1.024	5,406.72	25	135,168.00	15,018.67	4,205.23	
22.327	22.370	ROUTE B	0.043	227.04	VAR.	9,097.20	1,010.80	283.02	ROUTE 68 INTERSECTION
1.399	1.419	ROUTE B			VAR.	2,342.70	260.30	72.88	RTE. CC INTERSECTION
3.461	3.487	ROUTE B			VAR.	3,759.30	417.70	116.96	RTE. C INTERSECTION
10.317	10.337	ROUTE B			VAR.	3,593.70	399.30	111.80	RTE. U INTERSECTION
16.288	16.308	ROUTE B			VAR.	2,677.50	297.50	83.30	RTE. EE INTERSECTION
TOTALS							322,252.65	90,230.72	
USE							322,253	90,231	

TEMPORARY TRAFFIC CONTROL						
SIGN	SIZE IN.	AREA SQ.FT.	QTY EACH	TOTAL AREA SQ.FT.	SIGN NUM.	DESCRIPTION
CONSTRUCTION SIGNS						
GO20-1	60X24	10.00	2	20	1	ROAD WORK NEXT 22 MILES
WO20-1	48X48	16.00	11	176	2	ROAD WORK AHEAD
WO20-4	48X48	16.00	13	208	7	ONE LANE ROAD AHEAD
WO20-7a	48X48	16.00	11	176	8	FLAGGER (SYMBOL, WITH FLAGS)
GO20-2	48X24	8.00	2	16	26	END ROAD WORK
WO8-12	48X48	16.00	24	384	35	NO CENTER LINE
GO20-4	36X18	4.50	1	4.5	53	PILOT CAR FOLLOW ME
WO8-7a	36X36	9.00	46	414	57	FRESH OIL LOOSE GRAVEL
GO20-4a	42X30	8.75	1	8.75	58	PILOT CAR IN USE WAIT & FOLLOW
GO20-4a	18X12	1.50	6	9	58	PILOT CAR IN USE WAIT & FOLLOW
CONST-8	48X36	12.00	2	24	59	WORK ZONE NO PHONE ZONE
GO22-1	21X15	2.19	4	8.76		WET PAINT (ARROW PIVOTS)
CONSTRUCTION SIGNS TOTAL				1449		
ADDITIONAL TRAFFIC CONTROL ITEMS						
		616-10.25		320	CHANNELIZERS (TRIM-LINE)	
		619-1098A		2 *	CHANGEABLE MESSAGE SIGN WITHOUT COMMUNICATION INTERFACE	
					CONTRACTOR FURNISHED, CONTRACTOR RETAINED	
TEMPORARY TRAFFIC CONTROL TOTAL				1 LUMP SUM		

\* NOT INCLUDED IN LUMP SUM TRAFFIC CONTROL

NOTE: ALL TRAFFIC CONTROL ITEMS ARE INCLUDED IN PAY ITEM 616-99.01, LUMP SUM TEMPORARY TRAFFIC CONTROL, UNLESS OTHERWISE NOTED IN THE PLANS. THE QUANTITIES SHOWN ARE ONLY AN ESTIMATE AND ARE SUBJECT TO CHANGE BASED UPON FIELD CONDITIONS AND CONTRACTOR'S OPERATIONS.

NO DIRECT PAY WILL BE MADE FOR RELOCATION OF CONSTRUCTION SIGNS OR DEVICES.

MOBILIZATION
1 LUMP SUM

STATE OF MISSOURI

GREGORY G. LEARY

NUMBER  
PE-026654

PROFESSIONAL ENGINEER

DATE PREPARED

6/10/2025

ROUTE

B

STATE

MO

DISTRICT

CD

SHEET NO.

3

COUNTY

GASCONADE / PHELPS

JOB NO.

JCD0153

CONTRACT ID.

PROJECT NO.

BRIDGE NO.

DESCRIPTION

DATE

MISSOURI HIGHWAYS AND TRANSPORTATION COMMISSION

105 WEST CAPITOL  
JEFFERSON CITY, MO 65102  
1-888-ASK-MODOT (1-888-275-6636)

PAVEMENT MARKING										
CLASS 1 MARKING PAINT (18-MIL , TYPE P BEADS)						THERMOPLASTIC PAVEMENT MARKING				
LOG MILE	TO LOG MILE	LOCATION	4" SOLID WHITE FT.	4" SOLID YELLOW FT.	4" INT. YELLOW FT.	LEFT TURN ARROW EA.	12 IN WHITE YIELD LINE TRIANGLES EA.	24" SOLID YELLOW FT.	24" SOLID WHITE FT.	REMARKS
0.000	3.459	RT RTE. B	18263.5							RT EDGE LINE
3.481	10.316	RT RTE. B	36088.8							RT EDGE LINE
10.333	16.288	RT RTE. B	31442.4							RT EDGE LINE
16.308	22.315	RT RTE. B	31717.0							RT EDGE LINE
22.350	22.359	RT RTE. B	47.5							RT - LT TURN LANE LINE
0.045	1.400	LT RTE. B	7154.4							LT EDGE LINE
1.418	10.316	LT RTE. B	46981.4							LT EDGE LINE
10.327	22.315	LT RTE. B	63296.6							LT EDGE LINE
0.017	0.036	RTE. B		200.6	200.6					DOUBLE YELLOW CENTER STRIPES
0.017	0.036	LT RTE. B		100.3	100.3					LT EDGE LINE
0.017	0.036	LT RTE. B						36.0		4 - YELLOW HASH MARKS (MATCH EXISTING
0.036		RT LANE RTE. B					4			PLACE AT EXISTING LOCATION
0.052		LT RTE. B		170.0						DOUBLE YELLOW AROUND CURVE TO RTE. 28
0.052	0.875	RTE. B		8690.9						DOUBLE YELLOW CENTER STRIPE
0.875	1.071	RTE. B		1034.9	258.7					SOLID YELLOW AND INTERMITTENT YELLOW CENTER STRIPE
1.071	1.195	RTE. B			163.7					INTERMITTENT YELLOW CENTER STRIPE
1.195	1.278	RTE. B		438.2	109.6					SOLID YELLOW AND INTERMITTENT YELLOW CENTER STRIPE
1.278	1.379	RTE. B			133.3					INTERMITTENT YELLOW CENTER STRIPE
1.379	1.539	RTE. B		844.8	211.2					SOLID YELLOW AND INTERMITTENT YELLOW CENTER STRIPE
1.539	2.079	RTE. B			712.8					INTERMITTENT YELLOW CENTER STRIPE
2.079	2.253	RTE. B		918.7	229.7					SOLID YELLOW AND INTERMITTENT YELLOW CENTER STRIPE
2.253	3.992	RTE. B		18363.8						DOUBLE YELLOW CENTER STRIPE
3.992	4.151	RTE. B		839.5	209.9					SOLID YELLOW AND INTERMITTENT YELLOW CENTER STRIPE
4.151	4.191	RTE. B			52.8					INTERMITTENT YELLOW CENTER STRIPE
4.191	4.352	RTE. B		850.1	212.5					SOLID YELLOW AND INTERMITTENT YELLOW CENTER STRIPE
4.352	5.707	RTE. B		14308.8						DOUBLE YELLOW CENTER STRIPE
5.707	5.794	RTE. B		459.4	114.8					SOLID YELLOW AND INTERMITTENT YELLOW CENTER STRIPE
5.794	5.856	RTE. B		654.7						DOUBLE YELLOW CENTER STRIPE
5.856	5.962	RTE. B		559.7	139.9					SOLID YELLOW AND INTERMITTENT YELLOW CENTER STRIPE
5.962	6.098	RTE. B		1436.2						DOUBLE YELLOW CENTER STRIPE
6.098	6.245	RTE. B		776.2	194.0					SOLID YELLOW AND INTERMITTENT YELLOW CENTER STRIPE
6.245	6.305	RTE. B			79.2					INTERMITTENT YELLOW CENTER STRIPE
6.305	6.360	RTE. B		290.4	72.6					SOLID YELLOW AND INTERMITTENT YELLOW CENTER STRIPE
6.360	7.735	RTE. B		14520.0						DOUBLE YELLOW CENTER STRIPE
7.735	7.861	RTE. B		665.3	166.3					SOLID YELLOW AND INTERMITTENT YELLOW CENTER STRIPE
7.861	9.095	RTE. B		13031.0						DOUBLE YELLOW CENTER STRIPE
9.095	9.190	RTE. B		501.6	125.4					SOLID YELLOW AND INTERMITTENT YELLOW CENTER STRIPE
9.190	9.218	RTE. B		295.7						DOUBLE YELLOW CENTER STRIPE
9.218	9.506	RTE. B		1520.6	380.2					SOLID YELLOW AND INTERMITTENT YELLOW CENTER STRIPE
9.506	9.552	RTE. B			60.7					INTERMITTENT YELLOW CENTER STRIPE
9.552	9.677	RTE. B		660.0	165.0					SOLID YELLOW AND INTERMITTENT YELLOW CENTER STRIPE
9.677	9.724	RTE. B			62.0					INTERMITTENT YELLOW CENTER STRIPE
9.724	10.046	RTE. B		1700.2	425.0					SOLID YELLOW AND INTERMITTENT YELLOW CENTER STRIPE
10.046	10.357	RTE. B			410.5					INTERMITTENT YELLOW CENTER STRIPE
10.357	10.938	RTE. B		3067.7	766.9					SOLID YELLOW AND INTERMITTENT YELLOW CENTER STRIPE
10.938	11.855	RTE. B		9683.5						DOUBLE YELLOW CENTER STRIPE
11.855	11.955	RTE. B		528.0	132.0					SOLID YELLOW AND INTERMITTENT YELLOW CENTER STRIPE
11.955	12.015	RTE. B		633.6						DOUBLE YELLOW CENTER STRIPE
12.015	12.095	RTE. B		422.4	105.6					SOLID YELLOW AND INTERMITTENT YELLOW CENTER STRIPE
12.095	12.335	RTE. B		2534.4						DOUBLE YELLOW CENTER STRIPE
12.335	12.415	RTE. B		422.4	105.6					SOLID YELLOW AND INTERMITTENT YELLOW CENTER STRIPE
12.415	12.495	RTE. B		844.8						DOUBLE YELLOW CENTER STRIPE
12.495	12.575	RTE. B		422.4	105.6					SOLID YELLOW AND INTERMITTENT YELLOW CENTER STRIPE
12.575	14.037	RTE. B		15438.7						DOUBLE YELLOW CENTER STRIPE
14.037	14.237	LT RTE. B		1056.0	264.0					SOLID YELLOW AND INTERMITTENT YELLOW CENTER STRIPE
14.327	14.400	RTE. B			96.4					INTERMITTENT YELLOW CENTER STRIPE
14.400	14.579	RTE. B		945.1	236.3					SOLID YELLOW AND INTERMITTENT YELLOW CENTER STRIPE
14.579	15.279	RTE. B		7392.0						DOUBLE YELLOW CENTER STRIPE
15.279	15.378	RTE. B		522.7	130.7					SOLID YELLOW AND INTERMITTENT YELLOW CENTER STRIPE
		SUB-TOTAL 1	234,991.6	127,745.3	6,933.8	0	4	36	0	

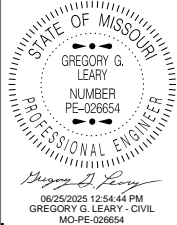

DATE PREPARED 6/10/2025	
ROUTE B	STATE MO
DISTRICT CD	SHEET NO. 3
COUNTY GASCONADE / PHELPS	
JOB NO. JCD0153	
CONTRACT ID.	

PROJECT NO.
BRIDGE NO.

DESCRIPTION	DATE								

MISSOURI HIGHWAYS AND TRANSPORTATION  
COMMISSION



105 WEST CAPITOL  
JEFFERSON CITY, MO 65102  
1-888-ASK-MODOT (1-888-275-6636)









ROUTE 68

SB L.M. 22.370

SB L.M. 22.327

ROUTE B

1,010.8 SY

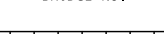
[illegible]

JEFFERSON CITY, MO 65102  
1 888 ASK MODOT (1 888 275 6636)



SPECIAL SHEET  
SHEET 2 OF 2







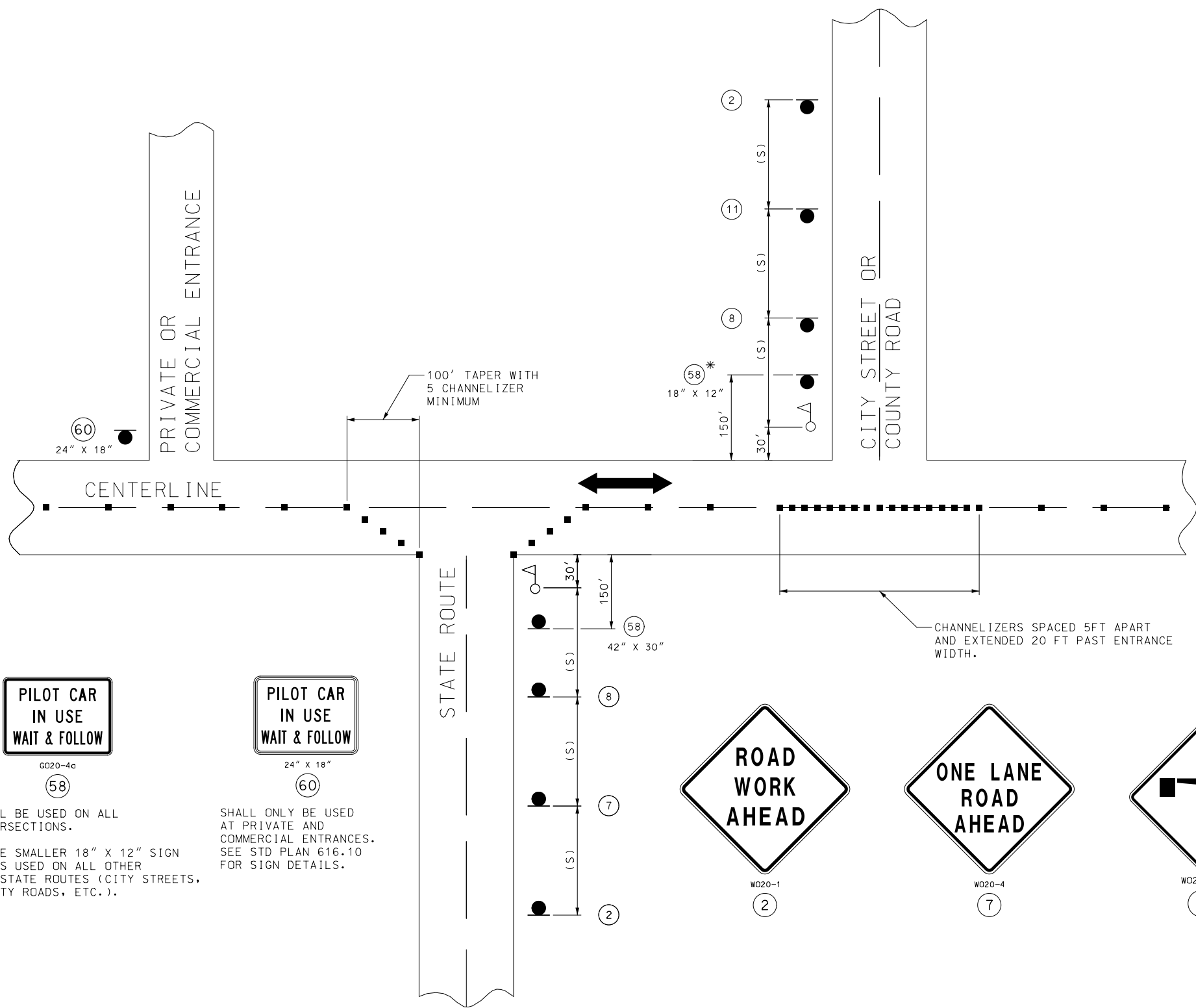

SPEED	SIGN SPACING (FT) (1)	CHANNELIZER SPACING (FT)
PERMANENT POSTED (MPH)	NON-DIVIDED HIGHWAYS (S)	BUFFER/ WORK AREA (TYP.)
0-35	200	40
40-45	350	80
50-55	500	80
60-70	1000	120

(1) SPACING BETWEEN SIGNS, BETWEEN LAST SIGN AND FLAGGER, BEGINNING OF TAPER OR SIGNED CONDITION.

SPACING MAY BE ADJUSTED AS NECESSARY TO MEET FIELD CONDITIONS.

NOTES:  
WARNING SIGNS SHALL BE ERECTED AT EACH INTERSECTION WITH ANOTHER STATE HIGHWAY WITHIN THE WORK ZONE.

ADDITIONAL WARNING SIGNS SHALL BE ERECTED AT OTHER INTERSECTIONS WITHIN THE WORK ZONE, AS DIRECTED BY THE ENGINEER.

■ - CHANNELIZERS (AS SPECIFIED)

△ - FLAGGER

NOT TO SCALE

STATE OF MISSOURI

GREGORY G. LEARY

NUMBER  
PE-008654

PROFESSIONAL ENGINEER

*Gregory G. Leary*

06/25/2025 12:52:02 PM

GREGORY G. LEARY - CIVIL

MO-PE-008654

DATE PREPARED

6/10/2025

ROUTE

B

STATE

MO

DISTRICT

CD

SHEET NO.

8

COUNTY

GASCONADE / PHELPS

JOB NO.

JCD0153

CONTRACT ID.

PROJECT NO.

BRIDGE NO.

DESCRIPTION

DATE

MISSOURI HIGHWAYS AND TRANSPORTATION COMMISSION

105 WEST CAPITOL

JEFFERSON CITY, MO 65102

1-888-ASK-MODOT (1-888-275-6636)

TRAFFIC CONTROL

SHEET 3 OF 5



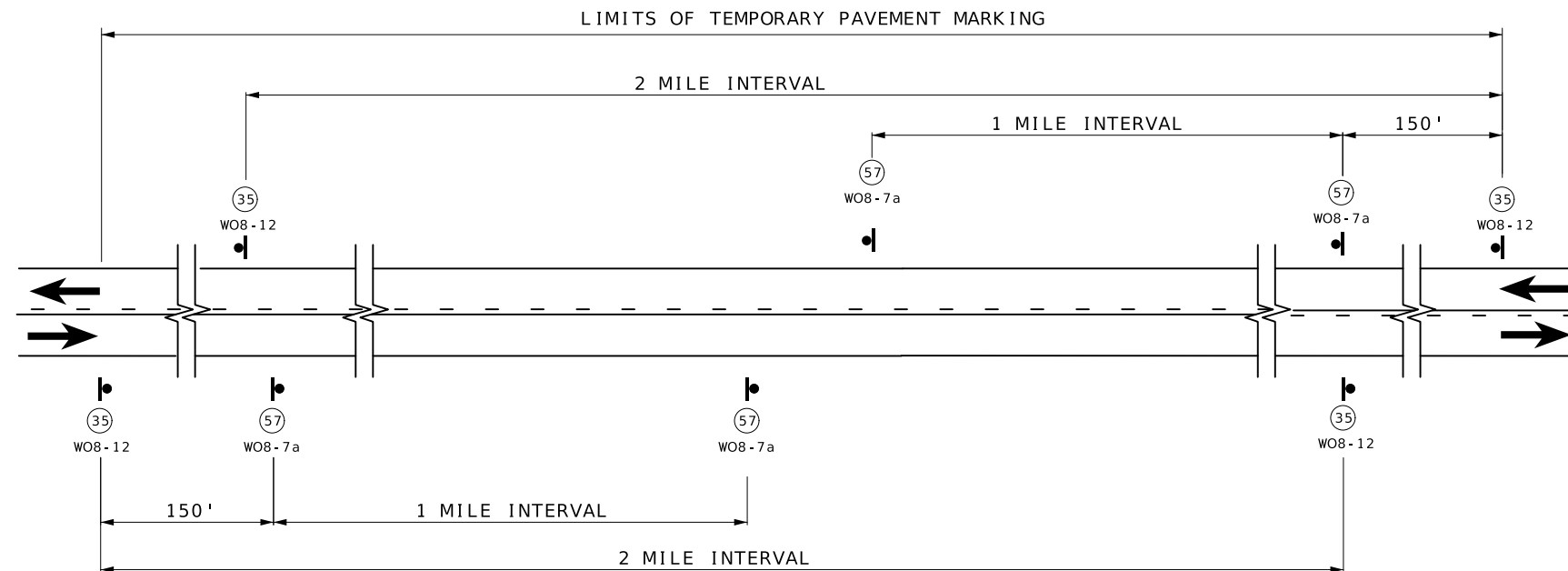

## SIGN SPACING AND TEMPORARY STRIPING FOR MAINLINE

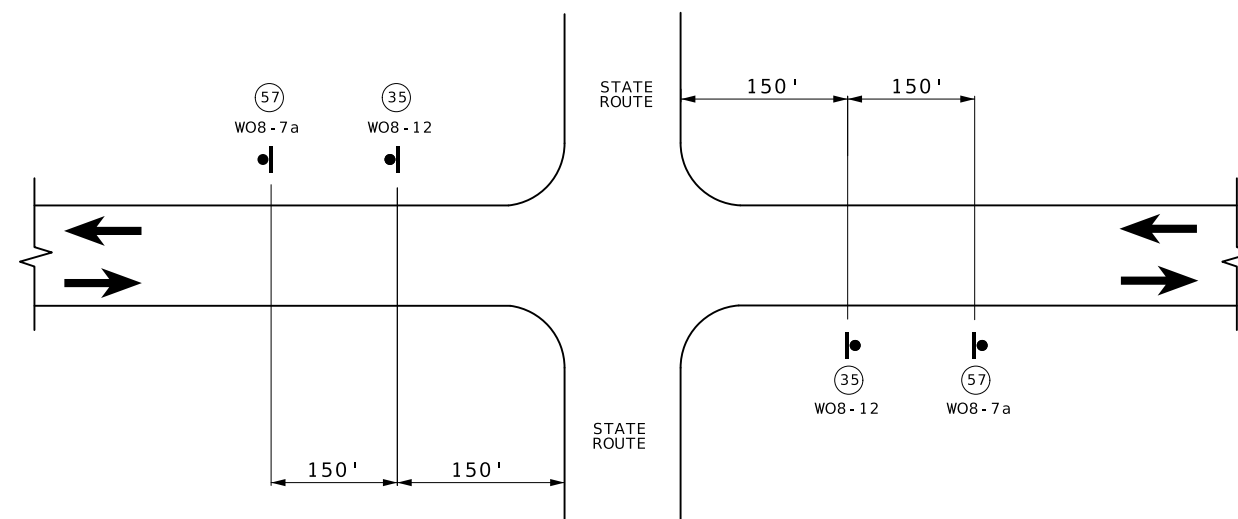

## SIGN SPACING AT STATE ROUTE INTERSECTIONS SHOWING TEMPORARY STRIPING FOR MAINLINE



NOTES :

SIGN (35) AND TEMPORARY RAISED PAVEMENT MARKING (SEE STANDARD PLAN 620.10) INSTALLED WHERE CENTERLINE STRIPING HAS BEEN COVERED OR REMOVED. SIGNS ARE TO REMAIN IN PLACE UNTIL THE PERMANENT CENTERLINE PAVEMENT MARKINGS ARE IN PLACE. SIGNS SHALL BE COVERED OR REMOVED WHEN PAVEMENT CENTERLINE MARKING HAS BEEN INSTALLED.

SIGN (35) IS PLACED AT APPROXIMATELY TWO-MILE INTERVALS AND AT STATE ROUTE JUNCTIONS. WHEN THE INSTALLATION AT A JUNCTION IS WITHIN ONE-EIGHTH MILE OF THE NORMAL MAINLINE SIGN (35), THE LATTER MAY BE ELIMINATED.

ALL SIGNS SHALL BE POST MOUNTED AND IN ACCORDANCE WITH  
STANDARD PLAN 616.10 AND 903.03.

NOT TO SCALE

TRAFFIC CONTROL  
SHEET 4 OF 5

SHEET 4 OF 5

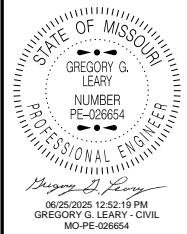

DATE PREPARED

6 / 10 / 2025

ROUTE	STATE
-------	-------

B	MO
---	----

DISTRICT	SHEET NO.
CD	2

CD	9
----	---

COUNTY

GASCONADE / PHELPS  
JOB NO.

JOB NO.  
LCD0153

JCD0153
CONTRACT ID.

CONTRACT ID.

[illegible]

MISSOURI HIGHWAYS AND TRANSPORTATION  
COMMISSION

105 WEST CAPITOL  
JEFFERSON CITY, MO 65102  
1-888-ASK-MODOT (1-888-275-6636)

MISSOURI HIGHWAYS AND TRANSPORTATION  
COMMISSION

105 WEST CAPITOL  
JEFFERSON CITY, MO 65102  
1-888-ASK-MODOT (1-888-275-6636)

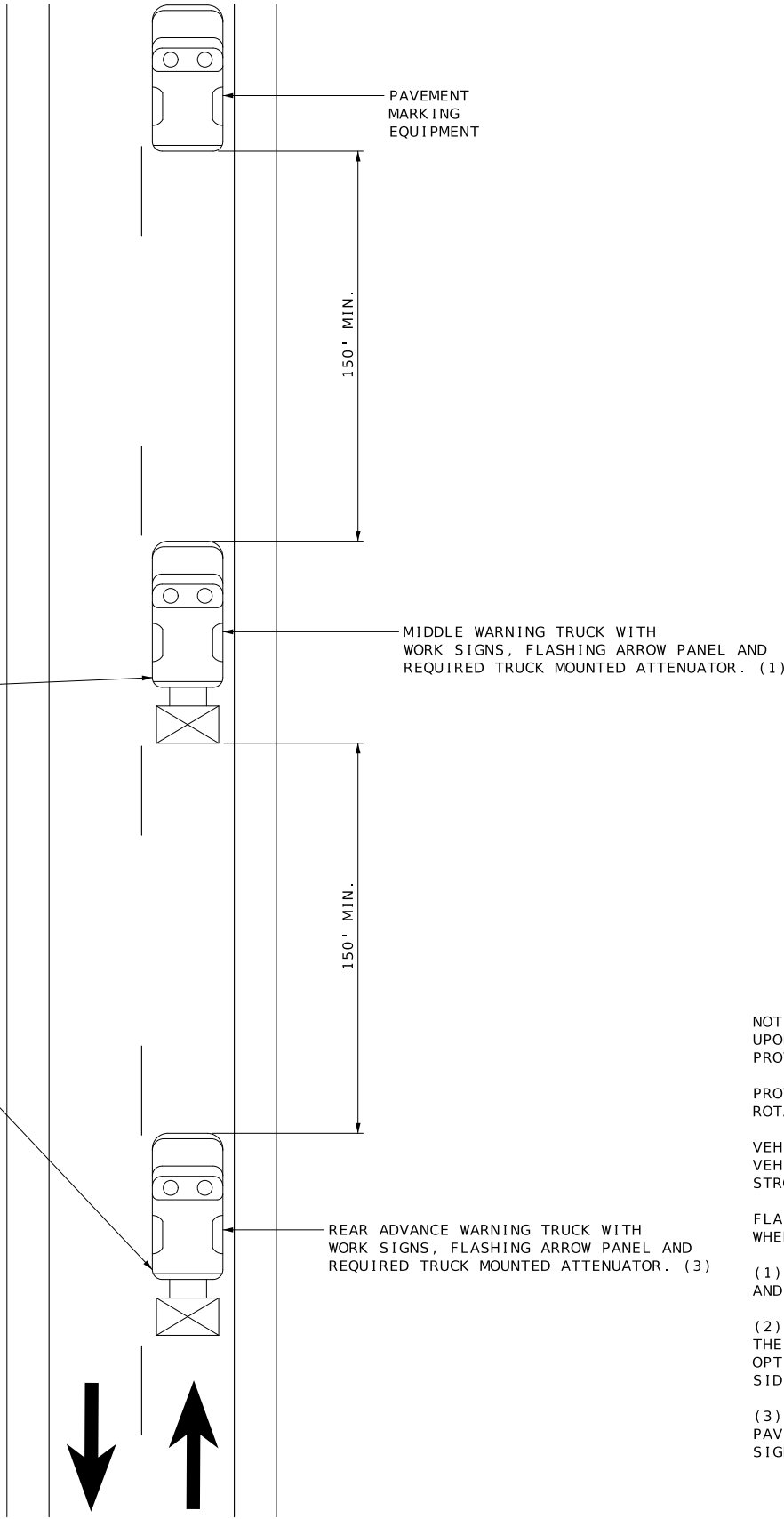
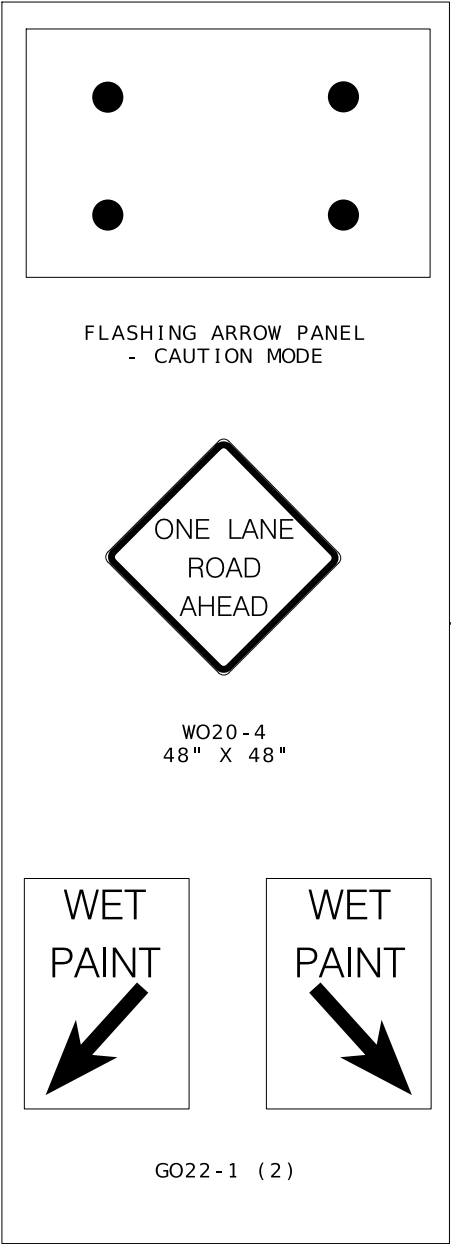

NOTES:  
UPON APPROVAL OF THE ENGINEER, THE CONTRACTOR MAY PROVIDE ADDITIONAL PROTECTIVE TRUCK EQUIPPED WITH PROPER WARNING DEVICES.

PROTECTIVE TRUCK AND WORK VEHICLES SHALL DISPLAY HIGH-INTENSITY ROTATING, FLASHING, OSCILLATING, OR STROBE LIGHTS.

VEHICLE HAZARD WARNING SIGNALS SHALL NOT BE USED INSTEAD OF THE VEHICLE'S HIGH-INTENSITY ROTATING, FLASHING, OSCILLATING, OR STROBE LIGHTS.

FLASHING ARROW PANELS SHALL BE INCIDENTAL TO TRUCK MOUNTED ATTENUATORS, WHEREVER USED. NO ADDITIONAL PAYMENT WILL BE MADE.

(1) TRUCK IS OPTIONAL ON TWO-LANE UNDIVIDED HIGHWAYS IF SIGNING AND ARROW BOARD IS MOUNTED ON THE PAVEMENT MARKING EQUIPMENT.

(2) WET PAINT SIGNS ARE INSTALLED TO INDICATE THE SIDE IN WHICH THE PAVEMENT MARKING MATERIAL IS BEING APPLIED. AT THE CONTRACTOR'S OPTION, A FRONT FACING WET PAINT SIGN MAY BE INSTALLED ON THE LEFT SIDE OF THE PAVEMENT MARKING EQUIPMENT.

(3) REAR ADVANCE WARNING TRUCK IS POSITIONED AT THE NO TRACK POINT OF THE PAVEMENT MARKING MATERIAL, OR VERTICAL OR HORIZONTAL CURVES THAT RESTRICT SIGHT DISTANCE, OR SPACING SHOWN.

STATE OF MISSOURI

GREGORY G. LEARY

NUMBER  
PE-026654

PROFESSIONAL ENGINEER

*Gregory G. Leary*

06/25/2025 12:53:25 PM

GREGORY G. LEARY - CIVIL

MO-PE-026654

DATE PREPARED

6/10/2025

ROUTE

B

STATE

MO

DISTRICT

CD

SHEET NO.

10

COUNTY

GASCONADE / PHELPS

JOB NO.

JCD0153

CONTRACT ID.

PROJECT NO.

BRIDGE NO.

DESCRIPTION

DATE

MISSOURI HIGHWAYS AND TRANSPORTATION COMMISSION

105 WEST CAPITOL

JEFFERSON CITY, MO 65102

1-888-ASK-MODOT (1-888-275-6636)

U.I.P. AND REHABILITATE EXISTING (35'-45'-35') CONTINUOUS I-BEAM SPANS (SKEW: 15° R.A.)

SEC/SUR 27 TWP 40 N RGE 6 W

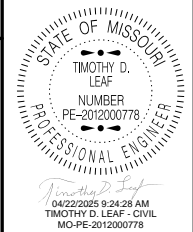

DATE PREPARED 4/22/2025	
ROUTE B	STATE MO
DISTRICT BR	SHEET NO. 1
COUNTY GASCONADE	
JOB NO. JCD0153	
CONTRACT ID.	
PROJECT NO.	
BRIDGE NO. X06992	

DESCRIPTION	DATE

MISSOURI HIGHWAYS AND TRANSPORTATION COMMISSION



105 WEST CAPITOL  
JEFFERSON CITY, MO 65102  
1-888-ASK-MODOT (1-888-275-6636)

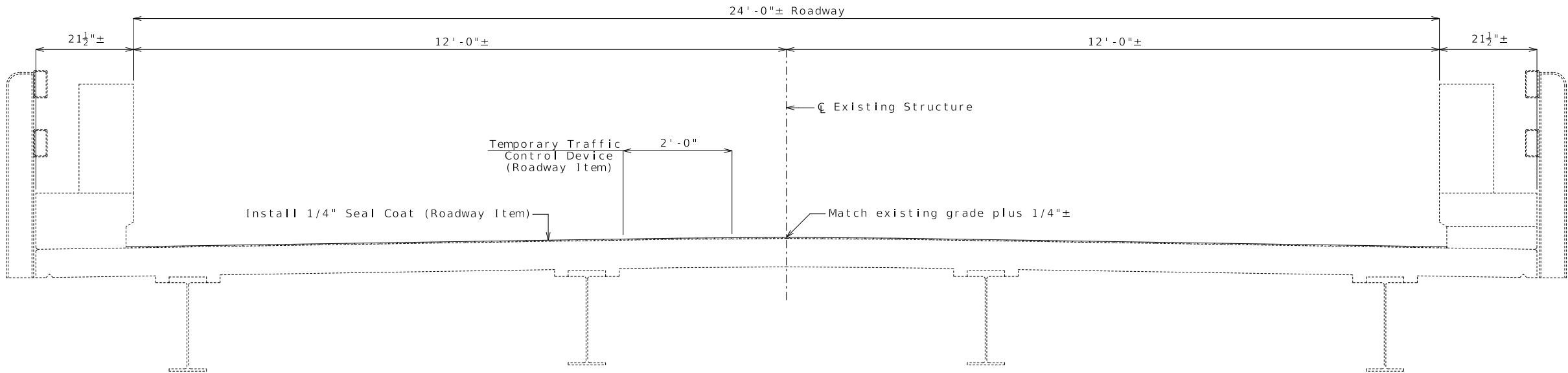

TYPICAL SECTION THRU EXISTING SLAB  
Diaphragms not shown for clarity.

General Notes:

- Design Specifications:
- 2002 AASHTO LFD (17th Ed.) Standard Specifications
  - Bridge Deck Rating = 5
- Design Loading:
- H15-44 (1 Lane)
- Miscellaneous:
- Roadway surfacing adjacent to bridge ends shall match new bridge surface (Roadway Item).
  - Outline of existing work is indicated by light dashed lines. Heavy lines indicate new work.
  - The contractor shall exercise care to ensure spillage over joint edges is prevented and that a neat line is obtained along any terminating edge of the seal coat.
- Traffic Handling:
- Traffic to be maintained on structure during construction. See roadway plans for traffic control.

REPAIRS TO BRIDGE: ROUTE B  
OVER PRICE CREEK

ROUTE B FROM ROUTE C TO ROUTE U  
ABOUT 6.3 MILES SOUTH OF ROUTE C  
BEGINNING STATION 520+08.50