

NOTES:

SIGN 1 AND 26 ARE ONLY USED ON PROJECT LENGTHS 2 MILES OR GREATER.

PROVIDE SIGNS IN EACH DIRECTION ON TWO-WAY HIGHWAY.

DISTANCE MAY BE ADJUSTED ACCORDING TO FIELD CONDITIONS.

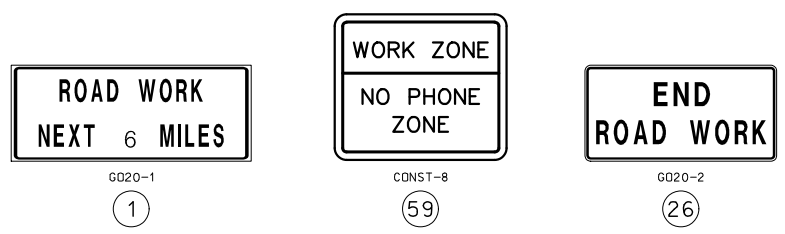

STATE OF MISSOURI

GREGORY G. LEARY

NUMBER

PE-026654

PROFESSIONAL ENGINEER

06/25/2025 12:18:01 PM

GREGORY G. LEARY - CIVIL

MO-PE-026654

DATE PREPARED

6/25/2025

ROUTE	STATE
UU	MO
DISTRICT	SHEET NO.
CD	4

COUNTY

CALLAWAY

JOB NO.

JCD0143

CONTRACT ID.

PROJECT NO.

BRIDGE NO.

DESCRIPTION	DATE

MISSOURI HIGHWAYS AND TRANSPORTATION COMMISSION

MODOT

105 WEST CAPITOL

JEFFERSON CITY, MO 65102

1-888-ASK-MODOT (1-888-275-6636)

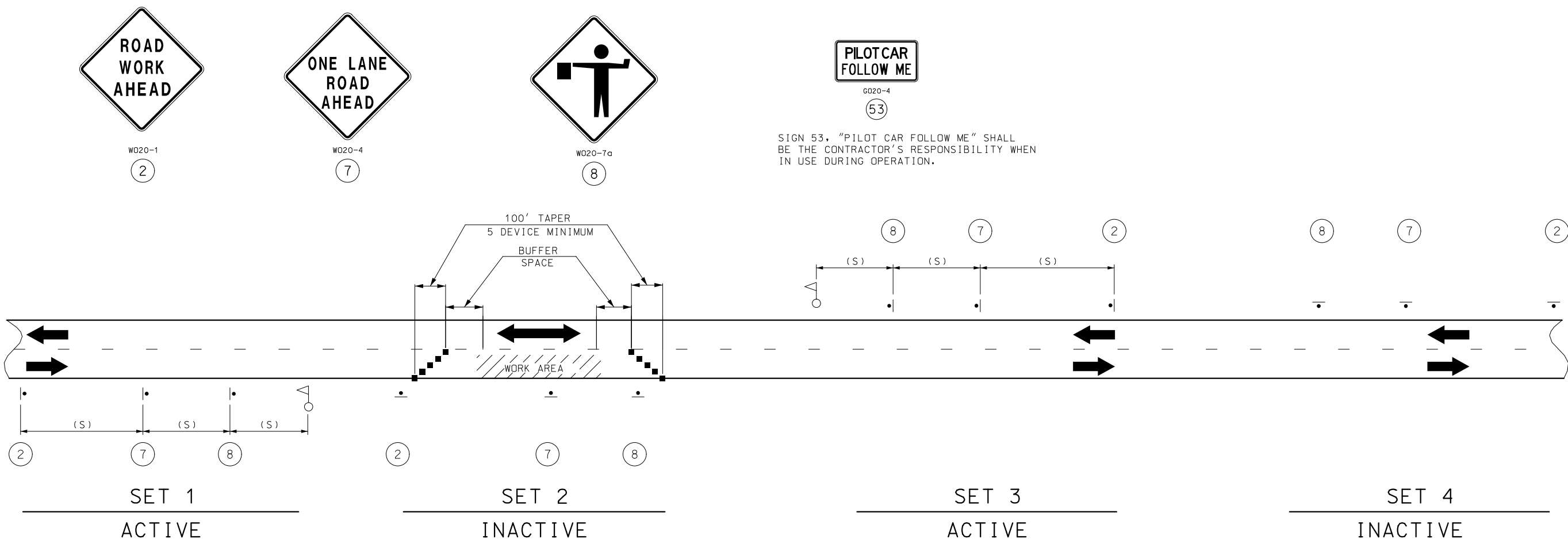

NOTES:

THIS PLAN IS FOR DAYLIGHT FLAGGING OPERATIONS ONLY. WHEN NIGHT WORK IS REQUIRED, OR OTHERWISE ALLOWED BY THE ENGINEER, WORK ZONE LIGHTING SHALL BE PROVIDED IN ACCORDANCE WITH SEC 616.5.2.

CHANNELIZING DEVICES LOCATED DOWNSTREAM OF THE ONE-LANE, TWO-WAY TAPER ARE OPTIONAL. THESE DEVICES SHOULD BE ELIMINATED WHEN THEIR USE WILL REDUCE THE USABLE LANE WIDTH, INCLUDING ANY ACCEPTABLE SHOULDERS, TO LESS THAN 10' OR WILL SIGNIFICANTLY AFFECT THE RESURFACING OPERATION.

SIGN SETS 1 AND 3 ARE ACTIVE AND (I.E., SIGNS FACE ONCOMING TRAFFIC) SIGN SETS 2 AND 4 ARE INACTIVE (I.E., SIGNS DO NOT FACE EITHER DIRECTION OF TRAFFIC) WHEN THE RESURFACING OPERATION IS LOCATED BETWEEN SIGN SETS 1 AND 3.

WHEN SIGN SETS 2 AND 4 ARE ACTIVE, SIGN SETS 1 AND 3 BECOME INACTIVE AND ARE ADVANCED TO BECOME SETS 2 AND 4 WITH SIGN LEGENDS TURNED AWAY FROM BOTH DIRECTIONS OF TRAFFIC. WHEN THE RESURFACING OPERATION ADVANCES TO BETWEEN SIGN SETS 2 AND 4, SIGN SETS 2 AND 4 BECOME ACTIVE (I.E., NEW SIGN SETS 1 AND 3) AND SIGN SETS 1 AND 3 ADVANCED IN THE DIRECTION OF THE OPERATION (I.E., NEW SIGN SETS 2 AND 4).

■ - CHANNELIZERS

○ - FLAGGER

SPEED	SIGN SPACING (FT) (1)	BUFFER SPACE
PERMANENT POSTED (MPH)	NON-DIVIDED HIGHWAYS (S)	LENGTH (FT)
0-35	200	250
40-45	350	360
50-55	500	495
60-70	1000	730

(1) SPACING BETWEEN SIGNS, BETWEEN LAST SIGN AND FLAGGER, BEGINNING OF TAPER OR SIGNED CONDITION.

SPACING MAY BE ADJUSTED AS NECESSARY TO MEET FIELD CONDITIONS.

STATE OF MISSOURI

GREGORY G. LEARY

NUMBER
PE-026654

PROFESSIONAL ENGINEER

06/25/2025 12:18:30 PM
GREGORY G. LEARY - CIVIL
MO-PE-026654

DATE PREPARED
6/25/2025

ROUTE
UU

DISTRICT
CD

STATE
MO

SHEET NO.
5

COUNTY
CALLAWAY

JOB NO.
JCD0143

CONTRACT ID.

PROJECT NO.

BRIDGE NO.

DESCRIPTION

DATE

MISSOURI HIGHWAYS AND TRANSPORTATION COMMISSION

105 WEST CAPITOL
JEFFERSON CITY, MO 65102
1-888-ASK-MODOT (1-888-275-6636)

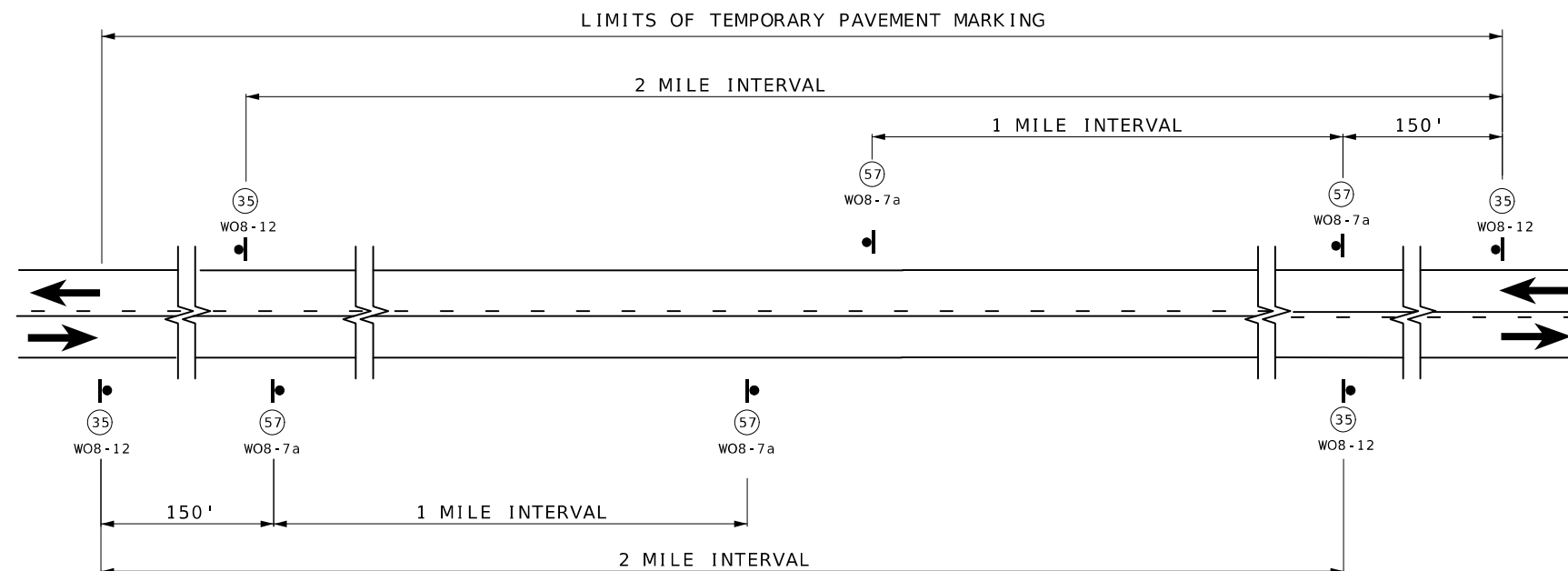

SIGN SPACING AND TEMPORARY STRIPING FOR MAINLINE

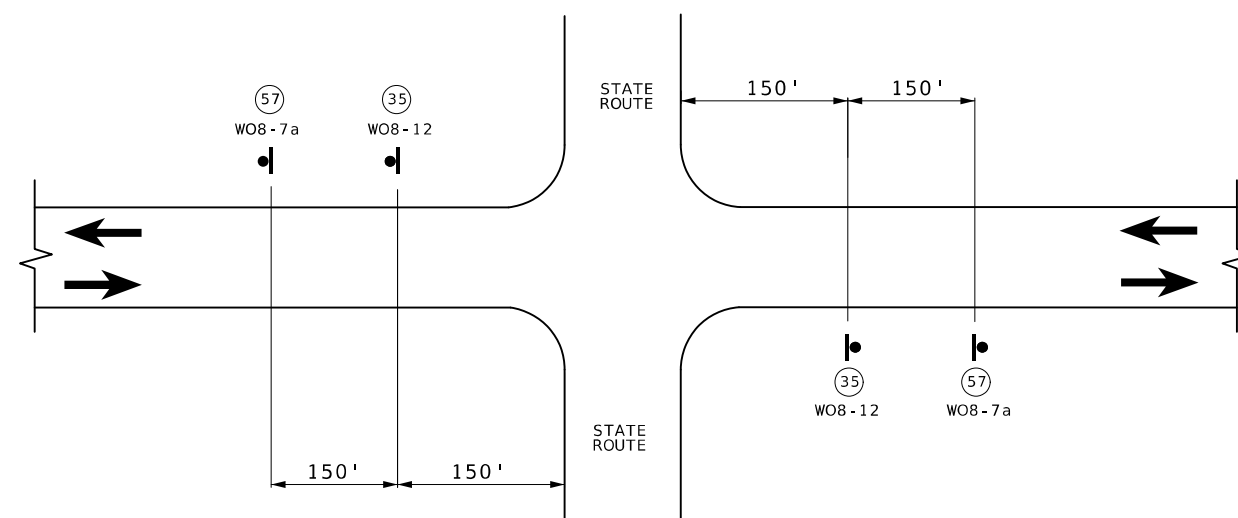

SIGN SPACING AT STATE ROUTE INTERSECTIONS SHOWING TEMPORARY STRIPING FOR MAINLINE



NOTES :

SIGN (35) AND TEMPORARY RAISED PAVEMENT MARKING (SEE STANDARD PLAN 620.10) INSTALLED WHERE CENTERLINE STRIPING HAS BEEN COVERED OR REMOVED. SIGNS ARE TO REMAIN IN PLACE UNTIL THE PERMANENT CENTERLINE PAVEMENT MARKINGS ARE IN PLACE. SIGNS SHALL BE COVERED OR REMOVED WHEN PAVEMENT CENTERLINE MARKING HAS BEEN INSTALLED.

SIGN (35) IS PLACED AT APPROXIMATELY TWO-MILE INTERVALS
AT STATE ROUTE JUNCTIONS. WHEN THE INSTALLATION
AT A JUNCTION IS WITHIN ONE-EIGHTH MILE OF THE NORMAL
MAINLINE SIGN (35), THE LATTER MAY BE ELIMINATED.

ALL SIGNS SHALL BE POST MOUNTED AND IN ACCORDANCE WITH
STANDARD PLAN 616.10 AND 903.03.

NOT TO SCALE

TRAFFIC CONTROL
SHEET 4 OF 5

SHEET 4 OF 5

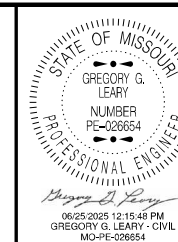

MU-PE-026854

DATE PREPARED

6/25/202

ROUTE	S*
-------	----

UU	M
----	---

DISTRICT	SHE
----------	-----

CD	
1	1
2	2
3	3
4	4
5	5
6	6
7	7
8	8
9	9
10	10
11	11
12	12
13	13
14	14
15	15
16	16
17	17
18	18
19	19
20	20
21	21
22	22
23	23
24	24
25	25
26	26
27	27
28	28
29	29
30	30
31	31
32	32
33	33
34	34
35	35
36	36
37	37
38	38
39	39
40	40
41	41
42	42
43	43
44	44
45	45
46	46
47	47
48	48
49	49
50	50
51	51
52	52
53	53
54	54
55	55
56	56
57	57
58	58
59	59
60	60
61	61
62	62
63	63
64	64
65	65
66	66
67	67
68	68
69	69
70	70
71	71
72	72
73	73
74	74
75	75
76	76
77	77
78	78
79	79
80	80
81	81
82	82
83	83
84	84
85	85
86	86
87	87
88	88
89	89
90	90
91	91
92	92
93	93
94	94
95	95
96	96
97	97
98	98
99	99
100	100

COUNTY

CALLAWA

JOB NO.

JCD0143

CONTRACT ID

[illegible]

PROJECT NO. _____

[illegible]

MISSOURI HIGHWAYS AND TRANSPORTATION
COMMISSION

105 WEST CAPITOL
JEFFERSON CITY, MO 65102

MISSOURI HIGHWAYS AND TRANSPORTATION
COMMISSION

105 WEST CAPITOL
JEFFERSON CITY MO 65102

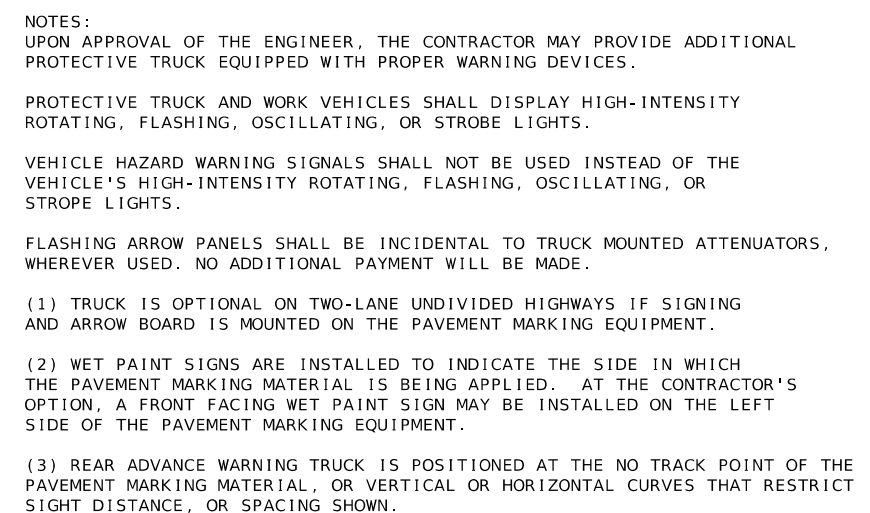
[illegible]

CONSTRUCTION SIGNING						
SIGN NO.	SIGN	SIZE (in.)	AREA (ft.²)	QTY.	TOTAL AREA (ft.²)	DESCRIPTION
① *	GO20-1	60 x 24	10.00	2	20	ROAD WORK NEXT 15 MILES
② **	WO20-1	48 x 48	16.00	9	144	ROAD WORK AHEAD
⑦	WO20-4	48 x 48	16.00	11	176	ONE LANE ROAD AHEAD
⑧	WO20-7a	48 x 48	16.00	9	144	FLAGGER (SYMBOL)
⑪	WO3-4	48 x 48	16.00			BE PREPARED TO STOP
②⑥	GO20-2	48 x 24	8.00	2	16	END ROAD WORK
③⑤	WO8-12	48 x 48	16.00	16	256	NO CENTER LINE
⑤③	GO20-4	36 x 18	4.5	1	4.5	PILOT CAR FOLLOW ME
⑤⑦ ***	WO8-7a	36 x 36	9.00	30	270	FRESH OIL LOOSE GRAVEL
⑤⑧	GO20-4a	42 x 30	8.75			PILOT CAR IN USE WAIT & FOLLOW
⑤⑧	GO20-4a	18 x 12	1.50	5	7.5	PILOT CAR IN USE WAIT & FOLLOW
⑤⑨	CONST-8	48 x 36	12.00	2	24	WORK ZONE NO PHONE ZONE
	GO22-1	21 X 15	2.19	4	8.76	WET PAINT (ARROW PIVOTS)
616-10.05 CONSTRUCTION SIGNS TOTAL					1071	

* IF LESS THAN TWO (2) MILES, DELETE SIGN NO. 1.

** ADDITIONAL SIGN NO. 2 USED AS SHOWN ON TRAFFIC CONTROL SHEET 4 OF 5 AND AS DIRECTED BY THE ENGINEER.

*** FRESH OIL/LOOSE GRAVEL SIGN SHALL BE PLACED AT THE START OF THE PROJECT AND AT ONE MILE INTERVALS. SIGNS SHOULD ALSO BE INSTALLED AFTER THE INTERSECTION OF A STATE ROUTE. ADDITIONAL SIGNS MAY BE INSTALLED AFTER OTHER INTERSECTIONS, AS DIRECTED BY THE ENGINEER.

NOTE:

REFER TO STANDARD PLANS 616.10 AND 903.03 FOR SIGN AND SIGN MOUNTING REQUIREMENTS.

ITEM NO.	QTY.	DESCRIPTION
616-10.25	110	CHANNELIZERS (TRIM-LINE)
616-10.98A	2	CHANGEABLE MESSAGE SIGN

MOBILIZATION
1 LUMP SUM

CLASS 1 PAVEMENT MARKING PAINT (18-MIL, TYPE P BEADS)					
LOG MILE	LOG MILE	LENGTH FT	4" YELLOW LF	4" WHITE LF	REMARKS
0.240	0.560	1689.60	3,379.2	3,379.2	DOUBLE YELLOW
0.560	0.697	723.360	180.8	1,446.7	INT YELLOW
0.697	0.797	528.000	660.0	1,056.0	WB PASSING
0.797	2.088	6816.480	13,633.0	13,633.0	DOUBLE YELLOW
2.088	2.217	681.120	851.4	1,362.2	WB PASSING
2.217	3.705	7856.640	15,713.3	15,713.3	DOUBLE YELLOW
3.705	3.837	696.960	871.2	1,393.9	EB PASSING
3.837	4.559	3812.160	7,624.3	7,624.3	DOUBLE YELLOW
4.559	4.679	633.600	792.0	1,267.2	EB PASSING
4.679	5.785	5839.680	11,679.4	11,679.4	DOUBLE YELLOW
5.785	5.935	792.000	990.0	1,584.0	EB PASSING
5.935	5.970	184.800	369.6	369.6	DOUBLE YELLOW
5.970	6.070	528.000	660.0	1,056.0	WB PASSING
6.070	7.402	7032.960	14,065.9	14,065.9	DOUBLE YELLOW
7.402	7.552	792.000	990.0	1,584.0	EB PASSING
7.552	7.597	237.600	475.2	475.2	DOUBLE YELLOW
7.597	7.704	564.960	706.2	1,129.9	WB PASSING
7.704	7.861	828.960	1,036.2	1,657.9	EB PASSING
7.861	7.881	105.600	211.2	211.2	DOUBLE YELLOW
7.881	8.041	844.800	1,056.0	1,689.6	WB PASSING
8.041	9.498	7692.960	15,385.9	15,385.9	DOUBLE YELLOW
9.498	9.637	733.920	917.4	1,467.8	EB PASSING
9.637	9.698	322.080	644.2	644.2	DOUBLE YELLOW
9.698	9.853	818.400	1,023.0	1,636.8	WB PASSING
9.853	10.359	2671.680	5,343.4	5,343.4	DOUBLE YELLOW
10.359	10.559	1056.000	1,320.0	2,112.0	EB PASSING
10.559	10.703	760.320	190.1	1,520.6	INT YELLOW
10.703	10.901	1045.440	1,306.8	2,090.9	WB PASSING
10.901	11.798	4736.160	9,472.3	9,472.3	DOUBLE YELLOW
11.798	11.897	522.720	653.4	1,045.4	EB PASSING
11.897	12.057	844.800	1,689.6	1,689.6	DOUBLE YELLOW
12.057	12.158	533.280	666.6	1,066.6	EB PASSING
12.158	12.538	2006.400	4,012.8	4,012.8	DOUBLE YELLOW
12.538	12.677	733.920	917.4	1,467.8	EB PASSING
12.677	12.838	850.080	1,062.6	1,700.2	WB PASSING
12.838	15.542	14277.120	28,554.2	28,554.2	DOUBLE YELLOW
		TOTAL	149,104.6	161,589.0	
		USE	149,105	161,589	

NOTE: TEMPORARY AND PERMANENT PAVEMENT MARKING SHALL BE IN ACCORDANCE WITH 620.10.

SEAL COAT						
LOG MILE	LOG MILE	LOCATION	NET LENGTH (MILES)	AVERAGE WIDTH (FEET)	MODIFIED SEAL COAT AGGREGATE, GRADE B2 (S.Y.)	EMULSIFIED ASPHALT, SEAL COAT 0.28 GAL/S.Y. (GALLONS)
0.240	5.720	ROUTE O	5.480	25	80,373.3	22,504.5
5.720	5.830	ROUTE O	0.110	26	1,677.9	469.8
5.830	5.882	ROUTE O	0.052			
5.882	6.132	ROUTE O	0.250	26	3,813.3	1,067.7
6.132	6.578	ROUTE O	0.446	25	6,541.3	1,831.6
6.578	6.929	ROUTE O	0.351	26	5,353.9	1,499.1
6.929	7.383	ROUTE O	0.454	25	6,658.7	1,864.4
7.383	7.867	ROUTE O	0.484	26	7,382.6	2,067.1
7.867	7.927	ROUTE O	0.060			
7.927	8.052	ROUTE O	0.125	26	1,906.7	533.9
8.052	15.545	ROUTE O	7.493	25	109,897.3	30,771.2
15.545	15.557	ROUTE O	0.012	VAR	555.6	155.6
				TOTAL	224,160.6	62,764.9
				USE	224,161	62,765

PREFORMED THERMOPLASTIC PAVEMENT MARKING				
LOG MILE	LOCATION	PAVEMENT MARKING REMOVAL LF	THERMOPLASTIC 24 IN WHITE LF	REMARKS
0.595	ROUTE O	30.00	30.0	5 LONGITUDINAL CROSSWALK BARS - 6 FT WIDTH
	TOTAL	30.0	30.0	
	USE	30	30	

SUMMARY OF QUANTITIES
SHEET 1 OF 1

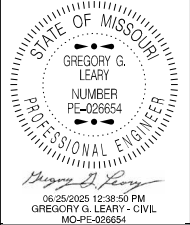

6/25/2025	
ROUTE O	STATE MO
DISTRICT CD	SHEET NO. 3
COUNTY CALLAWAY	
JOB NO. JCD0144	
CONTRACT ID.	

PROJECT NO.
BRIDGE NO.

DESCRIPTION	DATE								

MISSOURI HIGHWAYS AND TRANSPORTATION COMMISSION

105 WEST CAPITOL
JEFFERSON CITY, MO 65102
1-888-ASK-MODOT (1-888-275-6636)

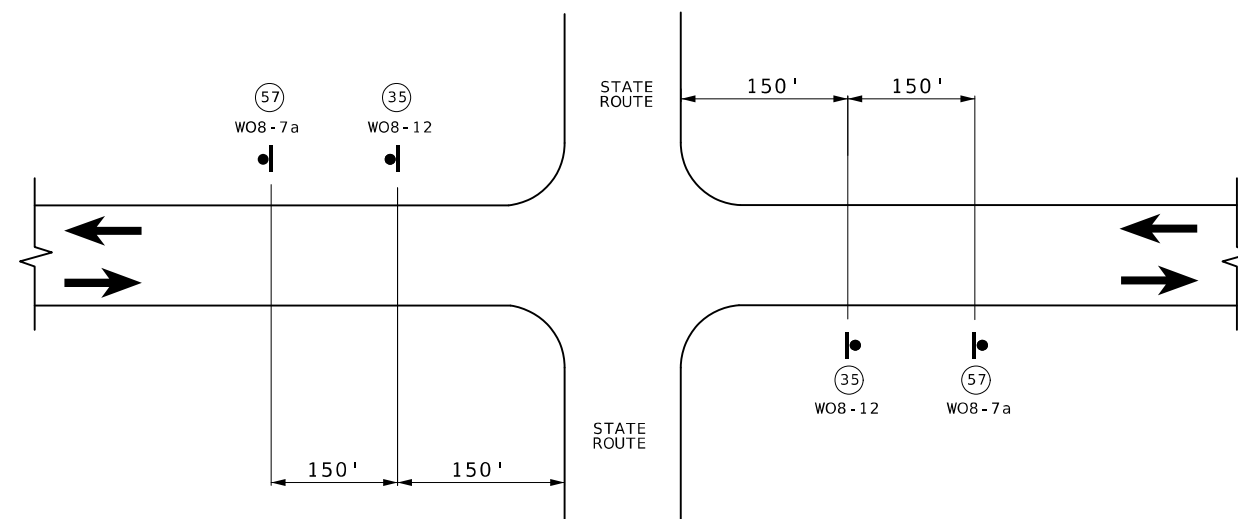
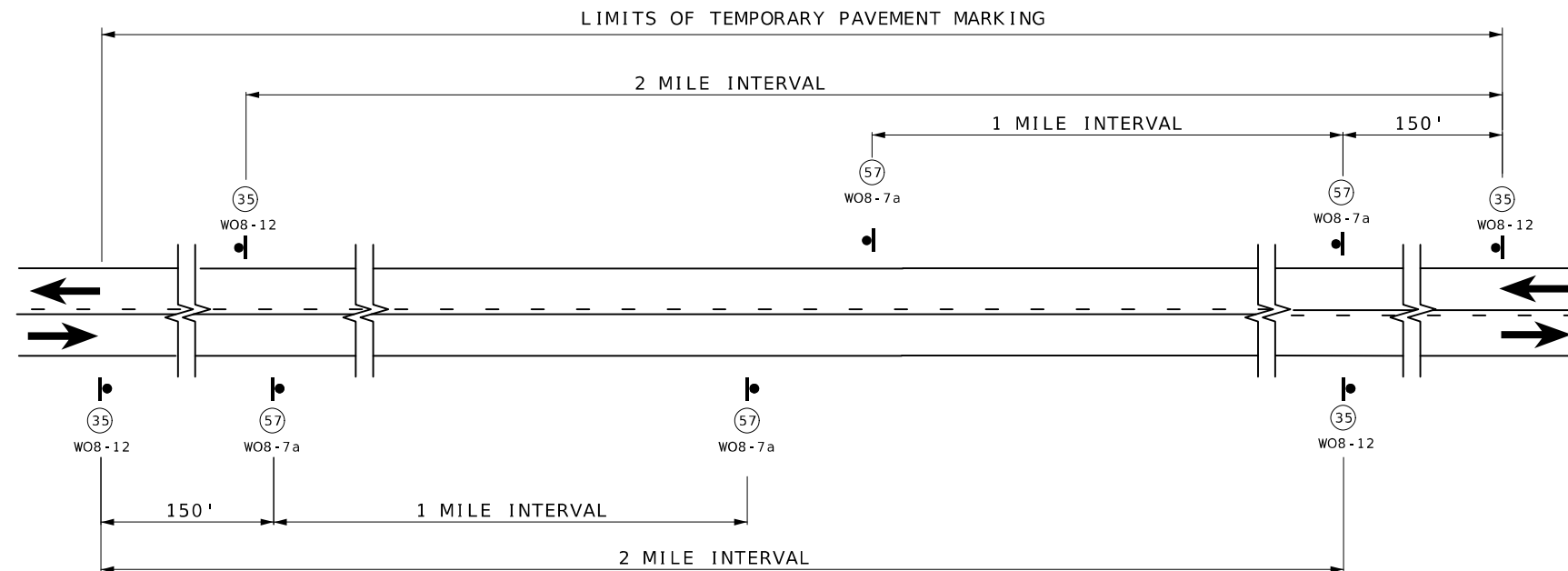

NOTES :

SIGN 35 AND TEMPORARY RAISED PAVEMENT MARKING (SEE STANDARD PLAN 620.10) INSTALLED WHERE CENTERLINE STRIPING HAS BEEN COVERED OR REMOVED. SIGNS ARE TO REMAIN IN PLACE UNTIL THE PERMANENT CENTERLINE PAVEMENT MARKINGS ARE IN PLACE. SIGNS SHALL BE COVERED OR REMOVED WHEN PAVEMENT CENTERLINE MARKING HAS BEEN INSTALLED.

SIGN (35) IS PLACED AT APPROXIMATELY TWO-MILE INTERVALS AND AT STATE ROUTE JUNCTIONS. WHEN THE INSTALLATION AT A JUNCTION IS WITHIN ONE-EIGHTH MILE OF THE NORMAL MAINLINE SIGN (35), THE LATTER MAY BE ELIMINATED.

ALL SIGNS SHALL BE POST MOUNTED AND IN ACCORDANCE WITH
STANDARD PLAN 616.10 AND 903.03.

NOT TO SCALE

TRAFFIC CONTROL
SHEET 4 OF 5

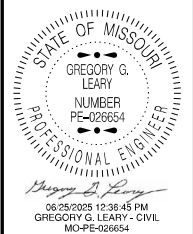

DATE PREPARED

6/25/2025

ROUTE	STATE
-------	-------

O	MO
---	----

DISTRICT	SHEET NO.
----------	-----------

CD	7
----	---

CD	
COUNTY	

CALLAWAY

CALLAWAY
JOB NO.

JCD0144

CONTRACT ID.

CONTRACT ID.

PROJECT NO.

[illegible]MISSOURI HIGHWAYS AND TRANSPORTATION
COMMISSION

105 WEST CAPITOL
JEFFERSON CITY, MO 65102
1-888-ASK-MODOT (1-888-275-6636)

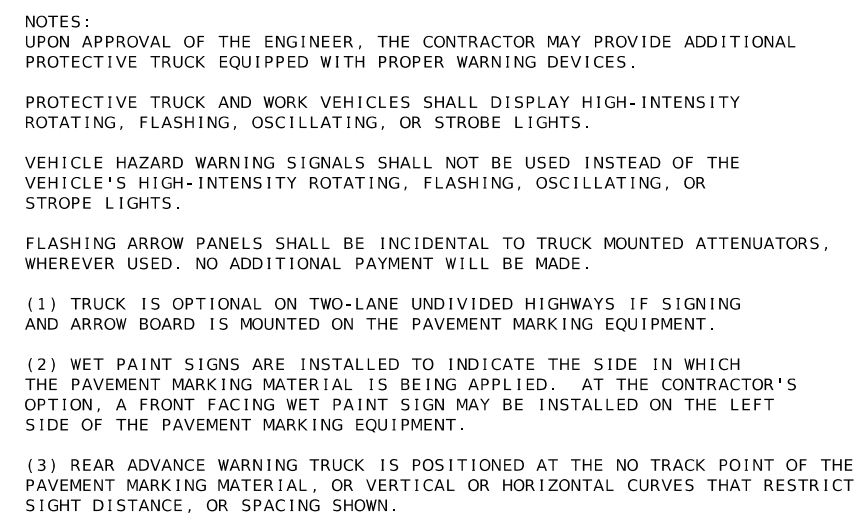

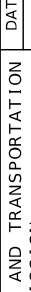
	
DATE PREPARED 6/25/2025	
ROUTE O	STATE MO
DISTRICT CD	SHEET NO. 8
COUNTY CALLAWAY	
JOB NO. JCD0144	
CONTRACT ID.	
PROJECT NO.	
BRIDGE NO.	
DESCRIPTION	DATE
MISSOURI HIGHWAYS AND TRANSPORTATION COMMISSION 	
105 WEST CAPITOL JEFFERSON CITY, MO 65102 1-888-ASK-MODOT (1-888-275-6636)	