

1-70 OR (HWY 54 TO RTE JJ)  
A.A.D.T. - 2024 = 546  
V = 55 M.P.H.

1-70 OR (RTE A/Z TO RTE D)  
A.A.D.T. - 2024 = 640  
V = 55 M.P.H.

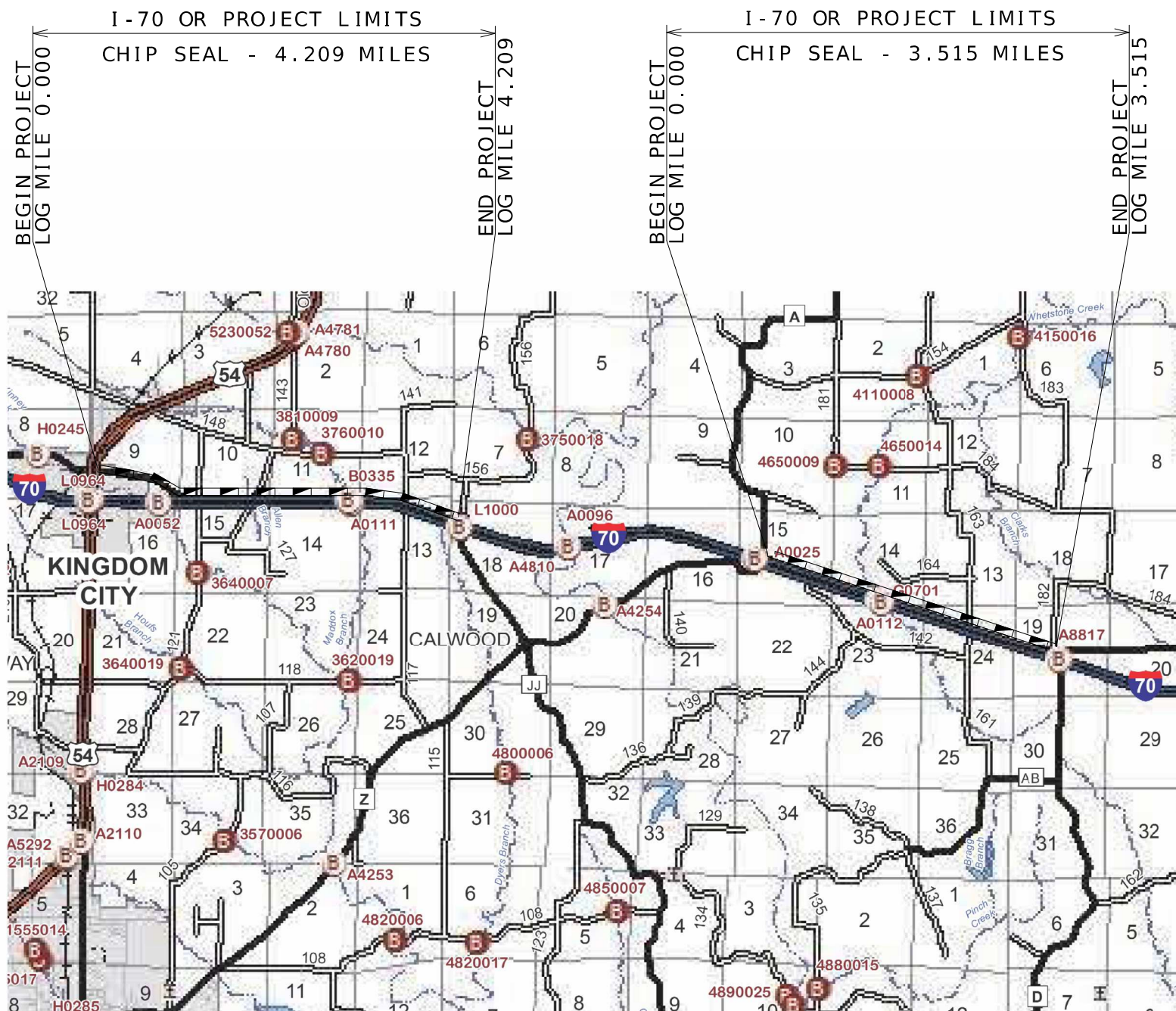

MISSOURI HIGHWAYS AND TRANSPORTATION COMMISSION  
PLANS FOR PROPOSED  
STATE HIGHWAY  
CALLAWAY COUNTY



NOT TO SCALE

THE EXISTENCE AND APPROXIMATE LOCATION OF UTILITY FACILITIES KNOWN TO EXIST, AS SHOWN ON THE PLANS, ARE BASED ON THE BEST INFORMATION AVAILABLE TO THE COMMISSION AT THIS TIME. THIS INFORMATION IS PROVIDED BY THE COMMISSION "AS-IS" AND THE COMMISSION EXPRESSLY DISCLAIMS ANY REPRESENTATION OR WARRANTY AS TO THE COMPLETENESS, ACCURACY, OR SUITABILITY OF THE INFORMATION FOR ANY USE. RELIANCE UPON THIS INFORMATION IS DONE AT THE RISK AND PERIL OF THE USER, AND THE COMMISSION SHALL NOT BE LIABLE FOR ANY DAMAGES THAT MAY ARISE FROM ANY ERROR IN THE INFORMATION. IT IS, THEREFORE, THE RESPONSIBILITY OF THE CONTRACTOR TO VERIFY THE EXISTENCE, LOCATION AND STATUS OF ANY FACILITY. SUCH VERIFICATION INCLUDES DIRECT CONTACT WITH THE LISTED UTILITIES.

DESCRIPTION	SHEET NUMBER
TITLE SHEET -----	1
TYPICAL SECTIONS (TS) (2 SHEET)----	2
QUANTITIES (QU) (1 SHEET)-----	3
TRAFFIC CONTROL SHEETS (TC)-----	4-8
BRIDGE DRAWINGS (B)	
B03351 -----	1

DATE PREPARED 6/25/2025	
ROUTE OR70	STATE MO
DISTRICT CD	SHEET NO 1

COUNTY  
CALLAWAY

JOB NO.  
JCD0145

CONTRACT ID.
--------------

PROJECT NO.
-------------

BRIDGE NO.

--	--	--	--	--	--	--	--

--	--	--	--	--	--	--	--

[illegible]

ATION						
-------	--	--	--	--	--	--

[illegible]

DESCO

[illegible][illegible]

1	2	3	4	5	6	7	8	9	10	11	12	13	14	15	16	17	18	19	20	21	22	23	24	25	26	27	28	29	30	31	32	33	34	35	36	37	38	39	40	41	42	43	44	45	46	47	48	49	50	51	52	53	54	55	56	57	58	59	60	61	62	63	64	65	66	67	68	69	70	71	72	73	74	75	76	77	78	79	80	81	82	83	84	85	86	87	88	89	90	91	92	93	94	95	96	97	98	99	100	101	102	103	104	105	106	107	108	109	110	111	112	113	114	115	116	117	118	119	120	121	122	123	124	125	126	127	128	129	130	131	132	133	134	135	136	137	138	139	140	141	142	143	144	145	146	147	148	149	150	151	152	153	154	155	156	157	158	159	160	161	162	163	164	165	166	167	168	169	170	171	172	173	174	175	176	177	178	179	180	181	182	183	184	185	186	187	188	189	190	191	192	193	194	195	196	197	198	199	200	201	202	203	204	205	206	207	208	209	210	211	212	213	214	215	216	217	218	219	220	221	222	223	224	225	226	227	228	229	230	231	232	233	234	235	236	237	238	239	240	241	242	243	244	245	246	247	248	249	250	251	252	253	254	255	256	257	258	259	260	261	262	263	264	265	266	267	268	269	270	271	272	273	274	275	276	277	278	279	280	281	282	283	284	285	286	287	288	289	290	291	292	293	294	295	296	297	298	299	300	301	302	303	304	305	306	307	308	309	310	311	312	313	314	315	316	317	318	319	320	321	322	323	324	325	326	327	328	329	330	331	332	333	334	335	336	337	338	339	340	341	342	343	344	345	346	347	348	349	350	351	352	353	354	355	356	357	358	359	360	361	362	363	364	365	366	367	368	369	370	371	372	373	374	375	376	377	378	379	380	381	382	383	384	385	386	387	388	389	390	391	392	393	394	395	396	397	398	399	400	401	402	403	404	405	406	407	408	409	410	411	412	413	414	415	416	417	418	419	420	421	422	423	424	425	426	427	428	429	430	431	432	433	434	435	436	437	438	439	440	441	442	443	444	445	446	447	448	449	450	451	452	453	454	455	456	457	458	459	460	461	462	463	464	465	466
---	---	---	---	---	---	---	---	---	----	----	----	----	----	----	----	----	----	----	----	----	----	----	----	----	----	----	----	----	----	----	----	----	----	----	----	----	----	----	----	----	----	----	----	----	----	----	----	----	----	----	----	----	----	----	----	----	----	----	----	----	----	----	----	----	----	----	----	----	----	----	----	----	----	----	----	----	----	----	----	----	----	----	----	----	----	----	----	----	----	----	----	----	----	----	----	----	----	----	-----	-----	-----	-----	-----	-----	-----	-----	-----	-----	-----	-----	-----	-----	-----	-----	-----	-----	-----	-----	-----	-----	-----	-----	-----	-----	-----	-----	-----	-----	-----	-----	-----	-----	-----	-----	-----	-----	-----	-----	-----	-----	-----	-----	-----	-----	-----	-----	-----	-----	-----	-----	-----	-----	-----	-----	-----	-----	-----	-----	-----	-----	-----	-----	-----	-----	-----	-----	-----	-----	-----	-----	-----	-----	-----	-----	-----	-----	-----	-----	-----	-----	-----	-----	-----	-----	-----	-----	-----	-----	-----	-----	-----	-----	-----	-----	-----	-----	-----	-----	-----	-----	-----	-----	-----	-----	-----	-----	-----	-----	-----	-----	-----	-----	-----	-----	-----	-----	-----	-----	-----	-----	-----	-----	-----	-----	-----	-----	-----	-----	-----	-----	-----	-----	-----	-----	-----	-----	-----	-----	-----	-----	-----	-----	-----	-----	-----	-----	-----	-----	-----	-----	-----	-----	-----	-----	-----	-----	-----	-----	-----	-----	-----	-----	-----	-----	-----	-----	-----	-----	-----	-----	-----	-----	-----	-----	-----	-----	-----	-----	-----	-----	-----	-----	-----	-----	-----	-----	-----	-----	-----	-----	-----	-----	-----	-----	-----	-----	-----	-----	-----	-----	-----	-----	-----	-----	-----	-----	-----	-----	-----	-----	-----	-----	-----	-----	-----	-----	-----	-----	-----	-----	-----	-----	-----	-----	-----	-----	-----	-----	-----	-----	-----	-----	-----	-----	-----	-----	-----	-----	-----	-----	-----	-----	-----	-----	-----	-----	-----	-----	-----	-----	-----	-----	-----	-----	-----	-----	-----	-----	-----	-----	-----	-----	-----	-----	-----	-----	-----	-----	-----	-----	-----	-----	-----	-----	-----	-----	-----	-----	-----	-----	-----	-----	-----	-----	-----	-----	-----	-----	-----	-----	-----	-----	-----	-----	-----	-----	-----	-----	-----	-----	-----	-----	-----	-----	-----	-----	-----	-----	-----	-----	-----	-----	-----	-----	-----	-----	-----	-----	-----	-----	-----	-----	-----	-----	-----	-----	-----	-----	-----	-----	-----	-----	-----	-----	-----	-----	-----	-----	-----	-----	-----	-----	-----	-----	-----	-----	-----	-----	-----	-----	-----	-----	-----	-----	-----	-----	-----	-----	-----	-----	-----	-----	-----	-----	-----

DATE						
------	--	--	--	--	--	--

ON	TOL	102	
----	-----	-----	--

STATI

PORT

TRANS

1 PERSON

JEFFREY



--	--

\_\_\_\_\_

\_\_\_\_\_

\_\_\_\_\_

\_\_\_\_\_

\_\_\_\_\_

\_\_\_\_\_

\_\_\_\_\_

\_\_\_\_\_

\_\_\_\_\_

\_\_\_\_\_

\_\_\_\_\_

---

BINDER APPLICATION RATE	0.28 GAL/YD <sup>2</sup>
-------------------------	--------------------------

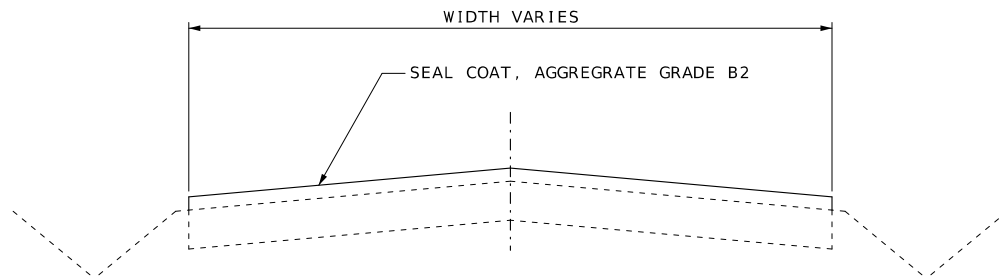

TYPICAL SECTION  
I-70 NORTH OUTER ROAD (HWY 54 TO RTE JJ)

LOG MILE 0.000 TO LOG MILE 0.014  
LOG MILE 4.194 TO LOG MILE 4.209

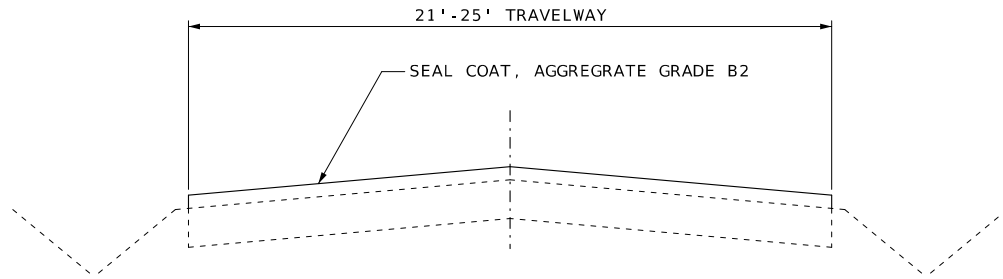

TYPICAL SECTION  
I-70 NORTH OUTER ROAD (HWY 54 TO RTE JJ)

LOG MILE 0.014 TO LOG MILE 0.206 - 25' WIDTH  
LOG MILE 0.206 TO LOG MILE 0.216 - 25' TO 21' WIDTH TAPER  
LOG MILE 0.216 TO LOG MILE 4.194 - 21' WIDTH

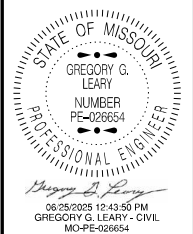

DATE PREPARED 6/25/2025	
ROUTE OR 70	STATE MO
DISTRICT CD	SHEET NO. 2
COUNTY CALLAWAY	
JOB NO. JCD0145	
CONTRACT ID.	
PROJECT NO.	
BRIDGE NO.	

DATE	DESCRIPTION

MISSOURI HIGHWAYS AND TRANSPORTATION  
COMMISSION



105 WEST CAPITOL  
JEFFERSON CITY, MO 65102  
1-888-ASK-MODOT (1-888-275-6636)

BINDER APPLICATION RATE	0.28 GAL/YD <sup>2</sup>
-------------------------	--------------------------

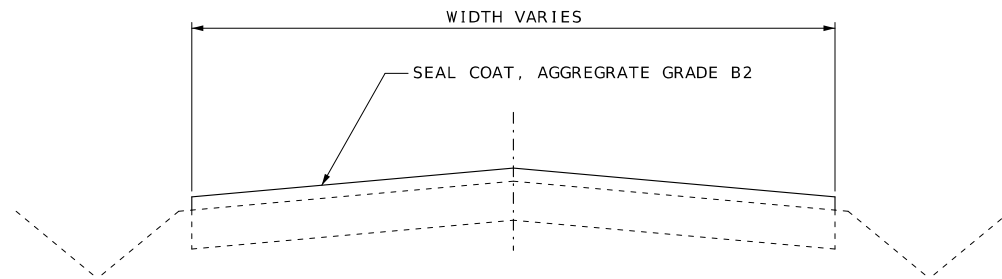

TYPICAL SECTION  
I-70 NORTH OUTER ROAD (RTE A/Z TO RTE D)  
LOG MILE 0.000 TO LOG MILE 0.013

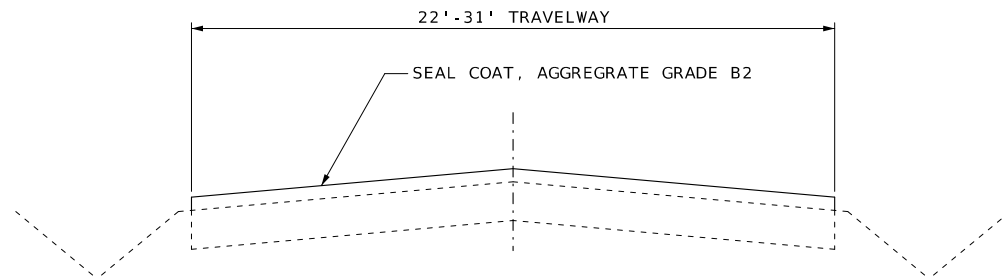

TYPICAL SECTION  
I-70 NORTH OUTER ROAD (RTE A/Z TO RTE D)

LOG MILE 0.013 TO LOG MILE 0.027 - 31' WIDTH  
LOG MILE 0.027 TO LOG MILE 0.039 - 31' TO 24' WIDTH TAPER  
LOG MILE 0.039 TO LOG MILE 0.085 - 24' WIDTH  
LOG MILE 0.085 TO LOG MILE 0.100 - 24' TO 22' WIDTH TAPER  
LOG MILE 0.100 TO LOG MILE 3.515 - 22' WIDTH

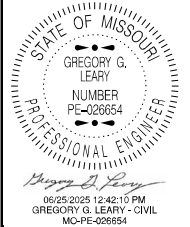

DATE PREPARED 6/25/2025	
ROUTE OR 70	STATE MO
DISTRICT CD	SHEET NO. 2
COUNTY CALLAWAY	
JOB NO. JCD0145	
CONTRACT ID.	
PROJECT NO.	
BRIDGE NO.	

DATE	DESCRIPTION

MISSOURI HIGHWAYS AND TRANSPORTATION  
COMMISSION

**MoDOT**

105 WEST CAPITOL  
JEFFERSON CITY, MO 65102  
1-888-ASK-MODOT (1-888-275-6636)

MISSOURI HIGHWAYS AND TRANSPORTATION COMMISSION



105 WEST CAPITAL  
JEFFERSON CITY, MO 65102  
1-888-ASK-MODOT (1-888-275-6636)

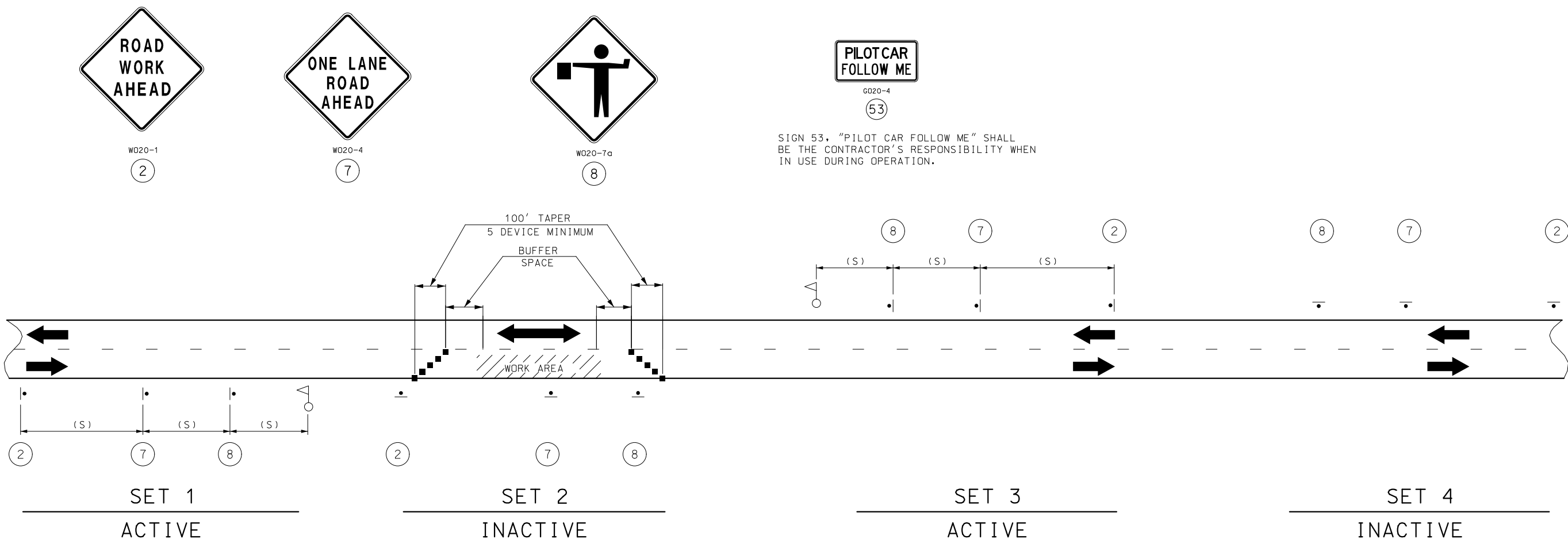

NOTES:

THIS PLAN IS FOR DAYLIGHT FLAGGING OPERATIONS ONLY. WHEN NIGHT WORK IS REQUIRED, OR OTHERWISE ALLOWED BY THE ENGINEER, WORK ZONE LIGHTING SHALL BE PROVIDED IN ACCORDANCE WITH SEC 616.5.2.

CHANNELIZING DEVICES LOCATED DOWNSTREAM OF THE ONE-LANE, TWO-WAY TAPER ARE OPTIONAL. THESE DEVICES SHOULD BE ELIMINATED WHEN THEIR USE WILL REDUCE THE USABLE LANE WIDTH, INCLUDING ANY ACCEPTABLE SHOULDERS, TO LESS THAN 10' OR WILL SIGNIFICANTLY AFFECT THE RESURFACING OPERATION.

SIGN SETS 1 AND 3 ARE ACTIVE AND (I.E., SIGNS FACE ONCOMING TRAFFIC) SIGN SETS 2 AND 4 ARE INACTIVE (I.E., SIGNS DO NOT FACE EITHER DIRECTION OF TRAFFIC) WHEN THE RESURFACING OPERATION IS LOCATED BETWEEN SIGN SETS 1 AND 3.

WHEN SIGN SETS 2 AND 4 ARE ACTIVE, SIGN SETS 1 AND 3 BECOME INACTIVE AND ARE ADVANCED TO BECOME SETS 2 AND 4 WITH SIGN LEGENDS TURNED AWAY FROM BOTH DIRECTIONS OF TRAFFIC. WHEN THE RESURFACING OPERATION ADVANCES TO BETWEEN SIGN SETS 2 AND 4, SIGN SETS 2 AND 4 BECOME ACTIVE (I.E., NEW SIGN SETS 1 AND 3) AND SIGN SETS 1 AND 3 ADVANCED IN THE DIRECTION OF THE OPERATION (I.E., NEW SIGN SETS 2 AND 4).

■ - CHANNELIZERS

○ - FLAGGER

SPEED	SIGN SPACING (FT) (1)	BUFFER SPACE
PERMANENT POSTED (MPH)	NON-DIVIDED HIGHWAYS (S)	LENGTH (FT)
0-35	200	250
40-45	350	360
50-55	500	495
60-70	1000	730

(1) SPACING BETWEEN SIGNS, BETWEEN LAST SIGN AND FLAGGER, BEGINNING OF TAPER OR SIGNED CONDITION.

SPACING MAY BE ADJUSTED AS NECESSARY TO MEET FIELD CONDITIONS.

STATE OF MISSOURI  
GREGORY G. LEARY  
NUMBER  
PE-026654  
PROFESSIONAL ENGINEER  
*Gregory G. Leary*  
06/25/2025 12:42:46 PM  
GREGORY G. LEARY - CIVIL  
MO-PE-026654

DATE PREPARED  
6/25/2025

ROUTE  
OR 70

STATE  
MO

DISTRICT  
CD

SHEET NO.  
5

COUNTY  
CALLAWAY

JOB NO.  
JCD0145

CONTRACT ID.

PROJECT NO.

BRIDGE NO.

DESCRIPTION

DATE

MISSOURI HIGHWAYS AND TRANSPORTATION COMMISSION  
105 WEST CAPITOL  
JEFFERSON CITY, MO 65102  
1-888-ASK-MODOT (1-888-275-6636)  
MoDOT



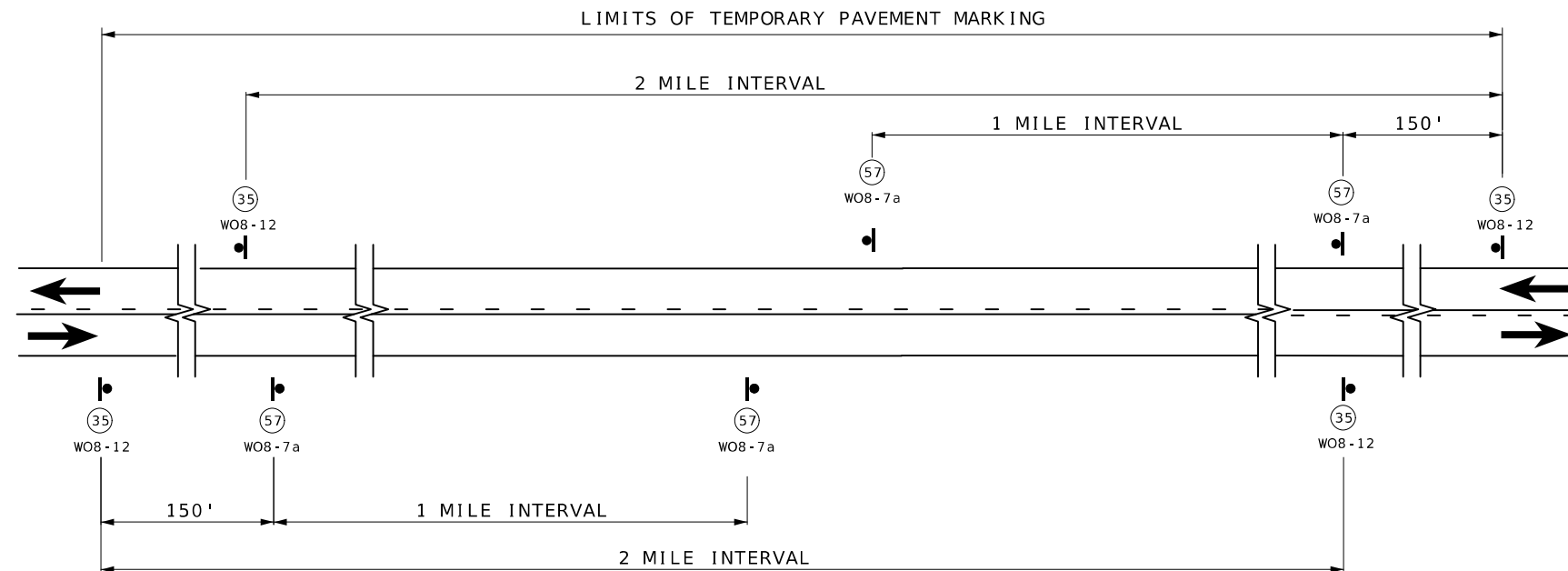

## SIGN SPACING AND TEMPORARY STRIPING FOR MAINLINE

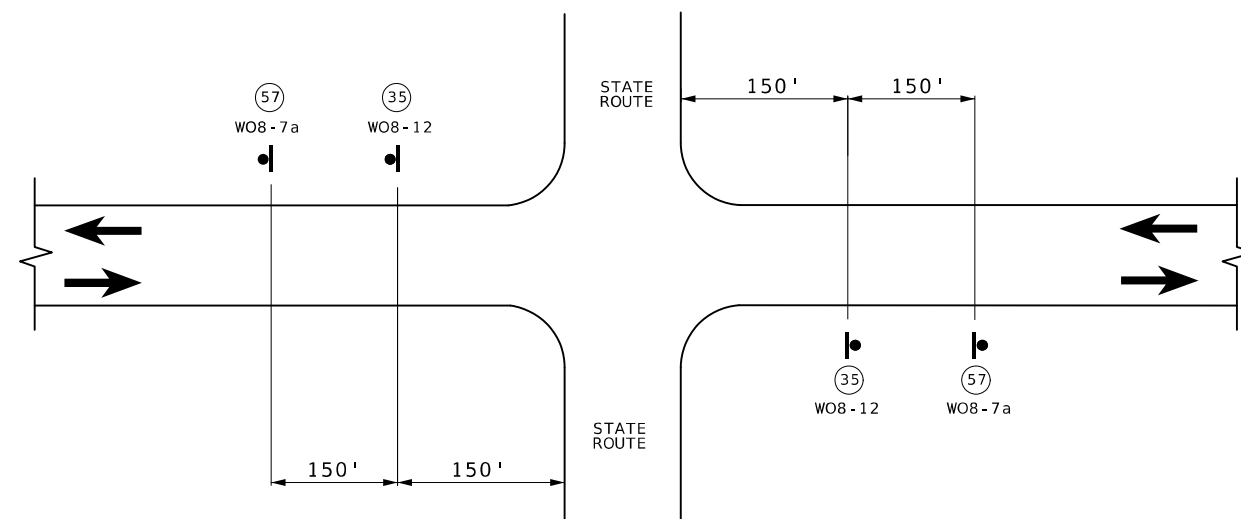

## SIGN SPACING AT STATE ROUTE INTERSECTIONS SHOWING TEMPORARY STRIPING FOR MAINLINE



NOTES :

SIGN 35 AND TEMPORARY RAISED PAVEMENT MARKING (SEE STANDARD PLAN 620.10) INSTALLED WHERE CENTERLINE STRIPING HAS BEEN COVERED OR REMOVED. SIGNS ARE TO REMAIN IN PLACE UNTIL THE PERMANENT CENTERLINE PAVEMENT MARKINGS ARE IN PLACE. SIGNS SHALL BE COVERED OR REMOVED WHEN PAVEMENT CENTERLINE MARKING HAS BEEN INSTALLED.

SIGN (35) IS PLACED AT APPROXIMATELY TWO-MILE INTERVALS AND AT STATE ROUTE JUNCTIONS. WHEN THE INSTALLATION AT A JUNCTION IS WITHIN ONE-EIGHTH MILE OF THE NORMAL MAINLINE SIGN (35), THE LATTER MAY BE ELIMINATED.

ALL SIGNS SHALL BE POST MOUNTED AND IN ACCORDANCE WITH  
STANDARD PLAN 616.10 AND 903.03.

NOT TO SCALE

TRAFFIC CONTROL  
SHEET 4 OF 5

SHEET 4 OF 5

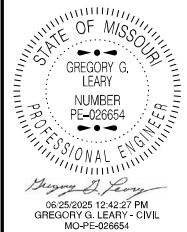

DATE PREPARED

ROUTE OR 70	STATE MO
DISTRICT CD	SHEET NO. 7

COUNTY  
CALLAWAY

JOB NO.  
JCD0145

CONTRACT ID.
--------------

PROJECT NO.
-------------

BRIDGE NO.

[illegible]MISSOURI HIGHWAYS AND TRANSPORTATION  
COMMISSION

105 WEST CAPITOL  
JEFFERSON CITY, MO 65102  
1-888-ASK-MODOT (1-888-275-6636)

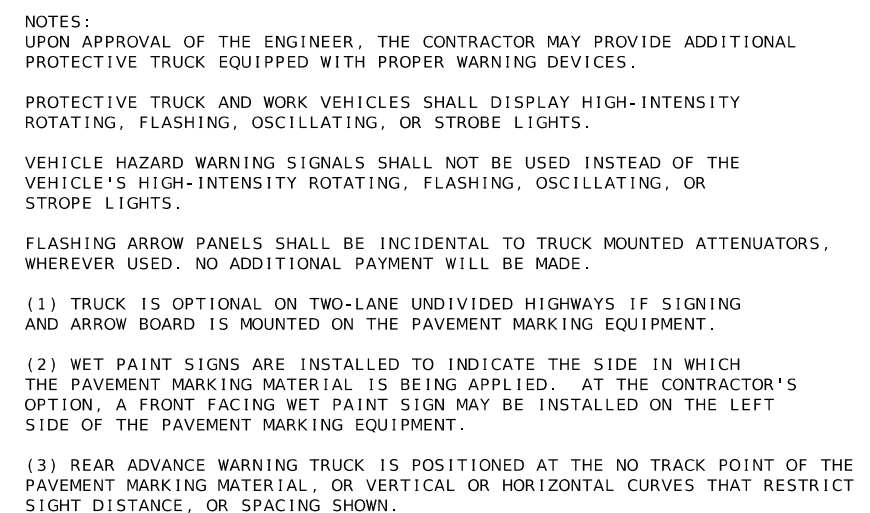

TRAFFIC CONTROL  
SHEET 5 OF 5

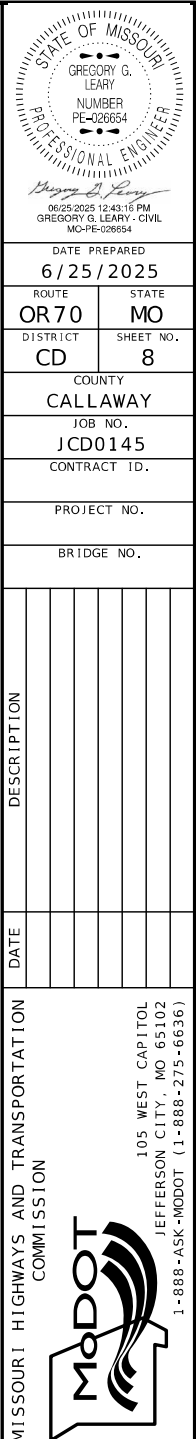

U.I.P. & REHABILITATE (65') ADJACENT CORED SLAB BEAM SPAN (SKEW: 30°00'00" R.A.)

SEC/SUR 11 TWP 48 N RGE 9 W

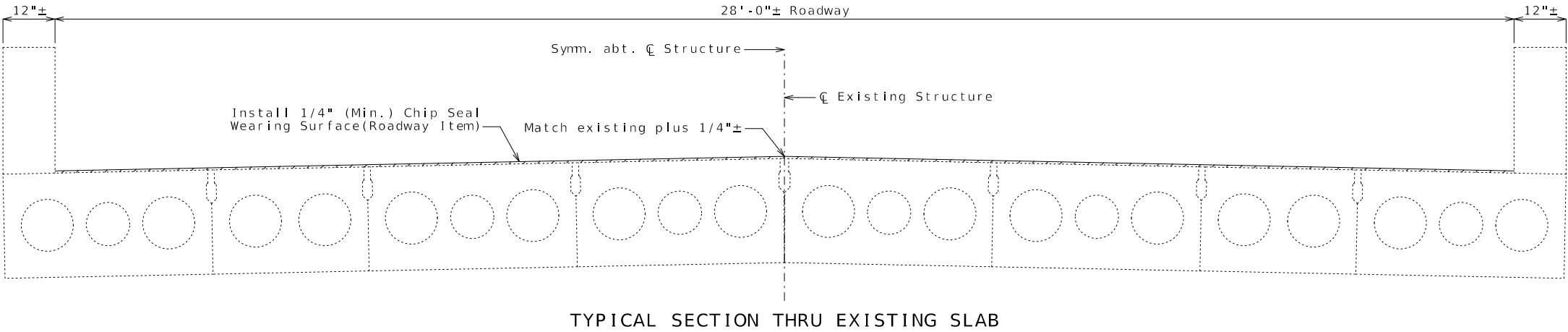

General Notes:

Design Specifications:

2002 AASHTO LFD (17th Ed.) Standard Specifications  
Bridge Deck Rating = 8

Design Loading:

HS20-44

Miscellaneous:

Roadway surfacing adjacent to bridge ends shall match new bridge surface (Roadway Item).

Outline of existing work is indicated by light dashed lines. Heavy lines indicate new work.

The contractor shall exercise care to ensure spillage over joint edges is prevented and that a neat line is obtained along any terminating edge of the seal coat.

Traffic Handling:

Traffic to be maintained on existing structure during construction. See roadway plans for traffic control.

Detailed June 2025  
Checked

Note: This drawing is not to scale. Follow dimensions.

Sheet No. 1 of 1

REPAIRS TO BRIDGE: ROUTE I-70 OR  
OVER MADDOX CREEK

ROUTE I-70 OR FROM ROUTE 54 TO ROUTE JJ  
ABOUT 2.9 MILES EAST OF ROUTE 54  
BEGINNING STATION 99+93.18 (MATCH EXISTING ±)

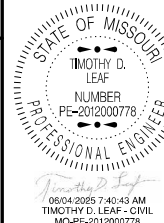

DATE PREPARED

6/4/2025

ROUTE STATE

I-70 OR MO

DISTRICT SHEET NO.

BR 1

COUNTY

CALLAWAY

JOB NO.

JCD0145

CONTRACT ID.

PROJECT NO.

BRIDGE NO.

B03351

DESCRIPTION

DATE

DATE

DATE

DATE

DATE

DATE

DATE

DATE

DATE

DATE

DATE

DATE

DATE

DATE

DATE

DATE

DATE

DATE

DATE

DATE

DATE

DATE

DATE

DATE

DATE

DATE

DATE

DATE

DATE

DATE

DATE

DATE

DATE

DATE

DATE

DATE

DATE

DATE

DATE

DATE

DATE

DATE

DATE

DATE

DATE

DATE

DATE

DATE

DATE

DATE

DATE

DATE

DATE

A.A.D.T. - 2025 = 739  
V = 55 M.P.H.

KEY MAP  
LOCATION OF CALLAWAY COUNTY

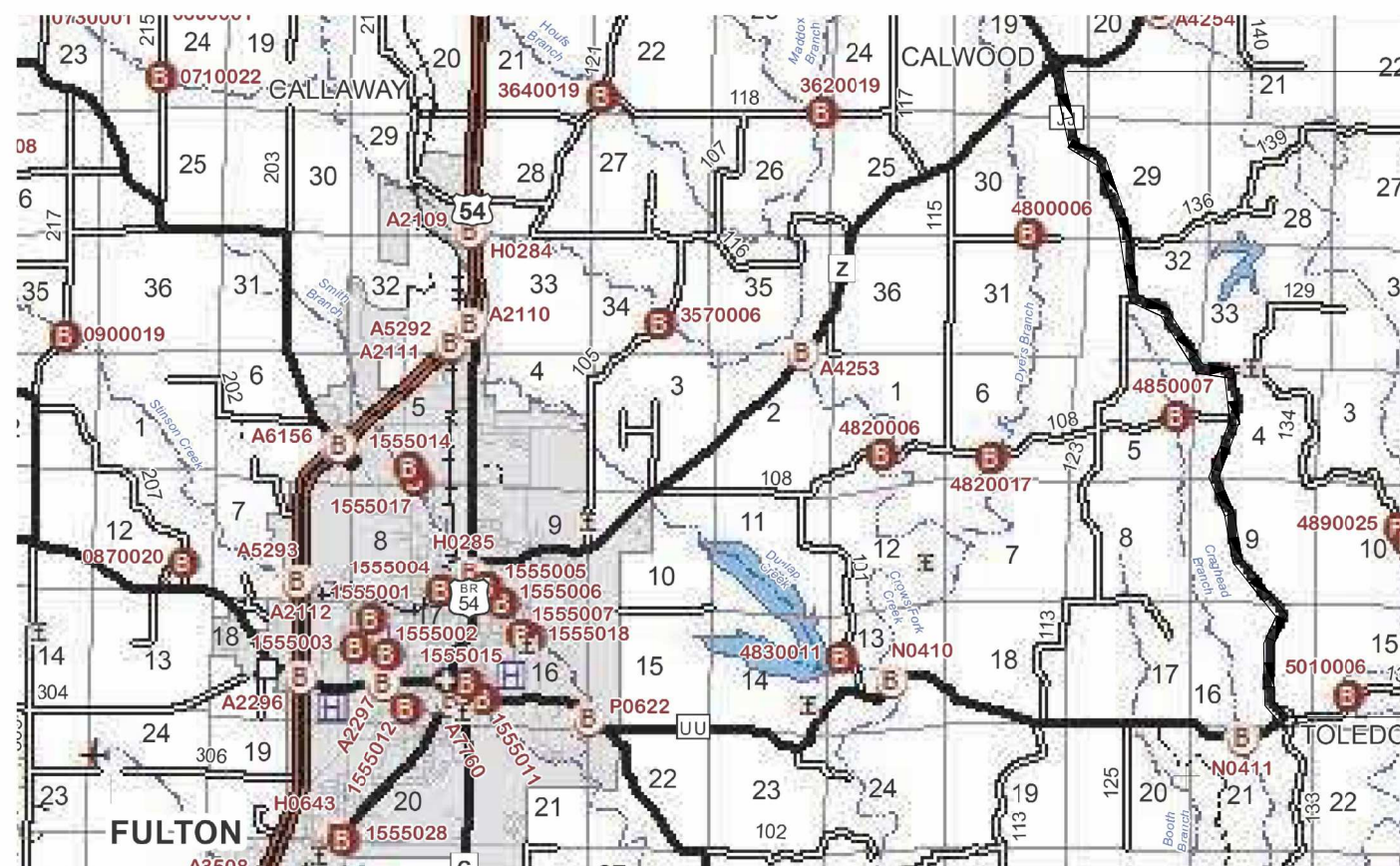

BEGIN PROJECT  
LOG MILE 1.665

ROUTE JJ PROJECT LIMITS  
CHIP SEAL - 6.573 MILES

END PROJECT  
LOG MILE 8.238

## INDEX OF SHEETS

DESCRIPTION	SHEET NUMBER
TITLE SHEET -----	1
TYPICAL SECTIONS (TS) (1 SHEET)----	2
QUANTITIES (QU) (1 SHEET)-----	3
TRAFFIC CONTROL SHEETS (TC)-----	4-8

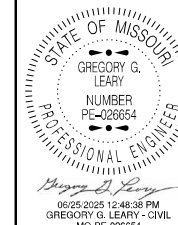

MC-FE-026694

DATE PREPARED  
6/25/2025

ROUTE	STATE
J J	MO

DISTRICT	SHEET NO.
CD	1

COUNTY  
CALLAWAY

JOB NO.  
LCD0146

CONTRACT ID.	
--------------	--

PROJECT NO.
-------------

BRIDGE NO.

[illegible]

**MISSOURI HIGHWAYS AND TRANSPORTATION COMMISSION**  
 105 WEST CAPITOL  
 JEFFERSON CITY, MO 65102

BEGINNING OF PROJECT	LOG MILE 1.665
END OF PROJECT	LOG MILE 8.238
APPARENT LENGTH	6.573 MILES

EQUATIONS AND EXCEPTIONS:

0 MILES

TOTAL CORRECTIONS	0 MILES
-------------------	---------

NET LENGTH OF PROJECT

STATE LENGTH	6.573 MILES
--------------	-------------

ESTIMATED DISTURBED ACRES (FOR INFORMATION ONLY)	0.0 ACRES
---	-----------



CONSTRUCTION SIGNING						
SIGN NO.	SIGN	SIZE (in.)	AREA (ft.²)	QTY.	TOTAL AREA (ft.²)	DESCRIPTION
① *	GO20-1	60 x 24	10.00	2	20	ROAD WORK NEXT 6 MILES
② **	WO20-1	48 x 48	16.00	8	128	ROAD WORK AHEAD
⑦	WO20-4	48 x 48	16.00	10	160	ONE LANE ROAD AHEAD
⑧	WO20-7a	48 x 48	16.00	8	128	FLAGGER (SYMBOL)
⑪	WO3-4	48 x 48	16.00			BE PREPARED TO STOP
②⑥	GO20-2	48 x 24	8.00	2	16	END ROAD WORK
③⑤	WO8-12	48 x 48	16.00	6	96	NO CENTER LINE
⑤③	GO20-4	36 x 18	4.5	1	4.5	PILOT CAR FOLLOW ME
⑤⑦ ***	WO8-7a	36 x 36	9.00	12	108	FRESH OIL   LOOSE GRAVEL
⑤⑧	GO20-4a	42 x 30	8.75			PILOT CAR IN USE WAIT & FOLLOW
⑤⑧	GO20-4a	18 x 12	1.50	4	6	PILOT CAR IN USE WAIT & FOLLOW
⑤⑨	CONST-8	48 x 36	12.00	2	24	WORK ZONE NO PHONE ZONE
	GO22-1	21 X 15	2.19	4	8.76	WET PAINT (ARROW PIVOTS)
616-10.05 CONSTRUCTION SIGNS TOTAL					700	

- \* IF LESS THAN TWO (2) MILES, DELETE SIGN NO. 1.
- \*\* ADDITIONAL SIGN NO. 2 USED AS SHOWN ON TRAFFIC CONTROL SHEET 4 OF 5 AND AS DIRECTED BY THE ENGINEER.
- \*\*\* FRESH OIL/LOOSE GRAVEL SIGN SHALL BE PLACED AT THE START OF THE PROJECT AND AT ONE MILE INTERVALS. SIGNS SHOULD ALSO BE INSTALLED AFTER THE INTERSECTION OF A STATE ROUTE. ADDITIONAL SIGNS MAY BE INSTALLED AFTER OTHER INTERSECTIONS, AS DIRECTED BY THE ENGINEER.

NOTE:

REFER TO STANDARD PLANS 616.10 AND 903.03 FOR SIGN AND SIGN MOUNTING REQUIREMENTS.

ITEM NO.	QTY.	DESCRIPTION
616-10.25	110	CHANNELIZERS (TRIM-LINE)
616-10.98A	1	CHANGEABLE MESSAGE SIGN

MOBILIZATION
1 LUMP SUM

CLASS 1 PAVEMENT MARKING PAINT (18-MIL, TYPE P BEADS)					
LOG MILE	LOG MILE	LENGTH FT	4" YELLOW LF	4" WHITE LF	REMARKS
1.667	1.977	1636.80	3,273.6	3,273.6	DOUBLE YELLOW
1.977	2.157	950.400	1,188.0	1,900.8	NB PASSING
2.157	3.557	7392.000	14,784.0	14,784.0	DOUBLE YELLOW
3.557	3.657	528.000	660.0	1,056.0	SB PASSING
3.657	3.757	528.000	660.0	1,056.0	NB PASSING
3.757	8.228	23606.880	47,213.8	47,213.8	DOUBLE YELLOW
		TOTAL	67,779.4	69,284.2	
		USE	67,779	69,284	

NOTE: TEMPORARY AND PERMANENT PAVEMENT MARKING SHALL BE IN ACCORDANCE WITH 620.10.

SEAL COAT							
LOG MILE	LOG MILE	LOCATION	NET LENGTH (MILES)	AVERAGE WIDTH (FEET)	MODIFIED SEAL COAT AGGREGATE, GRADE B2 (S.Y.)	EMULSIFIED ASPHALT, SEAL COAT 0.28 GAL/S.Y. (GALLONS)	REMARKS
1.665	1.676	ROUTE JJ	0.011	VAR	422.2	118.2	BEGIN PROJECT - ROUTE Z IN CALWOOD
1.676	8.238	ROUTE JJ	6.562	20	76,994.1	21,558.3	END PROJECT - ROUTE UU
				TOTAL	77,416.3	21,676.5	
				USE	77,416	21,677	

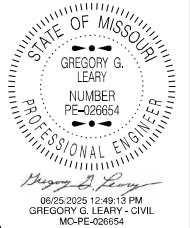

DATE PREPARED 6/25/2025	
ROUTE JJ	STATE MO
DISTRICT CD	SHEET NO. 3
COUNTY CALLAWAY	
JOB NO. JCD0146	
CONTRACT ID.	
PROJECT NO.	
BRIDGE NO.	

DESCRIPTION	DATE

MISSOURI HIGHWAYS AND TRANSPORTATION COMMISSION



105 WEST CAPITOL  
JEFFERSON CITY, MO 65102  
1-888-ASK-MODOT (1-888-275-6636)

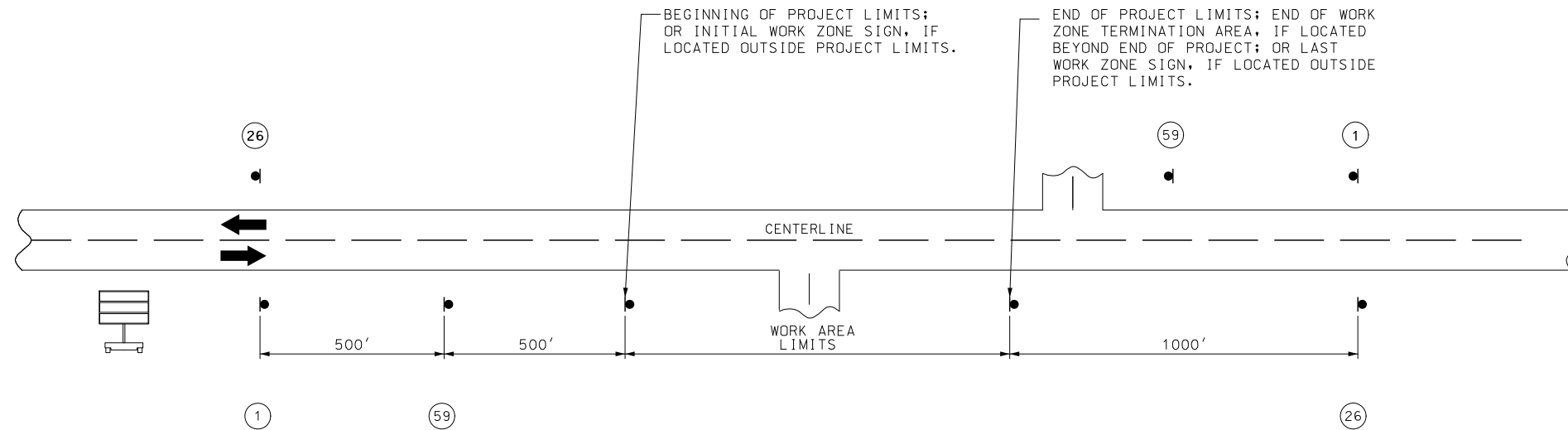

DISTANCE MAY BE ADJUSTED ACCORDING TO FIELD CONDITIONS.

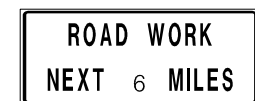

①



(59)

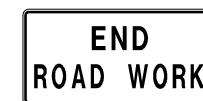

(26)

TRAFFIC CONTROL  
SHEET 1 OF 5

[illegible]MISSOURI HIGHWAYS AND TRANSPORTATION  
COMMISSION

105 WEST CAPITOL  
JEFFERSON CITY, MO 65102  
1-888-ASK-MODOT (1-888-275-6636)



SPEED	SIGN SPACING (FT) (1)	CHANNELIZER SPACING (FT)
PERMANENT POSTED (MPH)	NON-DIVIDED HIGHWAYS (S)	BUFFER/ WORK AREA (TYP.)
0-35	200	40
40-45	350	80
50-55	500	80
60-70	1000	120

(1) SPACING BETWEEN SIGNS, BETWEEN LAST SIGN AND FLAGGER, BEGINNING OF TAPER OR SIGNED CONDITION.

SPACING MAY BE ADJUSTED AS NECESSARY TO MEET FIELD CONDITIONS.

NOTES:  
WARNING SIGNS SHALL BE ERECTED AT EACH INTERSECTION WITH ANOTHER STATE HIGHWAY WITHIN THE WORK ZONE.

ADDITIONAL WARNING SIGNS SHALL BE ERECTED AT OTHER INTERSECTIONS WITHIN THE WORK ZONE, AS DIRECTED BY THE ENGINEER.

■ - CHANNELIZERS (AS SPECIFIED)

◁ - FLAGGER

NOT TO SCALE

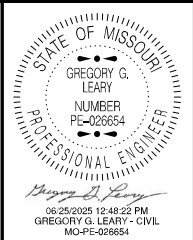

DATE PREPARED 6/25/2025	
ROUTE J J	STATE MO
DISTRICT CD	SHEET NO. 6
COUNTY CALLAWAY	
JOB NO. JCD0146	
CONTRACT ID.	
PROJECT NO.	
BRIDGE NO.	

DESCRIPTION	DATE

MISSOURI HIGHWAYS AND TRANSPORTATION COMMISSION



105 WEST CAPITOL  
JEFFERSON CITY, MO 65102  
1-888-ASK-MODOT (1-888-275-6636)

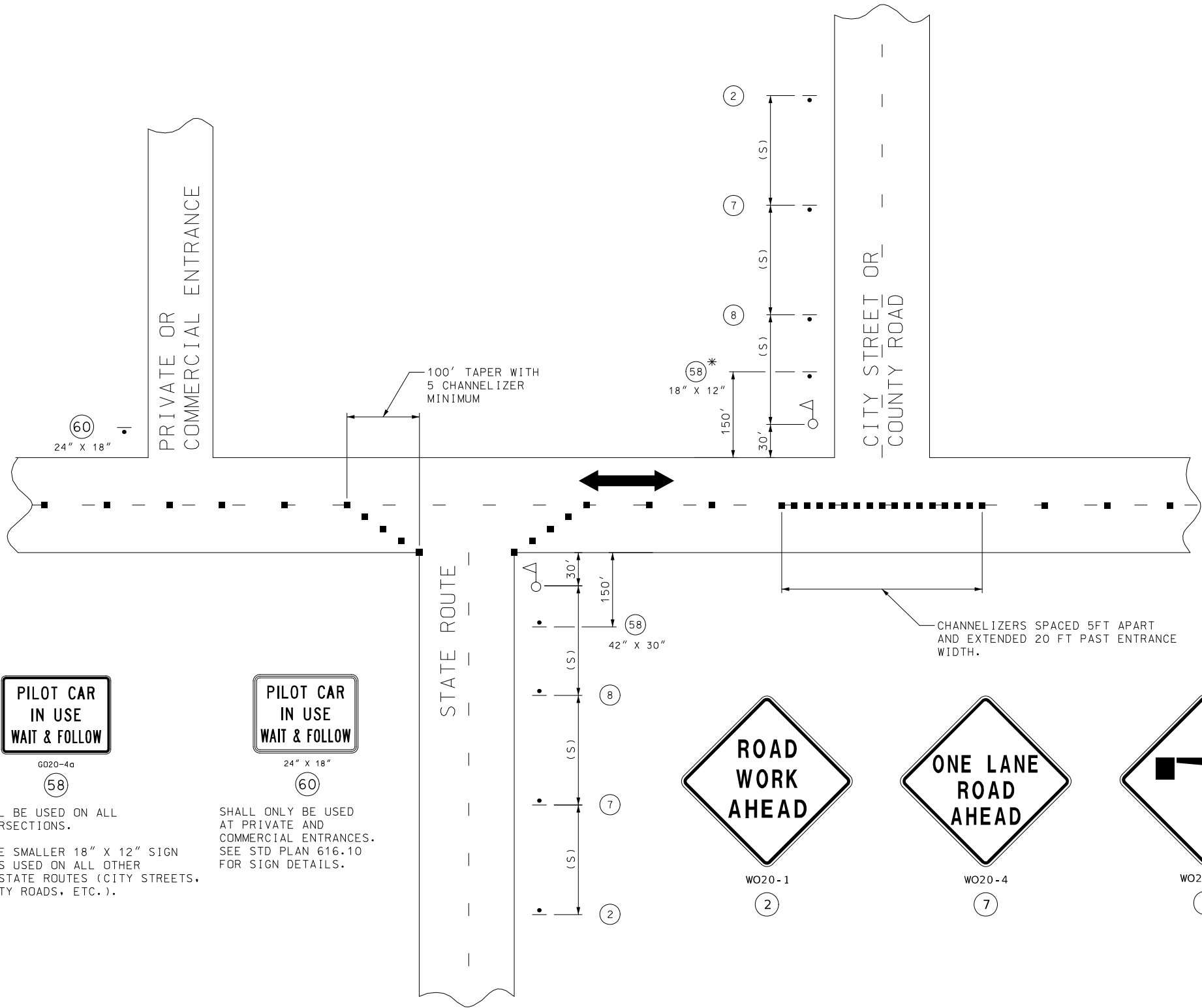

SIDE ROADS ENTERING WORK ZONES

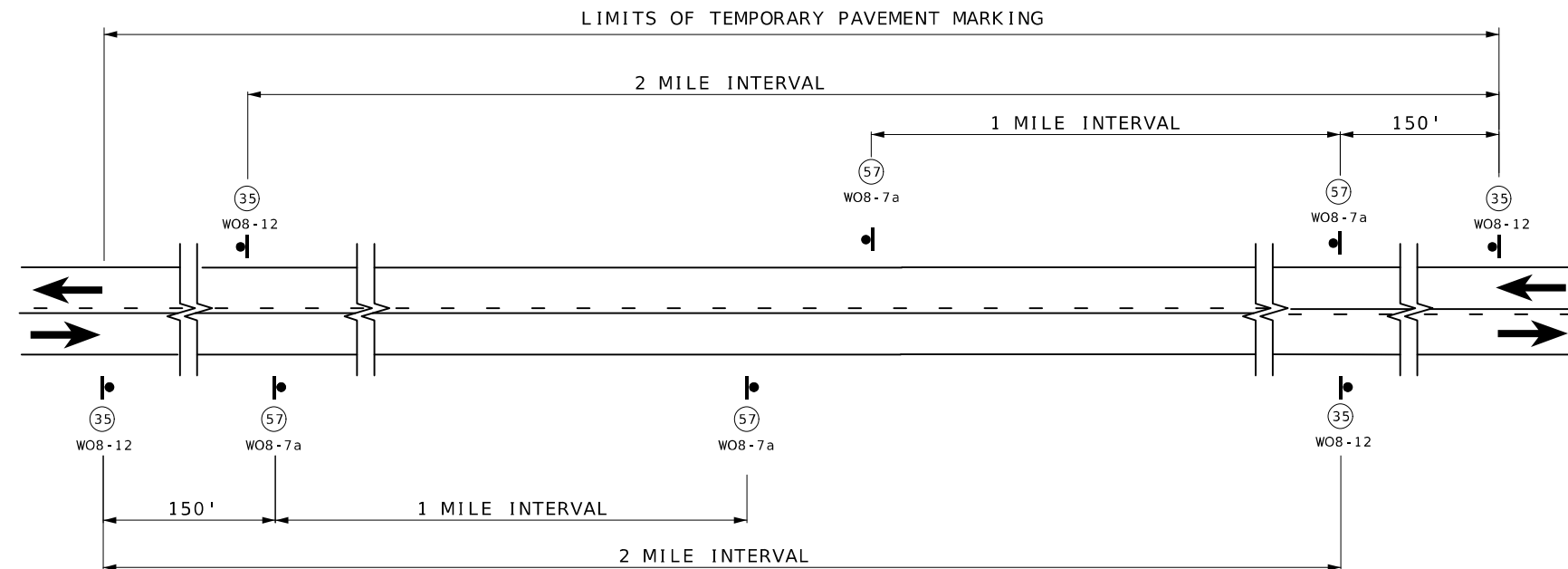

SIGN SPACING AND TEMPORARY STRIPING FOR MAINLINE

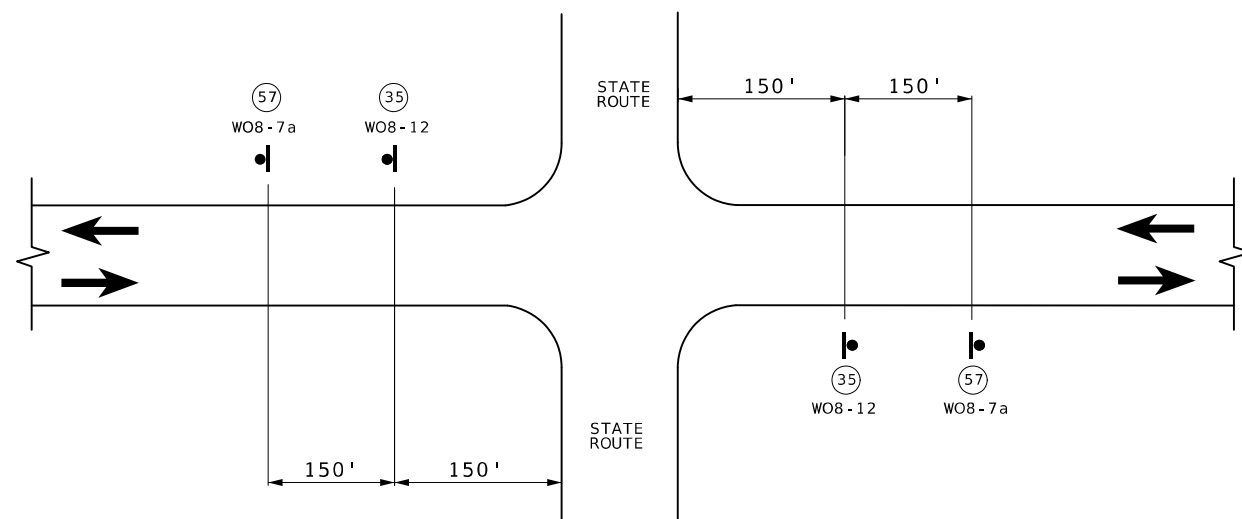

SIGN SPACING AT STATE ROUTE INTERSECTIONS  
SHOWING TEMPORARY STRIPING FOR MAINLINE



NOTES:

SIGN (35) AND TEMPORARY RAISED PAVEMENT MARKING (SEE STANDARD PLAN 620.10) INSTALLED WHERE CENTERLINE STRIPING HAS BEEN COVERED OR REMOVED. SIGNS ARE TO REMAIN IN PLACE UNTIL THE PERMANENT CENTERLINE PAVEMENT MARKINGS ARE IN PLACE. SIGNS SHALL BE COVERED OR REMOVED WHEN PAVEMENT CENTERLINE MARKING HAS BEEN INSTALLED.

SIGN (35) IS PLACED AT APPROXIMATELY TWO-MILE INTERVALS AND AT STATE ROUTE JUNCTIONS. WHEN THE INSTALLATION AT A JUNCTION IS WITHIN ONE-EIGHTH MILE OF THE NORMAL MAINLINE SIGN (35), THE LATTER MAY BE ELIMINATED.

ALL SIGNS SHALL BE POST MOUNTED AND IN ACCORDANCE WITH STANDARD PLAN 616.10 AND 903.03.

NOT TO SCALE

TRAFFIC CONTROL  
SHEET 4 OF 5

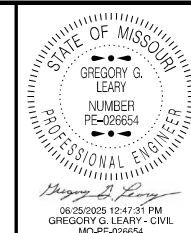

DATE PREPARED  
6/25/2025

ROUTE  
J J

DISTRICT  
CD

STATE  
MO

SHEET NO.  
7

COUNTY  
CALLAWAY

JOB NO.  
JCD0146

CONTRACT ID.

PROJECT NO.

BRIDGE NO.

DESCRIPTION

DATE

DATE

DATE

DATE

DATE

DATE

DATE

DATE

DATE

DATE

DATE

DATE

DATE

DATE

DATE

DATE

DATE

DATE

DATE

DATE

DATE

DATE

DATE

DATE

DATE

DATE

DATE

DATE

DATE

DATE

DATE

DATE

DATE

DATE

DATE

DATE

