

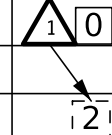

													EFFECTIVE: 04-01-2024												
SIGN	SIZE IN.	AREA SQ.FT.	QTY EACH	TOTAL AREA SQ.FT.	QTY RELOC EACH	TOTAL RELOC SQ.FT.	SIGN NUM.	DESCRIPTION	SIGN	SIZE IN.	AREA SQ.FT.	QTY EACH	TOTAL SQ.FT.	QTY RELOC EACH	TOTAL RELOC SQ.FT.	SIGN NUM.	DESCRIPTION	ITEM NUMBER	TOTAL QTY	DESCRIPTION					
WARNING SIGNS									GUIDE SIGNS									REGULATORY SIGNS							
W01-1L	48X48	16.00						TURN (SYMBOL LEFT ARROW)	E05-1	36X48	12.00						GORE EXIT	6122008		IMPACT ATTENUATOR 40 MPH (SAND BARRELS)					
W01-1R	48X48	16.00						TURN (SYMBOL RIGHT ARROW)	E05-2	48X36	12.00						EXIT OPEN	6122009		IMPACT ATTENUATOR 45 MPH (SAND BARRELS)					
W01-2L	48X48	16.00						CURVE (SYMBOL LEFT ARROW)	E05-2a	48X36	12.00						EXIT CLOSED	6122010		IMPACT ATTENUATOR 50 MPH (SAND BARRELS)					
W01-2R	48X48	16.00						CURVE (SYMBOL RIGHT ARROW)	GO20-1	60X24	10.00	2	20				ROAD WORK NEXT XX MILES	6122012		IMPACT ATTENUATOR 55 MPH (SAND BARRELS)					
W01-3L	48X48	16.00						REVERSE TURN (SYMBOL LEFT ARROW)	GO20-2	48X24	8.00	2	16				END ROAD WORK	6122014		IMPACT ATTENUATOR 60 MPH (SAND BARRELS)					
W01-3R	48X48	16.00						REVERSE TURN (SYMBOL RIGHT ARROW)	GO20-4	36X18	4.50	2	9				PILOT CAR FOLLOW ME	6122017		IMPACT ATTENUATOR 65 MPH (SAND BARRELS)					
W01-4L	48X48	16.00						REVERSE CURVE (SYMBOL LEFT ARROW)	GO20-4a	42X30	8.75	0					PILOT CAR IN USE WAIT & FOLLOW	6122019		IMPACT ATTENUATOR 70 MPH (SAND BARRELS)					
W01-4R	48X48	16.00						REVERSE CURVE (SYMBOL RIGHT ARROW)	GO20-4a	18X12	1.50	2	3				PILOT CAR IN USE WAIT & FOLLOW	6122020		REPLACEMENT SAND BARREL					
W01-4bL	48X48	16.00						DOUBLE ARROW REVERSE CURVE (SYMBOL LT ARROWS)	GO20-5aP	36X24	6.00						WORK ZONE (PLAQUE)	6122030							
W01-4bR	48X48	16.00						DOUBLE ARROW REVERSE CURVE (SYMBOL RT ARROWS)	MO4-8a	24X18	3.00						END DETOUR	6123001		TRUCK MOUNTED ATTENUATOR (TMA)					
W01-4cL	48X48	16.00						TRIPLE ARROW REVERSE CURVE (SYMBOL LT ARROWS)	MO4-9L	48X36	12.00						DETOUR (LEFT ARROW)	6161008		ADVANCED WARNING RAIL SYSTEM					
W01-4cR	48X48	16.00						TRIPLE ARROW REVERSE CURVE (SYMBOL RT ARROWS)	MO4-9R	48X36	12.00						DETOUR (RIGHT ARROW)	6161012		BUOYS (BOATS KEEP OUT)					
W01-6	60X30	12.50						HORIZONTAL ARROW (SYMBOL)	MO4-9P	48X12	4.00						STREET NAME (PLAQUE)	6161013		BUOYS (NO WAKE)					
W01-6a	72X36	18.00						HORIZ. ARROW (SYMBOL ON PERMANENT BARRICADE)	MO4-10L	48X18	6.00						DETOUR (ARROW LEFT)	6161014		SPECIAL SIGN ASSEMBLY (BOATS KEEP OUT)					
W01-7	60X30	12.50						DOUBLE HEAD HORIZONTAL ARROW (SYMBOL)	MO4-10R	48X18	6.00						DETOUR (ARROW RIGHT)	6161025	100	CHANNELIZER (TRIM LINE)					
W01-7a	72X36	18.00						DOUBLE HEAD HORIZ. ARROW (SYMBOL ON PERM. BARR.)	REGULATORY SIGNS								6161030		TYPE III MOVEABLE BARRICADE						
W01-8	18X24	3.00						CHEVRON (SYMBOL)	R1-1	48X48	13.25						STOP	6161033		DIRECTION INDICATOR BARRICADE					
W01-8a	30X36	7.50						CHEVRON (SYMBOL FOR DIVIDED HIGHWAYS)	R1-2	48TRI	6.93						YIELD	6161040		FLASHING ARROW PANEL					
W03-1	48X48	16.00						STOP AHEAD (SYMBOL)	R1-2a	36X36	9.00						TO ONCOMING TRAFFIC (PLAQUE)	6161047		TYPE III OBJECT MARKER					
W03-2	48X48	16.00						YIELD AHEAD (SYMBOL)	R1-3P	30X12	2.50						ALL WAY (PLAQUE)	6161055		SEQUENTIAL FLASHING WARNING LIGHT					
W03-3	48X48	16.00						SIGNAL AHEAD (SYMBOL)	R2-1	36X48	12.00						SPEED LIMIT XX	6161070		TUBULAR MARKER					
W03-4	48X48	16.00	2	32				BE PREPARED TO STOP	R3-1	48X48	16.00						NO RIGHT TURN (SYMBOL)	6161095		RADAR SPEED ADVISORY SYSTEM					
W03-5	48X48	16.00						SPEED LIMIT AHEAD	R3-2	48X48	16.00						NO LEFT TURN (SYMBOL)			CHANGEABLE MESSAGE SIGN,					
W04-1L	48X48	16.00						MERGE (SYMBOL FROM LEFT)	R3-3	36X36	9.00						NO TURNS	6161096		COMMISSION FURNISHED/RETAINED					
W04-1R	48X48	16.00						MERGE (SYMBOL FROM RIGHT)	R3-4	48X48	16.00						NO U-TURN (SYMBOL)			CHANGEABLE MESSAGE SIGN W/O COMM.					
W04-1aL	48X48	16.00						MERGE (ARROW SYMBOL)	R3-7L	30X30	6.25						LEFT LANE MUST TURN LEFT	6161098A		INTERFACE - CONTRACTOR FURNISHED/RETAINED					
W04-1aR	48X48	16.00						MERGE (ARROW SYMBOL)	R3-7R	30X30	6.25						RIGHT LANE MUST TURN RIGHT			CHANGEABLE MESSAGE SIGN WITH COMM.					
W05-1	48X48	16.00						ROAD/BRIDGE/RAMP NARROWS	R4-1	36X48	12.00						DO NOT PASS	6161099	4	INTERFACE - CONTRACTOR FURNISHED/RETAINED					
W05-3	48X48	16.00						ONE LANE BRIDGE	R4-2	36X48	12.00						PASS WITH CARE	6162000A		WORK ZONE TRAFFIC SIGNAL SYSTEM					
W05-5	48X48	16.00						NARROW LANES	R4-8a	36X48	12.00						KEEP LEFT (HORIZONTAL ARROW)	6162002		TEMPORARY LONG-TERM RUMBLE STRIPS					
W06-1	48X48	16.00						DIVIDED HIGHWAY (SYMBOL)	R4-7a	36X48	12.00						KEEP RIGHT (HORIZONTAL ARROW)			TEMPORARY TRAFFIC BARRIER					
W06-2	48X48	16.00						DIVIDED HIGHWAY END (SYMBOL)	R5-1	30X30	6.25						DO NOT ENTER	6173600D		CONTRACTOR FURNISHED/RETAINED					
W06-3	48X48	16.00						TWO WAY TRAFFIC (SYMBOL)	R5-1a	36X24	6.00						WRONG WAY			TEMPORARY TRAFFIC BARRIER					
W07-3a	30X24	5.00						NEXT XX MILES (PLAQUE)	R6-1L	54X18	6.75						ONE WAY ARROW (LEFT)	6173602B		CONTRACTOR FURNISHED/COMMISSION RETAINED					
W08-1	48X48	16.00						BUMP	R6-1R	54X18	6.75						ONE WAY ARROW (RIGHT)	6174000A		TEMP. TRAFFIC BARRIER HEIGHT TRANSITION					
W08-2	48X48	16.00						DIP	R6-2L	24X30	5.00						ONE WAY (LEFT)	6175010A		RELOCATING TEMPORARY TRAFFIC BARRIER					
W08-3	48X48	16.00						PAVEMENT ENDS	R6-2R	24X30	5.00						ONE WAY (RIGHT)			TEMPORARY TRAFFIC BARRIER					
W08-4	48X48	16.00						SOFT SHOULDER	R9-9	24X12	2.00						SIDEWALK CLOSED	6176000B		COMMISSION FURNISHED/RETAINED					
W08-5	48X48	16.00						SLIPPERY WHEN WET (SYMBOL)									SIDEWALK CLOSED AHEAD,			TEMP. TRAFFIC BARRIER HEIGHT TRANSITION					
W08-6	48X48	16.00						TRUCK CROSSING	R9-11L	24X18	3.00						(ARROW LEFT) CROSS HERE	6177000B		COMMISSION FURNISHED/RETAINED					
W08-6c	48X48	16.00						TRUCK ENTRANCE									SIDEWALK CLOSED AHEAD,	6208064A		TEMPORARY RAISED PAVEMENT MARKER					
W08-7	36X36	9.00						LOOSE GRAVEL	R9-11R	24X18	3.00						(ARROW RIGHT) CROSS HERE	9029400		TEMPORARY TRAFFIC SIGNALS					
W08-7a	36X36	9.00						FRESH OIL/LOOSE GRAVEL	R10-6	24X36	6.00						STOP HERE ON RED (45° ARROW)	9029401		TEMPORARY TRAFFIC SIGNALS AND LIGHTING					
W08-9	48X48	16.00						LOW SHOULDER	R11-2	48X30	10.00						ROAD CLOSED								
W08-11	48X48	16.00	62	992				UNEVEN LANES									ROAD CLOSED XX MILES AHEAD								
W08-12	48X48	16.00	32	512				NO CENTER LINE	R11-3a	60X30	12.50						LOCAL TRAFFIC ONLY								
W08-15	48X48	16.00						GROOVED PAVEMENT	R11-4	60X30	12.50						ROAD CLOSED TO THRU TRAFFIC								
W08-15P	30X24	5.00						MOTORCYCLE (PLAQUE)	CONST-3A	60X48	20.00						FINE SIGN								
W08-17L	48X48	16.00						SHOULDER DROP-OFF (SYMBOL LEFT)	CONST-3X	56X12	4.67						SPEEDING/PASSING (PLATE)								
W08-17R	30X24	5.00						SHOULDER DROP-OFF (SYMBOL RIGHT)	MISCELLANEOUS SIGNS																
W08-17P	30X24	5.00						SHOULDER DROP-OFF (PLAQUE)	CONST-5	48X36	12.00						POINT OF PRESENCE		REVISED						
W10-1	42RND.	9.62						RAILROAD CROSSING	CONST-5	96X48	32.00	2	64				POINT OF PRESENCE								
W012-1	24X24	4.00						DOUBLE DOWN ARROW (SYMBOL)	CONST-7	48X24	8.00						RATE OUR WORK ZONE								
W012-2	48X48	16.00						LOW CLEARANCE (SYMBOL)	CONST-7	72X36	18.00	2	36				RATE OUR WORK ZONE								
W012-2X	24X18	3.00						LOW CLEARANCE (PLAQUE)	CONST-8	48X36	12.00	2	24				WORK ZONE NO PHONE ZONE								
W012-2a	84X24	14.00						OVERHEAD LOW CLEARANCE (FEET AND INCHES)	SPECIAL	36X78	19.50	14	273				DETOUR ROUTE ASSEMBLY								
W012-4	120X60	50.00						LOW CLEARANCE XX FT XX IN XX MILES AHEAD																	
W012-5	120X60	50.00						WIDTH RESTRICTION XX FT XX IN XX MILES AHEAD																	
W013-1	30X30	6.25						ADVISORY SPEED (PLAQUE)																	
W016-2	30X24	5.00						XXX FEET (PLAQUE)																	
W016-3	30X24	5.00						X MILE (PLAQUE)																	
W020-1	48X48	16.00	6	96				ROAD/BRIDGE/RAMP WORK AHEAD	616-10.05																
W020-2	48X48	16.00						DETOUR AHEAD	CONSTRUCTION SIGNS				TOTAL	2205											
W020-3	48X48	16.00						ROAD CLOSED AHEAD	616-10.10																
W020-4	48X48	16.00	4	64				ONE LANE ROAD AHEAD	RELOCATED SIGNS								TOTAL	0							
W020-5	48X48	16.00						RIGHT/CENTER/LEFT LANE CLOSED AHEAD																	
W020-5a	48X48	16.00						2 RIGHT/CENTER/LEFT LANES CLOSED AHEAD																	
W020-6a	48X48	16.00						RIGHT/CENTER/LEFT LANE CLOSED																	
W020-7a	48X48	16.00	4	64				FLAGGER (SYMBOL)																	
W021-2	36X36	9.00						FRESH OIL																	
W021-5	48X48	16.00						SHOULDER WORK AHEAD																	
W022-1	48X48	16.00						BLASTING ZONE AHEAD																	
W022-2	42X36	10.50						TURN OFF 2-WAY RADIO AND PHONE																	
W022-3	42X36	10.50						END BLASTING ZONE																	

SUMMARY OF QUANTITIES
SHEET 5 OF 5

STATE OF MISSOURI

SHANNON M. KELLNER

NUMBER PE-201015763

PROFESSIONAL ENGINEER

THIS SHEET HAS BEEN SIGNED, SEALED AND DATED ELECTRONICALLY.

DATE PREPARED
9/4/2025

ROUTE
52

STATE
MO

DISTRICT
SW

SHEET NO.
3

COUNTY
BATES

JOB NO.
JSR0310

CONTRACT ID.

PROJECT NO.

BRIDGE NO.

DESCRIPTION

DATE

MISSOURI HIGHWAYS AND TRANSPORTATION COMMISSION

105 WEST CAPITOL

JEFFERSON CITY, MO 65102

1-888-ASK-MODOT (1-888-275-6636)

PROJECT NO.
BRIDGE NO.

[illegible]

MISSOURI HIGHWAYS AND TRANSPORTATION
COMMISSION

105 WEST CAPITOL
JEFFERSON CITY, MO 65102

1. ANY EXISTING SIGNS THAT CONFLICT WITH THE TRAFFIC CONTROL SIGNING SHALL BE COMPLETELY COVERED OR REMOVED.
2. TEMPORARY SIGNING SHOWN IS FOR WORK ON ONE SIDE OF THE ROAD. FOR WORK ON THE OTHER SIDE, REVERSE ORDER OF THE SIGNS AND CHANNELIZERS.
3. SIGNING SHOWN SHALL REMAIN IN PLACE UNTIL CONSTRUCTION IS COMPLETE.
4. ALTERNATE TRAFFIC CONTROL MAY BE USED AS NEEDED AT THE APPROVAL OF THE ENGINEER.
5. REFER TO STANDARD DRAWING 616.10, 619.10, AND 620.10 FOR ADDITIONAL DETAILS AND 903.03 FOR SIGN AND SIGN MOUNTING REQUIREMENTS.
6. SPEED LIMIT SIGNS INDICATING THE NORMAL SPEED LIMIT SHALL BE INSTALLED AT THE END OF THE WORK ZONE, PROVIDED NO FURTHER WORK ZONES WILL BE ENCOUNTERED WITHIN THE NEXT 1/2 MILE.
7. TEMPORARY SPEED LIMIT SIGNS SHALL BE COVERED OR REMOVED WHEN THE CONDITIONS REQUIRING REDUCED SPEEDS DO NOT EXIST.
8. NO DIRECT PAYMENT WILL BE MADE FOR THE RELOCATION OF CHANNELIZERS, CONSTRUCTION SIGNS, OR FLASHING ARROW PANEL.
9. ALL SIGNS SHALL BE PORTABLE MOUNT AND ARE TO BE MOVED AS WORK PROGRESSES, UNLESS OTHERWISE NOTED. ALL TRAFFIC CONTROL ITEMS SHALL BE REMOVED FROM THE ROADWAY DURING NON-WORKING HOURS.
10. THE CONTRACTOR SHALL BE RESPONSIBLE FOR IMPLEMENTING AND MAINTAINING PROPER TRAFFIC CONTROL SETUPS THROUGHOUT CONSTRUCTION AS DESCRIBED IN THESE PLANS OR AS APPROVED BY THE ENGINEER.
11. WHERE MINIMUM LANE WIDTHS CANNOT BE ACHIEVED ON THE SIDE STREETS, THE CONTRACTOR SHALL CLOSE HALF OF THE APPROACH AND POSITION A FLAGGER AT EACH END OF THE WORK AREA. LOCATION TO BE DETERMINED BY THE ENGINEER. ADVANCE FLAGGER SIGNING SHALL BE INSTALLED AS OUTLINED IN THE MUTCD.
12. THE CONTRACTOR SHALL MAINTAIN PUBLIC ACCESS TO ALL BUSINESSES AND STREETS. NO STREET OR ENTRANCE SHALL BE COMPLETELY BLOCKED.
13. SPACING & DISTANCES OF TRAFFIC CONTROL DEVICES ARE APPROXIMATE. THE EXACT LOCATIONS SHALL BE DETERMINED IN THE FIELD & APPROVED BY THE ENGINEER.
14. TRAFFIC CONTROL SHALL CONFORM TO THE LATEST EDITION OF THE MANUAL ON UNIFORM TRAFFIC CONTROL DEVICES (MUTCD).
15. ADJUST ADVANCE WARNING SIGN SPACING TO AVOID SIGN PLACEMENT WITHIN THE LIMITS OF THE RAILROAD RIGHT OF WAY.
16. CONTRACTOR SHALL COORDINATE WITH ADA PROJECT, JXXXXXX.

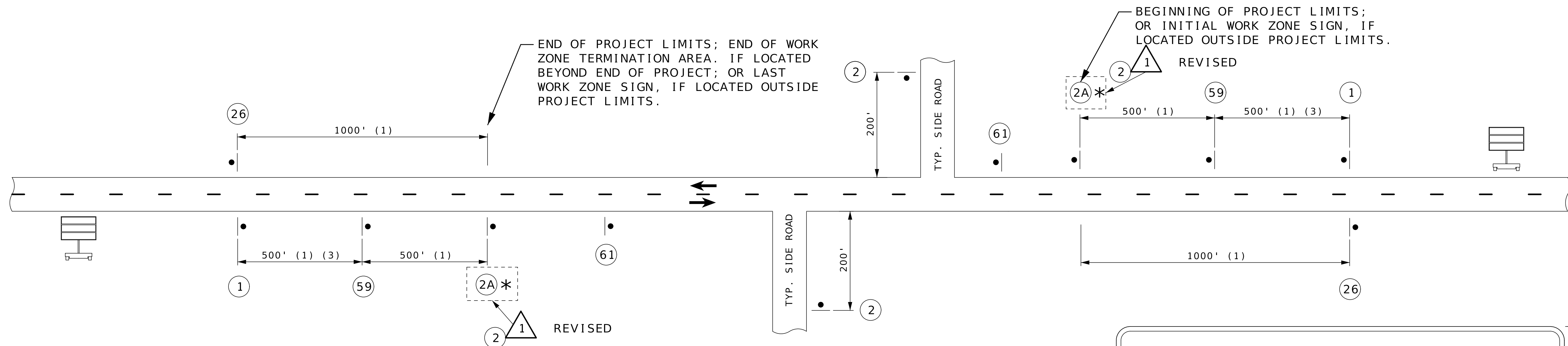

(4) CMS PLACEMENT SHALL BE APPROVED BY THE ENGINEER.

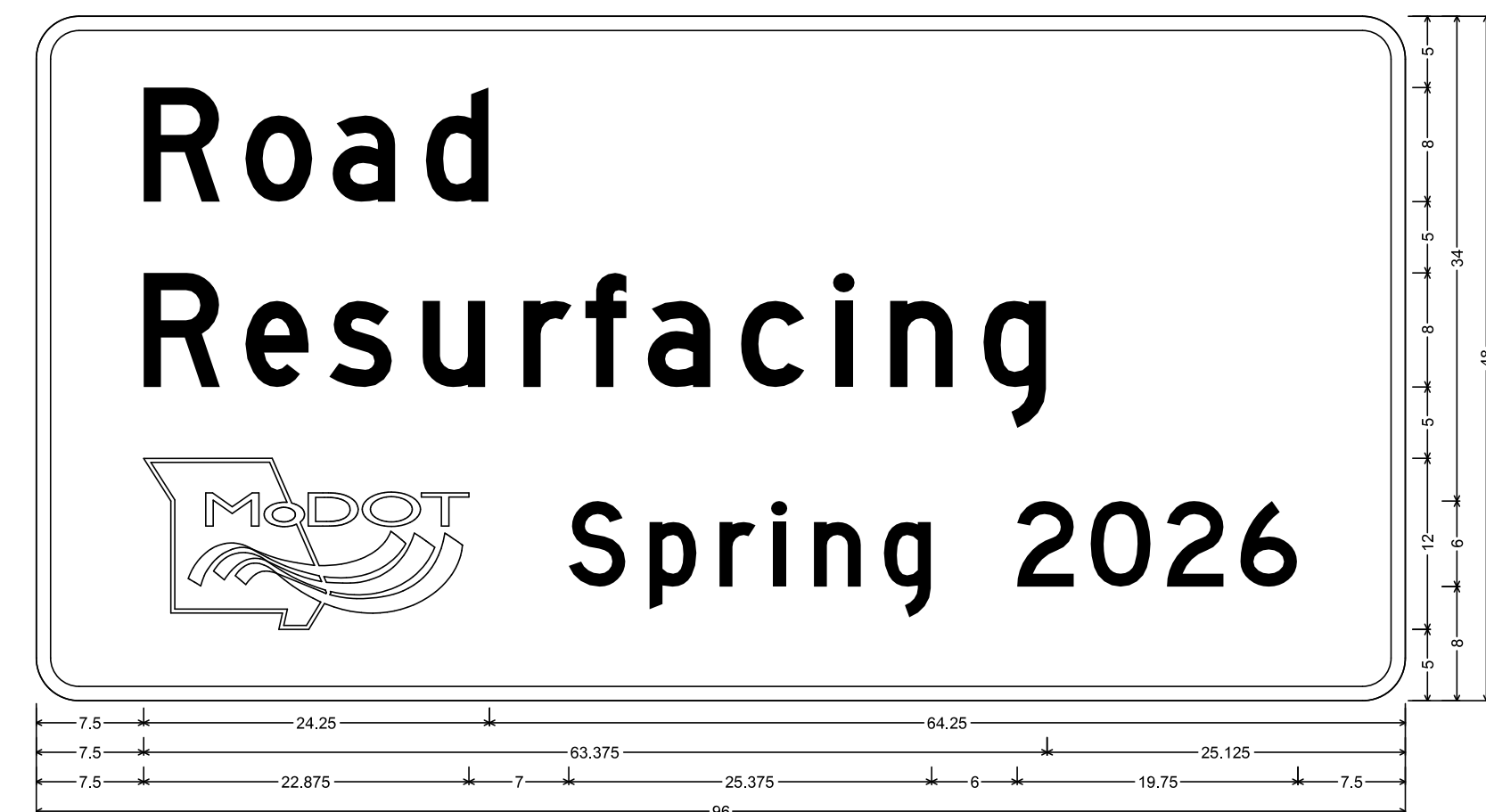
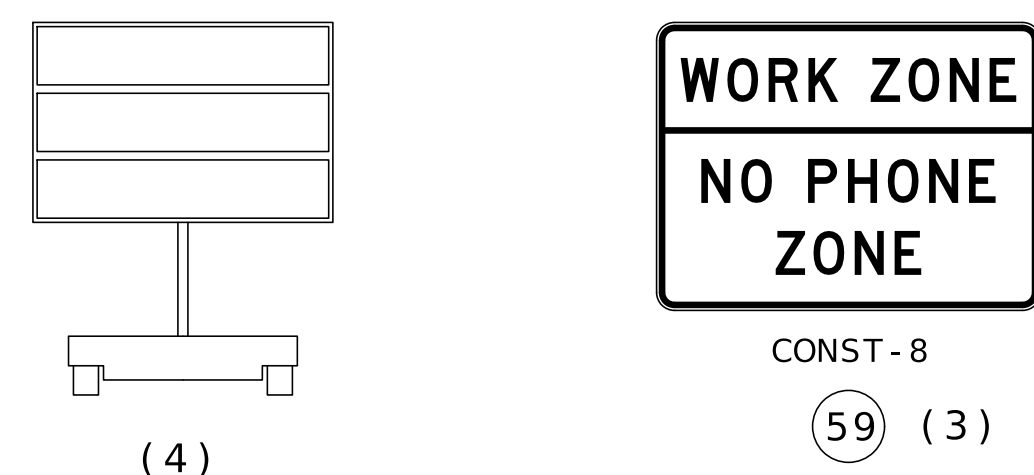
[illegible]

CONST-5-96
(61) (2)

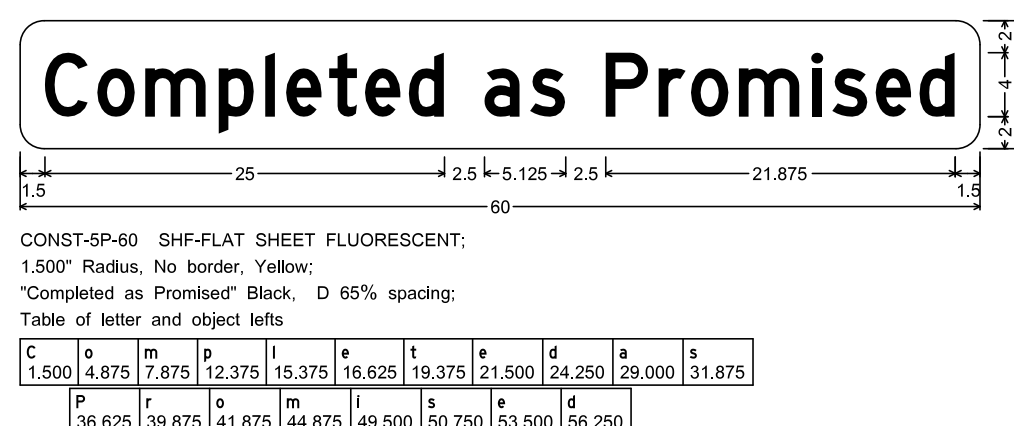

TRAFFIC CONTROL
SHEET 4 OF 9