

DISCLAIMER
THE PROFESSIONAL WHOSE SIGNATURE AND PERSONAL SEAL APPEAR HEREON ASSUMES RESPONSIBILITY ONLY FOR WHAT APPEARS ON THIS PAGE, AND DISCLAIMS (PURSUANT TO SECTION 327.411 RSMO) SPECIFICATION, ESTIMATES, REPORTS, OR OTHER DOCUMENTS OR INSTRUMENTS NOT SEALED BY THE UNDERSIGNED PROFESSIONAL RELATING TO OR INTENDED TO BE USED FOR ANY PART OR PARTS OF THE PROJECT TO WHICH THIS PAGE REFERS.

OPTIONAL PAVEMENT DESIGN	
ROUTE 370	
ASPHALT OPTION	CONCRETE OPTION
15.5" HMA 2" SP125BSM w/ PG 76-22 OVER 2" SP125B w/ PG 76-22 OVER 10.5" SP190C w/ PG 64-22 12" ROCK BASE	10" PCCP WIDEN SLAB 15 FT. JOINT SPACING, 1 1/2" DOWELS 12" ROCK BASE

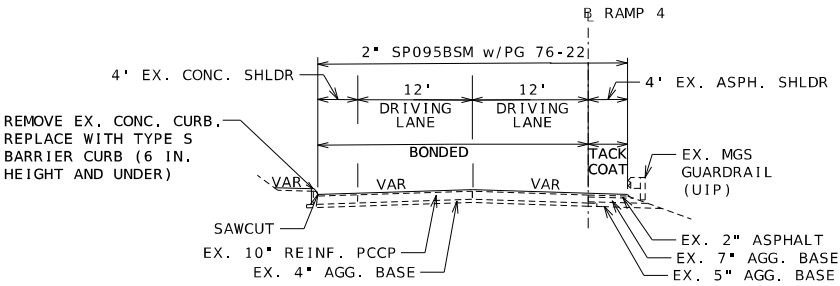

RAMP 4
RTE 370 @ RTE 94 INTERCHANGE
ST. CHARLES COUNTY
(SHOWING 2-LANE SECTION)

NOTES:
WARM MIX WILL NEED TO BE UTILIZED INSTEAD OF THE TYPICAL HOT MIX DUE TO EXISTING HOT APPLIED POLYMER PATCHES ON MAINLINE PAVEMENT.

ASPHALT UNDERSEALING SHOULD BE PERFORMED IN THE DRIVING LANES ONLY.

ASPHALT SHOULDER THAT WILL ONLY BE OVERLAYED WILL USE 2" X 2" MILL/FILL TO REMOVE EXISTING RUMBLE STRIPE PRIOR TO OVERLAY.

PRIOR TO INSTALLING PROPOSED OVERLAY ALL EXISTING RUMBLE STRIPES SHALL BE MILLED AND FILLED. ALL WORK IS COVERED UNDER PAY ITEM 613-99.07 MISC. PARITAL DEPTH CONCRETE PAVEMENT REPAIR USING HYBRID POLYMER REPAIR MATERIAL. A 2' WIDE BY 2' DEPTH WAS ASSUMED WHEN CALCULATING THE QUANTITY.

* ASPHALT SHOULDERS & SURFACES ARE TO USE TACK COAT
CONCRETE SHOULDERS & SURFACES ARE TO BE BONDED

APPLICATION RATES:

SP095BSM (PG76-22) = 1.900 TONS PER CUYD
BP-1 (PG64-22) = 1.987 TONS PER CUYD

TACK COAT = 0.10 GAL/SQYD (OVER COLDMILLED SURF.)
TACK COAT = 0.08 GAL/SQYD (OVER EX.ASPH. OR CONC SURF.)
MODIFIED TACK COAT = 0.20 GAL/SQYD

TYPICAL SECTIONS
SHEET 2 OF 3

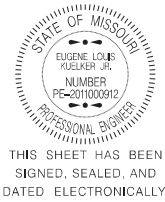

DATE PREPARED
6/25/2025

ROUTE
370
DISTRICT
SL

STATE
MO
SHEET NO.
2

COUNTY
ST. LOUIS/ST. CHARLES

JOB NO.
J6P3554

CONTRACT ID.

PROJECT NO.

BRIDGE NO.

DESCRIPTION	DATE	REVISED RUMBLE STRIP NOTE
9/9/25		

DATE
9/9/25

MISSOURI HIGHWAYS AND TRANSPORTATION
COMMISSION

105 WEST CAPITOL
JEFFERSON CITY, MO 65102
1-888-ASK-MODOT (1-888-275-6636)



HDR Engineering, Inc.
401 S. 18th Street
Suite 300
St. Louis, MO 63103-2287
314-425-8300
Certificate of Authority: 000856

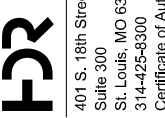

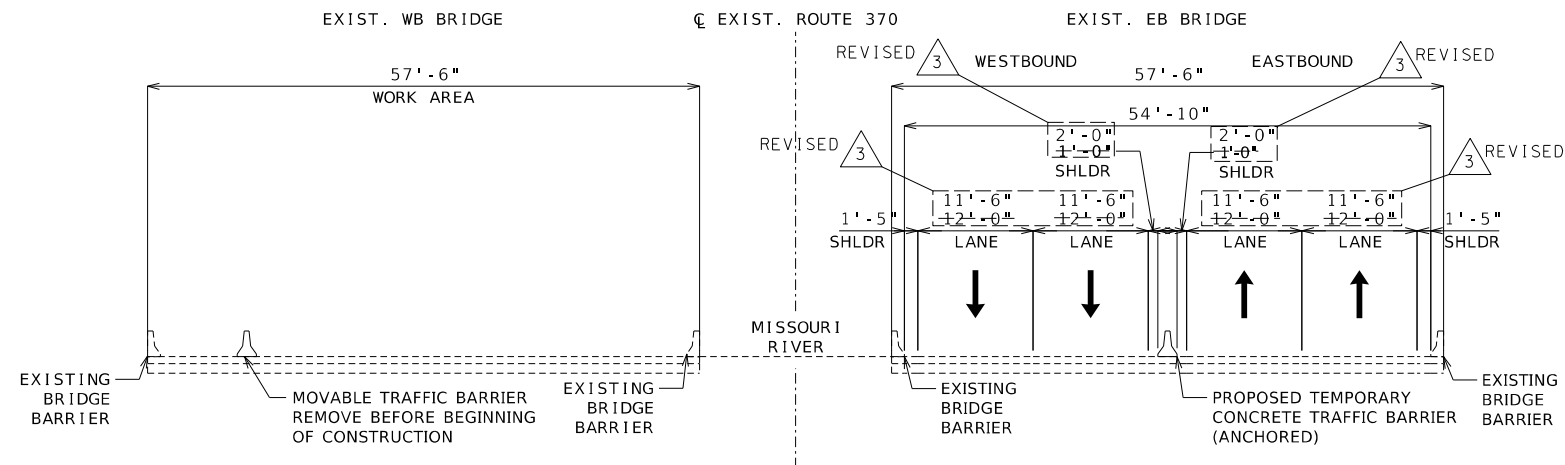

STAGE 1 - MOT PHASE ALL TRAFFIC ON EB BRIDGE

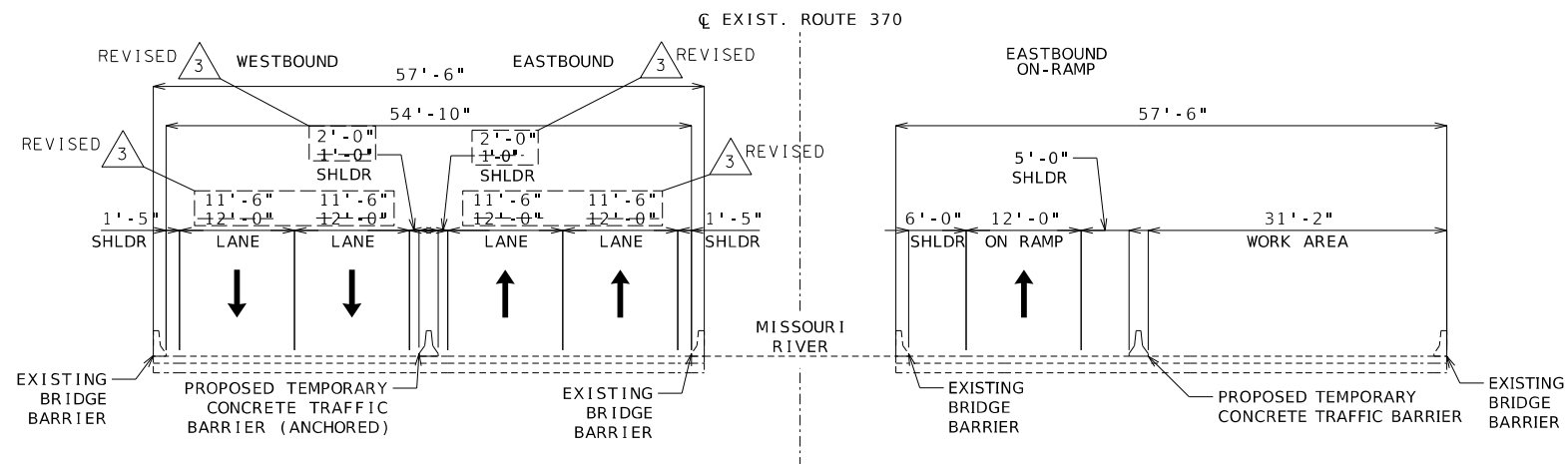

STAGE 2A - MOT PHASE ALL TRAFFIC ON WB BRIDGE
RTE 94 EB RAMP CONTINUE ON EB BRIDGE, INSIDE LANE

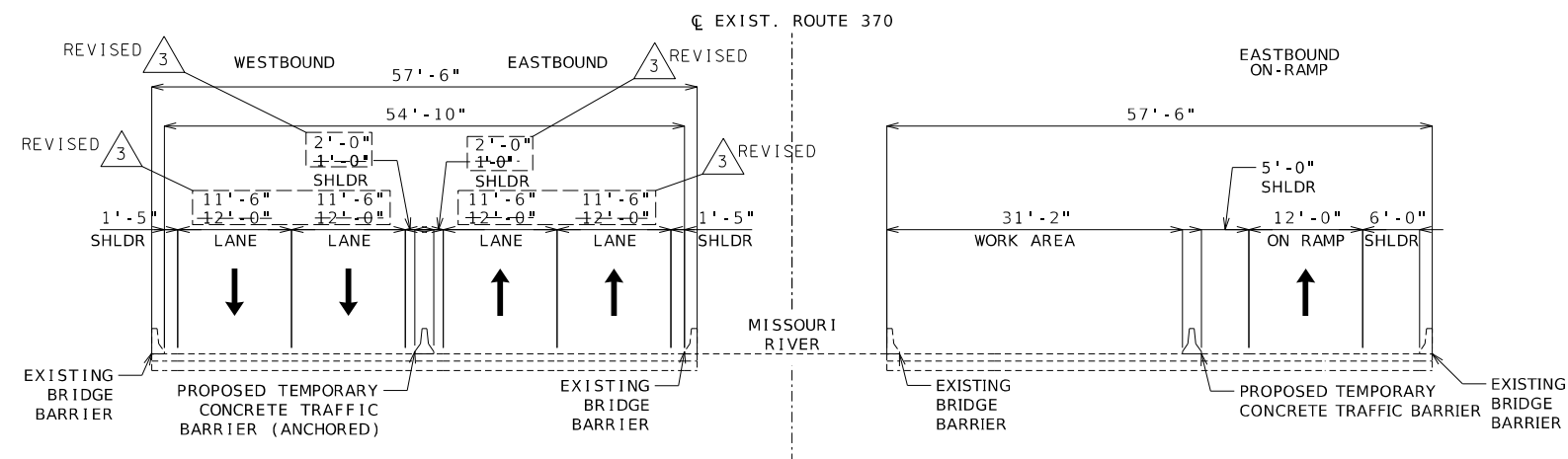

STAGE 2B - MOT PHASE ALL TRAFFIC ON WB BRIDGE
RTE 94 EB RAMP CONTINUE ON EB BRIDGE, OUTSIDE LANE

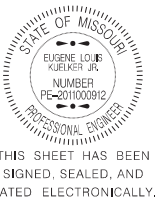
DATE PREPARED
0-1-68-10000

ROUTE	STATE
370	MO

DISTRICT	SHEET NO.
SL	2

COUNTY
LOUIS/ST. CHARLE

JOB NO.
J6P3554

CONTRACT ID.

PROJECT NO.

BRIDGE NO.

9/9/25	3- REVISED LANE AND SHOULDER WIDTHS



COMMISSION

105 WEST CAPITOL
JEFFERSON CITY, MO 65102
1-888-ASK-MODOT (1-888-275-6636)

FDR
HDR Engineering, Inc.
401 S. 18th Street
Suite 300
St. Louis, MO 63103-2267
314-425-8300
Certificate of Authority: 000856

MOT TYPICAL SECTIONS
SHEET 3 OF 3

REVISED 3

REVISED 3

REVISED 3

REMOVAL OF IMPROVEMENTS - TABLE FOR INFORMATION ONLY						
S NO.	FROM STA	TO STA	ROADWAY	LOCATION	DESCRIPTION	REMARKS
4	504+00	508+57	ROUTE 370	CL	TYPE C BARRIER	457 LF
4	508+57	509+48	ROUTE 370	CL	TYPE C MODIFIED BARRIER	91 LF
4	509+48	513+26	ROUTE 370	RT	TYPE D BARRIER	378 LF
4	509+48	513+26	ROUTE 370	LT	TYPE D BARRIER	378 LF
4	547+87	550+26	ROUTE 370	LT	TYPE D BARRIER	239 LF
4	547+87	550+26	ROUTE 370	RT	TYPE D BARRIER	239 LF
4	550+26	550+50	ROUTE 370	CL	TYPE C MODIFIED BARRIER	24 LF
4	550+50	560+42	ROUTE 370	CL	TYPE C BARRIER	992 LF
9	509+33	555+33	ROUTE 370	LT	MOVEABLE BARRIER	4600 LF REMOVE AND REPLACE
5	548+45	550+43	ROUTE 370	LT	GUARDRAIL	198 LF
5	548+36	548+79	ROUTE 370	RT	GUARDRAIL	43 LF
4	512+91	513+06	ROUTE 370	LT	CONCRETE APPROACH SLAB PAVEMENT	96.2 SY
4	512+91	513+06	ROUTE 370	RT	CONCRETE APPROACH SLAB PAVEMENT	116.7 SY
5	548+07	548+22	ROUTE 370	LT	CONCRETE APPROACH SLAB PAVEMENT	94.2 SY
5	548+07	548+22	ROUTE 370	RT	CONCRETE APPROACH SLAB PAVEMENT	96.2 SY
16	554+72		ROUTE 370	LT	IMPACT ATTENUATOR	
4	-	-	RAMP 4	LT	CONCRETE CURB	455 LF
4	-	-	RAMP 4	LT	SAWCUT	455 LF
4	513+06	513+28	ROUTE 370	LT	BRIDGE APPROACH SLAB (MAJOR)	139 SY
4	513+06	513+28	ROUTE 370	RT	BRIDGE APPROACH SLAB (MAJOR)	176 SY
5	548+86	548+07	ROUTE 370	LT	BRIDGE APPROACH SLAB (MAJOR)	134 SY
5	548+86	548+07	ROUTE 370	RT	BRIDGE APPROACH SLAB (MAJOR)	128 SY
LUMP SUM = 1						

TABLE IS PROVIDED FOR INFORMATION ONLY REMOVAL OF IMPROVEMENTS LUMP SUM INCLUDES ITEMS LISTED ON THE TABLE AND ALL OTHER INCIDENTAL REMOVALS WITHIN PLANS NECESSARY TO PERFORM THE PROPOSED WORK.

3 DELETED

3 DELETED

3 ADDED

RUMBLE STRIPS REMOVALS						
FROM STA	TO STA	ROADWAY	DIRECTION	LOCATION	PARTIAL DEPTH CONCRETE PAVEMENT REPAIR USING HYBRID POLYMER MATERIAL CY	REMOVE PRIOR TO TRAFFIC CONTROL PHASE
502+55	508+70	ROUTE 370	EB	INSIDE	7.6	STAGE 1
503+00	509+02	ROUTE 370	WB	INSIDE	7.4	STAGE 1
504+49	509+44	ROUTE 370	EB	OUTSIDE	6.1	STAGE 1
548+21	556+74	ROUTE 370	EB	OUTSIDE	10.5	STAGE 1
549+15	555+57	ROUTE 370	WB	INSIDE	7.9	STAGE 1
550+08	555+98	ROUTE 370	EB	INSIDE	7.3	STAGE 1
SUBTOTAL					46.8	
PAY TOTAL					46.8	

3 REVISED

RUMBLE STRIPS					
FROM STA	TO STA	ROADWAY	DIRECTION	LOCATION	BITUMINOUS SHOULDER RUMBLE STRIP STA
501+88	507+77	ROUTE 370	EB	OUTSIDE	5.9
501+88	512+91	ROUTE 370	EB	INSIDE	11.0
504+00	512+91	ROUTE 370	WB	OUTSIDE	8.9
504+00	512+91	ROUTE 370	WB	INSIDE	8.9
510+28	512+91	ROUTE 370	EB	OUTSIDE	2.6
548+22	560+42	ROUTE 370	WB	INSIDE	12.2
548+22	560+42	ROUTE 370	WB	OUTSIDE	12.2
548+22	560+42	ROUTE 370	EB	INSIDE	12.2
548+22	560+42	ROUTE 370	EB	OUTSIDE	12.2
SUBTOTAL					86.1
PAY TOTAL					86.1

3 DELETED

MISC. VEGETATION, REMOVAL AND TRIMMING
LUMP SUM = 1

3 ADDED

MISC. RTS REPLACEMENT
LUMP SUM = 1

MOBILIZATION
LUMP SUM = 1

MISC. LUMP SUM DRIFT MAT REMOVAL
LUMP SUM = 1

MISC. RTS REMOVAL, STORAGE, REINSTALLATION
LUMP SUM = 1

CONTRACTOR FURNISHED SURVEYING & STAKING
LUMP SUM = 1

RTS BARRIER REPLACEMENT					
SHEET NO.	STA	LOCATION	ROADWAY	MISC. RTS BARRIER UNITS EA	MISC. RTS BARRIER GUARD TOPPER EA
-	-	LT	ROUTE 370	75	175
SUBTOTAL				75	175
PAY TOTAL				75	175

* SEE JOB SPECIAL PROVISIONS

3 ADDED

SUMMARY OF QUANTITIES
SHEET 1 OF 5



THIS SHEET HAS BEEN
SIGNED, SEALED, AND
DATED ELECTRONICALLY.

DATE PREPARED

6/25/2025

ROUTE STATE

370 MO

DISTRICT SHEET NO.

SL 3

COUNTY

ST. LOUIS/ST. CHARLES

JOB NO.

J6P3554

CONTRACT ID.

PROJECT NO.

BRIDGE NO.

DATE	DESCRIPTION	ADDED AND REVISED	QUANTITY TABLES AND NOTES
9/9/25			

MISSOURI HIGHWAYS AND TRANSPORTATION
COMMISSION



105 WEST CAPITOL
JEFFERSON CITY, MO 65102
1-888-ASK-MODOT (1-888-275-6636)

HDR Engineering, Inc.

401 S. 18th Street
Suite 300
St. Louis, MO 63103-2267
314-425-8300
Certificate of Authority: 000856



IF A SEAL IS PRESENT ON THIS SHEET IT HAS BEEN ELECTRONICALLY SEALED AND DATED.

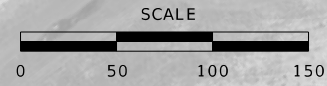
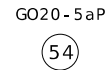

MATCHLINE STA 509+00

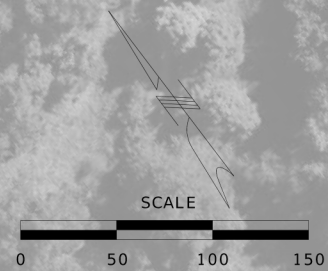
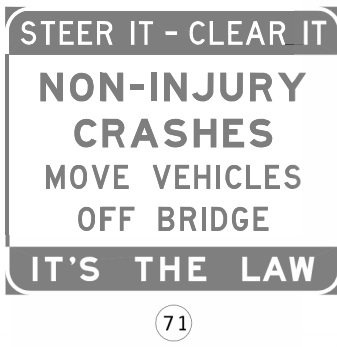

ROUTE 370
TRAFFIC CONTROL STAGE 1
STA 509+00 TO STA 522+50
SHEET 5 OF 13

HDR HDR Engineering, Inc.
401 S. 18th Street
Suite 300
St. Louis, MO 63103-2287
314-425-8300
Certificate of Authority: 000856

DATE	DESCRIPTION
9/15/25	3- REVISED LANE WIDTHS

IF A SEAL IS PRESENT ON THIS SHEET IT HAS BEEN ELECTRONICALLY SEALED AND DATED.

MATCHLINE STA 522+50

MATCHLINE STA 536+00

NON-INJURY
CRASHES
MOVE OFF
BRIDGE

70

525

530

535

MISSOURI RIVER

SCALE

0 50 100 150

ROUTE 370 WESTBOUND
ROUTE 370 EASTBOUND

1350' 4" TSW
1350' 4" TSY

1350 LF TCTB (ANCHORED)

REVISED 3

11'-6" ±2'
11'-6" ±2'
11'-6" ±2'
11'-6" ±2'

EXIST. ROUTE 370

1000' SIGN SPACING

TRAFFIC CONTROL LEGEND

- SIGN (SINGLE SIDED)
- FLASHING ARROW PANEL
- CHANNELIZER
- DIRECTIONAL INDICATOR BARRICADE
- TYPE III MOVEABLE BARRICADE
- WORK AREA
- IMPACT ATTENUATOR
- TEMPORARY CONCRETE TRAFFIC BARRIER (TCTB)
- TRAFFIC USAGE

STRIPING LEGEND

- TSY TEMPORARY SOLID YELLOW
- TSW TEMPORARY SOLID WHITE
- TIW TEMPORARY INTERMITTENT WHITE

ROUTE 370
TRAFFIC CONTROL STAGE 1
STA 522+50 TO STA 536+00
SHEET 6 OF 13

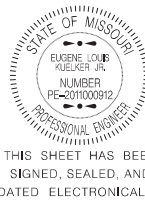

THIS SHEET HAS BEEN
SIGNED, SEALED, AND
DATED ELECTRONICALLY.

DATE PREPARED

6/25/2025

ROUTE STATE

370 MO

DISTRICT SHEET NO.

SL 18

COUNTY

ST. LOUIS/ST. CHARLES

JOB NO.

J6P3554

CONTRACT ID.

PROJECT NO.

BRIDGE NO.

DATE	DESCRIPTION
9/15/25	REVISED LANE WIDTHS

MISSOURI HIGHWAYS AND TRANSPORTATION COMMISSION



105 WEST CAPITOL
JEFFERSON CITY, MO 65102
1-888-ASK-MODOT (1-888-275-6636)

HDR Engineering, Inc.

401 S. 18th Street
Suite 300
St. Louis, MO 63103-2267
314-425-6300
Certificate of Authority: 000856

IF A SEAL IS PRESENT ON THIS SHEET IT HAS BEEN ELECTRONICALLY SEALED AND DATED.

MATCHLINE STA 536+00

MATCHLINE STA 549+50



R4-1
(46)



R9-9
(56)

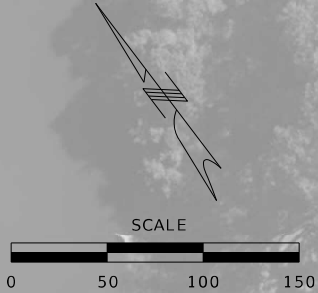

2 TYPE III
MOVABLE BARRICADES

50 LF TCTB
STA 549+41.00

540

545

ROUTE 370 WESTBOUND
ROUTE 370 EASTBOUND

(46)

1350' 4" TSW
1350' 4" TSY

1350 LF TCTB (ANCHORED)

REVISED 3

11'-6" 12'
11'-6" 12'
11'-6" 12'
11'-6" 12'

EXIST. ROUTE 370

1000' SIGN SPACING

1000' SIGN SPACING

TRAFFIC CONTROL LEGEND

- SIGN (SINGLE SIDED)
- FLASHING ARROW PANEL
- CHANNELIZER
- DIRECTIONAL INDICATOR BARRICADE
- TYPE III MOVEABLE BARRICADE
- WORK AREA
- IMPACT ATTENUATOR
- TEMPORARY CONCRETE TRAFFIC BARRIER (TCTB)
- TRAFFIC USAGE

STRIPING LEGEND

- TSY TEMPORARY SOLID YELLOW
- TSW TEMPORARY SOLID WHITE
- TIW TEMPORARY INTERMITTENT WHITE

ROUTE 370
TRAFFIC CONTROL STAGE 1
STA 536+00 TO STA 549+50
SHEET 7 OF 13

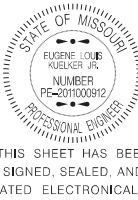

THIS SHEET HAS BEEN
SIGNED, SEALED, AND
DATED ELECTRONICALLY.

DATE PREPARED

6/25/2025

ROUTE STATE

370 MO

DISTRICT SHEET NO.

SL 19

COUNTY

ST. LOUIS/ST. CHARLES

JOB NO.

J6P3554

CONTRACT ID.

PROJECT NO.

BRIDGE NO.

DATE	DESCRIPTION
9/15/25	REVISED LANE WIDTHS

MISSOURI HIGHWAYS AND TRANSPORTATION
COMMISSION



105 WEST CAPITOL
JEFFERSON CITY, MO 65102
1-888-ASK-MODOT (1-888-275-6636)

HDR Engineering, Inc.

401 S. 18th Street
Suite 300
St. Louis, MO 63103-2267
314-425-8300
Certificate of Authority: 000856

IF A SEAL IS PRESENT ON THIS SHEET IT HAS BEEN ELECTRONICALLY SEALED AND DATED.

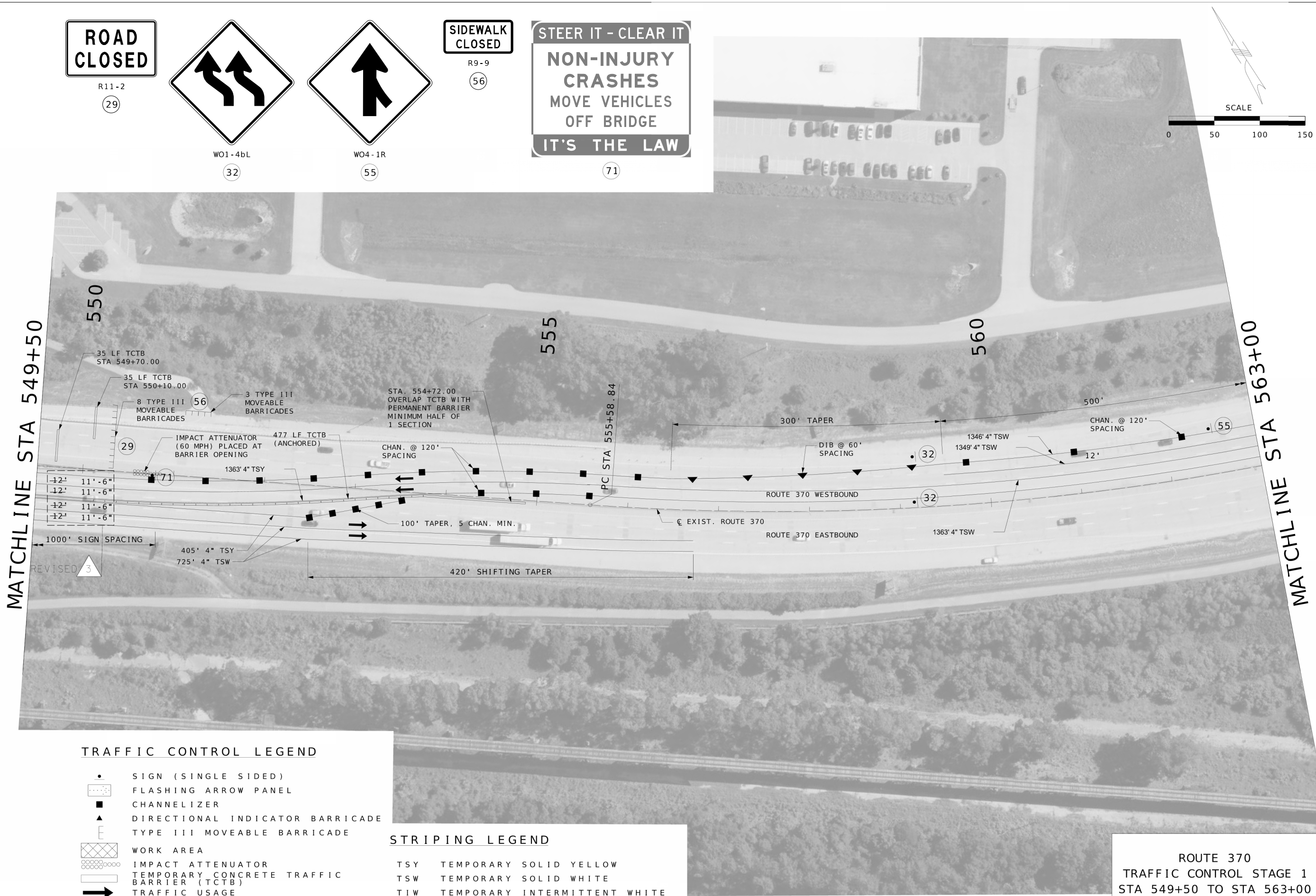

ROAD
CLOSED

R11-2

(29)

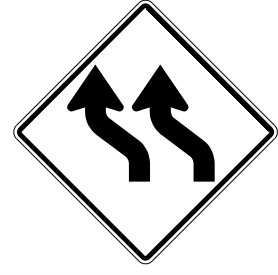

WO1-4bL

(32)

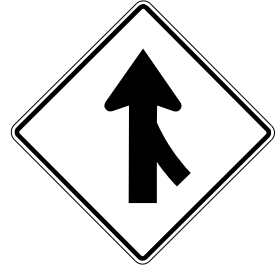

WO4-1R

(55)

SIDEWALK
CLOSED

R9-9

(56)

STEER IT - CLEAR IT
NON-INJURY
CRASHES
MOVE VEHICLES
OFF BRIDGE
IT'S THE LAW

(71)



SCALE



THIS SHEET HAS BEEN
SIGNED, SEALED, AND
DATED ELECTRONICALLY.

DATE PREPARED
6/25/2025

ROUTE
370

STATE
MO

DISTRICT
SL

SHEET NO.
20

COUNTY
ST. LOUIS/ST. CHARLES

JOB NO.
J6P3554

CONTRACT ID.

PROJECT NO.

BRIDGE NO.

DESCRIPTION

DATE

9/15/25

3-

REVISED LANE WIDTHS

DATE

9/15/25

3-

REVISED LANE WIDTHS

DATE

9/15/25

3-

REVISED LANE WIDTHS

DATE

9/15/25

3-

REVISED LANE WIDTHS

DATE

9/15/25

3-

REVISED LANE WIDTHS

DATE

9/15/25

3-

REVISED LANE WIDTHS

DATE

9/15/25

3-

REVISED LANE WIDTHS

DATE

9/15/25

3-

REVISED LANE WIDTHS

DATE

9/15/25

3-

REVISED LANE WIDTHS

DATE

9/15/25

3-

REVISED LANE WIDTHS

DATE

9/15/25

3-

REVISED LANE WIDTHS

DATE

9/15/25

3-

REVISED LANE WIDTHS

DATE

9/15/25

3-

REVISED LANE WIDTHS

DATE

9/15/25

3-

REVISED LANE WIDTHS

DATE

9/15/25

3-

REVISED LANE WIDTHS

DATE

9/15/25

3-

REVISED LANE WIDTHS

DATE

9/15/25

3-

REVISED LANE WIDTHS

DATE

9/15/25

3-

REVISED LANE WIDTHS

DATE

9/15/25

3-

REVISED LANE WIDTHS

DATE

9/15/25

3-

REVISED LANE WIDTHS

DATE

9/15/25

3-

REVISED LANE WIDTHS

DATE

9/15/25

3-

REVISED LANE WIDTHS

DATE

9/15/25

3-

REVISED LANE WIDTHS

DATE

9/15/25

3-

REVISED LANE WIDTHS

DATE

9/15/25

3-

REVISED LANE WIDTHS

DATE

9/15/25

3-

REVISED LANE WIDTHS

DATE

9/15/25

3-

REVISED LANE WIDTHS

DATE

9/15/25

3-

REVISED LANE WIDTHS

DATE

9/15/25

3-

REVISED LANE WIDTHS

DATE

9/15/25

3-

REVISED LANE WIDTHS

DATE

9/15/25

3-

REVISED LANE WIDTHS

DATE

9/15/25

3-

REVISED LANE WIDTHS

DATE

9/15/25

3-

REVISED LANE WIDTHS

DATE

9/15/25

3-

REVISED LANE WIDTHS

DATE

9/15/25

3-

REVISED LANE WIDTHS

DATE

9/15/25

3-

REVISED LANE WIDTHS

DATE

9/15/25

3-

REVISED LANE WIDTHS

DATE

9/15/25

3-

REVISED LANE WIDTHS

DATE

9/15/25

3-

REVISED LANE WIDTHS

DATE

9/15/25

3-

REVISED LANE WIDTHS

DATE

9/15/25

3-

REVISED LANE WIDTHS

DATE

9/15/25

3-

REVISED LANE WIDTHS

DATE

9/15/25

3-

REVISED LANE WIDTHS

DATE

9/15/25

3-

REVISED LANE WIDTHS

DATE

9/15/25

3-

REVISED LANE WIDTHS

DATE

9/15/25

3-

REVISED LANE WIDTHS

DATE

9/15/25

3-

REVISED LANE WIDTHS

DATE

9/15/25

3-

REVISED LANE WIDTHS

DATE

9/15/25

3-

REVISED LANE WIDTHS

DATE

9/15/25

3-

REVISED LANE WIDTHS

DATE

9/15/25

3-

REVISED LANE WIDTHS

DATE

9/15/25

3-

REVISED LANE WIDTHS

DATE

9/15/25

3-

REVISED LANE WIDTHS

DATE

9/15/25

3-

REVISED LANE WIDTHS

DATE

9/15/25

3-

REVISED LANE WIDTHS

DATE

9/15/25

3-

REVISED LANE WIDTHS

DATE

9/15/25

3-

REVISED LANE WIDTHS

DATE

9/15/25

3-

REVISED LANE WIDTHS

DATE

9/15/25

3-

REVISED LANE WIDTHS

DATE

9/15/25

3-

REVISED LANE WIDTHS

DATE

9/15/25

3-

REVISED LANE WIDTHS

DATE

9/15/25

3-

REVISED LANE WIDTHS

DATE

9/15/25

3-

REVISED LANE WIDTHS

DATE

9/15/25

3-

REVISED LANE WIDTHS

DATE

9/15/25

3-

REVISED LANE WIDTHS

DATE

9/15/25

3-

REVISED LANE WIDTHS

DATE

9/15/25

3-

REVISED LANE WIDTHS

DATE

9/15/25

3-

REVISED LANE WIDTHS

DATE

9/15/25

3-

REVISED LANE WIDTHS

DATE

9/15/25

3-

REVISED LANE WIDTHS

DATE

9/15/25

3-

REVISED LANE WIDTHS

DATE

9/15/25

3-

REVISED



WO20-1
(2)



WO20-5
(5R)



WO1-8a
(16A)



R11-2
(29)

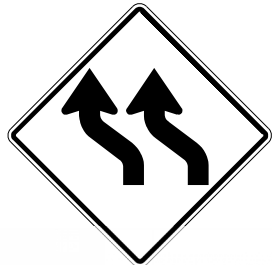

WO1-4bL
(32)



GO20-5aP
(54)



R2-1
(4)



R9-9
(56)



(71)

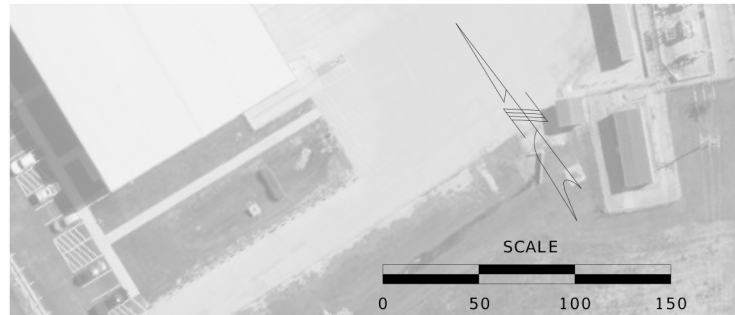

MATCHLINE STA 495+50

MATCHLINE STA 509+00

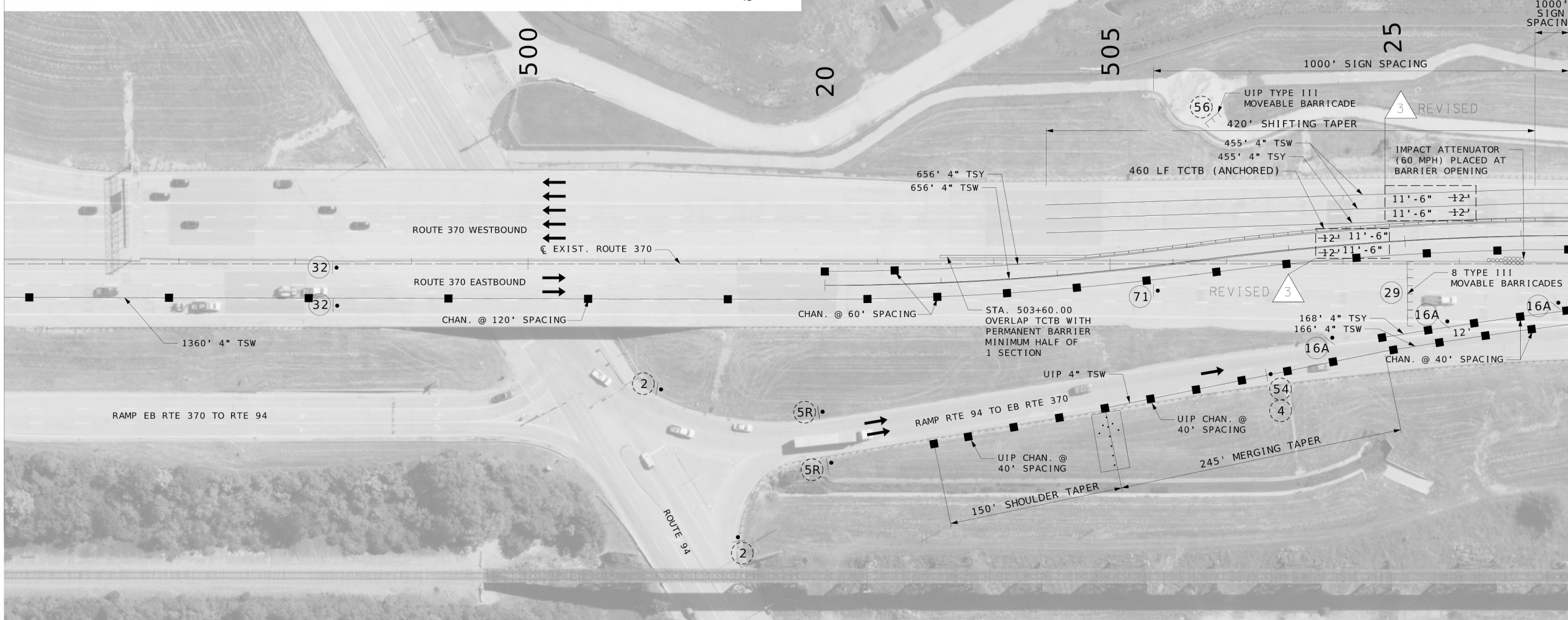

TRAFFIC CONTROL LEGEND

- SIGN (SINGLE SIDED)
- FLASHING ARROW PANEL
- CHANNELIZER
- ▲ DIRECTIONAL INDICATOR BARRICADE
- TYPE III MOVEABLE BARRICADE
- WORK AREA
- IMPACT ATTENUATOR
- TEMPORARY CONCRETE TRAFFIC BARRIER (TCTB)
- TRAFFIC USAGE
- PLACED IN PREVIOUS PHASE

STRIPING LEGEND

- TSY TEMPORARY SOLID YELLOW
- TSW TEMPORARY SOLID WHITE
- TIW TEMPORARY INTERMITTENT WHITE

ROUTE 370
TRAFFIC CONTROL STAGE 2A
STA 495+50 TO STA 509+00
SHEET 4 OF 11

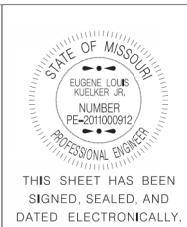

DATE PREPARED
6/25/2025
ROUTE
370
STATE
MO
DISTRICT
SL
SHEET NO.
29
COUNTY
ST. LOUIS/ST. CHARLES
JOB NO.
J6P3554
CONTRACT ID.

PROJECT NO.

BRIDGE NO.

DATE	DESCRIPTION
9/15/25	3- REVISED LANE WIDTHS

MISSOURI HIGHWAYS AND TRANSPORTATION
COMMISSION



105 WEST CAPITOL
JEFFERSON CITY, MO 65102
1-888-ASK-MODOT (1-888-275-6636)

HDR Engineering, Inc.



401 S. 18th Street
Suite 300
St. Louis, MO 63103-2267
314-425-8300
Certificate of Authority: 000856

IF A SEAL IS PRESENT ON THIS SHEET IT HAS BEEN ELECTRONICALLY SEALED AND DATED.

MATCHLINE STA 509+00

MATCHLINE STA 522+50

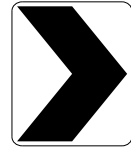

WO1-8a

16A



R4-1

46



R9-9

56



70



71

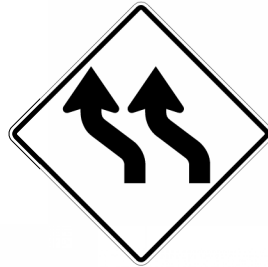

WO1-4bL

32

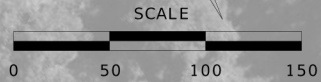

SCALE

TRAFFIC CONTROL LEGEND

- SIGN (SINGLE SIDED)
- ◻ FLASHING ARROW PANEL
- ◼ CHANNELIZER
- ▲ DIRECTIONAL INDICATOR BARRICADE
- ◻ TYPE III MOVEABLE BARRICADE
- ◻ WORK AREA
- ◻ IMPACT ATTENUATOR
- ◻ TEMPORARY CONCRETE TRAFFIC BARRIER (TCTB)
- ◻ TRAFFIC USAGE
- ◻ PLACED IN PREVIOUS PHASE

STRIPING LEGEND

- TSY TEMPORARY SOLID YELLOW
- TSW TEMPORARY SOLID WHITE
- TIW TEMPORARY INTERMITTENT WHITE

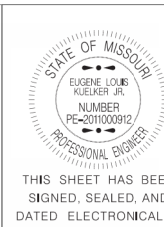

THIS SHEET HAS BEEN
SIGNED, SEALED, AND
DATED ELECTRONICALLY.

DATE PREPARED
6/25/2025

ROUTE STATE
370 MO

DISTRICT SHEET NO.
SL 30

COUNTY
ST. LOUIS/ST. CHARLES

JOB NO.
J6P3554

CONTRACT ID.

PROJECT NO.

BRIDGE NO.

DATE	DESCRIPTION
9/15/25	3- REVISED LANE WIDTHS

MISSOURI HIGHWAYS AND TRANSPORTATION
COMMISSION



105 WEST CAPITOL
JEFFERSON CITY, MO 65102
1-888-ASK-MODOT (1-888-275-6636)

HDR Engineering, Inc.



401 S. 18th Street
Suite 300
St. Louis, MO 63103-2267
314-425-8300
Certificate of Authority: 000856

ROUTE 370
TRAFFIC CONTROL STAGE 2A
STA 509+00 TO STA 522+50
SHEET 5 OF 11

IF A SEAL IS PRESENT ON THIS SHEET IT HAS BEEN ELECTRONICALLY SEALED AND DATED.



R4-1
(46)



(70)

MATCHLINE STA 522+50

525

530

535

MATCHLINE STA 536+00

TRAFFIC CONTROL LEGEND

- SIGN (SINGLE SIDED)
- FLASHER FLASHING ARROW PANEL
- CHANNELIZER
- ▲ DIRECTIONAL INDICATOR BARRICADE
- E TYPE III MOVEABLE BARRICADE
- WORK AREA
- IMPACT ATTENUATOR
- TEMPORARY CONCRETE TRAFFIC BARRIER (TCTB)
- TRAFFIC USAGE
- PLACED IN PREVIOUS PHASE

STRIPING LEGEND

- TSY TEMPORARY SOLID YELLOW
- TSW TEMPORARY SOLID WHITE
- TIW TEMPORARY INTERMITTENT WHITE

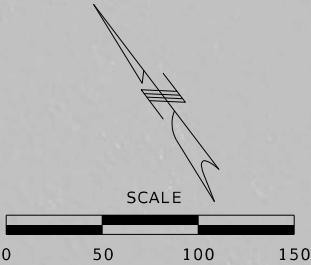
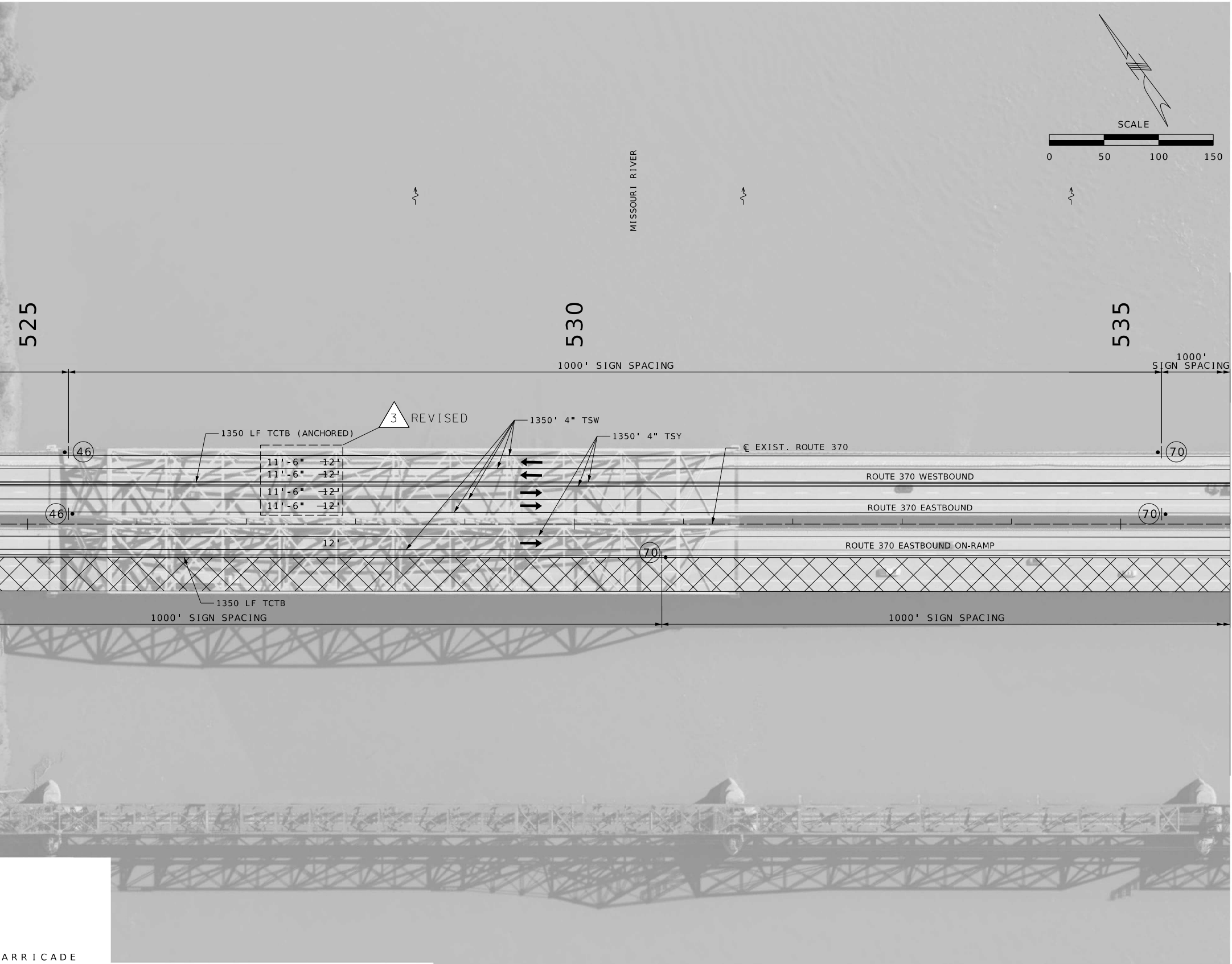

ROUTE 370
TRAFFIC CONTROL STAGE 2A
STA 522+50 TO STA 536+00
SHEET 6 OF 11

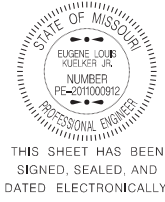

DATE PREPARED
6/25/2025
ROUTE
370
STATE
MO
DISTRICT
SL
SHEET NO.
31
COUNTY
ST. LOUIS/ST. CHARLES
JOB NO.
J6P3554
CONTRACT ID.
PROJECT NO.
BRIDGE NO.

DATE	DESCRIPTION
9/15/25	REVISED LANE WIDTHS

MISSOURI HIGHWAYS AND TRANSPORTATION COMMISSION
MoDOT
105 WEST CAPITOL
JEFFERSON CITY, MO 65102
1-888-ASK-MODOT (1-888-275-6636)

HDR Engineering, Inc.
401 S. 18th Street
Suite 300
St. Louis, MO 63103-2267
314-425-8300
Certificate of Authority: 000856

IF A SEAL IS PRESENT ON THIS SHEET IT HAS BEEN ELECTRONICALLY SEALED AND DATED.



W01-4R
(15)

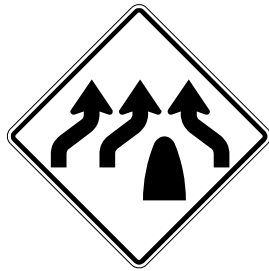

(57)



W013-1
(34)



R4-1
(46)



R9-9
(56)

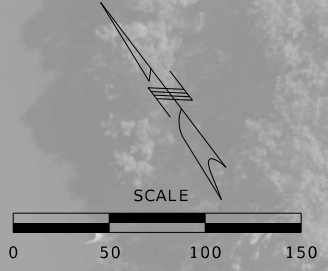

SCALE

MATCHLINE STA 536+00

MATCHLINE STA 549+50

TRAFFIC CONTROL LEGEND

- SIGN (SINGLE SIDED)
- ◻ FLASHING ARROW PANEL
- ◼ CHANNELIZER
- ▲ DIRECTIONAL INDICATOR BARRICADE
- E TYPE III MOVEABLE BARRICADE
- ◻ WORK AREA
- ◻ IMPACT ATTENUATOR
- ◻ TEMPORARY CONCRETE TRAFFIC BARRIER (TCTB)
- ◻ TRAFFIC USAGE
- ◻ PLACED IN PREVIOUS PHASE

STRIPING LEGEND

- TSY TEMPORARY SOLID YELLOW
- TSW TEMPORARY SOLID WHITE
- TIW TEMPORARY INTERMITTENT WHITE

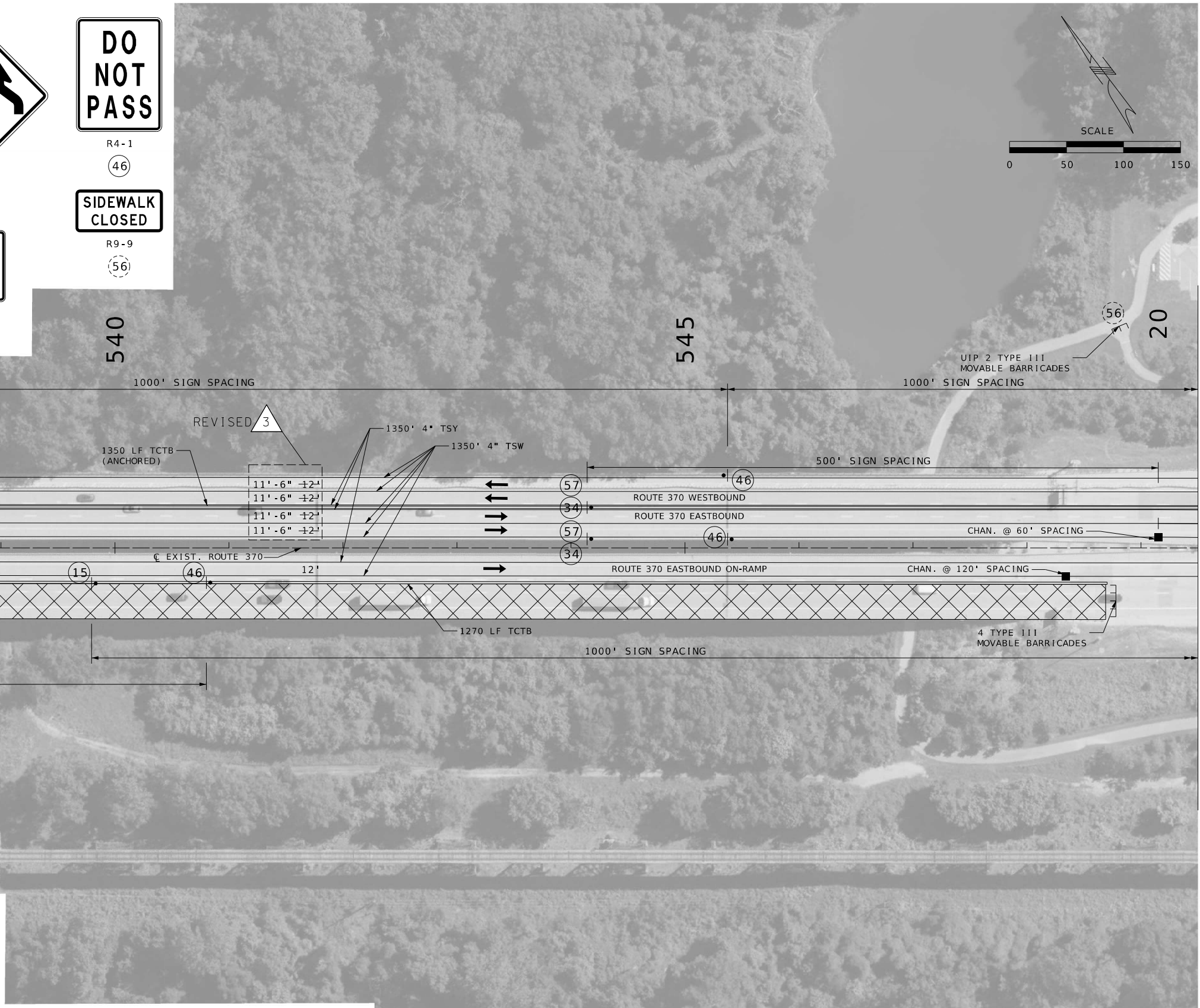

ROUTE 370
TRAFFIC CONTROL STAGE 2A
STA 536+00 TO STA 549+50
SHEET 7 OF 11

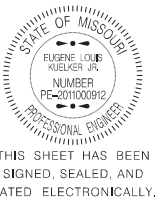

THIS SHEET HAS BEEN
SIGNED, SEALED, AND
DATED ELECTRONICALLY.

DATE PREPARED
6/25/2025

ROUTE 370 STATE MO

DISTRICT SL SHEET NO. 32

COUNTY

ST. LOUIS/ST. CHARLES

JOB NO.
J6P3554

CONTRACT ID.

PROJECT NO.

BRIDGE NO.

DATE	DESCRIPTION
9/15/25	REVISED LANE WIDTHS

MISSOURI HIGHWAYS AND TRANSPORTATION
COMMISSION

MoDOT

105 WEST CAPITOL
JEFFERSON CITY, MO 65102
1-888-ASK-MODOT (1-888-275-6636)

HDR Engineering, Inc.

401 S. 18th Street
Suite 300
St. Louis, MO 63103-2267
314-425-8300
Certificate of Authority: 000856

IF A SEAL IS PRESENT ON THIS SHEET IT HAS BEEN ELECTRONICALLY SEALED AND DATED.

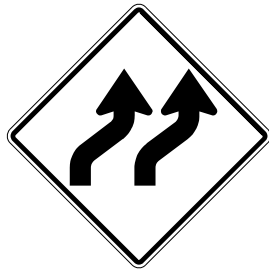

W01-4bR

32

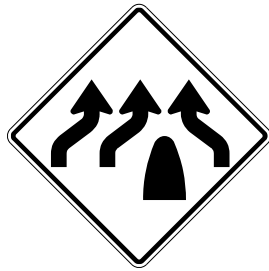

57

STEER IT - CLEAR IT
NON-INJURY
CRASHES
MOVE VEHICLES
OFF BRIDGE
IT'S THE LAW

71

SIDEWALK
CLOSED

R9-9

56



SCALE

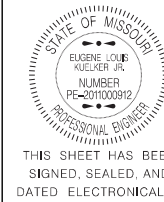

THIS SHEET HAS BEEN
SIGNED, SEALED, AND
DATED ELECTRONICALLY.

DATE PREPARED
6/25/2025

ROUTE STATE
370 MO

DISTRICT SHEET NO.
SL 33

COUNTY
ST. LOUIS/ST. CHARLES

JOB NO.
J6P3554

CONTRACT ID.

PROJECT NO.

BRIDGE NO.

DESCRIPTION

DATE

9/15/25

3- REVISED LANE WIDTHS

DATE

9/15/25

3- REVISED LANE WIDTHS

DATE

9/15/25

3- REVISED LANE WIDTHS

DATE

9/15/25

3- REVISED LANE WIDTHS

DATE

9/15/25

3- REVISED LANE WIDTHS

DATE

9/15/25

3- REVISED LANE WIDTHS

DATE

9/15/25

3- REVISED LANE WIDTHS

DATE

9/15/25

3- REVISED LANE WIDTHS

DATE

9/15/25

3- REVISED LANE WIDTHS

DATE

9/15/25

3- REVISED LANE WIDTHS

DATE

9/15/25

3- REVISED LANE WIDTHS

DATE

9/15/25

3- REVISED LANE WIDTHS

DATE

9/15/25

3- REVISED LANE WIDTHS

DATE

9/15/25

3- REVISED LANE WIDTHS

DATE

9/15/25

3- REVISED LANE WIDTHS

DATE

9/15/25

3- REVISED LANE WIDTHS

DATE

9/15/25

3- REVISED LANE WIDTHS

DATE

9/15/25

3- REVISED LANE WIDTHS

DATE

9/15/25

3- REVISED LANE WIDTHS

DATE

9/15/25

3- REVISED LANE WIDTHS

DATE

9/15/25

3- REVISED LANE WIDTHS

DATE

9/15/25

3- REVISED LANE WIDTHS

DATE

9/15/25

3- REVISED LANE WIDTHS

DATE

9/15/25

3- REVISED LANE WIDTHS

DATE

9/15/25

3- REVISED LANE WIDTHS

DATE

9/15/25

3- REVISED LANE WIDTHS

DATE

9/15/25

3- REVISED LANE WIDTHS

DATE

9/15/25

3- REVISED LANE WIDTHS

DATE

9/15/25

3- REVISED LANE WIDTHS

DATE

9/15/25

3- REVISED LANE WIDTHS

DATE

9/15/25

3- REVISED LANE WIDTHS

DATE

9/15/25

3- REVISED LANE WIDTHS

DATE

9/15/25

3- REVISED LANE WIDTHS

DATE

9/15/25

3- REVISED LANE WIDTHS

DATE

9/15/25

3- REVISED LANE WIDTHS

DATE

9/15/25

3- REVISED LANE WIDTHS

DATE

9/15/25

3- REVISED LANE WIDTHS

DATE

9/15/25

3- REVISED LANE WIDTHS

DATE

9/15/25

3- REVISED LANE WIDTHS

DATE

9/15/25

3- REVISED LANE WIDTHS

DATE

9/15/25

3- REVISED LANE WIDTHS

DATE

9/15/25

3- REVISED LANE WIDTHS

DATE

9/15/25

3- REVISED LANE WIDTHS

DATE

9/15/25

3- REVISED LANE WIDTHS

DATE

9/15/25

3- REVISED LANE WIDTHS

DATE

9/15/25

3- REVISED LANE WIDTHS

DATE

9/15/25

3- REVISED LANE WIDTHS

DATE

9/15/25

3- REVISED LANE WIDTHS

DATE

9/15/25

3- REVISED LANE WIDTHS

DATE

9/15/25

3- REVISED LANE WIDTHS

DATE

9/15/25

3- REVISED LANE WIDTHS

DATE

9/15/25

3- REVISED LANE WIDTHS

DATE

9/15/25

3- REVISED LANE WIDTHS

DATE

9/15/25

3- REVISED LANE WIDTHS

DATE

9/15/25

3- REVISED LANE WIDTHS

DATE

9/15/25

3- REVISED LANE WIDTHS

DATE

9/15/25

3- REVISED LANE WIDTHS

DATE

9/15/25

3- REVISED LANE WIDTHS

DATE

9/15/25

3- REVISED LANE WIDTHS

DATE

9/15/25

3- REVISED LANE WIDTHS

DATE

9/15/25

3- REVISED LANE WIDTHS

DATE

9/15/25

3- REVISED LANE WIDTHS

DATE

9/15/25

3- REVISED LANE WIDTHS

DATE

9/15/25

3- REVISED LANE WIDTHS

DATE

9/15/25

3- REVISED LANE WIDTHS

DATE

9/15/25

3- REVISED LANE WIDTHS

DATE

9/15/25

3- REVISED LANE WIDTHS

DATE

9/15/25

3- REVISED LANE WIDTHS

DATE

9/15/25

3- REVISED LANE WIDTHS

DATE

9/15/25

3- REVISED LANE WIDTHS

DATE

9/15/25

3- REVISED LANE WIDTHS

DATE

9/15/25

3- REVISED LANE WIDTHS

DATE

9/15/25

3- REVISED LANE WIDTHS

DATE

9/15/25

3- REVISED LANE WIDTHS

DATE

9/15/25

3- REVISED LANE WIDTHS

DATE

9/15/25

3- REVISED LANE WIDTHS

DATE

9/15/25

3- REVISED LANE WIDTHS

DATE

9/15/25

3- REVISED LANE WIDTHS

DATE

9/15/25

3- REVISED LANE WIDTHS

DATE

9/15/25

3- REVISED LANE WIDTHS

DATE

9/15/25

3- REVISED LANE WIDTHS

DATE

9/15/25

3- REVISED LANE WIDTHS

DATE

9/15/25

3- REVISED LANE WIDTHS

DATE

9/15/25

3- REVISED LANE WIDTHS

DATE

9/15/25

3- REVISED LANE WIDTHS

DATE

9/15/25

3- REVISED LANE WIDTHS

DATE

9/15/25

3- REVISED LANE WIDTHS

DATE

9/15/25

3- REVISED LANE WIDTHS

DATE

9/15/25

3- REVISED LANE WIDTHS

DATE

9/15/25

3- REVISED LANE WIDTHS

DATE

9/15/25

3- REVISED LANE WIDTHS

DATE

9/15/25

3- REVISED LANE WIDTHS

DATE

9/15/25

3- REVISED LANE WIDTHS

DATE

9/15/25

3- REVISED LANE WIDTHS

DATE

9/15/25

MATCHLINE STA 495+50

MATCHLINE STA 509+00

TRAFFIC CONTROL LEGEND

- SIGN (SINGLE SIDED)
- FLASHING ARROW PANEL
- CHANNELIZER
- ▲ DIRECTIONAL INDICATOR BARRICADE
- TYPE III MOVEABLE BARRICADE
- WORK AREA
- IMPACT ATTENUATOR
- TEMPORARY CONCRETE TRAFFIC BARRIER (TCTB)
- TRAFFIC USAGE
- ↓ PLACED IN PREVIOUS PHASE

STRIPING LEGEND

- TSY TEMPORARY SOLID YELLOW
- TSW TEMPORARY SOLID WHITE
- TIW TEMPORARY INTERMITTENT WHITE

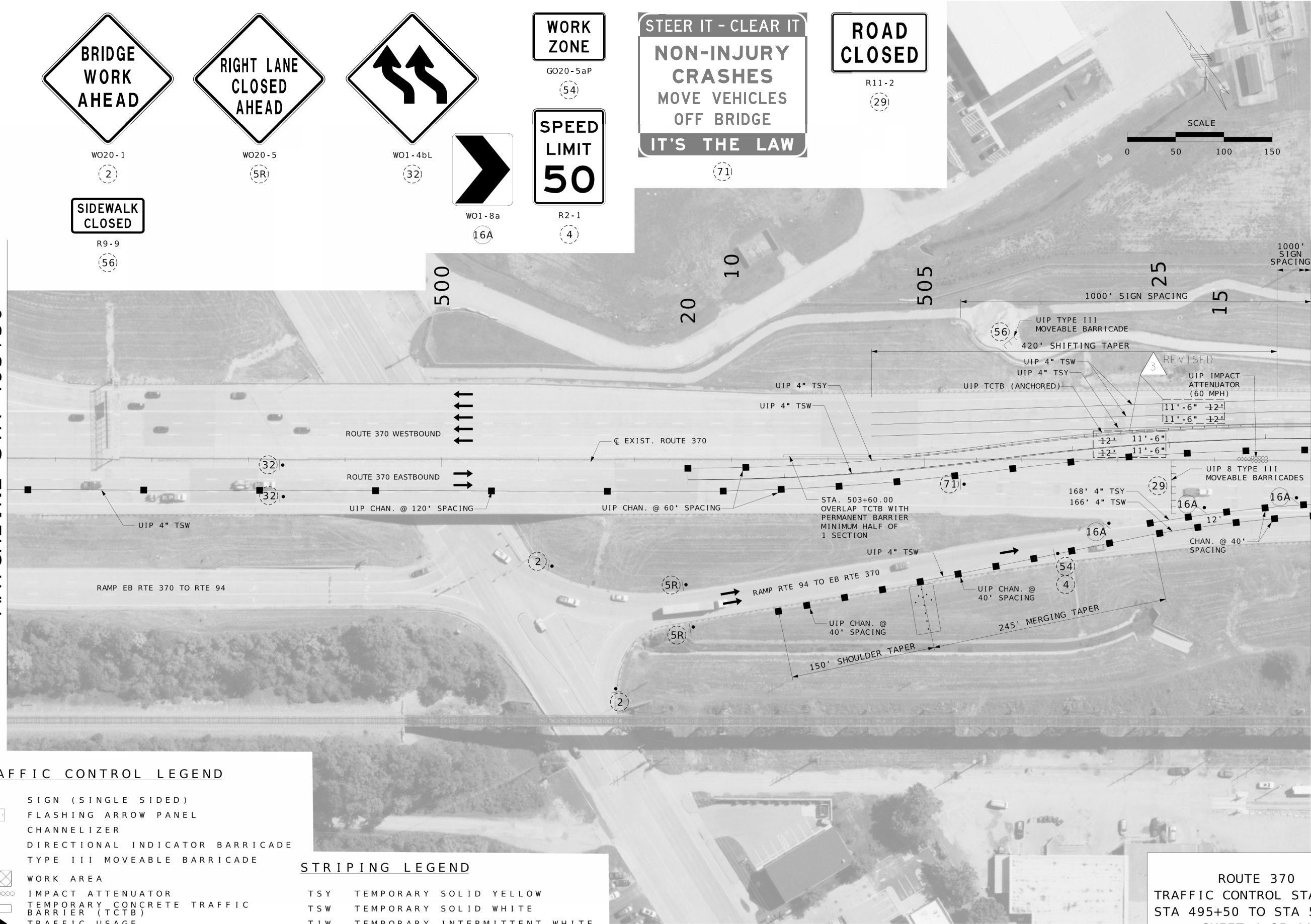

ROUTE 370
TRAFFIC CONTROL STAGE 2B
STA 495+50 TO STA 509+00
SHEET 4 OF 11

STATE OF MISSOURI

EUGENE LOUIS KUEBBER JR.

NUMBER PE-201000912

PROFESSIONAL ENGINEER

THIS SHEET HAS BEEN SIGNED, SEALED, AND DATED ELECTRONICALLY.

DATE PREPARED

6/25/2025

ROUTE

370

STATE

MO

DISTRICT

SL

SHEET NO.

40

COUNTY

ST. LOUIS/ST. CHARLES

JOB NO.

J6P3554

CONTRACT ID.

PROJECT NO.

BRIDGE NO.

DESCRIPTION

REVISED LANE WIDTHS

DATE

9/15/25

MISSOURI HIGHWAYS AND TRANSPORTATION COMMISSION

MoDOT

105 WEST CAPITOL

JEFFERSON CITY, MO 65102

1-888-ASK-MODOT (1-888-275-6636)

HDR Engineering, Inc.

401 S. 18th Street

Suite 300

St. Louis, MO 63103-2267

314-425-8300

Certificate of Authority: 000856

IF A SEAL IS PRESENT ON THIS SHEET IT HAS BEEN ELECTRONICALLY SEALED AND DATED.

MATCHLINE STA 509+00

MATCHLINE STA 522+50

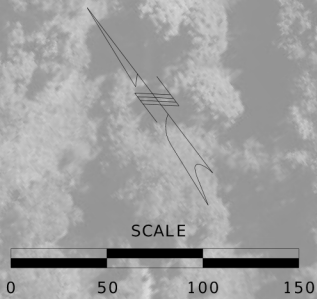
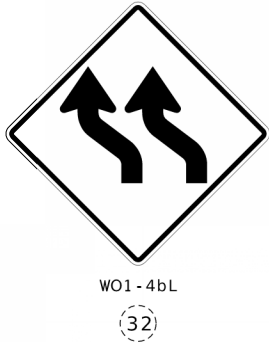
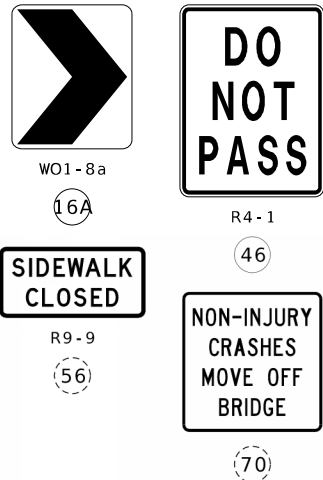

TRAFFIC CONTROL LEGEND

- SIGN (SINGLE SIDED)
- ◻ FLASHING ARROW PANEL
- ◼ CHANNELIZER
- ▲ DIRECTIONAL INDICATOR BARRICADE
- E TYPE III MOVEABLE BARRICADE
- ◻ WORK AREA
- ◻ IMPACT ATTENUATOR
- ◻ TEMPORARY CONCRETE TRAFFIC BARRIER (TCTB)
- ◻ TRAFFIC USAGE
- ◻ PLACED IN PREVIOUS PHASE

STRIPING LEGEND

- TSY TEMPORARY SOLID YELLOW
- TSW TEMPORARY SOLID WHITE
- TIW TEMPORARY INTERMITTENT WHITE

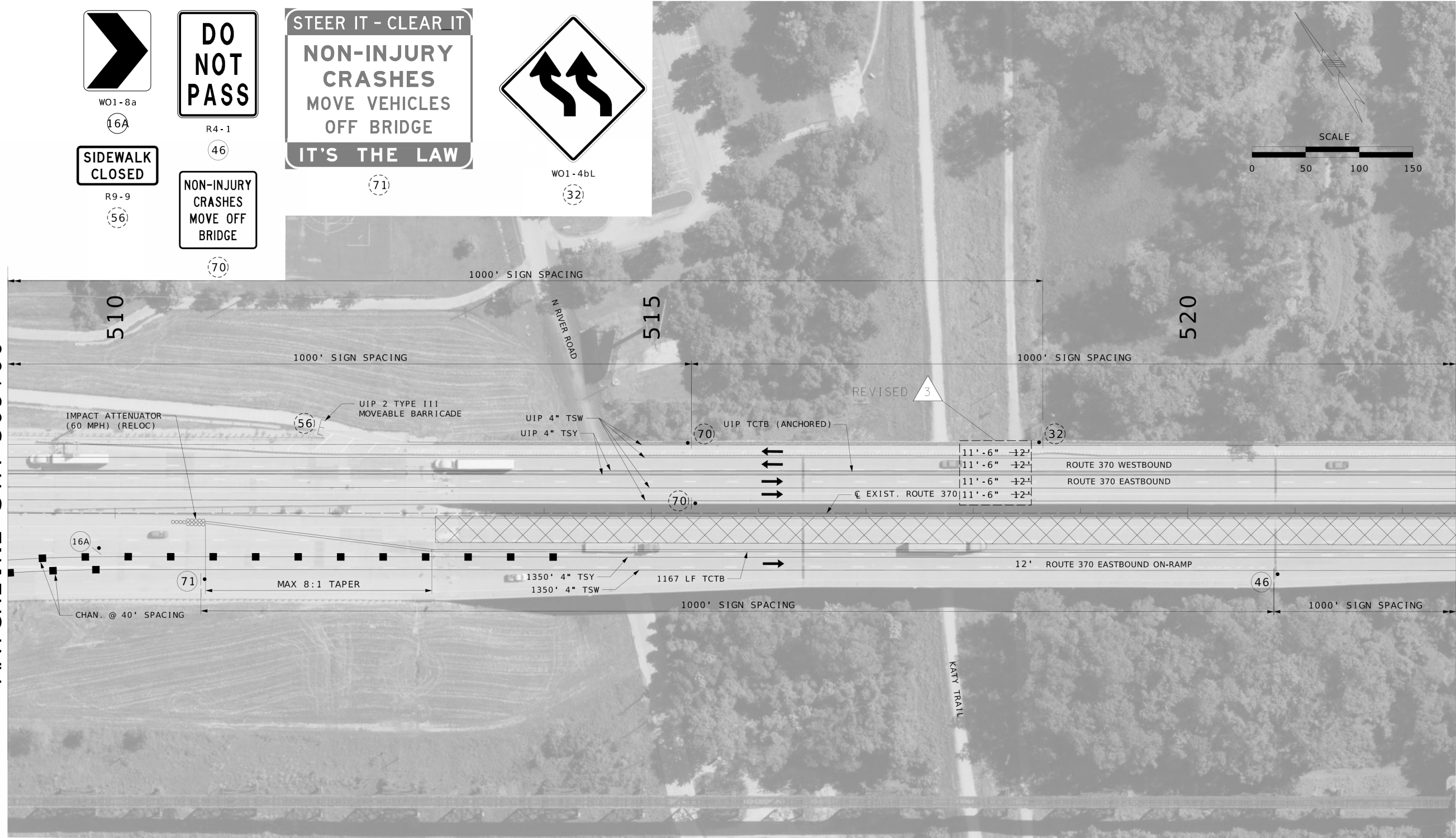

ROUTE 370
TRAFFIC CONTROL STAGE 2B
STA 509+00 TO STA 522+50
SHEET 5 OF 11

STATE OF MISSOURI

EUGENE LOUIS KUEVER JR.

NUMBER PE-201000912

PROFESSIONAL ENGINEER

THIS SHEET HAS BEEN SIGNED, SEALED, AND DATED ELECTRONICALLY.

DATE PREPARED

6/25/2025

ROUTE

370

STATE

MO

DISTRICT

SL

SHEET NO.

41

COUNTY

ST. LOUIS/ST. CHARLES

JOB NO.

J6P3554

CONTRACT ID.

PROJECT NO.

BRIDGE NO.

DESCRIPTION

3- REVISED LANE WIDTHS

DATE

9/15/25

MISSOURI HIGHWAYS AND TRANSPORTATION COMMISSION

MoDOT

105 WEST CAPITOL

JEFFERSON CITY, MO 65102

1-888-ASK-MODOT (1-888-275-6636)

HDR Engineering, Inc.

401 S. 18th Street

Suite 300

St. Louis, MO 63103-2267

314-425-8300

Certificate of Authority: 000856

IF A SEAL IS PRESENT ON THIS SHEET IT HAS BEEN ELECTRONICALLY SEALED AND DATED.

c:\pwworking\central01\d5264103\041_TC30_J6P3554_150_Rte_370_003.dgn 12:03:15 PM 6/25/2025



R4-1
(46)



(70) (70)

MATCHLINE STA 522+50

525

530

535

MATCHLINE STA 536+00

TRAFFIC CONTROL LEGEND

- SIGN (SINGLE SIDED)
- FLASHER FLASHING ARROW PANEL
- CHANNELIZER
- ▲ DIRECTIONAL INDICATOR BARRICADE
- TYPE III MOVEABLE BARRICADE
- WORK AREA
- IMPACT ATTENUATOR
- TEMPORARY CONCRETE TRAFFIC BARRIER (TCTB)
- TRAFFIC USAGE
- PLACED IN PREVIOUS PHASE

STRIPING LEGEND

- TSY TEMPORARY SOLID YELLOW
- TSW TEMPORARY SOLID WHITE
- TIW TEMPORARY INTERMITTENT WHITE

REVISED 3

11'-6" 12'
11'-6" 12'
11'-6" 12'
11'-6" 12'

UIP 1350 LF TCTB (ANCHORED)

UIP 4" TSW

UIP 4" TSY

EXIST. ROUTE 370

ROUTE 370 WESTBOUND

ROUTE 370 EASTBOUND

ROUTE 370 EASTBOUND ON-RAMP

12'

1350 LF TCTB

1350' 4" TSW

1350' 4" TSY

1000' SIGN SPACING

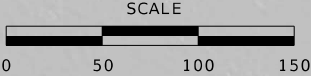

ROUTE 370
TRAFFIC CONTROL STAGE 2B
STA 522+50 TO STA 536+00
SHEET 6 OF 11

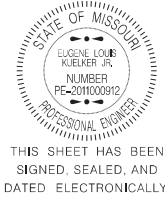

THIS SHEET HAS BEEN
SIGNED, SEALED, AND
DATED ELECTRONICALLY.

DATE PREPARED
6/25/2025

ROUTE 370 STATE MO

DISTRICT SL SHEET NO. 42

COUNTY ST. LOUIS/ST. CHARLES

JOB NO. J6P3554

CONTRACT ID.

PROJECT NO.

BRIDGE NO.

DATE	DESCRIPTION
9/15/25	REVISED LANE WIDTHS



HDR Engineering, Inc.
401 S. 18th Street
Suite 300
St. Louis, MO 63103-2267
314-425-8300
Certificate of Authority: 000856

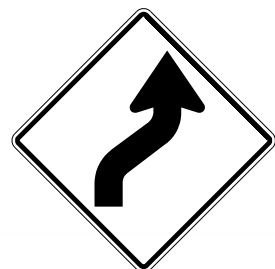

WO1 - 4R

(15)



(57)



WO13-1

(34)



R4 - 1

46 46



R9-9

56

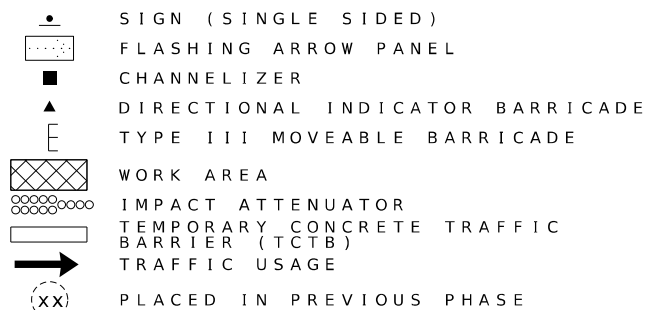
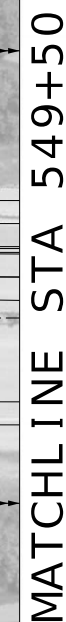
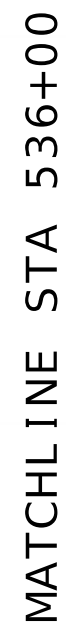
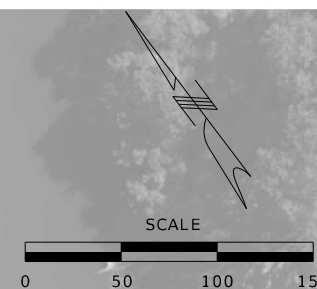

STRIPING LEGEND

TSY	TEMPORARY	SOLID	YELLOW
TSW	TEMPORARY	SOLID	WHITE
TIW	TEMPORARY	INTERMITTENT	WHITE

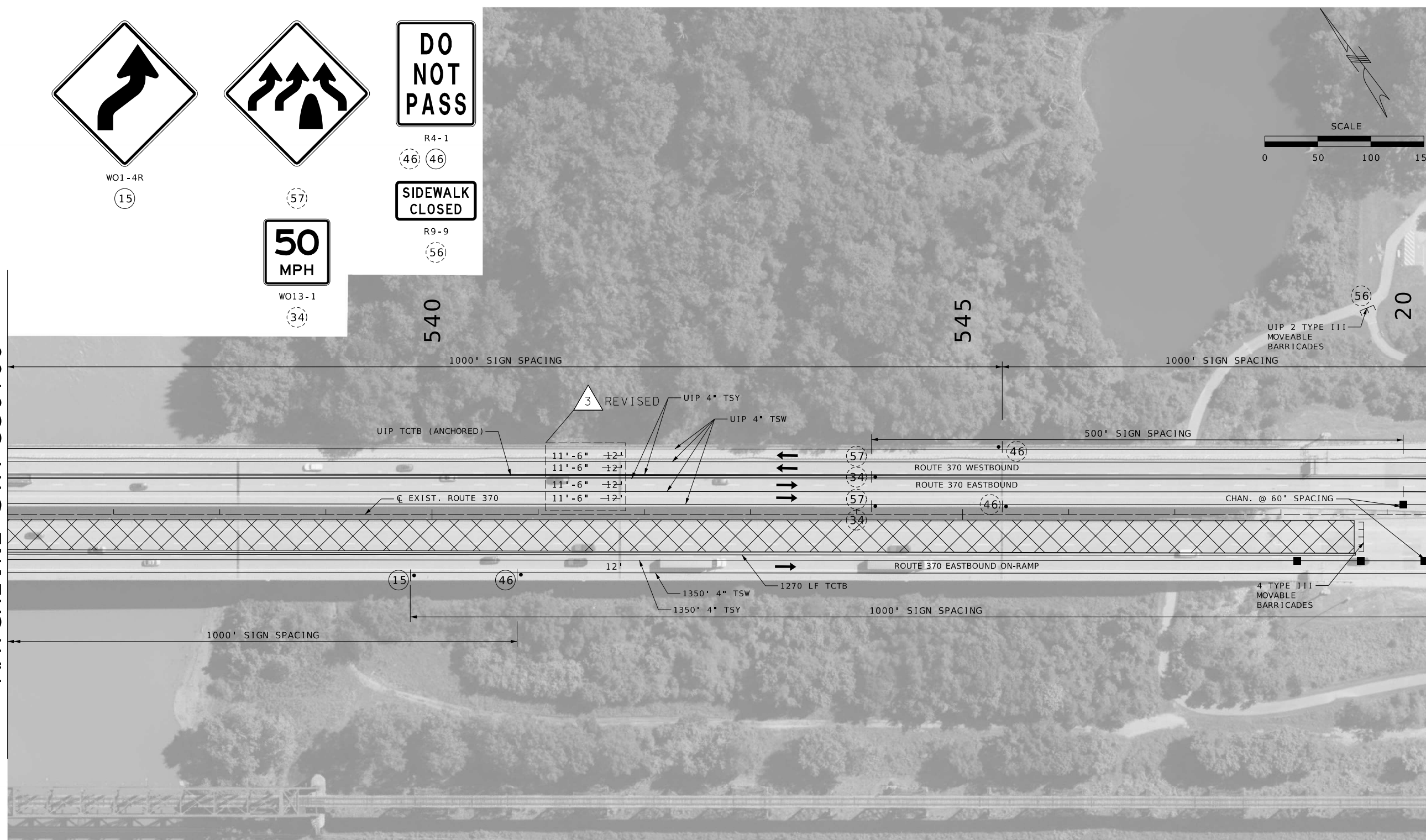

ROUTE 370
TRAFFIC CONTROL STAGE 2B
STA 536+00 TO STA 549+50
SHEET 7 OF 11

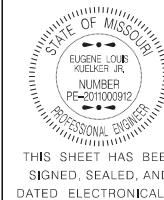

THIS SHEET HAS BEEN
SIGNED, SEALED, AND
DATED ELECTRONICALLY.

DATE PREPARED

6/25/2025

ROUTE	STA
270	11

370	Mo
-----	----

DISTRICT	SHEET
SI	4

3L	4
COUNTY	

T. LOUIS/ST. CH

JOB NO.	
---------	--

J6P3554

CONTRACT ID.

100

PROJECT NO.

BRIDGE NO.

DATE	DESCRIPTION
9/15/25	A- REVISED LANE WIDTHS

MISSOURI HIGHWAYS AND TRANSPORTATION
COMMISSION

105 WEST CAPITOL
JEFFERSON CITY, MO 65102
1-888-ASK-MODOT (1-888-275-6636)

HDR Engineering, Inc.

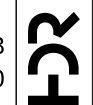

401 S. 18th Street
Suite 300
St. Louis, MO 63103-2267
314-425-8300
Certificate of Authority: 000856

				S	
IF A SEAL IS PRESENT ON THIS SHEET IT HAS BEEN ELECTRONICALLY SEALED AND DATED.					

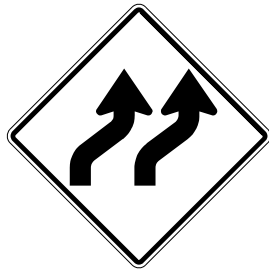

W01-4bR

(32)

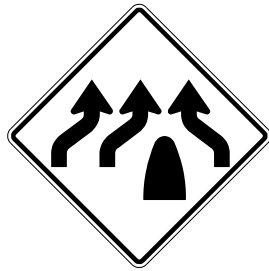

(57)

STEER IT - CLEAR IT
NON-INJURY
CRASHES
MOVE VEHICLES
OFF BRIDGE
IT'S THE LAW

(71)

SIDEWALK
CLOSED

R9-9

(56)



SCALE

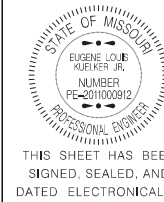

THIS SHEET HAS BEEN
SIGNED, SEALED, AND
DATED ELECTRONICALLY.

DATE PREPARED

6/25/2025

ROUTE STATE

370 MO

DISTRICT SHEET NO.

SL 44

COUNTY

ST. LOUIS/ST. CHARLES

JOB NO.

J6P3554

CONTRACT ID.

PROJECT NO.

BRIDGE NO.

DATE	DESCRIPTION
9/15/25	3- REVISED LANE WIDTHS



HDR Engineering, Inc.
401 S. 18th Street
Suite 300
St. Louis, MO 63103-2267
314-425-8300
Certificate of Authority: 000856

MATCHLINE STA 549+50

MATCHLINE STA 563+00

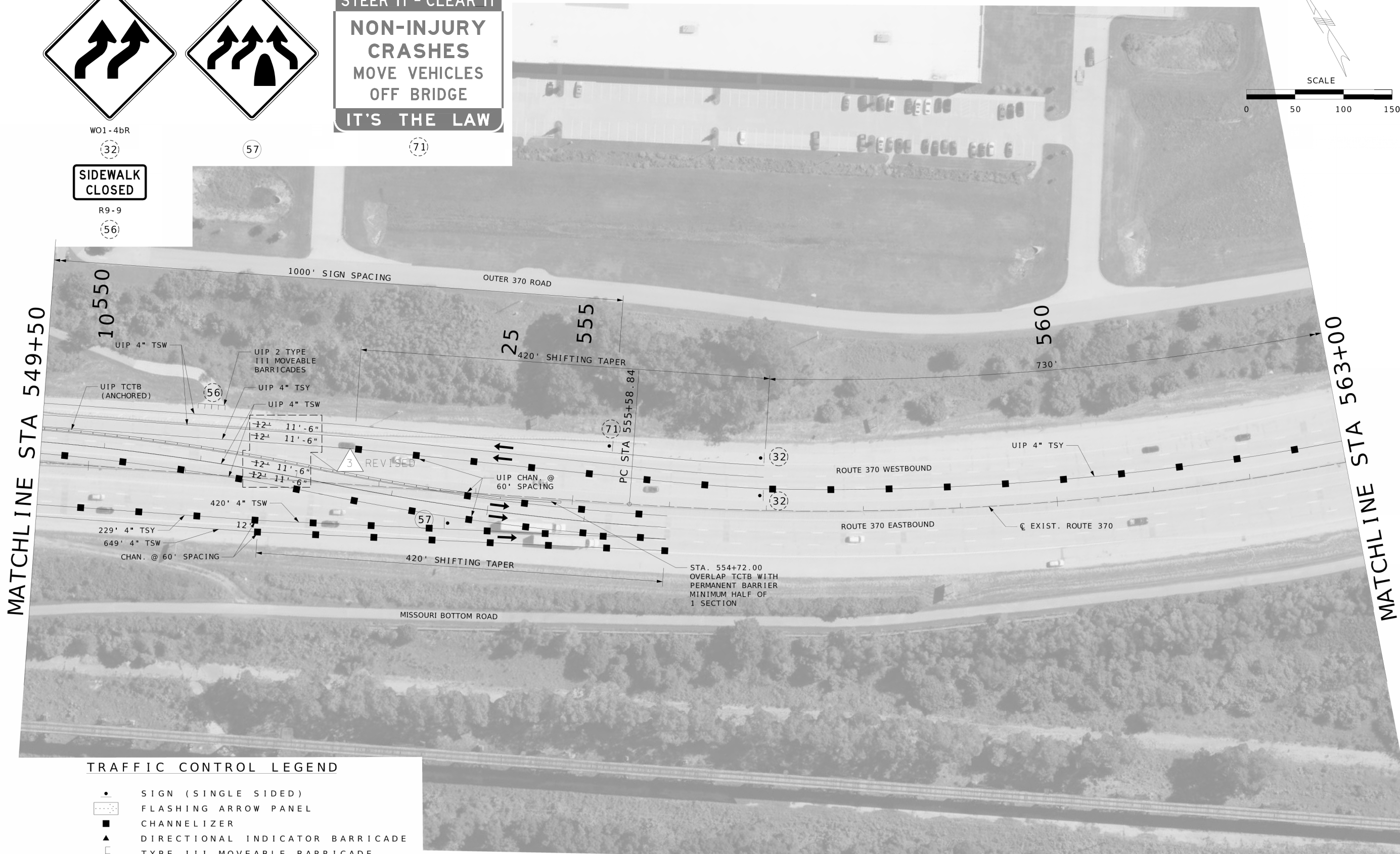

TRAFFIC CONTROL LEGEND

- SIGN (SINGLE SIDED)
- FLASHING ARROW PANEL
- CHANNELIZER
- ▲ DIRECTIONAL INDICATOR BARRICADE
- E TYPE III MOVEABLE BARRICADE
- WORK AREA
- IMPACT ATTENUATOR
- TEMPORARY CONCRETE TRAFFIC BARRIER (TCTB)
- TRAFFIC USAGE
- (XX) PLACED IN PREVIOUS PHASE

STRIPING LEGEND

- TSY TEMPORARY SOLID YELLOW
- TSW TEMPORARY SOLID WHITE
- TIW TEMPORARY INTERMITTENT WHITE

ROUTE 370
TRAFFIC CONTROL STAGE 2B
STA 549+50 TO STA 563+00
SHEET 8 OF 11

Exist. anchor bolts, cut to 1" below concrete surface at Pier 13 (2C) top of bearing seat and Pier 16 (5C) top of cap (Typ.)

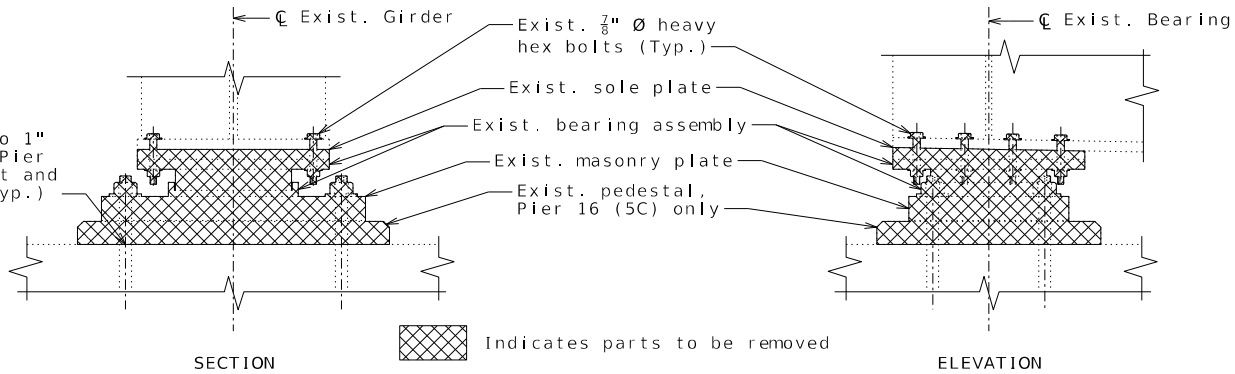

REMOVE EXISTING BEARINGS (Piers 13 (2C) and 16 (5C))

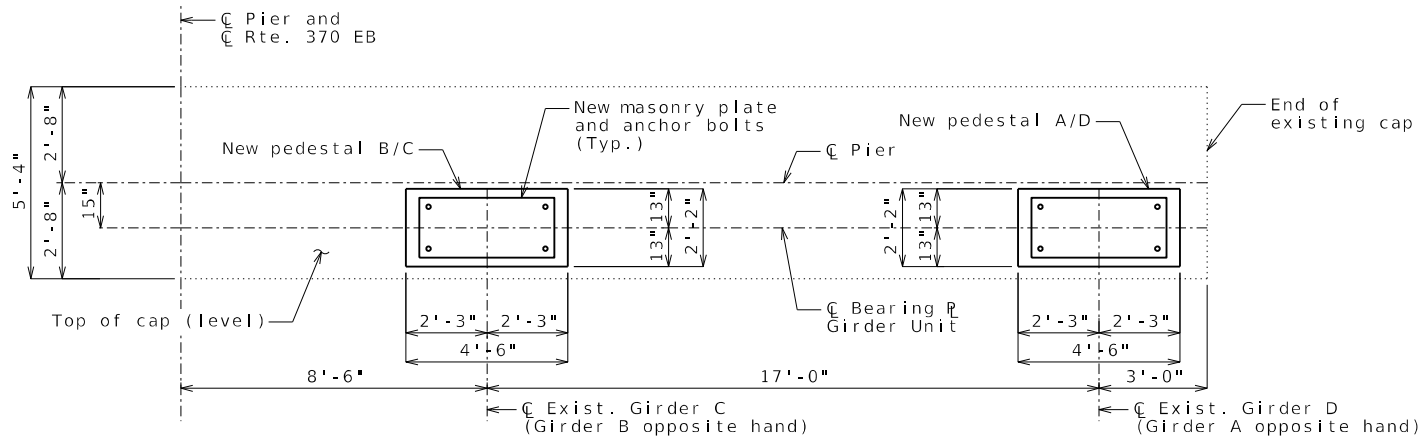

PART PLAN-PIER 16 (5C)
(Symmetric about ϕ Pier and ϕ Rte. 370 EB)

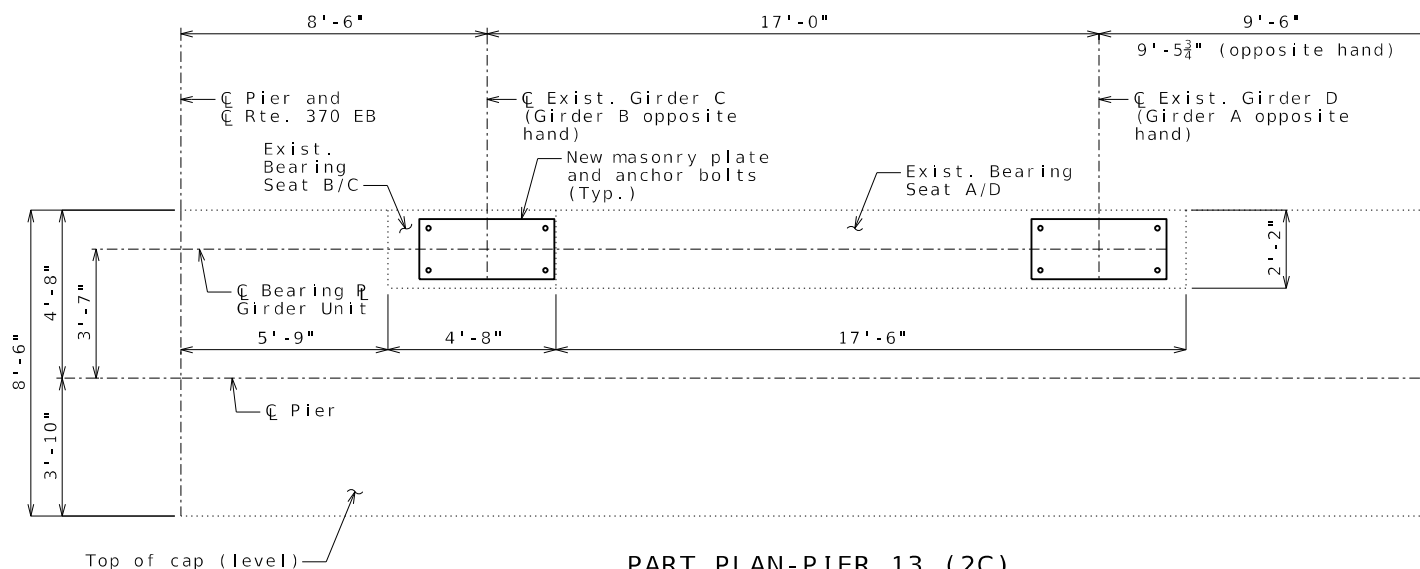

PART PLAN-PIER 13 (2C)
(Symmetric about ϕ Pier and ϕ Rte. 370 EB, except as shown)

Approx. Existing Pedestal/Bearing Seat Height (measured from top of cap)

Location	Girders	Height	Girders	Height
Pier 13 (2C)	A & D	3'-2 $\frac{1}{8}$ "	B & C	3'-5 $\frac{3}{8}$ "
Pier 16 (5C)	A & D	4"	B & C	7 $\frac{1}{4}$ "

Notes:

Concrete for new pedestals at Pier 16 (5C) shall be Class B, $f'c = 3,000$ psi and will be considered completely covered by the contract unit price for High Load Multi-Rotational (HLMR) Disc Bearing Assembly.



ADDED

HIGH LOAD MULTI-ROTATIONAL (HLMR) DISC BEARING RETROFIT DETAILS

Note: This drawing is not to scale. Follow dimensions.

Sheet No. 8 of 40

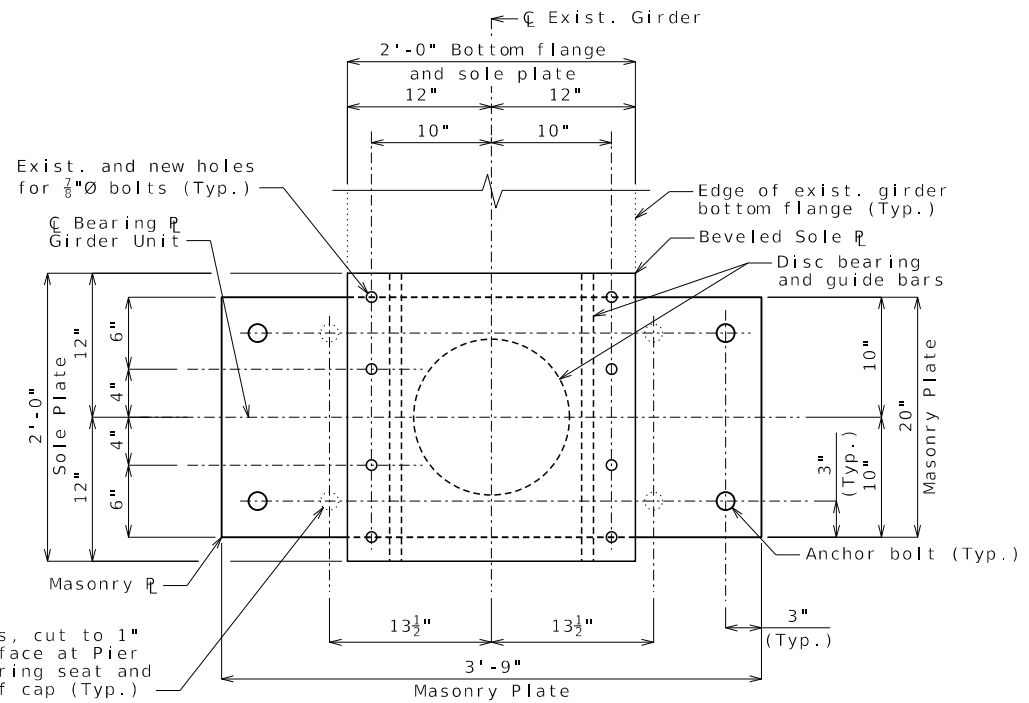

PART PLAN - BEARING

Beveled Sole Plates	
Location	Slope (Ft/Ft)
Pier 13 (2C)	-0.0090
Pier 16 (5C)	-0.0220

Girder Service (Unfactored) Bearing Reactions (Per Girder) (kip)						
Location	Girders	Dead Load	Live Load with Impact	Girders	Dead Load	Live Load with Impact
Pier 13 (2C)	A & D	168	167	B & C	214	209
Pier 16 (5C)	A & D	170	167	B & C	216	209

*The contractor, in coordination with the bearing manufacturer, shall locate the reinforcement in the pier caps adjacent to the anchor bolts. Adjustments to the spacing of the anchor bolts shall be coordinated with the dimensions of the masonry plate prior to fabrication. See Sheet No. 9.

Notes:

The above reactions are the maximum service bearing reactions.

Reactions shown include Dead Load of the existing structure and vehicular live load. Any additional Dead Load or Construction Live Load shall be determined by the contractor. Capacities of the jacks used to lift the bridge shall be at least 50% greater than those reactions and additional load determined by the contractor.

Jacking and replacement of bearings shall be performed one pier at a time.

The contractor shall submit a jacking sequence for approval.

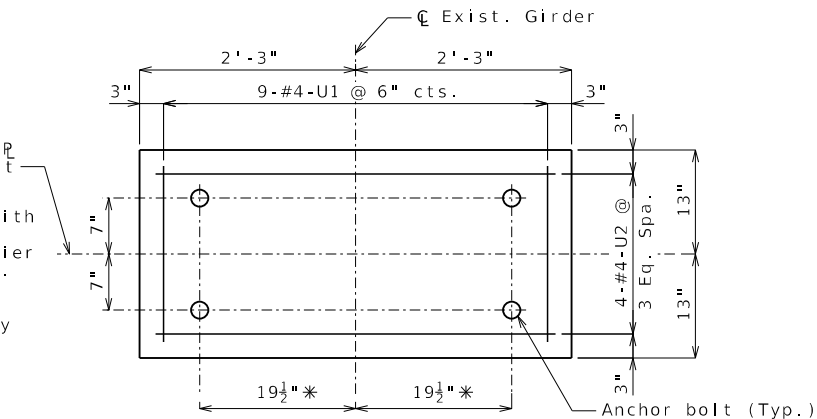

PEDESTAL REINFORCING DETAIL

Note: Drill and grout #4-U bars 6" min. into top of cap. U-Bars may be shifted 1/2" to miss exist. reinforcement.

The contractor shall be responsible for maintaining the stability of the structure at all times and shall take all necessary precautions to maintain the stability and safety of the existing bridge at the contractor's cost.

Remove existing bearing assembly, masonry plate, and sole plate. Remove existing concrete pedestals at Pier 16 (5C). Cut existing anchor bolts to 1" below top of bearing seat or top of cap. At Pier 13 (2C), fill holes with a special qualified mortar.

Sole plates shall be beveled to the slope shown above.

Existing pier caps are Class B Concrete, $f'c = 3,000$ psi.

The cost of all labor, materials, and equipment necessary for jacking the superstructure and removal of existing bearings will be considered completely covered by the contract price for Removal of Existing Bearings, per each.



REVISED



THIS SHEET HAS BEEN SIGNED, SEALED AND DATED ELECTRONICALLY

DATE PREPARED
9/10/2025

ROUTE
370

STATE
MO

DISTRICT
BR

SHEET NO.
8

COUNTY
ST. LOUIS/
ST. CHARLES

JOB NO.
J6P3554

CONTRACT ID.

PROJECT NO.

BRIDGE NO.
A45576

DESCRIPTION

DATE

DATE

DATE

DATE

DATE

DATE

DATE

DATE

DATE

DATE

DATE

DATE

DATE

DATE

DATE

DATE

DATE

DATE

DATE

DATE

DATE

DATE

DATE

DATE

DATE

DATE

DATE

DATE

DATE

DATE

DATE

DATE

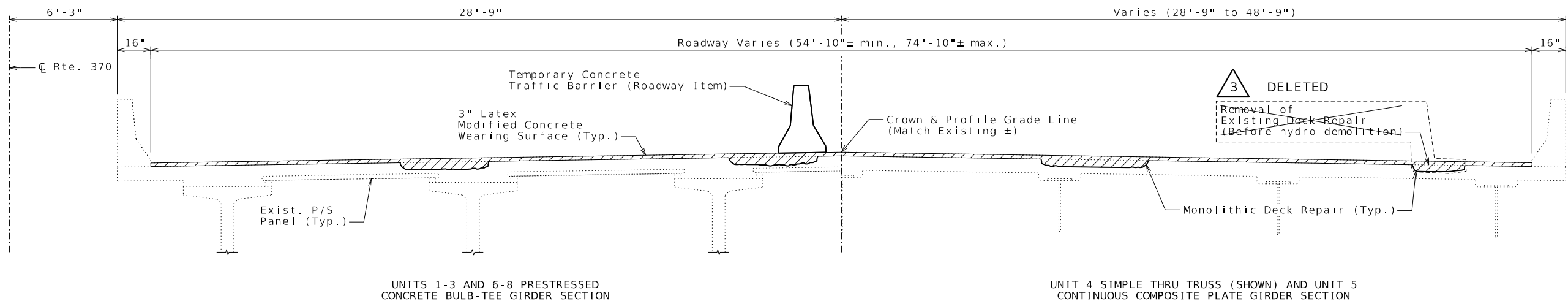

TYPICAL SECTION THRU EXISTING DECK

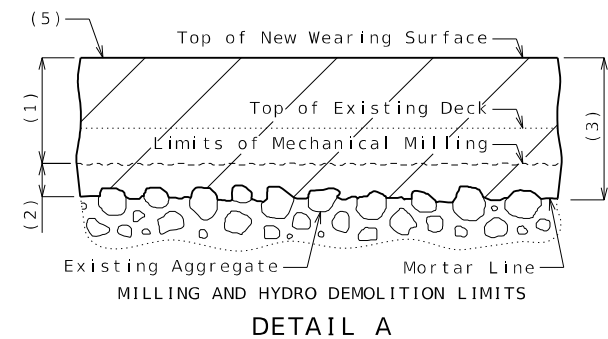
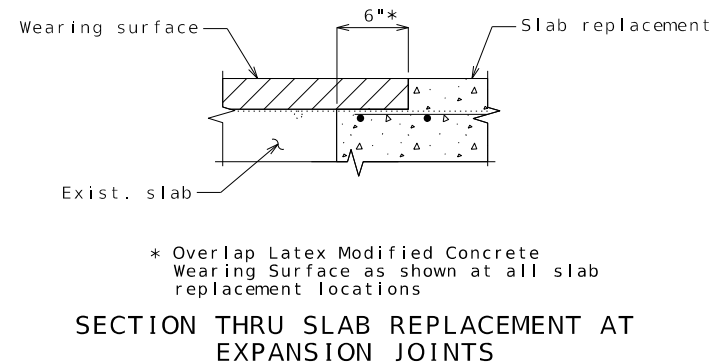
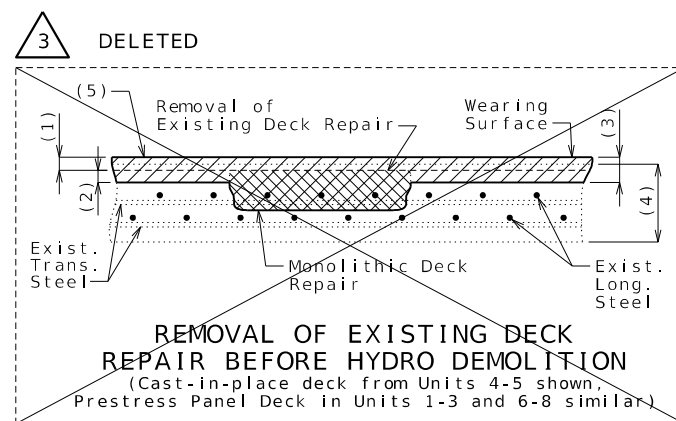
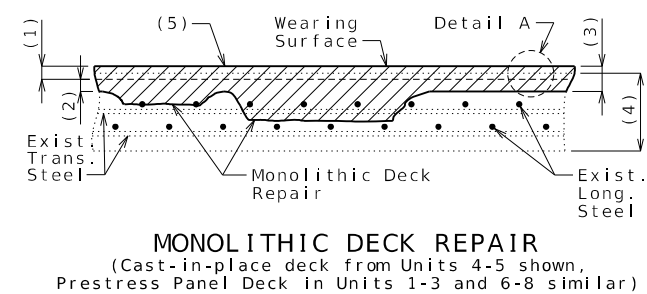

- (1) Removal of existing 2 1/4" \pm Low Slump Concrete wearing surface plus 1/4" of existing deck.
- (2) 1/2" minimum total surface hydro demolition of sound concrete, measured to mortar line.
- (3) 3" minimum Latex Modified concrete wearing surface.
- (4) Original depth of deck minus previous scarification.
- (5) Diamond Grind new wearing surface. See Special Provisions.

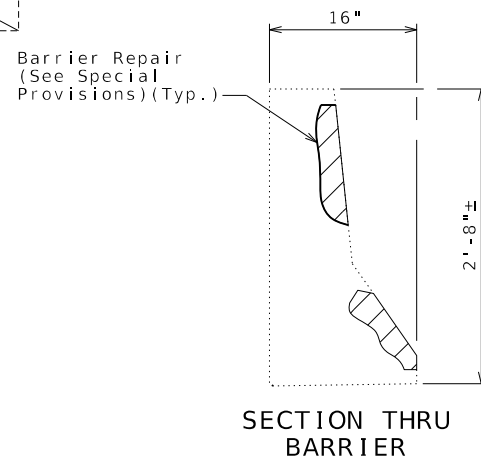

Notes:

For Staging Plans, see Sheet No. 4.

Unformed Barrier Repair may utilize shotcrete concrete repair method. See Special Provisions.

DECK AND BARRIER REPAIR DETAILS

Detailed May 2025
Checked May 2025

Note: This drawing is not to scale. Follow dimensions.

Sheet No. 12 of 40

3 REVISED

c:\pwworking\central01\d4318782\B_A45576_012_J6P3554_R003.dgn 3:27:17 PM 9/9/2025

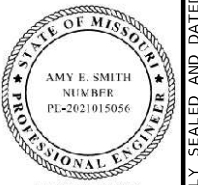

DATE PREPARED

9/9/2025

ROUTE STATE

370 MO

DISTRICT SHEET NO.

BR 12

COUNTY

ST. LOUIS/ST. CHARLES

JOB NO.

J6P3554

CONTRACT ID.

PROJECT NO.

BRIDGE NO.

A45576

DESCRIPTION

DATE

MISSOURI HIGHWAYS AND TRANSPORTATION COMMISSION

105 WEST CAPITOL

JEFFERSON CITY, MO 65102

1-888-ASK-MODOT (1-888-275-6636)

MODOT

HDR Engineering, Inc.

401 S. 18th Street

Suite 300

St. Louis, MO 63103-2287

314-425-8300

Certificate of Authority: 000856



Note: This drawing is not to scale. Follow dimensions.

Sheet No. 32 of 40



The minimum embedment depth in concrete with $f'_c = 4,000$ psi for the resin anchor systems shall be that required to meet the minimum ultimate pullout strength in accordance with Sec 1039 but shall not be less than 5".

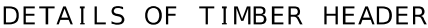

Remove timber header when concrete pavement is placed.

3 REVISED

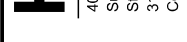

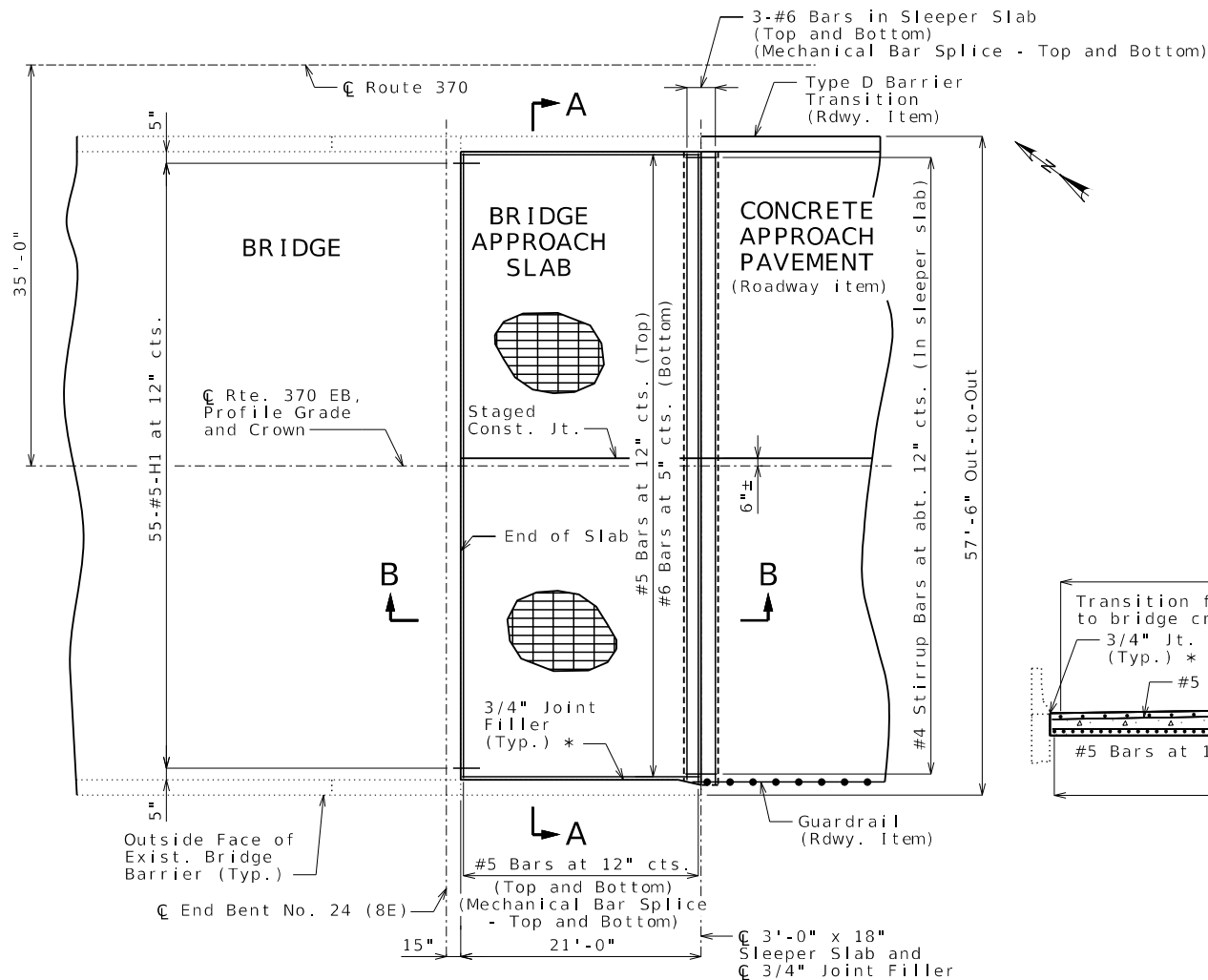

PART PLAN SHOWING REINFORCEMENT

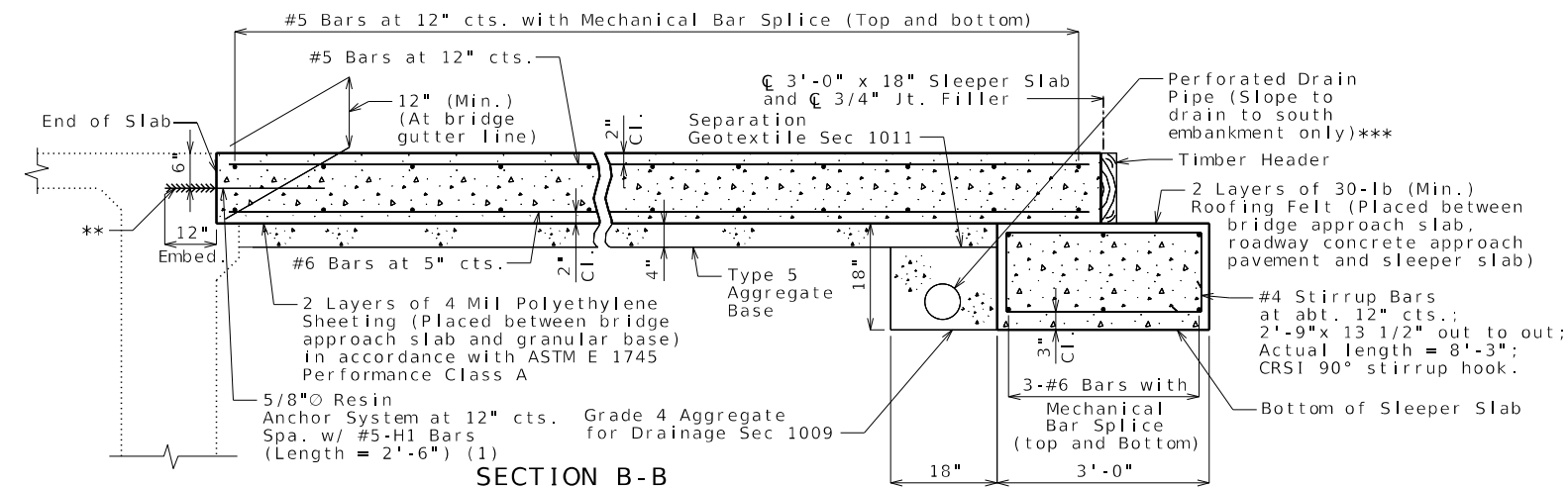

SECTION B-B

DETAILS OF BRIDGE APPROACH SLAB AT END BENT NO. 24 (8E) (MAJOR)

Detailed May 2025
Checked May 2025

Note: This drawing is not to scale. Follow dimensions.

Sheet No. 33 of 40

3 galvanized

General Notes:

All concrete for the bridge approach slab and sleeper slab shall be in accordance with Sec 503 (f'c = 4,000 psi).

The reinforcing steel in the bridge approach slab and the sleeper slab shall be epoxy coated Grade 60 with fy = 60,000 psi.

Drain pipe may be either 6" diameter corrugated metallic-coated pipe underdrain, 4" diameter polyvinyl chloride (PVC) drain pipe, or 4" diameter corrugated polyethylene (PE) drain pipe.

Minimum clearance to reinforcing steel shall be 1 1/2", unless otherwise shown.

The longitudinal reinforcing steel in the bridge approach slab shall be continuous. The reinforcing in the sleeper slab and transverse reinforcing steel in the bridge approach slab shall be made continuous by mechanical bar splice as detailed.

Mechanical bar splices shall be in accordance with Sec 710. (Estimate 48 splices.)

All joint filler shall be in accordance with Sec 1057 for preformed fiber expansion joint filler except as noted.

Longitudinal construction joints in approach slab and sleeper slab shall be aligned with longitudinal construction joints in bridge slab.

The contractor shall use one of the qualified resin anchor systems in accordance with Sec 1039.

For concrete approach pavement details, see Roadway Plans.

Payment for furnishing all materials, labor and excavation necessary to construct the approach slab, including the timber header, sleeper slab, underdrain, Type 5 aggregate base, joint filler and all other appurtenances and incidental work as shown on this sheet including furnishing and installing the resin anchor systems, complete in place, will be considered completely covered by the contract unit price for Bridge Approach Slab (Major) per square yard.

Removal of existing approach slab is included in Roadway Items.

* Seal joint between vertical face of approach slab and wing with sealant in accordance with Sec 717 for silicone joint sealant for saw cut and formed joints.

** Existing reinforcement connecting the existing end bent and approach slab to be cleaned and reused if present. Otherwise, 5/8" dia. Resin Anchor System to be utilized as shown. Cost will be considered completely covered by the contract unit price for Bridge Approach Slab (Major) per square yard.

*** Contractor shall redirect Drain Pipe as required to daylight along the south embankment. Drain Pipe falling outside the limits of the bridge approach slab shall be unperforated drain pipe.

(1) Cost of furnishing and installing the resin anchor systems, complete in place, will be considered completely covered by the contract unit price for Bridge Approach Slab (Major) per square yard.

The minimum embedment depth in concrete with f'c = 4,000 psi for the resin anchor systems shall be that required to meet the minimum ultimate pullout strength in accordance with Sec 1039 but shall not be less than 5".

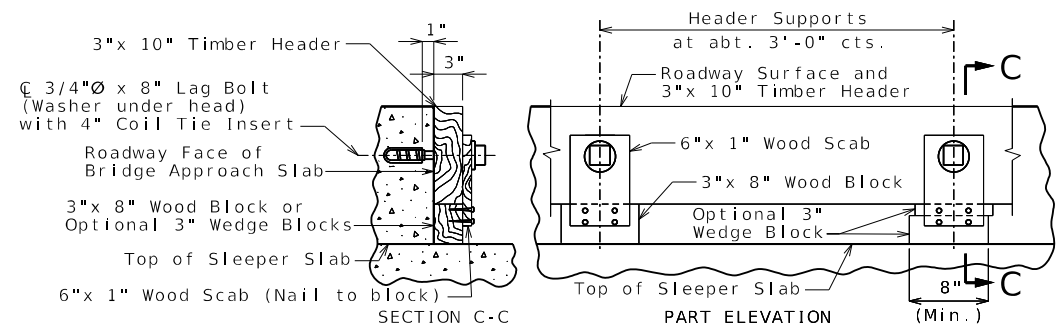

DETAILS OF TIMBER HEADER

Remove timber header when concrete pavement is placed.

3 REVISED

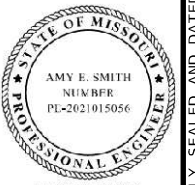

THIS SHEET HAS BEEN SIGNED, SEALED AND DATED ELECTRONICALLY

DATE PREPARED

9/9/2025

ROUTE 370 STATE MO

DISTRICT BR SHEET NO. 33

COUNTY ST. LOUIS/ST. CHARLES

JOB NO.

J6P3554

CONTRACT ID.

PROJECT NO.

BRIDGE NO.

A45576

DESCRIPTION

DATE

MISSOURI HIGHWAYS AND TRANSPORTATION COMMISSION

105 WEST CAPITOL

JEFFERSON CITY, MO 65102

1-888-ASK-MODOT (1-888-275-6636)

ModOT

HDR Engineering, Inc.

401 S. 18th Street

Suite 300

St. Louis, MO 63103-2287

314-425-8300

Certificate of Authority: 000856

IF A SEAL IS PRESENT ON THIS SHEET IT HAS BEEN ELECTRONICALLY SEALED AND DATED.

U.I.P. AND REHABILITATE
EXISTING (100'-110'-110'), (4@110'), (4@110') CONT. PRESTRESSED CONCRETE BULB-TEE GIRDER SPANS,
(625') SIMPLE THRU TRUSS SPAN, (210'-250'-210') CONT. COMPOSITE PLATE GIRDER SPANS,
(3@120'), (3@120'), (2@120') CONT. PRESTRESSED CONCRETE BULB-TEE GIRDER SPANS

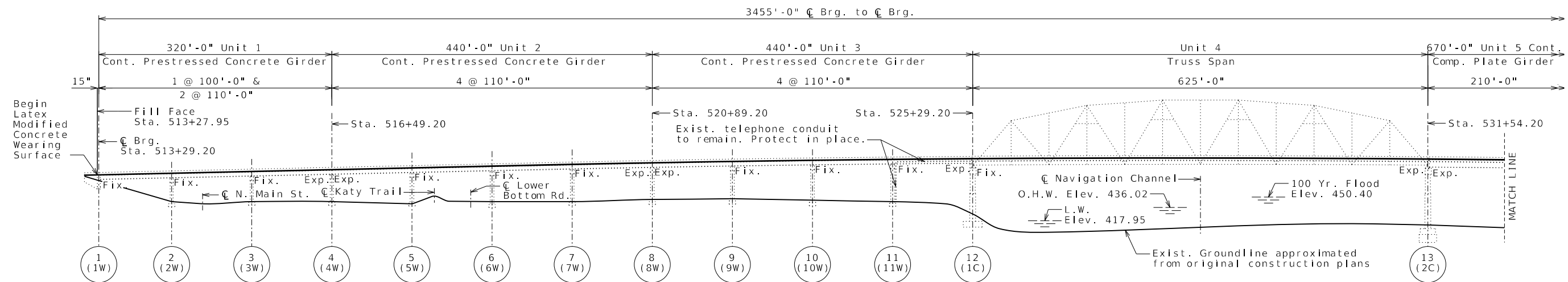

GENERAL ELEVATION

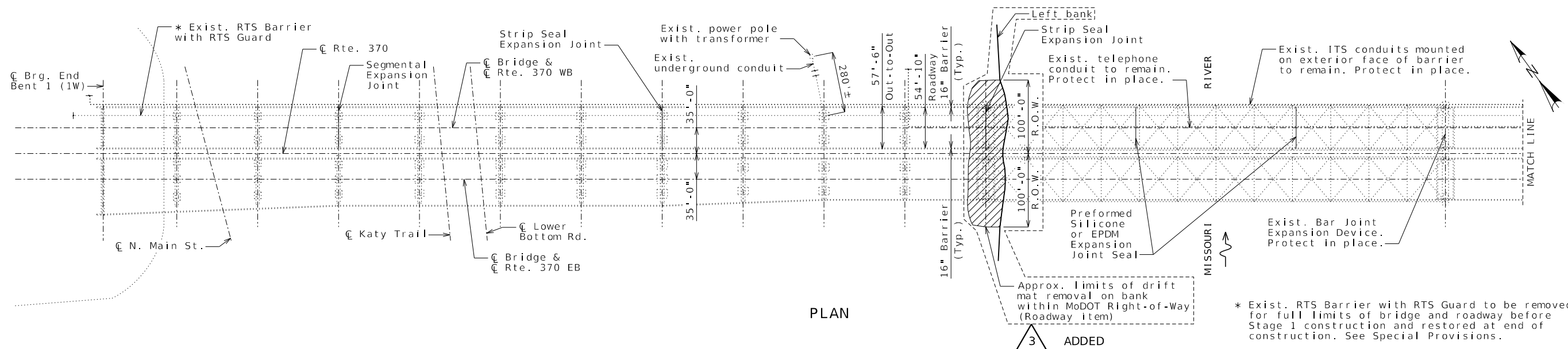

PLAN

INDEX OF SHEETS

1. General Elevation and Plan
2. General Elevation and Plan
3. General Notes and Quantities
4. Construction Staging
5. Substructure Repair & Concrete Protective Coating Details
6. Substructure Repair & Concrete Protective Coating Details
7. Concrete Diaphragm Repair and Diaphragm and Girders Protective Coating Details
8. High Load Multi-Rotational (HLMR) Disc Bearing Retrofit Details
9. High Load Multi-Rotational (HLMR) Disc Bearing Assembly
10. Type N PTFE Bearings
11. Bearing Retainer Retrofit Details
12. Deck and Barrier Repair Details
13. Steel Protective Coating Limits
14. Gusset Plate L0 Retrofit
15. Gusset Plate L0 Retrofit
16. Gusset Plate L0 Retrofit
17. Gusset Plate L0 Retrofit

18. Drainage Modifications at Pier 13 (2C)
19. Drainage Modifications at Pier 13 (2C)
20. Slab Drain Extensions in Truss Span
21. Expansion Device Removal Details
22. Expansion Device Removal Details
23. Strip Seal Expansion Joint Details at Bents 8 (8W), 12 (1C), 19 (3E) and 22 (6E)
24. Strip Seal Expansion Joint Details at Bents 8 (8W), 12 (1C), 19 (3E) and 22 (6E)
25. Segmental Expansion Joint Details at Bents 4 (4W) and 16 (5C)
26. Preformed Silicone or EPDM Joint Seal in Unit 4
27. Slab Replacement at Bent 4 (4W)
28. Slab Replacement at Bents 8 (8W), 19 (3E) and 22 (6E)
29. Slab Replacement at Pier 12 (1C)
30. Slab Replacement at Pier 16 (5C)
31. Barrier Replacement at Expansion Joint Locations
32. Details of Bridge Approach Slab at End Bent No. 1 (1W) (Major)
33. Details of Bridge Approach Slab at End Bent No. 24 (8E) (Major)

34. Bending Diagrams and Reinforcing Steel Totals
35. Bill of Reinforcing Steel
36. Navigation Lighting Plan
37. Navigation Lighting Details
38. Navigation Placard and River Gauge Marking Details
39. Median Lighting Details
40. Miscellaneous Details
41. Bicycle Plate Details at Bar Joint
42. Bicycle Plate Details at Strip Seal Expansion Joints
43. Bicycle Plate Details at Segmental Expansion Joints

GENERAL ELEVATION AND PLAN

Note: This drawing is not to scale. Follow dimensions.

Sheet No. 1 of 43

REPAIRS TO BRIDGE:
ROUTE 370 WB OVER MISSOURI RIVER

ROUTE 370 FROM ROUTE 94 TO ROUTE 141
ABOUT 0.2 MILE EAST OF ROUTE 94
STA. 513+27.95± (MATCH EXISTING)

3 REVISED

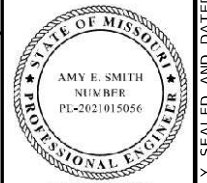

THIS SHEET HAS BEEN
SIGNED, SEALED AND DATED
ELECTRONICALLY

DATE PREPARED
9/9/2025

ROUTE 370	STATE MO
--------------	-------------

DISTRICT BR	SHEET NO. 1	Z L L O
COUNTY		

COUNTY	ST. LOUIS/ ST. CHARLES
JOB NO.	

J6P3554	
CONTRACT ID.	

PROJECT NO.	

BRIDGE NO.	
A4EE77	

[illegible]

MISSOURI HIGHWAYS AND TRANSPORTATION COMMISSION

MoDOT

105 WEST CAPITOL
JEFFERSON CITY, MO 65102
1-888-ASK-MODOT (1-888-275-6636)

HDR HDR Engineering, Inc.
401 S. 18th Street
Suite 300
St. Louis, MO 63103-2267
314-425-8300
Certificate of Authority: 000856

Designed	May	2025
Detailed	May	2025
Checked	May	2025

c:\pwworking\central01\d4318784\B A45577 001 J6P3554 R003.dgn 3:38:08 PM 9/9/2025

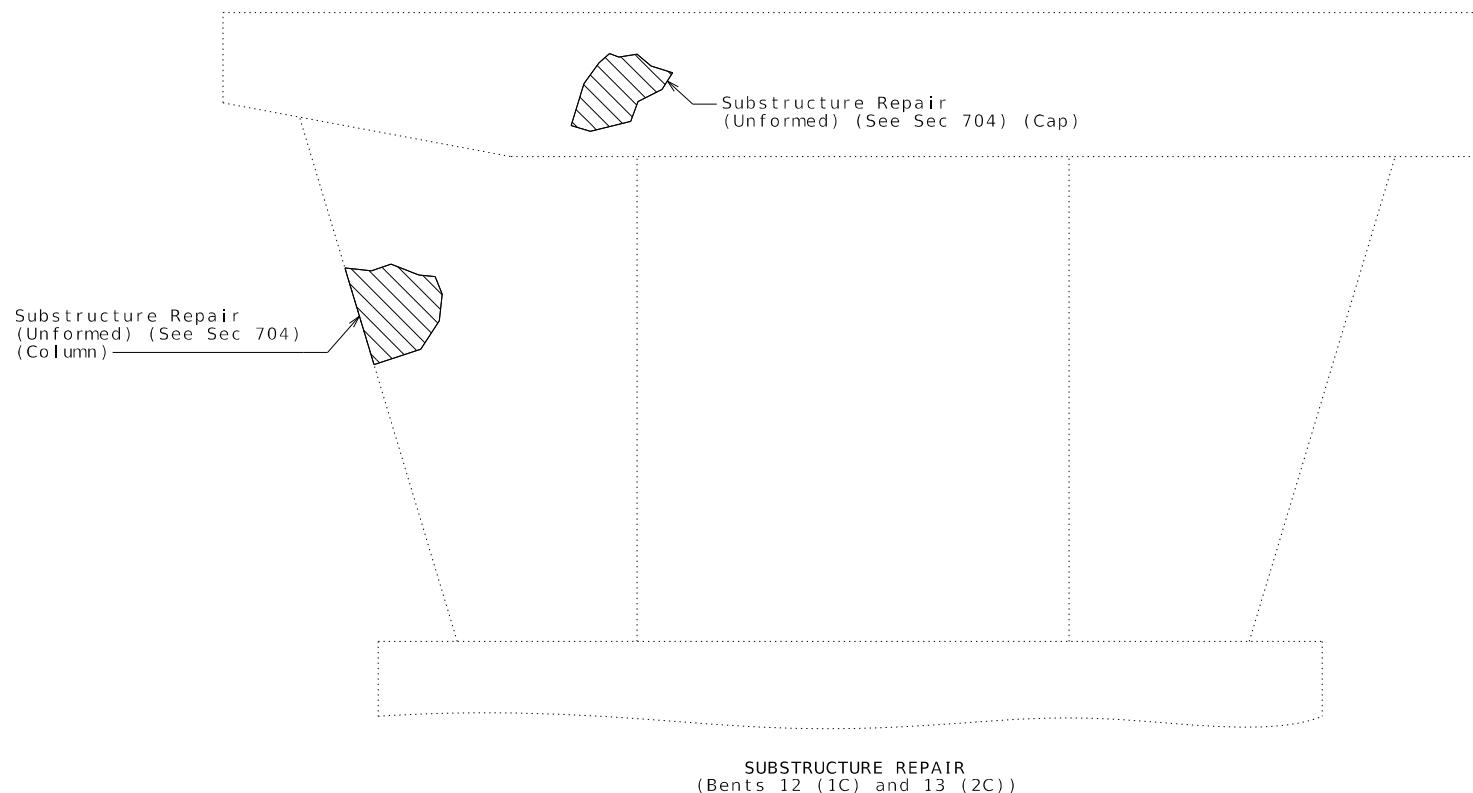
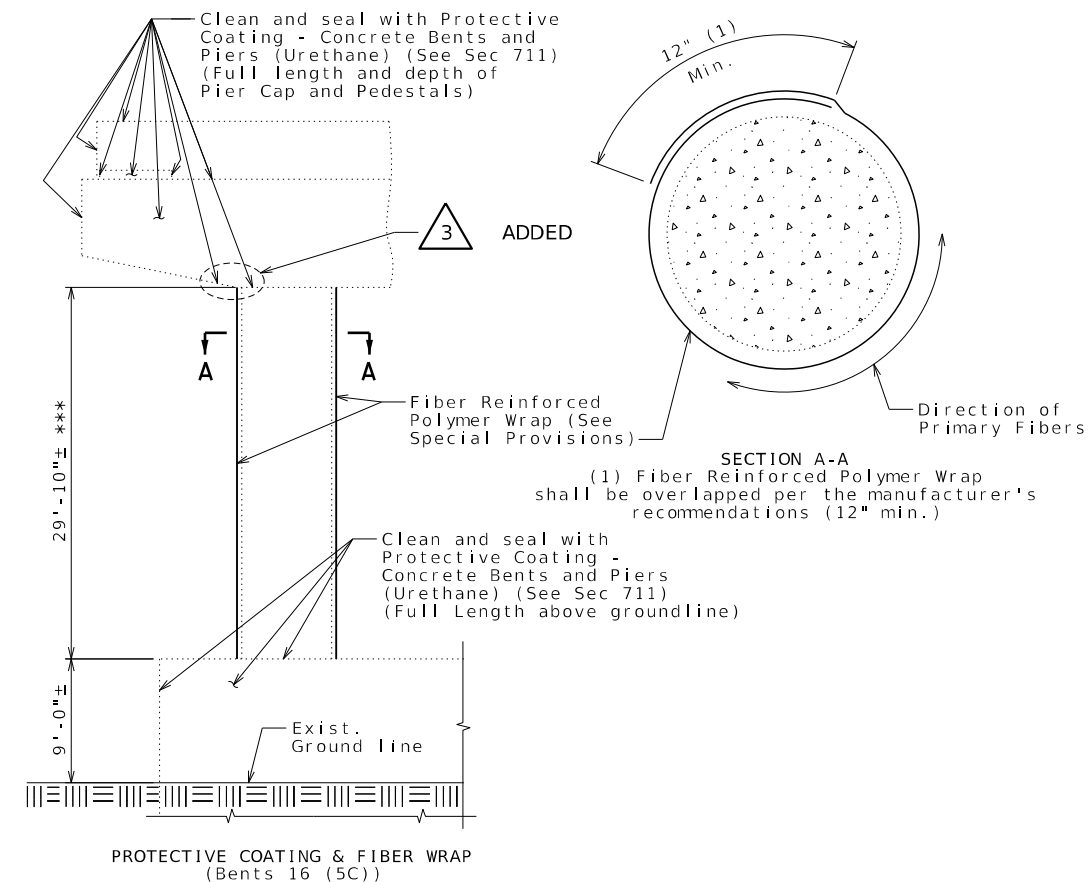
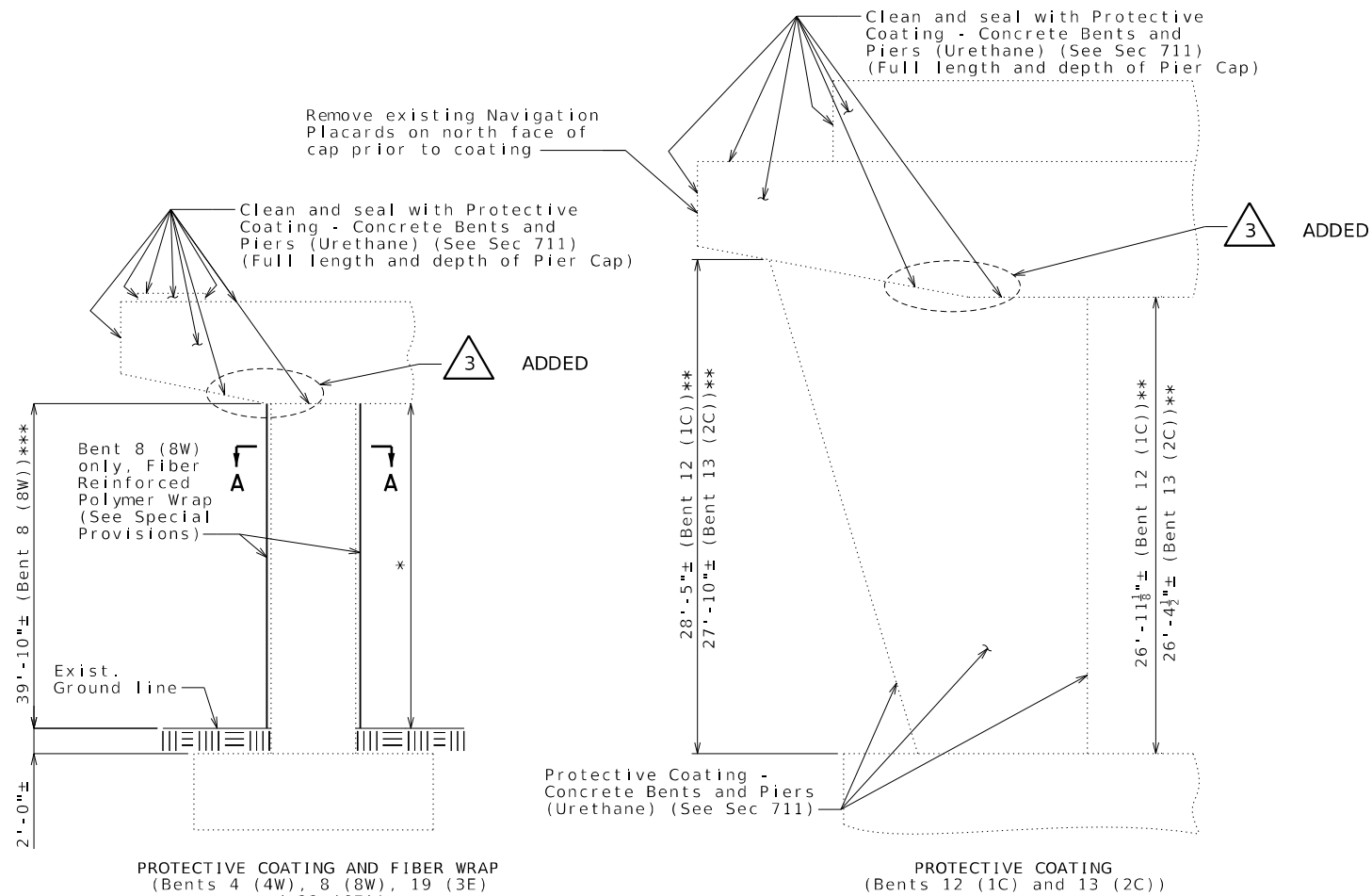

- * Limits of Protective Coating - Concrete Bents and Piers (Urethane) (Typ. @ each column)
31'-4"± (Bent 4 (4W))
28'-7"± (Bent 19 (3E))
23'-8"± (Bent 22 (6E))
- ** Limits of Protective Coating - Concrete Bents and Piers (Urethane) (Typ. @ each column)
- *** Limits of Fiber Reinforced Polymer Wrap (see Special Provisions) (Typ. @ each column)

Notes:

Work this sheet with Sheet No. 5.

Protective Coating - Concrete Bents and Piers (Urethane) shall not be applied on the FRP system.

3 REVISED

Detailed May 2025
Checked May 2025

Note: This drawing is not to scale. Follow dimensions.

Sheet No. 6 of 43

SUBSTRUCTURE REPAIR & CONCRETE PROTECTIVE COATING DETAILS

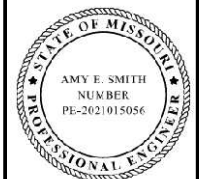

THIS SHEET HAS BEEN SIGNED, SEALED AND DATED ELECTRONICALLY

DATE PREPARED
8/28/2025

ROUTE
370

STATE
MO

DISTRICT
BR

SHEET NO.
6

COUNTY
ST. LOUIS/
ST. CHARLES

JOB NO.
J6P3554

CONTRACT ID.

PROJECT NO.

BRIDGE NO.
A45577

DESCRIPTION

DATE

DATE

DATE

DATE

DATE

DATE

DATE

DATE

DATE

DATE

DATE

DATE

DATE

DATE

DATE

DATE

DATE

DATE

DATE

DATE

DATE

DATE

DATE

DATE

DATE

DATE

IF A SEAL IS PRESENT ON THIS SHEET IT HAS BEEN ELECTRONICALLY SEALED AND DATED.

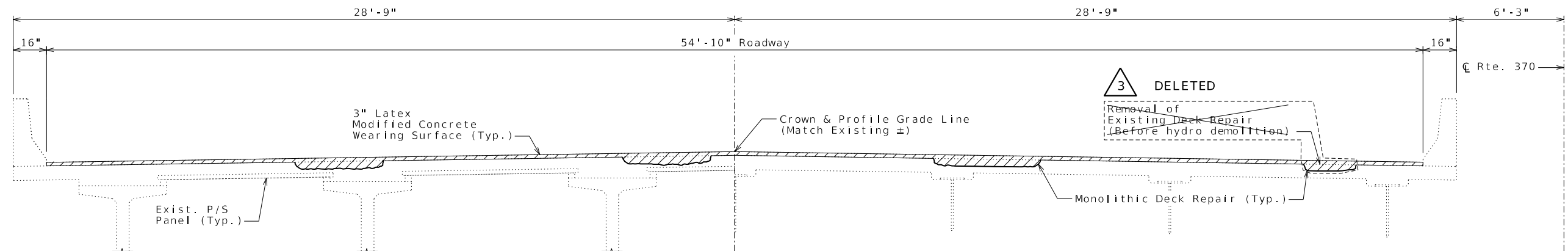

UNITS 1-3 AND 6-8 PRESTRESSED
CONCRETE BULB-TEE GIRDER SECTION

UNIT 4 SIMPLE THRU TRUSS (SHOWN) AND UNIT 5
CONTINUOUS COMPOSITE PLATE GIRDER SECTION

TYPICAL SECTION THRU EXISTING DECK

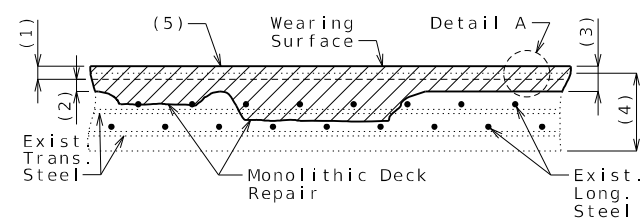

MONOLITHIC DECK REPAIR

(Cast-in-place deck from Units 4-5 shown,
Prestress Panel Deck in Units 1-3 and 6-8 similar)

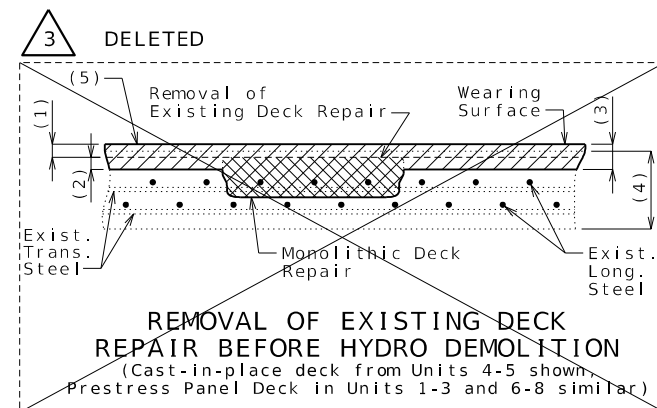

~~REMOVAL OF EXISTING DECK
REPAIR BEFORE HYDRO DEMOLITION~~

~~(Cast-in-place deck from Units 4-5 shown,
Prestress Panel Deck in Units 1-3 and 6-8 similar)~~

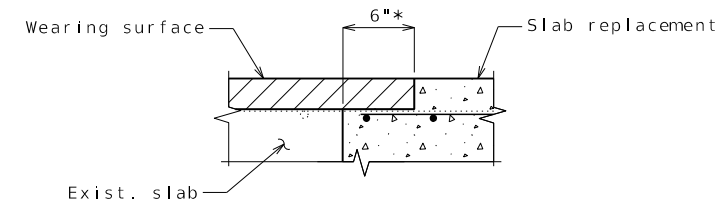

* Overlap Latex Modified Concrete Wearing Surface as shown at all slab replacement locations

SECTION THRU SLAB REPLACEMENT AT EXPANSION JOINTS

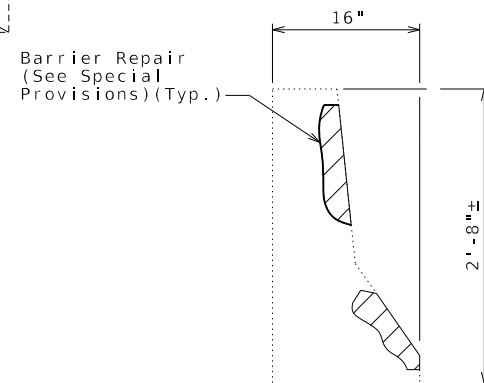

SECTION THRU BARRIER

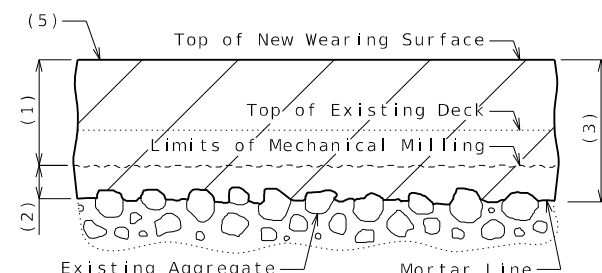

DETAIL A

- (1) Removal of existing 2 1/4" \pm Low Slump Concrete wearing surface plus 1/4" of existing deck.
- (2) 1/2" minimum total surface hydro demolition of sound concrete, measured to mortar line.
- (3) 3" minimum Latex Modified concrete wearing surface.
- (4) Original depth of deck minus previous scarification.
- (5) Diamond Grind new wearing surface.
See Special Provisions.

Notes:

For Staging Plans, see Sheet No. 4.

Unformed Barrier Repair may utilize
shotcrete concrete repair method.
See Special Provisions.

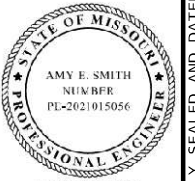

THIS SHEET HAS BEEN
SIGNED, SEALED AND DATED
ELECTRONICALLY

DATE PREPARED

9/9/2025		CTD
ROUTE	STATE	

ROUTE	STATE
370	MO

DISTRICT	SHEET NO.
55	13

BR	12	RECEIVED
COUNTY		

ST. LOUIS/
ST. CHARLES

JOB NO.
LCB2554

J6P3554	
CONTRACT ID.	

334

PROJECT NO.	U
-------------	---

BRIDGE NO.

A45577

--	--	--	--	--	--	--	--	--

[illegible][illegible]

**MISSOURI HIGHWAYS AND TRANSPORTATION
COMMISSION**

 **MoDOT**

105 WEST CAPITOL
JEFFERSON CITY, MO 65102
1-888-ASK-MODOT (1-888-275-6636)



HDR HDR Engineering, Inc.
401 S. 18th Street
Suite 300
St. Louis, MO 63103-2267
314-425-8300
Certificate of Authority: 000856

Detailed	May	2025
Checked	May	2025

Note: This drawing is not to scale. Follow dimensions.

Sheet No. 12 of 43

3 REVISED

c:\pwworking\central01\d4318784\B_A45577_012_J6P3554_R003.dgn 3:38:30 PM 9/9/2025

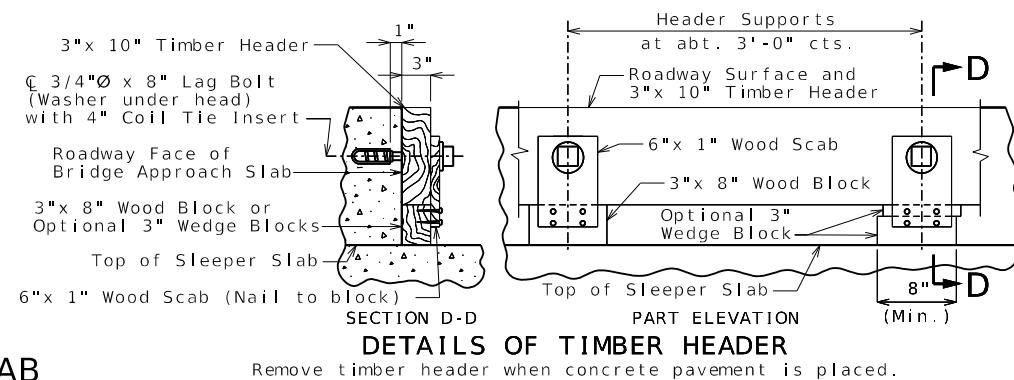
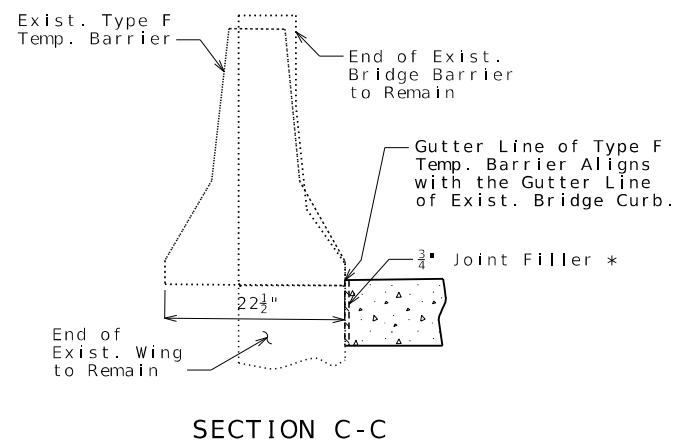
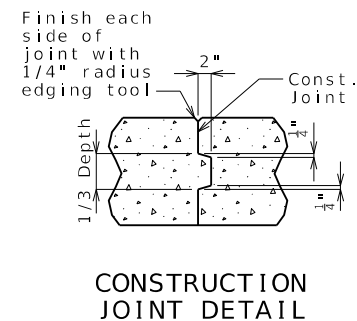
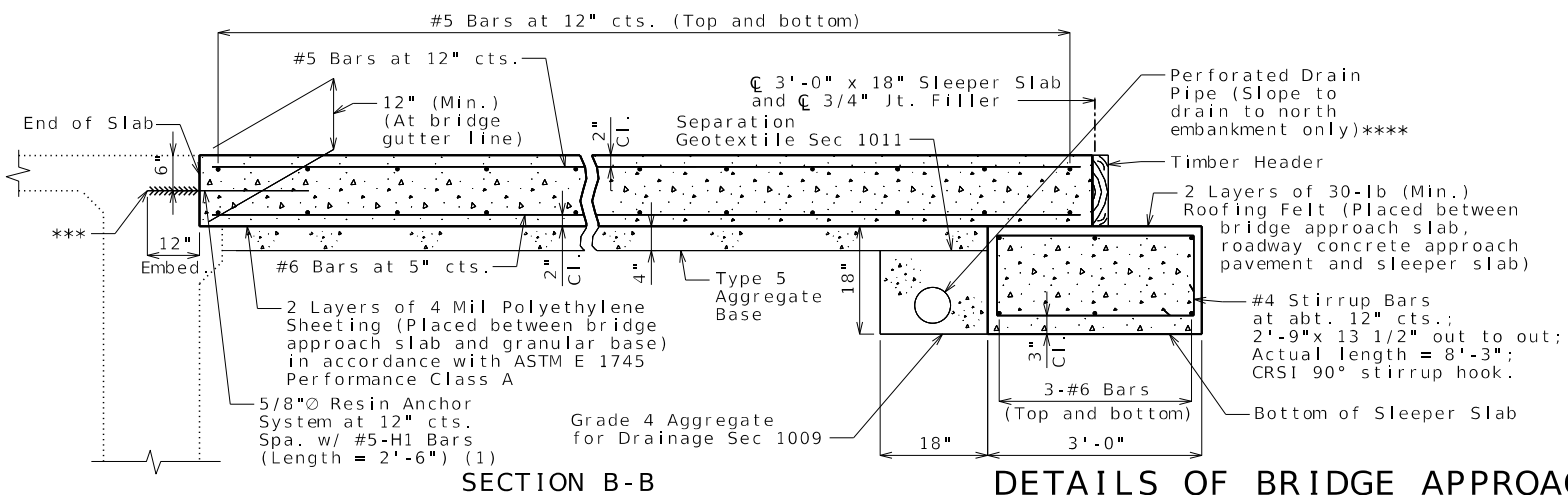
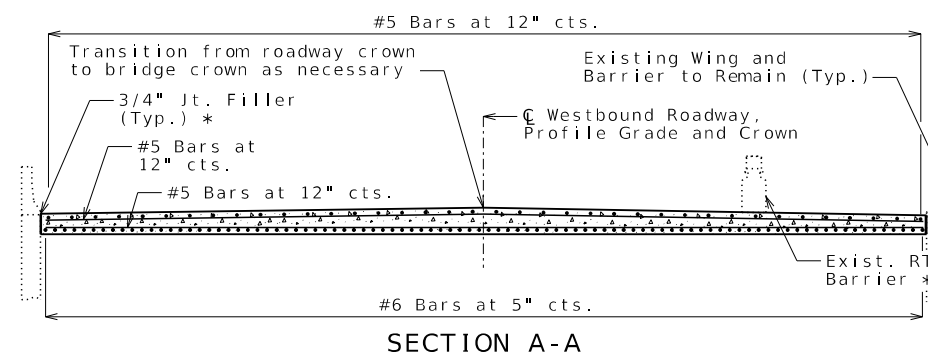
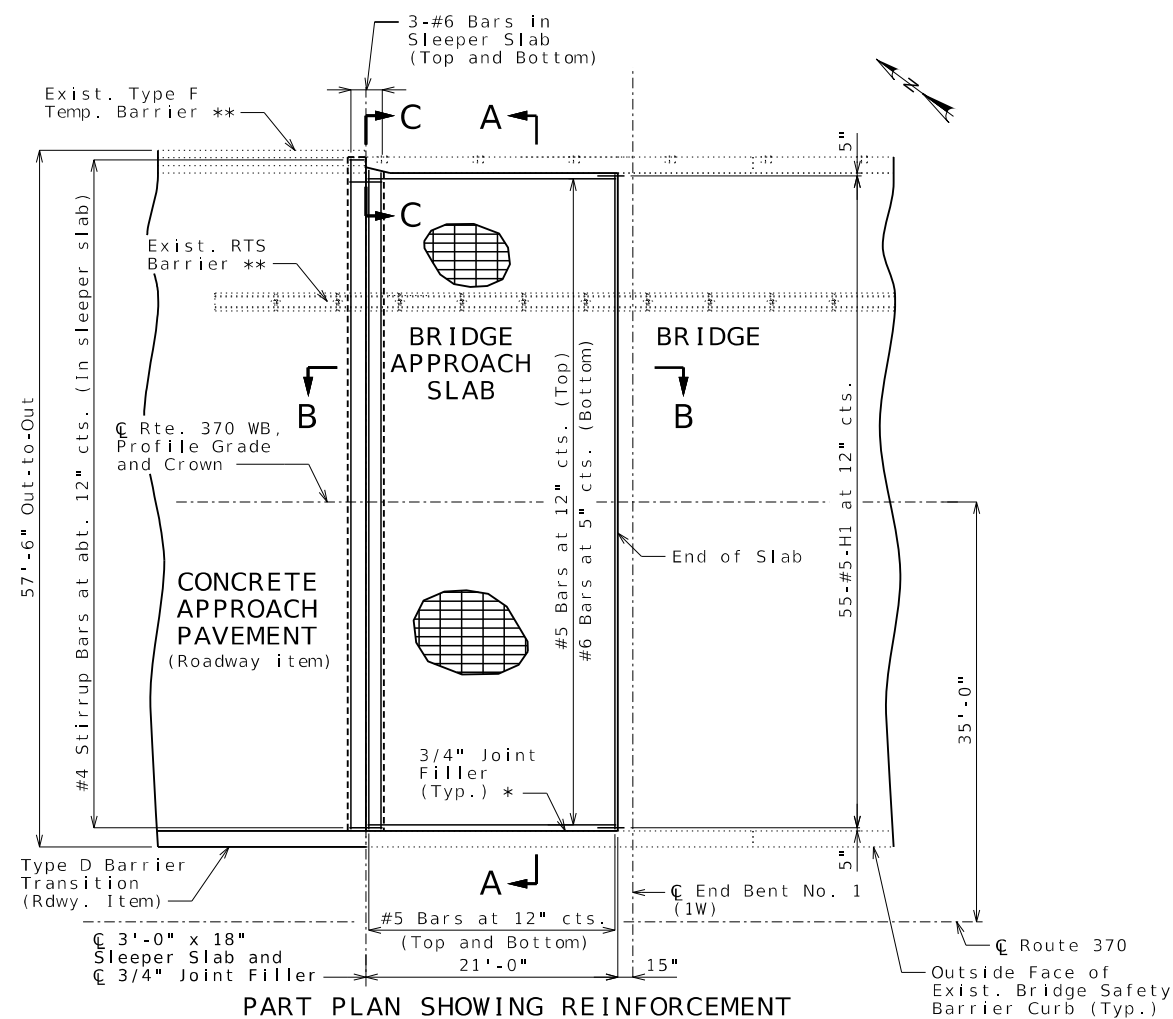

General Notes:

All concrete for the bridge approach slab and sleeper slab shall be in accordance with Sec 503 ($f'_c = 4,000$ psi).

The reinforcing steel in the bridge approach slab and the sleeper slab shall be epoxy coated Grade 60 with $f_y = 60,000$ psi.

Drain pipe may be either 6" diameter corrugated metallic-coated pipe underdrain, 4" diameter polyvinyl chloride (PVC) drain pipe, or 4" diameter corrugated polyethylene (PE) drain pipe.

Minimum clearance to reinforcing steel shall be 1 1/2",
unless otherwise shown.

The reinforcing steel in the bridge approach slab and the sleeper slab shall be continuous. The transverse reinforcing steel may be made continuous by providing a minimum lap splice of 29 inches for #5 bars and 44 inches for #6 bars, or by mechanical bar splice.

Mechanical bar splices shall be in accordance with Sec 710.

All joint filler shall be in accordance with Sec 1057 for preformed fiber expansion joint filler except as noted.

The contractor shall use one of the qualified resin anchor systems in accordance with Sec 1039.

For concrete approach pavement details, see Roadway Plans.

Payment for furnishing all materials, labor and excavation necessary to construct the approach slab, including the timber header, sleeper slab, underdrain, Type 5 aggregate base, joint filler and all other appurtenances and incidental work including the temporary relocation and replacement of the Type F Temp. Barrier as shown on this sheet, complete in place, will be considered completely covered by the contract unit price for Bridge Approach Slab (Major) per square yard.

Cost of furnishing and installing the resin anchor systems, complete in place, will be considered covered by the contract unit price for Bridge Approach Slab (Major) per square yard.

Removal of existing approach slab is included in Roadway Items.

* Seal joint between vertical face of approach slab and wing with sealant in accordance with Sec 717 for silicone joint sealant for saw cut and formed joints.

** Contractor to temporarily relocate barrier as needed to facilitate removal and replacement of the approach slab.

*** Existing reinforcement connecting the existing end bent and approach slab to be cleaned and reused if present. Otherwise, 5/8" dia. Resin Anchor System to be utilized as shown. Cost will be considered completely covered by the contract unit price for Bridge Approach Slab (Major) per square yard.

**** Contractor shall redirect Drain Pipe as required to daylight along the north embankment. Drain Pipe falling outside the limits of the bridge approach slab shall be unperforated drain pipe.

(1) Cost of furnishing and installing the resin anchor systems, complete in place, will be considered completely covered by the contract unit price for Bridge Approach Slab (Major) per square yard.

The minimum embedment depth in concrete with $f'c = 4,000$ psi for the resin anchor systems shall be that required to meet the minimum ultimate pullout strength in accordance with Sec 1039 but shall not be less than 5".

