

DESIGN DESIGNATION

A.A.D.T. - 2024 = 199

V = 55 M.P.H.

T = 10%

FUNCTIONAL CLASSIFICATION- MINOR COLLECTOR

NO NEW RIGHT OF WAY

MISSOURI HIGHWAYS AND TRANSPORTATION COMMISSION  
PLANS FOR PROPOSED  
STATE HIGHWAY  
WASHINGTON COUNTY

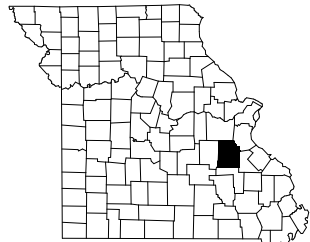

KEY MAP  
LOCATION OF WASHINGTON COUNTY

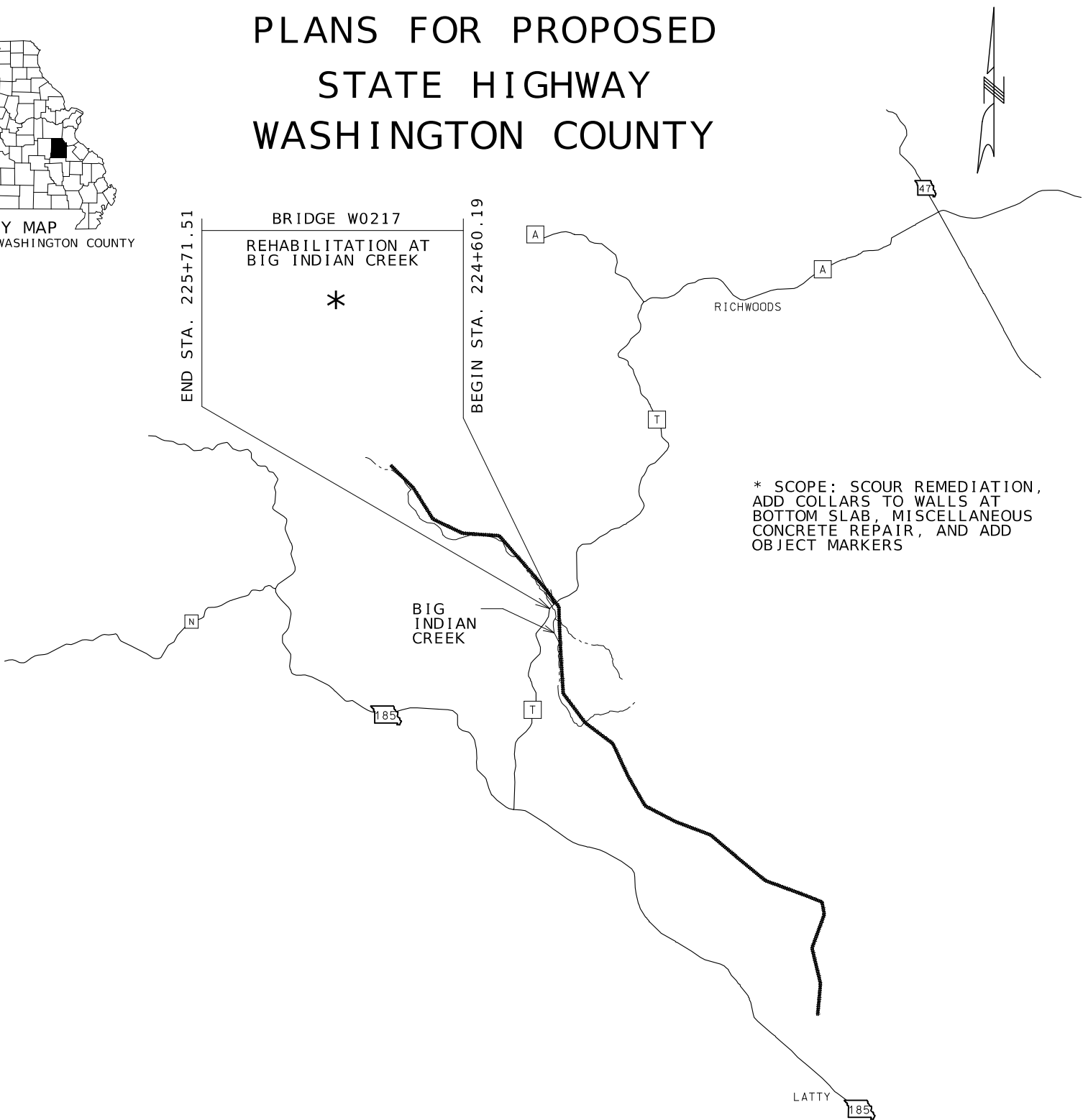

\* SCOPE: SCOUR REMEDIATION,  
ADD COLLARS TO WALLS AT  
BOTTOM SLAB, MISCELLANEOUS  
CONCRETE REPAIR, AND ADD  
OBJECT MARKERS

NOT TO SCALE

THE EXISTENCE AND APPROXIMATE LOCATION OF UTILITY FACILITIES KNOWN TO EXIST, AS SHOWN ON THE PLANS, ARE BASED ON THE BEST INFORMATION AVAILABLE TO THE COMMISSION AT THIS TIME. THIS INFORMATION IS PROVIDED BY THE COMMISSION "AS-IS" AND THE COMMISSION EXPRESSLY DISCLAIMS ANY REPRESENTATION OR WARRANTY AS TO THE COMPLETENESS, ACCURACY, OR SUITABILITY OF THE INFORMATION FOR ANY USE. RELIANCE UPON THIS INFORMATION IS DONE AT THE RISK AND PERIL OF THE USER, AND THE COMMISSION SHALL NOT BE LIABLE FOR ANY DAMAGES THAT MAY ARISE FROM ANY ERROR IN THE INFORMATION. IT IS, THEREFORE, THE RESPONSIBILITY OF THE CONTRACTOR TO VERIFY THE EXISTENCE, LOCATION AND STATUS OF ANY FACILITY. SUCH VERIFICATION INCLUDES DIRECT CONTACT WITH THE LISTED UTILITIES.

INDEX OF SHEETS

DESCRIPTION	SHEET NUMBER
TITLE SHEET .....	1
TYPICAL SECTIONS (TS) (1 SHEET)----	2
QUANTITIES (QU) (1 SHEET)-----	3
PLAN-PROFILE (PP)-----	4
SPECIAL SHEETS (SS)-----	5
TRAFFIC CONTROL SHEETS (TC) .....	6-8
BRIDGE DRAWINGS (B) (2 SHEETS)	
W0217-----	1-2



DATE PREPARED 12/1/2025	
ROUTE T	STATE MO
DISTRICT CD	SHEET NO. 1
COUNTY WASHINGTON	
JOB NO. J5S3556	
CONTRACT ID.	

PROJECT NO.
BRIDGE NO.

DESCRIPTION	DATE

LENGTH OF PROJECT

BEGINNING OF PROJECT	STA. 224+60.19
END OF PROJECT	STA. 225+71.51

APPARENT LENGTH 111.32 FEET

EQUATIONS AND EXCEPTIONS: NONE

TOTAL CORRECTIONS	0.00 FEET
NET LENGTH OF PROJECT	111.32 FEET
STATE LENGTH	0.021 MILES

ESTIMATED DISTURBED ACRES (FOR INFORMATION ONLY) 0.01

MISSOURI HIGHWAYS AND TRANSPORTATION COMMISSION

105 WEST CAPITOL  
JEFFERSON CITY, MO 65102  
1-888-ASK-MODOT (1-888-275-6636)

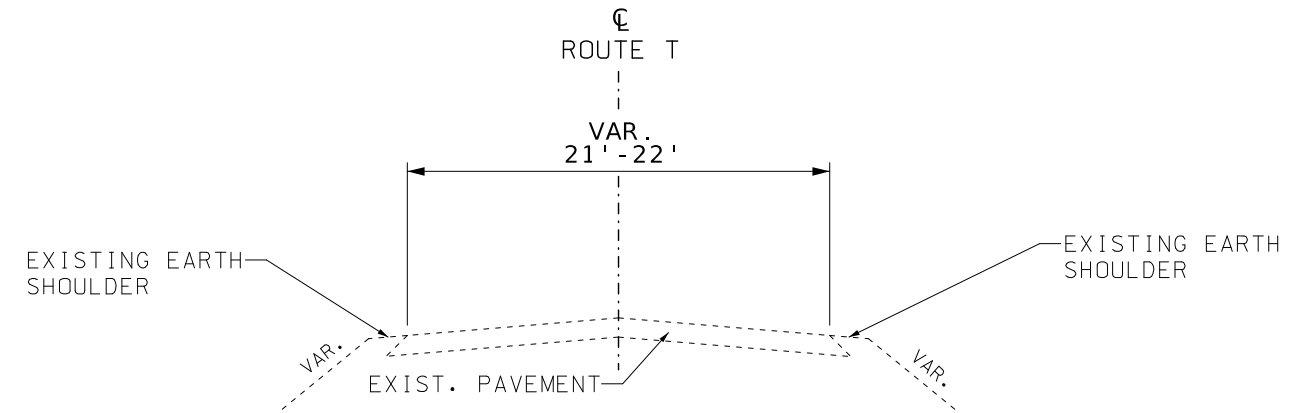

EXISTING TYPICAL SECTION  
ROUTE T  
STA. 224+60.19 TO STA. 225.00.19  
STA. 225+31.19 TO STA. 225+71.51

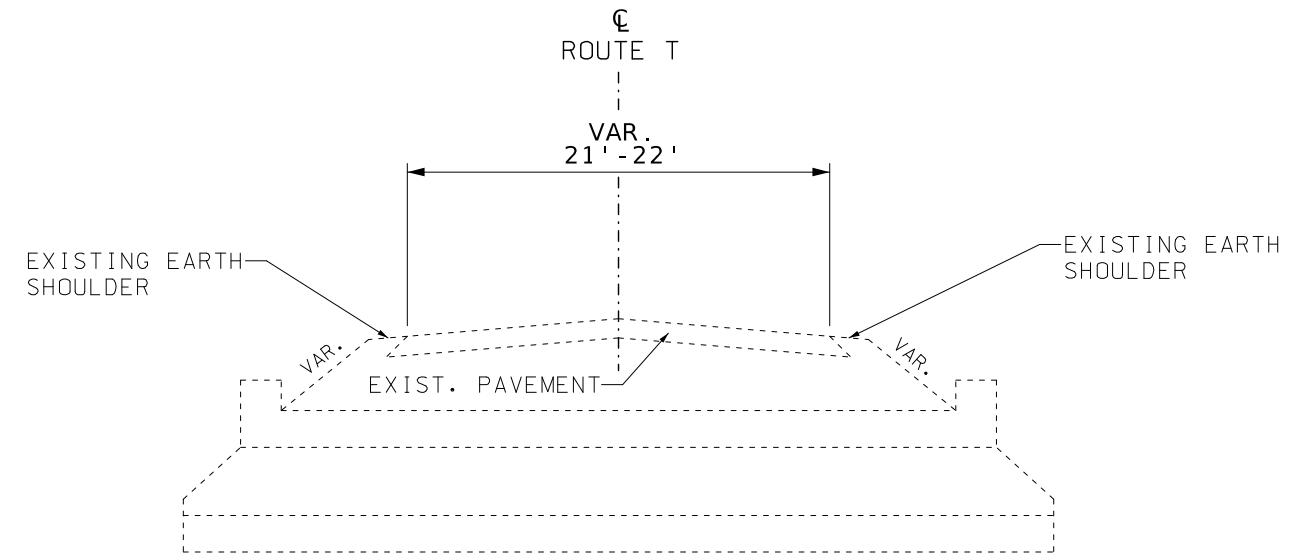

EXISTING TYPICAL SECTION  
ROUTE T  
BOX CULVERT BRIDGE W0217  
STA. 225+00.19 TO STA. 225+31.51

NOT TO SCALE

TYPICAL SECTIONS



*Maria Peters*  
10/27/2025 10:05:54 AM  
MARIA K. PETERS - CIVIL  
MO-PE-2000162118



DATE PREPARED	
10/27/2025	
ROUTE	STATE
T	MO
DISTRICT	SHEET NO.
CD	2
COUNTY	
WASHINGTON	
JOB NO.	
J5S3556	
CONTRACT ID.	
PROJECT NO.	
BRIDGE NO.	

DATE	DESCRIPTION

MISSOURI HIGHWAYS AND TRANSPORTATION COMMISSION



105 WEST CAPITOL  
JEFFERSON CITY, MO 65102  
1-888-ASK-MODOT (1-888-275-6636)

STANDARD SIGN ASSEMBLIES				
SIGN SET NO.	STATION	LOCATION	TYPE	TYPE
			OM3 -L	OM3 -R
			SIGN DESCRIPTION, SIZES & NUMBER - QTY. (SF)	SIGN DESCRIPTION, SIZES & NUMBER - QTY. (SF)
				
3	224+60.19	BRIDGE W0217 / RT		3
3	224+60.19	BRIDGE W0217 / LT	3	
2	224+80.19	BRIDGE W0217 / RT		3
2	224+80.19	BRIDGE W0217 / LT	3	
1	225+00.19	BRIDGE W0217 / RT		3
1	225+00.19	BRIDGE W0217 / LT	3	
1	225+31.51	BRIDGE W0217 / RT		3
1	225+31.51	BRIDGE W0217 / LT	3	
2	225+51.51	BRIDGE W0217 / RT		3
2	225+51.51	BRIDGE W0217 / LT	3	
3	225+71.51	BRIDGE W0217 / RT		3
3	225+71.51	BRIDGE W0217 / LT	3	

SIGN POSTS					U CHANNEL POST 3 LB. POST SIZE 14' LENGTH ITEM NO. 9031250A LF
SIGN SET NO.	STATION	SIGN SIZE	LOCATION	POST QTY.	
3	224+60.19	1X3	RTE T / RT	1	14
3	224+60.19	1X3	RTE T / LT	1	14
2	224+80.19	1X3	RTE T / RT	1	14
2	224+80.19	1X3	RTE T / LT	1	14
1	225+00.19	1X3	RTE T / RT	1	14
1	225+00.19	1X3	RTE T / LT	1	14
1	225+31.51	1X3	RTE T / RT	1	14
1	225+31.51	1X3	RTE T / LT	1	14
2	225+51.51	1X3	RTE T / RT	1	14
2	225+51.51	1X3	RTE T / LT	1	14
3	225+71.51	1X3	RTE T / RT	1	14
3	225+71.51	1X3	RTE T / LT	1	14
				TOTAL	168

NOTE: U CHANNEL POST SHALL BE CUT IN THE FIELD TO MEET THE MIN. SIGN MOUNTING HEIGHT SHOWN ON SPECIAL SHEET 1 OF 1

CULVERT CLEANOUT				
STATION	STATION	LOCATION	CULVERT CLEANOUT (EA)	REMARKS
225+00.19	225+31.51	RTE T	1	BOX CULVERT HAS 3 CELLS
		TOTAL	1.0	
		USE	1	

SIGN SUMMARY				
STANDARD SIGN OR SPECIAL SIGN NUMBER	SIGN DETAIL SHEET NO.	QTY.	SIZE, TYPE & SQUARE FEET	
			SIZE	FLAT SHEET FLUORESCENT, SHF
				ITEM NO.
				9035069A SF
OBJECT MARKER (OM3-L)	STD	6	12" X 36"	18
OBJECT MARKER (OM3-R)	STD	6	12" X 36"	18
		TOTAL	36	

TYPE 2 ROCK BLANKET					
SHEET NO.	LOCATION	FURNISHING ROCK BLANKET (CY)	PLACING ROCK BLANKET (CY)	PERMANENT EROSION CONTROL GEOTEXTILE (SY)	REMARKS
4	RTE T	175.0	175.0	115.0	SEE PLAN SHEET 1
	TOTAL	175.0	175.0	115.0	
	USE	175	175	115	

REMOVAL OF IMPROVEMENTS			
STATION	LOCATION	ITEM	QUANTITY
225+00.19	RTE T / RT	OBJECT MARKERS AND POST	1 EA
225+00.19	RTE T / LT	OBJECT MARKERS AND POST	1 EA
225+31.51	RTE T / RT	OBJECT MARKERS AND POST	1 EA
225+31.51	RTE T / LT	OBJECT MARKERS AND POST	1 EA
		USE	1 LUMP SUM

CONSTRUCTION SIGNING RTE T						
SIGN	SIZE IN.	AREA SQ.FT.	QTY EACH	TOTAL AREA SQ.FT.	SIGN NUM.	DESCRIPTION
WARNING SIGNS						
WO20-1	48X48	16	2	32	2	ROAD WORK AHEAD
WO20-4	48X48	16	2	32	7	ONE LANE ROAD AHEAD
WO20-7a	48X48	16	2	32	8	FLAGGER (SYMBOL, WITH FLAGS)
WO21-5	48X48	16	2	32	21	SHOULDER WORK AHEAD
616.10.05 CONSTRUCTION SIGNS TOTAL				128		

ADDITIONAL CONSTRUCTION ITEMS		
ITEM NO.	QUANTITY	DESCRIPTION
616-10.25	30	CHANNELIZERS (TRIM-LINE)
616-1099 *	2	CHANGEABLE MESSAGE SIGNS *

SEEDING AND MULCHING	
COOL SEASON GRASS	
1 LUMP SUM	

CLEARING AND GRUBBING	
QUANTITY (ACRE)	
1	

MOBILIZATION	
1 LUMP SUM	

STATE OF MISSOURI

MARIA K. PETERS

NUMBER

PE-2000162118

PROFESSIONAL ENGINEER

Maria K. Peters

10/27/2025 1:37:18 PM

MARIA K. PETERS - CIVIL

MO-PE-2000162118

DATE PREPARED

10/27/2025

ROUTE

T

STATE

MO

DISTRICT

CD

SHEET NO.

3

COUNTY

WASHINGTON

JOB NO.

J5S3556

CONTRACT ID.

PROJECT NO.

BRIDGE NO.

DESCRIPTION

DATE

MISSOURI HIGHWAYS AND TRANSPORTATION COMMISSION

105 WEST CAPITOL

JEFFERSON CITY, MO 65102

1-888-ASK-MODOT (1-888-273-6636)

MoDOT

NOTE:  
TREE CLEARING LIMITS SHALL BE WITHIN  
THE LIMITS OF EXISTING RIGHT OF WAY  
AND PERMANENT EASEMENTS, AS NEEDED FOR  
CONSTRUCTABILITY. SEE TREE CLEARING  
RESTRICTION JSP FOR DETAILS.

NOTE:  
NO ROADWAY SIDESLOPE DISTURBANCE  
EXPECTED. IT IS THE RESPONSIBILITY  
OF THE CONTRACTOR TO MAINTAIN  
THE SWPP.

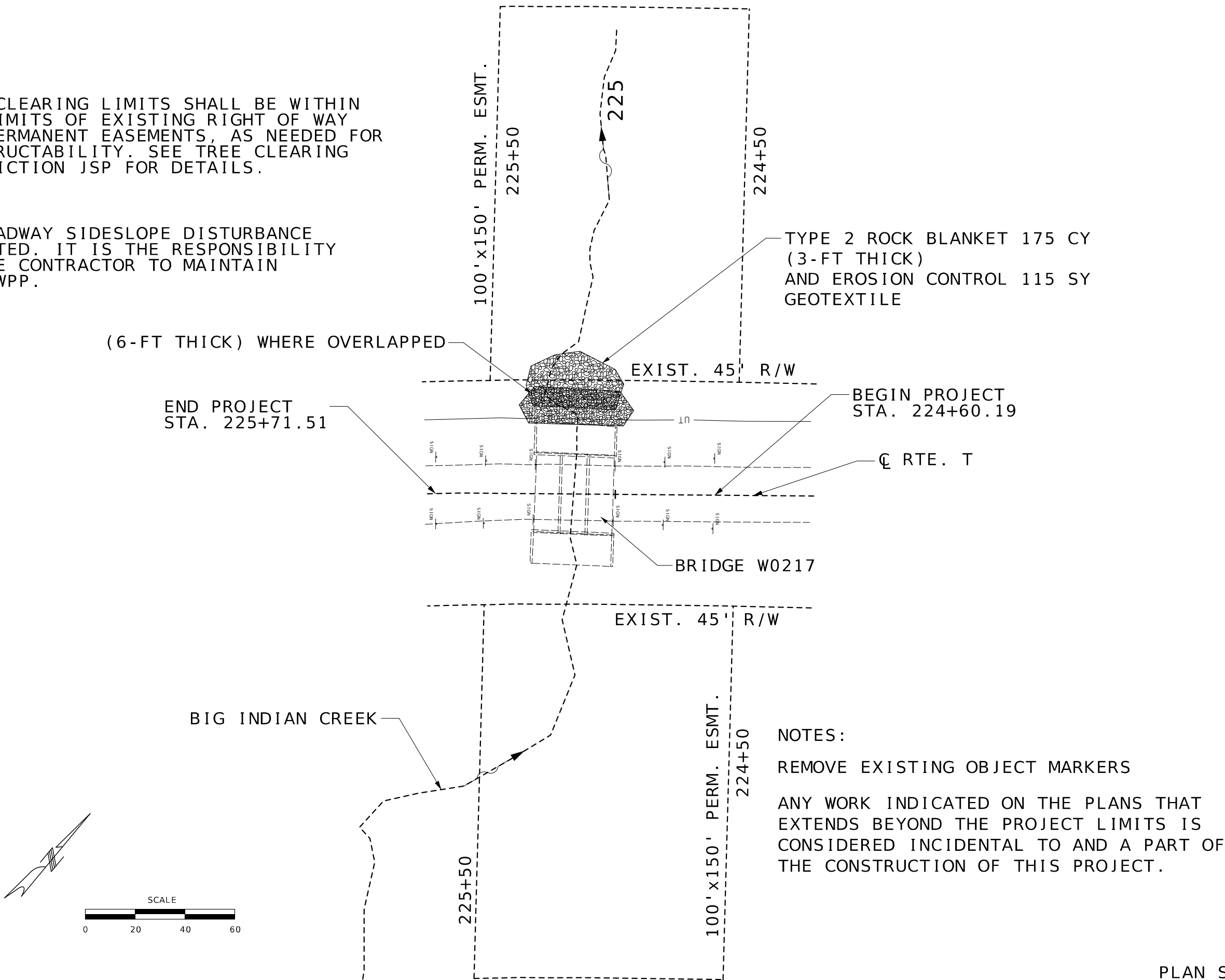

NOTES:  
REMOVE EXISTING OBJECT MARKERS  
ANY WORK INDICATED ON THE PLANS THAT  
EXTENDS BEYOND THE PROJECT LIMITS IS  
CONSIDERED INCIDENTAL TO AND A PART OF  
THE CONSTRUCTION OF THIS PROJECT.



DATE PREPARED  
12/1/2025

ROUTE  
T

STATE  
MO

DISTRICT  
CD

SHEET NO.  
4

COUNTY  
WASHINGTON

JOB NO.  
J553556

CONTRACT ID.

PROJECT NO.

BRIDGE NO.

DESCRIPTION

DATE

DATE

DATE

DATE

DATE

DATE

DATE

DATE

DATE

DATE

DATE

DATE

DATE

DATE

DATE

DATE

DATE

DATE

DATE

DATE

DATE

DATE

DATE

DATE

DATE

DATE

DATE

DATE

DATE

DATE

DATE

DATE

DATE

DATE

DATE

DATE

DATE

DATE

DATE

DATE

DATE

DATE

DATE

DATE

DATE

TYPE 3 OBJECT MARKERS			
STATION	SIGN SET	LOCATION	BRIDGE
224+60.19	3	RTE T / RT	W0217
224+60.19	3	RTE T / LT	W0217
224+80.19	2	RTE T / RT	W0217
224+80.19	2	RTE T / LT	W0217
225+00.19	1	RTE T / RT	W0217
225+00.19	1	RTE T / LT	W0217
225+31.51	1	RTE T / RT	W0217
225+31.51	1	RTE T / LT	W0217
225+51.51	2	RTE T / RT	W0217
225+51.51	2	RTE T / LT	W0217
225+71.51	3	RTE T / RT	W0217
225+71.51	3	RTE T / LT	W0217

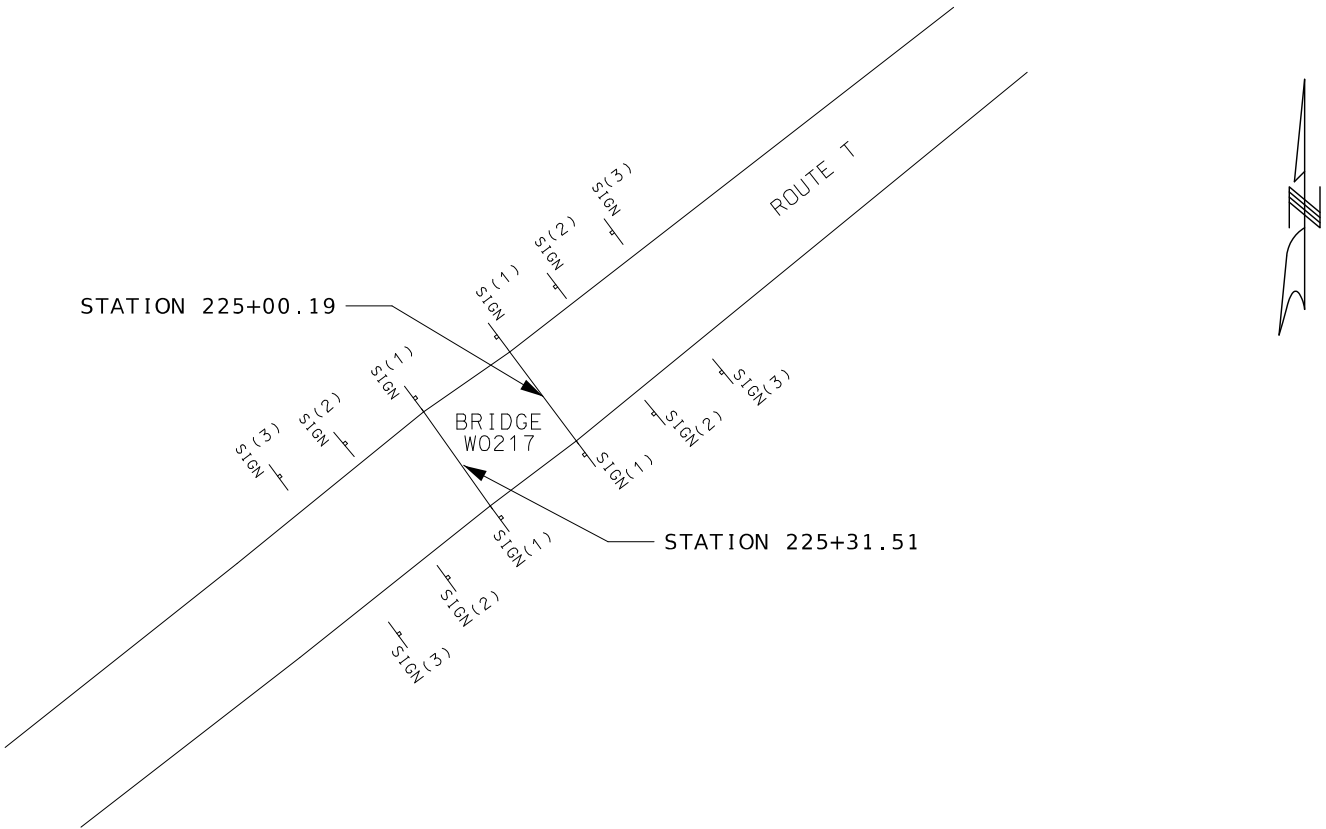

- (1) PLACED AS NEAR THE OBSTRUCTION AS POSSIBLE AND SET TO LINE UP WITH INSIDE EDGE OF OBSTRUCTION.  
(2) PLACED 1.5 FEET OFF THE EDGE OF PAVEMENT AND 20 FEET FROM THE END OF THE OBSTRUCTION.  
(3) PLACED 3.0 FEET OFF THE EDGE OF PAVEMENT AND 40 FEET FROM THE END OF THE OBSTRUCTION.

NOT TO SCALE

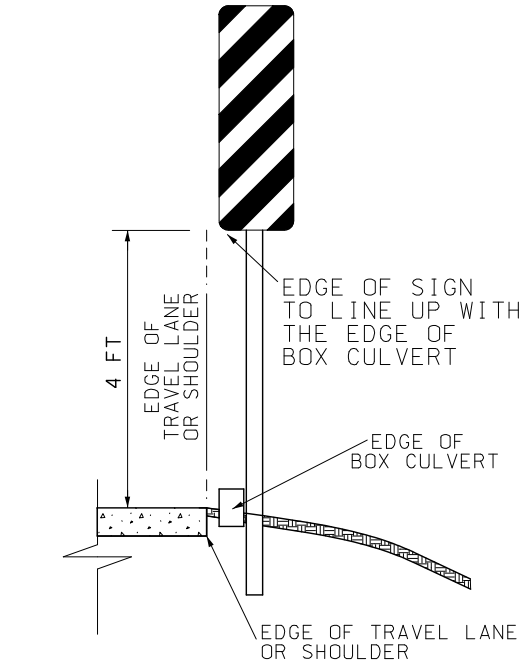

MOUNTING HEIGHT AND OFFSET  
TYPE 3 OBJECT MARKER INSTALLATION

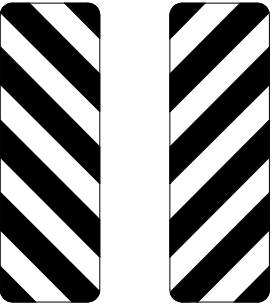

OM3-L OM3-R

TYPE 3 OBJECT MARKER  
12 IN. X 36 IN.

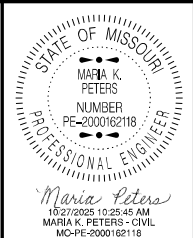

DATE PREPARED 10/27/2025	
ROUTE T	STATE MO
DISTRICT CD	SHEET NO. 5
COUNTY WASHINGTON	
JOB NO. J5S3556	
CONTRACT ID.	
PROJECT NO.	
BRIDGE NO.	

DESCRIPTION	DATE

MISSOURI HIGHWAYS AND TRANSPORTATION COMMISSION

105 WEST CAPITOL  
JEFFERSON CITY, MO 65102  
1-888-ASK-MODOT (1-888-275-6636)

MoDOT

Sign Spacing, Device Spacing  
and Channelizing Taper Lengths

SIGN SPACING (S) FOR ADVANCE SIGN SERIES (1) (2)		
SPEED MPH	UNDIVIDED HIGHWAYS	DIVIDED HIGHWAYS
0-35	200	200
40-45	350	500
50-55	500	1000
60-70	1000	SA-1000 SB-1500 SC-2640

TAPER LENGTHS AND SPACING OF CHANNELIZING DEVICES					
SPEED MPH	MINIMUM TAPER LENGTHS (L) FOR LANE WIDTHS (W)			MAXIMUM CHANNELIZER SPACING	
	10 FT	11 FT	12 FT	THROUGH TAPER	THROUGH WORK AREA
0-35	205	225	245	35	40
40-45	450	495	540	40	80
50-55	550	605	660	50	80
60-70	700	770	840	60	120

NOTES:

DIMENSIONS IN FEET UNLESS OTHERWISE NOTED.

(1) SPACING BETWEEN SIGNS AND SPACING BETWEEN LAST SIGN AND FLAGGER, BEGINNING OF TAPER, OR SIGNED CONDITION

(2) SPACINGS MAY BE ADJUSTED AS NECESSARY TO MEET FIELD CONDITIONS

LONGITUDINAL BUFFER SPACE (B)	
SPEED MPH	BUFFER SPACE
0-35	250
40-45	360
50-55	495
60-70	730

TAPER LENGTH (L):

L = WS FOR 40 MPH OR MORE

L =  $\frac{WS^2}{60}$  FOR 35 MPH OR LESS

FOR SHOULDER TAPER USE L/3

WHERE:

L = TAPER LENGTH IN FEET

W = LATERAL SHIFT IN FEET

S = POSTED SPEED IN MPH

TRAFFIC CONTROL DEVICES

GENERAL NOTES:

- SEE STANDARD PLAN 616.10 FOR DETAILS AND ITEMS NOT SHOWN
- EXISTING SIGNS SHALL BE COVERED DURING WORKING HOURS ONLY IF IN CONFLICT WITH TRAFFIC CONTROL PLANS.
- NO DIRECT PAYMENT WILL BE MADE FOR RELOCATING, COVERING, UNCOVERING OR REMOVING SIGNS.
- CONES ALLOWABLE FOR DAYTIME OPERATIONS ONLY.
- LOCATE FLASHING ARROW PANEL AT BEGINNING OF TAPER WHEN FEASIBLE, ARROW PANELS ARE ALWAYS LOCATED BEHIND CHANNELIZERS OR CONES.

TRAFFIC CONTROL LEGEND

• SIGN (SINGLE SIDED)

• SIGN (DOUBLE SIDED)

◁ FLAGGER

▲ DIRECTION INDICATOR BARRICADE

■ CHANNELIZER

E BARRICADE

CHANGEABLE MESSAGE BOARD

FLASHING ARROW PANEL

TMA (TRUCK MOUNTED ATTENUATOR) WITH FLASHING ARROW PANEL

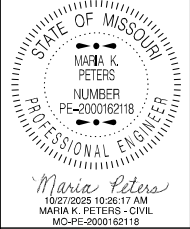

DATE PREPARED 10/27/2025	
ROUTE T	STATE MO
DISTRICT CD	SHEET NO. 6
COUNTY WASHINGTON	
JOB NO. J5S3556	
CONTRACT ID.	

PROJECT NO.
BRIDGE NO.

DESCRIPTION	DATE

MISSOURI HIGHWAYS AND TRANSPORTATION COMMISSION



105 WEST CAPITOL  
JEFFERSON CITY, MO 65102  
1-888-ASK-MODOT (1-888-275-6636)



WORK BEYOND THE SHOULDER  
UNDIVIDED OR DIVIDED HIGHWAY

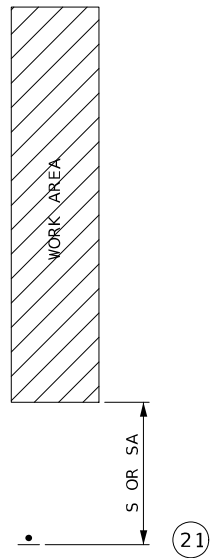

W021 - 5  
21

NOT TO SCALE

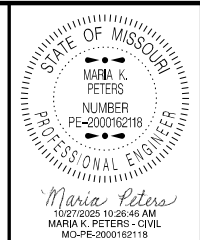

DATE PREPARED 10/27/2025	
ROUTE T	STATE MO
DISTRICT CD	SHEET NO. 7
COUNTY WASHINGTON	
JOB NO. J5S3556	
CONTRACT ID.	
PROJECT NO.	
BRIDGE NO.	

DATE	DESCRIPTION

MISSOURI HIGHWAYS AND TRANSPORTATION COMMISSION



105 WEST CAPITOL  
JEFFERSON CITY, MO 65102  
1-888-ASK-MODOT (1-888-275-6636)

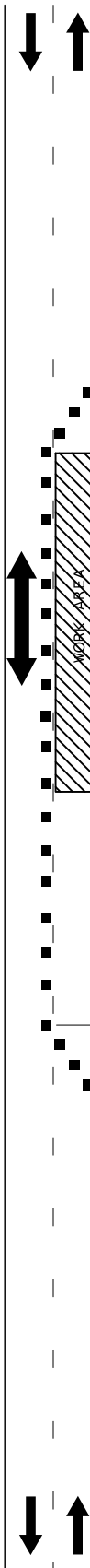
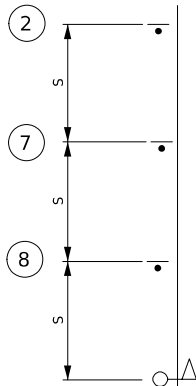

100' TAPER  
5 DEVICE MINIMUM

100' TAPER  
5 DEVICE MINIMUM

LOCATION TO BE DETERMINED BY ENGINEER

LOCATION TO BE DETERMINED BY ENGINEER



WO20-1

2



WO20-4

7



WO20-7a

8a

NOT TO SCALE

LANE CLOSURE  
ON TWO-LANE ROAD  
USING FLAGGERS

TEMPORARY TRAFFIC CONTROL  
SHEET 3 OF 3



DATE PREPARED  
10/27/2025

ROUTE  
T

STATE  
MO

DISTRICT  
CD

SHEET NO.  
8

COUNTY  
WASHINGTON

JOB NO.  
J5S3556

CONTRACT ID.

PROJECT NO.

BRIDGE NO.

DESCRIPTION

DATE

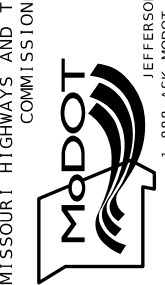

MISSOURI HIGHWAYS AND TRANSPORTATION  
COMMISSION



105 WEST CAPITOL  
JEFFERSON CITY, MO 65102  
1-888-ASK-MODOT (1-888-273-6636)



U.I.P. AND REHABILITATE 3(10'X 8') CONCRETE BOX CULVERT

SEC/SUR 28 TWP 39 N RGE 1 E

General Notes:

Design Specifications:  
2002 AASHTO LFD (17th Ed.) Standard Specifications  
Culvert Condition Rating = 5

Design Loading:  
H15 (AASHO 1926-1928 Assumed)

Design Unit Stresses:  
Class B-1 Concrete (Box Culvert)  $f'c = 4,000$  psi  
Structural Carbon Steel (ASTM A709 Grade 36)  $fy = 36,000$  psi  
Reinforcing Steel (ASTM A615 Grade 60)  $fy = 60,000$  psi

Reinforcing Steel:  
Minimum clearance to reinforcing steel shall be 1 1/2", unless otherwise shown.

Miscellaneous:  
Bars bonded in existing concrete not removed shall be cleanly stripped and embedded into new concrete where possible. If length is available, existing bars shall extend into new concrete at least 40 diameters for plain bars and 30 diameters for deformed bars, unless otherwise noted.  
Outline of existing work is indicated by light dashed lines. Heavy lines indicate new work.  
Contractor shall verify all dimensions in field before ordering new materials.  
The area exposed by the removal of concrete and not covered with new concrete shall be coated with an approved qualified special mortar in accordance with Sec 704.  
Traffic Handling:  
Traffic to be maintained on structure during construction. See roadway plans for traffic control.

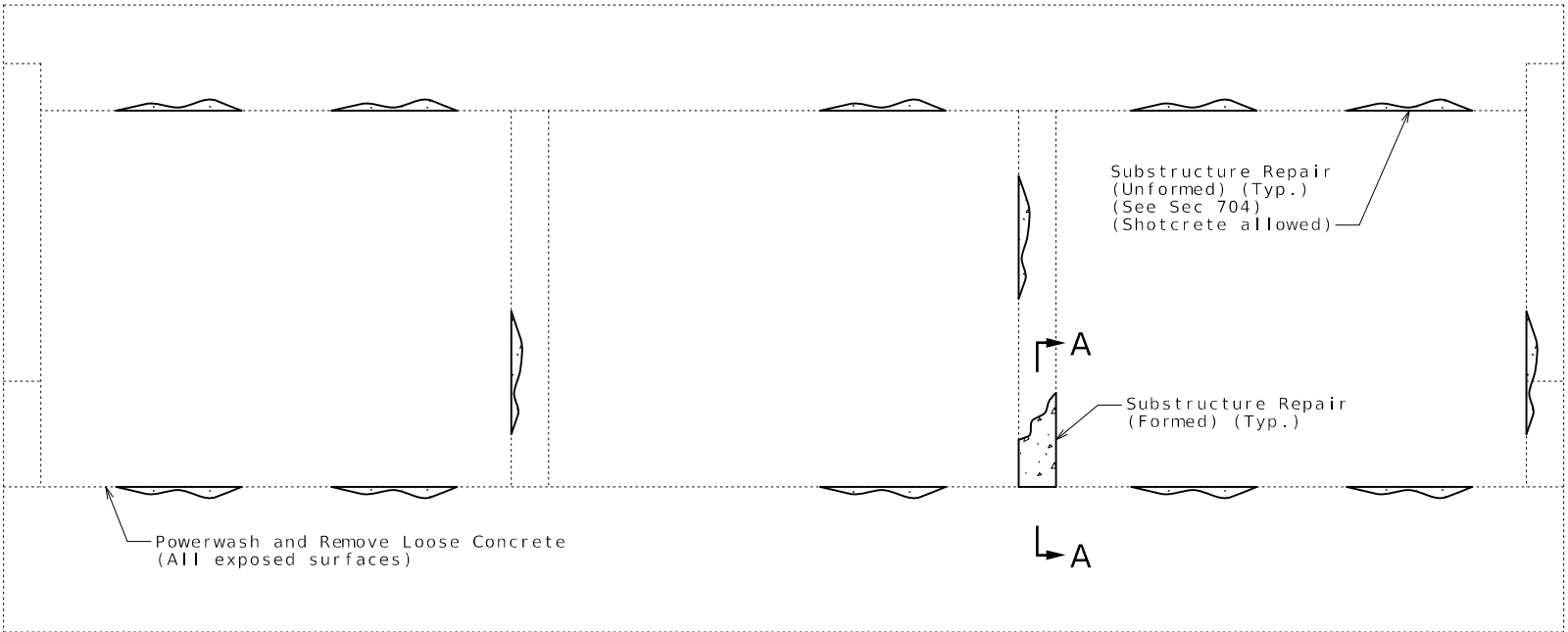

UPSTREAM ELEVATION OF BOX CULVERT SHOWING REPAIRS

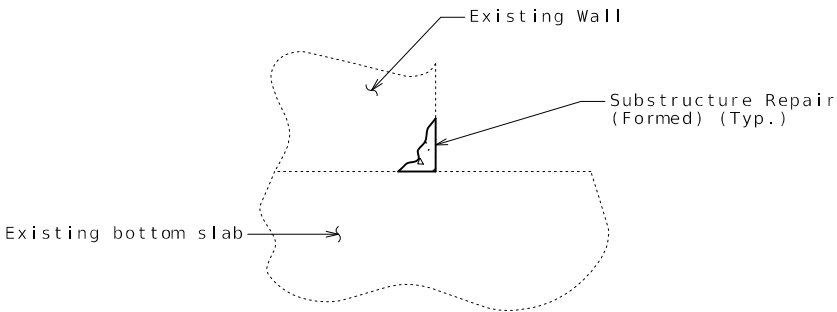

SECTION A-A

REPAIRS TO CULVERT: ROUTE T  
OVER INDIAN CREEK BRANCH

ROUTE T FROM ROUTE 185 TO ROUTE A  
ABOUT 3.1 MILES NORTH OF ROUTE 185  
TIE STATION 225+16.00± (MATCH EXISTING)

Estimated Quantities		
Item		Total
Dewatering	lump sum	1
Powerwash and Remove Loose Concrete	sq. foot	5115
Class B-1 Concrete	cu. yard	5.2
Substructure Repair (Formed)	sq. foot	31
Substructure Repair (Unformed)	sq. foot	150
Cleaning & Epoxy Coating	sq. yard	300
Reinforcing Steel	pound	510
Resin Anchor System	each	336
Install Galvanized Angles	lump sum	1

STATE OF MISSOURI

TED S. KOESTER

NUMBER

PE-2013000591

PROFESSIONAL ENGINEER

Ted Koester

10/28/2025 7:39:24 AM

TED S. KOESTER-CIVIL

MO-PE-2013000591

DATE PREPARED

10/28/2025

ROUTE

T

STATE

MO

DISTRICT

BR

SHEET NO.

1

COUNTY

WASHINGTON

JOB NO.

J5S3556

CONTRACT ID.

PROJECT NO.

BRIDGE NO.

W02171

DESCRIPTION									
DATE									

MISSOURI HIGHWAYS AND TRANSPORTATION COMMISSION

MoDOT

105 WEST CAPITOL

JEFFERSON CITY, MO 65102

1-888-ASK-MODOT (1-888-273-6636)

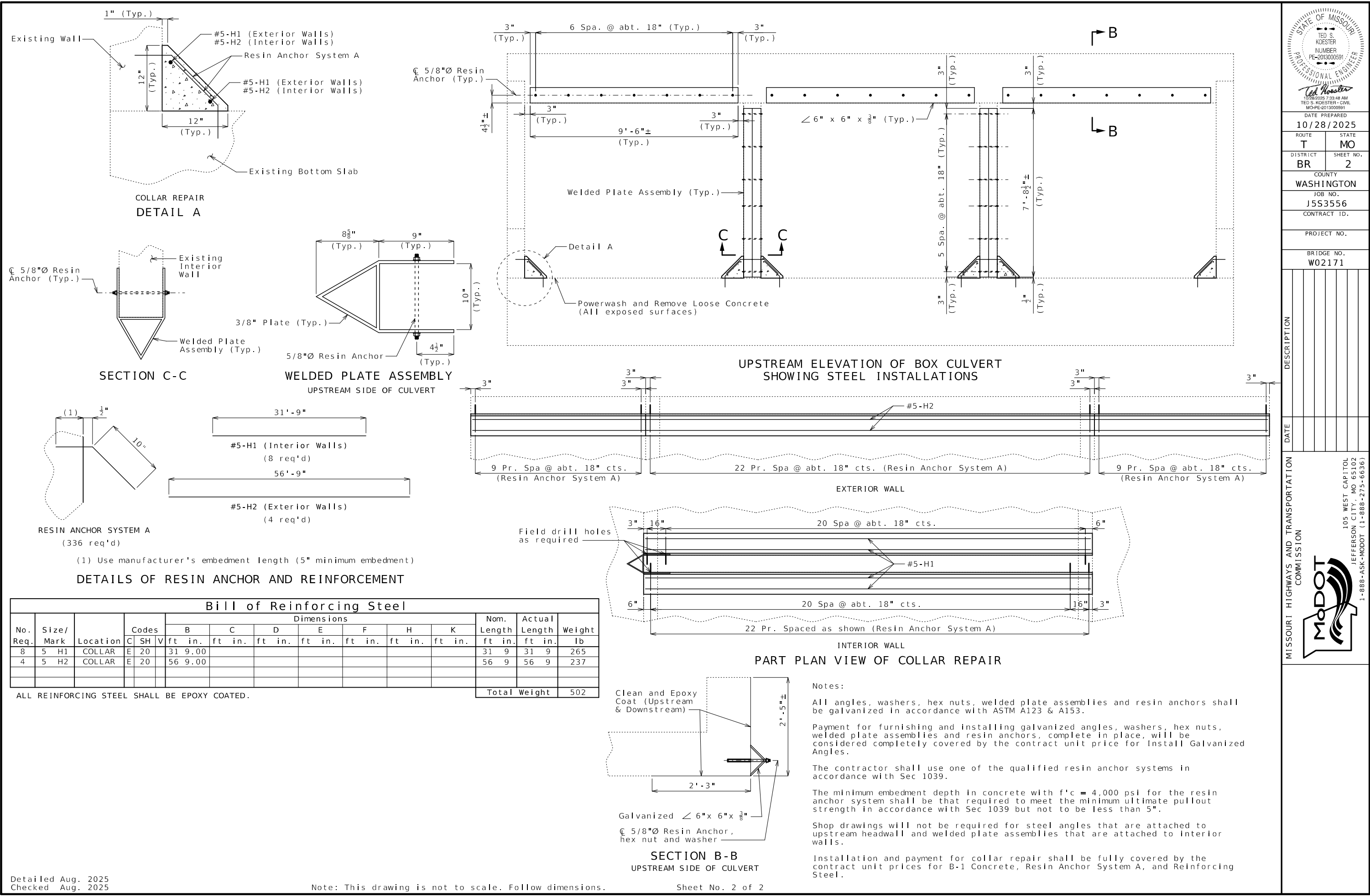

STATE OF MISSOURI  
TED S. KOESTER  
NUMBER  
PE-2013000591  
PROFESSIONAL ENGINEER

DATE PREPARED  
10/28/2025  
ROUTE  
T  
DISTRICT  
BR  
COUNTY  
WASHINGTON  
JOB NO.  
J553556  
CONTRACT ID.  
PROJECT NO.  
BRIDGE NO.  
W02171

DESCRIPTION  
DATE

MISSOURI HIGHWAYS AND TRANSPORTATION COMMISSION  
105 WEST CAPITOL  
JEFFERSON CITY, MO 65102  
1-888-ASK-MODOT (1-888-273-6636)