

(34'-46'-34') PRESTRESSED CONCRETE SPREAD BOX BEAM SPANS
SKEW: 35° R.A.

SEC/SUR 3 & 4 TWP 29N RGE 30W

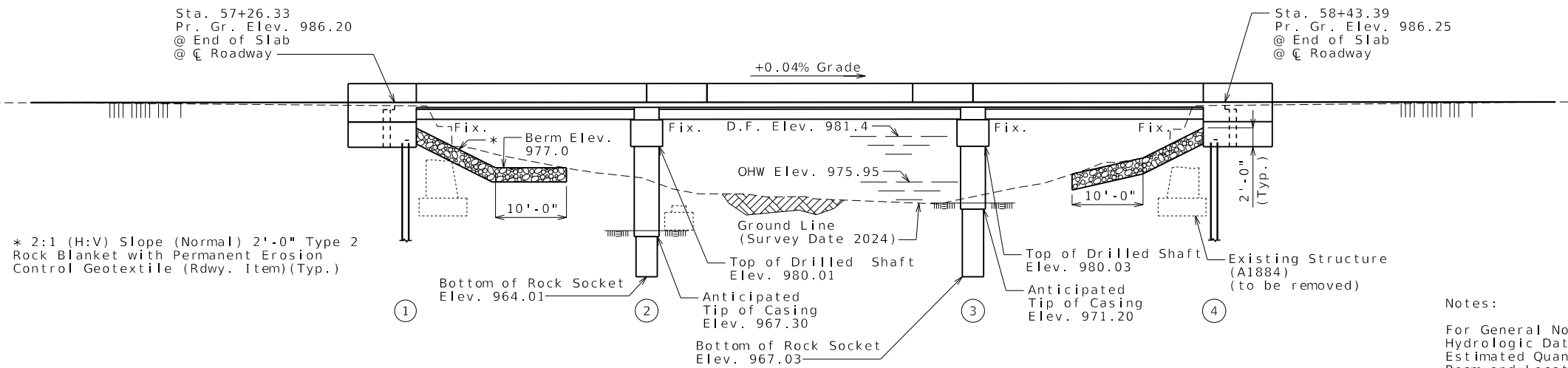

GENERAL ELEVATION

Notes:

For General Notes, Foundation data, Hydrologic Data, Estimated Quantities, Estimated Quantities for Slab on Concrete Beam and Location sketch, see Sheet No. 2.

Roadway fill shall be completed to the final roadway section and up to the elevation of the bottom of the concrete beam within the limits of the structure and for not less than 25 feet in back of the fill face of the end bents before any piles are driven for any bents falling within the embankment section.

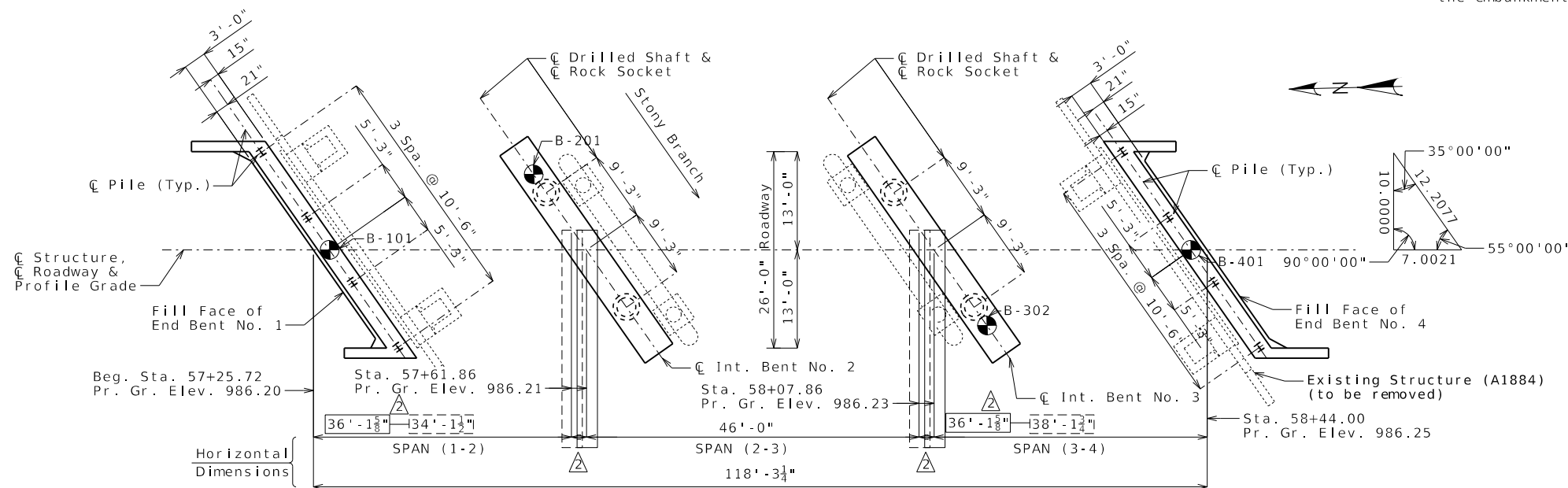

PLAN

Indicates location of borings.

Notice and Disclaimer Regarding Boring Log Data

The locations of all subsurface borings for this structure are shown on the plan sheet(s) for this structure. The boring data for all locations indicated, as well as any other boring logs or other factual records of subsurface data and investigations performed by the department for the design of the project, are shown on Sheet No. 22 and may be included in the Electronic Bridge Deliverables. They will also be available from the Project Contact upon written request. No greater significance or weight should be given to the boring data depicted on the plan sheets than is given to the subsurface data available from the district or elsewhere.

The Commission does not represent or warrant that any such boring data accurately depicts the conditions to be encountered in constructing this project. A contractor assumes all risks it may encounter in basing its bid prices, time or schedule of performance on the boring data depicted here or those available from the district, or on any other documentation not expressly warranted, which the contractor may obtain from the Commission.

C.P. #1 -
N. 404444.373, E. 2877077.988, ELEV. 983.376

C.P. #2 -
N. 403710.566, E. 2877060.310, ELEV. 995.371

C.P. #3 -
N. 405742.683, E. 2877110.868, ELEV. 993.421

BRIDGE: ROUTE BB OVER STONY BRANCH

ROUTE BB FROM ROUTE N TO ROUTE 96
ABOUT 1.1 MILES SOUTH OF ROUTE N
BEGINNING STATION 57+25.72

REVISED

Designed July 2025
Detailed July 2025
Checked Sept.2025

Note: This drawing is not to scale. Follow dimensions.

Sheet No. 1 of 22

B_A9601_001_JSR0137_PLAN ELEVATION.dgn 1:06:58 PM 1/13/2026

DATE PREPARED 1/13/2026	
ROUTE BB	STATE MO
DISTRICT BR	SHEET NO. 1
COUNTY JASPER	
JOB NO. JSR0137	
CONTRACT ID.	
PROJECT NO.	
BRIDGE NO. A9601	
DESCRIPTION	
DATE	
MISSOURI HIGHWAYS AND TRANSPORTATION COMMISSION	
	
800 E 101st Terr., Ste. 200 Kansas City, MO 64131 Phone (816) 701-3100 Fax (816) 942-3013 Missouri Cert. of Authority #2003007599	
105 WEST CAPITOL JEFFERSON CITY, MO 65102 1-888-ASK-MODOT (1-888-275-6636)	