

DESIGN DESIGNATION

A.A.D.T. - 2025 = 20,000
 A.A.D.T. - 2045 = 25,000
 D.H.V. = 9%
 T = 10.7%
 V = 30 & 45 M.P.H.
 D = 48.2%NB, 51.8%SB

FUNCTIONAL CLASSIFICATION- PRINCIPAL ARTERIAL

NO RIGHT-OF-WAY ACQUISITION

MISSOURI HIGHWAYS AND TRANSPORTATION COMMISSION

PLANS FOR PROPOSED STATE HIGHWAY FRANKLIN COUNTY

T44N - R1E

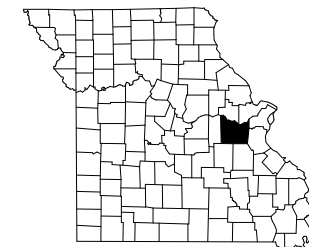

KEY MAP
LOCATION OF FRANKLIN COUNTY

DISCLAIMER
 THE PROFESSIONAL WHOSE SIGNATURE AND PERSONAL SEAL APPEAR HEREON ASSUMES RESPONSIBILITY ONLY FOR WHAT APPEARS ON THIS PAGE, AND DISCLAIMS (PURSUANT TO SECTION 327.411 RSMO) SPECIFICATION, ESTIMATES, REPORTS, OR OTHER DOCUMENTS OR INSTRUMENTS NOT SEALED BY THE UNDERSIGNED PROFESSIONAL RELATING TO OR INTENDED TO BE USED FOR ANY PART OR PARTS OF THE PROJECT TO WHICH THIS PAGE REFERS.

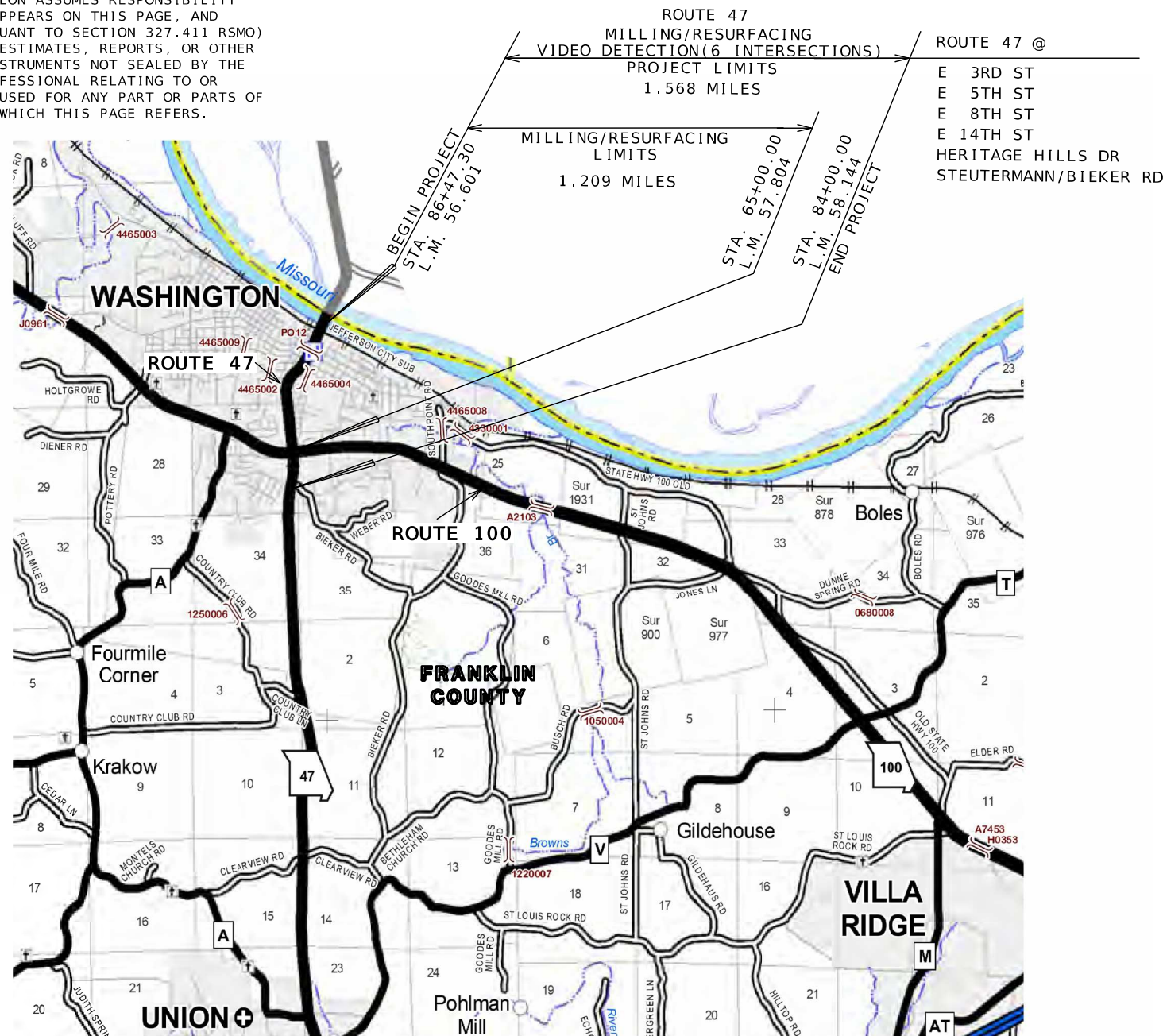

NOT TO SCALE

THE EXISTENCE AND APPROXIMATE LOCATION OF UTILITY FACILITIES KNOWN TO EXIST, AS SHOWN ON THE PLANS, ARE BASED ON THE BEST INFORMATION AVAILABLE TO THE COMMISSION AT THIS TIME. THIS INFORMATION IS PROVIDED BY THE COMMISSION "AS-IS" AND THE COMMISSION EXPRESSLY DISCLAIMS ANY REPRESENTATION OR WARRANTY AS TO THE COMPLETENESS, ACCURACY, OR SUITABILITY OF THE INFORMATION FOR ANY USE. RELIANCE UPON THIS INFORMATION IS DONE AT THE RISK AND PERIL OF THE USER, AND THE COMMISSION SHALL NOT BE LIABLE FOR ANY DAMAGES THAT MAY ARISE FROM ANY ERROR IN THE INFORMATION. IT IS, THEREFORE, THE RESPONSIBILITY OF THE CONTRACTOR TO VERIFY THE EXISTENCE, LOCATION AND STATUS OF ANY FACILITY. SUCH VERIFICATION INCLUDES DIRECT CONTACT WITH THE LISTED UTILITIES.

INDEX OF SHEETS

DESCRIPTION	SHEET NUMBER
TITLE SHEET	1
TYPICAL SECTIONS (TS) (5 SHEETS)--	2
QUANTITIES (QU) (3 SHEETS)-----	3
PLAN-PROFILE (PP)-----	4-9
SPECIAL SHEETS (SS)-----	10
TRAFFIC CONTROL SHEETS (TC)-----	11-16
SIGNALS (SG)-----	17-22
SIGNING (SN)-----	23
PAVEMENT MARKING (PM)-----	24-28

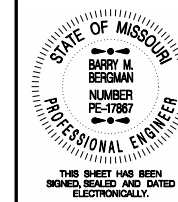

DATE PREPARED
2/20/2026
 ROUTE 47 STATE MO
 DISTRICT SL SHEET NO. 1
 COUNTY FRANKLIN
 JOB NO. JSL0033
 CONTRACT ID.
 PROJECT NO.
 BRIDGE NO.

DESCRIPTION	DATE

CONVENTIONAL SYMBOLS
(USED IN PLANS)

	EXISTING	NEW
BUILDINGS AND STRUCTURES		
GUARD RAIL		
GUARD CABLE		
CONCRETE RIGHT-OF-WAY MARKER		
STEEL RIGHT-OF-WAY MARKER		
LOCATION SURVEY MARKER		
UTILITIES		
FIBER OPTICS	-FO-	-FO-
OVERHEAD CABLE TV	-OTV-	-OTV-
UNDERGROUND CABLE TV	-UTV-	-UTV-
OVERHEAD TELEPHONE	-OT-	-OT-
UNDERGROUND TELEPHONE	-UT-	-UT-
OVERHEAD POWER	-OE-	-OE-
UNDERGROUND POWER	-UE-	-UE-
SANITARY SEWER	-S-	-S-
STORM SEWER	-SS-	-SS-
GAS	-G-	-G-
WATER	-W-	-W-
MANHOLE		
FIRE HYDRANT		
WATER VALVE		
WATER METER		
DROP INLET		
DITCH BLOCK		
GROUND MOUNTED SIGN		
LIGHT POLE		
H-FRAME POWER POLE		
TELEPHONE PEDESTAL		
FENCE		
CHAIN LINK		
WOVEN WIRE		
GATE POST		
BENCHMARK		

NOTE: DASHED OR OPEN SYMBOLS INDICATE EXISTING FEATURES

LENGTH OF PROJECT

BEGINNING OF PROJECT	STA. 86 + 47.30
END OF PROJECT	STA. 84 + 00.00
APPARENT LENGTH	-247.30 FEET
EQUATIONS AND EXCEPTIONS:	
STA. 94+00.00 BK = STA.8+69.36 AH	+8530.64 FEET
STA. 22+00.99 BK = STA.21+99.77 AH	+0.23 FEET
STA. 37+09.22 BK = STA.37+12.12 AH	-2.90 FEET

TOTAL CORRECTIONS	+8,527.97 FEET
NET LENGTH OF PROJECT	8280.67 FEET
STATE LENGTH	1.568 MILES
FOR INFORMATION ONLY	
ESTIMATED DISTURBED ACRES	0 ACRES

MISSOURI HIGHWAYS AND TRANSPORTATION COMMISSION
 105 WEST CAPITOL
 JEFFERSON CITY, MO 65102
 1-888-ASK-MODOT (1-888-275-6636)



TITLE SHEET

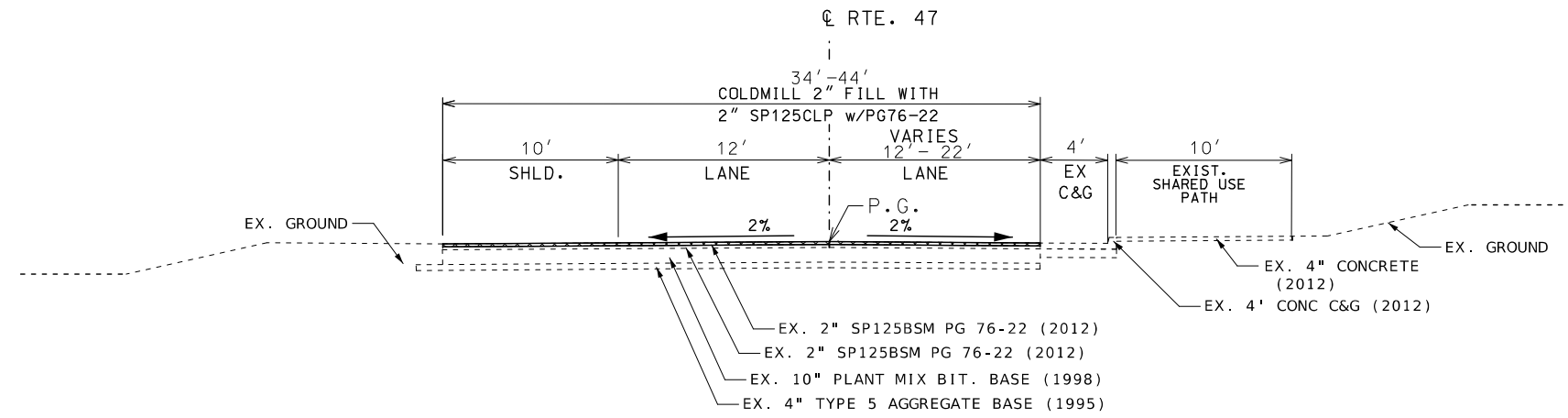

SECTION ON TANGENT
TYPICAL SECTION (2 LANES)
STA. 86+47.27 TO STA. 88+00.00

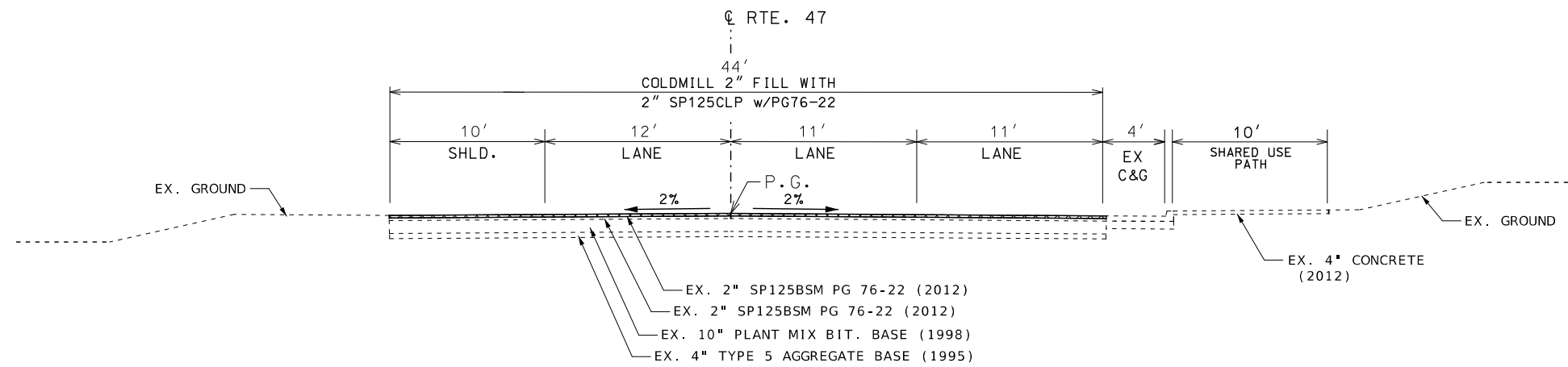

SECTION ON TANGENT
TYPICAL SECTION (3 LANES)
STA. 88+00.00 TO STA. 89+50.00

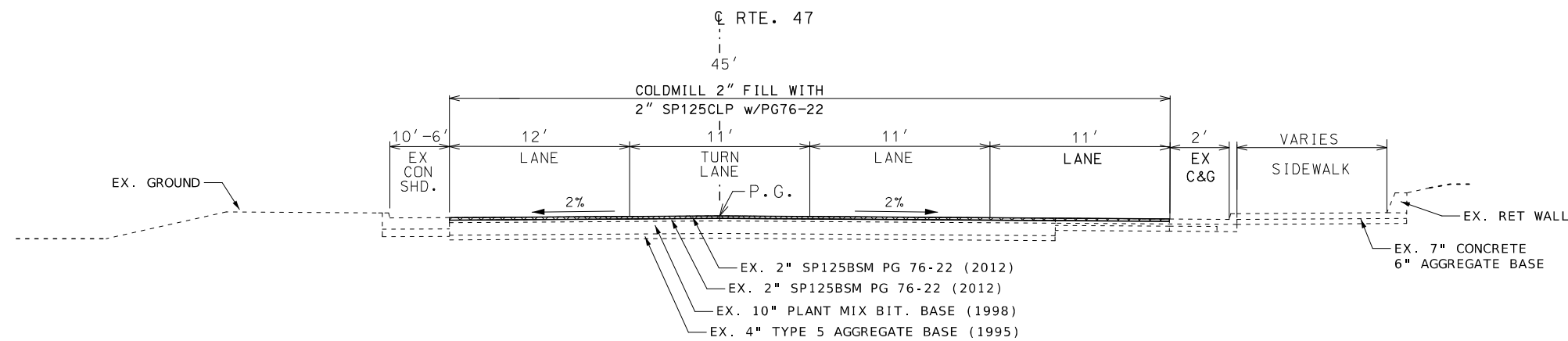

SECTION ON TANGENT
TYPICAL SECTION (4 LANES)
STA. 89+50.00 TO STA. 94+00.00

DISCLAIMER
THE PROFESSIONAL WHOSE SIGNATURE AND PERSONAL SEAL APPEAR HEREON ASSUMES RESPONSIBILITY ONLY FOR WHAT APPEARS ON THIS PAGE, AND DISCLAIMS (PURSUANT TO SECTION 327.411 RSMO) SPECIFICATION, ESTIMATES, REPORTS, OR OTHER DOCUMENTS OR INSTRUMENTS NOT SEALED BY THE UNDERSIGNED PROFESSIONAL RELATING TO OR INTENDED TO BE USED FOR ANY PART OR PARTS OF THE PROJECT TO WHICH THIS PAGE REFERS.



DATE PREPARED 3/2/2026	
ROUTE 47	STATE MO
DISTRICT SL	SHEET NO. 2
COUNTY FRANKLIN	
JOB NO. JSL0033	
CONTRACT ID.	
PROJECT NO.	
BRIDGE NO.	

DATE	DESCRIPTION

MISSOURI HIGHWAYS AND TRANSPORTATION COMMISSION

105 WEST CAPITOL
JEFFERSON CITY, MO 65102
1-888-ASK-MODOT (1-888-275-6636)

TYPICAL SECTION SHEET
SHEET 1 OF 5

APPLICATION RATES:
SP125CLP w/PG 76-22 1.94 TONS/CY
TACK COAT NON-TRACKING .1 GAL/SQYD

NOT TO SCALE

- CROSS SLOPES:
 1) MATCH EXISTING
 2) 1.0%
 3) SUPERELEVATION RATE

DISCLAIMER
 THE PROFESSIONAL WHOSE SIGNATURE AND PERSONAL SEAL APPEAR HEREON ASSUMES RESPONSIBILITY ONLY FOR WHAT APPEARS ON THIS PAGE, AND DISCLAIMS (PURSUANT TO SECTION 327.411 RSMO) SPECIFICATION, ESTIMATES, REPORTS, OR OTHER DOCUMENTS OR INSTRUMENTS NOT SEALED BY THE UNDERSIGNED PROFESSIONAL RELATING TO OR INTENDED TO BE USED FOR ANY PART OR PARTS OF THE PROJECT TO WHICH THIS PAGE REFERS.

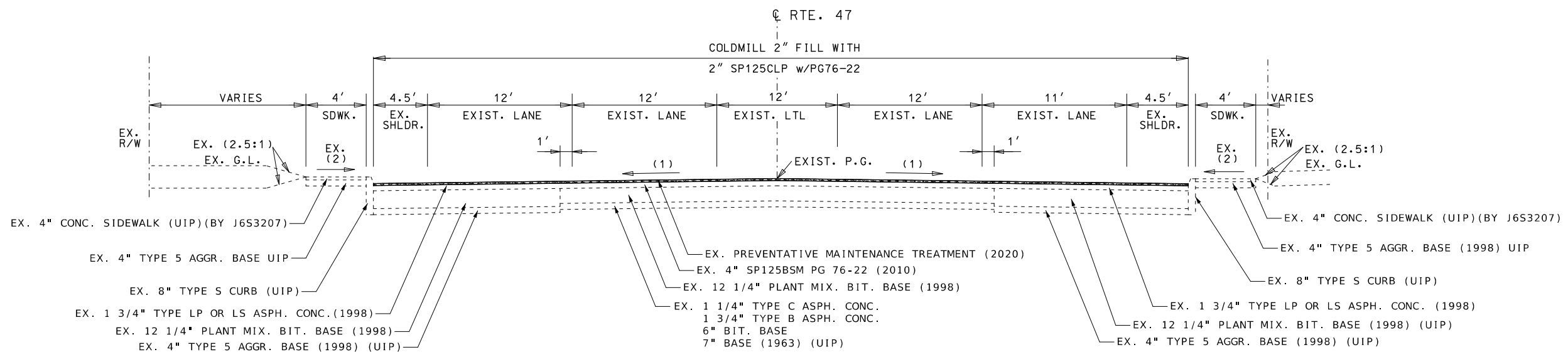
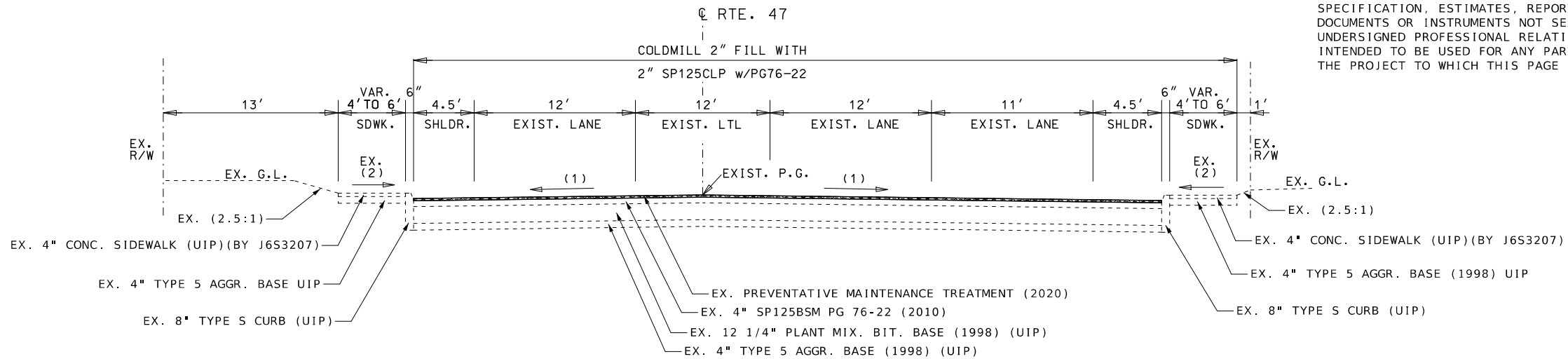

APPLICATION RATES:
 SP125CLP w/PG 76-22 1.94 TONS/CY
 TACK COAT NON-TRACKING .1 GAL/SQYD

NOT TO SCALE

DATE PREPARED		2/20/2026	
ROUTE	STATE	47	MO
DISTRICT	SHEET NO.	SL	2
COUNTY			
FRANKLIN			
JOB NO.			
JSL0033			
CONTRACT ID.			
PROJECT NO.			
BRIDGE NO.			

DATE	DESCRIPTION

MISSOURI HIGHWAYS AND TRANSPORTATION COMMISSION

105 WEST CAPITOL
 JEFFERSON CITY, MO 65102
 1-888-ASK-MODOT (1-888-275-6636)

TYPICAL SECTION SHEET
 SHEET 2 OF 5

DISCLAIMER
 THE PROFESSIONAL WHOSE SIGNATURE AND PERSONAL SEAL APPEAR HEREON ASSUMES RESPONSIBILITY ONLY FOR WHAT APPEARS ON THIS PAGE, AND DISCLAIMS (PURSUANT TO SECTION 327.411 RSMO) SPECIFICATION, ESTIMATES, REPORTS, OR OTHER DOCUMENTS OR INSTRUMENTS NOT SEALED BY THE UNDERSIGNED PROFESSIONAL RELATING TO OR INTENDED TO BE USED FOR ANY PART OR PARTS OF THE PROJECT TO WHICH THIS PAGE REFERS.

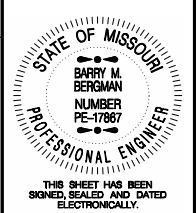

DATE PREPARED 2/20/2026	
ROUTE 47	STATE MO
DISTRICT SL	SHEET NO. 2
COUNTY FRANKLIN	
JOB NO. JSL0033	
CONTRACT ID.	
PROJECT NO.	
BRIDGE NO.	

- CROSS SLOPES:
 1) MATCH EXISTING
 2) 1.0%
 3) SUPERELEVATION RATE

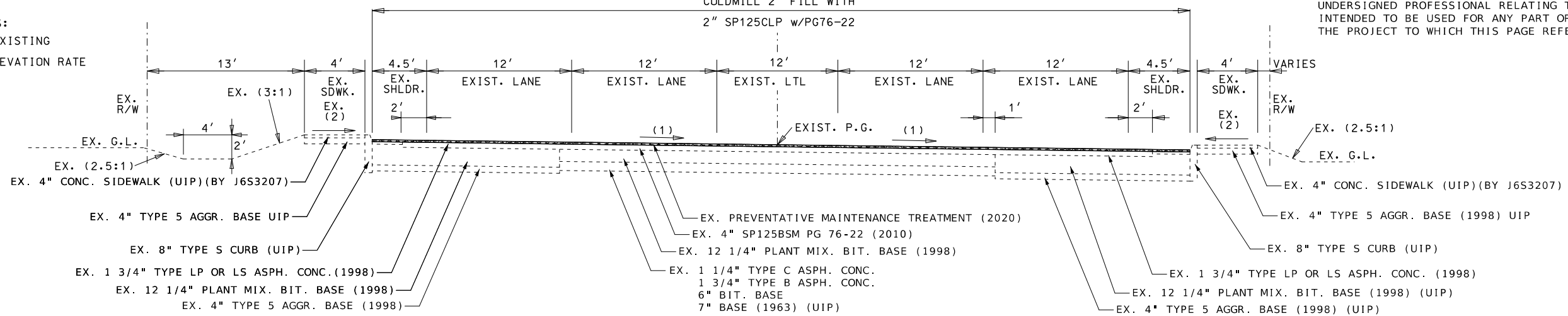

SECTION ON SUPERELEVATION
 TYPICAL SECTION RTE. 47
 STA. 16+01.87 TO STA. 19+00.00

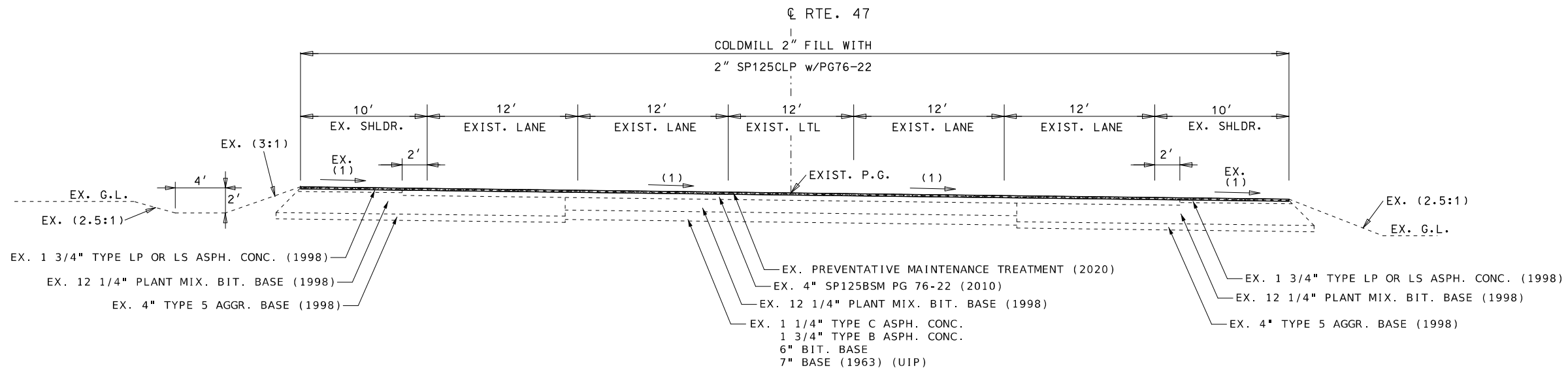

SECTION ON SUPERELEVATION
 TYPICAL SECTION RTE. 47
 STA. 19+00.00 TO STA. 21+99.77

APPLICATION RATES:
 SP125CLP w/PG 76-22 1.94 TONS/CY
 TACK COAT NON-TRACKING .1 GAL/SQYD

NOT TO SCALE

DATE	DESCRIPTION

MISSOURI HIGHWAYS AND TRANSPORTATION COMMISSION

105 WEST CAPITOL
 JEFFERSON CITY, MO 65102
 1-888-ASK-MODOT (1-888-275-6636)

TYPICAL SECTION SHEET
 SHEET 3 OF 5

REMOVAL OF IMPROVEMENTS				
PLAN SHEET NO.	ROADWAY	STA.	LOCATION	DESCRIPTION OF REMOVAL
5	ROUTE 47	19+81	75' RT	48" YIELD SIGN, POST, ANCHOR
7	ROUTE 47	40+15	76' RT	48" YIELD SIGN, POST, ANCHOR
PAY TOTAL				1 LUMP SUM

MOBILIZATION	
LUMP SUM	QUANTITY
	1

ADJUSTING MANHOLES					
PLAN SHEET NO.	ROADWAY	STATION	LOCATION	ADJUSTING MANHOLES	REMARKS
4	ROUTE 47	91+83	22' RT	1	NORTH OF 3RD STREET
4	ROUTE 47	93+21	38.5' RT	1	
TOTAL				2	

DISCLAIMER
 THE PROFESSIONAL WHOSE SIGNATURE AND PERSONAL SEAL APPEAR HEREON ASSUMES RESPONSIBILITY ONLY FOR WHAT APPEARS ON THIS PAGE, AND DISCLAIMS (PURSUANT TO SECTION 327.411 RSMO) SPECIFICATION, ESTIMATES, REPORTS, OR OTHER DOCUMENTS OR INSTRUMENTS NOT SEALED BY THE UNDERSIGNED PROFESSIONAL RELATING TO OR INTENDED TO BE USED FOR ANY PART OR PARTS OF THE PROJECT TO WHICH THIS PAGE REFERS.



DATE PREPARED
3/4/2026
 ROUTE 47 STATE MO
 DISTRICT SL SHEET NO. 3
 COUNTY FRANKLIN
 JOB NO. JSL0033
 CONTRACT ID.

PAVEMENT								
PLAN SHEET NO.	ROADWAY	STATION	STATION	AREA S.F.	COLDMILLING BITUMINOUS PAVEMENT FOR RESURFACING (3 IN. OR LESS)	2" SP125CLP ASPHALTIC CONCRETE MIXTURE PG 76-22 (1.94 TN/CY)	TACK COAT NON - TRACKING (0.10 GAL/SY)	REMARKS
					S.Y.	TONS	GAL	
4	RTE 47	86+47.30	12+88.00	77969	8663.2	933.9	866.3	
5	RTE 47	12+88.00	26+48.00	112381	12486.8	1346.1	1248.7	
6	RTE 47	26+48.00	39+76.00	114047	12671.9	1366.0	1267.2	
7	RTE 47	39+76.00	54+26.00	121973	13552.6	1461.0	1355.3	
8	RTE 47	54+26.00	65+00.00	104738	11637.6	1254.5	1163.8	
SUB-TOTALS					59012.1	6361.5	5901.3	
5% IRREGULARITIES						318.1	295.1	
PAY TOTALS					59012.1	6679.6	6200	

POT HOLING FOR UTILITY FACILITIES					
PLAN SHEET NO.	ROADWAY	STATION	LOCATION	# OF POTHOLES	REMARKS
5	ROUTE 47	19+65	116' RT	1	8TH STREET
5	ROUTE 47	19+87	71' RT	1	8TH STREET
5	ROUTE 47	20+12	48' RT	1	8TH STREET
6	ROUTE 47	39+50	66' RT	1	
7	ROUTE 47	40+35	95' RT	1	14TH STREET
TOTAL				5	

NOTE: NO ADDITIONAL PAY FOR LOCATIONS ADDED NOT NOTED ABOVE

PAVEMENT MARKING																			
PLAN SHEET NO.	LOCATION	STATION	STATION	CLASS 2 PAVEMENT MARKING PAINT (25-MIL, TYPE L BEADS)					PREFORMED THERMOPLASTIC PAVEMENT MARKING										REMARKS
				4" S.Y.	6" S.W.	6" I.W.	6" D.W.	6" D.W. BIKE	24" WHITE (STOP BAR)	24" WHITE LONGITUDINAL BAR CROSSWALK	24" YELLOW (45 DEGREE)	24 IN. X 36 IN. YIELD LINE TRIANGLE	STRAIGHT ARROW	LEFT ARROW	RIGHT ARROW	STRAIGHT/RIGHT ARROW	ONLY WORD MARKING	BIKE & ARROW SYMBOL	
				L.F.	L.F.	L.F.	L.F.	L.F.	L.F.	L.F.	L.F.	L.F.	L.F.	EA.	EA.	EA.	EA.	EA.	
24	RTE 47	86+47.30	12+88.00	2813	3251	130			242	492	36		3	8	3	3		1	
25	RTE 47	12+88.00	26+48.00	3511	3598	510	24		165	390	117	6		10	1	2	1	2	
26	RTE 47	26+48.00	39+76.00	3609	4139	500	84		120		115			7	3			5	
27	RTE 47	39+76.00	54+26.00	3818	4358	400			248	162	155	6		8	1	3		4	
28	RTE 47	54+26.00	65+00.00	4030	3667	520	54		25		210			4	2			4	
SUB-TOTALS				17781	19013	2060	78	84	800	1044	633	12	3	37	10	8	1	16	
PAY-TOTALS				17781		21235				1844	633	12	3	47	8	1	16		

SIGN REMOVAL & RELOCATION					
PLAN SHEET NO.	ROADWAY	STATION	LOCATION	SIGN REMOVAL AND RELOCATION (EA)	REMARKS
5	ROUTE 47	20+17	50' RT	1	STOP SIGN, NO MOTOR VEHICLES SIGN AND POST (PED PATH)
TOTAL				1	

PAVEMENT MARKING REMOVAL (SYMBOLS)					
PLAN SHEET NO.	ROADWAY	STA.	LOCATION	DESCRIPTION OF REMOVAL (EA)	REMARKS
24	ROUTE 47	92+99	104' RT	LEFT ARROW	E 3RD STR
24	ROUTE 47	93+16.6	108' RT	STRAIGHT/RIGHT ARROW	E 3RD STR
PAY TOTAL				2	

DESCRIPTION

DATE

MISSOURI HIGHWAYS AND TRANSPORTATION COMMISSION



QUANTITY SHEET SHEET 1 OF 3

WARNING SIGNS										GUIDE SIGNS										EFFECTIVE: 07-01-2025		STATE OF MISSOURI BARRY M. BERGMAN NUMBER PE-17867 PROFESSIONAL ENGINEER THIS SHEET HAS BEEN SIGNED, SEALED AND DATED ELECTRONICALLY.										
SIGN	SIZE	AREA	QTY	TOTAL	QTY	TOTAL	SIGN	DESCRIPTION		SIGN	SIZE	AREA	QTY	TOTAL	QTY	TOTAL	SIGN	DESCRIPTION	ITEM	TOTAL	DESCRIPTION		DATE PREPARED	ROUTE	STATE	DISTRICT	SHEET NO.	COUNTY	JOB NO.	CONTRACT ID.	PROJECT NO.	BRIDGE NO.
IN.	SQ. FT.	EACH	SQ. FT.	EACH	SQ. FT.	NO.				IN.	SQ. FT.	EACH	SQ. FT.	EACH	SQ. FT.	NO.			NUMBER	QTY			2/20/2026	47	MO	SL	3	FRANKLIN	JSL0033			
WO1-1L	48X48	16.00						TURN (SYMBOL LEFT)		E05-1	36X48	12.00						GORE EXIT	6122008		IMPACT ATTENUATOR 40 MPH (SAND BARRELS)											
WO1-1R	48X48	16.00						TURN (SYMBOL RIGHT)		E05-2	48X36	12.00						EXIT OPEN	6122010		IMPACT ATTENUATOR 45 MPH (SAND BARRELS)											
WO1-2L	48X48	16.00						CURVE (SYMBOL LEFT)		E05-2a	48X36	12.00						EXIT CLOSED	6122012		IMPACT ATTENUATOR 50 MPH (SAND BARRELS)											
WO1-2R	48X48	16.00						CURVE (SYMBOL RIGHT)		GO20-1	60X24	10.00						ROAD WORK NEXT XX MILES	6122014		IMPACT ATTENUATOR 55 MPH (SAND BARRELS)											
WO1-3L	48X48	16.00						REVERSE TURN (SYMBOL LEFT)		GO20-2	48X24	8.00						END ROAD WORK	6122017		IMPACT ATTENUATOR 60 MPH (SAND BARRELS)											
WO1-3R	48X48	16.00						REVERSE TURN (SYMBOL RIGHT)		GO20-4	36X18	4.50	2	9.00			53	PILOT CAR FOLLOW ME	6122019		IMPACT ATTENUATOR 65 MPH (SAND BARRELS)											
WO1-4L	48X48	16.00						REVERSE CURVE (SYMBOL LEFT)		GO20-4a	42X30	8.75	1	8.75				PILOT CAR IN USE WAIT & FOLLOW	6122020		IMPACT ATTENUATOR 70 MPH (SAND BARRELS)											
WO1-4R	48X48	16.00						REVERSE CURVE (SYMBOL RIGHT)		GO20-4a	18X12	1.50	10	15.00			60	PILOT CAR IN USE WAIT & FOLLOW	6122030		REPLACEMENT SAND BARREL											
WO1-4bL	48X48	16.00						DOUBLE ARROW REVERSE CURVE (SYMBOL LEFT)		GO20-5aP	36X24	6.00	6	36.00			54	WORK ZONE (PLAQUE)	6122040		IMPACT ATTENUATOR (RELOCATION)											
WO1-4bR	48X48	16.00						DOUBLE ARROW REVERSE CURVE (SYMBOL RIGHT)		MO4-8a	24X18	3.00						END DETOUR	6122040		WORK ZONE CRASH CUSHION (NARROW)											
WO1-4cL	48X48	16.00						TRIPLE ARROW REVERSE CURVE (SYMBOL LEFT)		MO4-9L	48X36	12.00						DETOUR (LEFT)	6122041		WORK ZONE CRASH CUSHION (RELOCATION)											
WO1-4cR	48X48	16.00						TRIPLE ARROW REVERSE CURVE (SYMBOL RIGHT)		MO4-9R	48X36	12.00						DETOUR (RIGHT)	6123001	2**	TRUCK MOUNTED ATTENUATOR (TMA)											
WO1-6	60X30	12.50						HORIZONTAL ARROW (SYMBOL)		MO4-10L	48X18	6.00						STREET NAME (PLAQUE)	6161012	2***	BUOYS (BOATS KEEP OUT)											
WO1-6a	72X36	18.00						HORIZ. ARROW (SYMBOL ON PERMANENT BARRICADE)		MO4-10R	48X18	6.00						DETOUR ARROW (LEFT)	6161013		BUOYS (NO WAKE)											
WO1-7	60X30	12.50						DOUBLE HEAD HORIZONTAL ARROW (SYMBOL)										DETOUR ARROW (RIGHT)	6161014		SPECIAL SIGN ASSEMBLY (BOATS KEEP OUT)											
WO1-7a	72X36	18.00						DOUBLE HEAD HORIZ. ARROW (SYMBOL ON PERM. BARR.)											6161020		CHANNELIZER (DRUM-LIKE)											
WO1-8	18X24	3.00						CHEVRON (SYMBOL)											6161022		CHANNELIZER (CONE)											
WO1-8a	30X36	7.50						CHEVRON (SYMBOL FOR DIVIDED HIGHWAYS)		R1-1	48X48	13.25						STOP	6161025	400	CHANNELIZER (TRIM-LINE)											
WO3-1	48X48	16.00						STOP AHEAD (SYMBOL)		R1-2	48TRI.	6.93						YIELD	6161026		CHANNELIZER (VERTICAL PANEL)											
WO3-2	48X48	16.00						YIELD AHEAD (SYMBOL)		R1-2a	36X36	9.00						TO ONCOMING TRAFFIC (PLAQUE)	6161030	2	TYPE 3 MOVEABLE BARRICADE											
WO3-3	48X48	16.00						SIGNAL AHEAD (SYMBOL)		R1-3P	30X12	2.50						ALL WAY (PLAQUE)	6161033	28	DIRECTION INDICATOR BARRICADE											
WO3-4	48X48	16.00	2	32.00			11	BE PREPARED TO STOP		R2-1	36X48	12.00	12	144.00			(4)(25)	SPEED LIMIT 25,30,35,40,45	6161040	2	FLASHING ARROW PANEL											
WO3-5	48X48	16.00						SPEED LIMIT AHEAD		R3-1	48X48	16.00						NO RIGHT TURN (SYMBOL)	6161047		TYPE 3 OBJECT MARKER											
WO4-1L	48X48	16.00						MERGE (SYMBOL FROM LEFT)		R3-2	48X48	16.00						NO LEFT TURN (SYMBOL)	6161055		SEQUENTIAL FLASHING WARNING LIGHT											
WO4-1R	48X48	16.00						MERGE (SYMBOL FROM RIGHT)		R3-3	36X36	9.00						NO TURNS	6161070		TUBULAR MARKER											
WO4-1aL	48X48	16.00						MERGE (LEFT)		R3-4	48X48	16.00						NO U-TURN (SYMBOL)	6161095		RADAR SPEED ADVISORY SYSTEM											
WO4-1aR	48X48	16.00						MERGE (RIGHT)		R3-7L	30X30	6.25	2	12.50			45	LEFT LANE MUST TURN LEFT	6161096		CHANGEABLE MESSAGE SIGN, COMMISSION FURNISHED/RETAINED											
WO5-1	48X48	16.00						ROAD/BRIDGE/RAMP NARROWS		R3-7R	30X30	6.25						RIGHT LANE MUST TURN RIGHT	6161098A	4**	CHANGEABLE MESSAGE SIGN WITHOUT COMM. INTERFACE, CONTRACTOR FURNISHED/RETAINED											
WO5-3	48X48	16.00						ONE LANE BRIDGE		R4-1	36X48	12.00						DO NOT PASS	6161099		CHANGEABLE MESSAGE SIGN WITH COMM. INTERFACE, CONTRACTOR FURNISHED/RETAINED											
WO5-5	48X48	16.00						NARROW LANES		R4-2	36X48	12.00						PASS WITH CARE	6162000A		WORK ZONE TRAFFIC SIGNAL SYSTEM											
WO6-1	48X48	16.00						DIVIDED HIGHWAY (SYMBOL)		R4-7a	36X48	12.00						KEEP RIGHT (HORIZONTAL ARROW)	6162002		TEMPORARY LONG-TERM RUMBLE STRIPS											
WO6-2	48X48	16.00						DIVIDED HIGHWAY END (SYMBOL)		R4-8a	36X48	12.00						KEEP LEFT (HORIZONTAL ARROW)	6173600D		TEMPORARY TRAFFIC BARRIER, CONTRACTOR FURNISHED/RETAINED											
WO6-3	48X48	16.00						TWO WAY TRAFFIC (SYMBOL)		R5-1	30X30	6.25						DO NOT ENTER	6173700B		TEMP. TRAFFIC BARRIER ANCHORED, CONTRACTOR FURNISHED/RETAINED											
WO7-3a	30X24	5.00						NEXT XX MILES (PLAQUE)		R5-1a	36X24	6.00						WRONG WAY	6173706		TEMP. TRAFFIC BARRIER STIFFNESS TRANSITION CONTRACTOR FURNISHED/RETAINED											
WO8-1	48X48	16.00						BUMP		R6-1L	54X18	6.75						ONE WAY ARROW (LEFT)	6175010A		RELOCATING TEMP. TRAFFIC BARRIER ANCHORED											
WO8-2	48X48	16.00						DIP		R6-1R	54X18	6.75						ONE WAY ARROW (RIGHT)	6175011B		RELOCATING TEMP. TRAFFIC BARRIER STIFFNESS											
WO8-3	48X48	16.00						PAVEMENT ENDS		R6-2L	24X30	5.00						ONE WAY (LEFT)	6175020A		RELOCATING TEMP. TRAFFIC BARRIER HEIGHT											
WO8-4	48X48	16.00						SOFT SHOULDER		R6-2R	24X30	5.00						ONE WAY (RIGHT)	6208064A		TEMPORARY RAISED PAVEMENT MARKER											
WO8-5	48X48	16.00						SLIPPERY WHEN WET (SYMBOL)		R9-9	24X12	2.00						SIDEWALK CLOSED	9029400		TEMPORARY TRAFFIC SIGNALS											
WO8-6	48X48	16.00						TRUCK CROSSING		R9-11L	24X18	3.00						SIDEWALK CLOSED AHEAD, (ARROW LEFT) CROSS HERE	9029401		TEMPORARY TRAFFIC SIGNALS AND LIGHTING											
WO8-6c	48X48	16.00						TRUCK ENTRANCE		R9-11R	24X18	3.00						SIDEWALK CLOSED AHEAD, (ARROW RIGHT) CROSS HERE														
WO8-7	36X36	9.00						LOOSE GRAVEL		R10-6	24X36	6.00						STOP HERE ON RED (45^ ARROW)														
WO8-7a	36X36	9.00						FRESH OIL / LOOSE GRAVEL		R11-2	48X30	10.00						ROAD CLOSED														
WO8-9	48X48	16.00						LOW SHOULDER		R11-3a	60X30	12.50						ROAD CLOSED XX MILES AHEAD														
WO8-11	48X48	16.00						UNEVEN LANES		R11-4	60X30	12.50						LOCAL TRAFFIC ONLY														
WO8-12	48X48	16.00	10	160.00				NO CENTER LINE		CONST-3A	60X48	20.00						ROAD CLOSED TO THRU TRAFFIC														
WO8-15	48X48	16.00						GROOVED PAVEMENT		CONST-3X	56X12	4.67						FINE SIGN														
WO8-15P	30X24	5.00						MOTORCYCLE (PLAQUE)										SPEEDING/PASSING (PLATE)														
WO8-17L	48X48	16.00						SHOULDER DROP-OFF (SYMBOL LEFT)																								
WO8-17R	48X48	16.00						SHOULDER DROP-OFF (SYMBOL RIGHT)																								
WO8-17P	30X24	5.00						SHOULDER DROP-OFF (PLAQUE)																								
W10-1	42RND.	9.62						RAILROAD CROSSING																								
WO12-1	24X24	4.00						DOUBLE DOWN ARROW (SYMBOL)																								
WO12-2	48X48	16.00						LOW CLEARANCE (SYMBOL)																								
WO12-2x	24X18	3.00						LOW CLEARANCE (PLAQUE)																								
WO12-2a	84X24	14.00						OVERHEAD LOW CLEARANCE (FEET AND INCHES)																								
WO12-4	120X60	50.00						LOW CLEARANCE XX FT XX IN XX MILES AHEAD																								
WO12-5	120X60	50.00						WIDTH RESTRICTION XX FT XX IN XX MILES AHEAD																								
WO13-1	30X30	6.25						ADVISORY SPEED (PLAQUE)</																								



THIS SHEET HAS BEEN SIGNED, SEALED AND DATED ELECTRONICALLY.

DATE PREPARED
3/2/2026

ROUTE 47 STATE MO

DISTRICT SL SHEET NO. 5

COUNTY FRANKLIN

JOB NO. JSL0033

CONTRACT ID.

PROJECT NO.

BRIDGE NO.

DATE	DESCRIPTION

MISSOURI HIGHWAYS AND TRANSPORTATION COMMISSION

105 WEST CAPITOL
JEFFERSON CITY, MO 65102
1-888-ASK-MODOT (1-888-275-6636)

PLAN SHEET

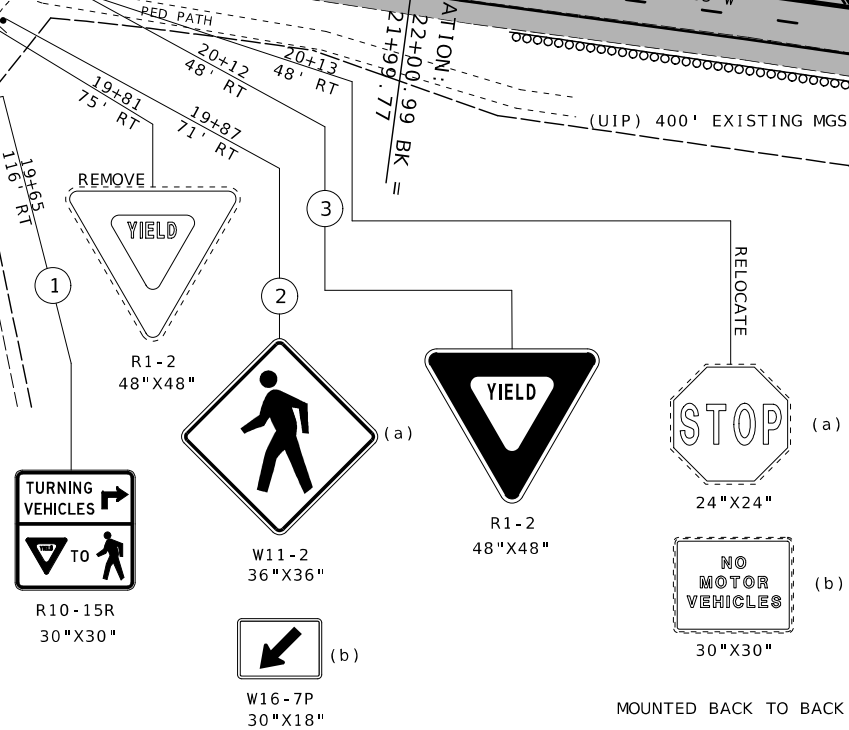
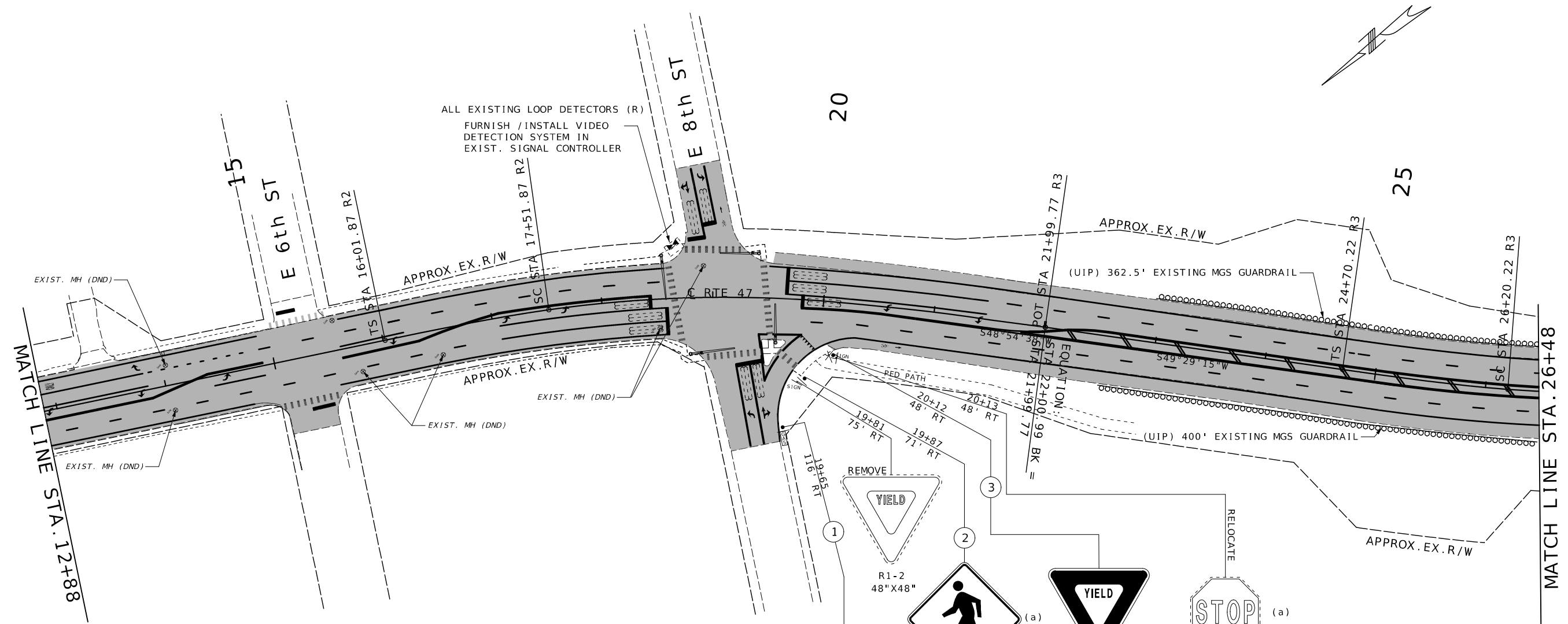

MOUNTED BACK TO BACK
(RELOCATE EXIST. PED PATH SIGNS AND POST TO APPROXIMATELY 5' FROM NEW YIELD SIGN ALONG PED PATH)

DISCLAIMER
THE PROFESSIONAL WHOSE SIGNATURE AND PERSONAL SEAL APPEAR HEREON ASSUMES RESPONSIBILITY ONLY FOR WHAT APPEARS ON THIS PAGE, AND DISCLAIMS (PURSUANT TO SECTION 327.411 RSMO) SPECIFICATION, ESTIMATES, REPORTS, OR OTHER DOCUMENTS OR INSTRUMENTS NOT SEALED BY THE UNDERSIGNED PROFESSIONAL RELATING TO OR INTENDED TO BE USED FOR ANY PART OR PARTS OF THE PROJECT TO WHICH THIS PAGE REFERS.

2" MILL/FILL WITH 2" SP125CLP

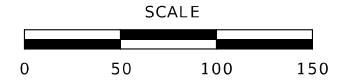



THIS SHEET HAS BEEN SIGNED, SEALED AND DATED ELECTRONICALLY.

DATE PREPARED
2/20/2026

ROUTE 47	STATE MO
-------------	-------------

DISTRICT SL	SHEET NO. 8
----------------	----------------

COUNTY
FRANKLIN

JOB NO.
JSL0033

CONTRACT ID.

PROJECT NO.

BRIDGE NO.

DATE	DESCRIPTION

MISSOURI HIGHWAYS AND TRANSPORTATION COMMISSION



105 WEST CAPITOL
JEFFERSON CITY, MO 65102
1-888-ASK-MODOT (1-888-273-6636)

PLAN SHEET

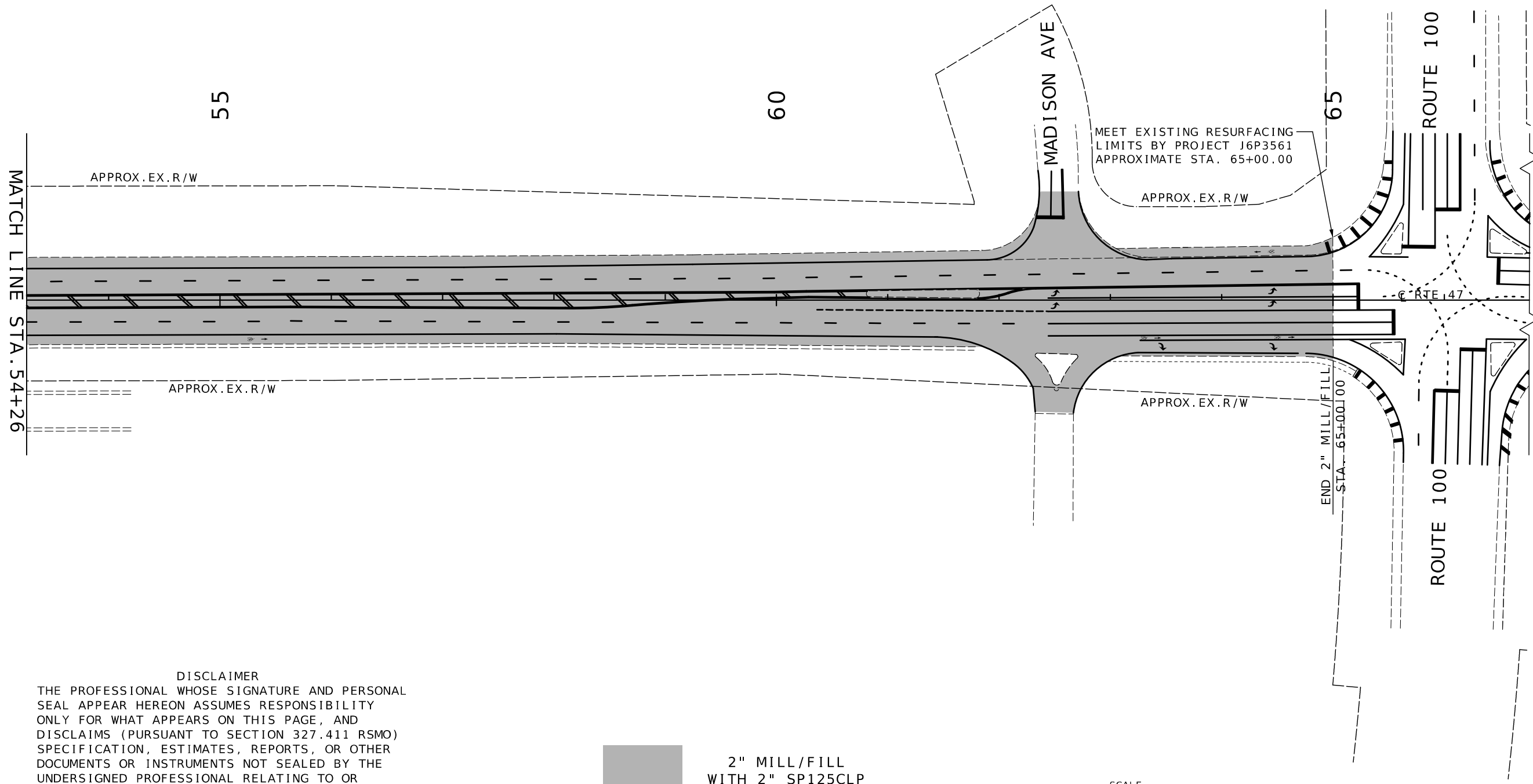
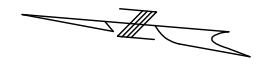

DISCLAIMER
THE PROFESSIONAL WHOSE SIGNATURE AND PERSONAL SEAL APPEAR HEREON ASSUMES RESPONSIBILITY ONLY FOR WHAT APPEARS ON THIS PAGE, AND DISCLAIMS (PURSUANT TO SECTION 327.411 RS MO) SPECIFICATION, ESTIMATES, REPORTS, OR OTHER DOCUMENTS OR INSTRUMENTS NOT SEALED BY THE UNDERSIGNED PROFESSIONAL RELATING TO OR INTENDED TO BE USED FOR ANY PART OR PARTS OF THE PROJECT TO WHICH THIS PAGE REFERS.

 2" MILL/FILL WITH 2" SP125CLP

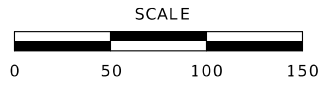

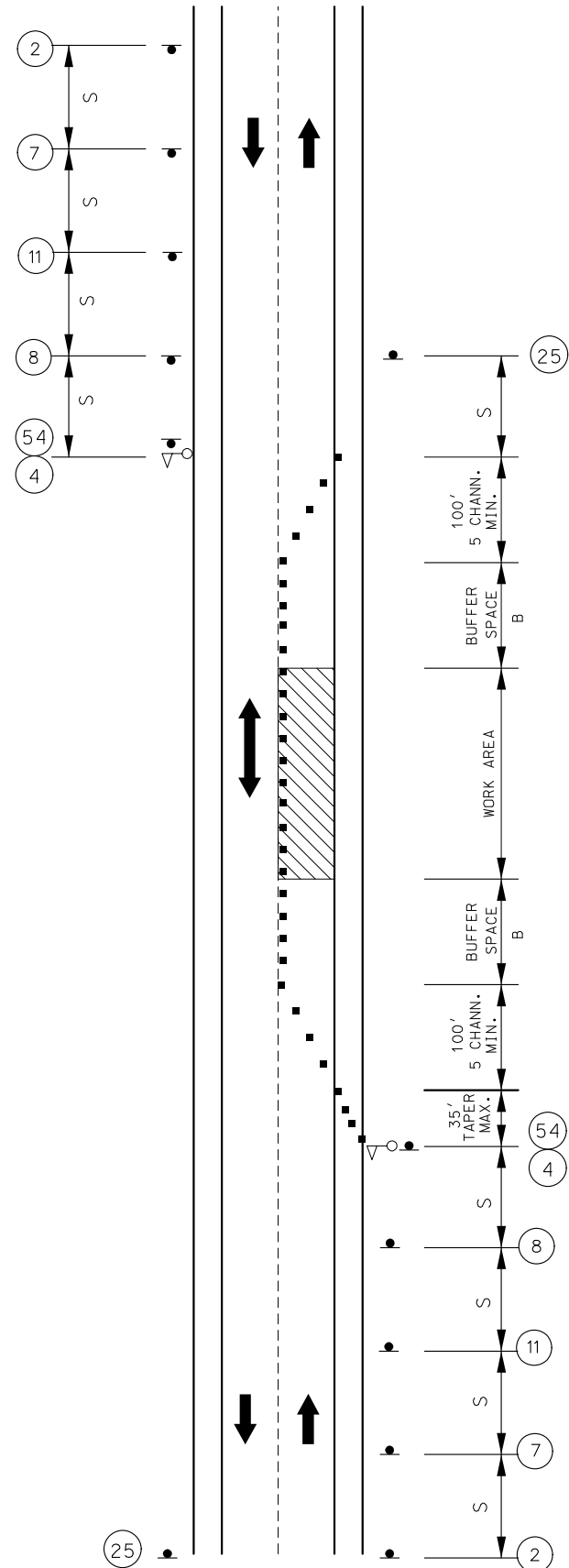

LANE CLOSURE ON TWO-LANE ROAD USING FLAGGERS

NOT TO SCALE

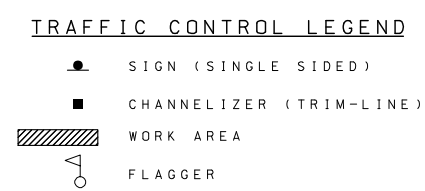
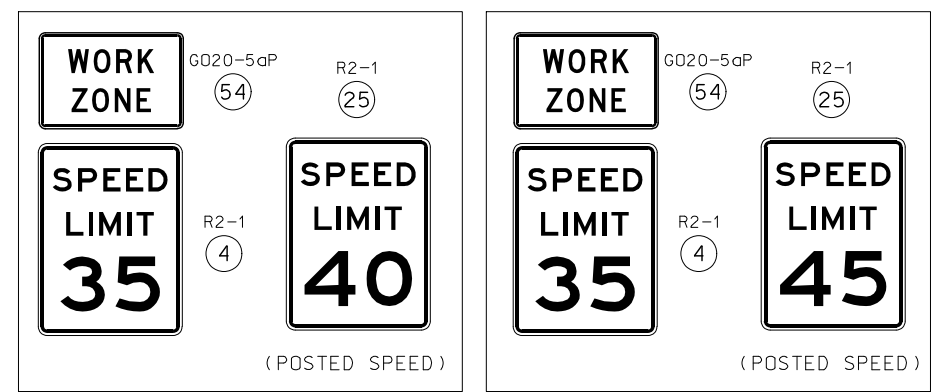
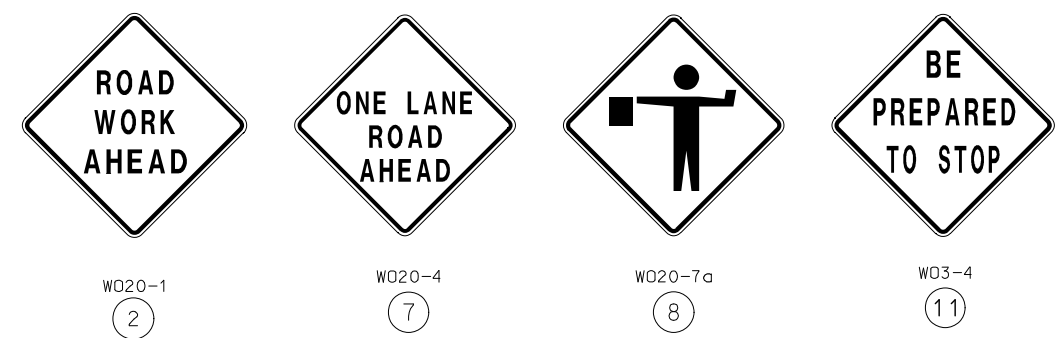

DISCLAIMER
 THE PROFESSIONAL WHOSE SIGNATURE AND PERSONAL SEAL APPEAR HEREON ASSUMES RESPONSIBILITY ONLY FOR WHAT APPEARS ON THIS PAGE, AND DISCLAIMS (PURSUANT TO SECTION 327.411 RSMO) SPECIFICATION, ESTIMATES, REPORTS, OR OTHER DOCUMENTS OR INSTRUMENTS NOT SEALED BY THE UNDERSIGNED PROFESSIONAL RELATING TO OR INTENDED TO BE USED FOR ANY PART OR PARTS OF THE PROJECT TO WHICH THIS PAGE REFERS.

NOTES:
 AUTOMATED FLAGGER ASSISTANCE DEVICES (AFAD) AND PORTABLE SIGNAL FLAGGING DEVICES (PSFD) MAY BE USED AS AN ALTERNATIVE FLAGGING OPERATION.
 IF USED AT NIGHT, THE FLAGGER STATIONS SHALL BE ILLUMINATED WITH AN AVERAGE MAINTAINED INTENSITY OF 0.6 FOOTCANDLES (6.5 LUX).

SPEED PERM. POSTED (MPH)	SIGN SPACING (ft.)		TAPER LENGTH (ft.)		OPTIONAL BUFFER LENGTH (ft.) (B)	CHANNELIZER SPACING (ft.)	
	UNDIVIDED (S)	DIVIDED (S)	SHOULDER (1) (T1)	LANE (2) (T2)		TAPERS	BUFFER/ WORK AREAS
0-35	200	-	-	-	280	-	40
40-45	350	-	-	-	400	-	80
50-55	500	-	-	-	560	-	80

1 Shoulder taper length based on 10 ft. (standard shoulder width) offset.
 2. Lane taper length based on 12 ft. (standard lane width) offset.

DATE PREPARED 2/20/2026	
ROUTE 47	STATE MO
DISTRICT SL	SHEET NO. 12
COUNTY FRANKLIN	
JOB NO. JSL0033	
CONTRACT ID.	
PROJECT NO.	
BRIDGE NO.	
DESCRIPTION	
DATE	

MISSOURI HIGHWAYS AND TRANSPORTATION COMMISSION

105 WEST CAPITOL
JEFFERSON CITY, MO 65102
1-888-ASK-MODOT (1-888-275-6636)

TRAFFIC CONTROL SHEET
 LANE CLOSURE ON
 TWO-LANE ROAD USING FLAGGERS

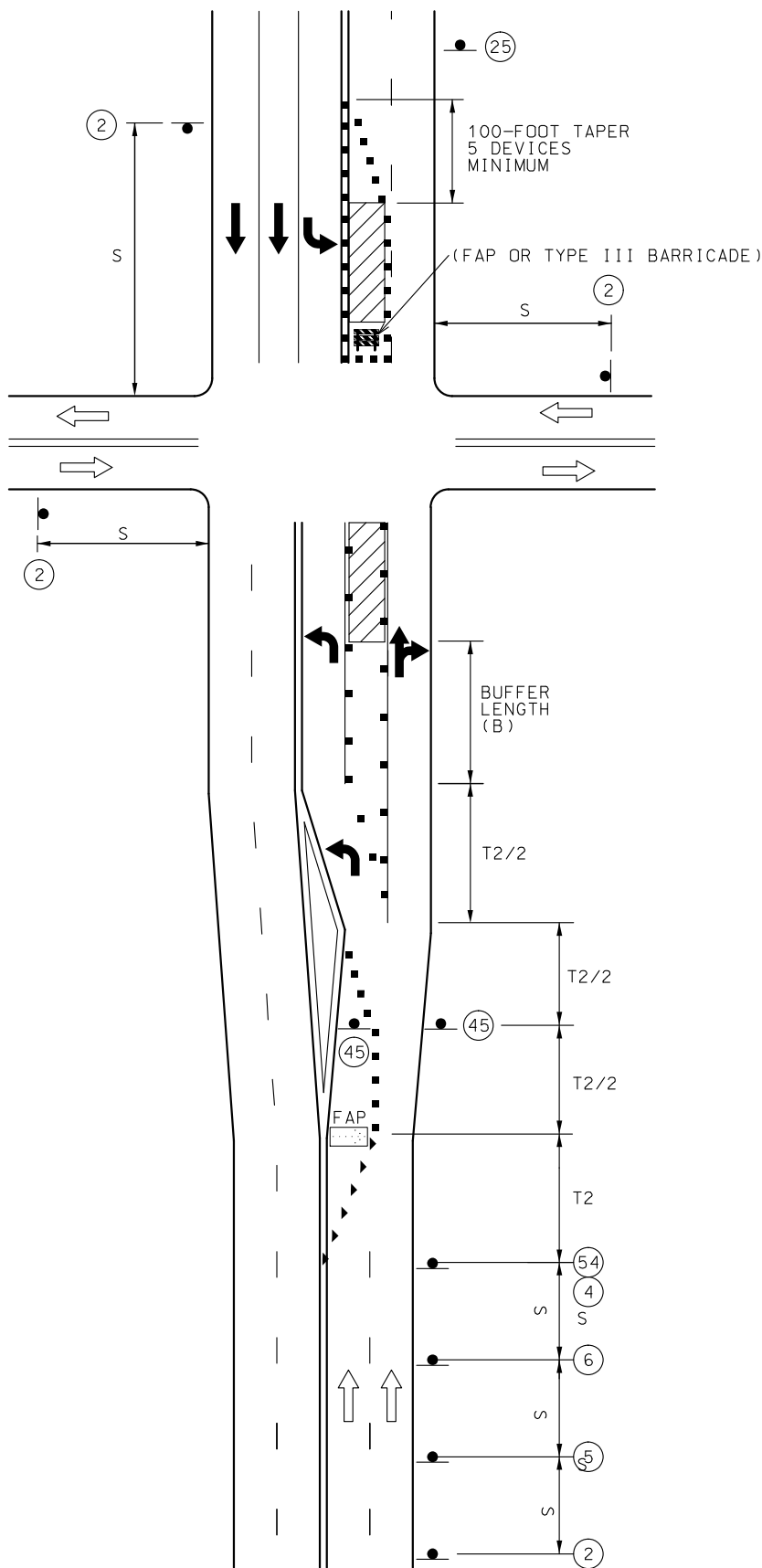

LEFT LANE CLOSURE AT INTERSECTION
WORK ON NEAR OR FAR SIDE

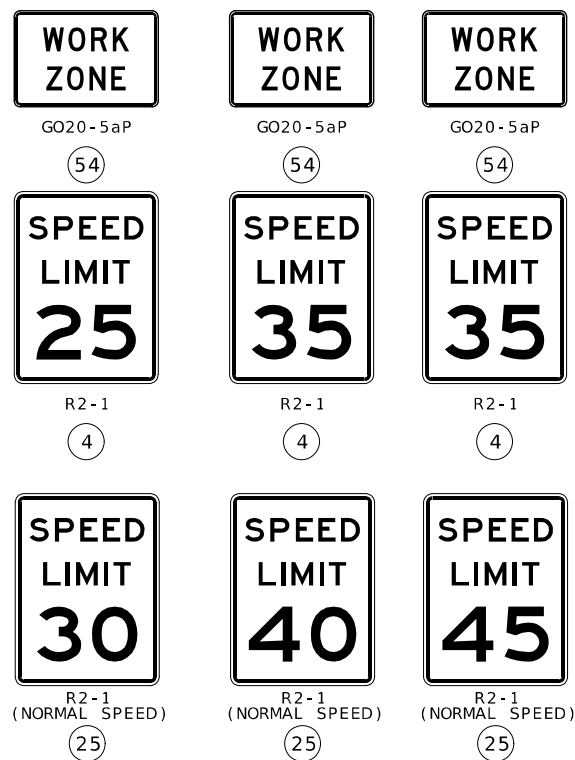
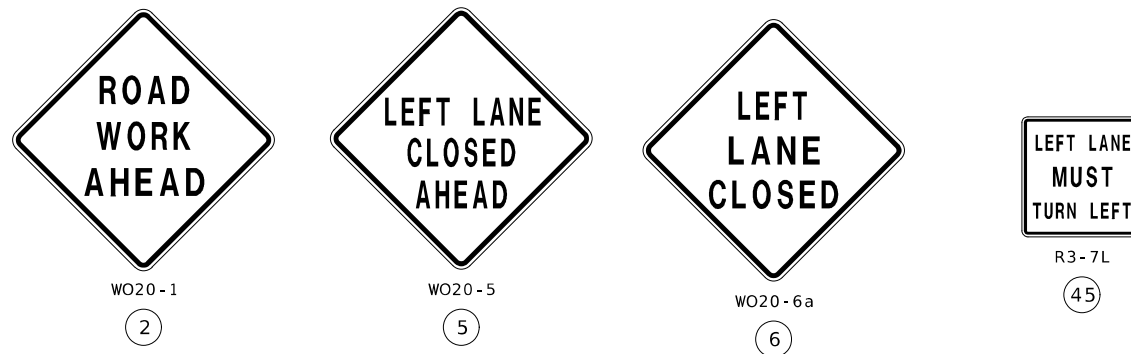

TRAFFIC CONTROL LEGEND

- SIGN (SINGLE SIDED)
- CHANNELIZER (TRIM-LINE)
- ▼ DIRECTIONAL INDICATOR BARRICADES (DIBS)
- ▨ WORK AREA
- ⋯ FLASHING ARROW PANEL
- ▩ TYPE 3 BARRICADE

DISCLAIMER
THE PROFESSIONAL WHOSE SIGNATURE AND PERSONAL SEAL APPEAR HEREON ASSUMES RESPONSIBILITY ONLY FOR WHAT APPEARS ON THIS PAGE, AND DISCLAIMS (PURSUANT TO SECTION 327.411 RSMO) SPECIFICATION, ESTIMATES, REPORTS, OR OTHER DOCUMENTS OR INSTRUMENTS NOT SEALED BY THE UNDERSIGNED PROFESSIONAL RELATING TO OR INTENDED TO BE USED FOR ANY PART OR PARTS OF THE PROJECT TO WHICH THIS PAGE REFERS.

SPEED	SIGN SPACING (ft.)		TAPER LENGTH (ft.)		OPTIONAL BUFFER LENGTH (ft.) (B)	CHANNELIZER SPACING (ft.)	
	UN -DIVIDED (S)	DIVIDED (S)	SHOULDER (1) (T1)	LANE (2) (T2)		TAPERS	BUFFER/ WORK AREAS
0-35	200	200	70	245	280	35	40
40-45	350	500	150	540	400	40	80
50-55	500	1000	185	660	560	50	80

1 Shoulder taper length based on 10 ft. (standard shoulder width) offset.
2. Lane taper length based on 12 ft. (standard lane width) offset.

NOTES:

REMOVE AND/OR MODIFY EXISTING PAVEMENT MARKING AS NEEDED.
FOR SIGNALIZED INTERSECTIONS, ADJUSTMENTS MAY NEED TO BE MADE TO SIGNAL PHASING, TIMING, INDICATIONS OR DETECTOR SETTINGS.

LEFT LANE CLOSED AHEAD SIGN MAY BE OMITTED IN LOW SPEED URBAN AREAS WHERE THERE IS NOT SUFFICIENT SPACE FOR THE FULL SIGN SERIES.
THE FLASHING ARROW BOARD SHOULD BE LOCATED AT THE BEGINNING OF THE MERGING TAPER WHEN MEDIAN WIDTH ALLOWS THIS PLACEMENT.

NOT TO SCALE

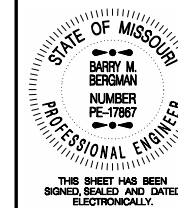

DATE PREPARED: 2/20/2026
ROUTE: 47 STATE: MO
DISTRICT: SL SHEET NO.: 14
COUNTY: FRANKLIN
JOB NO.: JSL0033
CONTRACT ID:

PROJECT NO.

BRIDGE NO.

DESCRIPTION

DATE

MISSOURI HIGHWAYS AND TRANSPORTATION COMMISSION



105 WEST CAPITOL
JEFFERSON CITY, MO 65102
1-888-ASK-MODOT (1-888-275-6636)

TRAFFIC CONTROL SHEET
LEFT LANE CLOSURE AT INTERSECTION
WORK ON NEAR OR FAR SIDE



THIS SHEET HAS BEEN SIGNED, SEALED AND DATED ELECTRONICALLY.

DATE PREPARED
2/20/2026

ROUTE 47 STATE MO

DISTRICT SL SHEET NO. 17

COUNTY FRANKLIN

JOB NO. JSL0033

CONTRACT ID.

PROJECT NO.

BRIDGE NO.

BRIDGE NO.

BRIDGE NO.

BRIDGE NO.

BRIDGE NO.

BRIDGE NO.

BRIDGE NO.

BRIDGE NO.

BRIDGE NO.

BRIDGE NO.

BRIDGE NO.

BRIDGE NO.

BRIDGE NO.

BRIDGE NO.

BRIDGE NO.

BRIDGE NO.

BRIDGE NO.

BRIDGE NO.

BRIDGE NO.

BRIDGE NO.

BRIDGE NO.

BRIDGE NO.

BRIDGE NO.

BRIDGE NO.

BRIDGE NO.

BRIDGE NO.

BRIDGE NO.

BRIDGE NO.

BRIDGE NO.

BRIDGE NO.

BRIDGE NO.

BRIDGE NO.

BRIDGE NO.

BRIDGE NO.

BRIDGE NO.

BRIDGE NO.

BRIDGE NO.

BRIDGE NO.

BRIDGE NO.

BRIDGE NO.

BRIDGE NO.

BRIDGE NO.

BRIDGE NO.

BRIDGE NO.

BRIDGE NO.

BRIDGE NO.

BRIDGE NO.

BRIDGE NO.

BRIDGE NO.

BRIDGE NO.

MISSOURI HIGHWAYS AND TRANSPORTATION COMMISSION
 MoDOT
 105 WEST CAPITOL
 JEFFERSON CITY, MO 65102
 1-888-ASK-MODOT (1-888-275-6636)

SIGNAL SHEET
 ROUTE 47 @ 3RD STREET

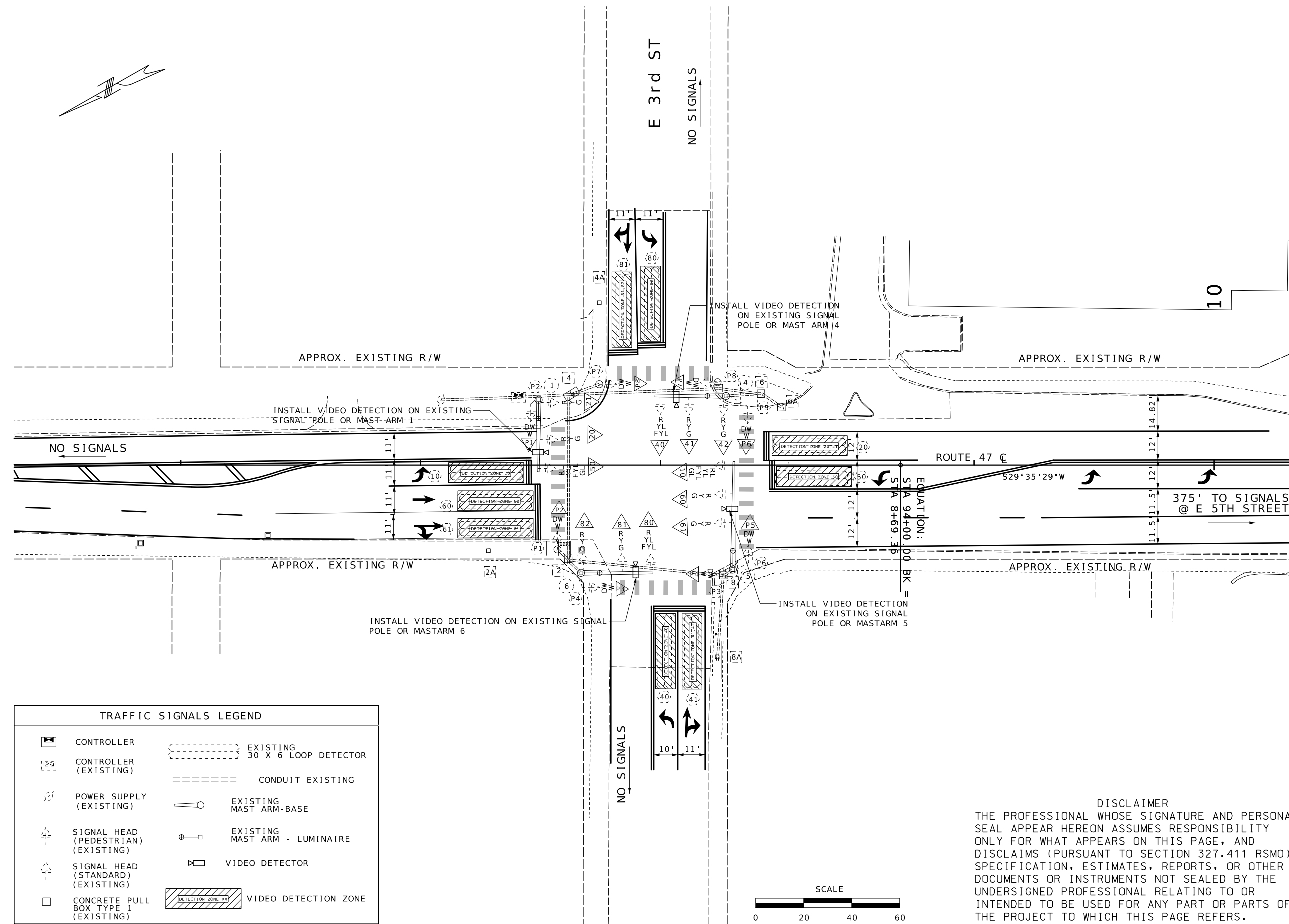

TRAFFIC SIGNALS LEGEND			
	CONTROLLER		EXISTING 30 X 6 LOOP DETECTOR
	CONTROLLER (EXISTING)		CONDUIT EXISTING
	POWER SUPPLY (EXISTING)		EXISTING MAST ARM-BASE
	SIGNAL HEAD (PEDESTRIAN) (EXISTING)		EXISTING MAST ARM - LUMINAIRE
	SIGNAL HEAD (STANDARD) (EXISTING)		VIDEO DETECTOR
	CONCRETE PULL BOX TYPE 1 (EXISTING)		VIDEO DETECTION ZONE

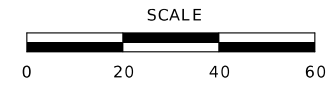

DISCLAIMER
 THE PROFESSIONAL WHOSE SIGNATURE AND PERSONAL SEAL APPEAR HEREON ASSUMES RESPONSIBILITY ONLY FOR WHAT APPEARS ON THIS PAGE, AND DISCLAIMS (PURSUANT TO SECTION 327.411 RSMO) SPECIFICATION, ESTIMATES, REPORTS, OR OTHER DOCUMENTS OR INSTRUMENTS NOT SEALED BY THE UNDERSIGNED PROFESSIONAL RELATING TO OR INTENDED TO BE USED FOR ANY PART OR PARTS OF THE PROJECT TO WHICH THIS PAGE REFERS.



THIS SHEET HAS BEEN SIGNED, SEALED AND DATED ELECTRONICALLY.

DATE PREPARED
2/20/2026

ROUTE 47 STATE MO

DISTRICT SL SHEET NO. 19

COUNTY FRANKLIN

JOB NO. JSL0033

CONTRACT ID.

PROJECT NO.

BRIDGE NO.

DESCRIPTION

DATE

MISSOURI HIGHWAYS AND TRANSPORTATION COMMISSION

105 WEST CAPITOL JEFFERSON CITY, MO 65102

1-888-ASK-MODOT (1-888-275-6636)

MoDOT

SIGNAL SHEET

ROUTE 47 @ 8TH STREET

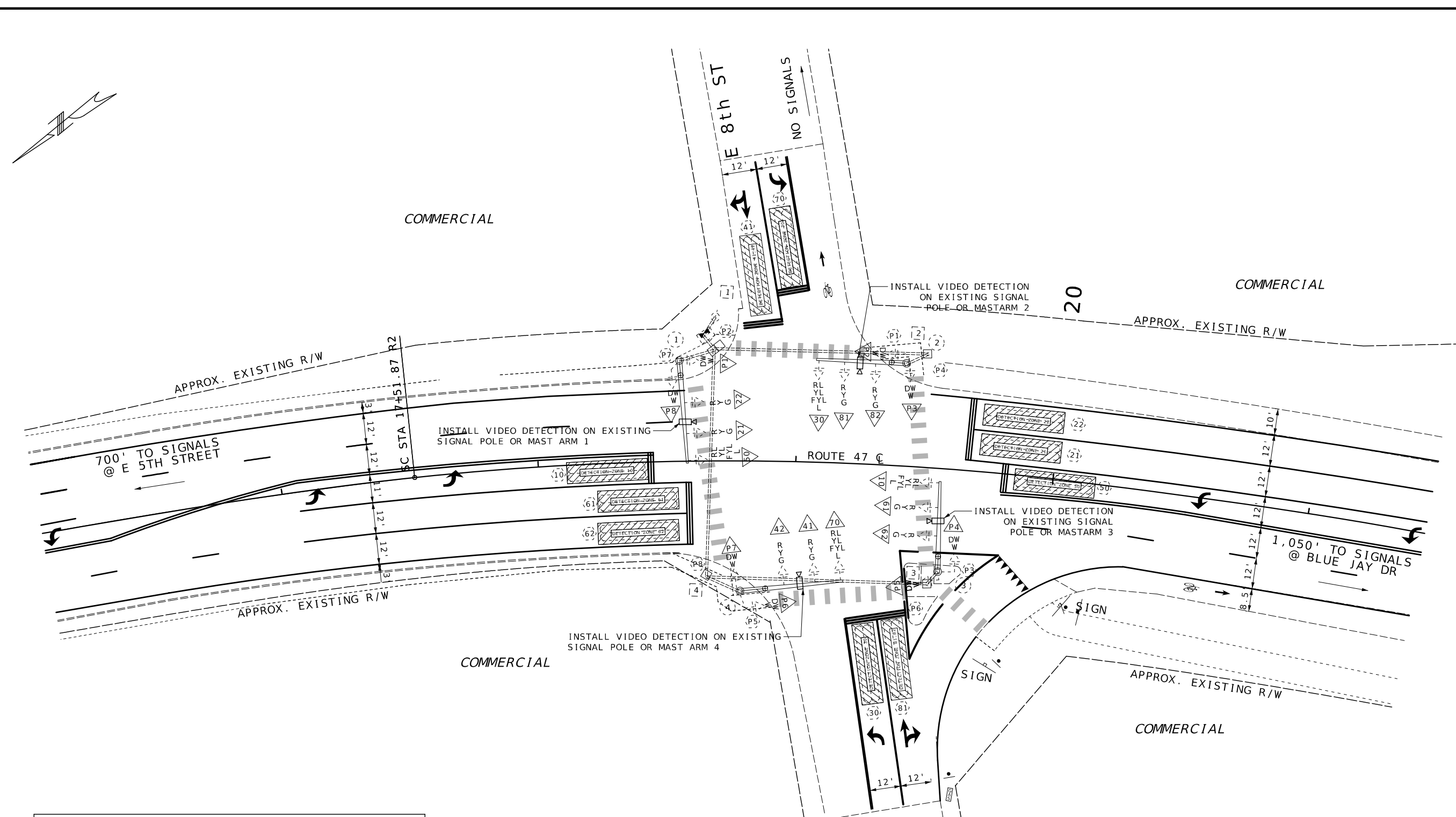

TRAFFIC SIGNALS LEGEND	
	CONTROLLER
	CONTROLLER (EXISTING)
	POWER SUPPLY (EXISTING)
	SIGNAL HEAD (PEDESTRIAN) (EXISTING)
	SIGNAL HEAD (STANDARD) (EXISTING)
	CONCRETE PULL BOX TYPE 1 (EXISTING)
	EXISTING 30 X 6 LOOP DETECTOR
	CONDUIT EXISTING
	EXISTING MAST ARM-BASE
	EXISTING MAST ARM - LUMINAIRE
	VIDEO DETECTOR
	VIDEO DETECTION ZONE

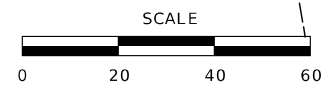

DISCLAIMER
THE PROFESSIONAL WHOSE SIGNATURE AND PERSONAL SEAL APPEAR HEREON ASSUMES RESPONSIBILITY ONLY FOR WHAT APPEARS ON THIS PAGE, AND DISCLAIMS (PURSUANT TO SECTION 327.411 RSMO) SPECIFICATION, ESTIMATES, REPORTS, OR OTHER DOCUMENTS OR INSTRUMENTS NOT SEALED BY THE UNDERSIGNED PROFESSIONAL RELATING TO OR INTENDED TO BE USED FOR ANY PART OR PARTS OF THE PROJECT TO WHICH THIS PAGE REFERS.

