

DESIGN DESIGNATION

A.A.D.T. - 2026 = 9,691
A.A.D.T. - 2036 = 11,813
T = 4%
V = 40.P.H.

FUNCTIONAL CLASSIFICATION- PRINCIPAL ARTERIAL

NO RIGHT OF WAY
ACQUISITION REQUIRED

MISSOURI HIGHWAYS AND TRANSPORTATION COMMISSION
PLANS FOR PROPOSED
STATE HIGHWAY
CLAY COUNTY

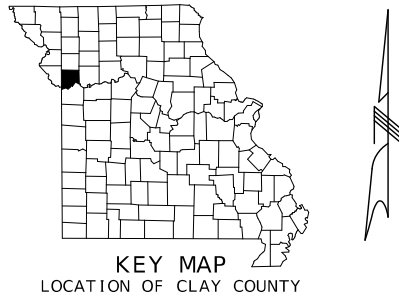

KEY MAP
LOCATION OF CLAY COUNTY

INDEX OF SHEETS

DESCRIPTION	SHEET NUMBER
TITLE SHEET	1
TYPICAL SECTIONS (TS) (1 SHEET)----	2
QUANTITIES (QU) (4 SHEETS)-----	3
SPECIAL SHEETS (SS)-----	4-5
TRAFFIC CONTROL SHEETS (TC)-----	6-15

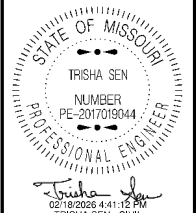

DATE PREPARED
2/16/2026
ROUTE 9 STATE MO
DISTRICT KC SHEET NO. 1
COUNTY CLAY
JOB NO. JKU0031
CONTRACT ID.

PROJECT NO.
BRIDGE NO.

BEGIN PROJECT
LOG MILE
11.021 SB

1" SP048FLP MILL/FILL,
PAVEMENT REPAIR - SB LANES ONLY

END PROJECT
LOG MILE
12.696 SB

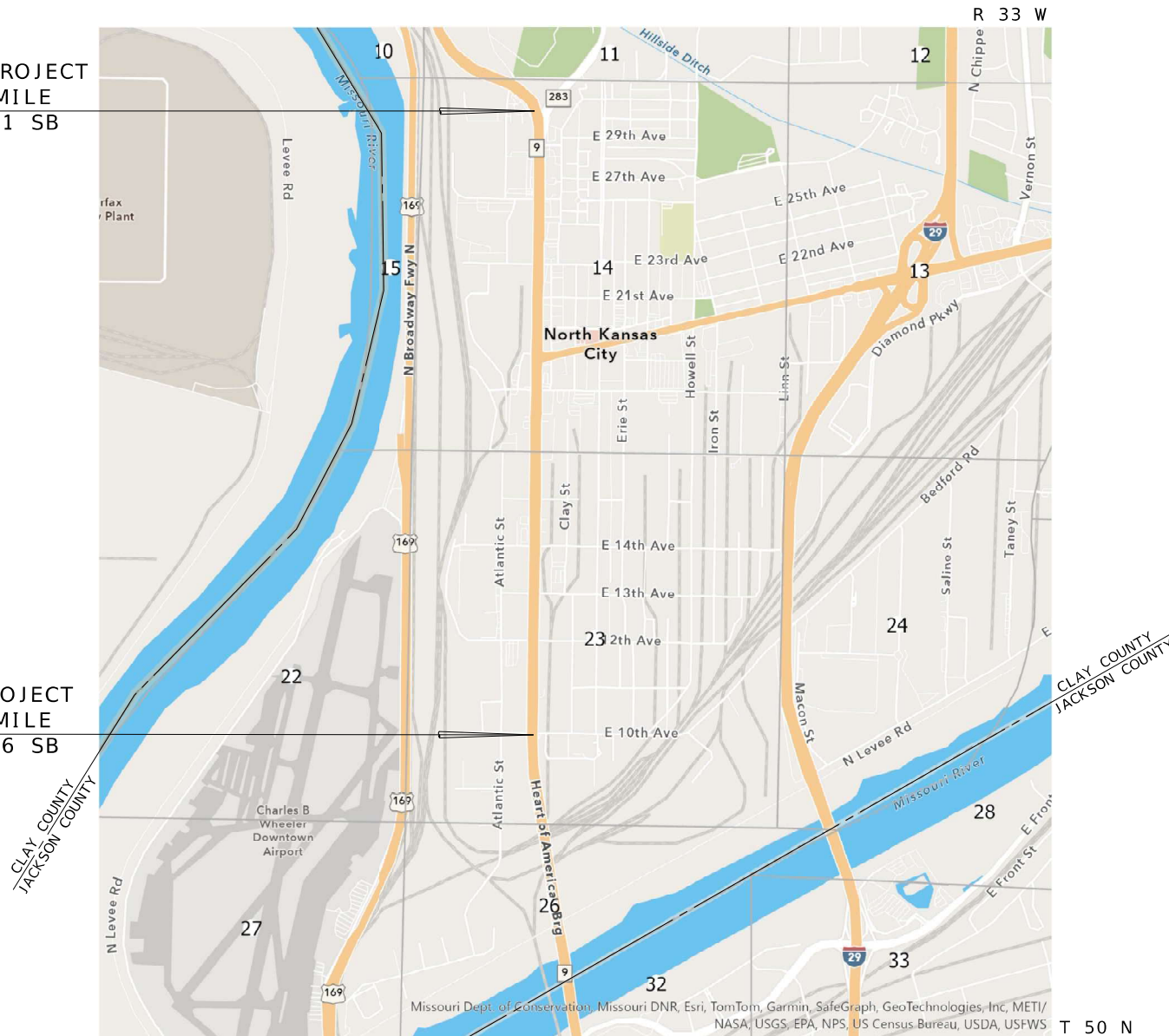

CONVENTIONAL SYMBOLS
(USED IN PLANS)

	EXISTING	NEW
BUILDINGS AND STRUCTURES	[Symbol]	[Symbol]
GUARD RAIL	[Symbol]	[Symbol]
GUARD CABLE	[Symbol]	[Symbol]
CONCRETE RIGHT-OF-WAY MARKER	[Symbol]	[Symbol]
STEEL RIGHT-OF-WAY MARKER	[Symbol]	[Symbol]
LOCATION SURVEY MARKER	[Symbol]	[Symbol]
UTILITIES		
FIBER OPTICS	-FO-	-FO-
OVERHEAD CABLE TV	-OTV-	-OTV-
UNDERGROUND CABLE TV	-UTV-	-UTV-
OVERHEAD TELEPHONE	-OT-	-OT-
UNDERGROUND TELEPHONE	-UT-	-UT-
OVERHEAD POWER	-OE-	-OE-
UNDERGROUND POWER	-UE-	-UE-
SANITARY SEWER	-S-	-S-
STORM SEWER	-SS-	-SS-
GAS	-G-	-G-
WATER	-W-	-W-
MANHOLE	[Symbol]	[Symbol]
FIRE HYDRANT	[Symbol]	[Symbol]
WATER VALVE	[Symbol]	[Symbol]
WATER METER	[Symbol]	[Symbol]
DROP INLET	[Symbol]	[Symbol]
DITCH BLOCK	[Symbol]	[Symbol]
GROUND MOUNTED SIGN	[Symbol]	[Symbol]
LIGHT POLE	[Symbol]	[Symbol]
H-FRAME POWER POLE	[Symbol]	[Symbol]
TELEPHONE PEDESTAL	[Symbol]	[Symbol]
FENCE	[Symbol]	[Symbol]
CHAIN LINK	[Symbol]	[Symbol]
WOVEN WIRE	[Symbol]	[Symbol]
GATE POST	[Symbol]	[Symbol]
BENCHMARK	[Symbol]	[Symbol]

NOTE: DASHED OR OPEN SYMBOLS INDICATE EXISTING FEATURES

NOT TO SCALE

THE EXISTENCE AND APPROXIMATE LOCATION OF UTILITY FACILITIES KNOWN TO EXIST, AS SHOWN ON THE PLANS, ARE BASED ON THE BEST INFORMATION AVAILABLE TO THE COMMISSION AT THIS TIME. THIS INFORMATION IS PROVIDED BY THE COMMISSION "AS-IS" AND THE COMMISSION EXPRESSLY DISCLAIMS ANY REPRESENTATION OR WARRANTY AS TO THE COMPLETENESS, ACCURACY, OR SUITABILITY OF THE INFORMATION FOR ANY USE. RELIANCE UPON THIS INFORMATION IS DONE AT THE RISK AND PERIL OF THE USER, AND THE COMMISSION SHALL NOT BE LIABLE FOR ANY DAMAGES THAT MAY ARISE FROM ANY ERROR IN THE INFORMATION. IT IS, THEREFORE, THE RESPONSIBILITY OF THE CONTRACTOR TO VERIFY THE EXISTENCE, LOCATION AND STATUS OF ANY FACILITY. SUCH VERIFICATION INCLUDES DIRECT CONTACT WITH THE LISTED UTILITIES.

LENGTH OF PROJECT

BEGINNING OF PROJECT	LOG MILE 11.021 SB
END OF PROJECT	LOG MILE 12.696 SB
APPARENT LENGTH	8844 FEET

EQUATIONS AND EXCEPTIONS:

TOTAL CORRECTIONS	0.00 FEET
NET LENGTH OF PROJECT	8844 FEET
STATE LENGTH	1.675 MILES
FOR INFORMATION ONLY ESTIMATED DISTURBED ACRES	0.00 ACRES

DESCRIPTION
DATE
MISSOURI HIGHWAYS AND TRANSPORTATION COMMISSION



105 WEST CAPITOL
JEFFERSON CITY, MO 65102
1-888-ASK-MODOT (1-888-275-6636)

SIGN	SIZE IN.	AREA SQ. FT.	QTY EACH	TOTAL AREA SQ. FT.	QTY RELOC EACH	TOTAL RELOC SQ. FT.	SIGN NUM.	DESCRIPTION
WARNING SIGNS								
WO1-1L	48X48	16.00						TURN (SYMBOL LEFT)
WO1-1R	48X48	16.00						TURN (SYMBOL RIGHT)
WO1-2L	48X48	16.00						CURVE (SYMBOL LEFT)
WO1-2R	48X48	16.00						CURVE (SYMBOL RIGHT)
WO1-3L	48X48	16.00						REVERSE TURN (SYMBOL LEFT)
WO1-3R	48X48	16.00						REVERSE TURN (SYMBOL RIGHT)
WO1-4L	48X48	16.00	6	96				REVERSE CURVE (SYMBOL LEFT)
WO1-4R	48X48	16.00						REVERSE CURVE (SYMBOL RIGHT)
WO1-4bL	48X48	16.00						DOUBLE ARROW REVERSE CURVE (SYMBOL LEFT)
WO1-4bR	48X48	16.00						DOUBLE ARROW REVERSE CURVE (SYMBOL RIGHT)
WO1-4cL	48X48	16.00						TRIPLE ARROW REVERSE CURVE (SYMBOL LEFT)
WO1-4cR	48X48	16.00						TRIPLE ARROW REVERSE CURVE (SYMBOL RIGHT)
WO1-6	60X30	12.50						HORIZONTAL ARROW (SYMBOL)
WO1-6a	72X36	18.00						HORIZ. ARROW (SYMBOL ON PERMANENT BARRICADE)
WO1-7	60X30	12.50						DOUBLE HEAD HORIZONTAL ARROW (SYMBOL)
WO1-7a	72X36	18.00						DOUBLE HEAD HORIZ. ARROW (SYMBOL ON PERM. BARR.)
WO1-8	18X24	3.00						CHEVRON (SYMBOL)
WO1-8a	30X36	7.50						CHEVRON (SYMBOL FOR DIVIDED HIGHWAYS)
WO3-1	48X48	16.00						STOP AHEAD (SYMBOL)
WO3-2	48X48	16.00						YIELD AHEAD (SYMBOL)
WO3-3	48X48	16.00						SIGNAL AHEAD (SYMBOL)
WO3-4	48X48	16.00						BE PREPARED TO STOP
WO3-5	48X48	16.00						SPEED LIMIT AHEAD
WO4-1L	48X48	16.00						MERGE (SYMBOL FROM LEFT)
WO4-1R	48X48	16.00						MERGE (SYMBOL FROM RIGHT)
WO4-1aL	48X48	16.00	6	96				MERGE (LEFT)
WO4-1aR	48X48	16.00	6	96				MERGE (RIGHT)
WO5-1	48X48	16.00	6	96				ROAD/BRIDGE/RAMP NARROWS
WO5-3	48X48	16.00						ONE LANE BRIDGE
WO5-5	48X48	16.00						NARROW LANES
WO6-1	48X48	16.00						DIVIDED HIGHWAY (SYMBOL)
WO6-2	48X48	16.00						DIVIDED HIGHWAY END (SYMBOL)
WO6-3	48X48	16.00						TWO WAY TRAFFIC (SYMBOL)
WO7-3a	30X24	5.00						NEXT XX MILES (PLAQUE)
WO8-1	48X48	16.00						BUMP
WO8-2	48X48	16.00						DIP
WO8-3	48X48	16.00						PAVEMENT ENDS
WO8-4	48X48	16.00						SOFT SHOULDER
WO8-5	48X48	16.00						SLIPPERY WHEN WET (SYMBOL)
WO8-6	48X48	16.00						TRUCK CROSSING
WO8-6c	48X48	16.00						TRUCK ENTRANCE
WO8-7	36X36	9.00						LOOSE GRAVEL
WO8-7a	36X36	9.00						FRESH OIL / LOOSE GRAVEL
WO8-9	48X48	16.00						LOW SHOULDER
WO8-11	48X48	16.00						UNEVEN LANES
WO8-12	48X48	16.00						NO CENTER LINE
WO8-15	48X48	16.00						GROOVED PAVEMENT
WO8-15P	30X24	5.00						MOTORCYCLE (PLAQUE)
WO8-17L	48X48	16.00						SHOULDER DROP-OFF (SYMBOL LEFT)
WO8-17R	48X48	16.00						SHOULDER DROP-OFF (SYMBOL RIGHT)
WO8-17P	30X24	5.00						SHOULDER DROP-OFF (PLAQUE)
WO10-1	42RND.	9.62						RAILROAD CROSSING
WO12-1	24X24	4.00	6	24				DOUBLE DOWN ARROW (SYMBOL)
WO12-2	48X48	16.00						LOW CLEARANCE (SYMBOL)
WO12-2x	24X18	3.00						LOW CLEARANCE (PLAQUE)
WO12-2a	84X24	14.00						OVERHEAD LOW CLEARANCE (FEET AND INCHES)
WO12-4	120X60	50.00						LOW CLEARANCE XX FT XX IN XX MILES AHEAD
WO12-5	120X60	50.00						WIDTH RESTRICTION XX FT XX IN XX MILES AHEAD
WO13-1	30X30	6.25						ADVISORY SPEED (PLAQUE) (35 MPH, 40 MPH, 2-45 MPH)
WO16-2	30X24	5.00						XXX FEET (PLAQUE)
WO16-3	30X24	5.00						X MILE (PLAQUE)
WO20-1	48X48	16.00	23	368				ROAD/BRIDGE/RAMP WORK AHEAD
WO20-2	48X48	16.00						DETOUR AHEAD
WO20-3	48X48	16.00						ROAD CLOSED AHEAD
WO20-4	48X48	16.00						ONE LANE ROAD AHEAD
WO20-5	48X48	16.00	6	96				RIGHT/CENTER/LEFT LANE CLOSED AHEAD
WO20-5a	48X48	16.00	6	96				2 RIGHT/CENTER/LEFT LANES CLOSED AHEAD
WO20-6a	48X48	16.00	6	96				RIGHT/CENTER/LEFT LANE CLOSED
WO20-7a	48X48	16.00						FLAGGER (SYMBOL)
WO21-2	36X36	9.00						FRESH OIL
WO21-5	48X48	16.00	12	192				SHOULDER WORK / SHOULDER WORK AHEAD
WO22-1	48X48	16.00						BLASTING ZONE AHEAD
WO22-2	42X36	10.50						TURN OFF 2-WAY RADIO AND PHONE
WO22-3	42X36	10.50						END BLASTING ZONE
GO22-1	21X15	2.19	2	4.38				WET PAINT (ARROW PIVOTS)

SIGN	SIZE IN.	AREA SQ. FT.	QTY EACH	TOTAL AREA SQ. FT.	QTY RELOC EACH	TOTAL RELOC SQ. FT.	SIGN NUM.	DESCRIPTION
GUIDE SIGNS								
E05-1	36X48	12.00						GORE EXIT
E05-2	48X36	12.00						EXIT OPEN
E05-2a	48X36	12.00						EXIT CLOSED
GO20-1	60X24	10.00	2	20				ROAD WORK NEXT 2 MILES
GO20-2	48X24	8.00	2	16				END ROAD WORK
GO20-4	36X18	4.50						PILOT CAR FOLLOW ME
GO20-4a	42X30	8.75						PILOT CAR IN USE WAIT & FOLLOW
GO20-4a	18X12	1.50						PILOT CAR IN USE WAIT & FOLLOW
GO20-5aP	36X24	6.00	6	36				WORK ZONE (PLAQUE)
MO4-8a	24X18	3.00						END DETOUR
MO4-9L	48X36	12.00						DETOUR (LEFT)
MO4-9R	48X36	12.00						DETOUR (RIGHT)
MO4-9P	48X12	4.00						STREET NAME (PLAQUE)
MO4-10L	48X18	6.00						DETOUR ARROW (LEFT)
MO4-10R	48X18	6.00						DETOUR ARROW (RIGHT)
R1-1	48X48	13.25						STOP
R1-2	48TRI.	6.93						YIELD
R1-2a	36X36	9.00						TO ONCOMING TRAFFIC (PLAQUE)
R1-3P	30X12	2.50						ALL WAY (PLAQUE)
R2-1	36X48	12.00	8	96				SPEED LIMIT 6-30 MPH, 2-40 MPH
R3-1	48X48	16.00						NO RIGHT TURN (SYMBOL)
R3-2	48X48	16.00						NO LEFT TURN (SYMBOL)
R3-3	36X36	9.00						NO TURNS
R3-4	48X48	16.00						NO U-TURN (SYMBOL)
R3-7L	30X30	6.25	6	37.5				LEFT LANE MUST TURN LEFT
R3-7R	30X30	6.25	6	37.5				RIGHT LANE MUST TURN RIGHT
R4-1	36X48	12.00						DO NOT PASS
R4-2	36X48	12.00						PASS WITH CARE
R4-7a	36X48	12.00						KEEP RIGHT (HORIZONTAL ARROW)
R4-8a	36X48	12.00						KEEP LEFT (HORIZONTAL ARROW)
R5-1	30X30	6.25						DO NOT ENTER
R5-1a	36X24	6.00						WRONG WAY
R6-1L	54X18	6.75						ONE WAY ARROW (LEFT)
R6-1R	54X18	6.75						ONE WAY ARROW (RIGHT)
R6-2L	24X30	5.00						ONE WAY (LEFT)
R6-2R	24X30	5.00						ONE WAY (RIGHT)
R9-9	24X12	2.00						SIDEWALK CLOSED
R9-11L	24X18	3.00						SIDEWALK CLOSED AHEAD, (ARROW LEFT) CROSS HERE
R9-11R	24X18	3.00						SIDEWALK CLOSED AHEAD, (ARROW RIGHT) CROSS HERE
R10-6	24X36	6.00						STOP HERE ON RED (45° ARROW)
R11-2	48X30	10.00						ROAD CLOSED
R11-3a	60X30	12.50						ROAD CLOSED XX MILES AHEAD LOCAL TRAFFIC ONLY
R11-4	60X30	12.50						ROAD CLOSED TO THRU TRAFFIC
CONST-3A	60X48	20.00						FINE SIGN
CONST-3X	56X12	4.67						SPEEDING/PASSING (PLATE)
MISCELLANEOUS SIGNS								
CONST-5	48X36	12.00						POINT OF PRESENCE
CONST-5	96X48	32.00	2	64				POINT OF PRESENCE
CONST-8	48X36	12.00	2	24				WORK ZONE NO PHONE ZONE
TOTAL								
616-10.05 CONSTRUCTION SIGNS						1592		
616-10.10 RELOCATED SIGNS							0	

SUMMARY OF QUANTITIES
SHEET 4 OF 4

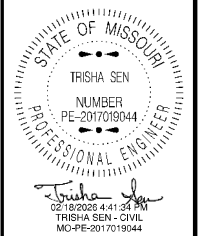

DATE PREPARED

2/16/2026

ROUTE 9 STATE MO

DISTRICT KC SHEET NO. 3

COUNTY CLAY

JOB NO. JKU0031

CONTRACT ID.

PROJECT NO.

BRIDGE NO.

DESCRIPTION

DATE

MISSOURI HIGHWAYS AND TRANSPORTATION COMMISSION

105 WEST CAPITOL JEFFERSON CITY, MO 65102

1-888-ASK-MODOT (1-888-275-6636)

MoDOT

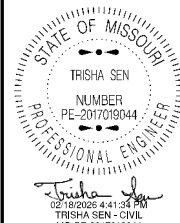

DATE PREPARED
2/16/2026

ROUTE	STATE
9	MO
DISTRICT	SHEET NO.
KC	4

COUNTY
CLAY

JOB NO.
JKU0031

CONTRACT ID.

PROJECT NO.

BRIDGE NO.

DATE	DESCRIPTION

MISSOURI HIGHWAYS AND TRANSPORTATION COMMISSION

105 WEST CAPITOL
JEFFERSON CITY, MO 65102
1-888-ASK-MODOT (1-888-275-6636)

SPECIAL SHEET
SHEET 1 OF 2

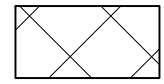
 1" COLDMILLING
1" SP048FLP W/ PG76-22

NOTES:
(1) APPROXIMATELY 15' OF CURB.

BEGIN PROJECT
SB MO 9
LOG MILE 11.021

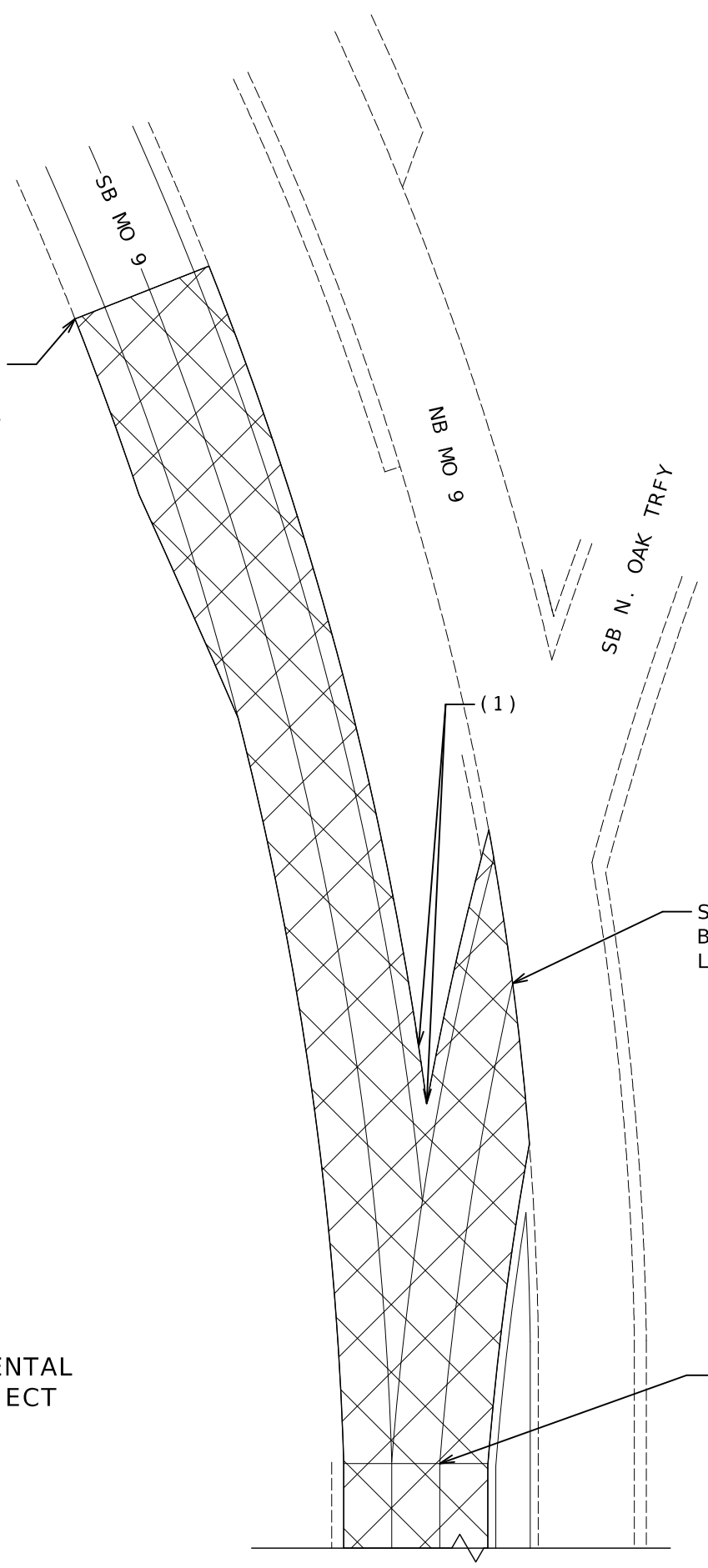

SB N. OAK TRFY
BEGIN COLDMILL/FILL SP048C
LOG MILE 10.612

SB N. OAK TRFY
END LOG MILE 10.642

SB MO 9
LOG MILE 11.067

ANY WORK INDICATED ON THE PLANS THAT EXTENDS
BEYOND THE PROJECT LIMITS IS CONSIDERED INCIDENTAL
TO AND A PART OF THE CONSTRUCTION OF THIS PROJECT



1" COLDMILLING
1" SP048FLP W/ PG76-22

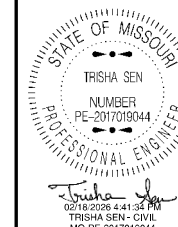
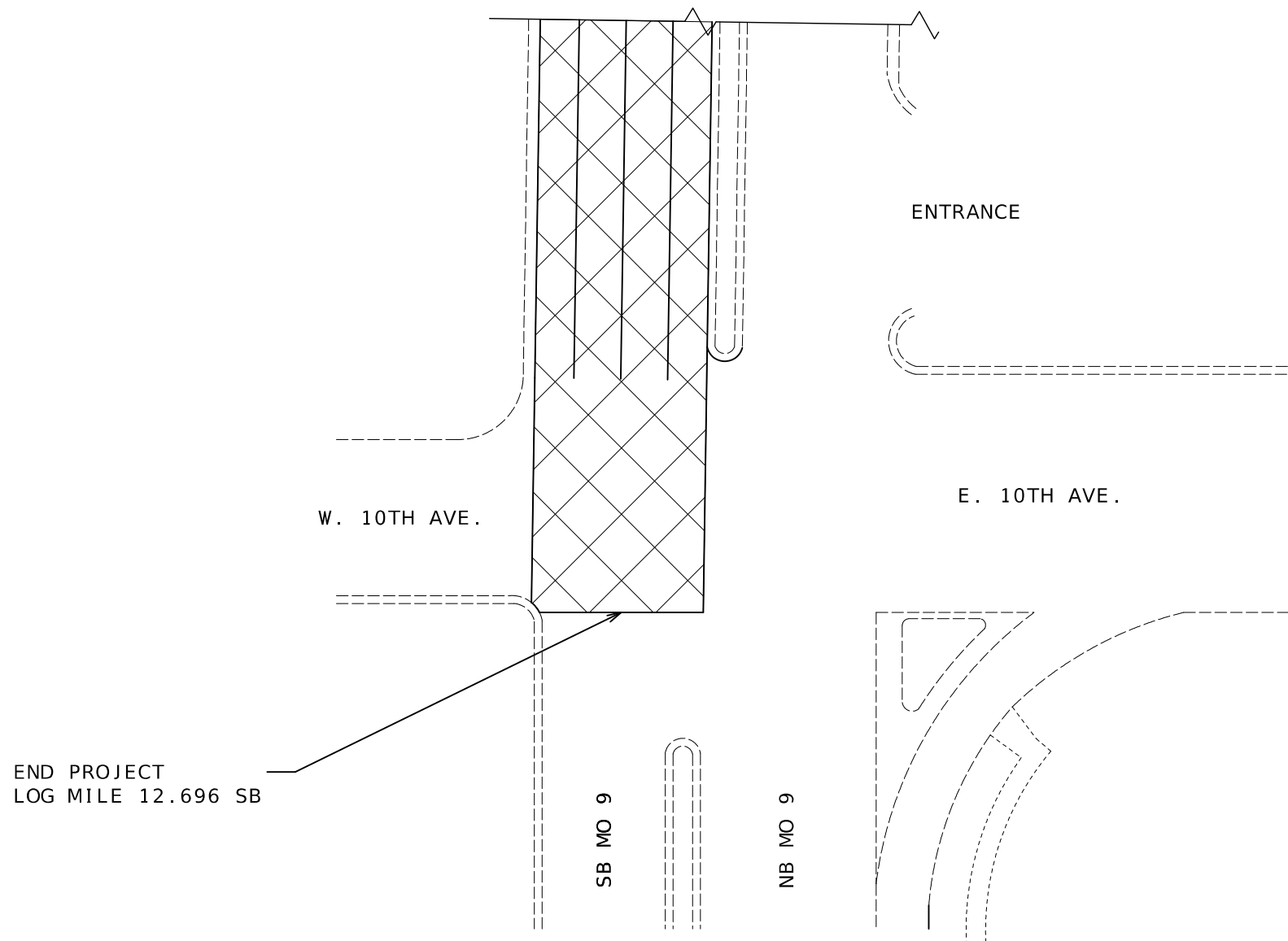

DATE PREPARED
2/16/2026

ROUTE 9 STATE MO

DISTRICT KC SHEET NO. 5

COUNTY CLAY

JOB NO. JKU0031

CONTRACT ID.

PROJECT NO.

BRIDGE NO.

DATE	DESCRIPTION

MISSOURI HIGHWAYS AND TRANSPORTATION COMMISSION

105 WEST CAPITOL
JEFFERSON CITY, MO 65102
1-888-ASK-MODOT (1-888-273-6636)

END OF PROJECT LIMITS; END OF WORK ZONE TERMINATION AREA, IF LOCATED BEYOND END OF PROJECT; OR LAST WORK ZONE SIGN, IF LOCATED OUTSIDE PROJECT LIMITS.

BEGINNING OF PROJECT LIMITS; OR INITIAL WORK ZONE SIGN, IF LOCATED OUTSIDE PROJECT LIMITS.

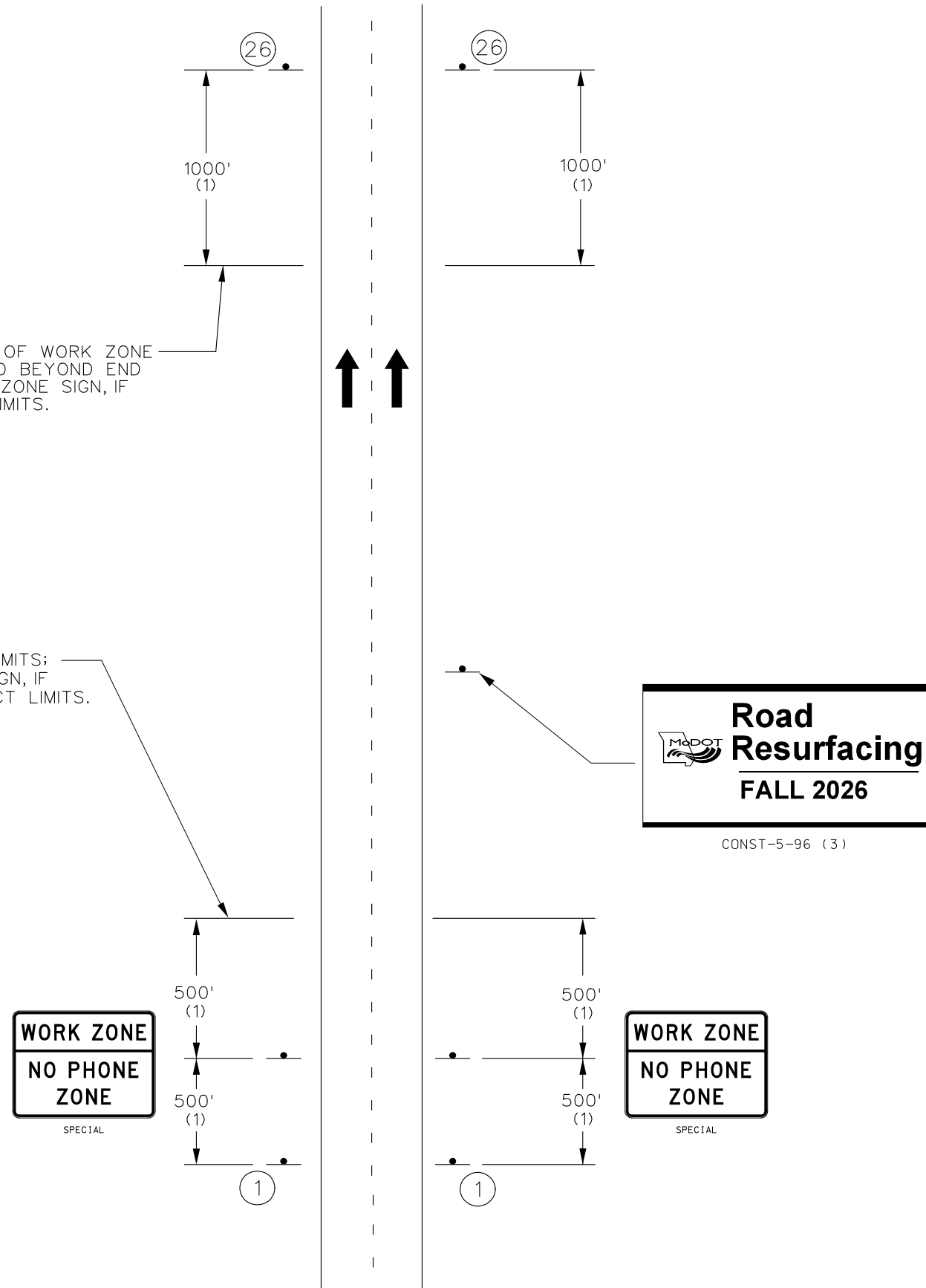

MULTI-LANE DIVIDED
BEGIN/END OF PROJECT SIGNING
(FOR USE ON ALL PROJECTS)

NOTES:

SIGN G020-1 IS REQUIRED PER EPG 616.6.56.

SIGN G020-2 IS USED ON ALL PROJECTS WHERE SIGN G020-1 IS USED.

OTHER SIGNS SUCH AS DETOUR OR ALTERNATE ROUTE SIGNING MAY BE USED OUTSIDE THE PROJECT LIMITS.

ANY EXISTING SIGNING THAT CONFLICTS WITH THE TRAFFIC CONTROL SIGNING SHALL BE COMPLETELY COVERED OR REMOVED.

(1) DISTANCE MAY BE ADJUSTED ACCORDING TO FIELD CONDITIONS. WHERE TRAFFIC BACKUPS ARE EXPECTED BEYOND THE ADVANCE WARNING AREA, ADDITIONAL SIGNING MAY BE NEEDED.

(2) SIGN CONST-7-48 OR CONST-7-72 IS PLACED 500 FEET BEFORE THE BEGINNING OF PROJECT LIMITS OR THE ROAD WORK AHEAD SIGN OR ROAD WORK NEXT XX MILES SIGN, IF USED, WHEN THESE SIGNS ARE LOCATED OUTSIDE THE PROJECT LIMITS.

(3) SIGN CONST-5-96 OR CONST-5-48 IS PLACED IN A VISIBLE AREA WITHIN THE PROJECT LIMITS PROVIDED ITS PLACEMENT DOES NOT DISRUPT A SEQUENCE OF SIGNS. IF A VISIBLE LOCATION WITHIN THE PROJECT IS NOT AVAILABLE, THE SIGN MAY BE PLACED 500 FEET BEFORE SIGN CONST-7-48 OR CONST-7-72.

(4) THE "RATE OUR WORK ZONE" SIGN IS AVAILABLE IN TWO SIZES DEPENDING ON ROADWAY CONDITIONS. THE 48 IN. X 24 IN. SIGN IS USED ON LOW VOLUME ROUTES THAT CARRY 400 AADT OR LESS, ON PROJECTS THAT HAVE A DURATION OF 4 WEEKS OR LESS OR IN URBAN AREAS WHERE THERE IS INSUFFICIENT RIGHT OF WAY FOR A SIX FOOT WIDE SIGN. THE 72 IN. X 36 IN. VERSION OF THE SIGN IS USED IN ALL OTHER APPLICATIONS. BUT CAN ALSO BE USED IN PLACE OF THE 48 IN. X 24 IN. SIGN IF ADDED EMPHASIS IS DEEMED NECESSARY.

(5) THE "POINT OF PRESENCE" SIGN IS AVAILABLE IN TWO SIZES DEPENDING ON ROADWAY CONDITION. THE 48 IN. X 36 IN. SIGN IS USED ON LOW VOLUME ROUTES THAT CARRY 400 AADT OR LESS, ON PROJECTS THAT HAVE A DURATION OF 4 WEEKS OR LESS OR IN URBAN AREAS WHERE THERE IS INSUFFICIENT RIGHT OF WAY FOR AN EIGHT FOOT WIDE SIGN. THE 96 IN. X 48 IN. VERSION OF THE SIGN IS USED IN ALL OTHER APPLICATIONS. BUT CAN ALSO BE USED IN PLACE OF THE 48 IN. X 36 IN. SIGN IF ADDED EMPHASIS IS DEEMED NECESSARY.

WORK ZONE
NO PHONE ZONE

SPECIAL

WHEN THE "ROAD WORK NEXT XX MILES" IS NOT USED THE "NO PHONE ZONE" SIGN IS TO BE PLACED A MINIMUM OF 500' BEFORE THE "ROAD WORK AHEAD" SIGN. REFER TO EPG 616.6.51.3 WORK ZONE NO PHONE ZONE SIGN



G020-1
①

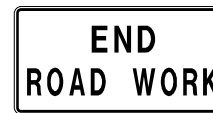

G020-2
②⑥

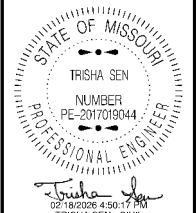

DATE PREPARED 2/16/2026	
ROUTE 9	STATE MO
DISTRICT KC	SHEET NO. 7
COUNTY CLAY	
JOB NO. JKU0031	
CONTRACT ID.	
PROJECT NO.	
BRIDGE NO.	

DATE	DESCRIPTION

MISSOURI HIGHWAYS AND TRANSPORTATION COMMISSION

105 WEST CAPITOL
JEFFERSON CITY, MO 65102
1-888-ASK-MODOT (1-888-275-6636)

NOT TO SCALE

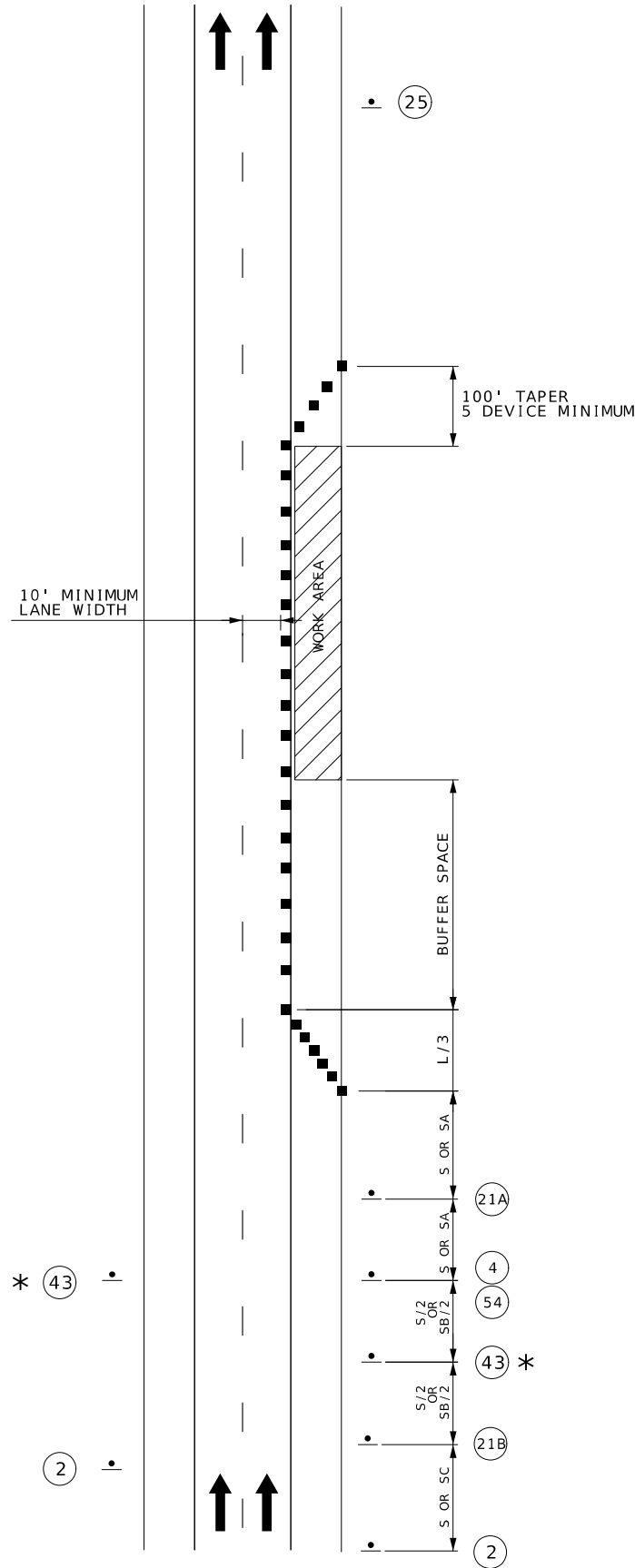

WORK ZONE

G020-5aP

(54)

SPEED LIMIT 30

R2-1

(4)

SPEED LIMIT 40

R2-1

(25)

ROAD WORK AHEAD

W020-1

(2)

BRIDGE OR RAMP

RIGHT SHOULDER CLOSED AHEAD

W021-5bR

(21B)

RIGHT SHOULDER CLOSED

W021-5aR

(21A)

ROAD NARROWS

W05-1

NEXT XX MILES

W07-3a

(PLAQUE NOT USED IF LESS THAN ONE MILE.)

(43) * OMIT SIGN 43 FOR NO TRAVELWAY ENCROACHMENT.

SHOULDER WORK
(DIVIDED HIGHWAY)

TEMPORARY TRAFFIC CONTROL
SHEET 3 OF 10

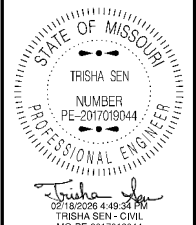

DATE PREPARED	
2/16/2026	
ROUTE	STATE
9	MO
DISTRICT	SHEET NO.
KC	8
COUNTY	
CLAY	
JOB NO.	
JKU0031	
CONTRACT ID.	
PROJECT NO.	
BRIDGE NO.	

DATE	DESCRIPTION

MISSOURI HIGHWAYS AND TRANSPORTATION COMMISSION

105 WEST CAPITOL
JEFFERSON CITY, MO 65102
1-888-ASK-MODOT (1-888-275-6636)

NOT TO SCALE

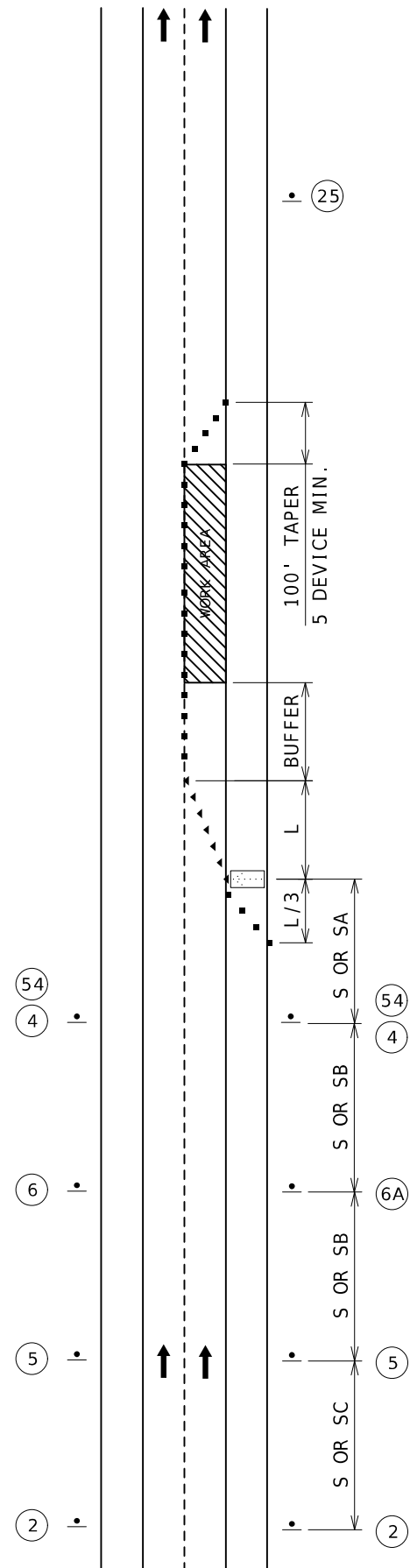

LEFT



LEFT

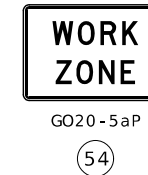
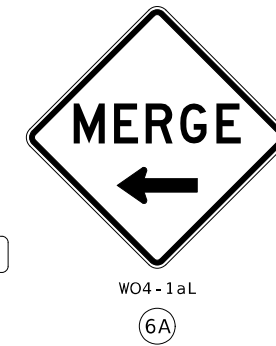

SINGLE LANE CLOSURE

TEMPORARY TRAFFIC CONTROL

SHEET 7 OF 10

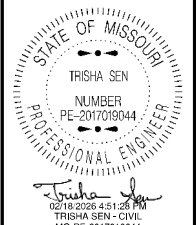

DATE PREPARED
2/16/2026
ROUTE 9 STATE MO
DISTRICT KC SHEET NO. 12
COUNTY CLAY
JOB NO. JKU0031
CONTRACT ID.
PROJECT NO.
BRIDGE NO.

DATE	DESCRIPTION

MISSOURI HIGHWAYS AND TRANSPORTATION COMMISSION
105 WEST CAPITOL JEFFERSON CITY, MO 65102
1-888-ASK-MODOT (1-888-273-6636)



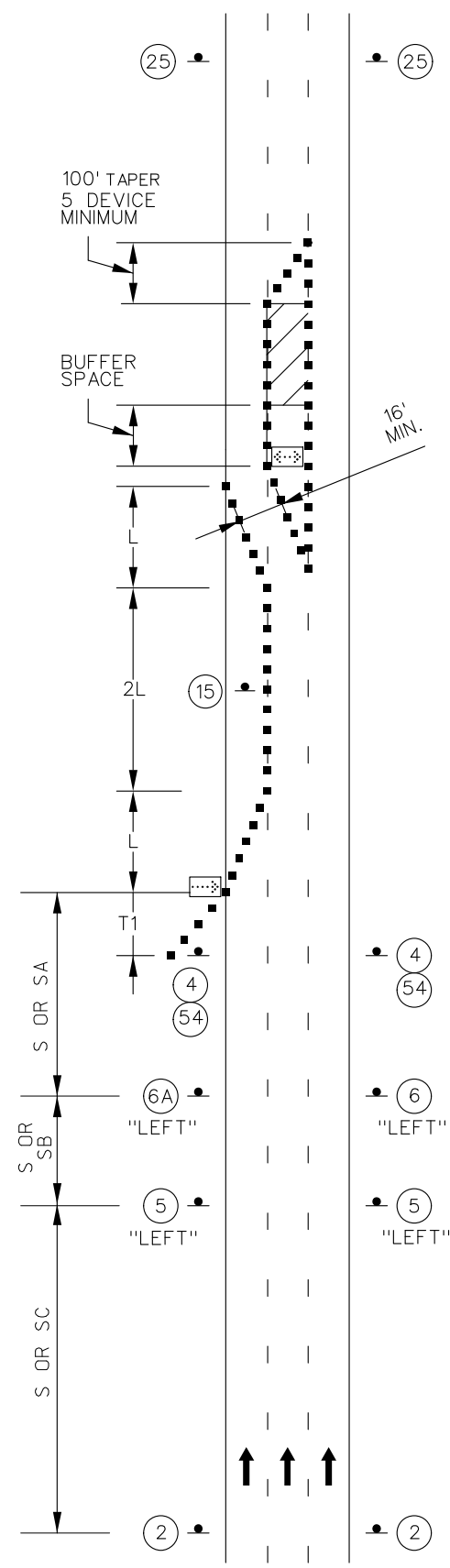

INTERIOR LANE

INTERIOR LANE CLOSURES OF MULTI-LANE DIVIDED HIGHWAY

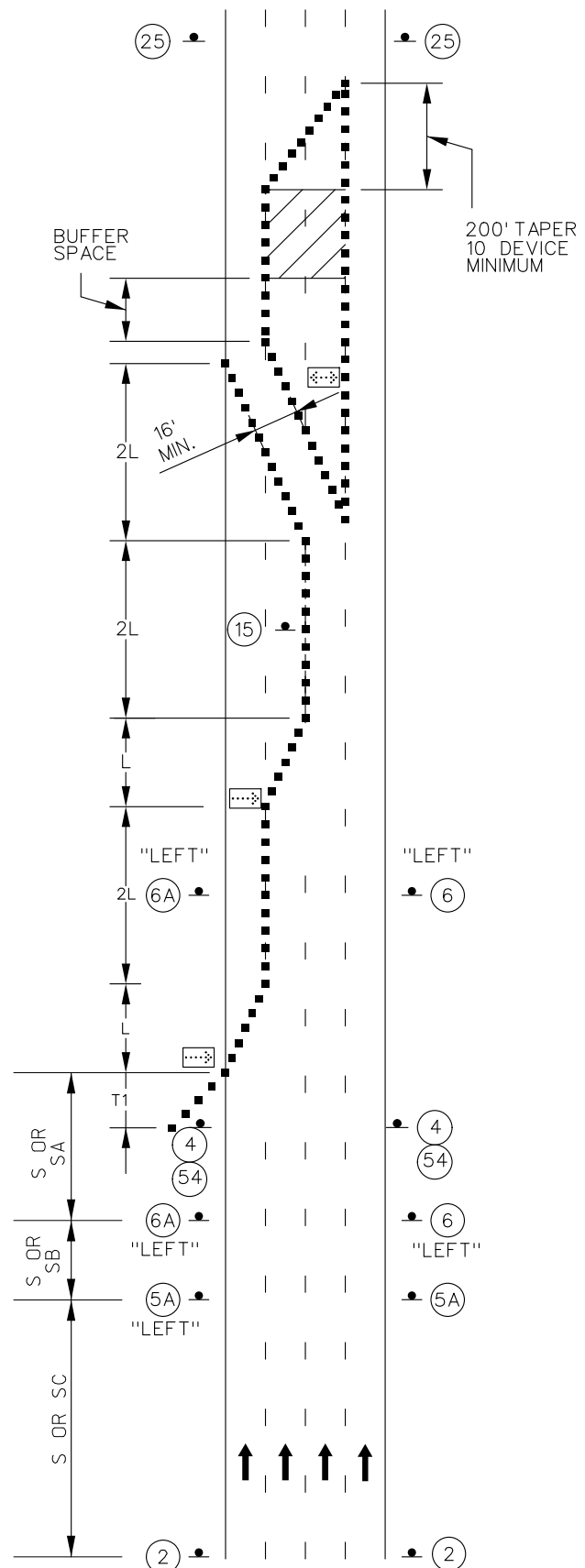

TWO INTERIOR LANES

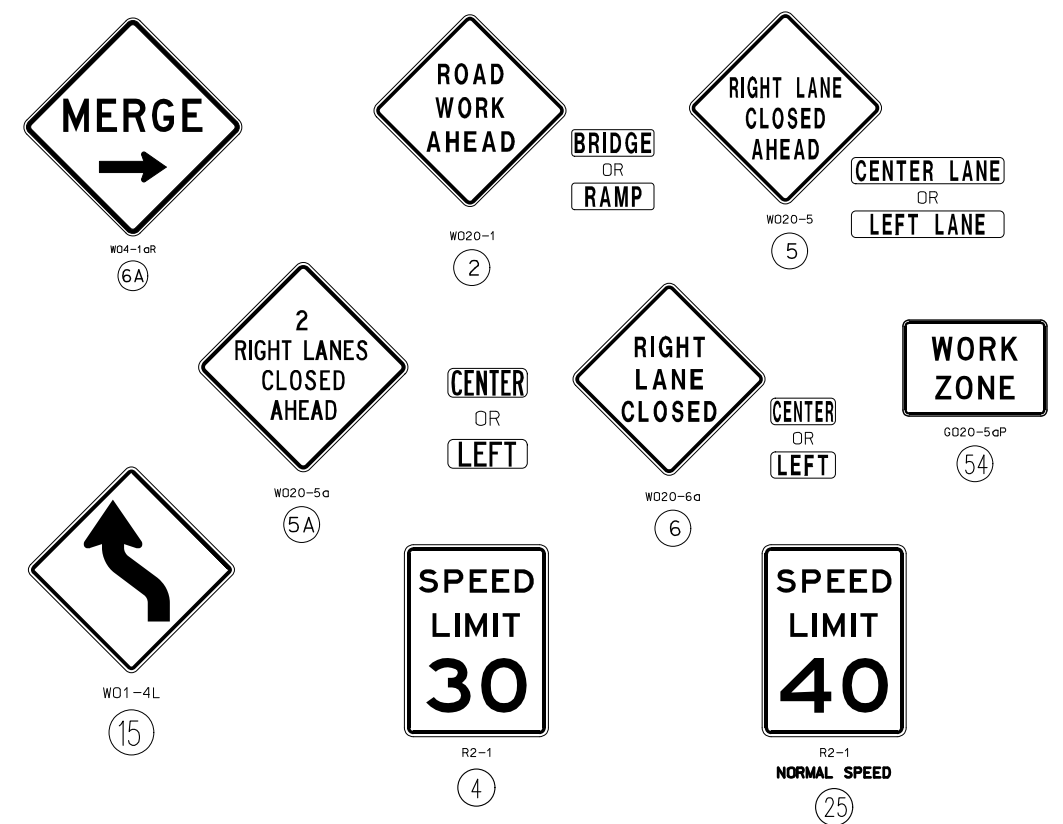

NOTES:

- (1). SEE TRAFFIC CONTROL SHEET 1 FOR WORK ZONE SPEED LIMIT GUIDELINES.
- (2). SEE TRAFFIC CONTROL SHEET 1 FOR SIGN SPACING, DEVICE SPACING AND CHANNELIZING TAPER LENGTHS.
- (3). REMOVE AND/OR MODIFY EXISTING PAVEMENT MARKING AS NEEDED.
- (4). TEMPORARY PAVEMENT MARKING REQUIRED WITH LONG TERM LANE CLOSURES.
- (5). ALTERNATIVE TEMPORARY TRAFFIC CONTROL SET-UPS SHOULD BE CONSIDERED WHEN REDUCTION IN CAPACITY CANNOT BE TOLERATED.
- (6). FOR NIGHTTIME OPERATIONS, REVIEW EPG 616.6.83 WARNING LIGHT FOR USE OF SEQUENTIAL LIGHTS.

INTERIOR LANE
CLOSURE ON FREEWAY
TEMPORARY
TRAFFIC CONTROL
SHEET 8 OF 10

TRISHA SEN
NUMBER PE-201709044
PROFESSIONAL ENGINEER

DATE PREPARED 2/16/2026	
ROUTE 9	STATE MO
DISTRICT KC	SHEET NO. 13
COUNTY CLAY	
JOB NO. JKU0031	
CONTRACT ID.	
PROJECT NO.	
BRIDGE NO.	
DESCRIPTION	DATE

MISSOURI HIGHWAYS AND TRANSPORTATION COMMISSION

105 WEST CAPITOL
JEFFERSON CITY, MO 65102
1-888-ASK-MODOT (1-888-275-6636)

NOTES:

UPON APPROVAL OF THE ENGINEER, THE CONTRACTOR MAY PROVIDE ADDITIONAL PROTECTIVE TRUCKS EQUIPPED WITH PROPER WARNING DEVICES.

PROTECTIVE TRUCKS AND WORK VEHICLES SHALL DISPLAY HIGH-INTENSITY ROTATING, FLASHING, OSCILLATING, OR STROBE LIGHTS.

VEHICLE HAZARD WARNING SIGNALS SHALL NOT BE USED INSTEAD OF THE VEHICLE'S HIGH-INTENSITY ROTATING, FLASHING, OSCILLATING, OR STROBE LIGHTS.

VEHICLE-MOUNTED SIGNS SHALL BE MOUNTED IN A MANNER SUCH THAT THEY ARE NOT OBLSCURED BY EQUIPMENT OR SUPPLIES. SIGN LEGENDS ON VEHICLE-MOUNTED SIGNS SHALL BE COVERED OR TURNED FROM VIEW WHEN WORK IS NOT IN PROGRESS.

FLASHING ARROW PANELS SHALL BE INCIDENTAL TO TRUCK MOUNTED ATTENUATORS, WHEREVER USED. NO ADDITIONAL PAYMENT WILL BE MADE.

FLASHING ARROW PANELS SHALL, AS A MINIMUM, BE TYPE B, WITH A SIZE OF 60 X 30 INCHES.

A FLASHING ARROW BOARD SHALL BE USED WHEN A FREEWAY LANE IS CLOSED. WHEN MORE THAN ONE LANE CLOSED, A SEPARATE FLASHING ARROW BOARD SHALL BE USED FOR EACH CLOSED LANE.

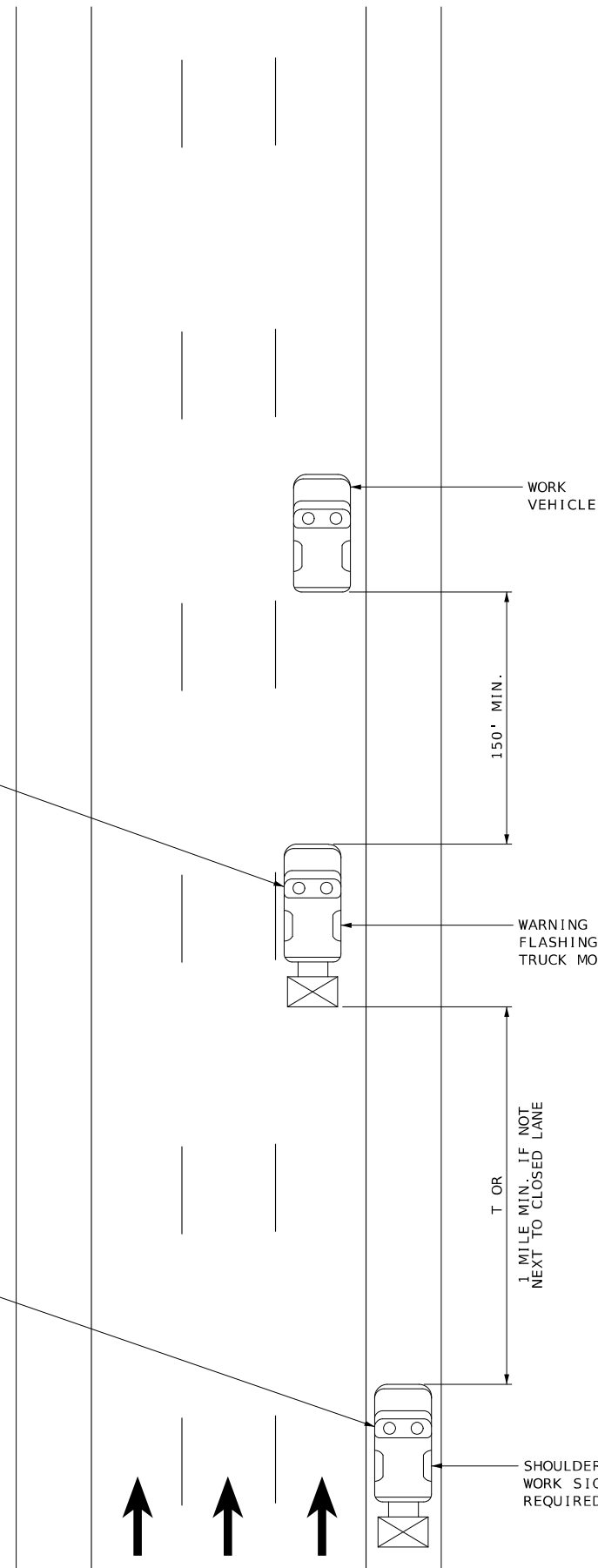
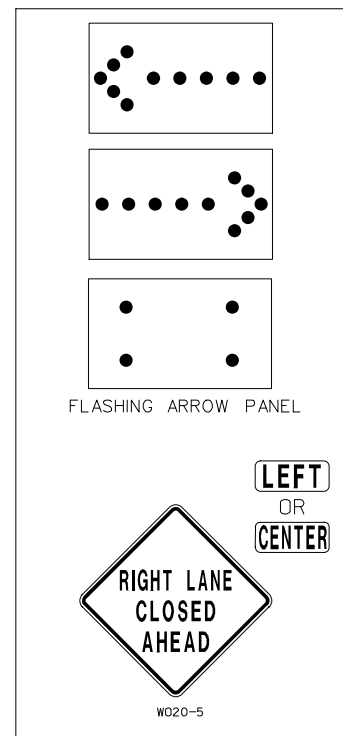
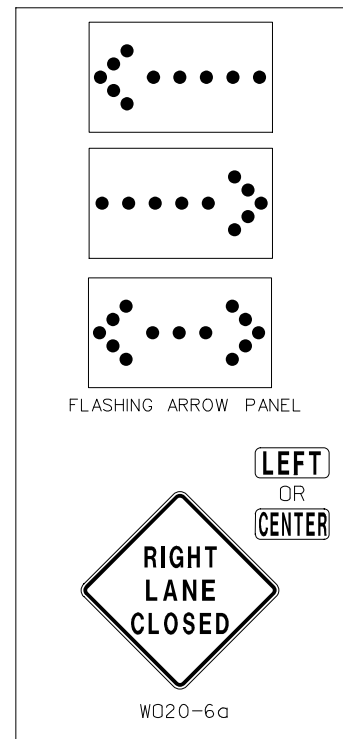

SPEED	SPACING
PERMANENT POSTED (MPH)	LENGTH T (FT)
≤ 35	245
40-45	540
50-55	660
60-70	840

MOBILE ON MULTI-LANE HIGHWAY

TEMPORARY TRAFFIC CONTROL

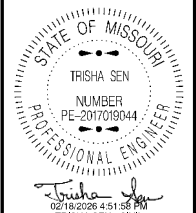

DATE PREPARED
2/16/2026

ROUTE 9	STATE MO
DISTRICT KC	SHEET NO. 14
COUNTY CLAY	
JOB NO. JKU0031	
CONTRACT ID.	
PROJECT NO.	
BRIDGE NO.	

DATE	DESCRIPTION

MISSOURI HIGHWAYS AND TRANSPORTATION COMMISSION

105 WEST CAPITOL
JEFFERSON CITY, MO 65102
1-888-ASK-MODOT (1-888-275-6636)

MOBILIZATION
 1 LUMP SUM

REMOVAL OF IMPROVEMENTS							
BEGIN LOG	DIRECTION	LOCATION	LT/RT	ITEM	UNIT	QUANTITY	REMARKS
12.878	SB	ROUTE 9	RT	GUARDRAIL	LF	125	BR. A4191
13.078	SB	ROUTE 9	RT	GUARDRAIL	LF	625	BR. A4191 / A4060
13.818	SB	ROUTE 9	RT	GUARDRAIL	LF	675	A4059 / A4058
14.058	SB	ROUTE 9	RT	GUARDRAIL	LF	125	BR. A4112
14.161	SB	ROUTE 9	RT	GUARDRAIL	LF	212.5	BR. A4112
0.157	SB	RAMP SB 9 TO SB I35	RT	GUARDRAIL	LF	549	BR. A4113
0.157	SB	RAMP SB 9 TO SB I35	LT	GUARDRAIL	LF	93	BR. A4113
0.157	SB	RAMP SB 9 TO NB I35	RT	GUARDRAIL	LF	90	BR. A4115
0.157	SB	RAMP SB 9 TO NB I35	LT	GUARDRAIL	LF	125	BR. A4115
0.157	SB	RAMP SB 9 TO I35	GORE	SAND BARRELS	ARRAY	1	BR. A4113/A4115
0.024	NB	ROUTE 9	RT	GUARDRAIL	LF	137.5	BR. A4112/A4457
0.126	NB	ROUTE 9	RT	GUARDRAIL	LF	62.5	BR. A4112/A4457
0.400	NB	RP 3RD ST TO NB 9	LT	GUARDRAIL	LF	130	
0.022	NB	RP 6TH ST TO NB 9	RT	GUARDRAIL	LF	130	BR. A4114
0.089	NB	RP 6TH ST TO NB 9	RT	GUARDRAIL	LF	662.5	BR. A4114
0.045	EB/NB	RP 35N TO NB 9	LT	GUARDRAIL	LF	825	BR. A4114
PAY TOTAL						1 LUMP SUM	

FULL DEPTH PAVEMENT REPAIR											
REPAIR NO.	# OF REPAIRS	LENGTH	WIDTH	FURN. PLACE	DOWEL BARS	TIE BARS	6" SUBGRADE COMPACTION	TYPE 1 OR 5 AGGREGATE	BASKETS	SAW CUT	COMMENTS
FT	FT	L.F.	L.F.	SY	EACH	EACH	SY	SY	EACH	L.F.	
1	1	6	12	8.0	20	0	2.4	2.4	0	30	6TH ST TO NB 9 HIGHWAY
2	1	6	12	8.0	20	0	2.4	2.4	0	30	6TH ST TO NB 9 HIGHWAY
3	1	6	12	8.0	20	0	2.4	2.4	0	30	FROM ADMIRAL, NB/SB RAMPS
4	1	6	12	8.0	20	0	2.4	2.4	0	30	
SUB-TOTALS				32.0	80	0	9.6	9.6	0	120	
20% WINTERING				3.2	16	0	1.9	1.9	0	24	
TOTALS				35.2	96	0	12	12	0	144	

NOTE: ALL PAVEMENT REPAIRS TO BE MARKED BY THE ENGINEER

CLASS A & C PARTIAL DEPTH PAVEMENT REPAIR								
Repair No.	NO. OF REPAIRS	Length	Width	REMOVAL	REMOVAL	FURNISH &	FURNISH &	REMARKS
				CLASS A	CLASS C	PLACE	PLACE	
				S.Y.	S.Y.	C.Y	TONS	
1	1	12	10		13.3		3.7	ON RAMP FROM 3RD ST
2	1	2	10		2.2		0.6	ON RAMP FROM 3RD ST
3	1	2	3		0.7		0.2	ON RAMP FROM 3RD ST
4	1	2	3		0.7		0.2	OFF RAMP AT 3RD ST
5	1	3	12		4.0		1.1	70 WB TO GRAND BLVD RAMP
6-15	10	3	12		40.0		11.1	6TH ST TO NB 9 HIGHWAY
16-29	14	3	12	56.0		7.8		BETWEEN HOA BRIDGE NB
30-40	11	3	36	132.0		18.3		SB BEFORE HOA BRIDGE
41-52	12	3	36	144.0		20.0		BETWEEN HOA BRIDGE SB
53-64	12	3	36	144.0		20.0		SB MO 9 TO 70 E/W RAMP
64-75	12	3	36		144.0		40.0	FROM ADMIRAL, NB/SB RAMPS
76-95	19	3	36	228.0		31.7		AFTER HOA BRIDGE NB
SUBTOTALS				704.0	204.9	97.8	56.9	
20% WINTERING				140.8	41.0	19.6	11.4	
TOTALS				844.8	245.9	117.4	68.3	

SUMMARY OF QUANTITIES
SHEET 1 OF 6

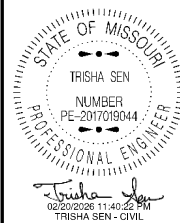

DATE PREPARED
2/16/2026

ROUTE **9** STATE **MO**

DISTRICT **KC** SHEET NO. **3**

COUNTY
CLAY / JACKSON

JOB NO.
JKU0465

CONTRACT ID.

PROJECT NO.

BRIDGE NO.

MISSOURI HIGHWAYS AND TRANSPORTATION COMMISSION

105 WEST CAPITOL
 JEFFERSON CITY, MO 65102
 1-888-ASK-MODOT (1-888-275-6636)

DESCRIPTION
 DATE

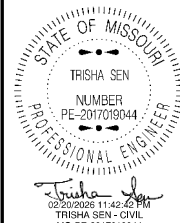

DATE PREPARED
2/16/2026
ROUTE 9 STATE MO
DISTRICT KC SHEET NO. 3
COUNTY
CLAY/JACKSON
JOB NO.
JKU0465
CONTRACT ID.
PROJECT NO.
BRIDGE NO.

SOUTHBOUND PAVEMENT QUANTITIES

BEGIN LOG MILE SB	END LOG MILE SB	DIRECTION	LENGTH FT	LOCATION	PAVEMENT WIDTH FT	SHOULDER WIDTH FT	MAINLINE SP048FLP W/ PG76-22 TONS	MAINLINE TACK COAT GAL	REMARKS	
12.696	12.914	SB	1151.04	MO 9	36		251.20	920.83	BEGIN PROJECT, BR. A4191 EXCEPTION	
13.088	13.117	SB	153.12	MO 9	36		33.42	122.50	BR. A4060 EXCEPTION, BR. A4059 EXCEPTION	
13.779	13.906	SB	670.56	MO 9	36	8	178.86	655.66	BR. A4058 EXCEPTION	
13.918	14.028	SB	580.80	MO 9	12	8	70.42	258.13		
14.028	14.085	SB	300.96	MO 9	36	8	80.28	294.27	BR. A4112 EXCEPTION	
14.163	14.185	SB	116.16	MO 9	36	8	30.98	113.58		
0.000	0.129	SB	681.12	RP SB MO 9 TO SB IS 35	34		282.46	514.62	OUTER RAMP	
0.129	0.157	SB	147.84	RP SB MO 9 TO SB IS 35	22		39.67	72.28	OUTER RAMP	
0.129	0.157	SB	147.84	RP SB MO 9 TO NB IS 35	22		39.67	72.28	OUTER RAMP	
0.143	0.251	SB	570.24	RP SB I-35 TO SB MO 9	24		166.93	304.13	INNER RAMP	
0.083	0.290	SB	1092.96	RP SB I-35 TO WB INDEPENDENCE AVE	VARIES 20' - 34	6	533.24	971.52		
0.000	0.028	SB	147.84	CST SB OAK ST.	36		64.92	118.27	END PROJECT	
							SUB TOTAL	1772.05	4418.07	
							SUB TOTAL (1)	1772.1	4418	

NORTHBOUND PAVEMENT QUANTITIES

BEGIN LOG MILE SB	END LOG MILE SB	DIRECTION	LENGTH FT	LOCATION	MAINLINE WIDTH FT	SHOULDER WIDTH FT	MAINLINE SP048FLP W/ PG76-22 TONS	MAINLINE TACK COAT GAL	REMARKS	
0.032	0.045	NB	68.64	MO 9	24	16	16.64	61.01	BR. A4112, BR. A4457 EXCEPTION	
0.122	0.176	NB	285.12	MO 9	36	6	72.59	266.11		
0.176	0.247	NB	374.88	MO 9	24	16	90.90	333.23		
0.247	0.287	NB	211.20	MO 9	38	10	61.45	225.28	BR. A4058 EXCEPTION	
0.308	0.421	NB	596.64	MO 9	36	14	180.84	662.93	BR. A4134, BR. A4060 EXCEPTION	
1.090	1.121	NB	163.68	MO 9	22	6	27.78	101.85	BR. A4173 EXCEPTION	
1.295	1.508	NB	1124.64	MO 9	60		409.06	1499.52		
0.000	0.044	NB	232.32	RP E 3RD ST. TO NB MO 9	VARIES 18' TO 42'		85.01	154.88	INCLUDES RAMP AND TURN LANE	
0.276	0.428	NB	802.56	RP NB IS 35 TO NB MO 9	22		293.67	392.36	OUTER RAMP	
0.000	0.131	NB	691.68	RP NB MO 9 TO WB INDEPENDENCE AVE	24		202.48	368.90	INNER RAMP	
							SUB TOTAL (2)	1440.42	4066.07	
							SUB TOTAL (1) + SUB TOTAL (2)	3212.47	8484.14	
							PAY TOTAL	3212.5	8485	

DESCRIPTION
DATE
MISSOURI HIGHWAYS AND TRANSPORTATION COMMISSION



GUARDRAIL															
LOG MILE	LOG MILE	LENGTH FT	LOCATION	DIR	LT/RT	MGS GUARDRAIL L.F.	MGS GUARDRAIL 8 FOOT POSTS L.F.	MGS END ANCHOR EA	TYPE A CW END TERMINAL (MASH) EA	BRIDGE ANCHOR SECTION 7.5 FT. POSTS (SAFETY BARRIER CURB) EA	ASYMMETRIC TRANSITION SECTION 7.5 FT POSTS EA	MGS BRIDGE APPROACH TRANSITION EXTENDED CURB EA	SHAPING SLOPES CLASS III STA	TYPE C CW MASH EACH	REMARKS
12.878	12.898	125	MO 9	SB	RT	37.5			1			1	1.25		BR. A4191
13.078	13.198	625	MO 9	SB	RT		568.75			1	1	1	1		BR. A4191* / A4060
13.818	13.898	675	MO 9	SB	RT		618.75			1	1	1	1		A4059 / A4058**
14.058	14.078	125	MO 9	SB	RT		37.5		1			1	1.25		BR. A4112
14.161	14.198	212.5	MO 9	SB	RT	200		1		1	1		0.5		BR. A4112***
0.046	0.156	550	RAMP SB 9 TO SB 135	SB	RT		462.5		1			1	1.25		BR. A4113
0.136	0.157	90	RAMP SB 9 TO SB 135	SB	LT	50						1	0.5	1	BR. A4113
0.132	0.157	90	RAMP SB 9 TO NB 135	SB	RT	50						1	0.5		BR. A4115
0.157	0.157	125	RAMP SB 9 TO NB 135	SB	LT	143.75			1	1	1		1.25		BR. A4115
0.024	0.046	137.5	MO 9	NB	RT	50			1			1	1.25		BR. A4112 / A4457
0.126	0.146	62.5	MO 9	NB	RT	31.25		1		1	1				BR. A4112 / A4457
0.020	0.040	130	RP 3RD ST TO NB 9	NB	LT	50			1			1	1.25		
0.020	0.033	100	RP 6TH ST TO NB 9	NB	RT	12.5			1			1	1.25		BR. A4114
0.089	0.171	662.5	RP 6TH ST TO NB 9	NB	RT	612.5		1				1			BR. A4114
0.045	0.201	825	RP 35N TO NB 9	EB/NB	LT	737.5			1			1	1.25		BR. A4114
SUBTOTALS						1975	1687.5	3	8	5	5	12	13.5	1	
PAY TOTALS						1975	1688	3	8	5	5	12	14	1	

* BUILD BR ANCHOR / ASYMMETRIC TRANS. SECTION AT S END OF A4191
 ** BUILD BR ANCHOR / ASYMMETRIC TRANS. SECTION AT S END OF A4058
 *** BUILD BR ANCHOR / ASYMMETRIC TRANS. SECTION AT S END OF A4112

CONCRETE PAD FOR TYPE C CRASHWORTH END TERMINAL (MASH)				
LOG MILE	LOCATION	8" NR CONCRETE PAVEMENT S.Y.	CLASS 1 LINEAR GRADING STA.	4" TYPE 1 AGGREGATE BASE S.Y.
0.136	SB OFF RAMP AT BR A4113	21.3	0.25	21.3
PAY TOTALS		21.3	0.3	21

PAVEMENT MARKING									
BEGIN LOG MILE	END LOG MILE	LENGTH FT	LOCATION	DIRECTION	PERFORMED THERMOPLASTIC PAVEMENT MARKING				REMARKS
					24" WHITE SOLID LF	30" WHITE MIDBLOCK EA*	LEFT/RIGHT ARROW EA	STRAIGHT ARROW EA	
12.696	12.696		MO 9	SB	24	20			10TH AVE. INTERSECTION
0.542	0.581	205.92	MO 9	NB	50				CHEVRONS, "STOP," CYCLIST
1.437	1.508	374.88	MO 9	NB			3		
1.508	1.508		MO 9	NB	48				
0.290	0.290		INDEPENDENCE AVE. AND GRAND BLVD. INTERSECTION	SB	24	12	1	1	RP 1-35 TO WB INDEPENDENCE AVE
0.028	0.028		CST SB OAK ST.	SB	40				STOP BAR
SUB TOTAL					186	32	4	1	
SUB TOTAL MIDBLOCKS					192		0	0	
PAY TOTALS					378		4	1	

* MIDBLOCKS PAID FOR AS 24" S.W. PER L.F. (6' EACH)

SUMMARY OF QUANTITIES
SHEET 4 OF 6

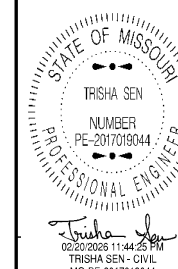

ROUTE 9 STATE MO
 DISTRICT KC SHEET NO. 3
 COUNTY CLAY / JACKSON
 JOB NO. JKU0465
 CONTRACT ID.
 PROJECT NO.
 BRIDGE NO.

DESCRIPTION	DATE

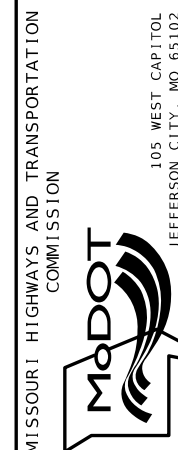

SIGN	SIZE	AREA	QTY	TOTAL	QTY	TOTAL	SIGN	DESCRIPTION
	IN.	SQ.FT.	EACH	SQ.FT.	EACH	SQ.FT.	NUM.	
WARNING SIGNS								
WO1-1L	48X48	16.00						TURN (SYMBOL LEFT)
WO1-1R	48X48	16.00						TURN (SYMBOL RIGHT)
WO1-2L	48X48	16.00						CURVE (SYMBOL LEFT)
WO1-2R	48X48	16.00						CURVE (SYMBOL RIGHT)
WO1-3L	48X48	16.00						REVERSE TURN (SYMBOL LEFT)
WO1-3R	48X48	16.00						REVERSE TURN (SYMBOL RIGHT)
WO1-4L	48X48	16.00	1	16				REVERSE CURVE (SYMBOL LEFT)
WO1-4R	48X48	16.00						REVERSE CURVE (SYMBOL RIGHT)
WO1-4bL	48X48	16.00						DOUBLE ARROW REVERSE CURVE (SYMBOL LEFT)
WO1-4bR	48X48	16.00						DOUBLE ARROW REVERSE CURVE (SYMBOL RIGHT)
WO1-4cL	48X48	16.00						TRIPLE ARROW REVERSE CURVE (SYMBOL LEFT)
WO1-4cR	48X48	16.00						TRIPLE ARROW REVERSE CURVE (SYMBOL RIGHT)
WO1-6	60X30	12.50						HORIZONTAL ARROW (SYMBOL)
WO1-6a	72X36	18.00						HORIZ. ARROW (SYMBOL ON PERMANENT BARRICADE)
WO1-7	60X30	12.50						DOUBLE HEAD HORIZONTAL ARROW (SYMBOL)
WO1-7a	72X36	18.00						DOUBLE HEAD HORIZ. ARROW (SYMBOL ON PERM. BARR.)
WO1-8	18X24	3.00						CHEVRON (SYMBOL)
WO1-8a	30X36	7.50						CHEVRON (SYMBOL FOR DIVIDED HIGHWAYS)
WO3-1	48X48	16.00						STOP AHEAD (SYMBOL)
WO3-2	48X48	16.00	2	32				YIELD AHEAD (SYMBOL)
WO3-3	48X48	16.00						SIGNAL AHEAD (SYMBOL)
WO3-4	48X48	16.00						BE PREPARED TO STOP
WO3-5	48X48	16.00						SPEED LIMIT AHEAD
WO4-1L	48X48	16.00	2	32				MERGE (SYMBOL FROM LEFT)
WO4-1R	48X48	16.00	2	32				MERGE (SYMBOL FROM RIGHT)
WO4-1aL	48X48	16.00	5	80				MERGE (LEFT)
WO4-1aR	48X48	16.00	2	32				MERGE (RIGHT)
WO5-1	48X48	16.00	3	48				ROAD/BRIDGE/RAMP NARROWS
WO5-3	48X48	16.00						ONE LANE BRIDGE
WO5-5	48X48	16.00						NARROW LANES
WO6-1	48X48	16.00						DIVIDED HIGHWAY (SYMBOL)
WO6-2	48X48	16.00						DIVIDED HIGHWAY END (SYMBOL)
WO6-3	48X48	16.00						TWO WAY TRAFFIC (SYMBOL)
WO7-3a	30X24	5.00						NEXT XX MILES (PLAQUE)
WO8-1	48X48	16.00						BUMP
WO8-2	48X48	16.00						DIP
WO8-3	48X48	16.00						PAVEMENT ENDS
WO8-4	48X48	16.00						SOFT SHOULDER
WO8-5	48X48	16.00						SLIPPERY WHEN WET (SYMBOL)
WO8-6	48X48	16.00						TRUCK CROSSING
WO8-6c	48X48	16.00						TRUCK ENTRANCE
WO8-7	36X36	9.00						LOOSE GRAVEL
WO8-7a	36X36	9.00						FRESH OIL / LOOSE GRAVEL
WO8-9	48X48	16.00						LOW SHOULDER
WO8-11	48X48	16.00						UNEVEN LANES
WO8-12	48X48	16.00						NO CENTER LINE
WO8-15	48X48	16.00						GROOVED PAVEMENT
WO8-15P	30X24	5.00						MOTORCYCLE (PLAQUE)
WO8-17L	48X48	16.00						SHOULDER DROP-OFF (SYMBOL LEFT)
WO8-17R	48X48	16.00						SHOULDER DROP-OFF (SYMBOL RIGHT)
WO8-17P	30X24	5.00						SHOULDER DROP-OFF (PLAQUE)
W10-1	42RND.	9.62						RAILROAD CROSSING
WO12-1	24X24	4.00	1	4				DOUBLE DOWN ARROW (SYMBOL)
WO12-2	48X48	16.00						LOW CLEARANCE (SYMBOL)
WO12-2x	24X18	3.00						LOW CLEARANCE (PLAQUE)
WO12-2a	84X24	14.00						OVERHEAD LOW CLEARANCE (FEET AND INCHES)
WO12-4	120X60	50.00						LOW CLEARANCE XX FT XX IN XX MILES AHEAD
WO12-5	120X60	50.00						WIDTH RESTRICTION XX FT XX IN XX MILES AHEAD
WO13-1	30X30	6.25						ADVISORY SPEED (PLAQUE) (35 MPH, 40 MPH, 2-45 MPH)
WO16-2	30X24	5.00						XXX FEET (PLAQUE)
WO16-3	30X24	5.00						X MILE (PLAQUE)
WO20-1	48X48	16.00	17	272				ROAD/BRIDGE/RAMP WORK AHEAD
WO20-2	48X48	16.00						DETOUR AHEAD
WO20-3	48X48	16.00						ROAD CLOSED AHEAD
WO20-4	48X48	16.00						ONE LANE ROAD AHEAD
WO20-5	48X48	16.00	9	144				RIGHT/CENTER/LEFT LANE CLOSED AHEAD
WO20-5a	48X48	16.00	2	32				2 RIGHT/CENTER/LEFT LANES CLOSED AHEAD
WO20-6a	48X48	16.00	7	112				RIGHT/CENTER/LEFT LANE CLOSED
WO20-7a	48X48	16.00						FLAGGER (SYMBOL)
WO21-2	36X36	9.00						FRESH OIL
WO21-5	48X48	16.00	2	32				SHOULDER WORK / SHOULDER WORK AHEAD
WO22-1	48X48	16.00						BLASTING ZONE AHEAD
WO22-2	42X36	10.50						TURN OFF 2-WAY RADIO AND PHONE
WO22-3	42X36	10.50						END BLASTING ZONE
GO22-1	21X15	2.19	2	4.38				WET PAINT (ARROW PIVOTS)

SIGN	SIZE	AREA	QTY	TOTAL	QTY	TOTAL	SIGN	DESCRIPTION
	IN.	SQ.FT.	EACH	SQ.FT.	EACH	SQ.FT.	NUM.	
GUIDE SIGNS								
E05-1	36X48	12.00	2	24				GORE EXIT
E05-2	48X36	12.00						EXIT OPEN
E05-2a	48X36	12.00						EXIT CLOSED
GO20-1	60X24	10.00						ROAD WORK NEXT 16 MILES
GO20-2	48X24	8.00						END ROAD WORK
GO20-4	36X18	4.50						PILOT CAR FOLLOW ME
GO20-4a	42X30	8.75						PILOT CAR IN USE WAIT & FOLLOW
GO20-4a	18X12	1.50						PILOT CAR IN USE WAIT & FOLLOW
GO20-5aP	36X24	6.00	8	48				WORK ZONE (PLAQUE)
MO4-8a	24X18	3.00						END DETOUR
MO4-9L	48X36	12.00						DETOUR (LEFT)
MO4-9R	48X36	12.00						DETOUR (RIGHT)
MO4-9P	48X12	4.00						STREET NAME (PLAQUE)
MO4-10L	48X18	6.00						DETOUR ARROW (LEFT)
MO4-10R	48X18	6.00						DETOUR ARROW (RIGHT)
REGULATORY SIGNS								
R1-1	48X48	13.25						STOP
R1-2	48TRI	6.93	2	13.86				YIELD
R1-2a	36X36	9.00						TO ONCOMING TRAFFIC (PLAQUE)
R1-3P	30X12	2.50						ALL WAY (PLAQUE)
R2-1	36X48	12.00	13	156				SPEED LIMIT 8-35 MPH, 5-45 MPH
R3-1	48X48	16.00						NO RIGHT TURN (SYMBOL)
R3-2	48X48	16.00						NO LEFT TURN (SYMBOL)
R3-3	36X36	9.00						NO TURNS
R3-4	48X48	16.00						NO U-TURN (SYMBOL)
R3-7L	30X30	6.25	2	12.5				LEFT LANE MUST TURN LEFT
R3-7R	30X30	6.25	2	12.5				RIGHT LANE MUST TURN RIGHT
R4-1	36X48	12.00						DO NOT PASS
R4-2	36X48	12.00						PASS WITH CARE
R4-7a	36X48	12.00						KEEP RIGHT (HORIZONTAL ARROW)
R4-8a	36X48	12.00						KEEP LEFT (HORIZONTAL ARROW)
R5-1	30X30	6.25						DO NOT ENTER
R5-1a	36X24	6.00						WRONG WAY
R6-1L	54X18	6.75						ONE WAY ARROW (LEFT)
R6-1R	54X18	6.75						ONE WAY ARROW (RIGHT)
R6-2L	24X30	5.00						ONE WAY (LEFT)
R6-2R	24X30	5.00						ONE WAY (RIGHT)
R9-9	24X12	2.00						SIDEWALK CLOSED
R9-11L	24X18	3.00						SIDEWALK CLOSED AHEAD, (ARROW LEFT) CROSS HERE
R9-11R	24X18	3.00						SIDEWALK CLOSED AHEAD, (ARROW RIGHT) CROSS HERE
R10-6	24X36	6.00						STOP HERE ON RED (45° ARROW)
R11-2	48X30	10.00	12	120				ROAD CLOSED
R11-3a	60X30	12.50						ROAD CLOSED XX MILES AHEAD
R11-4	60X30	12.50						LOCAL TRAFFIC ONLY
CONST-3A	60X48	20.00						ROAD CLOSED TO THRU TRAFFIC
CONST-3X	56X12	4.67						FINE SIGN
MISCELLANEOUS SIGNS								
CONST-5	48X36	12.00						POINT OF PRESENCE
CONST-5	96X48	32.00	2	64				POINT OF PRESENCE
CONST-8	48X36	12.00	2	24				WORK ZONE NO PHONE ZONE
CONSTRUCTION SIGNS								
616-10.05				TOTAL				
CONSTRUCTION SIGNS				1348				
RELOCATED SIGNS								
616-10.10				TOTAL				
RELOCATED SIGNS				0				

ITEM	TOTAL	DESCRIPTION
NUMBER	QTY	
6122008		IMPACT ATTENUATOR 40 MPH (SAND BARRELS)
6122009		IMPACT ATTENUATOR 45 MPH (SAND BARRELS)
6122010		IMPACT ATTENUATOR 50 MPH (SAND BARRELS)
6122012		IMPACT ATTENUATOR 55 MPH (SAND BARRELS)
6122014		IMPACT ATTENUATOR 60 MPH (SAND BARRELS)
6122017		IMPACT ATTENUATOR 65 MPH (SAND BARRELS)
6122019		IMPACT ATTENUATOR 70 MPH (SAND BARRELS)
6122020		REPLACEMENT SAND BARREL
6122030		IMPACT ATTENUATOR (RELOCATION)
6123001		TRUCK MOUNTED ATTENUATOR (TMA)
6161008		ADVANCED WARNING RAIL SYSTEM
6161012		BUOYS (BOATS KEEP OUT)
6161013		BUOYS (NO WAKE)
6161014		SPECIAL SIGN ASSEMBLY (BOATS KEEP OUT)
6161025	250	CHANNELIZER (TRIM LINE)
6161030	12	TYPE III MOVEABLE BARRICADE
6161033	70	DIRECTION INDICATOR BARRICADE
6161040	5	FLASHING ARROW PANEL
6161047		TYPE III OBJECT MARKER
6161055	70	SEQUENTIAL FLASHING WARNING LIGHT
6161070		TUBULAR MARKER
6161095		RADAR SPEED ADVISORY SYSTEM
6161096		CHANGEABLE MESSAGE SIGN, COMMISSION FURNISHED/RETAINED
6161098A	5	INTERFACE - CONTRACTOR FURNISHED/RETAINED
6161099		CHANGEABLE MESSAGE SIGN W/O COMM. INTERFACE - CONTRACTOR FURNISHED/RETAINED
6162000A		WORK ZONE TRAFFIC SIGNAL SYSTEM
6162002		TEMPORARY LONG-TERM RUMBLE STRIPS
6173600D		TEMPORARY TRAFFIC BARRIER CONTRACTOR FURNISHED/RETAINED
6173602B		TEMPORARY TRAFFIC BARRIER CONTRACTOR FURNISHED/COMMISSION RETAINED
6174000A		TEMP. TRAFFIC BARRIER HEIGHT TRANSITION
6175010A		RELOCATING TEMPORARY TRAFFIC BARRIER
6176000B		TEMPORARY TRAFFIC BARRIER COMMISSION FURNISHED/RETAINED
6177000B		TEMP. TRAFFIC BARRIER HEIGHT TRANSITION COMMISSION FURNISHED/RETAINED
6208064A		TEMPORARY RAISED PAVEMENT MARKER
9029400		TEMPORARY TRAFFIC SIGNALS
9029401		TEMPORARY TRAFFIC SIGNALS AND LIGHTING



DATE PREPARED
2/16/2026

ROUTE **9** STATE **MO**

DISTRICT **KC** SHEET NO. **3**

COUNTY
CLAY / JACKSON

JOB NO.
JKU0465

CONTRACT ID.

PROJECT NO.

BRIDGE NO.

DATE

DESCRIPTION

MISSOURI HIGHWAYS AND TRANSPORTATION COMMISSION

105 WEST CAPITOL
JEFFERSON CITY, MO 65102
1-888-ASK-MODOT (1-888-275-6636)

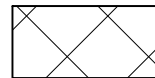

COLDMILL EXISTING UBAs
1" SP048FLP W/ PG76-22

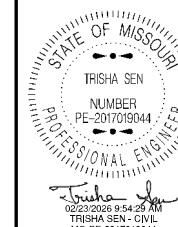
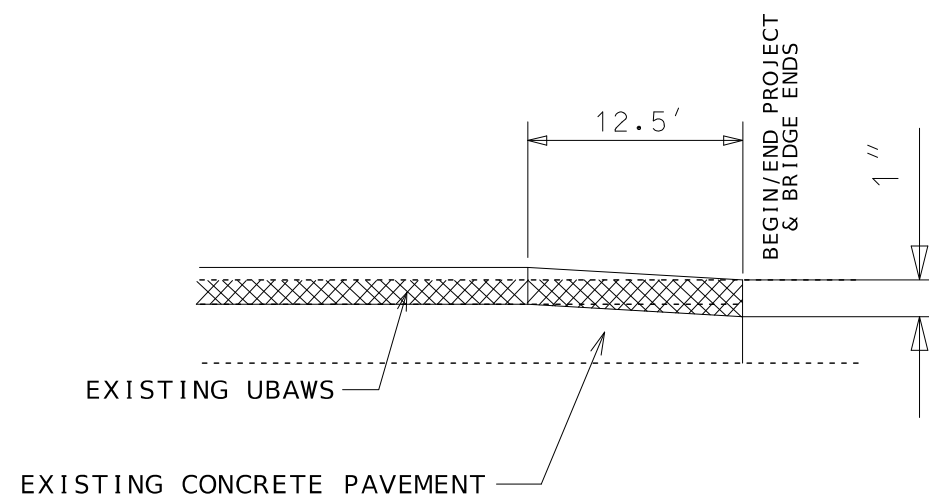
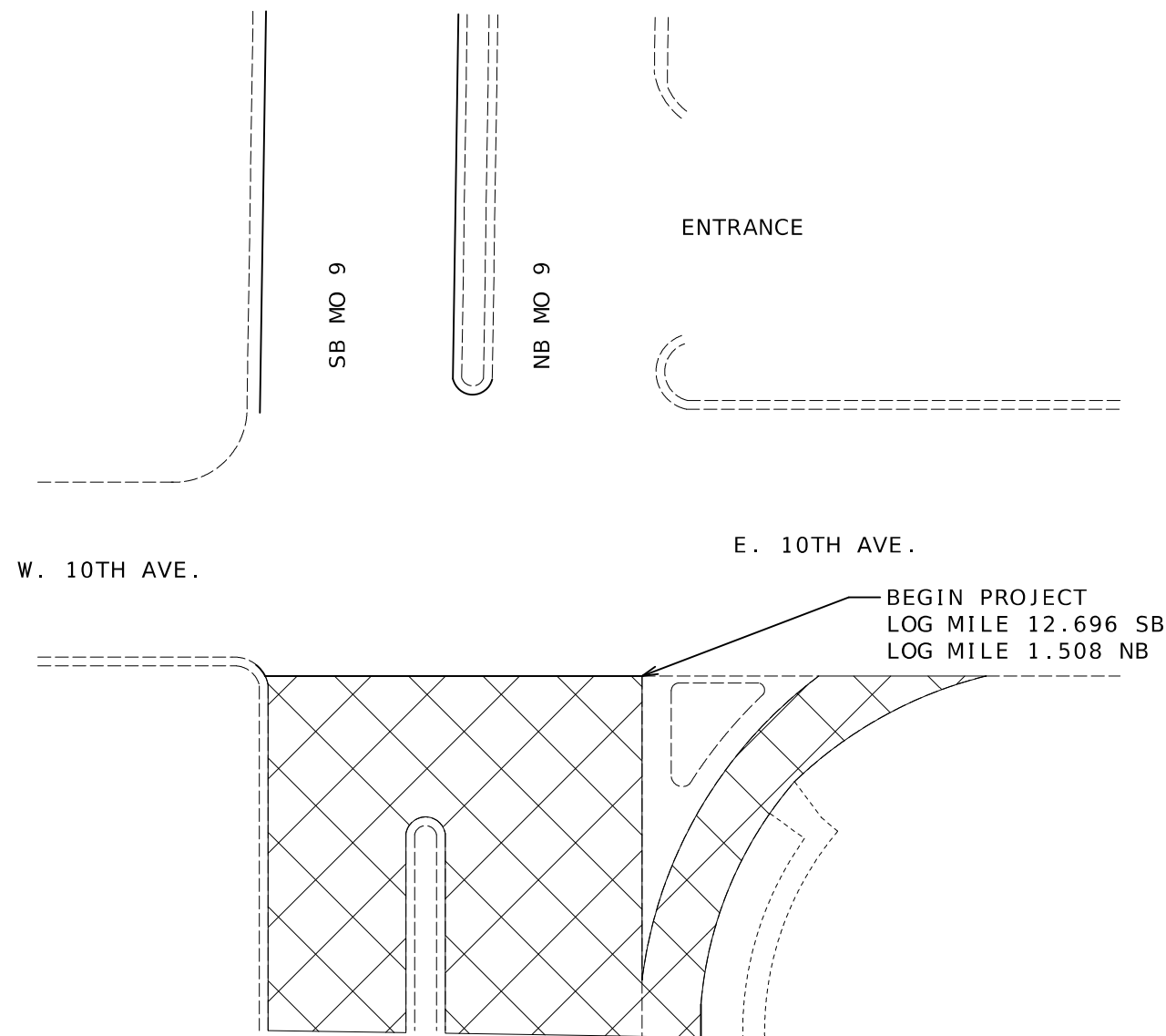

DATE PREPARED
2/23/2026

ROUTE 9 STATE MO

DISTRICT KC SHEET NO. 4

COUNTY CLAY / JACKSON

JOB NO. JKU0465

CONTRACT ID.

PROJECT NO.

BRIDGE NO.

DATE	DESCRIPTION

MISSOURI HIGHWAYS AND TRANSPORTATION COMMISSION

105 WEST CAPITOL
JEFFERSON CITY, MO 65102
1-888-ASK-MODOT (1-888-275-6636)

Sign Spacing, Device Spacing and Channelizing Taper Lengths

SIGN SPACING (S) FOR ADVANCE SIGN SERIES (1) (2)		
SPEED MPH	UNDIVIDED HIGHWAYS	DIVIDED HIGHWAYS
0-35	200	200
40-45	350	500
50-55	500	1000
60-70	1000	SA-1000 SB-1500 SC-2640

LONGITUDINAL BUFFER SPACE (B)	
SPEED MPH	BUFFER SPACE
0-35	250
40-45	360
50-55	495
60-70	730

TAPER LENGTHS AND SPACING OF CHANNELIZING DEVICES					
SPEED MPH	MINIMUM TAPER LENGTHS (L) FOR LANE WIDTHS (W)			MAXIMUM CHANNELIZER SPACING	
	10 FT	11 FT	12 FT	THROUGH TAPER	THROUGH WORK AREA
0-35	205	225	245	35	40
40-45	450	495	540	40	80
50-55	550	605	660	50	80
60-70	700	770	840	60	120

TAPER LENGTH (L):
 L = WS FOR 40 MPH OR MORE
 $L = \frac{WS^2}{60}$ FOR 35 MPH OR LESS
 FOR SHOULDER TAPER USE L/3

WHERE:
 L = TAPER LENGTH IN FEET
 W = LATERAL SHIFT IN FEET
 S = POSTED SPEED IN MPH

NOTES:

- DIMENSIONS IN FEET UNLESS OTHERWISE NOTED.
- (1) SPACING BETWEEN SIGNS AND SPACING BETWEEN LAST SIGN AND FLAGGER, BEGINNING OF TAPER, OR SIGNED CONDITION
 - (2) SPACINGS MAY BE ADJUSTED AS NECESSARY TO MEET FIELD CONDITIONS

TRAFFIC CONTROL DEVICES

GENERAL NOTES:

1. SEE STANDARD PLAN 616.10 FOR DETAILS AND ITEMS NOT SHOWN
2. EXISTING SIGNS SHALL BE COVERED DURING WORKING HOURS ONLY IF IN CONFLICT WITH TRAFFIC CONTROL PLANS.
3. NO DIRECT PAYMENT WILL BE MADE FOR RELOCATING, COVERING, UNCOVERING OR REMOVING SIGNS.
4. CONES ALLOWABLE FOR DAYTIME OPERATIONS ONLY.
6. LOCATE FLASHING ARROW PANEL AT BEGINNING OF TAPER WHEN FEASIBLE, ARROW PANELS ARE ALWAYS LOCATED BEHIND CHANNELIZERS OR CONES.

TRAFFIC CONTROL LEGEND

- SIGN (SINGLE SIDED)
- ◫ SIGN (DOUBLE SIDED)
- ◁ FLAGGER
- ▲ DIRECTION INDICATOR BARRICADE
- CHANNELIZER
- ⌌ BARRICADE
- ▮ CHANGEABLE MESSAGE BOARD
- ◻ FLASHING ARROW PANEL
- ⊞ TMA (TRUCK MOUNTED ATTENUATOR) WITH FLASHING ARROW PANEL

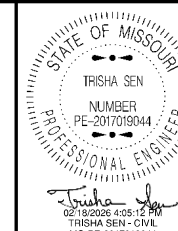

DATE PREPARED
2/16/2026

ROUTE 9 STATE MO

DISTRICT KC SHEET NO. 5

COUNTY CLAY/JACKSON

JOB NO. JKU0465

CONTRACT ID.

PROJECT NO.

BRIDGE NO.

DESCRIPTION	DATE

MISSOURI HIGHWAYS AND TRANSPORTATION COMMISSION

105 WEST CAPITOL
JEFFERSON CITY, MO 65102
1-888-ASK-MODOT (1-888-275-6636)

END OF PROJECT LIMITS; END OF WORK ZONE TERMINATION AREA, IF LOCATED BEYOND END OF PROJECT; OR LAST WORK ZONE SIGN, IF LOCATED OUTSIDE PROJECT LIMITS.

BEGINNING OF PROJECT LIMITS; OR INITIAL WORK ZONE SIGN, IF LOCATED OUTSIDE PROJECT LIMITS.

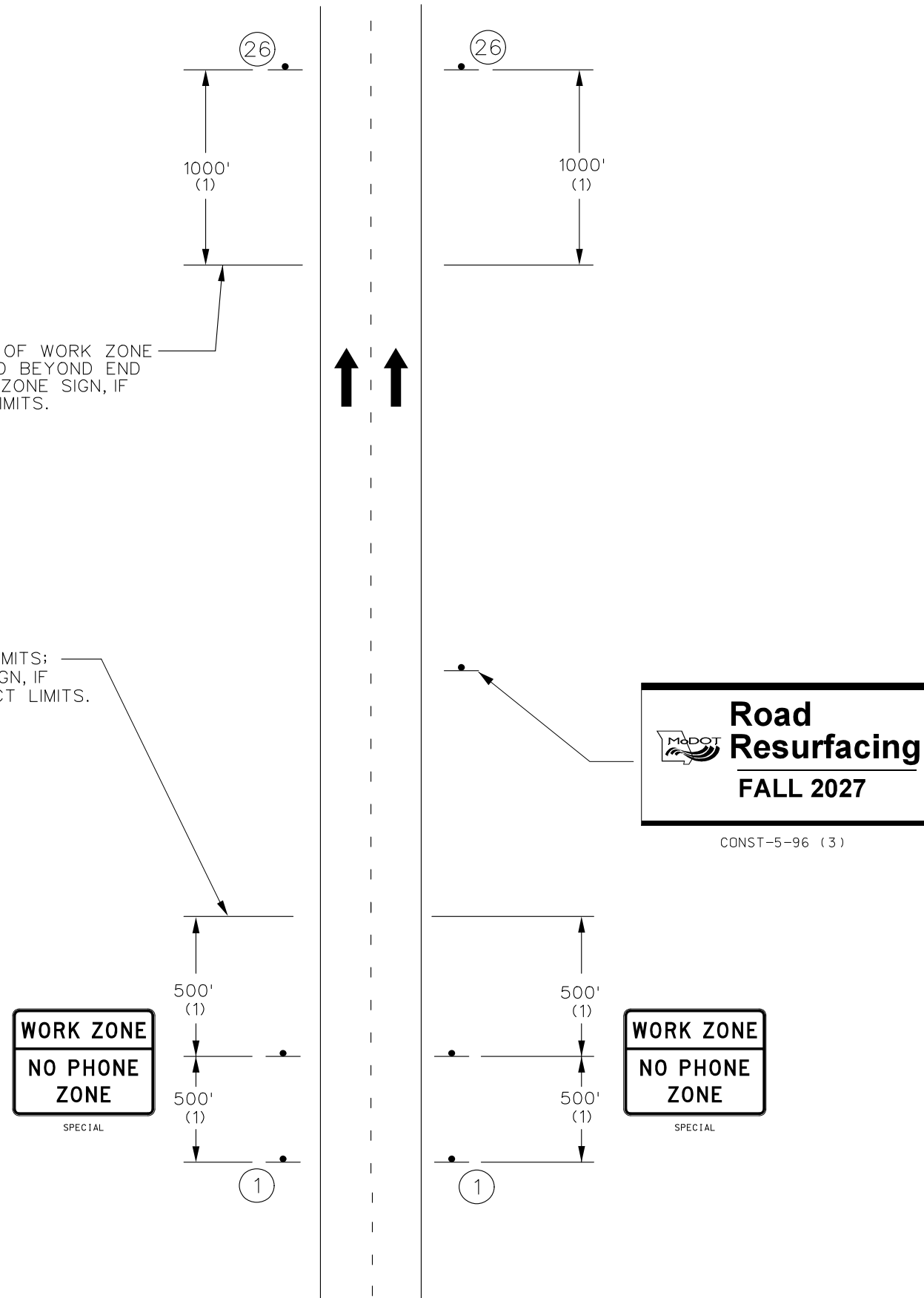

MULTI-LANE DIVIDED
BEGIN/END OF PROJECT SIGNING
(FOR USE ON ALL PROJECTS)

NOTES:

SIGN G020-1 IS REQUIRED PER EPG 616.6.56.

SIGN G020-2 IS USED ON ALL PROJECTS WHERE SIGN G020-1 IS USED.

OTHER SIGNS SUCH AS DETOUR OR ALTERNATE ROUTE SIGNING MAY BE USED OUTSIDE THE PROJECT LIMITS.

ANY EXISTING SIGNING THAT CONFLICTS WITH THE TRAFFIC CONTROL SIGNING SHALL BE COMPLETELY COVERED OR REMOVED.

(1) DISTANCE MAY BE ADJUSTED ACCORDING TO FIELD CONDITIONS. WHERE TRAFFIC BACKUPS ARE EXPECTED BEYOND THE ADVANCE WARNING AREA, ADDITIONAL SIGNING MAY BE NEEDED.

(2) SIGN CONST-7-48 OR CONST-7-72 IS PLACED 500 FEET BEFORE THE BEGINNING OF PROJECT LIMITS OR THE ROAD WORK AHEAD SIGN OR ROAD WORK NEXT XX MILES SIGN, IF USED, WHEN THESE SIGNS ARE LOCATED OUTSIDE THE PROJECT LIMITS.

(3) SIGN CONST-5-96 OR CONST-5-48 IS PLACED IN A VISIBLE AREA WITHIN THE PROJECT LIMITS PROVIDED ITS PLACEMENT DOES NOT DISRUPT A SEQUENCE OF SIGNS. IF A VISIBLE LOCATION WITHIN THE PROJECT IS NOT AVAILABLE, THE SIGN MAY BE PLACED 500 FEET BEFORE SIGN CONST-7-48 OR CONST-7-72.

(4) THE "RATE OUR WORK ZONE" SIGN IS AVAILABLE IN TWO SIZES DEPENDING ON ROADWAY CONDITIONS. THE 48 IN. X 24 IN. SIGN IS USED ON LOW VOLUME ROUTES THAT CARRY 400 AADT OR LESS, ON PROJECTS THAT HAVE A DURATION OF 4 WEEKS OR LESS OR IN URBAN AREAS WHERE THERE IS INSUFFICIENT RIGHT OF WAY FOR A SIX FOOT WIDE SIGN. THE 72 IN. X 36 IN. VERSION OF THE SIGN IS USED IN ALL OTHER APPLICATIONS. BUT CAN ALSO BE USED IN PLACE OF THE 48 IN. X 24 IN. SIGN IF ADDED EMPHASIS IS DEEMED NECESSARY.

(5) THE "POINT OF PRESENCE" SIGN IS AVAILABLE IN TWO SIZES DEPENDING ON ROADWAY CONDITION. THE 48 IN. X 36 IN. SIGN IS USED ON LOW VOLUME ROUTES THAT CARRY 400 AADT OR LESS, ON PROJECTS THAT HAVE A DURATION OF 4 WEEKS OR LESS OR IN URBAN AREAS WHERE THERE IS INSUFFICIENT RIGHT OF WAY FOR AN EIGHT FOOT WIDE SIGN. THE 96 IN. X 48 IN. VERSION OF THE SIGN IS USED IN ALL OTHER APPLICATIONS. BUT CAN ALSO BE USED IN PLACE OF THE 48 IN. X 36 IN. SIGN IF ADDED EMPHASIS IS DEEMED NECESSARY.

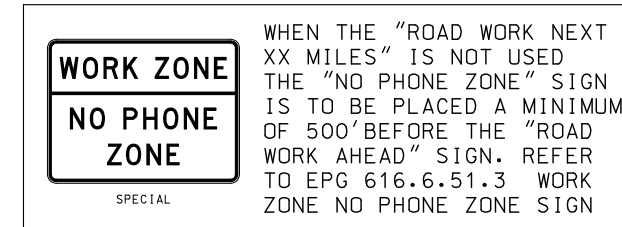

G020-1

(1)

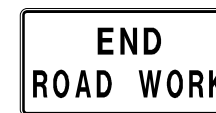

G020-2

(26)

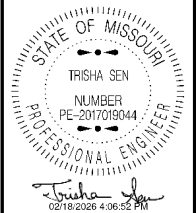

DATE PREPARED
2/16/2026

ROUTE 9	STATE MO
DISTRICT KC	SHEET NO. 6
COUNTY CLAY / JACKSON	
JOB NO. JKU0465	
CONTRACT ID.	
PROJECT NO.	
BRIDGE NO.	

DATE	DESCRIPTION

MISSOURI HIGHWAYS AND TRANSPORTATION COMMISSION

105 WEST CAPITOL
JEFFERSON CITY, MO 65102
1-888-ASK-MODOT (1-888-275-6636)

NOT TO SCALE

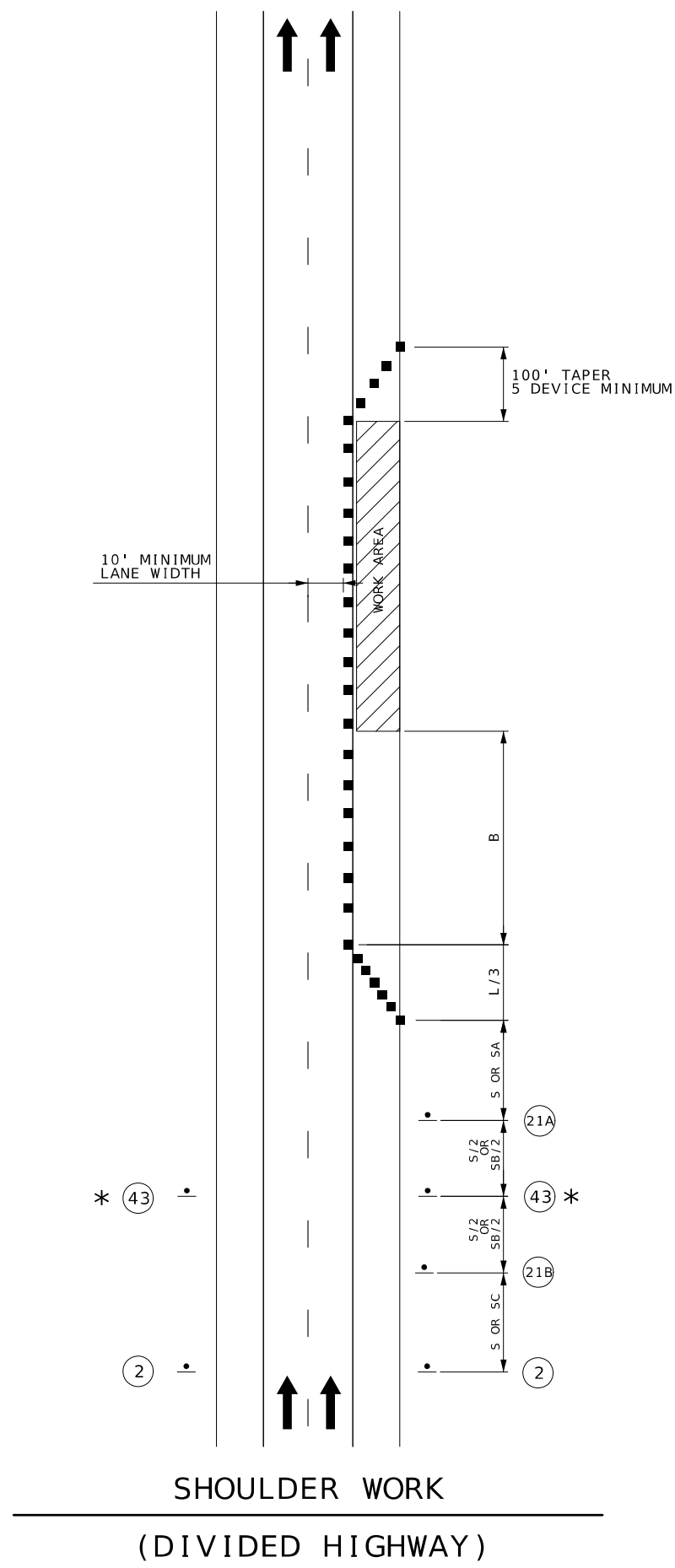

BRIDGE
OR
RAMP



BRIDGE
OR
RAMP



(PLAQUE NOT USED IF LESS THAN ONE MILE.)

43 * OMIT SIGN 43 FOR NO TRAVELWAY ENCROACHMENT.

STATE OF MISSOURI
TRISHA SEN
NUMBER
PE-2017019044
PROFESSIONAL ENGINEER
Trisha Sen
02/18/2026 4:08:02 PM
TRISHA SEN - CIVIL
MO-PE-2017019044

DATE PREPARED
2/16/2026

ROUTE 9	STATE MO
DISTRICT KC	SHEET NO. 7
COUNTY CLAY / JACKSON	
JOB NO. JKU0465	
CONTRACT ID.	
PROJECT NO.	
BRIDGE NO.	

DESCRIPTION	DATE

MISSOURI HIGHWAYS AND TRANSPORTATION COMMISSION

105 WEST CAPITOL
JEFFERSON CITY, MO 65102
1-888-ASK-MODOT (1-888-275-6636)

NOT TO SCALE

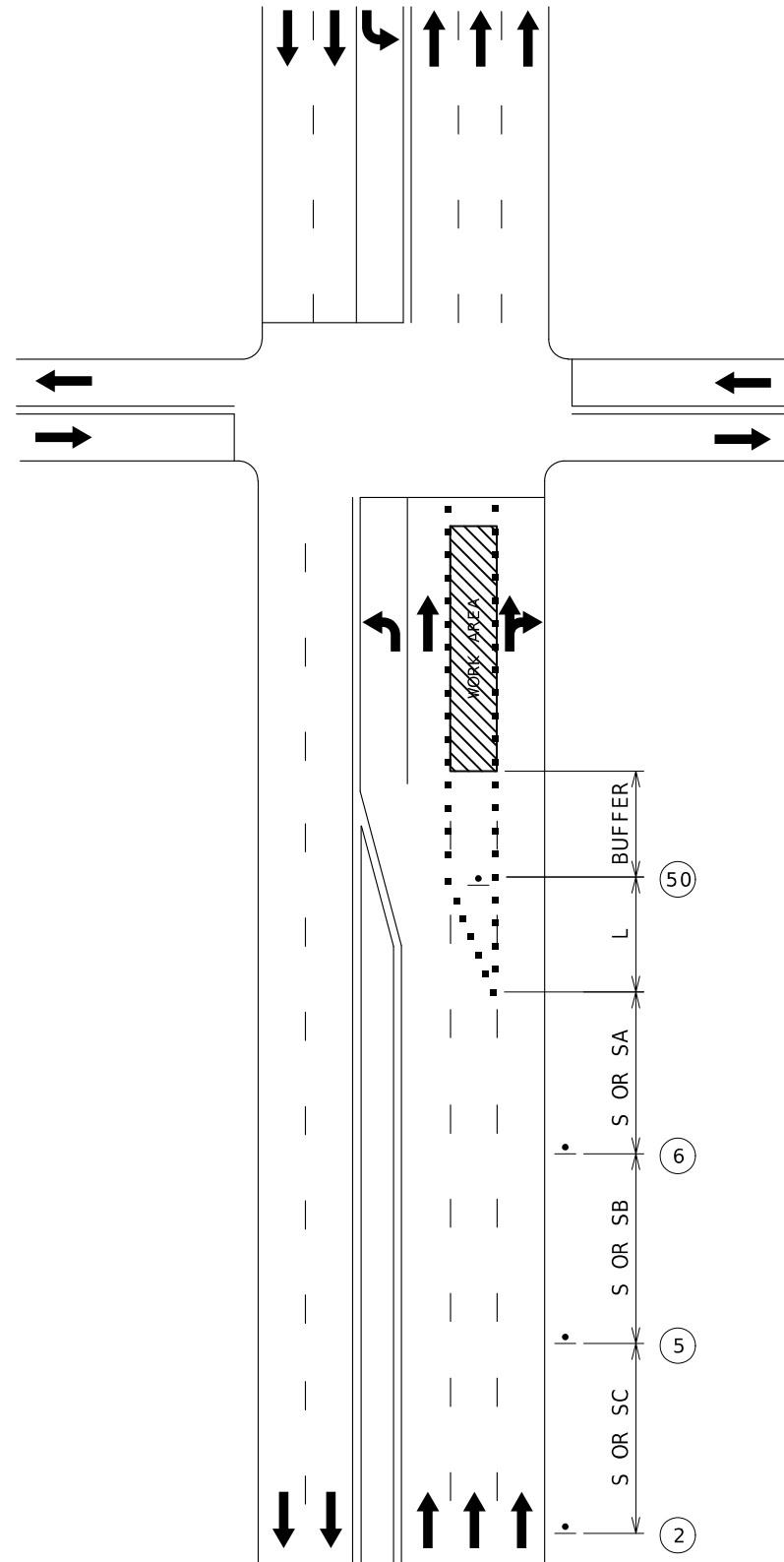

LANE CLOSURE ON NEAR SIDE OF INTERSECTION



WO20-1
2



WO20-5
5

CENTER
OR
LEFT



WO20-6a
6

CENTER
OR
LEFT

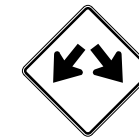

WO12-1
50

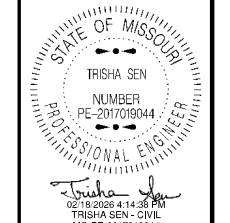

DATE PREPARED 2/16/2026	
ROUTE 9	STATE MO
DISTRICT KC	SHEET NO. 9
COUNTY CLAY / JACKSON	
JOB NO. JKU0465	
CONTRACT ID.	
PROJECT NO.	
BRIDGE NO.	

DATE	DESCRIPTION

MISSOURI HIGHWAYS AND TRANSPORTATION COMMISSION

105 WEST CAPITOL
JEFFERSON CITY, MO 65102
1-888-ASK-MODOT (1-888-275-6636)

NOT TO SCALE

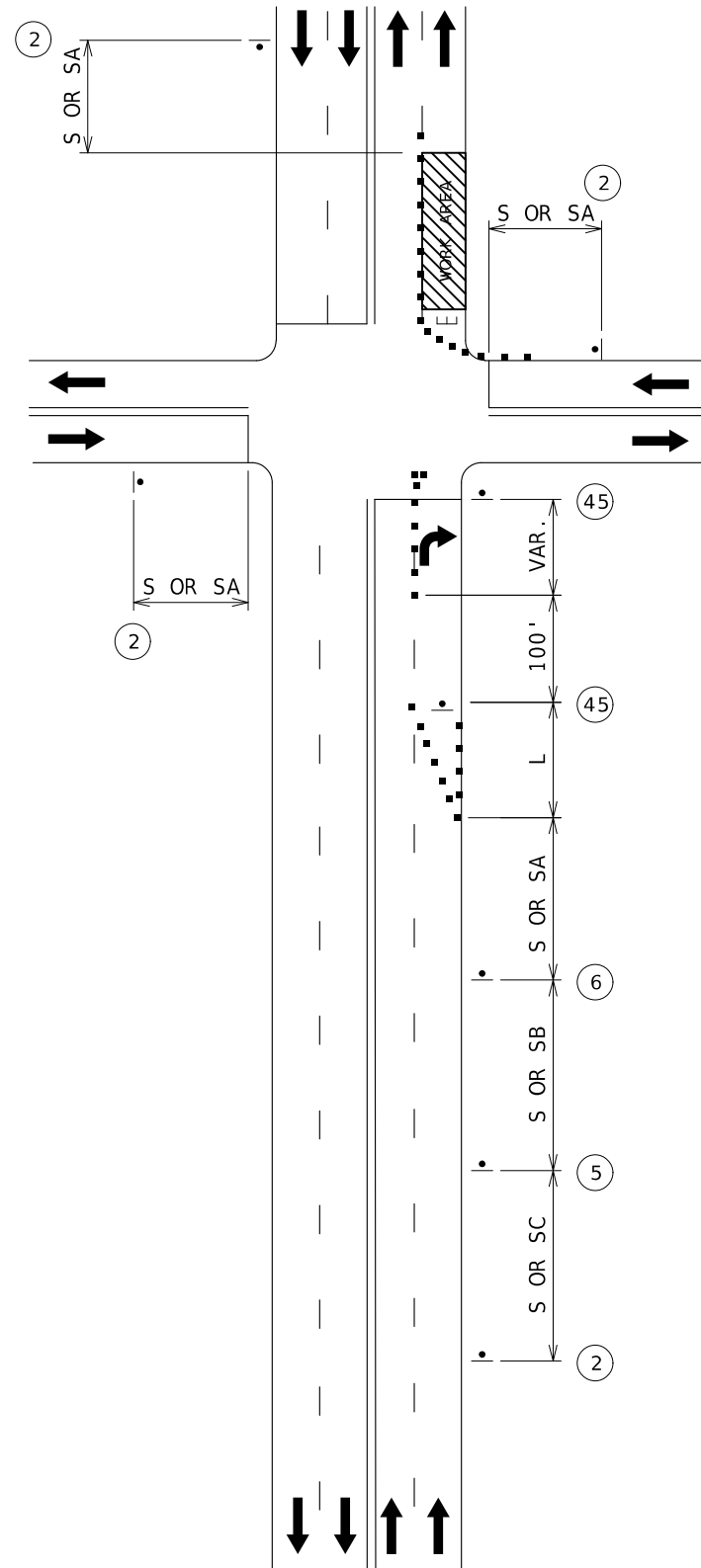

RIGHT LANE CLOSURE ON FAR SIDE OF INTERSECTION



WO20-1

2



WO20-5

5

CENTER
OR
LEFT



WO20-6a

6

CENTER
OR
LEFT



R3-7R

45

DESCRIPTION

DATE

MISSOURI HIGHWAYS AND TRANSPORTATION COMMISSION



105 WEST CAPITOL
JEFFERSON CITY, MO 65102
1-888-ASK-MODOT (1-888-275-6636)

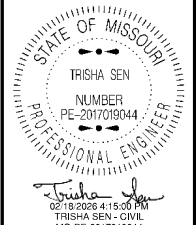

DATE PREPARED

2/16/2026

ROUTE 9 STATE MO

DISTRICT KC SHEET NO. 10

COUNTY CLAY / JACKSON

JOB NO. JKU0465

CONTRACT ID.

PROJECT NO.

BRIDGE NO.

TEMPORARY TRAFFIC CONTROL

SHEET 6 OF 14

NOT TO SCALE

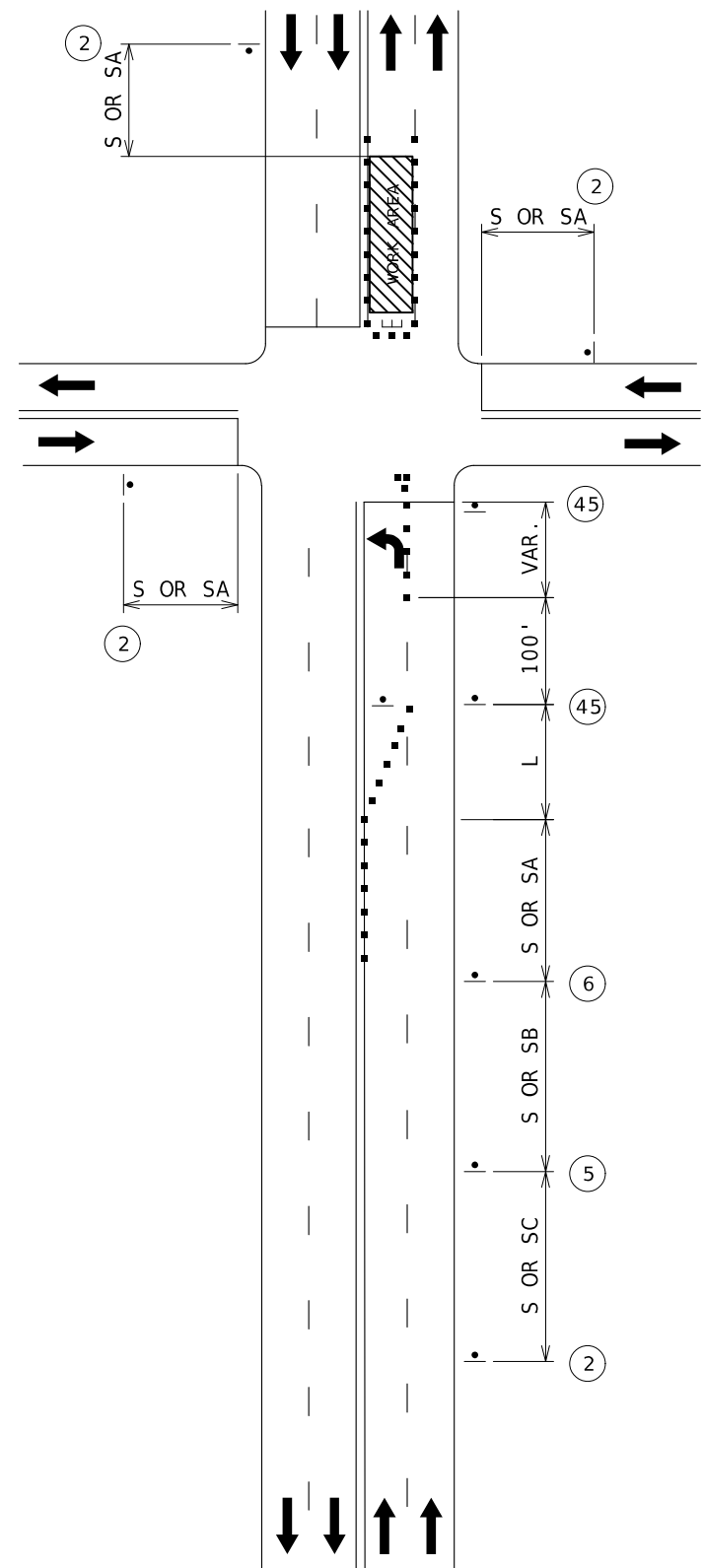

LEFT LANE CLOSURE ON FAR SIDE OF INTERSECTION



WO20-1

2



WO20-5

5

CENTER
OR
LEFT



WO20-6a

6

CENTER
OR
LEFT

LEFT LANE
MUST
TURN LEFT

R3-7L

45

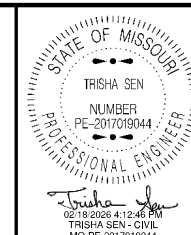

DATE PREPARED

2/16/2026

ROUTE STATE

9 MO

DISTRICT SHEET NO.

KC 11

COUNTY

CLAY / JACKSON

JOB NO.

JKU0465

CONTRACT ID.

PROJECT NO.

BRIDGE NO.

DESCRIPTION

DATE

MISSOURI HIGHWAYS AND TRANSPORTATION COMMISSION

105 WEST CAPITOL JEFFERSON CITY, MO 65102

1-888-ASK-MODOT (1-888-273-6636)



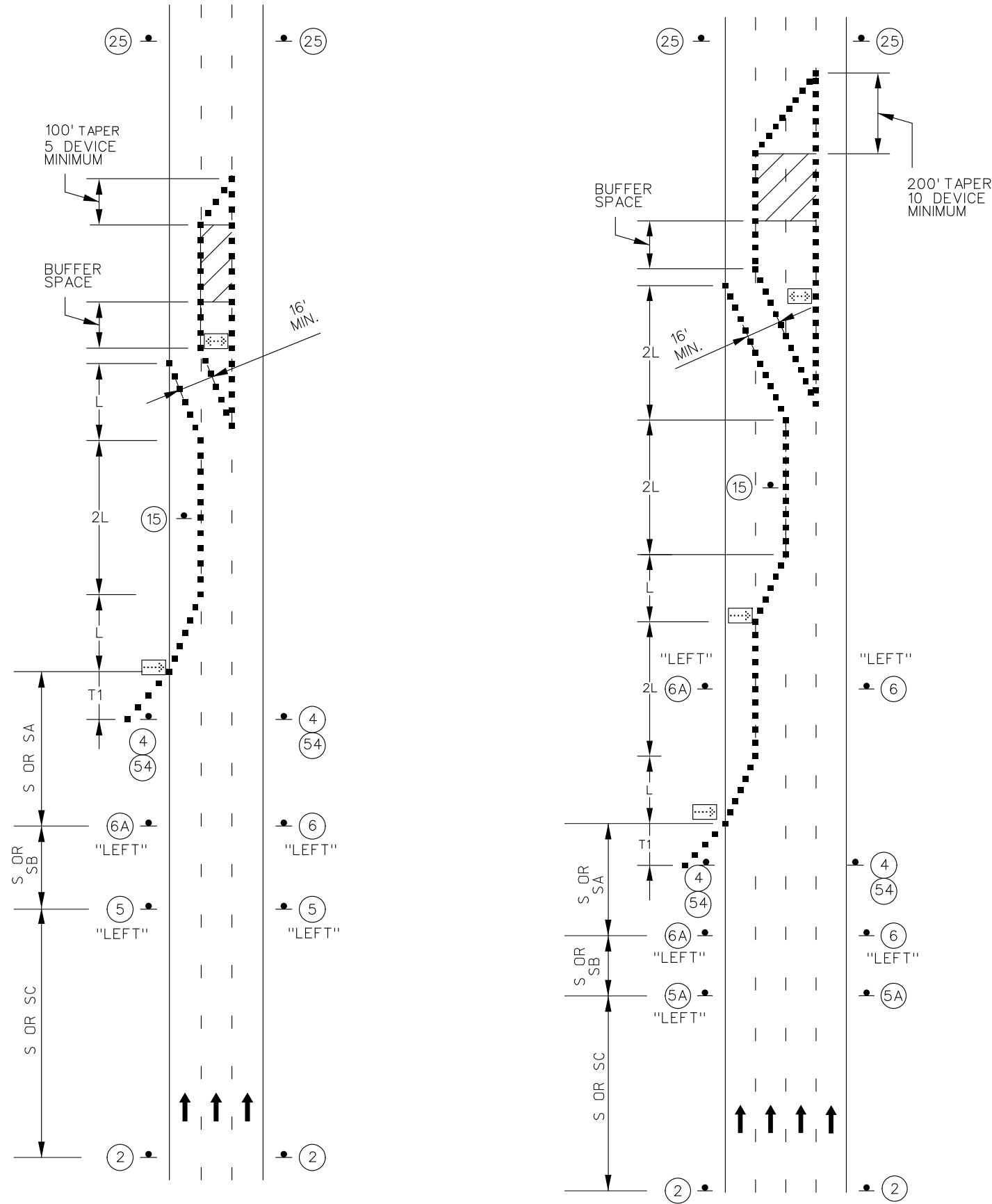

INTERIOR LANE CLOSURES OF MULTI-LANE DIVIDED HIGHWAY

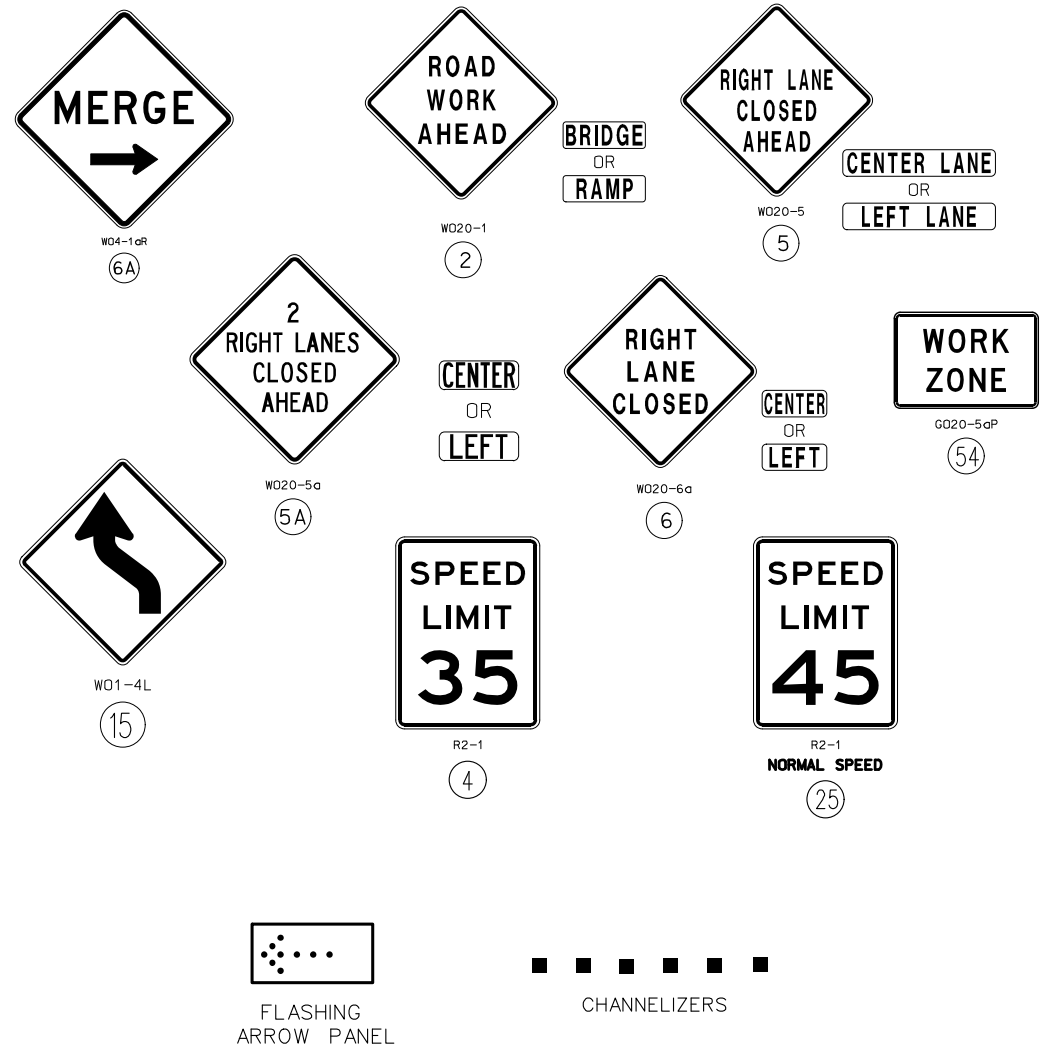

NOTES:

- (1). SEE TRAFFIC CONTROL SHEET 1 FOR WORK ZONE SPEED LIMIT GUIDELINES.
- (2). SEE TRAFFIC CONTROL SHEET 1 FOR SIGN SPACING, DEVICE SPACING AND CHANNELIZING TAPER LENGTHS.
- (3). REMOVE AND/OR MODIFY EXISTING PAVEMENT MARKING AS NEEDED.
- (4). TEMPORARY PAVEMENT MARKING REQUIRED WITH LONG TERM LANE CLOSURES.
- (5). ALTERNATIVE TEMPORARY TRAFFIC CONTROL SET-UPS SHOULD BE CONSIDERED WHEN REDUCTION IN CAPACITY CANNOT BE TOLERATED.
- (6). FOR NIGHTTIME OPERATIONS, REVIEW EPG 616.6.83 WARNING LIGHT FOR USE OF SEQUENTIAL LIGHTS.

INTERIOR LANE
CLOSURE ON FREEWAY
TEMPORARY
TRAFFIC CONTROL
SHEET 8 OF 14

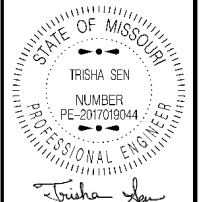

DATE PREPARED
2/16/2026
ROUTE 9 STATE MO
DISTRICT KC SHEET NO. 12
COUNTY CLAY / JACKSON
JOB NO. JKU0465
CONTRACT ID.
PROJECT NO.
BRIDGE NO.

DATE	DESCRIPTION

MISSOURI HIGHWAYS AND TRANSPORTATION COMMISSION

105 WEST CAPITOL
JEFFERSON CITY, MO 65102
1-888-ASK-MODOT (1-888-275-6636)

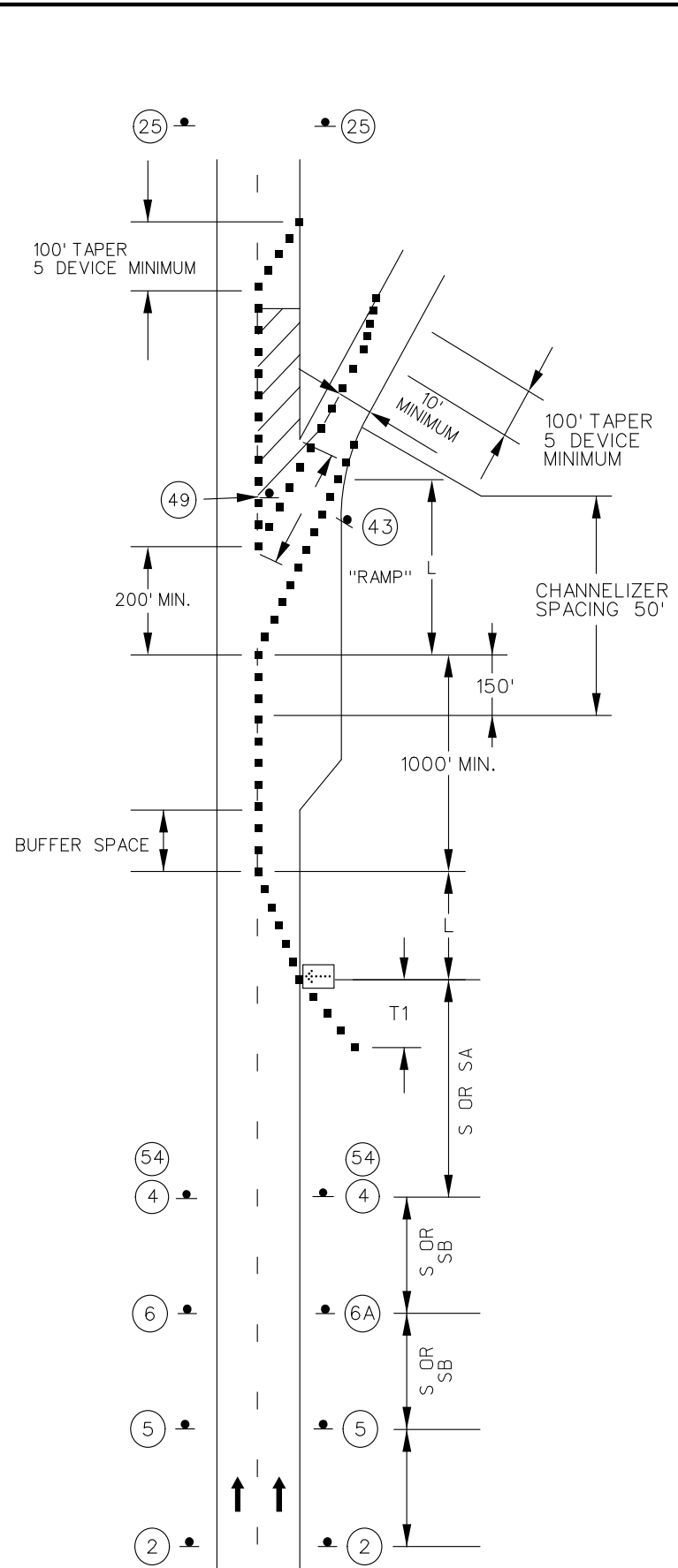
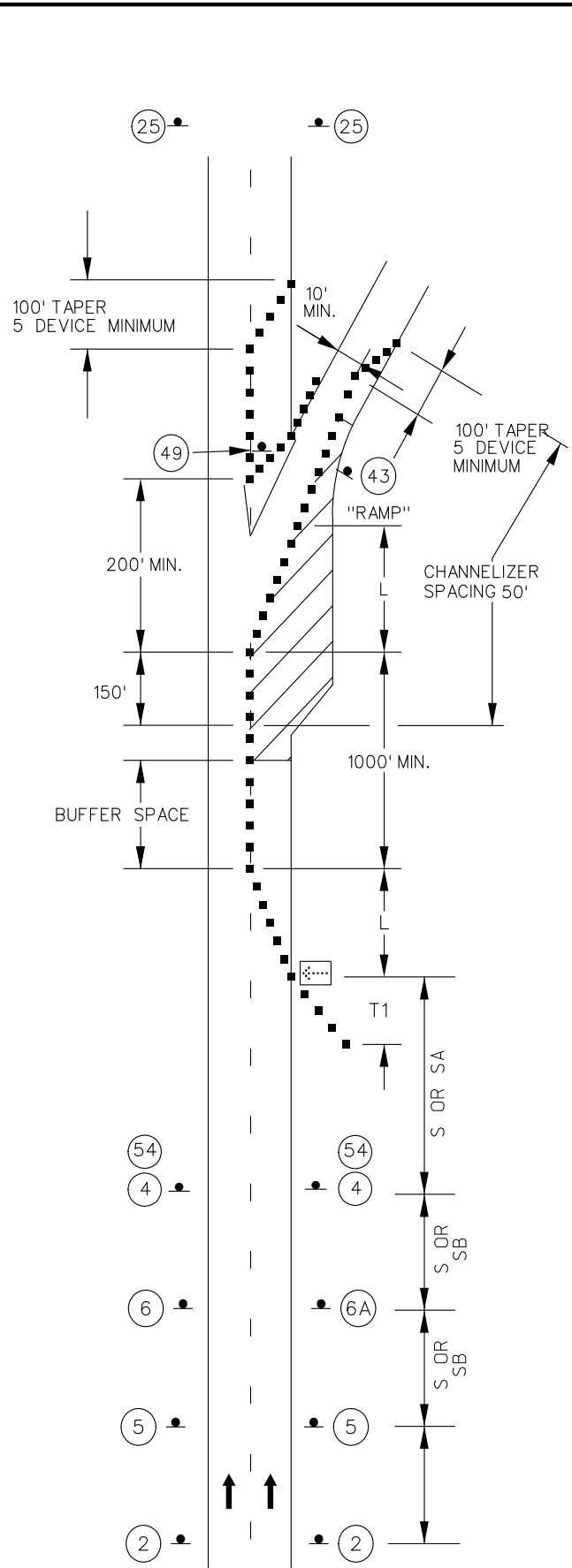

CENTER OR LEFT



BRIDGE OR RAMP



CENTER LANE OR LEFT LANE

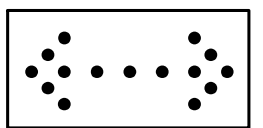

FLASHING ARROW PANEL



CHANNELIZERS



BRIDGE OR RAMP



- NOTES:
- SEE TRAFFIC CONTROL SHEET 1 FOR WORK ZONE SPEED LIMIT GUIDELINES.
 - SEE TRAFFIC CONTROL SHEET 1 FOR SIGN SPACING, DEVICE SPACING AND CHANNELIZING TAPER LENGTHS.
 - REMOVE AND/OR MODIFY EXISTING PAVEMENT MARKING AS NEEDED.
 - TEMPORARY PAVEMENT MARKING REQUIRED WITH LONG TERM LANE CLOSURES.
 - IF RUMBLE STRIPS ARE USED, REVIEW EPG 616.6.87 RUMBLE STRIPS.
 - FOR NIGHT TIME OPERATIONS, REVIEW EPG 616.6.83 WARNING LIGHTS FOR USE OF SEQUENTIAL LIGHTS.
 - REVIEW EPG 616.6.63 CHANNELIZING DEVICES FOR DIFFERENT TYPES AND GUIDELINES FOR THE DEVICE.
 - (1). SIGN 43 REQUIRED WHEN RAMP WIDTH IS REDUCED.
 - (2). FIVE CHANNELIZER DEVICE MINIMUM.



DATE PREPARED
2/16/2026

ROUTE 9 STATE MO
DISTRICT KC SHEET NO. 13
COUNTY CLAY / JACKSON
JOB NO. JKU0465
CONTRACT ID.

DATE	DESCRIPTION

MISSOURI HIGHWAYS AND TRANSPORTATION COMMISSION

105 WEST CAPITOL
JEFFERSON CITY, MO 65102
1-888-ASK-MODOT (1-888-275-6636)



TRISHA SEN
 NUMBER
 PE-2017019044
 PROFESSIONAL ENGINEER

DATE PREPARED
 2/16/2026

ROUTE 9 STATE MO

DISTRICT KC SHEET NO. 14

COUNTY CLAY / JACKSON

JOB NO. JKU0465

CONTRACT ID.

PROJECT NO.

BRIDGE NO.

BRIDGE NO.

BRIDGE NO.

BRIDGE NO.

BRIDGE NO.

BRIDGE NO.

BRIDGE NO.

BRIDGE NO.

BRIDGE NO.

BRIDGE NO.

BRIDGE NO.

BRIDGE NO.

BRIDGE NO.

BRIDGE NO.

BRIDGE NO.

BRIDGE NO.

BRIDGE NO.

BRIDGE NO.

BRIDGE NO.

BRIDGE NO.

BRIDGE NO.

BRIDGE NO.

BRIDGE NO.

BRIDGE NO.

BRIDGE NO.

BRIDGE NO.

BRIDGE NO.

BRIDGE NO.

BRIDGE NO.

BRIDGE NO.

BRIDGE NO.

BRIDGE NO.

BRIDGE NO.

BRIDGE NO.

BRIDGE NO.

BRIDGE NO.

BRIDGE NO.

BRIDGE NO.

BRIDGE NO.

BRIDGE NO.

BRIDGE NO.

BRIDGE NO.

BRIDGE NO.

BRIDGE NO.

BRIDGE NO.

BRIDGE NO.

BRIDGE NO.

BRIDGE NO.

BRIDGE NO.

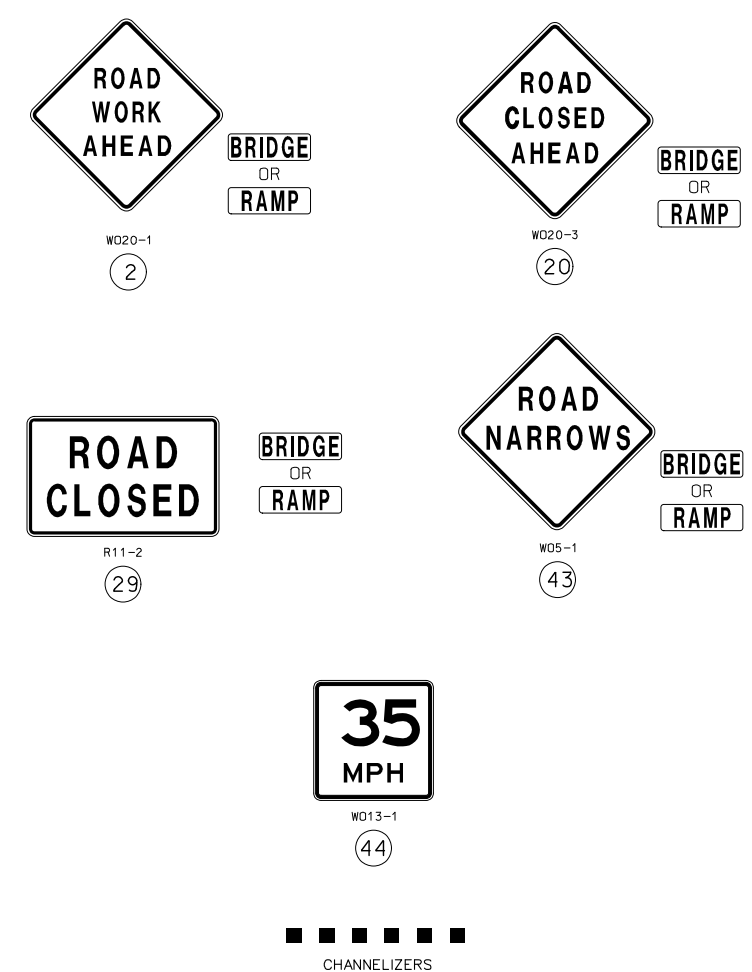
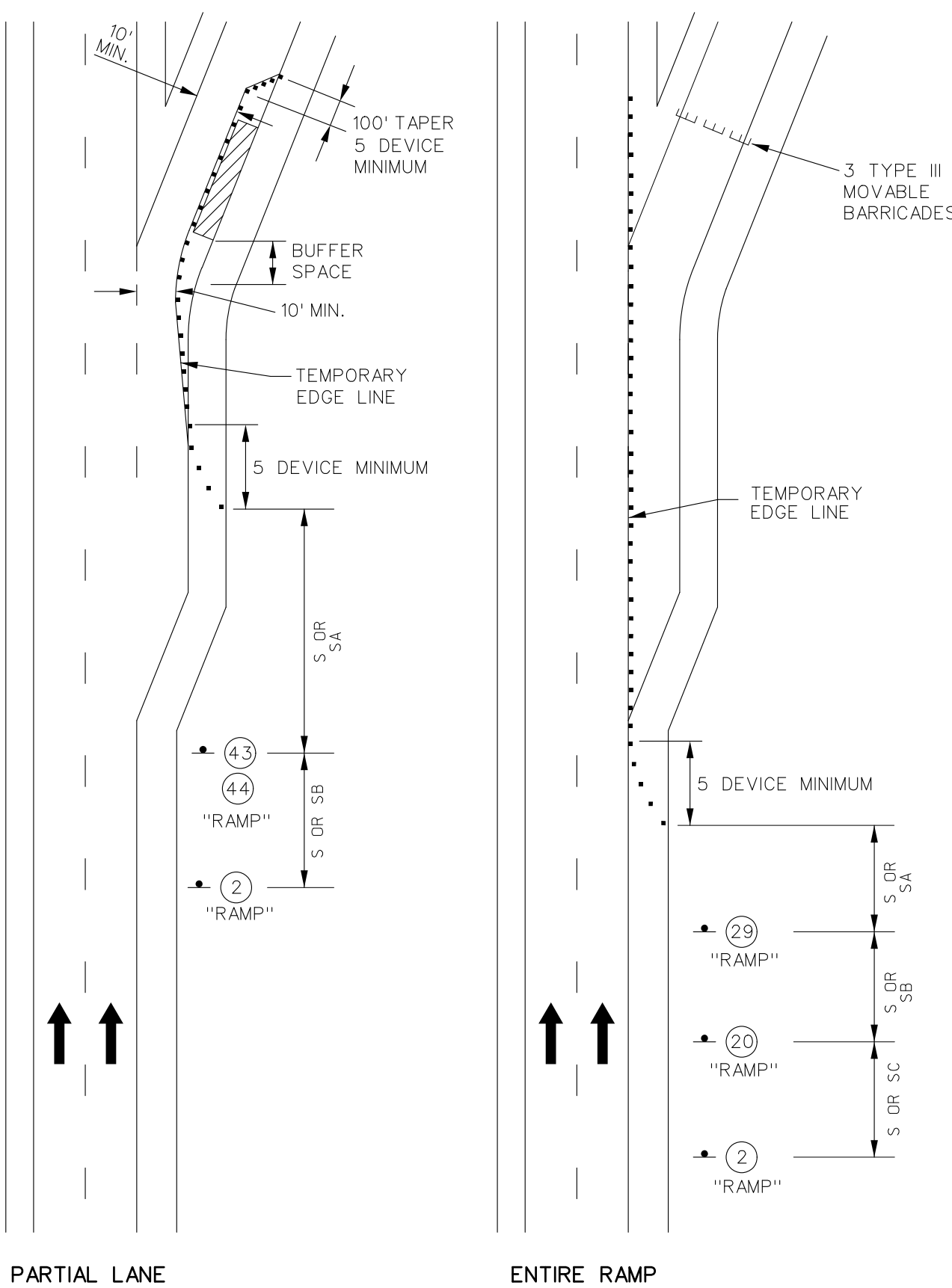

NOTES:

- SEE TRAFFIC CONTROL SHEET 1 FOR WORK ZONE SPEED LIMIT GUIDELINES.
- SEE TRAFFIC CONTROL SHEET 1 FOR SIGN SPACING, DEVICE SPACING AND CHANNELIZING TAPER LENGTHS.
- TEMPORARY PAVEMENT MARKING OPTIONAL FOR SHORT TERM OPERATIONS.
- IF RUMBLE STRIPS ARE USED, REVIEW EPG 616.6.87 RUMBLE STRIPS.
- REVIEW EPG 616.6.63 CHANNELIZING DEVICES FOR DIFFERENT TYPES AND GUIDELINES FOR THE DEVICE.

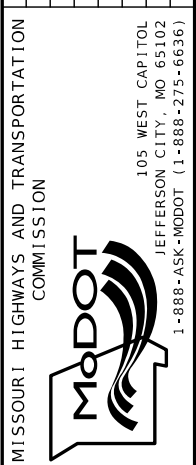

NOT TO SCALE

NOTES:

UPON APPROVAL OF THE ENGINEER, THE CONTRACTOR MAY PROVIDE ADDITIONAL PROTECTIVE TRUCKS EQUIPPED WITH PROPER WARNING DEVICES.

PROTECTIVE TRUCKS AND WORK VEHICLES SHALL DISPLAY HIGH-INTENSITY ROTATING, FLASHING, OSCILLATING, OR STROBE LIGHTS.

VEHICLE HAZARD WARNING SIGNALS SHALL NOT BE USED INSTEAD OF THE VEHICLE'S HIGH-INTENSITY ROTATING, FLASHING, OSCILLATING, OR STROBE LIGHTS.

VEHICLE-MOUNTED SIGNS SHALL BE MOUNTED IN A MANNER SUCH THAT THEY ARE NOT OBSCURED BY EQUIPMENT OR SUPPLIES. SIGN LEGENDS ON VEHICLE-MOUNTED SIGNS SHALL BE COVERED OR TURNED FROM VIEW WHEN WORK IS NOT IN PROGRESS.

FLASHING ARROW PANELS SHALL BE INCIDENTAL TO TRUCK MOUNTED ATTENUATORS, WHEREVER USED. NO ADDITIONAL PAYMENT WILL BE MADE.

FLASHING ARROW PANELS SHALL, AS A MINIMUM, BE TYPE B, WITH A SIZE OF 60 X 30 INCHES.

A FLASHING ARROW BOARD SHALL BE USED WHEN A FREEWAY LANE IS CLOSED. WHEN MORE THAN ONE LANE CLOSED, A SEPARATE FLASHING ARROW BOARD SHALL BE USED FOR EACH CLOSED LANE.

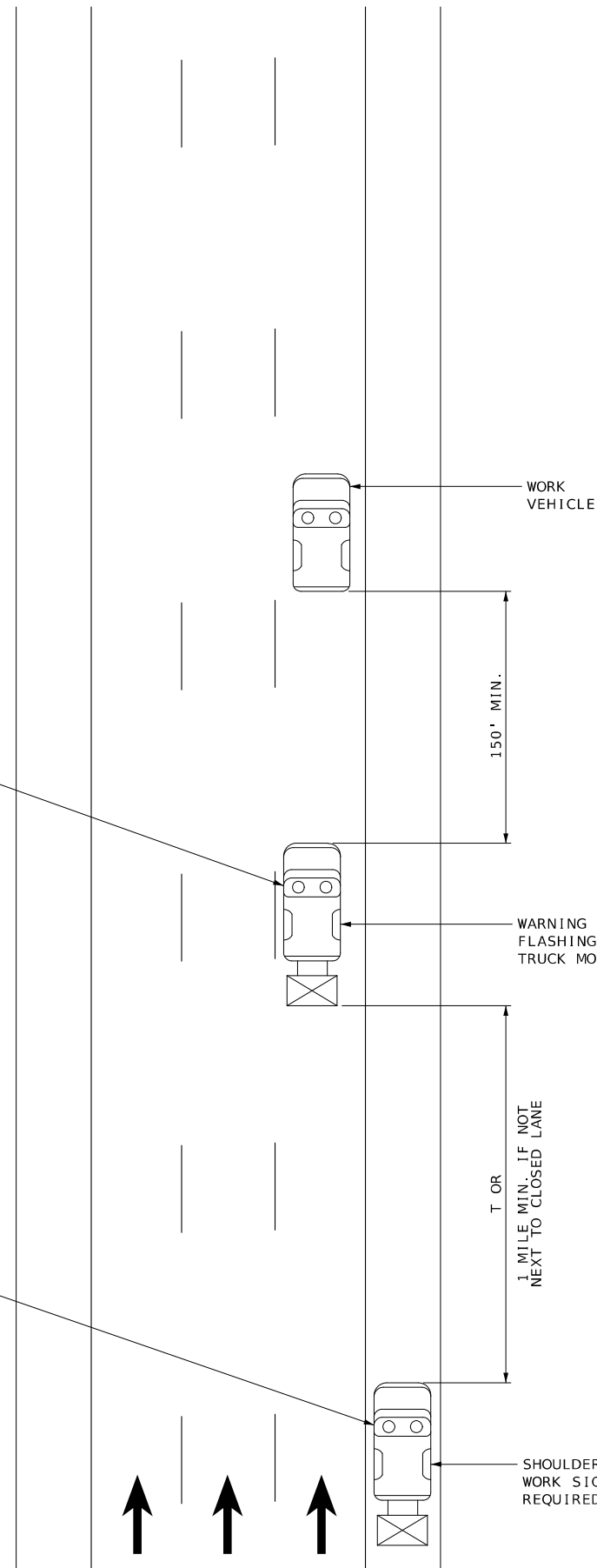
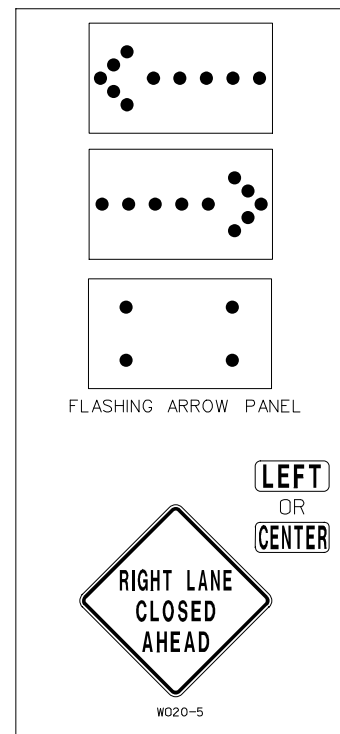
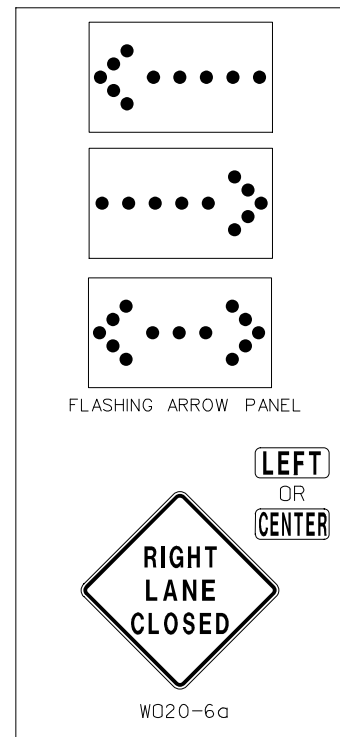

WORK VEHICLE

150' MIN.

WARNING TRUCK WITH WORK SIGNS, FLASHING ARROW PANEL AND REQUIRED TRUCK MOUNTED ATTENUATOR.

T OR 1 MILE MIN. IF NOT NEXT TO CLOSED LANE

SHOULDER ADVANCE WARNING TRUCK WITH WORK SIGNS, FLASHING ARROW PANEL AND REQUIRED TRUCK MOUNTED ATTENUATOR.

SPEED	SPACING
PERMANENT POSTED (MPH)	LENGTH T (FT)
≤ 35	245
40-45	540
50-55	660
60-70	840

MOBILE ON MULTI-LANE HIGHWAY

TEMPORARY TRAFFIC CONTROL

SHEET 13 OF 14



DATE PREPARED
2/16/2026
ROUTE 9 STATE MO
DISTRICT KC SHEET NO. 17
COUNTY CLAY/JACKSON
JOB NO. JKU0465
CONTRACT ID.
PROJECT NO.
BRIDGE NO.

DATE	DESCRIPTION

MISSOURI HIGHWAYS AND TRANSPORTATION COMMISSION
MoDOT
105 WEST CAPITOL JEFFERSON CITY, MO 65102
1-888-ASK-MODOT (1-888-275-6636)

