

**DESIGN DESIGNATION
RTE D**

A.A.D.T. - 2026 = 3,780
 A.A.D.T. - 2046 = 6,363
 D.H.V. = 10.75%
 T = 11%
 V = 55 M.P.H.
 D = 51.3%/48.7%

FUNCTIONAL CLASSIFICATION-MAJOR COLLECTOR

NO NEW R/W REQUIRED

**MISSOURI HIGHWAYS AND TRANSPORTATION COMMISSION
 PLANS FOR PROPOSED
 STATE HIGHWAY
 BATES COUNTY**

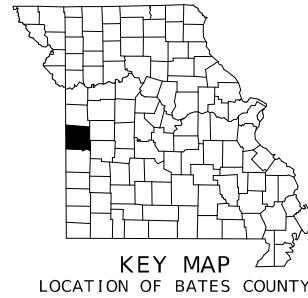

PROJECT LIMITS - RTE D
 BRIDGE REPLACEMENT
 PROJECT LENGTH 0.187 MILES
 BRIDGE NO. A2156

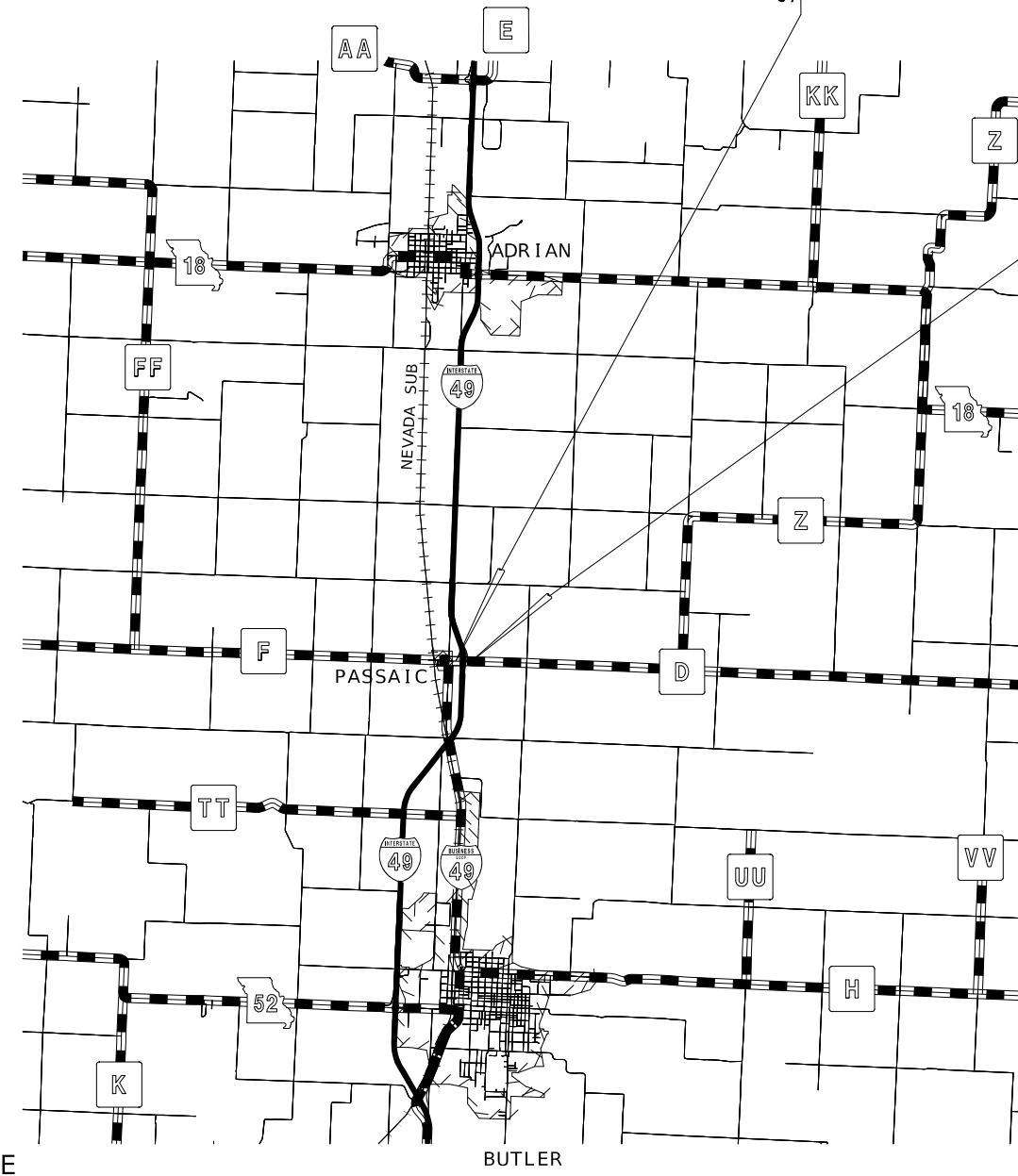

NOT TO SCALE

THE EXISTENCE AND APPROXIMATE LOCATION OF UTILITY FACILITIES KNOWN TO EXIST, AS SHOWN ON THE PLANS, ARE BASED ON THE BEST INFORMATION AVAILABLE TO THE COMMISSION AT THIS TIME. THIS INFORMATION IS PROVIDED BY THE COMMISSION "AS-IS" AND THE COMMISSION EXPRESSLY DISCLAIMS ANY REPRESENTATION OR WARRANTY AS TO THE COMPLETENESS, ACCURACY, OR SUITABILITY OF THE INFORMATION FOR ANY USE. RELIANCE UPON THIS INFORMATION IS DONE AT THE RISK AND PERIL OF THE USER, AND THE COMMISSION SHALL NOT BE LIABLE FOR ANY DAMAGES THAT MAY ARISE FROM ANY ERROR IN THE INFORMATION. IT IS, THEREFORE, THE RESPONSIBILITY OF THE CONTRACTOR TO VERIFY THE EXISTENCE, LOCATION AND STATUS OF ANY FACILITY. SUCH VERIFICATION INCLUDES DIRECT CONTACT WITH THE LISTED UTILITIES.

INDEX OF SHEETS

DESCRIPTION	SHEET NUMBER
TITLE SHEET	1
TYPICAL SECTIONS (TS) (3 SHEETS)---	2
QUANTITIES (QU) (3 SHEETS)-----	3
PLAN-PROFILE (PP)-----	4-5
COORDINATE POINTS (CP)-----	6
SPECIAL SHEETS (SS)-----	7-9
TRAFFIC CONTROL SHEETS (TC)-----	10-16
EROSION CONTROL SHEETS (EC)-----	17
SIGNING (SN)-----	18-27
PAVEMENT MARKING (PM)-----	28
BRIDGE DRAWINGS (B)	
A9691-----	1-29
CROSS SECTIONS (XS)-----	1-38

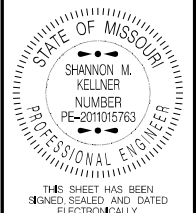

DATE PREPARED
4/2/2026

ROUTE D	STATE MO
DISTRICT SW	SHEET NO. 1

COUNTY
BATES

JOB NO.
JSR0134

CONTRACT ID.

PROJECT NO.

BRIDGE NO.

DESCRIPTION	DATE

LENGTH OF PROJECT

RTE D

BEGINNING OF PROJECT	STA. 4 + 41.00
END OF PROJECT	STA. 14 + 29.12
APPARENT LENGTH	988.12 FEET
EQUATIONS AND EXCEPTIONS:	

TOTAL CORRECTIONS	0 FEET
NET LENGTH OF PROJECT	988.12 FEET
STATE LENGTH	0.187 MILES
FOR INFORMATION ONLY ESTIMATED DISTURBED ACRES	5.5 ACRES

**CONVENTIONAL SYMBOLS
(USED IN PLANS)**

	EXISTING	NEW
BUILDINGS AND STRUCTURES		
GUARD RAIL		
GUARD CABLE		
CONCRETE RIGHT-OF-WAY MARKER		
STEEL RIGHT-OF-WAY MARKER		
LOCATION SURVEY MARKER		
UTILITIES		
FIBER OPTICS	-FO-	-FO-
OVERHEAD CABLE TV	-OTV-	-OTV-
UNDERGROUND CABLE TV	-UTV-	-UTV-
OVERHEAD TELEPHONE	-OT-	-OT-
UNDERGROUND TELEPHONE	-UT-	-UT-
OVERHEAD POWER	-OE-	-OE-
UNDERGROUND POWER	-UE-	-UE-
SANITARY SEWER	-S-	-S-
STORM SEWER	-SS-	-SS-
GAS	-G-	-G-
WATER	-W-	-W-
MANHOLE		
FIRE HYDRANT		
WATER VALVE		
WATER METER		
DROP INLET		
DITCH BLOCK		
GROUND MOUNTED SIGN		
LIGHT POLE		
H-FRAME POWER POLE		
TELEPHONE PEDESTAL		
FENCE		
CHAIN LINK		
WOVEN WIRE		
GATE POST		
BENCHMARK		

NOTE: DASHED OR OPEN SYMBOLS INDICATE EXISTING FEATURES

MISSOURI HIGHWAYS AND TRANSPORTATION COMMISSION

105 WEST CAPITOL
JEFFERSON CITY, MO 65102
1-888-ASK-MODOT (1-888-275-6636)

EQUIVALENT PAVEMENT DESIGN				
LOCATION	BASE TYPE	HMA DESIGN	PCCP DESIGN	SHOULDERS
ROUTE D	6" TYPE 5 AGGREGATE BASE	10" HMA 2" BP1 W/ PG 64-22 OVER 8" BIT. BASE W/ PG 64-22	9.5" PCCP 15 FT JOINTS W/ 1 1/4" DOWELS	A2 OR FULL DEPTH

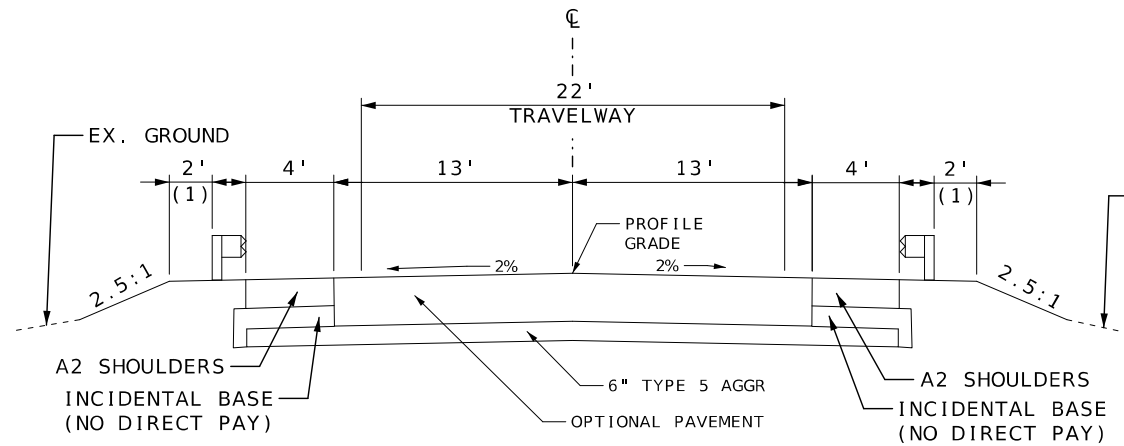
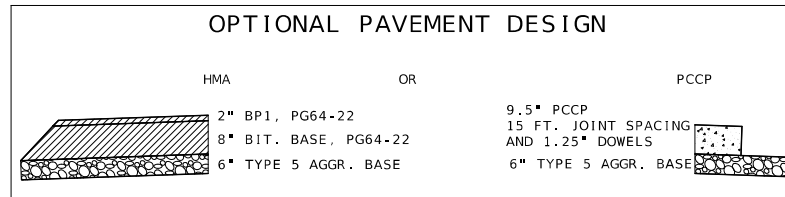

SECTION ON TANGENT
PROPOSED TYPICAL SECTION RTE D
 STA 4+41.00 TO STA 8+12.94
 STA 10+96.44 TO STA 11+55.00

CROSS SECTIONS AND EARTHWORK IN THIS PROJECT ARE BASED ON THE CONCRETE OPTIONAL CONTRACTOR IS RESPONSIBLE FOR MAKING ANY ADJUSTMENTS WITH NO EXTRA PAY IF THE ASPHALT OPTIONAL IS USED.

NO DIRECT PAY FOR SAWCUTS.

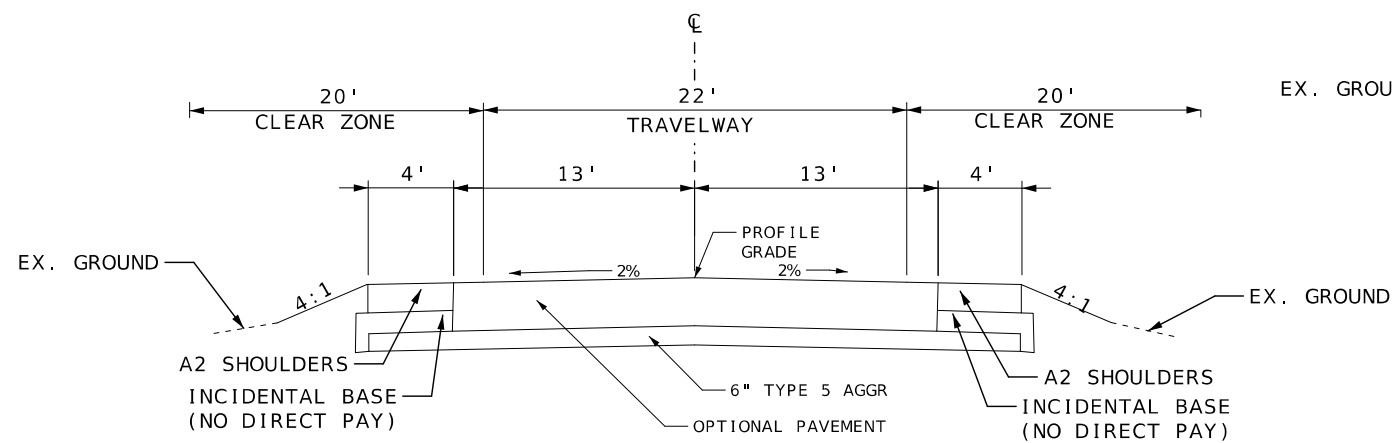

SECTION ON TANGENT
PROPOSED TYPICAL SECTION RTE D
 STA 11+55.00 TO STA 14+29.12

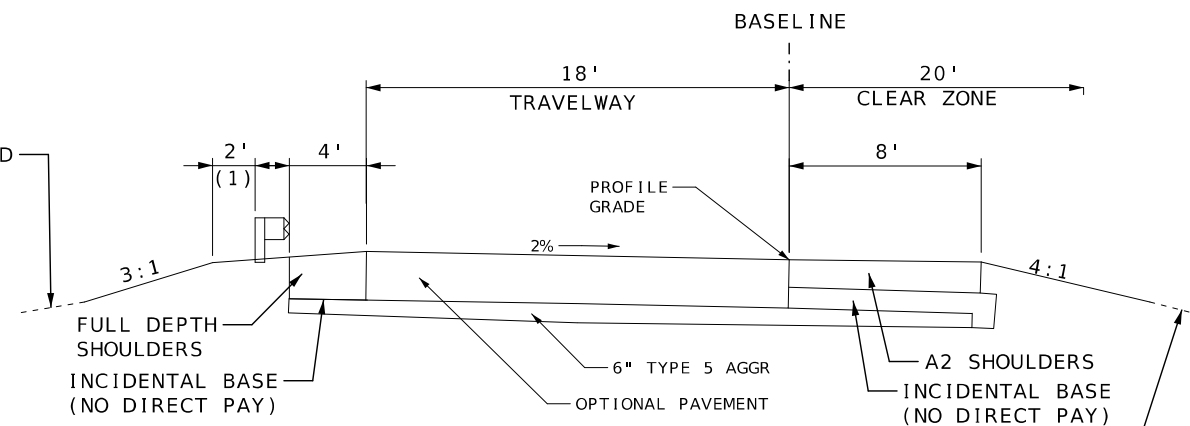

SECTION ON TANGENT
PROPOSED TYPICAL SECTION RAMP 1 & 3
 RAMP 1: STA 0+00.00 TO STA 1+30.87
 RAMP 3: STA 11+62.94 TO STA 14+69.91

NOTE:

(1) GUARDRAIL INSTALLATION SHALL BE IN ACCORDANCE WITH STANDARD PLANS 606.50 AND 606.81. SEE PLAN SHEET FOR EXACT LIMITS OF MGS GUARDRAIL.

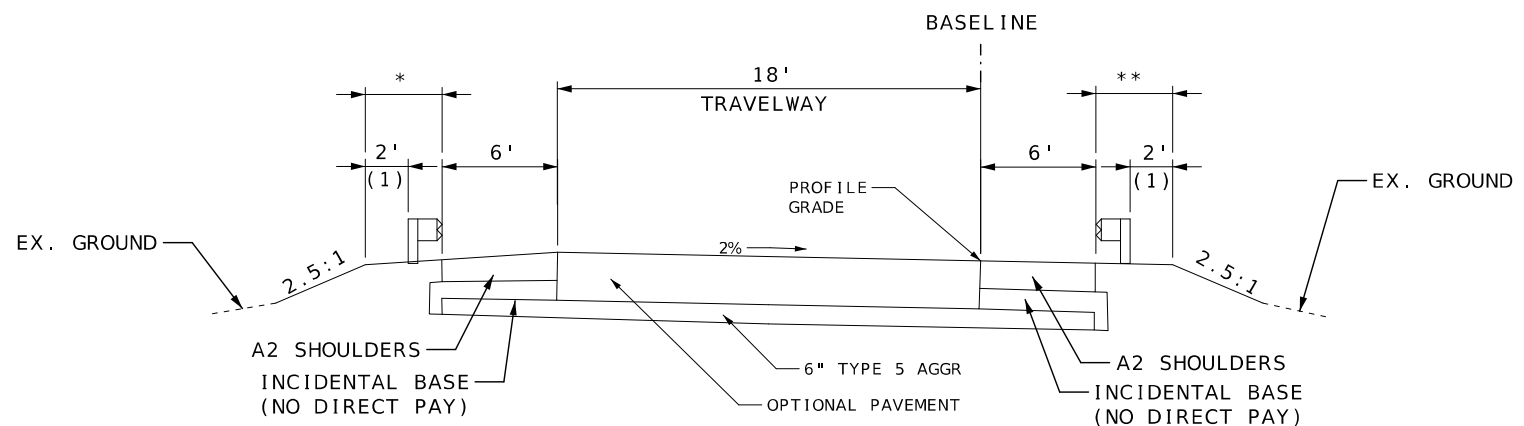

SECTION ON TANGENT
PROPOSED TYPICAL SECTION RAMP 2 & 4
 RAMP 2: STA 13+52.80 TO STA 15+68.44
 RAMP 4: STA 0+00.00 TO STA 3+98.95

* RAMP 2 RT SHAPING SLOPES CLASS 3 FROM STA 10+28.62 TO STA 13+52.80
 ** RAMP 2 LT SHAPING SLOPES CLASS 3 FROM STA 10+50.97 TO STA 13+52.80

NOT TO SCALE

TYPICAL SECTIONS
 SHEET 2 OF 3

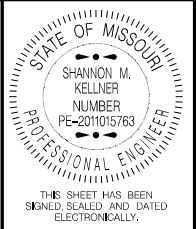

DATE PREPARED 2/27/2026	
ROUTE D	STATE MO
DISTRICT SW	SHEET NO. 2
COUNTY BATES	
JOB NO. JSR0134	
CONTRACT ID.	
PROJECT NO.	
BRIDGE NO.	

DESCRIPTION	DATE

MISSOURI HIGHWAYS AND TRANSPORTATION COMMISSION

105 WEST CAPITOL
 JEFFERSON CITY, MO 65102
 1-888-ASK-MODOT (1-888-275-6636)

TEMPORARY EROSION CONTROL					
STA	STA	LOCATION	SILT FENCE (LF)	ROCK DITCH CHECK (LF)	SEDIMENT REMOVAL (CY)
2+25.28	8+83.30	LT & RT RTE D	1316.04		13.16
10+29.30	14+29.12	LT & RT RTE D	799.64		8.00
0+00.00	5+77.04	LT RAMP 1	577.04		5.77
0+00.00	1+30.85	RT RAMP 1	130.85		1.31
13+52.80	15+68.44	LT & RT RAMP 2	431.28		4.31
11+62.94	14+69.91	LT & RT RAMP 3	613.94	16	22.14
0+00.00	3+98.95	LT & RT RAMP 4	797.9		7.98
		TOTAL	4666.69	16	62.67
		USE	4667	16	63

SEEDING						
STA	STA	LOCATION	SEEDING COOL SEASON MIX (ACRES)	TEMPORARY SEEDING (ACRES)	MULCHING (ACRES)	REMARKS
4+41.00	8+12.94		1.944	0.486	2.430	WEST OF BRIDGE (RTE D, RAMP 2, RAMP 4)
10+96.44	14+29.12		0.831	0.208	1.039	EAST OF BRIDGE (RTE D, RAMP 1, RAMP 3)
		TOTAL	2.775	0.694	3.469	
		USE	2.8	0.7	3.5	

PERMANENT PAVEMENT MARKING								
BEGIN STA	END STA	LOCATION	LENGTH (FT)	6" WHITE CLASS 2 PAVEMENT MARKING PAINT (25-MIL, TYPE L BEADS) (FT)	6" YELLOW CLASS 2 PAVEMENT MARKING PAINT (25-MIL, TYPE L BEADS) (FT)	4" WHITE CLASS 1 PAVEMENT MARKING PAINT (18-MIL, TYPE P BEADS) (FT)	4" YELLOW CLASS 1 PAVEMENT MARKING PAINT (18-MIL, TYPE P BEADS) (FT)	REMARKS
4+41.00	14+29.12	RTE D	988.12			1437.14	1976.24	DOUBLE CL & EDGE LINES, EXCEPT OUT EDGELINES ACROSS INTERSECTIONS
0+00.00	1+30.85	RAMP 1	130.85	159.43	140.65			LT YELLOW EDGELINE, RT WHITE EDGELINE, INCLUDED EOP RADI I AT INTERSECTION
13+52.80	15+68.44	RAMP 2	215.64	252.89	226.91			LT YELLOW EDGELINE, RT WHITE EDGELINE, INCLUDED EOP RADI I AT INTERSECTION
11+62.94	14+69.91	RAMP 3	306.97	342.81	314.96			LT YELLOW EDGELINE, RT WHITE EDGELINE, INCLUDED EOP RADI I AT INTERSECTION
0+00.00	3+98.95	RAMP 4	398.95	426.40	408.84			LT YELLOW EDGELINE, RT WHITE EDGELINE, INCLUDED EOP RADI I AT INTERSECTION
		TOTAL		1181.53	1091.36	1437.14	1976.24	
		USE		1182	1092	1438	1977	

GUARDRAIL & BARRIERS									
BEGIN STA	END STA	LOCATION	MGS BRIDGE APPROACH TRANSITION (REGULAR/NO CURB) (EACH)	TYPE A CRASHWORTHY END TERMINAL (MASH) (EACH)	END ANCHORS (EACH)	MGS GUARDRAIL (FT)	SHAPING SLOPES CLASS 3 (100FT)	TYPE D CONCRETE BARRIER (FT)	REMARKS
2+55.43	10+28.62	LT RTE D - RT RAMP 2		2		837.5	3.3		NW CORNER OF RTE D AND RAMP 2 INTERSECTION
3+55.35	3+72.29	RT RTE D - RT RAMP 4		1	1	625			SW CORNER OF RTE D AND RAMP 4 INTERSECTION
10+50.97	8+25.94	LT RAMP 2 - LT RTE D		1		487.5	3.1		NE CORNER OF RTE D AND RAMP 2 INTERSECTION
3+73.87	8+25.94	LT RAMP 4 - RT RTE D		1	1	362.5			SE CORNER OF RTE D AND RAMP 4 INTERSECTION
10+83.44	0+93.88	LT RTE D - LT RAMP 1		1	1	100			NW CORNER OF RTE D AND RAMP 1 INTERSECTION
10+83.44	13+37.17	RT RTE D - LT RAMP 3		1		87.5			SW CORNER OF RTE D AND RAMP 3 INTERSECTION
572+81.70	577+99.84	RT I-49 NB	2	1	1	275	4.2	100	
573+62.23	578+49.81	LT I-49 NB	1	1		300	3.9	100	
569+17.92	574+09.15	LT I-49 SB	1	1		300	4.0	100	
569+65.10	574+61.26	RT I-49 SB	2	1	1	250	4.0	100	
		TOTAL		10	5	3625	22.5	400	
		USE		10	5	3625	23	400	

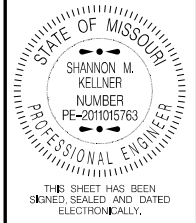

DATE PREPARED
3/2/2026

ROUTE STATE
D MO

DISTRICT SHEET NO.
SW 3

COUNTY
BATES

JOB NO.
JSR0134

CONTRACT ID.

PROJECT NO.

BRIDGE NO.

DATE	DESCRIPTION

MISSOURI HIGHWAYS AND TRANSPORTATION COMMISSION

105 WEST CAPITOL
JEFFERSON CITY, MO 65102
1-888-ASK-MODOT (1-888-275-6636)



DATE PREPARED
3/2/2026

ROUTE D STATE MO
DISTRICT SW SHEET NO. 5

COUNTY BATES
JOB NO. JSR0134
CONTRACT ID.

PROJECT NO.

BRIDGE NO.

DATE	DESCRIPTION

MISSOURI HIGHWAYS AND TRANSPORTATION COMMISSION

105 WEST CAPITOL
JEFFERSON CITY, MO 65102
1-888-ASK-MODOT (1-888-275-6636)

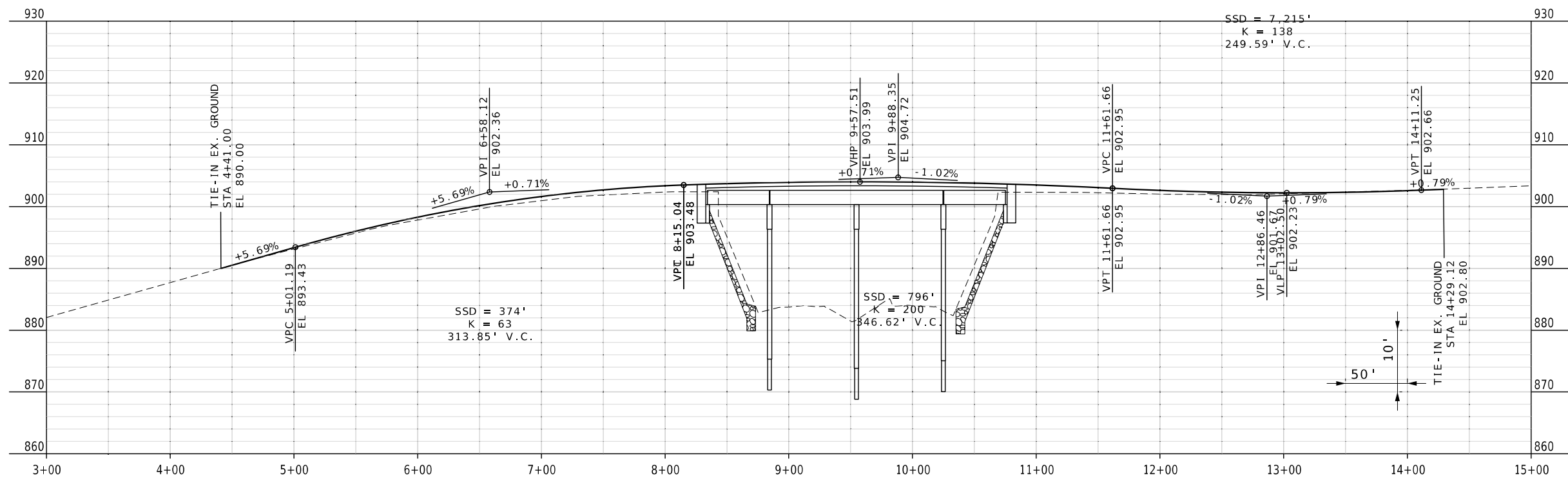

SSD = INF'
K = 94
65.40' V.C.

RTE D ☐

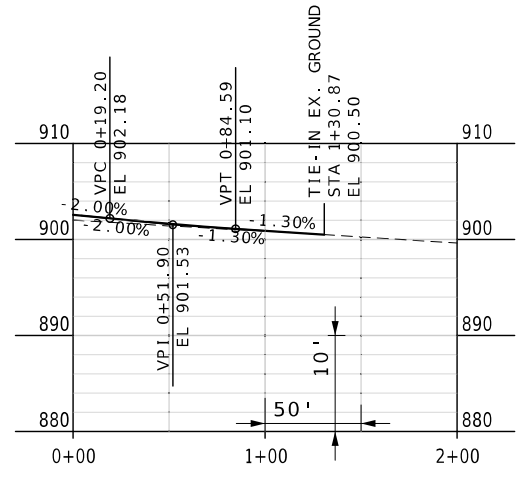

RAMP 1 BASELINE

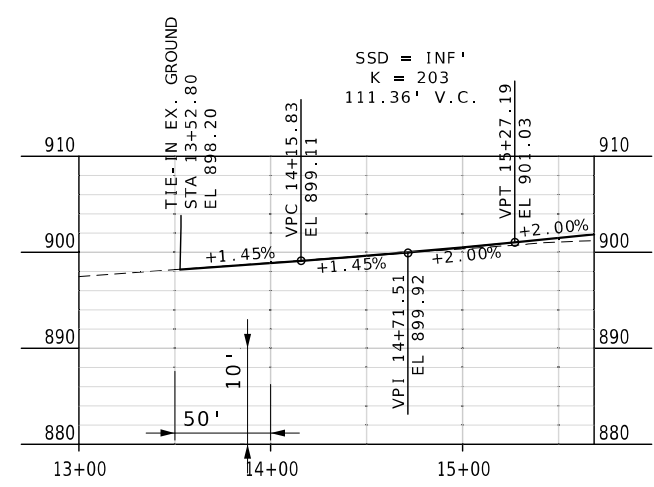

RAMP 2 BASELINE

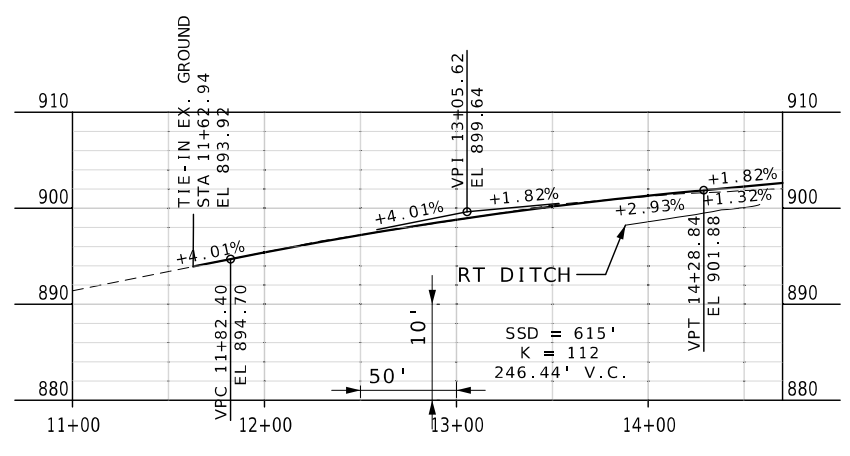

RAMP 3 BASELINE

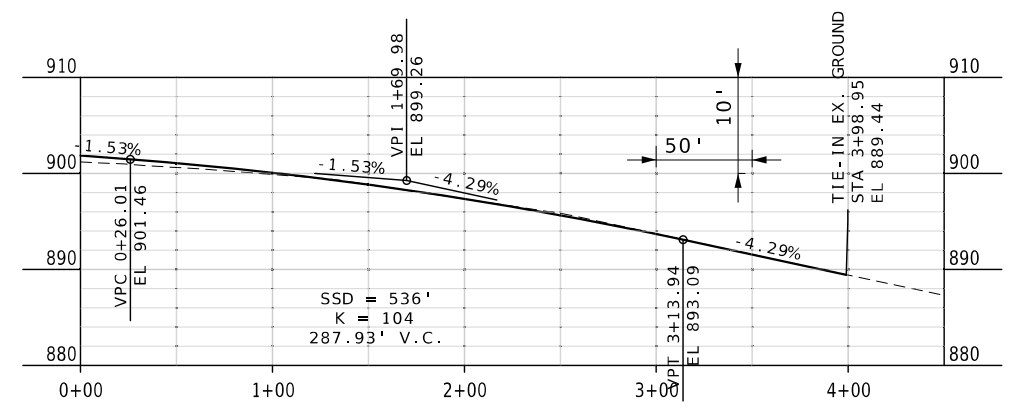

RAMP 4 BASELINE

☐ PROPOSED
- - - EXISTING GROUND



THIS SHEET HAS BEEN SIGNED, SEALED AND DATED ELECTRONICALLY.

DATE PREPARED
2/27/2026

ROUTE STATE
D MO

DISTRICT SHEET NO.
SW 6

COUNTY
BATES

JOB NO.
JSR0134

CONTRACT ID.

PROJECT NO.

BRIDGE NO.

DATE

DESCRIPTION

DATE

DESCRIPTION

DATE

DESCRIPTION

DATE

DESCRIPTION

DATE

DESCRIPTION

DATE

DESCRIPTION

DATE

DESCRIPTION

DATE

DESCRIPTION

DATE

DESCRIPTION

DATE

DESCRIPTION

DATE

DESCRIPTION

DATE

DESCRIPTION

DATE

DESCRIPTION

DATE

DESCRIPTION

DATE

DESCRIPTION

DATE

DESCRIPTION

DATE

DESCRIPTION

DATE

DESCRIPTION

DATE

DESCRIPTION

DATE

DESCRIPTION

DATE

DESCRIPTION

DATE

DESCRIPTION

DATE

DESCRIPTION

DATE

DESCRIPTION

DATE

DESCRIPTION

DATE

DESCRIPTION

DATE

DESCRIPTION

DATE

DESCRIPTION

DATE

DESCRIPTION

DATE

DESCRIPTION

DATE

DESCRIPTION

DATE

DESCRIPTION

DATE

DESCRIPTION

DATE

DESCRIPTION

DATE

DESCRIPTION

MISSOURI HIGHWAYS AND TRANSPORTATION COMMISSION

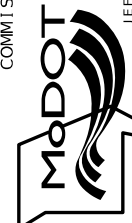

105 WEST CAPITOL JEFFERSON CITY, MO 65102
1-888-ASK-MODOT (1-888-275-6636)

ALL PROJECT COORDINATES HAVE BEEN PROJECTED FROM THE MISSOURI STATE PLANE COORDINATE (SPC) SYSTEM OF 1983 USING AN AVERAGE PROJECT PROJECTION (GRID TO GROUND) FACTOR. TO GET BACK TO STATE PLANE COORDINATES MULTIPLY THE PROJECT COORDINATES BY THE AVERAGE GRID FACTOR AS SHOWN IN THE "REFERENCE CONTROL INFORMATION" PORTION OF THIS TABLE.

PROJECT COORDINATE INFORMATION

COORDINATE SYSTEM	MODIFIED STATE PLANE
HORIZONTAL DATUM	NAD83
VERTICAL DATUM	NAVD88
GEOID MODEL	GEOID 18
ELEVATIONS DETERMINED BY	MODOT GNSS
PROJECT PROJECTION FACTOR	1.00009472

REFERENCE CONTROL INFORMATION

COORDINATE SYSTEM	MISSOURI STATE PLANE
CONTROL STATION	MODOT GNSS
DESIGNATION	MODOT NEVADA CORS ARP
CORS_ID	MONE
PID	DM4686
LATITUDE	375156.7199
LONGITUDE	942058.3688
NORTHING (M)	188561.0070
EASTING (M)	863237.9460
ZONE	WEST
PROJECT AVERAGE GRID FACTOR	0.99990529

EXAMPLE OF PROJECT COORDINATE TO S.P.C.

PROJECT NORTHING X AVERAGE GRID FACTOR = STATE PLANE NORTHING
PROJECT EASTING X AVERAGE GRID FACTOR = STATE PLANE EASTING
EXAMPLE: CONTROL POINT #CP1
N 784825.225 X 0.99990529 = N 784750.8942
E 2834226.784 X 0.99990529 = E 2833958.354

LINEAR UNIT CONVERSION

1 METER = 3.280833333 US SURVEY FEET (USFT)

COORDINATE POINT LISTING

SHEET NO	STATION	LOCATION	OFFSET (USFT)	MODIFIED STATE PLANE (GROUND)			DESCRIPTION
				NORTHING (US SURVEY FT)	EASTING (US SURVEY FT)	ELEVATION (US SURVEY FT)	
PROJECT CONTROL POINTS							
4	12+99.04	CL RTE D	38.07	784825.225	2834226.784	902.169	CP1 5/8" I.P. WITH PINK PLASTIC CAP
N/A	0+54.12	CL RTE D	50.89	784810.674	2832981.880	870.302	CP2 5/8" I.P. WITH PINK PLASTIC CAP
4	7+52.97	CL RTE D	76.74	784887.23	2833680.761	901.424	CP3 5/8" I.P. WITH PINK PLASTIC CAP
4	12+61.87	CL RTE D	77.45	784785.79	2834189.667	901.597	BM-CHISELED SQUARE IN RW MARKER BASE
4	8+35.04	CL RTE D	-18.28	784880.932	2833762.700	903.009	BM-CHISELED SQ NW CORNER OF BRIDGE RAIL
ALIGNMENTS							
N/A	0+00.00	CL RTE D	0.00	784861.4850	2832927.6894		POT - BEGIN RTE D CHAIN
4	15+49.71	CL RTE D	0.00	784863.6451	2834477.3942		POT
N/A	18+30.34	CL RTE D	0.00	784864.0363	2834758.0269		POT - END RTE D CHAIN
N/A	557+06.98	CL I-49	0.00	786485.5336	2833531.4509		POT - BEGIN I-49 CHAIN
N/A	563+03.00	CL I-49	0.00	785924.7519	2833733.3594		TS
N/A	565+53.00	CL I-49	0.00	785687.7874	2833812.8829		SC
4	570+06.90	CL I-49	0.00	785240.8342	2833885.6164		CS
4	572+56.90	CL I-49	0.00	784990.8820	2833885.3298		ST
N/A	587+33.04	CL I-49	0.00	783515.1361	2833851.4367		POT - END I-49 CHAIN
4	0+00.00	BL RAMP 1	0.00	784863.1658	2834133.5337		POT - BEGIN RAMP 1 BL
4	2+82.75	BL RAMP 1	0.00	785144.6815	2834107.1709		PC 1
N/A	8+24.51	BL RAMP 1	0.00	785661.3094	2833955.4892		PT 1
N/A	11+18.62	BL RAMP 1	0.00	785922.4828	2833820.2570		PC 2
N/A	13+21.08	BL RAMP 1	0.00	786107.5784	2833738.5527		PT 2
N/A	14+53.82	BL RAMP 1	0.00	786232.1119	2833692.5841		POT - END RAMP 1 BL
N/A	0+00.00	BL RAMP 2	0.00	786410.1981	2833500.6101		POT - BEGIN RAMP 2 BL
N/A	3+43.10	BL RAMP 2	0.00	786081.9790	2833600.5482		PC
N/A	7+79.10	BL RAMP 2	0.00	785651.5560	2833657.6860		PT
4	15+68.44	BL RAMP 2	0.00	784862.4742	2833637.3887		POT - END RAMP 2 BL
N/A	0+00.00	BL RAMP 3	0.00	783413.1190	2833902.3694		POT - BEGIN RAMP 3 BL
N/A	3+80.52	BL RAMP 3	0.00	783792.8526	2833926.7584		PC
N/A	6+51.52	BL RAMP 3	0.00	784061.2614	2833962.5993		PT
4	14+69.91	BL RAMP 3	0.00	784863.1554	2833902.2856		POT - END RAMP 3 BL
4	0+00.00	BL RAMP 4	0.00	784862.4742	2833637.3887		POT - BEGIN RAMP 4 BL
N/A	5+34.99	BL RAMP 4	0.00	784337.5507	2833740.6672		PC
N/A	10+90.85	BL RAMP 4	0.00	783784.8946	2833789.7684		PT
N/A	11+38.99	BL RAMP 4	0.00	783736.7640	2833788.9481		POT - END RAMP 4 BL

POINT	STATION	OFFSET	ELEVATION	NOTES
E1	6+28.40	-17.00	899.05	EOS
E2	6+39.18	-17.90	899.33	EOS
E3	6+48.94	-20.03	899.66	EOS
E4	6+58.36	-23.37	899.91	EOS
E5	6+67.28	-27.88	900.11	EOS
E6	6+75.56	-33.48	900.26	EOS
E7	6+83.07	-40.07	900.36	EOS
E8	6+89.68	-47.56	900.41	EOS
E9	6+95.30	-55.83	900.42	EOS
E10	6+99.82	-64.74	900.38	EOS
E11	7+03.19	-74.15	900.32	EOS
E12	7+05.34	-83.91	900.21	EOS
E13	7+06.24	-93.86	899.93	EOS

NOTE: ALL POINTS STATIONED FROM RTE. D

POINT	STATION	OFFSET	ELEVATION	NOTES
E14	7+35.12	-51.92	901.05	EOS
E15	7+36.31	-42.03	901.30	EOS
E16	7+40.32	-32.91	901.66	EOS
E17	7+46.80	-25.34	902.04	EOS
E18	7+55.20	-19.97	902.35	EOS
E19	7+64.79	-17.28	902.66	EOS
E20	7+69.10	-17.00	902.65	EOS

NOTE: ALL POINTS STATIONED FROM RTE. D

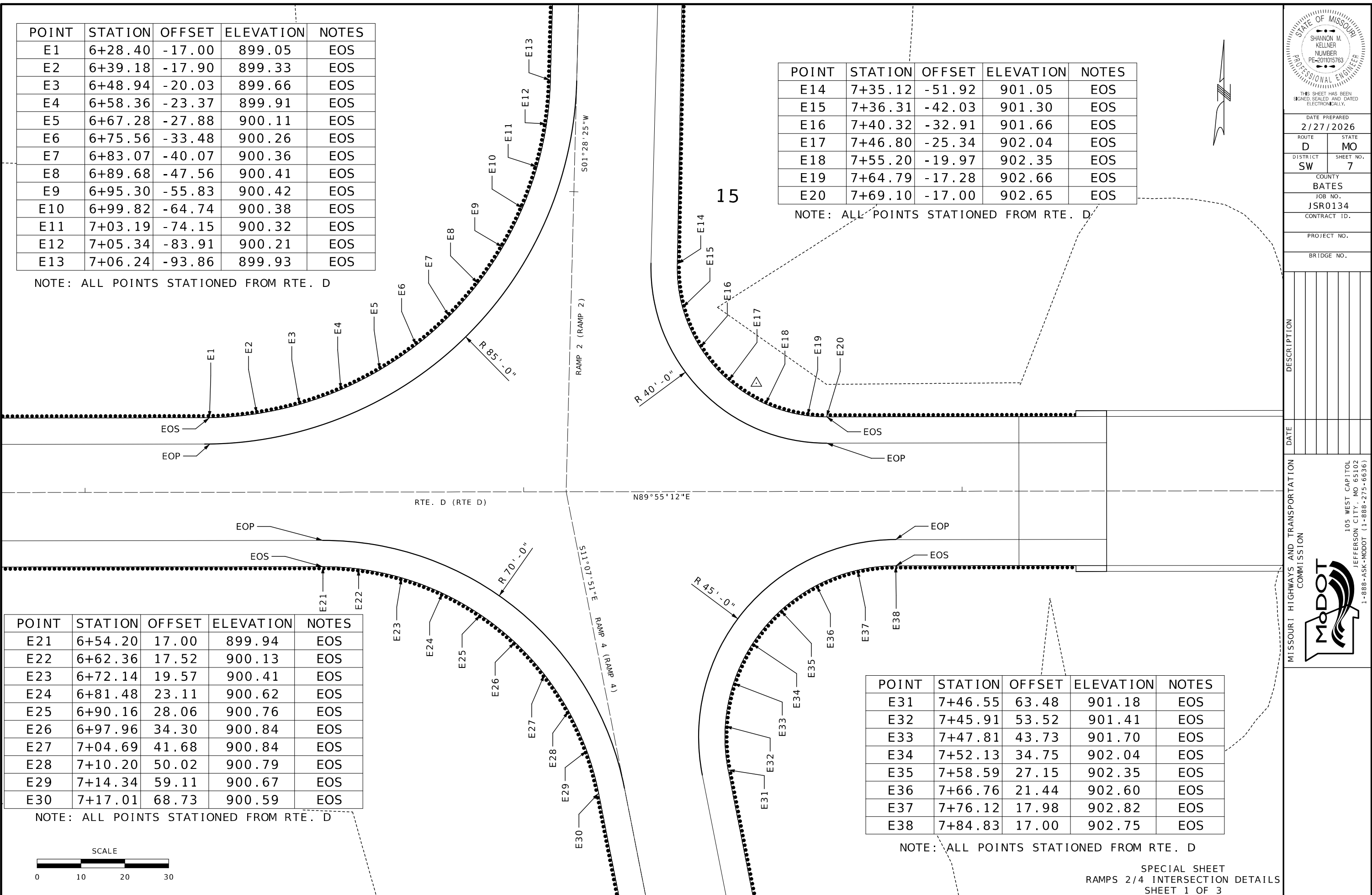

POINT	STATION	OFFSET	ELEVATION	NOTES
E21	6+54.20	17.00	899.94	EOS
E22	6+62.36	17.52	900.13	EOS
E23	6+72.14	19.57	900.41	EOS
E24	6+81.48	23.11	900.62	EOS
E25	6+90.16	28.06	900.76	EOS
E26	6+97.96	34.30	900.84	EOS
E27	7+04.69	41.68	900.84	EOS
E28	7+10.20	50.02	900.79	EOS
E29	7+14.34	59.11	900.67	EOS
E30	7+17.01	68.73	900.59	EOS

NOTE: ALL POINTS STATIONED FROM RTE. D

POINT	STATION	OFFSET	ELEVATION	NOTES
E31	7+46.55	63.48	901.18	EOS
E32	7+45.91	53.52	901.41	EOS
E33	7+47.81	43.73	901.70	EOS
E34	7+52.13	34.75	902.04	EOS
E35	7+58.59	27.15	902.35	EOS
E36	7+66.76	21.44	902.60	EOS
E37	7+76.12	17.98	902.82	EOS
E38	7+84.83	17.00	902.75	EOS

NOTE: ALL POINTS STATIONED FROM RTE. D



DATE PREPARED
2/27/2026
ROUTE D STATE MO
DISTRICT SW SHEET NO. 7
COUNTY BATES
JOB NO. JSR0134
CONTRACT ID.
PROJECT NO.
BRIDGE NO.

DESCRIPTION	DATE

MISSOURI HIGHWAYS AND TRANSPORTATION COMMISSION
105 WEST CAPITOL
JEFFERSON CITY, MO 65102
1-888-ASK-MODOT (1-888-275-6636)

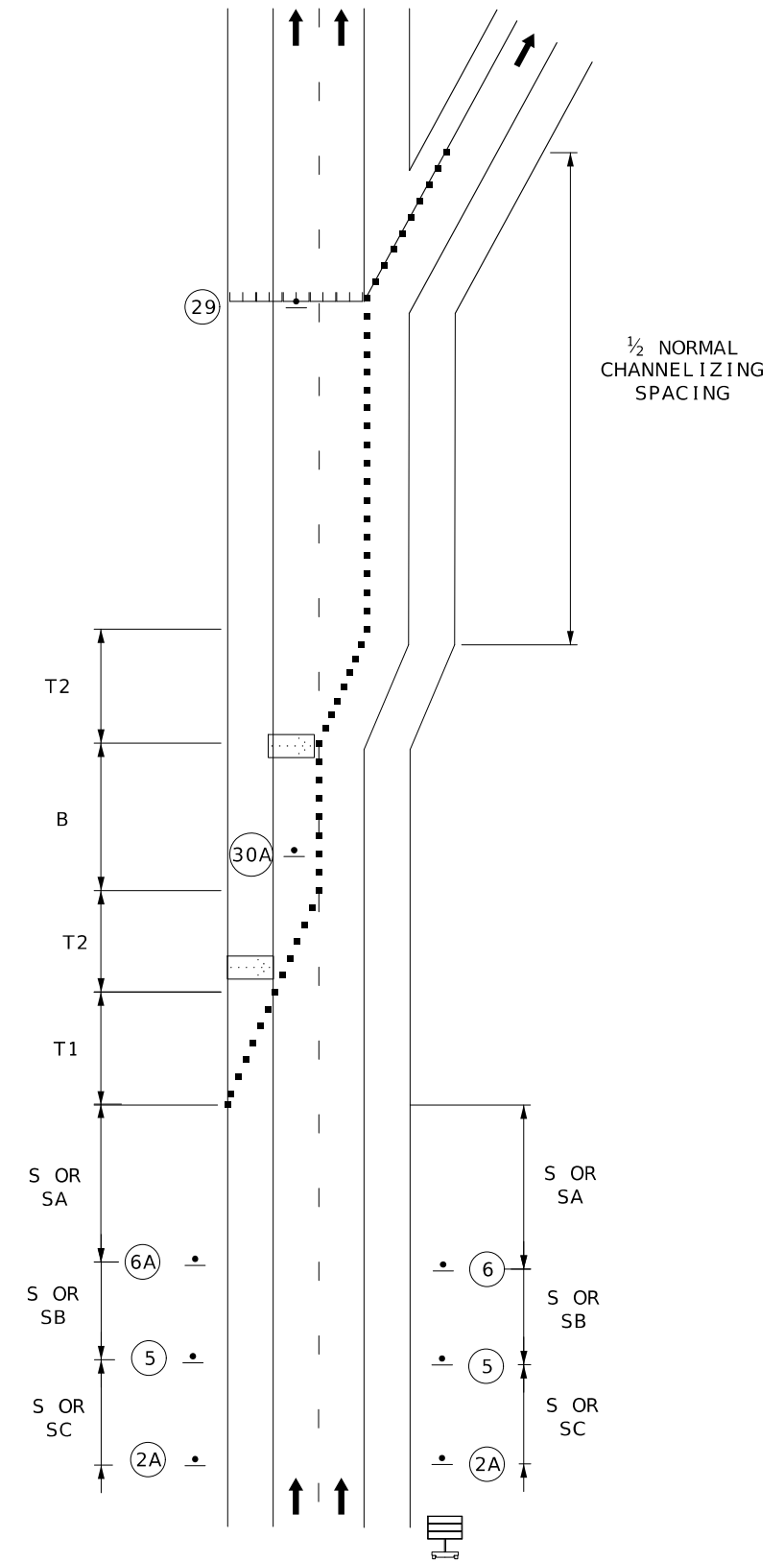

RAMP BY-PASS DURING EXISTING BRIDGE REMOVAL

PERMANENT POSTED (MPH)	SIGN SPACING (FT)	TAPER LENGTH (FT)		OPTIONAL BUFFER LENGTH (FT) (B)	CHANNELIZER SPACING (FT)	
		SHOULDER (1) (T1)	LANE (2) (T2)		TAPERS	BUFFER/WORK AREAS
0-35	200	70	245	250	35	40
40-45	500	150	540	360	40	80
50-55	1000	185	660	495	50	80
60-70	SA - 1000 SB - 1500 SC - 2640	235	840	730	60	120

NOTES:
 (1) SHOULDER TAPER LENGTH BASED ON 10 FT. (STANDARD SHOULDER WIDTH) OFFSET.
 (2) LANE TAPER LENGTH BASED ON 12 FT. (STANDARD LANE WIDTH) OFFSET.
 (3) 5' CHANNELIZER DEVICE MINIMUM.
 REMOVE AND/OR MODIFY EXISTING PAVEMENT MARKING AS NEEDED.
 TEMPORARY PAVEMENT MARKING REQUIRED WITH LONG TERM LANE CLOSURES.

■	CHANNELIZER	▤	TYPE 3 BARRICADE
•	SIGN	▤	FLASHING ARROW BOARD
▤	CHANGEABLE MESSAGE BOARD		

NOTES:
 SEE TRAFFIC CONTROL SHEET 7 OF 7 FOR TEMPORARY SIGNING LEGEND AND OTHER TRAFFIC CONTROL NOTES.

NOT TO SCALE

TRAFFIC CONTROL SHEET 1 OF 7



DATE PREPARED
3/2/2026

ROUTE D	STATE MO
DISTRICT SW	SHEET NO. 10

COUNTY
BATES

JOB NO.
JSR0134

CONTRACT ID.

PROJECT NO.

BRIDGE NO.

DATE	DESCRIPTION

MISSOURI HIGHWAYS AND TRANSPORTATION COMMISSION

105 WEST CAPITOL
JEFFERSON CITY, MO 65102
1-888-ASK-MODOT (1-888-275-6636)

NOT TO SCALE

NOTES:

SEE TRAFFIC CONTROL SHEET 7 OF 7 FOR TEMPORARY SIGNING LEGEND AND OTHER TRAFFIC CONTROL NOTES.

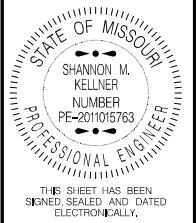
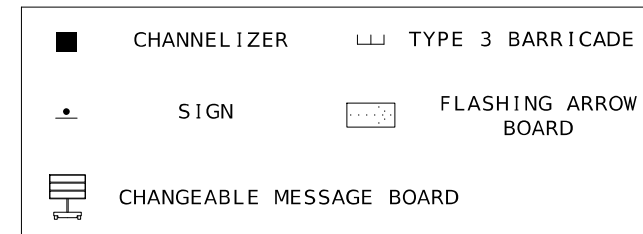

DATE PREPARED
 3/2/2026
 ROUTE D STATE MO
 DISTRICT SW SHEET NO. 14
 COUNTY BATES
 JOB NO. JSR0134
 CONTRACT ID.
 PROJECT NO.
 BRIDGE NO.

DATE	DESCRIPTION

MISSOURI HIGHWAYS AND TRANSPORTATION COMMISSION

 105 WEST CAPITOL JEFFERSON CITY, MO 65102
 1-888-ASK-MODOT (1-888-275-6636)

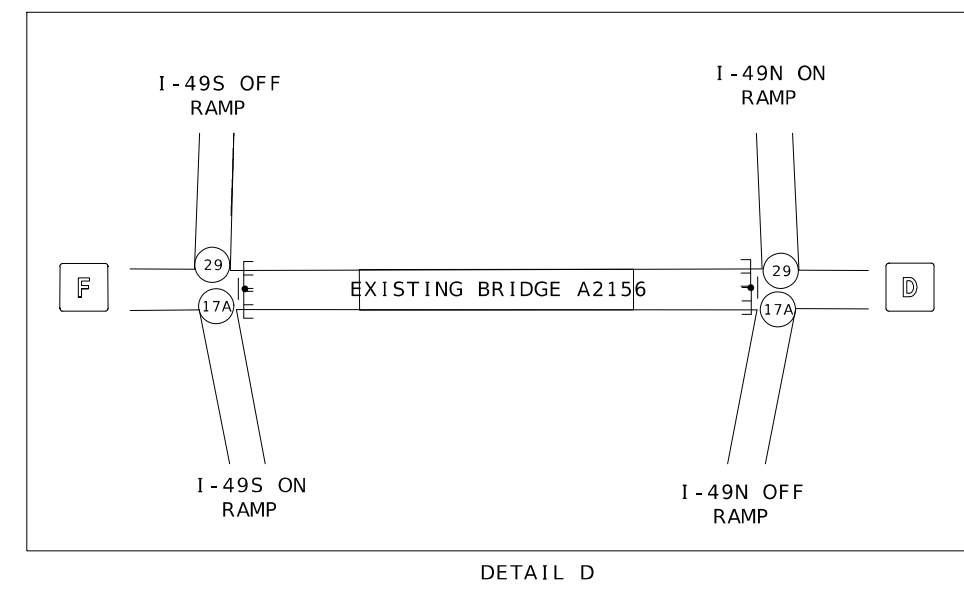
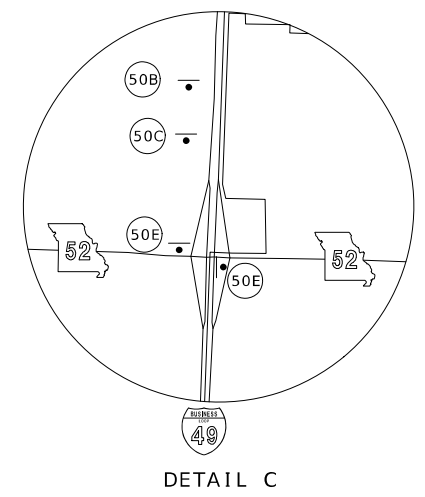
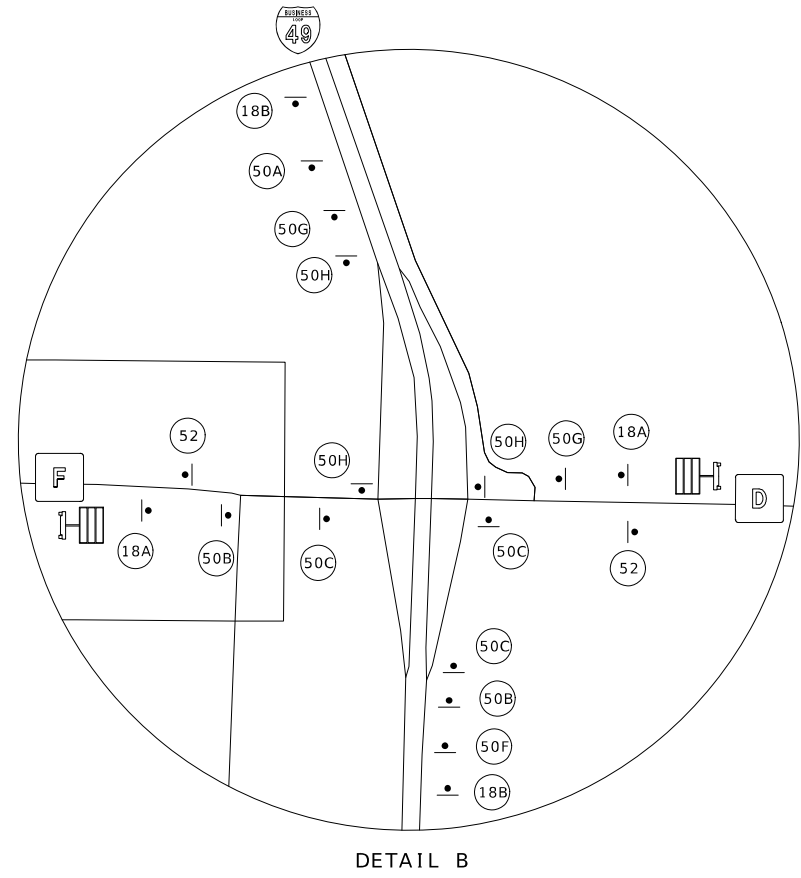
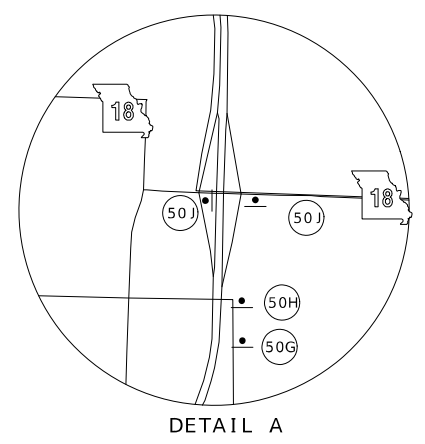
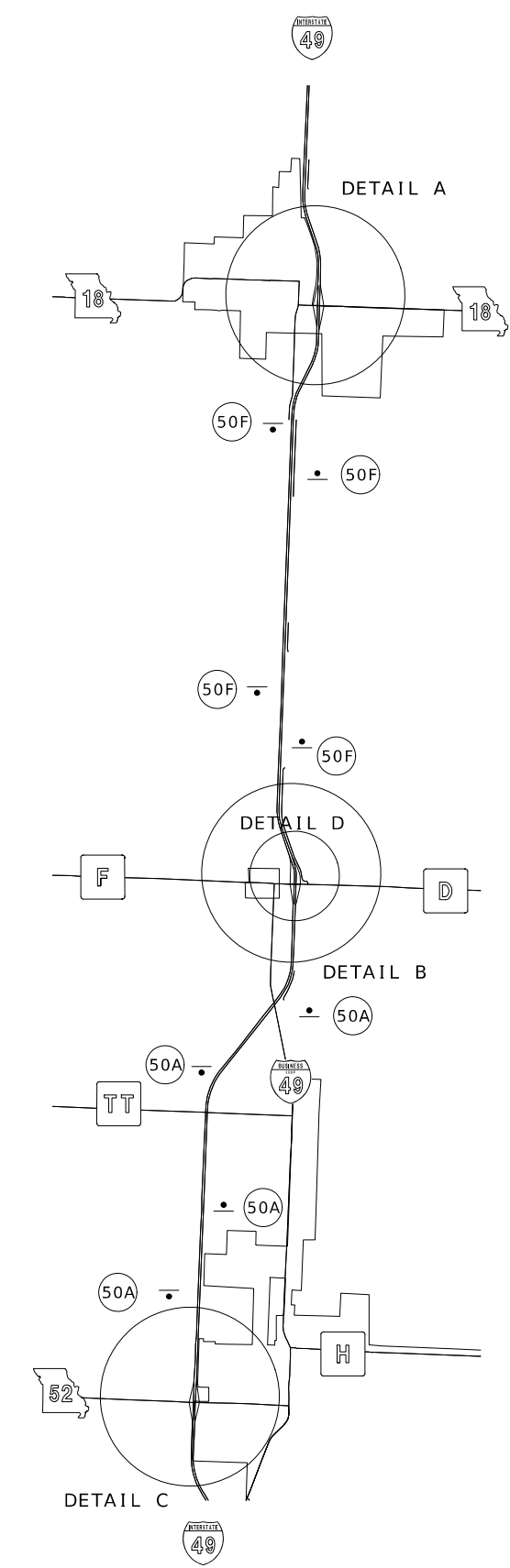

STATIONARY LANE CLOSURE ON A DIVIDED HIGHWAY

SPEED	SIGN SPACING (FT)	MINIMUM TAPER LENGTH (L) FOR LANE WIDTHS (W)			OPTIONAL BUFFER LENGTH (FT) (B)	CHANNELIZER SPACING (FT)	
		10 FT	11 FT	12 FT		TAPERS	BUFFER / WORK AREAS
0-35	200	205	225	245	250	35	40
40-45	500	450	495	540	360	40	80
50-55	1000	550	605	660	495	50	80
60-70	SA - 1000 SB - 1500 SC - 2640	700	770	840	730	60	120

NOTES:

TEMPORARY PAVEMENT MARKING REQUIRED WITH LONG TERM CLOSURES. NO DIRECT PAY.

REMOVE AND/OR MODIFY ANY EXISTING PAVEMENT MARKING AS NEEDED.

THIS INFORMATION ALSO SHALL BE USED WHEN WORK IS BEING PERFORMED IN THE LANE ADJACENT TO THE MEDIAN ON A DIVIDED HIGHWAY. IN THIS CASE, THE LEFT LANE CLOSED SIGNS AND THE CORRESPONDING MERGE OR LANE ENDS SIGNS SHALL BE SUBSTITUTED.

WHEN A SIDE ROAD INTERSECTS THE HIGHWAY WITHIN THE TTC ZONE, ADDITIONAL TTC DEVICES SHALL BE PLACED AS NEEDED. AN ARROW BOARD SHALL BE USED WHEN A FREEWAY LANE IS CLOSED.

WHEN MORE THAN ONE FREEWAY LANE IS CLOSED, A SEPARATE ARROW BOARD SHALL BE USED FOR EACH CLOSED LANE.

SEE TRAFFIC CONTROL SHEET 7 OF 7 FOR TEMPORARY SIGNING LEGEND AND OTHER TRAFFIC CONTROL NOTES.

TRAFFIC CONTROL LEGEND

- SIGN (SINGLE SIDED)
- CHANNELIZER
- FLASHING ARROW PANEL

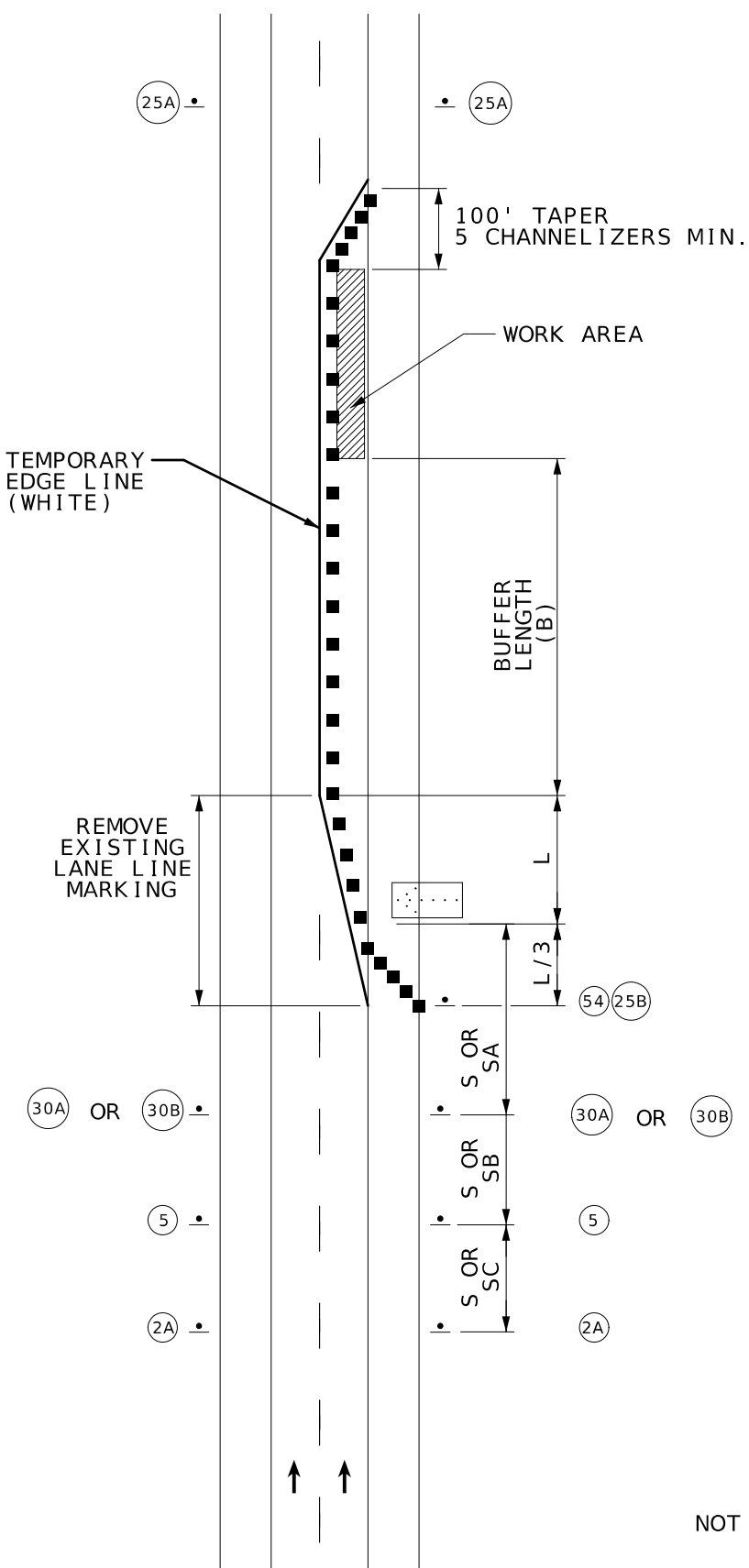

NOT TO SCALE
TRAFFIC CONTROL
SHEET 6 OF 7

SHANNON M. KELLNER
NUMBER PE-201015763
PROFESSIONAL ENGINEER

THIS SHEET HAS BEEN SIGNED, SEALED AND DATED ELECTRONICALLY.

DATE PREPARED 3/2/2026	
ROUTE D	STATE MO
DISTRICT SW	SHEET NO. 15
COUNTY BATES	
JOB NO. JSR0134	
CONTRACT ID.	
PROJECT NO.	
BRIDGE NO.	
DESCRIPTION	DATE
<p>MISSOURI HIGHWAYS AND TRANSPORTATION COMMISSION</p> <p>105 WEST CAPITOL JEFFERSON CITY, MO 65102 1-888-ASK-MODOT (1-888-275-6636)</p>	

Passaic
Butler 4

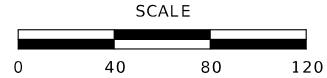
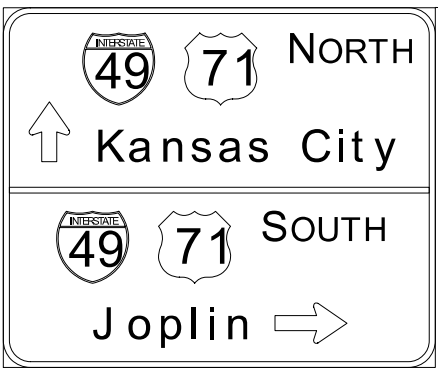
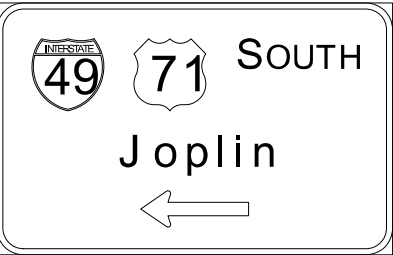
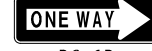
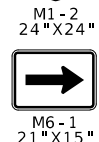

STATE OF MISSOURI
SHANNON M. KELLNER
NUMBER PE-201015763
PROFESSIONAL ENGINEER
THIS SHEET HAS BEEN SIGNED, SEALED AND DATED ELECTRONICALLY.
DATE PREPARED 3/2/2026
ROUTE 2
STATE MO
DISTRICT SW SHEET NO. 18
COUNTY BATES
JOB NO. JSR0134
CONTRACT ID.
PROJECT NO.
BRIDGE NO.

DATE	DESCRIPTION

MISSOURI HIGHWAYS AND TRANSPORTATION COMMISSION
MoDOT
105 WEST CAPITOL
JEFFERSON CITY, MO 65102
1-888-ASK-MODOT (1-888-275-6636)

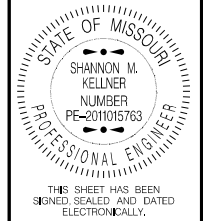
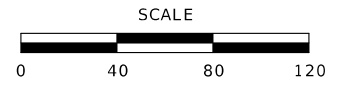

DATE PREPARED
3/2/2026

ROUTE	STATE
D	MO
DISTRICT	SHEET NO.
SW	19

COUNTY
BATES

JOB NO.
JSR0134

CONTRACT ID.

PROJECT NO.

BRIDGE NO.

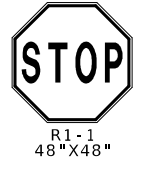
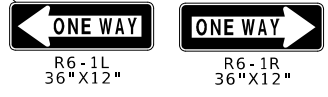
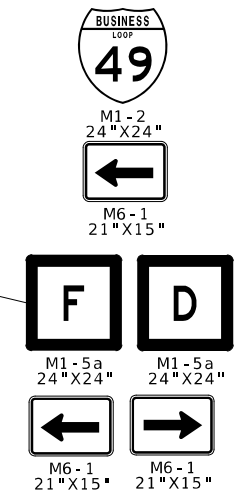
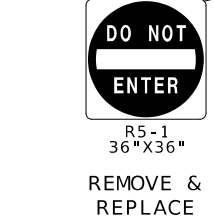
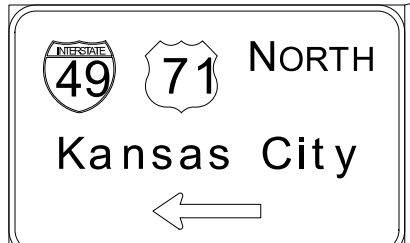
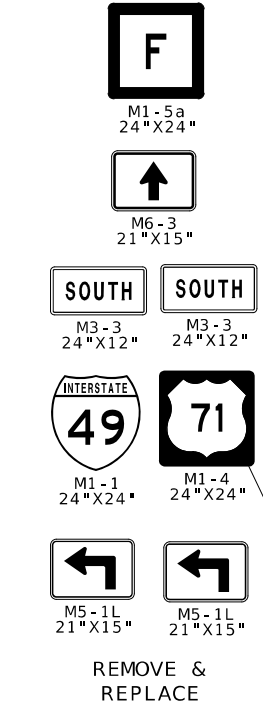
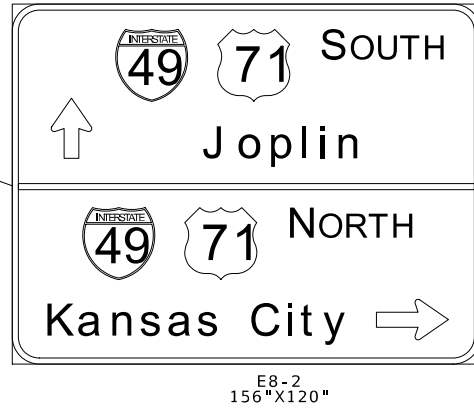

DESCRIPTION

DATE

MISSOURI HIGHWAYS AND TRANSPORTATION COMMISSION

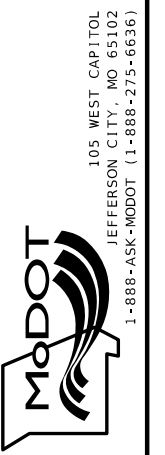

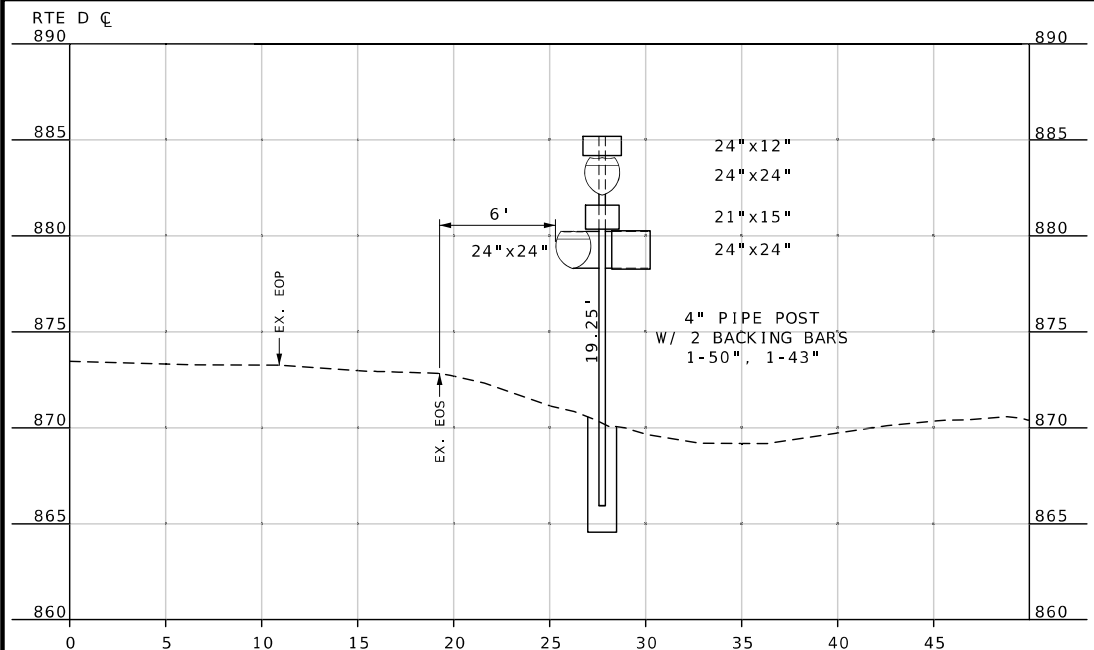

① STA 0+90.70
RT OF RTE D

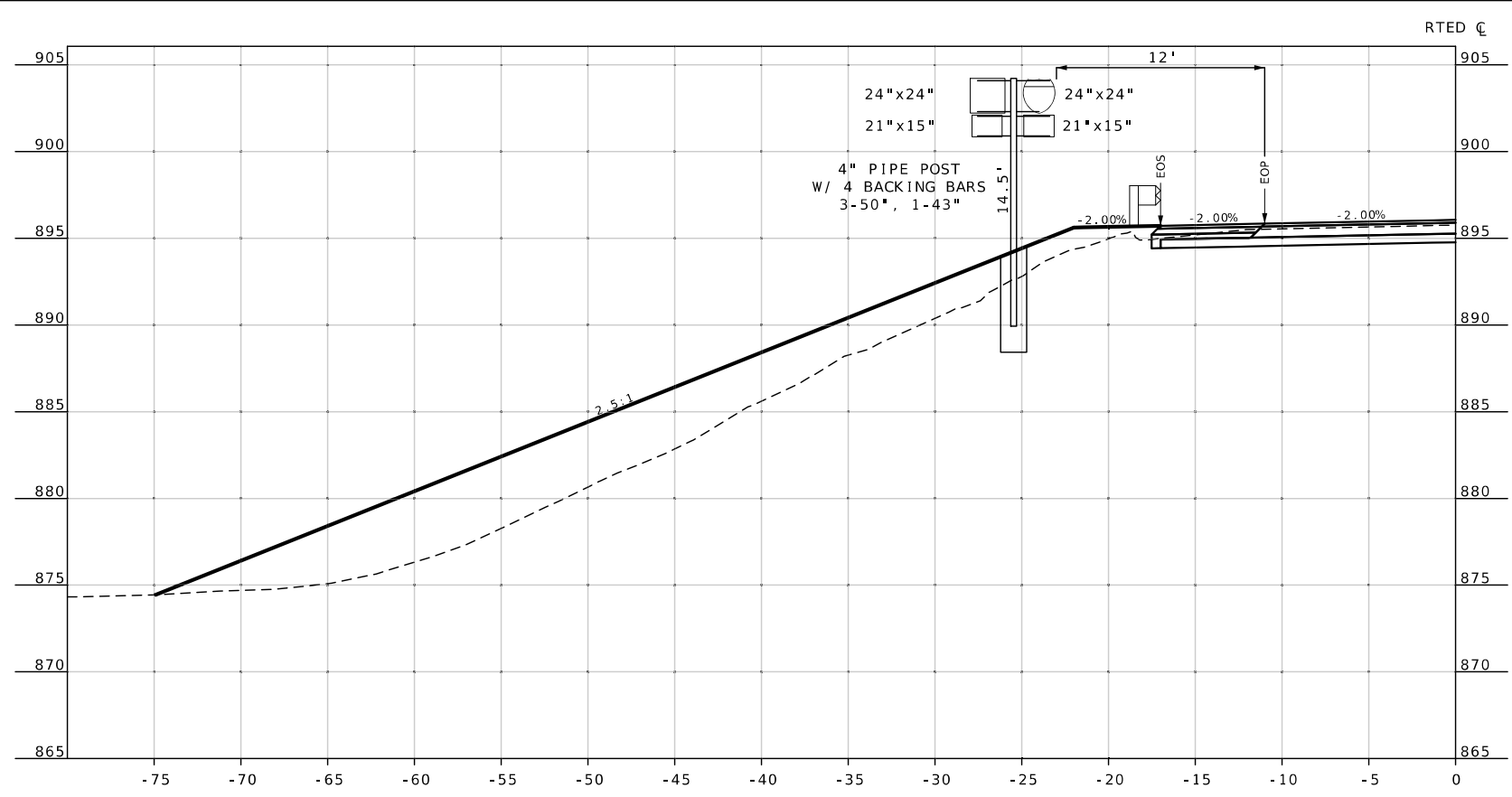

④ STA 5+50.80
LT OF RTE D

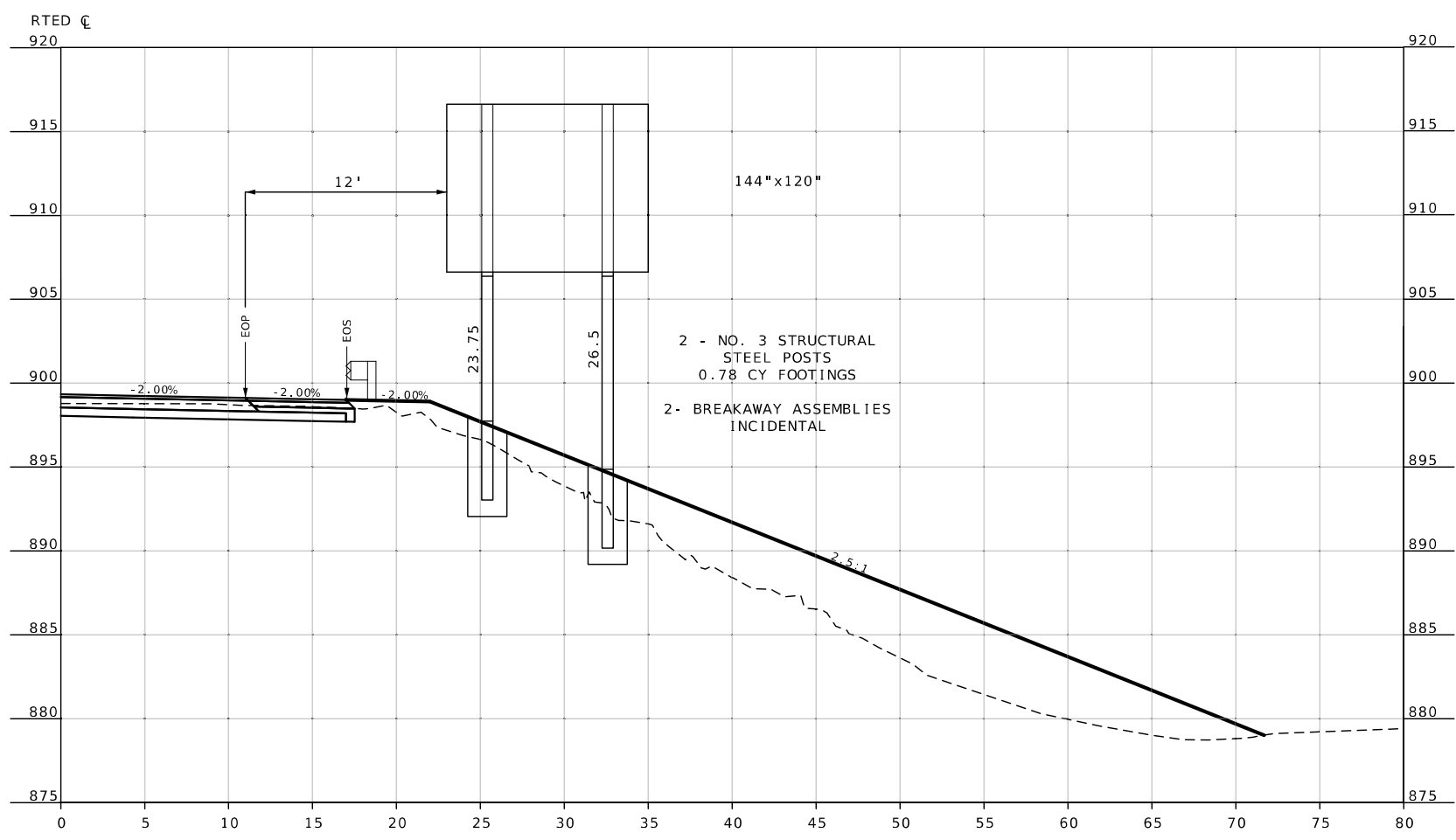

⑥ STA 6+27.01
RT OF RTE D

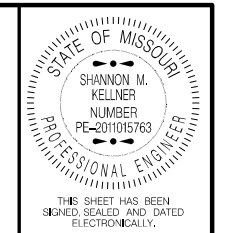

DATE PREPARED
3/2/2026
ROUTE D STATE MO
DISTRICT SW SHEET NO. 22
COUNTY BATES
JOB NO. JSR0134
CONTRACT ID.
PROJECT NO.
BRIDGE NO.

DATE	DESCRIPTION

MISSOURI HIGHWAYS AND TRANSPORTATION COMMISSION

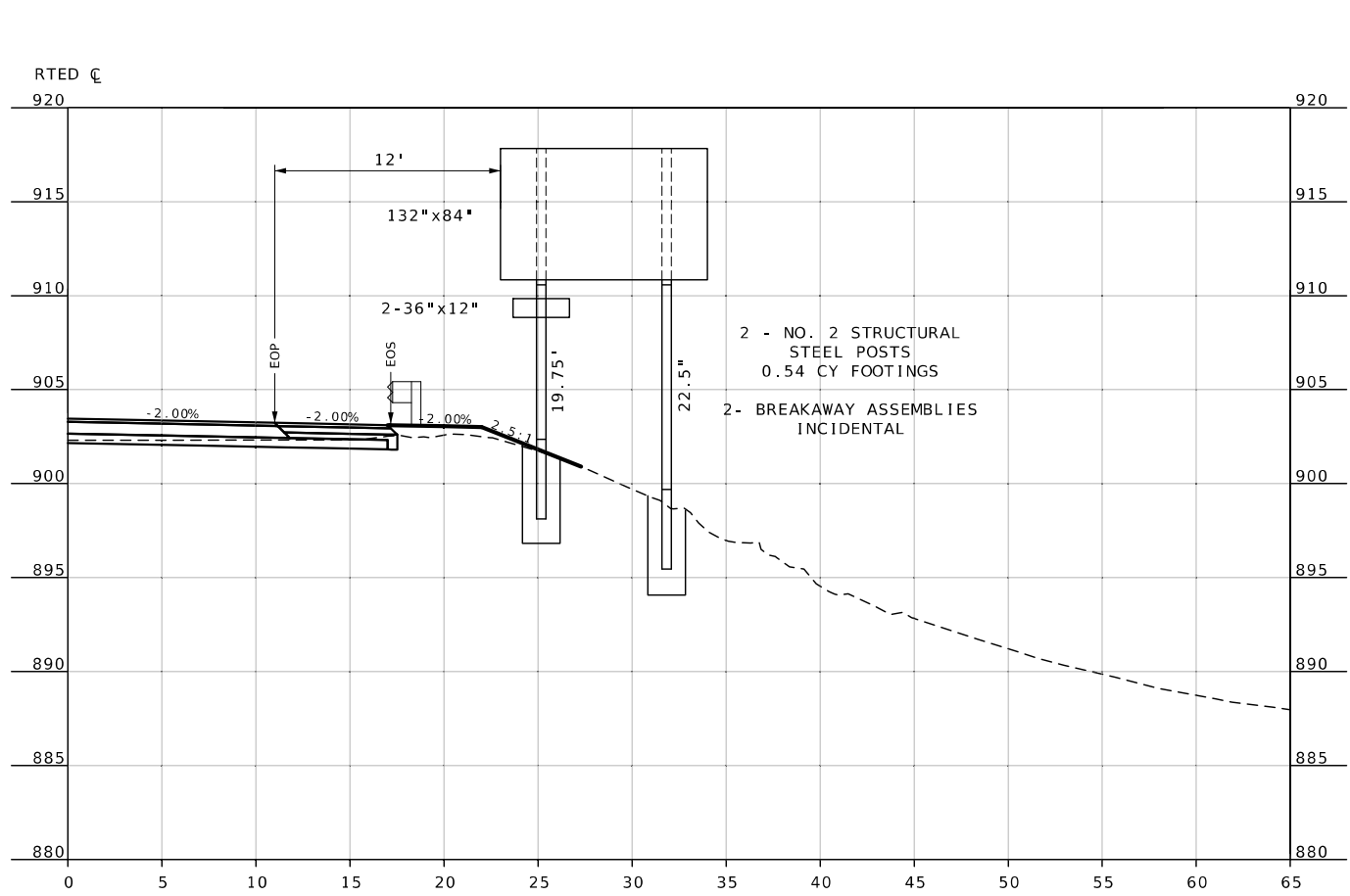
 105 WEST CAPITOL
 JEFFERSON CITY, MO 65102
 1-888-ASK-MODOT (1-888-275-6636)

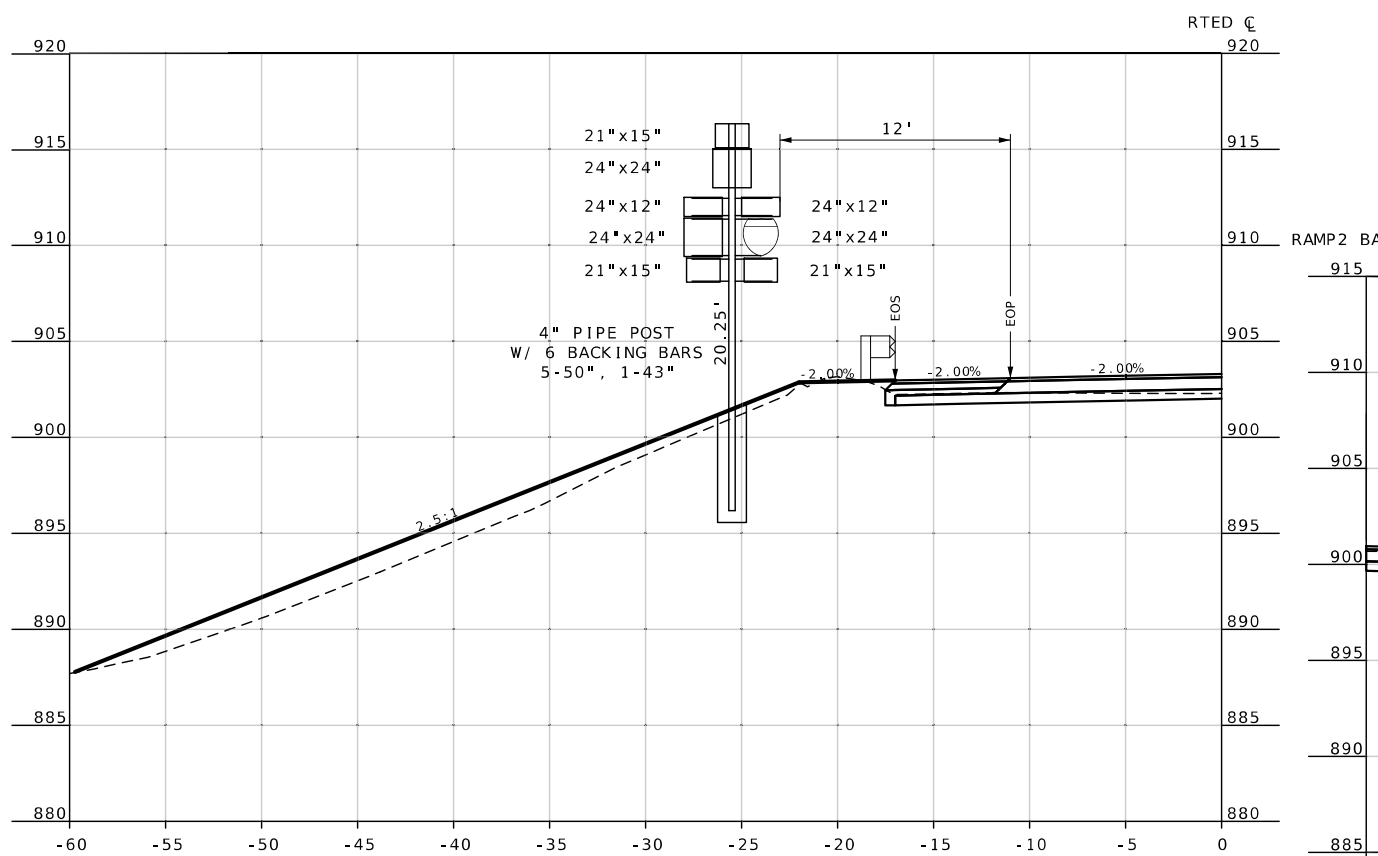

13 STA 11+03.94
RT OF RTE D

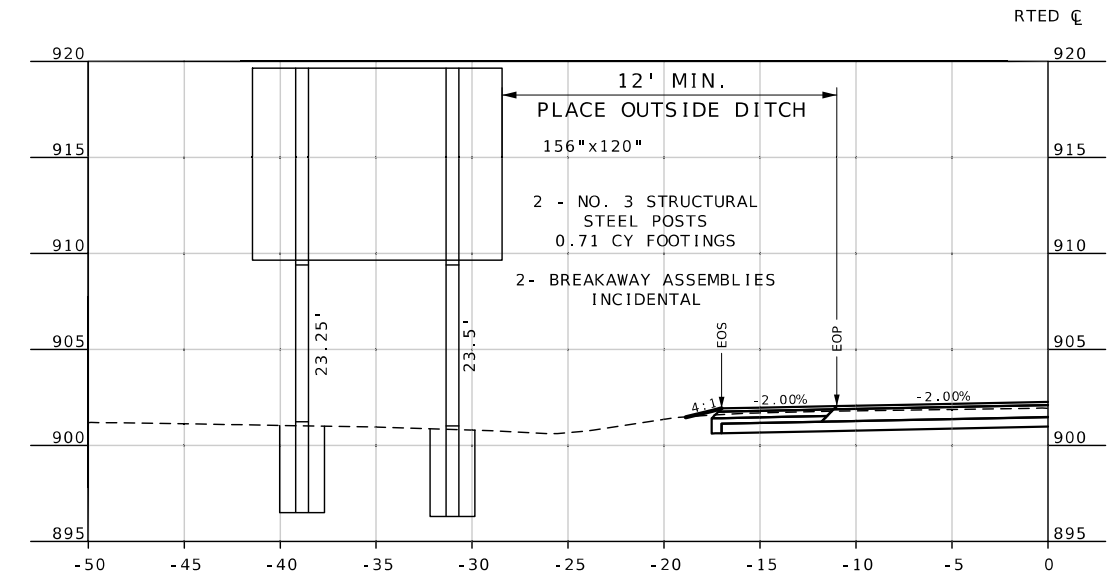

14 STA 11+22.88
LT OF RTE D



21 STA 12+73.31
LT OF RTE D

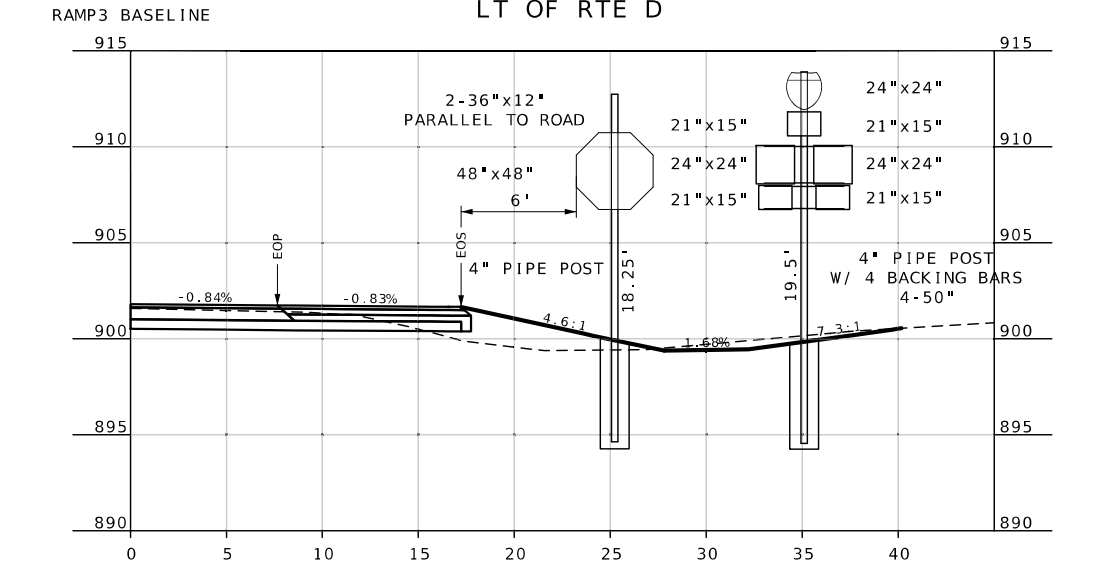

19 20 STA 14+24.62
RT OF RAMP 3

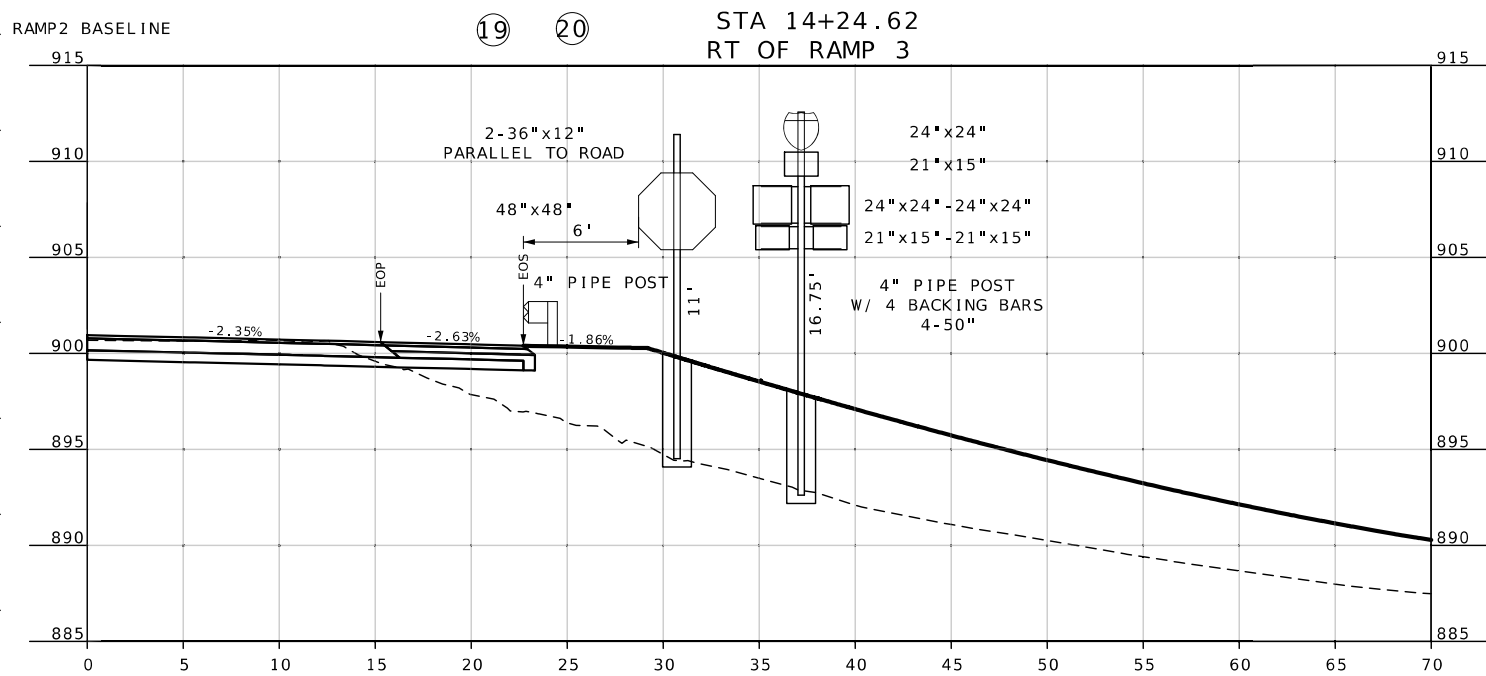

5 7 STA 15+23.30
RT OF RAMP 2

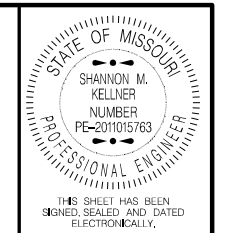

DATE PREPARED
3/2/2026
ROUTE D STATE MO
DISTRICT SW SHEET NO. 24
COUNTY BATES
JOB NO. JSR0134
CONTRACT ID.
PROJECT NO.
BRIDGE NO.

DATE	DESCRIPTION

MISSOURI HIGHWAYS AND TRANSPORTATION COMMISSION
105 WEST CAPITOL
JEFFERSON CITY, MO 65102
1-888-ASK-MODOT (1-888-275-6636)



